

**MCCALL-DONNELLY JT. SCHOOL DISTRICT NO. 421
BOARD OF TRUSTEES
REGULAR MEETING AGENDA**

LOCATION: McCall-Donnelly High School Commons, 401 N Mission, McCall, ID 83638
DATE: November 14, 2022
TIME: 6:00 PM

1. Call to Order	
2. Pledge of Allegiance	
3. Announcement of Changes/ additions to the agenda	
4. Awards and Recognition	
a. Fall Sports Awards	2
5. Consent Agenda	
a. Minutes of the October 10, 2022 Regular Meeting	4
b. Monthly Financials	
1. District Financials	7
2. ASB Financials	21
c. Resignations	40
6. Audience and Communication	
a. Policy 3113 - Ashley Pernell	41
7. Reports	
a. 5 Year Facilities Maintenance Plan	42
b. MDHS CTE Program Update - Tim Thomas	44
c. Construction Update	48
d. SDE Student Transportation Spot Inspection Report	49
e. Fall Assessment Data	54
f. Continuous Improvement Plan Community Forum	59
g. Crestline Academy Lease Update	60
8. Action Items	
a. New Intervention Paraprofessional Position - Heartland High School (Class Size)	80
b. New Teacher Position - Barbara R. Morgan Elementary School (Class Size)	81
c. High Reliability Schools Summit Attendance Request	82
d. Out of State Attendance Request - KC Wheeler	83
e. Moving Developmental Preschool to the District Office	85
f. Idaho Workforce Development Grant Opportunity	86
g. EPA Bus Rebate Program	87
h. Policy 5460 Housing Assistance Program Review	88
i. Gifted & Talented 3 year plan	89
j. Memorandum of Understanding with McCall Police Department (FERPA)	120
k. Selection of Construction Manager/General Contractor for Staff Housing Project	125
9. Executive Session	
a. To acquire an interest in real property not owned by a public agency	
10. Adjournment	

Note: Because of the need to efficiently conduct its business within the available time, and to deal with situations where unexpected issues arise and/or where the Board needs to address issues not on the Agenda, the Agenda may be modified either before or at the meeting.

Notice of this agenda has been given to the public by posting conspicuously, forty-eight (48) hours prior to the time for convening the meeting at the following public buildings within the District.

Bianca Imel
 Bianca Imel, Board Clerk
 McCall-Donnelly Jt. School District No. 421
 Valley and Adams Counties, Idaho



**THE MCCALL-DONNELLY
BOOSTER CLUB PRESENTS
FALL SPORTS AWARDS DESSERT
NOVEMBER 9, 2022**

6:00 Dessert Commons

6:20 Welcome Conor Kennedy

6:25 Introduction of Coaches:

Cross Country	Ted McManus
Boys' Soccer	Brad Kindall
Girls' Soccer	Mike Maini
Volleyball	Amber Green
Football	Lee Leslie

6:35 Team Assignments:

Football	Gym
Girls Soccer	Commons
Boys' Soccer	Library
Volleyball	MPR
Cross Country	Heartland High School

ADMINISTRATORS:

Superintendent: Eric Pingrey
Principal: Tim Thomas
Athletic Director: Conor Kennedy

SCHOOL BOARD
Jeremy Griffin
Jon Walker
Jim Cole
Laurie Erekson
Jill Wright

SECRETARIAL STAFF:
Lauren Bevill
Daniel Wheeler

BOOSTER CLUB OFFICERS:

President: Stephanie Sorensen Vice President: Julia Newman Secretary: Christine Naugle
Merchandise: Maria Ames Membership: Katie Morgan Member at Large: Deanne Langreder

FALL SPORTS ACHIEVEMENTS 2022:

*** 6 TEAMS WITH GPA OF 3.0 OR HIGHER:**

BOYS CROSS COUNTRY 3.63
GIRLS CROSS COUNTRY 3.71
GIRLS SOCCER 3.60
BOYS SOCCER 3.42
VOLLEYBALL 3.44
FOOTBALL 3.13

***27 ATHLETES WITH A GPA OF 3.75 OR ABOVE**

Jake See
Lauren Nelson
Zach Atchley
Claire Warren
Lee Kindall
Rylan Pate
Ella Carey
Sofia Monahan
Ensi Armacost

Daniel Jackson
Keelee Burns
George Speirs
Delaney Ott
Leo Gelardi
Josh Sorensen
Ella Klasner
Peyton Lathrop
Lauren Mapp

Michael Wyman
Olivia Cline
Jack McManus
Grace Esplin
Bogdan Monahan
Kaiya Wave
Tylie Value
Sadie Berry
Liliana Mihlfeith

FOOTBALL
4TH PLACE SRV
STATE FIRST ROUND GAME

VOLLEYBALL
3RD PLACE LEAGUE
QUALIFIED FOR STATE TOURNAMENT

GIRLS SOCCER
1ST PLACE SRV LEAGUE
QUALIFIED FOR STATE TOURNAMENT

BOYS SOCCER
1ST PLACE SRV LEAGUE
DISTRICT CHAMPIONS
4TH PLACE STATE TOURNAMENT

CROSS COUNTRY:
GIRLS DISTRICT CHAMPION
QUALIFIED FOR STATE TOURNAMENT
BOYS 2ND PLACE DISTRICT
QUALIFIED FOR STATE TOURNAMENT
JACK MCMANUS 2ND PLACE, GEORGE SPEIRS 7TH PLACE
TAYLOR NALDER, 12TH PLACE

The Regular Meeting of the Board of Trustees of McCall-Donnelly Joint School District No. 421, Valley and Adams Counties, Idaho, was convened on Monday, October 10, 2022, at 6:00 p.m. at the McCall-Donnelly High School Commons, 401 N Mission, McCall, Idaho, in said District, as provided in Section 33-510, Idaho Code.

1. CALL TO ORDER

Trustee Walker convened the Regular Meeting with the Call to Order at 6:01 p.m.

Trustees Present:	Jim Cole	Zone 1
	Jon Walker	Zone 2
	Jeremy Griffin	Zone 3
	Jill Wright	Zone 5

Also present:

Eric Pingrey, Superintendent

Bianca Imel, Board Clerk

Rachel Shrope, Board Clerk

Absent:

Laurie Erekson Zone 4

2. PLEDGE OF ALLEGIANCE

3. ANNOUNCEMENTS OF CHANGES/ADDITIONS TO THE AGENDA

None

4. AWARDS AND RECOGNITION

None

5. CONSENT AGENDA

- a. Minutes of the September 12, 2022 Regular Board Meeting**
- b. Minutes of the September 27, 2022 Special Meeting**
- c. Monthly Financials**

- c.1. District Financials**
- c.2. ASB Financials**
- d. New Hires**
- e. Resignations**
- f. Gift and Grant Approval**

Upon a motion by Trustee Cole, and a second by Trustee Wright, the Board voted to approve the consent agenda.

6. AUDIENCE AND COMMUNICATION

One patron requested a meeting with Superintendent Pingrey. Board of Trustees and Superintendent Pingrey acknowledged and confirmed they would reach out.

7. REPORTS

a. Fiscal Year 2022 District Financials Audit – Quest CPA’s PLLC

Kurt Folke of Quest CPA’s PLLC via zoom, presented the 2022 District Financials Audit Report. He states the audit went very well. Mr. Folke reviewed with the board the three main auditor’s reports. The reports provided that the figures are accurate and can be relied upon to make decisions. The reports verified that the District is in compliance and there were no findings or issues. Kurt Folke and the Board commended the work of Penny Lancaster, Director of Finance, for her continued efforts in properly overseeing the operations of District funds.

b. Sabbatical Presentation (School Climate) – Melissa Maini

Melissa Maini, 4th grade teacher, shared her learnings from her year-long sabbatical. During this time, she was able to study and be certified in mindfulness and breathing techniques for stress reduction. She is now back in the classroom and is excited to be teaching her students these techniques.

c. HRS Report (Academic Achievement) – Lisa Pingrey and Lesley Doane

Lisa Pingrey and Lesley Doane, instructional coaches, presented the ways they are creating more support for the District’s teaching staff. They are following the High Reliability Schools alignment that helps create a rubric of learning. Ms. Pingrey and Ms. Doane reported those who have participated have started using learned techniques the following day and department meetings feel they have focus.

d. Updated Fall 2022 Enrollment

Superintendent Pingrey presented 2022-2023 enrollment numbers currently at 1384, up from 1334 last year. He stated these numbers are trending with the ten-year projections for District growth.

8. ACTION ITEMS

a. Transfer of funds

Upon a motion by Trustee Cole and a second by Trustee Wright, the Board unanimously voted to approve the transfer of funds. Motion passed. No further discussion.

b. 2022-2023 MDSO Continuous Improvement Plan

Upon a motion by Trustee Wright, and a second by Trustee Cole, the Board unanimously voted to approve the MDSO Continuous Improvement Plan. Motion passed. No further discussion.

c. Concussion Protocol

Upon a motion by Trustee Griffin, and a second by Trustee Wright, the Board unanimously voted to approve the concussion protocol. Motion passed. No further discussion.

d. Professional Development Day February 24, 2023

Upon a motion by Trustee Griffin, and a second by Trustee Wright, the Board unanimously voted to approve the professional development day on February 24, 2023. Motion passed. No further discussion.

e. Co-Board Clerks

Upon a motion by Trustee Cole, and a second by Trustee Wright, the Board voted unanimously to approve the co-board clerks. Motion passed. No further discussion.

f. Administrative Assistant Extra Days

Upon a motion by Trustee Wright, and a second by Trustee Cole, the Board voted unanimously to approve the administrative assistant extra days. Motion passed. No further discussion.

9. ADJOURNMENT

ADJORN Whereas, the Board has no further business to conduct or come before it, the meeting adjourned at 6:42 p.m.

ATTEST:

Laurie Erikson, Chair

Bianca Imel, Clerk

Rachel Shrope, Co-Clerk

SUMMARY STATEMENT 2022 - 2023 REVENUE AND EXPENSE

GENERAL FUND

Ending October 31, 2022

GENERAL M & O FUND							
REVENUES	Prior Year Actual 2019-2020	Prior Year Actual 2020-2021	Prior Year Budget 2021-2022	Current Budget 2022-2023	Activity FY to Date 2022-2023	Unexpended Balance 2022-2023	Percentage FY to Date 2022-2023
Beginning Balances	4,859,512	5,512,515	5,839,982	3,503,483	-	3,503,483	0.00%
Local Tax Revenue	5,780,441	5,857,243	5,824,212	5,838,712	36,790	5,801,922	0.63%
Other Local	243,405	-	-			-	
County Revenue	-	-	-			-	
State Revenue	8,694,198	8,811,328	9,574,251	10,051,045	5,151,322	4,899,723	51.25%
Federal Revenue	7,624	418,675	-	-		-	0.00%
Other Sources					-	-	
Totals	19,585,180	20,599,761	21,238,445	19,393,240	5,188,112	14,205,128	26.75%
EXPENDITURES	Prior Year Actual 2019-2020	Prior Year Actual 2020-2021	Prior Year Budget 2021-2022	Current Budget 2022-2023	Activity FY to Date 2022-2023	Unexpended Balance 2022-2023	Percentage FY to Date 2022-2023
Salaries	8,408,260	8,519,667	9,150,492	9,873,499	1,956,519	7,916,980	19.82%
Benefits	2,904,514	2,957,383	3,306,934	3,636,778	797,011	2,839,767	21.92%
Purchased Services	1,989,391	2,477,066	2,542,186	2,493,749	717,590	1,776,159	28.78%
Supplies & Materials	532,407	442,768	580,650	636,900	142,336	494,564	22.35%
Capital Outlay	171,365	215,731	280,300	364,530	219,683	144,847	60.26%
Debt Retirement						-	
Insurance & Judgments	66,728	65,219	69,400	126,774	78,126	48,648	61.63%
Transfers (net)	-	81,945	1,780,000	50,000	1,884,069	(1,834,069)	3768.14%
Contingency Reserve	-		25,000	25,000	-		
Unappropriated Balances	5,512,515	5,839,982	3,503,483	2,186,010	-	2,186,010	
Totals	19,585,180	20,599,761	21,238,445	19,393,240	5,795,334	13,572,906	29.88%

OTHER FUND SUMMARY REPORT

McCall Donnelly School District #421

Ending October 31, 2022

Summary Statement --Other Funds --Revenue and Expense

FUND	Account	Budget	Monthly Activity	FY to Date Activity	Unexpended Balance	FY to Date Percent
220 - Federal Forest Fund	Revenue	1,500.00	-	269.98	1,230.02	18.00%
	Expense	337,836.00	1,389,723.89	1,411,325.43	(1,073,489.43)	417.75%
230 - MDSO Employee Housing	Revenue	-	-	1,691,425.46	(1,691,425.46)	0.00%
	Expense	-	425.00	425.00	-	0.00%
231 - MDEF Grant	Revenue	49,176.00	49,176.00	49,176.00	-	100.00%
	Expense	49,176.00	23,593.92	35,784.36	13,391.64	72.77%
232 - Dual Credit/AO	Revenue	5,550.00	6,075.00	6,075.00	(525.00)	109.46%
	Expense	12,000.00	1,800.00	11,074.28	925.72	92.29%
233 - Expanding Arts Grant - SDE	Revenue	15,000.00	-	15,000.00	-	0.00%
	Expense	15,000.00	943.60	943.60	14,056.40	6.29%
241 - Driver Education	Revenue	34,000.00	307.00	15,312.00	18,688.00	45.04%
	Expense	37,150.00	5,191.63	24,383.01	12,766.99	65.63%
243 - State Professional Technical	Revenue	39,779.00	-	-	39,779.00	0.00%
	Expense	39,779.00	6,559.73	14,084.88	25,694.12	35.41%
245 - State Instructional Technology	Revenue	142,500.00	-	-	142,500.00	0.00%
	Expense	142,500.00	-	30,674.44	111,825.56	21.53%
246 - State Substance Abuse	Revenue	10,300.00	-	-	10,300.00	0.00%
	Expense	43,000.00	8,263.02	8,263.02	34,736.98	19.22%
250 - ESSER III Funds	Revenue	295,000.00	-	-	295,000.00	0.00%
	Expense	295,000.00	1,600.00	79,979.07	215,020.93	27.11%
251 - Title I-A	Revenue	154,919.00	-	-	154,919.00	0.00%
	Expense	154,919.00	12,061.57	46,398.75	108,520.25	29.95%
254 - ESSER II Funds	Revenue	546,019.00	-	-	546,019.00	0.00%
	Expense	546,019.00	17,819.61	53,922.30	492,096.70	9.88%
257 - IDEA Part B School Age	Revenue	227,747.00	-	-	227,747.00	0.00%
	Expense	227,747.00	21,405.07	78,951.57	148,795.43	34.67%
258 - IDEA Part B - Preschool	Revenue	8,490.00	-	-	8,490.00	0.00%
	Expense	8,490.00	993.62	2,116.81	6,373.19	24.93%
260 - School Based Medicaid	Revenue	200,000.00	-	(6,558.92)	206,558.92	-3.28%
	Expense	200,000.00	34,159.96	37,172.62	162,827.38	18.59%
261 - Title IV-A	Revenue	19,931.00	-	-	19,931.00	0.00%
	Expense	19,931.00	1,397.28	3,287.28	16,643.72	16.49%
262 - Title VI-B Rural Education	Revenue	21,936.00	-	-	21,936.00	0.00%
	Expense	21,936.00	-	-	21,936.00	0.00%
271 - Title II-A	Revenue	31,694.00	-	-	31,694.00	0.00%
	Expense	31,694.00	1,420.46	12,160.21	19,533.79	38.37%
290 - Food Services	Revenue	514,256.00	21,641.00	87,325.80	426,930.20	16.98%
	Expense	514,256.00	63,027.24	119,806.00	394,450.00	23.30%
310 - Debt Services	Revenue	2,353,275.00	-	77,757.31	2,275,517.69	3.30%
	Expense	2,350,275.00	-	1,848,475.00	501,800.00	78.65%
410 - Major Maintenance	Revenue	12,212,000.00	-	2,540,734.46	9,671,265.54	20.81%
	Expense	12,212,000.00	830,289.29	5,338,929.01	6,873,070.99	43.72%
412 -Capital Improvement Fund	Revenue	-	1,884,068.94	1,884,068.94	(1,884,068.94)	
	Expense	-	330,000.06	2,214,069.00	(2,214,069.00)	
710 - MDSO EE Scholarship	Revenue	2,000.00	259.00	736.00	1,264.00	36.80%
	Expense	2,000.00	-	3,000.00	(1,000.00)	150.00%
720 - Neisinger Scholarship	Revenue	200.00	-	56.56	143.44	28.28%
	Expense	1,000.00	-	-	1,000.00	0.00%
730- DES Scholarship	Revenue	1,000.00	110.00	380.00	620.00	38.00%
	Expense	1,000.00	-	500.00	500.00	50.00%
Totals	Revenue	16,886,272.00	1,961,636.94	6,361,758.59	12,215,938.87	413.38%
	Expense	17,262,708.00	2,750,674.95	11,375,300.64	5,887,407.36	12.70

CHECK NUMBER	CHECK DATE	VENDOR	AMOUNT	INVOICE NUMBER	INVOICE DESCRIPTION
21390	10/25/2022	Blue Cross of Idaho	-21,859.45	20220825AD	Payroll accrual
21390	10/25/2022	Blue Cross of Idaho	-1,074.18	20220825AD	Payroll accrual
21390	10/25/2022	Blue Cross of Idaho	-17,803.17	20220825AF	Payroll Benefit
21390	10/25/2022	Blue Cross of Idaho	-41,833.70	20220825AF	Payroll Benefit
21390	10/25/2022	Blue Cross of Idaho	-54,241.55	20220825AF	Payroll accrual
21390	10/25/2022	Blue Cross of Idaho	-360.80	20220825EA	65 + 71 MEMBERS = 136 X \$2.80/EACH = \$360.80
21471	10/12/2022	Office Savers Online	-1,849.99	8052	supplies
21539	10/17/2022	4 Corners Communicat	620.00	3154	Invoice 3151, 3152, 3153, 3154 MDHS, PLMS, BRMES, HHS security camera and vape detector cabling and installation
21539	10/17/2022	4 Corners Communicat	1,897.12	3153	Invoice 3151, 3152, 3153, 3154 MDHS, PLMS, BRMES, HHS security camera and vape detector cabling and installation
21539	10/17/2022	4 Corners Communicat	3,029.95	3152	Invoice 3151, 3152, 3153, 3154 MDHS, PLMS, BRMES, HHS security camera and vape detector cabling and installation
21539	10/17/2022	4 Corners Communicat	2,715.95	3151	Invoice 3151, 3152, 3153, 3154 MDHS, PLMS, BRMES, HHS security camera and vape detector cabling and installation
21540	10/17/2022	A Plus Awards	181.50	32164	AP Plaques
21541	10/17/2022	AllWest Testing & En	7,458.60	26880	DES work
21542	10/17/2022	Alpine Automotive	284.02	27055	2017 Ford F350 lube, oil, filter
21543	10/17/2022	Amazon	235.67	4364993664	Amazon September 2022
21543	10/17/2022	Amazon	656.38	8686584638	Amazon September 2022
21543	10/17/2022	Amazon	901.58	4467888384	parking lot lights
21543	10/17/2022	Amazon	21.98	9995666793	supplies
21543	10/17/2022	Amazon	1,716.97	5583665688	Abrams, Heflin, Herbst, Library, Office, Paper, Pickard, Playground, Reading Room, Sick Room, Stegner, Supply Closet
21543	10/17/2022	Amazon	3,600.99	9747486335	SUPPLIES
21543	10/17/2022	Amazon	2,696.84	7386986637	Supplies
21543	10/17/2022	Amazon	183.26	8648789638	SUPPLIES - dry erase boards for math classroom
21543	10/17/2022	Amazon	46.32	4655366463	JEDRY - calculators
21543	10/17/2022	Amazon	102.01	4459543999	STONE - supplies
21543	10/17/2022	Amazon	209.97	6797849794	ARRASMITH - desk risers
21543	10/17/2022	Amazon	138.99	4375474888	STONE - air purifier
21543	10/17/2022	Amazon	8,701.50	9783663684	September Amazon Purchases
21544	10/17/2022	Anderson Julian & Hu	546.00	77341	Legal Services
21545	10/17/2022	Beaver, Emily	12,827.50	101722	Occupational Services
21546	10/17/2022	Brodhecker, Sara	138.13	101422	Reim mileage
21546	10/17/2022	Brodhecker, Sara	45.33	1014221	Reimbursement Supplies
21547	10/17/2022	Builders FirstSource	352.34	86110437,8	Shop Supplies
21547	10/17/2022	Builders FirstSource	15.38	86195174	supplies
21547	10/17/2022	Builders FirstSource	17.88	86141156	supplies

CHECK	CHECK		INVOICE	INVOICE	
NUMBER	DATE	VENDOR	AMOUNT	NUMBER	DESCRIPTION
21547	10/17/2022	Builders FirstSource	204.04	61285957	Shop Supplies
21547	10/17/2022	Builders FirstSource	70.79	86107315	Shop Supplies
21548	10/17/2022	Campbell Tractor and	171.14	N25541	hydraulic reser, freight
21549	10/17/2022	Canon Financial Serv	1,379.00	29206417	Copiers
21550	10/17/2022	Caxton Printers Ltd	2,118.69	1044373	Spanish Consumables for PLMS Math Team
21551	10/17/2022	CDW Government Inc	660.33	CT71664	Lenovo 34" Monitor New payroll clerk
21551	10/17/2022	CDW Government Inc	409.47	CV38819	Long HDMI cables Wireless Display Adapters
21551	10/17/2022	CDW Government Inc	184.80	CZ83791	Long HDMI cables Wireless Display Adapters
21551	10/17/2022	CDW Government Inc	684.28	DC67830	Monitor
21552	10/17/2022	Cengage Learning	336.00	79302948	Life 2E Ame student books, app
21552	10/17/2022	Cengage Learning	16.97	79406444	
21553	10/17/2022	Childrens Health Mar	43.13	49982	5 additional K copies for DES
21554	10/17/2022	Clay, Jason	50.00	101222	Reim cell phone
21555	10/17/2022	CM Company, Inc	803,567.95	101422	DES project
21556	10/17/2022	CNA Surety Direct Bi	60.00	101222	Premium for ID Notary Public Ginger Hughes
21557	10/17/2022	Companion Corporatio	5,192.00	122450	Alexandria Library Software Renewal - 2022-2023
21558	10/17/2022	Consolidated Electri	66.04	4438-10175	supplies
21559	10/17/2022	Core Health and Fitn	14,286.41	110853817	Spin Bikes
21559	10/17/2022	Core Health and Fitn	1,390.00	110853757	Spin Bikes
21560	10/17/2022	Curriculum Associate	17,820.00	90206755	110 IReady Intervention Licenses (six years)
21560	10/17/2022	Curriculum Associate	195.72	90704086	INTERVENTION - 4 First Level Student Books (5 pack), 1 First Level Teacher Guide Order #60125976
21560	10/17/2022	Curriculum Associate	178.98	90205183	INTERVENTION- 4, Second Level Student Book 5 Pack Phonics for Reading
21560	10/17/2022	Curriculum Associate	402.70	90203283	INTERVENTION - 9, Second Level Student Book 5 Pack Phonics for Reading
21561	10/17/2022	D&A Door and Special	1,402.51	SI031998	supplies
21562	10/17/2022	Davydov, Brandi	47.78	101322	DAVYDOV reimbursement - supplies
21563	10/17/2022	Decker Equipment	1,198.50	491089B	Standing desks and stools
21564	10/17/2022	Department of Health	1,309.47	August 202	Medicaid match
21564	10/17/2022	Department of Health	1,349.15	Sept 2022	Medicaid match
21565	10/17/2022	Design West Architec	9,440.68	21054-13	#21054 DES bldg addition construction administration
21565	10/17/2022	Design West Architec	9,440.68	21054-12	DES construction administration
21566	10/17/2022	Directv	6.25	076082149X	MDHS Business channels
21567	10/17/2022	Dittmer, Cynthia	292.54	101322	Reim Id art educators conference 10/01/22
21568	10/17/2022	Donnelly Rural Fire	150.00	10622	CPR class for staff
21569	10/17/2022	Donnelly City of	281.03	101022	DES water,sewer
21570	10/17/2022	Dunkley Music Inc	2,660.89	multiple	Music Repairs
21570	10/17/2022	Dunkley Music Inc	84.27	4217117	Classroom Supplies
21571	10/17/2022	Ecolab Inc	7,756.40	6270794740	NX Conc Sani
21572	10/17/2022	Ed Staub & Sons	296.06	8214084	Maint Propane

CHECK NUMBER	CHECK DATE	VENDOR	AMOUNT	INVOICE NUMBER	INVOICE DESCRIPTION
21573	10/17/2022	Edmentum	1,444.90	195439	Plato Licenses for HHS
21574	10/17/2022	EdNetics	6,100.73	116823	Phone Service
21574	10/17/2022	EdNetics	856.75	116531	New District Office - Additional Phones Cisco 8811
21575	10/17/2022	Elevate 208, LLC	1,225.00	101422	Counseling
21576	10/17/2022	Fatbeam LLC	2,100.00	29162	internet charges
21577	10/17/2022	Ferguson Enterprises	394.30	0858757	supplies
21577	10/17/2022	Ferguson Enterprises	15.53	0862023	supplies
21577	10/17/2022	Ferguson Enterprises	-40.68	CM171688	credit for supplies
21577	10/17/2022	Ferguson Enterprises	50.83	0844816	supplies
21578	10/17/2022	Fisher's Document Sy	1,778.61	1072109	Copies
21579	10/17/2022	Flinn Scientific Inc	276.65	2716510	ESSER Supplies
21579	10/17/2022	Flinn Scientific Inc	86.05	2732857	ESSER Science Supplies
21580	10/17/2022	Glass Pro Inc	211.40	2310	class for nurses area
21580	10/17/2022	Glass Pro Inc	594.23	2368	2018 Chevy Traxx windshield
21580	10/17/2022	Glass Pro Inc	742.60	2381	New DO replace failed seal in picture window
21581	10/17/2022	Gold Star Foods Nort	661.81	3171459	DES
21581	10/17/2022	Gold Star Foods Nort	592.17	3171458	DES
21581	10/17/2022	Gold Star Foods Nort	946.31	3171464	BRMES
21581	10/17/2022	Gold Star Foods Nort	29.82	3171465	BRMES
21581	10/17/2022	Gold Star Foods Nort	1,068.87	3171469	BRMES
21581	10/17/2022	Gold Star Foods Nort	885.76	3171468	MDHS
21581	10/17/2022	Gold Star Foods Nort	949.83	3171470	MDHS
21581	10/17/2022	Gold Star Foods Nort	21.30	3171471	MDHS
21581	10/17/2022	Gold Star Foods Nort	987.05	3171010	PLMS
21581	10/17/2022	Gold Star Foods Nort	21.30	3171455	PLMS
21581	10/17/2022	Gold Star Foods Nort	963.91	3171456	PLMS
21582	10/17/2022	Grainger	93.33	9437872907	supplies
21583	10/17/2022	Grasmick Produce Com	87.75	01812350	Supplies
21583	10/17/2022	Grasmick Produce Com	225.95	01814688	Supplies
21583	10/17/2022	Grasmick Produce Com	135.32	01817455	Supplies
21583	10/17/2022	Grasmick Produce Com	299.97	01819967	Supplies
21583	10/17/2022	Grasmick Produce Com	150.05	01811789	Supplies
21583	10/17/2022	Grasmick Produce Com	51.18	01814315	Supplies
21583	10/17/2022	Grasmick Produce Com	146.40	01814068	Supplies
21583	10/17/2022	Grasmick Produce Com	242.80	01816852	Supplies
21583	10/17/2022	Grasmick Produce Com	185.78	01819396	Supplies
21583	10/17/2022	Grasmick Produce Com	81.80	01811855	Supplies
21583	10/17/2022	Grasmick Produce Com	273.46	01817000	Supplies
21583	10/17/2022	Grasmick Produce Com	147.00	01819940	Supplies

CHECK NUMBER	CHECK DATE	VENDOR	AMOUNT	INVOICE NUMBER	INVOICE DESCRIPTION
21583	10/17/2022	Grasmick Produce Com	477.45	01812349	Supplies
21583	10/17/2022	Grasmick Produce Com	315.00	01814685	Supplies
21583	10/17/2022	Grasmick Produce Com	478.30	01817466	Supplies
21583	10/17/2022	Grasmick Produce Com	470.00	01819968	Supplies
21584	10/17/2022	Grizzly Industrial	420.99	11054957-0	Shop Supplies
21585	10/17/2022	Harlow's School Bus	85,134.43	Sept 2022	Bus Routes
21586	10/17/2022	Harris, Michelle	120.59	101422	Supplies
21586	10/17/2022	Harris, Michelle	27.92	101722	Supplies Reimbursement
21587	10/17/2022	Haws, Jessica	24.38	101122	Reimburse mileage
21588	10/17/2022	Heartland Payment Sy	6,299.00	HSSREC0231	My school apps online, mosaic cloud front and back of the house
21589	10/17/2022	Henry Schein Inc	48.25	25454948	Medical Supplies
21589	10/17/2022	Henry Schein Inc	877.93	24660687	Medical Supplies
21590	10/17/2022	Hodsdon, Janell	133.75	101122	Reim SRV middle school AD Meeting 9/29/22
21591	10/17/2022	Holiday Inn Express	179.00	91525	Room, G Hughes
21592	10/17/2022	HomeCraft Home Inspe	425.00	S-0922012	650 Douglas Dr McCall Home inspection
21593	10/17/2022	Hotel McCall	110.00	8908758	Karen Toerne Room - Psych supervision for L Walz
21594	10/17/2022	Howes, Lisa	50.00	101222	Reim cell phone
21595	10/17/2022	Hub International	874.00	2911663	Endorsement premium add 299 S Third St McCall
21596	10/17/2022	Hughes, Ginger	135.00	101422	Reim ISEE Roadshow 9/19/22
21597	10/17/2022	Hunt, Lisa	175.23	101322	HUNT reimbursement - supplies
21598	10/17/2022	Idaho Digital Learni	1,500.00	421242-1	Drivers Ed
21598	10/17/2022	Idaho Digital Learni	150.00	421228-2	IDLA Class Fees
21599	10/17/2022	Idaho Power Processi	7,211.31	092122	Acct#2201371255
21599	10/17/2022	Idaho Power Processi	4,796.22	91422	Acct#2205728773
21600	10/17/2022	Idaho School Distric	190.05	22-23.886	white copy paper
21601	10/17/2022	Ident-A-Kid	795.00	122710	Ident-a-Kid Renewal - 2022-2023
21602	10/17/2022	Imel, Bianca	151.25	101422	Reim ISEE Roadshow 9/20/22
21603	10/17/2022	ISBA	3,850.00	2144	ISBA 2022 Convention Registration
21604	10/17/2022	IXL Learning	5,950.00	S448403	1-yr subscription
21604	10/17/2022	IXL Learning	600.00	S451353	IXL Annual Renewal
21605	10/17/2022	Jeffries, Sean	300.00	101122	Reim 6 cr BSU, English Language learner materials and methods
21606	10/17/2022	JW Pepper & Son Inc	169.99	364517258,	Music
21606	10/17/2022	JW Pepper & Son Inc	52.00	364590869	Classroom Supplies
21607	10/17/2022	Kennedy, Conor	50.00	101222	Reim cell phone
21608	10/17/2022	Kindall, Brad	110.63	101222	Reim mileage soccer game to Weiser
21609	10/17/2022	LaFay, Carrie	169.71	101322	LAFAY reimbursement - supplies
21610	10/17/2022	Lakeshore Disposal	575.95	25908555S2	BRMES 263081
21610	10/17/2022	Lakeshore Disposal	516.80	25908432S2	PLMS 115569
21610	10/17/2022	Lakeshore Disposal	633.05	25908389S2	MDHS 112602-002,112602-003,112602-005

CHECK NUMBER	CHECK DATE	VENDOR	AMOUNT	INVOICE NUMBER	INVOICE DESCRIPTION
21610	10/17/2022	Lakeshore Disposal	241.30	25908389S2	HHS 112602-006
21610	10/17/2022	Lakeshore Disposal	399.23	25908388S2	DES-112600-001
21610	10/17/2022	Lakeshore Disposal	243.14	25909028S2	DO garbage
21611	10/17/2022	Lakeshore Learning M	686.55	4788780908	EQUIPMENT PRE-K - Room dividers
21612	10/17/2022	Lamination Depot	233.60	128779	Supplies
21613	10/17/2022	Land Group, The	3,772.87	0148983	MDSB stibnite, re-zone applicaton, meetings
21614	10/17/2022	Learning A-Z	375.00	5870139	RAZ KIDS - 2nd grade teachers, 3 classrooms, 12 months
21615	10/17/2022	Learning Without Tea	754.38	159088	LICENSES - Keyboarding Without Tears, Quote Q-38518
21615	10/17/2022	Learning Without Tea	360.00	159400	KWT
21616	10/17/2022	Luff, Joseph	196.51	101222	Reim mileage
21617	10/17/2022	Maini, Michael	127.50	101222	Reim fuel for soccer game in Payette
21618	10/17/2022	Mapp, Mitchell	120.00	101322	Reimbursement
21619	10/17/2022	May Hardware	13.50	51591	supplies
21619	10/17/2022	May Hardware	76.47	51474	supplies
21619	10/17/2022	May Hardware	39.58	51192	supplies
21619	10/17/2022	May Hardware	77.50	51064	supplies
21619	10/17/2022	May Hardware	3.58	51822	supplies
21619	10/17/2022	May Hardware	35.61	52247	supplies
21619	10/17/2022	May Hardware	27.68	52270	supplies
21619	10/17/2022	May Hardware	0.54	52634	supplies
21619	10/17/2022	May Hardware	11.05	52538	supplies
21619	10/17/2022	May Hardware	32.38	52780	supplies
21619	10/17/2022	May Hardware	29.97	52838	supplies
21619	10/17/2022	May Hardware	91.96	52795	supplies
21619	10/17/2022	May Hardware	45.98	52860	supplies
21619	10/17/2022	May Hardware	17.58	53097	supplies
21619	10/17/2022	May Hardware	17.99	53126	supplies
21619	10/17/2022	May Hardware	107.32	53491,5221	Shop Supplies
21619	10/17/2022	May Hardware	31.45	53066	supplies
21619	10/17/2022	May Hardware	64.72	52301	Supplies-Hopkins
21620	10/17/2022	McCall City of	1,500.00	zon-22-02	Zon
21620	10/17/2022	McCall City of	496.10	91422BRMES	BRMES 1.8332.1
21620	10/17/2022	McCall City of	52.51	91422Maint	Maint 1.4252.1
21620	10/17/2022	McCall City of	49.61	91422DO1	DO 2.0460.1
21620	10/17/2022	McCall City of	100.67	91422HHS	HHS 2.0465.1
21620	10/17/2022	McCall City of	49.61	91422MDHS	MDHS 2.0474.1
21620	10/17/2022	McCall City of	701.48	91422MDHS1	2.0471.1 MDHS
21620	10/17/2022	McCall City of	507.70	91422PLMS	PLMS 1.8320.1
21620	10/17/2022	McCall City of	747.53	061322MDHS	2.0471.1 MDHS

CHECK CHECK			INVOICE	INVOICE
NUMBER	DATE	VENDOR	AMOUNT	NUMBER DESCRIPTION
21620	10/17/2022	McCall City of	105.02	61322HHS HHS 2.0465.1
21620	10/17/2022	McCall City of	49.61	61322DO1 DO 2.0460.1
21620	10/17/2022	McCall City of	49.61	61322Maint Maint 1.4252.1
21620	10/17/2022	McCall City of	501.90	61322BRMES BRMES 1.8332.1
21620	10/17/2022	McCall City of	543.95	61322PLMS PLMS 1.8320.1
21621	10/17/2022	McCall Delivery Serv	66.00	2022-0849 Rural Arts Grant Services
21622	10/17/2022	McCall Donnelly Hot	147.20	101322 HOT LUNCH TICKETS - meal tickets for staff, helpers, etc.
21623	10/17/2022	McCall-Donnelly Scho	1,050.38	101322 SUPPLIES REIMBURSEMENT FOR ASB ACCOUNT - school year theme supplies
21623	10/20/2022	McCall-Donnelly Scho	-1,050.38	101322 SUPPLIES REIMBURSEMENT FOR ASB ACCOUNT - school year theme supplies
21624	10/17/2022	McManus, Ted	134.07	101122 Gas for white bus
21625	10/17/2022	Meadow Gold Dairy	302.17	8260584 BRMES
21625	10/17/2022	Meadow Gold Dairy	245.68	8261320 BRMES
21625	10/17/2022	Meadow Gold Dairy	213.32	8262282 BRMES
21625	10/17/2022	Meadow Gold Dairy	88.85	111120352 BRMES
21625	10/17/2022	Meadow Gold Dairy	317.09	8263067 BRMES
21625	10/17/2022	Meadow Gold Dairy	142.20	8261323 PLMS
21625	10/17/2022	Meadow Gold Dairy	213.28	8262285 PLMS
21625	10/17/2022	Meadow Gold Dairy	248.83	8263070 PLMS
21625	10/17/2022	Meadow Gold Dairy	-36.98	111120589 PLMS
21625	10/17/2022	Meadow Gold Dairy	142.18	8261322 MDHS
21625	10/17/2022	Meadow Gold Dairy	-82.10	111119876 MDHS
21625	10/17/2022	Meadow Gold Dairy	199.42	8262284 MDHS
21625	10/17/2022	Meadow Gold Dairy	146.10	8263069 MDHS
21625	10/17/2022	Meadow Gold Dairy	177.78	8261321 DES
21625	10/17/2022	Meadow Gold Dairy	195.56	8262283 DES
21625	10/17/2022	Meadow Gold Dairy	195.56	8263068 DES
21626	10/17/2022	Miner's Grab n Go	667.58	Sept2022 fuel
21627	10/17/2022	Murray Group	2,562.00	Sept 2022- Benefit consulting Fee
21628	10/17/2022	Nelco	496.70	8195459 laser checks
21629	10/17/2022	Norheim Enterprises	2,300.00	001 MANDT Trainnig
21629	10/17/2022	Norheim Enterprises	12,065.44	203 CRBS
21630	10/17/2022	OETC	45.39	282447 Azure Overages and OETC Membership - 2022-2023
21630	10/17/2022	OETC	47.30	282616 OETC Membership - 2022-2023
21631	10/17/2022	Office Savers Online	1,919.60	8275 supplies
21631	10/17/2022	Office Savers Online	579.99	8323 supplies
21631	10/17/2022	Office Savers Online	2,955.00	8212 supplies
21632	10/17/2022	Olson, Annika	187.50	101122 Reimburse mileage
21633	10/17/2022	Payette Lakes Rec Wa	405.18	10/22-1890 MCC4304 MDHS#2 sewer
21633	10/17/2022	Payette Lakes Rec Wa	405.18	10/22-1889 MCC4303 MDHS #1 sewer

CHECK	CHECK		INVOICE	INVOICE
NUMBER	DATE	VENDOR	AMOUNT	NUMBER DESCRIPTION
21633	10/17/2022	Payette Lakes Rec Wa	50.65	10/22-1888 MCC4302 HHS sewer
21633	10/17/2022	Payette Lakes Rec Wa	50.65	10/22-1887 MCC4301 DO sewer
21633	10/17/2022	Payette Lakes Rec Wa	50.65	10/22-1885 MCC4299 MDHS Sewer
21633	10/17/2022	Payette Lakes Rec Wa	50.65	10/22-1884 MCC4298 Maint shop sewer
21633	10/17/2022	Payette Lakes Rec Wa	810.37	10/22-0201 BAR4306 BRMES sewer
21633	10/17/2022	Payette Lakes Rec Wa	50.65	10/22-1886 MCC4300 MDHS #3 sewer
21633	10/17/2022	Payette Lakes Rec Wa	810.37	10/22-1891 MCC4305 PLMS sewer
21634	10/17/2022	Pingrey, Eric	50.00	101222 Reim cell phone
21634	10/17/2022	Pingrey, Eric	200.00	1012221 Monthly transportation stipend
21635	10/17/2022	Potter's Center	877.60	18715 Rural Arts Grant Supplies
21635	10/17/2022	Potter's Center	7,335.00	D1521 Supplies-Hopkins (MDEF)
21636	10/17/2022	Pro Nation Healthcar	2,298.72	2252 PT & OT SERVICES - 9/16/22-9/30/22
21637	10/17/2022	Proprint	81.65	61821 Card Printing
21638	10/17/2022	Quill Corporation	256.79	27647730 supply closet
21638	10/17/2022	Quill Corporation	28.54	27359036 Supply closet
21638	10/17/2022	Quill Corporation	66.27	27357790 Supply closet
21638	10/17/2022	Quill Corporation	46.74	27378937 Supply closet
21638	10/17/2022	Quill Corporation	1,387.32	27371815 Supply closet
21639	10/17/2022	Really Good Stuff LL	58.98	8080585 Herbst - journals
21639	10/17/2022	Really Good Stuff LL	330.02	8079375 Hudson & Herbst
21640	10/17/2022	Riddell -All America	867.54	951653495 Helmet Reconditioning
21641	10/17/2022	Ridley's Family Mark	377.03	101422Kitc supplies
21641	10/17/2022	Ridley's Family Mark	99.92	101422PLMS Supplies
21641	10/17/2022	Ridley's Family Mark	82.80	101422DES staff lunch, shoes for a homeless child
21641	10/17/2022	Ridley's Family Mark	23.98	101422DO Batteries for Board Meeting microphones
21641	10/17/2022	Ridley's Family Mark	69.37	101422Sped Supplies
21641	10/17/2022	Ridley's Family Mark	160.93	101422MDHS September Purchases
21641	10/17/2022	Ridley's Family Mark	67.18	101722Kitc supplies
21641	10/17/2022	Ridley's Family Mark	17.76	101722IC PLC trainings
21642	10/17/2022	Riggers, Brenna	50.00	101222 Cell phone reimbursement
21643	10/17/2022	Rocky Mountain Signs	3,406.00	23497 MDHS recreate and install main entrance sign
21644	10/17/2022	Schoensee, Phillip	50.00	101222 Reim cell phone
21645	10/17/2022	Scholastic Inc	219.78	M7318546 subscription
21646	10/17/2022	School Nurse Supply	750.27	0913718-IN orders for schools
21647	10/17/2022	School Specialty Inc	340.83	2081308465 Replacement Chair
21648	10/17/2022	Scolab Inc	900.00	5964 1 yr. subscription
21649	10/17/2022	Shell Fleet Plus	1,543.01	84225800 Fuel
21650	10/17/2022	Sherwin-Williams	65.19	1752-2 supplies
21651	10/17/2022	Shred-It USA -Boise	122.07	8002521714 Shredding services

CHECK NUMBER	CHECK DATE	VENDOR	AMOUNT	INVOICE NUMBER	INVOICE DESCRIPTION
21652	10/17/2022	Silver Creek Supply	-198.41	8239565-00	Credit memo on supplies
21652	10/17/2022	Silver Creek Supply	125.86	8089120-00	supplies
21652	10/17/2022	Silver Creek Supply	407.49	8022780-00	supplies
21652	10/17/2022	Silver Creek Supply	509.52	8301632-00	supplies
21653	10/17/2022	Simplot Partners	2,730.00	216062105	supplies
21654	10/17/2022	Sparklight Business	45.00	1725-1022	MDHS - 112491725
21654	10/17/2022	Sparklight Business	419.98	5585 Oct 2	BRMES ethernet
21655	10/17/2022	Star-News	71.50	58607	Paper ads
21656	10/17/2022	StateFire	1,054.50	12477945	MDHS swapped out power supply in mens locker room
21657	10/17/2022	SYSCO Food Services	929.04	240144263	Supplies - DES
21657	10/17/2022	SYSCO Food Services	1,966.83	240126307	Supplies - BRMES
21657	10/17/2022	SYSCO Food Services	1,239.79	240130690	Supplies - BRMES
21657	10/17/2022	SYSCO Food Services	1,423.49	240135277	Supplies - BRMES
21657	10/17/2022	SYSCO Food Services	1,445.49	240139880	Supplies - BRMES
21657	10/17/2022	SYSCO Food Services	2,096.93	240144157	Supplies - BRMES
21657	10/17/2022	SYSCO Food Services	601.68	240126308	Supplies - PLMS
21657	10/17/2022	SYSCO Food Services	681.07	240130691	Supplies - PLMS
21657	10/17/2022	SYSCO Food Services	1,173.66	240135278	Supplies - PLMS
21657	10/17/2022	SYSCO Food Services	60.68	240137449	Supplies - PLMS
21657	10/17/2022	SYSCO Food Services	1,293.43	240139881	Supplies - PLMS
21657	10/17/2022	SYSCO Food Services	430.09	240144158	Supplies - PLMS
21657	10/17/2022	SYSCO Food Services	666.13	240126319	Supplies - MDHS
21657	10/17/2022	SYSCO Food Services	553.47	240130698	Supplies - MDHS
21657	10/17/2022	SYSCO Food Services	1,233.06	240135287	Supplies - MDHS
21657	10/17/2022	SYSCO Food Services	754.56	240139883	Supplies - MDHS
21657	10/17/2022	SYSCO Food Services	984.71	240144168	Supplies - MDHS
21657	10/17/2022	SYSCO Food Services	488.27	240126417	Supplies - DES
21657	10/17/2022	SYSCO Food Services	709.03	240130785	Supplies - DES
21657	10/17/2022	SYSCO Food Services	311.13	240135377	Supplies - DES
21657	10/17/2022	SYSCO Food Services	535.70	240140001	Supplies - DES
21658	10/17/2022	Tates Rents - McCall	129.92	1654242-7	breaker chisle, cord, hammer
21658	10/17/2022	Tates Rents - McCall	408.00	1660848-7	manlift
21658	10/17/2022	Tates Rents - McCall	500.64	1558671-7	air compressor
21659	10/17/2022	Teachers Pay Teacher	502.99	201268611	staff online gift card
21660	10/17/2022	Thomas, Timothy	140.50	101322	Reim SRV Principal, athletic mtg 10/5/22
21661	10/17/2022	TK Elevator	396.90	3006852630	MDHS
21662	10/17/2022	Todd, Nathan	20.00	101222	Reim cell phone
21663	10/17/2022	Toerne, Karen	1,827.17	101422	Mentoring services
21664	10/17/2022	USPS	374.00	101222	post office box renewal

CHECK NUMBER	CHECK DATE	VENDOR	AMOUNT	INVOICE NUMBER	INVOICE DESCRIPTION
21665	10/17/2022	Verizon Wireless	532.03	9917062507	Cell phone service
21666	10/17/2022	Voyager Sopris	231.00	5900504	
21667	10/17/2022	Wagner, Jeffrey	41.84	101322	Reimbursement for classroom supplies
21668	10/17/2022	Walker, Jeffrey	20.00	101222	Reim cell phone
21669	10/17/2022	Winn, Sara	23.56	101422	Reim mileage
21670	10/17/2022	Wolf, Sara	363.79	101422	WOLF reimbursement - supplies, Read Live licenses
21671	10/17/2022	Xerillion Corporatio	3,302.50	69318	Microsoft Office 365 Licenses - 2022-2023 Xerillion Confident Cloud Advantage
21671	10/17/2022	Xerillion Corporatio	2,707.79	02148-G5J8	Microsoft Office 365 Licenses - 2022-2023 Xerillion Confident Cloud Advantage
21671	10/17/2022	Xerillion Corporatio	2,445.00	69572	Microsoft Office 365 Licenses - 2022-2023 Xerillion Confident Cloud Advantage
21672	10/17/2022	Young, Natalie	19.98	101322	YOUNG reimbursement - Supplies
21673	10/20/2022	Barbara R Morgan Ele	1,050.38	101322	SUPPLIES REIMBURSEMENT FOR ASB ACCOUNT - school year theme supplies purchased by ASB but should have been district paid
21674	10/20/2022	Marzano Resources	1,600.00	101922	Marzano professional development2/24/23
21680	10/24/2022	Kelsey, Aaron	60.00	Aug, Sept	Cell phone reimbursement - Aug, Sept and Oct
21681	10/24/2022	Monroe, Melissa	660.63	In lieu -	In-Lieu transportation reimbursement - J Monroe - School for Deaf and Blind
21682	10/25/2022	Blue Cross of Idaho	20,173.09	20221025AD	Payroll accrual
21682	10/25/2022	Blue Cross of Idaho	862.66	20221025AD	Payroll accrual
21682	10/25/2022	Blue Cross of Idaho	408.80	20221025AF	Payroll accrual
21682	10/25/2022	Blue Cross of Idaho	18,600.90	20221025AF	Payroll Benefit
21682	10/25/2022	Blue Cross of Idaho	44,385.45	20221025AF	Payroll Benefit
21682	10/25/2022	Blue Cross of Idaho	60,979.25	20221025AF	Payroll accrual
21682	10/25/2022	Blue Cross of Idaho	21,859.45	20220825AD	Payroll accrual
21682	10/25/2022	Blue Cross of Idaho	1,074.18	20220825AD	Payroll accrual
21682	10/25/2022	Blue Cross of Idaho	17,803.17	20220825AF	Payroll Benefit
21682	10/25/2022	Blue Cross of Idaho	41,833.70	20220825AF	Payroll Benefit
21682	10/25/2022	Blue Cross of Idaho	54,241.55	20220825AF	Payroll accrual
21682	10/25/2022	Blue Cross of Idaho	360.80	20220825EA	65 + 71 MEMBERS = 136 X \$2.80/EACH = \$360.80
21683	10/25/2022	United Heritage	577.63	20221025AD	Payroll accrual
21684	10/25/2022	BPA Health	86.80	20221025AF	Payroll accrual
21685	10/25/2022	The Club	295.00	20221025AD	Payroll accrual
21686	10/25/2022	McCall-Donnelly Scho	110.00	20221025AD	Payroll accrual
21686	10/25/2022	McCall-Donnelly Scho	189.00	20221025AD	Payroll accrual
21686	10/25/2022	McCall-Donnelly Scho	1,369.48	20221025AD	Payroll accrual
21686	10/25/2022	McCall-Donnelly Scho	216.68	20221025AD	Payroll accrual
21687	10/25/2022	McCall-Donnelly Educ	40.00	20221025AD	Payroll accrual
21688	10/25/2022	NCPERS Idaho	32.00	20221025AD	Payroll accrual
21689	10/25/2022	The Standard	39.75	20221025AD	Payroll accrual
21689	10/25/2022	The Standard	542.99	20221025AD	Payroll accrual
21689	10/25/2022	The Standard	319.68	20221025AD	Payroll accrual

CHECK	CHECK		INVOICE	INVOICE
NUMBER	DATE	VENDOR	AMOUNT	NUMBER DESCRIPTION
21689	10/25/2022	The Standard	590.70	20221025AF Payroll accrual
21690	10/25/2022	United Heritage	733.06	20221025AD Payroll accrual
21690	10/25/2022	United Heritage	1,034.26	20221025AF Payroll Benefit
21691	10/26/2022	Coastline Equipment	80,135.00	09091379 Skid steer
202200042	10/17/2022	US Bank Corp 0941	1,171.71	101722BRME SUPPLIES
202200042	10/17/2022	US Bank Corp 0941	210.00	101722Curr TCI middle school social studies student licenses
202200042	10/17/2022	US Bank Corp 0941	812.47	101722DES District credit card
202200042	10/17/2022	US Bank Corp 0941	119.52	101722DO US Bank September 2022 Visa
202200042	10/17/2022	US Bank Corp 0941	349.00	101722D01 Prime membership
202200042	10/17/2022	US Bank Corp 0941	2,588.33	101722HHS, US Bank Bill September 2022
202200042	10/17/2022	US Bank Corp 0941	119.00	101722Kitc gas, postage
202200042	10/17/2022	US Bank Corp 0941	1,934.13	101722Main Garbage, Lights, timedox, shirts
202200042	10/17/2022	US Bank Corp 0941	4,129.16	101722MDHS September Credit Card Purchases
202200042	10/17/2022	US Bank Corp 0941	705.22	101722PLMS Supplies
202200042	10/17/2022	US Bank Corp 0941	153.00	101722Sped ASSESSMENTS - Brief 2
202200042	10/17/2022	US Bank Corp 0941	215.97	101722Tech Standard SSL Renewal, zoom, MSFT
202200043	10/25/2022	American Fidelity As	75.00	20221025AD Payroll accrual
202200044	10/25/2022	EFTPS	8.49	20221025AD Payroll accrual
202200044	10/25/2022	EFTPS	4,817.15	20221025AD Payroll accrual
202200044	10/25/2022	EFTPS	1,024.90	20221025AD Payroll accrual
202200044	10/25/2022	EFTPS	57,696.74	20221025AD Payroll accrual
202200044	10/25/2022	EFTPS	53,957.91	20221025AD Payroll accrual
202200044	10/25/2022	EFTPS	12,619.28	20221025AD Payroll accrual
202200044	10/25/2022	EFTPS	53,957.91	20221025AF Payroll accrual
202200044	10/25/2022	EFTPS	12,619.28	20221025AF Payroll accrual
202200045	10/25/2022	Idaho State Tax Comm	21,381.00	20221025AD Payroll accrual
202200045	10/25/2022	Idaho State Tax Comm	1.42	20221025AD Payroll accrual
202200045	10/25/2022	Idaho State Tax Comm	2,105.41	20221025AD Payroll accrual
202200045	10/25/2022	Idaho State Tax Comm	539.50	20221025AD Payroll accrual
202200046	10/25/2022	Public Employee Reti	12,808.54	20221025AD Payroll accrual
202200046	10/25/2022	Public Employee Reti	5,109.24	20221025AD Payroll accrual
202200046	10/25/2022	Public Employee Reti	62,634.53	20221025AD Payroll accrual
202200046	10/25/2022	Public Employee Reti	104,448.91	20221025AF Payroll accrual
202200047	10/25/2022	VALIC	80.00	20221025AD Payroll accrual
202200047	10/25/2022	VALIC	852.35	20221025AD Payroll accrual
202200047	10/25/2022	VALIC	375.00	20221025AD Payroll accrual
202200047	10/25/2022	VALIC	2,275.00	20221025AD Payroll accrual
202200047	10/25/2022	VALIC	25.00	20221025AD Payroll accrual
202200048	10/25/2022	Delta Dental	4,456.30	20221025AD Payroll accrual

CHECK CHECK			INVOICE		INVOICE
NUMBER	DATE	VENDOR	AMOUNT	NUMBER	DESCRIPTION
202200048	10/25/2022	Delta Dental	5,396.25	20221025AF	Payroll Benefit
202200049	10/25/2022	State of Idaho/Natio	1,616.67	20221025AD	Payroll accrual
202200049	10/25/2022	State of Idaho/Natio	327.83	20221025AD	Payroll accrual
202200050	10/25/2022	Health Equity	10,240.53	20221025AD	Payroll accrual
202200050	10/25/2022	Health Equity	9,210.51	20221025AF	HSA EMPLOYER MATCH
202200050	10/25/2022	Health Equity	44.25	20221025AD	Payroll accrual
202200050	10/25/2022	Health Equity	220.20	20221025AD	Payroll accrual
202200051	10/25/2022	Colonial Life	1,300.51	20221025AD	Payroll accrual
202200051	10/25/2022	Colonial Life	574.89	20221025AD	Payroll accrual
202200051	10/25/2022	Colonial Life	79.05	20221025AD	Payroll accrual
202200051	10/25/2022	Colonial Life	552.68	20221025AD	Payroll accrual
202200052	10/25/2022	EFTPS	2,744.54	20221025BD	Payroll accrual
202200052	10/25/2022	EFTPS	3,968.00	20221025BD	Payroll accrual
202200052	10/25/2022	EFTPS	928.00	20221025BD	Payroll accrual
202200052	10/25/2022	EFTPS	3,968.00	20221025BF	Payroll accrual
202200052	10/25/2022	EFTPS	928.00	20221025BF	Payroll accrual
202200053	10/25/2022	Idaho State Tax Comm	585.00	20221025BD	Payroll accrual
202200054	10/25/2022	Public Employee Reti	4,582.40	20221025BD	Payroll accrual
202200054	10/25/2022	Public Employee Reti	7,641.60	20221025BF	Payroll accrual
Totals for checks			1,902,929.17		

FUND SUMMARY

FUND	DESCRIPTION	BALANCE SHEET	REVENUE	EXPENSE	TOTAL
100	General M & O	573,564.56	-1,500.00	321,244.08	893,308.64
220	Forest Reserve Fund	13,896.93	0.00	150.00	14,046.93
230	Local Special Projects	0.00	0.00	425.00	425.00
231	Local Special Projects	75.87	0.00	23,421.71	23,497.58
232	Local Special Projects	0.00	0.00	1,800.00	1,800.00
233	Local Special Projects	0.00	0.00	943.60	943.60
241	Driver's Education	813.83	0.00	2,325.53	3,139.36
243	Professional Technical - State	0.00	0.00	6,619.73	6,619.73
246	Safe & Drug Free Schools	0.00	0.00	8,263.02	8,263.02
250	ESSERF III	0.00	0.00	1,600.00	1,600.00
251	Title I-A	6,888.51	0.00	0.00	6,888.51
254	ESSER II	1,585.34	0.00	13,826.44	15,411.78
257	IDEA Part B School-Age	9,087.73	0.00	3,974.13	13,061.86
258	IDEA Part B Pre-School	474.24	0.00	0.00	474.24
260	School Based Medicaid	0.00	0.00	34,159.96	34,159.96
261	Title IV-A	75.27	0.00	1,225.00	1,300.27
271	Title II-A - Teacher Quality	736.46	0.00	0.00	736.46
290	Child Nutrition Fundhild Nutri	13,166.21	0.00	33,796.73	46,962.94
410	Capital Construction Projects	0.00	0.00	830,289.29	830,289.29
***	Fund Summary Totals ***	620,364.95	-1,500.00	1,284,064.22	1,902,929.17

***** End of report *****

Description: SBAA Entity 101 Check Request Report - ASB Check Register Report

Bank Account: BRME Checking (Us Bank Na)

Check Nbr	Check ID	Amount	Void	Check Date	Vendor	Prt/Pst Dt	Stmt Date	Entered By
<u>Description</u>				1099	Invoice Amount	Invoice Number	Invoice Date	
<u>General Ledger Account Distribution</u>					<u>Accounting Amount</u>			
000002358	000034573	89.34		10/20/2022	US Bank Na		10/31/2022	Butler, Christine A.
Art Club - Envelopes for art cards						89.34		
750 L 417000 222 101 000						89.34		

Grand Totals

	1	Check Requests
89.34		Net Amount of Check Requests
0.00		1099 Amount of Check Requests

* A void check record exists for this check.

***** End of report *****

Description: SBAA Entity 102 Check Request Report - ASB Check Request Report

Bank Account: DES Checking (Us Bank Na)

Check Nbr	Check ID	Amount	Void	Check Date	Vendor	Prt/Pst Dt	Stmt Date	Entered By
Description		1099	Invoice Amount	Invoice Number	Invoice Date			
General Ledger Account Distribution		Accounting Amount						
000002099	000034700	16.00		10/28/2022	Idaho Vital Records	10/28/2022		Davenport, Wendy L.
	B.C. for ArianaJo Brock		16.00		102822	10/28/2022		
	750 L 417000 401 102 000		16.00					

Grand Totals

	16.00	1	Check Requests
	0.00		Net Amount of Check Requests
		1099	Amount of Check Requests

* A void check record exists for this check.

***** End of report *****

Description: SBAA Entity 401 Check Request Report - Check Request Report

Bank Account: MDHS Checking (Us Bank Na)

Check Nbr	Check ID	Amount	Void	Check Date	Vendor	Prt/Pst Dt	Stmt Date	Entered By
Description		1099	Invoice Amount	Invoice Number	Invoice Date			
General Ledger Account Distribution		Accounting Amount						
000023696	000034218	216.00		10/03/2022	Family, Career, Community Leaders of	10/03/2022		Bevill, Lauren
	National and Idaho Membership		216.00		127082		09/28/2022	
	750 L 417000 919 401 000		216.00					
000023697	000034214	17,650.00		10/03/2022	Henggeler Packing Co.	10/03/2022		Bevill, Lauren
	Peaches and Apples		17,650.00		15245		09/25/2022	
	750 L 417000 928 401 000		17,650.00					
000023698	000034217	375.00		10/03/2022	Idaho CTE	10/03/2022		Bevill, Lauren
	MDHS FCCLA BASIC Registration		375.00		381		09/30/2022	
	750 L 417000 919 401 000		375.00					
000023699	000034215	2,668.00		10/03/2022	Rustic Road Shirt Shop	10/03/2022		Bevill, Lauren
	Football Team Gear		2,668.00		2022-0906B		09/06/2022	
	750 L 417000 928 401 000		2,668.00					
000023700	000034216	5,080.00		10/03/2022	Velocity Athletics	10/03/2022		Bevill, Lauren
	Football Uniforms		5,080.00		V1437		09/01/2022	
	750 L 417000 928 401 000		5,080.00					
000023701	000034219	203.00		10/03/2022	Rocky Mountain Signs	10/03/2022		Bevill, Lauren
	Booster Club Banners		203.00		23555		09/30/2022	
	750 L 417000 864 401 000		203.00					
000023702	000034227	1,298.91		10/07/2022	Idaho State Tax Commission	10/07/2022		Bevill, Lauren
	September Tax Collected		1,298.91					
	750 L 417000 866 401 000		1,298.91					
000023703	000034228	448.82		10/07/2022	McCall City of	10/07/2022		Bevill, Lauren
	Q3 LOT Tax		448.82					
	750 L 417000 866 401 000		448.82					
000023704	000034232	75.00		10/10/2022	Cole Valley Christian School	10/10/2022		Bevill, Lauren
	Cross Country Entry		75.00					
	750 L 417000 920 401 000		75.00					
000023705	000034239	200.00		10/10/2022	Crossley, Nicole	10/10/2022		Bevill, Lauren
	REIM: Costco & Amazon Football Senior Night		200.00					
	750 L 417000 864 401 000		200.00					
000023706	000034230	900.00		10/10/2022	Hudl	10/10/2022		Bevill, Lauren
	22-23 Football Hudl		900.00		INV01388632		10/09/2022	
	750 L 417000 928 401 000		900.00					
000023707	000034231	150.00		10/10/2022	Ice Cream Alley	10/10/2022		Bevill, Lauren
	Talent Show Supplies		150.00		001		10/09/2022	
	750 L 417000 928 401 000		150.00					

Bank Account: MDHS Checking (Us Bank Na)

Check Nbr	Check ID	Amount	Void	Check Date	Vendor	Prt/Pst Dt	Stmt Date	Entered By
Description		1099	Invoice Amount	Invoice Number	Invoice Date			
General Ledger Account Distribution				Accounting Amount				
000023708	000034233	65.00		10/10/2022	Nampa Christian Schools	10/10/2022		Bevill, Lauren
	Cross Country Entry		65.00					
	750 L 417000 920 401 000		65.00					
000023709	000034235	38.00		10/10/2022	Payette Lakes Middle School	10/10/2022		Bevill, Lauren
	MDHS Football Concessions		38.00				10/06/2022	
	750 L 417000 928 401 000		38.00					
000023710	000034237	230.00		10/10/2022	Rustic Road Shirt Shop	10/10/2022		Bevill, Lauren
	Football Gear		230.00	2022-0928	YES		09/28/2022	
	750 L 417000 928 401 000		230.00					
000023711	000034229	2,106.95		10/10/2022	Shamrock Foods	10/10/2022		Bevill, Lauren
	Football Concessions		789.06	2628843	YES		08/31/2022	
	750 L 417000 928 401 000		789.06					
	Football Concessions		30.26	26251807	YES		09/05/2022	
	750 L 417000 928 401 000		30.26					
	Football Concessions		530.19	26298337	YES		09/21/2022	
	750 L 417000 928 401 000		530.19					
	Football Concessions		757.44	26258047	YES		09/07/2022	
	750 L 417000 928 401 000		757.44					
000023712	000034238	66.59		10/10/2022	Sorensen, Stephanie	10/10/2022		Bevill, Lauren
	REIM: Albertsons, ASB supplies		66.59				10/05/2022	
	750 L 417000 872 401 000		66.59					
000023713	000034234	45.07		10/10/2022	Swanson, Audrey	10/10/2022		Bevill, Lauren
	REIM: Amazon, drama supplies		35.09				09/26/2022	
	750 L 417000 875 401 000		35.09					
	REIM: Monologue Blog, drama supplies		9.98				10/06/2022	
	750 L 417000 875 401 000		9.98					
000023714	000034236	90.00		10/10/2022	Warren, Claire	10/10/2022		Bevill, Lauren
	September Ticket Taker		90.00					
	750 L 417000 918 401 000		90.00					
000023715	000034240	1,634.66		10/10/2022	Ridley's Family Markets	10/10/2022		Bevill, Lauren
	Football Concessions		251.28				09/01/2022	
	750 L 417000 928 401 000		251.28					
	BSOC Concessions		136.69				09/02/2022	
	750 L 417000 925 401 000		136.69					
	BSOC Concessions		80.30				09/06/2022	
	750 L 417000 925 401 000		80.30					
	Football, team supplies		256.88				09/07/2022	
	750 L 417000 928 401 000		256.88					
	Football Concessions		399.10				09/08/2022	
	750 L 417000 928 401 000		399.10					
	BSOC Concessions		56.46				09/10/2022	
	750 L 417000 925 401 000		56.46					

Bank Account: MDHS Checking (Us Bank Na)

Check Nbr	Check ID	Amount	Void	Check Date	Vendor	Prt/Pst Dt	Stmt Date	Entered By
Description		1099	Invoice Amount	Invoice Number	Invoice Date			
General Ledger Account Distribution		Accounting Amount						
000023715	000034240				continued			
	ASB Homecoming Supplies		109.15				09/21/2022	
	750 L 417000 872 401 000		109.15					
	Football Concessions		172.31				09/23/2022	
	750 L 417000 928 401 000		172.31					
	BSOC Concessions		50.30				09/30/2022	
	750 L 417000 925 401 000		50.30					
	Football Tean Supplies		122.19				09/28/2022	
	750 L 417000 928 401 000		122.19					
000023716	000034456	414.00		10/13/2022	AmericInn Hailey	10/13/2022		Bevill, Lauren
	Football Rooms		414.00				10/11/2022	
	750 L 417000 921 401 000		414.00					
000023717	000034415	75.00		10/13/2022	Idaho Digital Learning	10/13/2022		Bevill, Lauren
	Corbt, Economics		75.00				10/03/2022	
	750 L 417000 874 401 000		75.00					
000023718	000034413	83.84		10/13/2022	May Hardware	10/13/2022		Bevill, Lauren
	Homecoming Supplies		83.84				09/17/2022	
	750 L 417000 872 401 000		83.84					
000023719	000034567	1,080.00		10/18/2022	Kindall, Brad	10/18/2022		Bevill, Lauren
	PER DIEM: BSOC Student Lunch		330.00					
	750 L 417000 864 401 000		330.00					
	PER DIEM: BSOC Student Dinner		660.00					
	750 L 417000 864 401 000		660.00					
	PER DIEM: BSOC Staff Lunch		60.00					
	750 L 417000 922 401 000		60.00					
	PER DIEM: BSOC Staff Dinner		30.00					
	750 L 417000 922 401 000		30.00					
000023720	000034568	1,080.00		10/18/2022	Maini, Michael	10/18/2022		Bevill, Lauren
	PER DIEM: GSOC Student Lunch		330.00					
	750 L 417000 864 401 000		330.00					
	PER DIEM: GSOC Student Dinner		660.00					
	750 L 417000 864 401 000		660.00					
	PER DIEM: GSOC Staff Lunch		60.00					
	750 L 417000 922 401 000		60.00					
	PER DIEM: GSOC Staff Dinner		30.00					
	750 L 417000 922 401 000		30.00					
000023721	000034644	100.95		10/24/2022	Gross, Jan	10/24/2022		Bevill, Lauren
	REIM: Costco, football concessions		100.95					
	750 L 417000 928 401 000		100.95					
000023722	000034642	35.00		10/24/2022	IHSAA	10/24/2022		Bevill, Lauren
	Activity Cards		35.00				10/06/2022	
	750 L 417000 930 401 000		35.00					

Bank Account: MDHS Checking (Us Bank Na)

Check Nbr	Check ID	Amount	Void	Check Date	Vendor	Prt/Pst Dt	Stmt Date	Entered By
Description		1099	Invoice Amount	Invoice Number	Invoice Date			
General Ledger Account Distribution		Accounting Amount						
000023723	000034639	325.00		10/24/2022	Mapp, Sonya	10/24/2022		Bevill, Lauren
	REIM: Boosters GSOC senior night		325.00					
	750 L 417000 864 401 000		325.00					
000023724	000034641	105.00		10/24/2022	Rubio, Megan	10/24/2022		Bevill, Lauren
	Ticket Taker October		105.00				10/14/2022	
	750 L 417000 918 401 000		105.00					
000023725	000034640	667.42		10/24/2022	Shamrock Foods	10/24/2022		Bevill, Lauren
	Football Concessions		667.42	26561453	YES		10/14/2022	
	750 L 417000 928 401 000		667.42					
000023726	000034645	384.65		10/24/2022	Snake River Timing	10/24/2022		Bevill, Lauren
	District Cross Country		384.65	22-39			10/22/2022	
	750 L 417000 200 401 000		384.65					
000023727	000034643	873.46		10/24/2022	Weiser High School	10/24/2022		Bevill, Lauren
	Girls Soccer District Gate		873.46					
	750 L 417000 915 401 000		873.46					
000023728	000034647	240.00 *		10/24/2022	Green, Amber	10/24/2022	10/24/2022	Bevill, Lauren
	PER DIEM: CC State Student Lunch		70.00					
	750 L 417000 864 401 000		70.00					
	PER DIEM: CC State Student Dinner		140.00					
	750 L 417000 864 401 000		140.00					
	PER DIEM: CC State Staff Lunch		10.00					
	750 L 417000 922 401 000		10.00					
	PER DIEM:CC State Staff Dinner		20.00					
	750 L 417000 922 401 000		20.00					
000023728	000034649	240.00	VOID	10/24/2022	Green, Amber	10/24/2022	10/24/2022	Bevill, Lauren
	PER DIEM: CC State Student Lunch		70.00					
	750 L 417000 864 401 000		70.00					
	PER DIEM: CC State Student Dinner		140.00					
	750 L 417000 864 401 000		140.00					
	PER DIEM: CC State Staff Lunch		10.00					
	750 L 417000 922 401 000		10.00					
	PER DIEM:CC State Staff Dinner		20.00					
	750 L 417000 922 401 000		20.00					
000023729	000034646	420.00		10/24/2022	Green, Amber	10/24/2022		Bevill, Lauren
	PER DIEM: VB State Student Lunch		120.00					
	750 L 417000 864 401 000		120.00					
	PER DIEM: VB State Student Dinner		240.00					
	750 L 417000 864 401 000		240.00					
	PER DIEM: VB State Staff Lunch		20.00					
	750 L 417000 922 401 000		20.00					
	PER DIEM:VB State Staff Dinner		40.00					
	750 L 417000 922 401 000		40.00					

* A void check record exists for this check.

Bank Account: MDHS Checking (Us Bank Na)

Check Nbr	Check ID	Amount	Void	Check Date	Vendor	Prt/Pst Dt	Stmt Date	Entered By
Description		1099	Invoice Amount	Invoice Number	Invoice Date			
General Ledger Account Distribution		Accounting Amount						
000023730	000034648	6,814.67		10/24/2022	US Bank Corp 0941		10/24/2022	Bevill, Lauren
	Amazon, Drama supplies		9.44					
	750 L 417000 875 401 000		9.44					
	Amazon, drama supplies		6.00					
	750 L 417000 875 401 000		6.00					
	Amazon, Junior Vending		339.94					
	750 L 417000 869 401 000		339.94					
	Amazon, Beverage Vending		292.09					
	750 L 417000 897 401 000		292.09					
	Amazon, ASB card blanks		22.89					
	750 L 417000 401 401 000		22.89					
	Amazon, Booster supplies		18.82					
	750 L 417000 864 401 000		18.82					
	Amazon, booster supplies		86.36					
	750 L 417000 864 401 000		86.36					
	Amazon, senior homecoming supplies		99.41					
	750 L 417000 868 401 000		99.41					
	Amazon, senior homecoming supplies		43.98					
	750 L 417000 868 401 000		43.98					
	Amazon, booster supplies		359.80					
	750 L 417000 864 401 000		359.80					
	Hometown, bsoc concessions supplies		84.00					
	750 L 417000 925 401 000		84.00					
	Athletic.net, cc race bibs		54.80					
	750 L 417000 921 401 000		54.80					
	Silverwood, CC team entry		250.00					
	750 L 417000 927 401 000		250.00					
	Albertsons, football team supplies		68.80					
	750 L 417000 928 401 000		68.80					
	HUDL, volleyball annual subscription		1,349.00					
	750 L 417000 930 401 000		1,349.00					
	Monologue Blogger, Mind Trick		9.98					
	750 L 417000 875 401 000		9.98					
	The Merc, FB fundraiser supplies		37.32					
	750 L 417000 928 401 000		37.32					
	The Merc, FB fundraiser supplies		75.00					
	750 L 417000 928 401 000		75.00					
	The Merc, FB fundraiser supplies		70.47					
	750 L 417000 928 401 000		70.47					
	Gerber Tours, Hiatt		375.00					
	750 L 417000 875 401 000		375.00					
	Gerber Tours, Siuce		2,290.00					
	750 L 417000 875 401 000		2,290.00					
	Gerber Tours, Dow		375.00					
	750 L 417000 875 401 000		375.00					
	Gerber Tours, Dow		375.00					
	750 L 417000 875 401 000		375.00					
	Monologue Blogger, Bad Mood		9.98					
	750 L 417000 875 401 000		9.98					

Bank Account: MDHS Checking (Us Bank Na)

Check Nbr	Check ID	Amount	Void	Check Date	Vendor	Prt/Pst Dt	Stmt Date	Entered By
Description		1099	Invoice Amount	Invoice Number	Invoice Date			
General Ledger Account Distribution		Accounting Amount						
000023730	000034648				...continued			
	Albertsons, football supplies		111.59					
	750 L 417000 928 401 000		111.59					
000023731	000034650	240.00		10/24/2022	McManus, Ted		10/24/2022	Bevill, Lauren
	PER DIEM: CC State Student Lunch		70.00					
	750 L 417000 864 401 000		70.00					
	PER DIEM: CC State Student Dinner		140.00					
	750 L 417000 864 401 000		140.00					
	PER DIEM: CC State Staff Lunch		10.00					
	750 L 417000 922 401 000		10.00					
	PER DIEM:CC State Staff Dinner		20.00					
	750 L 417000 922 401 000		20.00					
000023732	000034684	140.00		10/26/2022	Carroll, Julina		10/26/2022	Bevill, Lauren
	PER DIEM: Cheer Athlete Dinner		130.00					
	750 L 417000 864 401 000		130.00					
	PER DIEM: Cheer Coach Dinner		10.00					
	750 L 417000 922 401 000		10.00					
000023733	000034691	290.43		10/26/2022	Fruitland High School		10/26/2022	Bevill, Lauren
	3A SRV Boys Soccer District Gate		41.68					
	750 L 417000 915 401 000		41.68					
	3A SRV Frosh VB District Gate		248.75					
	750 L 417000 915 401 000		248.75					
000023734	000034688	5,250.16		10/26/2022	Holiday Inn Express & Suites Twin Fal		10/26/2022	Bevill, Lauren
	Girls Soccer State Hotel Rooms		5,250.16		17895		10/25/2022	
	750 L 417000 922 401 000		5,250.16					
000023735	000034692	143.00		10/26/2022	Kindall, Brad		10/26/2022	Bevill, Lauren
	REIM: Bowladrome, BSOC state team aup		143.00					
	750 L 417000 925 401 000		143.00					
000023736	000034685	360.00		10/26/2022	Leslie, Leon		10/26/2022	Bevill, Lauren
	PER DIEM: Football Athlete Dinner		340.00					
	750 L 417000 864 401 000		340.00					
	PER DIEM: Football Coach Dinner		20.00					
	750 L 417000 922 401 000		20.00					
000023737	000034687	1,103.89		10/26/2022	Parma High School		10/26/2022	Bevill, Lauren
	District VB Gate 10/18		471.50					
	750 L 417000 915 401 000		471.50					
	District VB Gate 10/20		632.39					
	750 L 417000 915 401 000		632.39					
000023738	000034690	41.68		10/26/2022	Payette High School		10/26/2022	Bevill, Lauren
	3A SRV Boys Soccer District Gate		41.68					
	750 L 417000 915 401 000		41.68					

Bank Account: MDHS Checking (Us Bank Na)

Check Nbr	Check ID	Amount	Void	Check Date	Vendor	Prt/Pst Dt	Stmt Date	Entered By
Description		1099	Invoice Amount	Invoice Number	Invoice Date			
General Ledger Account Distribution		Accounting Amount						
000023739	000034686	55.00		10/26/2022	Rocky Mountain Signs	10/26/2022		Bevill, Lauren
	Booster Signs		55.00	23625		10/18/2022		
	750 L 417000 864 401 000		55.00					
000023740	000034689	131.89		10/26/2022	S.W. District I. A.A.	10/26/2022		Bevill, Lauren
	3A SRV Boys Soccer District Gate		131.89					
	750 L 417000 915 401 000		131.89					
000023741	000034693	41.68		10/26/2022	Weiser High School	10/26/2022		Bevill, Lauren
	3A SRV Boys Soccer District Gate		41.68					
	750 L 417000 915 401 000		41.68					
000023742	000034694	40.00 *		10/26/2022	Peterson	10/26/2022	10/26/2022	Bevill, Lauren
	Ticket Taker 10/14		40.00					
	750 L 417000 918 401 000		40.00					
000023742	000034695	40.00	VOID	10/26/2022	Peterson	10/26/2022	10/26/2022	Bevill, Lauren
	Ticket Taker 10/14		40.00					
	750 L 417000 918 401 000		40.00					
000023743	000034697	40.00		10/26/2022	Peterson, Brynlee	10/26/2022		Bevill, Lauren A.
	Ticket Taker 10/14		40.00					
	750 L 417000 918 401 000		40.00					

50 Check Requests for MDHS Checking
2 Void(s)
53,837.72 Net Amount of Check Requests for MDHS Checking
23,322.37 1099 Amount of Check Requests for MDHS Checking

Grand Totals

50 Check Requests
2 Void(s)
53,837.72 Net Amount of Check Requests
23,322.37 1099 Amount of Check Requests

* A void check record exists for this check.

***** End of report *****

Description: SBAA Entity 602 Check Request Report - ASB Check Request Report

Bank Account: PLMS Checking (Us Bank Na)

Check Nbr	Check ID	Amount	Void	Check Date	Vendor	Prt/Pst Dt	Stmt Date	Entered By
Description		1099	Invoice Amount	Invoice Number	Invoice Date			
General Ledger Account Distribution		Accounting Amount						
000006285	000034220	150.00		10/04/2022	Campbell, Jacki		10/04/2022	Campbell, Sally
Volleyball Referee: 6 games			150.00	2022				
750 L 417000 903 602 000			150.00					
000006286	000034222	100.00		10/04/2022	Caple, Jennifer		10/04/2022	Campbell, Sally
Volleyball Referee: 4 games			100.00	2022	YES			
750 L 417000 903 602 000			100.00					
000006287	000034221	250.00		10/04/2022	Walker, Matraca		10/04/2022	Campbell, Sally
Volleyball Scoreboard: 10 games			250.00	2022	YES			
750 L 417000 904 602 000			250.00					
000006288	000034225	100.00		10/05/2022	McNamara, Dennis		10/05/2022	Campbell, Sally
Football Official vs. Weiser			100.00	2 games	YES	10/5/22		
750 L 417000 904 602 000			100.00					
000006289	000034226	306.80		10/05/2022	Onthank, Lexis		10/05/2022	Campbell, Sally
Reim football concessions			235.45		Ricley's			
750 L 417000 906 602 000			235.45					
Reim football concessions			71.35		Costco			
750 L 417000 906 602 000			71.35					
000006290	000034223	215.00		10/05/2022	Pettet, Theodore		10/05/2022	Campbell, Sally
Football Official vs. Weiser			215.00	2 games	YES	10/5/22		
750 L 417000 904 602 000			215.00					
000006291	000034224	110.00		10/05/2022	Porter, Keith		10/05/2022	Campbell, Sally
Football Official vs. Weiser			110.00	2 games	YES	10/5/22		
750 L 417000 904 602 000			110.00					
000006292	000034666	1,154.11		10/24/2022	Hansen, Cody		10/24/2022	Campbell, Sally
Reim vending supplies			1,154.11		Amzn & Costco			
750 L 417000 944 602 000			1,154.11					
000006293	000034664	75.00		10/24/2022	Idaho Digital Learning		10/24/2022	Campbell, Sally
IDLA Class: Algebra 1A - Lennox Bowling			75.00	421238-2				
750 L 417000 940 602 000			75.00					
000006294	000034569	45.00		10/19/2022	McCall Chiropractic		10/24/2022	Campbell, Sally
Sports physical: A. Bonilla-Farfan			45.00	7478-Medicaid	10/19/2022			
750 L 417000 899 602 000			45.00					
000006295	000034665	35.00		10/24/2022	Parma Middle School		10/24/2022	Campbell, Sally
XC Meet 9/20/22			35.00					
750 L 417000 900 602 000			35.00					

Bank Account: PLMS Checking (Us Bank Na)

<u>Check Nbr</u>	<u>Check ID</u>	<u>Amount</u>	<u>Void</u>	<u>Check Date</u>	<u>Vendor</u>	<u>Prt/Pst Dt</u>	<u>Stmt Date</u>	<u>Entered By</u>
					1099	<u>Invoice Amount</u>	<u>Invoice Number</u>	<u>Invoice Date</u>
						<u>Accounting Amount</u>		

Grand Totals
 18 Check Requests
 5,463.66 Net Amount of Check Requests
 1,405.00 1099 Amount of Check Requests

* A void check record exists for this check.

***** End of report *****

Description: SBAA Entity 101 Acct. Receipt/Disbursement Summary Rpt - ASB BOARD SUMMARY REPORT

Account	Description	Oct. 1, 2022	Posted SBAA	Posted SBAA	Oct. 31, 2022
		Beginning Balance	Receipts	Disbursements	Ending Balance
750 A 111000 101 101 000	Cash/Cash/Cash	19,067.14	1,295.46	-89.34	20,273.26
750 A 111000 103 101 000	Cash/Cash-Savings/Cash-Savings	683.31	0.00	0.00	683.31
Total Asset Accounts:		19,750.45	1,295.46	-89.34	20,956.57
750 L 114000 111 101 000	Other Receivabl/Elementary Fund	0.00	0.00	0.00	0.00
750 L 417000 111 101 000	Student Body Ac/Elementary Fund/Elementary Fund	-11,918.46	-1,050.38	0.00	-12,968.84
750 L 417000 120 101 000	Student Body Ac/Music/Music Fund	-6.98	0.00	0.00	-6.98
750 L 417000 201 101 000	Student Body Ac/Donations-Grant/Donations	-1,969.60	0.00	0.00	-1,969.60
750 L 417000 222 101 000	Student Body Ac/McCall Art/McCall Art Calendar	-1,169.81	-60.00	89.34	-1,140.47
750 L 417000 303 101 000	Student Body Ac/Sunshine Fund/Sunshine Fund	-264.00	-185.00	0.00	-449.00
750 L 417000 305 101 000	Student Body Ac/Classroom 1/1st Grade	0.00	0.00	0.00	0.00
750 L 417000 306 101 000	Student Body Ac/Classroom 2/2nd Grade	0.00	0.00	0.00	0.00
750 L 417000 307 101 000	Student Body Ac/Classroom 3/3rd Grade	0.00	0.00	0.00	0.00
750 L 417000 309 101 000	Student Body Ac/Classroom 5/5th Grade	-4.40	0.00	0.00	-4.40
750 L 417000 444 101 000	Student Body Ac/Fourth Grade/Fourth Grade	-577.11	0.00	0.00	-577.11
750 L 417000 620 101 000	Student Body Ac/Interest/Interest	55.90	-0.08	0.00	55.82
750 L 417000 909 101 000	Student Body Ac/Library/Library	-3,895.99	0.00	0.00	-3,895.99
Total Liability Accounts:		-19,750.45	-1,295.46	89.34	-20,956.57
Total Asset Accounts:		19,750.45	1,295.46	-89.34	20,956.57
Total Liability Accounts:		-19,750.45	-1,295.46	89.34	-20,956.57
Total Equity Accounts:		0.00	0.00	0.00	0.00
Total Revenue Accounts:		0.00	0.00	0.00	0.00
Total Expense Accounts:		0.00	0.00	0.00	0.00
Grand Total:		0.00	0.00	0.00	0.00

***** End of report *****

Description: SBAA Entity 102 Acct. Receipt/Disbursement Summary Rpt - ASB Board Summary Report

Account	Description	Oct. 1, 2022 Beginning Balance	Posted SBAA Receipts	Posted SBAA Disbursements	Oct. 31, 2022 Ending Balance
750 A 111000 101 102 000	Cash/Cash	13,539.84	0.05	-16.00	13,523.89
Total Asset Accounts:		13,539.84	0.05	-16.00	13,523.89
750 L 417000 120 102 000	Student Body Ac/Music/Music	-262.13	0.00	0.00	-262.13
750 L 417000 201 102 000	Student Body Ac/Donations-Grant/Donations-Grants	-48.02	0.00	0.00	-48.02
750 L 417000 202 102 000	Student Body Ac/Spanish/Spanish	-551.51	0.00	0.00	-551.51
750 L 417000 304 102 000	Student Body Ac/Classroom K/Classroom K	-179.18	0.00	0.00	-179.18
750 L 417000 305 102 000	Student Body Ac/Classroom 1/Classroom 1	-533.52	0.00	0.00	-533.52
750 L 417000 306 102 000	Student Body Ac/Classroom 2/Classroom 2	-244.08	0.00	0.00	-244.08
750 L 417000 307 102 000	Student Body Ac/Classroom 3/Classroom 3	-362.27	0.00	0.00	-362.27
750 L 417000 308 102 000	Student Body Ac/Classroom 4/Classroom 4	-226.34	0.00	0.00	-226.34
750 L 417000 309 102 000	Student Body Ac/Classroom 5/Classroom 5	-5,109.05	0.00	0.00	-5,109.05
750 L 417000 401 102 000	Student Body Ac/General/General	-2,197.41	-0.05	16.00	-2,181.46
750 L 417000 666 102 000	Student Body Ac/Run Girl Run/Run Girl Run	-121.45	0.00	0.00	-121.45
750 L 417000 888 102 000	Student Body Ac/Greenhouse/Greenhouse	-945.62	0.00	0.00	-945.62
750 L 417000 909 102 000	Student Body Ac/Library/Library	-275.40	0.00	0.00	-275.40
750 L 417000 948 102 000	Student Body Ac/Lifetime Sports/Ski Day/Lifetime	-1,206.00	0.00	0.00	-1,206.00
750 L 417000 999 102 000	Student Body Ac/PE/Athletic/Physical Education	-1,277.86	0.00	0.00	-1,277.86
Total Liability Accounts:		-13,539.84	-0.05	16.00	-13,523.89
Total Asset Accounts:		13,539.84	0.05	-16.00	13,523.89
Total Liability Accounts:		-13,539.84	-0.05	16.00	-13,523.89
Total Equity Accounts:		0.00	0.00	0.00	0.00
Total Revenue Accounts:		0.00	0.00	0.00	0.00
Total Expense Accounts:		0.00	0.00	0.00	0.00
Grand Total:		0.00	0.00	0.00	0.00

***** End of report *****

Description: SBAA Entity 401 Acct. Receipt/Disbursement Summary Rpt - ASB Board Summary Report

Account	Description	Oct. 1, 2022	Posted SBAA	Posted SBAA	Oct. 31, 2022
		Beginning Balance	Receipts	Disbursements	Ending Balance
750 A 111000 101 401 000	Cash/Cash/US Bank Checking	169,470.96	18,880.58	-66,837.72	121,513.82
750 A 111000 103 401 000	Cash/Cash-Savings/US Bank Savings	16.78	0.00	0.00	16.78
750 A 111000 103 401 003	Cash/Cash-Savings/Savings	13,744.91	0.05	0.00	13,744.96
750 A 111000 104 401 000	Cash/Cash - CD/US Bank CD	0.00	0.00	0.00	0.00
750 A 111000 105 401 000	Cash/Cash - CD 2/ID First CD	0.00	0.00	0.00	0.00
750 A 111000 106 401 000	Cash/LGIP Savings 3634	101,247.15	0.00	174.65	101,421.80
750 A 111000 879 401 000	Cash/Petty Cash/Petty Cash	939.00	0.00	0.00	939.00
Total Asset Accounts:		285,418.80	18,880.63	-66,663.07	237,636.36
750 L 111000 879 401 000	Cash/Petty Cash/Petty Cash	0.00	0.00	0.00	0.00
750 L 417000 000 401 000	Student Body Ac/Out of District Student Travel	0.00	0.00	0.00	0.00
750 L 417000 120 401 000	Student Body Ac/Music/Music	-1,823.05	0.00	0.00	-1,823.05
750 L 417000 200 401 000	Student Body Ac/Benefits/SRV PRESIDENT	-3,345.80	-100.00	384.65	-3,061.15
750 L 417000 202 401 000	Student Body Ac/Spanish/Spanish	0.00	0.00	0.00	0.00
750 L 417000 303 401 000	Student Body Ac/Sunshine Fund/Sunshine Fund	-906.07	-100.00	0.00	-1,006.07
750 L 417000 401 401 000	Student Body Ac/General/General	-12,901.44	0.00	22.89	-12,878.55
750 L 417000 407 401 000	Student Body Ac/Science Club/Science Club	-227.87	0.00	0.00	-227.87
750 L 417000 864 401 000	Student Body Ac/MDJSD: Athletic/MDHS Booster	-14,746.91	-860.00	4,771.28	-10,835.63
750 L 417000 865 401 000	Student Body Ac/Postage/Postage	-16.73	-11.00	0.00	-27.73
750 L 417000 866 401 000	Student Body Ac/Sales Tax/Sales Tax	-1,794.92	-580.93	1,747.73	-628.12
750 L 417000 867 401 000	Student Body Ac/Class of 2017/Class of 2022	-1,716.36	0.00	1,616.36	-100.00
750 L 417000 868 401 000	Student Body Ac/Class of 2018/Class of 2023	-7,705.71	0.00	143.39	-7,562.32
750 L 417000 869 401 000	Student Body Ac/Class of 2019/Class of 2024	-1,368.58	-770.04	339.94	-1,798.68
750 L 417000 870 401 000	Student Body Ac/Class of 2020/Class of 2026	-100.00	-1,616.36	0.00	-1,716.36
750 L 417000 871 401 000	Student Body Ac/Class of 2021/Class of 2025	-1,170.92	0.00	0.00	-1,170.92
750 L 417000 872 401 000	Student Body Ac/ASB Senate/ASB Senate	-3,735.99	-12.00	267.28	-3,480.71
750 L 417000 873 401 000	Student Body Ac/BPA/BPA	-51.89	0.00	0.00	-51.89
750 L 417000 874 401 000	Student Body Ac/Counseling/Counseling	-4,525.37	-75.00	75.00	-4,525.37
750 L 417000 875 401 000	Student Body Ac/Drama/Drama	-4,790.41	0.00	3,495.47	-1,294.94
750 L 417000 876 401 000	Student Body Ac/Science/Science	0.00	0.00	0.00	0.00
750 L 417000 877 401 000	Student Body Ac/Family Consumer/Family Consumer S	-2,777.80	0.00	0.00	-2,777.80
750 L 417000 878 401 000	Student Body Ac/French Club/French Club	-543.27	0.00	0.00	-543.27
750 L 417000 879 401 000	Student Body Ac/Petty Cash/Petty Cash	-1,017.95	0.00	0.00	-1,017.95
750 L 417000 881 401 000	Student Body Ac/Industrial Arts/Industrial Arts	-4,949.36	0.00	0.00	-4,949.36
750 L 417000 882 401 000	Student Body Ac/Interact Club/Interact Club	0.00	0.00	0.00	0.00
750 L 417000 883 401 000	Student Body Ac/Lost Books/Lost Books	-3,157.51	0.00	0.00	-3,157.51
750 L 417000 884 401 000	Student Body Ac/NHS/National Honor Society	-2,205.54	-180.00	0.00	-2,385.54

Account	Description	Oct. 1, 2022	Posted SBAA	Posted SBAA	Oct. 31, 2022
		Beginning Balance	Receipts	Disbursements	Ending Balance
750 L 417000 885 401 000	Student Body Ac/Scholarships/Scholarships	-4,679.46	0.00	0.00	-4,679.46
750 L 417000 886 401 000	Student Body Ac/Weight Room/Weight Room	-465.58	0.00	0.00	-465.58
750 L 417000 887 401 000	Student Body Ac/Yearbook/Yearbook	-14,022.05	-153.45	0.00	-14,175.50
750 L 417000 888 401 000	Student Body Ac/Greenhouse/Greenhouse	0.00	0.00	0.00	0.00
750 L 417000 889 401 000	Student Body Ac/Art Club/Art Club	-1,084.82	0.00	0.00	-1,084.82
750 L 417000 891 401 000	Student Body Ac/iClub/iClub	-1,936.16	0.00	0.00	-1,936.16
750 L 417000 892 401 000	Student Body Ac/Humanitarian/Humanitarian Club	-174.90	0.00	0.00	-174.90
750 L 417000 893 401 000	Student Body Ac/Mathletes Club/Mathletes Club	0.00	0.00	0.00	0.00
750 L 417000 894 401 000	Student Body Ac/MDHS Garden/MDHS Garden	-1,697.94	0.00	0.00	-1,697.94
750 L 417000 895 401 000	Student Body Ac/Committed/Committed Program	0.00	0.00	0.00	0.00
750 L 417000 896 401 000	Student Body Ac/Music Boosters/Music Boosters	-7,309.50	0.00	0.00	-7,309.50
750 L 417000 897 401 000	Student Body Ac/Beverage Vend/Beverage Vending	-2,600.72	-423.15	292.09	-2,731.78
750 L 417000 898 401 000	Student Body Ac/BSoccer G/BSoccer General	-32.90	0.00	0.00	-32.90
750 L 417000 899 401 000	Student Body Ac/Cheerleading G/Cheerleading Gener	-623.11	0.00	0.00	-623.11
750 L 417000 900 401 000	Student Body Ac/Cross Country G/Cross Country Gen	-405.00	0.00	0.00	-405.00
750 L 417000 901 401 000	Student Body Ac/Football G/Football General	-506.65	0.00	0.00	-506.65
750 L 417000 902 401 000	Student Body Ac/GSoccer G/GSoccer General	-567.48	0.00	0.00	-567.48
750 L 417000 903 401 000	Student Body Ac/Volleyball G/Volleyball General	-500.00	0.00	0.00	-500.00
750 L 417000 904 401 000	Student Body Ac/BBasketball G/BBasketball General	-500.00	0.00	0.00	-500.00
750 L 417000 905 401 000	Student Body Ac/GBasketball G/GBasketball General	-503.99	0.00	0.00	-503.99
750 L 417000 906 401 000	Student Body Ac/Wrestling G/Wrestling General	-400.75	0.00	0.00	-400.75
750 L 417000 907 401 000	Student Body Ac/Baseball G/Baseball General	-304.28	0.00	0.00	-304.28
750 L 417000 908 401 000	Student Body Ac/Golf G/Golf General	-405.95	0.00	0.00	-405.95
750 L 417000 909 401 000	Student Body Ac/Library/Library	-645.68	0.00	0.00	-645.68
750 L 417000 910 401 000	Student Body Ac/Bank Interest/Bank Interest/Servi	-963.99	-175.39	0.00	-1,139.38
750 L 417000 911 401 000	Student Body Ac/Softball G/Softball General	-326.15	0.00	0.00	-326.15
750 L 417000 912 401 000	Student Body Ac/Track G/Track General	-400.00	0.00	0.00	-400.00
750 L 417000 913 401 000	Student Body Ac/Vandal Pride C/Vandal Pride Club	-5,209.35	0.00	0.00	-5,209.35
750 L 417000 915 401 000	Student Body Ac/Admissions/Admissions	-8,112.48	-6,186.73	2,583.03	-11,716.18
750 L 417000 916 401 000	Student Body Ac/ASB Cards/ASB Cards	-18,326.66	-83.70	0.00	-18,410.36
750 L 417000 917 401 000	Student Body Ac/Family Passes/Family Passes	-8,873.55	-930.00	0.00	-9,803.55
750 L 417000 918 401 000	Student Body Ac/Game Manager/Game Manager	-292.50	0.00	235.00	-57.50
750 L 417000 919 401 000	Student Body Ac/Real Foods/Real Foods for Real Pe	-929.70	0.00	591.00	-338.70
750 L 417000 920 401 000	Student Body Ac/Officials/Officials	-9,627.39	0.00	13,140.00	3,512.61
750 L 417000 921 401 000	Student Body Ac/Athletic Mgmt/Athletic Management	-14,243.37	-1,062.00	468.80	-14,836.57
750 L 417000 922 401 000	Student Body Ac/State Travel/State Travel	-15,802.95	-30.00	5,550.16	-10,282.79
750 L 417000 923 401 000	Student Body Ac/Uniforms/Uniforms	0.00	0.00	0.00	0.00
750 L 417000 924 401 000	Student Body Ac/WIC/WIC	-4,208.01	0.00	0.00	-4,208.01
750 L 417000 925 401 000	Student Body Ac/B Soccer F/B Soccer - Fundraising	-1,841.85	-2,557.75	1,582.75	-2,816.85

<u>Account</u>	<u>Description</u>	<u>Oct. 1, 2022</u> <u>Beginning Balance</u>	<u>Posted SBAA</u> <u>Receipts</u>	<u>Posted SBAA</u> <u>Disbursements</u>	<u>Oct. 31, 2022</u> <u>Ending Balance</u>
750 L 417000 926 401 000	Student Body Ac/Cheerleading F/Cheerleading Fundr	-6,201.99	0.00	0.00	-6,201.99
750 L 417000 927 401 000	Student Body Ac/Cross Country F/Cross Country Fun	-626.00	0.00	250.00	-376.00
750 L 417000 928 401 000	Student Body Ac/Football F/Football Fundraising	-44,699.34	-3,003.75	31,235.26	-16,467.83
750 L 417000 929 401 000	Student Body Ac/GSoccer F/GSoccer - Fundraising	-5,431.55	-990.75	0.00	-6,422.30
750 L 417000 930 401 000	Student Body Ac/Volleyball F/Volleyball Fundraisi	-9,996.42	-2,191.64	1,384.00	-10,804.06
750 L 417000 931 401 000	Student Body Ac/BBasketball F/BBasketball Fundrai	-1,828.71	0.00	0.00	-1,828.71
750 L 417000 932 401 000	Student Body Ac/GBasketball F/GBasketball Fundrai	-917.17	0.00	0.00	-917.17
750 L 417000 933 401 000	Student Body Ac/Wrestling F/Wrestling Fundraising	-561.19	0.00	0.00	-561.19
750 L 417000 934 401 000	Student Body Ac/Baseball F/Baseball Fundraising	-3,007.98	0.00	0.00	-3,007.98
750 L 417000 935 401 000	Student Body Ac/Golf F/Golf Fundraising	-171.48	-300.00	0.00	-471.48
750 L 417000 936 401 000	Student Body Ac/Softball F/Softball Fundraising	-3,497.96	0.00	0.00	-3,497.96
750 L 417000 937 401 000	Student Body Ac/Track F/Track Fundraising	-4,433.00	0.00	0.00	-4,433.00
750 L 417000 938 401 000	Student Body Ac/Clearing Acct/Clearing Account	232.68	0.00	0.00	232.68
750 L 417000 999 401 000	Student Body Ac/PE/Athletic/Physical Education/At	-174.37	0.00	0.00	-174.37
	Total Liability Accounts:	-285,418.80	-22,393.64	70,176.08	-237,636.36
					37
	Total Asset Accounts:	285,418.80	18,880.63	-66,663.07	237,636.36
	Total Liability Accounts:	-285,418.80	-22,393.64	70,176.08	-237,636.36
	Total Equity Accounts:	0.00	0.00	0.00	0.00
	Total Revenue Accounts:	0.00	0.00	0.00	0.00
	Total Expense Accounts:	0.00	0.00	0.00	0.00
	Grand Total:	0.00	-3,513.01	3,513.01	0.00

***** End of report *****

Description: SBAA Entity 602 Acct. Receipt/Disbursement Summary Rpt - ASB Board Summary Report

Account	Description	Oct. 1, 2022	Posted SBAA	Posted SBAA	Oct. 31, 2022
		Beginning Balance	Receipts	Disbursements	Ending Balance
750 A 111000 101 602 000	Cash/Cash	13,462.09	0.00	-5,463.66	7,998.43
Total Asset Accounts:		13,462.09	0.00	-5,463.66	7,998.43
750 L 111000 101 602 000	Cash/Cash/Petty Cash	0.00	0.00	0.00	0.00
750 L 111000 952 602 000	Cash/Gifted-Talented/Gifted and Talented	0.00	0.00	0.00	0.00
750 L 417000 120 602 000	Student Body Ac/Music/Music	-28.90	0.00	0.00	-28.90
750 L 417000 202 602 000	Student Body Ac/Spanish/Spanish Club	-726.71	0.00	0.00	-726.71
750 L 417000 401 602 000	Student Body Ac/General/Miscellaneous	-11.56	0.00	9.99	-1.57
750 L 417000 866 602 000	Student Body Ac/Sales Tax/Sales Tax	0.00	0.00	0.00	0.00
750 L 417000 876 602 000	Student Body Ac/Science/Science Club	-86.78	0.00	0.00	-86.78
750 L 417000 879 602 000	Student Body Ac/Petty Cash/Petty Cash	-500.00	0.00	0.00	-500.00
750 L 417000 884 602 000	Student Body Ac/NHS/Honor Society	-304.99	0.00	0.00	-304.99
750 L 417000 887 602 000	Student Body Ac/Yearbook/Yearbook	-1,938.16	0.00	205.00	-1,733.16
750 L 417000 889 602 000	Student Body Ac/Art Club/Art Club	-1,034.68	0.00	0.00	-1,034.68
750 L 417000 899 602 000	Student Body Ac/Cheerleading G/Cheerleading	-659.34	0.00	472.50	-186.84
750 L 417000 900 602 000	Student Body Ac/Cross Country G/Cross Country	-226.71	0.00	155.00	-71.71
750 L 417000 901 602 000	Student Body Ac/Football G/Football	-47.34	0.00	0.00	-47.34
750 L 417000 903 602 000	Student Body Ac/Volleyball G/Volleyball	-264.05	0.00	250.00	-14.05
750 L 417000 904 602 000	Student Body Ac/BBasketball G/Boys Basketball	-754.90	0.00	675.00	-79.90
750 L 417000 905 602 000	Student Body Ac/GBasketball G/Girls Basketball	-53.53	0.00	0.00	-53.53
750 L 417000 906 602 000	Student Body Ac/Wrestling G/Wrestling	-451.45	0.00	306.80	-144.65
750 L 417000 912 602 000	Student Body Ac/Track G/Track & Field	-92.17	0.00	0.00	-92.17
750 L 417000 939 602 000	Student Body Ac/Faculty/Faculty	-22.65	0.00	0.00	-22.65
750 L 417000 940 602 000	Student Body Ac/Student Council/Student Council	-749.57	0.00	104.97	-644.60
750 L 417000 941 602 000	Student Body Ac/7th Grade/7th Grade	-194.32	0.00	0.00	-194.32
750 L 417000 942 602 000	Student Body Ac/Veterans Prg/Veterans Program	-472.11	0.00	0.00	-472.11
750 L 417000 943 602 000	Student Body Ac/Chess Club/Chess Club	-45.27	0.00	0.00	-45.27
750 L 417000 944 602 000	Student Body Ac/Business Club/Business Club	-1,762.46	0.00	1,154.11	-608.35
750 L 417000 945 602 000	Student Body Ac/Special Ed/Special Education	-5.72	0.00	0.00	-5.72
750 L 417000 948 602 000	Student Body Ac/Lifetime Sports/Lifetime Sports	-2,136.54	0.00	2,130.29	-6.25
750 L 417000 949 602 000	Student Body Ac/Debate Club/Debate Club	-100.00	0.00	0.00	-100.00
750 L 417000 950 602 000	Student Body Ac/7th Grade/7th Grade	-250.06	0.00	0.00	-250.06
750 L 417000 951 602 000	Student Body Ac/8th Grade/8th Grade	-350.58	0.00	0.00	-350.58
750 L 417000 952 602 000	Student Body Ac/Gifted-Talented/Gifted and Talent	-82.02	0.00	0.00	-82.02
750 L 417000 953 602 000	Student Body Ac/Samson/Samson Trail Run	-109.52	0.00	0.00	-109.52
750 L 417000 954 602 000	Student Body Ac/Viking Way/Viking Way Club	0.00	0.00	0.00	0.00
750 L 417000 955 602 000	Student Body Ac/Athletics - General	0.00	0.00	0.00	0.00

<u>Account</u>	<u>Description</u>	<u>Oct. 1, 2022</u>	<u>Posted SBAA</u>	<u>Posted SBAA</u>	<u>Oct. 31, 2022</u>
		<u>Beginning Balance</u>	<u>Receipts</u>	<u>Disbursements</u>	<u>Ending Balance</u>
	Total Liability Accounts:	-13,462.09	0.00	5,463.66	-7,998.43
	Total Asset Accounts:	13,462.09	0.00	-5,463.66	7,998.43
	Total Liability Accounts:	-13,462.09	0.00	5,463.66	-7,998.43
	Total Equity Accounts:	0.00	0.00	0.00	0.00
	Total Revenue Accounts:	0.00	0.00	0.00	0.00
	Total Expense Accounts:	0.00	0.00	0.00	0.00
	Grand Total:	0.00	0.00	0.00	0.00

***** End of report *****



McCall-Donnelly Joint School District No. 421
120 Idaho Street, McCall, ID 83638
Phone: (208) 634-2161 Fax: (208) 634-4075

"Developing Lifelong Learners Today"

Date: November 14, 2022
To: Board of Trustees
From: Eric Pingrey
Subject: Employee Resignations

It is recommended that the following resignations be approved:

Location	Employee	Current Assignment	Effective Date
BRMES	Sara Anderegg	Special Education Teacher	November 2022

Eric Pingrey
Superintendent



"Developing Lifelong Learners Today"

McCall-Donnelly Joint School District No. 421
120 Idaho Street, McCall, ID 83638
Phone: (208) 634-2161 Fax: (208) 634-4075

Date: November 14, 2022
To: Board of Trustees
From: Eric Pingrey
Subject: Policy 3113

Policy 3113 Homeschooling/non accredited programs is a policy that governs the transfer of credits from homeschooling and non-accredited programs. Currently there are students transferring back into MDSB that this policy effects. Ms. Pernell has followed the chain of communication and has worked with the high school principal and superintendent to problem solve the effects of earning credit in a non-accredited school. Since this is a policy issue, I have placed Ms. Pernell on the agenda so as to communicate her concerns in a format that may allow dialogue.

Eric Pingrey
Superintendent

FY 2024 Major Maintenance - Capital Improvement Considerations

Code	Location	Type	Estimate	FY '24 priority
2	Repair/replace damaged concrete sidewalks	BRMES	\$ -	
2	Upgrade/replace gym sound system	BRMES	\$ -	
		BRMES	<u>\$ 99,000.00</u>	<u>\$ -</u>
3	Addition/remodel	DES	\$ -	X
		DES	<u>\$ 14,000,000.00</u>	<u>\$ -</u>
2	Upgrade/replace gym speakers	MDHS	\$ -	
2	Replace smooth surface flooring	MDHS	\$ -	
2	Replace irrigation- main field	MDHS	\$ -	
2	Repair/replace concrete sidewalks	MDHS	\$ -	
2	Heating boiler maintenance	MDHS	\$ -	X
2	Softball dugout	MDHS	\$ -	X
2	Repave bus lane	MDHS	\$ -	X
		MDHS	<u>\$ 665,000.00</u>	<u>\$ -</u>
3	Addition/remodel	PLMS	\$ -	X
3	Traffic solution/Parking lot repair/replace	PLMS	\$ -	X
2	Replace lockers	PLMS	\$ -	
		PLMS	<u>\$ 8,590,000.00</u>	<u>\$ -</u>
2	Pave and surface East end of Sabala	Sabala	\$ -	
1 2	Refresh concession stand	Sabala	\$ -	
		Sabala	<u>\$ 95,000.00</u>	
2	Staff housing - Phase 1	MDSD	\$ -	X
		MDSD	<u>\$ 4,000,000.00</u>	<u>\$ -</u>
Legend			Total	<div style="display: flex; justify-content: space-around;"> <div style="border: 1px solid black; padding: 2px;">\$ 27,449,000.00</div> <div style="border: 1px solid black; padding: 2px;">\$ 8,868,500.00</div> </div>

- 1 Potential Health and Safety Issue
- 2 Repair/Upgrade
- 3 New/Change
- 4 Annual Needs

Agriculture, Food, and Natural Resources

Agriculture, Food, and Natural Resources

- ▶ Agriculture Food Science & Processing
- ▶ Agriculture Leadership & Communications
- ▶ Animal Science
- ▶ Horticulture
- ▶ Plant and Soil
- ▶ Agribusiness
- ▶ Ecology & Natural Resource Management
- ▶ Agricultural Welding*
- ▶ Agricultural Small Engine Repair*
- ▶ Agricultural Mechanics*

Agriculture, Food, and Natural Resources

Agriculture, Food & Natural Resources Secondary Pathway Sequence

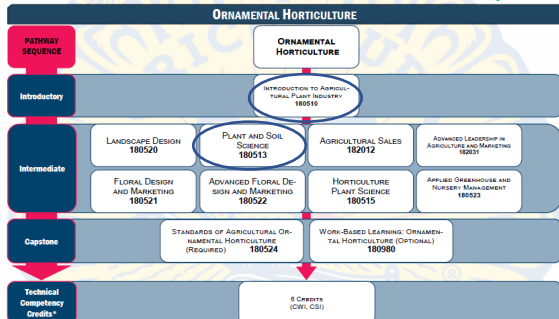

*Credits can be transcribed at the specified postsecondary institutions.

Agriculture, Food & Natural Resources Secondary Pathway Sequence

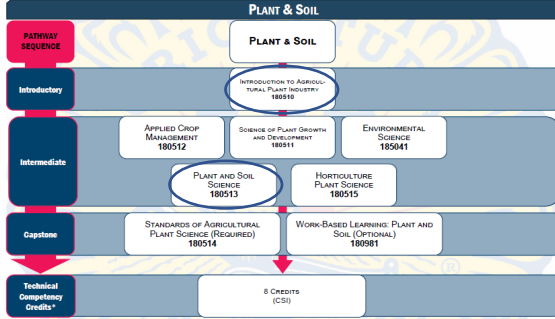

*Credits can be transcribed at the specified postsecondary institutions.

Agriculture, Food, & Natural Resources Secondary Pathway Sequence*

*This pathway sequence goes into effect on August 1st, 2020 for the 2020-2021 school year. A CTE program should include a minimum of three sequential semesters** that culminates in the required capstone course. **Career Technical Schools must include a minimum of five semesters.

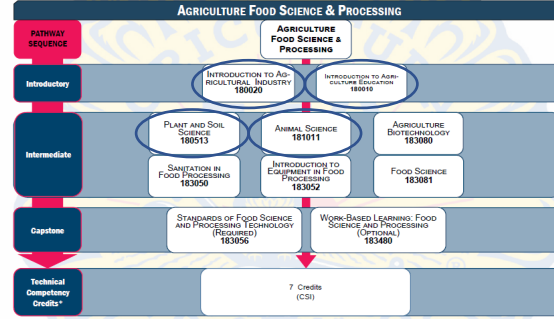

*Credits can be transcribed at the specified postsecondary institutions.

Agriculture, Food & Natural Resources Secondary Pathway Sequence

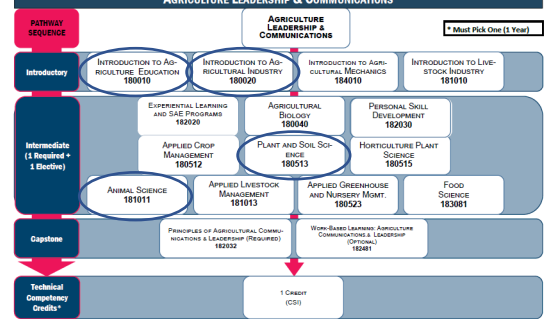

*Credits can be transcribed at the specified postsecondary institutions.

Agriculture, Food & Natural Resources Secondary Pathway Sequence

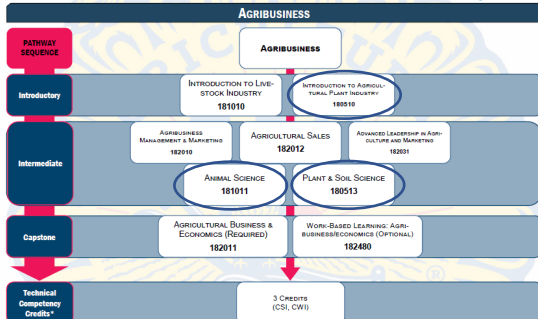

*Credits can be transcribed at the specified postsecondary institutions.

Agriculture, Food & Natural Resources Secondary Pathway Sequence

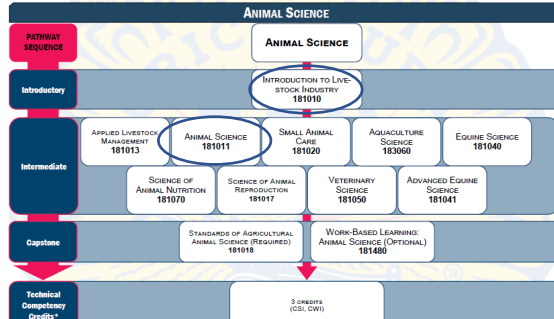

*Credits can be transcribed at the specified postsecondary institutions.

Agriculture, Food & Natural Resources Secondary Pathway Sequence

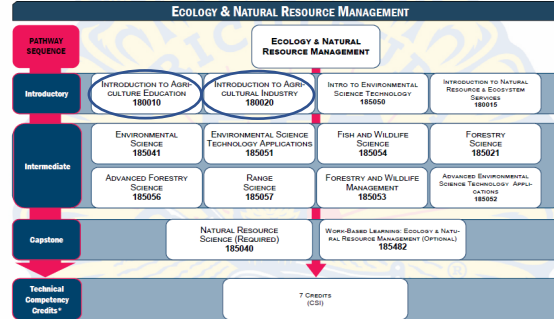

*Credits can be transcribed at the specified postsecondary institutions.

Agriculture, Food, & Natural Resources Secondary Pathway Sequence

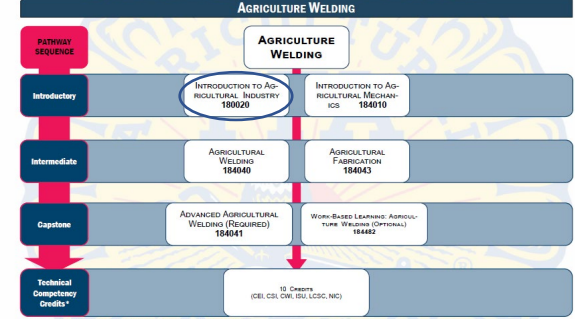

*Credits can be transcribed at the specified postsecondary institutions.

Agriculture, Food, and Natural Resources

▶ 9th Grade

- ▶ Business Computers (1)
- ▶ Technology 1 (1)
- ▶ *

▶ 10th Grade

- ▶ Business Computers 2 (1)
- ▶ Technology 2 (1)
- ▶ *

*Intro to Agricultural Industry (2)

▶ 11th Grade

- ▶ Technology 3 (1)
- ▶ Animal Science (1)
- ▶ Plant Science (1)

▶ 12th Grade

- ▶ Accounting (2)
- ▶ CDL (2)



"Developing Lifelong Learners Today"

McCall-Donnelly Joint School District No. 421
120 Idaho Street, McCall, ID 83638
Phone: (208) 634-2161 Fax: (208) 634-4075

Date: November 14, 2022
To: Board of Trustees
From: Eric Pingrey
Subject: Construction Update

The PLMS project was brought before the Planning and Zoning committee for the city of McCall. The city is recommending that the school must give up a 70 ft easement on the south of the property for future development. Design West spoke on behalf of the district and opposed this once again. The decision of the Planning and Zoning is to table this until January as they feel they do not have enough information to proceed.

Staff housing parcel rezone. The plot of land on Mission and Stibnite was recommended to be rezoned R-8 by the district. It was unanimously approved by the planning and zoning committee. It will go before the council in December. Once finalized the southern parcel may be auctioned off.

Donnelly Elementary project is continuing to move forward. The gymnasium is nearly to the roof. The multipurpose room is slotted to be completed by December 10th, along with the front entrance.

Internet is connected at the new district office and we will be planning our move.

Eric Pingrey
Superintendent



"Developing Lifelong Learners Today"

McCall-Donnelly Joint School District No. 421
120 Idaho Street, McCall, ID 83638
Phone: (208) 634-2161 Fax: (208) 634-4075

Date: November 14, 2022
To: Board of Trustees
From: Eric Pingrey
Subject: Transportation Spot Inspection Final Results

Attached is a memo from the State Department of Education in reference to our transportation services. I have included the summary below.

"In conclusion, although certain operational items have been identified as needing or requiring improvement, these items should not overshadow the positive aspects of the district's student transportation operational program. The commendations listed at the beginning of this report affirm the inspection team's assessment of the district's effort to manage an efficient student transportation program that ensures student safety."

Eric Pingrey
Superintendent



November 4, 2022

Eric Pingrey, Superintendent
McCall-Donnelly Joint School District #421
120 Idaho Street
McCall, ID 83638

Dear Superintendent Pingrey,

Re: Findings of Spot Inspection
Preliminary Financial Audit Report
Appeals Due Date: November 18, 2022

The State Department of Education, Student Transportation conducted a spot inspection on October 24-27, 2022. I rode school bus routes, inspected school buses, reviewed driver personnel files, financial and maintenance records. The following are commendations related to the findings:

- School bus drivers exhibited excellent vehicle operation and student management skills.
- Drivers exhibited excellent rapport and management skills with the students.
- Drivers are performing their student crossing in accordance with state loading / unloading training curriculum with proper eye contact from students and proper hand signal.
- The inspection team reviewed the district's ridership. The district's methodology appears to reconcile to the student transportation ridership report.
- The supervision at the schools shows a safe and courteous structure in the staging and loading areas.
- Many inspection discrepancies were corrected prior to the completion of the review.
- The transportation staff was helpful and courteous throughout the inspection process.
- Lewis Miller has met the criteria to qualify as a district school bus driver trainer.

Listed below are exceptions to Idaho Code, State Board of Education Rules of the Board Governing Education, and rules and regulations adopted by reference, including the Standards

for Idaho School Buses and Operations (SISBO). These requirements must be met if the district is to operate a fully approved reimbursable student transportation program.

I rode two school bus routes, evaluated driver skills and bus stops, and assessed district routing configurations, resulting in a compliance rating of 93%.

"The procedure for stopping to load/unload students shall be:

- a. Signal intention to stop with alternately flashing overhead yellow warning lights at a distance of two hundred (200) feet before stopping.*

While riding bus routes the buses stopped four times at various schools and I observed one instances of schools without continuous and interactive loading/unloading zone supervision, resulting in a compliance rating of 75%.

"Providing supervision of loading and unloading areas at or near schools during unloading and loading of school buses. School districts shall provide an adequate number of supervisors for the size of the loading area and number of students present and ensure close, continuous and interactive supervision whenever students and/or buses are present in the loading area." Standards for Idaho School Buses & Operations (SISBO) Rule by Reference. (33-1511, Idaho Code; ID APA 08.02.02.150)

Three driver files were reviewed. Driver files did not contain current copies of one fall emergency evacuations, and two spring emergency evacuations. The missing documentation reflects a compliance rating of 91%.

"Each district that operates or contracts pupil transportation services shall cause to have filed for each school bus driver, in a secure area with limited access, the following information:

Historical record of all topic specific school bus driver training.

Copy of all driver and route evaluations." (Idaho Codes 33-1506, 33-1508-1509; SISBO)

"The district's written policies shall, at a minimum, include:

"Providing emergency training and periodic evacuation drills for students in accordance with National Highway Safety Program Guideline 17. Documentation of all evacuation drills shall be maintained for a period of three years by the school district in either a batch file or in the driver's individual file." (SISBO)

I reviewed the sixty-day and annual inspection records of three buses. Three sixty-day inspections occurred outside the required time frame, resulting in a compliance rating of 90%.

"The board of trustees of each school district shall provide for an annual inspection of all school buses by district personnel or upon contract at intervals of not more than twelve (12) months. At intervals of not more than sixty (60) days during each school year the board of trustees shall cause inspection to be made of all school buses operating under the authority of the board." (Idaho Code 33-1506)

I inspected three school buses, resulting in a compliance rating of 96.46%. All vehicle components inspected may be viewed in the Idaho Bus Utilization System at <https://apps.sde.idaho.gov/ibus> and all deficiencies need to be certified in IBUS as repaired within 30 days of the inspection.

I reviewed the district's 2021-2022 Transportation Reimbursement Claim. *The Claim will be reviewed by the department's financial specialist, and information will be provided at that time.*

You can review the detailed audit report in IBUS at <https://apps.sde.idaho.gov/ibus>.

The above operational findings are open to appropriate differences of opinion. I welcome your comments and expressions of concern. Resolution inquiries related to any of the operational findings detailed above should be directed to Kyle Rahn (krahn@sde.idaho.gov), Transportation Director, at (208) 332-6851.

Based on observations, Student Transportation believes the following recommendations will strengthen your student transportation program, if implemented:

- The transportation supervisor should utilize Terry Lenz while performing or in helping with driver evaluations and emergency evacuation drills with/out students.
- The district shall ensure that Harlow's is conducting a training session for all school bus drivers, covering the school district's student transportation student management policy, including the duties and responsibilities of students, teachers and drivers. This policy shall be in concert with the district's written classroom policies. (33-512, Idaho Code) (SISBO page 54)
- **Sixty-day inspections should be scheduled on a less than sixty day rotation prior to the start of the school year.**
- The district shall ensure that Harlow's is tracking all school bus training each fiscal year. **All experienced school bus drivers will complete at least ten (10) hours refresher each fiscal school year.** At least three (3) hours of pre service training shall be provided before school begins in the fall. In addition, at least three (3) in service training sessions shall be provided during the school year.

- The district's student transportation policies were reviewed and found to be missing one required component resulting in a compliance rating of 90% **Supervision at Schools**. In support of Idaho Code 33-1501 through 33-1512, the local board shall have in place written policies governing the student transportation program. (For a minimum list see SISBO page 67)

In conclusion, although certain operational items have been identified as needing or requiring improvement, these items should not overshadow the positive aspects of the district's student transportation operational program. The commendations listed at the beginning of this report affirm the inspection team's assessment of the district's effort to manage an efficient student transportation program that ensures student safety.

I would like to thank administrative and transportation personnel for their cooperation during my visit.

Sincerely,

A handwritten signature in blue ink, appearing to read "Brandon Collar".

Brandon Collar
Regional Specialist, Student Transportation

cc: Lewis Miller, Contract Manager
Penny Lancaster, Business Manager
Laurie Erekson, School Board Chair



Fall 2022

MDSD

Fall Benchmark Report

2022 MAP Fall Benchmark Data MDSD 3-5 ELA (Reading)

ELA Reading	ELA / Reading	Fall 2021 Mean RIT	Fall 2022 Mean RIT	NWEA Norms RIT Scores	Fall 2022 Projected Proficiency (SBAC)	Winter 2022 Projected Proficiency (SBAC)
3 rd Grade		183.1	185	186.62	43%	Feb 23
4 th Grade		204.4	200.6	196.67	60%	Feb 23
5 th Grade		209.9	213	204.48	83%	Feb 23

2022 iReady Fall Benchmark Data MDSD K-5 (MATH)

Overall Placement

Students Assessed/Total: 563/573

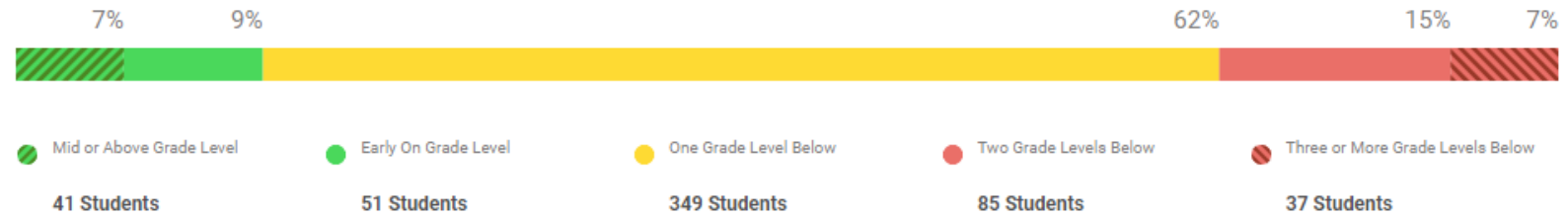

[i The Mapping Between 5-Level and 3-Level Placements](#)

Placement by Domain



Projected to:

ID-Smarter Balanced Assessment Consortia

taken in

spring

View Linking Study:

<https://www.nwea.org/resources/sbac-linking-study/>

Grade	Student Count	Level 1		Level 2		Level 3		Level 4	
		Count	Percent	Count	Percent	Count	Percent	Count	Percent
6	105	13	12.4%	18	17.1%	50	47.6%	24	22.9%
7	104	10	9.6%	25	24.0%	47	45.2%	22	21.2%
8	95	11	11.6%	13	13.7%	46	48.4%	25	26.3%
Total	304	34	11.2%	56	18.4%	143	47.0%	71	23.4%

PLMS
projected
proficiency
ENGLISH
from FALL 2022
MAP

Projected to:

ID-Smarter Balanced Assessment Consortia

taken in

spring

View Linking Study:

<https://www.nwea.org/resources/sbac-linking-study/>

Grade	Student Count	Level 1		Level 2		Level 3		Level 4	
		Count	Percent	Count	Percent	Count	Percent	Count	Percent
6	108	18	16.7%	32	29.6%	34	31.5%	24	22.2%
7	107	21	19.6%	38	35.5%	29	27.1%	19	17.8%
8	96	20	20.8%	27	28.1%	27	28.1%	22	22.9%
Total	311	59	19.0%	97	31.2%	90	28.9%	65	20.9%

PLMS
projected
proficiency
MATH
from FALL 2022
MAP



Community Forum

November 21, 2022

6-7pm

McCall-Donnelly High School Commons

401 N Mission St, McCall, ID

A discussion about data and the Continuous Improvement Plan.

Questions? Please call the district office at 208-634-2161.



"Developing Lifelong Learners Today"

McCall-Donnelly Joint School District No. 421
120 Idaho Street, McCall, ID 83638
Phone: (208) 634-2161 Fax: (208) 634-4075

Date: November 14, 2022
To: Board of Trustees
From: Eric Pingrey
Subject: Crestline Academy Lease Update

With the purchase of the property at 299 S. 3rd street all tenants have moved out except for Crestline Academy. Our intent with the building is to move forward with an early childhood center/childcare program as soon as feasible. A lease has been offered to Crestline Academy for the 2022-2023 school year, as a courtesy. The main component of the lease is to freeze the price at last year's rate, which comes out to only \$1.11 per square foot. At the writing of this memo, Crestline Academy has not signed the lease. Crestline is requesting that rent be reduced from last year's rate to pay \$0.58 per square foot.

Eric Pingrey
Superintendent

**McCall-Donnelly Joint School District No. 421 Lease of Premises
to Crestline Academy.**

THIS LEASE AGREEMENT ("Lease") is entered into as of the date of the last signature hereto by and between the Lessor and Lessee named below.

Lease Summary

0.1	Lessor	<i>McCall-Donnelly Joint School District No. 421</i>
0.2	Lessor's Address for Notices	<i>120 Idaho Street, McCall, Idaho 83638</i>
0.3	Lessee	<i>Crestline Academy</i>
0.4	Lessee's Address for Notices	299 South Third Street, McCall, Idaho 83638
0.5	Lessee's Trade Name	Crestline Academy
0.6	Demised Land	See Exhibit "A" attached hereto and incorporated herein
0.7	NA	
0.8	Lease Term	Nine (9) Months
0.9	Commencement Date	October 1, 2022
0.10	Expiration Date	June 30, 2023
0.11	Monthly Rent	Eight Thousand Five Hundred and 00/100 (\$8,500.00) Dollars per month to include October 2022
0.12	Security Deposit	Eight Thousand Five Hundred and 00/100 (\$8,500.00) Dollars per month
0.13	Use of Premises	Private School
0.14	Commercial General Liability Policy Minimum Limits	Limit per occurrence: \$1,000,000.00 Aggregate Limit: \$2,000,000.00
0.15	Guarantor[s]	Not Applicable
0.16	Guarantor[s] Address[es]	Not Applicable

Exhibits:

Exhibit A: Demised Premises

Article I Definitions

As used in this Lease, the following terms have the following meanings:

1.1 *Commencement Date*: The Commencement Date of this Lease shall be as set out in 0.9 hereof.

1.2 *Common Area*: The areas of the Premises or Improvements identified on Exhibit "E" attached hereto and incorporated herein.

1.3 *Day*: As used herein shall mean a twenty four (24) hour calendar day.

1.4 *Demised Land*: The parcels of real property and all easements, rights, privileges and appurtenances relating thereto as described in Exhibit "A," attached hereto and incorporated herein and leased to Lessee by Lessor pursuant to this Lease.

1.5 *Force Majeure*: Any delay beyond the reasonable control of the asserting party, due to theft, fire, Act of God or public enemy, severe and unusual weather conditions, injunction, riot, strikes, lockouts, inability to obtain labor or materials, insurrection, war, or court order. Matters of Lessee's finances shall not be considered a Force Majeure.

1.6 *Hazardous Material or Substance*: "Hazardous Material" or "Hazardous Substance" means and includes any of the substances, materials, elements or compounds that are contained in the list of hazardous substances adopted by the United States Environmental Protection Agency (EPA) and the list of toxic pollutants designated by the United States Congress or the EPA, or any substances, materials, elements or compounds affected by any other federal, state or local statute, law, ordinance, code, rule, regulation, order or decree now or at any time hereafter in effect regulating, relating to, or imposing liability or standards of conduct concerning any hazardous, toxic, dangerous, restricted or otherwise regulated waste, substance or material, as of now or at any time hereafter in effect.

1.7 *Improvements*: The buildings, structures, appurtenances and other improvements including, without limitation, all building machinery, equipment, floor coverings, heating, plumbing and air conditioning equipment, and any built-in appliances, which may now or hereafter during the term of the Lease be erected or located on the Demised Land; provided, however, that the term "Improvements" shall specifically exclude non-fixture personal property and Lessee's, or any Sub-Lessee's, trade fixtures.

1.8 *Inflation Index*: The Inflation Index for calculation of Annual Rent shall be the non-seasonally adjusted U.S. City Average All Items Consumer Price Index for All Urban Consumers, published monthly by the Bureau of Labor Statistics of the United States Department of Labor. If the Inflation Index is no longer available, Lessor will choose a new Inflation Index based upon comparable information, and Lessor will provide written notice to the Lessee of the new Inflation Index.

1.9 *Insurance Requirements:* All terms of any insurance policy or loss retention covering or applicable to the Premises or any part thereof and all requirements of the issuer of any such policy, and all orders, rules and regulations of the National Board of Fire Underwriters applicable to or materially affecting the Premises or any part thereof.

1.10 *Legal Requirements:* All laws, statutes, codes, ordinances, orders, judgments, decrees, injunctions, rules, regulations, permits or licenses which now or at any time hereafter may be materially applicable to the Premises or any part thereof, or to any adjoining sidewalks, streets or walkways or to any material use or condition of the Premises or any part thereof.

1.11 *Premises or Demised Premises:* The Demised Land and the Improvements as defined and described herein.

Article II Demised Premises

2.1 *Lessor's demise.* Upon the terms and conditions hereinafter set forth, and in consideration of the payment of the rents and the prompt performance by the Lessee of the covenants and agreements to be kept and performed by the Lessee, the Lessor does lease, let, and demise to the Lessee and the Lessee hereby leases from the Lessor, the land and improvements described on Exhibit "A" annexed hereto and incorporated herein.

2.2 *NA*

2.3 *Covenants running with land; binding effect.* All covenants, conditions, and obligations contained herein or implied by law are covenants running with the land and shall attach and bind and inure to the benefit of the Lessor and Lessee and their respective heirs, legal representatives, successors, and assigns, except as otherwise provided herein.

2.4 *Renovations to Premises.* N/A.

2.5 *Acceptance of Premises.* "As-is."

2.6 *Landlord-tenant relationship only.* Nothing in this Lease Agreement is intended to nor shall be deemed to create a relationship between the parties other than that of Landlord and Tenant.

Article III Term

To have and to hold the Demised Premises for the term set out in 0.8 above, unless terminated sooner as provided herein. Lessee shall have the right after execution of this Lease and upon payment of the rent to enter upon the Premises and to take possession thereof in accordance with this Lease.

Article IV
Rent

4.1 *Rents.* The Monthly Rent for the term of this Lease shall be as set out in 0.11 above.

4.2 *Adjustment of rent.*

4.2.1 *Rent adjustments due to Inflation Index.* N/A.

4.2.2 *Notice of rent adjustments due to Inflation Index.* N/A.

4.3 *Due date.* The Monthly Rent shall be paid in advance, and shall be due on or before the 10th day of each calendar month.

4.4 *Place of payment.* Rent shall be payable at such place as the Lessor may specify, in writing, from time to time.

4.5 *No offset or netting of rents.* All rent due hereunder shall be paid to Lessor without offset or netting of any costs or expenses paid or incurred by Lessee, whether or not such payments were for obligations or to fulfill duties of Lessor. Lessee shall pay all costs, expenses, and obligations allocated to Lessee under this Lease of whatever kind or nature, which may arise or become due during the term of this Lease, and shall indemnify and hold harmless the Lessor from and against the same.

Article V
Payment of Taxes, Assessments and Other Charges

5.1 *Lessee's obligations.* Tenant shall pay all personal taxes and any other charges which may be levied against the Premises and which are attributable to Tenant's use of the Premises, along with all sales and/or use taxes (if any) that may be due in connection with lease payments.

5.2 *Lessee's default.* If the Lessee fails, refuses, or neglects to make any payment required in this Article, Lessee shall be in default under this Lease. Lessor may elect to make such payment without any obligation to do so. However, the Lessor's election to pay such taxes or obligations shall not waive the Lessee's default. Lessee shall, upon the Lessor's demand, repay to Lessor the amounts so paid, including reasonable attorneys' fees and all other expenses reasonably incurred because of or in connection with the payments, together with interest thereon as provided in this Lease. The Lessor may collect or enforce any payment in the same manner as though it were an installment of rent specifically required by the terms of the Lease to be paid by the Lessee, on the day when the Lessor demands repayment of or reimbursement therefor.

Article VI Liens

6.1 *No lien.* The Lessee shall not subject the Lessor's interest in the premises to any mechanics or material liens or other lien of any kind, except to the extent that the creation of such lien or liens is specifically authorized by a provision in this Lease.

6.2 *Release of lien.* The Lessee shall not allow a lien or claim of any kind (except for mortgages specifically permitted by this Lease) to be filed or claimed against the Premises during the continuance of this Lease without Lessor's prior written consent. If such lien is claimed or filed, the Lessee shall cause the Premises to be released from the claim within 30 days after the Lessee is given written notice that a claim has been filed, or within 30 days after the Lessor is given written notice of the claim and transmits written notice of its receipt to the Lessee, whichever 30-day period expires earlier. In the alternative, if Lessee reasonable objects to such lien claim, Lessee may, within such 30-day time period, provide a bond in favor of Lessor from a surety company qualified to do business in the State of Idaho, or a cash deposit in favor of Lessor with an escrow agent in the county where the leased Premises are located, in an amount equal to one hundred sixty per cent (160%) of the lien claim, which bond or cash deposit shall remain while Lessee defends against such claim. In the event Lessee's defense against such lien claim is not successful, Lessee shall be responsible for all sums due the lien claimant, including such costs and fees as are awarded by the Court, and Lessor may seek payment thereof from Lessee's bond or cash deposit.

6.3 *No consent.* Nothing in this Lease shall be deemed to constitute a consent or authorization by Lessor to the creation of any lien or encumbrance, including any mechanic's or materialmen's lien, on Lessor's interest in the Premises or any part thereof, to the extent that such lien or encumbrance would not otherwise be allowed without Lessor's consent. Lessor does not consent to any lien or encumbrance which would be superior to Lessor's interest in the Premises. In any event, no lien or encumbrance of any kind or nature shall attach to the Premises in a fashion that survives termination of the Lessee's interest under this Lease.

Article VII Indemnification of Lessor

7.1 *Indemnification by Lessee.* Lessee agrees to indemnify and save Lessor harmless from and against any and all claims and demands (except for Lessor's proportionate share of any such claim which arises out of the negligence or intentional acts of Lessor or Lessor's agents, contractors, servants or employees) for, or in connection with, any accident, injury, or damage whatsoever caused to any person or property arising, directly or indirectly, out of the business activities conducted in or the use and/or occupancy of the Premises or occurring in, on or about the Premises or any part thereof, or arising directly or indirectly, from any negligent or intentional act of Lessee or its licensees, servants, agents, employees or contractors, and from and against any and all cost, including reasonable attorney's fees, expenses and liabilities incurred in connection with any such claims and/or proceedings brought thereon.

7.2 *Survival of Lessee's indemnification.* The indemnity granted by Lessee pursuant to this Article shall survive termination of the Lease and shall continue for all such claims arising during the Term of this Lease or during any holdover period during which Lessee remains in possession, whether such claim is brought before or after termination of the Lease.

7.3 *NA.*

Article VIII Insurance

8.1 *Lessee's Insurance.* Lessee shall obtain insurance of the types and in the amounts described below.

8.1.1 *Commercial General and Umbrella Liability Insurance.* Lessee shall maintain commercial general liability (CGL) and, if necessary, commercial umbrella insurance with a limit of not less than as set forth in 0.14 herein for each occurrence. If such CGL insurance contains a general aggregate limit, it shall apply separately to the Demised Premises and shall not be less than as set out in 0.14.

8.1.1(i) CGL insurance shall be in a form, and from, an insurance company satisfactory to Lessor and shall cover liability for bodily injury, property damage and personal injury, arising from Lessee's use and/or occupation of the Premises, including without limitation, operations, independent contractors, products-completed operations, personal injury and advertising injury, and liability assumed under an insured contract including the tort liability of another assumed in a business contract.

8.1.1(ii) Lessor shall be included as an additional insured under the CGL and under the commercial umbrella, if any, and Lessor's status as an additional insured shall be evidenced by an endorsement acceptable to Lessor. This insurance shall apply as primary insurance with respect to any other insurance or self-insurance programs afforded to Lessor.

8.1.1. (iii) There shall be no endorsement or modification of the CGL limiting the scope of coverage for liability arising from pollution or employment-related practices.

8.1.2 *Builders Risk Insurance.*

8.1.2(i) N/A.

8.1.2(ii) N/A.

8.1.3 *Workers' compensation and other insurance.*

8.1.3. (i) Lessee shall purchase insurance to cover Lessee's personal property. In no event shall Lessor be liable for any damage to or loss of personal property sustained by Lessee, whether or not insured, even if such loss is caused by the negligence of Lessor, its employees, officers, or agents.

8.1.3(ii) Lessee may, at Lessee's option, purchase business income, business interruption, extra expense or similar coverage as part of Lessee's commercial property insurance, however, in no event shall Lessor be liable for any business interruption or other consequential loss sustained by Lessee, whether or not it is insured, even if such loss is caused by the negligence or the Lessor, its employees, officers or agents.

8.1.3(iii) Lessee shall maintain all required coverages including Employer's Liability, and Worker's Compensation Insurance as required by Idaho Law.

8.2 *Lessee's insurance policy requirements.*

8.2.1 *Evidence of insurance.* All insurance required under this Article shall be with companies licensed and admitted in Idaho and approved for this Lease by Lessor. Lessor's general requirements for such approval include a Best's rating of A- or better. Prior to taking occupancy or commencing construction and at least annually thereafter, Lessee shall furnish Lessor with a certificate of insurance executed by a duly authorized representative of each insurer, and a copy of any applicable policy or policy endorsement showing compliance with the insurance requirements set forth above. All policies required under this Article shall be written as primary policies and not contributing to nor in excess of any coverage Lessor may choose to maintain.

8.2.1(i) All certificates shall provide for 30 days' written notice to Lessor prior to cancellation or material change of any insurance referred to therein.

8.2.1(ii) The words "endeavor to" and "but failure to mail such notice shall impose no obligation or liability of any kind upon the company, its agents or representatives" shall be deleted from the certificate form's cancellation provision.

8.2.1(iii) Failure of Lessor to demand such certificate or other evidence of full compliance with these insurance requirements or failure of Lessor to identify a deficiency from evidence that is provided shall not be construed as a waiver of Lessee's obligation to maintain such insurance.

8.2.1(iv) Failure to maintain the required insurance may result in termination of this Lease at Lessor's option.

8.2.1(v) If Lessee fails to maintain the insurance as set forth herein, Lessor shall have the right but not the obligation to purchase said insurance at Lessee's expense.

8.2.1(vi) Lessee shall provide certified copies of all insurance policies required above within 10 days of Lessor's written request for said copies.

8.2.2 *No Representation of Coverage Adequacy.* By requiring insurance herein, Lessor does not represent that coverage and limits will necessarily be adequate to protect Lessee, and such coverage and limits shall not be deemed as a limitation on Lessee's liability under the indemnities granted to Lessor in this Lease.

8.2.3 *Cross-Liability Coverage.* If Lessee's liability policies do not contain the standard ISO separation of insured provision, or a substantially similar clause, they will be endorsed to provide cross-liability coverage.

8.2.4 *Payment of Premiums.* The Lessee shall pay premiums for all of the insurance policies it is required to carry under the terms of this Lease, and shall deliver to the Lessor evidence of such payment before the payment of any premiums become in default. The Lessee shall also cause renewals of expiring policies to be written and the policies or copies thereof, as required by the Lease, to be delivered to the Lessor at least 10 days before the policies' expiration dates.

8.3 *NA.*

8.4 *Lessor's insurance.* Lessor shall at all times during the Lease Term insure and keep in effect on the building in which the Leased Premises are located standard fire and extended coverage insurance with such carrier as Landlord may select and in such amount as is prudent to pay the full replacement cost of loss of such building. Landlord may procure and maintain public liability insurance with respect to any common area in such amounts and with such carriers as Landlord deems prudent.

8.5 *Waiver of subrogation.* Lessor shall not be liable for any damage by fire or other peril, or for loss by Lessee or claims against Lessee to the extent any such damage, loss of claim are includable in the coverage afforded by the commercial general liability or commercial umbrella liability insurance maintained pursuant to this Lease agreement (whether or not such coverage is in effect), no matter how caused, it being understood that Lessee will look solely to its insurer for reimbursement, provided that this provision shall not be deemed to be a limitation on Lessor's indemnification under this Lease.

Article IX Assignment/Subleasing

9.1 *Written assignment by Lessee; filing.* This Lease is not assignable by Lessee.

9.2 *NA.*

9.3 *Subleases by Lessee.* Lessee may not sublease any portion of the Premises.

9.4 *Attornment.* N/A.

9.5 *Release from future obligations.* N/A.

9.6 *Lessee's primary liability.* Lessee's making of any assignment, mortgage, pledge, encumbrance or subletting, in whole or in part, shall not relieve Lessee for the performance of every term, condition and obligation contained in this Lease unless a written release is granted by Lessor, which release shall be at Lessor's sole discretion.

9.7 *Limited consent.* N/A.

9.8 *Assignment by Lessor.* Lessor may sell or assign Lessor's right title and interest in this Lease, or in the Premises, provided that, except as may be specifically limited in this Lease, any such purchaser or assignee shall be subject to the terms of this Lease.

Article X

Condemnation and Destruction of Premises

10.1 Condemnation.

10.1.1 *Complete Taking.* If the whole of the Premises, or such portion thereof as shall render the remaining portion unsuitable in Lessor's reasonable judgment for the purposes of Lessee's use, shall be condemned by eminent domain or acquired in lieu of condemnation for any public or quasi-public use or purpose, all rentals and taxes or other charges shall be paid up to that date and this Lease shall terminate. Lessee shall have the right to claim and recover such compensation as may be separately awarded for any and all damage to Lessee's interest in the leasehold estate and to Lessee's business by reason of the condemnation and for or on account of any cost or loss to which Lessee might be put in removing Lessee's merchandise, furniture, equipment and other personal property. Lessor shall give Lessee notice, as provided in this Lease, of the filing of any condemnation action or of Lessor's receipt of any notice of intention to condemn within ten (10) days from the date of Lessor's receipt of notice of such filing or receipt of such notice of intent.

10.1.2 *Partial Taking* If a portion of the Premises shall be taken as a result of the exercise of the power of eminent domain, or conveyed by Lessor to the condemning authority under the threat of the exercise of such power, and the remaining portion not so taken shall be suitable in Lessor's reasonable judgment for the purposes of Lessee's use, this Lease shall continue in effect with respect to such remaining portion, but the rent payable hereunder by Lessee shall be equitably reduced based upon the reduction in the fair market rental value of the Premises. In such event, Lessor will, within a reasonable time from the date of the taking, repair or replace the Improvements as may be necessary so that Lessee may continue in occupancy. Lessor's obligation to rebuild or restore the building on the Premises shall be limited to the proceeds of any condemnation award that is received and retained by Lessor; provided, however, in the event the proceeds are insufficient to rebuild or restore, Lessor shall have no obligation to do so unless Lessee provides funds sufficient to cover the difference between the amount of the condemnation award and the cost of such rebuilding or restoration. If pursuant to this subsection the Premises are not rebuilt or restored, Lessee shall not be entitled to any portion of the award for the Land or for Lessor's interest in this Lease Agreement, and all such amounts are hereby assigned to Lessor; provided, however, that Lessee has the right to receive any award which may be made for damages to, or condemnation of Lessee's moveable trade fixtures, equipment, and other personal property.

10.2 *Destruction of Premises.*

10.2.1 In the event of damage or destruction to Improvements on the Premises, which significantly impacts Lessee's authorized use of the Premises under this Lease, Lessor will, within a reasonable time, repair or replace the damaged Improvement to the extent necessary to reinstate Lessee in occupancy and use, and during such time, the monthly rent shall be abated in the

same proportion as any untenable portion of the Premises bears to the whole thereof, and Lessor shall then have ninety (90) days from the date of such damage or destruction to complete the remainder of repairs as are necessary to restore the Premises to its condition prior to such damage or destruction, *provided however*, in the event such damage or destruction destroys more than 50% of the Premises, Lessor or Lessee shall have the option to terminate this lease and in the event of such termination, Lessor shall have no obligation to repair or replace such Improvement. Lessor or Lessee will give notice within thirty (30) days after the happening of such casualty of any election to terminate.

10.2.2 If Improvements cannot be replaced or repaired within a reasonable time due to the inability of Lessor to obtain materials and labor needed therefor, or because of strikes, acts of God or governmental restrictions that would prohibit, limit or delay the construction, then the time for completion of the repair or replacement shall be extended accordingly. Lessee hereby expressly waives and releases any and all claims against Lessor for damages or destruction. Lessee hereby expressly waives and releases any and all claims against Lessor for damages in the event Lessor elects not to rebuild or restore the building in accordance with the provisions this Section, it being understood and agreed that Lessee's sole remedy therefor shall be to elect to terminate this Lease as of the date of occurrence of the damage or destruction, and rent shall abate as of such date.

10.2.3 In all cases, Lessor's obligation to rebuild or restore damaged Improvements on the Leased Premises shall be limited to the proceeds of any insurance policy covering the Improvements that is received and retained by Lessor; provided, however, in the event the proceeds are insufficient to rebuild or restore, Lessor shall have no obligation to do so unless Lessee provides funds sufficient to cover the difference between the amount of the insurance proceeds and the cost of such rebuilding or restoration. If the damaged Improvements are not to be replaced or repaired due to a lack of insurance funds, Lessor or Lessee shall have the option to terminate this lease and in the event of such termination, Lessor shall have no obligation to repair or replace such Improvement. Lessor or Lessee will give notice within 30 days after the happening of such casualty of any election to terminate.

10.2.4 In the event Improvements are not repaired, restored or replaced, for any reason, all proceeds of the fire and extended coverage insurance applicable to the Improvements shall be paid and given to Lessor. Lessee agrees to execute and deliver any release or other document Lessor may request to obtain the release and/or control of said proceeds. Lessee shall be entitled to any proceeds received by Lessee from any loss of business coverage carried by Lessee.

10.3 *Return of unearned Rent.* In the event the Premises occupied by Lessee are rendered untenable as provided in this Section, and this Lease is terminated, any unearned portion of the rent paid by Lessee shall be refunded within thirty (30) days after Lessee's vacation of the Premises.

Article XI
Title to Improvements, Use, Expenses and Maintenance

11.1 *Title to Improvements.* N/A.

11.2 *Expenses and maintenance of grounds and Improvements.* N/A:

11.2.1 *Landscaping.* Lessor agrees to maintain lawn, flower beds, garden areas, shrubbery, and all other landscaping on the Premises as of the date of this Lease or hereafter placed on the Premises by Lessor or Lessee (hereinafter collectively the “Landscaping”), including mowing, watering, weeding and fertilizing the Landscaping. Lessee shall not make any changes to the Landscaping of the Premises without prior written approval of Lessor.

11.2.2 *Fencing, parking and other grounds.* Lessor shall maintain any perimeter fence, any parking areas and all other areas of the grounds of the Premises during the term of this Lease, including repairs to any perimeter fence, any maintenance of parking areas (including grading and/or asphalt repair where necessary) controlling noxious weeds on the Premises and maintaining the appearance of the Premises in a neat and orderly manner commensurate with the appearances of the properties surrounding the Premises.

11.2.3 *Trash removal.* Lessee shall maintain the Premises in a clean and sanitary condition, and shall have all trash and garbage removed from the Premises on a weekly basis. All garbage and trash is to be placed in a suitable, substantial, non-leaking container and placed for pick-up as directed by the trash removal company.

11.2.4 *Utilities.* Lessor shall be liable for any and all utility expense including, but not limited to, electric power service, natural gas, trash removal, water and sewer.

11.2.5 *Advertising or signs.* Except as set forth on Exhibit “D”, Lessee shall post no permanently affixed or structural advertising or signs on the property without prior written approval of Lessor. Lessee may post temporary advertisement or signs without prior written approval. Any signs or advertisement (whether or not Lessor’s approval is required hereunder) must comply with any and all applicable federal, state or local laws, regulations and ordinances.

11.2.6 *Protection from freezing temperatures.* Lessor shall, prior to the onset of freezing temperatures, remove garden hoses from outside faucets and turn off the water supply to outside spigots, to avoid bursting of pipes. Lessor shall also maintain adequate heat in the Improvements to ensure that all water pipes remain free of ice, or ensure that water pipes are properly drained and winterized in those areas where heat will not be maintained.

11.2.7 *Keys and locks.* Lessee shall pay for replacement of all lost or misplaced keys, all costs arising therefrom including, but not limited to, the cost of re-keying or replacement of locks, and the cost, if any, of gaining admittance to the Premises in the event of a lost or misplaced key.

11.2.8 *Cleaning.* Lessee shall regularly conduct normal cleaning of the Premises, including without limitation vacuuming (and steam cleaning at least annually) carpets, cleaning and

waxing woodwork, tiles and linoleum, cleaning sinks, exposed plumbing, and appliances and all other normal cleaning of the Improvements.

11.2.9 *Maintenance of the heating and air conditioning equipment.* Lessor shall be responsible for routine maintenance of the heating and air-conditioning equipment for the Improvements including changing filters, and cleaning ducting, fans and motors.

11.2.10 *Maintenance of electrical fixtures.* Lessee shall be responsible for routine maintenance of electrical fixtures and replacement of inoperative light bulbs.

11.2.11 *Ice and snow removal.* Lessor shall, prior to the start of each business day, remove ice and snow from Common Areas and sidewalks. Lessor shall hire snow removal for parking areas.

11.3 *Repairs.*

11.3.1 *Notice of repairs.* Lessee shall give the Lessor written notice of the need for any repairs to the Premises (irrespective of whether such repairs are Lessor's or Lessee's responsibility). Lessee shall also give immediate, oral notice of needed repairs where the need for repairs is to prevent ongoing, material damage to the Premises or to Lessee's belongings.

11.3.2 *Authorization for repairs.* Lessee shall not perform or authorize any repairs (irrespective of whether such repairs are Lessor's or Lessee's responsibility), without prior written approval of Lessor, unless such repair is necessary to prevent immediate and material damage to the Premises or to Lessee's belongings and Lessee is unable, after reasonable efforts, to contact Lessor and obtain written approval. In any such event, Lessee shall contact Lessor at the earliest reasonable opportunity to notify Lessor of the needed repairs and of the actions taken by Lessee.

11.3.3 *Performance of repairs.* Any repairs done or authorized by Lessee shall be completed in a workmanlike manner and shall be of a quality comparable to equivalent professional repairs in the community. Repairs done or authorized by Lessee in violation of this paragraph shall be deemed to be at Lessee's own risk. Lessor shall have no obligation to reimburse Lessee for any such repairs.

11.4 *Use of Premises.* In addition to any other restrictions on use of the Premises herein contained, Lessee shall use the Premises only for the purposes set out in 0.13 above. Lessee shall promptly comply with all statutes, ordinances, rules, orders, regulations, and requirements of the federal, state and municipal governments and of any and all of their departments and bureaus which are applicable to the use by Lessee of the Premises during the term or any renewal thereof.

Article XII Construction and Alterations

12.1 *Alterations.* Lessee shall not make any alterations in or to the Premises.

12.2 *Alterations by Lessor.* N/A.

Article XIII Mortgages

Lessee shall not have the right to subject the Improvements, or any part thereof, to any mortgages or deeds of trust, or to encumber the Improvements or Lessee's interest therein in any fashion without the prior written consent of Lessor, to which consent Lessor may attach such terms and conditions as Lessor deems necessary and appropriate.

Article XIV Default

14.1 *Events of default by Lessee.* Lessee shall be in default hereunder if any one or more of the following occurs:

14.1.1 Lessee fails to pay when due any installment of Rent, or any additional sum due hereunder, and such failure shall continue for five (5) days after written notice thereof to Lessee;

14.1.2 Lessee fails to observe or perform any of the covenants, agreements, conditions or undertakings herein contained to be kept, observed and performed by Lessee other than the payment of rent, or any part thereof when due, and such failure shall continue for thirty (30) days after written notice thereof to Lessee;

14.1.3 Proceedings in bankruptcy or for liquidation, reorganization or rearrangement of Lessee's affairs are instituted by or against the Lessee;

14.1.4 A receiver or trustee is appointed for all or substantially all of the Lessee's business or assets;

14.1.5 A trustee is appointed for Lessee after a petition has been filed for Lessee's reorganization under the United States Bankruptcy Code, or if this lease is rejected under § 365 of the United States Bankruptcy Code;

14.1.6 Lessee shall make an assignment for the benefit of its creditors; or

14.1.7 Lessee shall abandon the Premises.

14.2 *Lessor's remedies.* In the event of any default by Lessee, Lessor, at its election, may enforce, by judicial action or otherwise, any one, or any combination, of any and all remedies available at law or in equity, or without limitation of any such remedies, any one, or any combination, of the following:

14.2.1 Lessor may terminate this lease, re-enter upon all or any part of the Premises, either by voluntary surrender or process of law, (Lessee hereby waiving any demand for

possession) and remove Lessee and any persons or property from the Premises, and the rent shall become due thereupon and be paid up to the time of such re-entry, dispossession and/ or termination. Nothing in this paragraph shall limit or affect Lessee's obligation to surrender possession of the Premises when required to do so under the terms of this Lease, or limit or affect Lessor's right to damages resulting from any failure of Lessee to do so;

14.2.2 Lessor may re-let the Premises or any part or parts thereof, either in the name of Lessor or otherwise, for a term or terms, which may at Lessor's option be less than or exceed the period which would otherwise have constituted the balance of the term of this lease and may grant concessions or free rent or charge a higher rental than that in this Lease; and/or

14.2.3 Lessee shall also pay Lessor damages for the failure of Lessee to observe and perform said Lessee's covenants herein contained, and shall pay any deficiency between the rent hereby reserved and/or covenanted to be paid under this Lease, and the net amount, if any, of the rents collected on account of the lease or leases of the demised premises for each month of the period which would otherwise have constituted the balance of the term of this lease.

14.3 *Lessor's damages and rights.* In the event of default by Lessee, Lessor shall be entitled to damages to the extent authorized by Idaho Law.

14.4 *Default period.* All default and grace periods shall be deemed to run concurrently and not consecutively.

14.5 *Cumulative remedies.* During the continuance of this Lease, Lessor and Lessee shall have all rights and remedies which this Lease and the laws of the State of Idaho accrue to them. All rights and remedies accruing to Lessor or Lessee shall be cumulative; that is, Lessor or Lessee may pursue any and/or all rights that the law and this Lease afford to them, in whatever order Lessor or Lessee desires and the law permits without being compelled to resort to any one remedy in advance of any other.

14.6 *Interest.* All arrearages in the payment of any sums due under this Lease shall bear interest from the date due until paid at eighteen (18%) percent per annum.

14.7 *Late charges.* In the event any payment due Lessor hereunder is not received by Lessor when due, Lessee shall pay a late charge for the first calendar month such payment has not been made equal to the greater of a) twenty-five dollars (\$25.00) or b) one percent (1%) of the amount due. For each subsequent calendar month until such payment is made, Lessee shall pay an additional late charge equal to one percent (1%) of the total amount due.

Article XV Additional Covenants of Lessee

15.1. *Compliance with Legal and Insurance Requirements.* Lessee shall, at its own cost and expense, promptly comply with, or cause to be complied with, all Legal Requirements, whether or not the same require structural repairs or alterations, which may be applicable to Lessee, the Premises or Lessee's use of or manner of use of the Premises, provided however, in the event

a Legal Requirement applicable to Lessee or to Lessees use or manner of use of the Premises requires structural repairs, alterations or modifications of the Premises, excluding repair, alteration or modification to Lessee's trade fixtures, at a cost equal to or greater than \$500.00, such structural repair, alteration or modification shall become the responsibility of Lessor, and Lessor shall have the option, on not less than thirty (30) days written notice, to terminate this lease rather than perform such structural repair, alteration or modification. Lessee shall also observe and comply with all Insurance Requirements at any time in force with respect to the Premises.

15.2 *Hazardous Materials.* Lessee shall not accumulate, handle, use, or store on the Premises Hazardous Materials except as in compliance with all applicable federal, state or local statute, law, ordinance, code, rule, regulation, order or decree now or at any time hereafter in effect, and shall only handle, use or store such materials to the extent reasonably necessary for Lessee's use of the Premises. Lessee shall comply with any lawful order by an entity reposed with authority to regulate the use, accumulation, storage or disposal of Hazardous Materials. Lessee hereby covenants and warrants that during the term of this Lease, neither Lessee nor any other person or entity acting under Lessee's control or authority shall discharge any Hazardous Substances on, in or under the Premises. Lessee expressly assumes all liability for any such contamination, unless such contamination is actually caused by the Lessor or its employees, officers or agents, and Lessee shall indemnify, defend and hold harmless Lessor from and against all claims, damages, expenses or causes of action arising therefrom.

15.3 *Zoning/Building restrictions.* All construction, parking, or signs shall be compatible with any applicable zoning or building regulations.

15.4 *Waste and nuisance prohibited.* Lessee shall not commit, or suffer to be committed, any waste or nuisance on the Premises.

15.5 *Termination.* Upon termination of this Lease, the Lessee shall peaceably and quietly deliver to the Lessor possession of the Premises including all fixtures and Improvements which the Lessee has brought, placed, or constructed upon the premises (to the extent not required to remove the same by Lessor as set forth in this Lease) with the exception of Lessee's non-fixture personal property and trade fixtures.

Article XVI Quiet Enjoyment

So long as the Lessee keeps and performs all of its covenants and conditions under this Lease, it shall have quiet, undisturbed, and continued possession of the premises, free from all claims against the Lessor and all persons claiming under, by, or through the Lessor.

Article XVII Right of Entry

The Lessor and its agents may enter upon the premises at all reasonable times to examine their condition and use, so long as that right is exercised in a manner that does not interfere with the Lessee in the conduct of its business on the Premises, or to perform any repair or alteration on

the Premises under the terms of this Lease or made necessary for the safety and preservation of the Premises.

Article XVIII
Miscellaneous

18.1 *Force Majeure.* If the Lessor or Lessee is delayed, hindered, or prevented from performing any act required hereunder by reason of Force Majeure then performance of the act shall be excused for the period of the delay. In that event, the period for the performance of the act shall be extended for a period equivalent to the period of the delay.

18.2 *NA*

18.3 *NA*

18.4 *Estoppel certificates.* N/A.

18.5 *Duplicates; recordation.* N/A.

18.6 *Non-waiver.* No waiver of a breach of any covenant in this Lease shall be construed to be a waiver of any succeeding breach of the same covenant. No delay or failure by either party to exercise any right under this Lease, and no partial or single exercise of that right, shall constitute a waiver of that or any other right, unless otherwise expressly provided herein.

18.7 *Impossibility.* In the event that any construction of law, ordinance or regulation, exists or hereafter be enacted that would prohibit or prevent Lessor from carrying out the purposes of this Lease, Lessor shall notify Lessee in writing of Lessor's intent to terminate this Lease and all obligations hereunder shall cease.

18.8 *Written modifications.* No modification, release, discharge, change or waiver of any provision hereof shall be of any force, effect, or value unless signed in writing by the Lessor.

18.9 *Entire agreement.* This instrument contains the entire agreement between parties as of this date. The execution hereof has not been induced by either party by representations, promises, or understandings not expressed herein.

18.10 *Notices.* All notices between the parties in connection with this Lease shall be in accordance with the term hereof requiring such notice. Notice shall be given by registered or certified mail, deposited in the United States mails with postage prepaid. Notices to Lessor and Lessee shall be sent to the addresses set forth in 0.2 and 0.4 hereof respectively. Either party may change the place for giving notice by written notice in the manner set forth in this paragraph.

18.11 *Joint liability.* If the Lessee consists of more than one person, such persons shall be jointly and severally liable on the covenants of this Lease.

18.12 *Execution of documents.* The Parties agree that they shall sign or cause to be signed all documents necessary to the effectuation of this Lease or any of the provisions herein.

18.13 *Warranty.* Lessor warrants that it has the power and authority to enter into this Lease and that the execution, delivery of this Lease and the performance of the contractual obligations set forth herein are not in violation of any federal, state, local statute, ordinance, rule or regulation and that no consents not already obtained are required. Lessor further warrants that Lessor has good and marketable title to the property described in Exhibit "A", free and clear of all liens and encumbrances. Lessee warrants it has the power and authority to enter into this Lease.

18.14 *Binding effect.* This Lease shall be binding upon and shall inure to the benefit of the heirs, personal representatives, successors and assigns of the parties.

18.15 *Liability continued.* All references to the Lessor and Lessee mean the persons or legal entities who, from time to time, occupy the positions, respectively, of Lessor and Lessee. However, this shall not be construed as relieving a person or legal entity of any liability incurred by reason of or in connection with it having been Lessor or Lessee at one time.

18.16 *Severability.* In the event any provision of this Lease shall be held invalid or unenforceable according to law, the validity, legality or enforceability of the remaining provisions and the application thereof shall not in any way be affected or impaired.

18.17 *Counterparts.* This Lease may be simultaneously executed in several counterparts, each of which shall be an original and all of which shall constitute but one and the same instrument.

18.18 *Headings.* Headings in this Lease are for convenience and reference only and shall not be used to interpret or construe its provisions.

18.19 *Time of essence.* Time is expressly declared to be of the essence of this Lease.

18.20 *Governing law.* All of the rights and remedies of the parties under this Lease shall be governed by the provisions of this instrument and by the laws of the State of Idaho. Any action brought to enforce this Lease can only be brought in Idaho State Court in the county where the Demised Land is located.

18.21 *Fees and costs of enforcement.* If Lessee shall default in the observance or performance of any term or covenant on Lessee's part to be observed or performed under or by virtue of any of the terms or provisions in any article of this Lease, after notice and upon expiration of any applicable grace period, (except in an emergency), then, unless otherwise provided elsewhere in this Lease, Lessor may immediately or at any time thereafter perform the obligation of Lessee thereunder. If Lessor, in connection with the foregoing or in connection with any default by Lessee in the covenant to pay rent hereunder, makes any expenditures or incurs any obligations for the payment of money, including but not limited to reasonable attorneys' fees, in asserting and/or enforcing Lessor's rights and remedies under this Lease, including instituting, prosecuting or defending any action or proceeding in which Lessor prevails, then Lessee will reimburse Lessor for such sums so paid or obligations incurred with interest and costs. The foregoing expenses

incurred by reason of Lessee's default shall be deemed to be additional rent hereunder and shall be paid by Lessee to Lessor within ten (10) days of rendition of any bill or statement to Lessee therefor. If Lessee's lease term shall have expired at the time of making of such expenditures or incurring of such obligations, such sums shall be recoverable by Lessor, as damages.

IN WITNESS WHEREOF the Lessor and the Lessee have hereunto have set their hands and seals, the day and year set forth by each signature.

LESSOR: *McCall-Donnelly Joint School
District No. 421*

LESSEE: *Crestline Academy*

By: _____

By: _____

Date: _____

Date: _____

EXHIBIT A

Demised Premise

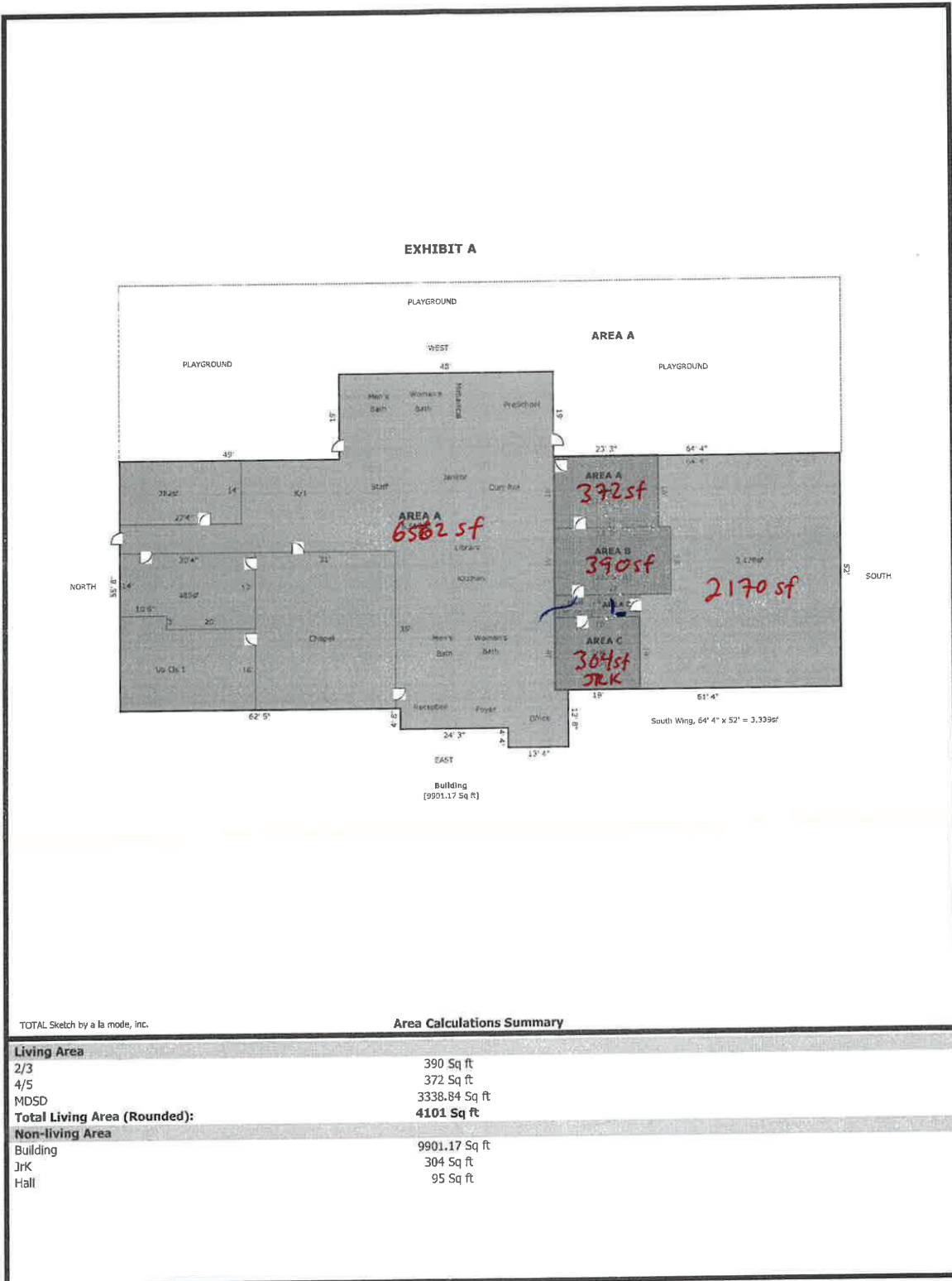

TOTAL Sketch by a la mode, inc.

Area Calculations Summary

Living Area	
2/3	390 Sq ft
4/5	372 Sq ft
MDSO	3338.84 Sq ft
Total Living Area (Rounded):	4101 Sq ft
Non-living Area	
Building	9901.17 Sq ft
Jrk	304 Sq ft
Hall	95 Sq ft

TOTAL Sketch software by a la mode inc. 1-800-alamode

McCall-Donnelly Jt. School District #421 PERSONNEL REQUEST FORM

Instructions:

1. Use a separate form for each position requested.
2. Complete Section I and submit to the Superintendent.
3. Building Administrators will submit a job description for requested positions.
4. Budget code numbers are required.

Section I (completed by Administrator)

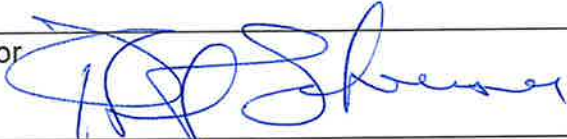
School Heartland High School		Budget Code		School Year 2022-23
New or Replacement New		Position Title 1.0 Intervention Paraprofessional		Grade/Subject/Shift 9-12
# of Days 5	Hrs. Per Day 7 M-Th; 4 Fri			Permanent/Temporary Temporary
<p>Justification: A part-time intervention paraprofessional is needed to provide overflow support to students and teachers as enrollment continues to increase, especially in our Integrated Math classes and to provide additional math intervention during Advisory. The para position will also help support students enrolled in credit recovery courses and students in our EL and SPED programs.</p> <p><input type="checkbox"/> Resignation</p> <p><input type="checkbox"/> Termination</p> <p><input checked="" type="checkbox"/> Other</p>				
Signature of Administrator 				

Section II (completed by District)

Allocation Available <input type="checkbox"/>	Special Allocation <input type="checkbox"/>	No Allocation Available <input type="checkbox"/>
Approved <input type="checkbox"/>	Explanation of Denial:	
Denied <input type="checkbox"/>		
Superintendent Signature:		
Advertise Vacancy for _____ days.		

McCall-Donnelly Jt. School District #421 PERSONNEL REQUEST FORM

Instructions:

1. Use a separate form for each position requested.
2. Complete Section I and submit to the Superintendent.
3. Building Administrators will submit a job description for requested positions.
4. Budget code numbers are required.

Section I (completed by Administrator)

School BRMES		Budget Code		School Year 2022-23
New or Replacement NEW		Position Title Grades 3-5 Teacher		Grade/Subject/Shift Grades 3, 4, and 5
# of Days 100	Hrs. Per Day 8			Permanent/Temporary Temporary till June 2023
Justification: Per Policy 2240 on Class Size: Grade 3 = 84 (28 in each class) (DES has 33 with 2 teachers). 0 DES students on OE at <input type="checkbox"/> Resignation BRMES Grade 4 = 79 (26/27 in each class) (DES has 27 with 1 teacher) We have 5 DES students on <input type="checkbox"/> Termination OE at BRMES. Grade 5 = 71 (23/24/25 in classes) (DES has 21 with 1 teacher). We have 5 DES students on <input checked="" type="checkbox"/> Other OE at BRMES.				
Signature of Administrator 				

Section II (completed by District)

Allocation Available <input type="checkbox"/>	Special Allocation <input type="checkbox"/>	No Allocation Available <input type="checkbox"/>
Approved <input type="checkbox"/>	Explanation of Denial:	
Denied <input type="checkbox"/>		
Superintendent Signature:		
Advertise Vacancy for _____ days.		



"Developing Lifelong Learners Today"

McCall-Donnelly Joint School District No. 421
120 Idaho Street, McCall, ID 83638
Phone: (208) 634-2161 Fax: (208) 634-4075

Date: November 14, 2022
To: Board of Trustees
From: Eric Pingrey
Subject: High Reliability Schools Out of State Attendance Request

As part of implementing the strategic plan with the High Reliability Schools Model I would like to recommend that we send a representative from each building along with the instructional coaches to participate in the HRS summit in San Antonio Texas on January 25th-27th. The district will establish an application process to select the staff members along with input from the building principals.

Eric Pingrey
Superintendent

MCCALL - DONNELLY SCHOOL DISTRICT

REQUEST FOR OUT OF DISTRICT ATTENDANCE

All requests for out of district attendance that involve time away from work and/or reimbursement from district funds must be filed and approved prior to such attendance on this form. Reimbursement of travel expenses will be in accordance with Board Policy 5341. No reimbursement will be granted without prior approval.

EMPLOYEE NAME K.C. Wheeler DATE 9/8/2022

SCHOOL OR ASSIGNMENT PLMS

TRAVEL REQUESTED TO Seattle WA DATE(S) March 27 to April 1

PURPOSE OF TRAVEL SHAPE AMERICA National Conference

ESTIMATED EXPENSES:

1. REGISTRATION	<u>595</u>
2. TRANSPORTATION/MILEAGE	<u>400</u>
3. MEALS	<u>186</u>
4. LODGING	<u>1000</u>
5. OTHER COSTS	<u> </u>
6. SUBSTITUTES	<u> </u>

TOTAL ESTIMATED EXPENSES 2181

Reimbursement will not be made from this request. Registration and Lodging fees are normally billed to the District through the purchase order system. An Expense Voucher for reimbursement of travel expenses must be submitted to the approving Principal or Supervisor (signature below) for approval following return. The Expense Voucher will be submitted to the District Office for payment by the approving Principal or Supervisor.

SIGNATURE OF EMPLOYEE 

BUDGET ACCOUNT Registration 271-512 300 000 Travel 271-512 380 000 000

APPROVED BY 
Principal or Supervisor

DATE 9/8/22

Superintendent or Business Manager

DATE _____

SPECIAL CONDITIONS _____

Copies: Employee
Supervisor
District Office

- How does the conference align to PLMS / district goals?

Relating this convention to the different mission statements and vision of the district and board:

Developing Lifelong Learners Today:

This works for both our students and our staff. As a lifelong learner myself this conference allows me to learn new skills related to my teaching and best practices, how to provide new and exciting learning opportunities for my students, and create opportunities for learning within our district as a whole related to PE and health.

Belief statement: McCall Donnelly School District believes public education provides a learning environment that is challenging, authentic, and current.

Physical Education standards are being evaluated at both the state and national level beginning last year through next year. Because we believe that we should be providing challenging, authentic, and current learning attending the national convention provides essential exposure to this. Not only currently standard discussions, but also update teaching tools, new unit resources, and current research in the fields of health and PE. This is also a unique opportunity to connect with other physical education teachers from across the nation to connect, network, be inspired, and provide my own experiences and ideas with them. Living in a smaller community this is one of the hardest things to do on a regular basis. I don't have a department of middle school physical education teachers, in that I am somewhat on an island, and this convention takes me off of that island and into the PE metropolis!

- How will the information be shared with staff? Can you make connection to the upcoming PE adoption?

There are two specific ways that this can be shared with our staff at MDSD. First, if we had the opportunity for a PLC, it would be possible to bring back some of the materials, tools, and lesson possibilities to help enhance their current curriculum. Second looking at the fact that we are coming up on an adoption year for PE, it is a great opportunity to see the newest curriculum resources out there, firsthand, and provide that information to our teachers here when we look at how we want to progress our programs in this next adoption year. Being able to talk directly to companies that provide PE curriculums, ask them questions, see materials ahead of time, and even have the opportunity to see some of them in practice, could provide us some much-needed insight when we go to evaluate our current curriculum and where we want to go for the next adoption.

The SHAPE America National Convention & Expo is the leading professional development opportunity for health and physical education professionals — from preK–12 educators who teach our country's youth about the benefits of living a healthy, physically active lifestyle, to university professors who conduct much-needed research and teach our industry's future professionals.



"Developing Lifelong Learners Today"

McCall-Donnelly Joint School District No. 421
120 Idaho Street, McCall, ID 83638
Phone: (208) 634-2161 Fax: (208) 634-4075

Date: November 14, 2022
To: Board of Trustees
From: Eric Pingrey
Subject: MDSD Preschool Move

The purchase of the new district office and early childhood center has allowed us to move the developmental preschool to the new building at semester time. I am recommending that the board support this move. This provides two opportunities, first it will free up space at both elementaries and secondly it will allow the preschool to finally have a permanent location.

Eric Pingrey
Superintendent



"Developing Lifelong Learners Today"

McCall-Donnelly Joint School District No. 421
120 Idaho Street, McCall, ID 83638
Phone: (208) 634-2161 Fax: (208) 634-4075

Date: November 14, 2022
To: Board of Trustees
From: Eric Pingrey
Subject: Idaho Workforce Development Grant Opportunity

In partnership with WCMEDC, MDSO, Valley County and Cascade School District began work on a funding source for daycare and early childhood programming. As the project evolved, MDSO is now in charge of the application. The funding source could fund up to \$15000 per student served. The funding source would focus on start-up costs to include renovations and supplies, playground equipment, as well as salaries and benefits. I recommend accepting the funding if awarded.

Eric Pingrey
Superintendent



"Developing Lifelong Learners Today"

McCall-Donnelly Joint School District No. 421
120 Idaho Street, McCall, ID 83638
Phone: (208) 634-2161 Fax: (208) 634-4075

Date: November 14, 2022
To: Board of Trustees
From: Eric Pingrey
Subject: EPA Bus Rebate Program

The Environmental Protection Agency created a clean energy school bus rebate program in which MDSB in partnership with Harlows submitted an application. The application was for \$3,750,000 for electric busses and \$200,000 for the infrastructure and charging. With a tremendous demand across the country for this program the selection process ended up being a lottery. MDSB was one of two schools in the state of Idaho to be selected. I would like to recommend that we accept the rebate and move forward with adding these vehicles to our fleet. The time frame for this project at earliest will be the 24-25 school year.

Eric Pingrey
Superintendent



"Developing Lifelong Learners Today"

McCall-Donnelly Joint School District No. 421
120 Idaho Street, McCall, ID 83638
Phone: (208) 634-2161 Fax: (208) 634-4075

Date: November 14, 2022
To: Board of Trustees
From: Eric Pingrey
Subject: Policy 5460 Housing Assistance Program

Policy 5460 addresses the housing crisis that the region faces. Implemented in 2013 this allowed staff to be paid a housing stipend to assist in the inflated costs of the region. I would like to recommend the housing committee create an updated program that clearly defines the program and benefits to staff. With median home price nearly doubling from @\$400,000 in 2017 to nearly @\$800,000 in 2022, I believe the metrics need to be clarified and updated to allow the board to address recruitment and retainment of high-quality staff.

Eric Pingrey
Superintendent



"Developing Lifelong Learners Today"

McCall-Donnelly Joint School District No. 421
120 Idaho Street, McCall, ID 83638
Phone: (208) 634-2161 Fax: (208) 634-4075

Date: November 14, 2022
To: Board of Trustees
From: Eric Pingrey
Subject: Gifted & Talented 3 Year Plan

The following plan was submitted by Phil Schoensee Director of Special Programs to meet the requirements set forth by the State Department of Education. I am recommending that you approve the plan.

Eric Pingrey
Superintendent

GIFTED AND TALENTED EDUCATION

HANDBOOK



McCall-Donnelly School District

#421

Updated September 2022

Red text with strikethrough shows deletions from the approved Fall 2019 version

Green text shows additions to the approved Fall 2019 version.

OVERVIEW OF SERVICES

THE RTI SYSTEM: Support for advanced learners in the McCall-Donnelly school district (MDS) follows a multi-tiered system, modeled after Response to Intervention (RTI).

The RTI Tier 1 level of support consists of core instruction in the general education classroom and classroom teacher-provided strategies for enrichment.

The RTI Tier 2 level of support is called the Candidate Pool (CP). Tier 2 is implemented when a student's needs are not met within Tier 1. Strategies for enrichment may be provided by the Gifted and Talented Education (GATE) facilitator. Identification of students for CP relies primarily on a system of screening tools for all five areas of giftedness. Secondly, students may be identified by either teacher or parent referrals, but placement is dependent on meeting the minimum criteria in the table below. Teacher and parent referral forms are available upon request from the GATE facilitator or may be found on the district website.

The RTI Tier 3 level of support is GATE identification. Students whose needs are not met by Tier 2 intervention may be considered for Tier 3. Strategies for enrichment and an Individual Learning Plan (ILP) are provided by the GATE facilitator. GATE identification and placement is determined by a preponderance of evidence, including full assessment with standardized/norm-referencing measures.

SERVICES: Students in the CP and those who are GATE-identified meet individually or in groups regularly with the GATE facilitator for pullout or push-in services. Each CP and each GATE-identified student is given the CogAT (Cognitive Abilities Test) full battery to assess his or her learning profile. Teachers of CP and GATE-identified students receive the CogAT learning profile from this test to help with differentiation strategies. Students who are GATE-identified receive the same services as CP students, plus an ILP and active advocacy from the GATE facilitator.

IDENTIFICATION TOOLS: The *Advanced Learners Rating Scale and Progress Monitor* tool (p. 21) includes a teacher form and a student form. It is a Likert-style questionnaire used to screen all five areas of giftedness. The purpose of the tool is to provide additional evidence of whether a student may benefit from Tier 2 placement in the CP and is also used to monitor progress once placed. CP services are deemed unnecessary for students who score higher than 70% on both the student and teacher questionnaires.

In addition to the screening tools listed in the following table, other types of formal and informal data are considered in each placement and identification decision made by the RTI leadership team. Integral to every decision is the collective professional judgement of the leadership team. A preponderance of evidence, not a single criterion, serves as the basis for placement or identification.

IDENTIFICATION MINIMUM REQUIREMENTS:

Area of Giftedness	Advanced Learners Rating Scale	Screening Tool for Tier 2 (CP)	Minimum Score for Tier 2 (CP)	Identifying Tool for Tier 3 (GATE)	Minimum Score for Tier 3 (GATE)
Intellectual	≤70%	CogAT screener	95th Percentile	Full CogAT battery	98 th Percentile
Academic	≤70%	MAP test iReady test	95th Percentile	MAP or iReady + 2 specific academic measures*	98 th Percentile
Creative	≤70%	Torrance Test of Creativity (TTC) or Renzulli Scales	95th Percentile	TTC or Profile of Creative Abilities(PCA)	98 th Percentile
Visual or Performing Arts	≤70%	PE, Art & Music teacher screener, based on Renzulli Scales	95th Percentile	Renzulli-based PE, Art & Music teacher screener, Gifted Rating Scale (GRS), or Scales for Identifying Gifted Students(SIGS), plus a recognized performance evaluation	98 th Percentile
Leadership	≤70%	Teacher and Student screeners, based on Renzulli Scales	95th Percentile	Renzulli-based Teacher and Student screeners, GRS, SIGS, or TTC, plus a recognized performance evaluation	98 th Percentile

*Includes criterion- or norm-referenced achievement tests, norm-referenced observation scales, or performance evaluations

The Five Areas in which a student may be identified are

1. Intellectually or Cognitively Gifted

2. Academically Gifted

3. Creatively Gifted

4. Gifted in Leadership

5. Gifted in Visual or Performing Arts or Psychomotor Abilities

GIFTED CHARACTERISTICS SPECIFIC TO EACH OF THE FIVE AREAS OF GIFTEDNESS

1. Characteristics of the Intellectually/Cognitively Gifted:

A significantly advanced ability to learn, reason, problem solve, and connect/adapt information to new situations without guidance. Generally, this is measured by an IQ test. Individuals with IQ or cognitive aptitude scores of 130+ are considered intellectually gifted. This kind of giftedness is characterized by an individual who strongly exhibits several of the traits below:

- Insatiable curiosity
 - Asks thoughtful or penetrating questions
 - Intense need to understand truth and gain knowledge
- Enjoys problem-solving & applying concepts
 - Easily finds patterns
 - Manipulates information
 - Thrives on complexity and abstract thinking
 - Constructs abstractions from ideas
 - Applies knowledge to make good guesses
 - Draws inferences/connections between subjects, academic knowledge, and real-life
- Enjoys learning and learns rapidly
 - Outstanding memory and broad knowledge base
 - Self-initiates learning
 - Independent worker
 - Persistent & intently focused on passions
 - Can concentrate for long periods of time
 - Rapid language acquisition
 - 1-8 repetitions for mastery
- Advanced language & reading
 - voracious & early reader
 - large, advanced, & expressive vocabulary for their age
- Many interests & abilities
- Critical thinker & skeptic
- Keenly observant
- Beyond the group

- Engages in distracting behavior and may seem to not pay attention, yet tests well & knows the answers

Identification in the Intellectual/Cognitive area is determined by a WISC or Stanford-Binet full scale score, or a score in Fluid or Perceptual Reasoning, Verbal Comprehension, Visual/Spatial, or Quantitative Reasoning at or above the

- 98th percentile (130 WISC/132 S-B) or
- 95th percentile (125 WISC/ 126 S-B) for students identified as ELL or with a recognized disability evidenced by an IEP or 504 plan

Identification in the Intellectual/Cognitive area may be determined by multiple sources of formal and informal data, including a CogAT score at or above the 98th percentile.

2. Characteristics of the Academically Gifted:

An individual is considered gifted academically when he or she demonstrates superior ability in mastering skills and concepts in one or more curriculum areas. Look for a student that strongly shows several of the following traits:

- Advanced levels of understanding in specific content area (i.e., reading, math, language, science, humanities)
 - Deep understanding of content regardless of performance on classroom tasks
 - Already knows/understands substantial content upon entering a class
- Excellent memory in content area
- Absorbs high quantities of information
- Quick mastery & factual recall
- Perseverant and intense with their interests, demonstrating a long attention span
- Hard worker and tests well in an academic setting
- Loves learning for the sake of learning
- Beyond the group

Identification in the academically gifted area is determined by a Woodcock-Johnson broad score or subtest score at or above the

- 98th percentile (score of 130) or
- 95th percentile (score of 124) for students identified as ELL or with a recognized disability evidenced by an IEP or 504 plan

Identification in the academically gifted area may be determined by multiple sources of formal and informal data, with scores on two specific academic measures at or above the 98th percentile on a norm-referenced achievement test, norm-referenced observation scales, or performance evaluations.

3. Characteristics of the Creatively Gifted:

Creativity is the process of developing new, uncommon, or unique ideas. A creatively gifted individual shows exceptional levels of creativity and will strongly exhibit several of the traits below:

- Inventive and unique ideas
 - Initiates projects
 - Creates new designs
 - Comes up with many solutions to a given problem
- Highly imaginative and fantastical
 - Wild and whimsical ideas
 - Exhibits original thinking in oral and written expression
- Independent attitude, thinking, & social behavior
 - Self-accepting & unconcern for social norms
 - Believes that society needs to be changed
- Keen sense of humor
- Detailed, elaborate answers
- Open to new experiences & risk-taking
- Intuitive
- Flexible thinker that can improvise easily and often
- Is intense/headstrong
- Aesthetic & moral commitment to self-selected work
- Challenged by creative tasks

Identification in the creatively gifted area is determined by a Torrance Test of Creativity or Naglieri Nonverbal Abilities Test (NNAT) score at or above the 98th percentile, in conjunction with an Intellectual or Specific Academic test score of at least the 92nd percentile.

Identification in the creatively gifted area may be determined by multiple sources of formal and informal data, including a TTC or PCA score at or above the 98th percentile.

4. Characteristics of the Gifted in Visual and Performing Arts: The visual and performing arts include dance, drama/theatre, art, and musical performance. A student considered gifted in these areas demonstrates superior ability in one or more of these areas typically through exhibition and performance.

Visual Arts:

- Works independently
 - Is critical of own artwork
 - Takes pride in own artwork
 - Enjoys experimenting with different media
 - Creates visuals to supplement work
 - Displays self-motivation while engaged in artistic experiences
 - Tends to select art media for free-time activity or spends a great deal of time, in and out of school, doing art

- Tends to exhibit more emotional responses to stimuli
 - Exhibits a flair for the dramatic
- Enjoys and appreciates the art of others
 - Comments on the colors, shapes, and structure of things
 - Shows insight, is observant
- Arrives at unique, unconventional solutions to artistic problems
- Is asked by others to do artwork
- Masters basic art skills easily and quickly
- Exhibits a passion or great zeal toward projects

Music/Dance

- Seems particularly sensitive to sounds of all kinds
 - Is aware of and can identify a variety of sounds heard at a given moment-is sensitive to “background” noises, to chords that accompany a melody, to the different sounds of singers or instrumentalists in a performance.
- Creates his/her own songs, instrumental compositions, or dances
 - Spontaneously dances, moves or creates rhythmic accompaniments to music on TV or radio.
- Shows an intense interest in learning an instrument, in singing, or in dancing
 - Practices a musical instrument, sings, or dances daily
 - Attempts to teach musical skills learned in school or in private lessons to younger brothers or sisters
 - Seeks information/knows about music and musicians

Drama/Theater

- Generates many unique ideas and solutions
 - Accepts suggestions and criticisms
- Enjoys participating in class plays or skits
 - Uses gestures and facial expressions
 - Can memorize quickly
 - Can easily tell a story or experience
- Holds attention of a group
 - Likes to be the center of attention
- Is a risk taker
- Likes physical tasks

Identification in the visual and performing arts gifted area may be determined by multiple sources of formal and informal data, including results of the GRS, SIGS, or TTC at the 98th percentile, or a Renzulli Scales score at or above 98% in the applicable behaviors, plus a recognized performance evaluation.

5. Characteristics of the Gifted in Leadership:

Leadership can be defined as the ability to direct individuals or groups to a common decision or action. Students who demonstrate giftedness in leadership ability use group skills and negotiate in difficult situations. Look for a student who strongly demonstrates several of the traits below:

- Strong interpersonal skills
 - Dominates and directs activities
 - Openly shares opinions
 - Cooperation and collaborative skills
- Assists readily with chores, childcare, and homework assistance
- Reliable and dependable
- Enjoys discussing & solving societal problems
- Is not afraid to ask questions
- Evaluative approach towards self and others
- Readily adapts to new situations

Identification in the leadership gifted area may be determined by multiple sources of formal and informal data, including results of the GRS or SIGS at the 98th percentile, or a Renzulli Scales for Leadership score at or above 98% of the maximum, plus a recognized performance evaluation.

GENERAL GIFTED CHARACTERISTICS

What is Giftedness?

Giftedness refers to an accelerated ability to learn and problem solve. Compared with other children, a gifted child shows a significant difference in the way the child perceives and processes their world. The federal government and the state of Idaho define giftedness as: "Students who are identified as possessing demonstrated or potential abilities that give evidence of high performing capabilities in intellectual, creative, specific academic or leadership areas, or ability in the performing or visual arts and who require services or activities not ordinarily provided by the school in order to fully develop such capabilities." (Idaho Code §33-2001)

General Characteristics/Traits of Gifted Children

A gifted student will not often show all of the following traits when compared to age-level peers. When two or more traits are observed consistently by parents and/or teachers, referral should be considered.

Gifted children may:

1. display asynchronous (uneven) development, i.e., highly advanced in math and/or reading skills, yet lagging social skills; high level thinkers, yet lacking organizational skills.
2. have heightened sensitivities that cause them to experience the world in a significantly different way, i.e., physical, emotional, sensory, intellectual, imaginal.

3. begin school with an abundance of knowledge, often not encountering new material until January of a school year.
4. be creative and are excellent problem solvers.
5. be analytical; they may overthink details and require additional time for task completion.
6. resist social injustices or perceived unfairness in any form, on the playground, in the classroom, or in the world at large.
7. struggle socially, particularly with grade-level peers. They may display a glaring lack of sensitivity to others.
8. be underachievers in school. Their educational interests may be incompatible with school goals and objectives. Their behavior may be interpreted as apathetic or unmotivated.
9. have perfectionistic tendencies, i.e., interpret grades below an A as failure.

Adapted from: "Giftedness Defined." NSGT Giftedness Defined Comments. N.p., n.d. Web. 10 June 2015. "5 Definitions of Giftedness." Institute for Educational Advancements Blog. N.p., 01 May 2012. Web. 10 June 2015. & "Giftedness and the Gifted: What's It All About?" Giftedness and the Gifted: What's It All About? N.p., n.d. Web. 10 June 2015.

Common Emotional Traits of Gifted Learners:

- Unusual depth & intensity of emotions
 - Highly emotionally sensitive with a need for emotional support—feelings easily hurt, easily offended, extremely sensitive to criticism
 - High levels of empathy towards others' emotions
 - High expectations of self & others—can lead to frustration, impatience, and/or intolerance
 - Strong feelings/opinions
- Highly sensitive to criticism
 - Heightened self-awareness
 - Sense of being different
 - Highly self-critical
 - Sets high standards for self; exhibits perfectionism
- Idealistic and strong sense of justice and fair play
 - Advanced levels of moral judgment
 - Sensitive to hypocrisy
 - Cares about ethical or humanitarian issues at an early age
- Relates to & enjoys older playmates

- Prefers adults to most age-level peers
- Exhibits leadership ability in peer group
- Intense; gets totally absorbed in activities and thoughts
- Has a sophisticated sense of humor

Common Traits of Culturally Diverse/Economically Disadvantaged Gifted Learners:

- Absorbed in intellectual tasks
 - Unusually varied interests and strong curiosity
 - Self-aware as learner
 - Keeps busy and entertained
 - Ability to use stored knowledge to solve problems
 - Ability to manipulate a symbol system
 - Ability to think logically and reason by analogy
- Have “street smarts”
 - Show resiliency: the ability to cope with school while living in poverty and/or with dysfunctional families
 - Acknowledge negative factors in life, yet counterbalance this by a willingness to overcome
 - Participate in effective risk-taking behavior
- Show independence
 - Ability to take on adult roles at home, such as managing the household and supervising siblings, even at the expense of school attendance and achievement
- Demonstrate effective communication through expressive speech
 - Richness in imagination through informal language
- High degree of emotional responsiveness
 - Strong sense of altruism i.e., caring about others
 - Keen sense of justice and quick to analyze injustice
- Creative and artistic ability

Common Traits of English Language Learning Gifted Learners:

- Read, in native language, 2+ years above grade level
- Rapid non-native language acquisition
- Desire to teach peers words from his/her native language
 - Ability to explain native dialect and figurative language
 - Demonstrate eagerness to translate for peers and/or adults
 - High levels of accuracy in translating between languages
- Have older playmates and easily engage adults in conversation

- Understand jokes and puns
- Explain ideas through role playing or storytelling
- Easily adapt to new environments
- Have strong leadership and interpersonal skills
- Exhibit strong sense of self, pride, and worth coupled with strong ties to own culture
 - Balance appropriate behaviors expected for his/her native culture and the new culture
 - Exceptional talent in areas viewed important by their culture

Adapted from: "Giftedness Defined." *NSGT Giftedness Defined Comments*. N.p., n.d. Web. 10 June 2015. "5 Definitions of Giftedness." *Institute for Educational Advancements Blog*. N.p., 01 May 2012. Web. 10 June 2015. & "Giftedness and the Gifted: What's It All About?" *Giftedness and the Gifted: What's It All About?* N.p., n.d. Web. 10 June 2015.

Gifted learners prefer idea-mates rather than age-mates.

They enjoy the company of peers when the peer group understands the shared ideas.

A High Achiever...	A Gifted Learner...	A Creative Thinker...
Remembers the answers.	Poses unforeseen questions.	Sees exceptions.
Is interested.	Is curious.	Wonders.
Is attentive.	Is selectively mentally engaged.	Daydreams; may seem off task.
Generates advanced ideas.	Generates complex, abstract ideas.	Overflows with ideas, many of which will never be developed.
Works hard to achieve.	Knows without working hard.	Plays with ideas and concepts.
Answer the questions in detail.	Ponders with depth and multiple perspectives.	Injects new possibilities.
Performs at the top of the group.	Is beyond the group.	Is in own group.
Responds with interest and opinions.	Exhibits feelings and opinions from multiple perspectives.	Shares bizarre, sometimes conflicting opinions.
Learns with ease.	Already knows.	Questions: What if...
Needs 6 to 8 repetitions to master.	Needs 1 to 3 repetitions to master.	Questions the need for mastery.
Comprehends at a high level.	Comprehends in-depth, complex ideas.	Overflows with ideas--many of which will never be developed.
Enjoys the company of age peers.	Prefers the company of intellectual peers.	Prefers the company of creative peers but often works alone.
Understands complex, abstract humor.	Creates complex, abstract humor.	Relishes wild, off-the-wall humor.
Grasps the meaning.	Infers and connects concepts.	Makes mental leaps: Aha!
Completes assignments on time.	Initiates projects and extensions of assignments.	Initiates more projects that will ever be completed.
Is receptive.	Is intense.	Is independent and unconventional.
Is accurate and complete.	Is original and continually developing.	Is original and continually developing.
Enjoys school often.	Enjoys self-directed learning.	Enjoys creating.
Absorbs information	Manipulates information	Improvises
Is a technician with expertise in a field.	Is an expert who abstracts beyond the field.	Is an inventor and idea generator.
Memorizes well.	Guesses and infers well.	Creates and brainstorms well.
Is highly alert and observant.	Anticipates and relates observations.	Is intuitive.
Is pleased with own learning.	Is self-critical.	Is never finished with possibilities.
Gets A's.	May not be motivated by grades.	May not be motivated by grades.
Is able.	Is intellectual.	Is idiosyncratic.

Adapted from: Kingore, Bertie. "High Achiever, Gifted Learner, Creative Thinker." *Understanding Our Gifted*, vol. 15, no. 3, 2004,:3-5

McCall Donnelly School District #421

Gifted and Talented Education

IDENTIFICATION AND QUALIFICATION PROCESS

The McCall-Donnelly School District follows the state of Idaho's Gifted and Talented Rules and Regulations (IDAPA 08.02.03.999) when identifying gifted and talented students for the GATE Program. The District's GATE identification and placement process includes screening and assessment practices and are not based on a single criterion. The process uses multiple indicators to obtain information about students. Both formal and informal assessments and information from multiple sources (known as the *Body of Evidence*) are used to document the substantial exceptional ability and achievement of students in determining GATE eligibility.

The assessment tools used to collect the Body of Evidence vary. These tools collect both formal and informal data and examine cognitive ability and academic achievement, as well as gifted characteristics. These tools *may* include, but are not limited to screening instruments, group tests, individualized tests, observations, checklists, rating scales, questionnaires, interviews, and work samples.

The District's GATE identification and qualification process reflects the **federal and state definitions** of gifted and talented students:

- Those identified as possessing talent or the potential for performing at remarkably high levels.
- These children and youth exhibit high performance capability in the areas of intelligence, academics, creativity, leadership and/or visual/performing arts.
- These students require services or activities not ordinarily provided by the school in order to fully develop such capabilities.

Screeners provide the primary route for considering placement in the CP and when to complete a full assessment for GATE identification. Referrals provide a secondary route to identification. Through the routine use of screeners that are targeted to each of the five areas of giftedness, students are placed in the Candidate Pool (CP) by an RTI team. In the CP, each student is given the *CogAT* full battery. The *CogAT* full battery provides a learner's profile to help teachers with specific differentiation. Students whose needs are not met by the CP intervention may be considered for GATE identification by the RTI team.

Placement in the CP depends on a student's score on the screener, his or her score on the *MDSD GATE Advanced Learner Rating Scale and Progress Monitor Questionnaire* (p. 20), and on the professional judgement of the RTI team members. Students may also be placed in the CP by teacher or parent referral, following approval by the RTI team.

The district accepts individual GATE referrals at any time. A complete referral packet includes the *Parent Referral and Consent* form (p. 16), *Teacher Referral* (p. 18) and *Teacher Rating Scale* (p. 19), plus any other supporting documents or evidence of gifted traits.

The **GATE Referral Process** may occur with parental consent by either of two routes:

1. **Group Screening and Data Collection Route**
 - A. Automatic Referral based on a screening test score at or above the 95th percentile
 - B. **Body of Evidence Procedure for screening test scores between the 85th and 95th percentile**

2. Individual Referral and Consent Route

Route 1: Group Screening and Data Collection

The district uses a formal screening and data collection process to create a pool of potential GATE candidates in the fall of each school year.

Elementary: Teachers review universal screening results and the Gifted Characteristics tool when considering possible students to refer to the pool.

Secondary: A review of universal screening data for students in the 6th and 9th grades is conducted by the GATE facilitator in the secondary schools for continued recruitment to the candidacy pool.

Route 2: Individual Referral

The District accepts individual GATE referrals at any time. A complete referral packet includes the Parent Referral and Consent form, Teacher Referral and Teacher Rating Scale, plus any other supporting documents or evidences of gifted traits.

Data collection tools used as universal screeners vary from grade to grade. Academic data collection tools may include the iStation, ISAT, AIMSweb, MAP, as well as tools to review the performance of English Language Learners (ELLs) as potential GATE candidates. A *Parent Kindergarten Questionnaire* may be used to gather data for incoming students prior to 1st grade. Universal cognitive data collection is accomplished through administration of the *CogAT 7 Screener* to all 2nd grade students. The *CogAT 7 Screener* is also given to individual students at any grade level who are referred and exhibit scores on universal screening tools that meet the guidelines.

The *CogAT 7* serves as part of the district's screening process to identify students for the GATE candidacy pool, using criteria scores that are primarily based on the 95th percentile. Results from this test are also used in the RTI decision-making process for all students, student grouping decisions made by classroom teachers, and programming and decision-making for English Language Learners.

The *CogAT 7* measures a student's abilities in reasoning and problem-solving using verbal, quantitative, and nonverbal (spatial) symbols, the three areas most linked to academic success in school. These three lenses of assessment offer a balanced view of the student's innate reasoning abilities, without being connected to academics. The *CogAT 7* is well-suited to help educators make important student placement decisions, such as selecting students for Gifted and Talented programs. It is also proven by research studies to identify more English Language Learners and minority students as possibly eligible for Gifted and Talented programs (Riverside Publishing, 2015).

Universal academic data collection is accomplished through administration of the *MAP* test in grades 3 through 8. Universal creativity data collection is accomplished through administration of the *TTC* to all 3rd graders. Universal visual or performing arts data collection is accomplished through the *MDSG GATE Visual or Performing Arts Screener* (p. 22), administered to all 4th grade teachers. Universal leadership data collection is accomplished through the *MDSG GATE Leadership Screener* (p. 23-25), administered to all 5th grade teachers.

If the referral route is used, once a referral has been made, an RTI team including which must include the GATE facilitator, determines whether to proceed with further cognitive testing for GATE identification qualification.

The **GATE Qualification Process** may occur in either of the following ways:

Automatic Qualification may occur with either of these test scores and other supporting evidence:

1. Intellectual

WISC or Stanford-Binet full scale or subtest scores in Fluid or Perceptual Reasoning, Verbal Comprehension, Visual/Spatial, or Quantitative Reasoning at or above the

- 98th percentile (130 WISC/132 S-B) or
- 95th percentile (125 WISC/ 126 S-B) for students identified as ELL or with a recognized disability evidenced by an IEP or 504 plan

2. Specific Academic

Woodcock-Johnson broad score or subtest score at or above the

- 98th percentile (score of 130) or
- 95th percentile (score of 124) for students identified as ELL or with a recognized disability evidenced by an IEP or 504 plan

Automatic Qualification may also occur with a Torrance Test of Creativity or Naglieri Nonverbal Abilities Test (NNAT) score at or above the 98th percentile, in conjunction with an Intellectual or Specific Academic test score of at least the 92nd percentile.

Body of Evidence Qualification may occur when the intellectual or specific academic test score is between the 92nd and 98th/95th percentile. An eligibility team, which must include the GATE facilitator and school psychologist, reviews the evidence gathered during screening and referral, and determines whether there is a need to collect additional evidence. Considerations include work samples, observation, interview, additional rating scales (Scales for Identifying Gifted Students – SIGS), documentation of leadership abilities or documentation of talent from a recognized expert in the talent field.

The **GATE Identification Process** requires parent consent before a qualified student may be identified.

The **GATE Services** provided include Individual Consultation for all K-12 identified students. The GATE facilitator, parents, and teachers develop and write an ILP for each identified student. The ILP includes background information, learning strengths and interests, and accommodations for the student. Classroom teachers implement the ILP, and the teachers, parents, and GATE facilitator monitor its success

K-5 identified students receive Pull-out and Push-in services. These services include

- Opportunities for peer association
- Opportunities for students to select their topics of learning and tie them to grade-level state standards. The GATE facilitator oversees the process of topic selection and tying topics to standards.
- Individual Learning Plans

6-8 identified students have the option of an Independent Projects class or group. Students in Independent Projects develop a project proposal, including intermediate goals and deadlines and a final product goal and deadline. The GATE facilitator oversees the independent projects. Services for 6-8 identified students include

- Opportunities for peer association

- Opportunities for students to select their topics of learning and tie them to grade-level state standards.
- Individual Learning Plans

9-12 identified students' options for peer association and for pursuing their topics of interest include

- Advanced STEM research projects, overseen by the GATE facilitator.
- Senior project
- Advanced Placement courses
- Dual Credit courses
- Individual Learning Plans

A Body of Evidence is used for the evaluation of services, including student performance data and parent and teacher comments.

Appeals to identification decisions made by the RTI team may be submitted to the GATE coordinator. The decision will then be reviewed and re-considered by the RTI team, including the GATE coordinator.

Examples of highly effective interventions for GATE students include:

- Teacher Training
Teachers who know how gifted students learn and are well trained in gifted education strategies are critical to high-level gifted programs; however, most gifted students spend their school days in the regular classroom. Providing basic training for all teachers on recognizing and serving advanced students helps identify and more appropriately educate those students in the regular classroom.
- Acceleration (subject or grade)
Educational acceleration is one of the cornerstones of exemplary gifted education practices, with more research supporting this intervention than any other in the literature on gifted individuals. The practice of educational acceleration has long been used to match high-level students' general abilities and specific talents with optimal learning opportunities.
- Curriculum Compacting
This important instructional strategy condenses, modifies, or streamlines the regular curriculum to reduce repetition of previously mastered material. "Compacting" what students already know allows time for acceleration or enrichment beyond the basic curriculum for students who would otherwise be simply practicing what they already know.
- Grouping
The practice of grouping or placing students with similar abilities and/or performance together for instruction, has been shown to positively impact student learning gains. Grouping gifted children together allows for more appropriate, rapid, and advanced instruction, which matches the rapidly developing skills and capabilities of gifted students.
- Identification
Identification is a critical component of effective gifted education programming. One size does not fit all. In addition to using assessments appropriate to the services provided, different strategies may be needed to ensure students with high potential are identified.
- Pull-Out and Other Specialized Programs
Programming options for gifted and talented students occur in a variety of ways, and

research demonstrates the effectiveness of pull-out programs, specialized classes, and other special programs and schools and the curriculum these services use in raising student achievement.

McCall Donnelly School District #421

Gifted and Talented Education

PARENT REFERRAL/CONSENT FORM

STUDENT'S NAME _____

PARENTS' NAMES _____

Mailing Address _____ Email Address _____

Mother: home phone _____ work phone _____ cell phone _____

Father: home phone _____ work phone _____ cell phone _____

Permission is given to conduct a cognitive, academic, or creative evaluation of my child. Testing instruments may include but are not limited to the Cognitive Achievement Test and the Torrance Test of Creativity. **Not all referrals result in evaluation.**

Parent signature _____ Date _____

1. What do you feel are your child's strongest talent areas?

2. My child exhibits exceptional talent in the following area(s):

__ Intellectual

___ Academic: strength area _____

__ Leadership

___ Creativity

___ Visual/Performing Arts

3. Please describe any areas of concern you may have for your child, academically or socially.

Continued on back

4. What activities (hobbies, collections, special lessons, etc.) occupy your child's time after school and on weekends?

5. What early evidences were there of your child's ability?

6. Please describe how your child's educational needs are being met in the regular classroom.

7. In what ways do you think your child would benefit from participation in gifted services?

McCall-Donnelly School District #421

Gifted and Talented Education

TEACHER REFERRAL FORM

STUDENT'S FULL NAME _____

PARENT(S) _____

SCHOOL _____ TEACHER _____ GRADE _____ DATE _____

NEEDS: I am referring this student to the GT program because of his/her high ability or potential. I have observed this student to have the following characteristics/needs:

___ 1. Regularly finishes assignments quickly and correctly resulting in excessive amounts of free time.

___ 2. Raises in-depth questions related to classroom assignments that require research and guidance.

___ 3. Student has peer association problems that seem to be the result of exceptional abilities or special interests that are not shared by the other students.

- A. The student avoids peer discussion of special interests.
- B. The teacher has noted a decline in student participation in peer activities.
- C. The student dominates peer discussion and causes irritation.
- D. Lack of opportunity to interact with children with similar abilities.

___ 4. Student has demonstrated acting out behavior that appears related to boredom or lack of interest in schoolwork.

___ 5. The student demonstrates marked discrepancy between ability and the performance level of assigned work.

___ 6. The student is just getting by in class assignments; only doing the minimum to maintain a grade.

COMMENTS: _____

INSTRUCTIONAL STRATEGIES being used in my classroom in order to meet this student's needs:

- ___ Curriculum Compacting
- ___ Acceleration
- ___ Independent Projects relating to curricular areas
- ___ Enrichment materials/activities in student's interest area, such as:
- ___ Individual Contracts - subjects:
- ___ Differentiated Curriculum

PERFORMANCE DATA: List any group standardized test data

Current Grades: Reading ___ Language ___ Math ___ Social Studies ___ Science ___

Please attach any relevant work samples, portfolio items or professional recommendations

McCall-Donnelly School District #421

Gifted and Talented Education

TEACHER RATING SCALE

Student Name _____ Age _____ Grade Level _____

School _____ Teacher _____ Date _____

Please rate the student on the following characteristics by checking the appropriate boxes, using the following criteria:

1-Seldom or never observe this characteristic 3-Frequently observe this characteristic

2-Occasionally observe this characteristic 4-Almost always observe this characteristic

	Characteristic	1	2	3	4
1.	Has unusually large vocabulary				
2.	Has ideas that are often very original and imaginative in one or more areas				
3.	Has an unusually good memory				
4.	Is alert and keenly observant; responds quickly				
5.	Has a long attention span				
6.	Uses longer sentences than peers				
7.	Reasons things out; thinks clearly; recognizes relationships; comprehends meanings				
8.	Is curious about places outside immediate environment				
9.	Is informed about a variety of areas				
10.	Shows a high level of sensitivity and empathy				
11.	Has an excellent sense of humor				
12.	Is an independent worker				
13.	Has a variety of interests				
14.	Is a leader in several kinds of activities; is able to influence others to work toward desirable goals				
15.	Has outstanding talent in a special area. Indicate the area here _____				

Total Score: ___ points

As a candidate for the Gifted/Talented Program, I consider this student to be:

___ Superior (50-60 pts.) ___ Very Good (40-49 pts.) ___ Average (30-39 pts.) ___ Below Average (<30 pts.)

Comments:

McCall-Donnelly School District #421

Gifted and Talented Education

Advanced Learners Rating Scale and Progress Monitor

Student Survey

NAME

1. I enjoy going to school
0)Never 1)Rarely 2)Most of the time 3)Always
2. In my class, we are taught new and interesting things
0)Never 1)Rarely 2)Most of the time 3)Always
3. I already know and understand the math we are taught in class
0)Always 1)Most of the time 2)Rarely 3)Never
4. I already know and understand the reading we are taught in class
0)Always 1)Most of the time 2)Rarely 3)Never
5. My teacher understands how I learn
0)Never 1)Rarely 2)Most of the time 3)Always
6. I put all of my effort into doing the assignments I am given
0)Never 1)Rarely 2)Most of the time 3)Always
7. My teacher gives me more challenging work than is given to most of my classmates
0)Never 1)Rarely 2)Most of the time 3)Always
8. My teacher gives me opportunities to engage my passions in learning new things
0)Never 1)Rarely 2)Most of the time 3)Always
9. I get in trouble for my sense of humor in my classroom
0) Always 1) Most of the time 2) Rarely 3) Never
10. I would like to participate in the Talent Pool
0) All the time 1) Most of the time 2) Maybe a little 3) Not at all
11. I am comfortable asking my teacher for different, more challenging or meaningful work
0)Never 1)Some of the time 2)Most of the time 3)All of the time

McCall-Donnelly School District #421

Gifted and Talented Education

Advanced Learners Rating Scale and Progress Monitor

Teacher Survey

NAME

1. How often do you observe this student underachieving?

0)All of the time 1)Most of the time 2)Rarely 3)Never

2. How often have you observed distracting or negative behavior in this student?

0)All of the time 1)Most of the time 2)Rarely 3)Never

3. How frequently does this student seem to be happy in school?

0)Never 1)Rarely 2)Most of the time 3)Always

4. How often does this student need enrichment beyond the Tier 1 material?

0)All of the time 1)Most of the time 2)Rarely 3)Never

5. How often do you observe outstanding creativity in the way this student approaches or solves problems?

0)All of the time 1)Most of the time 2)Rarely 3)Never

6. How often do you observe outstanding leadership in this student's relationships with others?

0)All of the time 1)Most of the time 2)Rarely 3)Never

7. How often do you observe outstanding performing or fine arts abilities in this student?

0)All of the time 1)Most of the time 2)Rarely 3)Never

8. This student is challenged adequately with the differentiation I provide in-class

0)Never 1)Rarely 2)Most of the time 3)Always

9. The amount of time and effort it takes to adequately differentiate for this student is disproportionately large

0)All of the time 1)Most of the time 2)Rarely 3)Never

10. This student's sense of humor is appropriate for the classroom

0)Never 1)Rarely 2)Most of the time 3)Always

11. This student displays a very strong sense of social justice

0)Always 1)Most of the time 2)Rarely 3)Never

12. This student advocates for his or her needs

0)Never 1)Rarely 2)Most of the time 3)Always

McCall Donnelly School District #421

Gifted and Talented Education

Visual or Performing Arts Screener

If you have students who consistently stand out in these attributes, write their names in the spaces below each attribute. Next to each name, assign a 1 if you observe this characteristic all of the time, a 2 for most of the time, or a 3 for rarely. This information will be used to determine students who may be considered for tier 2 enrichment in the visual or performing arts area of gifted and talented. *Adapted from Joseph S. Renzulli's Scales for Rating the Behavioral Characteristics of Superior Students.*

Teacher name _____ Date _____

DRAMA

<i>Volunteers to participate in classroom plays/skits</i>	<i>Easily tells a story or gives an account of some experience</i>	<i>Communicates feelings by effectively using gesture/facial expression</i>	<i>Adept at role-playing, improvising, acting out situations on the spot</i>
<i>Regularly identifies with the moods and motivations of characters</i>	<i>Handles body with ease and poise asynchronously for age</i>	<i>Creates original plays or makes them up from stories</i>	<i>Commands and holds attention of a group when speaking</i>
<i>Evokes emotional responses, gets people to laugh or frown</i>		<i>Imitates others, mimics them in the way they speak, walk, or gesture</i>	

MUSICAL

<i>Sustained interest in music, seeking opportunities to hear and create it</i>	<i>Perceives fine differences in musical tone, in pitch, loudness, timbre, duration</i>	<i>Easily remembers and accurately reproduces melodies</i>	<i>Eagerly participates in musical activities</i>
<i>Plays or has strong desire to play a musical instrument</i>	<i>Sensitive to the rhythm of music</i>	<i>Responds to changes in tempo of music through body movement</i>	<i>Aware of and identifies a variety of sounds at any moment</i>
<i>Sensitive to background noises</i>	<i>Sensitive to accompanying chords</i>	<i>Sensitive to sounds of individuals in a group</i>	

--	--	--

ARTISTIC

<i>Eagerly participates in and visually expresses ideas in art activities</i>	<i>Incorporates a large number of elements into artwork</i>	<i>Varies the subject and content of artwork</i>	<i>Presents unique, unconventional solutions to artistic problems</i>
<i>Concentrates for long periods of time on art projects</i>	<i>Experiments with a variety of media, materials, techniques</i>	<i>Selects art media for free activities or class projects</i>	<i>Keen observer, particularly sensitive to the environment</i>
<i>Produces balance and order in artwork</i>	<i>Critical of own work, refines and reworks to high standards</i>	<i>Studies and discusses others' artwork</i>	<i>Elaborates on others' ideas as jumping-off points</i>

PROPOSAL BUDGET

CogAT 7 screener for 81 second graders (59 in MES and 22 in DES on 9/6/22)

Cost per license = \$11.70

Total cost this year for 100 licenses = \$1,170

Total cost for 110 tests each successive year = \$1,287

(Riverside Publishing)

Torrance test for 3rd graders each year: 81 MES + 35 DES = 116 total on 9/6/2022. These tests are purchased in sets of 20 each.

Cost for 120 tests and starting materials = \$440.50

Total cost for 120 tests each successive year = \$379.50

(Scholastic Testing Service)

CogAT full battery for each CP student one time when he or she enters the CP, and for each GATE student one time, unless he or she has already taken it while in the CP. Number of CP students on 9/6/2022 = 44. Number of GATE students on 9/6/2022 = 44. We will need 88 licenses to cover these, plus 20 more for next year's additions to the talent pool.

Cost per license = \$15.25

Total cost this year (88 licenses)= \$1,342

Cost per each successive year, estimating 20 new Talent Pool students per year, K-8 = \$305

(Riverside Publishing)

Renzulli Behavior Scales for each Talent Pool candidate for leadership GATE identification or visual or performing arts GATE identification

Cost for this year, including the administration manual and 50 booklets = \$108

Cost per each successive year, estimating 10 students K-8 (\$76 for 50 booklets) = \$15.20

(Prufrock Press)

Total Cost of proposal for the 2022-2023 school year = \$3,060.50

Total Cost per year for each successive year = \$1,986.70



"Developing Lifelong Learners Today"

McCall-Donnelly Joint School District No. 421
120 Idaho Street, McCall, ID 83638
Phone: (208) 634-2161 Fax: (208) 634-4075

Date: November 14, 2022
To: Board of Trustees
From: Eric Pingrey
Subject: Memorandum of Understanding Between MDS and MPD

I am requesting approval to enter into a Memorandum of Understanding between the MDS and the McCall Police department to ensure that FERPA (Families Educational Rights and Privacy Act) and ISDAA (Idaho Student Data Accessibility and Accountability Act of 2014) are both followed when the McCall Police department and the District are collaborating on student, staff and community safety. This memorandum will ensure that student data and information remain confidential.

Eric Pingrey
Superintendent

MEMORANDUM OF AGREEMENT

Between

McCall-Donnelly Joint School District No. 421 and McCall Police Department

For the purpose of sharing confidential business information

This Memorandum of Agreement is made and entered into between the McCall Donnelly Joint School District No. 421 located in the State of Idaho hereinafter referred to as "District" and the McCall Police Department, a department of the City of McCall, a municipal corporation of the state of Idaho, hereinafter referred to as "MPD".

WITNESSETH:

- A. The purpose of the agreement between the District and MPD is to:
 - a. Provide a safe learning environment and help reduce school violence; and
 - b. Improve school and law enforcement collaboration.
- B. The District and the MPD recognize the positive benefits to the school and community of collaboration between agencies.
- C. It is in the interest of the District, MPD, and Patrons of the District to work collaboratively to ensure the safety of our schools and community

NOW THEREFORE, in consideration of the mutual promises and covenants herein contained, the District and MPD hereby agree as follows.

ARTICLE 1

The District shall provide an area which need not be permanent to conduct matters of confidential business and shall provide records which are deemed necessary by the District realizing the District is subject to FERPA (Family Educational Rights and Privacy Act) and the Idaho Student Data Accessibility and Accountability Act of 2014 (section 33-133 Idaho Code) (hereinafter ISDAA). The parties recognize that they are bound to comply with FERPA and ISDAA in their handling of educational records.

ARTICLE 2

This Memorandum of Agreement shall remain in full force and effect and shall automatically be renewed each year unless either party exercise the right to terminate this agreement pursuant to Article 3.

Prior to June 15 of each year, the parties shall review the agreement and consider whether modifications to the agreement are necessary or advisable to accomplish its purposes. The parties agree to cooperate and negotiate in good faith in fulfilling the intent of the parties' concerning continuation of the Agreement by the MPD and/or the District. Included in this discussion would be any other matters of mutual concern.

The parties, their agents, and employees agree to cooperate in good faith in fulfilling the terms of this Agreement. The parties agree that they will attempt to resolve any disputes concerning the interpretation of this Agreement and unforeseen questions and difficulties which may arise by good faith negotiations before resorting to litigation.

ARTICLE 3

This Agreement may be terminated by either party by giving ninety (90) days prior written notice to the other party that has failed to substantially perform in accordance with the terms and conditions of this Agreement. This Agreement may be terminated without cause by either party giving one hundred eighty (180) days prior written notice to the other party.

ARTICLE 4

This document constitutes the full understanding of the parties, and no term, condition, understanding or agreement purporting to modify or vary the terms of this Agreement shall be binding unless hereafter made in writing and signed by the affected parties.

McCall Police Department

McCall-Donnelly School District

By: _____
Dallas Palmer, Chief of Police

By: _____
Eric Pingrey, Superintendent

Dated: _____

Dated: _____

Attested: _____

Attested: _____

NOTARY:

STATE OF IDAHO)
) ss.
County of Valley)

On this ____ day of _____, 2022, before me, the undersigned, a Notary Public in and for the State, personally appeared Dallas Palmer, known to me to be the Chief of Police for the City of McCall, a municipal corporation of Idaho, who executed the foregoing instrument on behalf of said municipal corporation, and acknowledged to me that said corporation executed the same.

IN WITNESS WHEREOF, I have hereunto set my hand and affixed my official seal the day and year in the certificate first above written.

NOTARY PUBLIC FOR IDAHO
Residing in _____, Idaho
My commission expires: _____

STATE OF IDAHO)
) ss.
County of Valley)

On this ____ day of _____, 2022, before me, the undersigned, a Notary Public in and for the State, personally appeared Eric Pingrey, known to me to be the Superintendent of the McCall-Donnelly Joint School District No. 421, and acknowledged to me that he executed the foregoing instrument on behalf of said public school district, and that said district executed the same.

IN WITNESS WHEREOF, I have hereunto set my hand and affixed my official seal the day and year in the certificate first above written.

NOTARY PUBLIC FOR IDAHO
Residing in _____, Idaho
My commission expires: _____



"Developing Lifelong Learners Today"

McCall-Donnelly Joint School District No. 421
120 Idaho Street, McCall, ID 83638
Phone: (208) 634-2161 Fax: (208) 634-4075

Date: November 14, 2022
To: Board of Trustees
From: Eric Pingrey
Subject: Construction Manager/General Contractor Recommendation

I would like to recommend the CM company be selected as the Construction Manager/General Contractor for the MDSD staff housing project. Two companies responded to the district's request for RFQ. Both companies were interviewed by committee on 11/7/22. The selection was a unanimous decision.

Eric Pingrey
Superintendent