

LISLE COMMUNITY UNIT SCHOOL DISTRICT 202
BOARD ROOM
5211 CENTER AVENUE
LISLE, ILLINOIS 60532
Board of Education Meeting
January 25, 2021
7:30 PM

Due to current conditions, the January 25, 2021 Board of Education Meeting will be held virtually. Members of the public are welcome to attend all meetings of the Lisle Community Unit School District 202 Board of Education, including those held via video conferencing. Anyone wishing to view the meeting or provide comment is encouraged to review the information below.

In-Person Meeting Viewing: Guests are welcome to attend the meeting in-person. Viewing areas will be located in the Board Room and the Junior High Auditorium. Capacity will be limited to 10 individuals per room.

Remote Meeting Viewing: The proceedings of the meeting will be streamed live and can be viewed using the following link: <http://www.youtube.com/c/LisleDistrict202>. Guests will join the meeting in view-only mode and will not be seen or heard in the meeting. A recording of the meeting will also be available on the School District website within 24 hours of the meetings conclusion.

Public Comment: Public comments can be made in-person or via email at publiccomment@lisle202.org. Comments must be received by 5:00 p.m. on the day in which the meeting is held. Comments submitted by the deadline will not be read aloud during the meeting, but rather will be provided to the School Board prior to the start of the meeting and will become part of the meeting record.

Please see the "Meeting Dates, Agendas and Minutes" page for links to the Board of Education meeting agendas, minutes and video feeds.

AGENDA

1. Call to Order and Roll Call - 7:30 pm
2. Pledge of Allegiance
3. Reading of Mission Statement 3
4. Public Comment
5. **ACTION ITEMS**
 - A. Consent Agenda:
 - (1) Board Meeting Minutes 4
 - (2) Payroll Pay Orders 9
 - (3) Vendor Pay Orders 28
 - (4) Personnel
 - a. Administrative Retirement 44
 - b. Certified Extra-Duty Employment 46
 - c. Certified Leave Request 49
 - d. Certified Resignation 50
 - e. Classified Employment 52
 - f. Classified Resignation 54
 - g. Classified Retirement 56
 - h. Non-Bargaining Support Staff Retirement 58
 - (5) Designation of Persons to Prepare Tentative Budget for FY2022 60
 - (6) Authorization to Release Closed Session Minutes for Public Inspection and Destruction of Audio Recordings 63
 - (7) Architect Professional Services Proposal - Summer 2022 Work 64
 - (8) Multi-Function School Activity Bus Purchase 69
6. **FINANCIAL INFORMATION** - The Board Acknowledges Receipt of the following Reports
 - A. Financial Report 83
 - B. Treasurer Report 84

7.	<u>DISCUSSION ITEMS</u>	
	A. Review of Draft 2022-2023 Official School Calendar	85
	B. Formative Assessment Presentation - Lisle Elementary and Junior High Schools	87
	C. Student In-Person/Remote Learning Plan Update	107
	D. Freedom of Information Request(s)	108
	E. Superintendent's Report	111
8.	<u>COMMITTEE REPORTS</u>	
	A. Educational Equity & Excellence (E3) - Did not meet	
	B. Facility Master Planning - Did not meet	
	C. Finance - See Finance Agenda	
	D. Policy - Did not meet	
9.	<u>BOARD REPRESENTATIVE REPORTS</u>	
	A. Eyes to the Skies - Did not meet	
	B. Home and School Organization	113
	C. IASB Delegate to Board	
	D. Intergovernmental - Did not meet	
	E. LEND	120
	F. Lisle Education Foundation	122
	G. SASSED	
10.	Agenda Topics for Future Board Meetings	
11.	Adjourn to Closed Session for the Purpose of Discussion of the Appointment, Performance, Discipline, Compensation or Dismissal of Employees	
12.	Return to Open Session	
13.	Adjournment	



Mission Statement

Lisle District 202 is committed to providing our learning community with the essential education, skills, and experiences for future success.

FOR ACTION

**Lisle Community Unit School District 202
Board of Education Meeting
January 25, 2021**

SUBJECT: Approval of Board of Education Meeting Minutes

SUGGESTED MOTION - That the Board of Education approve the Regular Minutes and Closed Session Minutes from the December 14, 2020 Board of Education Meeting.

LISLE COMMUNITY UNIT SCHOOL DISTRICT NO. 202
BOARD OF EDUCATION
REGULAR MEETING MINUTES
December 14, 2020

Record of Minutes of the Regular Meeting of the Board of Education of Lisle Community Unit School District 202, DuPage County Illinois, which was held in the Board Room of the Administrative Office, 5211 Center Avenue, Lisle Illinois on December 14, 2020.

The meeting was called to order at 6:50 p.m. by Vice-President Ahlmann.

Present: Meg Sima (by telephone per Board Policy)
Pam Ahlmann
Eunice McConville
Daniel Helderle
Lisa Kiener-Barnett
Wendy Nadeau
Randee Sims

Absent: none

Also Present: Dr. Keith Filipiak, Superintendent
Dr. Linda Kotalik, Assistant Superintendent
Dave Wilkinson, Director of Business Services
Jenna Engler, Communications Coordinator

Motion to Adjourn to Closed Session

At 6:50 p.m., motion by Mrs. Sims, seconded by Mrs. Kiener-Barnett
ADJOURN TO CLOSED SESSION FOR THE PURPOSE OF DISCUSSION APPOINTMENT, PERFORMANCE,
DISCIPLINE, COMPENSATION OR DISMISSAL OF EMPLOYEES

Answering to a roll call vote:

AYE: Sims, Kiener-Barnett, Nadeau, Helderle, Sima, McConville, Ahlmann

NAY: None

Motion carried 7-0

Return to Open Session

At 7:32 p.m., motion by Mrs. Nadeau, seconded by Mr. Helderle

RETURN TO OPEN SESSION

Motion carried with a voice vote of 7-0.

The Pledge of Allegiance was recited. Mrs. Ahlmann read the District Mission Statement.

Public Comment

- None

Consent Agenda

Motion by Mrs. Sims, seconded by Mrs. Kiener-Barnett

TO APPROVE/ACCEPT THE FOLLOWING CONSENT AGENDA ITEMS AS PRESENTED;

- Minutes of Regular and Closed Session of November 23, 2020
- November 2020 Payroll Pay Orders in the amount of \$ 1,530,431.30
- November 2020 Vendor Pay Orders in the amount of \$ 1,812,616.07
- Personnel:
 - Certified Leave Request
 - Emma Joy, Evening Custodian at Lisle Junior High School, has requested 12 weeks of FMLA Leave at the beginning on December 28, 2020.
 - Classified Retirement Request
 - Candace Lorkiewicz, Paraprofessional at Lisle Elementary School, has requested to retire at the conclusion of the 2020-2021 school year.
 - Approval of Administrative Support Staff Compensation Program
 - 2020 Real Estate Levy (discussed in depth at the December and November Finance meetings)
 - Resolution transferring funds to the Debt Services Fund of the District and abating a portion of the tax heretofore levied for the year 2020 to pay debt service on the District's General Obligation Limited Tax School Bonds, Series 2019
 - SY20-21 Second Semester Student Parking Fee Waiver - Lisle Senior High School
 - Board Policies - Second Reading PRESS Policies 106
 - Policy 3:40 Superintendent
 - Policy 4:80 Accountability and Audits
 - Policy 4:90 Student Activity and Fiduciary Funds
 - Policy 5:270 Employment At-Will, Compensation and Assignment
 - Policy 6:20 School Year Calendar and Day
 - Policy 6:300 Graduation Requirements
 - Policy 6:310 High School Credit for Non-District Experiences; Course Substitutions; Re-entering Student
 - Policy 6:315 High School Credit for Students in Grade 7 or 8
 - Policy 6:320 High School Credit for Proficiency
 - Policy 6:340 Student Testing and Assessment Program
 - Policy 7:100 Health, Eye and Dental Examinations; Immunizations; and Exclusion of Students
 - Policy 7:140 Search and Seizure
 - Policy 7:300 Extra Curricular Athletics

Answering to a roll call vote:

AYE: Sims, Kiener-Barnett, Helderle, Nadeau, Sima, McConville, Ahlmann

NAY: None

Motion carried 7-0

Financial Information

The Board Acknowledges Receipt of the following Reports:

- Financial Report - November 2020
- Treasurer's Report - November 2020

Discussion Items

E Rate and Internet Safety

- Dr. Kotalik explained that E Rate provides funding to schools and libraries.
- Lisle 202 incorporates internet safety instruction to teach students how to navigate online spaces safely and is in accordance with the E Rate requirements.
- A Board member suggested that the four relevant Board Policies be cross-referred.

School Year 2020-2021 In-Person Plan Update

- Students returned from the Thanksgiving adaptive pause on December 14, 2020.
- Some families have opted to remain remote for the remainder of the first semester.
- Concurrent learning at the elementary and junior high school allows for a smoother transition for families who wish to remain in remote instruction following the adaptive pause.
- Lisle High School will adjust the daily schedule for the second semester to increase instructional minutes.

Select Date for Special Meeting to Discuss Student Academic Achievement Presentations

- Additional virtual Board meetings will be scheduled for the Student Academic Achievement Presentations.
 - Thursday, January 21, 2021 - Elementary and Junior High
 - Wednesday, February 17, 2021 - High School

Freedom of Information Requests

The District received Freedom of Information Act request(s) from the following individual(s):

- none

Committee Reports

Board Committee Report summaries are located in Board Books unless otherwise indicated.

- EDUCATIONAL EQUITY & EXCELLENCE (E3) - did not meet
- FACILITY MASTER PLANNING – did not meet
- FINANCE Committee – See Finance Agenda
- POLICY Committee – See Board Meeting Agenda

Board Representative Reports

Board Representative Report summaries are located in Board Books unless otherwise indicated.

- Eyes to the Skies – did not meet
- Home and School Organization-did not meet
- IASB Delegate to Board - did not meet
- Intergovernmental – did not meet
- LEND-See Board Meeting Agenda
- Lisle Education Foundation - did not meet
- SASSED

Future Agenda Topics

- Return to School Updates
- Review and discuss how club and activity fees are determined

Motion to Adjourn to Closed Session

At 7:52 p.m., motion by Mrs. Sims, seconded by Mrs. Kiener-Barnett
ADJOURN TO CLOSED SESSION FOR THE PURPOSE OF DISCUSSION APPOINTMENT, PERFORMANCE, DISCIPLINE, COMPENSATION OR DISMISSAL OF EMPLOYEES

Answering to a roll call vote:

AYE: Sims, Kiener-Barnett, Nadeau, Helderle, Sima, McConville, Ahlmann

NAY: None

Motion carried 7-0

Return to Open Session

At 8:52 p.m., motion by Mrs. McConville, seconded by Mrs. Nadeau
RETURN TO OPEN SESSION

Motion carried with a voice vote of 7-0.

Motion to Adjourn

At 8:52 p.m., motion by Mr. Helderle, seconded Mrs. Nadeau
THAT THE MEETING BE ADJOURNED.

The motion carried with a voice vote of 7-0

ATTEST:

President

Secretary

LISLE COMMUNITY UNIT SCHOOL DISTRICT #202

PAYROLL PAY ORDERS

This is to certify that the Board of Education of Lisle Community Unit School District No. 202 ratified the following payroll pay orders: January 25, 2021

PAYROLL CHECKS ISSUED

Beginning	114949	and Ending	114951
Beginning	114955	and Ending	114957

PAYROLL ACH DEPOSIT

Beginning	9000022935	and Ending	9000023218
Beginning	9000023219	and Ending	9000023498

PAYROLL CHECKS VOIDED

PAYROLL ACH DEPOSITS VOIDED

FUND DISTRIBUTION

EDUCATIONAL	\$ 1,449,102.09
OPERATIONS & MAINTENANCE	\$ 81,902.37
DEBT SERVICES	\$ -
TRANSPORTATION	\$ 768.30
IMRF/SOCIAL SECURITY	\$ -
CAPITAL PROJECTS	\$ -
WORKING CASH	\$ -
TOTAL	<u>\$ 1,531,772.76</u>

President - Board of Education

Date

Secretary - Board of Education

Date

Payroll Run Check Listing for Board

Payroll	12/15/2020			Lisle CUSD 202
Check/ ACH	Employee	Check Location	Pay Gross	Net Amount
114949	Wollenzien, Nichole	300	166.60	153.85
114950	Balaban, Nicholas	800	1,226.36	1,132.55
114951	Wei, Joanna	800	334.46	292.31
9000022935	Buchholz, Marilyn	000	2,044.50	1,260.93
9000022936	Engler, Jennifer R	000	2,364.00	1,520.91
9000022937	Filipiak, Keith	000	8,838.58	5,910.98
9000022938	Hinton, Jeffery	000	2,467.32	1,331.02
9000022939	Kempfer-Kotalik, Linda	000	7,044.29	3,368.52
9000022940	Law, Jennifer S	000	6,381.96	4,256.19
9000022941	McCormick, Jennifer	000	1,925.31	975.62
9000022942	Navarro, Lawrence M	000	1,927.36	1,310.87
9000022943	Posego, John C	000	5,167.80	3,186.64
9000022944	Quinlan, Kevin	000	2,349.00	1,503.77
9000022945	Rannocho, Alisa	000	1,954.10	1,405.93
9000022946	Rich, Mary Beth	000	2,624.84	1,865.82
9000022947	Tsamis, Anna	000	3,340.98	1,934.98
9000022948	Van Volkenburg, Nancy L	000	2,808.36	1,948.08
9000022949	Wilkinson, David	000	6,056.54	4,049.49
9000022950	Anderson, Erik D	100	3,270.29	2,644.85
9000022951	Anderson, Herbert	100	4,203.25	2,819.39
9000022952	Bamboot, Darius	100	3,456.08	2,522.90
9000022953	Begley, Elizabeth	100	1,014.71	431.90
9000022954	Biezynski, Jenna A	100	826.35	534.76
9000022955	Brady, Jennifer L	100	3,047.29	2,308.23
9000022956	Bylsma, Nathan	100	5,054.06	3,657.04
9000022957	Bylsma, Svea	100	4,480.94	3,085.15
9000022958	Chandhok, Mona A	100	2,750.00	2,206.41
9000022959	Clarke, Jeannette	100	3,270.29	2,449.16
9000022960	Costello, Sheri	100	4,575.33	3,430.51
9000022961	Czyl, Maureen	100	1,014.71	599.81
9000022962	Davis, John	100	4,363.58	3,345.84
9000022963	Ferenzi, Daniella	100	1,492.69	1,172.05

Payroll Run Check Listing for Board

Payroll		12/15/2020			Lisle CUSD 202
Check/ ACH	Employee	Check Location	Pay Gross	Net Amount	
9000022964	Fitzgerald, Karen	100	1,843.15	417.04	
9000022965	Gansberg, Michele	100	1,015.91	667.38	
9000022966	Gomez, Vasilici	100	2,898.67	2,261.92	
9000022967	Gucciardo, Anjanette	100	3,679.04	2,910.34	
9000022968	Gumina, Scott	100	4,994.17	3,292.43	
9000022969	Hamann, Kelly	100	3,270.29	2,515.45	
9000022970	Hamilton, Mary Pat	100	805.76	517.11	
9000022971	Hardy, Venessa	100	4,234.57	2,624.39	
9000022972	Henrichs, Greg	100	3,493.21	2,534.26	
9000022973	Hochstetter, Judith	100	1,294.33	895.36	
9000022974	Holmes, Steven	100	1,693.89	1,216.37	
9000022975	Honzel, Robin	100	4,478.42	3,247.89	
9000022976	Howard, Jeffrey	100	7,042.13	4,907.32	
9000022977	Irvine, Karin	100	4,013.50	3,174.79	
9000022978	Jaegle, Christine A	100	3,404.07	2,728.57	
9000022979	Jaegle, Ronald	100	4,993.76	3,482.34	
9000022980	Javior, Jeffrey	100	4,133.96	2,629.98	
9000022981	Jenkins, David A	100	1,727.82	1,219.19	
9000022982	Jensen, Christine	100	3,522.97	2,885.62	
9000022983	Kehoe, Debra	100	4,478.42	3,166.73	
9000022984	Kern, Erin	100	2,963.46	2,084.61	
9000022985	Klempic, Mirza	100	2,002.18	1,439.84	
9000022986	Koeppen, Kelly	100	1,427.19	1,218.20	
9000022987	Kohorn, Paul	100	1,532.03	1,139.01	
9000022988	Kucera, Sasha	100	941.25	598.60	
9000022989	Kuefner, Julie	100	3,753.38	2,566.44	
9000022990	LaScala, Mark	100	5,475.11	4,024.10	
9000022991	Love, Sherry	100	834.75	670.62	
9000022992	Maldre, Sarah	100	3,431.06	2,159.87	
9000022993	Marcum, Thomas C	100	4,590.92	3,697.72	
9000022994	Martinez-Alvear, Aldo	100	1,627.77	1,149.02	
9000022995	Matariyeh, Yousef	100	4,788.59	3,402.31	

Payroll Run Check Listing for Board

Payroll	12/15/2020	Lisle CUSD 202		
Check/ ACH	Employee	Check Location	Pay Gross	Net Amount
9000022996	Meyer, Kendra	100	4,248.75	3,104.95
9000022997	Milinki, Jennifer	100	4,024.32	2,804.49
9000022998	Mlynarski, Tim	100	809.55	495.81
9000022999	Multhaupt, Courtney	100	4,640.41	3,493.96
9000023000	Musbach, Darlene	100	4,133.96	2,442.67
9000023001	Nadolny, Mary	100	653.22	366.34
9000023002	Ng, Joanna	100	3,323.13	2,150.96
9000023003	Novak, Emily	100	3,679.04	2,266.81
9000023004	Ogan, Elizabeth	100	4,478.42	3,416.25
9000023005	O'Hara, James	100	3,684.38	2,862.21
9000023006	Perez, Kevin E	100	3,233.13	2,409.31
9000023007	Perretta, Mia	100	4,080.43	3,066.12
9000023008	Polinski, Michael	100	2,898.67	2,388.70
9000023009	Pomatto-Zimmerman, Jennifer	100	4,576.08	3,674.01
9000023010	Provenzano, Lisa	100	1,052.13	835.86
9000023011	Renguso, Amy	100	3,308.27	2,342.01
9000023012	Ridges, Daniel	100	1,255.35	891.01
9000023013	Sanko, April	100	4,133.96	2,895.53
9000023014	Sanko, Daniel	100	4,248.75	2,804.34
9000023015	Schalk, Trent J	100	3,205.97	1,935.55
9000023016	Schwartz, Rebecca	100	4,582.72	3,273.66
9000023017	Smith, Justin	100	3,827.71	2,938.33
9000023018	Steben, James	100	5,258.83	3,992.49
9000023019	Stelk, Scott	100	1,627.77	943.33
9000023020	Stellmacher, James M	100	4,674.30	3,455.47
9000023021	Thome, Nicholas	100	2,074.48	1,267.94
9000023022	Thurnall, Katelyn	100	1,312.33	1,146.04
9000023023	Todd, Adam	100	1,599.06	1,154.73
9000023024	Waibel, Scott	100	3,649.34	2,569.29
9000023025	Wallenberg, Michelle	100	3,360.29	2,453.49
9000023026	Weissinger, Derek C	100	2,057.38	1,346.02
9000023027	Wolak, Brandon P	100	834.75	568.74

Payroll Run Check Listing for Board

Payroll	12/15/2020	Lisle CUSD 202		
Check/ ACH	Employee	Check Location	Pay Gross	Net Amount
9000023028	Woyna, Eric	100	4,162.16	2,934.26
9000023029	Woyna, Patrick	100	3,218.79	2,023.50
9000023030	Zita, Blair	100	1,303.82	1,204.62
9000023031	Alexander, Jarvis	200	705.79	543.95
9000023032	Blatchley, Monica	200	4,195.90	3,231.73
9000023033	Bossenga, Emmy	200	4,156.38	2,493.67
9000023034	Braun, Katherine	200	2,619.95	1,834.44
9000023035	Broadus, Gretchen	200	3,485.80	2,819.08
9000023036	Burdeaux, Jessica	200	759.53	536.77
9000023037	Burris, Karen M	200	1,318.69	670.26
9000023038	Byrne, Sharon	200	3,248.29	2,654.38
9000023039	Cerny, Marie	200	2,675.67	2,194.05
9000023040	Cervený, Karen	200	3,233.13	2,288.52
9000023041	Chiappetta, Rebecca	200	1,464.95	1,227.19
9000023042	Cornfield, Betty	200	4,852.20	2,088.92
9000023043	De Nichols, Patricia	200	4,266.18	2,355.18
9000023044	Dembowski, Kasie	200	1,598.24	1,202.04
9000023045	Dooley, Tara	200	1,229.06	823.74
9000023046	Dybeck, David	200	3,716.21	2,167.88
9000023047	Erickson, Tor	200	4,029.96	3,025.71
9000023048	Fitzner, Kenneth	800	1,120.00	893.69
9000023049	Hanson, Janet	200	4,478.42	1,755.57
9000023050	Harris, Thomas	200	1,285.59	1,079.14
9000023051	Hazard, Jean	200	925.46	607.39
9000023052	Henning, Mary	200	840.94	679.77
9000023053	Huschart, Kelly	200	3,146.42	2,423.22
9000023054	Joy, Emma P	200	1,924.94	1,144.87
9000023055	Kearney, David	200	5,761.79	4,176.95
9000023056	Keigher, Natalie	200	3,906.54	2,765.45
9000023057	Kim, Paul	200	3,827.71	2,584.99
9000023058	Klepper, Mary	200	2,898.67	2,160.17
9000023059	Lemke, Nanette	200	886.46	591.97

Payroll Run Check Listing for Board

Payroll		12/15/2020			Lisle CUSD 202
Check/ ACH	Employee	Check Location	Pay Gross	Net Amount	
9000023060	Lima, Valerie	200	991.44	645.38	
9000023061	Lumsden, Jason	200	4,125.76	2,807.49	
9000023062	Malcolm, Lauren	200	3,188.47	2,427.81	
9000023063	Marriner, Carmen M	200	1,065.06	663.98	
9000023064	McIntyre, Celeste	200	3,765.80	2,727.36	
9000023065	McLear IV, Robert	200	3,344.58	2,550.16	
9000023066	Meyer, Peter	200	4,880.08	2,607.19	
9000023067	Meyer, Phillip	200	2,398.39	1,791.90	
9000023068	Miller, Jaime	200	3,010.14	2,191.02	
9000023069	Nelson, Kelli	200	4,662.20	3,268.04	
9000023070	Norwood, Lindsay	200	3,572.09	2,649.13	
9000023071	Oros, Natalie	200	2,053.29	1,606.78	
9000023072	Park, Aimee	200	3,795.05	2,631.67	
9000023073	Pilon, Erica	200	4,295.50	3,081.10	
9000023074	Pivek, Elena	200	2,304.04	1,858.14	
9000023075	Ptak, Jeff R	200	2,043.04	1,388.14	
9000023076	Quick, Lyndsey Ann	200	790.22	520.47	
9000023077	Rankin, Chrysan	200	2,378.38	1,863.39	
9000023078	Ratzer, Bonnie	200	775.13	576.96	
9000023079	Reband, Jennifer	200	4,191.89	3,207.27	
9000023080	Rohlicek, Daniel	200	1,840.05	1,220.98	
9000023081	Sauer, Mary	200	3,270.29	2,496.49	
9000023082	Schindler, Dorene	200	814.55	591.93	
9000023083	Schmidt, Michael	200	5,258.83	3,725.61	
9000023084	Schraub, Daniel	200	3,728.63	2,379.93	
9000023085	Seastrom, Tamela	200	1,704.33	1,113.77	
9000023086	Sergeant, Andrew H	200	1,776.53	1,282.28	
9000023087	Slowiak, Vincent	200	3,233.13	2,071.32	
9000023088	Smid, Jason	200	3,567.57	2,556.60	
9000023089	Stevens, Patricia	200	4,627.07	3,333.73	
9000023090	Twaddle, Debra	200	917.43	505.42	
9000023091	Weissinger, Zachary T	200	1,643.43	1,204.96	

Payroll Run Check Listing for Board

Payroll		12/15/2020			Lisle CUSD 202
Check/ ACH	Employee	Check Location	Pay Gross	Net Amount	
9000023092	Wiertel, Jason	200	4,600.71	3,425.74	
9000023093	Altic, Megan	300	3,532.34	2,306.69	
9000023094	Angileri, Debra	300	1,294.71	1,162.38	
9000023095	Barber, Lorie	300	2,898.67	1,684.67	
9000023096	Bell, Courtney	300	878.00	571.65	
9000023097	Bonini, Susan	300	898.38	458.40	
9000023098	Briggs, Patricia L	300	2,094.56	1,139.70	
9000023099	Burdett, Paul	300	1,750.58	1,007.35	
9000023100	Campian, James, JR	300	2,340.25	1,631.68	
9000023101	Capristo, Linda	300	3,344.58	2,527.63	
9000023102	Carlson, Susan M	300	937.33	739.21	
9000023103	Chasensky, Lauren	300	3,271.08	2,397.39	
9000023104	Cheek, Maria M	300	187.43	173.09	
9000023105	Cracco, Catherine	300	216.58	189.29	
9000023106	Cyrus, Richard	300	4,756.79	3,444.21	
9000023107	Cyrus, Tonia	300	3,042.75	2,236.84	
9000023108	Dahleen, Shayla	300	2,824.33	2,014.13	
9000023109	Davis, Brianne	300	3,902.04	2,939.24	
9000023110	Davis, Courtney	300	1,858.13	1,356.21	
9000023111	Dawson, Rachel	300	3,344.58	2,420.39	
9000023112	Diaz, Madeline	300	1,322.06	1,148.12	
9000023113	Dineen-Hendricks, Kathleen	300	3,991.54	3,310.22	
9000023114	Donahue, Renee	300	916.78	679.84	
9000023115	DuBois, Heidi	300	2,824.33	2,069.57	
9000023116	Emde, John C, II	300	2,113.99	1,531.89	
9000023117	Gomez, Benigno	300	2,522.05	1,752.37	
9000023118	Gosselink, Wesley	300	6,312.42	4,508.82	
9000023119	Graff, Patrick	300	2,688.68	2,086.71	
9000023120	Grau, Jason	300	3,158.79	2,414.09	
9000023121	Green, Patricia	300	1,971.12	1,621.57	
9000023122	Grimm, Rhonda	300	942.10	701.66	
9000023123	Han, Jieun	300	2,675.67	2,068.10	

Payroll Run Check Listing for Board

Payroll	12/15/2020	Lisle CUSD 202		
Check/ ACH	Employee	Check Location	Pay Gross	Net Amount
9000023124	Hausler, Linda	300	3,233.13	2,197.16
9000023125	Heneghan, Dipti	300	766.80	589.69
9000023126	Herrmann, Mary Jo	300	797.02	498.44
9000023127	Hicks, Dena	300	4,089.81	2,769.59
9000023128	Hutchison, Sarah	300	732.86	623.55
9000023129	James, Lauren	300	2,378.38	1,638.75
9000023130	Johnson, Diane	300	4,478.42	1,968.82
9000023131	Jung, Diane	300	933.23	484.69
9000023132	Kerback, Patricia M	300	541.08	447.51
9000023133	Kimmerly, Suzanne	300	2,789.94	1,978.46
9000023134	Klepadlo, Scott E.	300	2,889.39	2,030.71
9000023135	Klimes, Christy	300	4,248.75	2,961.90
9000023136	Kolacz, Jolanta	300	935.42	492.11
9000023137	Koven, Kelly A.	300	1,971.12	1,579.53
9000023138	Lambert, Stephanie	300	1,582.03	1,154.70
9000023139	Lantz, Janet L	300	216.58	194.08
9000023140	Lapham, Kathleen	300	3,716.21	2,903.11
9000023141	Larson, Richard W	300	1,897.53	1,396.03
9000023142	Lauten, Theresa	300	3,894.60	2,217.21
9000023143	Leonard, Arlene	300	4,483.46	3,443.51
9000023144	Lieder, Jami	300	1,078.96	930.62
9000023145	Livolsi-Hudgens, Carmella	300	764.46	587.56
9000023146	Lorkiewicz, Candace	300	884.88	514.04
9000023147	Madonia, Lindsey	300	3,188.47	2,602.68
9000023148	Magness, Adrienne	300	2,750.00	2,079.23
9000023149	Malave-Flavin, Kimberly	300	3,047.29	2,538.60
9000023150	Marino, Jillian	300	1,835.55	1,279.32
9000023151	Martin, Stacey	300	2,898.67	2,033.34
9000023152	Masa, Janelle	300	868.40	507.61
9000023153	McCormick, Meredith	300	4,010.58	3,135.73
9000023154	Miller, Anna	300	2,220.46	1,579.81
9000023155	Murphy, Caitlyn J.	300	2,378.38	1,740.80

Payroll Run Check Listing for Board

Payroll	12/15/2020			Lisle CUSD 202
Check/ ACH	Employee	Check Location	Pay Gross	Net Amount
9000023156	Murphy, Trisha	300	3,716.22	2,758.99
9000023157	Navarro, Michael	300	1,049.20	710.56
9000023158	Nelson, Nicole	300	4,478.42	3,528.37
9000023159	Neustadt, Leslie	300	3,796.80	2,744.48
9000023160	Nielsen, Joan	300	884.88	670.81
9000023161	Noreen, Diane C	300	1,062.30	231.14
9000023162	O'Connor-Young, Sheri	300	720.58	555.27
9000023163	Ortiz, Carmen	300	1,784.86	1,207.06
9000023164	O'Shea, Amy	300	3,418.92	2,233.69
9000023165	Parker, Elizabeth	300	3,976.38	2,854.69
9000023166	Paulson, Kristine	300	3,114.18	1,964.47
9000023167	Pavilionis, Vincent	300	2,824.33	1,951.11
9000023168	Payne, Melissa	300	5,864.13	4,335.17
9000023169	Peterson, Marybeth	300	3,418.92	1,941.93
9000023170	Polmanteer, Colette	300	3,155.03	2,032.76
9000023171	Poremba, Katherine	300	3,567.58	2,347.16
9000023172	Potempa, Tracey	300	3,270.29	2,482.09
9000023173	Preen, Judith	300	877.03	674.42
9000023174	Pridmore, Elizabeth	300	3,158.79	1,828.98
9000023175	Puetz, Lauren	300	2,816.89	1,827.49
9000023176	Pupillo, Lauren	300	2,971.86	2,066.16
9000023177	Rasner, Kimberly	300	2,066.98	1,242.04
9000023178	Remigio, Maria	300	4,290.42	3,063.88
9000023179	Renko, Alexandra	300	1,322.06	1,153.87
9000023180	Reyes, Cathy M	300	880.39	512.90
9000023181	Schlessinger, Lukas	300	2,861.50	1,797.65
9000023182	Schroeder, Sara	300	2,824.33	2,171.74
9000023183	Schwarz, Jeanene	300	819.07	90.05
9000023184	Shehee, Wendy	300	884.88	515.79
9000023185	Skonieczny, Sandra	300	723.15	367.05
9000023186	Slade, Stephanie	300	2,601.33	1,988.65
9000023187	Smith, Brittany	300	2,222.47	1,731.17

Payroll Run Check Listing for Board

Payroll	12/15/2020				Lisle CUSD 202
Check/ ACH	Employee	Check Location	Pay Gross	Net Amount	
9000023188	Smith, Elisa	300	4,019.08	2,847.47	
9000023189	Sproviero, Rochelle	300	843.82	610.24	
9000023190	Staley, Shannon	300	3,374.31	2,478.71	
9000023191	Stefani, Colleen	300	4,430.47	3,119.09	
9000023192	Svejda, Michele	300	776.25	455.65	
9000023193	Tarkowski, Emma	300	2,601.33	2,119.85	
9000023194	Toby, Maureen	300	3,084.46	2,225.66	
9000023195	Trotter, Suzanne	300	2,037.96	1,605.00	
9000023196	Tuzzolino, Victoria	300	3,010.13	2,218.67	
9000023197	Uster, Julia	300	926.74	482.31	
9000023198	Weeks, Stacey	300	615.92	495.49	
9000023199	Weissinger, Karla	300	835.38	505.82	
9000023200	Wojcik, Jane	300	1,297.23	1,185.59	
9000023201	Yaniz, Catherine	300	3,121.58	2,325.55	
9000023202	Zitt, Jean	300	4,019.08	2,916.42	
9000023203	Schmidtke, Carol	800	246.40	230.63	
9000023204	Aske, Jacob	800	2,281.12	1,836.37	
9000023205	Benson, Mary Diane	800	216.58	183.47	
9000023206	Bester, Briana	800	668.93	565.26	
9000023207	Breeden, Anne	800	1,120.00	953.69	
9000023208	Crenshaw, Samuel, JR	800	780.41	682.07	
9000023209	Drake, Alissa	300	632.61	308.60	
9000023210	Glow, Jessica	800	880.00	710.71	
9000023211	Holub, Lauren	800	220.00	180.60	
9000023212	Holub, Nicole	800	222.98	194.89	
9000023213	Krestan, Kimberly S	800	208.25	186.81	
9000023214	Martinez, Brian	100	1,536.17	1,122.60	
9000023215	Parpet, Paul	800	36.00	26.50	
9000023216	Rieser, Irina	800	361.35	315.82	
9000023217	Stewart, Shikila	800	149.94	135.84	
9000023218	Weeks, Dawn	800	1,971.12	1,511.04	
			759,875.55	533,682.92	

Payroll Run Check Listing for Board

Payroll	12/31/2020			Lisle CUSD 202
Check/ ACH	Employee	Check Location	Pay Gross	Net Amount
114955	Balaban, Nicholas	800	1,226.36	1,132.55
114956	Wei, Joanna	800	334.46	292.31
114957	Young, Karen	800	110.00	102.95
9000023219	Buchholz, Marilyn	000	2,044.50	1,260.93
9000023220	Engler, Jennifer R	000	2,511.75	1,626.79
9000023221	Filipiak, Keith	000	8,838.58	5,880.79
9000023222	Hinton, Jeffery	000	2,467.32	1,331.02
9000023223	Kempfer-Kotalik, Linda	000	7,044.29	3,368.52
9000023224	Law, Jennifer S	000	6,381.96	4,256.19
9000023225	McCormick, Jennifer	000	1,925.31	975.62
9000023226	Navarro, Lawrence M	000	1,927.36	1,310.87
9000023227	Posego, John C	000	5,167.80	3,186.64
9000023228	Quinlan, Kevin	000	2,349.00	1,503.77
9000023229	Rannochio, Alisa	000	1,770.45	1,274.33
9000023230	Rich, Mary Beth	000	2,867.48	2,039.71
9000023231	Tsamis, Anna	000	3,365.19	1,947.60
9000023232	Van Volkenburg, Nancy L	000	2,808.36	1,948.08
9000023233	Wilkinson, David	000	6,056.54	4,281.23
9000023234	Anderson, Erik D	100	3,270.29	2,644.85
9000023235	Anderson, Herbert	100	4,203.25	2,819.39
9000023236	Bamboot, Darius	100	3,456.08	2,522.90
9000023237	Begley, Elizabeth	100	1,014.71	431.90
9000023238	Biezynski, Jenna A	100	826.35	534.76
9000023239	Brady, Jennifer L	100	3,047.29	2,308.23
9000023240	Bylsma, Nathan	100	5,054.06	3,657.04
9000023241	Bylsma, Svea	100	4,480.94	3,085.15
9000023242	Chandhok, Mona A	100	2,750.00	2,206.41
9000023243	Clarke, Jeannette	100	3,270.29	2,449.16
9000023244	Costello, Sheri	100	4,575.33	3,430.51
9000023245	Czyl, Maureen	100	1,014.71	599.81
9000023246	Davis, John	100	4,363.58	3,345.84
9000023247	Ferenzi, Daniella	100	1,492.69	1,172.05

Payroll Run Check Listing for Board

Payroll	12/31/2020	Lisle CUSD 202		
Check/ ACH	Employee	Check Location	Pay Gross	Net Amount
9000023248	Fitzgerald, Karen	100	1,843.15	417.04
9000023249	Gansberg, Michele	100	1,015.91	667.38
9000023250	Gomez, Vasilici	100	2,898.67	2,261.92
9000023251	Gucciardo, Anjanette	100	3,949.04	3,127.61
9000023252	Gumina, Scott	100	4,994.17	3,292.43
9000023253	Hamann, Kelly	100	3,270.29	2,515.45
9000023254	Hamilton, Mary Pat	100	805.76	517.11
9000023255	Hardy, Venessa	100	4,234.57	2,624.39
9000023256	Henrichs, Greg	100	3,493.21	2,534.26
9000023257	Hochstetter, Judith	100	1,294.33	895.36
9000023258	Holmes, Steven	100	1,693.89	1,216.37
9000023259	Honzel, Robin	100	4,478.42	3,247.89
9000023260	Howard, Jeffrey	100	7,042.13	4,907.32
9000023261	Irvine, Karin	100	4,013.50	3,174.79
9000023262	Jaegle, Christine A	100	3,404.07	2,728.57
9000023263	Jaegle, Ronald	100	5,053.76	3,524.60
9000023264	Javior, Jeffrey	100	4,133.96	2,629.98
9000023265	Jenkins, David A	100	1,727.82	1,219.19
9000023266	Jensen, Christine	100	3,522.97	2,885.62
9000023267	Kehoe, Debra	100	4,478.42	3,166.73
9000023268	Kerrn, Erin	100	3,023.46	2,126.90
9000023269	Klempic, Mirza	100	2,002.18	1,439.84
9000023270	Koeppen, Kelly	100	1,457.19	1,242.92
9000023271	Kohorn, Paul	100	1,532.03	1,079.93
9000023272	Kucera, Sasha	100	941.25	598.60
9000023273	Kuefner, Julie	100	3,753.38	2,566.44
9000023274	LaScala, Mark	100	5,475.11	4,024.10
9000023275	Love, Sherry	100	834.75	670.62
9000023276	Maldre, Sarah	100	3,431.06	2,159.87
9000023277	Marcum, Thomas C	100	4,590.92	3,697.72
9000023278	Martinez, Brian	100	1,536.17	1,122.60
9000023279	Martinez-Alvear, Aldo	100	1,627.77	1,149.02

Payroll Run Check Listing for Board

Payroll	12/31/2020			Lisle CUSD 202
Check/ ACH	Employee	Check Location	Pay Gross	Net Amount
9000023280	Matariyeh, Yousef	100	4,788.59	3,402.31
9000023281	Meyer, Kendra	100	4,248.75	3,104.95
9000023282	Milinki, Jennifer	100	4,024.32	2,804.49
9000023283	Mlynarski, Tim	100	809.55	495.81
9000023284	Multhaupt, Courtney	100	4,640.41	3,493.96
9000023285	Musbach, Darlene	100	4,133.96	2,442.67
9000023286	Nadolny, Mary	100	653.22	366.34
9000023287	Ng, Joanna	100	3,233.13	2,087.42
9000023288	Novak, Emily	100	3,808.86	2,371.71
9000023289	Ogan, Elizabeth	100	4,478.42	3,416.25
9000023290	O'Hara, James	100	3,684.38	2,862.21
9000023291	Perez, Kevin E	100	3,233.13	2,409.31
9000023292	Perretta, Mia	100	4,080.43	3,066.12
9000023293	Polinski, Michael	100	2,898.67	2,388.70
9000023294	Pomatto-Zimmerman, Jennifer	100	4,576.08	3,674.01
9000023295	Provenzano, Lisa	100	1,052.13	835.86
9000023296	Renguso, Amy	100	3,308.27	2,342.01
9000023297	Ridges, Daniel	100	1,255.35	891.01
9000023298	Sanko, April	100	4,133.96	2,895.53
9000023299	Sanko, Daniel	100	4,248.75	2,804.34
9000023300	Schalk, Trent J	100	3,205.97	1,935.55
9000023301	Schwartz, Rebecca	100	4,582.72	3,273.66
9000023302	Smith, Justin	100	3,827.71	2,938.33
9000023303	Steben, James	100	5,258.83	3,992.49
9000023304	Stelk, Scott	100	1,627.77	943.33
9000023305	Stellmacher, James M	100	4,440.30	3,290.83
9000023306	Thome, Nicholas	100	1,627.77	961.20
9000023307	Thurnall, Katelyn	100	1,312.33	1,146.04
9000023308	Todd, Adam	100	1,599.06	1,154.73
9000023309	Waibel, Scott	100	3,649.34	2,569.29
9000023310	Wallenberg, Michelle	100	3,450.29	2,517.02
9000023311	Weissinger, Derek C	100	1,951.32	1,270.02

Payroll Run Check Listing for Board

Payroll		12/31/2020			Lisle CUSD 202
Check/ ACH	Employee	Check Location	Pay Gross	Net Amount	
9000023312	Wolak, Brandon P	100	834.75	568.74	
9000023313	Woyna, Eric	100	4,162.16	2,934.26	
9000023314	Woyna, Patrick	100	3,278.79	2,065.86	
9000023315	Zita, Blair	100	1,303.82	1,204.62	
9000023316	Alexander, Jarvis	200	705.79	503.95	
9000023317	Blatchley, Monica	200	4,195.90	3,231.73	
9000023318	Bossenga, Emmy	200	4,396.38	2,663.12	
9000023319	Braun, Katherine	200	2,619.95	1,834.44	
9000023320	Broadus, Gretchen	200	3,485.80	2,819.08	
9000023321	Burdeaux, Jessica	200	759.53	536.77	
9000023322	Burris, Karen M	200	1,318.69	670.26	
9000023323	Byrne, Sharon	200	3,248.29	2,654.38	
9000023324	Cerny, Marie	200	2,675.67	2,194.05	
9000023325	Cervený, Karen	200	3,233.13	2,288.52	
9000023326	Chiappetta, Rebecca	200	1,464.95	1,227.19	
9000023327	Cornfield, Betty	200	5,032.20	2,233.72	
9000023328	De Nichols, Patricia	200	4,266.18	2,355.18	
9000023329	Dembowski, Kasie	200	1,598.24	1,202.04	
9000023330	Dooley, Tara	200	1,229.06	808.79	
9000023331	Dybeck, David	200	3,716.21	2,167.88	
9000023332	Erickson, Tor	200	4,029.96	3,025.71	
9000023333	Fitzner, Kenneth	800	5,563.65	3,843.00	
9000023334	Hanson, Janet	200	4,478.42	1,755.57	
9000023335	Harris, Thomas	200	1,285.59	1,079.14	
9000023336	Hazard, Jean	200	925.46	607.39	
9000023337	Henning, Mary	200	840.94	679.77	
9000023338	Huschart, Kelly	200	3,146.42	2,423.22	
9000023339	Joy, Emma P	200	1,884.70	1,120.06	
9000023340	Kearney, David	200	5,761.79	4,176.95	
9000023341	Keigher, Natalie	200	3,906.54	2,765.45	
9000023342	Kim, Paul	200	3,827.71	2,584.99	
9000023343	Klepper, Mary	200	2,898.67	2,160.17	

Payroll Run Check Listing for Board

Payroll	12/31/2020			Lisle CUSD 202
Check/ ACH	Employee	Check Location	Pay Gross	Net Amount
9000023344	Lemke, Nanette	200	886.46	591.97
9000023345	Lima, Valerie	200	991.44	645.38
9000023346	Lumsden, Jason	200	4,125.76	2,807.49
9000023347	Malcolm, Lauren	200	3,188.47	2,427.81
9000023348	Marriner, Carmen M	200	1,065.06	663.98
9000023349	McIntyre, Celeste	200	3,765.80	2,727.36
9000023350	McLear IV, Robert	200	3,344.58	2,550.16
9000023351	Meyer, Peter	200	4,880.08	2,607.19
9000023352	Meyer, Phillip	200	2,398.39	1,791.90
9000023353	Miller, Jaime	200	3,010.14	2,191.02
9000023354	Nelson, Kelli	200	4,662.20	3,268.04
9000023355	Norwood, Lindsay	200	3,572.09	2,649.13
9000023356	Oros, Natalie	200	2,053.29	1,606.78
9000023357	Park, Aimee	200	3,795.05	2,631.67
9000023358	Pascale, Dominic	200	1,251.92	1,091.67
9000023359	Pilon, Erica	200	4,295.50	3,081.10
9000023360	Pivek, Elena	200	2,404.04	1,941.55
9000023361	Ptak, Jeff R	200	2,043.04	1,388.14
9000023362	Quick, Lyndsey Ann	200	805.49	533.16
9000023363	Rankin, Chrysan	200	2,378.38	1,863.39
9000023364	Ratzer, Bonnie	200	858.61	638.37
9000023365	Reband, Jennifer	200	4,191.89	3,207.27
9000023366	Rohlicek, Daniel	200	1,840.05	1,220.98
9000023367	Sauer, Mary	200	3,270.29	2,496.49
9000023368	Schindler, Dorene	200	830.29	603.51
9000023369	Schmidt, Michael	200	5,258.83	3,725.61
9000023370	Schraub, Daniel	200	3,728.63	2,379.93
9000023371	Seastrom, Tamela	200	1,704.33	1,113.77
9000023372	Sergeant, Andrew H	200	1,776.53	1,282.28
9000023373	Slowiak, Vincent	200	3,233.13	2,071.32
9000023374	Smid, Jason	200	3,567.57	2,556.60
9000023375	Stevens, Patricia	200	4,627.07	3,333.73

Payroll Run Check Listing for Board

Payroll	12/31/2020	Lisle CUSD 202		
Check/ ACH	Employee	Check Location	Pay Gross	Net Amount
9000023376	Twaddle, Debra	200	917.43	505.42
9000023377	Weissinger, Zachary T	200	1,643.43	1,204.96
9000023378	Wiertel, Jason	200	4,600.71	3,425.74
9000023379	Altic, Megan	300	3,532.34	2,306.69
9000023380	Angileri, Debra	300	1,294.71	1,162.38
9000023381	Barber, Lorie	300	2,898.67	1,684.67
9000023382	Bell, Courtney	300	859.23	558.20
9000023383	Bonini, Susan	300	898.38	458.40
9000023384	Briggs, Patricia L	300	2,094.56	1,139.70
9000023385	Burdett, Paul	300	1,750.58	1,007.35
9000023386	Campion, James, JR	300	2,340.25	1,631.68
9000023387	Capristo, Linda	300	3,344.58	2,527.63
9000023388	Carlson, Susan M	300	902.98	713.94
9000023389	Chasensky, Lauren	300	3,271.08	2,397.39
9000023390	Cyrus, Richard	300	4,756.79	3,444.21
9000023391	Cyrus, Tonia	300	3,042.75	2,236.84
9000023392	Dahleen, Shayla	300	2,824.33	2,014.13
9000023393	Davis, Brianne	300	3,902.04	2,939.24
9000023394	Davis, Courtney	300	1,858.13	1,356.21
9000023395	Dawson, Rachel	300	3,344.58	2,274.29
9000023396	Diaz, Madeline	300	1,322.06	1,148.12
9000023397	Dineen-Hendricks, Kathleen	300	3,991.54	3,310.22
9000023398	Donahue, Renee	300	916.78	679.84
9000023399	Drake, Alissa	300	617.34	297.76
9000023400	DuBois, Heidi	300	2,824.33	2,069.57
9000023401	Emde, John C, II	300	2,040.01	1,478.87
9000023402	Gomez, Benigno	300	2,129.49	1,471.05
9000023403	Gosselink, Wesley	300	6,312.42	4,508.82
9000023404	Graff, Patrick	300	2,688.68	2,086.71
9000023405	Grau, Jason	300	3,158.79	2,414.09
9000023406	Green, Patricia	300	2,710.29	2,150.82
9000023407	Grimm, Rhonda	300	897.93	669.16

Payroll Run Check Listing for Board

Payroll	12/31/2020	Lisle CUSD 202		
Check/ ACH	Employee	Check Location	Pay Gross	Net Amount
9000023408	Han, Jieun	300	2,675.67	2,068.10
9000023409	Hausler, Linda	300	3,233.13	2,197.16
9000023410	Heneghan, Dipti	300	830.70	638.90
9000023411	Herrmann, Mary Jo	300	797.02	498.44
9000023412	Hicks, Dena	300	4,089.81	2,769.59
9000023413	Hutchison, Sarah	300	732.86	623.55
9000023414	James, Lauren	300	2,378.38	1,638.75
9000023415	Johnson, Diane	300	4,478.42	1,968.82
9000023416	Jung, Diane	300	884.88	450.70
9000023417	Kerback, Patricia M	300	541.08	447.51
9000023418	Kimmerly, Suzanne	300	2,789.94	1,978.46
9000023419	Klepadlo, Scott E.	300	2,889.39	2,030.71
9000023420	Klimes, Christy	300	4,248.75	2,961.90
9000023421	Kolacz, Jolanta	300	1,008.03	538.26
9000023422	Koven, Kelly A.	300	2,710.29	2,121.56
9000023423	Lambert, Stephanie	300	1,270.81	896.02
9000023424	Lapham, Kathleen	300	3,716.21	2,903.11
9000023425	Larson, Richard W	300	1,804.87	1,328.11
9000023426	Lauten, Theresa	300	3,894.60	2,217.21
9000023427	Leonard, Arlene	300	4,483.46	3,443.51
9000023428	Lieder, Jami	300	1,078.96	930.62
9000023429	Livolsi-Hudgens, Carmella	300	748.02	575.47
9000023430	Lorkiewicz, Candace	300	884.88	514.04
9000023431	Madonia, Lindsey	300	3,188.47	2,602.68
9000023432	Magness, Adrienne	300	2,750.00	2,079.23
9000023433	Malave-Flavin, Kimberly	300	3,047.29	2,538.60
9000023434	Marino, Jillian	300	1,835.55	1,279.32
9000023435	Martin, Stacey	300	2,898.67	2,033.34
9000023436	Masa, Janelle	300	742.40	414.90
9000023437	McCormick, Meredith	300	4,010.58	3,135.73
9000023438	Miller, Anna	300	2,220.46	1,579.81
9000023439	Murphy, Caitlyn J.	300	2,378.38	1,740.80

Payroll Run Check Listing for Board

Payroll	12/31/2020			Lisle CUSD 202
Check/ ACH	Employee	Check Location	Pay Gross	Net Amount
9000023440	Murphy, Trisha	300	3,716.22	2,758.99
9000023441	Navarro, Michael	300	1,049.20	710.56
9000023442	Nelson, Nicole	300	4,478.42	3,528.37
9000023443	Neustadt, Leslie	300	3,796.80	2,744.48
9000023444	Nielsen, Joan	300	884.88	670.81
9000023445	Noreen, Diane C	300	1,062.30	231.14
9000023446	O'Connor-Young, Sheri	300	701.10	540.94
9000023447	Ortiz, Carmen	300	1,784.86	1,207.06
9000023448	O'Shea, Amy	300	3,418.92	2,233.69
9000023449	Parker, Elizabeth	300	3,976.38	2,854.69
9000023450	Paulson, Kristine	300	3,114.18	1,964.47
9000023451	Pavillonis, Vincent	300	2,824.33	1,951.11
9000023452	Payne, Melissa	300	5,864.13	4,335.17
9000023453	Peterson, Marybeth	300	3,418.92	1,941.93
9000023454	Polmanteer, Colette	300	3,155.03	2,032.76
9000023455	Poremba, Katherine	300	3,567.58	2,347.16
9000023456	Potempa, Tracey	300	3,270.29	2,482.09
9000023457	Preen, Judith	300	855.07	658.27
9000023458	Pridmore, Elizabeth	300	3,158.79	1,828.98
9000023459	Puetz, Lauren	300	2,816.89	1,827.49
9000023460	Pupillo, Lauren	300	2,971.86	2,066.16
9000023461	Rasner, Kimberly	300	2,066.98	1,242.04
9000023462	Remigio, Maria	300	4,290.42	3,063.88
9000023463	Renko, Alexandra	300	1,322.06	1,153.87
9000023464	Reyes, Cathy M	300	847.98	489.06
9000023465	Schlessinger, Lukas	300	2,861.50	1,797.65
9000023466	Schroeder, Sara	300	2,824.33	2,171.74
9000023467	Schwarz, Jeanene	300	819.07	90.05
9000023468	Shehee, Wendy	300	884.88	515.79
9000023469	Skonieczny, Sandra	300	723.15	367.05
9000023470	Slade, Stephanie	300	2,601.33	1,988.65
9000023471	Smith, Brittany	300	2,222.47	1,731.17

Payroll Run Check Listing for Board

Payroll	12/31/2020	Lisle CUSD 202		
Check/ ACH	Employee	Check Location	Pay Gross	Net Amount
9000023472	Smith, Elisa	300	4,019.08	2,843.84
9000023473	Sproviero, Rochelle	300	843.82	610.24
9000023474	Staley, Shannon	300	3,374.31	2,478.71
9000023475	Stefani, Colleen	300	4,430.47	3,119.09
9000023476	Svejda, Michele	300	776.25	455.65
9000023477	Tarkowski, Emma	300	2,601.33	2,119.85
9000023478	Toby, Maureen	300	3,084.46	2,225.66
9000023479	Trotter, Suzanne	300	2,710.29	2,011.36
9000023480	Tuzzolino, Victoria	300	3,010.13	2,218.67
9000023481	Uster, Julia	300	916.78	476.14
9000023482	Weeks, Stacey	300	615.92	495.49
9000023483	Weissinger, Karla	300	835.38	505.82
9000023484	Wojcik, Jane	300	1,297.23	1,185.59
9000023485	Yaniz, Catherine	300	3,121.58	2,325.55
9000023486	Zitt, Jean	300	4,019.08	2,916.42
9000023487	Schmidtke, Carol	800	492.80	461.26
9000023488	Aske, Jacob	800	1,240.00	1,082.08
9000023489	Bester, Briana	800	668.93	565.26
9000023490	Breeden, Anne	800	5,670.04	4,228.16
9000023491	Crenshaw, Samuel, JR	800	780.41	682.07
9000023492	Dimmick, Connor	800	550.00	461.26
9000023493	Glow, Jessica	800	1,480.00	1,152.04
9000023494	Holub, Lauren	800	840.00	641.23
9000023495	Holub, Nicole	800	222.98	194.89
9000023496	Parpet, Paul	800	144.00	105.98
9000023497	Rieser, Irina	800	135.45	118.39
9000023498	Weeks, Dawn	800	2,463.90	1,868.93
			771,897.21	542,078.63

LISLE COMMUNITY UNIT SCHOOL DISTRICT #202

VENDOR PAY ORDERS

This is to certify that the Board of Education of Lisle Community Unit School District No. 202 ratified the following vendor pay orders: January 21, 2021

GENERAL CHECKING ACCOUNT

CHECKS ISSUED	Beginning	114952	Ending	114954
	Beginning	114958	Ending	114961
	Beginning	114962	Ending	114990
	Beginning	114996	Ending	115122
WIRES ISSUED	Beginning	8000000531	Ending	8000000535
	Beginning	8000000536	Ending	8000000542
ACH DEPOSITS	Beginning	9000023783	Ending	9000023796

FUND DISTRIBUTION

EDUCATIONAL	\$	1,229,596.38
OPERATIONS & MAINTENANCE	\$	169,718.06
DEBT SERVICES	\$	-
TRANSPORTATION	\$	142,194.96
IMRF/SOCIAL SECURITY	\$	107,825.92
CAPITAL PROJECTS	\$	72,866.50
WORKING CASH	\$	-
	TOTAL	<u>\$ 1,722,201.82</u>

IMPREST CHECKING ACCOUNT

CHECKS ISSUED	Beginning	9733	Ending	9735
----------------------	-----------	------	--------	------

FUND DISTRIBUTION

EDUCATIONAL	\$	1,500.00
OPERATIONS & MAINTENANCE	\$	183.58
TRANSPORTATION	\$	-
CAPITAL PROJECTS	\$	-
	TOTAL	<u>\$ 1,683.58</u>

GRAND TOTAL \$ 1,723,885.40

President - Board of Education

Date

Secretary - Board of Education

Date

AP Check Register

Lisle CUSD 202

Accounts Payable Run: 12/15/2020 ZPAY 12/15/2020

R - Regular Run Type

Check Number	Name	Net Check Amt
114952	Classified Employee	706.77
114953	Lisle CUSD #202	2,095.19
114954	Lisle Education Association	8,579.97
8000000531	Harris Bank	113,036.54
8000000532	Illinois Department Of Revenue	32,709.69
8000000533	Teachers' Health Ins Security	14,582.34
8000000534	Teachers' Retirement System	64,675.34
8000000535	U.S. OMNI	38,312.71
Regular Checks:	3	11381.93
ACH Checks:	0	0.00
Wire Transfers:	5	263316.62
Total:	8	274,698.55

AP Check Register

Lisle CUSD 202

Fund Summary

Fund	Balance Sheet	Revenue	Expense	Total
10 - Educational	\$232,326.29	\$0.00	\$0.00	232,326.29
20 - Operations & Maintenance	\$5,886.43	\$0.00	\$0.00	5,886.43
40 - Transportation	(\$67.02)	\$0.00	\$0.00	-67.02
55 - Social Security	\$36,552.85	\$0.00	\$0.00	36,552.85

AP Check Register

Lisle CUSD 202

Accounts Payable Run: 12/31/2020 ZPAYEOM 12/31/2020

R - Regular Run Type

Check Number	Name	Net Check Amt
114958	Classified Employee	706.77
114959	Lisle CUSD #202	2,095.19
114960	Lisle Education Association	8,579.97
114961	VSP of Illinois, NFP	5,085.58
8000000536	Educational Benefit Coop	374,117.94
8000000537	Harris Bank	114,288.10
8000000538	Illinois Department Of Revenue	33,268.61
8000000539	Illinois Municipal Retirement	50,698.92
8000000540	Teachers' Health Ins Security	15,035.83
8000000541	Teachers' Retirement System	66,686.78
8000000542	U.S. OMNI	38,552.71
Regular Checks:	4	16467.51
ACH Checks:	0	0.00
Wire Transfers:	7	692648.89
Total:	11	709,116.40

AP Check Register

Lisle CUSD 202

Fund Summary

Fund	Balance Sheet	Revenue	Expense	Total
10 - Educational	\$603,802.51	\$0.00	\$0.00	603,802.51
20 - Operations & Maintenance	\$33,980.50	\$0.00	\$0.00	33,980.50
40 - Transportation	\$60.32	\$0.00	\$0.00	60.32
50 - Muncipal Retirement	\$35,193.07	\$0.00	\$0.00	35,193.07
55 - Social Security	\$36,080.00	\$0.00	\$0.00	36,080.00

AP Check Register

Lisle CUSD 202

Accounts Payable Run: 12/31/2020 December End of Month

R - Regular Run Type

Check Number	Name	Net Check Amt
114962	ADDitude	19.95
114963	Amazon.com Corporate Credit	3,903.07
114964	Aramark Services, Inc	37,533.69
114965	AT&T: Acct 198-2	177.03
114966	AT&T: Acct 680	657.28
114967	AT&T: Acct 927	1,682.80
114968	AT&T: Acct 988-5	186.74
114969	Candor Health Education	1,232.00
114970	Capital One Commercial	958.65
114971	Chicago Office Technology	1,855.12
114972	Crystal Lake Central High	50.00
114973	Custom Security Electronics Inc	1,068.00
114974	Gordon Flesch Co, Inc	919.53
114975	Hinckley Springs	31.99
114976	Home Depot Credit Services	702.99
114977	IHSBCA	100.00
114978	Illinois Science Olympiad	175.00
114979	Kipp's Lawnmower Sales and	178.18
114980	Kretman Masonry Inc	2,700.00
114981	Lisle Community Unit School	1,739.53
114982	Nextera Energy Services	21,069.64
114983	Otis Elevator Company	964.32
114984	River Bend Golf Club	3,400.00
114985	Staples Business Advantage	65.35
114986	T-Mobile for Government	1,472.07
114987	Vanguard Energy Services,	6,493.87
114988	Veritiv Operating Company	122.00
114989	Walmart Community	57.11

AP Check Register

Lisle CUSD 202

Accounts Payable Run: 12/31/2020 December End of Month

R - Regular Run Type

Check Number	Name		Net Check Amt
114990	Westway Coach, Inc		87,230.77
Regular Checks:	29	176746.68	
ACH Checks:	0	0.00	
Wire Transfers:	0	0.00	
Total:	29	176,746.68	

AP Check Register

Lisle CUSD 202

Fund Summary

Fund	Balance Sheet	Revenue	Expense	Total
10 - Educational	\$52,996.27	\$0.00	\$0.00	52,996.27
20 - Operations & Maintenance	\$36,519.64	\$0.00	\$0.00	36,519.64
40 - Transportation	\$87,230.77	\$0.00	\$0.00	87,230.77

AP Check Register

Lisle CUSD 202

Accounts Payable Run: 01/25/2021 January Board Bills

R - Regular Run Type

Check Number	Name	Net Check Amt
114996	1st AYD Corporation	685.05
114997	ABLE Academy	30,475.20
114998	Adrian, Sandra	38.00
114999	A-Formula Mechanical Corp.	4,976.92
115000	Albertsons / Safeway	42.96
115001	Allegra Marketing/Print/Mail	1,160.00
115002	Almendinger, Stacey	3,500.00
115003	Amita GlenOaks School	7,749.69
115004	Anderson Pest Solutions	416.45
115005	Apple Inc.	1,946.99
115006	Aramark Services, Inc	18,252.96
115007	AssetGenie, Inc	69.50
115008	Aurora Naper Transportation	8,080.00
115009	B & H Photo-Video	3,132.63
115010	Bilingual Therapies, Inc	770.00
115011	BMO Harris Bank NA	2,875.84
115012	BrainPOP LLC	460.00
115013	BrightStar Healthcare	4,254.26
115014	BSN Sports, LLC	1,648.00
115015	Buckeye Cleaning Centers	453.74
115016	Cambridge Educational	1,295.00
115017	Camelot Education - Naperville	2,748.76
115018	Chicago Office Technology	1,855.12
115019	Coffman Truck Sales Inc	63.50
115020	Com Ed	7,098.38
115021	Custom Security Electronics Inc	696.00
115022	Datamation Imaging Services	2,039.40
115023	Demco Inc	1,177.78
115024	Discovery Benefits	114.75
115025	Downers Grove School District	1,987.50
115026	Doyle Signs Inc	5,904.00

AP Check Register

Lisle CUSD 202

Accounts Payable Run: 01/25/2021 January Board Bills

R - Regular Run Type

Check Number	Name	Net Check Amt
115027	Dupage Regional Office of	1,650.00
115028	EBSCO Information Services	5,022.00
115029	ENECON Corporation	435.00
115030	ESI Chicago, Incorporated	320.00
115031	Everest Snow Management,	6,920.00
115032	Ferguson Enterprises LLC	1,107.90
115033	Fine Line Creative Arts Center	60.00
115034	Follett School Solutions, Inc	793.25
115035	Fox Valley Fire & Safety	809.50
115036	Franczek	442.50
115037	Frontline Technologies Group	2,267.69
115038	Full Compass Systems, Ltd	172.00
115039	G & G Lawncare Inc	2,435.00
115040	Gale/CENGAGE Learning	8,628.77
115041	Georgia CPR LLC	594.00
115042	Giant Steps Illinois, Inc	14,422.20
115043	Gopher Sport	803.38
115044	Gordon Flesch Co, Inc	381.96
115045	Green, Steven	2,515.71
115046	Harmon, Mary	2,500.00
115047	Heinemann	4,400.61
115048	Himes, Petrarca & Fester, Chtd	2,877.50
115049	Home Depot U.S.A., Inc	1,485.58
115050	Home Depot U.S.A., Inc (GA)	90.97
115051	Illinois American Water	1,432.22
115052	Illinois Bone and Joint Institute	6,125.00
115053	Illinois High School Association	200.00
115054	Illinois State Police	339.00
115055	Illinois Time Recorder Co	861.15
115056	Illinois Tollway	126.15
115057	Integrated Systems Corporation	4,800.00

AP Check Register

Lisle CUSD 202

Accounts Payable Run: 01/25/2021 January Board Bills

R - Regular Run Type

Check Number	Name	Net Check Amt
115058	International Translation	1,732.50
115059	Ivy Lane Corporation	107.92
115060	Johnson Controls Security	239.21
115061	Kuta Software LLC	262.00
115062	Law, Jennifer S	345.50
115063	Lewis Paper	55.80
115064	Linden Oaks Tutoring Services	282.10
115065	Lisle Automotive & Tire	121.88
115066	Little Friends, Inc.	2,884.00
115067	Lowe's Pro	78.10
115068	Marberry Cleaners & Laundry	2,659.00
115069	Mazzolini, Michael	38.00
115070	Midwest Principals' Center, Inc.	230.00
115071	MPGTandem	2,276.74
115072	NASCO	752.52
115073	National Restaurant Association	450.00
115074	NCS Pearson, Inc	60.00
115075	NEUCO Inc	2,363.24
115076	New Connections Academy	10,018.10
115077	Nextera Energy Services	21,884.27
115078	Nicor Gas	4,027.39
115079	Notable, Inc	2,880.00
115080	Parkland Preparatory Academy,	13,849.64
115081	Pascente, Sharon T	2,000.00
115082	Performance Chemical &	1,117.50
115083	Perkins + Will, Inc	1,818.30
115084	Pitsco	100.93
115085	Powerone Supply, Inc	427.57
115086	Progress Software Corporation	3,270.00
115087	Quinlan & Fabish Music	180.05
115088	Rannochio, Alisa	7.99

AP Check Register

Lisle CUSD 202

Accounts Payable Run: 01/25/2021 January Board Bills

R - Regular Run Type

Check Number	Name	Net Check Amt
115089	Really Good Stuff, LLC	457.94
115090	Reef Contractors LLC	71,725.00
115091	S.E.A.L. South, Inc	6,210.12
115092	Schalk, Nancy	3,500.00
115093	School Association For Special	73,571.56
115094	School Specialty, Inc	430.77
115095	ScreenCloud Inc	648.00
115096	SEAL of Illinois Inc	9,288.30
115097	Shaw Media	1,170.20
115098	Sherwin Williams	235.80
115099	SHI International Corp	1,530.36
115100	Shorewood Home & Auto, Inc.	33.90
115101	Soaring Eagle Academy, Inc	16,923.06
115102	Sta-Kleen, Inc	1,115.00
115103	Sunrise Southwest LLC	44,887.39
115104	Super Duper Publications	299.00
115105	Technology Center of DuPage	1,297.32
115106	Telcom Innovations Group	260.00
115107	Telesolutions Consultants LLC	900.00
115108	The Bookstore	1,208.68
115109	UPS Store in Lisle	66.29
115110	Vanguard Energy Services,	10,642.46
115111	Venard, Gail	2,500.00
115112	Vex Robotics, Inc.	3,723.87
115113	Village of Lisle	13,239.58
115114	Village of Lisle (Utilities)	77.83
115115	Village of Lisle (Utilities)	22.89
115116	Vivacity Tech PBC	3,625.00
115117	Volt Electric Inc	8,773.80
115118	Warehouse Direct	1,900.27
115119	Waste Management of Illinois,	801.68

AP Check Register

Lisle CUSD 202

Accounts Payable Run: 01/25/2021 January Board Bills

R - Regular Run Type

Check Number	Name	Net Check Amt
115120	Weller, Mary Jo	3,000.00
115121	Wheaton North High School	240.00
115122	Wolska, Agnieszka	35.60
9000023783	Cervený, Karen	60.37
9000023784	Fitzgerald, Karen	17.02
9000023785	Gosselink, Wesley	1,577.09
9000023786	Hardy, Venessa	202.74
9000023787	Jensen, Christine	99.90
9000023788	Johnson, Diane	513.86
9000023789	Law, Jennifer S	6,592.80
9000023790	Milinki, Jennifer	68.71
9000023791	Musbach, Darlene	80.91
9000023792	Navarro, Lawrence M	40.00
9000023793	O'Hara, James	50.45
9000023794	Pridmore, Elizabeth	285.00
9000023795	Schraub, Daniel	100.00
9000023796	Waibel, Scott	102.00
Regular Checks:	127	551849.34
ACH Checks:	14	9790.85
Wire Transfers:	0	0.00
Total:	141	561,640.19

AP Check Register

Lisle CUSD 202

Fund Summary

Fund	Balance Sheet	Revenue	Expense	Total
10 - Educational	\$340,471.31	\$0.00	\$0.00	340,471.31
20 - Operations & Maintenance	\$93,331.49	\$0.00	\$0.00	93,331.49
40 - Transportation	\$54,970.89	\$0.00	\$0.00	54,970.89
60 - Capital Projects	\$72,866.50	\$0.00	\$0.00	72,866.50

AP Check Register

Lisle CUSD 202

Accounts Payable Run: 12/04/2020 Imprest 12.4.20

R - Regular Run Type

Check Number	Name	Net Check Amt
9733	AT&T: Mobility	131.94
9734	T-Mobile for Government	1,500.00
Regular Checks:	2	1631.94
ACH Checks:	0	0.00
Wire Transfers:	0	0.00
Total:	2	1,631.94

Accounts Payable Run: 12/14/2020 Imprest 12.14.20

R - Regular Run Type

Check Number	Name	Net Check Amt
9735	AT&T: Acct 978-4	51.64
Regular Checks:	1	51.64
ACH Checks:	0	0.00
Wire Transfers:	0	0.00
Total:	1	51.64

AP Check Register

Lisle CUSD 202

Fund Summary

Fund	Balance Sheet	Revenue	Expense	Total
10 - Educational	\$1,500.00	\$0.00	\$0.00	1,500.00
20 - Operations & Maintenance	\$183.58	\$0.00	\$0.00	183.58

FOR ACTION

**Lisle Community Unit School District 202
Board Of Education Meeting
January 25, 2021**

SUBJECT: Acceptance of Administrative Retirement.

BACKGROUND: A retirement request has been received from an Administrator.

RECOMMENDATION: Acceptance of retirement request.

SUGGESTED MOTION: That the Board of Education accepts the retirement of:

Jeff Howard, Principal at Lisle Senior High School, requests to resign at the conclusion of the 2023-2024 school year (June 30, 2024).



January 5, 2021

Dr. Filipiak and Members of the Board of Education,

Please accept this letter as notification of my intent to retire at the conclusion of the 2023-24 school year. In accordance with the Administrative Compensation Contract, my final day as principal of Lisle High School will be June 30, 2024, which will conclude my 34th year in education and my 10th year in District 202.

During the remainder of my tenure, I continue to be committed to collaborating with the faculty, staff, and parents to provide exceptional opportunities for our students to enhance their growth and development. The opportunity to lead Lisle's ONEPRIDE has been one of the greatest privileges of my life.

I am grateful for all of the support the high school administrative team has received from students, parents, staff members, the district office and the school board. Lisle is a village dedicated to the success of its children, and I am proud to have been a part of that tradition.

A handwritten signature in black ink, appearing to read "J. Howard". The signature is fluid and cursive, with a large initial "J" and "H".

Jeffrey R. Howard
Principal - Lisle High School

For Action

**Lisle Community Unit School District 202
Board Of Education Meeting
January 25, 2021**

SUBJECT: Approval of Extra-Duty Employment.

BACKGROUND: The Administration is pleased to recommend the employment of the certified candidates as outlined by the Administrative recommendation included in your packet.

FINANCIAL IMPACT: These positions are budgeted for FY 21.

RECOMMENDATION: Acceptance of Recommendation.

SUGGESTED MOTION: That the Board of Education approves the Extra-Duty employment of:

James Steben, Varsity Volleyball Coach for Lisle Junior High School for the 2020-2021 school year. He is placed at a Step 13+, \$6,243.

Jennifer Pomatto-Zimmerman, Head Softball Coach at Lisle Senior High School for the 22020-2021 school year. She is placed at a Step 13+, \$

Name	School	Sport	Placement	Salary
Steben, James	LJHS	Volleyball 6-8	Step 13+	\$6,243
Pomatto-Zimmerman, Jenifer	LSHS	Softball 9-12	Step 13+	\$8,919

LISLE COMMUNITY UNIT SCHOOL DISTRICT NO. 202

RECOMMENDATION FOR NEW EMPLOYEE

CERTIFIED PERSONNEL

DATE: 12/16/2020 RECOMMENDED BY: Dave Kearney

POSITION A. TO BE FILLED: Lisle Junior High Varsity Girls Volleyball

POSITION B. TO BE FILLED: _____

Grant Program: _____ Yes _____ No

If "Yes" _____ Reading Improvement _____ Title I _____ Other (specify)

REPLACING: Mia Perreta NEW POSITION: _____

NAME OF RECOMMENDED INDIVIDUAL: Jim Steben

COLLEGE/MAJOR: _____

PRIOR EXPERIENCE: Jim has been a coach at Lisle High School in the volleyball program for more than 17 years.

START DATE: 01/21/2021 BOARD APPROVAL DATE: 01/25/2021

RECOMMENDED SALARY SCHEDULE PLACEMENT: Step 13 (\$6,243)

FULL TIME EQUIVALENCY: _____ CONTRACTED DAYS _____

BACKGROUND INFORMATION: Jim has been our boys' basketball coach for many years and has done a tremendous job balancing developing the necessary skills needed to continue at the high level and making it enjoyable for his student athletes. With his experience coaching volleyball at the high school level along with working with middle school students in basketball, I am confident he will be the perfect fit for our program

(Attach additional information if necessary)

LISLE COMMUNITY UNIT SCHOOL DISTRICT NO. 202

RECOMMENDATION FOR NEW EMPLOYEE

CERTIFIED PERSONNEL

DATE: 12/21/20 RECOMMENDED BY: Tom Marcum

POSITION A. TO BE FILLED: High School Softball Head Coach

POSITION B. TO BE FILLED: _____

Grant Program: Yes No

If "Yes" Reading Improvement Title I Other (specify)

REPLACING: Trent Schalk NEW POSITION: _____

NAME OF RECOMMENDED INDIVIDUAL: Jen Zimmerman

ADDRESS: On File in Central Office

COLLEGE/MAJOR: Benedictine University/Secondary Education

PRIOR EXPERIENCE: Collegiate experience; LHS: 7 years as an assistant (187-54 Record); 6 years as head coach (125 - 63 record).

START DATE: January 2021 BOARD APPROVAL DATE: January 25, 2021

RECOMMENDED SALARY SCHEDULE PLACEMENT: Level 5 - 13+ (\$8,919)

FULL TIME EQUIVALENCY: _____ CONTRACTED DAYS _____

BACKGROUND INFORMATION: I am pleased to recommend Ms. Zimmerman as Head Softball Coach at the High School. I believe that with her strong voice for female advocacy, passion, motivation, extensive playing/coaching experience, and willingness to devote time to her craft, she will grow the program on a district-wide level. Ms. Zimmerman's coaching resume at the High School is really next to none, making this hire all that more ideal.

(Attach additional information if necessary)

For Action

**Lisle Community Unit School District 202
Board Of Education Meeting
January 25, 2021**

SUBJECT: Approval of Certified Leave of Absence Request.

BACKGROUND: A certified staff member has submitted a request for FMLA.

RECOMMENDATION: The Administration recommends approval of the request.

SUGGESTED MOTION: That the Board of Education approves the Leave requests of:

Linda Capristo: Special Education Teacher at Lisle Elementary School is requesting 10 Unpaid days and 12 weeks of FMLA beginning approximately February 22, 2021.

Lauren James: Kindergarten Teacher at Lisle Elementary School is requesting Parental leave, upon completion of her FMLA, for the remainder of the 2020-2021 school year.

Natalie Keigher: Science Teacher at Lisle Junior High School is requesting the remaining 3 weeks of FMLA that she has remaining for this school year, to be used January 7, 2021 through February 5, 2021.

Mary Sauer: English Teacher at Lisle Junior High School is requesting 12 weeks of FMLA to begin on January 19. Ms. Sauer will return at the beginning of the 2021-2022 school year.

FOR ACTION

**Lisle Community Unit School District 202
Board Of Education Meeting
January 25, 2021**

SUBJECT: Acceptance of Certified Resignation.

BACKGROUND: A resignation has been received from a Certified Employee.

FINANCIAL IMPACT: This position has been included in the FY 21 budget and will be filled accordingly.

RECOMMENDATION: Acceptance of Resignation.

SUGGESTED MOTION: That the Board of Education accepts the resignation of:

Stephanie Lambert- School Nurse at Lisle Elementary School has submitted her resignation to be effective on January 2, 2021.

Stephanie Lambert
1037 Briarbrook Dr
Wheaton, IL 60189
Stephanielambert622@gmail.com

December 22, 2020

Dear Board of Education,

I'm writing to inform you that I am resigning from my position as School Nurse at Lisle Elementary School effective 12/22/2020. I would like to thank you for the opportunity to work for Lisle School District.

Sincerely,
Stephanie A. Lambert

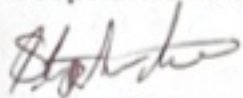

FOR ACTION

**Lisle Community Unit School District 202
Board Of Education Meeting
January 25, 2021**

SUBJECT: Approval of Classified Employment.

BACKGROUND: The Administration is pleased to recommend the employment of the Classified candidate as outlined by the Administrative recommendation included in your packet.

FINANCIAL IMPACT: These positions are budgeted for FY 2021.

RECOMMENDATION: Approval of employment.

SUGGESTED MOTION: That the Board of Education approve the employment of:

Julia Campos: Lunchroom/Playground Supervisor at Lisle Elementary School; \$16.66/hr.

Name	School	Placement	Salary
Campos, Julia	LES	-	\$ 16.66/hr.

LISLE COMMUNITY UNIT SCHOOL DISTRICT NO. 202

RECOMMENDATION FOR NEW EMPLOYEE

SUPPORT PERSONNEL

DATE: 1-11-21 RECOMMENDED BY: Kathy Dineen-Hendricks

POSITION A. TO BE FILLED: Lunchroom Supervisor (Lisle Elementary)

POSITION B. TO BE FILLED: _____

Grant Program: _____ Yes No

If "Yes" _____ Reading Improvement _____ Title I _____ Other (specify)

REPLACING: Shakila Stewart NEW POSITION: _____

NAME OF RECOMMENDED INDIVIDUAL: Julia Campos

ADDRESS: On file in Central Office

COLLEGE/MAJOR: Loyola University/Psychology

PRIOR EXPERIENCE: Naperville 203 – teaching assistant; SS. Peter & Paul – children's ministry volunteer.

START DATE: _____ BOARD APPROVAL DATE: 01-25-2021

RECOMMENDED SALARY SCHEDULE PLACEMENT: \$16.66/hour

FULL TIME EQUIVALENCY: _____ CONTRACTED DAYS _____

BACKGROUND INFORMATION: Ms. Campos comes to us with experience working in a junior high as a teaching assistant. While working as teaching assistant, she had experience supervising students in class and during lunch.

(Attach additional information if necessary)

FOR ACTION

**Lisle Community Unit School District 202
Board Of Education Meeting
January 25, 2021**

SUBJECT: Acceptance of Support Staff Resignation.

BACKGROUND: A resignation has been received from a Support Staff Employee

FINANCIAL IMPACT: This position has been included in the FY 21 budget and will be filled accordingly.

RECOMMENDATION: Acceptance of Resignation.

SUGGESTED MOTION: That the Board of Education accepts the resignation of:

Shakila Stewart, Lunchroom/Playground Supervisor at Lisle Elementary School, is resigning effective January 12, 2021.

RECEIVED

JAN 12 2021

By



Kathy,

I'm sorry but unfortunately
January 8th will be my last
day. my evening job ended
my assignment and I hope
I test well with the bus
training but I having trouble
some with the skills test.
So right now I have to
get a fulltime job..... I
really enjoyed working with
you guys and the kids
are great! I will
miss you guys and thank
you so much for the
opportunity!

sincerely,



FOR ACTION

**Lisle Community Unit School District 202
Board Of Education Meeting
January 25, 2021**

SUBJECT: Acceptance of Classified Retirement.

BACKGROUND: A retirement request has been received from a Classified Employee .

RECOMMENDATION: Acceptance of retirement request.

SUGGESTED MOTION: That the Board of Education accepts the resignation of:

Elizabeth Begley, Paraprofessional at Lisle Senior High School, has requested to retire on December 23, 2021.

January 12, 2021

Lisle Board of Education

Dr. Keith Filipiak, Superintendent

Dear Board of Education and Dr. Filipiak,

I would like to submit my formal intent to retire from my Paraprofessional position at Lisle CUSD 202 on December 23, 2021.

I have worked here for many wonderful years and am thankful for having this opportunity. I have worked with many great people and have had amazing experiences throughout my entire Lisle 202 career.

Thank you for the opportunity to have worked for Lisle CUSD 202.

Sincerely,



Elizabeth Begley

Paraprofessional

RECEIVED

JAN 20 2021

By 

FOR ACTION

**Lisle Community Unit School District 202
Board Of Education Meeting
January 25, 2021**

SUBJECT: Acceptance of Non-Bargaining Unit Retirement.

BACKGROUND: A retirement request has been received from a Non-Bargaining Unit Employee .

RECOMMENDATION: Acceptance of retirement request.

SUGGESTED MOTION: That the Board of Education accepts the resignation of:

John Posego, Coordinator of Buildings and Grounds, has requested to retire on August 3, 2023.

January 4, 2021

Lisle Board of Education

Dr. Keith Filipiak, Superintendent

Dear Board of Education and Dr. Filipiak,

I would like to submit my formal intent to retire from my Coordinator of Buildings and Grounds position at Lisle CUSD 202 on August 1, 2023.

I have worked here for many wonderful years and am thankful for having this opportunity. I have worked with many great people and have had amazing experiences throughout my entire Lisle 202 career.

Thank you for the opportunity to have worked for Lisle CUSD 202.

Sincerely,



John Posego

Coordinator of Buildings and Grounds

FOR ACTION

**Lisle Community Unit School District No. 202
Board of Education Meeting
January 25, 2021**

SUBJECT: Designation of Persons to Prepare Tentative Budget for FY2022

BACKGROUND DATA: The School Code of Illinois requires that the Board of Education designates “some person or persons” to prepare the budget in tentative form. The attached resolution designates the Superintendent and Director of Finance to prepare the Tentative Budget for FY2022.

In addition, the proposed FY2022 Budget Calendar is attached for reference.

FINANCIAL IMPACT: N/A

RECOMMENDATION: The Administration recommends that the Board designate the Superintendent and Director of Finance to prepare the FY2022 Tentative Budget.

SUGGESTED MOTION: That the Board of Education approve the resolution designating the Superintendent and Director of Finance to prepare the Tentative Budget for FY2022.

Lisle Community Unit School District 202

RESOLUTION FOR DESIGNATION OF A PERSON OR PERSONS TO PREPARE TENTATIVE BUDGET FOR THE FISCAL YEAR 2022

BE IT RESOLVED, by the school board of School District Number 202 in the County of DuPage, State of Illinois, that the Superintendent and Director of Finance are hereby appointed to prepare a tentative budget for said School District for the fiscal year beginning July 1, 2021, and ending June 30, 2022, which tentative budget shall be filed with the Secretary of this Board.

Lisle Community Unit School District No. 202

FY2022 BUDGET CALENDAR

November 23, 2020	Board approves 2020 Tentative Real Estate Tax Levy
December 14, 2020	Board approves 2020 Real Estate Tax Levy
January 25, 2021	Board designates the Superintendent and Director of Finance to prepare the Tentative Budget for FY2022
March 22, 2021	Superintendent makes staffing recommendations to the Board and the Board acts on reduction of staff, if necessary
April 1, 2021	Budget manuals are distributed to administrators
May 14, 2021	Administrators submit recommended budgets to the Business Office
June 28, 2021	Finance Committee and Board review the first draft of FY2022 Tentative Budget and authorize its placement on public display
August 23, 2021	Finance Committee and Board review updates to the FY2022 Tentative Budget
September 27, 2021	Finance Committee reviews and the Board adopts the FY2022 Budget

FOR ACTION

**Lisle Community Unit School District 202
Board of Education Meeting
January 25, 2021**

SUBJECT: Authorization to Release Closed Session Minutes for Public Inspection and Destruction of Audio Recordings

BACKGROUND DATA: Semi-annually the Board of Education is required to review the minutes of Closed Session meetings and approve their public availability. Minutes of meetings closed to the public shall be available only after the Board determines that it is no longer necessary to protect the public interest or the privacy of an individual by keeping them confidential.

FINANCIAL IMPACT: N/A

RECOMMENDATION: The Administration recommends:

- 1) The Closed Session minutes from September 28, 2020 and October 26, 2020 be released
- 2) The Closed Session minutes from June 15, 2020 and November 23, 2020 not be released due to the confidential nature of the topics and the need to protect the public interest or the privacy of an individual.
- 3) The destruction of audio recordings of Closed Session meetings more than 18 months old, unless the recordings are otherwise required by law to be preserved.

SUGGESTED MOTION: That the Board of Education release of Closed Session minutes from September 28, 2020 and October 26, 2020 and destroy audio recordings of Closed Session meetings more than 18 months old, unless the recordings are otherwise required by law to be preserved.

FOR ACTION

**Lisle Community Unit School District 202
Board of Education Meeting
January 25, 2021**

SUBJECT: Architect Professional Services Proposal – 2022 Summer Work

BACKGROUND: Attached is a proposal from the District’s architect, Perkins+Will, for architectural services for the proposed 2022 Summer Work at Lisle Senior High School. The project scope includes full replacement of the roof membrane and insulation in the areas designated on Attachment A of the proposal. For the most part, the projects in the proposal align with the Senior High work outlined in the Facility Needs Plan presented to the Board in October 2020. The only exception is that replacement of the roof over the south gym and receiving area has been moved forward two years to take advantage of economies of scale in performing the work.

The scope of services laid out in the proposal involves planning, design, management and coordination of the projects. The Architects will proceed with design and developing the construction documents and bid packages upon the Board’s approval of the proposal.

FINANCIAL IMPACT: For the scope of services described in the proposal, Perkins+Will is stipulating a fee of \$53,600. The cost of these services will be included in the FY2021 and FY2022 budgets and allocated to the Capital Projects Fund. As noted in the proposal, the anticipated construction budget is between \$595,800 and \$744,750 depending on the cost per square foot.

RECOMMENDATION: The Administration recommends that the Board of Education approve the proposal from Perkins+Will.

SUGGESTED MOTION: That the Board of Education approve the 2022 Summer Work Professional Services Proposal from Perkins+Will for a total fee of \$53,600.

Perkins&Will

Date: 1.12.2021

David Wilkinson
Director of Finance
Lisle Community Unit School District 202
5211 Center Avenue
Lisle, Illinois 60532

**Re: Lisle Senior High School – Professional Services Proposal
2022 Summer Work – Revised v3**

Dear Dave,

Perkins&Will is pleased to submit the following proposal to Lisle Community School District 202 for Architectural and Project Management services for the replacement of selected roof areas at Lisle Senior High School. This proposal is based on the Terms and Conditions as executed in the January 23, 2017, AIA B101 – 2007, “Standard Form of Agreement Between Owner and Architect”.

The Project team will include Mark Jolicoeur as Managing Principal and Rick Young as Project Manager. Rick Young will be the main point of contact with the District for the duration of the effort.

Project Scope

Perkins&Will proposes to provide Project Management, Architectural, and Construction Phase services for the proposed Project. Professional services will be provided as delineated in the Scope of Architect’s Basic Services as described in Article 3 of executed contract above.

Based upon our site visit and conversations between Perkins&Will and District Administration, our understanding of the project scope includes the full replacement of roof membrane and insulation in the areas illustrated on Attachment A. The total roof area to be replaced in 2022 is approximately 29,790 square feet. Subsequent to review with the District, the new roof is to be a fully adhered EPDM sheet roofing membrane with new insulation similar to the installation at the newly constructed Lisle Elementary School.

Budget

Based upon the cost of the roofing at Lisle Elementary School, taking into account escalation over the last two years and adding in the demolition of the existing roof for this project, we estimate \$20 - \$25 per square foot for the roofing to be replaced. This would place the construction budget at \$595,800 - \$744,750. We recommend the District budget an additional 10% contingency beyond the estimated construction cost.

Bidding

Perkins&Will anticipates this project to be publicly bid by general contractors. We have included a pre-bid meeting to review the project with perspective bidders. See the Schedule section for the proposed date. We shall manage the bidding process and assist the District with permitting through the ROE.

Date: 1.12.2021

Re: Lisle Senior High School –
Professional Services
Proposal
2022 Summer Work –
Revised v3

Construction Phase meetings

Based upon the scope of work and project schedule, Perkins&Will anticipates the following number of site visits/meetings during Construction Phase Services.

- Pre-Construction meeting
- Weekly OAC meetings (6-8)
- Additional Site Observation Visits will be performed at our hourly rates listed below
- Punch List Inspection
- Final Completion Inspection

Schedule

The project is to be constructed during the summer of 2022 (early June – end of July). The following is our initial proposed schedule to be reviewed with the District following approval to proceed:

- Design & Documentation January – April, 2021
- 95% set to District for Review No later than Mid-July, 2021
- 95% set page turn with District August 4, 2021
- Issue for Bid August 18, 2021
- Pre-Bid Meeting September 1, 2021
- Bids Due (4 week bid period) September 15, 2021
- Recommendation Letter to District September 22, 2021
- Board Approval September 27, 2021
- Start of On-site Construction June 6, 2022
- Substantial Completion July 15, 2022
- Punch List Inspection July 15, 2022
- Final Completion July 29, 2022

Compensation

For the scope of services and within the schedule durations described above, Perkins&Will proposes a lump sum fee of fifty three thousand six hundred dollars and zero cents (\$53,600.00), exclusive of all reimbursable expenses, and broken down by phase as follows:

Construction Documents	75%	\$ 40,200.00
Procurement	5%	\$ 2,680.00
Construction	20%	\$ 10,720.00
Total Basic Compensation	100%	\$ 53,600.00

The Construction Phase Services fee is a slightly higher percentage than previous proposals based upon the anticipated division of effort between the design and construction phases.

The above fee does not include engineering services for the replacement of existing piping or equipment on the roof as it has not been identified as part of the project scope. However, should a mechanical or other engineer be required for replacement of existing piping, modification of existing equipment on the roof, or other scope, then we would obtain a proposal for the District's consideration.

Date: 1.12.2021

Re: Lisle Senior High School –
Professional Services
Proposal
2022 Summer Work –
Revised v3

Additional Services

For the hourly billing related to other supplemental services requested, including significant change orders during construction due to unforeseen conditions or Owner requested changes after bidding, Perkins&Will shall be reimbursed at our customary hourly billing rates as listed below.

Principal	\$	285
Associate Principal	\$	235
Specification Writer	\$	210
Senior Project Manager	\$	205
Senior Project Designer	\$	205
Senior Interior Designer	\$	205
Senior Project Architect	\$	205
Senior Technical Coordinator	\$	200
Project Manager	\$	190
Project Designer	\$	180
Interior Designer	\$	180
Project Architect	\$	180
Technical Coordinator	\$	175
Architect III / Designer III	\$	160
Architect II / Designer II	\$	125
Architect I / Designer I	\$	115
Intern	\$	95
Administrative	\$	90

* The hourly billing rates are subject to change on a yearly basis, but will be held for the duration of this project.

Please do not hesitate to contact me directly at 312.755.4521 or mark.jolicoeur@perkinswill.com if you have any questions or comments. If this proposal meets with your approval, please sign below and return a copy to me. If authorized to proceed, Perkins and Will shall submit monthly invoices for services to date; payment would be expected within 30 days of invoice.

Perkins&Will is very pleased to submit this proposal. We are looking forward to continuing our relationship with Lisle Community School District 202 on this exciting Project. Thank you for your consideration.

Perkins and Will, Inc.

Lisle Community School District 202

Signature

Signature Date

Mark Jolicoeur, AIA LEED AP
Printed Name (authorized to sign)

Printed Name (authorized to sign)

Principal _____

Title

Title

Title

ATTACHMENT A

Perkins&Will

Ave. Ricardo Margain Zozaya,
#338 T2-P11 PTE, Col. Valle del
Campeche,
San Pedro Garza Garcia,
Nuevo Leon CP 66255 Mexico
12 14 283 8700
www.perkinswill.com

CONSULTANTS

MEP
MSA - Mechanical Services Associates
111 S Virginia Street
Crystal Lake, IL 60154
OWNER
Lisle Community School District 202
5211 Center Ave
Lisle, IL 60532
ARCHITECT
Lisle Senior High School
1800 Short Street
Lisle, IL 60532

Roof Area Legend:

2021:		
- North Gym Mech.	2,509	
2022:		
- Gym Corridor	1,843	
- Band	5,755	
- Band Mech. Well	527	
- Auditorium Corridor	528	
- Scene Shop	1,860	
- Stage	2,623	
- South Gym	9,317	
- Receiving	1,994	
- S. Library & Clsrms.	5,343	
Total Area:	29,790	
Re-Assess for 2024:		
- North Gym	13,764	
- Auditorium	5,819	
- Main Entrance	4,576	
Total Area:	24,159	

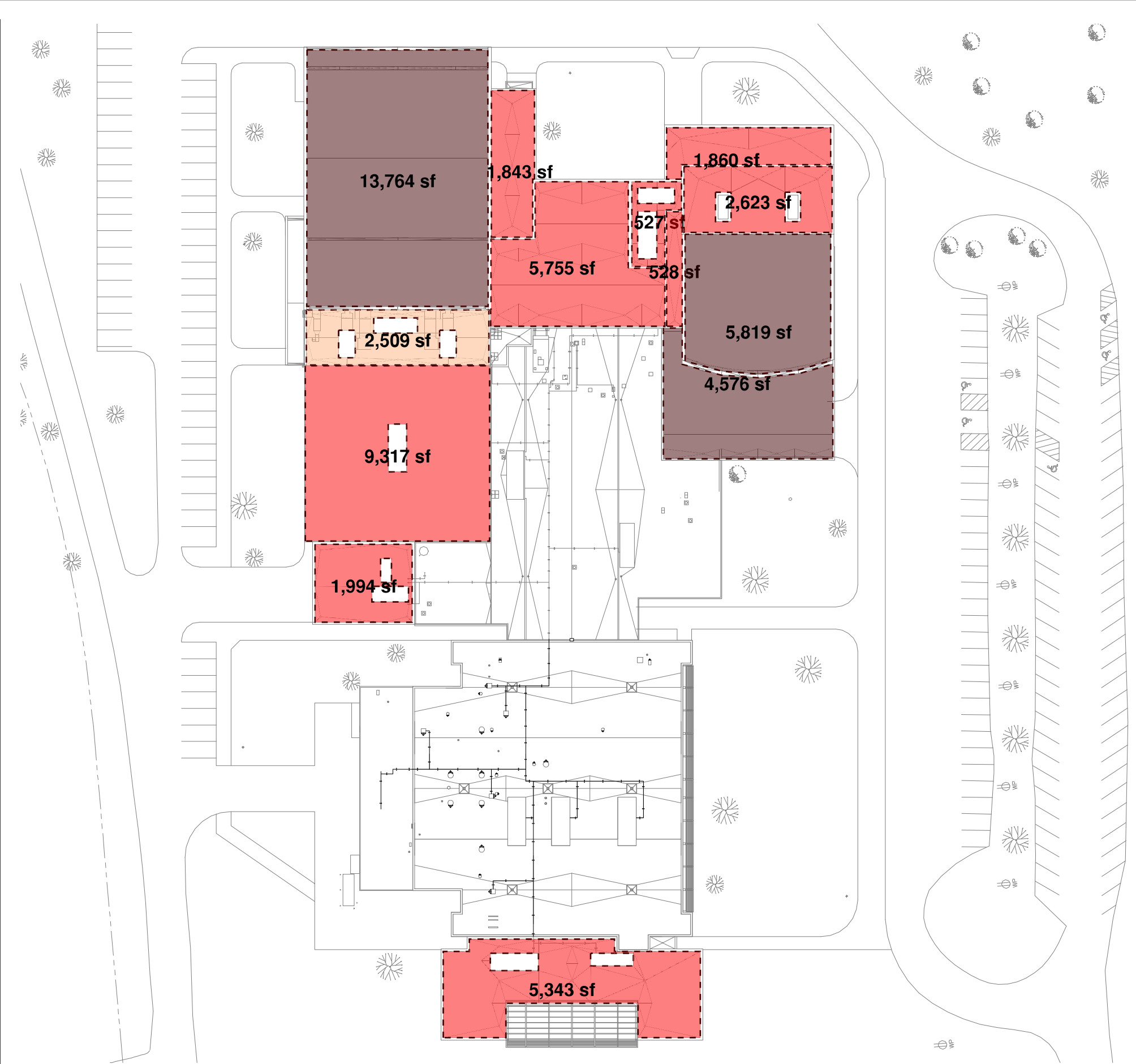

1 ARCHITECTURAL SITE AND ROOF PLAN - EXISTING
3/6" = 1'-0"

PROJECT
LISLE SENIOR HIGH SCHOOL SUMMER WORK 2022
1800 Short Street
Lisle, IL 60532



Lisle Community School District 202
5211 Center Ave
Lisle, IL 60532

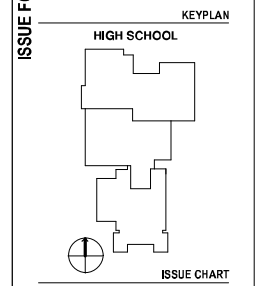

DATE: 10/20/20
JOB NUMBER: 021000440
TITLE:

ARCHITECTURAL SITE AND ROOF PLAN - BACKGROUND

SHEET NUMBER

X-A04-01

12/02/2020 3:25:20 PM BIM 360://Lisle 0202 - 2021 Summer Work/ARCH/Lisle 0202 HS-2021 Summer Work.rvt

FOR ACTION

**Lisle Community Unit School District 202
Board of Education Meeting
January 25, 2021**

SUBJECT: Multi-Function School Activity Bus Purchase

BACKGROUND DATA: The District currently owns two (2) 1998 Ford Club Wagon 8-Passenger vans. The vans are used primarily to transport smaller teams and individuals for interscholastic activities. For the most part, the vans have not had any major maintenance issues. Mileage on the vans is relatively low for their age at approximately 80,000 miles each. Both vans are inspected at an Illinois Department of Transportation (IDOT) inspection lane every 6 months.

While the vans are still running well, most schools in the area have moved away from vans for interscholastic trips. In July 2003, the National Highway Traffic and Safety Administration (NHTSA) defined a new vehicle type, the "Multifunction School Activity Bus" (MFSAB) which was defined as a vehicle that is sold for purposes that do not include transportation between home and school for pupils from kindergarten through Grade 12. NHTSA promoted this vehicle to serve as a safe choice for institutions, including school districts that have a need to transport groups of people. A particular safety benefit was that the MFSAB was a safer alternative to transporting 11 to 15 passengers instead of the 15 passenger vans that had been used in the past. The National Highway Traffic Safety Administration (NHTSA), National Association for Pupil Transportation (NAPT) and the National Association of State Directors of Pupil Transportation Services (NASDPTS) believe that school buses may be more expensive than other types of vehicles, but the increased level of safety justifies a higher cost

It should be noted that for non-curriculum activities, the buses can be operated by anyone with a valid driver's license. Curriculum related events (home to school and school to home prohibited) would require a school bus driver permit (CDL) or restricted school bus driver permit (Non-CDL).

With safety in mind, the Administration would like to purchase two multi-function school activity buses via the State of Illinois bid. The cost of a 2020 Chevy 14 passenger TransTech MFSAB with the most popular options is \$55,493. The 14 passenger MFSAB's can be delivered in February 2021.

FINANCIAL IMPACT: Based on activities/events where the vans have been used in the past, the cost to transport these students utilizing Westway Coach would be approximately \$20,000 to \$25,000 each year. Thus the break even on purchasing the buses for \$110,986 is a little more than four years. The FY2021 Transportation Fund budget includes a \$100,000 line item for the purchase of two MFSAB's.

RECOMMENDATION: That the Board approve the purchase of two MFSAB's utilizing the State of Illinois Bid.

SUGGESTED MOTION: That the Board of Education approve the purchase of two multifunction school activity buses from Southern Bus & Mobility at a cost of \$55,493 each as presented on the attached proposal.

12950 Koch Lane
PO Box 37
Breese, IL 62230

phone (618) 526-4131
toll-free (877) 526-4131
fax (618) 526-4585



80 South Highway Drive
Valley Park, MO 63088
(St. Louis I-44 & Highway 141)

phone (636) 825-0700
toll-free (866) 327-1600
fax (636) 825-0701

Body #15946 /PO 8228

IL STATE BID PROPOSAL

January 14, 2021

Mr. David Wilkinson
Director of Finance
Lisle CUSD #202
5211 Center Ave.
Lisle, IL 60532
Tel: 630-493-8000 E-mail: dwilkinson@lisle202.org

We are pleased to quote on (1) new 2020-2021 Chevy TransTech **14** passenger MFSAB per the specifications below. Please note - The 14 passenger MFSAB is a bus that meets all FMVSS for a school bus with the exceptions of the warning lamps and stop arm and it cannot be used to stop traffic on any roadway. The MFSAB is a vehicle that meets all Federal construction standards for a school bus to provide maximum protection for your passengers.

CHASSIS SPECIFICATIONS

X	139" Wheelbase	
X	6.0L Vortec V-8 gasoline engine 323 HP	
X	1370 cca battery (dual)	
X	3.73 – 1 axle ratio	
X	Engine cooler	
X	6 Speed automatic transmission with overdrive	
X	Brake/ transmission shift interlock	
X	Driveshaft guards	
X	12,300 lb. GVWR	
X	4,300 lb. front axle	
X	8,800 lb. rear axle	
X	4,300 lb. front springs	
X	8,600 lb. rear springs	
X	Heavy duty radiator	
X	Dual rear wheels	
X	LT225/75R16 all season radial tires	
X	4-wheel disc brakes with 4-wheel anti-lock brake system	
X	Brake warning indicator	
X	220 amp. Alternator	
X	Front and rear shock absorbers	
X	Front stabilizer bar	
X	Power steering	
X	33 gallon fuel tank	
X	Two speed intermittent windshield wipers with electric washers	
X	In dash heater, defroster and 15,000 BTU A/C system	
X	Tilt Steering	

X	Driver information center: includes fuel range, average speed, oil life monitor, fuel used, ice warning, engine hours, average fuel economy, tachometer, and maintenance reminders	
X	Instrumentation: Analog with speedometer, odometer with trip odometer, fuel level, voltmeter, engine temperature and oil pressure	
X	Theft deterrent system PASS-Key III	
X	Warning tones for headlights on and key in ignition	
X	Driver's high back seat with lap and shoulder harness	
X	Driver's door with roll up window and key lock	
X	Tinted windshield and drivers door glass	
X	Driver side sun visor	
X	Driver's storage console with cup holders	
X	(2) 12 volt auxiliary power outlets	
X	(1) 120 volt power outlet	
X	Aluminized stainless steel muffler and tailpipe	
X	Black rubberized floor covering	
X	Driver's air bag	
X	Daytime driving lights	
X	OEM AM/FM Radio with MP3 Player	
X	5 year or 100,000 mile power train warranty (which ever comes first)	
X	3 year or 36,000 mile bumper to bumper chassis warranty	
X	5 year or 60,000 mile 24 hour road assistance	

SCHOOL BUS BODY SPECIFICATIONS

X	75" Interior headroom / Overall height 110"	
X	90" interior width / Exterior width 96"	
X	Aerodynamic front roof cap which improves fuel efficiency and direct mounted on cab to prevent water leaks	
X	Bolted galvanized steel cage providing enhanced crash protection	
X	(3) Full length front to back roof strainers for added strength and safety	
X	Aluminum interior side walls	
X	Steel exterior side walls (22 gauge galvanized steel)	
X	Fiberglass exterior front and rear endcaps	
X	Fiberglass front and rear interior panels	
X	Aluminum interior ceiling panels	
X	Single seam roof construction with .040 thick aluminum roof panels	
X	Rear wheel ABS high impact textured plastic fenderettes	
X	4 Rubrails located at floor, seat, window and skirt level	
X	Double-out, panic-free entrance door with manual door control 24 ½" wide x 76 ½" tall	
X	Storage compartment above driver with latch	
X	Tinted split sash side windows constructed w/black anodized aluminum frames	
X	Curb side safety window 430 square inches	
X	Wrap-around, anti-ride rear bumper	
X	Bus body will be completely undercoated	

X	High-strength square tube reinforced side skirt impact panels	
X	1 ½" Fiberglass insulation in roof, side & rear ¼ panels	
X	Two step step-well (ground to first step 11 ½")	
X	Anodized aluminum rear emergency door frame with full length tempered glass 52 ½" high x 35 ½" wide and 3 point emergency door latching	
X	½" Red emergency door pilot light for driver	
X	14 gauge galvanized one piece pan-formed and corrugated steel floor for enhanced strength	
X	1/8" Black smooth rubber floor covering under seats	
X	3/16" Black ribbed rubber in aisle and on entrance steps	
X	½" Exterior grade plywood sub-floor	
X	45,000 BTU rear heater	
X	Heater shut-off valves located behind entry door under RH side	
X	Heater bleed valves	
X	Static Roof Vent	
X	Stainless steel hand rail at entrance steps	
X	6" x 16" interior mirror	
X	Bright white polyurethane heat treated Sherwin Williams exterior paint	
X	White interior	
X	Drip rail above passenger side windows designed to shed water away from body and cab	
X	Reflective striping around all emergency exits	
X	Rosco 7" x 10" flat with 7" x 4" convex rearview mirrors	
X	Rosco fender mounted crossview mirrors	
X	Header bumper pads over entrance and emergency doors	
X	Reflective triangle kit	
X	2-1/2 lb. Fire extinguisher with indicator sign	
X	First aid kit mounted on front header panel	
X	Control board for all body circuits mounted above driver in driver's storage compartment	
X	Body circuit relay disconnect	
X	Ergonomic overhead switch control panel above windshield	
X	Color, number, and function coded electrical wire harness	
X	(6) LED Dome lights for passengers	
X	LED ¾" Driver dome light on separate switch	
X	LED ¾" Marker and ID lamps	
X	LED 4" Brake and tail lights	
X	LED 4" Round back up lights	
X	LED 7" Red incandescent brake and tail lights	
X	LED 7" Amber incandescent rear turn signals	
X	LED 2" x 5" rectangular Step well-light	
X	Amber side turn signals	
X	Master switch – Heater/Fan shutdown	
X	Back-up alarm	
X	Crossing arm – Specialty w/interrupt switch	
X	Strobe light lo-profile located 4 feet from rear of bus and back lit switch mounted in overhead control panel	
X	Rear vandal lock with buzzer & front indicator light with starter interrupt.	

X	(7) School bus bench seats	
X	Seat belts on all passenger seats	
X	Seat belt cutter with indicator sign	
X	Versa-Track seating system (wall and floor mounted tracks) provides maximum versatility & safety	
X	Padded barriers in front of passenger seats	
X	Front mud flaps	
X	Rear mud flaps	
X	Back up alarm	
X	Fuel access plate cover	
X	Delivered with new State inspection sticker	
X	Belt line lettering and bus numbers	
X	60,000 BTU rear tie in A/C system with a 3 fan side mounted condenser	
X	Altoona Tested for safety and durability	
X	Limited Structural Warranty (5 years / 75,000 miles) – see attached warranty brochure	
X	Limited Corrosion Warranty (5 years / 75,000 miles) – see attached warranty brochure	
X	Limited Paint Warranty (5 years / Unlimited miles) – see attached warranty brochure	
X	Basic Body Coverage (3 years / 60,000 miles) – see attached warranty brochure	
X	Lifetime Warranty on Power center circuit board	

Price for (1) 14 passenger MFSAB as per the IL State Bid Contract for the sum of - **\$53,028.00**

Options already included on the bus:

Cruise Control – \$217.00

Heated rearview and crossview mirrors with pilot light in lieu of std – \$176.00

High Back Activity Seats with vinyl upholstery in lieu of std seats – \$1,460.00

Gray floor and step-well in lieu of black floor - \$318.00

Storage Rack in rear of bus - \$556.00

New 2020 chassis in lieu of 2021 chassis – (\$773.00)

Price of bus with options - **\$54,982.00**

Options:

Delivery cost – \$1.25 X 283 miles to Lisle, IL = \$353.00

(If delivery is desired, circle and add to the above price of the bus)

Terms:

- Price quoted **does not** include license and title fees (\$158) each bus
- Price quoted includes all applicable rebates from General Motors
- Bus is in production at the factory and delivery can be February, 2021
- **Bus is subject to prior sale**

Accepted / Date

Phyllis Gelke 1/14/21
Sales Representative
Southern Bus & Mobility

THIS DRAWING CONTAINS CONFIDENTIAL PROPRIETARY INFORMATION OF TCI AND IS NOT TO BE DISCLOSED TO THE PUBLIC OR TO COMPETITORS NOR TO BE USED EXCEPT FOR EVALUATING PROPOSALS OF TCI OR INSTALLING, OPERATING, OR MAINTAINING TCI EQUIPMENT UNLESS OTHERWISE AUTHORIZED IN WRITING BY TCI

LEGEND:

ACT - ACTIVITY C.E. WHITE SEATS
 CS - CURBSIDE
 SS - STREET SIDE

NOTE:

1. VERSA TRACK MOUNTED SEATS & BARRIERS.
2. CENTER AISLE HEIGHT: 75"

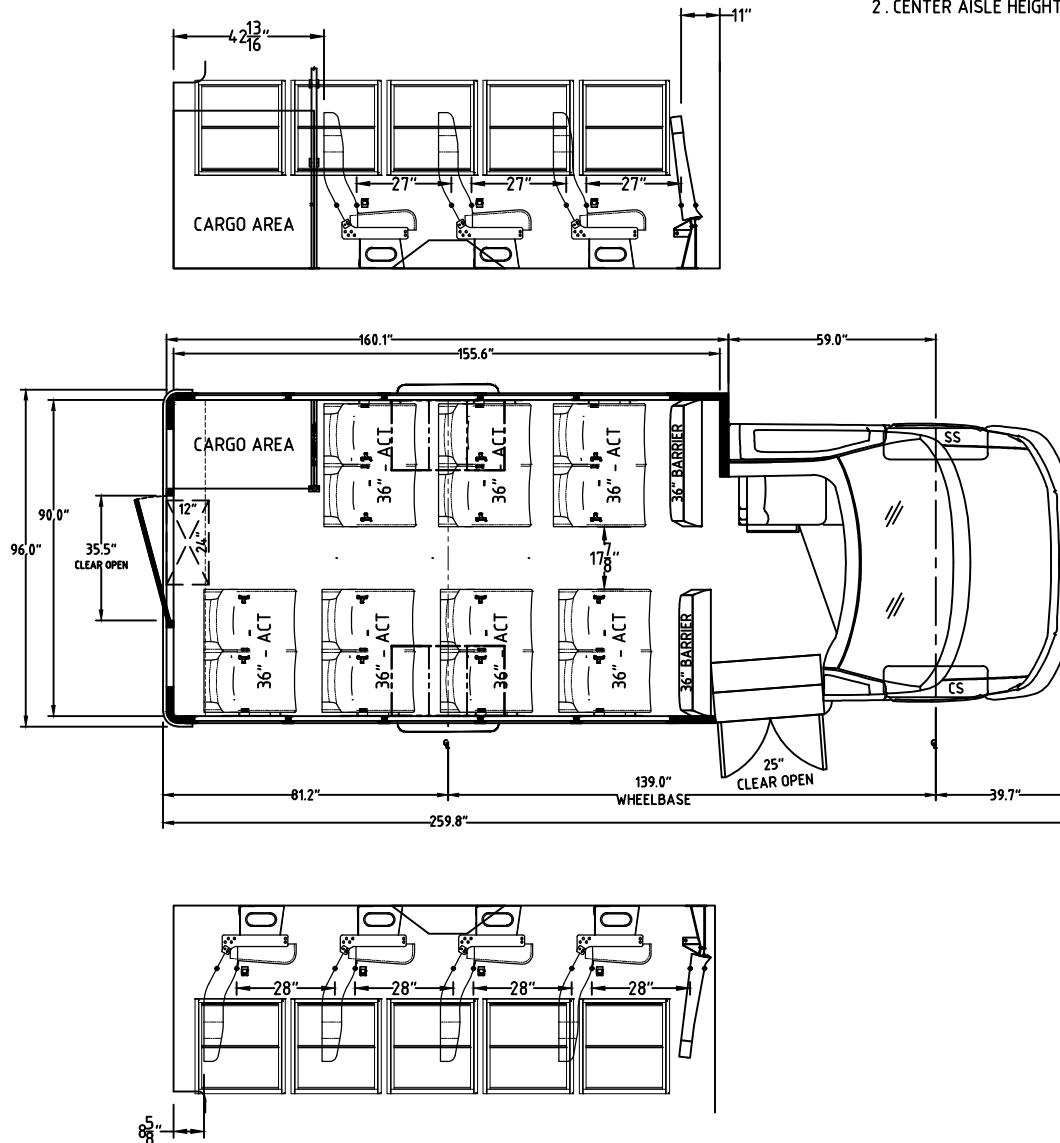

FLOOR PLAN APPROVAL

SIGNATURE		DATE	
WHEELBASE: 139"		DATE: 01/10/2017	
DRAWING #: C0163		DRAWN BY: MAO	



DOT APPROVAL NUMBER: 381-NY-14-00WC-TTB		08/23/2018	
MAKE: CHEVY	CHASSIS: DRW	MODEL: CC139DMSA500	
CAPACITY: 14C/14A	WHEELCHAIR: -	KNEE SPACING: SS: 27" CS: 28"	
PUBLISHED ON: Thursday, August 23, 2018			

USE FLOOR PLAN FOR ILLUSTRATION PURPOSES.

PATH: S:\Confirmed Chassis\CST\C0163_CC139DMSA500.dwg

12950 Koch Lane
Breese, IL 62230
877-526-4131



80 South Highway Drive
Valley Park, MO 63088
866-327-1600



Capacity of
9 – 32
passengers



Benefits of a Trans Tech Bus:

- One piece, wind Resistant Aerodynamic front roof cap which reduces: wind turbulence, interior noise, vibration. It also improves fuel economy and is mounted directly on top of cab to prevent water leaks.
- Single seam roof construction with two rows of rivets for enhanced strength and prevents water leaks.
- One piece steel reinforced fiberglass rear roof cap, rear wall and emergency door jam to prevent water leaks, rust, and corrosion.
- Rust and corrosion resistant aluminum rear emergency door with full length steel reinforced glass and three point latch.
- Stamped pan-formed steel floor for increased strength and less corrosion
- Heavy duty vinyl aisle moldings to cover seams in floor (vinyl strips snap in and will not rust and corrode).
- Polyurethane heat treated Sherwin Williams exterior paint
- The best warranty in the Type-A market, featuring 3-year/60,000-mile bumper-to-bumper coverage.

SEE REVERSE SIDE

14 pass + driver
Activity Seats & Cargo

MFSAB floor plans & options

14 pass + driver
School Bus seats

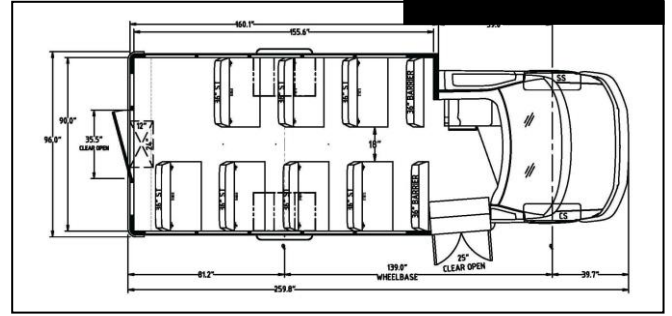
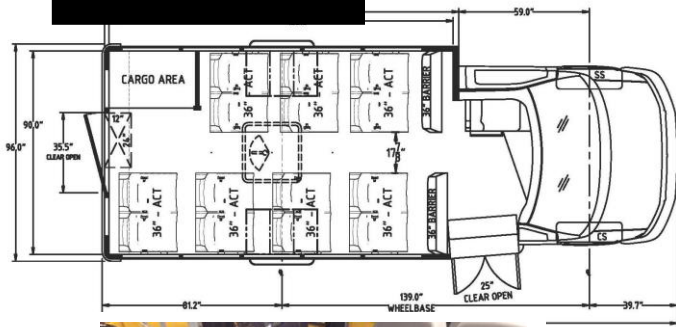

Vinyl Activity Seats



Cloth Activity Seats



Storage

School Bus floor plans

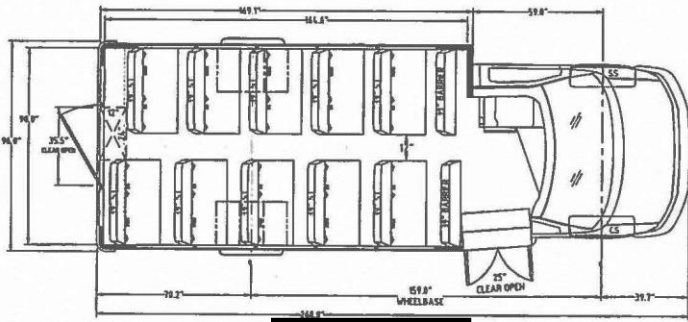

30 passenger

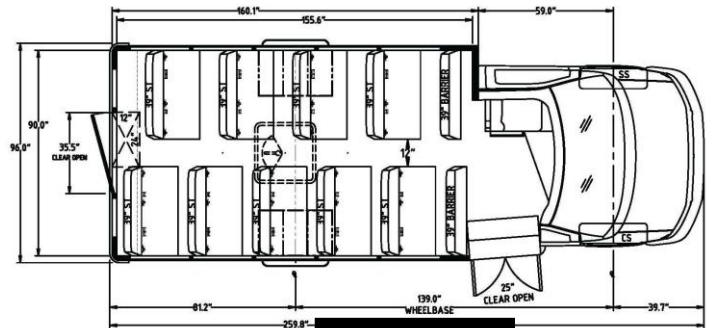

27 passenger

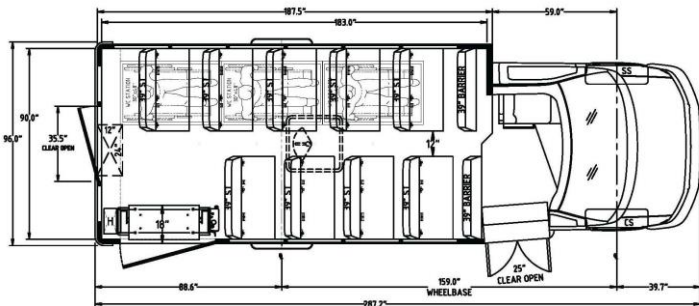

27, 24+1, 18+2, 12+3

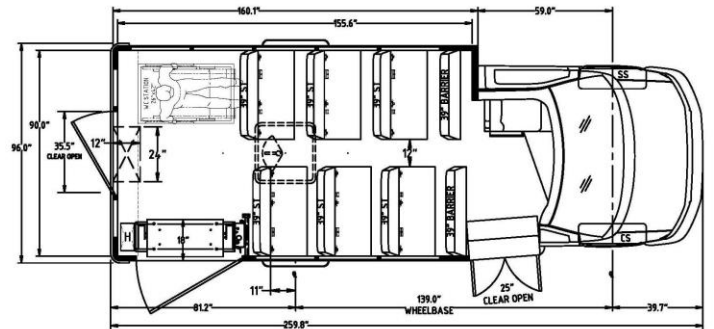

18+1 W/C

Above is just a sample of the many floor plans available.





LISLE
COMMUNITY HIGH SCHOOL DISTRICT
202

V8

FOOT TRAFFIC ONLY
NO MOTOR VEHICLES
OR TRUCKS



Before leaving van, throw away your trash in the garbage can in garage by walk-in door!



Before leaving van, throw away your trash in the garbage can in garage by walk-in door!





EMERGENCY EXIT

12

COMMUNITY HIGH SCHOOL DISTRICT 128

GASOLINE

AUX BATTERY



12

LISLE COMMUNITY UNIT SCHOOL DISTRICT #202
FINANCIAL REPORT
December 2020

	Total All Funds	Educational	Operations & Maintenance	Debt Services	Transportation	IMRF/Social Security		Capital Projects	Working Cash	Tort
						IMRF	Social Security			
BEGINNING FUND										
BALANCE 7/1/20	18,056,178.99	11,120,412.00	520,599.43	183,150.06	2,291,800.18	240,141.62	221,660.55	2,673,622.03	804,793.12	0.00
REVENUES										
JULY	16,461,682.31	12,879,557.15	2,083,055.64	643,445.65	354,239.30	228,701.54	266,000.29	1,518.26	2,813.14	2,351.34
AUGUST	3,649,794.13	2,721,273.14	408,557.28	124,059.25	297,050.95	44,173.30	51,348.30	1,857.23	1,023.10	451.58
SEPTEMBER	10,085,091.06	7,860,550.23	1,228,341.29	378,557.79	320,773.93	134,580.50	156,512.23	2,300.27	2,093.39	1,381.43
OCTOBER	1,469,667.48	1,057,180.32	139,453.81	40,289.37	200,862.78	14,324.84	16,657.21	462.70	289.96	146.49
NOVEMBER	730,703.45	645,333.38	53,986.03	11,968.22	9,981.71	4,253.10	4,946.20	113.12	78.13	43.56
DECEMBER	1,400,424.49	350,563.53	33,856.66	1,006,082.83	5,092.30	2,160.76	2,512.73	85.27	48.32	22.09
JANUARY	0.00	0.00	0.00	0.00	0.00	0.00	0.00	0.00	0.00	0.00
FEBRUARY	0.00	0.00	0.00	0.00	0.00	0.00	0.00	0.00	0.00	0.00
MARCH	0.00	0.00	0.00	0.00	0.00	0.00	0.00	0.00	0.00	0.00
APRIL	0.00	0.00	0.00	0.00	0.00	0.00	0.00	0.00	0.00	0.00
MAY	0.00	0.00	0.00	0.00	0.00	0.00	0.00	0.00	0.00	0.00
JUNE	0.00	0.00	0.00	0.00	0.00	0.00	0.00	0.00	0.00	0.00
SUB-TOTAL	33,797,362.92	25,514,457.75	3,947,250.71	2,204,403.11	1,188,000.97	428,194.04	497,976.96	6,336.85	6,346.04	4,396.49
EXPENDITURES										
JULY	1,284,441.15	974,234.50	237,841.47	0.00	2.11	36,800.24	35,466.24	0.00	0.00	96.59
AUGUST	1,342,631.27	1,005,179.23	248,031.59	0.00	0.91	38,905.04	36,362.92	13,700.00	0.00	451.58
SEPTEMBER	3,013,070.93	2,679,342.03	240,299.79	0.00	18,607.88	37,630.34	35,809.46	0.00	0.00	1,381.43
OCTOBER	2,566,553.34	2,226,145.35	189,380.89	0.00	68,561.77	36,732.87	36,526.09	6,805.13	0.00	2,401.24
NOVEMBER	2,648,598.22	2,181,926.22	225,767.79	500.00	150,565.37	35,764.41	37,110.87	16,920.00	0.00	43.56
DECEMBER	5,184,560.07	3,591,376.47	169,824.06	1,213,375.00	133,533.89	35,193.07	37,174.69	4,060.80	0.00	22.09
JANUARY	0.00	0.00	0.00	0.00	0.00	0.00	0.00	0.00	0.00	0.00
FEBRUARY	0.00	0.00	0.00	0.00	0.00	0.00	0.00	0.00	0.00	0.00
MARCH	0.00	0.00	0.00	0.00	0.00	0.00	0.00	0.00	0.00	0.00
APRIL	0.00	0.00	0.00	0.00	0.00	0.00	0.00	0.00	0.00	0.00
MAY	0.00	0.00	0.00	0.00	0.00	0.00	0.00	0.00	0.00	0.00
JUNE	0.00	0.00	0.00	0.00	0.00	0.00	0.00	0.00	0.00	0.00
SUB- TOTAL	16,039,854.98	12,658,203.80	1,311,145.59	1,213,875.00	371,271.93	221,025.97	218,450.27	41,485.93	0.00	4,396.49
ENDING FUND BALANCE	35,813,686.93	23,976,665.95	3,156,704.55	1,173,678.17	3,108,529.22	447,309.69	501,187.24	2,638,472.95	811,139.16	0.00
LIABILITIES	66,105.13	6,005.13	60,100.00	0.00	0.00	0.00	0.00	0.00	0.00	0.00
ENDING LIABILITY & FUND BALANCE	35,879,792.06	23,982,671.08	3,216,804.55	1,173,678.17	3,108,529.22	447,309.69	501,187.24	2,638,472.95	811,139.16	0.00

LISLE COMMUNITY UNIT SCHOOL DISTRICT NO. 202
MONTHLY TREASURER'S REPORT
December 31, 2020

							IMRF/Social Security				
		Total All Funds	Educational	Operations & Maintenance	Debt Services	Transportation	IMRF	Social Security	Capital Projects	Working Cash	Tort
ISDLAF+/PMA - 101 ACCOUNT											
12/1/20	LIQ Beginning Balance (1121)	1,743,433.83	443,207.40	182,236.77	212,517.18	300,903.22	13,122.27	20,575.85	440,946.33	129,924.81	-
	Monthly Transactions	(628,294.08)	302,138.51	(82,216.23)	(176,018.17)	(204,243.60)	788.15	(4,989.94)	(359,052.77)	(104,700.03)	-
12/31/20	LIQ Ending Balance (1121)	1,115,139.75	745,345.91	100,020.54	36,499.01	96,659.62	13,910.42	15,585.91	81,893.56	25,224.78	-
12/1/20	MAX Beginning Balance (1122)	25,454,788.55	18,028,328.28	2,126,243.46	780,251.88	1,988,066.98	311,187.33	343,580.61	1,432,738.12	444,391.89	-
	Monthly Transactions	(3,405,561.85)	(3,290,892.00)	(148,575.99)	(58,571.11)	(76,853.75)	(36,141.91)	(35,406.53)	186,511.49	54,367.95	-
12/31/20	MAX Ending Balance (1122)	22,049,226.70	14,737,436.28	1,977,667.47	721,680.77	1,911,213.23	275,045.42	308,174.08	1,619,249.61	498,759.84	-
12/1/20	Investment Beginning Balance (1210)	12,445,057.91	8,737,168.69	1,043,791.72	388,201.28	947,700.61	156,032.40	171,692.74	763,696.33	236,774.14	-
	Monthly Transactions	249,500.00	(252,279.80)	94,824.82	27,297.11	152,655.76	2,321.45	5,734.51	168,565.75	50,380.40	-
12/31/20	Investment Ending Balance (1210)	12,694,557.91	8,484,888.89	1,138,616.54	415,498.39	1,100,356.37	158,353.85	177,427.25	932,262.08	287,154.54	-
Total Ending Balance - 101 Account		35,858,924.36	23,967,671.08	3,216,304.55	1,173,678.17	3,108,229.22	447,309.69	501,187.24	2,633,405.25	811,139.16	-
OTHER CASH, DEPOSITS & ACCOUNTS RECEIVABLE											
	Imprest Fund (1110)	10,800.00	10,000.00	500.00		300.00					
	Flex Spending (1150)	5,000.00	5,000.00								
	Deposits (1910)	5,067.70							5,067.70		
12/31/20	Other Cash, Dep. & AR Ending Balance	20,867.70	15,000.00	500.00	-	300.00	-	-	5,067.70	-	-
Total Cash, Investments & Deposits		35,879,792.06	23,982,671.08	3,216,804.55	1,173,678.17	3,108,529.22	447,309.69	501,187.24	2,638,472.95	811,139.16	-

 David Wilkinson, Treasurer

1/15/21
 Date

FOR REVIEW

**Lisle Community Unit School District 202
Board of Education Meeting
January 25, 2021**

SUBJECT: 2022-2023 DRAFT School Calendar

BACKGROUND DATA:

The proposed 2021-2022 School Calendar reflects a student start date of Wednesday, August 17, 2022 with the tentative closing of the school year on Friday, May 26, 2023. When viewing this draft calendar please note the following:

- Institute Days and School Improvement/early release days follow a similar schedule and frequency (4 each) as the past few years.
- The Parent Teacher Conference schedule remains unchanged from the past few years.
- Winter break will begin on Monday, December 26th and will conclude on Friday, January 6th. This schedule helps balance student attendance days with 86 days in the first semester and 90 days in the second semester. This balance is a priority for students and staff, especially at the high school.
- Spring break falls in the last week of March with the “spring holiday” scheduled for Friday, April 7th.
- If no emergency days are used school will conclude on May 26, 2023. Use of emergency days may extend the calendar to June 5, 2023.

Administration will bring the 2022-2023 official School Calendar for approval at the February 2021 Board of Education meeting. Please note that should the Board decide to amend the calendar for any reason it may be brought back to the Board for discussion and vote.

FINANCIAL IMPACT: None.

RECOMMENDATION: None.

SUGGESTED MOTION: None.

2022-2023 LISLE CUSD 202 OFFICIAL SCHOOL CALENDAR

1/19/21

Jul-22					
M	T	W	T	F	
				1	
H	5	6	7	8	
11	12	13	14	15	
18	19	20	21	22	
25	26	27	28	29	

Jan-23					
M	T	W	T	F	
NA	NA	NA	NA	NA	0
9	10	11	12	ER	5
H	17	18	19	20	4
23	24	^25	26	27	5
30	31				2
					16

Aug-22					
M	T	W	T	F	
1	2	3	4	5	0
8	9	10	11	12	0
A	I	(17	18	19	3
22	23	24	25	26	5
29	30	31			3
					11

Feb-23					
M	T	W	T	F	
		1	2	3	3
6	7	^8	9	10	5
13	14	15	16	I	4
H	21	^22	23	24	4
27	28				2
					18

Sep-22					
M	T	W	T	F	
			1	2	2
H	6	^7	8	9	4
12	13	14	15	ER	5
19	20	^21	22	23	5
26	27	28	29	30	5
					21

Mar-23					
M	T	W	T	F	
		1	2	I	2
6	7	^8	9	10	5
13	14	15	16	17	5
20	21	^22	23	24	5
NA	NA	NA	NA	NA	0
					17

Oct-22					
M	T	W	T	F	
3	4	^5	6	I	4
H	11	12	13*	14*	3
17	18	^19	20	21	5
24	25	26	27	28	5
31					1
					18

Apr-23					
M	T	W	T	F	
3	4	5	6	H	4
10	11	^12	13	14	5
17	18	19	20	21	5
24	25	^26	27	28	5
					0
					19

Nov-22					
M	T	W	T	F	
	1	2	3	ER	4
7	8	9	10	11	5
14	15	^16	17	18	5
21*	22*	NA	H	NA	2
28	29	^30			3
					19

May-23					
M	T	W	T	F	
1	2	3	4	5	5
8	9	10	11	ER	5
15	16	17	18	19	5
22	23	24	25	26	5
H	ED	ED			0
					20

Dec-22					
M	T	W	T	F	
			1	2	2
5	6	7	8	9	5
12	13	^14	15	16	5
19	20	21	22	23	5
NA	NA	NA	NA	NA	0
					17

Jun-23					
M	T	W	T	F	
			ED	ED	
ED	6	7	8	9	
12	13	14	15	16	
19	20	21	22	23	
26	27	28	29	30	
					0

STUDENT ATTENDANCE DAYS (176 DAYS)

- August 15, 2022 Staff Attendance Day - Opening Day Ceremony
- August 17, 2022 First attendance day, full day
- May 26, 2023 Last day of school if *no* emergency days are taken, full day
- June 5, 2023 Last day of school if *all* emergency days are taken, full day

TEACHER INSTITUTE

- August 16, 2022 Building Planning Meetings/District
- October 7, 2022 Building Planning Meetings/District
- February 17, 2023 Staff Development
- March 3, 2023 County Institute

PARENT-TEACHER CONFERENCES

- October 13, 2022* Grades 6-12 2:00 P.M. P/T Conferences
- October 14, 2022* Grades 6-12 NO SCHOOL-P/T Conferences
- November 21, 2022* Grades PK-5, 2:30 P.M. P/T Conferences
- November 22, 2022* Grades PK-5 NO SCHOOL, P/T Conferences

EARLY RELEASE DAYS

EARLY RELEASE TIMES

- September 16, 2022 Elementary: 11:45
- November 4, 2022 Junior High: 11:30
- January 13, 2023 High School: 11:22
- May 12, 2023

CALENDAR

- First school day August 17, 2022
- Last school day if no emergency days are used May 26, 2023

End of Trimester (K-5)

Quarters (6-8)

Semester (9-12)

- 1. November 11
- 2. February 24
- 3. May 26
- 1. October 21
- 2. December 23
- 3. March 14
- 4. May 26
- 1. December 23
- 2. May 26

Lisle High School Graduation - Friday, May 19, 2023

NON-ATTENDANCE DAYS

- Thanksgiving Break 11/23/22 - 11/25/22
- Winter Break 12/24/22 - 01/06/23
- Spring Break 03/27/23 - 03/31/23
- Spring Holiday 04/07/23

LEGAL PUBLIC SCHOOL HOLIDAYS

- Independence Day 07/04/22
- Labor Day 09/05/22
- Columbus Day 10/10/22
- Veteran's Day (In Attendance) 11/11/22
- Thanksgiving Day 11/24/22
- Christmas Day (Observed) 12/25/22
- New Year's Day (Observed) 01/01/23
- M.L. King Day 01/16/23
- President's Day 02/20/23
- Memorial Day 05/29/23

EMERGENCY DAYS (5 DAYS - if required)

- Emergency Days 05/30/2023 - 06/05/23

TYPES OF DAYS

- Holiday H
- Institute Day I
- Not in Attendance NA
- Early Release Days ER
- School Begins (
- School Ends)
- Staff Attendance Day A
- Emergency Days ED
- High School PLC Early Dismissal Days ^

LEGEND



LISLE 202

COMMUNITY UNIT SCHOOL DISTRICT

iReady:

One Proven Program to Support Every Learner

January 2021

Why do we use iReady?

ISBE recommendations for 2020-2021 school year

- Assess learning gaps
- Differentiation
- Create individualized student growth goals
- Identify the priorities of grade-level content

What is iReady?

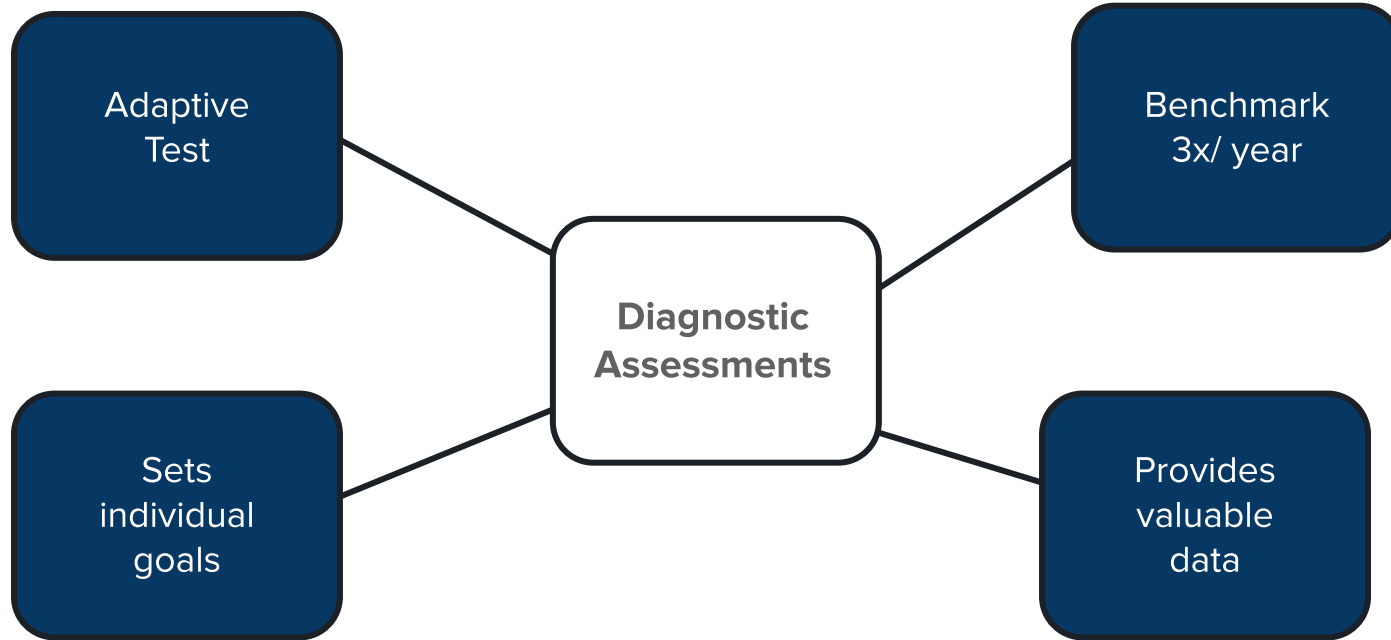

What does iReady tell us about a student?

Goals are provided for individual students based on their placement on the first Diagnostic assessment of the year.

- **Typical Growth** - average annual growth
- **Stretch Growth** - level of growth which closes learning gaps or accelerates to higher levels

How is iReady different from MAP?

Three dark blue circles are arranged horizontally across the middle of the slide. Each circle contains white text. The first circle on the left contains the text 'Personalized Instruction'. The middle circle contains the text 'Additional Assessments'. The third circle on the right contains the text 'On Demand Lessons'.

Personalized
Instruction

Additional
Assessments

On Demand
Lessons

Benefits from a Teacher's Point of View

Instructional groupings report

On demand lessons and instructional next steps report

Grade level reports to identify curriculum gaps

Opportunities for Growth Report- Reading-LES

C

Can Do ⓘ

Interpret figurative language and other literary devices.

Identify or interpret an author's use of figurative language, including metaphors, similes, or allusions, in Grade 4 literary or informational text. Identify literary devices such as alliteration or repetition.

[Standards](#)

Analyze characters in literary text.

Analyze characterization in Grade 5 literary text. Identify how the characters change or respond to challenges.

[Standards](#)

Analyze plot elements in literary text.

Identify and evaluate structural elements of the plot, including rising action, climax, falling action, and resolution, in Grade 5 literary text, drawing on specific details in the text.

[Standards](#)

Make inferences based on textual evidence.

Draw conclusions or make inferences in Grade 5 literary or informational text.

[Standards](#)

Next Steps & Resources for Instruction ⓘ

- + [Provide strategies for determining word meaning. Teach \[REDACTED\] to ask these questions about an unfamiliar ...](#)
- + [Deepen understanding of the influence of setting. Using a familiar literary text, help \[REDACTED\] analyze how the ...](#)
- + [Teach denotation and connotation. Help \[REDACTED\] understand that words have denotative, or literal meanings, ...](#)
- + [Teach determining theme. Explain that theme is the central message that an author wants to share with reade...](#)
- + [Develop knowledge of summarizing. Support \[REDACTED\] in practicing the following skills:](#)

LISLE DISTRICT 202

LISLE ELEMENTARY SCHOOL



iReady at LES: Grades 1-5 Fall 2020 Reading

Percent of Students at Each Performance Level

Three or More Grade Levels Below

4.7%

Two Grade Levels Below

9.7%

One Grade Level Below

40.5%

Mid or Above Grade Level

23.7%

Early On Grade Level

21.3%

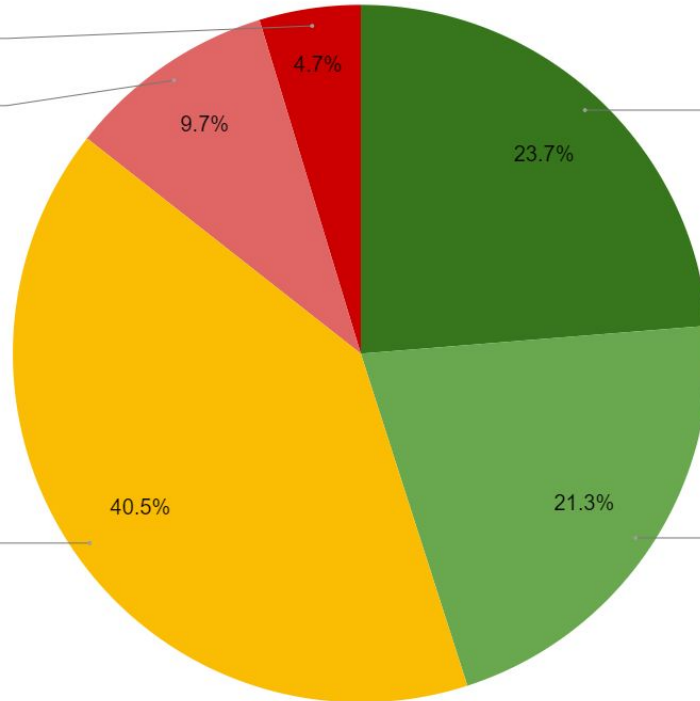

iReady at LES: Grades 1-5 Fall 2020 Math

Percent of Students at Each Performance Level

Three or More Grade Levels Below

2.7%

Two Grade Levels Below

9.9%

One Grade Level Below

50.6%

Mid or Above Grade Level

18.4%

Early On Grade Level

18.4%

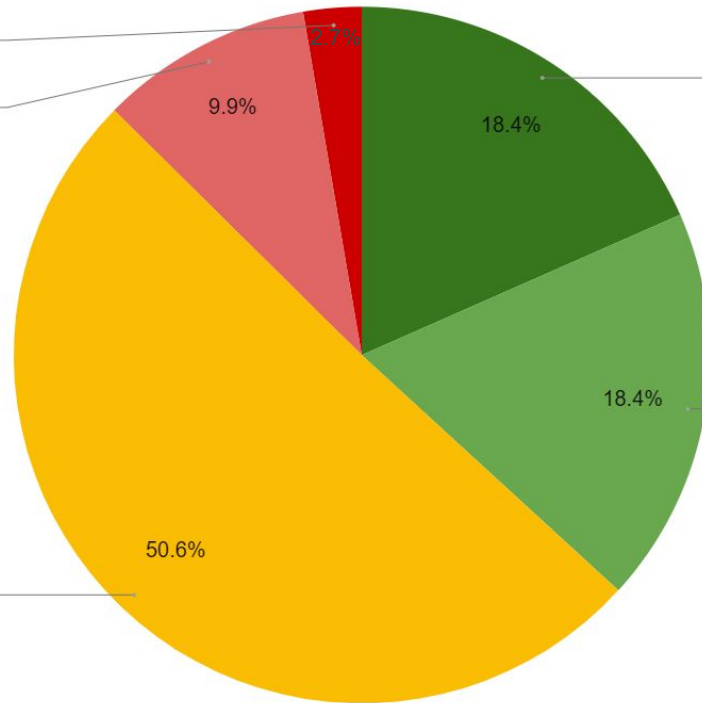

LISLE DISTRICT 202

LISLE JUNIOR HIGH SCHOOL



iReady at LJHS: Grades 6-8 Fall 2020

Reading

Percent of Students at Each Performance Level

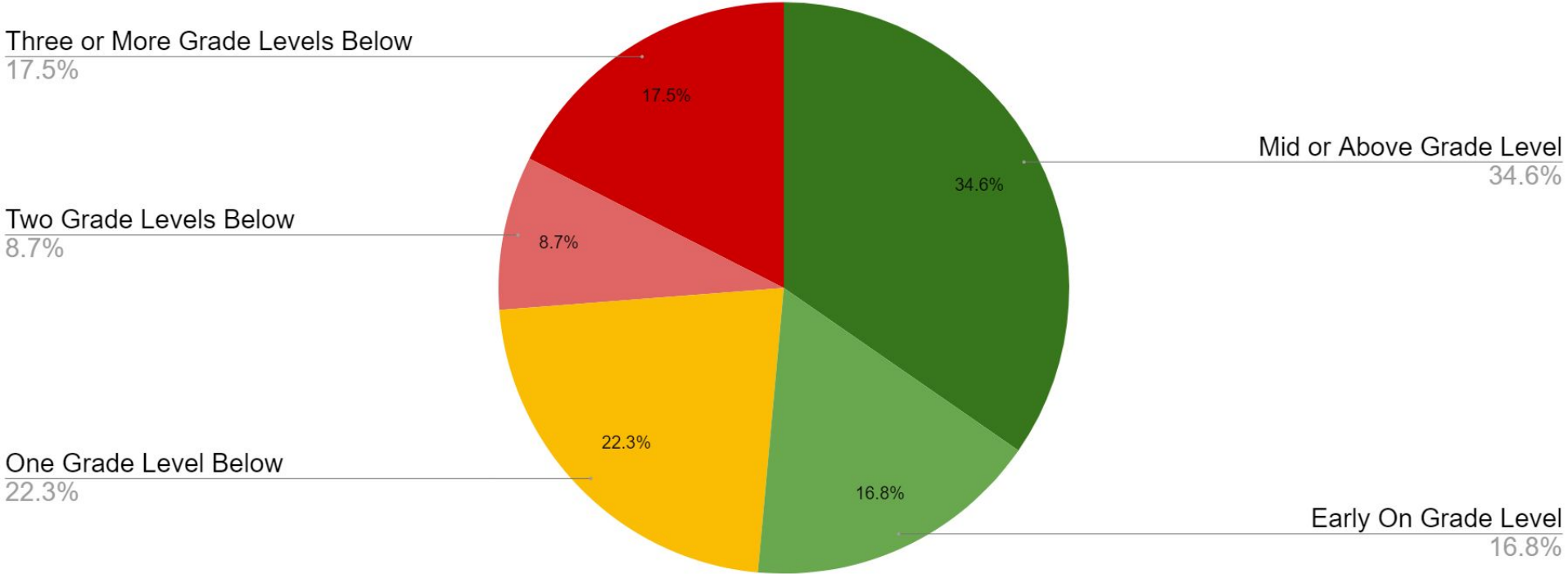

Individual Student Diagnostic Growth: Reading

Year-to-Date Growth

Progress to Annual Typical Growth

Scale Points: 34/19

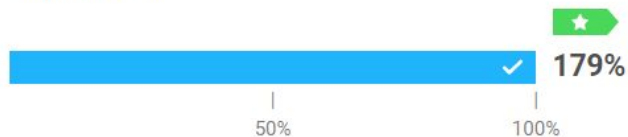

This student has made 179% progress toward Annual Typical Growth. Typical Growth is the average annual growth for a student at this grade and initial placement level.

Progress to Annual Stretch Growth

Scale Points: 34/51



This student has made 67% progress toward Stretch Growth. For students who are below grade level on their initial Diagnostic, Stretch Growth is an ambitious, but attainable, level of annual growth that puts them on a path to proficiency.

Overall Diagnostic Growth



†This Diagnostic used to establish Growth Measures.

Individual Student Opportunities for Growth: Comprehending Informational Text

Can Do

Identify cause-and-effect relationships.

Identify cause-and-effect relationships in Grade 3 literary or informational text.

Standards

Identify sequence of events.

Identify sequence of events in Grade 3 literary or informational text.

Standards

Next Steps & Resources for Instruction

- + [Extend understanding of making inferences.](#)
- + [Teach citing textual evidence. Explain that when readers make a point about a text in discussion or in writing, ...](#)
- + [Build knowledge of author's point of view and purpose.](#)
- + [Provide practice with interpreting an author's use of language. Choose examples of informational text with viv...](#)
- + [Develop understanding of main idea.](#)

iReady at LJHS: Grades 6-8 Fall 2020 Math

Percent of Students at Each Performance Level

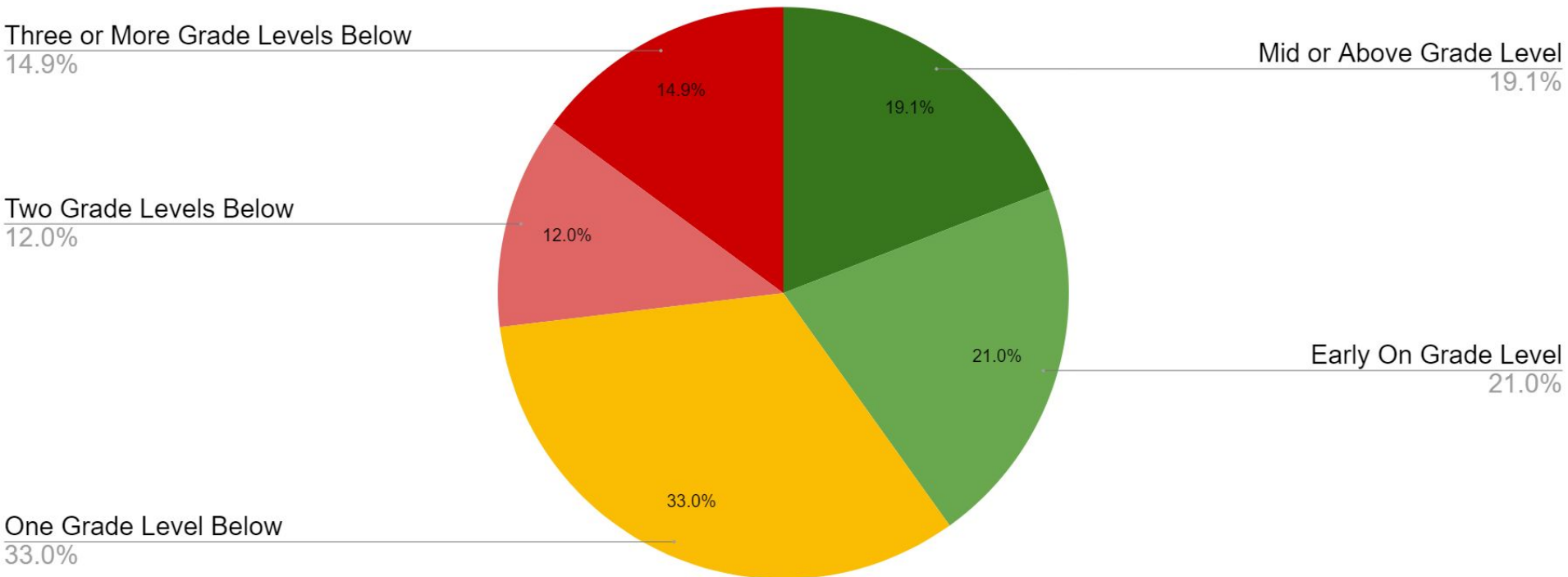

Individual Student Diagnostic Growth: Math

Year-to-Date Growth

Progress to Annual Typical Growth

Scale Points: 20/12

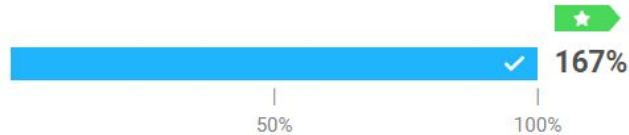

This student has made 167% progress toward Annual Typical Growth. Typical Growth is the average annual growth for a student at this grade and initial placement level.

Progress to Annual Stretch Growth

Scale Points: 20/23



This student has made 87% progress toward Stretch Growth. For students who are below grade level on their initial Diagnostic, Stretch Growth is an ambitious, but attainable, level of annual growth that puts them on a path to proficiency.

Overall Diagnostic Growth



Individual Student Opportunities for Growth: Algebra & Algebraic Thinking

Can Do

Operations and Algebraic Thinking

Solve one- and two-step real-world problems involving addition, subtraction, and multiplication of decimals.

Standards

Apply divisibility rules for 2, 3, 4, 5, 6, 9, and 10.

Standards

Describe, extend, analyze, and make generalizations about numeric patterns.

Standards

Next Steps & Resources for Instruction

Ratios and Proportional Relationships

- + [Solve problems involving unit rate.](#)
- + [Solve problems using ratio and rate reasoning.](#)

Expressions and Equations

- + [Write and evaluate numerical expressions with whole-number exponents.](#)
- + [Evaluate expressions for given values of the variables.](#)
- + [Write a variable expression to represent a real-world or mathematical problem.](#)

The logo features a stylized tiger's head in profile, facing right, rendered in a light blue color. The tiger has a striped pattern and is shown with its mouth open, revealing its teeth and tongue.

LISLE 2022

COMMUNITY UNIT SCHOOL DISTRICT

iReady: Reflection & Response

Next Steps

Professional
development
for teachers

Parent
education

Accountability
for students to
use iReady
lessons

Questions?

FOR INFORMATION

**Lisle Community Unit School District 202
Board of Education Meeting
January 25, 2021**

SUBJECT: Student In-Person/Remote Learning Plan Update

BACKGROUND DATA: The Administration will provide a brief overview of the District's operations since the last Board Meeting and answer Board Member questions.

FOR INFORMATION

**Lisle Community Unit School District 202
Board of Education Meeting
January 25, 2021**

SUBJECT: Freedom of Information Act Request

BACKGROUND DATA: The District received Freedom of Information Act request(s) from the following individual(s):

1. Kaza Rhan
2. Zoe Yalcin, smartprocure

The District will respond to all the request(s) within the required timeline.

From: **Kaza Rhan** <news@news.locallabs.com>
Date: Mon, Dec 14, 2020 at 6:44 PM
Subject: FOIA Request - Elected Boards and Officials
To: <mbuchholz@lisle202.org>

To whom it may concern,

I am writing to you on behalf of LocalLabs which is the publisher of Prairie State Wire, an online publication that reports on and informs the public about local government activities. We are requesting data on your elected boards and officials.

Additionally, we are requesting electronic (preferably non-PDF such as CSV, Excel, Txt) data with the following data points:

- 1) Name
- 2) Term start date
- 3) Term end date
- 4) Salary
- 5) Email Address

The purpose of the request is to access and disseminate information as a matter of public interest and is not for the principal purpose of personal or commercial benefit. I qualify as media under the definition in Section 2 (c-10) ("Commercial purpose"), Section 2 (f) ("News media"), Section 2 (g) ("Recurrent requester"), and Section 2 (h) ("Voluminous request") of the Freedom of Information Act, for the purposes of being exempt to the provisions of Section 3.1 (Requests for commercial purposes), Section 3.2 (Recurrent requesters), Section 3.6 (Voluminous requests), and Section 6 (Authority to charge fees). Therefore, I request you furnish any responsive documents and items without charge.

Thank you,

Kaza Rhan

Manager

LocalLabs

From: Zoe Yalcin <zyalcin@smartprocure.com>

Sent: Wednesday, January 6, 2021 3:11 PM

To: kfilipiak@lisle202.org

Subject: SmartProcure FOIA Request to Lisle Community Unit School District No. 202 For PO/Vendor Information

Dear Keith Filipiak,

SmartProcure is submitting a commercial FOIA request to the Lisle Community Unit School District No. 202 for any and all purchasing records from 09/30/2020 (mm/dd/yyyy) to current. The request is limited to readily available records without physically copying, scanning or printing paper documents. Any editable electronic document is acceptable.

The specific information requested from your record keeping system is:

- 1. Purchase order number. If purchase orders are not used a comparable substitute is acceptable, i.e., invoice, encumbrance, or check number
- 2. Purchase date
- 3. Line item details (Detailed description of the purchase)
- 4. Line item quantity
- 5. Line item price
- 6. Vendor ID number, name, address, contact person and their email address

If you would like to let me know what type of financial software you use, I may have report samples that help to determine how, or if, you are able to respond.

Please email or click on the button below to upload the information. There is no file size limitation:

[Click Here To Upload](#)

If this request was misrouted, please forward to the correct contact person and reply to this communication with the appropriate contact information.

If you have any questions, please feel free to respond to this email or I can be reached at the phone number below in my signature.

Regards,

Zoe Yalcin
Data Acquisition Specialist

SmartProcure

Direct: 9544209900

Email: zyalcin@smartprocure.com

Superintendent's Report – January 2021

Lisle Elementary School - We are pleased to share that at Lisle Elementary School, learning goes on...TOGETHER! The emotional impact of the pandemic has been different for different students and adults. In an effort to support ALL at LES, we have implemented the following:

1. Virtual Buddies - Classrooms are paired to do virtual activities together. For example, a Kindergarten class paired with a 3rd grade class will read books to each other, share their writing, play virtual games, etc... during a defined time that is collaboratively planned by the classroom teachers.
2. Teacher Buddies - The classroom teachers above are also buddied up to support one another, check in with each other and be a friendly support during these times.
3. LES Student Connections - Classroom teachers identified students who just needed a little extra support, time to talk, and/or guidance from an adult. The rest of the staff then chose one of these students to mentor. This adult serves as another school based adult, beyond their classroom teacher, in the life of this child in order to maintain a connection to school. We have 47 students being served by this. The list was filled immediately. Way to go LES teachers!

Lisle Junior High School - Teachers have continued to push themselves as virtual pedagogical trailblazers in order to best engage students in digital and hybrid environments. Teachers have become near experts on navigating Google Meets and have been able to use the new breakout room feature to allow students to collaborate in small groups including analyzing articles and breaking out further to share with classmates.

Students also have designed their own digital lessons to teach classmates about different vocabulary terms; the lessons were uploaded onto FlipGrid in order to allow students to watch and review each other's lessons.

Teachers have also dug in to our newest learning tech tool Kami. Kami allows students to be able to annotate, comment, and record themselves all within a PDF pushed out by the teacher. While more professional learning opportunities are in the works, many teachers and students have eagerly jumped in the sandbox to play and explore Kami and all it can offer.

The amount of learning our staff has done to meet the needs of students is immeasurable. Their dedication to students in these trying times is unmatched. We appreciate their work and are so proud of them.

Lisle High School - On Tuesday, Jan 12th, the Lisle High School DECA students competed in a DECA Sectional vs Elmwood Park, Geneva, and Timothy Christian. They took a content area exam (100 questions) and performed a role play before judges. For the role play, students were presented with a real-world business problem, given 30-minutes to prepare, then presented their solution to the judges.

We are pleased to share that the following students qualified for the State Competition. To qualify, students needed to place in the top 3 in their content area.

- Emma F. and Alexa T., 1st Place, Hospitality Services
- Lia D. and Maya S., 1st Place, Travel and Tourism
- Hannah B. and Tori S., 1st Place, Buying and Merchandising
- Ben F. and James H., 2nd Place, Financial Services
- Kylie R. and Faith V., 2nd Place, Buying and Merchandising
- Connor G., 3rd Place, Personal Financial Literacy
- Brady C. and Connor E., 3rd Place, Sports and Entertainment Marketing

Additional DECA team members competing included:

- Christian S. and Andrew S., Hospitality Services
- Bradley K. and Samantha R., Travel and Tourism

The 2021 DECA State Competition will take place during both the last week in January (content area exam) and first week in February (role play). Everything is virtual.

HSO Council Meeting Agenda January 20, 2021

IN ATTENDANCE:

CALL TO ORDER:

APPROVAL OF MINUTES:

SUPERINTENDENT REPORT: Keith Filipiak

SCHOOL BOARD LIAISON:

PRESIDENT REPORT: Laura Tchakanakis

TREASURER REPORT: Katie Candler

CORRESPONDING SECRETARY REPORT: Jennifer Zink

RECORDING SECRETARY REPORT: Kathy Gill

OPEN FORUM:

UNIT DELEGATE REPORTS:

Elementary:

Junior High:

High School:

COMMITTEE REPORTS

FLOWER SALE

DIRECTORY

AWARDS

5K FUN RUN/WALK

UNFINISHED BUSINESS

NEW BUSINESS

Meeting adjourned

****Next meeting date: March 17, 2021****

HSO Council Meeting Minutes October 21, 2020

IN ATTENDANCE: Laura Tchakanakis, Jennifer Zink, Rebecca Harris, Irene Evert, Katie Candler, Health Tumbarelli, Mary Ebert, Dena Klein, Keith Filipiak, Sharon Helderie, Pam Ahlmann, Anne Blaske, Raquel Waggoner, Kathy Gill

CALL TO ORDER: Laura Tchakanakis called the meeting to order at 7:02pm

APPROVAL OF MINUTES:

Jen Zink made motion to approve minutes, Katie Candler seconded motion

SUPERINTENDENT REPORT: Keith Filipiak

- Many questioning will we go remote
- Students coming in at elementary level
- Junior high will be starting
- High school started
- Feedback from students is excitement to be in school
- 43 Dupage County Superintends talked
 - DuPage County Health Department has information about the number of positive cases as well as percent of tests coming back positive.
 - Looked specifically at Lisle - 5 positive cases per day.
 - Will look at DuPage and Lisle numbers.
 - Some are saying schools may be the safest place to be.
 - Difficult to change back and forth for families.
 - Goal is that if it feels like getting close to closing - give families advance notice.
 - In DuPage county districts are not all doing the same thing
 - Will update numbers of positive (staff and students) and number of students quarantined and this available to the public.
 - There is no exact number that will indicate moving to remote, will look for trends, numbers, and pockets.
 - Showed council group the DuPage County Metrics charts that will be sent home
 - If new symptom in child then should keep home

SCHOOL BOARD LIAISON: Pam Ahlmann

- Thanking HSO for communication efforts at every level
- Kudos for continuing fund raisers
- Mum sale was fantastic
- National Merit Scholars
- Want to hear feedback on webinars
- Amy Park received award
- News from USDA - free lunch will be provided until the end of the year

PRESIDENT REPORT: Laura Tchakanakis

- E-mailed the minutes
- Each unit president should have received e-mail with commonly used forms
- Still have opening for Vice President
- Thank you to Unit Board for representing HSO in positive manner
- Thank you to Rebecca Harris and Anne Blaske for directory
- Anne Blaske volunteered to chair awards committee
- Thank you to Katie Candler treasurer - putting in a lot of work as well as past treasurers helping
- Thank you to district and school board for getting students back into classroom

TREASURER REPORT: Katie Candler

- See attached report
- Enrollment at schools - figured out allocations
- Katie Candler went through report
- Unusual budget this year
- Suggestion to make a motion to provisionally approve budget - revisit in January 2021
- Anne Blaske made a motion, Jen Zink seconded motion

CORRESPONDING SECRETARY REPORT: Jennifer Zink

Nothing to report

RECORDING SECRETARY REPORT: Kathy Gill

Please send reports to Kathy Gill to include in the minutes

OPEN FORUM:

None

UNIT DELEGATE REPORTS:

Elementary: Heather Tumbarelli

Lehso Meeting Notes from Oct 7th

- Restaurant Nights
 - new this year, they will be district wide
 - Portillos - 10/21 5-8pm
- Book Fair
 - ONLINE ONLY through Anderson's - November 2nd - 6th
 - Get books to kids before Thanksgiving
 - All online. Several shipping options (ship to you \$\$, ship to store \$0, ship to school \$0)
 - Anything over \$3500 Anderson's donates 25%

- Brainstorm ideas for Spring Resale
- Market Day
 - Bring Market Day back 10% of sales goes to LEHSO. Lauren Clavelli will look into it further.
- Virtual Parent Nights
 - Save the date 10/21 and 12/3 with the Collective
 - 10/21 - Fall Watercolor - \$23 <https://the-collective-lhe.myshopify.com/products/lehso-private-watercolor-ink-fall-tree>
 - 12/3 - Small Holiday Greeting Sign - \$25
 - Chicago Pizza and Culinary Academy -Pizza Night
 - Zoom Cupcake night
 - Halloween Costume Parade / COVID friendly Halloween event

Junior High: Raquel Pedraza

- Mr Cerney spoke at meeting to talk about schedule and welcoming kids into school
- Will start on Friday this week
- 85% capacity
- Working toward concurrent model
- Dr. Copeland leaving
- Lost 4 teachers due to medical leave
- Looking into gift cards for sale/fundraiser
- Talked about Trivia Night November 6

High School Mary Ebert

- Mr Howard spoke about the importance of communication and streamlining the messages. He said they are still planning for a hybrid or blended plan but it will be a slow transition. The learning for life students are coming to the building every day except for Wednesdays and it has been a positive experience having them in the building. They may start bringing some classes in as needed (i.e. science labs, wood class, art)
- Seniors will be coming into the building on September 23rd to take the SAT test. They are offering remote SAT prep for Seniors at this time. The Junior SAT schedule looks like it normally does with the PSAT being offered in October and prep opportunities prior to the SAT test that is hopefully going to take place in April.
- The IHSA is allowing contact days for off season sports and you can attend if you are not participating in a Fall sport. The sports are broken into three sessions and are listed in the Principal's weekly message.
- Mr Howard reminded us that the teachers update their weekly agenda/plans and post them on the school website. Someone asked if someone could post the link on the HS HSO Facebook page as well for those that frequently follow this page.
- Jen Lauerman asked if we could provide a treat or something for the teachers as a gesture of appreciation for all they are doing as we start the school year. Mr Howard said it would have to be individually wrapped items and the Administration could assist with the distribution.

- Dena reported that the HSO was able to offer 16 students scholarships in the amount of \$750 each.
- The Fall Mum sale is doing really well and the pick-up is on Saturday, September 26th. There will be extras available to purchase on the pick-up day.
- We discussed whether we should approach local businesses for restaurant nights. Jen Lauermann mentioned that the owner of Sizzaly seems interested in doing something as a new business in town. Lanie researched Meal Village as a possible restaurant night. We also plan to do the Nothing Bundt Cake fundraiser in the Spring.
- The next meeting is on October 6th at 7:00

COMMITTEE REPORTS

FLOWER SALE - Still selling stones

DIRECTORY - Rebecca said a lot of work, should be out next week

Talked about emailing parents about joining HSO

AWARDS - Anne Blaske is chairing this committee

5K FUN RUN/WALK Going to be a virtual event - there are a lot of options including prizes, pictures, voting, etc.

UNFINISHED BUSINESS

- Membership dues
 - JH has 35 (350\$)
 - Will follow up with Elementary and High School

NEW BUSINESS

None

Meeting adjourned 8:25pm

****Next meeting date: January 20 2021****

LISLE HSO COUNCIL TREASURER'S REPORT

September 14, 2020

1. The cash balance as of 09/14/20 is \$8157.95
2. \$12,000 in scholarships were awarded to 16 seniors from the Class of 2020 in the amount of \$750 each.
3. Income/Expense items to note:
 - The Flower Sale was extremely successful! After expenses, the net profit was \$3,391.96
 - Total membership collected for 2019-2020 was \$3,286.40
 - 50% of membership remains with Council; the other 50% is split among the other 3 Units.

2019-2020 District Enrollment			
School	# Students	Membership Allocation	Amount to Distribute
LES	674	48%	\$807
LJH	252	16%	\$260
LHS	476	36%	\$607
Total	1400	100%	\$1674

4. Audits for the 2019 – 2020 school year have been completed for each unit.
5. Unit Presidents or Treasurers, please check with your school and collect any memberships (family/staff) so that they can be deposited.

LISLE HSO COUNCIL TREASURER'S REPORT
January 20, 2021

- 1) The cash balance as of 1/20/2021 is \$8,945.02
- 2) Income/Expense items to note:
 - a) Membership
 - i) Amount collected for 2020-2021 school year is \$1,670.
 - ii) The following staff dues have been deposited:
 - (1) LES - \$0 lump sum from admin (there have been 12 individual faculty signups online)
 - (2) LJHS - \$0
 - (3) LSHS - \$390 (plus 6 individual faculty signups)
 - iii) 50% of membership remains with Council; the other 50% is split among the other 3 Units.

2020-2021 District Enrollment			
School	# Students	Membership Allocation	Amount to Distribute
LES	665	47%	\$392.45
LJHS	309	22%	\$183.70
LSHS	428	31%	\$258.85
Total	1,402	100%	\$835.00

- b) The modified proposed budget for the 2020-2021 School Year is as follows:

REVENUES		EXPENSES	
Membership	\$1,800	Membership	\$900
Installation Dinner	\$0	Installation Dinner	\$0
Scholarships	\$5,000	Scholarships	\$10,000
Memorials	\$0	Memorials	\$0
Interest	\$10	Administrative	\$50
Flower Sale	\$8,000	Flower Sale	\$5,000
Miscellaneous	\$0	Filing Fees	\$200
Donations	\$0	5K/Fun Run	\$500
5K/Fun Run	\$1,840		
TOTAL = REVENUES - EXPENSES = \$0			

- 3) The old Sales Tax Exemption certificate expired January 1, 2021. We have a new certificate that expires in February 1, 2026. I should be receiving a paper copy any day now, and will scan and forward to unit treasurers as soon as I receive it.

LEND Updates

January 22, 2021

Submitted by: Pam Ahlmann

Criminal Justice and Police Reform

- HB 3653 (Sims) passed the General Assembly bringing changes to police training policies, police accountability, transparency in law enforcement and the rights of detainees and prisoners.
- There was no inclusion of language to remove SROs from public schools.
- Passed both chambers.

Senator Gillespie presented the Seclusion Time Out Restraint legislation:

Seclusion Time Out Restraint

- The bill passed the Senate but was stalled in the House.
- The sponsors of the bill (Representative Carrol and Senator Gillespie) will move the language again in the spring.
- This is a negotiated bill vetted by special education cooperatives in DuPage.

102nd General Assembly

History was made with the election of a new Speaker of the House. Speaker Emanuel "Chris" Welch takes the gavel as the first Black Speaker of the House ever elected in Illinois. This action ended the historic tenure of now Former Speaker Michael Madigan, as the longest serving speaker in history.

Congratulations to all elected officials sworn in on January 13th.

Welcome to newly elected DuPage legislators:

- Senator Karina Villa (previously our State Representative)
- Senator John Connor (previously our State Representative)
- Senator Dee Avaral
- Representative Janet Yang-Rohr
- Representative Seth Lewis
- Representative Maura Hirschauer

LEND Council Zoom Meeting, Friday, 1/22/2021

LEND welcomed DuPage elected officials for an introduction on what we can expect for the Spring 2021 session.

Both chambers have a full session calendar and new bills are being introduced daily; the Senate will be back 2/8; still meet remotely every week.

- House Republican Leader Jim Durkin - Expressed that any changes to EBF need to come with study and explanations; 300 new bills have already been introduced and probably another 5,000 bills will be coming; State faces a deficit of nearly \$3 billion; Covid has a big impact on all states; budget issues will be massive; hope for bi-partisan agreement on House rules
- Senator John Curran
- Senator Tom Cullerton
- Senator Laura Ellman

- Senator Laura Murphy - Represents mostly Cook county but some DuPage; e-learning will not be the solution; path out will not be additional taxes; hopeful for federal help; not a fan of changing EBF at this time
- Senator Karina Villa - Former elementary teacher; looking at SEL standards with an emphasis on equity; and trauma informed curriculum.
- Representative Amy Grant - Expressed concerns with unfunded mandates; AIM scholarship program formula; and duplication
- Representative Terra Costa Howard - Emphasized the need to tone down rhetoric and lead by example; former school board member; need to represent all not just the vocal minority; let EBF settle before changing; advocate of public education
- Representative Maura Hirschauer
- Representative Seth Lewis - Dedicated to education; focus on getting dollars to students and the learning environment
- Representative Deanne Mazzochi - Concerned that new teacher certifications look more at ideology than experience; will reintroduce unfunded mandates bill; restorative justice needs to focus on behavior in relation to violence; feels Covid vaccine is not a panacea; supports in school learning
- Representative Anne Stava- Murray
- Representative Michelle Mussman - Education Committee - Looking at how to bring in new resources and revenue
- Representative Kathleen Willis - Believes academic equity is critical; spent 12 years on her local school board; early childhood education saves in the long term
- Representative Janet Yang Rohr - Recent D203 school board member; D203 graduate; represents D203, D204 and D200; supported D203 resolutions relating to PTELL and election day as an e-learning day
- Dr. Darlene Ruscitti, DuPage Regional Office of Education - HB 2170; focus on equity in education and recruiting, hiring and retention; "acceleration of learning" rather than "learning loss"; concerns with truancy and language barriers; rise in work permits by 15 year olds; micro-credentials and how to demonstrate competencies.

**LISLE EDUCATION FOUNDATION OF LISLE SCHOOL DISTRICT 202
BOARD OF DIRECTORS MEETING
JANUARY 13, 2021 MINUTES**

The meeting of the Board of Directors of the Lisle Education Foundation for the Lisle School District 202 met via Zoom on Wednesday, January 13, 2021. The meeting was called to order at 12:04 p.m. by Jane McGrath. Also in attendance at the meeting were: Keith Filipiak, Marilyn Buchholz, Eunice McConville, Dr. Eric Williams, Amish Patel, Deb Pawlowicz, Keith Krestan, Matt Minnerick and Michael Shuta. Absent: Linda Kotalik, Dennis Webb and Pamela Ahlmann.

Eunice McConville made a motion to approve the November 11, 2020 Minutes. Jane McGrath seconded the motion. All present voted aye.

Treasurer's Report

Eunice McConville reported that as of December 31, 2020 available fund balance is \$163,166.55.

- There is still \$420 outstanding, that was the deposit for Medieval Presentation at Lisle Jr. High School. This money was not refunded; but carried over to the 2020-2021 school year program. If program does take place in the 2020-2021 school year, the deposit will be used. If the program does not take place in the 2020-2021 school year, the funds will not be reimbursed.
- Eunice also reported that \$155 was donated to the Lisle Education Foundation from body work done at Midwest Auto Body of Lisle.

Jane McGrath made a motion to approve the December 31, 2020 Treasurer's Report. Deb Pawlowicz seconded the motion. All present voted aye.

Grant Requests

- Grant Application submitted by Katherine Braun, Lisle Jr. High School, English Instructor, is requesting funding for the spring 2021 publication of Inspire was discussed. After discussion, Dr. Eric Williams made a motion to approve the publication, not to exceed \$2,750. Deb Pawlowicz seconded the motion. Matt Minnerick abstained from voting. All others present voted aye.
- Board members were impressed with the 2020 edition. Jane McGrath asked if the publication can acknowledge the Lisle Education Foundation's donation and also add Allegra's logo on the publication.

Golf Outing

- Save the Dates will be mailed out the first week of February.
- Golf Invite website is ready to go
- Paypal has been set up to accept payments in the Golf Invite website

New Business

- Eunice McConville noted that Amish Patel emailed her and Marilyn Buchholz in December regarding an online donation company, Guidestar. The Lisle Education Foundation would set up an account and then customers would have a chance to choose the Lisle Education Foundation to make a charitable donation. Eunice will research this company and report back at the February meeting.

Adjourn

- Dr. Eric Williams made a motion to adjourn the meeting; Deb Pawlowicz seconded the motion. All present voted aye. The meeting was adjourned at 12:35 p.m.
- The next meeting will be held on Wednesday, February 10, 2021 via Zoom.

Respectfully submitted,
Marilyn Buchholz