

Wausau School District
Board of Education Meeting Agenda
In Compliance with the Wisconsin Open Meeting Law

James Bouché, President
Public Notice s.19.84 (3)

Cory Sillars, Clerk
Exemptions s.19.85

A **Regular Meeting** of the BOARD OF EDUCATION will be held in the **Horace Mann Middle School Library, 3101 North 13th Street, Wausau, WI 54403** at **5:00 PM** on **Monday, November 10, 2025.**

I. CALL TO ORDER

II. ROLL CALL

III. PLEDGE OF ALLEGIANCE: Jim Bouché, President

IV. READING OF THE MISSION STATEMENT

V. RESOLUTION OF COMMENDATION: JT Michlig (**Action Requested**)

VI. EXCELLENCE IN ACTION: Horace Mann Middle School

VII. EXCELLENCE IN ACTION: Wausau Area Montessori Charter School

VIII. PUBLIC AND STUDENT COMMENT

IX. APPROVE CONSENT AGENDA (**Action Requested**)

IX.A. Appointments (Additional Staff, Replacement Staff, Contract Increases)

IX.B. Separations (Resignations, Contract Decreases, Terminations)

IX.C. Leaves of Absence

IX.D. Retirements

IX.E. Minutes: Regular Session of October 13, 2025; and the Special Session of October 27, 2025.

IX.F. Payment of Bills/Budget Status and Investment Report

IX.G. Donations to the District

X. OLD/RECURRING BUSINESS

X.A. Education/Operations Committee Meeting

X.A.1. Legal Expense Summary for 1st Quarter

XI. NEW BUSINESS

XI.A. Riverview Design Presentation

XI.B. Committee Structure / Name

XI.C. Audit of the Bills Procedure

XI.D. Education/Operations Committee Meeting

XI.D.1. Activities Code Update (**Action Requested**)

XI.D.2. Student Fees (**Action Requested**)

XI.D.3. Course Approval (**Action Requested**)

XII. OPEN FORUM

XII.A. Board Member Professional Growth & Development Report

XII.B. Legislative Liaison

XII.C. Superintendent Commentary

XII.D. Presiding Officer Commentary

XIII. ADJOURN

*** Following the adjournment of the meeting, the public is welcome to join the Board and Administration on a tour of the recent updates to Horace Mann Middle School and Wausau Area Montessori Charter School. A quorum of the Board will be present; however, no official Board action will occur. ***

NOTICE POSTED: Friday, November 7, 2025, at 2:15 pm

By: Cassie Peck

NOTICE SENT TO:

WSAU WSAW-TV WAOW-TV WJFW-TV CITY PAGES WAUSAU PILOT & REVIEW SCHOOLS WAUSAU DAILY HERALD WAAM CITY HALL COURTHOUSE PUBLIC LIBRARY

The Wausau School District does not discriminate on the basis of race, age, color, religion, national origin, ancestry, creed, pregnancy, marital status, parental status, sexual orientation, sex (including transgender status, change of sex, or gender identity), or physical, mental, emotional, or learning disability ("Protected Classes")



Resolution of Commendation

November 10, 2025

The Resolution of Commendation Committee recommends the following individual for recognition:

Jeffrey Michlig

Jeffrey is a sophomore at Wausau East High School and was nominated by Glenn Peters for the Resolution of Commendation. He is being recognized for his outstanding dedication and contributions to the Wausau East Auditorium lighting team. Jeffrey has devoted countless hours to ensure each performance was supported with professional, effective, and artistic lighting design. His hard work and commitment have not gone unnoticed.

Congratulations Jeffrey!

The background features a warm, autumnal theme. At the top right, there is a tree branch with several maple leaves in shades of orange, red, and yellow. A single leaf is also shown falling from the branch. The bottom of the image is filled with a dense field of golden-brown grass. The overall color palette is soft and seasonal, with a light beige background.

Horace Mann Excellence in Action

Dr. Rob Phelps

Nov. 10, 2025

School Report Card Review



17-18

Exceeds Expectations

21-22

Exceeds Expectations

18-19

Exceeds Expectations

22-23

Meets Expectations

19-20

No School Report Card

23-24

Exceeds Expectations

20-21

Exceeds Expectations

24-25

Find out tomorrow (11/11/25)

How?



$$(A + R) + TL = S^2$$

Attendance and Relationships +
Teaching/Learning = Student Success

Staff and Students





Thank You

WAUSAU SCHOOL DISTRICT
HUMAN RESOURCES

TO: Board of Education
 FROM: Tabatha Gundrum
 MEETING: November 10, 2025
 SUBJECT: Staffing Consent Agenda

The Administration respectfully asks that the Board of Education approve the following staffing changes pertaining to the Consent Agenda:

APPOINTMENTS (Additional Staff, Replacement Staff, Contract Increases):

		TEACHING STAFF	
NAME	BUILDING	POSITION	EFFECTIVE DATE

		ADMINISTRATIVE STAFF	
NAME	BUILDING	POSITION	EFFECTIVE DATE

SEPARATIONS (Resignations, Contract Decreases, Terminations):

		TEACHING STAFF	
NAME	BUILDING	POSITION	EFFECTIVE DATE

		ADMINISTRATIVE STAFF	
NAME	BUILDING	POSITION	EFFECTIVE DATE

LIMITED TERM CONTRACTS:

		TEACHING STAFF	
NAME	BUILDING	POSITION	EFFECTIVE DATE

		ADMINISTRATIVE STAFF	
NAME	BUILDING	POSITION	EFFECTIVE DATE

LEAVES OF ABSENCE:

		TEACHING STAFF	
NAME	BUILDING	POSITION	EFFECTIVE DATE

		ADMINISTRATIVE STAFF	
NAME	BUILDING	POSITION	EFFECTIVE DATE

RETIREMENTS:

		TEACHING STAFF	
NAME	BUILDING	POSITION	EFFECTIVE DATE
Timothy Kostroski	Wausau West HS	1.0 FTE, Health & Physical Education Teacher	06/08/2026

		ADMINISTRATIVE STAFF	
NAME	BUILDING	POSITION	EFFECTIVE DATE

WAUSAU SCHOOL DISTRICT
HUMAN RESOURCES

TO: Board of Education
FROM: Tabatha Gundrum
MEETING: November 10, 2025
SUBJECT: Staffing Consent Agenda ADDENDUM

The Administration respectfully asks that the Board of Education approve the following staffing changes pertaining to the Consent Agenda:

APPOINTMENTS (Additional Staff, Replacement Staff, Contract Increases):

		TEACHING STAFF	
NAME	BUILDING	POSITION	EFFECTIVE DATE

		ADMINISTRATIVE STAFF	
NAME	BUILDING	POSITION	EFFECTIVE DATE

SEPARATIONS (Resignations, Contract Decreases, Terminations):

		TEACHING STAFF	
NAME	BUILDING	POSITION	EFFECTIVE DATE

		ADMINISTRATIVE STAFF	
NAME	BUILDING	POSITION	EFFECTIVE DATE

LIMITED TERM CONTRACTS:

		TEACHING STAFF	
NAME	BUILDING	POSITION	EFFECTIVE DATE

		ADMINISTRATIVE STAFF	
NAME	BUILDING	POSITION	EFFECTIVE DATE

LEAVES OF ABSENCE:

		TEACHING STAFF	
NAME	BUILDING	POSITION	EFFECTIVE DATE

		ADMINISTRATIVE STAFF	
NAME	BUILDING	POSITION	EFFECTIVE DATE

RETIREMENTS:

		TEACHING STAFF	
NAME	BUILDING	POSITION	EFFECTIVE DATE
Betsy Stangel	Wausau East HS	1.0 FTE, Math Teacher	06/08/2026
Collette Brown	Franklin Elementary	1.0 FTE, EL Teacher	06/08/2026

		ADMINISTRATIVE STAFF	
NAME	BUILDING	POSITION	EFFECTIVE DATE
Shannon Young	EEA	0.5 FTE Principal; 0.5 FTE School Counselor	06/30/2026
Karen Fochs	District/MOB	1.0 FTE, Director of Nutrition Services	06/30/2026

Minutes of REGULAR MEETING

The Board of Education Wausau School District

DRAFT

A Special Meeting of the Board of Education of the Wausau School District was held Monday, October 27, 2025, beginning at 5:15 PM in the Nicholson Board Room, 415 Seymour Street, Wausau, Wisconsin 54403.

Present: James Bouche; Sarah Brock; Charles Burger; Jon Creisher; Nick Crochiere; Pat McKee; Jennifer Paoli; Cory Sillars; and Lance Trollop.

I. CALL TO ORDER

The meeting was called to order at 5:27 pm.

II. APPROVE CONSENT AGENDA (Action Requested)

A. Appointments (Additional Staff, Replacement Staff, Contract Increases)

Jennifer Krueger (Special Education Teacher/Franklin) 1.0 FTE, effective 11/3/25.

B. Separations (Resignations, Contract Decreases, Terminations)

C. Leaves of Absence

D. Retirements

Pat McKee moved to approve the consent agenda, seconded by Jennifer Paoli.

The motion carried 9-0.

III. Adopt Final 2025-26 Budget (Action Requested)

Lance Trollop moved to approve the final 2025-26 budgets as presented below:

Fund 10: Expense \$117,577,935 (\$107,505,312 plus transfers to Funds 27 and 38)

Revenue \$117,577,935

Fund 27: \$20,234,845 (\$10,193,544 plus transfer from fund 10)

Other Fund 20: \$3,125,000

Fund 30: Expense \$20,154,168 Revenue \$20,038,121

Fund 40: Expense \$29,873,069 Revenue \$1,510,000

Fund 50: Expense \$5,374,233 Revenue \$5,111,000

Fund 80: \$1,575,653 (levy, fees, and carryover), seconded by Sarah Brock. The motion carried 9-0.

IV. Adopt Final 2025-26 District Levy (Action Requested)

Sarah Brock moved to adopt a final tax levy of \$44,385,527 representing

\$23,255,150 for the General Fund, \$20,038,121 for the Debt Service Funds, and

\$1,092,000 for the Community Service Fund, seconded by Charles Burger. The motion carried 9-0.

V. 2026 WASB Delegate (Action Requested)

Lance Trollop moved to recommend Jon Creisher as the 2026 WASB Delegate and Sarah Brock as the Alternate Delegate, seconded by Charles Burger. The motion carried 9-0.

VI. ADJOURN

Pat McKee moved to adjourn, seconded by Charles Burger. The motion carried at 5:41 pm.

Respectfully Submitted,

Cory Sillars,
Board Clerk

CS:cp

Minutes of REGULAR MEETING

The Board of Education Wausau School District

DRAFT

A Regular Meeting of the Board of Education of the Wausau School District was held Monday, October 13, 2025, beginning at 5:00 PM in the Wausau East High School Auditorium, 2607 N. 18th Street, Wausau, WI 54403.

Present: James Bouche; Sarah Brock; Charles Burger, Jon Creisher arrived at 5:02 pm; Nick Crochiere; Pat McKee; Cory Sillars; Lance Trollop.

Absent: Jennifer Paoli;

I. CALL TO ORDER

The meeting was called to order at 5:00 pm.

II. ROLL CALL

Ms. Peck read the roll call.

III. PLEDGE OF ALLEGIANCE: Jim Bouché, President

President Bouche led everyone in the Pledge of Allegiance.

IV. READING OF THE MISSION STATEMENT

President Bouche read the mission statement.

V. INDIGENOUS PEOPLES DAY PROCLAMATION

President Bouche read the Indigenous Peoples Day Proclamation.

VI. EXCELLENCE IN ACTION: Wausau East High School

Wausau East Principal, Lucas Barth, and students from Wausau East gave a brief presentation.

VII. EXCELLENCE IN ACTION: Franklin Elementary

Franklin Elementary Principal, Krista Tretter, provided a brief presentation.

VIII. PUBLIC AND STUDENT COMMENT

There was none.

IX. **APPROVE CONSENT AGENDA (Action Requested)**

A. Appointments (Additional Staff, Replacement Staff, Contract Increases)

B. Separations (Resignations, Contract Decreases, Terminations)

C. Leaves of Absence

D. Retirements

E. Minutes: Regular Session of September 8, 2025; Special Session of September 16, 2025; Special Session of September 22, 2025; and Special Session of September 29.

- F. Payment of Bills/Budget Status and Investment Report
- G. School Board Member Salaries
- H. Donations to the District

Cory Sillars moved to approve the consent agenda with great gratitude for donations to the District, seconded by Lance Trollop. The motion carried 7-0.

X. The Wausau School Board will be conducting interviews with qualified elector(s) of the Wausau School District to fill a vacancy to the Wausau School Board. This vacancy is for an unexpired term and will be for a term commencing on October 13, 2025, and running through April 26, 2026.

- A. Cody Nikolai – Withdrew his candidacy.
- B. Charles Burger – made brief comments and had comments made on his behalf.
- C. Michelle Gleason – made brief comments and had comments made on her behalf.
- D. John Huntington – made brief comments.

XI. The Board of Education may entertain a motion to convene in closed session, pursuant to s. 19.85(1)(f). Following the closed session, the Board may entertain a motion to reconvene into open session and may take further action if necessary/and or appropriate.

The Board did not go into closed session.

XII. Discussion and potential action to appoint a qualified elector of the Wausau School District to fill a vacancy to the Wausau School Board. The vacancy is for an unexpired term and will be for a term commencing on October 13, 2025, and running through April 26, 2026.

Board members voted via written ballot. Superintendent Bushman and Ms. Peck tallied the votes and Charles Burger was announced as the winner.

XIII. Swear in New Board Member

Ms. Peck swore in Charles Burger and Mr. Burger took his seat.

XIV. OLD/RECURRING BUSINESS

A. Consolidation Update

Dr. Katie Colwell, Diana White, Ralph Williams and Julie Schell gave a brief presentation.

B. Building Sale Update

Josh Viegut provided an update on the sale of Hawthorn Hills, Hewitt Texas, and Grant elementary schools.

C. Education/Operations Committee Meeting

There was none.

XV. NEW BUSINESS

A. Education/Operations Committee Meeting

1. Primary Care Clinic (**Action Requested**)

Cory Sillars approved to enter into a contract for a Direct Primary Care clinic with Anovia, seconded by Sarah Brock. The motion carried 7-0-1 with Lance Trollop abstaining.

2. District ACP Plan (Action Requested)

Lance Trollop moved to approve of the Wausau School District 2025-26 Education for Employment (E4E) and Academic Career Plan (ACP), seconded by Cory Sillars. The motion carried 8-0.

XVI. OPEN FORUM

A. Board Member Professional Growth & Development Report

There was none.

B. Legislative Liaison

Mr. Sillars shared that the Senate was not currently in session. He also shared that nothing related to education was on the schedule for the assembly the following day.

C. Superintendent Commentary

Mr. Bushman thanked the candidates for their willingness to serve. He also thanked the Board and wished them a Happy School Board Appreciation week.

D. Presiding Officer Commentary

The Board Liaison report for the month of October is as follows: Lance Trollop visited South Mountain Elementary, toured the CARE program, and attended the Wausau West Homecoming Assembly.

XVII. ADJOURN

Charles Burger moved to adjourn, seconded by Cory Sillars. The motion carried at 6:45 pm.

*** Following the adjournment of the meeting, the public was welcome to join the Board and Administration on a tour of the recent updates to Wausau East. A quorum of the Board was present; however, no official Board action occurred. ***

Respectfully Submitted,

Cory Sillars,
Board Clerk

CS:cp

WAUSAU SCHOOL DISTRICT
APPROVAL OF BILLS

Education/Operations Committee of the Whole - October 27, 2025
Board Meeting - November 10, 2025

25-26 Budgets
September 16, 2025 to October 20, 2025

Vouchers 1066400-1066605, 202500059, 252600828-252601539

General Fund - Fund 10	\$1,735,406.03
Grants - Fund 11	\$73,915.58
Federal Projects Fund - Fund 20	\$7,430.28
Special Education - 27	\$49,409.93
Food Service Fund - Fund 50	\$368,926.37
Trust Funds - Fund 72	\$3,640.00
Community Service Fund - Fund 80	\$38,159.69
Total	\$2,276,887.88

Vouchers 1066403,1066543,252600947, 252601105-25601107, 252601411-12, 252601538-39

Capital Projects - Fund 49	\$628,831.48
Total	\$628,831.48

WAUSAU SCHOOL DISTRICT

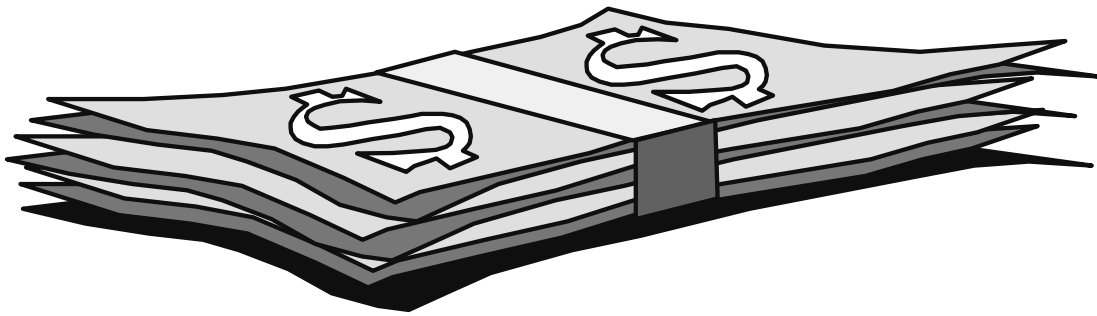

BUDGET STATUS REPORT

Month Ending

October 31, 2025

INVESTMENT PORTFOLIO
October 31, 2025

<u>INSTITUTION</u>	<u>BALANCE</u>	<u>RATE</u>
Associated Bank	14,963,567.89	0 to 3.2%/variable
BMO Financial Group	4,728,126.91	variable
CoVantage Credit Union	7,052.62	.645% to .745%
State of Wisconsin Investment Pool	6,866.84	4.39%
Wisconsin Investment Series Cooperative	35,800,223.11	4.173-4.296%

BALANCE SHEET

October 31, 2025

ASSETS

General Fund	\$7,477,882.58
Special Projects Fund	\$155.00
Community Services Fund	\$202,811.50
Special Education	(\$4,873,725.64)
Food Service Fund	\$1,600,388.24
Scholarships/Donations/Activity Accounts	\$2,242,600.87
HRA Account	(\$12,195.45)
Trust Funds - OPEB	\$4,728,126.91
Petty Cash Fund	\$249.00
Investments	
General Fund	\$12,079,167.20
Debt Service Fund	\$8,685,997.89
Long Term Capital Improvement Trust Fund	\$4,767,393.37
Capital Projects Fund	<u>\$21,563,642.91</u>
Interest Receivable	\$543.63
Taxes Receivable	\$0.04
Accounts Receivable	(\$760,309.62)
Prepaid	\$0.00
<u>TOTAL ASSETS</u>	<u><u>\$57,702,728.43</u></u>

LIABILITIES

Line of Credit	\$0.00
Salaries and Benefits Payable	\$1,699,136.61
Accrued Interest Payable	\$0.00
Accounts Payable	\$440,809.67
<u>TOTAL LIABILITIES</u>	<u><u>\$2,139,946.28</u></u>

EQUITY - FUND BALANCE

General Fund Balance	\$11,899,322.21
Federal Programs Balance	\$0.00
Special Education	(\$5,677,961.95)
Debt Service Balance	\$8,686,152.89
Food Service Balance	\$1,725,233.01
Scholarships/Donations/Activity Accounts	\$2,190,355.76
Trust Fund Balance - OPEB	\$3,989,215.29
Community Service Balance	\$195,581.13
<u>TOTAL FUND BALANCE</u>	<u><u>\$23,007,898.34</u></u>
Restricted for Insurance Claims	\$6,227,845.94
Restricted for Long Term Capital Improvement Trust Fund	\$4,767,393.37
Restricted for Construction	\$21,559,644.50
<u>TOTAL EQUITY - FUND BALANCE</u>	<u><u>\$55,562,782.15</u></u>
<u>TOTAL EQUITY AND LIABILITIES</u>	<u><u>\$57,702,728.43</u></u>

Fd	T	Loc	Obj	Func	Prj	OBJECT	2025-26 Revised Budget	October 2025-26 Monthly Activity	2025-26 FYTD Activity	Unexpended Balance
10	R	---	211	-----	---	CURRENT PROPERTY TAX	23,246,150.00	0.00	0.00	23,246,150.00
10	R	---	212	-----	---	PROPERTY TAX CHARGEBACKS	9,000.00	0.00	0.00	9,000.00
10	R	---	213	-----	---	MOBILE HOME TAX	35,000.00	0.00	0.00	35,000.00
10	R	---	249	-----	---	TRANSPORTATION FEES-PRIVATE	2,000.00	0.00	3,241.65	-1,241.65
10	R	---	271	-----	---	ADMISSIONS ATHL/SPRT	60,000.00	0.00	0.00	60,000.00
10	R	---	279	-----	---	OTH SCH ACTIVITY INC	105,000.00	2,135.00	49,084.00	55,916.00
10	R	---	280	-----	---	INT ON INVESTMENTS	375,000.00	27,621.02	85,793.62	289,206.38
10	R	---	290	-----	---	OTHER REVENUE	0.00	0.00	40,000.00	-40,000.00
10	R	---	291	-----	---	GIFTS, FUNDRAISING, CONTRIBU	0.00	0.00	10,000.00	-10,000.00
10	R	---	292	-----	---	STUDENT FEES	65,000.00	7,992.50	46,341.01	18,658.99
10	R	---	293	-----	---	RENTALS	55,000.00	975.00	9,542.83	45,457.17
10	R	---	341	-----	---	NON-OPEN ENROLL GENERAL TUIT	5,000.00	0.00	0.00	5,000.00
10	R	---	345	-----	---	OPEN ENROLLMENT GEN. TUITION	2,413,714.00	0.00	0.00	2,413,714.00
10	R	---	515	-----	---	STATE AID TRANSIT/INT. SOURC	35,000.00	0.00	0.00	35,000.00
10	R	---	612	-----	---	TRANSPORTATION AID	175,000.00	0.00	0.00	175,000.00
10	R	---	613	-----	---	LIBRARY AID	475,000.00	0.00	0.00	475,000.00
10	R	---	618	-----	---	BILINGUAL STATE AID	315,000.00	0.00	0.00	315,000.00
10	R	---	619	-----	---	OTHER STATE CATEGORICAL AID	22,028.00	1,395.33	1,395.33	20,632.67
10	R	---	621	-----	---	EQUALIZATION AID	75,312,316.00	0.00	11,634,050.00	63,678,266.00
10	R	---	630	-----	---	SPECIAL PROJECT GRNT	429,941.00	0.00	0.00	429,941.00
10	R	---	641	-----	---	STATE TUITION PAYMENTS	85,000.00	0.00	0.00	85,000.00
10	R	---	650	-----	---	STATE SAGE AID	1,682,071.00	0.00	0.00	1,682,071.00
10	R	---	660	-----	---	STATE REV. THROUGH LOCAL GOV	5,000.00	0.00	28,738.16	-23,738.16
10	R	---	691	-----	---	STATE TAX EXEMPT AIDS	1,860,824.00	0.00	564,121.52	1,296,702.48
10	R	---	695	-----	---	PER PUPIL AID	5,907,058.00	0.00	0.00	5,907,058.00
10	R	---	780	-----	---	FED AID STATE AGENCY. NOT DP	900,000.00	0.00	0.00	900,000.00
10	R	---	861	-----	---	EQUIPMENT SALES	40,000.00	0.00	200,000.00	-160,000.00
10	R	---	971	-----	---	REFUND OF PRIOR YEAR EXPENSE	275,000.00	0.00	39,949.97	235,050.03
10	R	---	990	-----	---	MISCELLANEOUS	190,000.00	-1,471,931.02	29,443.24	160,556.76
10	-	---	---	-----	---	GENERAL FUND	114,080,102.00	-1,431,812.17	12,741,701.33	101,338,400.67

Fd	T	Loc	Obj	Func	Prj	OBJECT	2025-26 Revised Budget	October 2025-26 Monthly Activity	2025-26 FYTD Activity	Unexpended Balance
10	E	---	131	-----	---	STRAIGHT TIME	27,900.00	14,490.72	14,490.72	13,409.28
10	E	---	161	-----	---	ADMIN SALARY	537,271.28	41,828.56	188,228.52	349,042.76
10	E	---	164	-----	---	OTHER PROF SALARIES	1,621,144.18	124,780.36	530,990.20	1,090,153.98
10	E	---	166	-----	---	PRINCIPALS SALARY	2,349,932.72	160,021.38	720,289.23	1,629,643.49
10	E	---	167	-----	---	ASSIST PRINC SALARY	810,661.92	71,974.00	326,896.12	483,765.80
10	E	---	171	-----	---	INSTR SUB TEACHERS	100,001.47	8,198.87	9,556.72	90,444.75
10	E	---	172	-----	---	OTHER CERT SALARIES	2,702,426.95	204,614.75	530,232.47	2,172,194.48
10	E	---	173	-----	---	SUB TEACHER SALARIES	671,509.85	47,569.05	63,566.12	607,943.73
10	E	---	174	-----	---	PROF HEALTH SALARIES	222,192.27	17,547.14	66,706.26	155,486.01
10	E	---	175	-----	---	TEACHERS SALARIES	32,672,692.52	2,384,673.23	6,594,262.98	26,078,429.54
10	E	---	176	-----	---	L-TERM SUB TCHRS	420,000.00	50,485.65	81,335.33	338,664.67
10	E	---	178	-----	---	COACHING SALARIES	795,612.26	115,160.10	230,222.65	565,389.61
10	E	---	180	-----	---	SUPPORT SALARIES	127,793.43	9,855.46	39,957.46	87,835.97
10	E	---	181	-----	---	CUSTODIAL SALARIES	4,639,108.58	353,470.81	1,453,638.70	3,185,469.88
10	E	---	182	-----	---	TEACHR AIDE SALARIES	3,017,313.93	256,053.84	569,778.97	2,447,534.96
10	E	---	184	-----	---	ATTENDANCE OFFICE	62,992.51	6,698.41	12,811.24	50,181.27
10	E	---	185	-----	---	OTHER MUNIC SALARIES	1,258,829.67	98,778.92	377,298.37	881,531.30
10	E	---	186	-----	---	SECR-CLER SALARIES	1,997,200.61	172,871.41	542,358.01	1,454,842.60
10	E	---	187	-----	---	MAINT WORKER SALARY	140,161.26	12,145.86	45,454.76	94,706.50
10	E	---	188	-----	---	TEACHER AIDE-ENROLLMENT	66,950.00	1,182.24	1,419.51	65,530.49
10	E	---	194	-----	---	OTHER SUPV SALARIES	289,591.76	22,507.73	89,701.68	199,890.08
10	E	---	195	-----	---	MISC PAYROLLS	125,000.00	7,016.01	10,754.22	114,245.78
10	E	---	212	-----	---	RET-EMPLR CONTRIBTN	3,674,682.12	279,964.74	844,732.41	2,829,949.71
10	E	---	218	-----	---	CONTR TO EMPLOYEE BENEFIT TR	1,430,626.80	90,534.53	282,726.57	1,147,900.23
10	E	---	219	-----	---	OTHER EMPLOYEE BENEFITS	20,000.00	0.00	0.00	20,000.00
10	E	---	221	-----	---	MEDICARE-EMPLOYER CONTRIBUTI	794,496.89	57,481.52	173,031.69	621,465.20
10	E	---	222	-----	---	S S EMLPR CON	3,389,950.42	245,473.56	739,547.97	2,650,402.45
10	E	---	230	-----	---	GROUP LIFE INS	107,348.27	8,774.99	22,320.08	85,028.19
10	E	---	243	-----	---	DENTAL INSURANCE	705,071.48	59,991.67	138,433.25	566,638.23
10	E	---	248	-----	---	HOSPITAL SURGICL INS	13,122,721.66	987,750.35	2,327,141.33	10,795,580.33
10	E	---	251	-----	---	DISABILITY INSURANCE	151,153.61	12,635.67	27,040.03	124,113.58
10	E	---	291	-----	---	COLLEGE CREDIT REIMB	40,000.00	0.00	2,011.41	37,988.59
10	E	---	293	-----	---	MISC BENEFITS	170,000.00	0.00	0.00	170,000.00
10	E	---	299	-----	---	MISC BENEFITS	8,000.00	0.00	17,360.00	9,360.00-
10	E	---	310	-----	---	PERSONAL SERVICES	862,632.00	282,759.64	446,323.07	416,308.93
10	E	---	321	-----	---	TECH RELATED REPAIRS & MAINT	4,035.00	1,495.27	10,615.03	6,580.03-
10	E	---	324	-----	---	MAINTENANCE SERVICES	1,796,174.00	121,203.22	730,614.82	1,065,559.18
10	E	---	325	-----	---	VEHICLE AND EQUIPMENT RENTAL	12,905.00	4,400.00	12,855.75	49.25
10	E	---	327	-----	---	CONSTRUCTION SERVICE	532,304.00	129,230.00	474,001.05	58,302.95
10	E	---	328	-----	---	BUILDING RENTAL	26,466.00	3,501.60	8,031.60	18,434.40

Fd	T	Loc	Obj	Func	Prj	OBJECT	2025-26 Revised Budget	October 2025-26 Monthly Activity	2025-26 FYTD Activity	Unexpended Balance
10	E	---	329	-----	---	CLEANING SERVICES	169,985.00	0.00	0.00	169,985.00
10	E	---	331	-----	---	GAS FOR HEAT	527,830.00	15,697.50	30,809.58	497,020.42
10	E	---	336	-----	---	ELECT NOT FOR HEAT	1,545,303.00	106,775.85	422,341.88	1,122,961.12
10	E	---	337	-----	---	WATER	120,661.00	26,673.46	40,295.42	80,365.58
10	E	---	338	-----	---	SEWER	83,153.00	9,858.39	25,576.21	57,576.79
10	E	---	339	-----	---	OTHER UTILITIES	103,446.00	2,274.00	5,661.88	97,784.12
10	E	---	341	-----	---	PUPIL TRANSPORTATION	2,631,641.00	39,905.99	44,044.39	2,587,596.61
10	E	---	342	-----	---	EMPLOYEE TRAVEL	166,506.00	2,763.63	8,247.51	158,258.49
10	E	---	345	-----	---	PUPIL LODGING & MEALS	28,190.00	0.00	6,217.34	21,972.66
10	E	---	348	-----	---	VEHICLE FUEL	356,263.00	4,891.81	16,107.45	340,155.55
10	E	---	351	-----	---	ADVERTISING	604.00	1,318.04	2,516.04	1,912.04-
10	E	---	352	-----	---	PHOTOGRAPHY	11,952.00	0.00	0.00	11,952.00
10	E	---	353	-----	---	POSTAGE	62,066.00	5,343.87	25,973.98	36,092.02
10	E	---	354	-----	---	PRINTING & BINDING	235,467.00	67,824.57	134,690.55	100,776.45
10	E	---	355	-----	---	TELEPHONE	120,900.00	11,055.54	25,335.02	95,564.98
10	E	---	358	-----	---	ON-LINE COMMUNICATIONS	228,109.00	9,058.51	22,258.44	205,850.56
10	E	---	359	-----	---	OTHER COMMUNICATIONS	29,032.00	0.00	0.00	29,032.00
10	E	---	360	-----	---	INFORMATION TECHNOLOGY	1,279,693.00	161,889.59	770,355.84	509,337.16
10	E	---	362	-----	---	SOFTWARE AS A SERVICE	189,931.00	19,370.30	331,766.67	141,835.67-
10	E	---	370	-----	---	EDUC SERV N-GOVT	0.00	0.00	0.00	0.00
10	E	---	382	-----	---	PAYMENTS TO WI SCHOOL DISTRI	4,674,671.00	0.00	647.00	4,674,024.00
10	E	---	386	-----	---	PAYMENT TO CESA-SERVICES	167,220.00	2,674.00	44,316.04	122,903.96
10	E	---	387	-----	---	PAYMENTS TO STATE	4,274,794.00	5,358.22	7,473.64	4,267,320.36
10	E	---	389	-----	---	PAYMENT TO WTCS	702,460.00	6,633.77	383,835.77	318,624.23
10	E	---	411	-----	---	GENERAL SUPPLIES	1,238,847.00	95,428.48	295,609.82	943,237.18
10	E	---	413	-----	---	COMPUTER SUPPLIES	1,762.00	0.00	0.00	1,762.00
10	E	---	415	-----	---	FOOD	40,251.00	4,243.45	18,549.05	21,701.95
10	E	---	416	-----	---	MEDICAL SUPPLIES	14,333.00	1,267.46	9,012.94	5,320.06
10	E	---	417	-----	---	PAPER	59,155.00	-47,492.56	-82,084.52	141,239.52
10	E	---	420	-----	---	APPAREL	24,256.00	568.21	2,155.15	22,100.85
10	E	---	430	-----	---	MEDIA	0.00	0.00	1,523.49	1,523.49-
10	E	---	431	-----	---	AUDIO-VISUAL MEDIA	8,328.00	2,057.87	3,331.07	4,996.93
10	E	---	432	-----	---	LIBRARY BOOKS	236,881.00	28,208.18	66,101.59	170,779.41
10	E	---	433	-----	---	NEWSPAPERS	343.00	0.00	0.00	343.00
10	E	---	434	-----	---	PERIODICALS	19,605.00	296.70	5,746.55	13,858.45
10	E	---	439	-----	---	OTHER MEDIA	210,434.00	2,661.44	4,629.68	205,804.32
10	E	---	440	-----	---	N-CAPITAL EQUIPMENT	791,672.00	63,863.01	225,342.34	566,329.66
10	E	---	441	-----	---	N/A	0.00	0.00	981.00	981.00-
10	E	---	449	-----	---	OTHER NON-CAPITAL OBJECTS	691.00	0.00	0.00	691.00
10	E	---	460	-----	---	EQUIPMENT COMPONENTS	5,368.00	0.00	919.89	4,448.11

Fd	T	Loc	Obj	Func	Prj	OBJECT	2025-26 Revised Budget	October 2025-26 Monthly Activity	2025-26 FYTD Activity	Unexpended Balance
10	E	---	470	-----	---	TEXTBOOKS & WORKBOOKS	180,655.00	12,337.13	94,889.18	85,765.82
10	E	---	472	-----	---	WORKBOOKS	0.00	125.36	125.36	125.36-
10	E	---	473	-----	---	SHEET MUSIC	16,105.00	1,605.78	6,049.13	10,055.87
10	E	---	480	-----	---	NON-INSTRUCTIONAL COMPUTER S	274,183.00	0.00	26,069.44	248,113.56
10	E	---	481	-----	---	TECHNOLOGY SUPPLIES	6,509.00	0.00	-172.00	6,681.00
10	E	---	482	-----	---	NON-CAPITAL HARDWARE	456,379.00	84,960.20	628,342.73	171,963.73-
10	E	---	483	-----	---	NON-CAPITAL SOFTWARE	20,063.00	0.00	5,450.74	14,612.26
10	E	---	551	-----	---	EQUIP PURCHASE ADDN	7,461.00	0.00	0.00	7,461.00
10	E	---	553	-----	---	EQUIP/VEHICLE PURCHASE	50,000.00	10,225.60	15,291.60	34,708.40
10	E	---	561	-----	---	EQUIPMENT REPLACE	15,117.00	0.00	0.00	15,117.00
10	E	---	678	-----	---	CAPITAL LEASE PRINCIPAL	213,531.00	5,055.74	19,785.61	193,745.39
10	E	---	688	-----	---	CAPITAL LEASE INTEREST	0.00	1,208.49	4,969.75	4,969.75-
10	E	---	711	-----	---	DIST LIABILITY INS	73,212.00	67,356.00	70,638.00	2,574.00
10	E	---	712	-----	---	DIST PROPERTY INS	182,332.00	32,493.47	300,053.13	117,721.13-
10	E	---	713	-----	---	WORKERS COMPENSATION	784,101.00	61,233.00	428,243.00	355,858.00
10	E	---	730	-----	---	UNEMPLOYMENT COMP	31,828.00	779.64	2,322.41	29,505.59
10	E	---	827	-----	---	SPECIAL ED FUND TRANSFERS	10,009,979.00	0.00	0.00	10,009,979.00
10	E	---	838	-----	---	NON-REFERENDUM DEBT FUND TRA	62,644.00	0.00	0.00	62,644.00
10	E	---	940	-----	---	DUES & FEES	250.00	0.00	0.00	250.00
10	E	---	941	-----	---	DISTRICT DUES & FEES	84,955.00	4,660.70	52,014.61	32,940.39
10	E	---	942	-----	---	EMPLOYEE DUES & FEES	3,871.00	0.00	112.50	3,758.50
10	E	---	943	-----	---	PUPIL DUES & FEES	51,529.00	1,738.00	8,019.83	43,509.17
10	E	---	972	-----	---	REFND RECPT N-AIDBLE	6,740.00	0.00	0.00	6,740.00
10	E	---	999	-----	---	OTHER MISCELLANEOUS	0.00	182,905.47	323,044.64	323,044.64-
10	-	---	---	-----	---	GENERAL FUND	114,398,101.42	7,584,275.12	23,642,274.66	90,755,826.76

Fd	T	Loc	Obj	Func	Prj	OBJECT	2025-26 Revised Budget	October 2025-26 Monthly Activity	2025-26 FYTD Activity	Unexpended Balance
11	R	---	630	-----	---	SPECIAL PROJECT GRNT	58,640.00	0.00	56,683.00	1,957.00
11	R	---	713	-----	---	VOCATIONAL EDUC ACT	90,822.00	33,406.13	15,063.88	75,758.12
11	R	---	730	-----	---	SPECIAL PROJ GRANT THROUGH D	1,572,204.00	234,262.03	1,399,948.47	172,255.53
11	R	---	751	-----	---	ESEA TITLE 1	1,758,167.00	305,592.74	143,403.19	1,614,763.81
11	-	---	---	-----	---	GENERAL GRANTS	3,479,833.00	573,260.90	1,615,098.54	1,864,734.46

Fd	T	Loc	Obj	Func	Prj	OBJECT	2025-26 Revised Budget	October 2025-26 Monthly Activity	2025-26 FYTD Activity	Unexpended Balance
11	E	---	166	-----	---	PRINCIPALS SALARY	15,286.62	0.00	0.00	15,286.62
11	E	---	171	-----	---	INSTR SUB TEACHERS	0.00	13,499.38	13,499.38	13,499.38-
11	E	---	172	-----	---	OTHER CERT SALARIES	0.00	7,180.98	7,180.98	7,180.98-
11	E	---	175	-----	---	TEACHERS SALARIES	1,085,083.14	104,982.63	260,496.70	824,586.44
11	E	---	182	-----	---	TEACHR AIDE SALARIES	23,853.01	581.68	1,967.77	21,885.24
11	E	---	185	-----	---	OTHER MUNIC SALARIES	70,876.62	5,814.72	10,516.14	60,360.48
11	E	---	186	-----	---	SECR-CLER SALARIES	0.00	1,804.95	1,804.95	1,804.95-
11	E	---	212	-----	---	RET-EMPLR CONTRIBTN	84,519.47	8,655.44	19,874.13	64,645.34
11	E	---	218	-----	---	CONTR TO EMPLOYEE BENEFIT TR	27,642.66	2,487.28	5,484.44	22,158.22
11	E	---	221	-----	---	MEDICARE-EMPLOYER CONTRIBUTI	17,679.93	1,840.10	4,060.51	13,619.42
11	E	---	222	-----	---	S S EMLPR CON	75,595.35	7,868.23	17,362.39	58,232.96
11	E	---	230	-----	---	GROUP LIFE INS	8,030.39	398.88	708.48	7,321.91
11	E	---	243	-----	---	DENTAL INSURANCE	17,040.93	1,582.45	2,621.04	14,419.89
11	E	---	248	-----	---	HOSPITAL SURGICL INS	289,837.72	26,069.44	43,107.77	246,729.95
11	E	---	251	-----	---	DISABILITY INSURANCE	6,345.68	319.54	526.60	5,819.08
11	E	---	310	-----	---	PERSONAL SERVICES	596,848.48	50,229.13	92,673.13	504,175.35
11	E	---	321	-----	---	TECH RELATED REPAIRS & MAINT	9,002.00	0.00	0.00	9,002.00
11	E	---	341	-----	---	PUPIL TRANSPORTATION	19,745.00	2,274.89	2,001.37	17,743.63
11	E	---	342	-----	---	EMPLOYEE TRAVEL	43,137.00	470.39	11,450.85	31,686.15
11	E	---	354	-----	---	PRINTING & BINDING	0.00	593.69	1,279.58	1,279.58-
11	E	---	360	-----	---	INFORMATION TECHNOLOGY	59,254.00	-729.99	0.00	59,254.00
11	E	---	362	-----	---	SOFTWARE AS A SERVICE	24,098.00	4,234.99	26,992.82	2,894.82-
11	E	---	371	-----	---	INSTR PAYMENTS-PRIV VENDOR	21,967.00	0.00	0.00	21,967.00
11	E	---	386	-----	---	PAYMENT TO CESA-SERVICES	16,021.00	0.00	4,455.00	11,566.00
11	E	---	387	-----	---	PAYMENTS TO STATE	0.00	0.00	1,000.00	1,000.00-
11	E	---	411	-----	---	GENERAL SUPPLIES	315,748.00	7,401.58	7,401.58	308,346.42
11	E	---	415	-----	---	FOOD	739.00	745.36	1,292.21	553.21-
11	E	---	420	-----	---	APPAREL	0.00	0.00	50.33	50.33-
11	E	---	440	-----	---	N-CAPITAL EQUIPMENT	51,879.00	2,890.08	10,732.80	41,146.20
11	E	---	470	-----	---	TEXTBOOKS & WORKBOOKS	0.00	4,183.04	4,581.20	4,581.20-
11	E	---	482	-----	---	NON-CAPITAL HARDWARE	282,482.00	0.00	3,827.99	278,654.01
11	E	---	483	-----	---	NON-CAPITAL SOFTWARE	16,825.00	0.00	0.00	16,825.00
11	E	---	490	-----	---	OTHER NON-CAPITAL OBJECTS	296.00	0.00	0.00	296.00
11	E	---	943	-----	---	PUPIL DUES & FEES	0.00	350.00	13,140.00	13,140.00-
11	E	---	999	-----	---	OTHER MISCELLANEOUS	0.00	4,344.61	8,142.89	8,142.89-
11	-	---	---	-----	---	GENERAL GRANTS	3,179,833.00	260,073.47	578,233.03	2,601,599.97

Fd	T	Loc	Obj	Func	Prj	OBJECT	2025-26 Revised Budget	October 2025-26 Monthly Activity	2025-26 FYTD Activity	Unexpended Balance
21	R	---	279	-----	---	OTH SCH ACTIVITY INC	3,000,000.00	288,041.40	776,516.97	2,223,483.03
21	R	---	291	-----	---	GIFTS, FUNDRAISING, CONTRIBU	125,000.00	-3,075.00	31,033.43	93,966.57
21	-	---	---	-----	---	DONATIONS	3,125,000.00	284,966.40	807,550.40	2,317,449.60

Fd	T	Loc	Obj	Func	Prj	OBJECT	2025-26 Revised Budget	October 2025-26 Monthly Activity	2025-26 FYTD Activity	Unexpended Balance
21	E	---	310	-----	---	PERSONAL SERVICES	7,800.00	10,247.39	24,038.57	16,238.57-
21	E	---	328	-----	---	BUILDING RENTAL	200,000.00	0.00	0.00	200,000.00
21	E	---	341	-----	---	PUPIL TRANSPORTATION	0.00	21,672.77	31,259.16	31,259.16-
21	E	---	342	-----	---	EMPLOYEE TRAVEL	500.00	2,401.50	2,401.50	1,901.50-
21	E	---	345	-----	---	PUPIL LODGING & MEALS	0.00	44,734.12	49,263.78	49,263.78-
21	E	---	353	-----	---	POSTAGE	1,200.00	171.40	171.40	1,028.60
21	E	---	354	-----	---	PRINTING & BINDING	5,000.00	606.50	2,060.73	2,939.27
21	E	---	360	-----	---	INFORMATION TECHNOLOGY	500.00	0.00	0.00	500.00
21	E	---	370	-----	---	EDUC SERV N-GOVT	0.00	0.00	219,960.00	219,960.00-
21	E	---	411	-----	---	GENERAL SUPPLIES	2,252,353.00	87,772.55	152,973.09	2,099,379.91
21	E	---	415	-----	---	FOOD	2,024.00	41,892.39	75,789.33	73,765.33-
21	E	---	420	-----	---	APPAREL	0.00	28,159.94	85,454.83	85,454.83-
21	E	---	440	-----	---	N-CAPITAL EQUIPMENT	225,623.00	5,316.65	15,722.05	209,900.95
21	E	---	470	-----	---	TEXTBOOKS & WORKBOOKS	0.00	1,208.40	1,208.40	1,208.40-
21	E	---	550	-----	---	EQUIPMENT ADDITION	40,000.00	0.00	0.00	40,000.00
21	E	---	940	-----	---	DUES & FEES	383,500.00	34,254.55	60,992.03	322,507.97
21	E	---	941	-----	---	DISTRICT DUES & FEES	6,500.00	2,795.00	2,795.00	3,705.00
21	E	---	943	-----	---	PUPIL DUES & FEES	0.00	254.00	605.00	605.00-
21	-	---	---	-----	---	DONATIONS	3,125,000.00	281,487.16	724,694.87	2,400,305.13

Fd	T	Loc	Obj	Func	Prj	OBJECT	2025-26 Revised Budget	October 2025-26 Monthly Activity	2025-26 FYTD Activity	Unexpended Balance
27	R	---	110	-----	---	GENERAL	10,041,301.00	0.00	0.00	10,041,301.00
27	R	---	346	-----	---	NON-OPEN ENROLL SP ED TUITIO	35,000.00	0.00	0.00	35,000.00
27	R	---	611	-----	---	HANDICAPPED AID	7,308,758.00	0.00	0.00	7,308,758.00
27	R	---	625	-----	---	HIGH COST SPECIAL EDUC AID	95,000.00	0.00	0.00	95,000.00
27	R	---	697	-----	---	AID FOR SPECIAL ED TRANSITIO	20,000.00	0.00	0.00	20,000.00
27	R	---	730	-----	---	SPECIAL PROJ GRANT THROUGH D	2,184,786.00	7,217.52	-1,657,916.66	3,842,702.66
27	R	---	780	-----	---	FED AID STATE AGENCY. NOT DP	550,000.00	0.00	77,231.24	472,768.76
27	-	---	---	-----	---	SPECIAL EDUCATION	20,234,845.00	7,217.52	-1,580,685.42	21,815,530.42

Fd	T	Loc	Obj	Func	Prj	OBJECT	2025-26 Revised Budget	October 2025-26 Monthly Activity	2025-26 FYTD Activity	Unexpended Balance
27	E	---	164	-----	---	OTHER PROF SALARIES	276,418.19	21,262.92	95,683.28	180,734.91
27	E	---	171	-----	---	INSTR SUB TEACHERS	15,000.00	0.00	0.00	15,000.00
27	E	---	172	-----	---	OTHER CERT SALARIES	1,470,733.87	110,894.91	287,674.30	1,183,059.57
27	E	---	173	-----	---	SUB TEACHER SALARIES	100,000.00	34,818.80	57,528.89	42,471.11
27	E	---	174	-----	---	PROF HEALTH SALARIES	90,754.58	7,167.16	27,149.04	63,605.54
27	E	---	175	-----	---	TEACHERS SALARIES	7,845,349.45	606,581.85	1,570,576.91	6,274,772.54
27	E	---	176	-----	---	L-TERM SUB TCHRS	76,500.00	4,171.50	6,489.00	70,011.00
27	E	---	182	-----	---	TEACHR AIDE SALARIES	2,502,924.74	269,108.96	453,466.84	2,049,457.90
27	E	---	185	-----	---	OTHER MUNIC SALARIES	262,158.67	30,063.41	50,378.87	211,779.80
27	E	---	186	-----	---	SECR-CLER SALARIES	90,687.26	7,158.41	29,574.62	61,112.64
27	E	---	212	-----	---	RET-EMPLR CONTRIBTN	875,174.91	72,649.45	174,257.55	700,917.36
27	E	---	218	-----	---	CONTR TO EMPLOYEE BENEFIT TR	247,858.17	19,073.39	51,096.56	196,761.61
27	E	---	221	-----	---	MEDICARE-EMPLOYER CONTRIBUTI	182,379.80	14,711.71	35,063.85	147,315.95
27	E	---	222	-----	---	S S EEMPLR CON	779,830.92	62,905.84	149,927.94	629,902.98
27	E	---	230	-----	---	GROUP LIFE INS	46,904.83	1,908.53	3,864.43	43,040.40
27	E	---	243	-----	---	DENTAL INSURANCE	193,174.78	15,623.55	29,588.76	163,586.02
27	E	---	248	-----	---	HOSPITAL SURGICL INS	3,066,430.13	274,729.04	520,429.61	2,546,000.52
27	E	---	251	-----	---	DISABILITY INSURANCE	39,301.16	3,209.17	5,929.02	33,372.14
27	E	---	310	-----	---	PERSONAL SERVICES	226,584.00	70,350.12	139,255.17	87,328.83
27	E	---	321	-----	---	TECH RELATED REPAIRS & MAINT	0.00	0.00	290.00	290.00-
27	E	---	324	-----	---	MAINTENANCE SERVICES	4,617.00	0.00	915.04	3,701.96
27	E	---	328	-----	---	BUILDING RENTAL	223,875.00	3,236.40	11,329.70	212,545.30
27	E	---	341	-----	---	PUPIL TRANSPORTATION	975,702.00	467.60	798.40	974,903.60
27	E	---	342	-----	---	EMPLOYEE TRAVEL	0.00	617.72	1,453.20	1,453.20-
27	E	---	348	-----	---	VEHICLE FUEL	82,952.00	0.00	0.00	82,952.00
27	E	---	353	-----	---	POSTAGE	7,527.00	105.07	201.95	7,325.05
27	E	---	354	-----	---	PRINTING & BINDING	157,902.00	1,539.94	2,339.77	155,562.23
27	E	---	355	-----	---	TELEPHONE	17,907.00	108.66	270.22	17,636.78
27	E	---	360	-----	---	INFORMATION TECHNOLOGY	0.00	550.00	953.72	953.72-
27	E	---	362	-----	---	SOFTWARE AS A SERVICE	88,290.00	868.05	31,114.99	57,175.01
27	E	---	371	-----	---	INSTR PAYMENTS-PRIV VENDOR	0.00	0.00	14,769.00	14,769.00-
27	E	---	373	-----	---	INSTR PAYMENTS-PRIV SCHOOLS	0.00	0.00	114,912.10	114,912.10-
27	E	---	383	-----	---	PAYMENT TO CCDEB	58,184.00	0.00	0.00	58,184.00
27	E	---	386	-----	---	PAYMENT TO CESA-SERVICES	64,229.01	0.00	81,900.64	17,671.63-
27	E	---	387	-----	---	PAYMENTS TO STATE	953.00	0.00	0.00	953.00
27	E	---	389	-----	---	PAYMENT TO WTCS	117,316.04	0.00	89,300.50	28,015.54
27	E	---	411	-----	---	GENERAL SUPPLIES	7,478.00	3,342.84	8,370.97	892.97-
27	E	---	415	-----	---	FOOD	0.00	50.91	527.61	527.61-
27	E	---	420	-----	---	APPAREL	0.00	395.64	395.64	395.64-
27	E	---	440	-----	---	N-CAPITAL EQUIPMENT	0.00	6,154.93	11,726.65	11,726.65-

Fd	T	Loc	Obj	Func	Prj	OBJECT	2025-26 Revised Budget	October 2025-26 Monthly Activity	2025-26 FYTD Activity	Unexpended Balance
27	E	---	471	-----	---	TEXTBOOKS	0.00	35.00	35.00	35.00-
27	E	---	481	-----	---	TECHNOLOGY SUPPLIES	0.00	35.99	95.30	95.30-
27	E	---	482	-----	---	NON-CAPITAL HARDWARE	0.00	0.00	4,551.32	4,551.32-
27	E	---	490	-----	---	OTHER NON-CAPITAL OBJECTS	4,396.00	4,578.80	4,578.80	182.80-
27	E	---	936	-----	---	SP EDUC AID TRANSITED TO OTH	20,000.00	0.00	0.00	20,000.00
27	E	---	940	-----	---	DUES & FEES	0.00	0.00	730.00	730.00-
27	E	---	941	-----	---	DISTRICT DUES & FEES	0.00	0.00	1,513.43	1,513.43-
27	E	---	942	-----	---	EMPLOYEE DUES & FEES	4,039.00	0.00	169.00	3,870.00
27	E	---	943	-----	---	PUPIL DUES & FEES	2,568.00	0.00	0.00	2,568.00
27	E	---	949	-----	---	OTHER DUES & FEES	8,744.96	839.00	1,708.50	7,036.46
27	E	---	999	-----	---	OTHER MISCELLANEOUS	0.00	47,934.92	83,722.56	83,722.56-
27	-	---	---	-----	---	SPECIAL EDUCATION	20,234,845.47	1,697,250.19	4,156,608.65	16,078,236.82

Fd	T	Loc	Obj	Func	Prj	OBJECT	2025-26 Revised Budget	October 2025-26 Monthly Activity	2025-26 FYTD Activity	Unexpended Balance
38	R	---	110	-----	---	GENERAL	31,322.00	0.00	0.00	31,322.00
38	R	---	211	-----	---	CURRENT PROPERTY TAX	1,082,291.00	0.00	0.00	1,082,291.00
38	R	---	280	-----	---	INT ON INVESTMENTS	0.00	594.42	2,290.02	-2,290.02
38	-	---	---	-----	---	NON-REFERENDUM DEBT SERVICE	1,113,613.00	594.42	2,290.02	1,111,322.98

Fd	T	Loc	Obj	Func	Prj	OBJECT	2025-26 Revised Budget	October 2025-26 Monthly Activity	2025-26 FYTD Activity	Unexpended Balance
38	E	---	683	-----	---	INT L-TERM LOANS	1,156,035.00	0.00	0.00	1,156,035.00
38	-	---	---	-----	---	NON-REFERENDUM DEBT SERVICE	1,156,035.00	0.00	0.00	1,156,035.00

Fd	T	Loc	Obj	Func	Prj	OBJECT	2025-26 Revised Budget	October 2025-26 Monthly Activity	2025-26 FYTD Activity	Unexpended Balance
39	R	---	211	-----	---	CURRENT PROPERTY TAX	18,924,508.00	0.00	0.00	18,924,508.00
39	R	---	280	-----	---	INT ON INVESTMENTS	0.00	20,424.22	69,109.72	-69,109.72
39	-	---	---	-----	---	DEBT SERVICE-REFERENDUM APPR	18,924,508.00	20,424.22	69,109.72	18,855,398.28

Fd	T	Loc	Obj	Func	Prj	OBJECT	2025-26 Revised Budget	October 2025-26 Monthly Activity	2025-26 FYTD Activity	Unexpended Balance
39	E	---	675	-----	---	PRINC L-TERM BONDS	15,027,353.00	0.00	0.00	15,027,353.00
39	E	---	685	-----	---	INT L-TERM BONDS	3,970,780.00	0.00	0.00	3,970,780.00
39	-	---	---	-----	---	DEBT SERVICE-REFERENDUM APPR	18,998,133.00	0.00	0.00	18,998,133.00

Fd	T	Loc	Obj	Func	Prj	OBJECT	2025-26 Revised Budget	October 2025-26 Monthly Activity	2025-26 FYTD Activity	Unexpended Balance
46	R	---	110	-----	---	GENERAL	0.00	2,254,186.00	2,254,186.00	-2,254,186.00
46	R	---	280	-----	---	INT ON INVESTMENTS	10,000.00	12,044.61	29,997.06	-19,997.06
46	-	---	---	-----	---	LONG TERM CAPITAL IMPR TRUST	10,000.00	2,266,230.61	2,284,183.06	-2,274,183.06

Fd	T	Loc	Obj	Func	Prj	OBJECT	2025-26 Revised Budget	October 2025-26 Monthly Activity	2025-26 FYTD Activity	Unexpended Balance
49	R	---	280	-----	---	INT ON INVESTMENTS	1,500,000.00	59,666.07	130,487.62	1,369,512.38
49	-	---	---	-----	---	OTHER CAPITAL PROJECTS FUND	1,500,000.00	59,666.07	130,487.62	1,369,512.38

Fd	T	Loc	Obj	Func	Prj	OBJECT	2025-26 Revised Budget	October 2025-26 Monthly Activity	2025-26 FYTD Activity	Unexpended Balance
49	E	---	327	-----	---	CONSTRUCTION SERVICE	29,873,069.00	302,680.91	5,999,307.56	23,873,761.44
49	E	---	482	-----	---	NON-CAPITAL HARDWARE	0.00	310,716.54	897,327.49	897,327.49-
49	E	---	712	-----	---	DIST PROPERTY INS	0.00	0.00	35,500.00	35,500.00-
49	E	---	941	-----	---	DISTRICT DUES & FEES	0.00	1,257.72	5,179.20	5,179.20-
49	E	---	998	-----	---	UNREALIZED LOSSES ON INVESTM	0.00	351.56	6,597.92	6,597.92-
49	-	---	---	-----	---	OTHER CAPITAL PROJECTS FUND	29,873,069.00	615,006.73	6,943,912.17	22,929,156.83

Fd	T	Loc	Obj	Func	Prj	OBJECT	2025-26 Revised Budget	October 2025-26 Monthly Activity	2025-26 FYTD Activity	Unexpended Balance
50	R	---	251	-----	---	PUPILS	1,250,000.00	0.00	-2,133.58	1,252,133.58
50	R	---	252	-----	---	ADULTS	35,000.00	0.00	0.00	35,000.00
50	R	---	259	-----	---	OTH FOOD SERV SALES	105,000.00	183,707.72	259,763.43	-154,763.43
50	R	---	280	-----	---	INT ON INVESTMENTS	15,000.00	1.40	1.40	14,998.60
50	R	---	617	-----	---	FOOD SERVICE AID	65,000.00	0.00	0.00	65,000.00
50	R	---	714	-----	---	USDA COMMODITIES	455,000.00	0.00	0.00	455,000.00
50	R	---	717	-----	---	FEDERAL FOOD SERVICE AID	3,150,000.00	354,852.57	578,285.01	2,571,714.99
50	R	---	730	-----	---	SPECIAL PROJ GRANT THROUGH D	30,000.00	0.00	0.00	30,000.00
50	R	---	861	-----	---	EQUIPMENT SALES	6,000.00	0.00	0.00	6,000.00
50	-	---	---	-----	---	FOOD SERVICE FUND	5,111,000.00	538,561.69	835,916.26	4,275,083.74

Fd	T	Loc	Obj	Func	Prj	OBJECT	2025-26 Revised Budget	October 2025-26 Monthly Activity	2025-26 FYTD Activity	Unexpended Balance
50	E	---	181	-----	---	CUSTODIAL SALARIES	65,179.00	5,019.76	20,051.87	45,127.13
50	E	---	183	-----	---	COOKS SALARIES	1,403,697.50	135,632.77	274,316.26	1,129,381.24
50	E	---	185	-----	---	OTHER MUNIC SALARIES	67,545.17	5,195.78	20,820.98	46,724.19
50	E	---	186	-----	---	SECR-CLER SALARIES	75,191.49	5,761.81	23,095.88	52,095.61
50	E	---	191	-----	---	FOOD SERVICE SUPVSR	96,177.20	7,398.24	33,292.16	62,885.04
50	E	---	212	-----	---	RET-EMPLR CONTRIBTN	100,687.42	10,022.57	23,818.88	76,868.54
50	E	---	218	-----	---	CONTR TO EMPLOYEE BENEFIT TR	7,213.28	554.86	2,496.88	4,716.40
50	E	---	221	-----	---	MEDICARE-EMPLOYER CONTRIBUTI	22,522.96	2,168.58	5,127.34	17,395.62
50	E	---	222	-----	---	S S EEMPLR CON	96,304.99	9,272.55	21,923.90	74,381.09
50	E	---	230	-----	---	GROUP LIFE INS	8,597.08	359.57	841.47	7,755.61
50	E	---	243	-----	---	DENTAL INSURANCE	29,489.88	2,440.81	4,471.17	25,018.71
50	E	---	248	-----	---	HOSPITAL SURGICL INS	419,920.09	39,743.12	77,064.38	342,855.71
50	E	---	251	-----	---	DISABILITY INSURANCE	5,207.30	359.51	802.52	4,404.78
50	E	---	310	-----	---	PERSONAL SERVICES	19,791.00	0.00	0.00	19,791.00
50	E	---	324	-----	---	MAINTENANCE SERVICES	33,956.00	7,449.97	16,999.97	16,956.03
50	E	---	342	-----	---	EMPLOYEE TRAVEL	1,989.00	0.00	1,047.68	941.32
50	E	---	348	-----	---	VEHICLE FUEL	582.00	0.00	0.00	582.00
50	E	---	353	-----	---	POSTAGE	0.00	41.44	1,481.03	1,481.03-
50	E	---	354	-----	---	PRINTING & BINDING	6,015.00	344.84	1,480.54	4,534.46
50	E	---	360	-----	---	INFORMATION TECHNOLOGY	0.00	0.00	23,008.44	23,008.44-
50	E	---	387	-----	---	PAYMENTS TO STATE	2,667.00	1,232.81	1,232.81	1,434.19
50	E	---	411	-----	---	GENERAL SUPPLIES	113,831.00	28,245.16	49,924.95	63,906.05
50	E	---	415	-----	---	FOOD	2,704,906.00	317,608.15	477,705.47	2,227,200.53
50	E	---	417	-----	---	PAPER	0.00	31.50	63.00	63.00-
50	E	---	420	-----	---	APPAREL	2,155.00	527.92	527.92	1,627.08
50	E	---	440	-----	---	N-CAPITAL EQUIPMENT	65,241.00	2,724.66	2,902.97	62,338.03
50	E	---	480	-----	---	NON-INSTRUCTIONAL COMPUTER S	18,867.00	0.00	0.00	18,867.00
50	E	---	551	-----	---	EQUIP PURCHASE ADDN	0.00	30,247.00	30,247.00	30,247.00-
50	E	---	561	-----	---	EQUIPMENT REPLACE	0.00	0.00	74,204.00	74,204.00-
50	E	---	941	-----	---	DISTRICT DUES & FEES	6,500.00	620.50	1,689.00	4,811.00
50	E	---	999	-----	---	OTHER MISCELLANEOUS	0.00	6,327.50	6,248.37	6,248.37-
50	-	---	---	-----	---	FOOD SERVICE FUND	5,374,233.36	619,331.38	1,196,886.84	4,177,346.52

Fd	T	Loc	Obj	Func	Prj	OBJECT	2025-26 Revised Budget	October 2025-26 Monthly Activity	2025-26 FYTD Activity	Unexpended Balance
72	R	---	280	-----	---	INT ON INVESTMENTS	0.00	0.00	-9,477.73	9,477.73
72	R	---	291	-----	---	GIFTS, FUNDRAISING, CONTRIBU	0.00	791.27	9,855.52	-9,855.52
72	-	---	---	-----	---	EXP/NONEXP TRUST FUNDS	0.00	791.27	377.79	-377.79

Fd	T	Loc	Obj	Func	Prj	OBJECT	2025-26 Revised Budget	October 2025-26 Monthly Activity	2025-26 FYTD Activity	Unexpended Balance
72	E	---	991	-----	---	TRUST FUND EXPENDITURES	0.00	3,640.00	30,502.00	30,502.00-
72	-	---	---	-----	---	EXP/NONEXP TRUST FUNDS	0.00	3,640.00	30,502.00	30,502.00-

Fd	T	Loc	Obj	Func	Prj	OBJECT	2025-26 Revised Budget	October 2025-26 Monthly Activity	2025-26 FYTD Activity	Unexpended Balance
80	R	---	211	-----	---	CURRENT PROPERTY TAX	1,575,653.00	0.00	0.00	1,575,653.00
80	-	---	---	-----	---	COMMUNITY SERVICES	1,575,653.00	0.00	0.00	1,575,653.00

Number of Accounts: 459

***** End of report *****

Fd	T	Loc	Obj	Func	Prj	OBJECT	2025-26 Revised Budget	October 2025-26 Monthly Activity	2025-26 FYTD Activity	Unexpended Balance
80	E	---	171	-----	---	INSTR SUB TEACHERS	13,968.00	553.69	812.91	13,155.09
80	E	---	175	-----	---	TEACHERS SALARIES	33,693.46	2,637.20	6,593.00	27,100.46
80	E	---	178	-----	---	COACHING SALARIES	166,980.00	40,516.38	76,582.69	90,397.31
80	E	---	181	-----	---	CUSTODIAL SALARIES	30,500.00	0.00	0.00	30,500.00
80	E	---	182	-----	---	TEACHR AIDE SALARIES	0.00	3,452.90	36,696.06	36,696.06-
80	E	---	185	-----	---	OTHER MUNIC SALARIES	205,721.00	23,909.46	51,476.33	154,244.67
80	E	---	186	-----	---	SECR-CLER SALARIES	11,957.11	1,173.96	2,744.67	9,212.44
80	E	---	195	-----	---	MISC PAYROLLS	0.00	0.00	221.35	221.35-
80	E	---	212	-----	---	RET-EMPLR CONTRIBTN	29,413.04	4,330.55	10,296.11	19,116.93
80	E	---	218	-----	---	CONTR TO EMPLOYEE BENEFIT TR	857.09	65.92	164.80	692.29
80	E	---	221	-----	---	MEDICARE-EMPLOYER CONTRIBUTI	6,707.38	1,000.98	2,464.16	4,243.22
80	E	---	222	-----	---	S S EMPLR CON	30,855.98	4,280.33	10,536.93	20,319.05
80	E	---	230	-----	---	GROUP LIFE INS	1,729.95	49.72	112.40	1,617.55
80	E	---	243	-----	---	DENTAL INSURANCE	766.74	82.22	144.84	621.90
80	E	---	248	-----	---	HOSPITAL SURGICL INS	5,005.98	860.30	1,290.45	3,715.53
80	E	---	251	-----	---	DISABILITY INSURANCE	851.95	46.89	111.08	740.87
80	E	---	310	-----	---	PERSONAL SERVICES	23,483.00	7,792.00	26,150.00	2,667.00-
80	E	---	341	-----	---	PUPIL TRANSPORTATION	35,259.00	5,234.68	5,784.68	29,474.32
80	E	---	342	-----	---	EMPLOYEE TRAVEL	1,561.00	0.00	747.43	813.57
80	E	---	345	-----	---	PUPIL LODGING & MEALS	0.00	122.37	122.37	122.37-
80	E	---	354	-----	---	PRINTING & BINDING	99.00	701.15	967.78	868.78-
80	E	---	355	-----	---	TELEPHONE	0.00	437.38	1,042.33	1,042.33-
80	E	---	360	-----	---	INFORMATION TECHNOLOGY	561.00	0.00	1,618.00	1,057.00-
80	E	---	381	-----	---	PAYMENT TO MUNICIPALITY	270,000.00	24,145.38	24,145.38	245,854.62
80	E	---	411	-----	---	GENERAL SUPPLIES	2,816.00	-1,107.72	-1,288.63	4,104.63
80	E	---	415	-----	---	FOOD	113.00	302.22	453.84	340.84-
80	E	---	420	-----	---	APPAREL	2,244.00	0.00	0.00	2,244.00
80	E	---	440	-----	---	N-CAPITAL EQUIPMENT	9,049.00	1,882.89	3,389.93	5,659.07
80	E	---	482	-----	---	NON-CAPITAL HARDWARE	337.00	0.00	0.00	337.00
80	E	---	551	-----	---	EQUIP PURCHASE ADDN	3,946.00	0.00	19,861.00	15,915.00-
80	E	---	940	-----	---	DUES & FEES	0.00	842.73	1,417.73	1,417.73-
80	E	---	941	-----	---	DISTRICT DUES & FEES	2,940.00	0.00	318.00	2,622.00
80	E	---	943	-----	---	PUPIL DUES & FEES	1,795.00	2,287.75	2,799.84	1,004.84-
80	E	---	999	-----	---	OTHER MISCELLANEOUS	0.00	500.00	493.75	493.75-
80	-	---	---	-----	---	COMMUNITY SERVICES	893,210.68	126,101.33	288,271.21	604,939.47

Number of Accounts: 9759

BALANCE SHEET SUMMARY

October 31, 2025

ASSETS

General Fund	\$7,477,882.58
Special Education	(\$4,873,725.64)
HRA Account	(\$12,195.45)
Petty Cash Fund	\$249.00
Investments	
General Fund	\$12,071,419.38
Interest Receivable	\$543.63
Taxes Receivable	\$0.04
Accounts Receivable	(\$28,829.12)
<u>TOTAL ASSETS</u>	<u>\$14,635,344.42</u>

LIABILITIES

Salaries and Benefits Payable	\$1,833,850.02
Accounts Payable	\$411,620.05
<u>TOTAL LIABILITIES</u>	<u>\$2,245,470.07</u>

EQUITY - FUND BALANCE

General Fund Balance	\$11,839,990.36
Special Education	(\$5,677,961.95)
TOTAL FUND BALANCE	<u>\$6,162,028.41</u>
Restricted for Insurance Claims	\$6,227,845.94
TOTAL EQUITY - FUND BALANCE	<u>\$12,389,874.35</u>
TOTAL EQUITY AND LIABILITIES	<u>\$14,635,344.42</u>

Fd	T	Loc	Obj	Func	Prj	OBJECT	2025-26 Revised Budget	October 2025-26 Monthly Activity	2025-26 FYTD Activity	Unexpended Balance
10	R	---	2--	-----	---	REVENUE FROM LOCAL SOURCES	23,952,150.00	38,723.52	244,003.11	23,708,146.89
10	R	---	3--	-----	---	INTER DISTRICT PAYMENTS	2,418,714.00	0.00	0.00	2,418,714.00
10	R	---	5--	-----	---	REVENUE FROM INTER. SOURCES	35,000.00	0.00	0.00	35,000.00
10	R	---	6--	-----	---	REVENUE FROM STATE	86,269,238.00	1,395.33	12,228,305.01	74,040,932.99
10	R	---	7--	-----	---	REVENUE FROM FEDERAL	900,000.00	0.00	0.00	900,000.00
10	R	---	8--	-----	---	OTHER FINANCING	40,000.00	0.00	200,000.00	-160,000.00
10	R	---	9--	-----	---	OTHER REVENUE	465,000.00	-1,471,931.02	69,393.21	395,606.79
10	-	---	---	-----	---	GENERAL FUND	114,080,102.00	-1,431,812.17	12,741,701.33	101,338,400.67

Fd	T	Loc	Obj	Func	Prj	OBJECT	2025-26 Revised Budget	October 2025-26 Monthly Activity	2025-26 FYTD Activity	Unexpended Balance
10	E	---	1--	-----	---	SALARIES	54,656,287.17	4,181,924.50	12,499,950.24	42,156,336.93
10	E	---	2--	-----	---	EMPLOYEE BENEFITS	23,614,051.25	1,742,607.03	4,574,344.74	19,039,706.51
10	E	---	3--	-----	---	PURCHASED SERVICES	20,944,393.00	1,041,956.77	4,030,911.97	16,913,481.03
10	E	---	4--	-----	---	NON-CAPITAL OBJECTS	3,605,820.00	250,130.71	1,312,572.63	2,293,247.37
10	E	---	5--	-----	---	CAPITAL OBJECTS	72,578.00	10,225.60	15,291.60	57,286.40
10	E	---	6--	-----	---	DEBT RETIREMENT	213,531.00	6,264.23	24,755.36	188,775.64
10	E	---	7--	-----	---	INSURANCE & JUDGEMENTS	1,071,473.00	161,862.11	801,256.54	270,216.46
10	E	---	8--	-----	---	OPERATING TRANSFERS - OUT	10,072,623.00	0.00	0.00	10,072,623.00
10	E	---	9--	-----	---	OTHER OBJECTS	147,345.00	189,304.17	383,191.58	235,846.58-
10	-	---	---	-----	---	GENERAL FUND	114,398,101.42	7,584,275.12	23,642,274.66	90,755,826.76

Fd	T	Loc	Obj	Func	Prj	OBJECT	2025-26 Revised Budget	October 2025-26 Monthly Activity	2025-26 FYTD Activity	Unexpended Balance
11	R	---	6--	-----	---	REVENUE FROM STATE	58,640.00	0.00	56,683.00	1,957.00
11	R	---	7--	-----	---	REVENUE FROM FEDERAL	3,421,193.00	573,260.90	1,558,415.54	1,862,777.46
11	-	---	---	-----	---	GENERAL GRANTS	3,479,833.00	573,260.90	1,615,098.54	1,864,734.46

Fd	T	Loc	Obj	Func	Prj	OBJECT	2025-26 Revised Budget	October 2025-26 Monthly Activity	2025-26 FYTD Activity	Unexpended Balance
11	E	---	1--	-----	---	SALARIES	1,195,099.39	133,864.34	295,465.92	899,633.47
11	E	---	2--	-----	---	EMPLOYEE BENEFITS	526,692.13	49,221.36	93,745.36	432,946.77
11	E	---	3--	-----	---	PURCHASED SERVICES	790,072.48	57,073.10	139,852.75	650,219.73
11	E	---	4--	-----	---	NON-CAPITAL OBJECTS	667,969.00	15,220.06	27,886.11	640,082.89
11	E	---	9--	-----	---	OTHER OBJECTS	0.00	4,694.61	21,282.89	21,282.89-
11	-	---	---	-----	---	GENERAL GRANTS	3,179,833.00	260,073.47	578,233.03	2,601,599.97

Fd	T	Loc	Obj	Func	Prj	OBJECT	2025-26 Revised Budget	October 2025-26 Monthly Activity	2025-26 FYTD Activity	Unexpended Balance
27	R	---	1--	-----	---		10,041,301.00	0.00	0.00	10,041,301.00
27	R	---	3--	-----	---	INTER DISTRICT PAYMENTS	35,000.00	0.00	0.00	35,000.00
27	R	---	6--	-----	---	REVENUE FROM STATE	7,423,758.00	0.00	0.00	7,423,758.00
27	R	---	7--	-----	---	REVENUE FROM FEDERAL	2,734,786.00	7,217.52	-1,580,685.42	4,315,471.42
27	-	---	---	-----	---	SPECIAL EDUCATION	20,234,845.00	7,217.52	-1,580,685.42	21,815,530.42

Number of Accounts: 66

***** End of report *****

Fd	T	Loc	Obj	Func	Prj	OBJECT	2025-26 Revised Budget	October 2025-26 Monthly Activity	2025-26 FYTD Activity	Unexpended Balance
27	E	---	1--	-----	---	SALARIES	12,730,526.76	1,091,227.92	2,578,521.75	10,152,005.01
27	E	---	2--	-----	---	EMPLOYEE BENEFITS	5,431,054.70	464,810.68	970,157.72	4,460,896.98
27	E	---	3--	-----	---	PURCHASED SERVICES	2,026,038.05	77,843.56	489,804.40	1,536,233.65
27	E	---	4--	-----	---	NON-CAPITAL OBJECTS	11,874.00	14,594.11	30,281.29	18,407.29-
27	E	---	9--	-----	---	OTHER OBJECTS	35,351.96	48,773.92	87,843.49	52,491.53-
27	-	---	---	-----	---	SPECIAL EDUCATION	20,234,845.47	1,697,250.19	4,156,608.65	16,078,236.82

Number of Accounts: 8651

***** End of report *****



District Donation Form

Gifts, Grants, and Bequests

Today's Date: 10/2/2025

- This is a grant.
 This is a donation.
 I wish to remain anonymous.

Donor's Name: HUB International

Donor's Address: 1205 Cedar Road

Kronenwetter, WI 54455

Donor's Phone: 715-841-9105

Amount of Donation: N/A

School/Building Receiving Donation: All Schools

Department/Program Receiving Donation: students in need

Designation/Purpose of Donation: hygiene supplies, school supplies for students in need.

The Wausau School District and staff and students Department/Program

of all schools gratefully acknowledge your gift of hygiene/supplies
School/Building Donation

to be used by the Department/Program named above for students in need. Purpose

Building Principal Signature: [Signature] Date: 10/2/2025

ROUTING:
Original to Donor
Email copy to Department/Program
Email copy to Building Administrative Assistant/Building Bookkeeper
Email copy to Superintendent's Administrative Assistant at Longfellow



District Donation Form

Gifts, Grants, and Bequests

- This is a grant.
 This is a donation.
 I wish to remain anonymous.

Today's Date: 11-3-2025

Donor's Name: Knights of Columbus Council 1069

Donor's Address: _____

Donor's Phone: _____

Amount of Donation: \$ 500.00

School/Building Receiving Donation: Project Life University

Department/Program Receiving Donation:

Designation/Purpose of Donation: Special Education student/program needs at Project Life University.

The Wausau School District and students and staff
Department/Program

of Project Life University gratefully acknowledge your gift of \$ 500.00
School/Building Donation

to be used by the Department/Program named above for student/program needs.
Purpose

Building Principal Signature: Date: 11-3-2025

- ROUTING:
Original to Donor
Email copy to Department/Program
Email copy to Building Administrative Assistant/Building Bookkeeper
Email copy to Superintendent's Administrative Assistant at Longfellow



District Donation Form Gifts, Grants, and Bequests

- This is a grant.
- This is a donation.
- I wish to remain anonymous.

Today's Date: October 9, 2025

Donor's Name: VFW Veterans of Foreign Wars Burns Post 388 and Auxiliary

Donor's Address: VFW Burns Post 388

P.O Box 388 Wausau, WI 54402-0388

Donor's Phone: 715-842-0388 or email: vfw388@gmail.com

Amount of Donation: \$250.00 total \$25.00 per deceased comrade.

School/Building Receiving Donation: All 15 Wausau School District Libraries

Department/Program Receiving Donation: Library Services

Designation/Purpose of Donation: For the purchase of Library books in memory of 10 recently deceased Comrades of Post #388 VFW Wausau

The Wausau School District and Library Services along with All Media Specialists
Department/Program

of All WSD Schools gratefully acknowledge your gift of \$250.00
School/Building Donation

to be used by the Department/Program named above for Purchasing Library Books
Purpose

Building Principal Signature: *Matthew Schilling* Date: 10/9/25

- ROUTING:
- Original to Donor
 - Email copy to Department/Program
 - Email copy to Building Administrative Assistant/Building Bookkeeper
 - Email copy to Superintendent's Administrative Assistant at Longfellow



District Donation Form

Today's Date: OCT 28 2025

Donor's Name: KURT HASE

Donor's Address: 611 WEST ST
WAUSAU WI 54401

Donor's Phone: _____

Amount of Donation: PUMPKINS & VEGGIES

School/Building Receiving Donation: LINCOLN EARLY LEARNING ACADEMY (LELA)

Department/Program Receiving Donation: 4K & EC PROGRAM

Designation/Purpose of Donation: NEIGHBORLY, KINDNESS

The Wausau School District and 4K + EC PROGRAM
Department/Program

of LELA gratefully acknowledge your gift of PUMPKINS / VEGGIES
School/Building Donation

to be used by the Department/Program named above for TEACHING KINDNESS
Purpose

Building Principal Signature: Kara Rakowski Date: 10.28.25

- ROUTING:
- Original to Donor
 - Email copy to Department/Program
 - Email copy to Building Administrative Assistant/Building Bookkeeper
 - Email copy to Superintendent's Administrative Assistant at Longfellow



District Donation Form

Gifts, Grants, and Bequests

- This is a grant.
- This is a donation.
- I wish to remain anonymous.

Today's Date: 10-22-2025

Donor's Name: Knights of Columbus Council 1069

Donor's Address: 1104 S. 9th AVE
Wausau, WI 54401

Donor's Phone: _____

Amount of Donation: 500⁰⁰

School/Building Receiving Donation: Horace Mann Middle

Department/Program Receiving Donation: Special Education

Designation/Purpose of Donation: Supplies, Student Activities

The Wausau School District and Special Education, Care Department
Department/Program

of Horace Mann gratefully acknowledge your gift of 500⁰⁰
School/Building Donation

to be used by the Department/Program named above for Supplies, Student Activities
Purpose

Building Principal Signature: Bob Phulgr Date: 10-27-25

ROUTING:
Original to Donor
Email copy to Department/Program
Email copy to Building Administrative Assistant/Building Bookkeeper
Email copy to Superintendent's Administrative Assistant at Longfellow



District Donation Form Gifts, Grants, and Bequests

- This is a grant.
- This is a donation.
- I wish to remain anonymous.

Today's Date: 10/29/2025

Donor's Name: Anonymous

Donor's Address: N/A

Donor's Phone: N/A

Amount of Donation: \$1,000

School/Building Receiving Donation: Stettin Elementary School

Department/Program Receiving Donation: Nutrition Services

Designation/Purpose of Donation: Meal Account Assistance Program; Pay off negative accounts

The Wausau School District and Pupil & Nutrition Services

Department/Program

of Stettin Elementary gratefully acknowledge your gift of \$1,000

School/Building

Donation

to be used by the Department/Program named above for Meal Assistance

Purpose

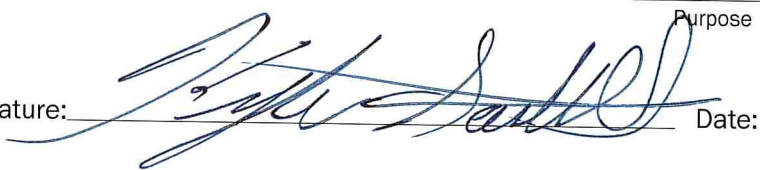
Building Principal Signature:  Date: 10/29/25

- ROUTING:
- Original to Donor
 - Email copy to Department/Program
 - Email copy to Building Administrative Assistant/Building Bookkeeper
 - Email copy to Superintendent's Administrative Assistant at Longfellow



WAUSAU SCHOOL DISTRICT DONATION FORM
(In compliance with Board Policy 1500 – Public Gifts to the Schools)

DONOR NAME: Covantage Credit Union

DONOR ADDRESS: 303 S 1st Ave, Wausau, WI 54401

DONOR PHONE: 715-845-4351

AMOUNT OF DONATION: \$350

SCHOOL: Thomas Elementary School

DEPT./PROGRAM RECEIVING DONATION: Pupil Services

DESIGNATION/PURPOSE OF DONATION: Helps kids with snacks

Date: 10/15/25

Signature

Routing:

- Original to Donor
- Email copy to Dept./Program
- Email copy to Building Secretary / Building Bookkeeper
- Email copy to Cassie Peck at Longfellow



WAUSAU SCHOOL DISTRICT DONATION FORM
(In compliance with Board Policy 1500 – Public Gifts to the Schools)

DONOR NAME: Poland Chiropractic

DONOR ADDRESS: 228 N. 3rd Ave Wausau, WI 54401

DONOR PHONE: 715-845-6722

AMOUNT OF DONATION: \$600

SCHOOL: Thomas Elementary School

DEPT./PROGRAM RECEIVING DONATION: Grades K - 5

DESIGNATION/PURPOSE OF DONATION: School/Classroom Needs

The Wausau School District and Thomas Jefferson Elementary gratefully acknowledge your donation of shoes, clothing, school supplies, classroom snacks, monetary donations, and gift cards.

Date 09/11/2025

Signature

Routing:

- Original to Donor
- Email copy to Dept./Program
- Email copy to Building Secretary / Building Bookkeeper
- Email copy to Cassie Peck at Longfellow



District Donation Form

Gifts, Grants, and Bequests

- This is a grant.
- This is a donation.
- I wish to remain anonymous.

Today's Date: 10/8/2025

Donor's Name: American Online Giving Foundation

Donor's Address: 611 Meeredith Road NE #700
Calgary, AB T2E 2W5

Donor's Phone: _____

Amount of Donation: \$92.70

School/Building Receiving Donation: Wausau Area Montessori Charter School

Department/Program Receiving Donation: N/A

Designation/Purpose of Donation: Student Activity Fund

The Wausau School District and Student Activity Fund
Department/Program

of WAMCS gratefully acknowledge your gift of \$92.70
School/Building Donation

to be used by the Department/Program named above for supporting student activity needs.
Purpose

Building Principal Signature: *E. Channell* Date: 10/8/25

ROUTING:
Original to Donor
Email copy to Department/Program
Email copy to Building Administrative Assistant/Building Bookkeeper
Email copy to Superintendent's Administrative Assistant at Longfellow



District Donation Form

Gifts, Grants, and Bequests

- This is a grant.
- This is a donation.
- I wish to remain anonymous.

Today's Date: 10/21/2025

Donor's Name: Forest Park Neighborhood - Cheryl Jones

Donor's Address: 3222 N 7th St

Wausau WI 54403

Donor's Phone: (715) 571-5791

Amount of Donation: \$350 worth of food and personal hygiene items

School/Building Receiving Donation: Wausau East High

Department/Program Receiving Donation: Zoro's Locker & Lumberjack Closet

Designation/Purpose of Donation: Students in need

The Wausau School District and Zoro's Locker & Lumberjack Closet
Department/Program

of Wausau East High gratefully acknowledge your gift of Large donation of food items for Zoro's Locker and personal hygiene items for the L
School/Building Donation

to be used by the Department/Program named above for Zoro's Locker & Lumberjack Closet
Purpose

Building Principal Signature: Lucas Barth Digitally signed by Lucas Barth
Date: 2025.10.24 13:50:55 -05'00' Date: _____

- ROUTING:
- Original to Donor
 - Email copy to Department/Program
 - Email copy to Building Administrative Assistant/Building Bookkeeper
 - Email copy to Superintendent's Administrative Assistant at Longfellow



District Donation Form

Gifts, Grants, and Bequests

Today's Date: 8-29-25

- This is a grant.
 This is a donation.
 I wish to remain anonymous.

Donor's Name: Sheldon Rouse

Donor's Address: 2217 Setter Drive

Kronenwetter WI 54455-7278

Donor's Phone: _____

Amount of Donation: \$1000

School/Building Receiving Donation: Wausau East High School

Department/Program Receiving Donation: Girls Swim - \$500 HOSA - \$500

Designation/Purpose of Donation: to use as needed for each sport/club

The Wausau School District and _____
Department/Program

of _____ gratefully acknowledge your gift of _____
School/Building Donation

to be used by the Department/Program named above for _____
Purpose

Building Principal Signature: Luke Barth/km Date: 9-15-25

ROUTING:
Original to Donor
Email copy to Department/Program
Email copy to Building Administrative Assistant/Building Bookkeeper
Email copy to Superintendent's Administrative Assistant at Longfellow



District Donation Form

Gifts, Grants, and Bequests

Today's Date: 10/8/2025

- This is a grant.
 This is a donation.
 I wish to remain anonymous.

Donor's Name: American Family Cup

Donor's Address: 3806 Schofield Ave Suite 3
Weston, WI 54476

Donor's Phone: _____

Amount of Donation: \$2,350.00

School/Building Receiving Donation: Wausau West High School

Department/Program Receiving Donation: Food Pantry

Designation/Purpose of Donation: Support for student's needs from the Food Pantry

The Wausau School District and The Food Pantry
Department/Program

of Wausau West High School gratefully acknowledge your gift of \$2,350.00
School/Building Donation

to be used by the Department/Program named above for support with student's needs
Purpose

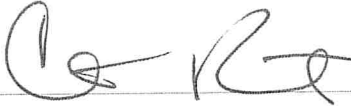
Building Principal Signature:  Date: 10/8/2025

ROUTING:
Original to Donor
Email copy to Department/Program
Email copy to Building Administrative Assistant/Building Bookkeeper
Email copy to Superintendent's Administrative Assistant at Longfellow



District Donation Form Gifts, Grants, and Bequests

Today's Date: 9/22/2025

- This is a grant.
- This is a donation.
- I wish to remain anonymous.

Donor's Name: Bethany Baptist Church

Donor's Address: 6601 Alderson St

Schofield, WI 54476

Donor's Phone: _____

Amount of Donation: \$100.00

School/Building Receiving Donation: Wausau West High School

Department/Program Receiving Donation: Food Pantry Donations

Designation/Purpose of Donation: for hygiene products that may be needed

The Wausau School District and The Food Pantry Donations acct
Department/Program

of Wausau West High School gratefully acknowledge your gift of \$100.00
School/Building Donation

to be used by the Department/Program named above for hygiene products needed
Purpose

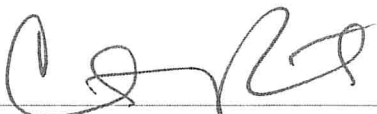
Building Principal Signature:  Date: 9/22/2025

ROUTING:
Original to Donor
Email copy to Department/Program
Email copy to Building Administrative Assistant/Building Bookkeeper
Email copy to Superintendent's Administrative Assistant at Longfellow



District Donation Form

Gifts, Grants, and Bequests

- This is a grant.
 This is a donation.
 I wish to remain anonymous.

Today's Date: 10/8/2025

Donor's Name: Chatterbox Charities

Donor's Address: 102 S. 2nd Ave
Wausau, WI 54401

Donor's Phone: _____

Amount of Donation: \$500.00

School/Building Receiving Donation: Wausau West High School

Department/Program Receiving Donation: Food Pantry

Designation/Purpose of Donation: Support for student's needs from the Food Pantry

The Wausau School District and The Food Pantry
Department/Program

of Wausau West High School gratefully acknowledge your gift of \$500.00
School/Building Donation

to be used by the Department/Program named above for support with student's needs
Purpose

Building Principal Signature:  Date: 10/8/2025

ROUTING:
Original to Donor
Email copy to Department/Program
Email copy to Building Administrative Assistant/Building Bookkeeper
Email copy to Superintendent's Administrative Assistant at Longfellow



District Donation Form

Gifts, Grants, and Bequests

- This is a grant.
 This is a donation.
 I wish to remain anonymous.

Today's Date: 10/29/2025

Donor's Name: Custom Steel Inc.

Donor's Address: 318 Ross Ave P.O. Box 25
Schofield, WI 54476

Donor's Phone: _____

Amount of Donation: \$500.00

School/Building Receiving Donation: Wausau West High School

Department/Program Receiving Donation: Skills USA

Designation/Purpose of Donation: To help support students to compete at
local, regional and state competitions

The Wausau School District and Skills USA activity account
Department/Program

of Wausau West HS gratefully acknowledge your gift of \$500.00
School/Building Donation

to be used by the Department/Program named above for support of students
Purpose

Building Principal Signature: Date: 11/5/25

ROUTING:
Original to Donor
Email copy to Department/Program
Email copy to Building Administrative Assistant/Building Bookkeeper
Email copy to Superintendent's Administrative Assistant at Longfellow



District Donation Form Gifts, Grants, and Bequests

Today's Date: 10/29/2025

- This is a grant.
 This is a donation.
 I wish to remain anonymous.

Donor's Name: Elevation Homes

Donor's Address: 5801 Packer Drive #2

Wausau, WI 54401

Donor's Phone: _____

Amount of Donation: \$1,000.00

School/Building Receiving Donation: Wausau West High School

Department/Program Receiving Donation: Skills USA

Designation/Purpose of Donation: To help support students to compete at

local, regional and state competitions

The Wausau School District and Skills USA activity account
Department/Program

of Wausau West HS gratefully acknowledge your gift of \$1,000.00
School/Building Donation

to be used by the Department/Program named above for support of students
Purpose

Building Principal Signature:  Date: 11/5/25

ROUTING:
Original to Donor
Email copy to Department/Program
Email copy to Building Administrative Assistant/Building Bookkeeper
Email copy to Superintendent's Administrative Assistant at Longfellow



District Donation Form Gifts, Grants, and Bequests

- This is a grant.
- This is a donation.
- I wish to remain anonymous.

Today's Date: 10/16/2025

Donor's Name: Ruth Geier

Donor's Address: 217341 County Road KK
Mosinee, WI 54455

Donor's Phone: 715-297-1303

Amount of Donation: \$419

School/Building Receiving Donation: Wausau West

Department/Program Receiving Donation: Music - Orchestra

Designation/Purpose of Donation: Franz Hoffman Maestro 4/4 size Violin/Bow/Case/Accessories

The Wausau School District and the Music Department
Department/Program

of Wausau West gratefully acknowledge your gift of Violin/Bow/Case/Accessories
School/Building Donation

to be used by the Department/Program named above for Orchestra
Purpose

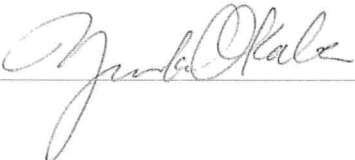
Building Principal Signature:  Date: 10/15/2025

ROUTING:
Original to Donor
Email copy to Department/Program
Email copy to Building Administrative Assistant/Building Bookkeeper
Email copy to Superintendent's Administrative Assistant at Longfellow



District Donation Form

Gifts, Grants, and Bequests

- This is a grant.
- This is a donation.
- I wish to remain anonymous.

Today's Date: 10/10/2025

Donor's Name: Michael Moern

Donor's Address: 303 S. 32nd Ave
Wausau, WI 54401

Donor's Phone: 715-848-1796

Amount of Donation: \$100⁰⁰

School/Building Receiving Donation: Wausau West High School

Department/Program Receiving Donation: Cross Country Team

Designation/Purpose of Donation: Scholarship in memory of
Darryl Westlund

The Wausau School District and the cross country team
Department/Program

of Wausau West gratefully acknowledge your gift of \$100⁰⁰
School/Building Donation

to be used by the Department/Program named above for a scholarship in memory of
Purpose Darryl Westlund

Building Principal Signature: [Signature] Date: 10/8/25

- ROUTING:
- Original to Donor
 - Email copy to Department/Program
 - Email copy to Building Administrative Assistant/Building Bookkeeper
 - Email copy to Superintendent's Administrative Assistant at Longfellow



District Donation Form

Gifts, Grants, and Bequests

- This is a grant.
 This is a donation.
 I wish to remain anonymous.

Today's Date: 09/04/2025

Donor's Name: The Needle Workshop

Donor's Address: 312 S. 3rd Ave.

Wausau, WI 54401

Donor's Phone: 715-848-5546

Amount of Donation: \$225.00

School/Building Receiving Donation: Wausau West High School

Department/Program Receiving Donation: Wausau West Food Pantry

Designation/Purpose of Donation: In support of the Food Pantry

The Wausau School District and The Food Pantry
Department/Program

of Wausau West High School gratefully acknowledge your gift of 225.00
School/Building Donation

to be used by the Department/Program named above for support and recognition
Purpose

Building Principal Signature: [Signature] Date: 9/10/25

- ROUTING:
Original to Donor
Email copy to Department/Program
Email copy to Building Administrative Assistant/Building Bookkeeper
Email copy to Superintendent's Administrative Assistant at Longfellow



District Donation Form Gifts, Grants, and Bequests

- This is a grant.
- This is a donation.
- I wish to remain anonymous.

Today's Date: 10/29/2025

Donor's Name: Rib Knights Inc - Snowmobile Club

Donor's Address: Attn: Jennifer Johnson P.O. Box 315
Wausau, WI 54402

Donor's Phone: _____

Amount of Donation: \$500.00

School/Building Receiving Donation: Wausau West High School

Department/Program Receiving Donation: Skills USA

Designation/Purpose of Donation: To help support students to compete at
local, regional and state competitions

The Wausau School District and Skills USA activity account
Department/Program

of Wausau West HS gratefully acknowledge your gift of \$500.00
School/Building Donation

to be used by the Department/Program named above for support of students
Purpose

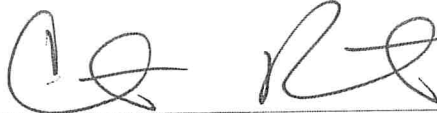
Building Principal Signature:  Date: 11/5/25

ROUTING:
Original to Donor
Email copy to Department/Program
Email copy to Building Administrative Assistant/Building Bookkeeper
Email copy to Superintendent's Administrative Assistant at Longfellow



District Donation Form

Gifts, Grants, and Bequests

- This is a grant.
- This is a donation.
- I wish to remain anonymous.

Today's Date: 10/30/2025

Donor's Name: Jill Tetzlaff

Donor's Address: 2145 Oregon Trail

Kronenwetter, WI 54455

Donor's Phone: _____

Amount of Donation: \$500.00

School/Building Receiving Donation: Wausau West High School

Department/Program Receiving Donation: Skills USA

Designation/Purpose of Donation: To help support students to compete at local, regional and state competitions

The Wausau School District and Skills USA activity account
Department/Program

of Wausau West HS gratefully acknowledge your gift of \$500.00
School/Building Donation

to be used by the Department/Program named above for support of students
Purpose

Building Principal Signature:  Date: 11/5/25

ROUTING:
Original to Donor
Email copy to Department/Program
Email copy to Building Administrative Assistant/Building Bookkeeper
Email copy to Superintendent's Administrative Assistant at Longfellow



District Donation Form

Gifts, Grants, and Bequests

- This is a grant.
 This is a donation.
 I wish to remain anonymous.

Today's Date: 09/11/2025

Donor's Name: Kyle & Elizabeth Utecht

Donor's Address: 2401 Elmwood Blvd
Wausau, WI 54403

Donor's Phone: _____

Amount of Donation: 150.00

School/Building Receiving Donation: Wausau West High School

Department/Program Receiving Donation: Technology Dept

Designation/Purpose of Donation: In support of Tech Ed dept as needed

The Wausau School District and Tech Department
Department/Program

of Wausau West High School gratefully acknowledge your gift of 150.00
School/Building Donation

to be used by the Department/Program named above for support & materials as needed
Purpose

Building Principal Signature: [Signature] Date: 9/10/25

ROUTING:
Original to Donor
Email copy to Department/Program
Email copy to Building Administrative Assistant/Building Bookkeeper
Email copy to Superintendent's Administrative Assistant at Longfellow



District Donation Form Gifts, Grants, and Bequests

Today's Date: 10/29/2025

- This is a grant.
- This is a donation.
- I wish to remain anonymous.

Donor's Name: Vizion Design Group

Donor's Address: 5801 Packer Drive #2
Wausau, WI 54401

Donor's Phone: _____

Amount of Donation: \$1,000.00

School/Building Receiving Donation: Wausau West High School

Department/Program Receiving Donation: Skills USA

Designation/Purpose of Donation: To help support students to compete at
local, regional and state competitions

The Wausau School District and Skills USA activity account
Department/Program

of Wausau West HS gratefully acknowledge your gift of \$1,000.00
School/Building Donation

to be used by the Department/Program named above for support of students
Purpose

Building Principal Signature: [Signature] Date: 11/5/25

ROUTING:
Original to Donor
Email copy to Department/Program
Email copy to Building Administrative Assistant/Building Bookkeeper
Email copy to Superintendent's Administrative Assistant at Longfellow



District Donation Form Gifts, Grants, and Bequests

Today's Date: 9/12/2025

- This is a grant.
 This is a donation.
 I wish to remain anonymous.

Donor's Name: WAUSAU MARATHON

Donor's Address: (No address given)

Donor's Phone: _____

Amount of Donation: \$1,900.00

School/Building Receiving Donation: Wausau West High School

Department/Program Receiving Donation: Cross Country Team

Designation/Purpose of Donation: In Support of the Cross Country team

The Wausau School District and Cross Country team
Department/Program

of Wausau West High School gratefully acknowledge your gift of \$1,900.00
School/Building Donation

to be used by the Department/Program named above for support of the team
Purpose

Building Principal Signature:  Date: 9/17/25

- ROUTING:
Original to Donor
Email copy to Department/Program
Email copy to Building Administrative Assistant/Building Bookkeeper
Email copy to Superintendent's Administrative Assistant at Longfellow



MEMO

TO: Education/Operations Committee of the Whole
 FROM: Josh Viegut, Assistant Superintendent of Operations
 DATE: October 27, 2025

RE: Legal Expenses for 1st Quarter of 2025-26

In an effort to inform the Board of all legal expenses incurred during the fiscal year, the following report captures all legal costs separated by category and law firm. This summary report represents a quarterly review for all legal expenses incurred during the first quarter of 2025-26 for which the District was billed as well as the year to date total.

7/1/25 to 9/30/25	FIRM	2025 - 2026 WSD 1st Quarter Legal Expenses											
		Student Services	HR Management and Administration	HR Personnel Issues and Grievances	Contract Review	Audit Related	Tax Sheltered Annuities	Board of Education	Insurance Issues	Open Records	Misc.	TOTAL	
	ATTOLLES LAW												-
	BOARDMAN & CLARK LLP	231						165		99			495
	BUELOW VETTER BUIKEMA												-
	QUARLES AND BRADY												-
	RUDER WARE												-
	WISCONSIN ASSOCIATION OF SCHOOL BOARDS												-
	VON BRIESEN & ROPER												-
	STRANG, PATTESON, RENNING, LEWIS & LACY												-
	RENNING, LEWIS & LACY	233	1,505	403	6,966			403			16		9,526
	STRANG LAW												-
	TOTAL	464	1,505	403	6,966	-	-	568	-	99	16		10,021



RIVERVIEW ELEMENTARY SCHOOL

PRESENTED BY:





INTRODUCTION

Background

Project Experience

Sample Client List

Riverview Elementary Summary

Project Team

Design & Construction Delivery Method





BACKGROUND

Milwaukee School of Engineering (MSOE) Graduate

- 2004 – B.S. Architectural Engineering with Environmental Specialty
- 2004 – M.S. Environmental Engineering

Work Experience

- Graef – 2.5 years
- Ring & DuChateau – 9 years
- Dynamic Consulting Engineers – 9 years
- MSOE Faculty – 19 years

Professional Engineer registered in Wisconsin since 2008

PROJECT EXPERIENCE



Market Sector Expertise:

- Office Buildings
- Industrial Buildings
- Educational
- Health Care – Medical Office Buildings
- Laboratories
- Data Centers
- Churches



CLIENT LIST



RIVERVIEW ELEMENTARY EXISTING CONDITIONS



Roof:

- EPDM Roof Replacement

HVAC:

- Air Handling Units
- Boilers
- Chiller

Electrical:

- Lighting Upgrade
- Fire Alarm Upgrade



RIVERVIEW ELEMENTARY EXISTING CONDITIONS



Roof:

- EPDM Roof Replacement

HVAC:

- Air Handling Units
- Boilers
- Chiller

Electrical:

- Lighting Upgrade
- Fire Alarm Upgrade

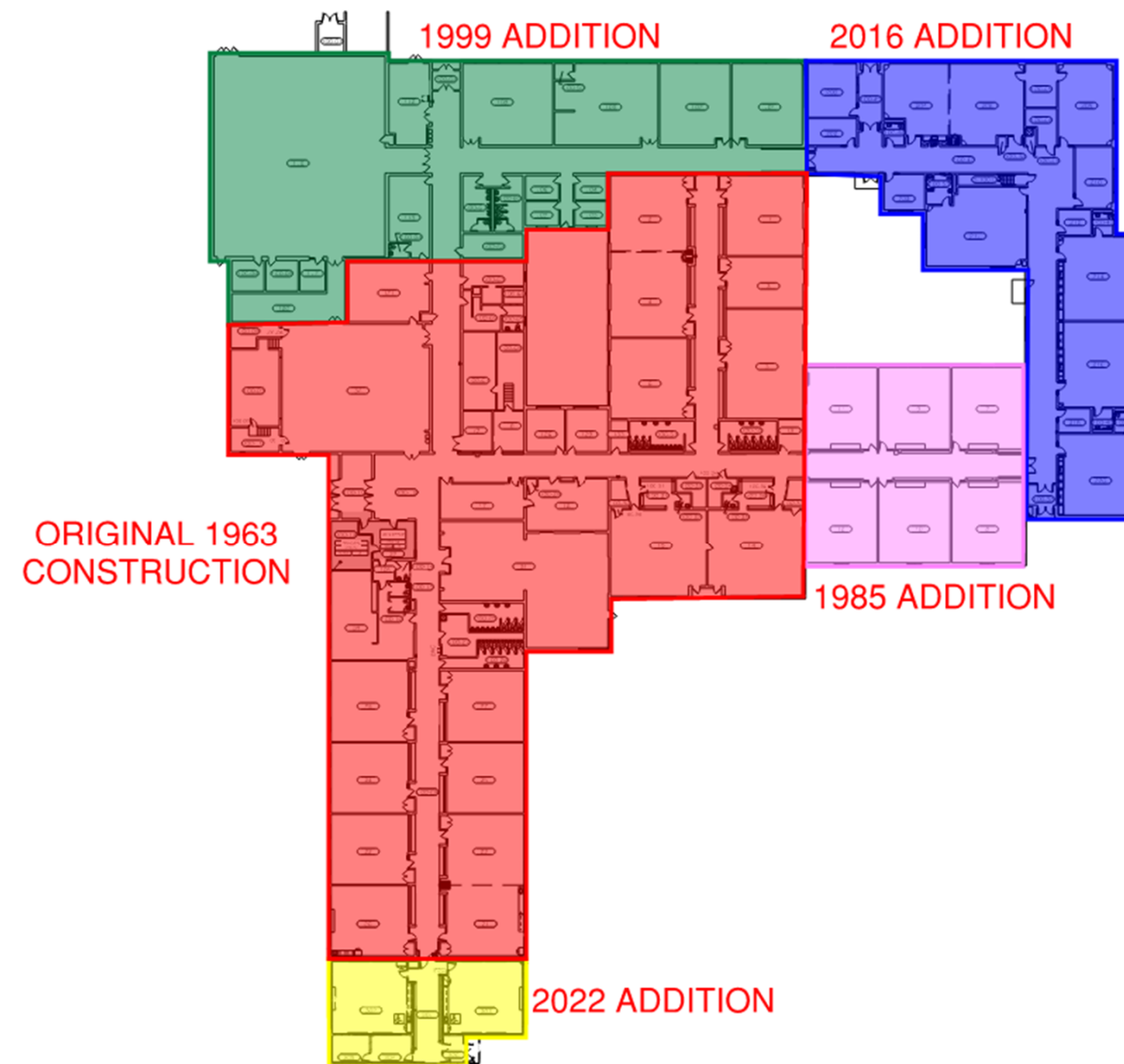

RIVERVIEW ELEMENTARY EXISTING CONDITIONS



Roof:

- EPDM Roof Replacement

HVAC:

- Air Handling Units
- Boilers
- Chiller

Electrical:

- Lighting Upgrade
- Fire Alarm Upgrade



PROJECT TEAM



DYNAMIC

Dynamic Consulting Engineers

David Grassl, PE

Principal-in-Charge & Project Manager

ARCHITECT

**Dan Beyer
Architects**

Dan Beyer, AIA

**MECHANICAL &
PLUMBING
ENGINEERS**

**Dynamic
Consulting Engineers**

Ed Gill, PE

**STRUCTURAL
ENGINEERS**

Pierce Engineers

Tom Hildebrandt, PE

**ELECTRICAL
ENGINEERS**

**Kornacki &
Associates**

David Kornacki, PE

**BUDGET &
SCHEDULE**

**General
Contractor**



PROJECT DELIVERY

Design to 75% Construction Documents

Issue RFP for Construction Manager at Risk

Pre-Construction Services

- Estimating
- Scheduling

Finish Construction Documents

Issue for Bid by Construction Manager at Risk to Subcontractors

Construction

Owner Turnover & Occupancy



THANK YOU!

Secondary Updates: Activities Code/Fees/Courses

Athletics/Activities Code Amendment

- Due to a change in grading practices at the secondary level, we would like to update the athletics/activities code verbiage around academic eligibility to reflect these changes.
 - [Section 5.A of the Wausau School District 6-12 Athletics and Activities Code of Conduct](#)

B. Academic

In order to be academically eligible, a student must have no failing ~~quarter~~ grades **at the end of quarter 1, semester 1, quarter 3 and semester 2**. A student not meeting this criterion will be ineligible for activities for fifteen (15) consecutive scheduled school days and nights. The ineligibility will begin on the fifth (5th) scheduled school day following the end of the first (1st) **quarter, first (1st) semester, second (2nd)**, or third (3rd) quarter. Eligibility for activities that begin on or before the first (1st) quarter of the new academic year shall be based on the previous ~~fourth (4th) quarter~~ **second (2nd) semester** grades. Opportunities may exist to regain eligibility through summer school courses. Students who are ineligible due to ~~fourth-quarter~~ **second semester** grades, may restore eligibility by taking and successfully completing the same number of courses (maximum of two), which caused ineligibility over summer school.

Grade changes and removal of an incomplete grade must be completed within two weeks of the date grades are posted. Students will remain ineligible until the grade is changed or the incomplete is removed.

To regain eligibility, a student must complete a grade check with the Activities Director on the fifteenth (15th) school day after the declaration of ineligibility to ensure passing grades in all classes. To maintain eligibility, the student must complete a second grade check on the thirtieth (30th) school day after the declaration of ineligibility to ensure continued passing grades in all classes. A student who is ineligible due to failing grades, will continue to practice, may attend home games but not travel with the team to away events, and may not return to competition - until the SCHOOL DAY FOLLOWING the fifteen (15) day ineligibility period. For fall activities, the period of ineligibility is the lesser of twenty-one (21) calendar days beginning with the date of earliest allowed competition in an activity or one-third of the maximum number of games/meets allowed in an activity. Students who withdraw-fail during the first or third quarter will be academically ineligible for the fifteen (15) day period and cannot return to competition until after this 15 day period. The student will not become ineligible for the same class when ~~2nd or 4th quarter~~ **grades semester 1 or semester 2 grades** are posted.

Motion

- We are seeking a motion to approve the amendment to the 2025-2026 Wausau School District 6-12 Athletics and Activities Code effective immediately.

Course Fees

- Fee Reductions
 - Spanish III & IV at East (from \$2-\$0)
 - Spanish IB I at East (from \$20-\$0)
 - Med Term at East/West (from \$80-\$5)
 - Dual-Credit
 - NTC stopped requiring the purchase of a specific textbook for the course
- Fee Increases
 - Foods I, II, III and Food Science at East/West (from \$25-\$30)

***If a family finds fees to be a barrier to access, we work with them to find a solution that works for everyone.

High School Athletics Fee Proposal

- Increase Athletics User Fee from \$50 to \$100
 - 3 sport athletes will pay fees for 2 out of their 3 sports
- Rationale
 - Costs associated with officials, transportation, entry fees, and other consumables associated with athletics have increased.
 - The last athletics fee increase took place in 2001.

***If a family finds fees to be a barrier to access, we work with them to find a solution that works for everyone.

Motion

- We are seeking a motion to approve all course fee increases and reductions as discussed for the 2026-2027 school year.
- We are seeking a motion to approve an increase in the high school athletics fee from \$50-\$100 for the 2026-2027 school year.

New Course: Art Foundations I and II

- Art Foundations I is the initial semester art course that explores drawing, painting, sculpture, and ceramics, focusing on the Art Elements in both two- and three-dimensional mediums. Emphasis is on initial techniques in various media and exploration.
- Art Foundations II extends the concepts learned in Art Foundations I. This course is highly recommended for all students, but especially serious art students. The Art Foundation II curriculum is an exploration of two and three-dimensional forms, focusing on the principles of design in a variety of media.
- Unless you are a junior or senior standing, Art Foundations I is a prerequisite class for all level-one art courses.
- These courses are both one-semester classes, offering .5 credit per course completed. Each course would require a lab fee of \$11/semester to offset expenses for class supplies.

New Course: ServSafe

ServSafe is an educational program from the National Restaurant Association that provides food safety training and certification for food service professions.

It offers various certifications, including for food handlers and managers, which cover topics like personal hygiene, time and temperature control, and preventing cross-contamination. Most working in the food industry are required to obtain this certification either before or shortly after accepting a position.

Working in food service is a high demand job/career and there are many places that will increase an offer of wages knowing the future employee already has the certification. If they do not have the certification the employer must provide the education, training and testing for their employees at the employers expense.

The certification is widely recognized and often required by local health departments, including Marathon County Health Department.

Upon successful completion of the ServSafe course students will earn 1 dual credit through NTC and with a score of at least 70% earn their ServSafe 'Food Handler' certification.

This course is a one semester course offering .5 credit in the WSD. The ServSafe course would require a lab fee of \$30/semester to offset expenses for their weekly labs.

Motion

- We are seeking a motion to approve Art Foundations I, Art Foundations II, and ServSafe to the district high school course catalogue for the 2026-2027 school year.



HIGH SCHOOL ATHLETIC FEES FOLLOW-UP



Review

We are proposing to raise the athletics fee for all athletics from \$50 per sport to \$100 per sport (with a cap of \$200 maximum for 3-sport athletes.



Rationale

- Since 2001, the cost to provide athletics has increased significantly, while the athletic fee amount has remained the same.
 - Inflation since 2001 is greater than 80%
 - \$50 in 2001 = \$92.75 in 2025
- Increasing costs and stagnated state funding (over 25 years) has created budgetary constraints and shortfalls in 2024-2025
 - Wausau East
 - 2024-25: **-\$13,807.00**
 - Wausau West
 - 2024-25: **-\$11,706.04**
 - Associated costs are **required** items, services, and equipment tied to operations of athletics and activities



Increases in Costs over Time

- Examples of costs that have increased over time:
 - Referees (past 5 years)
 - Track increased from \$90 to \$200
 - Football increased from \$90 to \$120
 - Basketball increased from \$90 to \$110
 - Approximate 35% increase in official costs over the past 5 years
 - Transportation (past 3 years)
 - Approximate 15% increase in busing costs
- Wausau West Athletic Budget in 2001: \$121,249
- Wausau West Athletic Budget in 2025: \$182,315



Current Athletic Budget



Wausau West

- \$182,315
- Athletic fees collected:
\$40,031*
- Total participants (24-25): 875



Wausau East

- \$155,917
- Athletic fees collected:
\$29,315*
- Total participants (24-25): 647

**Athletic fees collected are included in the budget total*



School Athletics' Expenses 2024-25



Wausau West

- This year's budget: \$182,315
- Expenses from 2024-25:
 - Referees: \$66,643.70
 - Transportation: \$74,352.82
 - Examples of Operational Expenses: \$33,225:
 - Same for each school
 - See next slide
 - Entry fees: \$13,480



Wausau East

- This year's budget: \$155,917
- Expenses from 2024-25:
 - Referees: \$44,988.00
 - Transportation: \$69,386.52
 - Examples of Operational Expenses: \$33,225:
 - Same for each school
 - See next slide
 - Entry fees: \$8,500



Continued...

- Examples of consumables and other expenses
 - Hudl: \$8,500 per school
 - CPR Certification: \$28 per coach every 2 years, plus the cost of the instructors 2x a year
 - Athletic letters, pins and bars: \$2,000 estimated per year
 - Printing: \$1,000
 - Conference dues and fees: \$5,300 per school
 - Athletic trainer consumables: \$1,800 per year
 - Porta potties: \$3,400 per school
 - Arbiter/rSchool: \$1,500 per school
 - Healthy Roster: \$1,875 per school
 - Neptune Radio - Clean Entertainment: \$3,000 per school
 - Train Heroic App: \$1,350
 - Travel Expenses: \$3,000

*Many of these budgetary items did not exist in 2001



Impact of Athletic Fee Increase

- How will the school use the increase in fees to benefit the programs?
 - Athletic fees directly support the athletic departments
 - Assist programs in the purchase of consumables, equipment, and services
 - Allow greater flexibility in booster club support of programs



Athletic Fees Around the WVC Conference/Area

- SPASH: A tiered system, depending on the sport - ranging from \$100-\$150 a sport
 - Extra fees associated with hockey
- DCE: A tiered system, depending on the sport, ranging from \$55-\$75 a sport
 - Extra fees associated with hockey
- Wausau: Currently \$50 a sport, seeking to raise it to \$100 a sport
 - Proposed increase would place Wausau between DCE and SPASH
- Marshfield: \$40- 2 per year max
 - Extra fees associated with hockey and golf
- Wisconsin Rapids: No user fee
 - Except for hockey: \$500

Other districts:

- Eau Claire: \$200/sport
- Mosinee: \$40/sport
- Merrill: No user fee



FEE REDUCTIONS PROCESS

- Free and reduced lunch rates
 - 50% reduction
- Fee reduction plans for families
 - Website option
 - Private meeting with ADs or other building administrators



Wausau East and Wausau West would never prohibit a student from participating in athletics/activities when fees are a barrier!





THANK YOU!

