

# **District 23 Working Committee Meeting**

Monday, September 26, 2022 5:30 PM

Grodsky Administration Building, 700 N Schoenbeck Rd, Prospect Heights, IL  
60070

## **I. Call to Order**

## **II. Roll Call**

## **III. Working Items**

III.A. Building a Better D23

III.B. Website Reboot

III.C. Custodian Appreciation Day - Oct. 3

III.D. D23PTO Golf Outing

III.E. Fundraisers - BOE approval

III.F. D23 Family Fest

III.G. Halloween Parades and Parties

III.H. Family Engagement Goals

## **IV. Old Business**

## **V. New Business**

## **VI. Adjournment**



# Prospect Heights School District 23

700 N. SCHOENBECK ROAD, PROSPECT HEIGHTS, ILLINOIS 60070

## DISTRICT OFFICE

Phone (847) 870-3850  
Fax: (847) 870-3896

## EISENHOWER SCHOOL

Phone (847) 870-3875  
Fax: (847) 870-3877

## BETSY ROSS SCHOOL

Phone (847) 870-3868  
Fax: (847) 870-3898

## ANNE SULLIVAN SCHOOL

Phone (847) 870-3865  
Fax: (847) 870-8113

## MACARTHUR MIDDLE SCHOOL

Phone (847) 870-3879  
Fax: (847) 870-3881

October 10, 2022

Dear Residents:

At District 23, we know that a community's education system is a shared public asset that benefits and impacts not only the children it serves, but the taxpayers who support it. This is your community, and these are your schools. That's why we're seeking your thoughts, opinions, and feedback regarding a funding proposal to improve our school buildings and programming—together *Building a Better D23*.

**The District 23 Board of Education is considering placing a funding measure on the April 2023 ballot,** with the proceeds focused on improving safety and security, addressing high-priority repairs and renovations, and adding and reconfiguring instructional space to expand full-day kindergarten and early childhood education programming. Due to space constraints, 35% of currently eligible students cannot participate in this programming.

**It's been 35 years since voters approved funding for improvements and upgrades at District 23's four schools.** Since then, we have done our best to be responsible stewards of the funds we gratefully receive from you, our taxpayers. Our schools have been properly maintained and our commitment to providing an innovative, student-centered education is unwavering. However, there are certain capital improvement projects that go beyond the scope of general upkeep and maintenance. Additionally, to meet the needs of today's students and families, important changes to improve security and advance instructional programming are warranted.

**With the funding proposal being considered, all four schools in the District would benefit.** Districtwide capital improvement projects include adding security cameras, replacing outdated exterior doors and windows, and repairing or replacing aging siding.

**Additional repairs, renovations and additions are also proposed for Eisenhower Elementary School.** These improvements include creating a new secure entryway and a safer traffic loop; adding space to expand full-day kindergarten and early childhood education for all eligible students; reconfiguring and adding space for school psychologists, speech therapists, and other student support professionals to **improve** program delivery and **enhance** confidentiality; and constructing a larger multipurpose room to meet the needs of our growing student body and community.

**There are many anticipated benefits of the proposed improvements,** including **improving** safety and security, **enhancing** programming, extending the useful life of existing facilities, solving overcrowding, **improving** energy efficiency, and protecting property values.

**The longstanding community need for full-day kindergarten and early childhood programming for all eligible students would finally be addressed.** If implemented, these programs would help **improve**

Please contact us if you would like this communication translated into your native language.

Por favor, póngase en contacto con nosotros si desea que esta comunicación traducido a su idioma nativo.

Prosimy o kontakt, jeżeli chcą Państwo by wiadomość ta została przetłumaczona na Państwa język ojczysty.

learning outcomes for students by creating a foundation for growth and success. They would also align our District's offerings with those of peer districts that already offer full-day kindergarten for all eligible students, enhancing our appeal to families.

**The proposed capital improvements are estimated to total \$24 million.** However, the proposal calls for the District to address \$4 million of the project costs with non-referendum dollars. Operating costs, including staff, materials, utilities and maintenance, are estimated to increase \$1.2 million annually due to increased enrollment in kindergarten and early childhood education programming.

**To address both building improvements and operating costs, District 23 is considering placing a limiting rate increase of 0.472 on the April 2023 ballot.** Approximately 58% of the proceeds would be allocated to capital improvement projects and the remaining 42% would be used to address operating expenses. The estimated annual tax impact is \$44.65 per \$1,000 of taxes paid, or approximately \$486 for a home with a fair market value of \$350,000.

**District 23 values the community's input.** Earlier this year, a Citizen Task Force was formed to vet proposed improvements and financing options. Additionally, in the next few weeks, a public opinion survey will be mailed to you and all other registered voter households in the District. We would greatly appreciate your participation.

The District will be hosting additional public information meetings this month.

#### Public Information Meetings

Eisenhower Elementary School  
1 N Schoenbeck Rd, Mt Prospect, IL 60056

- Tuesday, October 18, 6 p.m., Anne Sullivan Elementary School
- Thursday, October 27, 7 p.m., Eisenhower Elementary School

Further details and current updates about the proposal can be found on our website at [www.d23.org](http://www.d23.org).

If you have any questions, concerns, or comments, feel free to contact me at 847.870.5554 or [dangelaccio@d23.org](mailto:dangelaccio@d23.org).

Respectfully,



Donald S. Angelaccio, Ed.D.  
Superintendent of Schools

# Proposed Improvements to Eisenhower Elementary School

In addition to safety, security, and building envelope improvements at all four of its schools, District 23 also seeks to address facility repairs, renovations, and additions at Eisenhower Elementary School. Upgrades include a new main entry and bus loop, adding classrooms for full-day kindergarten and early childhood education expansion, addressing space needs for psychologists and other student support service professionals, and providing a larger multipurpose room.



## New Secure Main Entry

A new secure main entry where visitors can be properly screened would be located adjacent to a new parking lot and include a parent waiting area. The Administration and Nurse's office would be relocated adjacent to the new main entry to further enhance safety and security.



## New Classrooms

The proposal calls for the addition of eight new classrooms to alleviate overcrowding and expand full-day kindergarten and early childhood education to serve all eligible students.



## Multipurpose Room

A new, larger multipurpose room would provide much-needed space for lunch, physical education, after-school programming, and other needs. The multipurpose room would be close to the fields and outdoor play. It would also be available for community use when school is not in session.

areas? spaces?



## New Parking & Bus Loop

Parking and traffic flow improvements, including a new bus loop, would improve both pedestrian and vehicular safety.



## Reclaimed Library Space

Half of the library would no longer be occupied by student support specialists. It would be fully returned to library programming, benefiting all Eisenhower students.



## Space for Specialists

There is currently a significant lack of space for school psychologists, speech pathologists, tutors, and other specialists. The proposed improvements would address these space needs.



To learn more about District 23's proposed facility and site improvements please scan the QR code or visit [www.d23.org](http://www.d23.org).

# Every District 23 School Would Benefit

Proposed improvements at each District 23 school include the replacement of doors, windows and siding that are more than 25 years old and the addition of security cameras. These improvements would provide a more secure perimeter, enhance energy efficiency, extend the useful life of **existing facilities and reduce costly** emergency repairs. The District also seeks to address other high-priority improvements at Eisenhower Elementary School.

missing comma



Eisenhower Elementary School  
Pre-K - Grade 1



Betsy Ross Elementary School  
Grades 2-3



Sullivan Elementary School  
Grades 4-5



MacArthur Middle School  
Grades 6-8

## Before



All District 23 schools are in need of exterior envelope repairs, including Anne Sullivan Elementary School pictured above.

## After



Conceptual Rendering of Anne Sullivan Elementary School with new windows, doors and siding.



Conceptual Rendering of Betsy Ross Elementary after improvements



Conceptual Rendering of Eisenhower Elementary after improvements



Conceptual Rendering of MacArthur Middle School after improvements

## Anticipated Benefits

- Improving safety and security
- Extending the useful life of existing facilities and reducing costly emergency repairs
- Expanding full-day kindergarten and early childhood education to serve all eligible District 23 students
- Alleviating overcrowding
- Improving energy efficiency, saving taxpayer dollars
- Protecting property values



# building a better D23

facilities and early childhood planning  
community presentation

september 29, 2022  
october 6, 2022  
october 18, 2022  
october 27, 2022





## agenda

- Welcome
- About D23
- Needs and priorities
- Existing conditions and proposed solutions
- Finances and funding
- Next Steps
- Questions and conversation

# welcome



**BUILDING  
A BETTER D23**



# four buildings—one school community



Betsy Ross  
Elementary  
Grades 2-3



Eisenhower  
Elementary  
Grades PK-1



Anne Sullivan  
Elementary  
Grades 4-5



MacArthur  
Middle School  
Grades 6-8





## about D23

- December, 1865—School is In Session!
- Currently serving students from four municipalities
  - Arlington Heights
  - Mount Prospect
  - Prospect Heights
  - Wheeling
- Approximately 1,500 Students
- Approximately 235 Total Staff (full and part-time),  
Represented by two organizations (PHEA and SEIU)
- Strong Community and Family Partnerships



# needs & priorities





# community priorities & district needs

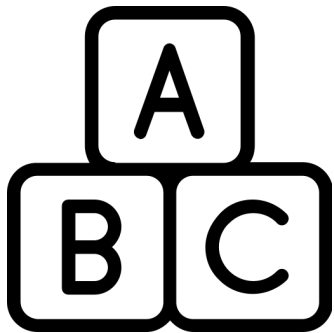

**Provide Full-Day  
Kindergarten &  
Early Childhood  
Education for ALL  
Students**

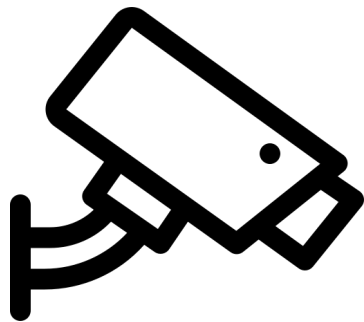

**Enhance and  
Improve  
Safety &  
Security**

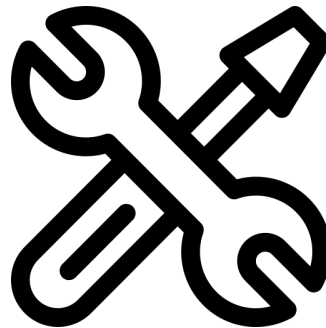

**Repair &  
Maintain  
Facilities**



**Support Community  
Needs**



## early learning

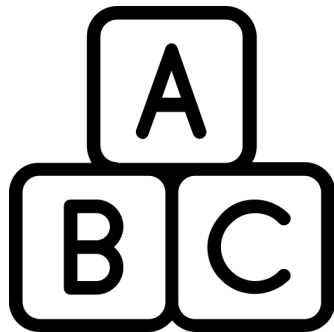

**Provide Full-Day Kindergarten (FDK) & Early Childhood Education (ECC) for ALL Students**

- High quality early learning programs are the foundation for student success.
- More time in school means more time for learning!
- D23 is unable to serve 35% of students who are eligible for ECC and FDK due to space constraints at Eisenhower school.
- Full-day kindergarten can narrow the achievement gap and translate into a decreased need for remedial and intervention services.
- D23 will soon be the only D214 feeder district that does not offer FDK.





## safety & security

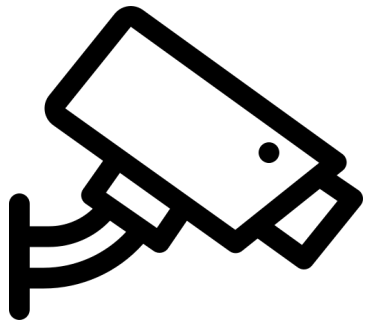

**Enhance and  
Improve  
Safety &  
Security**

- The safety and security of students and staff is our highest priority.
- We regularly evaluate and refine our plan and conduct staff training.
- The following enhancements are recommended:
  - Adding additional security cameras
  - Improving traffic flow to enhance pedestrian and vehicular safety.
  - Improving perimeter sight lines for better supervision.
  - Replace existing secure entrance at Eisenhower school.



## facilities

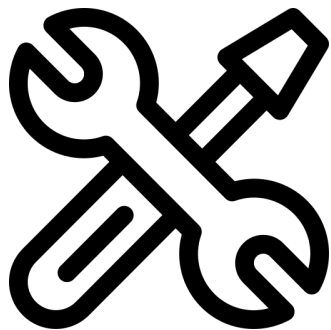

### Repair & Maintain Facilities

- The District's long range facilities plan provides a roadmap for identifying and addressing infrastructure needs at all four schools.
- Alleviates overcrowding at Eisenhower.
- Windows, siding, and doors at the four buildings are over 25 years old.
- Functionality, energy efficiency, and security are compromised and our buildings appear dated.



## community



### Support Community Needs

- Our public schools are a community asset that impact both the students we serve and the taxpayers that support us.
- D23 works collaboratively with the Prospect Heights & Arlington Heights Park Districts and other community organizations.
- District multi-purpose rooms, gyms, and fields are used by the park districts and other organizations when school is not in session.

# existing conditions & proposed solutions



every D23 school will benefit



# current exteriors





betsy ross rendering



potential

existing





# anne sullivan rendering



potential

existing





macarthur rendering



potential

existing





# safety & security

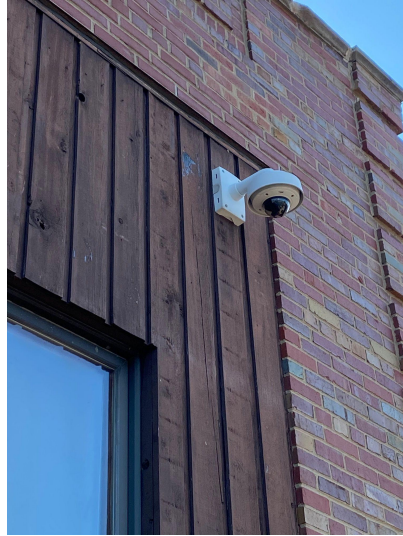



# eisenhower capacity challenges

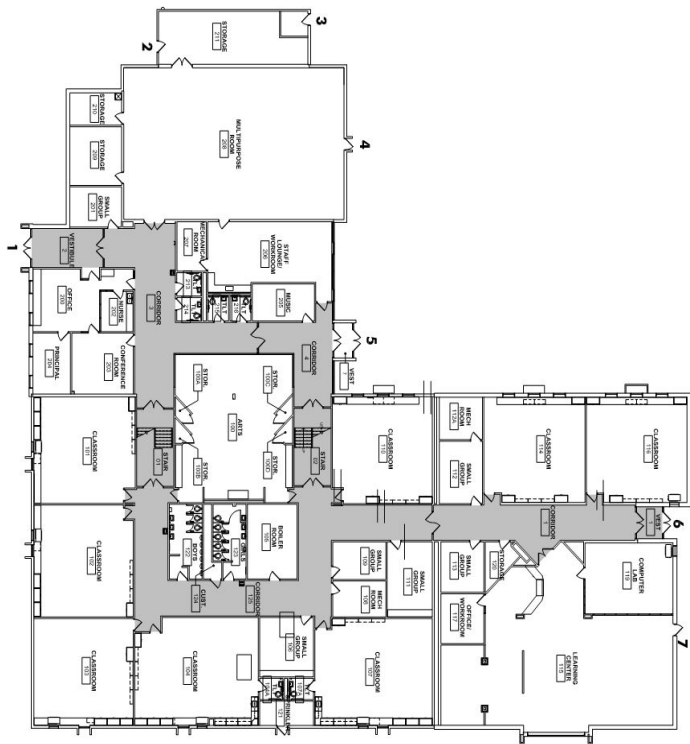

1. The District is unable to serve 35% of Pre-K and Kindergarten students because there are not enough classrooms.
2. The Library is being used for Occupational Therapy and Reading Support; this limits access for other students.
3. Support Service staff are sharing offices; Overcrowding complicates service provision and staff has to negotiate for space.
4. The Multipurpose Room is at maximum capacity and is fully utilized during all school hours.



# eisenhower proposed solution



1. Add eight (8) additional classrooms to alleviate overcrowding and expand early childhood and full-day kindergarten programming to accommodate all eligible students.
2. Enlarge the multi-purpose room to accommodate additional enrollment.
3. Add dedicated space for speech and language, reading, and math support as well as psychologists and social workers.
4. Reclaim library space.



# eisenhower—program enhancements

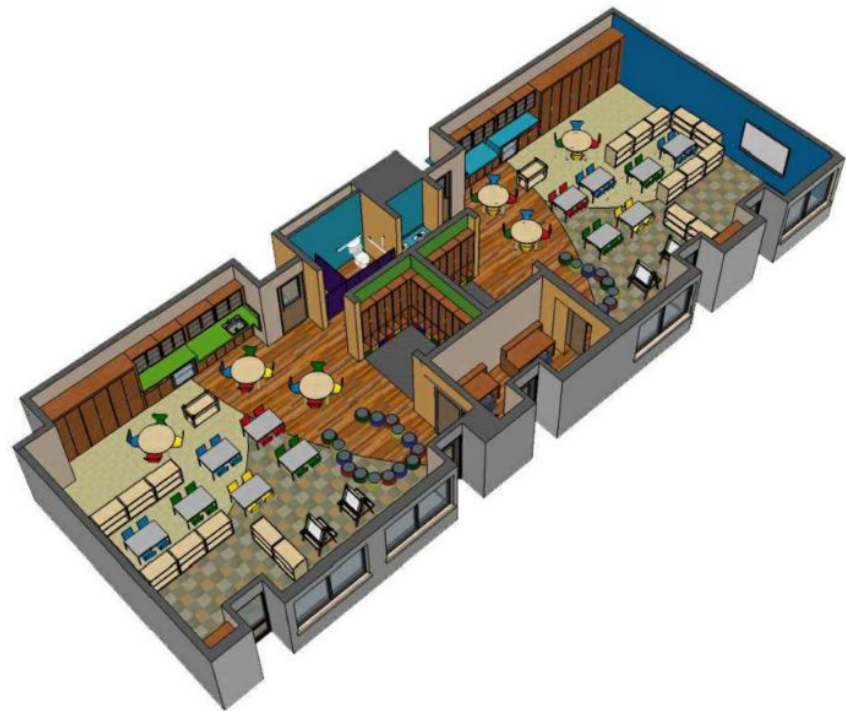



# eisenhower—safety & security





# eisenhower—community enhancements

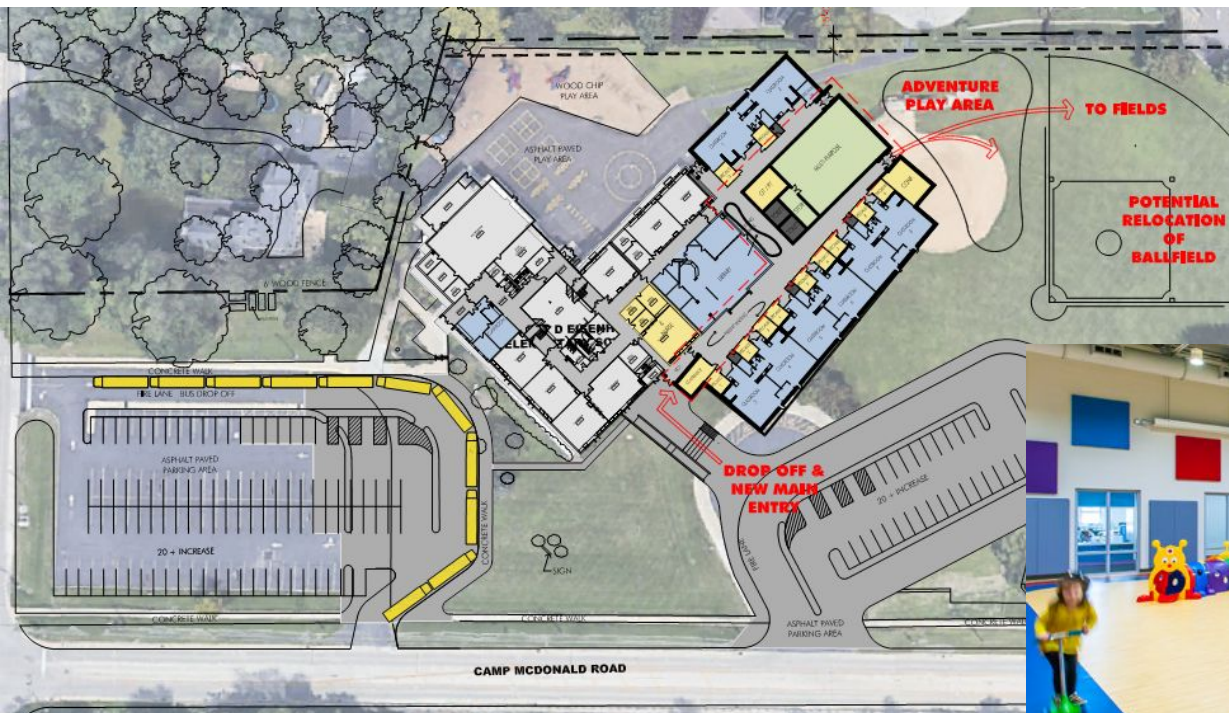

# finances & funding





# D23 revenue overview

**83.7% of D23 revenue comes from local sources.**

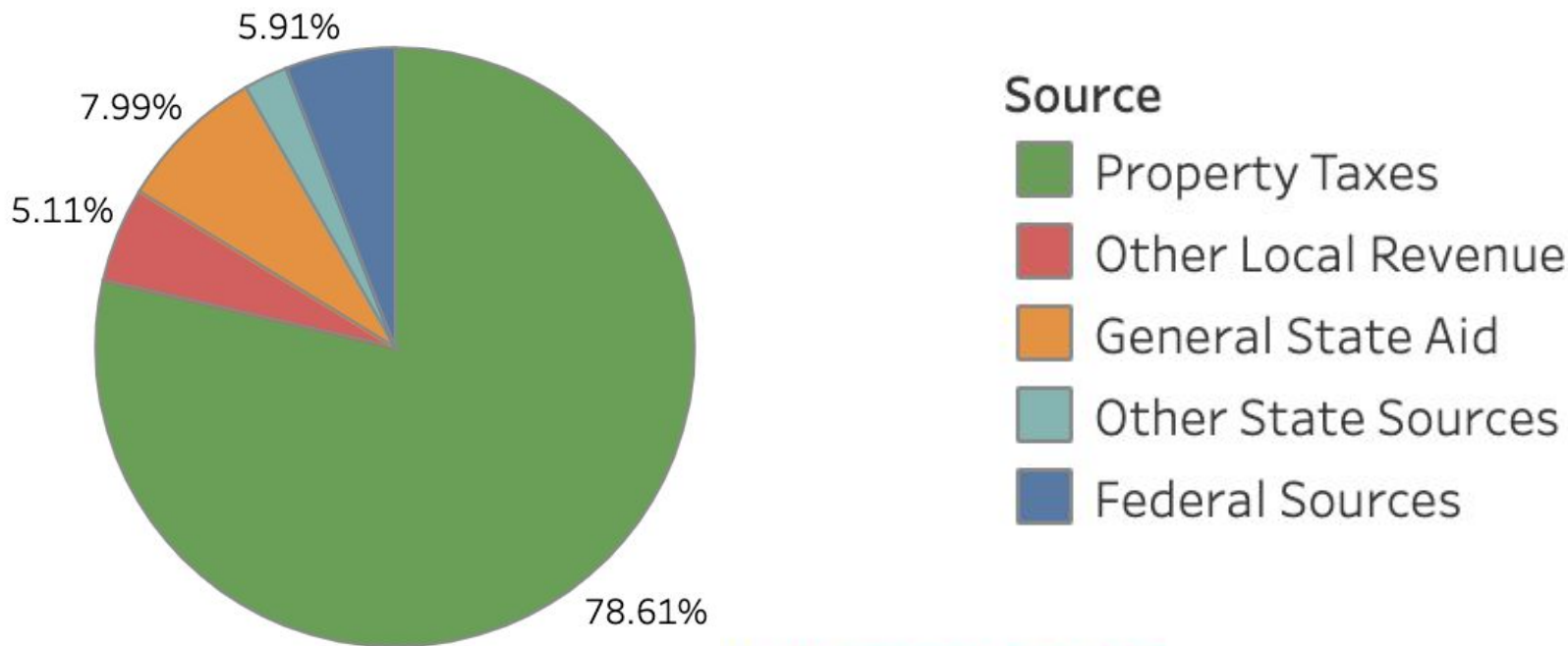



# D23 expenditure overview

**96.4% of D23 revenue is spent on instruction and support services.**

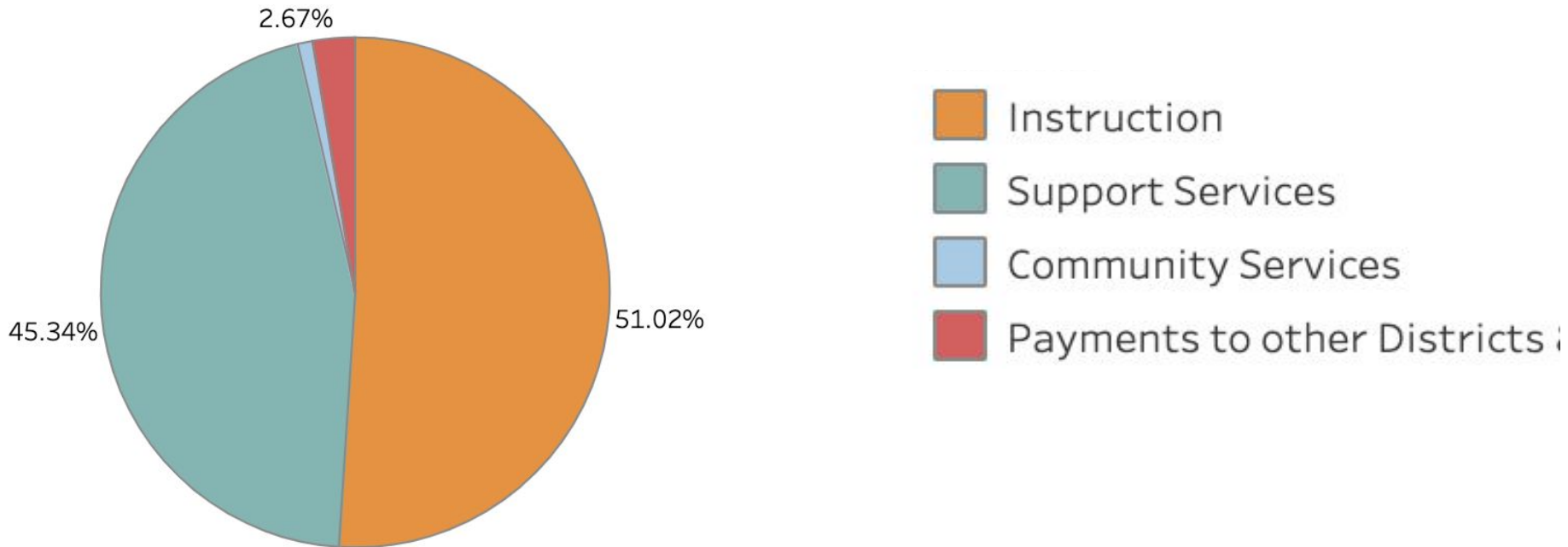



# D23 fund balances

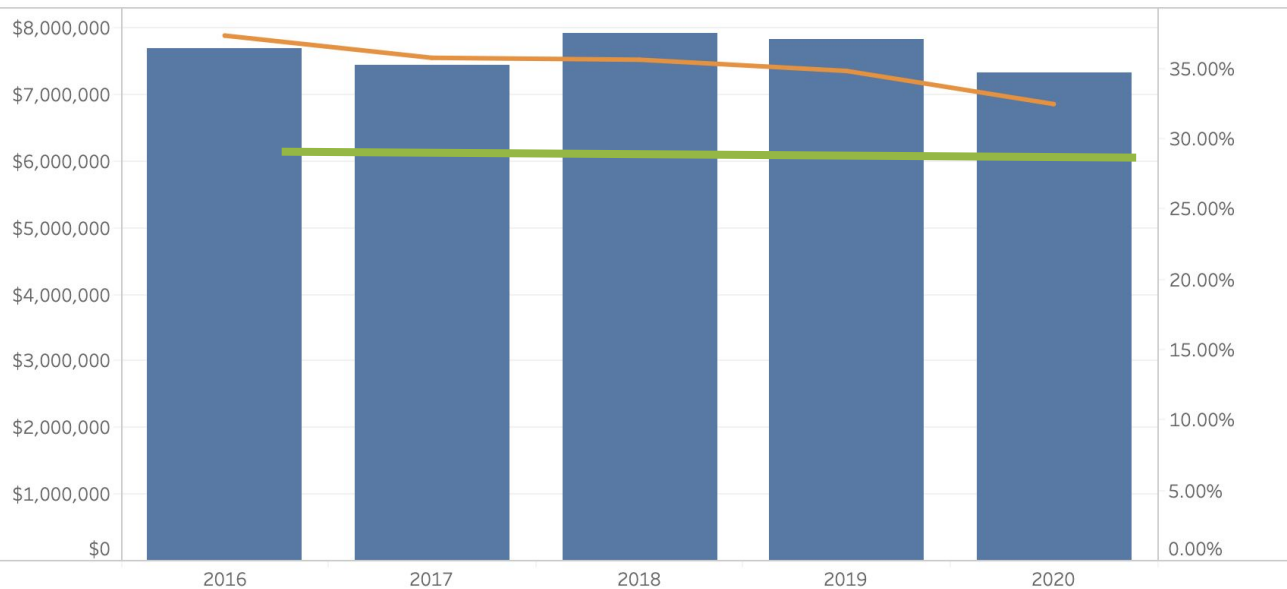

Fund balances represent accumulated surpluses and provide financial flexibility. The orange line represents the ratio of fund balance to total revenues. The green line represents the District's fund balance goal.



FY 2020



# D23 fund balances—local comparisons

***D23 fund balances are lower than neighboring districts.***

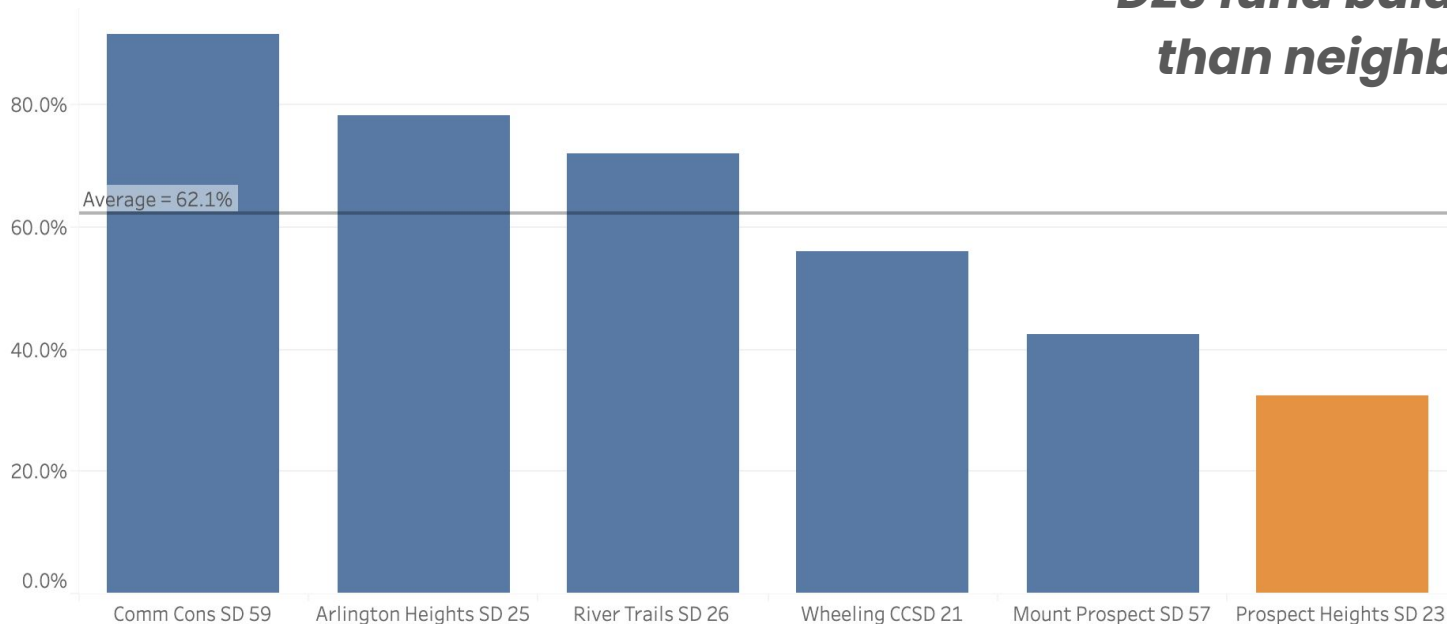

FY 2020



# D23 tax rate—local comparisons

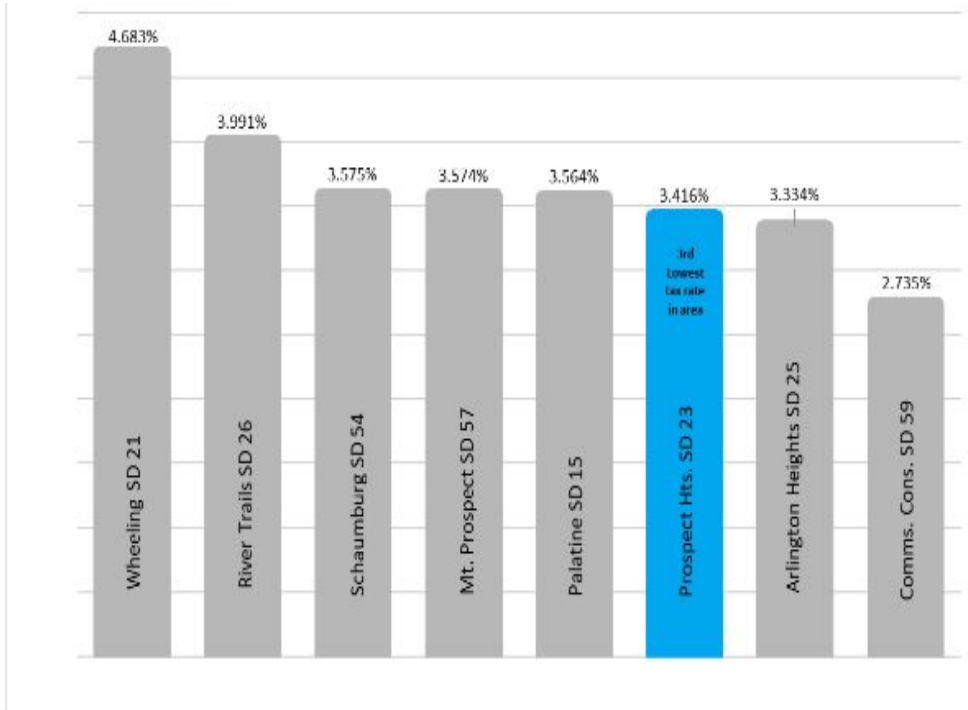

***D23 has the third lowest tax rate when compared to surrounding districts.***



FY 2020



## funding the proposed plan

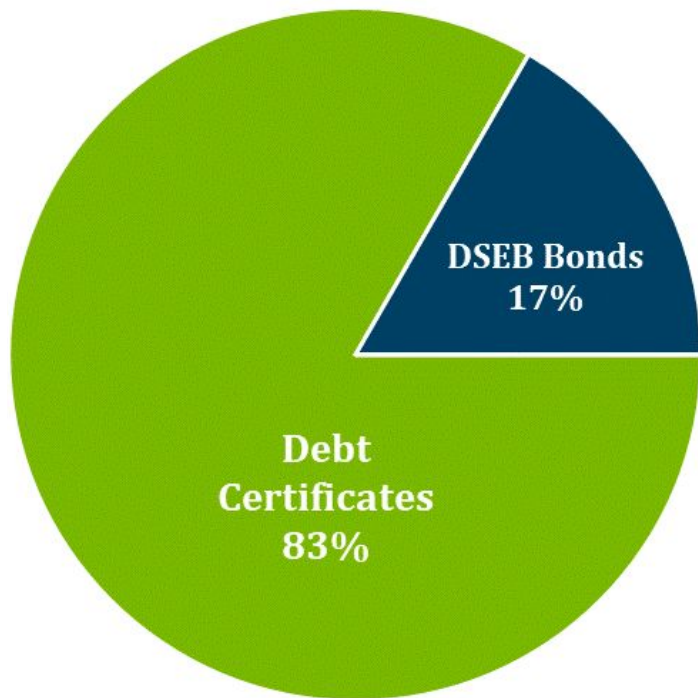

### Preliminary Project Budget:

\$24M to complete:

- Eisenhower Expansions/Renovation
- Facility Maintenance/Repairs

### Potential Funding approach:

- \$20M Debt Certificates
  - Requires taxpayer approval
- \$4M DSEB Bonds
  - The District can issue a limited number of bonds for maintenance



## funding annual operations

Expanding Full-Day Kindergarten (FDK) and Early Childhood Education will result in additional annual expenditures for operating costs including staffing, curricular materials, utilities, and maintenance.

If the plan is approved and implemented:

**143 additional students** will be served in pre-K, FDK, and first grade (estimate based on current enrollment)

**18.3 more staff members** will be needed

**\$1.2 million annual budget** for staffing, curricular materials, utilities, facility consumables, and maintenance





# Funding proposal

Limiting Tax Rate Increase:	Purpose:
Issue of \$20M Debt Certificates, 20-year payback (approx. \$1.66M per year)	Eisenhower Expansion/Renovation & Facility Master Planning Projects, including safety and security projects
Increases operating revenues by \$1.2M annually	Funds operations, including increased staffing, curricular materials, utilities and maintenance

**One** referendum question

**Two** purposes

- Facility Improvements and Eisenhower addition
- Ongoing operational costs

Limiting rate increase referendum

- Estimated tax impact **\$44.65**/\$1,000 of taxes paid in Prospect Heights
- Approximately **\$485.78** for a \$350,000 home

# timeline & next steps





## timeline and next steps

- September–November 2022—
  - community meetings and mailers
- November 2022 —
  - mail survey
- December 2022—
  - review feedback
- December 14, 2022 BOE meeting—
  - Community comment and BOE discussion
- January 17, 2023—
  - Last day to place a question on the Spring 2023 ballot
- April 4, 2023—
  - Election Day (If the BOE puts a question on the ballot)



*questions & conversation*

***visit [D23.org](https://D23.org) for updates***





# **building a better D23**

facilities and early childhood planning  
community presentation

september 29, 2022  
october 6, 2022





# DISTRICT 23 FAMILY FEST

FRIDAY, OCTOBER 21  
4:00-7:00PM

FREE for all D23 Families!!  
at Sullivan/MacArthur playground



**FOOD TRUCKS, GAMES,  
INFLATABLES, MUSIC, AND  
MORE...**