



**ROCKFORD AREA SCHOOLS
INDEPENDENT SCHOOL DISTRICT 883
BOARD OF EDUCATION**

Building a Community for Life-long Learning

**Agenda for April 19, 2021
6:30 PM
Teleconference**

1. **CALL MEETING TO ORDER**
 - A. Pledge of Allegiance
 - B. Board Roll Call
2. **APPROVAL OF AGENDA**
3. **PUBLIC COMMENTS**
4. **CONSENT ITEMS**
 - A. Consent--Approval of Minutes 3
 - B. Consent--Personnel 10
 - C. Consent--Approval of Bills and Wire Transfers 12
 - D. Consent--Approval of Open Enrollments 25
5. **FISCAL RESPONSIBILITY**
 - A. Resolution of Acknowledgement of Contributions/Donations
 - B. Bond Resolution 26
6. **HIGH STUDENT ACHIEVEMENT**
 - A. Teaching and Learning and POSA report 41
 - B. RMS - CES Principal Report 46
7. **SAFE & WELCOMING ENVIRONMENT**
 - A. Rockford Community Education Update 49
 - B. Buildings and Grounds update 50
 - C. Staff Recognition Program 51
8. **EFFICIENT & EFFECTIVE OPERATIONS**
 - A. School Board Meeting Location discussion 53
9. **BOARD AND SUPERINTENDENT UPDATES AND ANNOUNCEMENTS**
 - A. School Board Retreat - June 24th, 9 am - 3 pm in the RCC.
 - B. Next Work Session: Monday, May 17th at 5:30 pm.
Regular Meeting of the Board of Education: Monday, May 17th, at 6:30 pm
 - C. BOARD COMMITTEE UPDATES
10. **ADJOURNMENT**

Our Building a Community for Life-Long Learning

Mission:

Our Provide a respectful learning environment in which all students achieve their



**ROCKFORD AREA SCHOOLS
INDEPENDENT SCHOOL DISTRICT 883
BOARD OF EDUCATION**

Vision: highest potential for a changing world.

Rockford Board of Education

Brady Anderson

Eric Gordee

Jenny Kneeland

Amy Edwards

Jessica Johnson

Beth Praska

Superintendent Rhonda Dean



Independent School District #883

Regular School Board Meeting

March 15, 2021

Chair Edwards called the meeting to order at 6:31 p.m. Pursuant to Minnesota Statutes 13D.021 with regards to the COVID-19 pandemic and the Minnesota Governor's peacetime emergency declaration, the meeting was held by conference call.

Pledge of Allegiance

The meeting opened with the Pledge of Allegiance.

Board Roll Call

Members present: *Anderson, Edwards, Gordee, Johnson, Kneeland, Praska and Superintendent Dean.* Also present were *Principal Brenda Nyhus, Director of Teaching and Learning Kevin Keller, POSA Matthew Scheidler, Jessica Peters, Galaxy Coordinator.*

Members absent: *None*

Board Members participating by telephone or other electronic means as outlined in M.S. §13D.021

APPROVAL OF AGENDA

Approval of Agenda motion by Johnson, seconded by Gordee, to approve the agenda as presented.

Roll call vote, the following voted in favor: Johnson, Kneeland, Gordee, Anderson, Praska, and Edwards. And the following voted against: None.

Motion carried unanimously

PUBLIC COMMENTS

Minnesota Governor Tim Walz declared a state of emergency on Friday, March 13, 2020 and moved to limit the size of public gatherings in response to the COVID-19 virus. Therefore, attendance of the public at this meeting would not be feasible due to the emergency declaration, pursuant to State Statute.

Joey Larson, of Rockford, MN requested Spanish offered in K-8; immediate automated parent notification of any issues including tardiness, absence, illness, missing assignments, etc. Grades

updated throughout the term. Chair Edwards read the full comment. Superintendent Dean to follow up.

CONSENT ITEMS

Gordee motioned, seconded by Anderson, to approve the following consent items. Roll call vote, the following voted in favor: Johnson, Kneeland, Gordee, Anderson, Praska, and Edwards. And the following voted against: None.

Motion passed unanimously.

- **Minutes:**

February 17, 2021 Work Session, February 17, 2021 Regular Meeting, February 26, 2021 Special Meeting, March 10, 2021 Regular Meeting

- **Personnel:**

| Status | First Name | Last Name | Position | Date(s) |
|-------------------|------------|-------------|-----------------------------------|------------------|
| Return from Leave | Hope | Laakkonen | RCC | 2/22/2021 |
| Return from Leave | Colleen | Peterson | REAMS | 3/1/2021 |
| Leave of Absence | Kellie | Leuer | REAMS Paraprofessional | 5/31/2021 |
| Leave of Absence | Lou Ann | Eberspacher | Paraprofessional | 3/24 - 4/25/2021 |
| Hire | Jackson | Schepp | REAMS Paraprofessional | 3/1/2021 |
| Hire | Tanley | Lego | Business Manager | 3/15/2021 |
| Hire | Aimee | Roehl | HS Counselor Secretary | 3/17/2021 |
| Hire | Robbie | D'Amato | Asst. Varsity / JV Baseball Coach | 3/22/2021 |
| Termination | Jesse | Neumann | Custodian | 2/16/2021 |
| Resignation | John | Engel | Director of Technology | 3/12/2021 |
| Resignation | Brandon | Nichols | HS MYP Language & Literature | 6/7/2021 |

- **Bills and Wire Transfers:**

Total: \$1,106,149.75

Note: A fund summary for this month's bills and wires listing will be presented at a future board meeting once the business manager position has been filled.

- **Open Enrollments:**

Resident Students Attending Other Schools

| | Grade | Non-Resident District | Number | Date Effective | NR/OE |
|---|-------|-----------------------|--------|----------------|-------|
| 1 | 5 | Delano | 879 | 2/22/21 | OE |
| 2 | 4 | Delano | 879 | 2/22/21 | OE |

Non-Resident Students Attending Rockford

| | Grade | Non-Resident District | Number | Date Effective | NR/OE |
|----|-------|-----------------------|--------|----------------|-------|
| 1 | 8 | Hutchinson | 423 | 1/21/2021 | OE |
| 2 | 8 | Wayzata | 284 | 3/26/2021 | OE |
| 3 | 8 | Wayzata | 284 | 3/26/2021 | OE |
| 4 | 8 | Wayzata | 284 | 3/26/2021 | OE |
| 5 | 3 | Elk River | 728 | 4/05/2021 | OE |
| 6 | 7 | Elk River | 728 | 4/05/2021 | OE |
| 7 | 3 | Osseo | 279 | 3/1/2021 | OE |
| 8 | 5 | Osseo | 279 | 3/1/2021 | OE |
| 9 | 6 | St. Michael | 885 | 2/18/2021 | OE |
| 10 | 9 | St. Michael | 885 | 3/1/2021 | OE |
| 11 | 1 | St. Michael | 885 | 2/18/21 | OE |
| 12 | 10 | Buffalo | 877 | 9/8/2020 | OE |

- **Recertify Identified Official with Authority for MDE Secure Websites:**

The Board authorized *Rhonda Dean*, *deanr@rockford.k12.mn.us*, and EDIAM user ID *deanr@rockford* to act as the Identified Official with Authority (IOWA) and *Ivonne Padilla*, *padillai@rockford.k12.mn.us* and EDIAM user ID *padillai* to act as the IOWA to add and remove names only *Rockford Public School District 0883-01*

- **Field Trip Requests to Deep Portage 2021**

The Board authorized the participation in the annual Deep Portage Trip for 6th grade on December 13-15, 2021 and for 7th grade from September 27-29, 2021.

- **Intent to Negotiate - RAS Principals Association**

The board approved the intent to negotiate from the RAS Principals Association

- **Strategic Road Map**

The board has approved the new Strategic Plan for Rockford Area Schools.

HIGH STUDENT ACHIEVEMENT

Principal Nyhus shared information about the Diversity lessons presentations in the classrooms, Kindergarten Round up, Conferences, MCA testing. A Distance Learning update was given by Distance Learning teacher Brenda Oeding, Desiree Koepke, and Kayla Manske.

Director of Teaching and Learning, Kevin Keller presented on District Testing and Assessments, STAR screening in Reading and Math for 9th and 10th grade, as well as the dates district tests and assessments will be taking place.

Matthew Scheidler, POSA, presented a Student Services Report on Targeted services Summer School: Session 1 June 14 to June 24; Session 2: July 12 to August 5; Session 3: July 26 to August 19. Mr Scheidler also presented about the Alternative Delivery of Specialized Instructional Services (ADSIS) application, and the Native American Parent Committee (NAPAC) and their collaboration with the Stork House and Rockford Historical Society. NAPAC and native students

met and discussed ways to celebrate and support Native American heritage/culture and Native American students at RAS.

FISCAL RESPONSIBILITY

Johnson motioned, seconded by Praska, to approve the following Resolution as presented:

- **Resolution of Acknowledgement of Contributions/Donations**

WHEREAS Minnesota Statute 123B.02 permits school boards to “receive, for the benefit of the district, bequests, donations, or gifts for any proper purpose and apply the same to the purpose designated. On that behalf, the board may act as trustee of any trust created for the benefit of the district, and for the benefit of pupils thereof.”

THEREFORE, be it resolved by the School Board of Rockford Area Schools, Independent School District 883 that the School Board accepts, with appreciation, the contributions detailed below.

| Donor | Amount | Fund |
|------------------|--------------------------|-----------------------------------|
| Greater Horizons | \$200.00 | Girls Basketball Activity Account |
| Christy Evans | Misc. Supplies | RMS-CES General Fund |
| Kwik | Kwik Trip \$50 dlls card | Community Center General Fund |

On a roll call vote, the following voted in favor: Praska, Gordee, Johnson, Anderson, Kneeland, Edwards. And the following voted against: None.

Whereupon said resolution was declared duly passed and adopted.

- **2021-2022 Purchasing Approval Request**

Gordee motioned to approve the issuance of purchase orders for necessary educational items for the 2021-22 school year prior to the 2021-22 proposed budget approval. Kneeland seconded.

On a roll call vote, the following voted in favor: Anderson, Edwards, Gordee, Johnson, Kneeland, and Praska. And the following voted against: None.

Motion carried unanimously.

- **FY21 Audit Proposal from CliftonLarsonAllen**

The Board reviewed the FY20 Audit proposal from CliftonLarsonAllen.

Johnson motioned to approve the FY21 Audit proposal from CliftonLarsonAllen as presented. Anderson seconded.

On a roll call vote, the following voted in favor: Anderson, Edwards, Gordee, Johnson, Kneeland, and Praska. And the following voted against: None.

Motion carried unanimously.

- **Approval of Student fees for the 20-21-2022 school year**

The Board reviewed the proposed 2021-22 fee schedule. The items that changed fees are: Sr Citizen Annual Pass-age 65 and in district FREE Student Annual Pass from \$33.00 to \$38.00; Adult Annual Pass from \$85.00 to \$98.00; Family Annual Pass from \$242.00 to \$278.00. Student admission per event from \$4.00 to \$5.00. Adult admission per event from \$6.00 to \$7.00. Graduation Participation fee from \$25.00 to \$40.00.

Gordee motioned to approve the 2021-22 fee schedule as presented. Anderson seconded.

On a roll call vote, the following voted in favor: Anderson, Edwards, Gordee, Johnson, Kneeland, and Praska. And the following voted against: None.

Motion carried unanimously.

EFFICIENT & EFFECTIVE OPERATIONS

- **Approval of proposed fee schedule for Galaxy Kids School-age Childcare Program**

Jessica Peters presented the proposed fee schedule for Galaxy Kids School age Childcare Program.

Anderson motioned to approve the proposed fee schedule for Galaxy Kids School age Childcare Program as presented. Kneeland seconded.

On a roll call vote, the following voted in favor: Anderson, Edwards, Gordee, Johnson, Kneeland, and Praska. And the following voted against: None.

Motion passed unanimously.

BOARD AND SUPERINTENDENT UPDATES AND ANNOUNCEMENTS

A work session is scheduled for April 5, 2021, 6:30 p.m. via teleconference. A regular meeting of the Board of Education will take place on Monday, April 19, 2021, at 6:30 pm via teleconference.

- **Board Committee Updates**

The Board gave updates on their committee assignments and events attended.

8.C.1. Minnesota State High School League - Anderson, Kneeland

8.C.2. Operations Committee - Edwards, Gordee

8.C.3. Continuing Education - Kneeland, Johnson

- 8.C.4. Curriculum Advisory System Accountability Committee - Gordee, Praska
- 8.C.5. Community Education Advisory Board/ Children First/ECFE/School Readiness Advisory Council - Anderson, Kneeland
- 8.C.6. Chamber Committee - Johnson, Anderson
- 8.C.7. Legislative/MSBA Delegate Assembly - Gordee, Johnson
- 8.C.8. Meeker & Wright Special Education Cooperative - Johnson, Praska
- 8.C.9. Northwest Suburban Integration School District - Gordee, Anderson
- 8.C.10. Schools for Equity in Education/MREA - Praska, Kneeland
- 8.C.11. District Staff Development - Praska, Johnson
- 8.C.12. Committee At-Large - Anderson, Kneeland, Gordee (Johnson as alternate)
- 8.C.13. Association of Metro School Districts - Edwards, Praska
- 8.C.14. Negotiations - Gordee, Johnson, Praska (Edwards as alternate)

Board/Superintendent Updates and Announcements

The Board gave updates on their committee assignments and events attended.

- Anderson - attended the Community Ed Advisory Council where the fee increased of the Galaxy Kids School Age childcare program was presented. Mr. Anderson will be participating in the Director of Technology interviews on March 22nd.
- Kneeland spoke about the involvement with an interview panel.
- Praska - attended a MSBA training for officers and another one about negotiations. She also attended the Strategic Plan meeting, negotiations meeting, met with Superintendent Dean and Chair Edwards, attended the Advocacy Group workshop and the SEE Winter meeting.
- Gordee - attended the negotiations Phase II training, met with staff for negotiations, participated in the Business Manager first round of interviews and in the Strategic Plan meeting.
- Johnson - attended a negotiations seminar, a MAWSECO meetings, Strategic Plan meeting, negotiations touch base meeting and the MSBA advocacy group workshop.
- Edwards - met with Superintendent Dean and Vice Chair Praska and the Strategic Plan meeting.
- Superintendent Dean - introduced new Business Manager Tanley Lego. Shared updates on the fourth quarter learning model where we will maintain the current learning model, staff will be working on site on Fridays. She also mentioned that if a staff member is absent on a Friday with no sub at REAMS, staff from RMS and RHS will be

covering for that sub absence. Building Principals will work with Director of Teaching and Learning Kevin Keller on what Fridays will look like and how we will be servicing struggling students on those days. Superintendent Dean met with Chair Edwards and Vice-Chair Praska, and attended the Chamber luncheon. Gave an update about the lighting project being completed in the Bus Garage. Vaccine appointments have been offered to staff members including coaches and volunteers; most staff received the first dose to the vaccine, some even the second one. Superintendent Dean made a recommendation to move the school board meetings to in person for the next regular meeting.

Closed Session

Gordee moved to enter into a closed session as pursuant to MN Statute 13D.03, to discuss labor negotiations strategy with SEIU 284. Praska seconded. The meeting was closed at 9:14 pm. On a roll call vote, the following voted in favor: Johnson, Kneeland, Gordee, Anderson, Praska, and Edwards. The following voted against: None.

Motion carried unanimously

Chair Edwards stated that the Board discussed labor negotiations strategy with SEIU 284.

Johnson motioned to adjourn the closed meeting at 10:01 p.m. Kneeland seconded. On a roll call vote, the following voted in favor: Anderson, Gordee, Johnson, Kneeland, Praska and Edwards. And the Following voted against: None.

Regular Session

Praska motioned to adjourn the meeting at 10:04 p.m. Johnson seconded. On a roll call vote, the following voted in favor: Anderson, Gordee, Johnson, Kneeland, Praska, and Edwards. And the following voted against: None.

Ivonne Padilla
Recorder

Jessica Johnson
Clerk



**ROCKFORD AREA SCHOOLS
INDEPENDENT SCHOOL DISTRICT 883
BOARD OF EDUCATION**

Subject: Consent Personnel

Meeting Date: April 19, 2021

Prepared by: Superintendent's Office

Date Prepared: April 19, 2021

| | | | | | | | |
|--------------------------|-------------|--------------------------|----------|-------------------------------------|--------|--------------------------|-------------------|
| <input type="checkbox"/> | Information | <input type="checkbox"/> | Briefing | <input checked="" type="checkbox"/> | Action | <input type="checkbox"/> | Enclosure Item(s) |
|--------------------------|-------------|--------------------------|----------|-------------------------------------|--------|--------------------------|-------------------|

Personnel Items:

| Status | First Name | Last Name | Position | Date(s) |
|-------------------------------|------------|-----------|----------------------------------|---------------------|
| Hire | Meghan | Larson | RMS/REAMS Choir | 2021-22 School Year |
| Hire | Jeffrey | Kienitz | Director of Technology | 4/5/2021 |
| LTS Extension | Aimee | Smith | LTS REAMS Physical Ed | 4/19 - 6/4/2021 |
| Position Title Update | Melissa | Joseph | Community Education Director | 3/16/2021 |
| Intermittent Leave of Absence | Diana | Wondra | Para Professional | 3/21/2021 |
| Return from Leave | Sue | Russell | Para Professional | 2021-22 School Year |
| Leave Approved | Michelle | Paulson | REAMS Kindergarten Teacher | 5/3/2021 - 6/7/2021 |
| Leave Approved | Krista | Bird | EL Teacher | 9/7/2021 - TBD |
| Leave Approved | Kylene | Hammer | Second Great Teacher | 8/31/2021 - TBD |
| Resignation | Colette | Viquez | RMS | 4/19/2021 |
| Resignation | Ivy | Balcer | RCC Front Desk | 4/30/2021 |
| Resignation | Lexi | Wacker | RCC Front Desk | 4/30/2021 |
| Resignation | Stephanie | Ogland | Early Childhood Teacher | 5/31/2021 |
| Resignation | Amanda | Jensen | REAMS Kindergarten Teacher | 6/7/2021 |
| Resignation | Deborra | Krebsbach | SPED Language Arts & OJT Teacher | 6/7/2021 |
| Retirement | Stacy | Welborn | EL Teacher | 6/7/2021 |
| Non-Renewal 1 Year Contract | Kayla | Manske | DL Teacher | 6/7/2021 |
| Non-Renewal 1 Year Contract | Desiree | Koepke | DL Teacher | 6/7/2021 |
| Non-Renewal LTS | Julia | Hensel | REAMS Building Sub | 6/7/2021 |



**ROCKFORD AREA SCHOOLS
INDEPENDENT SCHOOL DISTRICT 883
BOARD OF EDUCATION**

| | | | | |
|-----------------|--------|--------|-----------------|----------|
| Non-Renewal LTS | Aimee | Smith | LTS DAPE | 6/7/2021 |
| Non-Renewal LTS | Meghan | Larson | RMS/REAMS Choir | 6/7/2021 |



**ROCKFORD AREA SCHOOLS
INDEPENDENT SCHOOL DISTRICT 883
BOARD OF EDUCATION**

Subject: Approval of Bills and Wire Transfers

Meeting Date: April 19, 2021

Prepared by: Tanley Lego

Date Prepared: April 16, 2021

| | | | |
|--------------------------------------|-----------------------------------|--|---|
| <input type="checkbox"/> Information | <input type="checkbox"/> Briefing | <input checked="" type="checkbox"/> Action | <input checked="" type="checkbox"/> Enclosure Item(s) |
|--------------------------------------|-----------------------------------|--|---|

February 2020 (listing attached)

| | |
|---------------|------------------------|
| Fund 01 | \$1,977,610.72 |
| Fund 02 | 114,118.34 |
| Fund 04 | 12,313.89 |
| Fund 21 | 3,598.25 |
| Fund 45 | 2,098.97 |
| Total: | \$ 1,109,740.17 |

March 2020 (listing attached)

| | |
|---------------|------------------------|
| Fund 01 | \$1,435,165.44 |
| Fund 02 | 55,682.44 |
| Fund 04 | 13,296.35 |
| Fund 21 | 11,069.98 |
| Fund 45 | 2,025.16 |
| Total: | \$ 1,517,239.37 |

Note: Reconciled as of 4/16/2021 by Tanley Lego, Business Manager

Rockford ISD #0883 Payment Reg by Bank and Check

| Bank | Batch | Pmt No | Check No | Pay Type | Grp Code | Rcd | Vendor | Tax Class | Print | Recon | Pay/Void | | Amount |
|------|-------|--------|----------|----------|----------|--------|---------------------------------|---------------------|-------|-------|----------|------------|------------|
| | | | | | | | | | | | Void | Date | |
| ASSO | | 52621 | | Wire | 1 4050 | | AFLAC | | Yes | Yes | Yes | 02/09/2021 | (810.36) |
| ASSO | | 52765 | | Wire | 1 8119 | | GIS BENEFITS, INC. | S Corporation | No | Yes | No | 02/04/2021 | 15,322.73 |
| ASSO | | 52771 | | Wire | 1 4050 | | AFLAC | | No | Yes | No | 02/09/2021 | 810.36 |
| ASSO | | 52864 | | Wire | 1 1962 | | MINNESOTA DEPT OF REVENUE | | No | Yes | No | 02/02/2021 | 18,697.33 |
| ASSO | | 52865 | | Wire | 1 1962 | | MINNESOTA DEPT OF REVENUE | | No | Yes | No | 02/16/2021 | 17,912.98 |
| ASSO | | 52866 | | Wire | 1 4050 | | AFLAC | | No | Yes | No | 02/19/2021 | 810.36 |
| ASSO | | 52867 | | Wire | 1 5459 | | LEGAL SHIELD | | No | Yes | No | 02/19/2021 | 220.30 |
| ASSO | | 52868 | | Wire | 1 2006 | | US GOVERNMENT | | No | Yes | No | 02/02/2021 | 111,763.60 |
| ASSO | | 52869 | | Wire | 1 2006 | | US GOVERNMENT | | No | Yes | No | 02/16/2021 | 105,816.89 |
| ASSO | | 52870 | | Wire | 1 3370 | | MN CHILD SUPPORT PMT CENTER | | No | Yes | No | 02/01/2021 | 614.60 |
| ASSO | | 52871 | | Wire | 1 3370 | | MN CHILD SUPPORT PMT CENTER | | No | Yes | No | 02/12/2021 | 614.60 |
| ASSO | | 52872 | | Wire | 1 1937 | | PUBLIC EMPLOYEES RETIREMENT ASS | | No | Yes | No | 02/25/2021 | 18,136.49 |
| ASSO | | 52873 | | Wire | 1 1937 | | PUBLIC EMPLOYEES RETIREMENT ASS | | No | Yes | No | 02/11/2021 | 21,539.95 |
| ASSO | | 52874 | | Wire | 1 1938 | | TRA | | No | Yes | No | 02/11/2021 | 54,840.61 |
| ASSO | | 52875 | | Wire | 1 1938 | | TRA | | No | Yes | No | 02/25/2021 | 53,080.75 |
| ASSO | | 52878 | | Wire | 1 2470 | | MSRS | | No | Yes | No | 02/23/2021 | 16,204.44 |
| ASSO | | 52880 | | Wire | 1 7649 | | TSA CONSULTING GROUP, INC. | | No | Yes | No | 02/23/2021 | 39,236.94 |
| ASSO | | 52881 | | Wire | 1 8119 | | GIS BENEFITS, INC. | S Corporation | No | Yes | No | 02/01/2021 | 8,300.22 |
| ASSO | | 52882 | | Wire | 1 8119 | | GIS BENEFITS, INC. | S Corporation | No | Yes | No | 02/01/2021 | 6,491.90 |
| ASSO | | 52725 | 99415 | Check | 1 1215 | | XCEL ENERGY | | Yes | Yes | No | 02/02/2021 | 18,302.97 |
| ASSO | | 52746 | 99416 | Check | 1 6623 | | ADVANCED IMAGING SOLUTIONS | | Yes | Yes | No | 02/04/2021 | 5,205.00 |
| ASSO | | 52730 | 99417 | Check | 1 2848 | | ANDERSON, DAWN | Ind/Sole Proprietor | Yes | Yes | No | 02/04/2021 | 132.00 |
| ASSO | | 52736 | 99418 | Check | 1 4472 | | BOLLANT JOE | | Yes | No | No | 02/04/2021 | 121.00 |
| ASSO | | 52749 | 99419 | Check | 1 7224 | | BSN SPORTS, LLC | | Yes | Yes | No | 02/04/2021 | 9,900.00 |
| ASSO | | 52727 | 99420 | Check | 1 1180 | | CENTERPOINT ENERGY | | Yes | Yes | No | 02/04/2021 | 124.03 |
| ASSO | | 52760 | 99421 | Check | 1 8126 | | COLEMAN, TAMMIE | Ind/Sole Proprietor | Yes | Yes | No | 02/04/2021 | 132.00 |
| ASSO | | 52748 | 99422 | Check | 1 7074 | | COLLEGE ENTRANCE EXAMINATION B | | Yes | Yes | No | 02/04/2021 | 646.00 |
| ASSO | | 52742 | 99423 | Check | 1 6087 | | COOK, ANDREW | Ind/Sole Proprietor | Yes | Yes | No | 02/04/2021 | 121.00 |
| ASSO | | 52756 | 99424 | Check | 1 8071 | | CREATIVE STAFFING SOLUTIONS | | Yes | Yes | No | 02/04/2021 | 534.38 |
| ASSO | | 52740 | 99425 | Check | 1 5555 | | DISCOUNT DANCE SUPPLY | | Yes | Yes | No | 02/04/2021 | 190.11 |
| ASSO | | 52744 | 99426 | Check | 1 6377 | | DISH | | Yes | Yes | No | 02/04/2021 | 108.04 |
| ASSO | | 52747 | 99427 | Check | 1 6829 | | DRUSCH, MERLYN | | Yes | Yes | No | 02/04/2021 | 121.00 |
| ASSO | | 52764 | 99428 | Check | 1 8130 | | GOVE, GEORGE | Ind/Sole Proprietor | Yes | Yes | No | 02/04/2021 | 121.00 |
| ASSO | | 52741 | 99429 | Check | 1 6054 | remit4 | HENNEPIN COUNTY TREASURER | | Yes | Yes | No | 02/04/2021 | 20.00 |
| ASSO | | 52732 | 99430 | Check | 1 3279 | remit | IXL LEARNING | | Yes | Yes | No | 02/04/2021 | 99.00 |
| ASSO | | 52751 | 99431 | Check | 1 7627 | | KEGLER, MICHAEL | Ind/Sole Proprietor | Yes | Yes | No | 02/04/2021 | 61.00 |
| ASSO | | 52761 | 99432 | Check | 1 8127 | | KES, HEATHER ¹³ | Ind/Sole Proprietor | Yes | Yes | No | 02/04/2021 | 132.00 |
| ASSO | | 52728 | 99433 | Check | 1 1746 | | KNUTSON FLYNN & DEANS | | Yes | Yes | No | 02/04/2021 | 110.00 |
| ASSO | | 52752 | 99434 | Check | 1 7628 | | KOPPI, WILLIAM | | Yes | Yes | No | 02/04/2021 | 61.00 |

Rockford ISD #0883 Payment Reg by Bank and Check

| Bank | Batch | Pmt No | Check No | Pay Type | Grp Code | Rcd | Vendor | Tax Class | Print | Recon | Void | Pay/Void | | Amount |
|------|-------|--------|----------|----------|----------|------|---------------------------------------|---------------------|-------|-------|------|------------|--|-----------|
| | | | | | | | | | | | | Date | | |
| ASSO | | 52745 | 99435 | Check | 1 | 6603 | LANO EQUIPMENT -LORETTO | | Yes | Yes | No | 02/04/2021 | | 1,584.58 |
| ASSO | | 52753 | 99436 | Check | 1 | 7697 | MARISELA V NELSON INTERPRETING | | Yes | Yes | No | 02/04/2021 | | 520.00 |
| ASSO | | 52743 | 99437 | Check | 1 | 6271 | MARSH & McLENNAN AGENCY LLC | | Yes | Yes | No | 02/04/2021 | | 963.00 |
| ASSO | | 52737 | 99438 | Check | 1 | 5277 | MINNEAPOLIS ATHENA AWARDS | | Yes | Yes | No | 02/04/2021 | | 100.00 |
| ASSO | | 52750 | 99439 | Check | 1 | 7608 | MOYNAGH, ROBERT JR. | Ind/Sole Proprietor | Yes | Yes | No | 02/04/2021 | | 121.00 |
| ASSO | | 52763 | 99440 | Check | 1 | 8129 | NORMAN, NATHAN | Ind/Sole Proprietor | Yes | Yes | No | 02/04/2021 | | 61.00 |
| ASSO | | 52754 | 99441 | Check | 1 | 7873 | ON SITE COMPANIES, INC. | | Yes | Yes | No | 02/04/2021 | | 241.00 |
| ASSO | | 52757 | 99442 | Check | 1 | 8072 | PEDIATRIC HOME SERVICE | | Yes | Yes | No | 02/04/2021 | | 225.00 |
| ASSO | | 52733 | 99443 | Check | 1 | 3403 | RANDY'S SANITATION INC | | Yes | Yes | No | 02/04/2021 | | 1,707.40 |
| ASSO | | 52759 | 99444 | Check | 1 | 8125 | REEVES, CAITLYN | Ind/Sole Proprietor | Yes | Yes | No | 02/04/2021 | | 264.00 |
| ASSO | | 52734 | 99445 | Check | 1 | 3915 | REINHART FOOD SERVICE | | Yes | Yes | No | 02/04/2021 | | 109.82 |
| ASSO | | 52729 | 99446 | Check | 1 | 1933 | SCSU - SENIOR TO SOPHOMORE | | Yes | Yes | No | 02/04/2021 | | 7,480.00 |
| ASSO | | 52755 | 99447 | Check | 1 | 7959 | SO BRIGHT PRODUCTIONS | | Yes | Yes | No | 02/04/2021 | | 500.00 |
| ASSO | | 52735 | 99448 | Check | 1 | 4387 | TAHER INC - BIN# 135092 | | Yes | Yes | No | 02/04/2021 | | 66,000.00 |
| ASSO | | 52758 | 99449 | Check | 1 | 8124 | TIARKS, JUSTIN | Ind/Sole Proprietor | Yes | Yes | No | 02/04/2021 | | 550.00 |
| ASSO | | 52739 | 99450 | Check | 1 | 5547 | UPS | | Yes | Yes | No | 02/04/2021 | | 11.42 |
| ASSO | | 52762 | 99451 | Check | 1 | 8128 | WEBER, SAMUEL | Ind/Sole Proprietor | Yes | Yes | No | 02/04/2021 | | 121.00 |
| ASSO | | 52738 | 99452 | Check | 1 | 5430 | WEST METRO LAWN MAINTENANCE | | Yes | Yes | No | 02/04/2021 | | 3,528.75 |
| ASSO | | 52731 | 99453 | Check | 1 | 2897 | WOOD, NICOLE | Ind/Sole Proprietor | Yes | Yes | No | 02/04/2021 | | 132.00 |
| ASSO | | 52726 | 99454 | Check | 1 | 1016 | WRIGHT-HENNEPIN COOP. ELECTRIC | | Yes | Yes | No | 02/04/2021 | | 431.25 |
| ASSO | | 52780 | 99455 | Check | 1 | 5306 | BORAAS, ROB | | Yes | Yes | No | 02/12/2021 | | 121.00 |
| ASSO | | 52799 | 99456 | Check | 1 | 8109 | BULK BOOKSTORE | | Yes | Yes | No | 02/12/2021 | | 553.30 |
| ASSO | | 52773 | 99457 | Check | 1 | 1180 | CENTERPOINT ENERGY | | Yes | Yes | No | 02/12/2021 | | 9,422.64 |
| ASSO | | 52774 | 99458 | Check | 1 | 1181 | CITY OF ROCKFORD | | Yes | Yes | No | 02/12/2021 | | 1,794.94 |
| ASSO | | 52796 | 99459 | Check | 1 | 8071 | CREATIVE STAFFING SOLUTIONS | | Yes | Yes | No | 02/12/2021 | | 759.38 |
| ASSO | | 52783 | 99460 | Check | 1 | 6253 | remit CULLIGAN OF BUFFALO | | Yes | Yes | No | 02/12/2021 | | 40.10 |
| ASSO | | 52777 | 99461 | Check | 1 | 2857 | DECKER, MARK | | Yes | Yes | No | 02/12/2021 | | 121.00 |
| ASSO | | 52795 | 99462 | Check | 1 | 8000 | ECLIPSE PAINTING, INC. | | Yes | Yes | No | 02/12/2021 | | 900.00 |
| ASSO | | 52785 | 99463 | Check | 1 | 6481 | GRADY'S ACE HARDWARE | | Yes | Yes | No | 02/12/2021 | | 797.31 |
| ASSO | | 52792 | 99464 | Check | 1 | 7738 | REMIT GRANITE TELECOMMUNICATIONS, LLC | | Yes | Yes | No | 02/12/2021 | | 732.56 |
| ASSO | | 52803 | 99465 | Check | 1 | 8134 | HEMMANN, MICHAEL | Ind/Sole Proprietor | Yes | Yes | No | 02/12/2021 | | 121.00 |
| ASSO | | 52782 | 99466 | Check | 1 | 6093 | IDE, GERALD | | Yes | Yes | No | 02/12/2021 | | 61.00 |
| ASSO | | 52778 | 99467 | Check | 1 | 4449 | ISD 745 ALBANY AREA SCHOOL | | Yes | Yes | No | 02/12/2021 | | 54.00 |
| ASSO | | 52791 | 99468 | Check | 1 | 7697 | MARISELA V NELSON INTERPRETING | | Yes | Yes | No | 02/12/2021 | | 550.00 |
| ASSO | | 52775 | 99469 | Check | 1 | 1394 | MBNA/BUSINESS CARD | | Yes | Yes | No | 02/12/2021 | | 9,644.74 |
| ASSO | | 52776 | 99470 | Check | 1 | 1394 | MBNA/BUSINESS CARD | | Yes | Yes | No | 02/12/2021 | | 5.00 |
| ASSO | | 52789 | 99471 | Check | 1 | 7620 | MIDDAGH, THOMAS ¹⁴ | | Yes | Yes | No | 02/12/2021 | | 121.00 |
| ASSO | | 52793 | 99472 | Check | 1 | 7811 | PASCO SCIENTIFIC | | Yes | Yes | No | 02/12/2021 | | 1,837.00 |
| ASSO | | 52797 | 99473 | Check | 1 | 8072 | PEDIATRIC HOME SERVICE | | Yes | Yes | No | 02/12/2021 | | 900.00 |

Rockford ISD #0883 Payment Reg by Bank and Check

| Bank | Batch | Pmt No | Check No | Pay Type | Grp Code | Rcd | Vendor | Tax Class | Print | Recon | Void | Pay/Void | | Amount |
|------|-------|--------|----------|----------|----------|------|--------------------------------|---------------------|-------|-------|------|------------|--|-----------|
| | | | | | | | | | | | | Date | | |
| ASSO | | 52794 | 99474 | Check | 1 | 7851 | PERFORMANCE ELITE GYMNASTICS | | Yes | Yes | No | 02/12/2021 | | 300.00 |
| ASSO | | 52798 | 99475 | Check | 1 | 8100 | REINDERS, INC. | | Yes | Yes | No | 02/12/2021 | | 3,407.25 |
| ASSO | | 52781 | 99476 | Check | 1 | 5337 | remit SCHOOL OUTFITTERS LLC | | Yes | Yes | No | 02/12/2021 | | 13,923.36 |
| ASSO | | 52784 | 99477 | Check | 1 | 6279 | SHI INTERNATIONAL CORP. | | Yes | Yes | No | 02/12/2021 | | 3,564.00 |
| ASSO | | 52801 | 99478 | Check | 1 | 8131 | STANGLER, JIM | Ind/Sole Proprietor | Yes | Yes | No | 02/12/2021 | | 180.00 |
| ASSO | | 52788 | 99479 | Check | 1 | 7545 | TEACHERS ON CALL | | Yes | Yes | No | 02/12/2021 | | 1,650.98 |
| ASSO | | 52779 | 99480 | Check | 1 | 4719 | TRACTOR SUPPLY COMPANY | | Yes | Yes | No | 02/12/2021 | | 108.18 |
| ASSO | | 52772 | 99481 | Check | 1 | 1060 | remit TRIARCO ARTS & CRAFTS | | Yes | Yes | No | 02/12/2021 | | 11.03 |
| ASSO | | 52786 | 99482 | Check | 1 | 6834 | URBAN, NICHOLAS | | Yes | Yes | No | 02/12/2021 | | 121.00 |
| ASSO | | 52800 | 99483 | Check | 1 | 8128 | WEBER, SAMUEL | Ind/Sole Proprietor | Yes | Yes | No | 02/12/2021 | | 121.00 |
| ASSO | | 52787 | 99484 | Check | 1 | 7333 | WEISSMAN | | Yes | Yes | No | 02/12/2021 | | 3,182.26 |
| ASSO | | 52790 | 99485 | Check | 1 | 7653 | WROGE, DAVID | | Yes | Yes | No | 02/12/2021 | | 61.00 |
| ASSO | | 52802 | 99486 | Check | 1 | 8132 | ZEHNDER, ROBERT | Ind/Sole Proprietor | Yes | Yes | No | 02/12/2021 | | 180.00 |
| ASSO | | 52815 | 99487 | Check | 1 | 4335 | 4 POINT 0 SCHOOL SERVICES | | Yes | Yes | No | 02/16/2021 | | 68,095.93 |
| ASSO | | 52816 | 99488 | Check | 1 | 4335 | 4 POINT 0 SCHOOL SERVICES | | Yes | Yes | No | 02/16/2021 | | 3,311.67 |
| ASSO | | 52836 | 99489 | Check | 1 | 7798 | ALBIN ACQUISITION CORP | | Yes | Yes | No | 02/16/2021 | | 14.00 |
| ASSO | | 52848 | 99490 | Check | 1 | 8140 | BLOMDAHL, KRISTA | Ind/Sole Proprietor | Yes | Yes | No | 02/16/2021 | | 59.00 |
| ASSO | | 52850 | 99491 | Check | 1 | 8142 | CHRISTENSEN, COLLEEN | Ind/Sole Proprietor | Yes | Yes | No | 02/16/2021 | | 74.00 |
| ASSO | | 52813 | 99492 | Check | 1 | 3317 | CITY OF GREENFIELD | | Yes | Yes | No | 02/16/2021 | | 1,371.20 |
| ASSO | | 52829 | 99493 | Check | 1 | 7519 | COMMON THREAD CUSTOM APPAREL | | Yes | Yes | No | 02/16/2021 | | 810.00 |
| ASSO | | 52840 | 99494 | Check | 1 | 8102 | CORNERSTONE EDCUATIONAL CONSL | | Yes | Yes | No | 02/16/2021 | | 800.00 |
| ASSO | | 52837 | 99495 | Check | 1 | 8071 | CREATIVE STAFFING SOLUTIONS | | Yes | Yes | No | 02/16/2021 | | 759.38 |
| ASSO | | 52811 | 99496 | Check | 1 | 2211 | CROWN COLLEGE | | Yes | Yes | No | 02/16/2021 | | 4,756.40 |
| ASSO | | 52831 | 99497 | Check | 1 | 7571 | DAVID BANK STUDIO | | Yes | Yes | No | 02/16/2021 | | 114.00 |
| ASSO | | 52841 | 99498 | Check | 1 | 8117 | DESIGNSTUDIO8, LLC | Ind/Sole Proprietor | Yes | Yes | No | 02/16/2021 | | 750.00 |
| ASSO | | 52828 | 99499 | Check | 1 | 7128 | EUERIE, CARRIE | Ind/Sole Proprietor | Yes | Yes | No | 02/16/2021 | | 31.50 |
| ASSO | | 52832 | 99500 | Check | 1 | 7615 | HASTY AWARDS | | Yes | Yes | No | 02/16/2021 | | 158.33 |
| ASSO | | 52849 | 99501 | Check | 1 | 8141 | HAY, KARNA | Ind/Sole Proprietor | Yes | Yes | No | 02/16/2021 | | 59.00 |
| ASSO | | 52805 | 99502 | Check | 1 | 1057 | HILLYARD | | Yes | Yes | No | 02/16/2021 | | 13,132.89 |
| ASSO | | 52818 | 99503 | Check | 1 | 4673 | INTEGRIPRINT | | Yes | Yes | No | 02/16/2021 | | 147.07 |
| ASSO | | 52809 | 99504 | Check | 1 | 1481 | J & J Glass | | Yes | Yes | No | 02/16/2021 | | 841.04 |
| ASSO | | 52846 | 99505 | Check | 1 | 8138 | JOHNSEN, NICOLE | Ind/Sole Proprietor | Yes | Yes | No | 02/16/2021 | | 59.00 |
| ASSO | | 52824 | 99506 | Check | 1 | 6029 | KIDZART | | Yes | Yes | No | 02/16/2021 | | 297.00 |
| ASSO | | 52823 | 99507 | Check | 1 | 5974 | KULLY SUPPLY | | Yes | Yes | No | 02/16/2021 | | 413.86 |
| ASSO | | 52826 | 99508 | Check | 1 | 6603 | LANO EQUIPMENT -LORETTO | | Yes | Yes | No | 02/16/2021 | | 41,093.36 |
| ASSO | | 52844 | 99509 | Check | 1 | 8136 | LARSON, ANGIE | Ind/Sole Proprietor | Yes | Yes | No | 02/16/2021 | | 31.50 |
| ASSO | | 52839 | 99510 | Check | 1 | 8090 | LUTHERAN SOCIAL SERVICES-HOMME | | Yes | Yes | No | 02/16/2021 | | 3,788.46 |
| ASSO | | 52843 | 99511 | Check | 1 | 8135 | MALACK, MELISSA | | Yes | Yes | No | 02/16/2021 | | 51.00 |
| ASSO | | 52833 | 99512 | Check | 1 | 7697 | MARISELA V NELSON INTERPRETING | | Yes | Yes | No | 02/16/2021 | | 725.00 |

Rockford ISD #0883 Payment Reg by Bank and Check

| Bank | Batch | Pmt No | Check No | Pay Type | Grp Code | Rcd | Vendor | Tax Class | Print | Recon | Pay/Void | | Amount | |
|------|-------|--------|----------|----------|----------|------|---------|---------------------------------|---------------------|-------|----------|------|------------|-----------|
| | | | | | | | | | | | Void | Date | | |
| ASSO | | 52822 | 99513 | Check | 1 | 5795 | remit 2 | MEDCO SURGICAL SUPPLY SERVICE | | Yes | Yes | No | 02/16/2021 | 2,352.15 |
| ASSO | | 52804 | 99514 | Check | 1 | 1039 | | MINNESOTA ELEVATOR, INC | | Yes | Yes | No | 02/16/2021 | 425.80 |
| ASSO | | 52825 | 99515 | Check | 1 | 6356 | | MITEL NETSOLUTIONS | | Yes | Yes | No | 02/16/2021 | 3,439.01 |
| ASSO | | 52827 | 99516 | Check | 1 | 6913 | | NEE INVESTMENT 9, LLC | | Yes | Yes | No | 02/16/2021 | 127.35 |
| ASSO | | 52806 | 99517 | Check | 1 | 1079 | | OFFICE DEPOT | | Yes | Yes | No | 02/16/2021 | 633.59 |
| ASSO | | 52838 | 99518 | Check | 1 | 8072 | | PEDIATRIC HOME SERVICE | | Yes | Yes | No | 02/16/2021 | 1,725.00 |
| ASSO | | 52842 | 99519 | Check | 1 | 8122 | | PROJECTOR LAMPS LLC | LLC - Partnership | Yes | Yes | No | 02/16/2021 | 440.80 |
| ASSO | | 52812 | 99520 | Check | 1 | 2537 | | REGION V | | Yes | Yes | No | 02/16/2021 | 31.00 |
| ASSO | | 52808 | 99521 | Check | 1 | 1266 | | SAFE COMMUNITIES OF WRIGHT CTY | | Yes | Yes | No | 02/16/2021 | 90.00 |
| ASSO | | 52807 | 99522 | Check | 1 | 1091 | | SCHMITT MUSIC CENTER | | Yes | Yes | No | 02/16/2021 | 1,128.00 |
| ASSO | | 52847 | 99523 | Check | 1 | 8139 | | SHEA, NATALIE | Ind/Sole Proprietor | Yes | Yes | No | 02/16/2021 | 59.00 |
| ASSO | | 52817 | 99524 | Check | 1 | 4387 | | TAHER INC - BIN# 135092 | | Yes | Yes | No | 02/16/2021 | 48,074.89 |
| ASSO | | 52830 | 99525 | Check | 1 | 7545 | | TEACHERS ON CALL | | Yes | Yes | No | 02/16/2021 | 4,501.70 |
| ASSO | | 52834 | 99526 | Check | 1 | 7778 | | TEAMWORKS INTERNATIONAL, INC | | Yes | Yes | No | 02/16/2021 | 1,250.00 |
| ASSO | | 52810 | 99527 | Check | 1 | 2208 | | TECH/CHECK | | Yes | Yes | No | 02/16/2021 | 3,290.00 |
| ASSO | | 52835 | 99528 | Check | 1 | 7786 | REMIT | TERRAFORM PHOENIX II ARCADIA | | Yes | Yes | No | 02/16/2021 | 64.65 |
| ASSO | | 52819 | 99529 | Check | 1 | 5149 | | TOLL COMPANY | | Yes | Yes | No | 02/16/2021 | 68.08 |
| ASSO | | 52821 | 99530 | Check | 1 | 5547 | | UPS | | Yes | Yes | No | 02/16/2021 | 14.22 |
| ASSO | | 52814 | 99531 | Check | 1 | 3727 | | VERNIER SOFTWARE & TECH | | Yes | Yes | No | 02/16/2021 | 1,984.03 |
| ASSO | | 52845 | 99532 | Check | 1 | 8137 | | WEEGMAN, TRICIA | Ind/Sole Proprietor | Yes | Yes | No | 02/16/2021 | 59.00 |
| ASSO | | 52820 | 99533 | Check | 1 | 5430 | | WEST METRO LAWN MAINTENANCE | | Yes | Yes | No | 02/16/2021 | 1,832.50 |
| ASSO | | 52853 | 99534 | Check | 1 | 3978 | | CBIZ FINANCIAL SOLUTIONS INC | | Yes | Yes | No | 02/19/2021 | 4.40 |
| ASSO | | 52852 | 99535 | Check | 1 | 1180 | | CENTERPOINT ENERGY | | Yes | Yes | No | 02/19/2021 | 5,715.82 |
| ASSO | | 52854 | 99536 | Check | 1 | 5507 | | CITY OF GREENFIELD WATER & SEWE | | Yes | Yes | No | 02/19/2021 | 1,054.11 |
| ASSO | | 52856 | 99537 | Check | 1 | 7593 | | GRAPHITE PUBLISHING | | Yes | Yes | No | 02/19/2021 | 143.75 |
| ASSO | | 52858 | 99538 | Check | 1 | 7697 | | MARISELA V NELSON INTERPRETING | | Yes | Yes | No | 02/19/2021 | 60.00 |
| ASSO | | 52855 | 99539 | Check | 1 | 6847 | | MN DECA | | Yes | Yes | No | 02/19/2021 | 1,670.00 |
| ASSO | | 52851 | 99540 | Check | 1 | 1012 | | SCHOOL SPECIALTY INC | | Yes | Yes | Yes | 02/19/2021 | 2,176.10 |
| ASSO | | 52859 | 99541 | Check | 1 | 8143 | | SCRIBBLES SOFTWARE | C Corporation | Yes | Yes | No | 02/19/2021 | 632.60 |
| ASSO | | 52857 | 99542 | Check | 1 | 7649 | | TSA CONSULTING GROUP, INC. | | Yes | Yes | No | 02/19/2021 | 350.40 |
| ASSO | | 52860 | 99543 | Check | 1 | 6031 | | POSTMASTER | | Yes | Yes | No | 02/19/2021 | 1,018.65 |
| ASSO | | 52863 | 99544 | Check | 1 | 2009 | | EDUCATION FOUNDATION - EMR | | Yes | Yes | No | 02/19/2021 | 9,185.28 |
| ASSO | | 52861 | 99545 | Check | 1 | 1644 | | ISD #883 EDUCATION FOUNDATION | | Yes | Yes | No | 02/19/2021 | 469.70 |
| ASSO | | 52862 | 99546 | Check | 1 | 1969 | | SCHOOL SERVICE EMPLOYEES | | Yes | Yes | No | 02/19/2021 | 1,758.30 |
| ASSO | | 52889 | 99547 | Check | 1 | 4138 | | BROUGH, TONY | | Yes | Yes | No | 02/26/2021 | 119.25 |
| ASSO | | 52883 | 99548 | Check | 1 | 1181 | | CITY OF ROCKFORD | | Yes | Yes | No | 02/26/2021 | 600.75 |
| ASSO | | 52884 | 99549 | Check | 1 | 1181 | | CITY OF ROCKFORD | | Yes | Yes | No | 02/26/2021 | 120.00 |
| ASSO | | 52901 | 99550 | Check | 1 | 8071 | | CREATIVE STAFFING SOLUTIONS | | Yes | Yes | No | 02/26/2021 | 759.38 |
| ASSO | | 52894 | 99551 | Check | 1 | 6054 | | HENNEPIN COUNTY TREASURER | | Yes | Yes | No | 02/26/2021 | 153.00 |

Rockford ISD #0883 Payment Reg by Bank and Check

| Bank | Batch | Pmt No | Check No | Pay Type | Grp Code | Rcd | Vendor | Tax Class | Pay/Void | | | Amount | |
|---------------|-------|--------|----------|----------|----------|------|---------------------------------------|---------------------|----------|-------|------|----------------|------------|
| | | | | | | | | | Print | Recon | Void | | Date |
| ASSO | | 52891 | 99552 | Check | 1 | 5165 | ICS CONSULTING, INC | | Yes | Yes | No | 02/26/2021 | 795.00 |
| ASSO | | 52890 | 99553 | Check | 1 | 4325 | INSTITUTE FOR MUTI SENSORY EDUC. | | Yes | Yes | No | 02/26/2021 | 100.00 |
| ASSO | | 52887 | 99554 | Check | 1 | 1463 | ISD 877 - BUFFALO | | Yes | Yes | No | 02/26/2021 | 8,865.57 |
| ASSO | | 52900 | 99555 | Check | 1 | 7697 | MARISELA V NELSON INTERPRETING | | Yes | Yes | No | 02/26/2021 | 190.00 |
| ASSO | | 52893 | 99556 | Check | 1 | 5795 | remit 2 MEDCO SURGICAL SUPPLY SERVICE | | Yes | Yes | No | 02/26/2021 | 77.30 |
| ASSO | | 52899 | 99557 | Check | 1 | 7633 | MORRIS, BRITTANY | Ind/Sole Proprietor | Yes | Yes | No | 02/26/2021 | 133.25 |
| ASSO | | 52886 | 99558 | Check | 1 | 1366 | NEFF/JOSTENS | | Yes | Yes | No | 02/26/2021 | 805.14 |
| ASSO | | 52897 | 99559 | Check | 1 | 7432 | NORTH HENNEPIN COMMUNITY COLLE | | Yes | Yes | No | 02/26/2021 | 21,150.00 |
| ASSO | | 52896 | 99560 | Check | 1 | 7144 | REMIT PIONEER CRITICAL POWER | | Yes | Yes | No | 02/26/2021 | 550.00 |
| ASSO | | 52892 | 99561 | Check | 1 | 5699 | RAMACHER, RACQUEL | Ind/Sole Proprietor | Yes | Yes | No | 02/26/2021 | 174.25 |
| ASSO | | 52902 | 99562 | Check | 1 | 8143 | SCRIBBLES SOFTWARE | C Corporation | Yes | Yes | No | 02/26/2021 | 87.85 |
| ASSO | | 52888 | 99563 | Check | 1 | 3692 | STATE OF MN DEPT PUBLIC SAFETY | | Yes | Yes | No | 02/26/2021 | 50.00 |
| ASSO | | 52895 | 99564 | Check | 1 | 6437 | TASC | | Yes | Yes | No | 02/26/2021 | 5.75 |
| ASSO | | 52898 | 99565 | Check | 1 | 7545 | TEACHERS ON CALL | | Yes | Yes | No | 02/26/2021 | 4,863.20 |
| ASSO | | 52885 | 99566 | Check | 1 | 1192 | VERIZON WIRELESS | | Yes | Yes | No | 02/26/2021 | 4,093.70 |
| Bank Total: | | | | | | | | | | | | \$947,111.33 | |
| WEST | | 52876 | | Wire | 1 | 6431 | HR SIMPLIFIED | | No | Yes | No | 02/01/2021 | 6,748.04 |
| WEST | | 52877 | | Wire | 1 | 6431 | HR SIMPLIFIED | | No | Yes | No | 02/12/2021 | 6,673.04 |
| WEST | | 52879 | | Wire | 1 | 1977 | BLUE CROSS BLUE SHIELD of MN | | No | Yes | No | 02/01/2021 | 145,617.34 |
| WEST | | 53181 | 77037 | Wire | 1 | 1968 | BANKWEST ROCKFORD | | Yes | Yes | No | 02/28/2021 | 3,287.05 |
| WEST | | 53182 | 77043 | Wire | 1 | 1968 | BANKWEST ROCKFORD | | Yes | Yes | No | 02/28/2021 | 48.66 |
| WEST | | 53178 | 2282021 | Wire | 1 | 4718 | MN TRUST | | Yes | Yes | No | 02/28/2021 | 254.71 |
| Bank Total: | | | | | | | | | | | | \$162,628.84 | |
| Report Total: | | | | | | | | | | | | \$1,109,740.17 | |

Rockford ISD #0883 Payment Reg by Bank and Check

| Bank | Batch | Pmt No | Check No | Pay Type | Grp Code | Rcd | Vendor | Tax Class | Print | Recon | Pay/Void | | Amount |
|------|-------|--------|----------|----------|----------|------|-------------------------------------|---------------------|-------|-------|----------|------------|------------|
| | | | | | | | | | | | Void | Date | |
| ASSO | | 53062 | | Wire | 1 | 1937 | PUBLIC EMPLOYEES RETIREMENT ASS | | No | Yes | No | 03/12/2021 | 19,585.25 |
| ASSO | | 53063 | | Wire | 1 | 1937 | PUBLIC EMPLOYEES RETIREMENT ASS | | No | Yes | No | 03/26/2021 | 16,985.07 |
| ASSO | | 53064 | | Wire | 1 | 1938 | TRA | | No | Yes | No | 03/12/2021 | 53,129.00 |
| ASSO | | 53065 | | Wire | 1 | 1938 | TRA | | No | Yes | No | 03/26/2021 | 53,647.79 |
| ASSO | | 53066 | | Wire | 1 | 1962 | MINNESOTA DEPT OF REVENUE | | No | Yes | No | 03/02/2021 | 17,940.24 |
| ASSO | | 53067 | | Wire | 1 | 1962 | MINNESOTA DEPT OF REVENUE | | No | Yes | No | 03/15/2021 | 17,053.22 |
| ASSO | | 53068 | | Wire | 1 | 2006 | US GOVERNMENT | | No | Yes | No | 03/02/2021 | 106,045.39 |
| ASSO | | 53069 | | Wire | 1 | 2006 | US GOVERNMENT | | No | Yes | No | 03/16/2021 | 102,211.50 |
| ASSO | | 53070 | | Wire | 1 | 3370 | MN CHILD SUPPORT PMT CENTER | | No | Yes | No | 03/15/2021 | 314.00 |
| ASSO | | 53071 | | Wire | 1 | 3370 | MN CHILD SUPPORT PMT CENTER | | No | Yes | No | 03/01/2021 | 614.60 |
| ASSO | | 53072 | | Wire | 1 | 4050 | AFLAC | | No | Yes | No | 03/19/2021 | 532.52 |
| ASSO | | 53073 | | Wire | 1 | 5459 | LEGAL SHIELD | | No | Yes | No | 03/17/2021 | 220.30 |
| ASSO | | 53097 | | Wire | 1 | 2470 | MSRS | | No | Yes | No | 03/22/2021 | 16,204.44 |
| ASSO | | 53101 | | Wire | 1 | 8119 | GIS BENEFITS, INC. | S Corporation | No | Yes | No | 03/01/2021 | 13,798.54 |
| ASSO | | 53102 | | Wire | 1 | 7649 | TSA CONSULTING GROUP, INC. | | No | Yes | No | 03/24/2021 | 39,138.26 |
| ASSO | | 52851 | 99540 | Check | 1 | 1012 | SCHOOL SPECIALTY INC | | Yes | Yes | Yes | 03/25/2021 | (2,176.10) |
| ASSO | | 52919 | 99567 | Check | 1 | 4335 | 4 POINT 0 SCHOOL SERVICES | | Yes | Yes | No | 03/05/2021 | 83,303.02 |
| ASSO | | 52973 | 99568 | Check | 1 | 8161 | ABEL, AMANDA | Ind/Sole Proprietor | Yes | Yes | No | 03/05/2021 | 105.00 |
| ASSO | | 52935 | 99569 | Check | 1 | 6623 | ADVANCED IMAGING SOLUTIONS | | Yes | Yes | No | 03/05/2021 | 5,205.00 |
| ASSO | | 52936 | 99570 | Check | 1 | 6623 | remit ADVANCED IMAGING SOLUTIONS | | Yes | Yes | No | 03/05/2021 | 68.00 |
| ASSO | | 52927 | 99571 | Check | 1 | 5372 | AMDAHL, DANA | Ind/Sole Proprietor | Yes | Yes | No | 03/05/2021 | 105.00 |
| ASSO | | 52979 | 99572 | Check | 1 | 8168 | ANDERSON, RITA | Ind/Sole Proprietor | Yes | Yes | No | 03/05/2021 | 105.00 |
| ASSO | | 52972 | 99573 | Check | 1 | 8160 | ANKER, JONI | Ind/Sole Proprietor | Yes | Yes | No | 03/05/2021 | 105.00 |
| ASSO | | 52929 | 99574 | Check | 1 | 5708 | APOLLO HIGH SCHOOL | | Yes | Yes | No | 03/05/2021 | 100.00 |
| ASSO | | 52937 | 99575 | Check | 1 | 6791 | BARFKNECHT, ALAN | | Yes | No | No | 03/05/2021 | 242.00 |
| ASSO | | 52910 | 99576 | Check | 1 | 1825 | BARTH, BRIAN | | Yes | Yes | No | 03/05/2021 | 305.00 |
| ASSO | | 52971 | 99577 | Check | 1 | 8159 | BIEDERWOLF, JOANNE | Ind/Sole Proprietor | Yes | Yes | No | 03/05/2021 | 105.00 |
| ASSO | | 52925 | 99578 | Check | 1 | 5306 | BORAAS, ROB | | Yes | Yes | No | 03/05/2021 | 242.00 |
| ASSO | | 52922 | 99579 | Check | 1 | 4581 | BREAKDOWN SPORTS USA | | Yes | Yes | No | 03/05/2021 | 250.00 |
| ASSO | | 52970 | 99580 | Check | 1 | 8158 | CARLSON, ALEXANDER | Ind/Sole Proprietor | Yes | Yes | No | 03/05/2021 | 105.00 |
| ASSO | | 52969 | 99581 | Check | 1 | 8157 | CASTER, BRANDON | Ind/Sole Proprietor | Yes | Yes | No | 03/05/2021 | 105.00 |
| ASSO | | 52909 | 99582 | Check | 1 | 1181 | CITY OF ROCKFORD | | Yes | Yes | No | 03/05/2021 | 15.95 |
| ASSO | | 52978 | 99583 | Check | 1 | 8167 | CONSTABLE, LORI | Ind/Sole Proprietor | Yes | Yes | No | 03/05/2021 | 105.00 |
| ASSO | | 52957 | 99584 | Check | 1 | 8145 | COOPET, JULIE | Ind/Sole Proprietor | Yes | Yes | No | 03/05/2021 | 94.00 |
| ASSO | | 52953 | 99585 | Check | 1 | 8071 | CREATIVE STAFFING SOLUTIONS | | Yes | Yes | No | 03/05/2021 | 1,255.51 |
| ASSO | | 52942 | 99586 | Check | 1 | 7570 | CST MN - BIN # 170065 | | Yes | Yes | No | 03/05/2021 | 59,720.37 |
| ASSO | | 52924 | 99587 | Check | 1 | 5274 | DECKER, DUSTY ¹⁸ | | Yes | Yes | No | 03/05/2021 | 121.00 |
| ASSO | | 52913 | 99588 | Check | 1 | 2857 | DECKER, MARK | | Yes | No | No | 03/05/2021 | 121.00 |
| ASSO | | 52967 | 99589 | Check | 1 | 8155 | FOKKEN, MARK | Ind/Sole Proprietor | Yes | Yes | No | 03/05/2021 | 105.00 |

Rockford ISD #0883 Payment Reg by Bank and Check

| Bank | Batch | Pmt No | Check No | Pay Type | Grp Code | Rcd | Vendor | Tax Class | Print | Recon | Void | Pay/Void | | Amount |
|------|-------|--------|----------|----------|----------|------|--|---------------------|-------|-------|------|------------|--|----------|
| | | | | | | | | | | | | Date | | |
| ASSO | | 52966 | 99590 | Check | 1 | 8154 | FRENCH, AUDREY | Ind/Sole Proprietor | Yes | Yes | No | 03/05/2021 | | 105.00 |
| ASSO | | 52908 | 99591 | Check | 1 | 1113 | GRAINGER | | Yes | Yes | No | 03/05/2021 | | 428.20 |
| ASSO | | 52939 | 99592 | Check | 1 | 7162 | GRAMS, RYAN | | Yes | Yes | No | 03/05/2021 | | 121.00 |
| ASSO | | 52905 | 99593 | Check | 1 | 1057 | HILLYARD | | Yes | Yes | No | 03/05/2021 | | 337.12 |
| ASSO | | 52923 | 99594 | Check | 1 | 4673 | INTEGRIPRINT | | Yes | Yes | No | 03/05/2021 | | 899.84 |
| ASSO | | 52946 | 99595 | Check | 1 | 7638 | JACOBSON, WAYNE | | Yes | Yes | No | 03/05/2021 | | 61.00 |
| ASSO | | 52965 | 99596 | Check | 1 | 8153 | JANKE, CLIFF | Ind/Sole Proprietor | Yes | Yes | No | 03/05/2021 | | 105.00 |
| ASSO | | 52964 | 99597 | Check | 1 | 8152 | JANKE, ROXY ANN | Ind/Sole Proprietor | Yes | Yes | No | 03/05/2021 | | 105.00 |
| ASSO | | 52907 | 99598 | Check | 1 | 1102 | JW PEPPER | | Yes | Yes | No | 03/05/2021 | | 421.71 |
| ASSO | | 52945 | 99599 | Check | 1 | 7627 | KEGLER, MICHAEL | Ind/Sole Proprietor | Yes | Yes | No | 03/05/2021 | | 64.00 |
| ASSO | | 52963 | 99600 | Check | 1 | 8151 | KYLLONEN, JODI | Ind/Sole Proprietor | Yes | Yes | No | 03/05/2021 | | 105.00 |
| ASSO | | 52951 | 99601 | Check | 1 | 7864 | LITCHFIELD PUBLIC SCHOOLS | | Yes | Yes | No | 03/05/2021 | | 104.49 |
| ASSO | | 52947 | 99602 | Check | 1 | 7672 | MAGNATAG VISIBLE SYSTEMS | | Yes | Yes | No | 03/05/2021 | | 1,533.54 |
| ASSO | | 52934 | 99603 | Check | 1 | 6479 | MAREK, MATTHEW | | Yes | Yes | No | 03/05/2021 | | 121.00 |
| ASSO | | 52948 | 99604 | Check | 1 | 7697 | MARISELA V NELSON INTERPRETING | | Yes | Yes | No | 03/05/2021 | | 445.00 |
| ASSO | | 52912 | 99605 | Check | 1 | 2518 | remit MCGRAW - HILL SCHOOL EDUCATION | | Yes | Yes | No | 03/05/2021 | | 138.06 |
| ASSO | | 52931 | 99606 | Check | 1 | 5795 | remit 2 MEDCO SURGICAL SUPPLY SERVICE | | Yes | Yes | No | 03/05/2021 | | 92.40 |
| ASSO | | 52949 | 99607 | Check | 1 | 7722 | MEDIA MINEFIELD, INC. | S Corporation | Yes | Yes | No | 03/05/2021 | | 4,500.00 |
| ASSO | | 52930 | 99608 | Check | 1 | 5720 | MEYER, ERIC | Ind/Sole Proprietor | Yes | No | No | 03/05/2021 | | 105.00 |
| ASSO | | 52962 | 99609 | Check | 1 | 8150 | MEYER-LARSON, REBECCA | Ind/Sole Proprietor | Yes | No | No | 03/05/2021 | | 105.00 |
| ASSO | | 52933 | 99610 | Check | 1 | 6313 | MINNESOTA COMMUNITY ED. ASSOC. | | Yes | Yes | No | 03/05/2021 | | 120.00 |
| ASSO | | 52944 | 99611 | Check | 1 | 7608 | MOYNAGH, ROBERT JR. | Ind/Sole Proprietor | Yes | Yes | No | 03/05/2021 | | 61.00 |
| ASSO | | 52916 | 99612 | Check | 1 | 3482 | MSHSL | | Yes | Yes | No | 03/05/2021 | | 2,544.00 |
| ASSO | | 52950 | 99613 | Check | 1 | 7751 | NATIONAL BUSINESS FURNITURE, LLC | | Yes | Yes | No | 03/05/2021 | | 778.30 |
| ASSO | | 52961 | 99614 | Check | 1 | 8149 | NEUSCHWANDER, DALE | Ind/Sole Proprietor | Yes | Yes | No | 03/05/2021 | | 105.00 |
| ASSO | | 52914 | 99615 | Check | 1 | 3025 | NEUSCHWANDER, PATRICIA | Ind/Sole Proprietor | Yes | Yes | No | 03/05/2021 | | 105.00 |
| ASSO | | 52954 | 99616 | Check | 1 | 8072 | PEDIATRIC HOME SERVICE | | Yes | Yes | No | 03/05/2021 | | 1,125.00 |
| ASSO | | 52941 | 99617 | Check | 1 | 7389 | PIKET, JOSEPH | | Yes | Yes | No | 03/05/2021 | | 121.00 |
| ASSO | | 52904 | 99618 | Check | 1 | 1020 | remit PITNEY BOWES GLOBAL FINANCIAL SE | | Yes | Yes | No | 03/05/2021 | | 912.12 |
| ASSO | | 52980 | 99619 | Check | 1 | 8169 | PURRINGTON, RICHARD | Ind/Sole Proprietor | Yes | Yes | No | 03/05/2021 | | 105.00 |
| ASSO | | 52915 | 99620 | Check | 1 | 3403 | RANDY'S SANITATION INC | | Yes | Yes | No | 03/05/2021 | | 1,707.40 |
| ASSO | | 52918 | 99621 | Check | 1 | 3915 | REINHART FOOD SERVICE | | Yes | Yes | No | 03/05/2021 | | 141.77 |
| ASSO | | 52921 | 99622 | Check | 1 | 4535 | ROCKFORD/GREENFIELD CHAMBER O | | Yes | Yes | No | 03/05/2021 | | 15.00 |
| ASSO | | 52977 | 99623 | Check | 1 | 8166 | ROSEEN, RYAN | Ind/Sole Proprietor | Yes | Yes | No | 03/05/2021 | | 105.00 |
| ASSO | | 52960 | 99624 | Check | 1 | 8148 | ROTHER, TRAVIS | Ind/Sole Proprietor | Yes | Yes | No | 03/05/2021 | | 105.00 |
| ASSO | | 52932 | 99625 | Check | 1 | 6103 | SCHEFF, GREG | | Yes | No | No | 03/05/2021 | | 121.00 |
| ASSO | | 52917 | 99626 | Check | 1 | 3880 | SCHERBER DREW ¹⁹ | | Yes | Yes | No | 03/05/2021 | | 121.00 |
| ASSO | | 52959 | 99627 | Check | 1 | 8147 | SCHMIDT, MELANIE | Ind/Sole Proprietor | Yes | Yes | No | 03/05/2021 | | 105.00 |
| ASSO | | 52906 | 99628 | Check | 1 | 1091 | SCHMITT MUSIC CENTER | | Yes | Yes | No | 03/05/2021 | | 23.88 |

Rockford ISD #0883 Payment Reg by Bank and Check

| Bank | Batch | Pmt No | Check No | Pay Type | Grp Code | Rcd | Vendor | Tax Class | Print | Recon | Void | Pay/Void | | Amount |
|------|-------|--------|----------|----------|----------|------|--------|-----------------------------------|---------------------|-------|------|----------|------------|-----------|
| | | | | | | | | | | | | Date | | |
| ASSO | | 52926 | 99629 | Check | 1 | 5337 | remit | SCHOOL OUTFITTERS | | Yes | Yes | No | 03/05/2021 | 19,936.97 |
| ASSO | | 52903 | 99630 | Check | 1 | 1012 | | SCHOOL SPECIALTY INC | | Yes | Yes | No | 03/05/2021 | 392.14 |
| ASSO | | 52952 | 99631 | Check | 1 | 8029 | | SFM | | Yes | Yes | No | 03/05/2021 | 27,105.00 |
| ASSO | | 52976 | 99632 | Check | 1 | 8165 | | SIELING, SCOTT | Ind/Sole Proprietor | Yes | Yes | No | 03/05/2021 | 105.00 |
| ASSO | | 52943 | 99633 | Check | 1 | 7590 | | ST. MICHAEL-ALBERTVILLE HIGH SCHC | | Yes | Yes | No | 03/05/2021 | 63.00 |
| ASSO | | 52920 | 99634 | Check | 1 | 4387 | | TAHER INC - BIN# 135092 | | Yes | Yes | No | 03/05/2021 | 55,635.99 |
| ASSO | | 52974 | 99635 | Check | 1 | 8163 | | TNT AUDIO INC. | S Corporation | Yes | No | No | 03/05/2021 | 550.00 |
| ASSO | | 52958 | 99636 | Check | 1 | 8146 | | TREMAIN, TOBY | Ind/Sole Proprietor | Yes | Yes | No | 03/05/2021 | 105.00 |
| ASSO | | 52956 | 99637 | Check | 1 | 8114 | | TREY HANNAM TRANING LLC | | Yes | Yes | No | 03/05/2021 | 321.88 |
| ASSO | | 52955 | 99638 | Check | 1 | 8081 | | TURNBULL, BLAINE | | Yes | Yes | No | 03/05/2021 | 121.00 |
| ASSO | | 52938 | 99639 | Check | 1 | 6834 | | URBAN, NICHOLAS | | Yes | Yes | No | 03/05/2021 | 242.00 |
| ASSO | | 52975 | 99640 | Check | 1 | 8164 | | VANLEEUEWE, LUCAS | Ind/Sole Proprietor | Yes | Yes | No | 03/05/2021 | 105.00 |
| ASSO | | 52968 | 99641 | Check | 1 | 8156 | | WAGNER, MARIA | Ind/Sole Proprietor | Yes | Yes | No | 03/05/2021 | 105.00 |
| ASSO | | 52940 | 99642 | Check | 1 | 7333 | | WEISSMAN | | Yes | Yes | No | 03/05/2021 | 123.40 |
| ASSO | | 52928 | 99643 | Check | 1 | 5430 | | WEST METRO LAWN MAINTENANCE | | Yes | Yes | No | 03/05/2021 | 510.00 |
| ASSO | | 52911 | 99644 | Check | 1 | 2298 | | YANKE, MICK | | Yes | Yes | No | 03/05/2021 | 305.00 |
| ASSO | | 52982 | 99645 | Check | 1 | 6377 | | DISH | | Yes | Yes | No | 03/09/2021 | 108.04 |
| ASSO | | 52983 | 99646 | Check | 1 | 8170 | | US BANCORP GOVN'T LEASING & FINA | C Corporation | Yes | Yes | No | 03/09/2021 | 7,569.12 |
| ASSO | | 52981 | 99647 | Check | 1 | 1215 | | XCEL ENERGY | | Yes | Yes | No | 03/09/2021 | 20,573.02 |
| ASSO | | 52995 | 99648 | Check | 1 | 4035 | | AYDT CHARLES | | Yes | Yes | No | 03/12/2021 | 132.00 |
| ASSO | | 52999 | 99649 | Check | 1 | 5137 | | B & H PHOTO | | Yes | Yes | No | 03/12/2021 | 151.92 |
| ASSO | | 52996 | 99650 | Check | 1 | 4138 | | BROUGH, TONY | | Yes | Yes | No | 03/12/2021 | 132.00 |
| ASSO | | 52992 | 99651 | Check | 1 | 2939 | | BURAU, CHAD | | Yes | Yes | No | 03/12/2021 | 121.00 |
| ASSO | | 52985 | 99652 | Check | 1 | 1180 | | CENTERPOINT ENERGY | | Yes | Yes | No | 03/12/2021 | 12,662.04 |
| ASSO | | 52990 | 99653 | Check | 1 | 2374 | | DEMCO INC | | Yes | Yes | No | 03/12/2021 | 943.08 |
| ASSO | | 53024 | 99654 | Check | 1 | 8172 | | DRENNAN, CHRISTOPHER | Ind/Sole Proprietor | Yes | Yes | No | 03/12/2021 | 121.00 |
| ASSO | | 53009 | 99655 | Check | 1 | 6829 | | DRUSCH, MERLYN | | Yes | Yes | No | 03/12/2021 | 121.00 |
| ASSO | | 53001 | 99656 | Check | 1 | 5658 | | EASTBAY INC. | | Yes | Yes | No | 03/12/2021 | 1,985.10 |
| ASSO | | 53004 | 99657 | Check | 1 | 5992 | | ECM PUBLISHERS, INC. | | Yes | Yes | No | 03/12/2021 | 229.54 |
| ASSO | | 53008 | 99658 | Check | 1 | 6481 | | GRADY'S ACE HARDWARE | | Yes | Yes | No | 03/12/2021 | 841.67 |
| ASSO | | 53010 | 99659 | Check | 1 | 7162 | | GRAMS, RYAN | | Yes | No | No | 03/12/2021 | 184.00 |
| ASSO | | 52994 | 99660 | Check | 1 | 3901 | | GRIMM KELLY | | Yes | No | No | 03/12/2021 | 50.00 |
| ASSO | | 53013 | 99661 | Check | 1 | 7414 | | HAAS, CASEY | | Yes | No | No | 03/12/2021 | 184.00 |
| ASSO | | 52998 | 99662 | Check | 1 | 4955 | remit | HENNEPIN CO ACCOUNTS RECEIV | | Yes | Yes | No | 03/12/2021 | 64.00 |
| ASSO | | 52984 | 99663 | Check | 1 | 1057 | | HILLYARD | | Yes | Yes | No | 03/12/2021 | 175.00 |
| ASSO | | 53025 | 99664 | Check | 1 | 8173 | | HOEKSTRA, PAMELA | | Yes | Yes | No | 03/12/2021 | 100.00 |
| ASSO | | 53015 | 99665 | Check | 1 | 7638 | | JACOBSON, WAYNE | | Yes | Yes | No | 03/12/2021 | 64.00 |
| ASSO | | 53017 | 99666 | Check | 1 | 7736 | | JOHNSON CONTROLS FIRE PROTECTI | | Yes | Yes | No | 03/12/2021 | 394.00 |
| ASSO | | 53003 | 99667 | Check | 1 | 5974 | | KULLY SUPPLY | | Yes | Yes | No | 03/12/2021 | 526.16 |

Rockford ISD #0883 Payment Reg by Bank and Check

| Bank | Batch | Pmt No | Check No | Pay Type | Grp Code | Rcd | Vendor | Tax Class | Print | Recon | Void | Pay/Void | | Amount |
|------|-------|--------|----------|----------|----------|------|---------------------------------------|---------------------|-------|-------|------|------------|--|-----------|
| | | | | | | | | | | | | Date | | |
| ASSO | | 53018 | 99668 | Check | 1 | 7833 | KYLLO, KARLEA | Ind/Sole Proprietor | Yes | Yes | No | 03/12/2021 | | 121.00 |
| ASSO | | 53016 | 99669 | Check | 1 | 7697 | MARISELA V NELSON INTERPRETING | | Yes | Yes | No | 03/12/2021 | | 1,115.00 |
| ASSO | | 52986 | 99670 | Check | 1 | 1394 | MBNA/BUSINESS CARD | | Yes | Yes | No | 03/12/2021 | | 5,532.34 |
| ASSO | | 52987 | 99671 | Check | 1 | 1394 | MBNA/BUSINESS CARD | | Yes | Yes | No | 03/12/2021 | | 5.00 |
| ASSO | | 53002 | 99672 | Check | 1 | 5795 | remit 2 MEDCO SURGICAL SUPPLY SERVICE | | Yes | Yes | No | 03/12/2021 | | 103.40 |
| ASSO | | 53006 | 99673 | Check | 1 | 6356 | MITEL NETSOLUTIONS | | Yes | Yes | No | 03/12/2021 | | 3,439.01 |
| ASSO | | 53019 | 99674 | Check | 1 | 7849 | NIESEN, ALI | Ind/Sole Proprietor | Yes | Yes | No | 03/12/2021 | | 132.00 |
| ASSO | | 53020 | 99675 | Check | 1 | 7873 | ON SITE COMPANIES, INC. | | Yes | Yes | No | 03/12/2021 | | 241.00 |
| ASSO | | 53011 | 99676 | Check | 1 | 7166 | PARPART, NATHAN | | Yes | No | No | 03/12/2021 | | 121.00 |
| ASSO | | 53022 | 99677 | Check | 1 | 8072 | PEDIATRIC HOME SERVICE | | Yes | Yes | No | 03/12/2021 | | 675.00 |
| ASSO | | 52991 | 99678 | Check | 1 | 2398 | PERFORMANCE TOURS | | Yes | Yes | No | 03/12/2021 | | 2,000.00 |
| ASSO | | 53021 | 99679 | Check | 1 | 7996 | REMEDIA PUBLICATIONS, INC. | | Yes | Yes | No | 03/12/2021 | | 206.96 |
| ASSO | | 52993 | 99680 | Check | 1 | 3880 | SCHERBER DREW | | Yes | Yes | No | 03/12/2021 | | 121.00 |
| ASSO | | 53005 | 99681 | Check | 1 | 6279 | SHI INTERNATIONAL CORP. | | Yes | Yes | No | 03/12/2021 | | 624.00 |
| ASSO | | 53007 | 99682 | Check | 1 | 6437 | TASC | | Yes | Yes | No | 03/12/2021 | | 5.75 |
| ASSO | | 53014 | 99683 | Check | 1 | 7545 | TEACHERS ON CALL | | Yes | Yes | No | 03/12/2021 | | 7,014.26 |
| ASSO | | 53012 | 99684 | Check | 1 | 7392 | THOUGHT FARM LLC | | Yes | No | No | 03/12/2021 | | 858.00 |
| ASSO | | 52988 | 99685 | Check | 1 | 1792 | THREE RIVERS PARK DISTRICT | | Yes | Yes | No | 03/12/2021 | | 88.20 |
| ASSO | | 53000 | 99686 | Check | 1 | 5149 | TOLL COMPANY | | Yes | Yes | No | 03/12/2021 | | 330.05 |
| ASSO | | 52997 | 99687 | Check | 1 | 4719 | TRACTOR SUPPLY COMPANY | | Yes | Yes | No | 03/12/2021 | | 136.68 |
| ASSO | | 52989 | 99688 | Check | 1 | 1828 | TRAEN, TODD | | Yes | Yes | No | 03/12/2021 | | 121.00 |
| ASSO | | 53023 | 99689 | Check | 1 | 8171 | TUPA, KRISTIN | Ind/Sole Proprietor | Yes | Yes | No | 03/12/2021 | | 105.00 |
| ASSO | | 53026 | 99690 | Check | 1 | 8174 | URTEL, JANICE | Ind/Sole Proprietor | Yes | No | No | 03/12/2021 | | 105.00 |
| ASSO | | 53038 | 99691 | Check | 1 | 4335 | 4 POINT 0 SCHOOL SERVICES | | Yes | Yes | No | 03/15/2021 | | 72,822.85 |
| ASSO | | 53039 | 99692 | Check | 1 | 4335 | 4 POINT 0 SCHOOL SERVICES | | Yes | Yes | No | 03/15/2021 | | 7,063.04 |
| ASSO | | 53032 | 99693 | Check | 1 | 1369 | ABC LETTERING | | Yes | Yes | No | 03/15/2021 | | 645.00 |
| ASSO | | 53047 | 99694 | Check | 1 | 6598 | ALL SEASONS SPORTS, LLC | | Yes | Yes | No | 03/15/2021 | | 1,475.00 |
| ASSO | | 53042 | 99695 | Check | 1 | 5051 | BYERS MICHELLE | | Yes | Yes | No | 03/15/2021 | | 102.00 |
| ASSO | | 53049 | 99696 | Check | 1 | 7480 | CORPORATE MECHANICAL, INC. | | Yes | Yes | No | 03/15/2021 | | 15,081.00 |
| ASSO | | 53045 | 99697 | Check | 1 | 5992 | ECM PUBLISHERS, INC. | | Yes | Yes | No | 03/15/2021 | | 356.18 |
| ASSO | | 53058 | 99698 | Check | 1 | 8175 | FEULNER, JASON | | Yes | No | No | 03/15/2021 | | 51.00 |
| ASSO | | 53050 | 99699 | Check | 1 | 7513 | FOLLETT SCHOOL SOLUTIONS | | Yes | Yes | No | 03/15/2021 | | 189.99 |
| ASSO | | 53031 | 99700 | Check | 1 | 1113 | GRAINGER | | Yes | Yes | No | 03/15/2021 | | 1,402.96 |
| ASSO | | 53046 | 99701 | Check | 1 | 6157 | GUSTAFSON, ZACH | | Yes | Yes | No | 03/15/2021 | | 121.00 |
| ASSO | | 53051 | 99702 | Check | 1 | 7615 | HASTY AWARDS | | Yes | Yes | No | 03/15/2021 | | 398.67 |
| ASSO | | 53030 | 99703 | Check | 1 | 1057 | HILLYARD | | Yes | Yes | No | 03/15/2021 | | 55.23 |
| ASSO | | 53035 | 99704 | Check | 1 | 3207 | REMIT HOUGHTON MIFFLIN HARCOURT | | Yes | Yes | No | 03/15/2021 | | 99.20 |
| ASSO | | 53034 | 99705 | Check | 1 | 2323 | HOUSE OF PRINT | | Yes | Yes | No | 03/15/2021 | | 3,141.43 |
| ASSO | | 53036 | 99706 | Check | 1 | 3679 | INNOVATIVE OFFICE SOLUTIONS | | Yes | Yes | No | 03/15/2021 | | 83.58 |

Rockford ISD #0883 Payment Reg by Bank and Check

| Bank | Batch | Pmt No | Check No | Pay Type | Grp Code | Rcd | Vendor | Tax Class | Print | Recon | Void | Pay/Void | | Amount |
|------|-------|--------|----------|----------|----------|------|-----------------------------------|---------------------|-------|-------|------|------------|--|-----------|
| | | | | | | | | | | | | Date | | |
| ASSO | | 53040 | 99707 | Check | 1 | 4673 | INTEGRIPRINT | | Yes | Yes | No | 03/15/2021 | | 61.70 |
| ASSO | | 53056 | 99708 | Check | 1 | 8090 | LUTHERAN SOCIAL SERVICES-HOMME | | Yes | Yes | No | 03/15/2021 | | 3,998.93 |
| ASSO | | 53052 | 99709 | Check | 1 | 7697 | MARISELA V NELSON INTERPRETING | | Yes | Yes | No | 03/15/2021 | | 60.00 |
| ASSO | | 53029 | 99710 | Check | 1 | 1044 | MAWSECO #938 | | Yes | Yes | No | 03/15/2021 | | 16,974.58 |
| ASSO | | 53054 | 99711 | Check | 1 | 7858 | MEEKER COMMUNITY SOLAR ONE LLC | | Yes | Yes | No | 03/15/2021 | | 988.99 |
| ASSO | | 53028 | 99712 | Check | 1 | 1039 | MINNESOTA ELEVATOR, INC | | Yes | Yes | No | 03/15/2021 | | 425.80 |
| ASSO | | 53055 | 99713 | Check | 1 | 8072 | PEDIATRIC HOME SERVICE | | Yes | Yes | No | 03/15/2021 | | 2,025.00 |
| ASSO | | 53057 | 99714 | Check | 1 | 8122 | PROJECTOR LAMPS LLC | LLC - Partnership | Yes | Yes | No | 03/15/2021 | | 217.00 |
| ASSO | | 53041 | 99715 | Check | 1 | 4937 | RUSSELL SECURITY RESOURCE INC | | Yes | Yes | No | 03/15/2021 | | 63.00 |
| ASSO | | 53059 | 99716 | Check | 1 | 8176 | SARKINEN, HEIDI | | Yes | No | No | 03/15/2021 | | 51.00 |
| ASSO | | 53027 | 99717 | Check | 1 | 1012 | SCHOOL SPECIALTY INC | | Yes | Yes | No | 03/15/2021 | | 380.73 |
| ASSO | | 53048 | 99718 | Check | 1 | 7387 | remit SFRC | | Yes | Yes | No | 03/15/2021 | | 132.43 |
| ASSO | | 53060 | 99719 | Check | 1 | 8177 | SOUERS, RANDY | Ind/Sole Proprietor | Yes | Yes | No | 03/15/2021 | | 121.00 |
| ASSO | | 53061 | 99720 | Check | 1 | 8178 | SULLIVAN, LAMARR | Ind/Sole Proprietor | Yes | Yes | No | 03/15/2021 | | 121.00 |
| ASSO | | 53053 | 99721 | Check | 1 | 7778 | TEAMWORKS INTERNATIONAL, INC | | Yes | No | No | 03/15/2021 | | 3,281.25 |
| ASSO | | 53037 | 99722 | Check | 1 | 4055 | REMIT TIERNEY BROTHERS INC | | Yes | Yes | No | 03/15/2021 | | 38,520.00 |
| ASSO | | 53044 | 99723 | Check | 1 | 5806 | UNIVERSAL ATHLETICS SERVICES, INC | | Yes | Yes | No | 03/15/2021 | | 19.99 |
| ASSO | | 53043 | 99724 | Check | 1 | 5430 | WEST METRO LAWN MAINTENANCE | | Yes | Yes | No | 03/15/2021 | | 1,565.00 |
| ASSO | | 53033 | 99725 | Check | 1 | 1841 | WRIGHT TECHNICAL CENTER | | Yes | Yes | No | 03/15/2021 | | 231.90 |
| ASSO | | 53076 | 99726 | Check | 1 | 2009 | EDUCATION FOUNDATION - EMR | | Yes | No | No | 03/19/2021 | | 9,185.28 |
| ASSO | | 53074 | 99727 | Check | 1 | 1644 | ISD #883 EDUCATION FOUNDATION | | Yes | No | No | 03/19/2021 | | 469.70 |
| ASSO | | 53075 | 99728 | Check | 1 | 1969 | SCHOOL SERVICE EMPLOYEES | | Yes | Yes | No | 03/19/2021 | | 1,846.79 |
| ASSO | | 53080 | 99729 | Check | 1 | 1492 | ADAM'S PEST CONTROL INC | | Yes | Yes | No | 03/19/2021 | | 313.59 |
| ASSO | | 53078 | 99730 | Check | 1 | 1247 | ALLINA HOSPITALS AND CLINICS | | Yes | Yes | No | 03/19/2021 | | 588.00 |
| ASSO | | 53094 | 99731 | Check | 1 | 8179 | BEN STEWART | Ind/Sole Proprietor | Yes | Yes | No | 03/19/2021 | | 386.00 |
| ASSO | | 53077 | 99732 | Check | 1 | 1180 | CENTERPOINT ENERGY | | Yes | Yes | No | 03/19/2021 | | 6,620.75 |
| ASSO | | 53087 | 99733 | Check | 1 | 5507 | CITY OF GREENFIELD WATER & SEWE | | Yes | Yes | No | 03/19/2021 | | 2,252.31 |
| ASSO | | 53086 | 99734 | Check | 1 | 5165 | ICS CONSULTING, INC | | Yes | Yes | No | 03/19/2021 | | 795.00 |
| ASSO | | 53079 | 99735 | Check | 1 | 1290 | ISD 466 DASSEL-COKATO | | Yes | No | No | 03/19/2021 | | 87.00 |
| ASSO | | 53083 | 99736 | Check | 1 | 4613 | KENNEDY AND GRAVEN | | Yes | Yes | No | 03/19/2021 | | 540.00 |
| ASSO | | 53082 | 99737 | Check | 1 | 2081 | MAPLE LAKE PUBLIC SCHOOLS | | Yes | No | No | 03/19/2021 | | 65.00 |
| ASSO | | 53092 | 99738 | Check | 1 | 7697 | MARISELA V NELSON INTERPRETING | | Yes | Yes | No | 03/19/2021 | | 790.00 |
| ASSO | | 53095 | 99739 | Check | 1 | 8180 | MISENCIK, JEFFREY | Ind/Sole Proprietor | Yes | Yes | No | 03/19/2021 | | 105.00 |
| ASSO | | 53089 | 99740 | Check | 1 | 7178 | MSOPA | | Yes | Yes | No | 03/19/2021 | | 50.00 |
| ASSO | | 53088 | 99741 | Check | 1 | 6913 | NEE INVESTMENT 9, LLC | | Yes | No | No | 03/19/2021 | | 226.12 |
| ASSO | | 53096 | 99742 | Check | 1 | 8181 | NEIDT, CHERYL | Ind/Sole Proprietor | Yes | Yes | No | 03/19/2021 | | 105.00 |
| ASSO | | 53084 | 99743 | Check | 1 | 4937 | RUSSELL SECURITY RESOURCE INC | | Yes | Yes | No | 03/19/2021 | | 3,105.10 |
| ASSO | | 53093 | 99744 | Check | 1 | 8143 | SCRIBBLES SOFTWARE | C Corporation | Yes | Yes | No | 03/19/2021 | | 106.65 |
| ASSO | | 53090 | 99745 | Check | 1 | 7387 | remit SFRC | | Yes | Yes | No | 03/19/2021 | | 158.69 |

Rockford ISD #0883 Payment Reg by Bank and Check

| Bank | Batch | Pmt No | Check No | Pay Type | Grp Code | Rcd | Vendor | Tax Class | Print | Recon | Void | Pay/Void | Date | Amount |
|------|-------|--------|----------|----------|----------|------|---------------------------------|---------------------|-------|-------|------|------------|------------|--------|
| | | | | | | | | | | | | Date | | |
| ASSO | | 53081 | 99746 | Check | 1 | 1820 | SUITS, ANN | Ind/Sole Proprietor | Yes | No | No | 03/19/2021 | 132.00 | |
| ASSO | | 53091 | 99747 | Check | 1 | 7545 | TEACHERS ON CALL | | Yes | Yes | No | 03/19/2021 | 3,402.00 | |
| ASSO | | 53085 | 99748 | Check | 1 | 5149 | TOLL COMPANY | | Yes | Yes | No | 03/19/2021 | 61.49 | |
| ASSO | | 53099 | 99749 | Check | 1 | 3824 | HANOVER INSURANCE GROUP | | Yes | Yes | No | 03/23/2021 | 29,330.46 | |
| ASSO | | 53122 | 99750 | Check | 1 | 4335 | 4 POINT 0 SCHOOL SERVICES | | Yes | Yes | No | 03/26/2021 | 95,166.15 | |
| ASSO | | 53111 | 99751 | Check | 1 | 1369 | ABC LETTERING | | Yes | No | No | 03/26/2021 | 617.50 | |
| ASSO | | 53124 | 99752 | Check | 1 | 5853 | ALL STATE COMMUNICATIONS, INC | remit | Yes | Yes | No | 03/26/2021 | 23,115.00 | |
| ASSO | | 53116 | 99753 | Check | 1 | 2553 | BRECK SCHOOL | | Yes | No | No | 03/26/2021 | 260.00 | |
| ASSO | | 53121 | 99754 | Check | 1 | 4138 | BROUGH, TONY | | Yes | No | No | 03/26/2021 | 304.50 | |
| ASSO | | 53145 | 99755 | Check | 1 | 8183 | BUSCH, LAURA | Ind/Sole Proprietor | Yes | Yes | No | 03/26/2021 | 332.50 | |
| ASSO | | 53130 | 99756 | Check | 1 | 7420 | CF-ADVERTISING | | Yes | Yes | No | 03/26/2021 | 1,930.00 | |
| ASSO | | 53109 | 99757 | Check | 1 | 1181 | CITY OF ROCKFORD | | Yes | Yes | No | 03/26/2021 | 545.48 | |
| ASSO | | 53137 | 99758 | Check | 1 | 7844 | CLEARSPAN FABRIC STRUCTURES INT | remit | Yes | Yes | No | 03/26/2021 | 4,993.46 | |
| ASSO | | 53141 | 99759 | Check | 1 | 8071 | CREATIVE STAFFING SOLUTIONS | | Yes | Yes | No | 03/26/2021 | 360.00 | |
| ASSO | | 53132 | 99760 | Check | 1 | 7570 | CST MN - BIN # 170065 | | Yes | Yes | No | 03/26/2021 | 146,818.06 | |
| ASSO | | 53127 | 99761 | Check | 1 | 6507 | DELONG KRISTA | Ind/Sole Proprietor | Yes | Yes | No | 03/26/2021 | 334.50 | |
| ASSO | | 53140 | 99762 | Check | 1 | 8000 | ECLIPSE PAINTING, INC. | | Yes | Yes | No | 03/26/2021 | 1,200.00 | |
| ASSO | | 53129 | 99763 | Check | 1 | 7094 | GRAPHITE ARTIST MANAGEMENT | LLC - S Corp | Yes | Yes | No | 03/26/2021 | 2,000.00 | |
| ASSO | | 53105 | 99764 | Check | 1 | 1057 | HILLYARD | | Yes | No | No | 03/26/2021 | 4,569.29 | |
| ASSO | | 53120 | 99765 | Check | 1 | 4022 | INFINITE CAMPUS | | Yes | Yes | No | 03/26/2021 | 399.00 | |
| ASSO | | 53119 | 99766 | Check | 1 | 3679 | INNOVATIVE OFFICE SOLUTIONS | | Yes | Yes | No | 03/26/2021 | 608.64 | |
| ASSO | | 53134 | 99767 | Check | 1 | 7681 | INTERNATIONAL BACCALAUREATE OR | | Yes | Yes | No | 03/26/2021 | 450.00 | |
| ASSO | | 53113 | 99768 | Check | 1 | 2014 | J & R SCHOOL SUPPLIES | | Yes | No | No | 03/26/2021 | 264.00 | |
| ASSO | | 53107 | 99769 | Check | 1 | 1102 | JW PEPPER | | Yes | No | No | 03/26/2021 | 71.99 | |
| ASSO | | 53135 | 99770 | Check | 1 | 7697 | MARISELA V NELSON INTERPRETING | | Yes | Yes | No | 03/26/2021 | 80.00 | |
| ASSO | | 53138 | 99771 | Check | 1 | 7857 | MCLEOD COMMUNITY SOLAR ONE LLC | | Yes | Yes | No | 03/26/2021 | 719.64 | |
| ASSO | | 53139 | 99772 | Check | 1 | 7858 | MEEKER COMMUNITY SOLAR ONE LLC | | Yes | Yes | No | 03/26/2021 | 1,386.78 | |
| ASSO | | 53108 | 99773 | Check | 1 | 1154 | MSBA | | Yes | No | No | 03/26/2021 | 1,365.00 | |
| ASSO | | 53128 | 99774 | Check | 1 | 6973 | MVP LOGISTICS, LLC | | Yes | Yes | No | 03/26/2021 | 11.49 | |
| ASSO | | 53142 | 99775 | Check | 1 | 8072 | PEDIATRIC HOME SERVICE | | Yes | No | No | 03/26/2021 | 731.25 | |
| ASSO | | 53114 | 99776 | Check | 1 | 2398 | PERFORMANCE TOURS | | Yes | No | No | 03/26/2021 | 2,500.00 | |
| ASSO | | 53143 | 99777 | Check | 1 | 8122 | PROJECTOR LAMPS LLC | LLC - Partnership | Yes | No | No | 03/26/2021 | 109.40 | |
| ASSO | | 53123 | 99778 | Check | 1 | 4937 | RUSSELL SECURITY RESOURCE INC | | Yes | Yes | No | 03/26/2021 | 1,770.00 | |
| ASSO | | 53106 | 99779 | Check | 1 | 1091 | SCHMITT MUSIC CENTER | | Yes | Yes | No | 03/26/2021 | 127.50 | |
| ASSO | | 53104 | 99780 | Check | 1 | 1012 | SCHOOL SPECIALTY INC | | Yes | No | No | 03/26/2021 | 2,196.96 | |
| ASSO | | 53125 | 99781 | Check | 1 | 6279 | SHI INTERNATIONAL CORP. | | Yes | No | No | 03/26/2021 | 2,400.00 | |
| ASSO | | 53117 | 99782 | Check | 1 | 3062 | SOUTHWEST MN STATE UNIVERSITY | | Yes | Yes | No | 03/26/2021 | 3,300.00 | |
| ASSO | | 53131 | 99783 | Check | 1 | 7545 | TEACHERS ON CALL | | Yes | Yes | No | 03/26/2021 | 2,973.98 | |
| ASSO | | 53126 | 99784 | Check | 1 | 6295 | TEACHING STRATEGIES LLC | remit | Yes | Yes | No | 03/26/2021 | 2,943.00 | |

Rockford ISD #0883 Payment Reg by Bank and Check

| Bank | Batch | Pmt No | Check No | Pay Type | Grp Code | Rcd | Vendor | Tax Class | Print | Recon | Void | Pay/Void | | Amount |
|---------------|-------|--------|----------|----------|----------|-------|--|-----------|-------|-------|------|------------|----------------|------------|
| | | | | | | | | | | | | Date | | |
| ASSO | | 53136 | 99785 | Check | 1 7786 | REMIT | TERRAFORM PHOENIX II ARCADIA | | Yes | Yes | No | 03/26/2021 | | 91.34 |
| ASSO | | 53112 | 99786 | Check | 1 1792 | | THREE RIVERS PARK DISTRICT | | Yes | No | No | 03/26/2021 | | 510.60 |
| ASSO | | 53118 | 99787 | Check | 1 3293 | | TREMCO | | Yes | No | Yes | 03/26/2021 | | 1,522.09 |
| ASSO | | 53133 | 99788 | Check | 1 7649 | | TSA CONSULTING GROUP, INC. | | Yes | Yes | No | 03/26/2021 | | 350.40 |
| ASSO | | 53115 | 99789 | Check | 1 2513 | REMIT | ULINE | | Yes | No | No | 03/26/2021 | | 3,107.78 |
| ASSO | | 53144 | 99790 | Check | 1 8170 | remit | US BANCORP GOVN'T LEASING & FINA C Corporation | | Yes | No | No | 03/26/2021 | | 7,569.12 |
| ASSO | | 53110 | 99791 | Check | 1 1192 | | VERIZON WIRELESS | | Yes | No | No | 03/26/2021 | | 4,057.25 |
| Bank Total: | | | | | | | | | | | | | \$1,359,122.43 | |
| WEST | | 53098 | | Wire | 1 6431 | | HR SIMPLIFIED | | No | Yes | No | 03/01/2021 | | 6,673.04 |
| WEST | | 53100 | | Wire | 1 1977 | | BLUE CROSS BLUE SHIELD of MN | | No | Yes | No | 03/01/2021 | | 140,367.05 |
| WEST | | 53103 | | Wire | 1 6431 | | HR SIMPLIFIED | | No | Yes | No | 03/15/2021 | | 7,343.97 |
| WEST | | 53180 | 77040 | Wire | 1 1968 | | BANKWEST ROCKFORD | | Yes | Yes | No | 03/31/2021 | | 3,408.37 |
| WEST | | 53183 | 77044 | Wire | 1 1968 | | BANKWEST ROCKFORD | | Yes | Yes | No | 03/31/2021 | | 21.62 |
| WEST | | 53179 | 3312021 | Wire | 1 4718 | | MN TRUST | | Yes | Yes | No | 03/31/2021 | | 302.89 |
| Bank Total: | | | | | | | | | | | | | \$158,116.94 | |
| Report Total: | | | | | | | | | | | | | \$1,517,239.37 | |



ROCKFORD AREA SCHOOLS

INDEPENDENT SCHOOL DISTRICT 883 BOARD OF EDUCATION

Subject: OPEN ENROLLMENTS

Meeting Date: April 19, 2021

Prepared by: Superintendent's Office

Date Prepared: April 15, 2021

Information
 Briefing
 Action
 Enclosure Item(s)

Resident Students Attending Other Schools

| | Grade | Non-Resident District | Number | Date Effective | NR/OE |
|----|-------|-----------------------|--------|----------------|-------|
| 1 | K | Delano | 879 | 9/7/2021 | OE |
| 2 | K | Delano | 879 | 9/7/2021 | OE |
| 3 | 7 | Delano | 879 | 9/7/2021 | OE |
| 4 | K | Delano | 879 | 9/7/2021 | OE |
| 5 | 2 | Delano | 879 | 9/7/2021 | OE |
| 6 | 7 | Delano | 879 | 9/7/2021 | OE |
| 7 | 8 | Buffalo | 877 | 4/12/2021 | OE |
| 8 | 7 | Delano | 879 | 9/7/2021 | OE |
| 9 | 5 | Delano | 879 | 9/7/2021 | OE |
| 10 | K | Delano | 879 | 9/7/2021 | OE |
| 11 | 12 | Elk River | 728 | 2/13/2021 | OE |
| 12 | 6 | Hutchinson | 423 | 4/06/2021 | OE |

Non-Resident Students Attending Rockford

| Grade | Non-Resident District | Number | Date Effective | NR/OE |
|-------|-----------------------|--------|----------------|-------|
|-------|-----------------------|--------|----------------|-------|

Note: Non-resident agreements will not be signed for families requesting a release from our school district. The students listed above are covered under MN Statute 124D.03, thus meeting the legal requirements for open enrollment.



**ROCKFORD AREA SCHOOLS
INDEPENDENT SCHOOL DISTRICT 883
BOARD OF EDUCATION**

**Subject: Resolution Providing for the Issuance and sale of
General Obligation Capital Facilities Refunding Bonds, Series
2021A**

Meeting Date: April 19, 2021

Prepared by: Tanley Lego

Date Prepared: April 15, 2021

Information

Briefing

Action

Enclosure Item(s)

Please consider approval of the attached resolution providing for the issuance and sale of the above-referenced bonds, subject to certain parameters.



PMATM
SECURITIES

April 19, 2021

ISD 883,
Rockford Area Schools

Refunding Presentation

Michael Hart

Director, Public Finance
mhart@pmanetwork.com
612-509-2569

Steve Pumper

Vice President
spumper@pmanetwork.com
612-509-2565



Refunding Analysis

| Refunding Candidate | General Obligation Capital Facilities Bonds, Series 2010A | General Obligation School Building Bonds, Series 2013A |
|---|---|--|
| Interest Rate on Current Bonds | 3.38% | 2.71% |
| Est. All Inclusive Cost on Refunding Bonds* | 1.89% | 0.96% |
| Est. Gross Savings* | \$18,000 | \$2,080,000 |
| Average Annual Savings* | Approximately \$4,500 | Approximately \$300,000 |

*Based on estimated rates as of April 6, 2021.

HISTORICAL INTEREST RATE COMPARISON

MMD "AAA" 5-Year Bond Index

10 Year History

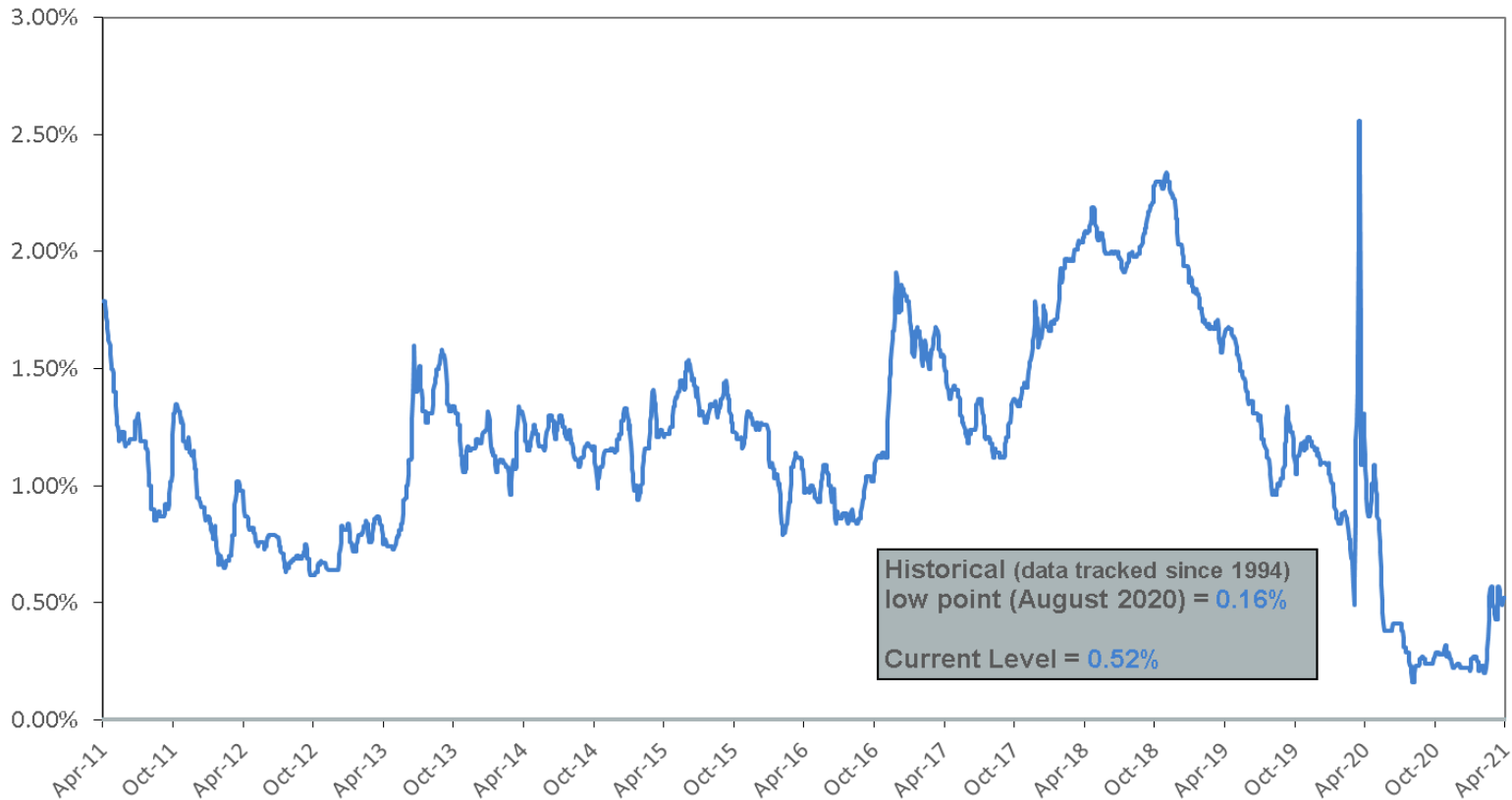

Information shown is the Municipal Market Data index for AAA-rated, 5-year bonds.



Series 2010A Savings Detail

| Date | Current Payment | New Payment | Savings |
|--------------|---------------------|---------------------|--------------------|
| 02/01/2022 | 154,262.50 | 150,028.68 | 4,233.82 |
| 02/01/2023 | 154,875.00 | 148,337.50 | 6,537.50 |
| 02/01/2024 | 155,325.00 | 152,250.00 | 3,075.00 |
| 02/01/2025 | 155,250.00 | 151,125.00 | 4,125.00 |
| Total | \$619,712.50 | \$601,741.18 | \$17,971.32 |

- Preliminary savings is shown after all costs of issuance have been included.
- Savings to be realized as a reduction in general fund expense as bonds are paid out of capital budget within the general fund.



Sources and Uses of Funds – Series 2010A Refunding

Sources Of Funds

| | |
|----------------------|---------------------|
| Par Amount of Bonds | \$591,000.00 |
| Total Sources | \$591,000.00 |

Uses Of Funds

| | |
|-----------------------------------|---------------------|
| Deposit to Current Refunding Fund | 578,775.14 |
| Financial Advisor | 5,000.00 |
| Other Costs of Issuance | 6,900.00 |
| Rounding Amount | 324.86 |
| Total Uses | \$591,000.00 |

* Costs of Issuance are contingent upon successful closing of the financing.



Timeline for Series 2010A Refunding

| April 2021 | | | | | | |
|------------|----|----|----|----|----|----|
| S | M | T | W | Th | F | Sa |
| | | | | 1 | 2 | 3 |
| 4 | 5 | 6 | 7 | 8 | 9 | 10 |
| 11 | 12 | 13 | 14 | 15 | 16 | 17 |
| 18 | 19 | 20 | 21 | 22 | 23 | 24 |
| 25 | 26 | 27 | 28 | 29 | 30 | |

| May 2021 | | | | | | |
|----------|----|----|----|----|----|----|
| S | M | T | W | Th | F | Sa |
| | | | | | | 1 |
| 2 | 3 | 4 | 5 | 6 | 7 | 8 |
| 9 | 10 | 11 | 12 | 13 | 14 | 15 |
| 16 | 17 | 18 | 19 | 20 | 21 | 22 |
| 23 | 24 | 25 | 26 | 27 | 28 | 29 |
| 30 | 31 | | | | | |

| June 2021 | | | | | | |
|-----------|----|----|----|----|----|----|
| S | M | T | W | Th | F | Sa |
| | | 1 | 2 | 3 | 4 | 5 |
| 6 | 7 | 8 | 9 | 10 | 11 | 12 |
| 13 | 14 | 15 | 16 | 17 | 18 | 19 |
| 20 | 21 | 22 | 23 | 24 | 25 | 26 |
| 27 | 28 | 29 | 30 | | | |

Board Action Dates

Est. Bond Pricing Date

Bond Closing

| Date | Action Item |
|----------------|--|
| April 19, 2021 | Board Considers Parameters Resolution |
| April 27, 2021 | Term Sheet Distributed to Banks |
| May 11, 2021 | Deadline for Banks to respond & award sale to best bid |
| May 17, 2021 | Board Considers Ratifying Resolution |
| May 18, 2021 | Call Notice Published |
| Early June | Bond Closing |
| June 21, 2021 | Bond Call |



Parameters Resolution

- Provides authorization to Superintendent or Business Manager and Board Officer to execute the sale with a minimum savings target.
- Includes action to apply for state credit enhancement program
- Sale via a private placement offered to banking institutions



Series 2013A Savings Detail

| Date | Current Payment | New Payment | Savings |
|--------------|------------------------|------------------------|-----------------------|
| 02/01/2022 | 667,337.50 | 665,733.63 | 1,603.87 |
| 02/01/2023 | 1,003,275.00 | 705,587.78 | 297,687.22 |
| 02/01/2024 | 4,526,975.00 | 4,232,000.00 | 294,975.00 |
| 02/01/2025 | 4,420,850.00 | 4,121,600.00 | 299,250.00 |
| 02/01/2026 | 4,410,800.00 | 4,111,900.00 | 298,900.00 |
| 02/01/2027 | 4,387,300.00 | 4,090,900.00 | 296,400.00 |
| 02/01/2028 | 4,386,850.00 | 4,088,800.00 | 298,050.00 |
| 02/01/2029 | 4,387,800.00 | 4,090,200.00 | 297,600.00 |
| Total | \$28,191,187.50 | \$26,106,721.41 | \$2,084,466.09 |

- Savings is shown after all costs of issuance have been included.
- Savings to be realized as a levy reduction for district taxpayers.



Estimated Timeline for Series 2013A Refunding

| August 2021 | | | | | | |
|-------------|----|----|----|----|----|----|
| S | M | T | W | Th | F | Sa |
| 1 | 2 | 3 | 4 | 5 | 6 | 7 |
| 8 | 9 | 10 | 11 | 12 | 13 | 14 |
| 15 | 16 | 17 | 18 | 19 | 20 | 21 |
| 22 | 23 | 24 | 25 | 26 | 27 | 28 |
| 29 | 30 | 31 | | | | |

| September 2021 | | | | | | |
|----------------|----|----|----|----|----|----|
| S | M | T | W | Th | F | Sa |
| | | | 1 | 2 | 3 | 4 |
| 5 | 6 | 7 | 8 | 9 | 10 | 11 |
| 12 | 13 | 14 | 15 | 16 | 17 | 18 |
| 19 | 20 | 21 | 22 | 23 | 24 | 25 |
| 26 | 27 | 28 | 29 | 30 | | |

| October 2021 | | | | | | |
|--------------|----|----|----|----|----|----|
| S | M | T | W | Th | F | Sa |
| | | | | | 1 | 2 |
| 3 | 4 | 5 | 6 | 7 | 8 | 9 |
| 10 | 11 | 12 | 13 | 14 | 15 | 16 |
| 17 | 18 | 19 | 20 | 21 | 22 | 23 |
| 24 | 25 | 26 | 27 | 28 | 29 | 30 |
| 31 | | | | | | |

| November 2021 | | | | | | |
|---------------|----|----|----|----|----|----|
| S | M | T | W | Th | F | Sa |
| | 1 | 2 | 3 | 4 | 5 | 6 |
| 7 | 8 | 9 | 10 | 11 | 12 | 13 |
| 14 | 15 | 16 | 17 | 18 | 19 | 20 |
| 21 | 22 | 23 | 24 | 25 | 26 | 27 |
| 28 | 29 | 30 | | | | |

| Date | Action Item |
|-----------------------------------|---|
| August 2021 | Board Considers Resolution to Call for Sale |
| Late September/Early October 2021 | Bond Sale (Interest Rate and Savings Locked |
| November 2021 | Bond Closing |
| February 1, 2022 | Bond Call |



Disclosure

The information contained herein is solely intended to suggest/discuss potentially applicable financing applications and is not intended to be a specific buy/sell recommendation, nor is it an official confirmation of terms. Any terms discussed herein are preliminary until confirmed in a definitive written agreement.

The analysis or information presented herein is based upon hypothetical projections and/or past performance that have certain limitations. No representation is made that it is accurate or complete or that any results indicated will be achieved. In no way is past performance indicative of future results. Changes to any prices, levels, or assumptions contained herein may have a material impact on results. Any estimates or assumptions contained herein represent our best judgment as of the date indicated and are subject to change without notice. Examples are merely representative and are not meant to be all-inclusive. The information set forth herein was gathered from sources which we believe, but do not guarantee, to be accurate. Neither the information, nor any options expressed, constitute a solicitation by us for purposes of sale or purchase of any securities or commodities. Investment/financing decisions by market participants should not be based on this information.

You should consider certain economic risks (and other legal, tax, and accounting consequences) prior to entering into any type of transaction with PMA Securities, LLC or PMA Financial Network, LLC. It is imperative that any prospective client perform its own research and due diligence, independent of us or our affiliates, to determine suitability of the proposed transaction with respect to the aforementioned potential economic risks and legal, tax, and accounting consequences. Our analyses are not and do not purport to be appraisals of the assets, or business of the Issuer or any other entity. PMA makes no representations as to the actual value which may be received in connection with a transaction nor the legal, tax, or accounting effects of consummating a transaction. PMA cannot be relied upon to provide legal, tax, or accounting advice. You should seek out independent and qualified legal, tax, and accounting advice from outside sources. This information has been prepared for informational and educational purposes and does not constitute a solicitation to purchase or sell securities, which may be done only after client suitability is reviewed and determined.

Securities, public finance and institutional brokerage services are offered through PMA Securities, LLC. PMA Securities, LLC is a broker-dealer and municipal advisor registered with the SEC and MSRB, and is a member of FINRA and SIPC. PMA Asset Management, LLC, an SEC registered investment adviser, provides investment advisory services to local government investment pools. All other products and services are provided by PMA Financial Network, LLC. PMA Financial Network, LLC, PMA Securities, LLC, and PMA Asset Management, LLC (collectively "PMA") are under common ownership. Securities and public finance services offered through PMA Securities, LLC are available in CA, CO, FL, IL, IN, IA, MI, MN, MO, NE, OH, OK, PA, SD, TX and WI. This document is not an offer of services available in any state other than those listed above, has been prepared for informational and educational purposes only and does not constitute a solicitation to purchase or sell securities, which may be done only after client suitability is reviewed and determined. All investments mentioned herein may have varying levels of risk, and may not be suitable for every investor. For more information, please visit us at www.pmanetwork.com. For institutional use only.

A RESOLUTION PROVIDING FOR THE ISSUANCE AND SALE OF GENERAL OBLIGATION CAPITAL FACILITIES REFUNDING BONDS, SERIES 2021A, SUBJECT TO CERTAIN PARAMETERS; AND TAKING OTHER ACTIONS WITH RESPECT THERETO

BE IT RESOLVED By the Board of Education (the “Board”) of Independent School District No. 883 (Rockford Area Schools) Wright and Hennepin Counties, Minnesota (the “District”) as follows:

1. Background. It is hereby determined and declared as follows:

(a) On March 3, 2010, the District issued its General Obligation Capital Facilities Bonds, Series 2010A (the “Refunded Bonds”), dated the date of issuance, in the original aggregate principal amount of \$1,875,000, pursuant to Minnesota Statutes, Section 123B.62, as amended, and Minnesota Statutes, Chapter 475, as amended (collectively, the “Act”). The Refunded Bonds are currently outstanding in the principal amount of \$570,000 and are subject to call for redemption and prepayment at the option of the District on any date. Proceeds of the Refunded Bonds were used to finance certain capital projects and related financing costs, including facilities improvements to address deferred maintenance, correct ventilation deficiencies, and implement energy conservation measures at the high school, middle school and elementary school facilities of the District.

(b) The District is authorized by Section 475.67, subdivision 3 of the Act to issue and sell its general obligation bonds to refund obligations and the interest thereon before the due date of the obligations, if consistent with covenants made with the holders thereof, when determined by the Board to be necessary or desirable for the reduction of debt service costs to the District or for the extension or adjustment of maturities in relation to the resources available for their payment.

(c) It is necessary and desirable for the reduction of debt service costs to the District that the District issue its General Obligation Capital Facilities Refunding Bonds, Series 2021A (the “Bonds”), in the proposed aggregate principal amount of \$595,000 pursuant to the Act, specifically Section 475.67, subdivision 3, to redeem and prepay the Refunded Bonds on or about June 21, 2021 (the “Redemption Date”).

(d) The District is authorized by Section 475.60, subdivision 2(9) of the Act to negotiate the sale of the Bonds it being determined that the District has retained an independent municipal advisor in connection with the sale of the Bonds. The actions of the District staff and its municipal advisor in negotiating the sale of the Bonds are ratified and confirmed in all aspects.

2. Covenant as to State Credit Enhancement.

(a) The District hereby covenants and obligates itself to notify the Minnesota Commissioner of Education of a potential default in the payment of principal and interest on the Bonds and to use the provisions of Minnesota Statutes, Section 126C.55 (the “Credit Enhancement Act”) to guarantee payment of the principal and interest on the Bonds when due. The District further covenants to deposit with the registrar for the Bonds (the “Registrar”) or any successor paying agent three (3) days prior to the date on which a payment is due an amount sufficient to make that payment or to notify the Commissioner of Education that it will be unable to make all or a portion of that payment. The Registrar is authorized and directed to notify the Commissioner of Education if it becomes aware of a potential default in the payment of principal or interest on the Bonds or if, on the day two (2) business days prior to the date a payment is due on the Bonds, there are insufficient funds to make that payment on deposit with the Registrar. The District understands that as a result of

its covenant to be bound by the provisions of the Credit Enhancement Act, the provisions of that section shall be binding as long as any Bonds of this issue remain outstanding.

(b) The District further covenants to comply with all procedures now and hereafter established by the Minnesota Departments of Management and Budget and Education pursuant to subdivision 2(c) of the Credit Enhancement Act and otherwise to take such actions as necessary to comply with that section. The Chair, Clerk, Superintendent, or Secretary of the District is authorized to execute any applicable Minnesota Department of Education forms.

3. Approval to Structure and Facilitate the Sale of Bonds. PMA Securities, LLC, the District's municipal advisor ("PMA"), is authorized and directed to structure the terms of the Bonds, provided that the final maturity shall be no later than February 1, 2025. PMA is further authorized to facilitate the sale of the Bonds. The Board authorizes the Superintendent or the Business Manager and an officer of the Board (a "Board Officer") to consider proposals and take any other appropriate action with respect to the Bonds, provided that the proposal of the selected purchaser (the "Purchaser") meets the following parameters: (i) the principal amount of the Bonds shall not exceed \$595,000, and (ii) the gross debt service savings to be produced by the issuance of the Bonds shall not be less than \$5,000.

4. Acceptance of Proposal. The Board will meet at a regular meeting on May 17, 2021 or on the first practicable date after acceptance by the Superintendent or Business Manager and a Board Officer of a proposal from the Purchaser, to ratify such acceptance and take any other appropriate action with respect to the Bonds.

5. Authority of Bond Counsel. The law firm of Kennedy & Graven, Chartered, as bond counsel for the District, is authorized to act as bond counsel and to assist in the preparation and review of necessary documents, certificates and instruments relating to the Bonds. The officers, employees and agents of the District are hereby authorized to assist Kennedy & Graven, Chartered in the preparation of such documents, certificates, and instruments.

6. Covenants. In the resolution ratifying the sale of the Bonds, the Board will set forth the covenants and undertakings required by the Act.

(The remainder of this page is intentionally left blank.)

The motion for the adoption of the foregoing resolution was duly seconded by Member _____, and upon vote being taken thereon, the following voted in favor thereof:

and the following voted against the same:

whereupon said resolution was declared duly passed and adopted.

STATE OF MINNESOTA)
)
 COUNTIES OF WRIGHT AND) SS.
 HENNEPIN)
)
 INDEPENDENT SCHOOL)
 DISTRICT NO. 883)
 (ROCKFORD AREA SCHOOLS)

I, the undersigned, being the duly qualified and acting District Clerk of Independent School District No. 883 (Rockford Area Schools) Wright and Hennepin Counties, Minnesota, do hereby certify that I have carefully compared the attached and foregoing extract of minutes of a regular meeting of the Board of Education of the District held on April 19, 2021 with the original minutes on file in my office and the extract is a full, true and correct copy of the minutes insofar as they relate to setting the parameters for and authorizing the issuance and sale of the District’s General Obligation Capital Facilities Refunding Bonds, Series 2021A.

WITNESS My hand officially as such District Clerk this _____ day of _____, 2021.

 District Clerk
 Independent School District No. 883
 (Rockford Area Schools)
 Wright and Hennepin Counties, Minnesota



**ROCKFORD AREA SCHOOLS
INDEPENDENT SCHOOL DISTRICT 883
BOARD OF EDUCATION**

**Subject: Director of Teaching & Learning and Principal on
Special Assignment-Student Services**

Meeting Date: April 19, 2021

Prepared by: Kevin Keller & Dr. Matthew J Scheidler

Date Prepared: April 14, 2021

Information Briefing Action Enclosure Item(s)

Highlighted Items:

- 1) **2021 RAS Summer Learning Opportunities**
 - a. **Schedule**
 - b. **Student Recommendation**
 - c. **Family Communication**
 - d. **Registration Window**
 - e. **Staffing**
 - f. **Budget**

2021 Summer Learning Opportunities Proposal

Program Name: REAMS, RMS-CES, and RHS Summer Learning Opportunities

School District: Rockford School District #883

Program Locations: Rockford Elementary School, Rockford Middle School-Center for Environmental Science, Rockford High School, and Maple Hill Estates Hope Center

Program Description/Introduction: The summer school program is designed to support at risk students who learn in different ways or at a different pace from others. By offering time for learning in new fun ways in smaller learning environments, the summer program gives those at risk students the opportunity to improve their academic skills in reading and math.

Grades Served: K-12

Educational Resources/Curriculum:

Licensed Teachers

Curriculum that is in line with MCA test strands (Math/Language Arts)

Grade appropriate skill building exercises

- a. Reading comprehension exercises/math activities
- b. Supplementary small group instruction using Mondo, Making Meaning, Being a Writer and Houghton Mifflin curriculum resources to supplement reading instruction.
- c. Focused instruction on number sense

Identify the Students and Grades Served:

Students in grades K-8 who have not performed well on the MCA or FAST benchmark tests, and whose ongoing assessments (FAST assessments, Fountas & Pinell leveling, teacher assessments) demonstrate that students are significantly behind their peers. Teachers will have access to the FAST Screening to Intervention (S2i) report to determine specific interventions based on the data from the fall, winter and spring Fast assessments. Rockford High School students will be identified through grades in 2nd semester and if they have failed a required class they need to graduate.

Measures of Success:

Fast Summer Universal Benchmark test will be administered at the end of each summer school session for K-8 students.

Reading Comprehension Activities - Fountas & Pinnell assessment, FAST assessments

Math Skill Assessment Activities - FAST progress monitoring, standards based assessment

RHS Student Measures of Success will be seen in number of successfully completed credits in required courses.

Estimated Number of Students:

| Grade | REAMS Recommendations | Maple Hills Recommendations | Estimated FTE - 15:1 ratio (approximate) |
|---------------|---------------------------|-----------------------------|--|
| K | 24 | 7 | 2 |
| 1 | 25 | 9 | 2 |
| 2 | 35 | 8 | 3 |
| 3 | 20 | 1 | 1 |
| 4 | 34 | 3 | 3 |
| Totals | 138 | 28 | 11 |
| Grade | RMS - CES Recommendations | Maple Hills Recommendation | Estimated FTE - 24:1 ratio (approximate) |
| 5 | 21 | 3 | 1.5 |
| 6 | 26 | 13 | 1.5 |
| 7 | 25 | 5 | 1.5 |
| 8 | 26 | 2 | 1.5 |
| Totals | 98 | 23 | 6 |

RHS is NOT able to access Targeted Services

| Grade | RHS Recommendations as of 4.15.21 | Estimated FTE - 24:1 ratio (approximate) |
|-------|-----------------------------------|--|
| 9 | 20 | 1.0 |
| 10 | 14 | |
| 11 | 19 | 1.0 |
| 12 | 3 | |

| | | |
|---------------|-----------|------------|
| Totals | 56 | 2.0 |
|---------------|-----------|------------|

Proposed Dates of Program: (direct student contact time)

Session #1:

- June 14, 2021 through June 24, 2021
- 3 hours per day (8:30 - 11:30 am)
- 8 Contact Days (M-Th, 2 weeks)
- 24 hours total instructional time
- Locations: Rockford Middle School-Center for Environmental Science (RMS-CES) and Rockford High School (RHS)

Session #2:

- July 12, 2021 through August 5, 2021
- 3 hours per day (8:30 - 11:30 am)
- 16 Contact Days (M-Th, 4 weeks)
- 48 hours total instructional time
- Locations: Rockford Elementary Arts Magnet School (REAMS), Rockford Middle School-Center for Environmental Science (RMS-CES), and Rockford High School (RHS)

Session #3:

- July 23, 2021 through August 19, 2021
- 3 hours per day (8:30 - 11:30 am)
- 16 Contact Days (M-Th, 4 weeks)
- 48 hours total instructional time
- Location: Maple Hill Estates Hope Center

Contact Person:

Matthew Scheidler, POSA - Student Services
 763-477-5837 x 1006
 scheidlerm@rockford.k12.mn.us

Staffing - To be determined based on student registration data

Session #1 Program Expenditures RMS-CES and RHS:

STAFF:

- Teachers paid at hourly contract rate (different for each teacher), average is \$39/hour
- Teachers paid prep (10 minutes prep per 50 minutes of instruction) Total teacher wages
- Teachers paid benefits (TRA, FICA) at 15.78% of hourly contract rate
- Nurses paid at hourly contract rate, average is \$45/hour
- Secretaries paid at hourly rate, average is \$20/hour
- Snacks (\$150)
- Materials (\$200)
- Acellus Licenses (\$100/student)

Session #2 and #3 Program Expenditures REAMS, RMS-CES, and RHS:

STAFF:

- Teachers paid at hourly contract rate (different for each staff member), Average is \$39/hr
- Teachers paid prep (10 minutes prep per 50 minutes of instruction)
- Teachers paid benefits (TRA, FICA) at 15.78% of hourly contract rate
- Nurses paid at hourly contract rate, average is \$45/hour
- Secretaries paid at hourly rate, average is \$20/hour
- Snacks (\$450)
- Materials (\$400)
- Acellus Licenses (\$100/student)

Program Revenue

-Revenue-Targeted Services

- K-6 = \$4.92/hour of attendance
- 7-8 = \$5.41/hour of attendance

-Revenue from CARES Summer School funding

- K-12 = \$4.00/hour of attendance



**ROCKFORD AREA SCHOOLS
INDEPENDENT SCHOOL DISTRICT 883
BOARD OF EDUCATION**

Subject: RMS-CES Principal's Report

Meeting Date: Monday, April 19, 2021

Prepared by: Bobbi Anderson-Hume, Ph.D.

Date Prepared: April 8, 2021

Information Briefing Action Enclosure Item(s)

Information:

Upcoming events

Update on Middle School Goals

- Power Standards
- Assessment (push to performance-based in Distance Learning)
- Standards-based Grading
- STEM Environmental Powerhouse (e.g. enrollment)
 - Outdoor Classrooms
 - Greenhouse
 - MDE School Forest
 - Makerspace
 - Crop Crates



**ROCKFORD AREA SCHOOLS
INDEPENDENT SCHOOL DISTRICT 883
BOARD OF EDUCATION**





**ROCKFORD AREA SCHOOLS
INDEPENDENT SCHOOL DISTRICT 883
BOARD OF EDUCATION**





**ROCKFORD AREA SCHOOLS
INDEPENDENT SCHOOL DISTRICT 883
BOARD OF EDUCATION**

Subject:

Meeting Date: April 19th, 2021

Prepared by: Melissa Joseph

Date Prepared: 4/12/2021

Information Briefing Action Enclosure Item(s)

Community Education Update:

- A. Class offerings returning to normal number. New class this year RC Racing!
- B. Working on brochure design for summer class offerings to be online by May 3rd.
- C. Fall Community Expo! Save the Date- Oct. 30th. Working with Chamber of Commerce on details for a renewed, revamped, and rejuvenated Expo.
- D. Registration for Fall pre-school opened Feb. 1st and numbers are consistent with pre-covid numbers.
- E. Summer Galaxy Registration is open and numbers are normal for early registrations. Deadline is May 15th and we will have a better idea of comparison to pre-covid numbers.
- F. Rentals are slowly starting to rise again. We have several entities already using our facilities this spring.



**ROCKFORD AREA SCHOOLS
INDEPENDENT SCHOOL DISTRICT 883
BOARD OF EDUCATION**

Subject: Buildings and Grounds

Meeting Date: 4/19/2021

Prepared by: James Leuer

Date Prepared: 4/14/2021

Information

Briefing

Action

Enclosure Item(s)

Buildings and Grounds update

- A. Bright School / LED upgrades
- B. Creating and 1,3,5,10 year plan for facilities
- C. COVID / Flooring replacement ES
- D. Short Staff (2)
- E. Been gearing up for spring sports the past few weeks
- F. Safety Committee
- G. Facility Committee



**ROCKFORD AREA SCHOOLS
INDEPENDENT SCHOOL DISTRICT 883
BOARD OF EDUCATION**

Subject: Staff Recognition Program

Meeting Date: April 19, 2021

Prepared by: Superintendent's Office

Date Prepared: April 8, 2021

Information

Briefing

Action

Enclosure Item(s)

**Rockford Area Schools
Independent School District 883
Staff Recognition Program**

It is the intent of the Rockford Area Schools, ISD 883 to recognize district employees in the following manner:

RETIREMENTS: (Employees who have retired in the past school year)

| | |
|------------------------|----------------------|
| Teachers/Support Staff | engraved glass apple |
| Administration | crystal globe |
| Board Members | brass bell |

(all at a nominal cost per state statute)

YEARS OF SERVICE:

(Actual Years Worked-hire date less any unpaid leaves)

| | |
|----------|--------------------|
| 5 years | certificate |
| 10 years | certificate |
| 15 years | certificate |
| 20 years | framed certificate |
| 25 years | framed certificate |
| 30 years | framed certificate |

If approved annually by the Rockford Education Foundation or alternate donor,

| | |
|----------|---------------------------|
| 20 years | gift certificate for \$40 |
| 25 years | gift certificate for \$45 |
| 30 years | gift certificate for \$50 |

SCHOOL BOARD STAR AWARDS:

For those who went above and beyond to benefit the students in our school district. Nominations are completed by staff and are due at a date determined annually by the Board with a Board committee finalizing the award winners. Plaques are given to individual finalists or group.



**ROCKFORD AREA SCHOOLS
INDEPENDENT SCHOOL DISTRICT 883
BOARD OF EDUCATION**

RECOGNITION THROUGH RESOURCE TRAINING AND SOLUTIONS

Leaders in Educational Excellence Award—Annual. The District will cover the cost, provided by Resource, of the following:

Banquet and Plaque Up to 3 honorees
Banquet Each Honoree’s guest and supervisor (up to 3 total supervisors)

Educational Support Staff Award—Annual. The District will cover the cost, provided through Resource, of the following:

Banquet and Plaque Up to 4 honorees
Banquet Each Honoree’s guest and supervisor (up to 4 total supervisors)

Timeline:

- Presentation to the DAT team - 4/21
- Nominations forms going out- Superintendent Memo on 4/23
- Deadline to submit nominations - May 2nd at 11:59 pm
- Selection Committee meeting - May 6th
- Recognition - 6/07 during the end of the year celebration



ROCKFORD AREA SCHOOLS

INDEPENDENT SCHOOL DISTRICT 883
BOARD OF EDUCATION

Subject: Proposal of In-Person School Board Meetings for May and June

Meeting Date: April 19, 2021

Prepared by: Superintendent's Office

Date Prepared: April 14, 2021

Information

Briefing

Action

Enclosure Item(s)

In-person School Board Meeting Proposal for May and June 2021

LOCATION:

RCC rooms 804, 805, and 806.

SOUND SYSTEM:

The recommendation from our Technology Director Jeff Kienitz is to move the sound system from the Heritage room to the RCC rooms, and the technology department will set it up for the meetings.

CAPACITY:

In the three RCC rooms, there is enough capacity for twelve people (Directors presenting, Superintendent, Executive Assistant, Board Members) plus 18-24 members of the public. In the event of more than 24 members of the public attending, the Board members will be moved to the Heritage Room at the high school and there will be a zoom meeting projected in the RCC rooms for the public.

SAFETY

The RCC rooms are right at the entrance of the Community Center, and the public will not have the opportunity to get through the building. It is a convenient space because the rooms are right at the entrance.

The following drawing shows the setup for the meetings:

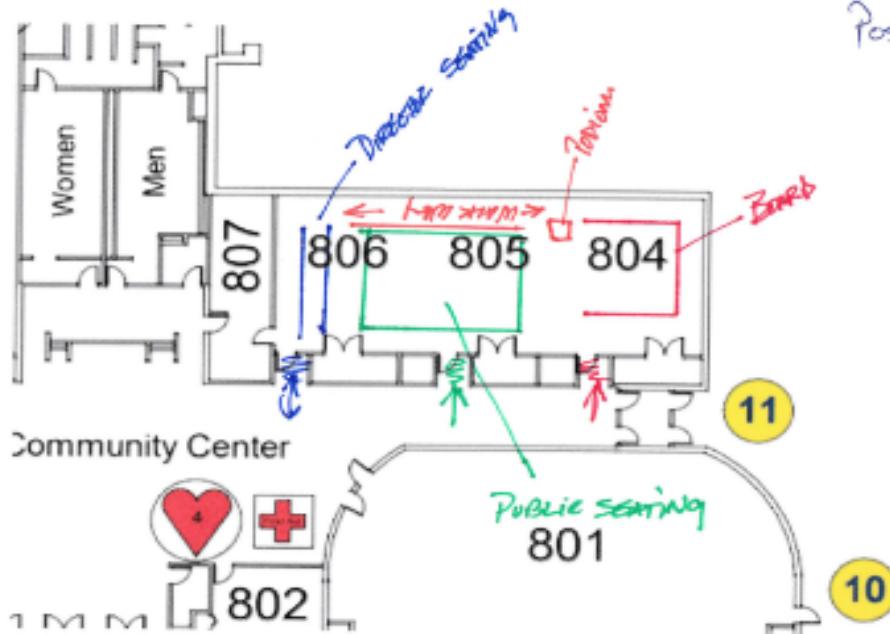

Board meetings
Possibly 18-24
Public Seating

Board entry -
Seating Red
Public entry
Seating Green
Director Seating
Entry
Blue.

change 6'
walkway -