



**Tecton**  
ARCHITECTS

# FF&E REVIEW FINAL SELECTIONS

NECK RIVER ELEMENTARY (PK-5)

11.05.2024

BOARD OF EDUCATION PREVIEW MEETING

## PROJECT SCHEDULE

**Town of Madison**  
New Elementary School

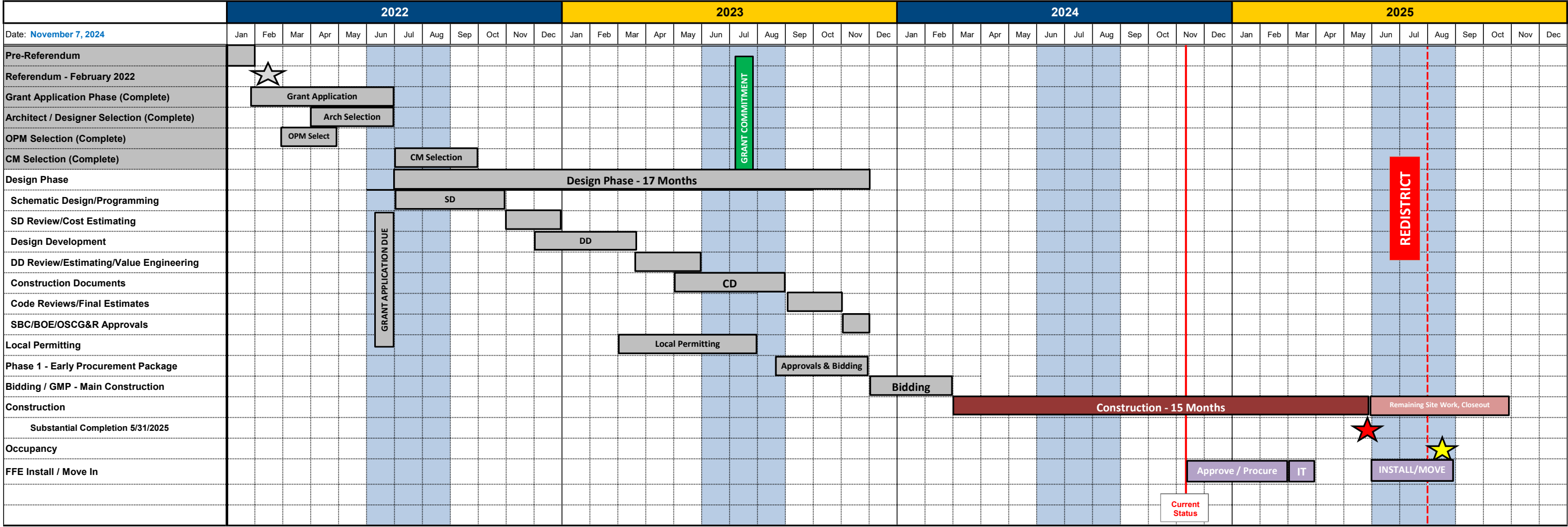

Town of Madison  
New Elementary School

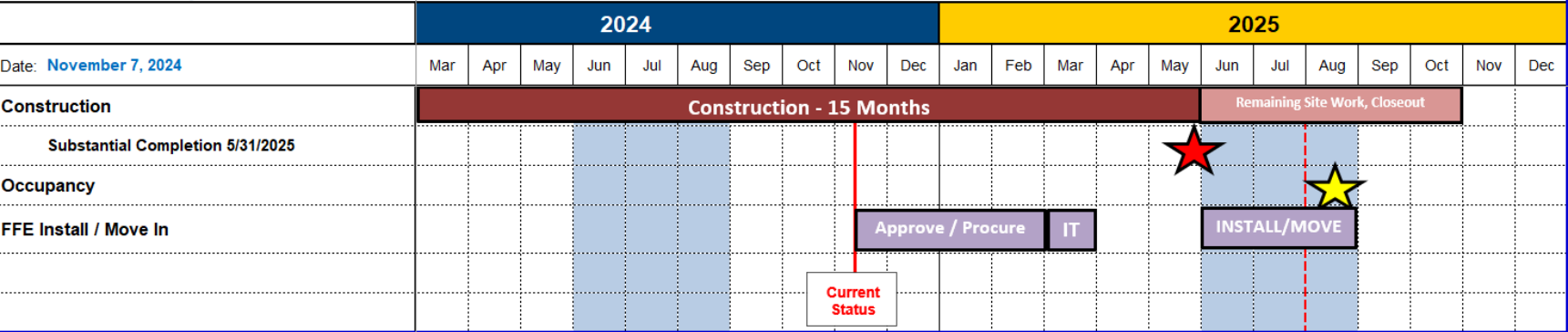

PRE-K & K  
DUNES



SPECIALS  
SHORE



GRADES  
1&2  
GREENWAY



GRADES  
3, 4 & 5  
WATER

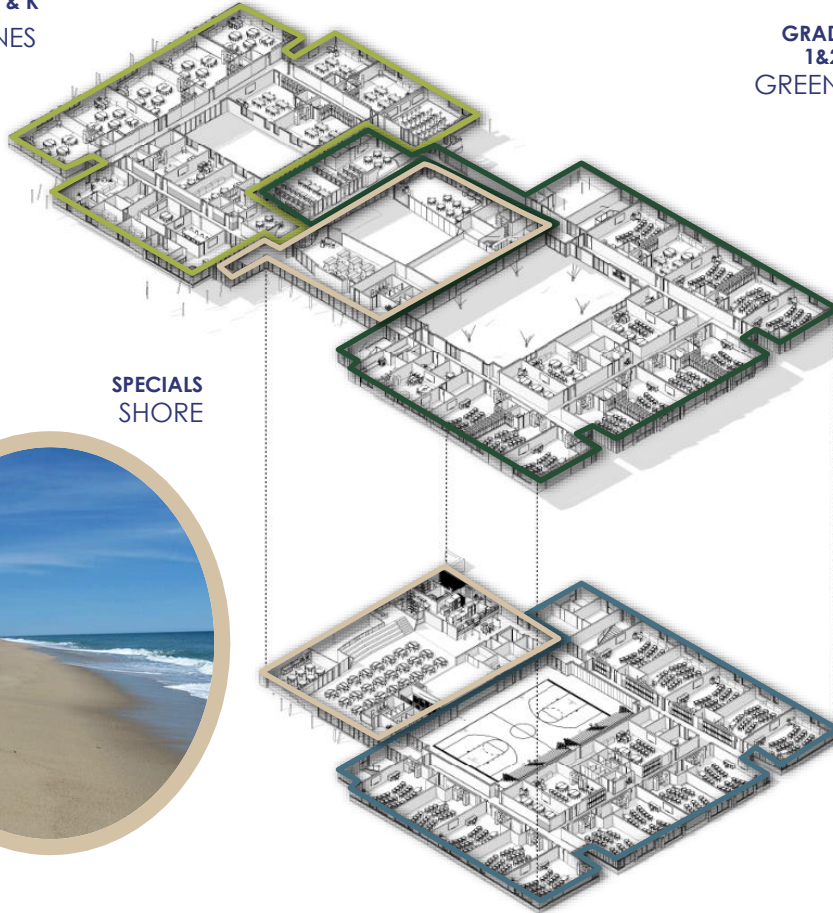



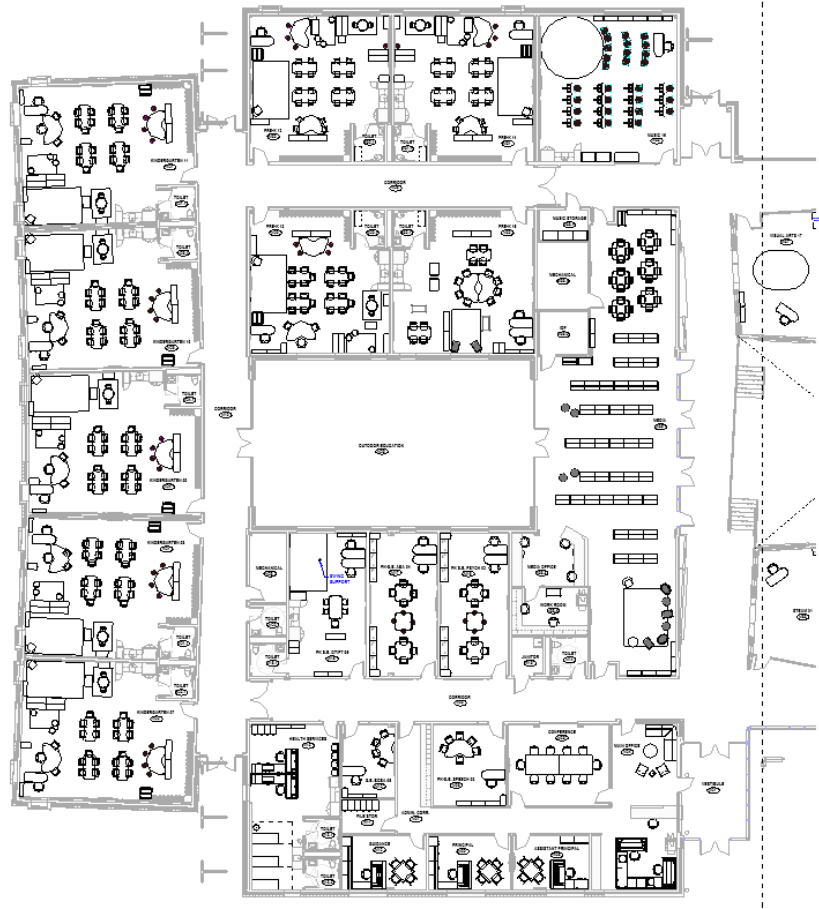

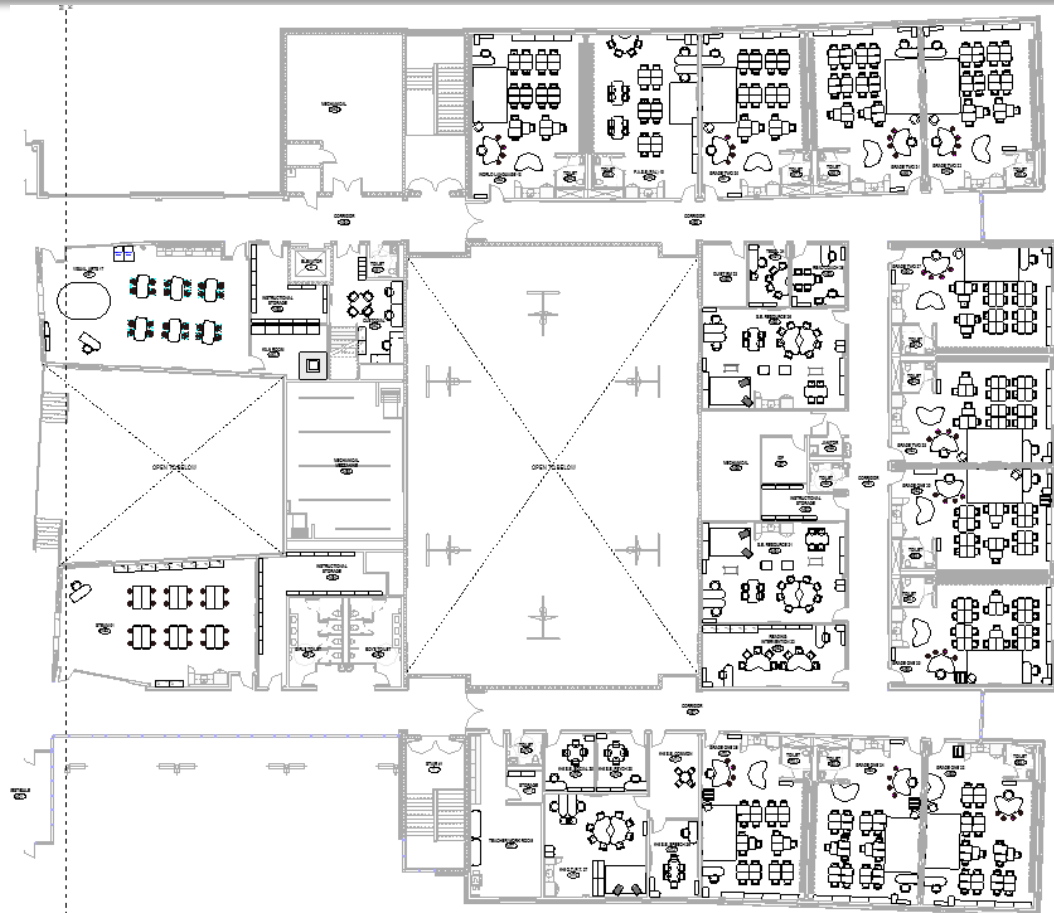

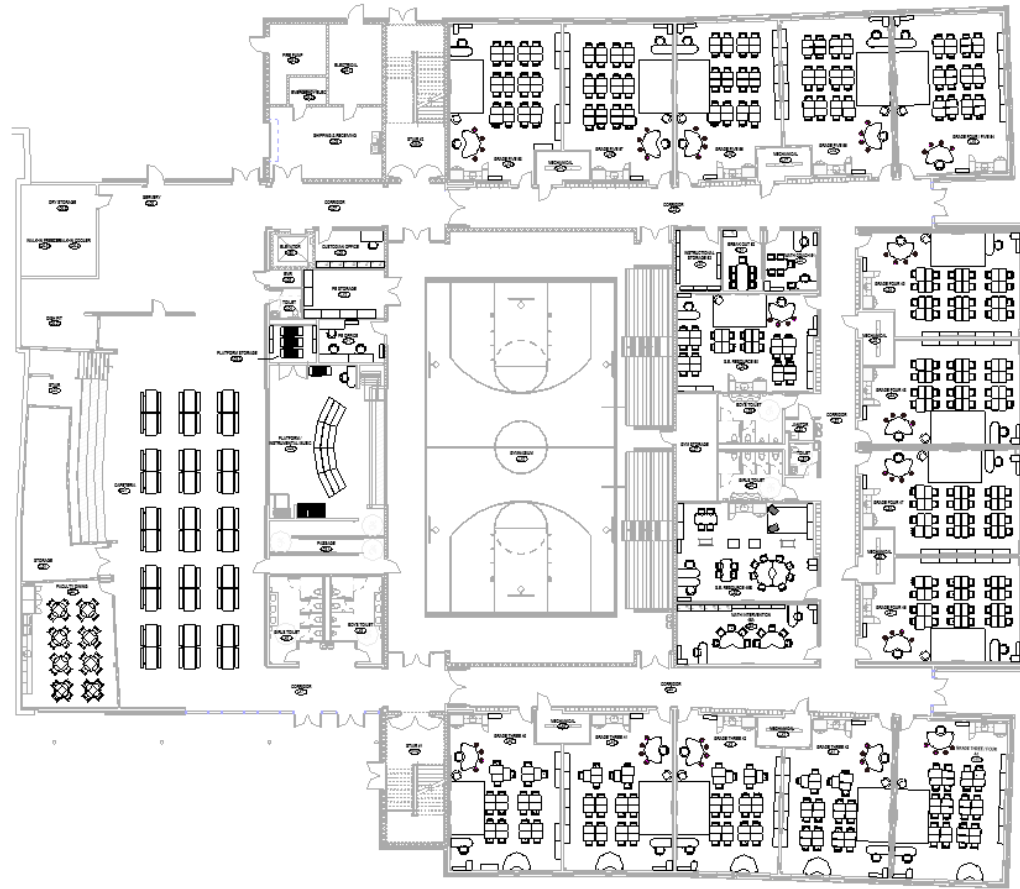

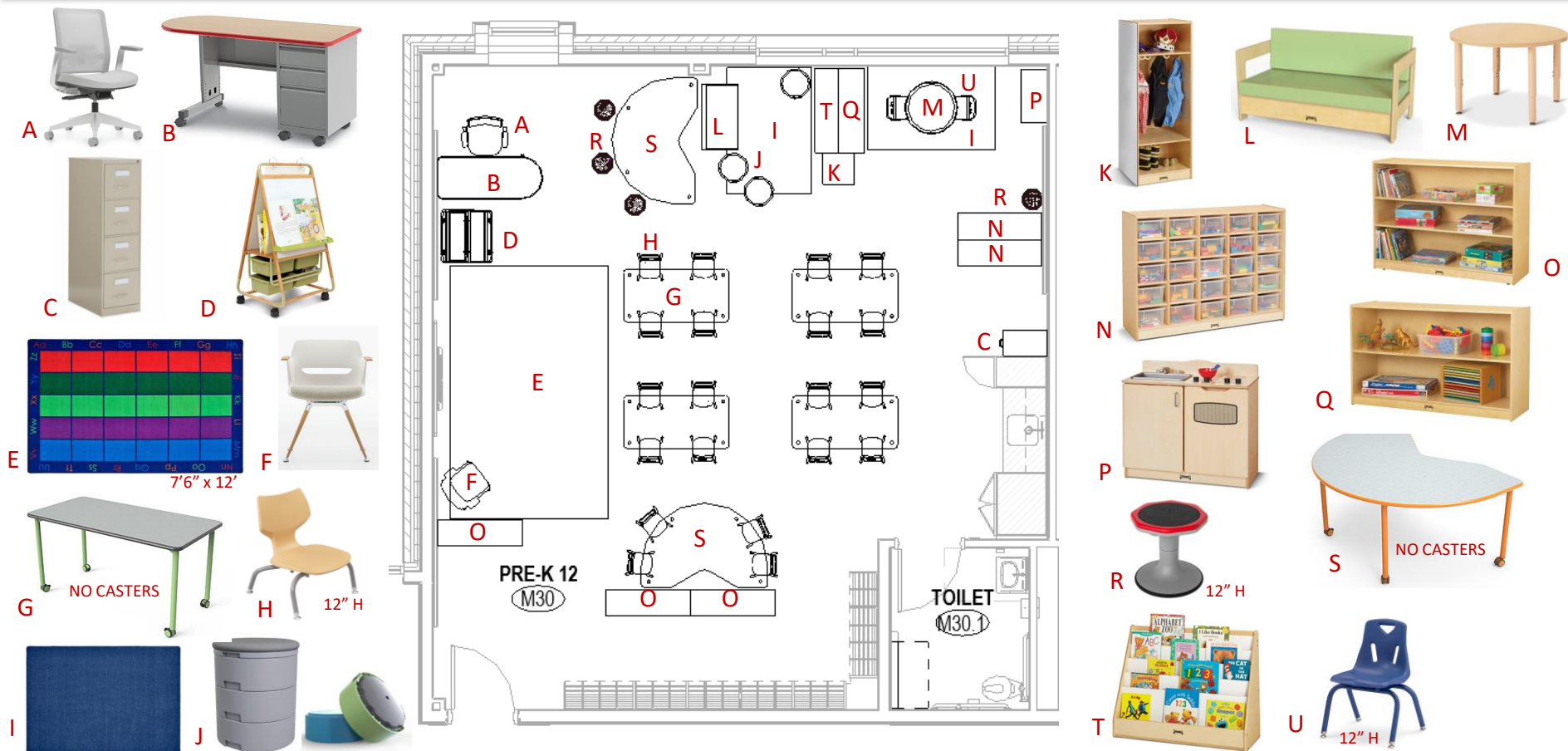

NOTE: ROOMS M29 & M32 FURNITURE LAYOUTS DIFFER PER DISCUSSION.

NECK RIVER ELEMENTARY SCHOOL (PK-5)

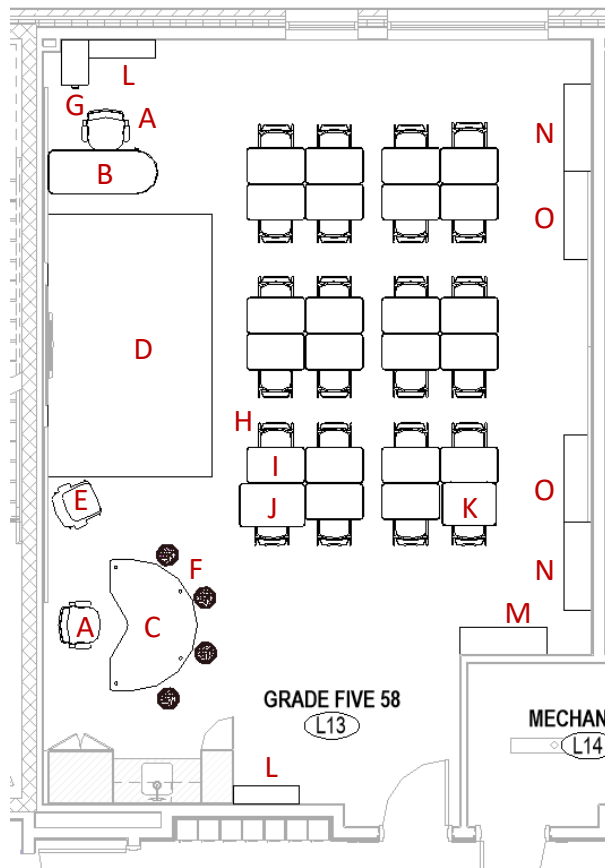



Sample notations from later working group session



APPROVED WITH CANTILEVER

NOTES:

- Cantilever base (left image) for K to 5<sup>th</sup> grade
- 4 Leg base (right images) for Pre-K **OK**
- Both chair types stack 4 high & are a stable sit on desk
- If preferred, we can have all chairs be the 4 legs

**DON'T WANT THIS**



Product Features

Model	Description	D x W x H
11877	14" Flavors Cantilever Chair	18" x 19" x 14"
11878	16" Flavors Cantilever Chair	18" x 19" x 16"
11879	18" Flavors Cantilever Chair	21" x 19" x 18"
F	Felt Glide Option (No upcharge)	

Product Features

Model	Description	D x W x H
11849	18" Flavors Stack Chair	20.5" x 19.5" x 18"
11848	16" Flavors Stack Chair	18" x 17.5" x 16"
11847	14" Flavors Stack Chair	17" x 17.5" x 14"
11846	12" Flavors Stack Chair	14.5" x 15" x 12"
11845	10" Flavors Stack Chair	13.5" x 15" x 10"
11844	8" Flavors Stack Chair	13.5" x 15" x 8"
S	Steel Glide Option	
F	Felt Glide Option	

AV / IT

Name	Number	Level
CAFETERIA	L01	LOWER LEVEL
STAIR	L02	LOWER LEVEL
PLATFORM / INSTRUMENTAL MUSIC	L03	LOWER LEVEL
PASSAGE	L03.1	LOWER LEVEL
PLATFORM STORAGE	L03.2	LOWER LEVEL
TOILET	L04	LOWER LEVEL
EMR	L05	LOWER LEVEL
SERVERY	L06	LOWER LEVEL
DISH PIT	L06.2	LOWER LEVEL
DRY STORAGE	L06.3	LOWER LEVEL
WALK-IN FREEZER	L06.4	LOWER LEVEL
WALK-IN COOLER	L06.5	LOWER LEVEL
CORRIDOR	L07	LOWER LEVEL
SHIPPING & RECEIVING	L08	LOWER LEVEL
ELECTRICAL	L08.1	LOWER LEVEL
EMERGENCY ELEC	L08.2	LOWER LEVEL
FIRE PUMP	L08.3	LOWER LEVEL
CUSTODIAN OFFICE	L09	LOWER LEVEL
GYMNASIUM	L10	LOWER LEVEL
PE OFFICE	L11	LOWER LEVEL
PE STORAGE	L12	LOWER LEVEL
GRADE FIVE 58	L13	LOWER LEVEL
MECHANICAL	L14	LOWER LEVEL
GRADE FIVE 57	L15	LOWER LEVEL
GRADE FIVE 56	L16	LOWER LEVEL
MECHANICAL	L17	LOWER LEVEL
GRADE FIVE 55	L18	LOWER LEVEL
GRADE FOUR / FIVE 54	L19	LOWER LEVEL
INSTRUCTIONAL STORAGE 53	L20	LOWER LEVEL
BREAK OUT 52	L21	LOWER LEVEL
MATH COACH 51	L22	LOWER LEVEL
CORRIDOR	L23	LOWER LEVEL
GRADE FOUR 49	L24	LOWER LEVEL

T-XX Promethean Board	T-XX Promethean Board Mount	T-XX Mitel Phone	T-XX Aruba WAP	T-XX Aruba Net. Switches
			2	
1	1	1	1	
		1		
			1	
		1		
			4	
		1		
1	1	1	1	
1	1	1	1	
1	1	1	1	
1	1	1	1	
1	1	1	1	
1	1	1		
1	1	1	1	

PLAYGROUND







# Sample Renderings



MADISON ELEMENTARY SCHOOL

MEO24836 • 10.28.2024



© 2024 Landscape Structures. All Rights Reserved



# Sample Renderings



MADISON ELEMENTARY SCHOOL

MEO24836 • 10.28.2024



© 2024 Landscape Structures. All Rights Reserved

# Sample Renderings



MADISON ELEMENTARY SCHOOL

MEO24836 • 10.28.2024



© 2024 Landscape Structures. All Rights Reserved

# Sample Renderings



MADISON ELEMENTARY SCHOOL

MEO24836 • 10.28.2024



© 2024 Landscape Structures. All Rights Reserved



# Sample Renderings



MADISON ELEMENTARY SCHOOL

MEO24836 • 10.28.2024



© 2024 Landscape Structures. All Rights Reserved

# Sample Renderings



MADISON ELEMENTARY SCHOOL

MEO24836 • 10.28.2024



© 2024 Landscape Structures. All Rights Reserved

TIMELINE

# Timeline: FFE/AV/IT Approvals

Approval of Scope/Drawings to Submit to State & Bid

-SBC & BOE: End of November / December

State Review (PCR meeting)

-December / January

Bidding / Contract Award

-SBC & BOS: January / February



**Tecton**  
ARCHITECTS

**Thank you!**



# Appendix - Full FFE Slides

## Current Design as of 11/5/24



**Tecton**  
ARCHITECTS

# CLASSROOMS

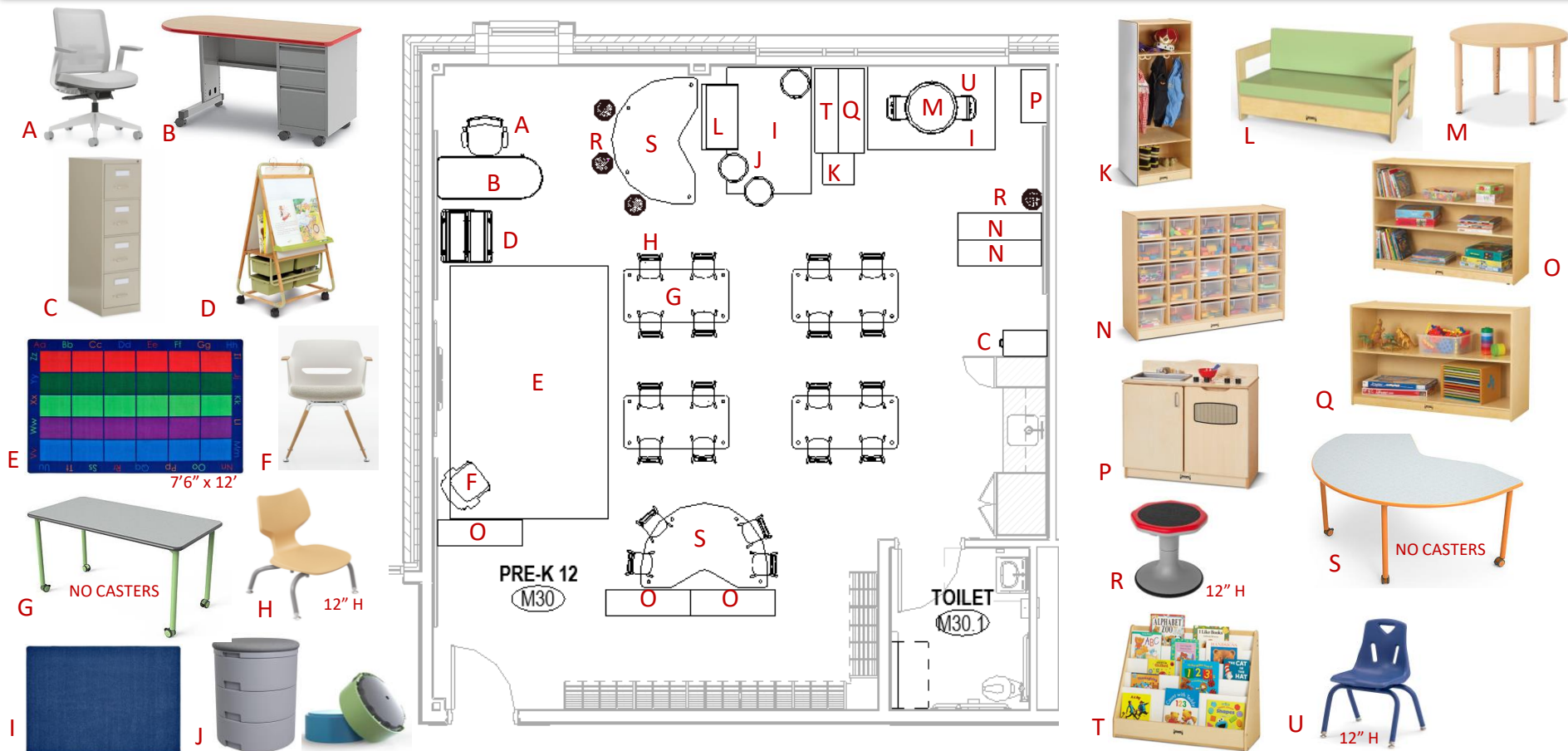

NOTE: ROOMS M29 & M32 FURNITURE LAYOUTS DIFFER PER DISCUSSION.

NECK RIVER ELEMENTARY SCHOOL (PK-5)

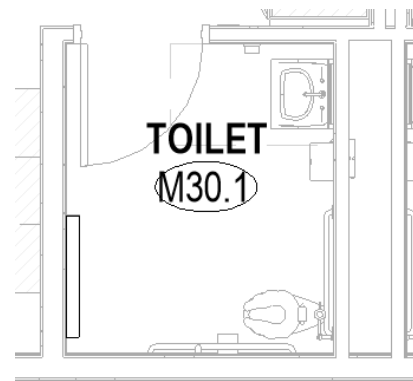
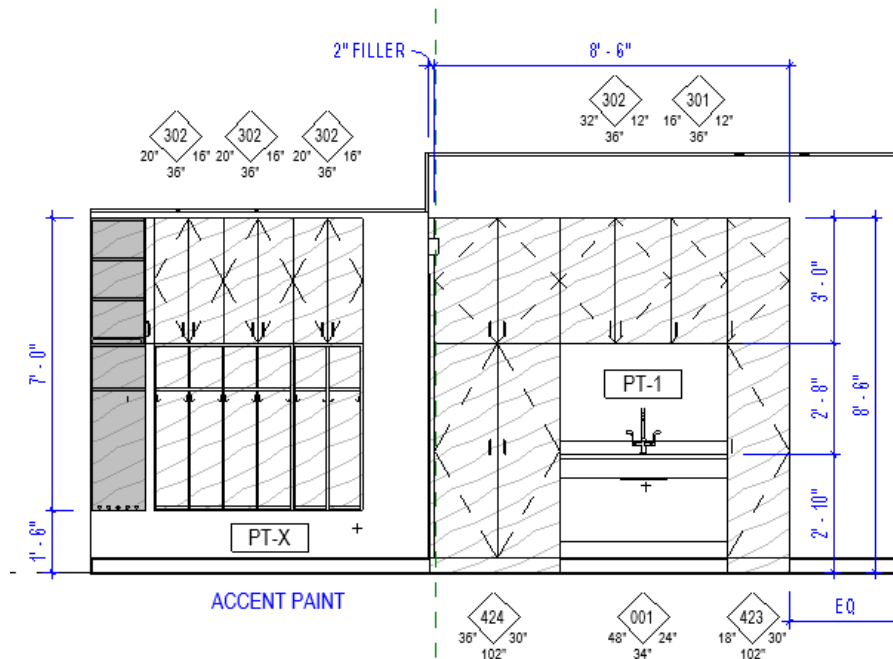

# KINDERGARTEN | PROPOSED LAYOUT

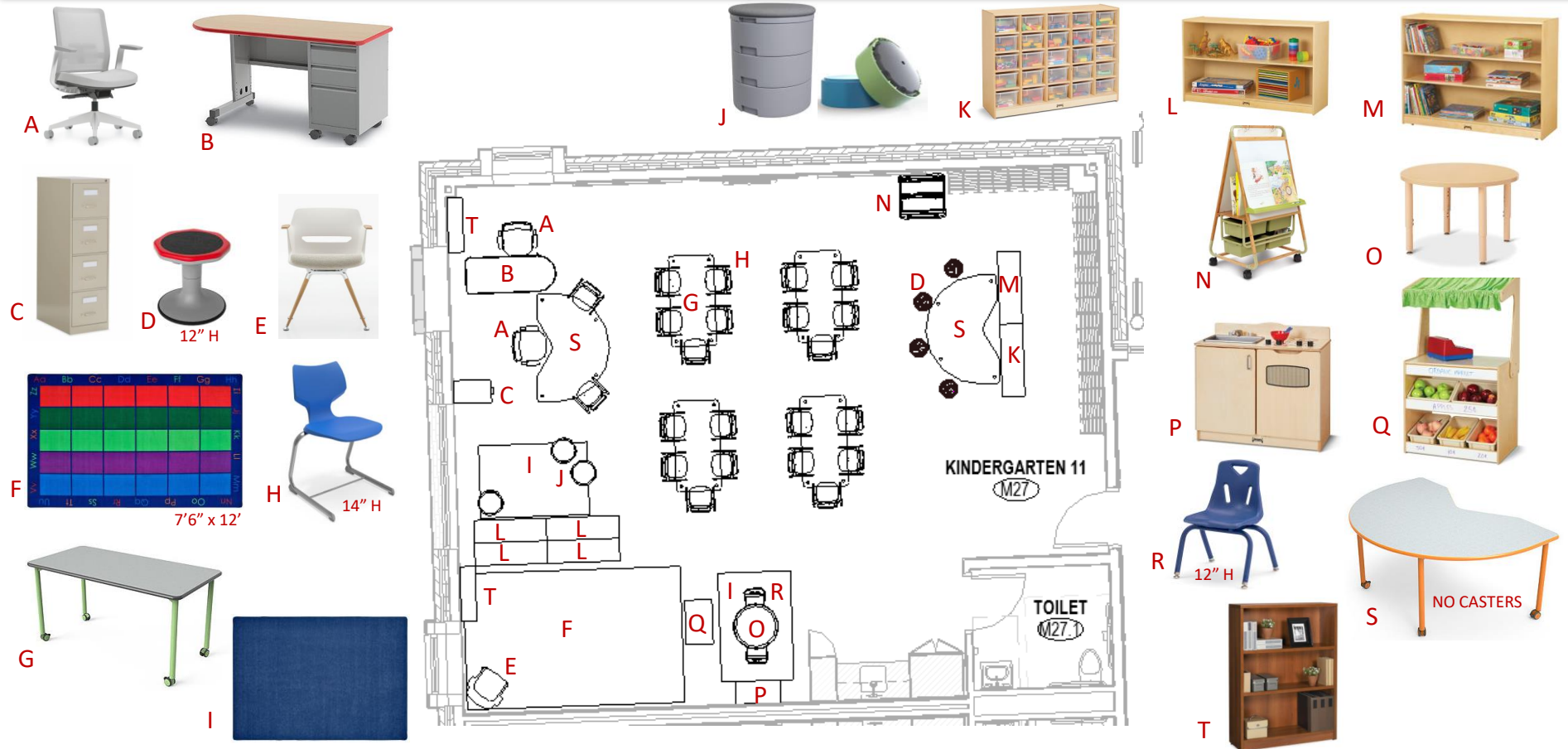

# GRADE 1 | PROPOSED LAYOUT

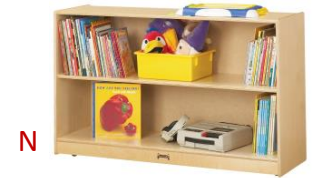
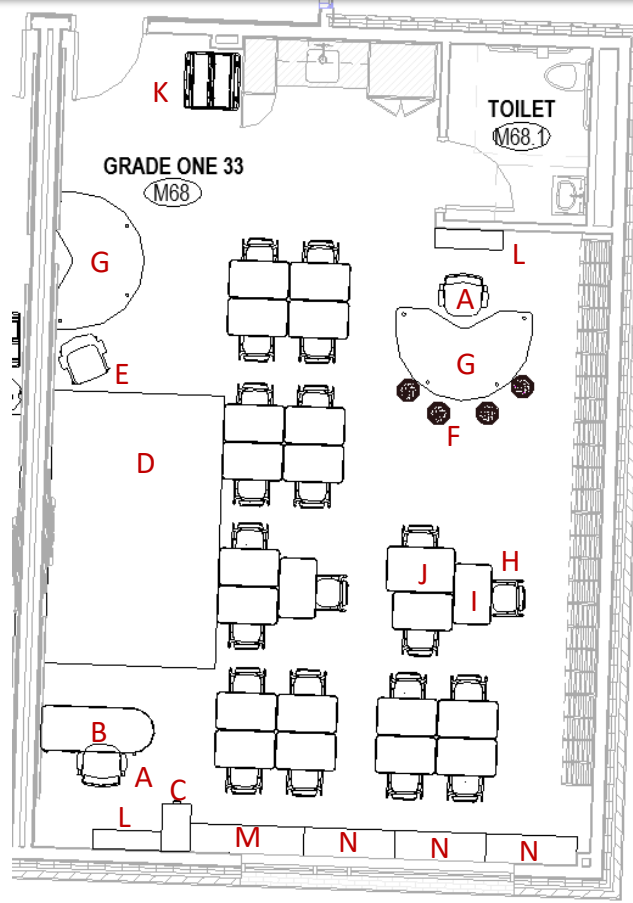
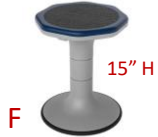
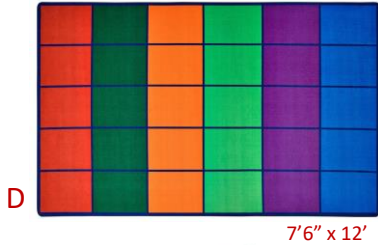



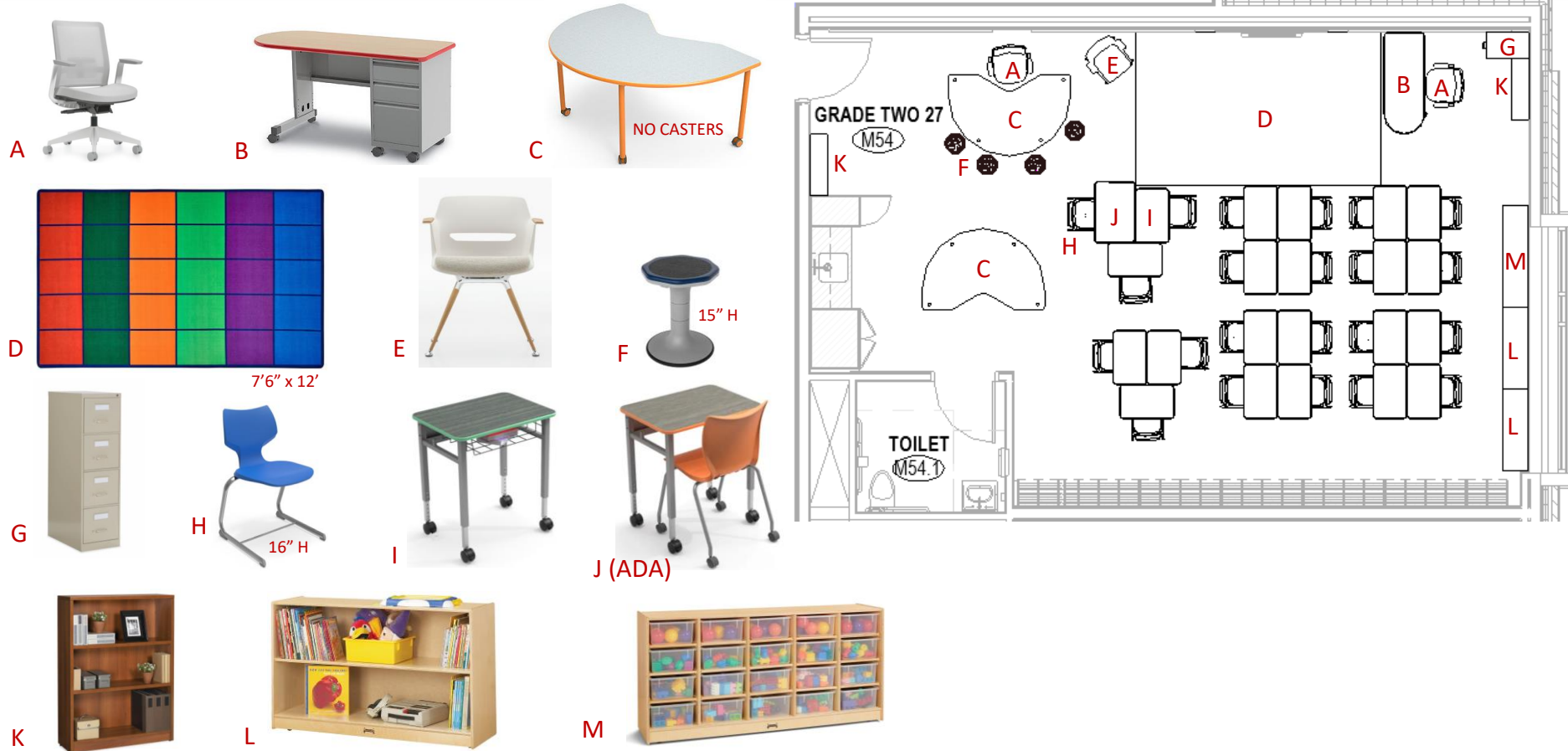

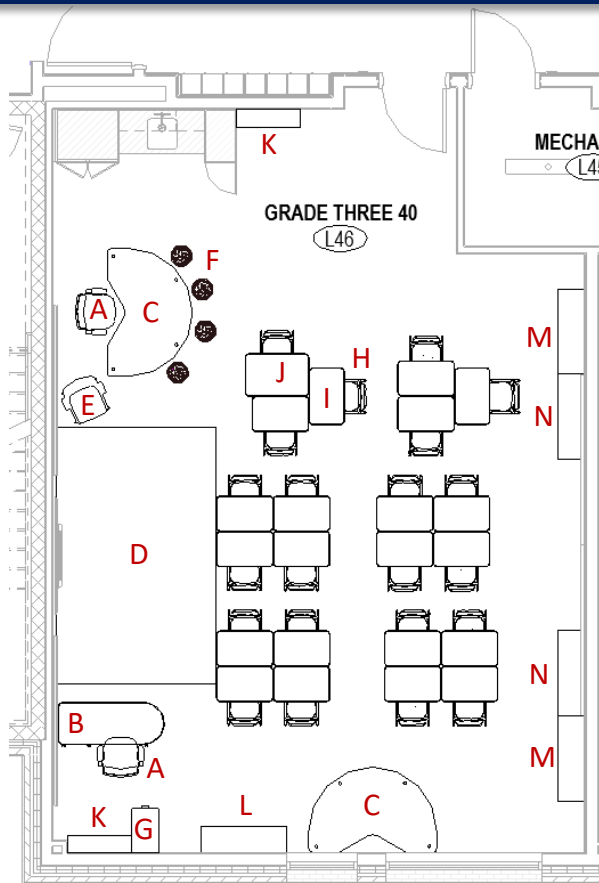

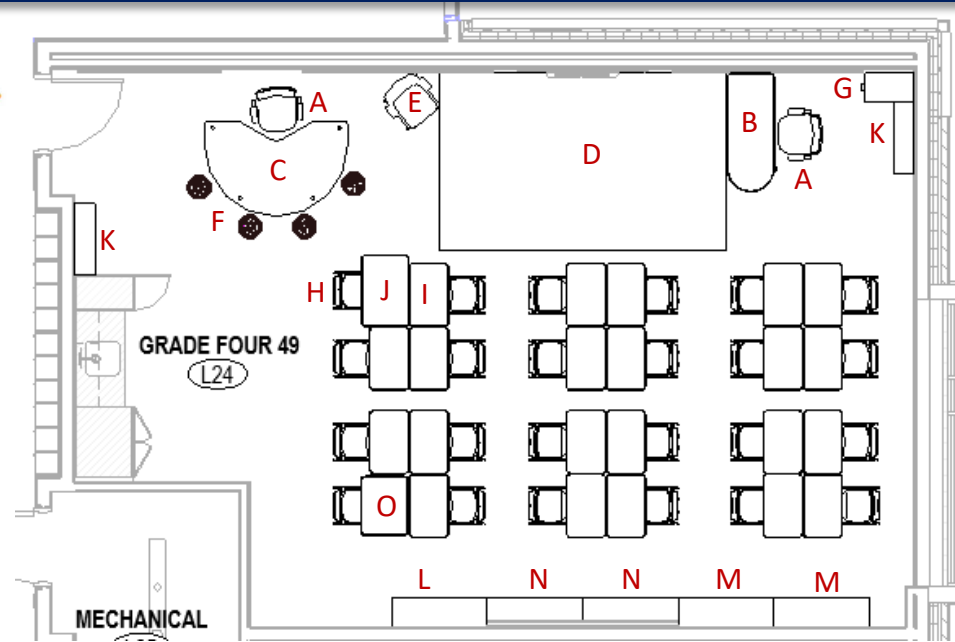

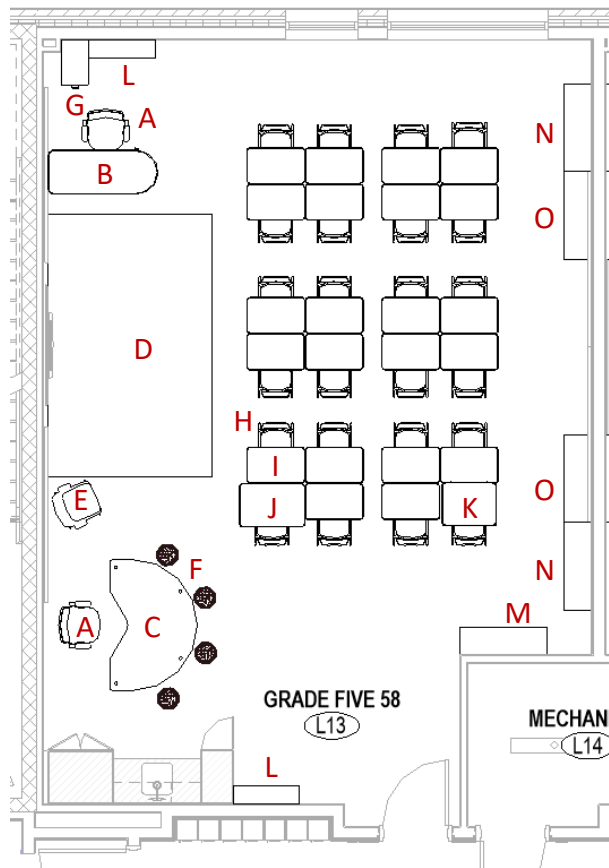



**Tecton**  
ARCHITECTS

# MEDIA & STEAM



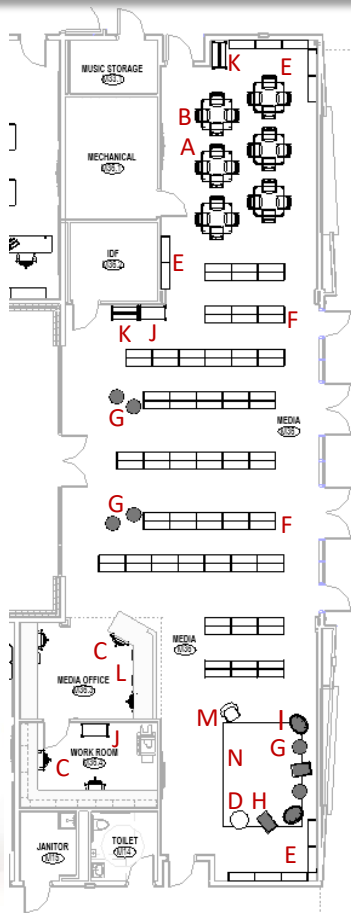



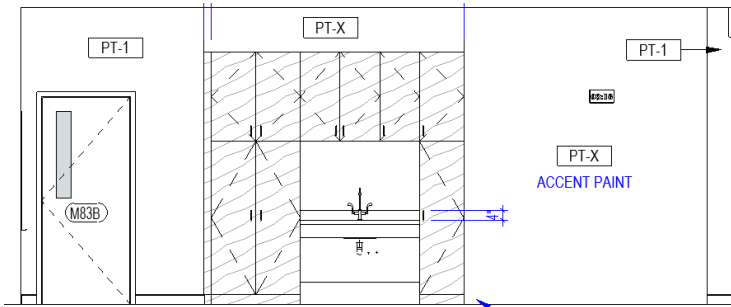
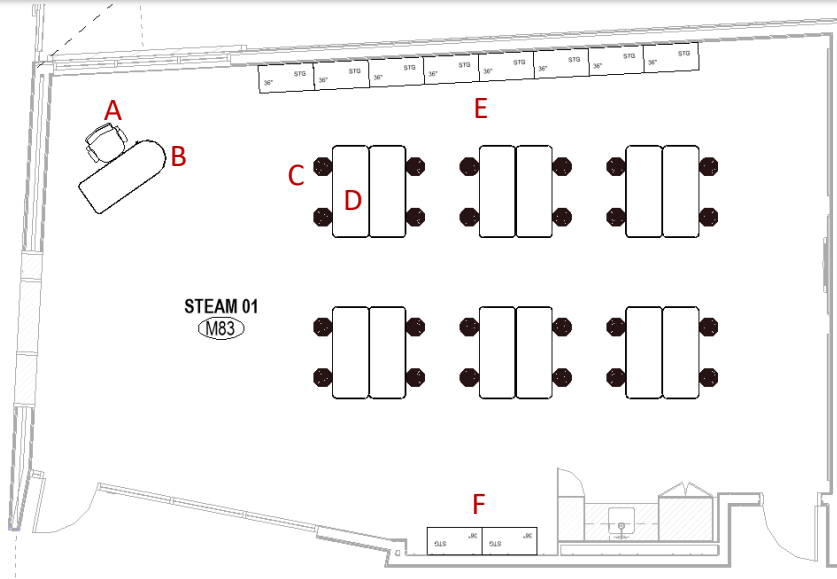



**Tecton**  
ARCHITECTS

# SPECIALTY & BACK OF HOUSE SPACES

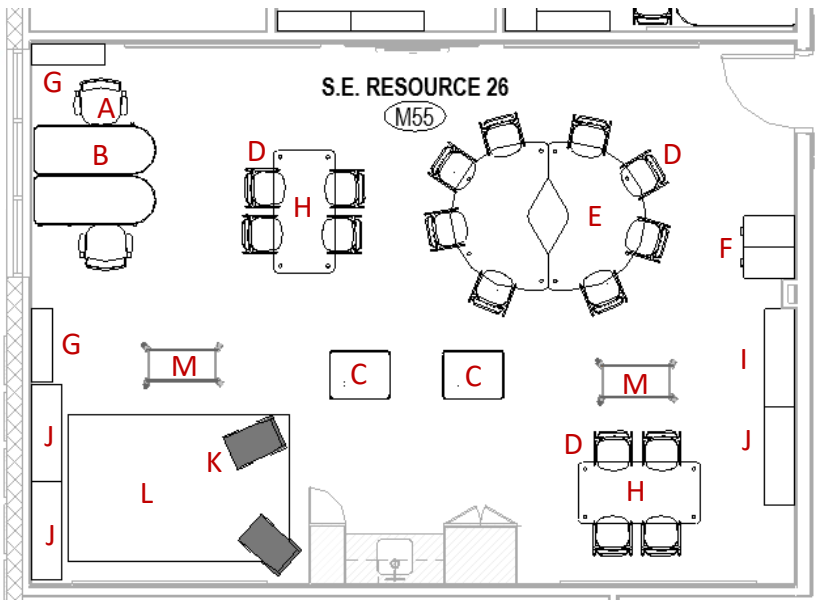

# VISUAL ARTS, KILN ROOM & INSTRUCTIONAL STORAGE | PROPOSED LAYOUT



A



B



C

NO CASTERS



D

18" H



E

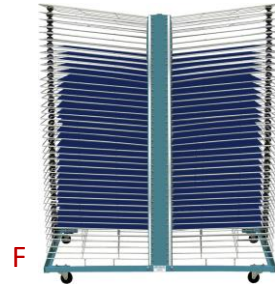

F

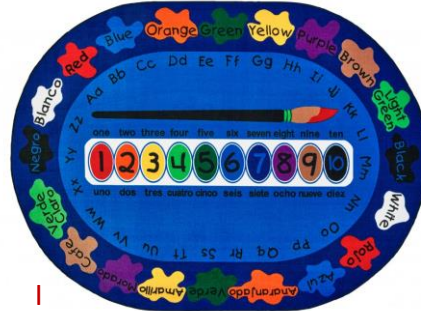

I

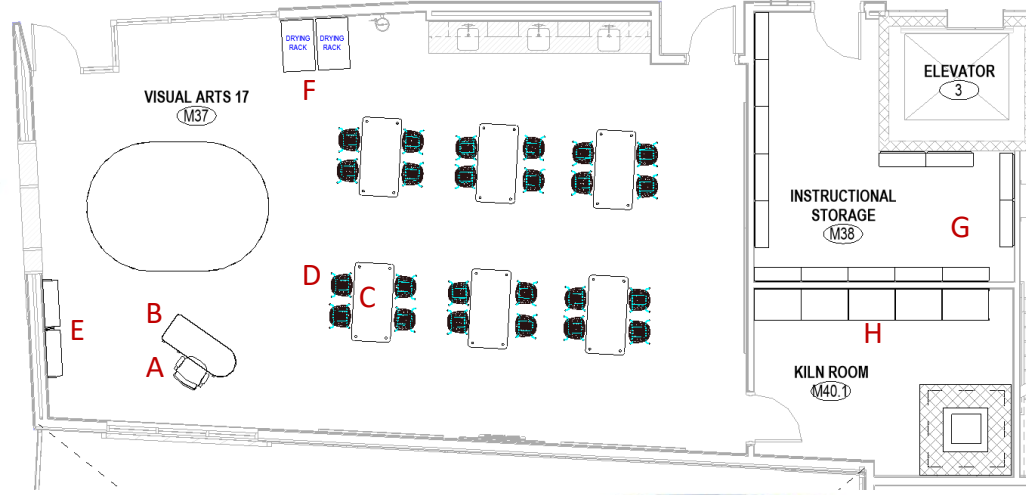

G



H

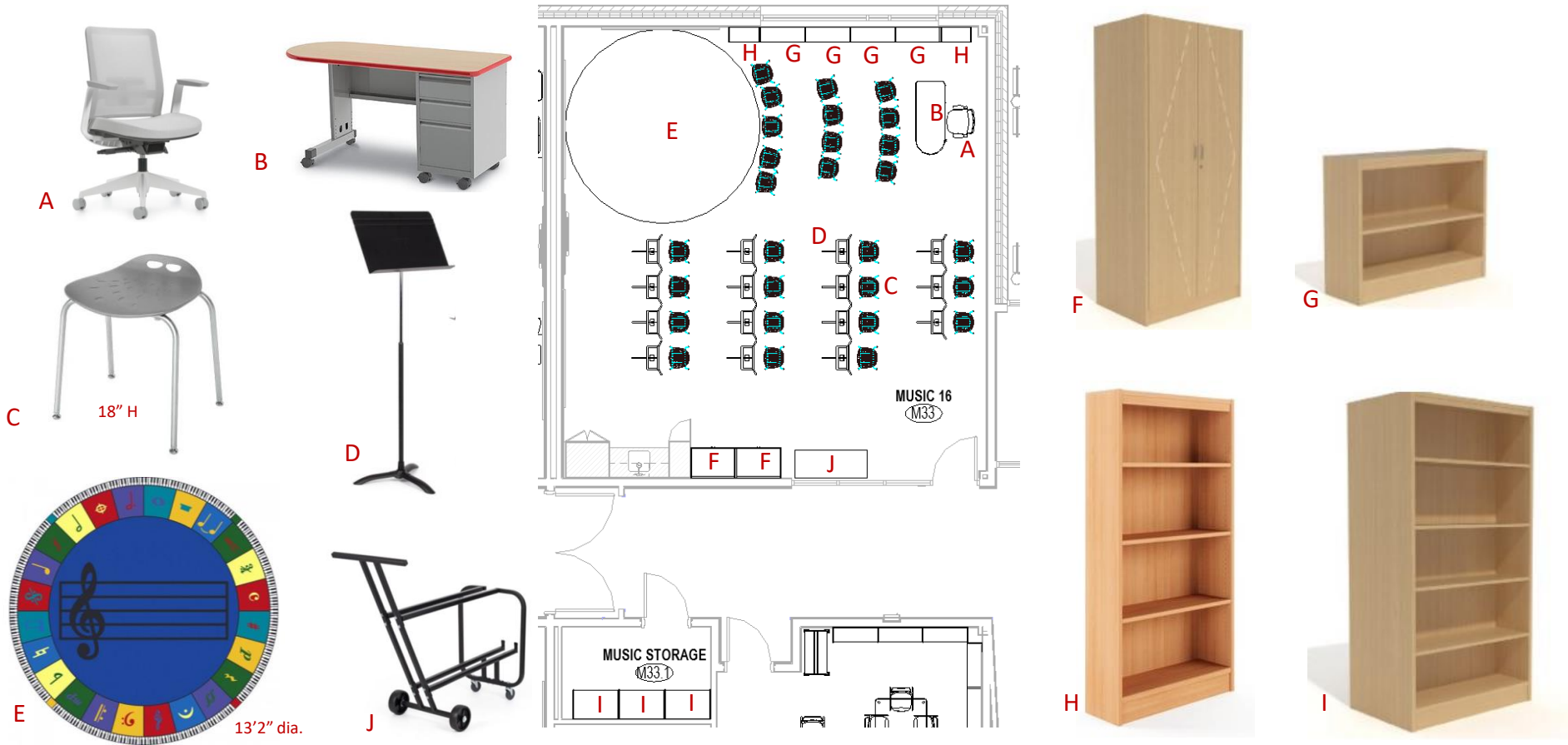

# INSTRUMENTAL MUSIC, PLATFORM STORAGE | PROPOSED LAYOUT

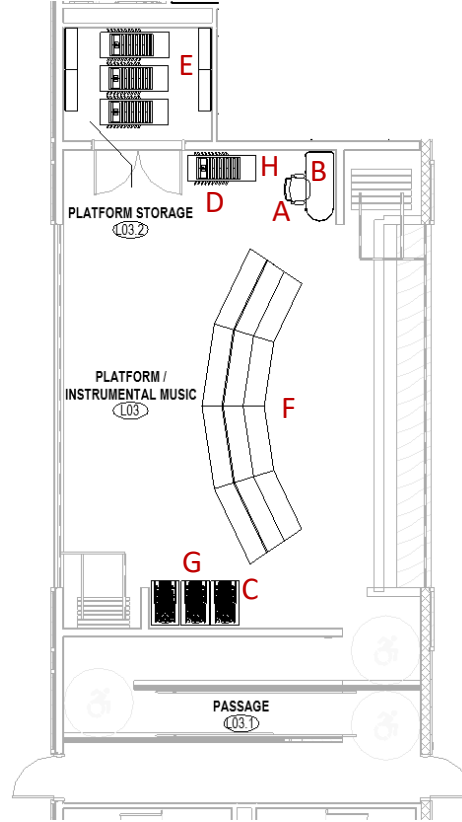





A

NOTE:

- Each table seats 10-14 seats per table
- Max of 210 available
- To accommodate ADA requirements  
5% of total seats need to be ADA accessible
- (10) tables will have (1) ADA space

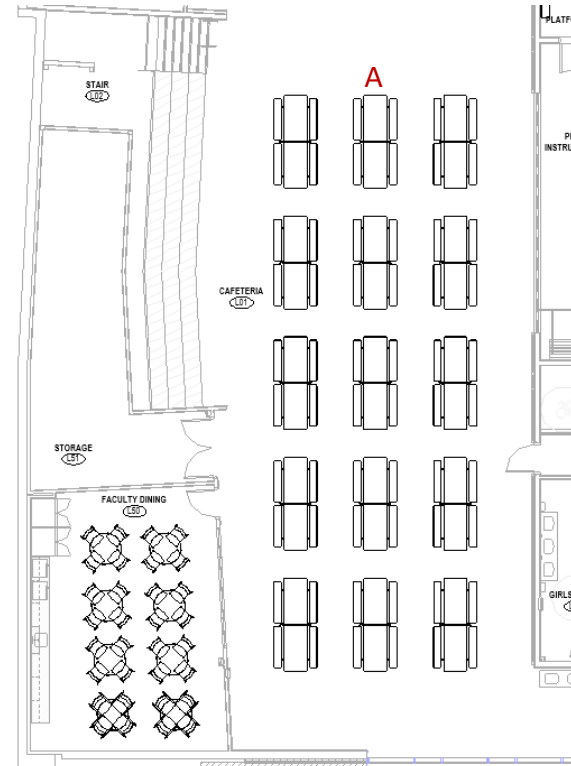

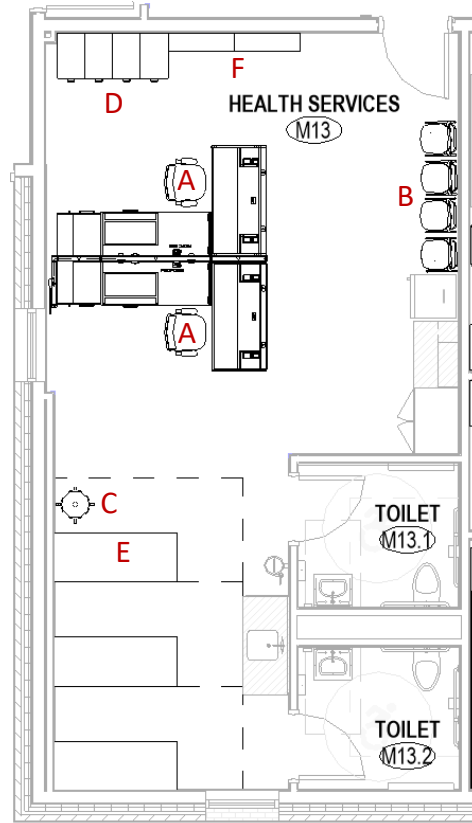
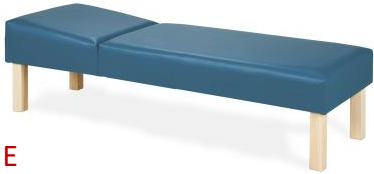

TACKABLE SURFACE

WARDROBE

OPEN SHELF

PEDESTAL (B/B/F)

LATERAL FILE

SIT-STAND  
DESK

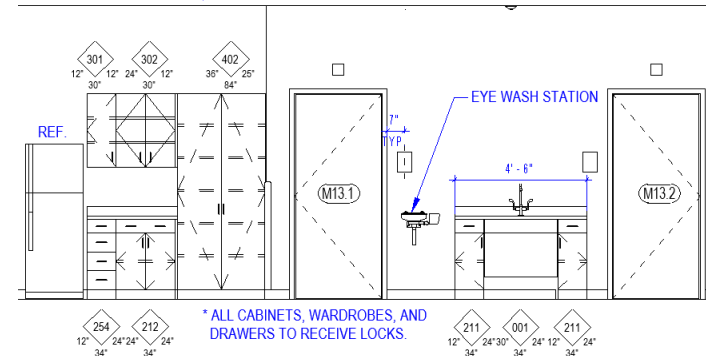
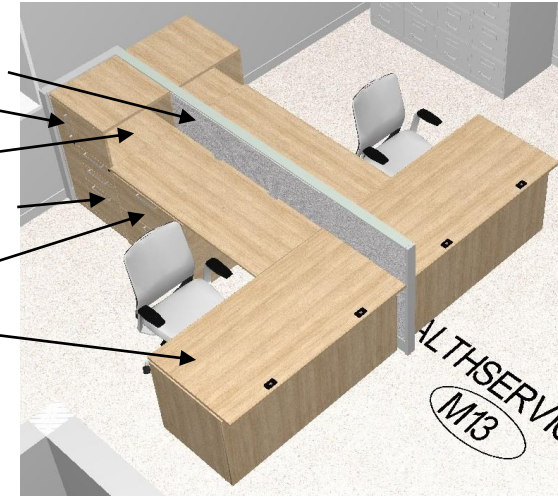

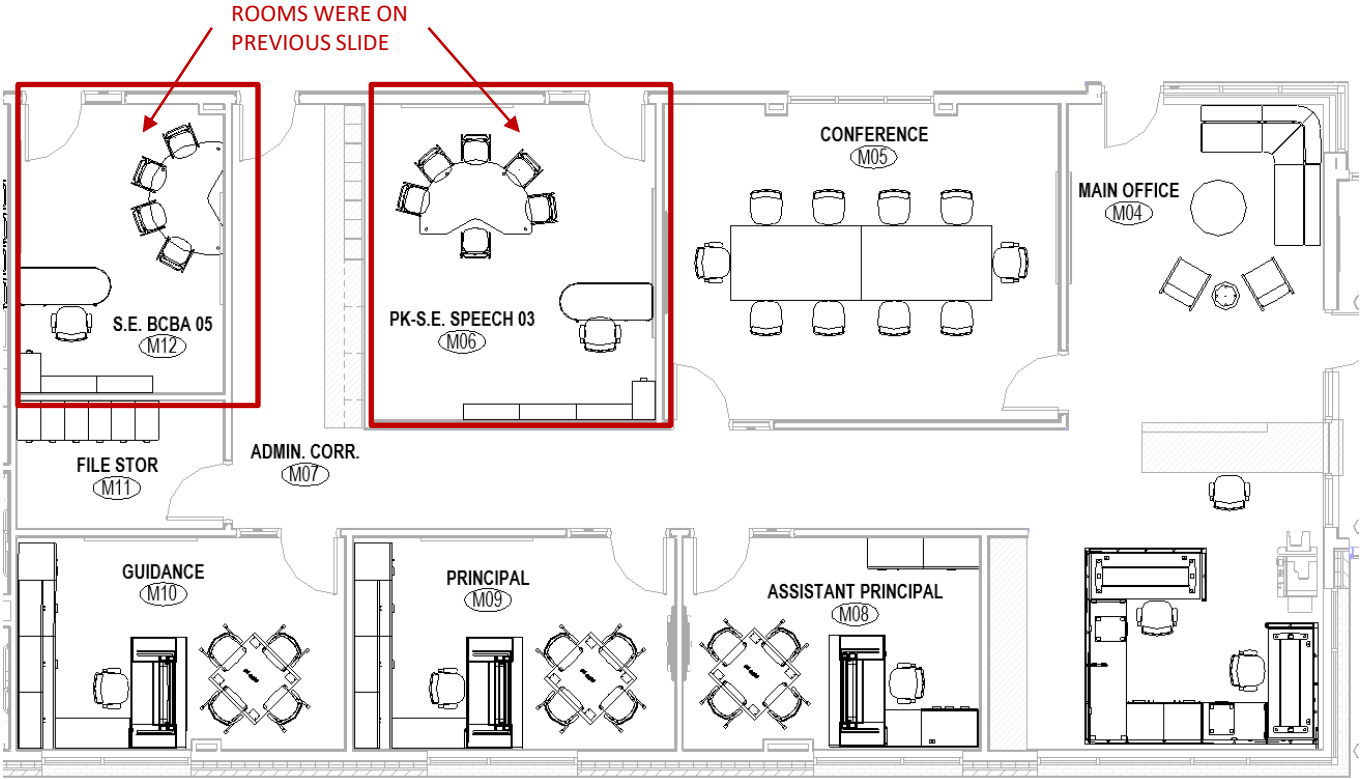

# MAIN OFFICE - RECEPTION | PROPOSED LAYOUT

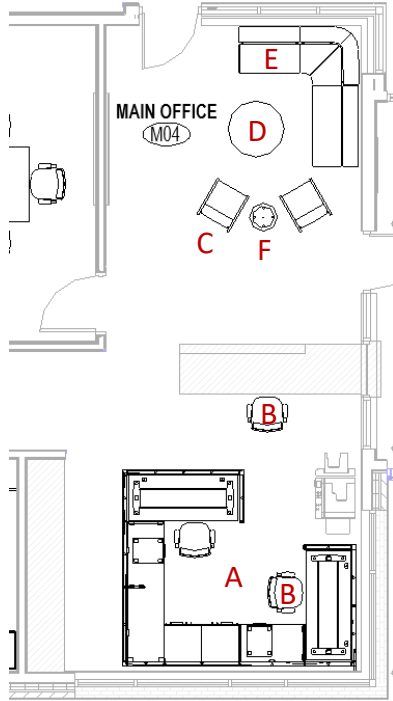

SIT-STAND DESK

MOBILE  
PEDESTAL (B/B/F)

WARDROBE

STORAGE CABINET  
WITH B/B/F

SIT-STAND DESK

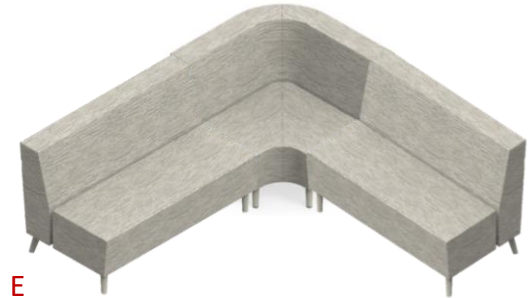
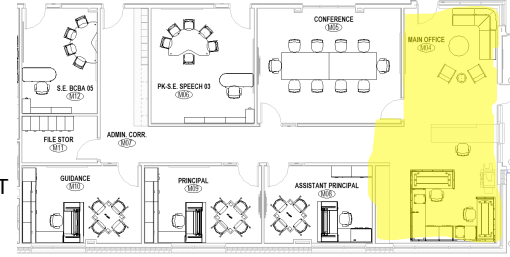

E



B



C



D



F

NOTE: IMAGES ARE FOR REFERENCE ONLY.

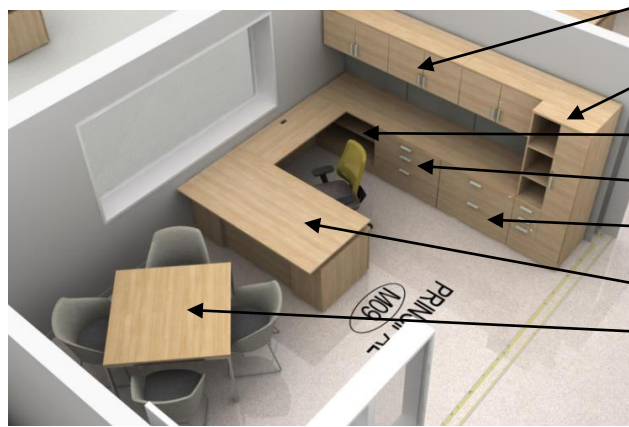
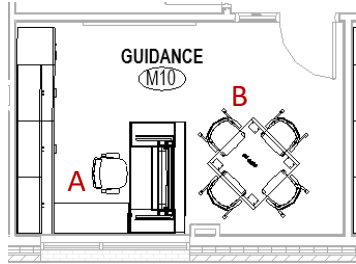

OVERHEAD STORAGE

BOOKSHELF,  
B/B/F,  
WARDROBE

BOOKSHELF

PEDESTAL (B/B/F)

LATERAL FILE

SIT-STAND DESK WITH BOX/BOX/FILE

SQUARE GUEST TABLE

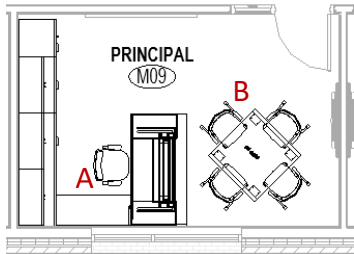
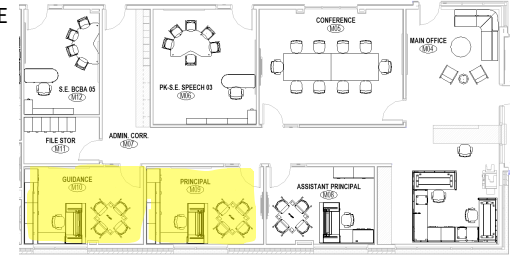

NOTE: IMAGES ARE FOR  
REFERENCE ONLY.



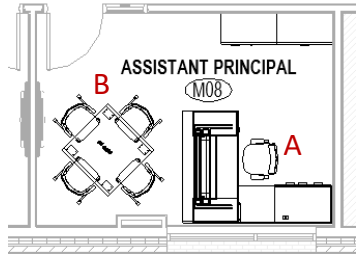

NOTE: IMAGES ARE FOR  
REFERENCE ONLY.

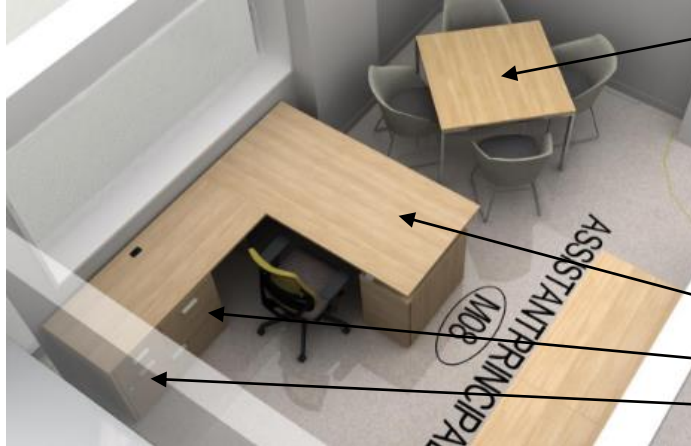
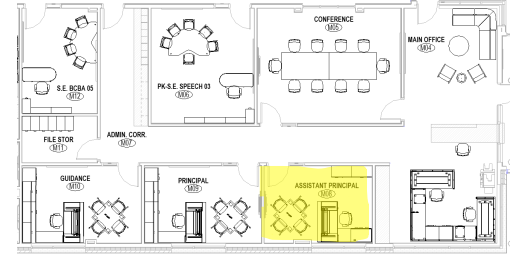

SQUARE GUEST TABLE

STORAGE WITH  
LATERAL FILE

BOOKSHELF,  
B/B/F,  
WARDROBE

SIT-STAND DESK WITH  
BOX/BOX/FILE

LATERAL FILE

PEDESTAL (B/B/F)

