



Buffalo Community Middle School

BUFFALO HANOVER MONTROSE SCHOOLS

THIS PLANNER BELONGS TO:

QUARTER ONE & TWO
SEPTEMBER 3RD, 2019 - JANUARY 17TH, 2020

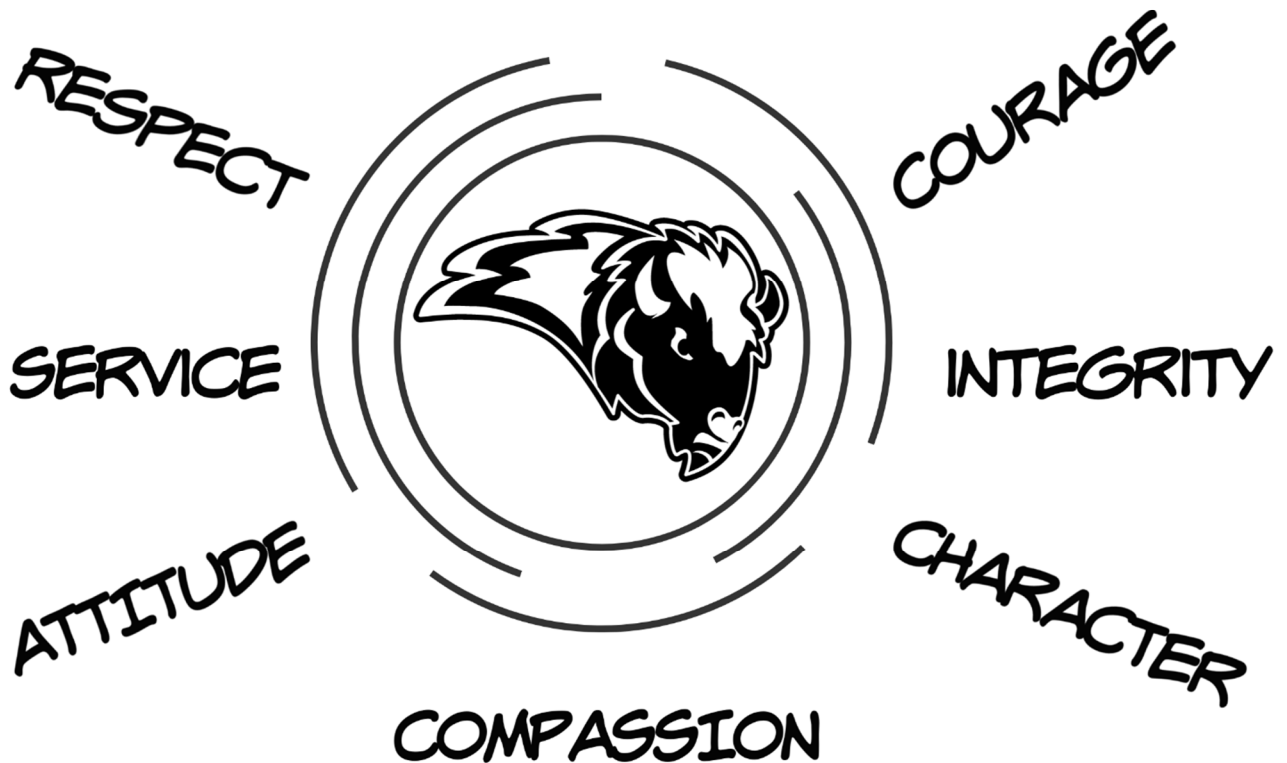

BCMS STUDENT PLANNER

<u>September</u>	<u>February</u>
<ul style="list-style-type: none"> ● 3 First Day of School - 6th Grade ONLY ● 4 First Day of School - All Grades 	<ul style="list-style-type: none"> ● 6 6th Orchestra Concert - 7:30 PAC ● 17 No School/ President's Day ● 18 Jazzin it Up (grades 7-12) - 7:30 PAC
<u>October</u>	<u>March</u>
<ul style="list-style-type: none"> ● 16 No School/Teacher Workshop ● 17 No School/ Fall Break ● 18 No School/ Fall Break 	<ul style="list-style-type: none"> ● 27 No School/Teacher Workshop <ul style="list-style-type: none"> ○ End of Term 3 ● 30 No School/ Spring Break
<u>November</u>	
<ul style="list-style-type: none"> ● 4 No School/Teacher Workshop <ul style="list-style-type: none"> ○ End of Term 1 ● 27 No School/Thanksgiving Break ● 28 No School/Thanksgiving Break ● 29 No School/Thanksgiving Break 	<u>April</u>
	<ul style="list-style-type: none"> ● 1 - 3 No School/ Spring Break
	<u>May</u>
	<ul style="list-style-type: none"> ● 12 7th Choir Concert - 7:30 PAC ● 14 8th Band Concert - 7:30 PAC ● 20 8th Choir Concert - 7:30 PAC ● 21 8th Orchestra Concert – 7:30 PAC ● 25 No School/ Memorial Day ● 26 7th Band Concert - 7:30 PAC
<u>December</u>	
<ul style="list-style-type: none"> ● 2 8th Choir Concert - 7:30 PAC ● 3 7th Band Concert - 7:30 PAC ● 6 8th Band Concert - 7:30 PAC ● 10 8th Orchestra Concert - 7:30 PAC ● 17 7th Choir Concert - 7:30 PAC ● 19 7th Orchestra Concert - 7:30 PAC ● 23 - 31 No School/ Winter Break 	<u>June</u>
	<ul style="list-style-type: none"> ● 1 6th Orchestra Concert – 6:30 PAC ● 1 6th Band Concert - 7:45 PAC ● 2 6th Choir Concert - 7:45 PAC ● 4 Last Day of School ● 5 No School/Teacher Workshop <ul style="list-style-type: none"> ○ End of Term 4
<u>January</u>	
<ul style="list-style-type: none"> ● 1 No School/ Winter Break ● 6 6th Choir Concert - 7:30 PAC ● 9 6th Band Concert - 7:30 PAC ● 20 No School/Teacher Workshop <ul style="list-style-type: none"> ○ End of Term 2 	



Buffalo Community Middle School

Daily Schedule



Schedule: Monday & Thursday

Prime Time	8:50 - 9:25
1st hour	9:30 - 10:20
2nd hour	10:25 - 11:15
3rd hour	11:20 - 12:10
4th Hour & Lunches	
8th Grade:	Lunch 12:10 - 12:35 Class 12:40 - 1:35
7th Grade:	Class 12:15 - 12:40 Lunch 12:40 - 1:05 Class Continues 1:10 - 1:35
6th Grade:	Class 12:15 - 1:10 Lunch 1:10 - 1:35
5th hour	1:40 - 2:30
6th hour	2:35 - 3:25

Schedule: Tuesday, Wednesday, Friday

Prime Time	8:50 - 9:10
1st hour	9:15 - 10:08
2nd hour	10:13 - 11:06
3rd hour	11:11 - 12:04
4th Hour & Lunches	
8th Grade:	Lunch 12:04 - 12:29 Class 12:34 - 1:29
7th Grade:	Class 12:09 - 12:34 Lunch 12:34 - 12:59 Class Continues 1:04 - 1:29
6th Grade:	Class 12:09 - 1:04 Lunch 1:04 - 1:29
5th hour	1:34 - 2:27
6th hour	2:32 - 3:25

TWO HOUR LATE START

Prime Time does not meet on late start days.

1st hour: 10:50 - 11:24

2nd hour: 11:29 - 12:02

4th hour: 12:07 - 1:30

8th Grade Lunch 12:02 - 12:27, 4th hour from 12:32-1:30

7th Grade 4th hour starts at 12:07-12:33, Lunch from 12:33 - 12:58, 4th hour continues from 1:03-1:30

6th Grade 4th hour starts at 12:07 -1:04, Lunch 1:04 - 1:29

3rd hour: 1:35 - 2:08

5th hour: 2:13 - 2:46

6th hour: 2:51 - 3:25

BUFFALO COMMUNITY MIDDLE SCHOOL

UPSTAIRS HALL LOCKER LOCATIONS

- A** – Lockers are in Corcoran Avenue
- B** – Lockers are in Montrose Avenue
- D** – Lockers are in Hanover Avenue
- E** – Lockers are in Main Street
- G** – Lockers are in Montrose Court
- L** – Lockers are in Lake Avenue & Buffalo Avenue
- M** – Lockers are in the Mall

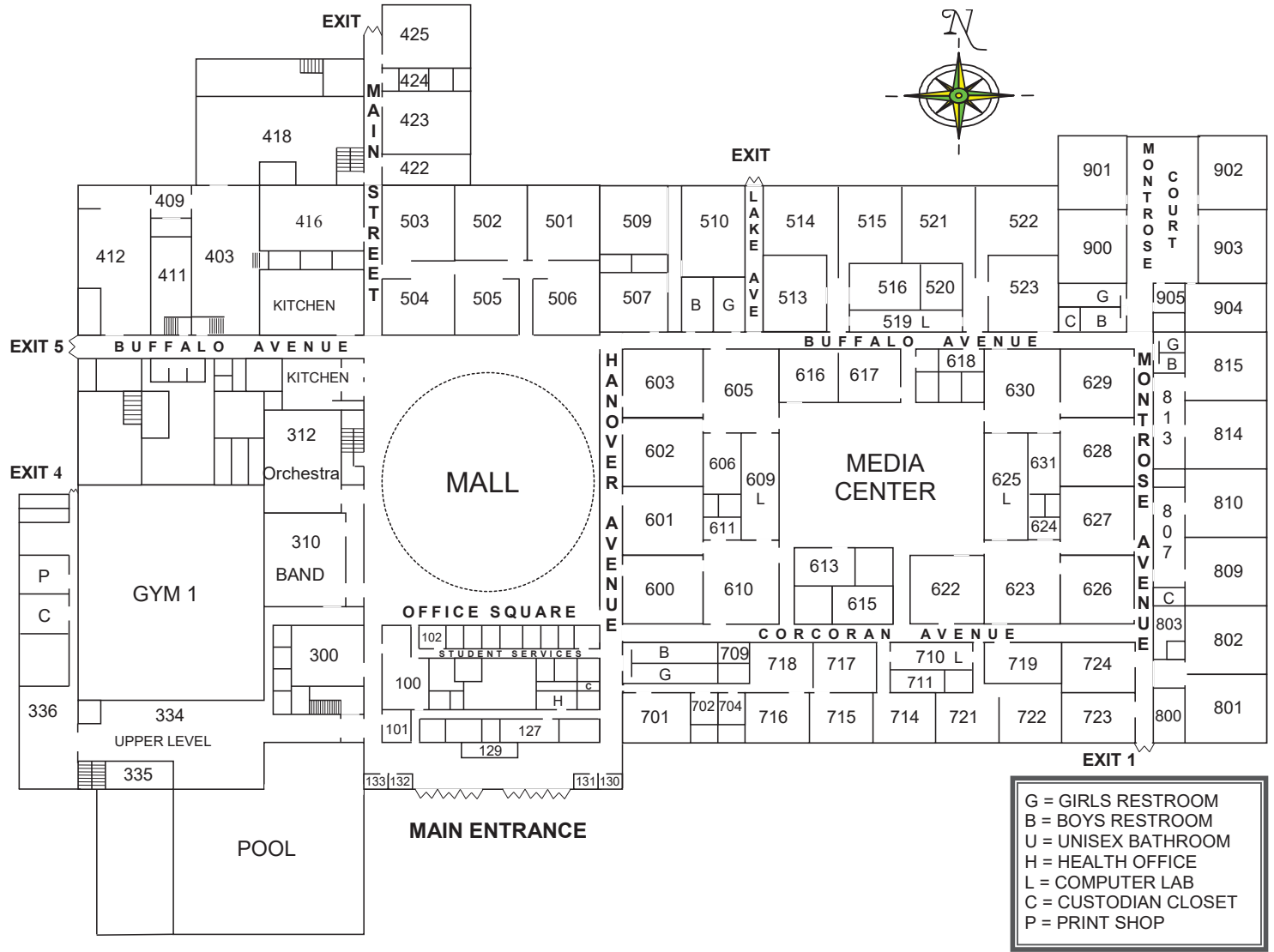
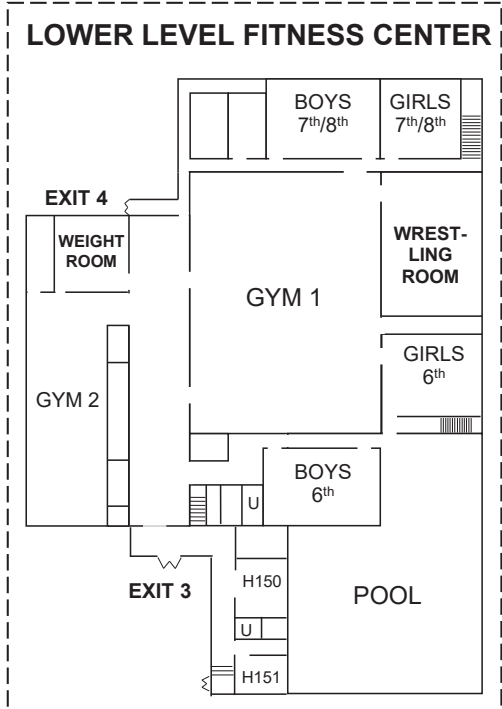

9/2		9/3		9/4	
MONDAY -NO SCHOOL		TUESDAY - 6th Grade ONLY		WEDNESDAY - All grades	
PT		PT		PT	
HR. 1	Learning Target:	HR. 1	Learning Target:	HR. 1	Learning Target:
Homework:		Homework:		Homework:	
HR. 2	Learning Target:	HR. 2	Learning Target:	HR. 2	Learning Target:
Homework:		Homework:		Homework:	
HR. 3	Learning Target:	HR. 3	Learning Target:	HR. 3	Learning Target:
Homework:		Homework:		Homework:	
HR. 4	Learning Target:	HR. 4	Learning Target:	HR. 4	Learning Target:
Homework:		Homework:		Homework:	
HR. 5	Learning Target:	HR. 5	Learning Target:	HR. 5	Learning Target:
Homework:		Homework:		Homework:	
HR. 6	Learning Target:	HR. 6	Learning Target:	HR. 6	Learning Target:
Homework:		Homework:		Homework:	

9/5 THURSDAY		9/6 FRIDAY - A Day		WEEKLY SUMMARY Notes & Reflection	
PT		PT		PT	
HR. 1	Learning Target:	HR. 1	Learning Target:	HR. 1	
Homework:		Homework:			
HR. 2	Learning Target:	HR. 2	Learning Target:	HR. 2	
Homework:		Homework:			
HR. 3	Learning Target:	HR. 3	Learning Target:	HR. 3	
Homework:		Homework:			
HR. 4	Learning Target:	HR. 4	Learning Target:	HR. 4	
Homework:		Homework:			
HR. 5	Learning Target:	HR. 5	Learning Target:	HR. 5	
Homework:		Homework:			
HR. 6	Learning Target:	HR. 6	Learning Target:	HR. 6	
Homework:		Homework:			

9/9 MONDAY		9/10 TUESDAY		9/11 WEDNESDAY	
PT		PT		PT	
HR. 1	Learning Target:	HR. 1	Learning Target:	HR. 1	Learning Target:
Homework:		Homework:		Homework:	
HR. 2	Learning Target:	HR. 2	Learning Target:	HR. 2	Learning Target:
Homework:		Homework:		Homework:	
HR. 3	Learning Target:	HR. 3	Learning Target:	HR. 3	Learning Target:
Homework:		Homework:		Homework:	
HR. 4	Learning Target:	HR. 4	Learning Target:	HR. 4	Learning Target:
Homework:		Homework:		Homework:	
HR. 5	Learning Target:	HR. 5	Learning Target:	HR. 5	Learning Target:
Homework:		Homework:		Homework:	
HR. 6	Learning Target:	HR. 6	Learning Target:	HR. 6	Learning Target:
Homework:		Homework:		Homework:	

9/12 THURSDAY		9/13 FRIDAY - B Day		WEEKLY SUMMARY Notes & Reflection	
PT		PT		PT	
HR. 1	Learning Target:	HR. 1	Learning Target:	HR. 1	
Homework:		Homework:			
HR. 2	Learning Target:	HR. 2	Learning Target:	HR. 2	
Homework:		Homework:			
HR. 3	Learning Target:	HR. 3	Learning Target:	HR. 3	
Homework:		Homework:			
HR. 4	Learning Target:	HR. 4	Learning Target:	HR. 4	
Homework:		Homework:			
HR. 5	Learning Target:	HR. 5	Learning Target:	HR. 5	
Homework:		Homework:			
HR. 6	Learning Target:	HR. 6	Learning Target:	HR. 6	
Homework:		Homework:			

9/16		9/17		9/18	
MONDAY		TUESDAY		WEDNESDAY	
PT		PT		PT	
HR. 1	Learning Target:	HR. 1	Learning Target:	HR. 1	Learning Target:
Homework:		Homework:		Homework:	
HR. 2	Learning Target:	HR. 2	Learning Target:	HR. 2	Learning Target:
Homework:		Homework:		Homework:	
HR. 3	Learning Target:	HR. 3	Learning Target:	HR. 3	Learning Target:
Homework:		Homework:		Homework:	
HR. 4	Learning Target:	HR. 4	Learning Target:	HR. 4	Learning Target:
Homework:		Homework:		Homework:	
HR. 5	Learning Target:	HR. 5	Learning Target:	HR. 5	Learning Target:
Homework:		Homework:		Homework:	
HR. 6	Learning Target:	HR. 6	Learning Target:	HR. 6	Learning Target:
Homework:		Homework:		Homework:	

9/19		9/20		WEEKLY SUMMARY	
THURSDAY		FRIDAY - A Day		Notes & Reflection	
PT		PT		PT	
HR. 1	Learning Target:	HR. 1	Learning Target:	HR. 1	
Homework:		Homework:			
HR. 2	Learning Target:	HR. 2	Learning Target:	HR. 2	
Homework:		Homework:			
HR. 3	Learning Target:	HR. 3	Learning Target:	HR. 3	
Homework:		Homework:			
HR. 4	Learning Target:	HR. 4	Learning Target:	HR. 4	
Homework:		Homework:			
HR. 5	Learning Target:	HR. 5	Learning Target:	HR. 5	
Homework:		Homework:			
HR. 6	Learning Target:	HR. 6	Learning Target:	HR. 6	
Homework:		Homework:			

9/23		9/24		9/25	
MONDAY		TUESDAY		WEDNESDAY	
PT		PT		PT	
HR. 1	Learning Target:	HR. 1	Learning Target:	HR. 1	Learning Target:
Homework:		Homework:		Homework:	
HR. 2	Learning Target:	HR. 2	Learning Target:	HR. 2	Learning Target:
Homework:		Homework:		Homework:	
HR. 3	Learning Target:	HR. 3	Learning Target:	HR. 3	Learning Target:
Homework:		Homework:		Homework:	
HR. 4	Learning Target:	HR. 4	Learning Target:	HR. 4	Learning Target:
Homework:		Homework:		Homework:	
HR. 5	Learning Target:	HR. 5	Learning Target:	HR. 5	Learning Target:
Homework:		Homework:		Homework:	
HR. 6	Learning Target:	HR. 6	Learning Target:	HR. 6	Learning Target:
Homework:		Homework:		Homework:	

9/26 THURSDAY		9/27 FRIDAY - B Day		WEEKLY SUMMARY Notes & Reflection	
PT		PT		PT	
HR. 1	Learning Target:	HR. 1	Learning Target:	HR. 1	
Homework:		Homework:			
HR. 2	Learning Target:	HR. 2	Learning Target:	HR. 2	
Homework:		Homework:			
HR. 3	Learning Target:	HR. 3	Learning Target:	HR. 3	
Homework:		Homework:			
HR. 4	Learning Target:	HR. 4	Learning Target:	HR. 4	
Homework:		Homework:			
HR. 5	Learning Target:	HR. 5	Learning Target:	HR. 5	
Homework:		Homework:			
HR. 6	Learning Target:	HR. 6	Learning Target:	HR. 6	
Homework:		Homework:			

9/30		10/1		10/2	
MONDAY		TUESDAY		WEDNESDAY	
PT		PT		PT	
HR. 1	Learning Target:	HR. 1	Learning Target:	HR. 1	Learning Target:
Homework:		Homework:		Homework:	
HR. 2	Learning Target:	HR. 2	Learning Target:	HR. 2	Learning Target:
Homework:		Homework:		Homework:	
HR. 3	Learning Target:	HR. 3	Learning Target:	HR. 3	Learning Target:
Homework:		Homework:		Homework:	
HR. 4	Learning Target:	HR. 4	Learning Target:	HR. 4	Learning Target:
Homework:		Homework:		Homework:	
HR. 5	Learning Target:	HR. 5	Learning Target:	HR. 5	Learning Target:
Homework:		Homework:		Homework:	
HR. 6	Learning Target:	HR. 6	Learning Target:	HR. 6	Learning Target:
Homework:		Homework:		Homework:	

10/3 THURSDAY		10/4 FRIDAY - A Day		WEEKLY SUMMARY Notes & Reflection	
PT		PT		PT	
HR. 1	Learning Target:	HR. 1	Learning Target:	HR. 1	
Homework:		Homework:			
HR. 2	Learning Target:	HR. 2	Learning Target:	HR. 2	
Homework:		Homework:			
HR. 3	Learning Target:	HR. 3	Learning Target:	HR. 3	
Homework:		Homework:			
HR. 4	Learning Target:	HR. 4	Learning Target:	HR. 4	
Homework:		Homework:			
HR. 5	Learning Target:	HR. 5	Learning Target:	HR. 5	
Homework:		Homework:			
HR. 6	Learning Target:	HR. 6	Learning Target:	HR. 6	
Homework:		Homework:			

10/7 MONDAY		10/8 TUESDAY		10/9 WEDNESDAY	
PT		PT		PT	
HR. 1	Learning Target:	HR. 1	Learning Target:	HR. 1	Learning Target:
Homework:		Homework:		Homework:	
HR. 2	Learning Target:	HR. 2	Learning Target:	HR. 2	Learning Target:
Homework:		Homework:		Homework:	
HR. 3	Learning Target:	HR. 3	Learning Target:	HR. 3	Learning Target:
Homework:		Homework:		Homework:	
HR. 4	Learning Target:	HR. 4	Learning Target:	HR. 4	Learning Target:
Homework:		Homework:		Homework:	
HR. 5	Learning Target:	HR. 5	Learning Target:	HR. 5	Learning Target:
Homework:		Homework:		Homework:	
HR. 6	Learning Target:	HR. 6	Learning Target:	HR. 6	Learning Target:
Homework:		Homework:		Homework:	

10/10 THURSDAY		10/11 FRIDAY - A Day		WEEKLY SUMMARY Notes & Reflection	
PT		PT		PT	
HR. 1	Learning Target:	HR. 1	Learning Target:	HR. 1	
Homework:		Homework:			
HR. 2	Learning Target:	HR. 2	Learning Target:	HR. 2	
Homework:		Homework:			
HR. 3	Learning Target:	HR. 3	Learning Target:	HR. 3	
Homework:		Homework:			
HR. 4	Learning Target:	HR. 4	Learning Target:	HR. 4	
Homework:		Homework:			
HR. 5	Learning Target:	HR. 5	Learning Target:	HR. 5	
Homework:		Homework:			
HR. 6	Learning Target:	HR. 6	Learning Target:	HR. 6	
Homework:		Homework:			

10/14 MONDAY		10/15 TUESDAY		10/16 WEDNESDAY - NO SCHOOL	
PT		PT		PT	
HR. 1	Learning Target:	HR. 1	Learning Target:	HR. 1	Learning Target:
Homework:		Homework:		Homework:	
HR. 2	Learning Target:	HR. 2	Learning Target:	HR. 2	Learning Target:
Homework:		Homework:		Homework:	
HR. 3	Learning Target:	HR. 3	Learning Target:	HR. 3	Learning Target:
Homework:		Homework:		Homework:	
HR. 4	Learning Target:	HR. 4	Learning Target:	HR. 4	Learning Target:
Homework:		Homework:		Homework:	
HR. 5	Learning Target:	HR. 5	Learning Target:	HR. 5	Learning Target:
Homework:		Homework:		Homework:	
HR. 6	Learning Target:	HR. 6	Learning Target:	HR. 6	Learning Target:
Homework:		Homework:		Homework:	

of:

10/17		10/18		WEEKLY SUMMARY	
THURSDAY - NO SCHOOL		FRIDAY - NO SCHOOL		Notes & Reflection	
PT		PT		PT	
HR. 1	Learning Target:	HR. 1	Learning Target:	HR. 1	
Homework:		Homework:			
HR. 2	Learning Target:	HR. 2	Learning Target:	HR. 2	
Homework:		Homework:			
HR. 3	Learning Target:	HR. 3	Learning Target:	HR. 3	
Homework:		Homework:			
HR. 4	Learning Target:	HR. 4	Learning Target:	HR. 4	
Homework:		Homework:			
HR. 5	Learning Target:	HR. 5	Learning Target:	HR. 5	
Homework:		Homework:			
HR. 6	Learning Target:	HR. 6	Learning Target:	HR. 6	
Homework:		Homework:			

of:

10/21 MONDAY		10/22 TUESDAY		10/23 WEDNESDAY	
PT		PT		PT	
HR. 1	Learning Target:	HR. 1	Learning Target:	HR. 1	Learning Target:
Homework:		Homework:		Homework:	
HR. 2	Learning Target:	HR. 2	Learning Target:	HR. 2	Learning Target:
Homework:		Homework:		Homework:	
HR. 3	Learning Target:	HR. 3	Learning Target:	HR. 3	Learning Target:
Homework:		Homework:		Homework:	
HR. 4	Learning Target:	HR. 4	Learning Target:	HR. 4	Learning Target:
Homework:		Homework:		Homework:	
HR. 5	Learning Target:	HR. 5	Learning Target:	HR. 5	Learning Target:
Homework:		Homework:		Homework:	
HR. 6	Learning Target:	HR. 6	Learning Target:	HR. 6	Learning Target:
Homework:		Homework:		Homework:	

10/24 THURSDAY		10/25 FRIDAY - A Day		WEEKLY SUMMARY Notes & Reflection	
PT		PT		PT	
HR. 1	Learning Target:	HR. 1	Learning Target:	HR. 1	
Homework:		Homework:			
HR. 2	Learning Target:	HR. 2	Learning Target:	HR. 2	
Homework:		Homework:			
HR. 3	Learning Target:	HR. 3	Learning Target:	HR. 3	
Homework:		Homework:			
HR. 4	Learning Target:	HR. 4	Learning Target:	HR. 4	
Homework:		Homework:			
HR. 5	Learning Target:	HR. 5	Learning Target:	HR. 5	
Homework:		Homework:			
HR. 6	Learning Target:	HR. 6	Learning Target:	HR. 6	
Homework:		Homework:			

10/28 MONDAY		10/29 TUESDAY		10/30 WEDNESDAY	
PT		PT		PT	
HR. 1	Learning Target:	HR. 1	Learning Target:	HR. 1	Learning Target:
Homework:		Homework:		Homework:	
HR. 2	Learning Target:	HR. 2	Learning Target:	HR. 2	Learning Target:
Homework:		Homework:		Homework:	
HR. 3	Learning Target:	HR. 3	Learning Target:	HR. 3	Learning Target:
Homework:		Homework:		Homework:	
HR. 4	Learning Target:	HR. 4	Learning Target:	HR. 4	Learning Target:
Homework:		Homework:		Homework:	
HR. 5	Learning Target:	HR. 5	Learning Target:	HR. 5	Learning Target:
Homework:		Homework:		Homework:	
HR. 6	Learning Target:	HR. 6	Learning Target:	HR. 6	Learning Target:
Homework:		Homework:		Homework:	

10/31 THURSDAY		11/1 FRIDAY - B Day		WEEKLY SUMMARY Notes & Reflection	
PT		PT		PT	
HR. 1	Learning Target:	HR. 1	Learning Target:	HR. 1	
Homework:		Homework:			
HR. 2	Learning Target:	HR. 2	Learning Target:	HR. 2	
Homework:		Homework:			
HR. 3	Learning Target:	HR. 3	Learning Target:	HR. 3	
Homework:		Homework:			
HR. 4	Learning Target:	HR. 4	Learning Target:	HR. 4	
Homework:		Homework:			
HR. 5	Learning Target:	HR. 5	Learning Target:	HR. 5	
Homework:		Homework:			
HR. 6	Learning Target:	HR. 6	Learning Target:	HR. 6	
Homework:		Homework:			

of:

11/4		11/5		11/6	
MONDAY - NO SCHOOL		TUESDAY		WEDNESDAY	
PT		PT		PT	
HR. 1	Learning Target:	HR. 1	Learning Target:	HR. 1	Learning Target:
Homework:		Homework:		Homework:	
HR. 2	Learning Target:	HR. 2	Learning Target:	HR. 2	Learning Target:
Homework:		Homework:		Homework:	
HR. 3	Learning Target:	HR. 3	Learning Target:	HR. 3	Learning Target:
Homework:		Homework:		Homework:	
HR. 4	Learning Target:	HR. 4	Learning Target:	HR. 4	Learning Target:
Homework:		Homework:		Homework:	
HR. 5	Learning Target:	HR. 5	Learning Target:	HR. 5	Learning Target:
Homework:		Homework:		Homework:	
HR. 6	Learning Target:	HR. 6	Learning Target:	HR. 6	Learning Target:
Homework:		Homework:		Homework:	

11/7 THURSDAY		11/8 FRIDAY - A Day		WEEKLY SUMMARY Notes & Reflection	
PT		PT		PT	
HR. 1	Learning Target:	HR. 1	Learning Target:	HR. 1	
Homework:		Homework:			
HR. 2	Learning Target:	HR. 2	Learning Target:	HR. 2	
Homework:		Homework:			
HR. 3	Learning Target:	HR. 3	Learning Target:	HR. 3	
Homework:		Homework:			
HR. 4	Learning Target:	HR. 4	Learning Target:	HR. 4	
Homework:		Homework:			
HR. 5	Learning Target:	HR. 5	Learning Target:	HR. 5	
Homework:		Homework:			
HR. 6	Learning Target:	HR. 6	Learning Target:	HR. 6	
Homework:		Homework:			

11/11 MONDAY		11/12 TUESDAY		11/13 WEDNESDAY	
PT		PT		PT	
HR. 1	Learning Target:	HR. 1	Learning Target:	HR. 1	Learning Target:
Homework:		Homework:		Homework:	
HR. 2	Learning Target:	HR. 2	Learning Target:	HR. 2	Learning Target:
Homework:		Homework:		Homework:	
HR. 3	Learning Target:	HR. 3	Learning Target:	HR. 3	Learning Target:
Homework:		Homework:		Homework:	
HR. 4	Learning Target:	HR. 4	Learning Target:	HR. 4	Learning Target:
Homework:		Homework:		Homework:	
HR. 5	Learning Target:	HR. 5	Learning Target:	HR. 5	Learning Target:
Homework:		Homework:		Homework:	
HR. 6	Learning Target:	HR. 6	Learning Target:	HR. 6	Learning Target:
Homework:		Homework:		Homework:	

11/14 THURSDAY		11/15 FRIDAY - B Day		WEEKLY SUMMARY Notes & Reflection	
PT		PT		PT	
HR. 1	Learning Target:	HR. 1	Learning Target:	HR. 1	
Homework:		Homework:			
HR. 2	Learning Target:	HR. 2	Learning Target:	HR. 2	
Homework:		Homework:			
HR. 3	Learning Target:	HR. 3	Learning Target:	HR. 3	
Homework:		Homework:			
HR. 4	Learning Target:	HR. 4	Learning Target:	HR. 4	
Homework:		Homework:			
HR. 5	Learning Target:	HR. 5	Learning Target:	HR. 5	
Homework:		Homework:			
HR. 6	Learning Target:	HR. 6	Learning Target:	HR. 6	
Homework:		Homework:			

11/18 MONDAY		11/19 TUESDAY		11/20 WEDNESDAY	
PT		PT		PT	
HR. 1	Learning Target:	HR. 1	Learning Target:	HR. 1	Learning Target:
Homework:		Homework:		Homework:	
HR. 2	Learning Target:	HR. 2	Learning Target:	HR. 2	Learning Target:
Homework:		Homework:		Homework:	
HR. 3	Learning Target:	HR. 3	Learning Target:	HR. 3	Learning Target:
Homework:		Homework:		Homework:	
HR. 4	Learning Target:	HR. 4	Learning Target:	HR. 4	Learning Target:
Homework:		Homework:		Homework:	
HR. 5	Learning Target:	HR. 5	Learning Target:	HR. 5	Learning Target:
Homework:		Homework:		Homework:	
HR. 6	Learning Target:	HR. 6	Learning Target:	HR. 6	Learning Target:
Homework:		Homework:		Homework:	

of:

11/21 THURSDAY		11/22 FRIDAY - A Day		WEEKLY SUMMARY Notes & Reflection	
PT		PT		PT	
HR. 1	Learning Target:	HR. 1	Learning Target:	HR. 1	
Homework:		Homework:			
HR. 2	Learning Target:	HR. 2	Learning Target:	HR. 2	
Homework:		Homework:			
HR. 3	Learning Target:	HR. 3	Learning Target:	HR. 3	
Homework:		Homework:			
HR. 4	Learning Target:	HR. 4	Learning Target:	HR. 4	
Homework:		Homework:			
HR. 5	Learning Target:	HR. 5	Learning Target:	HR. 5	
Homework:		Homework:			
HR. 6	Learning Target:	HR. 6	Learning Target:	HR. 6	
Homework:		Homework:			

11/25 MONDAY		11/26 TUESDAY		11/27 WEDNESDAY - NO SCHOOL	
PT		PT		PT	
HR. 1	Learning Target:	HR. 1	Learning Target:	HR. 1	Learning Target:
Homework:		Homework:		Homework:	
HR. 2	Learning Target:	HR. 2	Learning Target:	HR. 2	Learning Target:
Homework:		Homework:		Homework:	
HR. 3	Learning Target:	HR. 3	Learning Target:	HR. 3	Learning Target:
Homework:		Homework:		Homework:	
HR. 4	Learning Target:	HR. 4	Learning Target:	HR. 4	Learning Target:
Homework:		Homework:		Homework:	
HR. 5	Learning Target:	HR. 5	Learning Target:	HR. 5	Learning Target:
Homework:		Homework:		Homework:	
HR. 6	Learning Target:	HR. 6	Learning Target:	HR. 6	Learning Target:
Homework:		Homework:		Homework:	

of:

11/28 THURSDAY - NO SCHOOL		11/29 FRIDAY - NO SCHOOL		WEEKLY SUMMARY Notes & Reflection	
PT		PT		PT	
HR. 1	Learning Target:	HR. 1	Learning Target:	HR. 1	
Homework:		Homework:			
HR. 2	Learning Target:	HR. 2	Learning Target:	HR. 2	
Homework:		Homework:			
HR. 3	Learning Target:	HR. 3	Learning Target:	HR. 3	
Homework:		Homework:			
HR. 4	Learning Target:	HR. 4	Learning Target:	HR. 4	
Homework:		Homework:			
HR. 5	Learning Target:	HR. 5	Learning Target:	HR. 5	
Homework:		Homework:			
HR. 6	Learning Target:	HR. 6	Learning Target:	HR. 6	
Homework:		Homework:			

12/2 MONDAY		12/3 TUESDAY		12/4 WEDNESDAY	
PT		PT		PT	
HR. 1	Learning Target:	HR. 1	Learning Target:	HR. 1	Learning Target:
Homework:		Homework:		Homework:	
HR. 2	Learning Target:	HR. 2	Learning Target:	HR. 2	Learning Target:
Homework:		Homework:		Homework:	
HR. 3	Learning Target:	HR. 3	Learning Target:	HR. 3	Learning Target:
Homework:		Homework:		Homework:	
HR. 4	Learning Target:	HR. 4	Learning Target:	HR. 4	Learning Target:
Homework:		Homework:		Homework:	
HR. 5	Learning Target:	HR. 5	Learning Target:	HR. 5	Learning Target:
Homework:		Homework:		Homework:	
HR. 6	Learning Target:	HR. 6	Learning Target:	HR. 6	Learning Target:
Homework:		Homework:		Homework:	

12/5 THURSDAY		12/6 FRIDAY - B DAY		WEEKLY SUMMARY Notes & Reflection	
PT		PT		PT	
HR. 1	Learning Target:	HR. 1	Learning Target:	HR. 1	
Homework:		Homework:			
HR. 2	Learning Target:	HR. 2	Learning Target:	HR. 2	
Homework:		Homework:			
HR. 3	Learning Target:	HR. 3	Learning Target:	HR. 3	
Homework:		Homework:			
HR. 4	Learning Target:	HR. 4	Learning Target:	HR. 4	
Homework:		Homework:			
HR. 5	Learning Target:	HR. 5	Learning Target:	HR. 5	
Homework:		Homework:			
HR. 6	Learning Target:	HR. 6	Learning Target:	HR. 6	
Homework:		Homework:			

12/9 MONDAY		12/10 TUESDAY		12/11 WEDNESDAY	
PT		PT		PT	
HR. 1	Learning Target:	HR. 1	Learning Target:	HR. 1	Learning Target:
Homework:		Homework:		Homework:	
HR. 2	Learning Target:	HR. 2	Learning Target:	HR. 2	Learning Target:
Homework:		Homework:		Homework:	
HR. 3	Learning Target:	HR. 3	Learning Target:	HR. 3	Learning Target:
Homework:		Homework:		Homework:	
HR. 4	Learning Target:	HR. 4	Learning Target:	HR. 4	Learning Target:
Homework:		Homework:		Homework:	
HR. 5	Learning Target:	HR. 5	Learning Target:	HR. 5	Learning Target:
Homework:		Homework:		Homework:	
HR. 6	Learning Target:	HR. 6	Learning Target:	HR. 6	Learning Target:
Homework:		Homework:		Homework:	

12/12 THURSDAY		12/13 FRIDAY - A Day		WEEKLY SUMMARY Notes & Reflection	
PT		PT		PT	
HR. 1	Learning Target:	HR. 1	Learning Target:	HR. 1	
Homework:		Homework:			
HR. 2	Learning Target:	HR. 2	Learning Target:	HR. 2	
Homework:		Homework:			
HR. 3	Learning Target:	HR. 3	Learning Target:	HR. 3	
Homework:		Homework:			
HR. 4	Learning Target:	HR. 4	Learning Target:	HR. 4	
Homework:		Homework:			
HR. 5	Learning Target:	HR. 5	Learning Target:	HR. 5	
Homework:		Homework:			
HR. 6	Learning Target:	HR. 6	Learning Target:	HR. 6	
Homework:		Homework:			

12/16 MONDAY		12/17 TUESDAY		12/18 WEDNESDAY	
PT		PT		PT	
HR. 1	Learning Target:	HR. 1	Learning Target:	HR. 1	Learning Target:
Homework:		Homework:		Homework:	
HR. 2	Learning Target:	HR. 2	Learning Target:	HR. 2	Learning Target:
Homework:		Homework:		Homework:	
HR. 3	Learning Target:	HR. 3	Learning Target:	HR. 3	Learning Target:
Homework:		Homework:		Homework:	
HR. 4	Learning Target:	HR. 4	Learning Target:	HR. 4	Learning Target:
Homework:		Homework:		Homework:	
HR. 5	Learning Target:	HR. 5	Learning Target:	HR. 5	Learning Target:
Homework:		Homework:		Homework:	
HR. 6	Learning Target:	HR. 6	Learning Target:	HR. 6	Learning Target:
Homework:		Homework:		Homework:	

of:

12/19 THURSDAY		12/20 FRIDAY - B DAY		WEEKLY SUMMARY Notes & Reflection	
PT		PT		PT	
HR. 1	Learning Target:	HR. 1	Learning Target:	HR. 1	
Homework:		Homework:			
HR. 2	Learning Target:	HR. 2	Learning Target:	HR. 2	
Homework:		Homework:			
HR. 3	Learning Target:	HR. 3	Learning Target:	HR. 3	
Homework:		Homework:			
HR. 4	Learning Target:	HR. 4	Learning Target:	HR. 4	
Homework:		Homework:			
HR. 5	Learning Target:	HR. 5	Learning Target:	HR. 5	
Homework:		Homework:			
HR. 6	Learning Target:	HR. 6	Learning Target:	HR. 6	
Homework:		Homework:			

12/23		12/24		12/25	
MONDAY - NO SCHOOL		TUESDAY - NO SCHOOL		WEDNESDAY - NO SCHOOL	
PT		PT		PT	
HR. 1	Learning Target:	HR. 1	Learning Target:	HR. 1	Learning Target:
Homework:		Homework:		Homework:	
HR. 2	Learning Target:	HR. 2	Learning Target:	HR. 2	Learning Target:
Homework:		Homework:		Homework:	
HR. 3	Learning Target:	HR. 3	Learning Target:	HR. 3	Learning Target:
Homework:		Homework:		Homework:	
HR. 4	Learning Target:	HR. 4	Learning Target:	HR. 4	Learning Target:
Homework:		Homework:		Homework:	
HR. 5	Learning Target:	HR. 5	Learning Target:	HR. 5	Learning Target:
Homework:		Homework:		Homework:	
HR. 6	Learning Target:	HR. 6	Learning Target:	HR. 6	Learning Target:
Homework:		Homework:		Homework:	

of:

12/26		12/27		WEEKLY SUMMARY	
THURSDAY - NO SCHOOL		FRIDAY - NO SCHOOL		Notes & Reflection	
PT		PT		PT	
HR. 1	Learning Target:	HR. 1	Learning Target:	HR. 1	
Homework:		Homework:			
HR. 2	Learning Target:	HR. 2	Learning Target:	HR. 2	
Homework:		Homework:			
HR. 3	Learning Target:	HR. 3	Learning Target:	HR. 3	
Homework:		Homework:			
HR. 4	Learning Target:	HR. 4	Learning Target:	HR. 4	
Homework:		Homework:			
HR. 5	Learning Target:	HR. 5	Learning Target:	HR. 5	
Homework:		Homework:			
HR. 6	Learning Target:	HR. 6	Learning Target:	HR. 6	
Homework:		Homework:			

12/30		12/31		1/1	
MONDAY - NO SCHOOL		TUESDAY - NO SCHOOL		WEDNESDAY - NO SCHOOL	
PT		PT		PT	
HR. 1	Learning Target:	HR. 1	Learning Target:	HR. 1	Learning Target:
Homework:		Homework:		Homework:	
HR. 2	Learning Target:	HR. 2	Learning Target:	HR. 2	Learning Target:
Homework:		Homework:		Homework:	
HR. 3	Learning Target:	HR. 3	Learning Target:	HR. 3	Learning Target:
Homework:		Homework:		Homework:	
HR. 4	Learning Target:	HR. 4	Learning Target:	HR. 4	Learning Target:
Homework:		Homework:		Homework:	
HR. 5	Learning Target:	HR. 5	Learning Target:	HR. 5	Learning Target:
Homework:		Homework:		Homework:	
HR. 6	Learning Target:	HR. 6	Learning Target:	HR. 6	Learning Target:
Homework:		Homework:		Homework:	

1/2 THURSDAY		1/3 FRIDAY - A Day		WEEKLY SUMMARY Notes & Reflection	
PT		PT		PT	
HR. 1	Learning Target:	HR. 1	Learning Target:	HR. 1	
Homework:		Homework:			
HR. 2	Learning Target:	HR. 2	Learning Target:	HR. 2	
Homework:		Homework:			
HR. 3	Learning Target:	HR. 3	Learning Target:	HR. 3	
Homework:		Homework:			
HR. 4	Learning Target:	HR. 4	Learning Target:	HR. 4	
Homework:		Homework:			
HR. 5	Learning Target:	HR. 5	Learning Target:	HR. 5	
Homework:		Homework:			
HR. 6	Learning Target:	HR. 6	Learning Target:	HR. 6	
Homework:		Homework:			

1/6 MONDAY		1/7 TUESDAY		1/8 WEDNESDAY	
PT		PT		PT	
HR. 1	Learning Target:	HR. 1	Learning Target:	HR. 1	Learning Target:
Homework:		Homework:		Homework:	
HR. 2	Learning Target:	HR. 2	Learning Target:	HR. 2	Learning Target:
Homework:		Homework:		Homework:	
HR. 3	Learning Target:	HR. 3	Learning Target:	HR. 3	Learning Target:
Homework:		Homework:		Homework:	
HR. 4	Learning Target:	HR. 4	Learning Target:	HR. 4	Learning Target:
Homework:		Homework:		Homework:	
HR. 5	Learning Target:	HR. 5	Learning Target:	HR. 5	Learning Target:
Homework:		Homework:		Homework:	
HR. 6	Learning Target:	HR. 6	Learning Target:	HR. 6	Learning Target:
Homework:		Homework:		Homework:	

1/9 THURSDAY		1/10 FRIDAY - B Day		WEEKLY SUMMARY Notes & Reflection	
PT		PT		PT	
HR. 1	Learning Target:	HR. 1	Learning Target:	HR. 1	
Homework:		Homework:			
HR. 2	Learning Target:	HR. 2	Learning Target:	HR. 2	
Homework:		Homework:			
HR. 3	Learning Target:	HR. 3	Learning Target:	HR. 3	
Homework:		Homework:			
HR. 4	Learning Target:	HR. 4	Learning Target:	HR. 4	
Homework:		Homework:			
HR. 5	Learning Target:	HR. 5	Learning Target:	HR. 5	
Homework:		Homework:			
HR. 6	Learning Target:	HR. 6	Learning Target:	HR. 6	
Homework:		Homework:			

1/13 MONDAY		1/14 TUESDAY		1/15 WEDNESDAY	
PT		PT		PT	
HR. 1	Learning Target:	HR. 1	Learning Target:	HR. 1	Learning Target:
Homework:		Homework:		Homework:	
HR. 2	Learning Target:	HR. 2	Learning Target:	HR. 2	Learning Target:
Homework:		Homework:		Homework:	
HR. 3	Learning Target:	HR. 3	Learning Target:	HR. 3	Learning Target:
Homework:		Homework:		Homework:	
HR. 4	Learning Target:	HR. 4	Learning Target:	HR. 4	Learning Target:
Homework:		Homework:		Homework:	
HR. 5	Learning Target:	HR. 5	Learning Target:	HR. 5	Learning Target:
Homework:		Homework:		Homework:	
HR. 6	Learning Target:	HR. 6	Learning Target:	HR. 6	Learning Target:
Homework:		Homework:		Homework:	

1/16 THURSDAY		1/17 FRIDAY - A Day		WEEKLY SUMMARY Notes & Reflection	
PT		PT		PT	
HR. 1	Learning Target:	HR. 1	Learning Target:	HR. 1	
Homework:		Homework:			
HR. 2	Learning Target:	HR. 2	Learning Target:	HR. 2	
Homework:		Homework:			
HR. 3	Learning Target:	HR. 3	Learning Target:	HR. 3	
Homework:		Homework:			
HR. 4	Learning Target:	HR. 4	Learning Target:	HR. 4	
Homework:		Homework:			
HR. 5	Learning Target:	HR. 5	Learning Target:	HR. 5	
Homework:		Homework:			
HR. 6	Learning Target:	HR. 6	Learning Target:	HR. 6	
Homework:		Homework:			

GENERAL STUDENT INFORMATION

STUDENT SUPPORT SERVICES

Counseling Services – You may make an appointment with the school counselor in the support services hallway. The counselors are available to talk over problems you might be having with your school work, students, teachers, family, etc. Our counselors are Penny Thalacker (682-8219) for 7th grade students, Kaitlin Kolbinger (682-8220) for 8th grade students, and Ashley Kamphenkel (682-8217) for 6th grade students.

Health & Nursing Services - The health office is directed by a licensed school nurse and staffed by a health aide. Students who become ill during the school day are to report to the health office. Students who need to take medications during the school day are to bring medications to the health office. Parental permission is required to use any medication at school and a physician's order is necessary for any prescription medications. The health office will hold over-the-counter medications (such as Tylenol or ibuprofen) as it may not be kept in your locker. Forms for medication use during school may be picked up at the health office. For the safety of our students, staff and the general public who use our buildings, the district does not allow the use of latex balloons in any capacity, in any school building, at any time of the day. However, Mylar (Foil) balloons are allowed. If students have special health needs such as diabetes, seizures, asthma, ADD, please feel free to contact our school nurse, Karen Schultz, RN with questions or concerns. Her number is 763-682-8120. Our school health aide, Mary Piekarski's number is 763-682-8208.

Special Education and Social Work - Trained staff are available to provide students who have learning and physical handicaps with help and support. Jennifer Holte (682-8216) & Patti Fisher(682-8213) serve as our building social workers for special education students.

Police Resource Officer – Our School Resource Officer at Buffalo Community Middle School is available to students, staff, and parents. She can be reached at 763-682-8240.

STUDENT HOURS

If you arrive before 8:25 am, please wait in the Mall Area until you hear the bell. After school, students should ride the bus home or make plans to walk or get picked up by 3:35 pm. If you are here after 3:35 pm, you must be under the supervision of a staff member. Any student unsupervised by a BCMS staff member after 3:35 pm must wait in the front office area. Students cannot leave school grounds and return without a valid excuse.

ACADEMIC TEAMS

Every 6th and 7th grade student is a member of a team. Each team is a smaller community within the larger school. Most team core classes are in a common area. 8th Grade students are not teamed.

MEDIA CENTER

You are always welcome in the Media Center – before classes begin, with your class, or with a pass. The Media Center is a place to look for materials, read, or work quietly. Computers are available for RC testing, class work and portal grade checks. Please follow instructions given by Ms. Bauernschmitt and staff members. You may check out books for 3 weeks and magazines for 1 week. You are allowed to have three items at a time. A charge will be assessed for books lost, damaged, or not returned.

FOOD SELECTIONS

The school cafeteria is a vital part of the health program of the school. To encourage good nutrition, a well-balanced lunch is offered for \$3.00. A breakfast program will be available from 8:00 am until 8:40 am at a cost of \$2.00. Money needs to be deposited in the payment box before 10:30 am to be available that day. Free and reduced lunches are available after filling out a qualifying application. Parents can call our food service at 763-682-8233 for lunch account information or sign into their parent portal to keep track of all lunch accounts. Daily, we show pride in our building by picking up our garbage and returning all trays and utensils to the dishwashing carts neatly stacked.

LOCKERS

8th graders will be allowed to choose their locker location in the mall area. 6th and 7th grade students will be assigned lockers. Please do not switch lockers or give your locker combination to another student. Hall lockers and physical education lockers are “on loan” to students for the school year and remain the property of the District 877. Students will be responsible for any damage incurred to lockers during the school year. School locks can be purchased in the front office for \$5.00. For security reasons, all lockers must have a school lock on them. It is the individual student’s responsibility to keep his/her locker clean and neat inside and out. Students are advised not to keep money or other valuables in their lockers. The school will not be responsible for lost, damaged, or stolen property. Students are expected to keep hallway and physical education lockers locked at all times. The school reserves the right to inspect lockers when building administrators deem such action necessary to ensure the safety and welfare of students and staff.

STUDENT RECORDS POLICY

District 877 shall permit the parents of a student to inspect and review the educational records of the student, except those that are made confidential by state or federal law. District 877 will comply with the request as soon as possible or within five days of the date of the request, excluding Saturday, Sunday, and legal holidays. If we can’t comply within five days, the parent will be notified and an additional five days will be permitted.

VISITORS

Any visitors who come to the school during the school day must sign in and wear an identification badge. We ask that all visitors follow these procedures so that we can ensure the safety of our students. Students are not to bring other student guests during the school day. Requests for visitations due to extenuating circumstances must be cleared by administration at least one week in advance.

BUS POLICIES

Each fall, the school sends out a transportation policy that explains bus rules. Riding the bus is a privilege, not a right and failure to follow the rules will mean loss of bus riding privileges. It is also the expectation that all students will ride his or her own bus to and from school. It is district policy that students may not ride to school or home on another student’s bus.

ACADEMIC INFORMATION

ACADEMIC INTEGRITY

All BCMS students are expected to adhere to the fundamental values of academic integrity, which include honesty, trust, fairness, respect and responsibility. Scholastic dishonesty is defined as cheating on assignments or tests, plagiarizing, altering, fabricating, forging, or acting alone or in cooperation with another to falsify records or to obtain dishonestly, homework, tests or grades.

PRIME TIME (Putting Relationships In My Education To Improve My Existence)

At the beginning of each school day, all BCMS students meet in Prime Time groups. These groups include sixth, seventh, and eighth graders together with an advisor, who will remain with the group all three years. This time will be spent learning about our school and one another, developing relationships, promoting reading and academic skills and having an adult who is there to answer any questions for you. Prime Time also is the place where “Bison Binder” organization and study skills will be taught and maintained.

STUDENT GRADE REPORTS

Parents and students will have access to mid-term progress reports and term report cards through the Infinite Campus portal. Parents must request a paper copy of report cards if they so desire. Please contact Kim Dingmann with requests (682-8207).

INCOMPLETE GRADES

Students must complete all coursework before the end of the term. In the event that an extenuating situation exists which may require additional time for completing coursework, a student must complete the required coursework on a timeline set by the instructor or the grade will change to an F by midterm of the following quarter.

GRADING SYSTEM

Buffalo Community Middle School's grading system is based on the following 12-point system:

(A+) = 12	(B) = 8	(C-) = 4	(F) = 0
(A) = 11	(B-) = 7	(D+) = 3	
(A-) = 10	(C+) = 6	(D) = 2	
(B+) = 9	(C) = 5	(D-) = 1	

Students will be recognized for scholastic achievement by a published honor roll. To be included on the "A" honor roll, students must achieve a grade point average of 10.00 or above. To be included on the "B" honor roll students must achieve a grade point average (GPA) from 7.000 to 9.999. Students in the 8th grade Geometry class will receive one high school credit upon successful completion of the course.

ACADEMIC AWARDS

PRESIDENTIAL ACADEMIC AWARD

Buffalo Community Middle School recognizes superior academic achievement. Students with a cumulative 11.0 grade point average for the first three quarters will receive a Presidential Academic Award Certificate.

STUDENT OF THE WEEK

Every two weeks, teams and departments name two "Students of the Week". Students receive a certificate from their teacher(s) describing positive contributions they have made to our school. Once a quarter, students and parents are invited to a morning breakfast and recognition ceremony.

8TH GRADE STUDENT OF DISTINCTION

Each month, our teachers collectively vote for an eighth grade Student of Distinction. This student leader is selected based on the attitude, character, respect, compassion, service, courage, and integrity exhibited throughout their middle school experience. At the end of the school year, a poster of selected students will be posted in our mall area.

ATTENDANCE PROCEDURES

STATEMENT OF PURPOSE

The administration and faculty of Buffalo Community Middle School believe that regular school attendance is a significant and valuable component of a student's education. Regular attendance is directly correlated to successful academic achievement. Moreover, consistent school attendance is one means by which a student develops responsibility and

self-discipline. For these reasons, student absence from school should be limited to those instances in which it is unavoidable. Each student, his or her parent or guardian, and the school share an obligation to encourage and ensure the student's continuous school attendance. The school may request medical verification for excessive absences. This philosophy is reflected and implemented in the Attendance Policy of Buffalo Community Middle School.

WHAT TO DO IF ABSENT: CALL THE ATTENDANCE HOTLINE: 763-682-8242

If a student is gone from school for any reason, parents or guardians need to call the absence in to the attendance hotline listed above, or send a note to school with their son or daughter as to why they missed. A student will be considered absent when the student is missing from school for any day or part of the day. When medical absences from school reach ten or more, a letter requesting medical verification may be sent home. From that point on, all additional absences will require medical verification to be considered excused.

REPORTING PROCEDURE

Before or on the morning of a student's absence, the student's parents or guardian is requested to call the attendance clerk's voice mail at 682-8242. This number may be accessed 24 hours a day. Students and parents should be aware that if the school does not receive verification to excuse the absence within two days of the absence, the absence may become a truancy.

STUDENT ABSENCES

The school reserves the right to excuse a student from school. Valid excuses for absence/tardies may include: illness, medical or dental appointments, death of a family member or close relative, religious reasons, official school field trips, co-curricular events, suspension, a significant family event, and other absences/tardies at the discretion of the building administration. Absences/tardies, which are not listed above and are not excused by administration, shall be considered unexcused. This includes missing the bus or oversleeping.

MAKE-UP WORK

Students who are absent because of activities, vacations, and other scheduled or pre arranged activities must notify the office in advance before their absence or the absence may be considered unexcused/truant. Advanced notification forms are available in the office. Homework must be completed in advance of the absence or other arrangements must be made with your teachers. When a student returns to class from an unanticipated absence, the teacher will provide make-up work and a clearly defined due date for that make-up work.

TARDINESS

We believe that being on time is a very important life skill and vital to academic success. Students are expected to be in class when the class begins. Students who are tardy at the start of the school day should report to the front desk and sign in.

Classroom Tardies

1. Warning
2. Teacher call home to parent
3. Detention assigned at the discretion of the teacher (i.e. with teacher after school, Tuesday through Friday afternoon detention, staying in at lunch, etc.)
4. Referral to administration

TRUANCY

Definition: When a student is absent from any class without parental request and administrative approval, the absence is considered a truancy. Absences that are not excused within two days are truanancies. Remember, the attendance telephone line is accessible 24 hours a day. It is the parent and student's responsibility to make sure his or her absences are verified. Minnesota law defines a student as "continuing truant" after only three class periods without a valid excuse on three

different days. At this point a letter will be sent out to parents stating the school’s concern. A child becomes a “habitual truant” in the eyes of the law when he or she is absent without a valid excuse for one or more class periods of seven school days. At this point a truancy petition will be filed with the county, and parents will be required to provide a doctor’s excuse for any future absences. A doctor’s note may also be required for excessive excused absences.

EXPECTED BEHAVIORS AND REQUIREMENTS

BUILDING A POSITIVE SCHOOL COMMUNITY

Each day, we ask our students to live up to the high expectations that we have for them. Positive behaviors need to be demonstrated while at school, at school activities, and when representing our school in the community. In our mall area, we have posted seven words to help guide our thoughts and actions. We will spend time in Prime Time exploring what these words mean along with how we can maximize our middle school experience by staying true to these words. The matrix below helps define what respect, attitude, and integrity looks like at BCMS.

Attitude Character Compassion Courage Integrity Respect Service



Respect

Attitude

Integrity

	Lunchroom	Halls	Bathroom	Classroom	Bus (Also part of school day)
Respect	<ul style="list-style-type: none"> <input type="checkbox"/> Put trash in cans, and neatly stack trays <input type="checkbox"/> Make sure your area is clean before you leave 	<ul style="list-style-type: none"> <input type="checkbox"/> Keep locker clean <input type="checkbox"/> Walk <input type="checkbox"/> Keep to the right 	<ul style="list-style-type: none"> <input type="checkbox"/> Keep area clean <input type="checkbox"/> Be mindful of others' personal space 	<ul style="list-style-type: none"> <input type="checkbox"/> Be on time <input type="checkbox"/> Be prepared <input type="checkbox"/> Attend regularly <input type="checkbox"/> Follow class rules 	<ul style="list-style-type: none"> <input type="checkbox"/> Be to your stop on time <input type="checkbox"/> Keep the bus seats and floors clean <input type="checkbox"/> Stay seated and keep aisle open
Attitude	<ul style="list-style-type: none"> <input type="checkbox"/> Be courteous to all staff and students <input type="checkbox"/> Monitor noise level 	<ul style="list-style-type: none"> <input type="checkbox"/> Monitor time to get to class <input type="checkbox"/> Be courteous to all staff and students <input type="checkbox"/> Monitor noise level 	<ul style="list-style-type: none"> <input type="checkbox"/> Be a good example to other students <input type="checkbox"/> Try to use bathroom during passing time <input type="checkbox"/> Return to class promptly 	<ul style="list-style-type: none"> <input type="checkbox"/> Do your best on all assignments and assessments <input type="checkbox"/> Be an active learner <input type="checkbox"/> Enter and exit orderly 	<ul style="list-style-type: none"> <input type="checkbox"/> Get on and off the bus calmly <input type="checkbox"/> Share the seat while keeping hands and feet to self <input type="checkbox"/> Be friendly and listen to the bus driver
Integrity	<ul style="list-style-type: none"> <input type="checkbox"/> Walk to and from lunch <input type="checkbox"/> Keep your own place in line <input type="checkbox"/> Maintain personal boundaries 	<ul style="list-style-type: none"> <input type="checkbox"/> Be considerate of your and others' personal space <input type="checkbox"/> Use appropriate language <input type="checkbox"/> Pick up trash off the floor 	<ul style="list-style-type: none"> <input type="checkbox"/> Report any vandalism immediately <input type="checkbox"/> Leave the room better than you found it <input type="checkbox"/> No technology use 	<ul style="list-style-type: none"> <input type="checkbox"/> Do your own work <input type="checkbox"/> Give everyone a chance to learn <input type="checkbox"/> Use technology for academic purposes with teacher permission 	<ul style="list-style-type: none"> <input type="checkbox"/> Ride only your own bus <input type="checkbox"/> Use appropriate voice level and language <input type="checkbox"/> Support other students

EXPECTED BEHAVIORS AND REQUIREMENTS

1. Be on time and prepared! Be attentive and participate in classroom activities. Make an effort each day to be successful.
2. Show respect for teachers, other students, and school property by not engaging in activities that disturb the class or school environment.
3. Take care of school property. Help keep classrooms and our school neat and clean.
4. Keep personal property in your possession or in your assigned locked locker.
5. Pictures and video taken by non-school personnel on school grounds or during school sponsored activities is not allowed without written consent.

6. Students will have opportunities to recite the Pledge of Allegiance. Any person may elect not to and students must respect another person's right to make that choice.
7. Skateboards, rollerblades, and roller shoes are not to be used on school property.
8. All bikes must be locked on bike racks, which are located on the East side of the school. For safety, bikes are not to be used in the bus loading area. Skateboards, rollerblades and roller shoes should not be used on school property.
9. Please refrain from having food and beverage in carpet and gymnasium areas and keep energy drinks at home.

COMPUTER/INTERNET USAGE

During the first weeks of school, all students will receive copies of the Buffalo Community Middle School computer and Internet Usage Policy. Students will sign a sheet saying that they know, understand and will abide by these policies. Computers at Buffalo Community Middle School are to be used for schoolwork and all printing must be related to school projects. Any electronic device that you bring to BCMS will be under the same guidelines.

CELL PHONES AND OTHER PERSONAL ELECTRONIC DEVICES (PED's)

Handheld devices such as cell phones and other electronic devices may be appropriately used before school until 8:50 AM. By 8:50 AM when the school day begins, all devices must be turned off and properly stowed away in lockers and students need to be in their first period class ready to begin. Personal devices may be used during passing times, as well as, after 3:25 PM. Teachers may allow students the use of phone's during instructional time for instructional purposes only. If students choose to bring a phone to school, the school is not responsible for loss, damage, or theft. If technology misuse is an issue, the student's parent may be required to pick the item up at school and the student may lose the privilege of bringing their device to school. Operation of all electronic devices are prohibited in bathroom and locker room areas.

APPROPRIATE CLOTHING / ACCESSORIES

Clothing acceptable for school does not jeopardize anyone's health or safety, does not disrupt the teaching/learning process, does not create school disorder, and is not immodest in any respect. Parents are asked to be observant of what their child wears to school and to assist in selecting appropriate clothing. No short shorts or skirts and low cut blouses or tops will be allowed. There will be no midriffs or undergarments showing. Students are asked to respectfully remove their headwear upon arriving at their locker. Students may not wear clothing or accessories which display words or images advertising directly or indirectly, alcohol, tobacco, drugs or related products or which promote the use of these products or which are profane, obscene, or sexually suggestive. During physical education swim units, female students are required to wear a one-piece swimsuit or cover up a two-piece suit with a tank top or t-shirt. Students wearing improper attire will be required to correct it at school if possible or be required to call home for a change of clothes.

STUDENT TOBACCO USE POLICY

Buffalo Community Middle School is a tobacco free school. Student use and/or possession of tobacco in any form including E-Cigarettes will not be permitted on or adjacent to, or within sight of any district property, on district property, on district school buses or loading or unloading areas or at any school event, home or away. Minnesota State Law prohibits anyone under 18 to possess/use tobacco. In addition to receiving school consequences, violators will be referred to the School Resource Officer.

DRUGS AND ALCOHOL

The possession or use of drugs or alcohol is a serious violation of state laws and punishable by fines and/or imprisonment. Violators will be reported to the proper authorities and/or social agencies. Students who are under the influence of chemicals while at school, or who consume, sell, give away or have possession of drugs, paraphernalia, or alcohol on school property or at school sponsored activities may be suspended or expelled from school. Illegal substances and related items will be confiscated. All over-the-counter drugs must be kept in the Health Office. Before a suspended student can be readmitted to school, a conference consisting of parents, student and the principal will be arranged to determine the best course of action for the student and the school. If exclusion or expulsion is recommended, it will follow state law. In addition, principals may send a student home if the principal suspects (via smell, action, and/or appearance) that a student

has used drugs/alcohol. Our goal is to handle the situation in a manner that is in the best interest of the student, the student body and staff.

BEHAVIOR INTERVENTIONS

Various intervention strategies will be used when infractions of school rules occur including consequences such as detentions, suspension, or in severe cases, expulsion. Parent conferences are necessary for re-admittance following a student suspension. Our school resource officer may talk to students about any school rule infraction.

SUSPENSION

Occasionally it becomes necessary to suspend a student from school. In this event, the Minnesota State Law (MSA 121A.46-127.40) will govern all procedures: Students may be suspended from school for any of the following:

1. Willful violation of any school regulation.
2. Willful conduct which materially and substantially disrupts the right of others to an education (this includes test cheating, harassment, threats of physical or mental harm, and/or offensive language).
3. Willful conduct which endangers persons or property (fighting, vandalism, stealing).
4. Other violations included in the District School Discipline Policy.

wRight CHOICE

wRight Choice is an alternative to suspension program for Wright County students in grades 6-12 located in the lower-level of the Buffalo Courthouse. Students attending wRight Choice can keep up on their schoolwork with help from a licensed teacher. The day is scheduled from 8 a.m. to 2 p.m. with the morning devoted to academic support and the afternoons alternating between probation; presentations about chemical health, children's mental health and public health; truancy intervention; and community service. Generally, BCMS administration has used this program when suspensions have not proven to be effective.

EXPULSION

Expulsion as defined by Minnesota State Law (MSA 127.26 - 127.40):

“Expulsion” means an action taken by a school board to prohibit an enrolled pupil from further attendance for a period that shall not extend beyond one calendar year. Students will be recommended to the Board of Education of Independent School District #877 for expulsion from school for severe or persistent violation of school policy.

SCHOOL SAFETY

All doors are to remain locked during normal school hours with the exception of the south side of the building by the main office. Students are asked to help us by not opening any back doors for any reason during the day. All district employees have identification badges to wear during student contact hours. Any visitor, parent, or worker should register in the office and wear a visitor's badge. If you see anyone without a badge, please tell the nearest adult. If you hear any information that could result in harm to any person or property, report that information to the nearest adult.

Video cameras are used throughout the hallways to ensure student safety. We have regularly scheduled fire drills, severe weather drills, and lockdown drills each year. Please participate and cooperate as if they are real so we can be prepared for these situations if they occur.

DANGEROUS WEAPONS POLICY

It is the policy of the Independent School District 877 to maintain a learning and working environment that is free from threats or harmful influence of any person(s) or group(s) that exhibit and promote violence and disruptive behaviors. The

Board of Education is committed to promoting healthy human relationships, working and learning environments that are physically and psychologically safe. It shall be a violation of this policy for any pupil or staff member to possess a firearm or a dangerous weapon when in the school building, or school grounds, on the school bus or on any school-related activity. District personnel or students shall not bring or store a “dangerous weapon” on school property. This policy does not apply to firearm safety, color guard or marksmanship courses or approved activities that may be conducted on school property.

RACIAL/RELIGIOUS/SEXUAL HARASSMENT & HAZING

It is the policy of Independent School District 877 to maintain a learning and working environment that is free of Racial/Religious/Sexual Harassment & Violence. It shall be a violation of this policy for any student or employee of School District 877 to harass a student or employee through conduct or communication of a racial/religious sexual nature or hazing nature. The school district will act to investigate all complaints, either formal or informal—verbal or written. The school district will discipline any student or employee who violates this policy. Students are requested to complete a “Student Concern Report Form” to provide documentation of any Racial/Religious/Sexual Harassment & Hazing. These forms are available from a principal or the front office.

RELEASE OF STUDENT DIRECTORY INFORMATION

In accordance with the Minnesota Data Practices Act, Buffalo-Hanover-Montrose Schools may release the following information without permission unless the district has been notified that it should not be released:

- Student’s name, address and telephone number
- Student’s gender and date and place of birth
- Major Field of study
- Participation in officially recognized activities and sports
- Weight and height of members of athletic teams
- Dates of attendance and grade levels completed
- Degrees and awards received
- Most recent previous educational agency or institution attended
- Photographs for school district publications and local newspaper

*Parents or students ages 18 or older who do not want this information released must notify the district in writing by October 1, 2016.

*Throughout the year, photographs are taken in classrooms and at school activities. Some of these may be published in district publications or submitted to local newspapers. Parents may request that their children’s photographs and identifying names not be published. This request must be made in writing to the District Communications Coordinator.

BULLYING (Board Policy 514)

A safe and civil environment is needed for students to learn and attain high academic standards and to promote healthy human relationships. Bullying, like other violent or disruptive behavior, is conduct that interferes with students’ ability to learn and teacher’s ability to educate students in a safe environment and is expressly prohibited on school property or at school-related functions. “Bullying” means any written, verbal or visual expression, physical act or gesture, or pattern thereof, by a student that is intended to cause or is perceived as causing distress to a student or a group of students and which substantially interferes with another student’s or students’ educational benefits, opportunities, or performance. Any bullying should be reported to our building principals immediately.

For a more comprehensive listing of Independent School District 877 policies, please visit the following website:

<http://www.bhmschools.org/information/policies>

CRIMINAL HISTORY BACKGROUND CHECK

Buffalo-Hanover-Montrose Schools is required to conduct a criminal history background check on all individuals who are offered employment in the district, any type III bus drivers, and on all individuals, except District 877 student volunteers, who provide athletic coaching or other extracurricular services, regardless of whether they receive compensation from the school district.

Recognizing our responsibility to ensure the safety and security of our students and everyone connected with the Buffalo-Hanover-Montrose Schools, we require a criminal history background check for school volunteers and chaperones. Any volunteer or chaperone supervising students or responsible for them will be required to have a background check. The cost of this background check is \$14.00 and is paid by the person requesting to volunteer in the District. Potential volunteers/chaperones will need to fill out a Volunteer Background Authorization Form and pay the fee. This can then be given to the school secretary for processing. If a background check has already been done for the District at another school, an additional background check will not be needed. You can pick up a form in any school office or access it from your school's website.

Parents and volunteers will only need to complete one background check, which at this time will be good for the entire time that their children are attending a district school. Applicants will be notified if they are not eligible to volunteer. Any questions can be directed to the building principal.

The background check will include a county, state and national search. If you have been charged or convicted of anything, please answer yes to this question on the consent form and give specifics. If something shows up on the Criminal Background Check and you did not answer yes, even if it was dismissed, it may prevent you from volunteering. Final approval will be up to the building principal.

PUBLIC NOTICE

Buffalo-Hanover-Montrose ISD 877 gives notice to parents of students currently in attendance in the school district, eligible students currently in attendance in the school district, and students currently in attendance in the school district of their rights regarding the conduct of surveys, collection and use of information for marketing purposes, and certain physical examinations.

1. Parents, eligible students, and students are hereby informed that they have the following rights:
 - a. All instructional materials, including teacher's manuals, films, tapes, or other supplementary material which will be used in connection with any survey, analysis, or evaluation as part of any program funded in whole or in part by the U.S. Department of Education, shall be available for inspection by parents or guardians of students.
 - b. No student shall be required, as part of any program funded in whole or in part by the U.S. Department of Education, without the prior consent of the student (if the student is an adult or emancipated minor), or in the case of an unemancipated minor, without the prior written consent of the parent, to submit to a survey that reveals information concerning:
 - (1) political affiliations or beliefs of the student or the student's parent;
 - (2) mental and psychological problems of the student or the student's family;
 - (3) sex behavior or attitudes;

- (4) illegal, antisocial, self-incriminating, or demeaning behavior;
 - (5) critical appraisals of other individuals with whom respondents have close family relationships;
 - (6) legally recognized privileged or analogous relationships, such as those of lawyers, physicians, and ministers;
 - (7) religious practices, affiliations, or beliefs of the student or the student's parent; or
 - (8) income (other than that required by law to determine eligibility for participation in a program or for receiving financial assistance under such program).
- c. A parent, on behalf of a student or an eligible student, has the right to receive notice and an opportunity to opt the student out of participating in:
- (1) Activities involving the collection, disclosure, or use of personal information collected from students for the purpose of marketing or for selling that information, or otherwise providing that information to others for that purpose.
 - (2) The administration of any third-party survey (non-Department of Education funded) containing one or more of the items contained in Paragraph 1.b., above.
 - (3) Any nonemergency, invasive physical examination or screening that is required as a condition of attendance, administered by the school or its agent, and not necessary to protect the immediate health and safety of a student, except for hearing, vision, or scoliosis screenings, or any physical examination or screening permitted or required under state law.
- d. This notice does not preempt applicable state law that may require parental notification.
- e. The school district has developed and adopted a policy, in consultation with parents, regarding these rights, as well as arrangements to protect student privacy in the administration of protected surveys and the collection, disclosure, or use of personal information for marketing, sales, or other distribution purposes.
- f. The school district will directly notify parents and eligible students of these policies at least annually at the start of each school year and after any substantive changes.
- g. The school district will directly notify parents and eligible students, at least annually at the start of each school year, of the specific or approximate dates of the following activities and provide an opportunity to opt a student out of participating in:
- (1) Collection, disclosure, or use of personal information for marketing, sales, or other distribution.
 - (2) Administration of any protected information survey not funded in whole or in part by the U.S. Department of Education.

- (3) Any nonemergency, invasive physical examination or screening as described above.

[See consent/opt-out for specific activities attached hereto.]

Parents/eligible students who believe their rights have been violated may file a complaint with:

Family Policy Compliance Office
U.S. Department of Education 400 Maryland
Avenue SW Washington, DC 20202-5920