

1 ELECTRICAL SITE PLAN

SCALE: 1/32" = 1'-0"

GENERAL NOTES

- REFER TO SHEET E-1 FOR GENERAL ELECTRICAL NOTES THAT SHALL APPLY TO ALL SHEETS IN THIS SET UNLESS NOTED OTHERWISE IN THE KEYED NOTES.

KEYNOTE LEGEND

- NEW RISER ON EXISTING UTILITY POWER. REFER TO RISER DIAGRAM.
- NEW UTILITY TRANSFORMER AND UNDERGROUND LINES FOR NEW BUILDING SERVICE. PAD SIZING IS APPROXIMATE.
- PROVIDE UNDERGROUND PULL BOX PER UTILITY SPEC.
- EXISTING BUILDING TO BE RENOVATED. MAINTAIN ALL EXISTING ELECTRICAL SERVICES AND EQUIPMENT.
- EXISTING BUILDING TO BE RENOVATED. REFEED EXISTING ELECTRICAL SERVICES AND EQUIPMENT FROM NEW MAIN DISTRIBUTION SWITCHBOARD 'MSB'. REFER TO ONE LINE DIAGRAM.
- BUILDING ADDITION. PROVIDE NEW SERVICE FROM NEW MAIN DISTRIBUTION SWITCHBOARD 'MSB'. REFER TO ONE LINE DIAGRAM.
- EXISTING BUILDING TO REMAIN. MAINTAIN ALL ELECTRICAL SERVICES THROUGHOUT CONSTRUCTION.
- FEEDER TO TRANSITION FROM UNDERGROUND. ENTER THE BUILDING, AND ROUTE TO MEZZANINE TO SERVE NEW TRANSFORMERS. REFER TO ONE LINE AND 3 SERIES PLANS FOR LOCATION OF TRANSFORMERS.
- APPROXIMATE ROUTING FOR UNDERGROUND ELECTRIC.
- (2) SCH80 4" C. FOR UNDERGROUND PRIMARY.
- REFER TO ONE-LINE FOR FEEDER TO FIRE-PUMP.
- EXISTING UTILITY POLE AND TRANSFORMERS TO REMAIN. TRANSFORMERS TO BE FED FROM NEW OVERHEAD PRIMARY LINES. COORDINATE SHUTDOWN WITH OWNER AND MINIMIZE DURATION.
- EXISTING UTILITY POLE AND TRANSFORMERS TO REMAIN.
- NEW POLE MOUNTED TRANSFORMER ON EXISTING POLE. MOUNT TRANSOCKET AND SERVICE DISCONNECT ON SIDE OF BUILDING. REFER TO RISER DIAGRAM.
- REFER TO ONE LINE FOR FEEDER TO ELECTRICAL ROOM.
- THE (2) CIRCUITS INDICATED WILL SERVE THE DIGITAL MARQUEE SIGN. WIRE 2#4, 2#6S IN 1 1/4" CONDUIT. TRANSITION TO A SMALLER WIRE SIZE TO CONNECT TO SIGNAGE.
- PROVIDE EACH SIGNAGE CIRCUIT WITH 20A RATED SWITCH IN NEMA 3R ENCLOSURE AFFIXED TO THE SIGN TO COMPLY WITH NEC ARTICLE 600.
- PROVIDE SIGNAGE WITH WP SERVICE RECEPTACLE. EXTEND CIRCUIT FROM ONE OF THE SIGNAGE CIRCUITS, AHEAD OF THE DISCONNECT, FOR THE RECEPTACLE TO REMAIN IN SERVICE.
- THE CIRCUIT INDICATED WILL SERVE THE MARQUEE LIGHTS. WIRE 2#4, 2#6S IN 1 1/4" CONDUIT. TRANSITION TO A SMALLER WIRE SIZE TO CONNECT TO MARQUEE. RUN CIRCUIT THROUGH NEW CONTACTOR ADJACENT TO PANEL 'AL3' FOR ON/OFF CONTROL.
- PROPOSED ROUTE FOR UNDERGROUND ELECTRICAL CONNECTION TO MARQUEE SIGN. PROVIDE ONE SPARE 1" CONDUIT WITH PULL STRING.
- PROVIDE (1) 4" CONDUIT WITH PULL STRING STUBBED INTO QUAZITE BOX. TO BE UTILIZED FOR FUTURE EXTENSION TO PORTABLES.
- NEW RISER POLE. COORDINATE LOCATION WITH UTILITY.

KEY PLAN

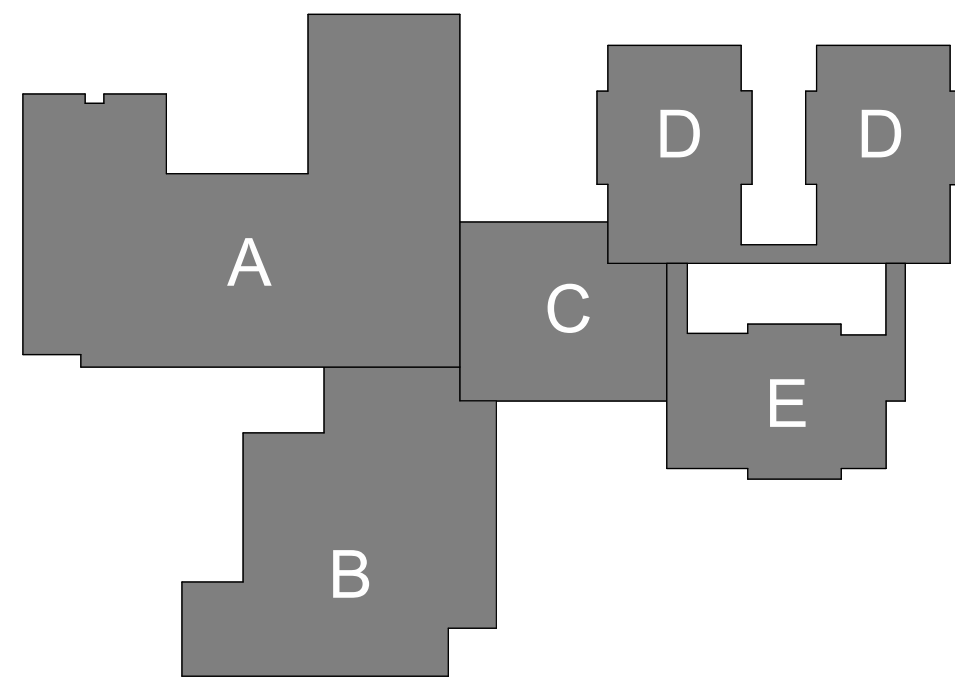

SITE PLAN LEGEND

- NEW BUILDING
- EXISTING BUILDING - MINIMAL SCOPE
- EXISTING BUILDING - FIRE ALARM REPLACEMENT ONLY
- PEC UTILITY EASEMENT

LEGEND

- NEW WORK
- EXISTING TO REMAIN

