

APPROVED FOR FABRICATION

APPROVED
 APPROVED AS NOTED
 RESUBMIT

COMPANY: _____
 BY: _____ DATE: _____

****ELECTRICAL NOTICE****

APPROVER OF FABRICATION AS DRAWN
 HEREIN ACKNOWLEDGES THE ELECTRICAL
 SPECIFICATIONS DEPICTED AND/OR NOTED
 CANNOT BE MODIFIED ONCE
 MANUFACTURING HAS BEGUN.
 APPROVER ACKNOWLEDGES THAT ANY
 ANY ALTERATIONS OF THE EQUIPMENT
 AFTER MANUFACTURING WILL VOID ALL
 WARRANTIES AND UL CERTIFICATION ON
 SAID EQUIPMENT.
 ANY EQUIPMENT ALTERED AFTER
 MANUFACTURING WILL BE SUBJECT TO UL
 REVIEW AND APPROVAL AT OWNER'S
 EXPENSE.

If you are placing equipment into an area which has certain
 standards or codes other than those normally accepted in
 the food - service industry (OS, UL, etc.) Defield must be
 advised of those specifications in detail before fabrication of
 the equipment in order that we may quote additional costs.
 If any. Failure to notify The Defield Company before fabrica-
 tion releases us from any obligation to modify our standards
 without any additional charges.

Shelleysteel®

NOTES:

- * TOPS ARE TO BE 14 GAUGE S/S
- * PROVIDE INTERLOCKS AS REQUIRED
- * ALL STANDARD LOCKING POLYURETHANE CASTERS
- * CORDS STANDARD WITH 90° PLUGS
- * UNITS SPECIFIED WITH DRAINS TO HAVE GATE VALVE AND GARDEN HOSE HOOK UP

* WHEN TRAY SLIDE/WORK SHELF BRACKETS ARE USED: FOLD DOWN BRACKETS ARE STANDARD UNLESS OTHERWISE REQUESTED

* ALL 120 VOLT RECEPTACLES (15 AND 20 AMP) WILL BE GFCI PROTECTED DUPLEXES

ENVIRONMENTALLY FRIENDLY INSULATION

- * KYOTO PROTOCOL COMPLIANT
- * NON O.D.P. (OZONE DEPLETION POTENTIAL)
- * NON G.W.P. (GLOBAL WARMING POTENTIAL)
- * POLYURETHANE INSULATION

* SHELLEYSTEEL: PROVIDE ANGULAR FRAME BASES WITH REINFORCED STAINLESS STEEL SIDE PANELS

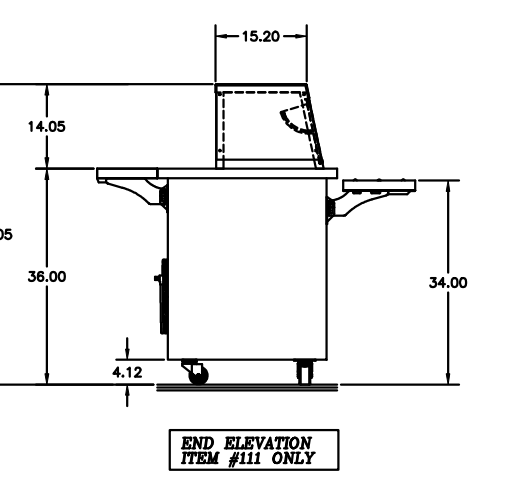
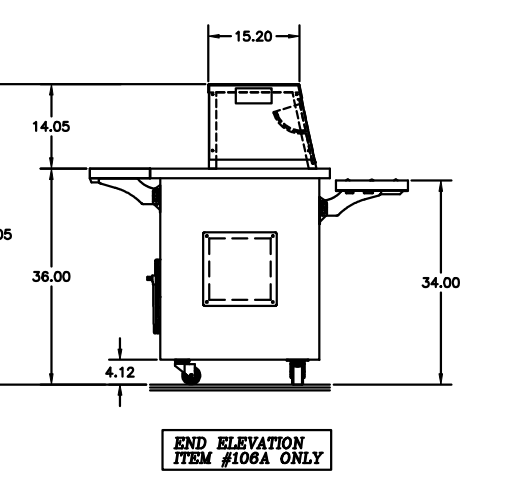
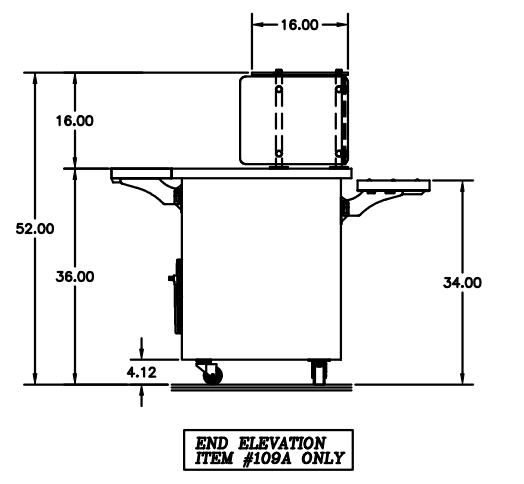
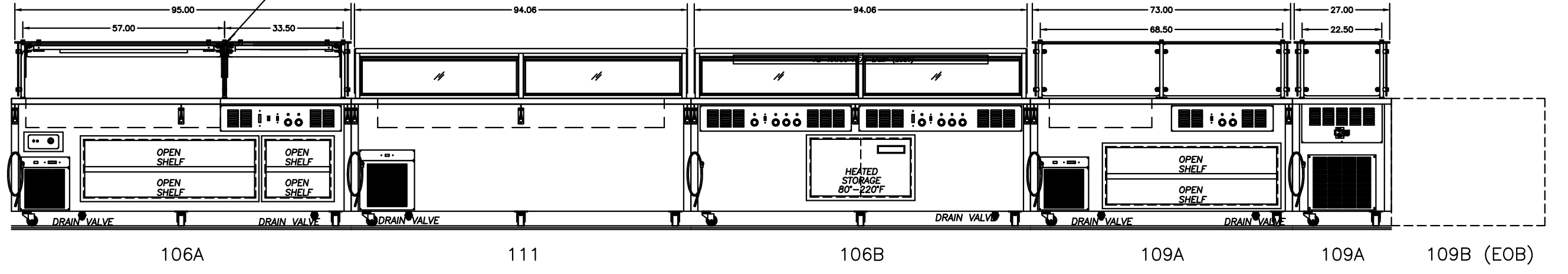
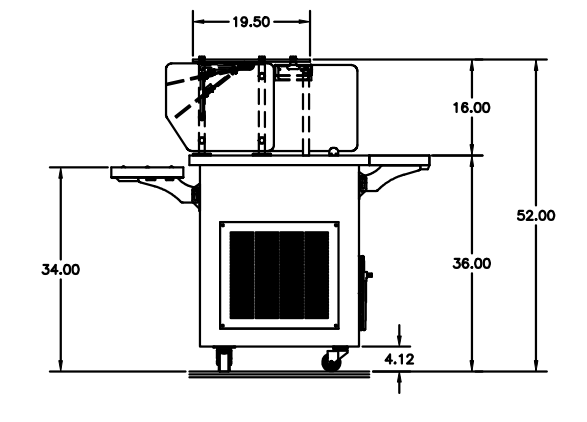
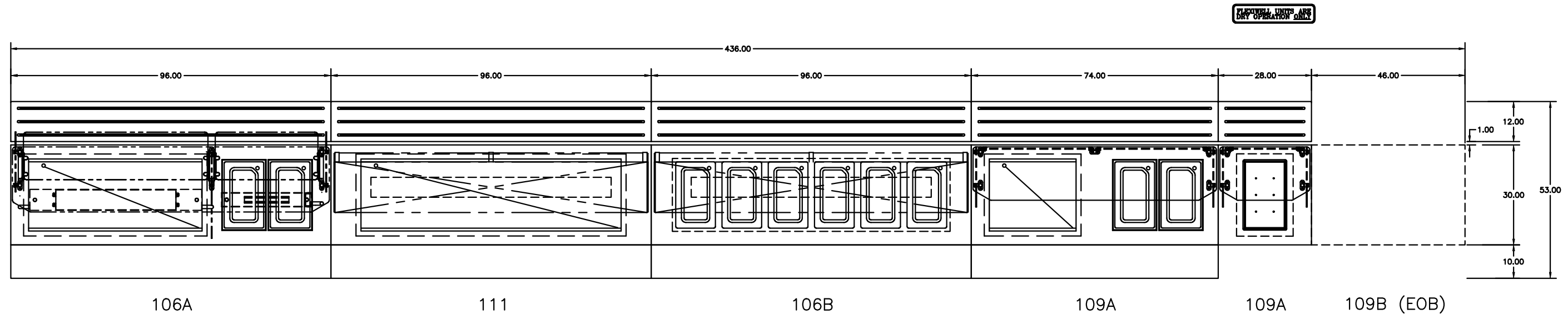
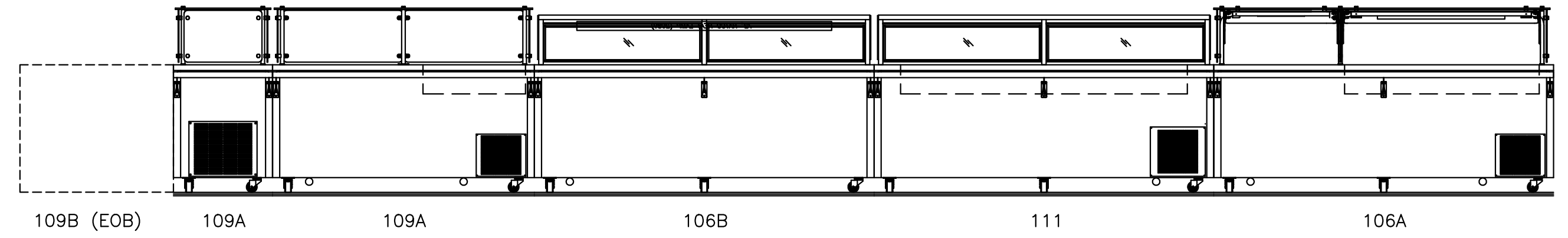
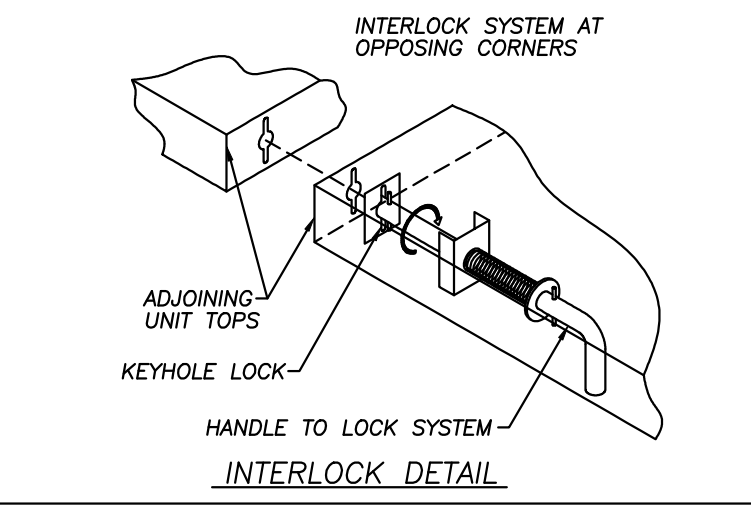

SJU NO. 000-00441KTY
MODEL NO. 2025S ITEM NO. 109A

- SINGLE TIER, SINGLE SERVICE/COOLER PROTECTOR
- FIELD GLASS FRONT
- SUPPORTS WITH S/S FINISH AND HEATING HARDWARE
- 0.38 TEMPERED GLASS TOP
- 0.38 TEMPERED GLASS FRONT AND ENDS
- 0.38 TEMPERED GLASS DIVIDER
- 12 LED LIGHT
- CERV-2000
- INSTALL 12" 30° MATCO GR5AL-36

SJU NO. 000-00441KTY
MODEL NO. 2025S ITEM NO. 109A

- SINGLE TIER, SINGLE SERVICE/COOLER PROTECTOR
- FIELD GLASS FRONT
- SUPPORTS WITH S/S FINISH AND HEATING HARDWARE
- 0.38 TEMPERED GLASS TOP
- 0.38 TEMPERED GLASS FRONT AND ENDS

SJU NO. 000-00441KTY
MODEL NO. 2025S ITEM NO. 109A

- SINGLE TIER, SINGLE SERVICE/COOLER PROTECTOR
- FIELD GLASS FRONT
- SUPPORTS WITH S/S FINISH AND HEATING HARDWARE
- 0.38 TEMPERED GLASS TOP
- 0.38 TEMPERED GLASS FRONT AND ENDS

SJU NO. 000-00441KTY
MODEL NO. 2025S ITEM NO. 109A

- COMBINATION SERVING COUNTER
- ELECTRIC LIGHT ON 3RD HOT FEED
- TABLE WITH BRACKS AND MANIFOLD
- 0.38 TEMPERED GLASS FRONT
- 0.38 TEMPERED GLASS TOP
- 0.38 TEMPERED GLASS DIVIDER
- 12 LED LIGHT
- CERV-2000
- INSTALL 12" 30° MATCO GR5AL-36

SJU NO. 000-00441KTY
MODEL NO. 2025S ITEM NO. 111

- COLD PAN SERVING COUNTER
- 750W BY 60W BY 720 MECH
- COLD PAN WITH DRAIN
- 0.38 TEMPERED GLASS FRONT
- 0.38 TEMPERED GLASS TOP
- 0.38 TEMPERED GLASS DIVIDER
- 12 LED LIGHT
- CERV-2000
- INSTALL 12" 30° MATCO GR5AL-36

SJU NO. 000-00441KTY
MODEL NO. 2025S ITEM NO. 106B

- HEATED SERVING COUNTER
- ELECTRIC LIGHT ON 3RD HOT FEED
- TABLE WITH BRACKS AND MANIFOLD
- 0.38 TEMPERED GLASS FRONT
- 0.38 TEMPERED GLASS TOP
- 0.38 TEMPERED GLASS DIVIDER
- 12 LED LIGHT
- CERV-2000
- INSTALL 12" 30° MATCO GR5AL-36

SJU NO. 000-00441KTY
MODEL NO. 2025S ITEM NO. 109A

- COMBINATION SERVING COUNTER
- ELECTRIC LIGHT ON 3RD HOT FEED
- TABLE WITH BRACKS AND MANIFOLD
- 0.38 TEMPERED GLASS FRONT
- 0.38 TEMPERED GLASS TOP
- 0.38 TEMPERED GLASS DIVIDER
- 12 LED LIGHT
- CERV-2000
- INSTALL 12" 30° MATCO GR5AL-36

SJU NO. 000-00441KTY
MODEL NO. 2025S ITEM NO. 109A

- COMBINATION SERVING COUNTER
- ELECTRIC LIGHT ON 3RD HOT FEED
- TABLE WITH BRACKS AND MANIFOLD
- 0.38 TEMPERED GLASS FRONT
- 0.38 TEMPERED GLASS TOP
- 0.38 TEMPERED GLASS DIVIDER
- 12 LED LIGHT
- CERV-2000
- INSTALL 12" 30° MATCO GR5AL-36

DATE:	
NO. REVISIONS:	
1	
2	
3	
4	
5	

JOB NAME: AURORA EAST HIGH SCHOOL
 DEALER:

VER. SITE: WWW.DEFIELDCOM
 980 S. ISABELLA RD.
 MT. PLEASANT, VT. 08688
 (889) 773-7981 • 800-733-8882
 THIS DRAWING IS THE PROPERTY OF DEFIELD AND IS NOT TO BE REPRODUCED OR USED FOR ANY OTHER PROJECT WITHOUT THE EXPRESS WRITTEN CONSENT OF DEFIELD.

Defield®

SHEET NUMBER:	1 OF 2
DRAWN BY:	JJD
APPROVED BY:	B. MARTIN
DRAWING NUMBER:	1894210_001A
DATE:	1/13/26
SCALE:	3/8" = 1'-0"

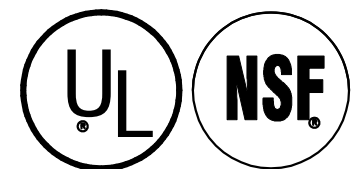

REF: 1640890/1872491

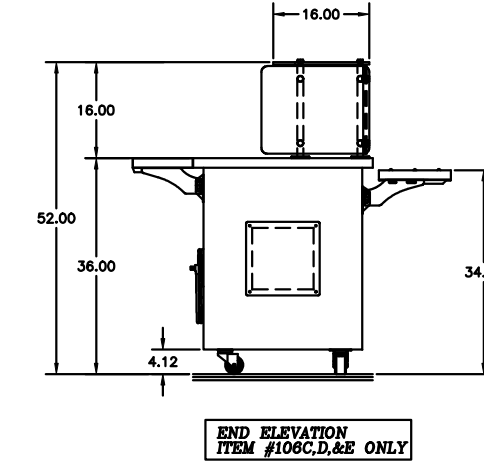
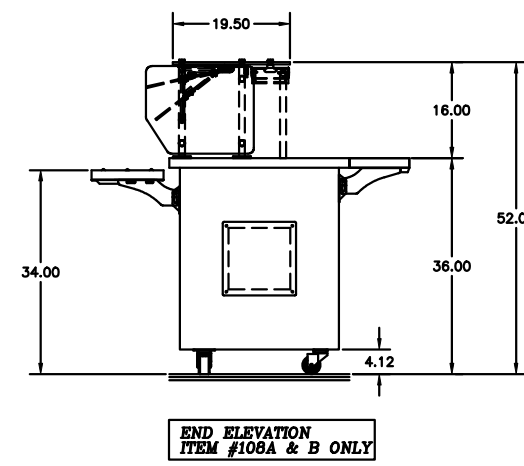
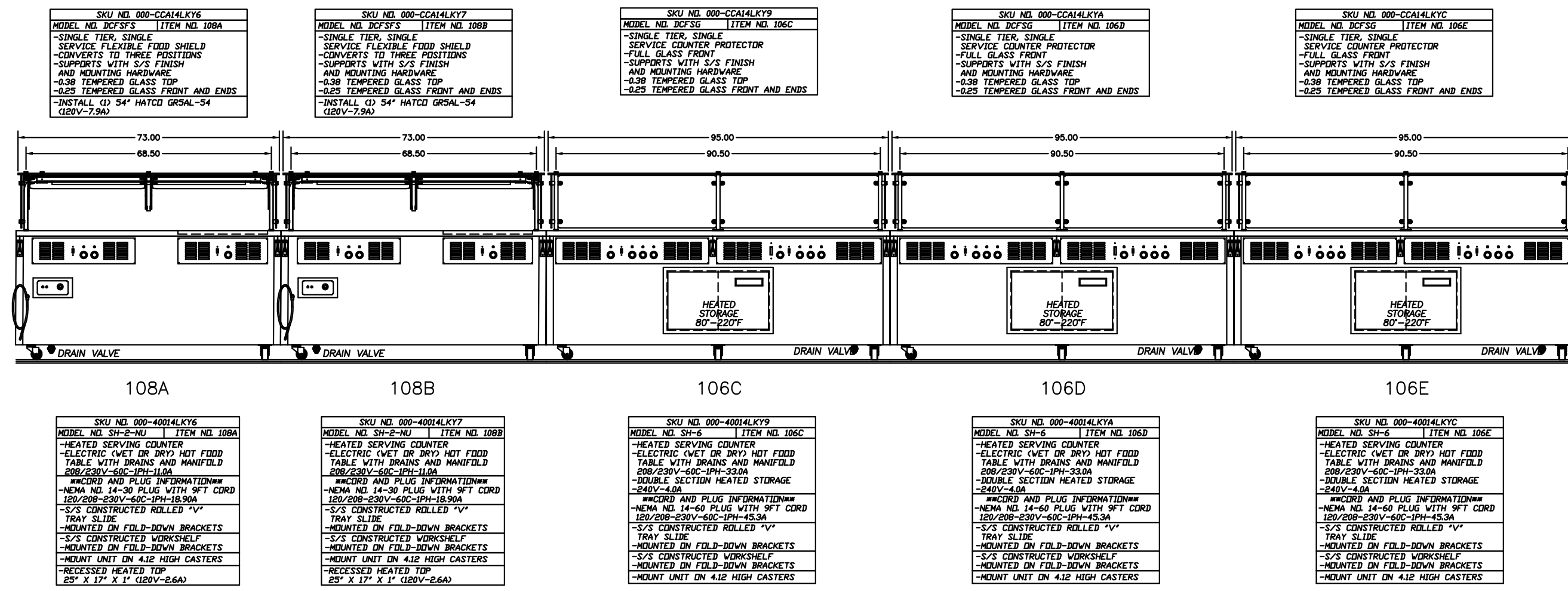
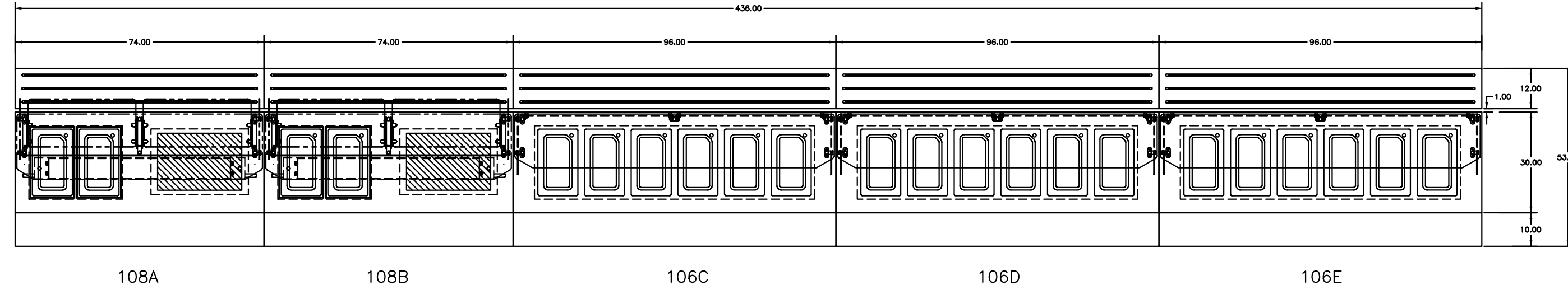
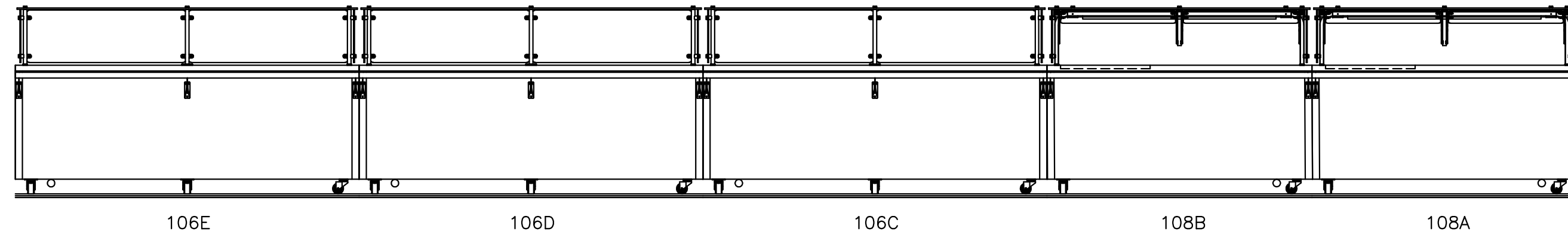

APPROVED FOR FABRICATION

APPROVED
 APPROVED AS NOTED
 RESUBMIT

COMPANY: _____
 BY: _____ DATE: _____

****ELECTRICAL NOTICE****

APPROVER OF FABRICATION AS DRAWN HEREIN ACKNOWLEDGES THE ELECTRICAL SPECIFICATIONS DEPICTED AND/OR NOTED CANNOT BE MODIFIED ONCE MANUFACTURING HAS BEGUN. APPROVER ACKNOWLEDGES THAT ANY ALTERATIONS OF THE EQUIPMENT AFTER MANUFACTURING WILL VOID ALL WARRANTIES AND UL CERTIFICATION ON SAID EQUIPMENT. ANY EQUIPMENT ALTERED AFTER MANUFACTURING WILL BE SUBJECT TO UL REVIEW AND APPROVAL AT OWNER'S EXPENSE.

If you are placing equipment into an area which has certain standards or codes other than those normally accepted in the food service industry (DOP, UL, etc.) Delfield must be advised of those specifications in detail before fabrication of the equipment in order that we may quote additional costs. If any failure to notify the Delfield Company before fabrication releases us from any obligation to modify our standards without any additional charges.

Shelleysteel

NOTES:

- * TOPS ARE TO BE 14 GAUGE S/S
- * PROVIDE INTERLOCKS AS REQUIRED
- * ALL STANDARD LOCKING POLYURETHANE CASTERS
- * CORDS STANDARD WITH 90° PLUGS
- * UNITS SPECIFIED WITH DRAINS TO HAVE GATE VALVE AND GARDEN HOSE HOOK UP

* WHEN TRAY SLIDE/WORK SHELF BRACKETS ARE USED: FOLD DOWN BRACKETS ARE STANDARD UNLESS OTHERWISE REQUESTED

* ALL 120 VOLT RECEPTACLES (15 AND 20 AMP) WILL BE GFCI PROTECTED DUPLEXES

ENVIRONMENTALLY FRIENDLY INSULATION

- * KYOTO PROTOCOL COMPLIANT
- * NON O.D.P. (OZONE DEPLETION POTENTIAL)
- * NON G.W.P. (GLOBAL WARMING POTENTIAL)
- * POLYURETHANE INSULATION

* SHELLEYSSTEEL: PROVIDE ANGULAR FRAME BASES WITH REINFORCED STAINLESS STEEL SIDE PANELS

INTERLOCK SYSTEM AT OPPOSING CORNERS

ADJOINING UNIT TOPS
 KEYHOLE LOCK
 HANDLE TO LOCK SYSTEM
 INTERLOCK DETAIL

DATE:	
BY:	
NO. REVISIONS:	
1	
2	
3	
4	
5	

JOB NAME: AURORA EAST HIGH SCHOOL

DEALER:

980 S. ISABELLA RD.
 MT. PLEASANT, MT. 48858
 (989) 773-7981 • 800-233-8821

THIS DRAWING IS THE PROPERTY OF DELFIELD AND IS NOT TO BE REPRODUCED OR USED IN ANY MANNER WITHOUT THE EXPRESS WRITTEN CONSENT OF DELFIELD.

Delfield

DRAWN BY: JD
 APPROVED BY: B. MARTIN
 DATE: 1/13/26
 SCALE: 3/8" = 1'-0"

SHEET NUMBER: 2 OF 2
 SJ NUMBER: 1894120_002A

(4) REQUIRED
 (1) SHOWN

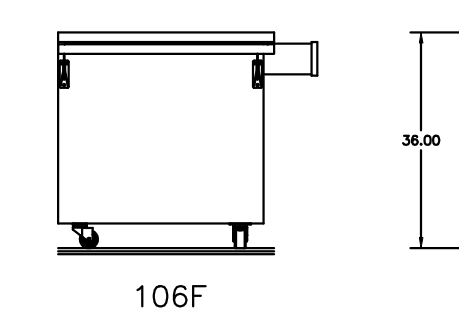
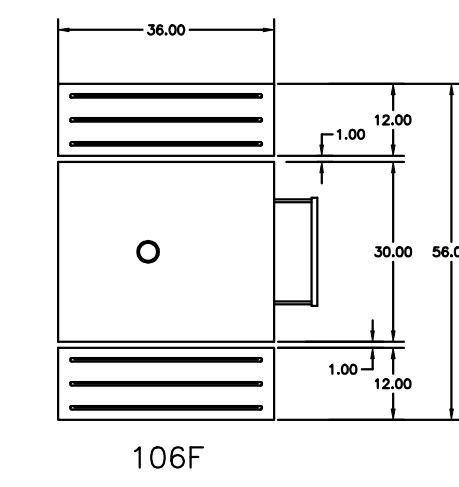

SKU NO. 000-4004LKY6
 MODEL NO. 303-036 ITEM NO. 106F
 -CHAMFER COUNTER
 -3 IN. CHAMFER RELL WITH GROMMET
 -1/2" TRAY SLIDE
 -S/S CONSTRUCTED ROLLER 1/2" TRAY SLIDE
 -MOUNTED ON FOLD-DOWN BRACKETS
 -MOUNT UNIT ON 4.12 HIGH CASTERS

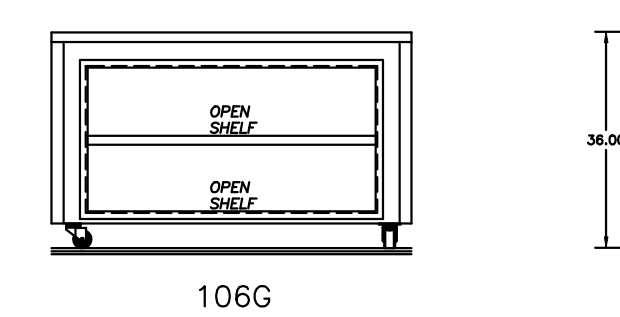
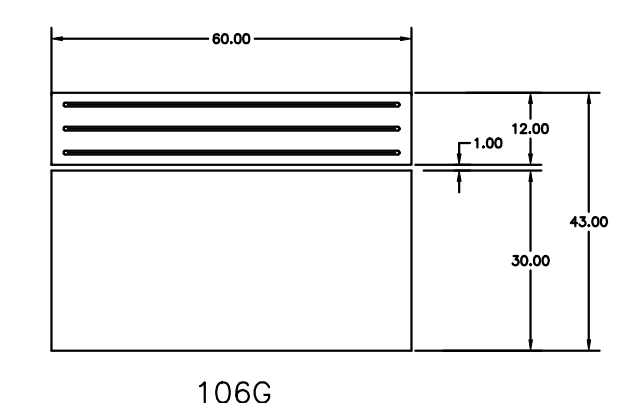

SKU NO. 000-4004LKY7
 MODEL NO. 303-036 ITEM NO. 106G
 -CHAMFER COUNTER
 -S/S CONSTRUCTED ROLLER 1/2" TRAY SLIDE
 -MOUNTED ON FOLD-DOWN BRACKETS
 -MOUNT UNIT ON 4.12 HIGH CASTERS

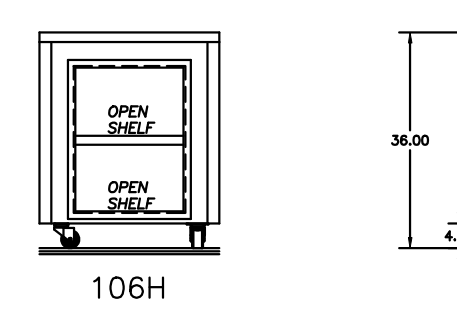
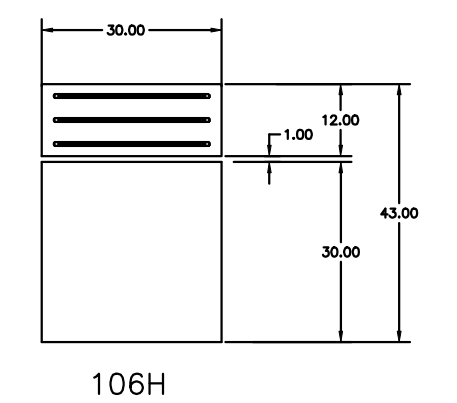

SKU NO. 000-4004LKY7
 MODEL NO. 303-036 ITEM NO. 106H
 -ALL PURPOSE COUNTER
 -S/S CONSTRUCTED ROLLER 1/2" TRAY SLIDE
 -MOUNTED ON FOLD-DOWN BRACKETS
 -MOUNT UNIT ON 4.12 HIGH CASTERS

