

H137 ENGLISH OFFICE - SEATS 20



RENDERED VIEW



RENDERED VIEW

UNIVERSAL STORAGE
CABINETS, LAMINATE TOPS

24X60 ELEMENTAL NEST
AND FOLD TABLES -
CASTERS

WIT CHAIR - CASTERS

WHIMSY OTTOMAN, WITH
LAMINATE TOP

TOP: CLAY NOCE LAMINATE

TOP: CLASSIC LINEN
LAMINATE, CHAMPAGNE EDGE

MESH BACK: NICKEL

FRAME: SILVER

BASE: PLATINUM METALLIC

BASE: CHARCOAL

SEAT: ELEMENT
RUBY

SIDE: DIDI CARBON

JENNY CHAIR - ROUND/CLUB

UPHOLSTERY: BRISA IRON

SLOPING SHELF
BOOK TRUCK

PAINT: NAVY

GENERAL NOTES:
NOT FOR CONSTRUCTION
ALL STRUCTURAL, MECHANICAL & ELECTRICAL ENGINEERING IS THE RESPONSIBILITY OF OTHERS.
ALL FURNITURE & DESIGN DRAWINGS ARE IN CONFIDENCE & DISSEMINATION MAY NOT BE MADE WITHOUT PRIOR WRITTEN CONSENT OF NBS. ALL COMMON LAW RIGHTS OF COPYRIGHT AND OTHERWISE ARE HEREBY SPECIFICALLY RESERVED.
FINAL FURNITURE FIT & PLACEMENT IS SUBJECT TO ANY VARIATION FROM THIS PLAN DUE TO CONSTRUCTION CHANGES, FIELD CONDITIONS, MATERIAL DIFFERENCES OR CHANGES REQUIRED FOR ANY REASON WITH NOTIFICATION TO NBS.
IF NBS DID NOT DESIGN THIS PROJECT, NBS DOES NOT ASSUME RESPONSIBILITY FOR THE DESIGN, SPECIFICATION OF PARTS OR APPLICATION OF PRODUCTS INCLUDED IN THIS BID. NBS HAS ONLY RESPONDED TO THE PRICING REQUEST FOR THE SPECIFICATIONS

APPROVED BY: DATE:

☐ APPROVED ☐ APPROVED AS NOTED

03/14/25	Issued For Preliminary
04/30/25	Issued For AUDIT
06/06/25	Issued For Review

OWNER:
Livonia Public Schools

PROJECT:
DEPARTMENT OFFICES

8900 NEWBURGH RD.
LIVONIA, MI

PROJECT FOLDER:	250318
HEDBERG ORDER #:	TBD
ACCOUNT MANAGER:	MDUGAN
DESIGNER:	MBRY
PROJECT MANAGER	FKREN

**H137
ENGLISH
OFFICE**

DRAWING NUMBER:

ID-3.1A

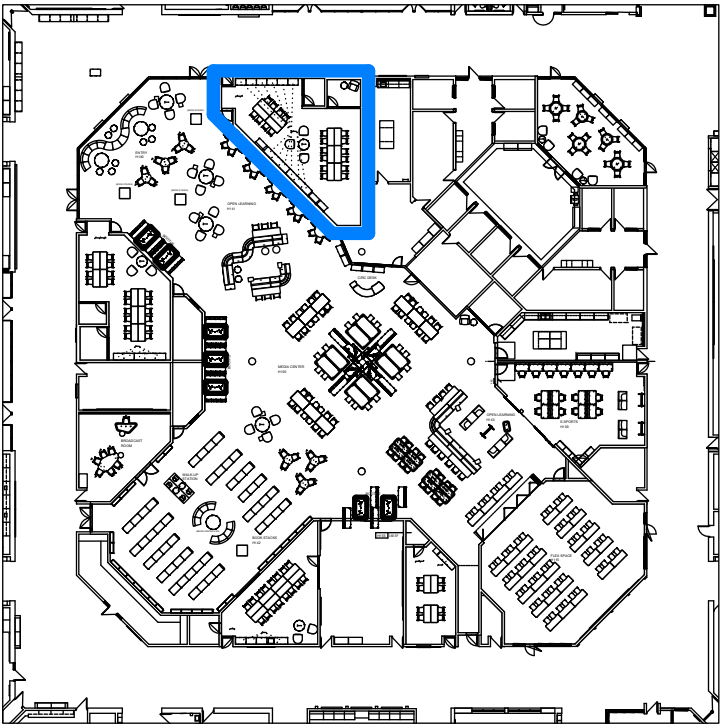

LOCATION PLAN

AUDIT Q#388589



RENDERED VIEW

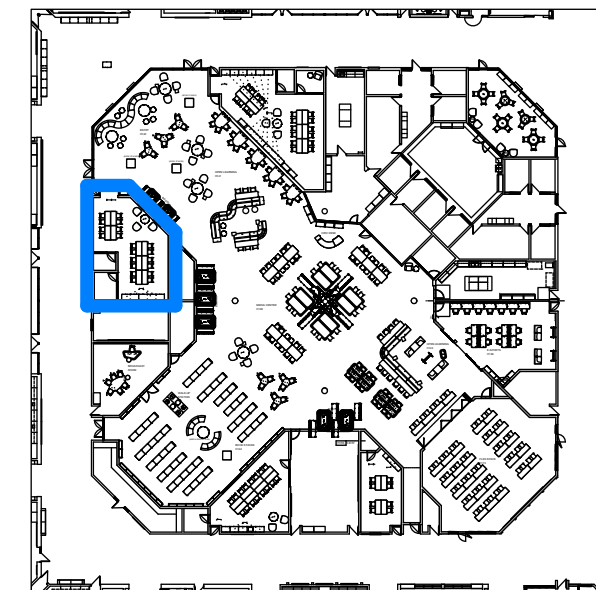
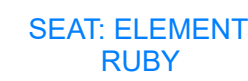
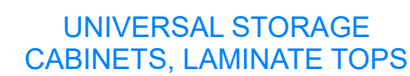

LOCATION PLAN

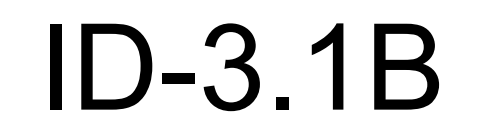
AUDIT Q#388589

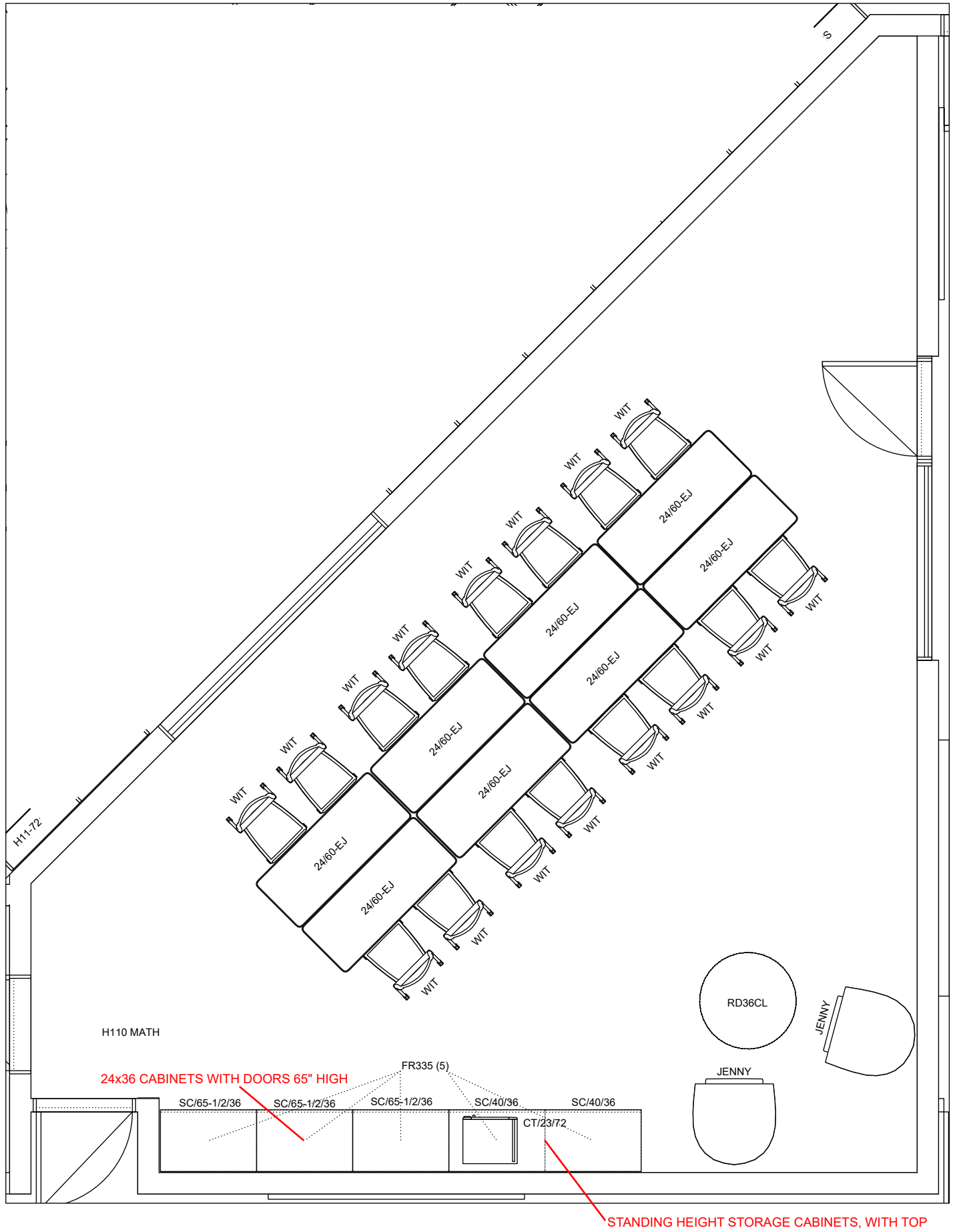

H110 MATH OFFICE - SEATS 16



RENDERED VIEW



RENDERED VIEW

UNIVERSAL STORAGE CABINETS, LAMINATE TOPS

TOP: CLAY NOCE LAMINATE

BASE: PLATINUM METALLIC

24X60 ELEMENTAL NEST AND FOLD TABLES - CASTERS

TOP: CLASSIC LINEN LAMINATE, CHAMPAGNE EDGE

BASE: CHARCOAL

WIT CHAIR - CASTERS

MESH BACK: NICKEL

FRAME: SILVER

SEAT: ELEMENT RUBY

WHIMSY OTTOMAN, WITH LAMINATE TOP

TOP: WHITE NEBBIA LAMINATE

SIDE: DIDI CARBON

JENNY CHAIR - ROUND

UPHOLSTERY: BRISA IRON

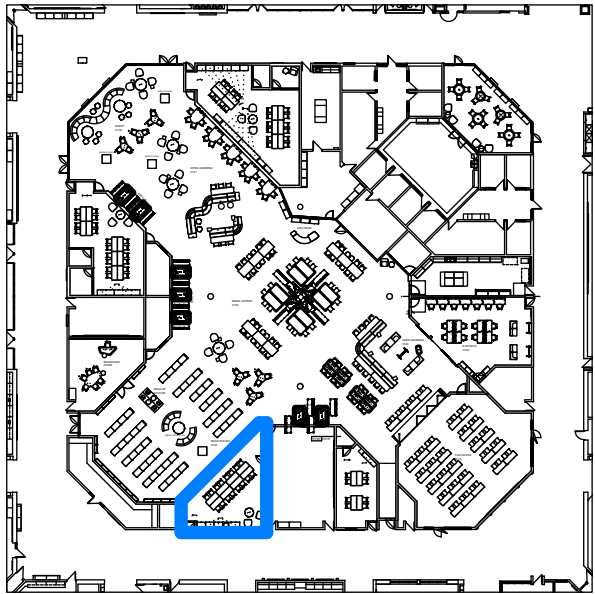

LOCATION PLAN

AUDIT Q#388589

GENERAL NOTES:
NOT FOR CONSTRUCTION
ALL STRUCTURAL, MECHANICAL & ELECTRICAL ENGINEERING IS THE RESPONSIBILITY OF OTHERS.
ALL FURNITURE & DESIGN DRAWINGS ARE IN CONFIDENCE & DISSEMINATION MAY NOT BE MAKE WITHOUT PRIOR WRITTEN CONSENT OF NBS. ALL COMMON LAW RIGHTS OF COPYRIGHT AND OTHERWISE ARE HEREBY SPECIFICALLY RESERVED.
FINAL FURNITURE FIT & PLACEMENT IS SUBJECT TO ANY VARIATION FROM THIS PLAN DUE TO CONSTRUCTION CHANGES, FIELD CONDITIONS, MATERIAL DIFFERENCES OR CHANGES REQUIRED FOR ANY REASON WITH NOTIFICATION TO NBS.
IF NBS DID NOT DESIGN THIS PROJECT, NBS DOES NOT ASSUME RESPONSIBILITY FOR THE DESIGN, SPECIFICATION OF PARTS OR APPLICATION OF PRODUCTS INCLUDED IN THIS BID. NBS HAS ONLY RESPONDED TO THE PRICING REQUEST FOR THE SPECIFICATIONS

APPROVED BY: DATE:

☐ APPROVED ☐ APPROVED AS NOTED

03/14/25	Issued For Preliminary
04/30/25	Issued For AUDIT
06/06/25	Issued For Review

OWNER:
Livonia Public Schools

PROJECT:
DEPARTMENT OFFICES

8900 NEWBURGH RD.
LIVONIA, MI

PROJECT FOLDER:	250318
HEDBERG ORDER #:	TBD
ACCOUNT MANAGER:	MDUGAN
DESIGNER:	MBRY
PROJECT MANAGER	FKREN

H110 MATH OFFICE

DRAWING NUMBER:

ID-3.1C

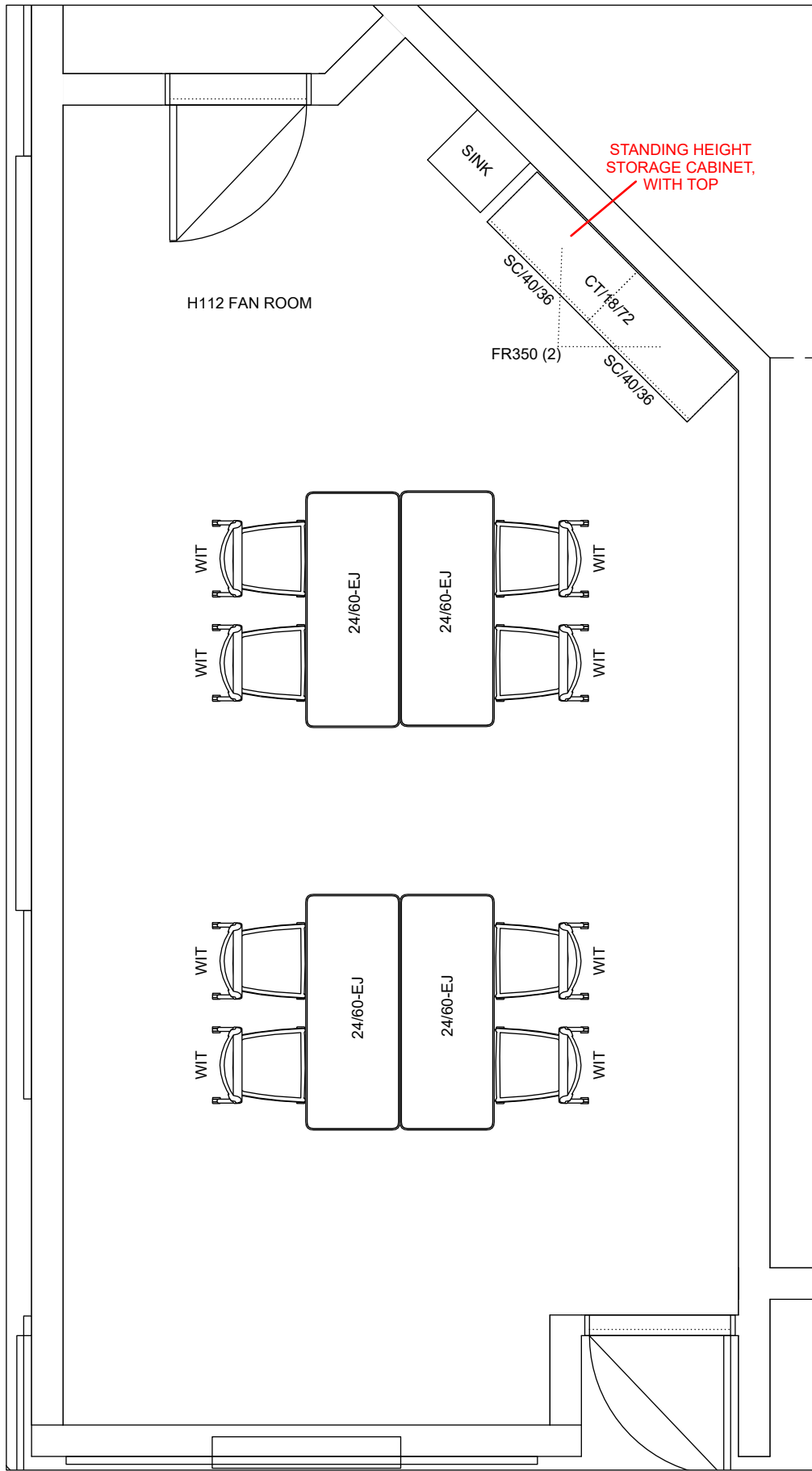

H112 FAN ROOM - SEATS 8



RENDERED VIEW



RENDERED VIEW



UNIVERSAL STORAGE
CABINETS, LAMINATE TOPS



24X60 ELEMENTAL NEST
AND FOLD TABLES -
CASTERS



WIT CHAIR - CASTERS



TOP: CLAY NOCE
LAMINATE



TOP: CLASSIC LINEN
LAMINATE, CHAMPAGNE EDGE



MESH BACK: NICKEL



BASE: PLATINUM
METALLIC



BASE: CHARCOAL



FRAME: SILVER



SEAT: ELEMENT
RUBY

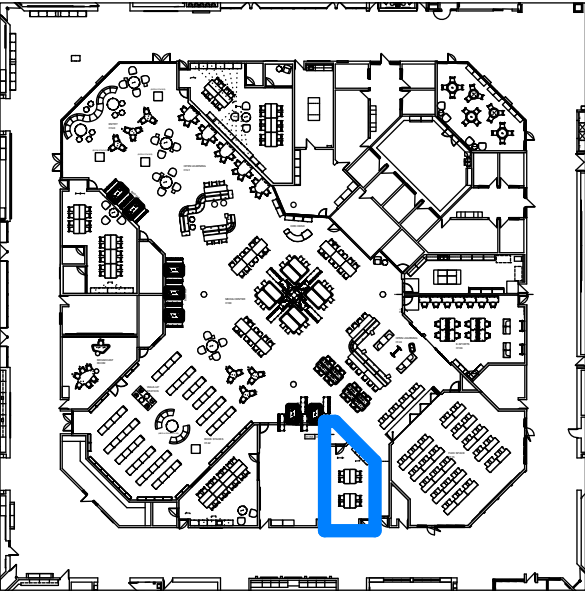

LOCATION PLAN

AUDIT Q#388589

GENERAL NOTES:
NOT FOR CONSTRUCTION
ALL STRUCTURAL, MECHANICAL & ELECTRICAL ENGINEERING IS THE RESPONSIBILITY OF OTHERS.
ALL FURNITURE & DESIGN DRAWINGS ARE IN CONFIDENCE & DISSEMINATION MAY NOT BE MAKE WITHOUT PRIOR WRITTEN CONSENT OF NBS. ALL COMMON LAW RIGHTS OF COPYRIGHT AND OTHERWISE ARE HEREBY SPECIFICALLY RESERVED.
FINAL FURNITURE FIT & PLACEMENT IS SUBJECT TO ANY VARIATION FROM THIS PLAN DUE TO CONSTRUCTION CHANGES, FIELD CONDITIONS, MATERIAL DIFFERENCES OR CHANGES REQUIRED FOR ANY REASON WITH NOTIFICATION TO NBS.
IF NBS DID NOT DESIGN THIS PROJECT, NBS DOES NOT ASSUME RESPONSIBILITY FOR THE DESIGN, SPECIFICATION OF PARTS OR APPLICATION OF PRODUCTS INCLUDED IN THIS BID. NBS HAS ONLY RESPONDED TO THE PRICING REQUEST FOR THE SPECIFICATIONS

APPROVED BY: DATE:

☐ APPROVED ☐ APPROVED AS NOTED

03/14/25	Issued For Preliminary
04/30/25	Issued For AUDIT
06/06/25	Issued For Review

OWNER:
Livonia Public
Schools

PROJECT:
DEPARTMENT OFFICES

8900 NEWBURGH RD.
LIVONIA, MI

PROJECT FOLDER:	250318
HEDBERG ORDER #:	TBD
ACCOUNT MANAGER:	MDUGAN
DESIGNER:	MBRY
PROJECT MANAGER	FKREN

H112 FAN
ROOM

DRAWING NUMBER:

ID-3.1D

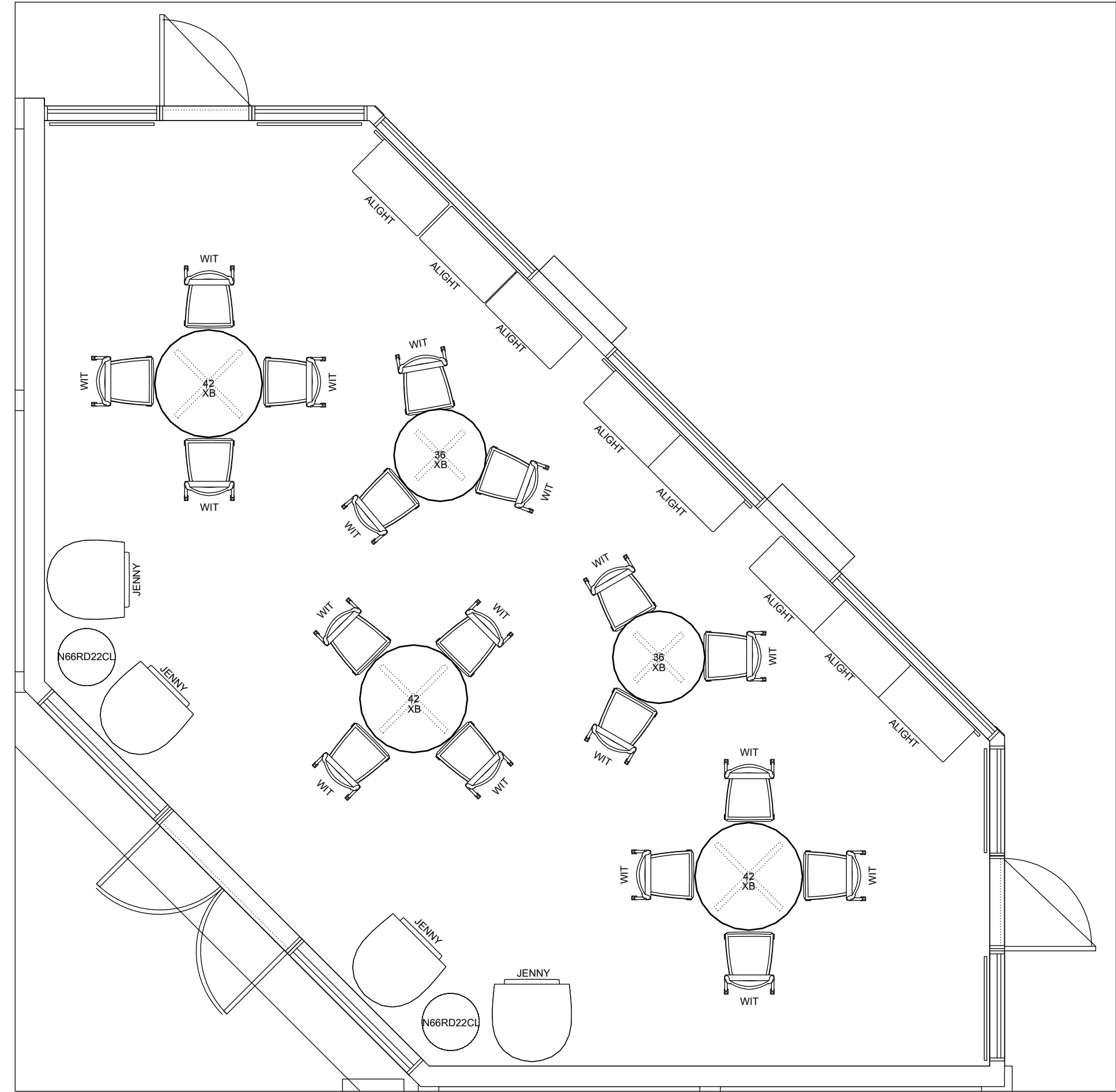

CIC ROOM - SEATS 30

 <p>UNIVERSAL ROUND TABLE, X-BASE 36 AND 42 DIAMETER</p>  <p>TOP: CLAY NOCE LAMINATE</p>  <p>BASE: PLATINUM METALLIC</p>	 <p>WIT CHAIR - CASTERS</p>  <p>MESH BACK: NICKEL</p>  <p>FRAME: SILVER</p>  <p>SEAT: ELEMENT RUBY</p>	 <p>JENNY CHAIR - ROUND</p>  <p>UPHOLSTERY: BRISA IRON</p>	 <p>WHIMSY OTTOMAN, WITH LAMINATE TOP</p>  <p>TOP: WHITE NEBBIA LAMINATE</p>  <p>SIDE: DIDI CARBON</p>	 <p>ALIGHT OTTOMAN</p>  <p>UPHOLSTERY: SWIFT MESA</p>  <p>UPHOLSTERY: BIG DOT GRAPHITE</p>
---	--	--	--	---



RENDERED VIEW



RENDERED VIEW

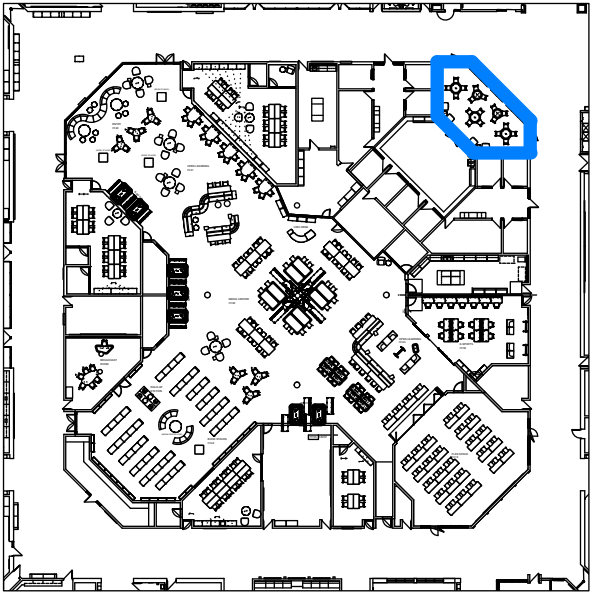

LOCATION PLAN

AUDIT Q#388589

GENERAL NOTES:
NOT FOR CONSTRUCTION
ALL STRUCTURAL, MECHANICAL & ELECTRICAL ENGINEERING IS THE RESPONSIBILITY OF OTHERS.
ALL FURNITURE & DESIGN DRAWINGS ARE IN CONFIDENCE & DISSEMINATION MAY NOT BE MADE WITHOUT PRIOR WRITTEN CONSENT OF NBS. ALL COMMON LAW RIGHTS OF COPYRIGHT AND OTHERWISE ARE HEREBY SPECIFICALLY RESERVED.
FINAL FURNITURE FIT & PLACEMENT IS SUBJECT TO ANY VARIATION FROM THIS PLAN DUE TO CONSTRUCTION CHANGES, FIELD CONDITIONS, MATERIAL DIFFERENCES OR CHANGES REQUIRED FOR ANY REASON WITH NOTIFICATION TO NBS.
IF NBS DID NOT DESIGN THIS PROJECT, NBS DOES NOT ASSUME RESPONSIBILITY FOR THE DESIGN, SPECIFICATION OF PARTS OR APPLICATION OF PRODUCTS INCLUDED IN THIS BID. NBS HAS ONLY RESPONDED TO THE PRICING REQUEST FOR THE SPECIFICATIONS

APPROVED BY: DATE:

☐ APPROVED ☐ APPROVED AS NOTED

04/04/25	Issued For Preliminary
04/23/25	Issued For Review
04/30/25	Issued For AUDIT
06/06/25	Issued For Review

OWNER:
Livonia Public Schools

PROJECT:
DEPARTMENT OFFICES

8900 NEWBURGH RD.
LIVONIA, MI

PROJECT FOLDER:	250318
HEDBERG ORDER #:	TBD
ACCOUNT MANAGER:	MDUGAN
DESIGNER:	MBRY
PROJECT MANAGER	FKREN

DRAWING:

CIC ROOM

DRAWING NUMBER:

ID-3.1E