



**LYNDA GUNSTREAM, RTA
ORANGE COUNTY
TAX ASSESSOR-COLLECTOR**

(409) 882-7971
(409) 769-0064

P. O. BOX 1568
ORANGE, TX 77631-1568
Email: lgunstream@co.orange.tx.us

FAX: (409) 882-7912

DATE: JANUARY 13, 2011
TO: WOS CISD
FROM: LYNDA GUNSTREAM
RE: BID PROPERTY

The account(s) listed below are trust properties on which bids have been submitted. Information on each property and your entity's portion of the bid is attached. The properties in question are:

	CASE #	ACCOUNT #
1	A990188-T	011945-005300
2	A090058-T	011945-011670

The County Commissioner's Court gave County approval for the acceptance of the above listed bid property. Your assistance in presenting this information to your governing body and insuring that it gets placed on the agenda for action will be appreciated. Once presented please complete and fax the attached form indicating the action taken.

If I can be of further assistance, please let me know.

Respectfully,

Lynda Gunstream
Tax Assessor/Collector

NOTIFICATION

**TO: Lynda Gunstream
Orange County Tax Assessor-Collector**

RE: Action Taken on Submitted Bid for Trust Property

On _____ the governing body for WOC CISD voted on the bid property referenced below. The action taken is reflected as indicated below:

Check Appropriate Box

	CASE #	ACCOUNT #	ACTION TAKEN	
			Approved	Disapproved
1	A990188-T	011945-005300		
2	A090058-T	011945-011670		

Signature

Title

Date

Upon approval please sign and fax to:
Lynda Gunstream
Orange County Tax Office
Fax: (409) 882.7912

ACCOUNT #
011945-005300

SUIT #
A1990188-T

LINEBARGER GOGGAN BLAIR & SAMPSON, LLP

ATTORNEYS AT LAW
1949 SOUTH I.H. 35
P. O. BOX 17428
AUSTIN, TEXAS 78760

512/447-6675
FAX 512/443-3494

Douglas Steven Bird

email to steve.bird@publicans.com

December 16, 2010

Ms. Lynda Gunstream, Tax Assessor Collector
Orange County
P. O. Box 1568
Orange, Texas 77631-1568

RE: Bid on trust property described as: Lot 7 - 9 Blk 91 Sheldon
Account # 11945-005300 Suit # A990188-T
Lot 7 - 9 Blk 91 Sheldon
Cherry Ave, Orange

Dear Lynda:

We recently received a bid on the property referenced above currently being held in trust.
Jimmy Mooney tendered the bid. If accepted the bid would be distributed
as noted below.

Amount of Bid: \$ 750.00
Less Court Cost of: \$ 1,172.14
Date of Tax Sale: March 6, 2007
Amount to be Distributed: \$ 0.00

	<u>Tax Amount</u>	<u>Percent of Total</u>	<u>Actual Recovery</u>
West Orange-C CISD	\$ 2,695.44	47.35 %	\$ 0.00
County	\$ 989.36	17.37 %	\$ 0.00
Farm to Market	\$ 13.59	0.24 %	\$ 0.00
Port District	\$ 33.97	0.60 %	\$ 0.00
Drainage District	\$ 167.13	2.94 %	\$ 0.00
City of Orange	\$ 1,793.43	31.50 %	\$ 0.00
Water District	\$ N/A	N/A %	\$ N/A
ESD	N/A	N/A %	\$ N/A
TOTAL	5,692.92	100.00 %	0.00

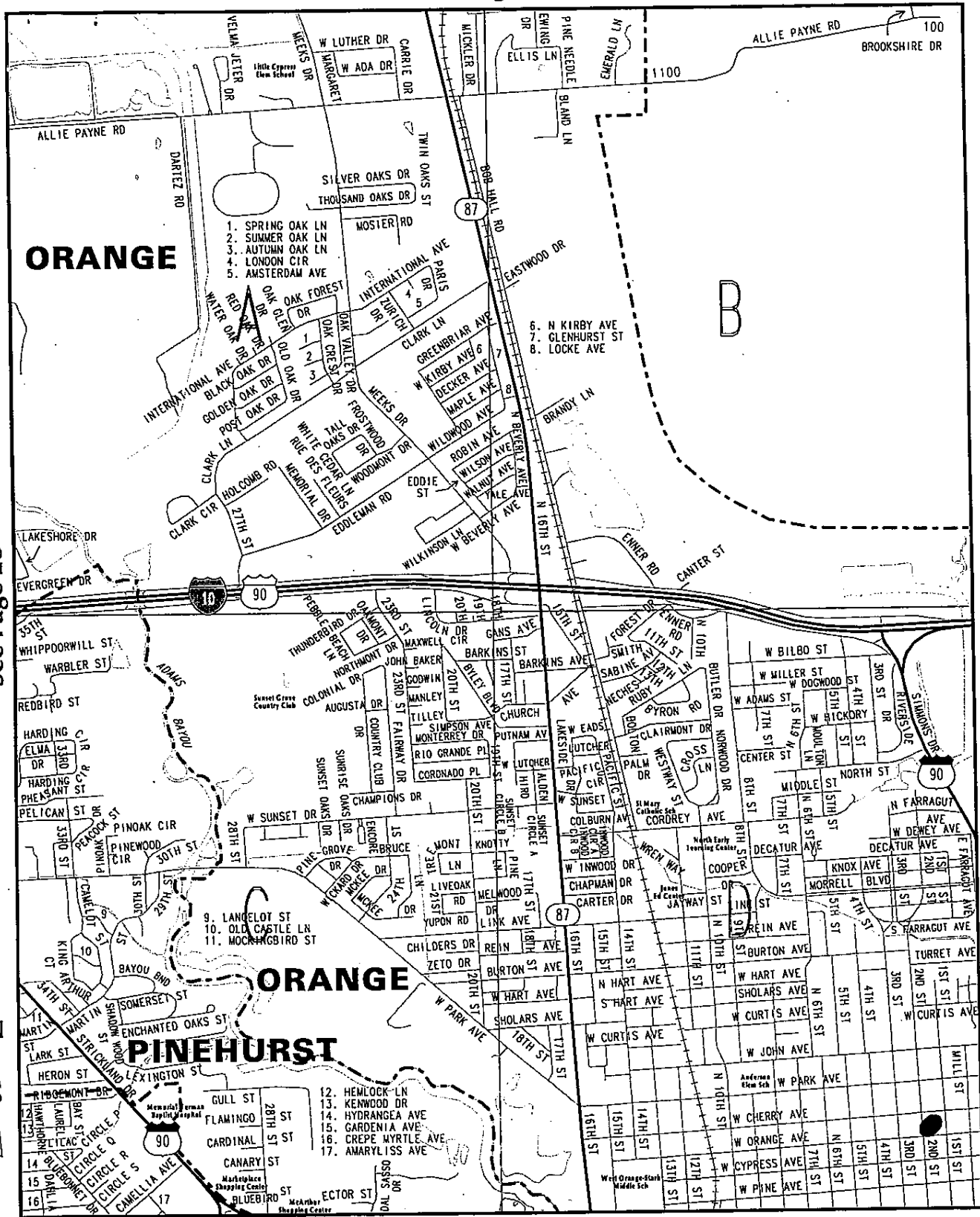

See Page 28

See Page 30

See Page 38

Page: 29



Emergency Network
 South East Texas
 Regional Planning Commission

Scale 2.5" = 1 Mile

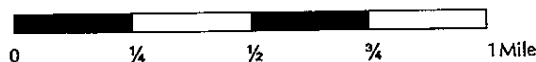

11945-5415

11945-547

Acct. #011945-005300 Suit #A90188-1
Cherry, Orange, TX
SALE #2.

Cherry

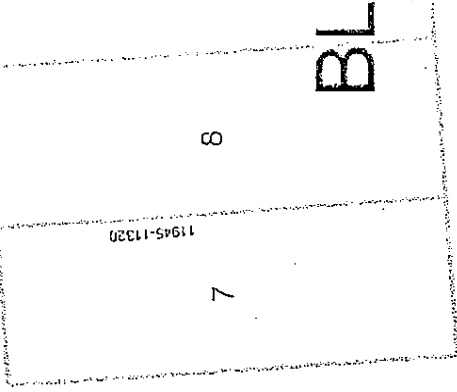
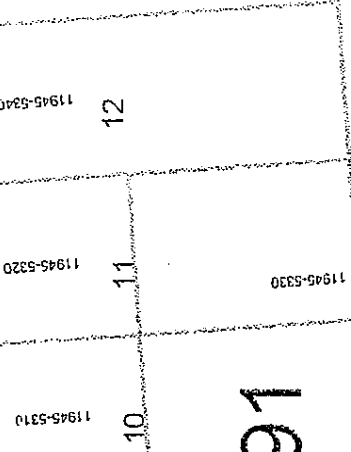
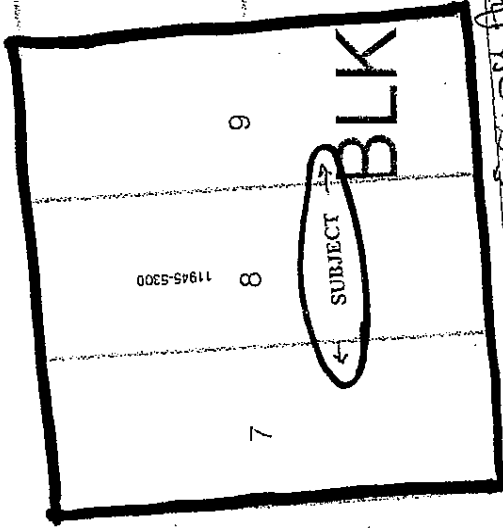

SA

BL

Orange

Orange Ave

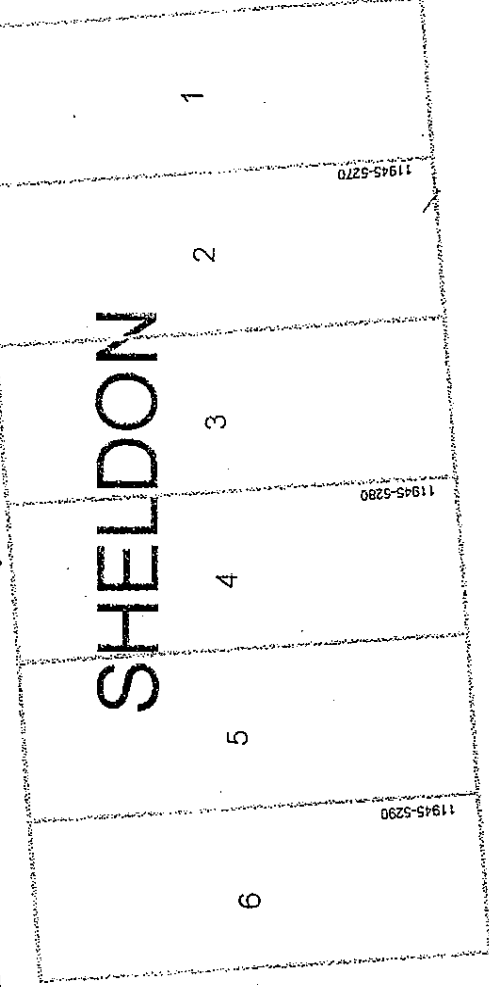
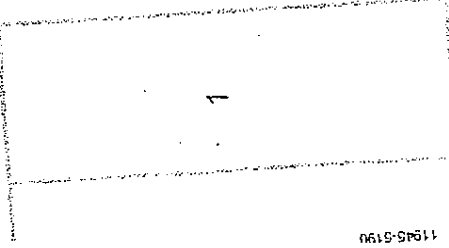

SHELDON

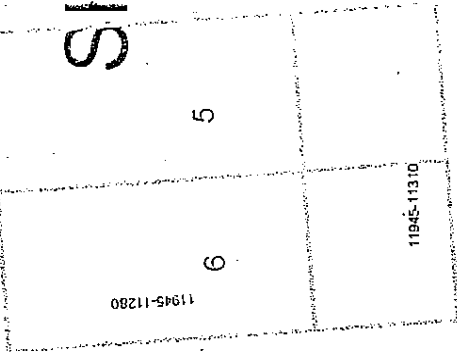

SI

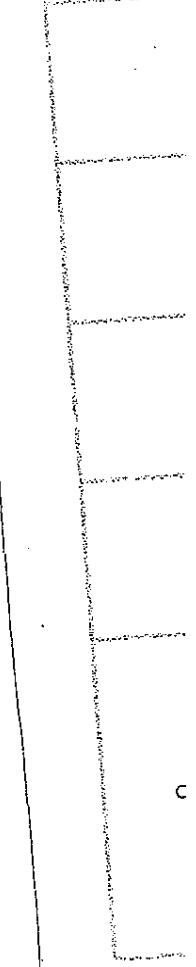

11945-11070

11945-5190



ACCOUNT # 11945-5300
CHERRY AVE.
ORANGE, TX

05/06/2009

ACCOUNT #
011945-011670

SUIT #
A090058-T

LINEBARGER GOGGAN BLAIR & SAMPSON, LLP

ATTORNEYS AT LAW
1949 SOUTH I.H. 35
P. O. BOX 17428
AUSTIN, TEXAS 78760

512/447-6675
FAX 512/443-3494

Douglas Steven Bird

email to steve.bird@publicans.com

December 16, 2010

Ms. Lynda Gunstream, Tax Assessor Collector
Orange County
P. O. Box 1568
Orange, Texas 77631-1568

RE: Bid on trust property described as: Lot W 26' of 4 & E 37.5' of 5 Blk A-8 Sheldon
Account # 11945-011670 Suit # A090058-T
Lot W 26' of 4 & E 37.5' of 5 Blk A-8 Sheldon
LOCATION: 86 Cherry, Orange

Dear Lynda:

We recently received a bid on the property referenced above currently being held in trust.

Jimmy Mooney tendered the bid. If accepted the bid would be distributed as noted below.

Amount of Bid: \$ 375.00
Less Court Cost of: \$ 603.49
Date of Tax Sale: October 6, 2009
Amount to be Distributed: \$ 0.00

	<u>Tax Amount</u>	<u>Percent of Total</u>	<u>Actual Recovery</u>
West Orange-C CISD	\$ 4,403.30	56.85 %	\$ 0.00
County	\$ 1,167.99	15.08 %	\$ 0.00
Farm to Market	\$ 14.91	0.19 %	\$ 0.00
Port District	\$ 31.60	0.41 %	\$ 0.00
Drainage District	\$ 266.42	3.44 %	\$ 0.00
City of Orange	\$ 1,861.09	24.03 %	\$ 0.00
Water District	\$ N/A	N/A %	\$ N/A
ESD	\$ N/A	N/A %	\$ N/A
TOTAL	7,745.31	100.00 %	0.00

Property ID and Legal Description R50802 011945-011670 LOT W 26' OF 4 & E 37.5 OF 5 BLK A-8 SHELDON 63.5X100	Tax Year: 2009	Owner Information GRAY, BEATRICE (DEC'D) (0030856) % SADIE ELLIOTT 5050 SUNFLOWER ST., APT. 158 HOUSTON, TX 77033	Market Value \$853	Card Printed 10/07/2009	Card # 1	Map ID
Property Status Address 88 CHERRY, Orange, TX		Last Inspected 02/05/2009		Assessed Value \$853		Comments
Match ID	Next Inspection/Reason					
Neighborhood 11945	Exemptions/Spec. Vals					
Taxing Unit Information X40;L03;D02;P01;C12;S05		Utilities PUBLIC				
Topography LEVEL	Access CONC-C-G	Other				
Const Style	Foundation	Ext. Finish	Int. Finish	Roof Style	Flooring	
Heat/AC	Plumbing	Fireplace	Rooms	Bedrooms		
Date	Price	Seller	Book / Instrument	Page		

Type	Description	St Cd, HS, Type	Class	Area	Area Factor	Adjusted Area	Perimeter	Unit Price	Yr. Blt / Act-Eff	Cond	% Gd	Ph %	Eco %	Fnc %	% Cmp	Value	
NBH% 0	ImpMod 80																TOTAL
																0	

Property ID and Legal Description R50802 011945-011670 LOT W 26' OF 4 & E 37.5 OF 5 BLK A-8 SHELDON 63.5X100		Tax Year: 2009	Owner Information GRAY, BEATRICE (DEC'D) (0030856) % SADIE ELLIOTT 5050 SUNFLOWER ST., APT. 158 HOUSTON, TX 77033	Market Value \$853	Card Printed 10/07/2009	Card # 1	Map ID
Property Status Address 88 CHERRY, Orange, TX		Last Inspected 02/05/2009		Assessed Value \$853		Comments	
Match ID	Next Inspection/Reason						
Neighborhood 11945	Exemptions/Spec. Vals						
Taxing Unit Information X40;L03;D02;P01;C12;S05		Utilities PUBLIC					
Topography LEVEL	Access CONC-C-G	Other					
Const Style	Foundation	Ext. Finish	Int. Finish	Roof Style	Flooring		
Heat/AC	Plumbing	Fireplace	Rooms	Bedrooms			
Date	Price	Seller	Book / Instrument	Page			

Property Status Address 88 CHERRY, Orange, TX		Last Inspected 02/05/2009		Assessed Value \$853		Comments	
Match ID	Next Inspection/Reason						
Neighborhood 11945	Exemptions/Spec. Vals						
Taxing Unit Information X40;L03;D02;P01;C12;S05		Utilities PUBLIC					
Topography LEVEL	Access CONC-C-G	Other					
Const Style	Foundation	Ext. Finish	Int. Finish	Roof Style	Flooring		
Heat/AC	Plumbing	Fireplace	Rooms	Bedrooms			
Date	Price	Seller	Book / Instrument	Page			

Type	Description	Table	ST Cd	HS	Meth	Area	Unit Price	Econ %	Adj %	Market Value	Ag Tbl	Meth	Ag Unit Pr	Ag Value	
VAC	Vacant		C1	Y	FF	63.5x100.0	20.00	100	100	853			0.00	0	
											TOTAL				
											TOTAL				
											TOTAL				

See Page 29

End of Map

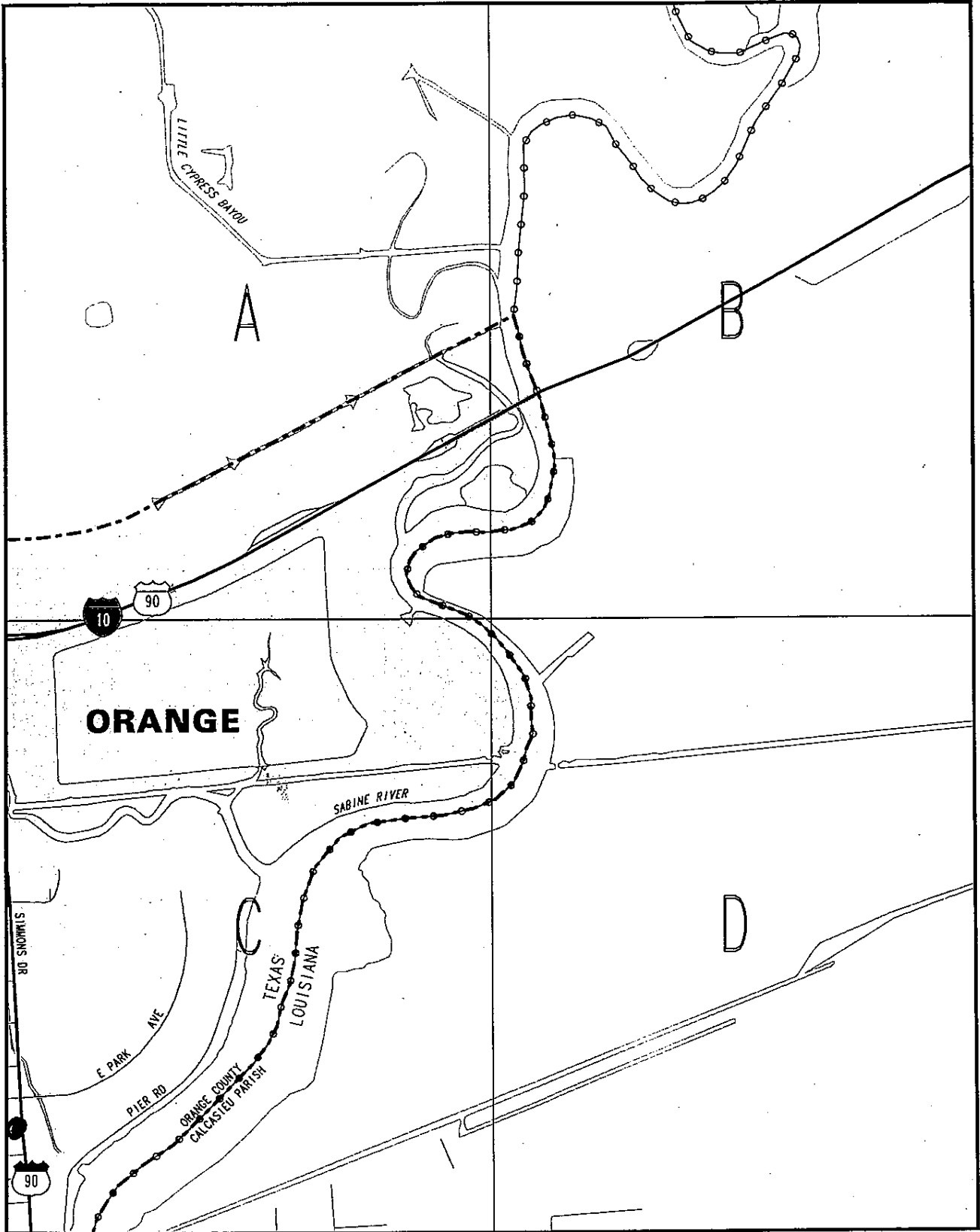

See Page 39

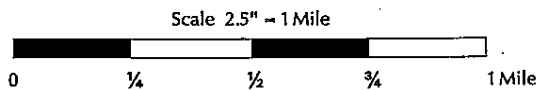

Emergency Network
 South East Texas
 Regional Planning Commission



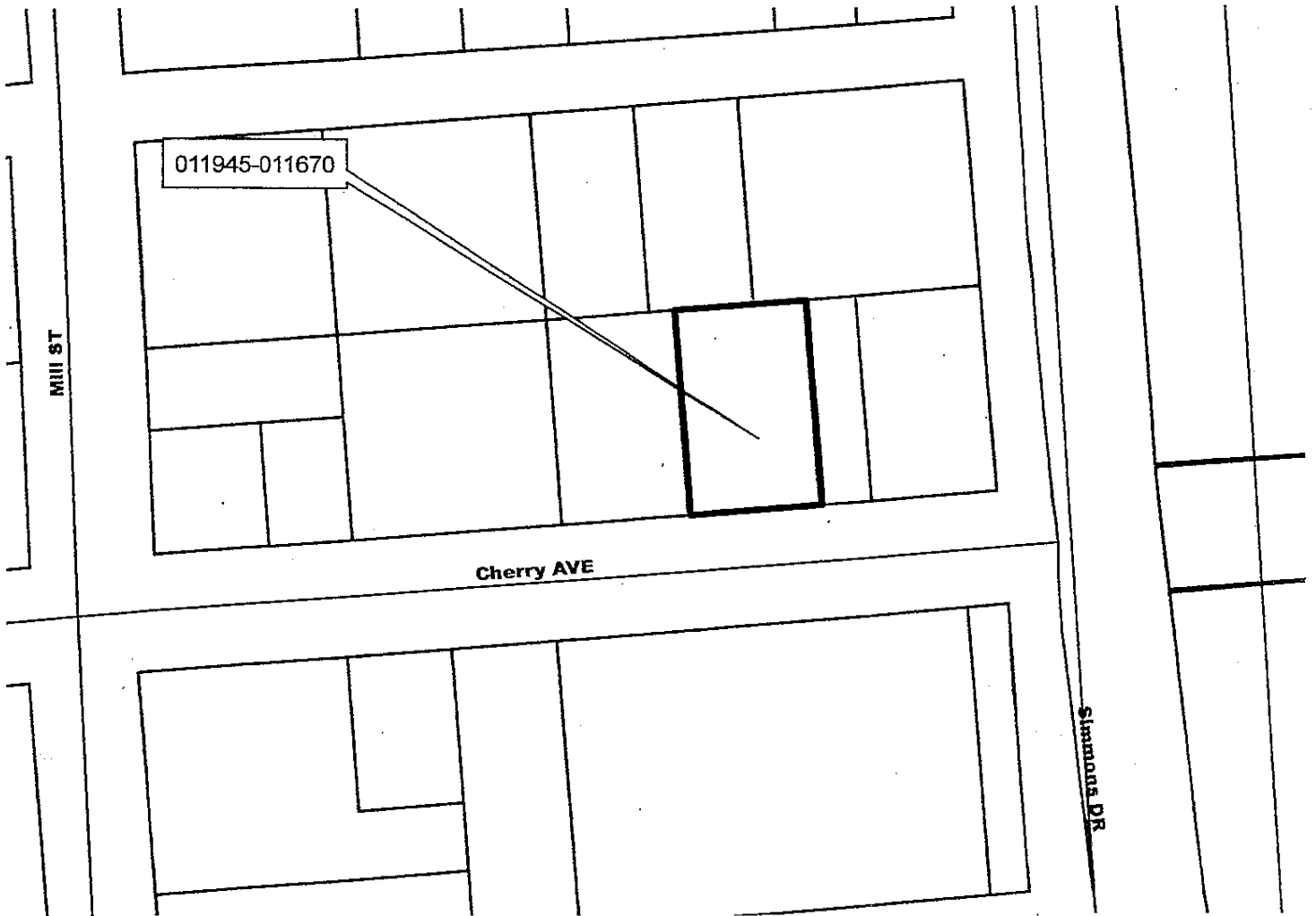

SUIT #A090058-T

SALE #:

86 CHERRY, ORANGE

ACCT. #011945-011670



Suit #A090058-T
86 Cherry, Orange

Sale #26
Acct. #011945-011670