



# Introduction



ARCHITECTURAL  
RESOURCES • INC.





# ATS&R Study – 2013



- Intensive local involvement
- Good and useful information
- Favored option called for four smaller additions and remodeling

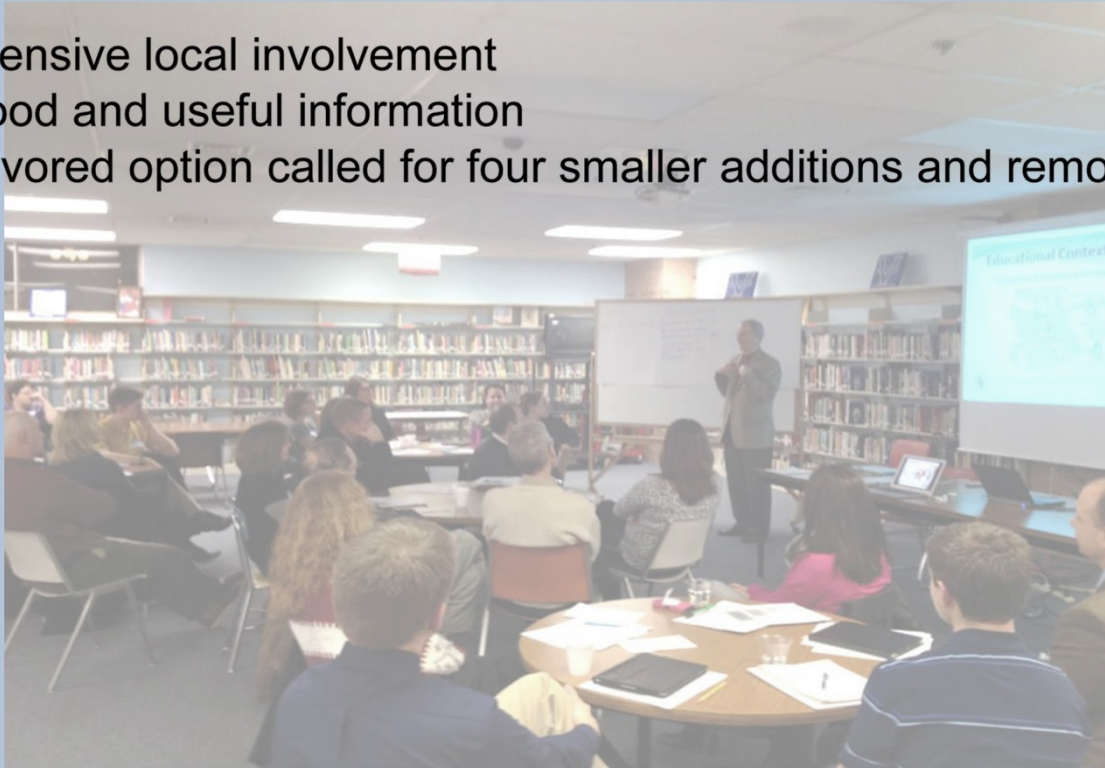

## VIRGINIA PUBLIC SCHOOLS' SPACE UTILIZATION STUDY

*March 1, 2013*





# ATS&R Concept Plan



ARCHITECTURAL  
RESOURCES • INC.

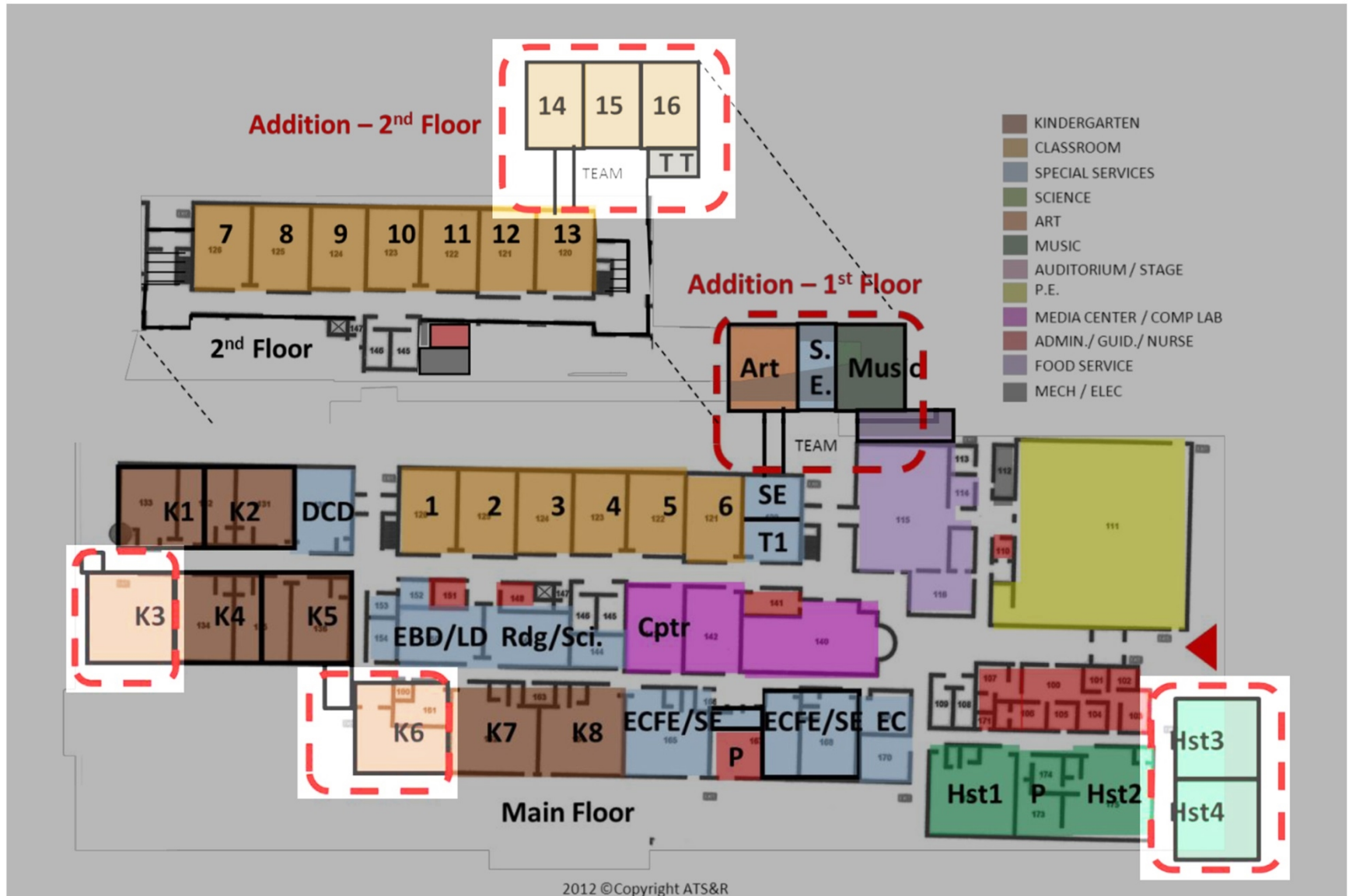



# What We Heard



- Initial discussions with Virginia School District
- **Parkview Learning Center** is “the crown jewel” – invest in it now
- **Develop a strong Head Start/School Readiness program** at Parkview to attract and retain students





# Parkview Open House



- **Met with staff** to establish and confirm facility space needs
- **Learned about concerns** with site function and **safety**
- **Toured school** to see daily operations and existing spaces







# Block Schematic Concept Plan



- **Developed concept plan diagram** with knowledge gained from Parkview staff input, District Facilities Management, building and site visit and observation
- After several iterations arrived at Block Schematic Concept Plan
- Plan called for 20,000 s.f. of new construction and 11,000 s.f. of internal remodeling to meet program needs

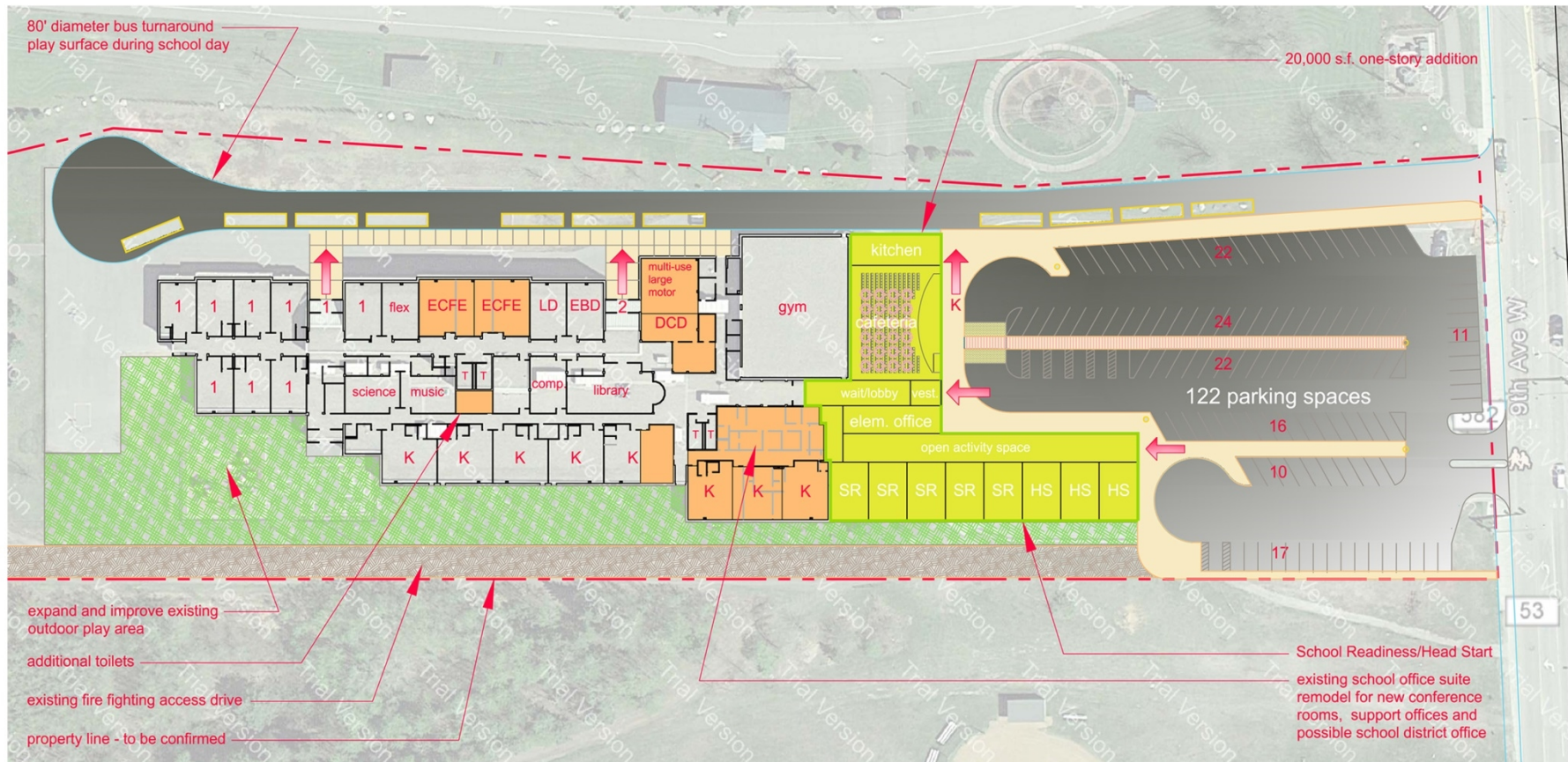



# Parkview Open House



- Showed Block Schematic Concept Plan to staff for review and comment
- **Documented constructive feedback** from staff
- Went back and utilized this information **to improve the plan**











# What's Next



- Approval of revised Block Schematic Plan – begin **Schematic Floor Plan**
- Present prototype Head Start/School Readiness rooms for review and comment
- Survey of existing Parkview Learning Center Site (no more snow, please!)
- Refinement of project budget as floor plan comes together

