

EXISTING ROOM LAYOUT

EXISTING CLASSROOM COUNT:

GENERAL CLASSROOM (#): 22

KINDERGARTEN (K): 5

SPECIAL ED (SP): 2

COMPUTER LAB (CL): 1

STEM LAB (SL): 0

TOTAL: 30

COLOR KEY:

- NEW CLASSROOM
- RENOVATED CLASSROOM
- NEW KINDERGARTEN CLASSROOM
- RENOVATED KINDERGARTEN CLASSROOM
- NEW SPECIAL EDUCATION
- RENOVATED SPECIAL EDUCATION
- RENOVATED ADMIN OFFICE
- RENOVATED STEM LAB
- NEW CORRIDOR
- NEW STORAGE OR OFFICE
- NEW TOILET
- NEW ROOF GARDEN

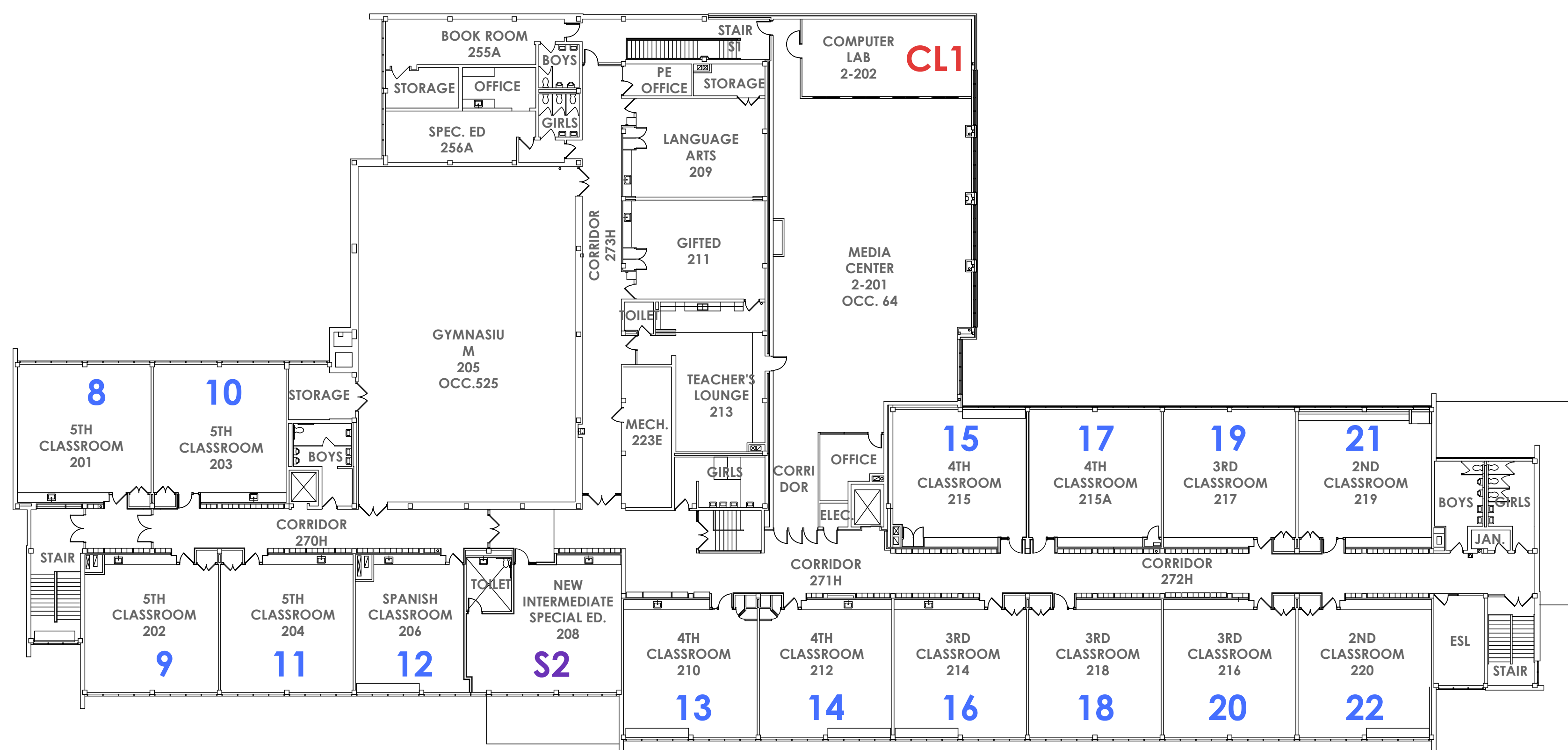

SECOND FLOOR PLAN

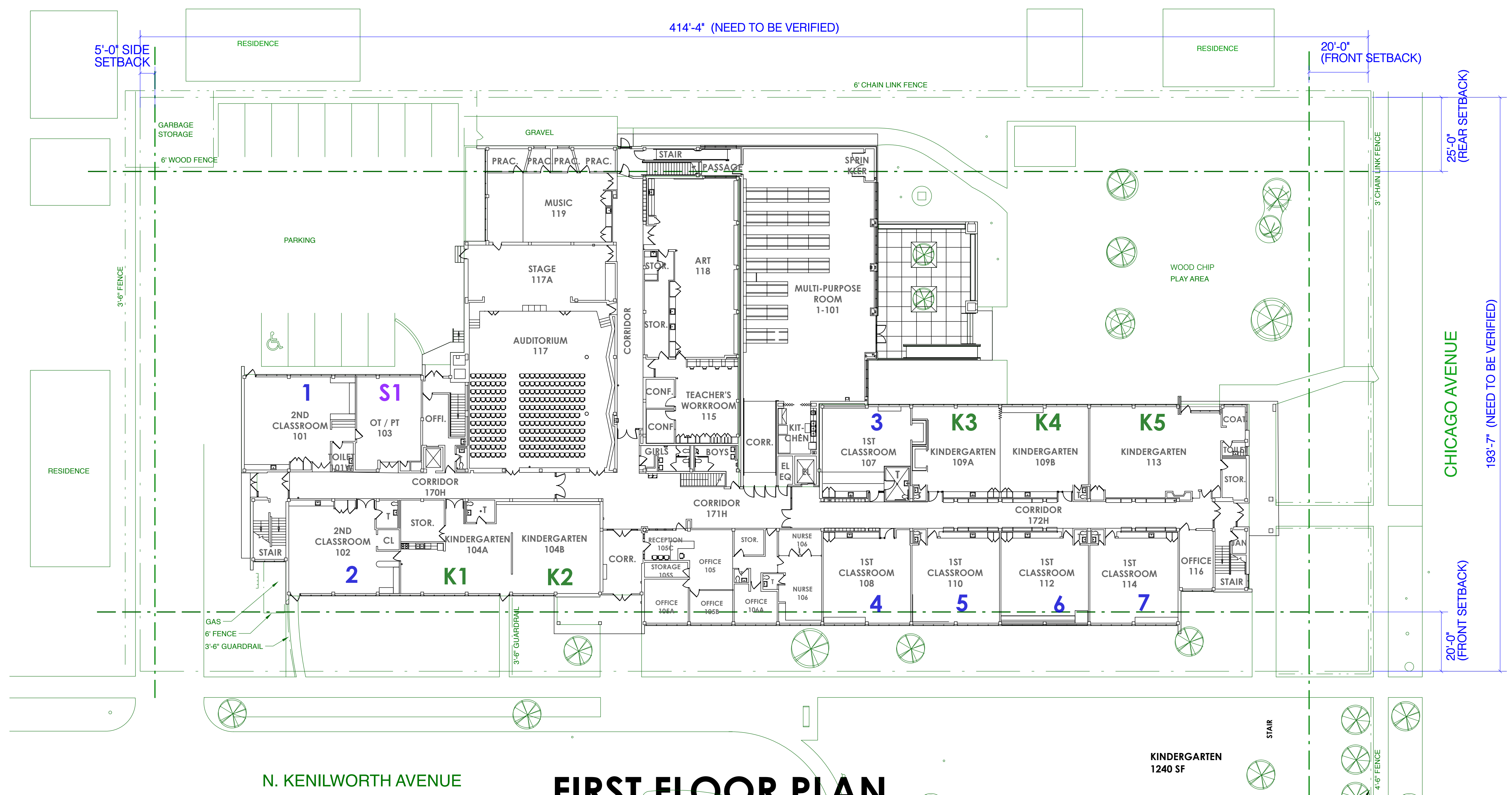

FIRST FLOOR PLAN

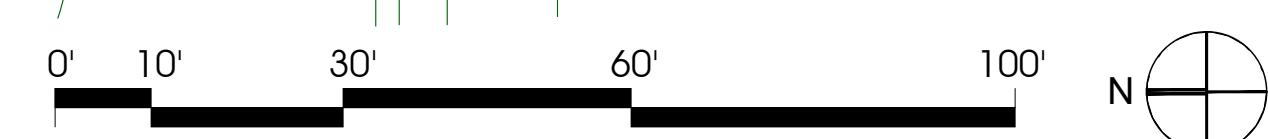

ADDITION TO EAST: 1-STORY 4 CLASSROOM DOUBLE LOADED CORRIDOR

EXISTING CLASSROOM COUNT:	AFTER ADDITION AND RENO:
GENERAL CLASSROOM (#): 22	25
KINDERGARTEN (K): 5	5
SPECIAL ED (SP): 2	2
COMPUTER LAB (CL): 1	0
STEM LAB (SL): 0	1
TOTAL:	30
	33

COLOR KEY:	NEW CONSTRUCTION AREA:	RENOVATION AREA:
■ NEW CLASSROOM	4,000 SF	4,200 SF
■ RENOVATED CLASSROOM		6,500 SF
■ NEW KINDERGARTEN CLASSROOM		1,000 SF
■ RENOVATED KINDERGARTEN CLASSROOM		2,000 SF
■ NEW SPECIAL EDUCATION		700 SF
■ RENOVATED SPECIAL EDUCATION		300 SF
■ RENOVATED ADMIN OFFICE		320 SF
■ RENOVATED STEM LAB		460 SF
■ NEW CORRIDOR	550 SF	
■ RENOVATED STORAGE OR OFFICE		
■ RENOVATED TOILET		
■ NEW ROOF GARDEN		
	TOTAL AREA: 4,550 SF	15,480 SF

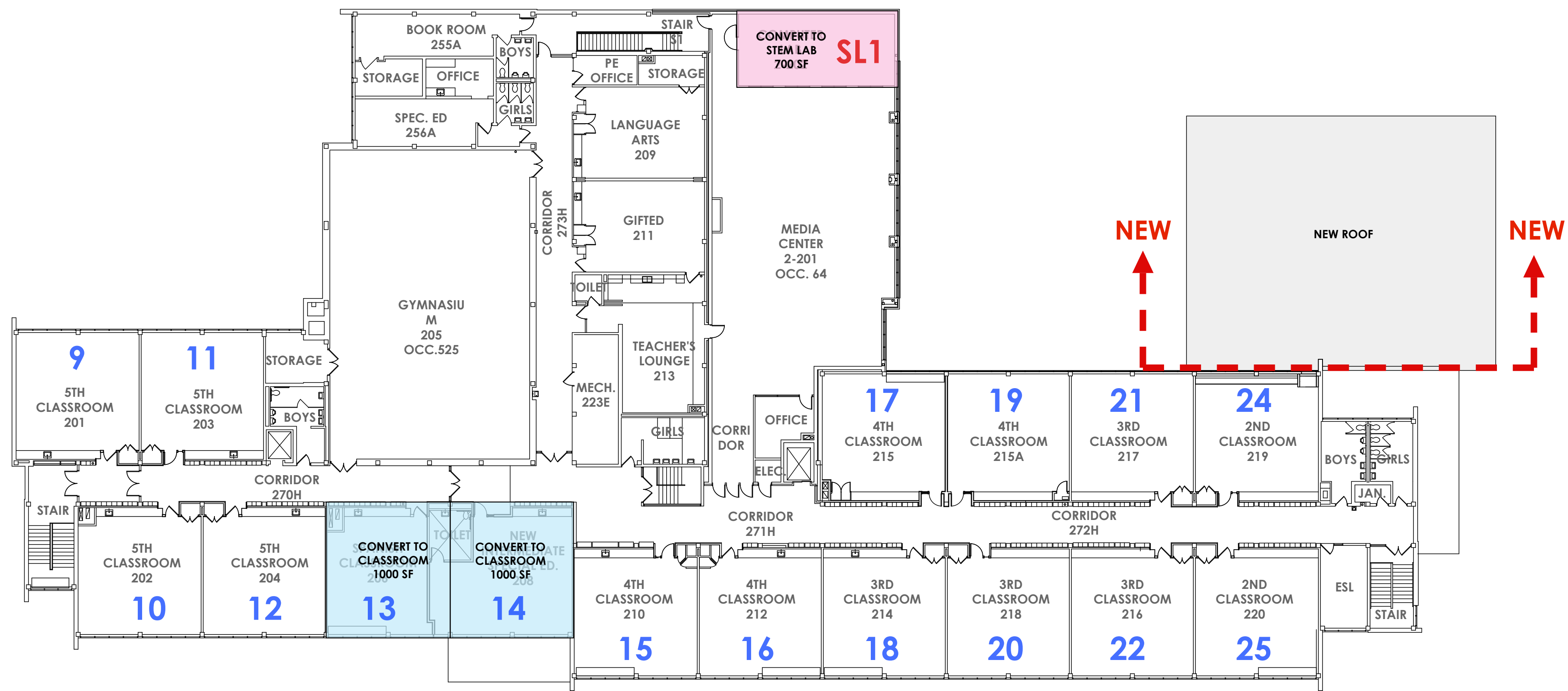

SECOND FLOOR PLAN

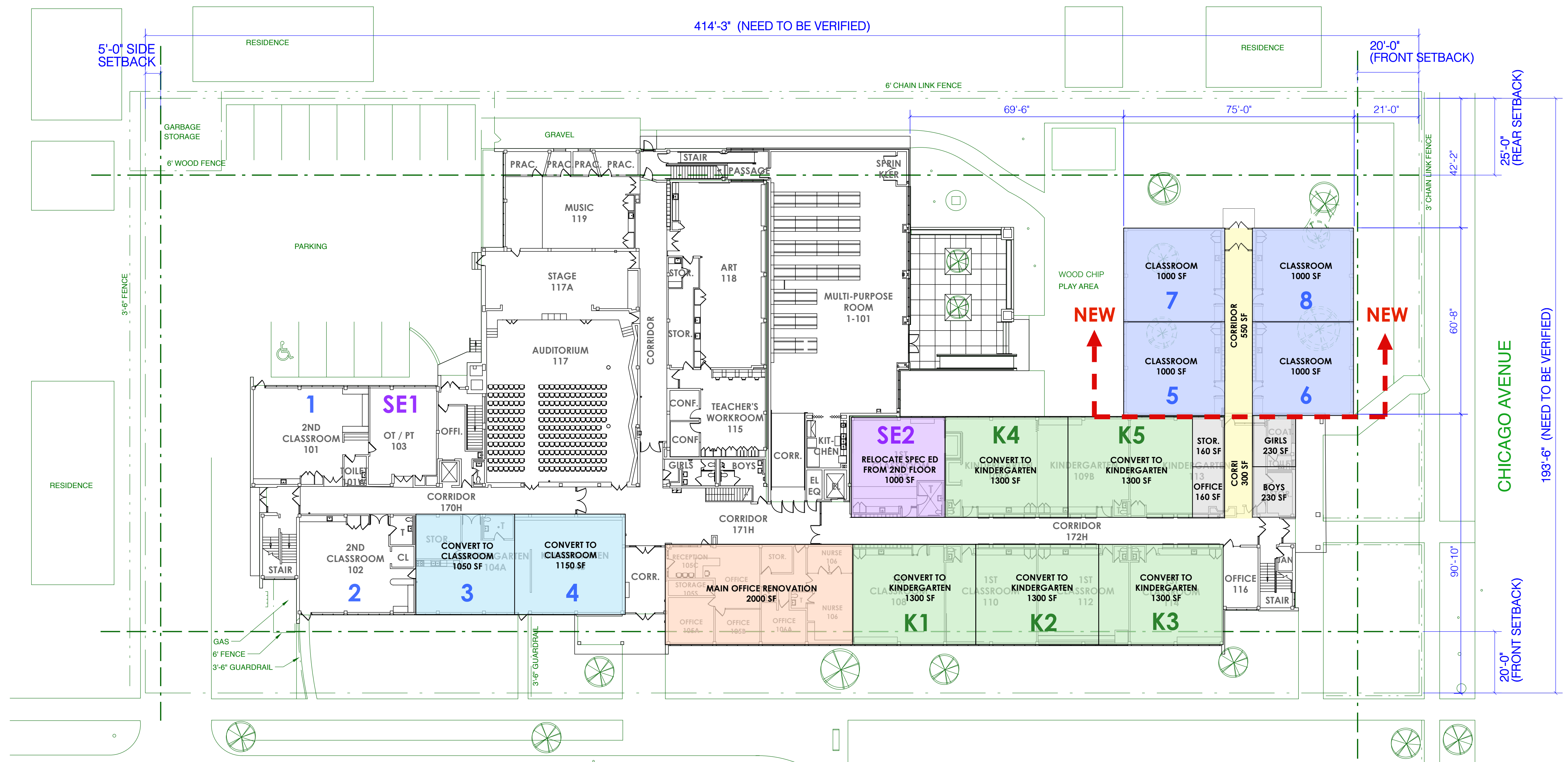

FIRST FLOOR PLAN

A1

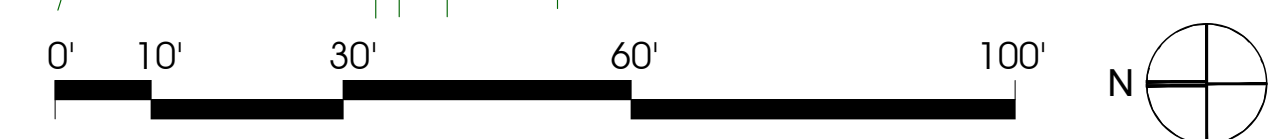

ADDITION TO EAST: 1-STORY 5 CLASSROOM DOUBLE LOADED CORRIDOR

EXISTING CLASSROOM COUNT:	AFTER ADDITION AND RENO:
GENERAL CLASSROOM (#): 22	24
KINDERGARTEN (K): 5	5
SPECIAL ED (SP): 2	2
COMPUTER LAB (CL): 1	0
STEM LAB (SL): 0	1
TOTAL:	30
*34 CLASSROOM W/O ADMIN OFFICE EXPANSION	

COLOR KEY:	NEW CONSTRUCTION AREA:	RENOVATION AREA:
 NEW CLASSROOM	4,000 SF	4,200 SF
 RENOVATED CLASSROOM		
 NEW KINDERGARTEN CLASSROOM		6,800 SF
 RENOVATED KINDERGARTEN CLASSROOM		
 NEW SPECIAL EDUCATION	1,000 SF	
 RENOVATED SPECIAL EDUCATION		
 RENOVATED ADMIN OFFICE		3,000 SF
 RENOVATED STEM LAB		700 SF
 NEW CORRIDOR	750 SF	300 SF
 NEW STORAGE OR OFFICE	100 SF	120 SF
 NEW TOILET	260 SF	300 SF
 NEW ROOF GARDEN		
	TOTAL AREA: 6,110 SF	15,420 SF

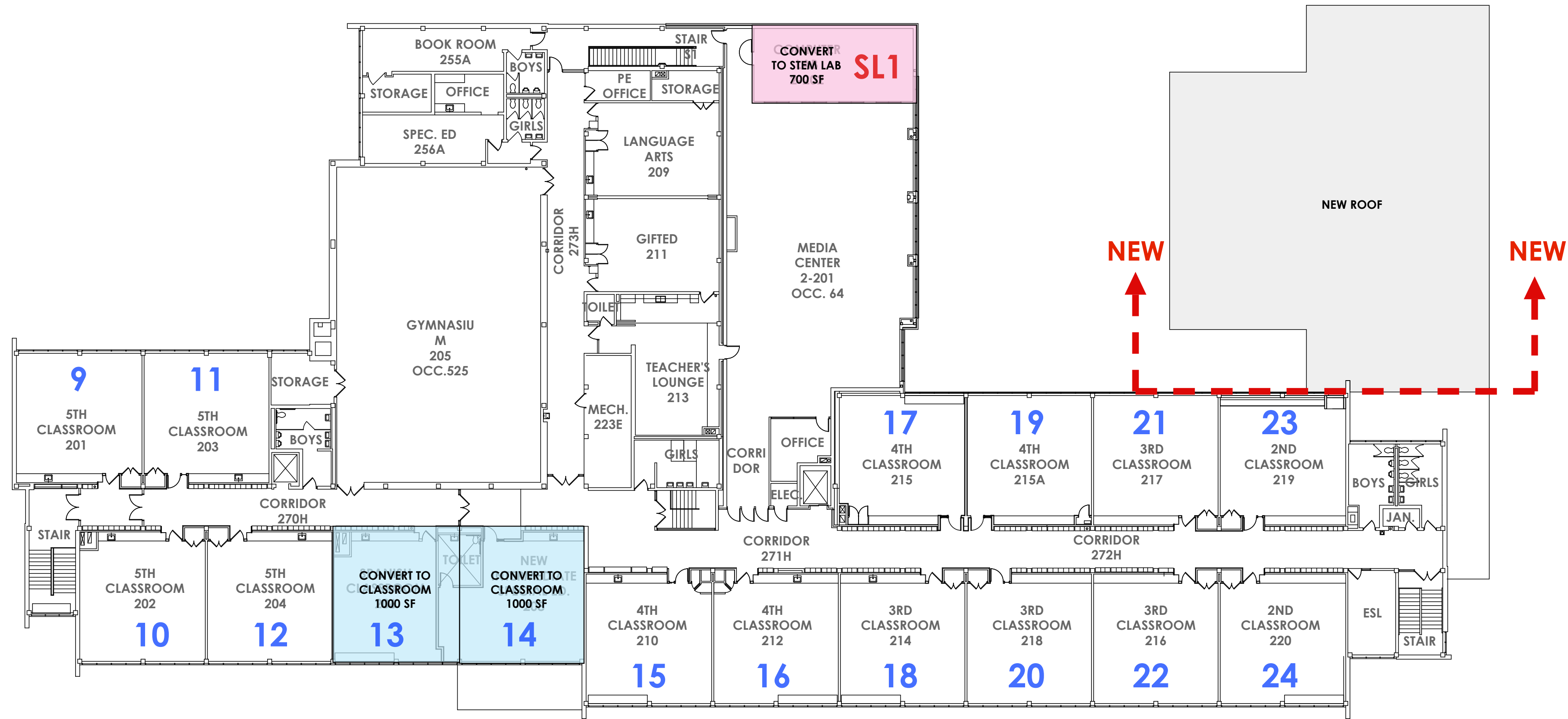

SECOND FLOOR PLAN



FIRST FLOOR PLAN

A2

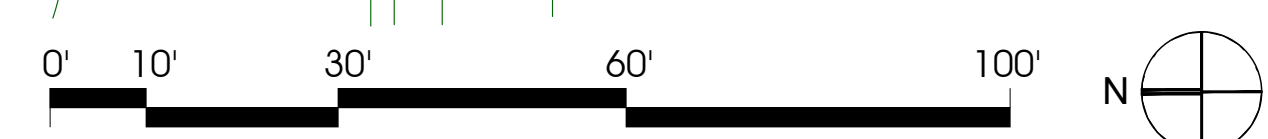

ADDITION TO EAST: 2-STORY 4 KINDERGARTEN SINGLE LOADED CORRIDOR

EXISTING CLASSROOM COUNT:	AFTER ADDITION AND RENO:
GENERAL CLASSROOM (#): 22	26
KINDERGARTEN (K): 5	5
SPECIAL ED (SP): 2	2
COMPUTER LAB (CL): 1	0
STEM LAB (SL): 0	1
TOTAL:	30
	34

COLOR KEY:	NEW CONSTRUCTION AREA:	RENOVATION AREA:
■ NEW CLASSROOM		
■ RENOVATED CLASSROOM		
■ NEW KINDERGARTEN CLASSROOM	5,200 SF	4,200 SF
■ RENOVATED KINDERGARTEN CLASSROOM		
■ NEW SPECIAL EDUCATION		1,000 SF
■ RENOVATED SPECIAL EDUCATION		
■ RENOVATED ADMIN OFFICE		2,000 SF
■ RENOVATED STEM LAB		700 SF
■ NEW CORRIDOR	3,200 SF	
■ NEW STORAGE OR OFFICE	250 SF	
■ NEW TOILET		
■ NEW ROOF GARDEN		
	TOTAL AREA: 8,650 SF*	7,900 SF

*MUST BE SPRINKLED OVER 7200 SF

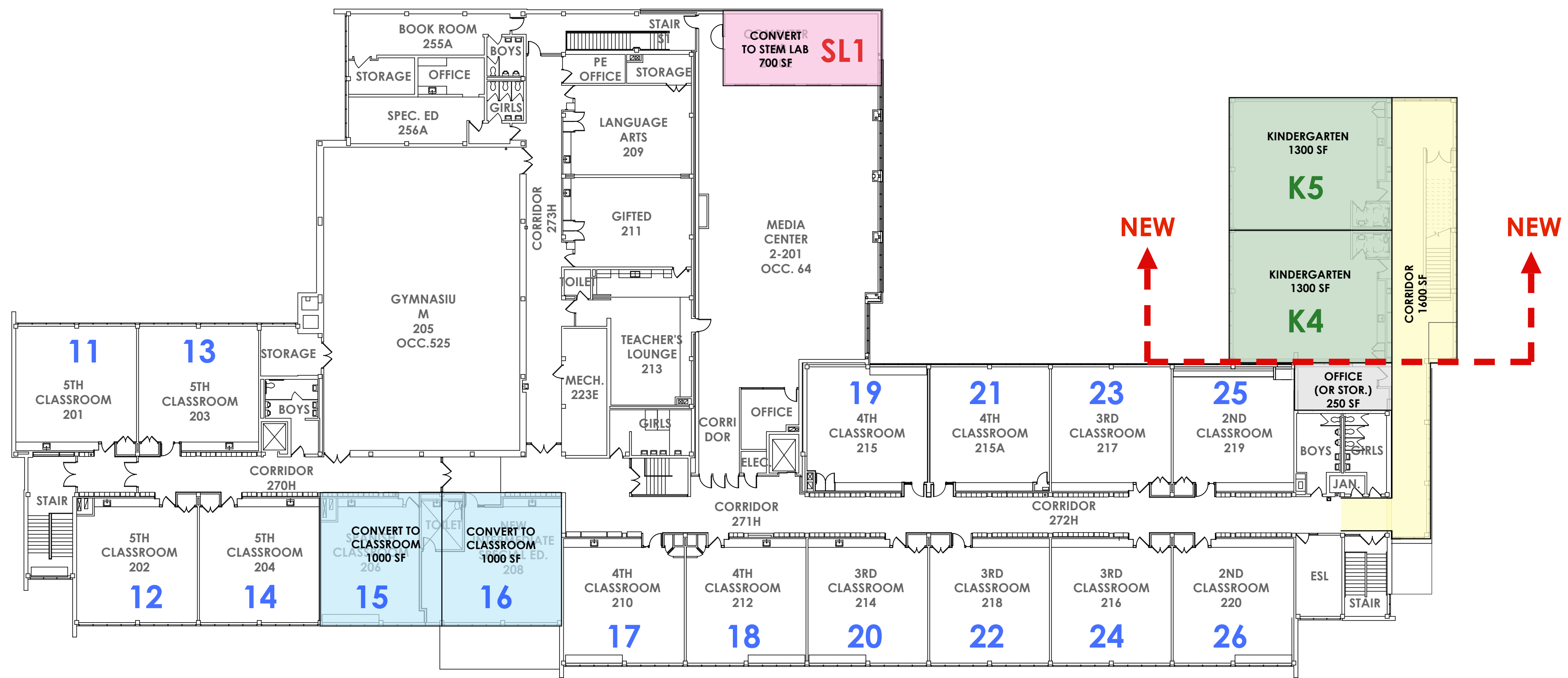

SECOND FLOOR PLAN

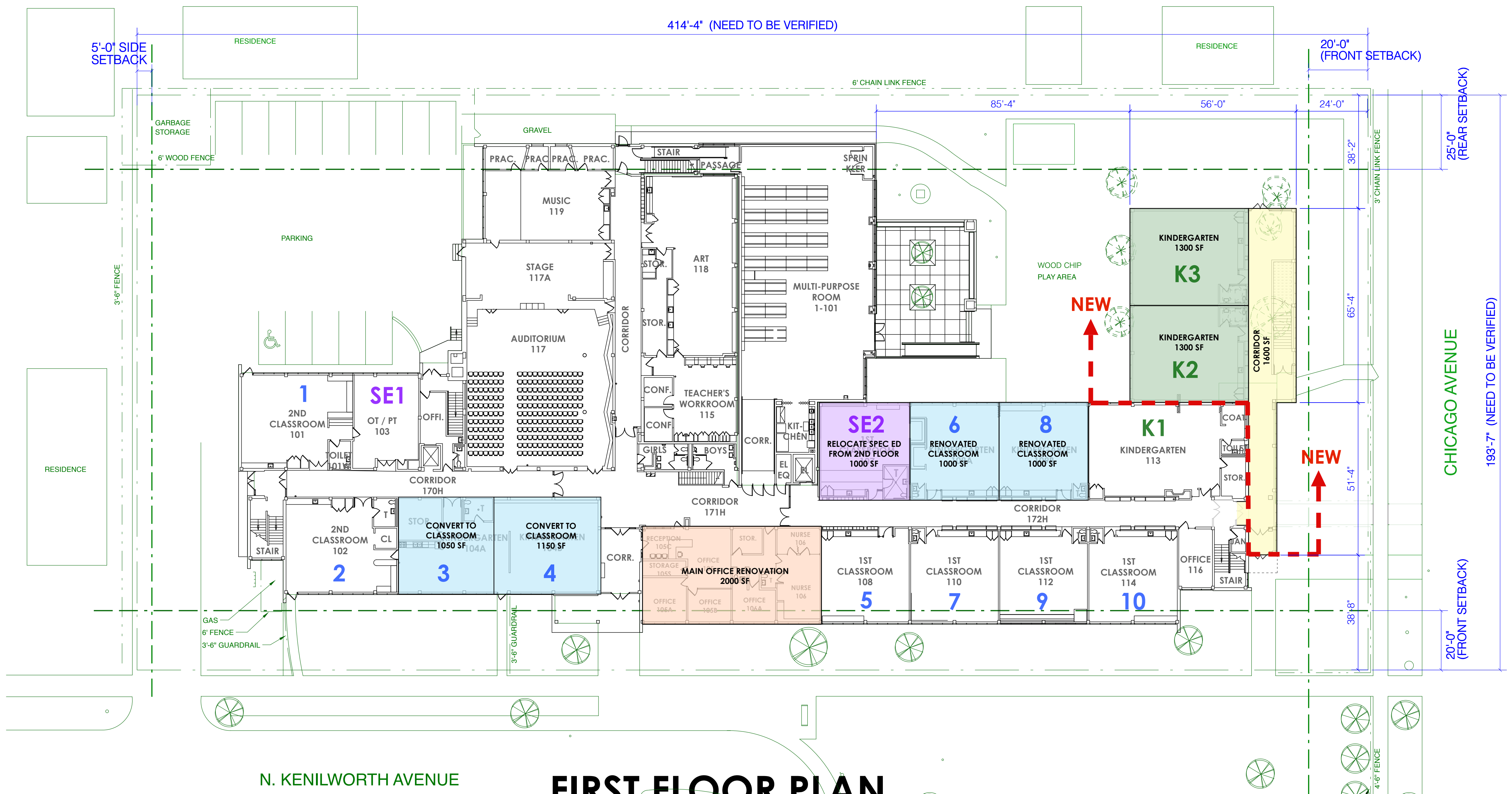

FIRST FLOOR PLAN

B1



ADDITION TO EAST: 2-STORY 6 CLASSROOM OPTION FOR 5 CLASSROOM WITH ROOF GARDEN

EXISTING CLASSROOM COUNT:		AFTER ADDITION AND RENO:
GENERAL CLASSROOM (#):	22	26 (25)
KINDERGARTEN (K):	5	5
SPECIAL ED (SP):	2	2
COMPUTER LAB (CL):	1	0
STEM LAB (SL):	0	1
TOTAL:	30	33* (32)

*34 CLASSROOM W/O ADMIN EXPANSION OR 33 CLASSROOMS W/ ROOF GARDEN

COLOR KEY:	NEW CONSTRUCTION AREA:	RENOVATION AREA:
NEW CLASSROOM	(ALT: 5,000 SF) 6,000 SF	
RENOVATED CLASSROOM		4,200 SF
NEW KINDERGARTEN CLASSROOM		4,250 SF
RENOVATED KINDERGARTEN CLASSROOM		4,250 SF
NEW SPECIAL EDUCATION		1,000 SF
RENOVATED SPECIAL EDUCATION		3,000 SF
RENOVATED ADMIN OFFICE		700 SF
RENOVATED STEM LAB		
NEW CORRIDOR	3,000 SF	
NEW STORAGE OR OFFICE	250 SF	
NEW TOILET		400 SF
NEW ROOF GARDEN	(ALT: 1,000 SF)	
TOTAL AREA:	(ALT: 8,250 SF*) 9,250 SF*	13,550 SF

*MUST BE SPRINKLED OVER 7200 SF

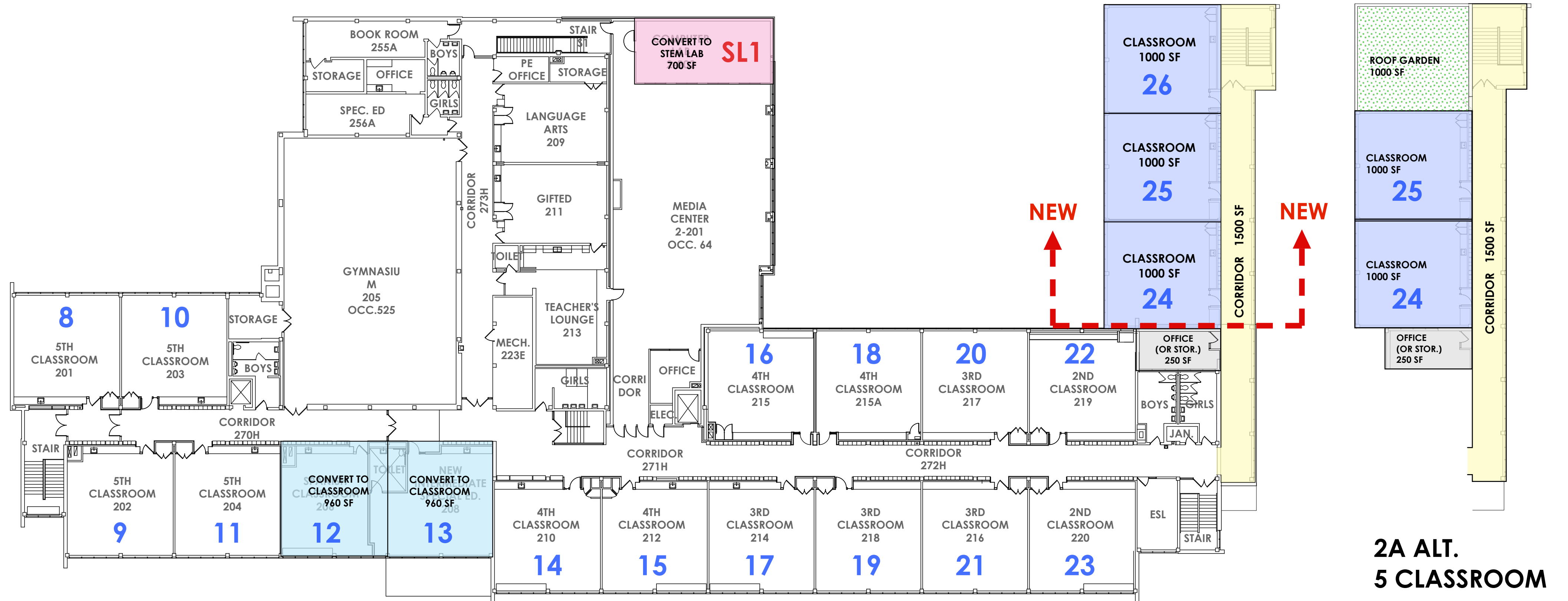

SECOND FLOOR PLAN

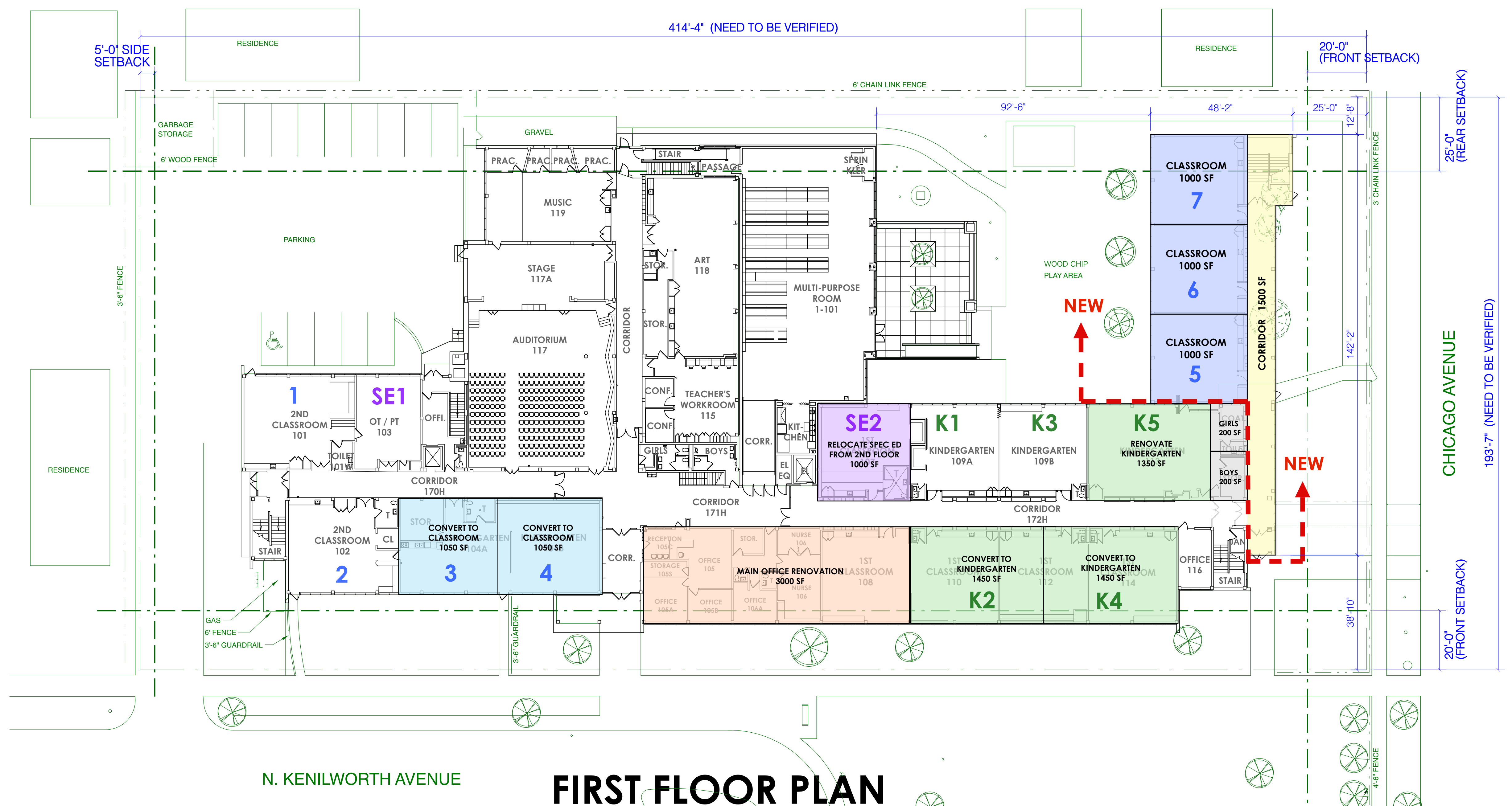

FIRST FLOOR PLAN

B2

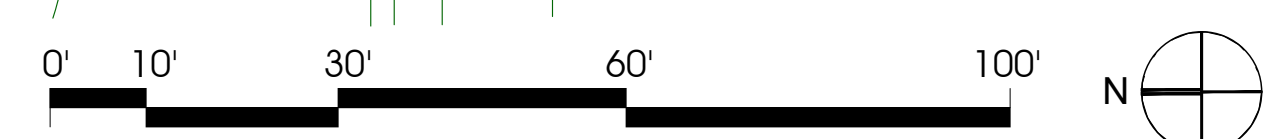

ADDITION TO WEST: 1-STORY 4 CLASSROOM DOUBLE LOADED CORRIDOR

EXISTING CLASSROOM COUNT:	AFTER ADDITION AND RENO:
GENERAL CLASSROOM (#): 22	25
KINDERGARTEN (K): 5	5
SPECIAL ED (SP): 2	2
COMPUTER LAB (CL): 1	0
STEM LAB (SL): 0	1
TOTAL:	30
	33

COLOR KEY:	NEW CONSTRUCTION AREA:	RENOVATION AREA:
■ NEW CLASSROOM	4,000 SF	
■ RENOVATED CLASSROOM		4,200 SF
■ NEW KINDERGARTEN CLASSROOM		3,900 SF
■ RENOVATED KINDERGARTEN CLASSROOM		1,000 SF
■ NEW SPECIAL EDUCATION		2,000 SF
■ RENOVATED SPECIAL EDUCATION		700 SF
■ RENOVATED ADMIN OFFICE		200 SF
■ RENOVATED STEM LAB		
■ NEW CORRIDOR	750 SF	
■ NEW STORAGE OR OFFICE	170 SF	
■ NEW TOILET	300 SF	
■ NEW ROOF GARDEN		
	TOTAL AREA: 5,220 SF	12,000 SF

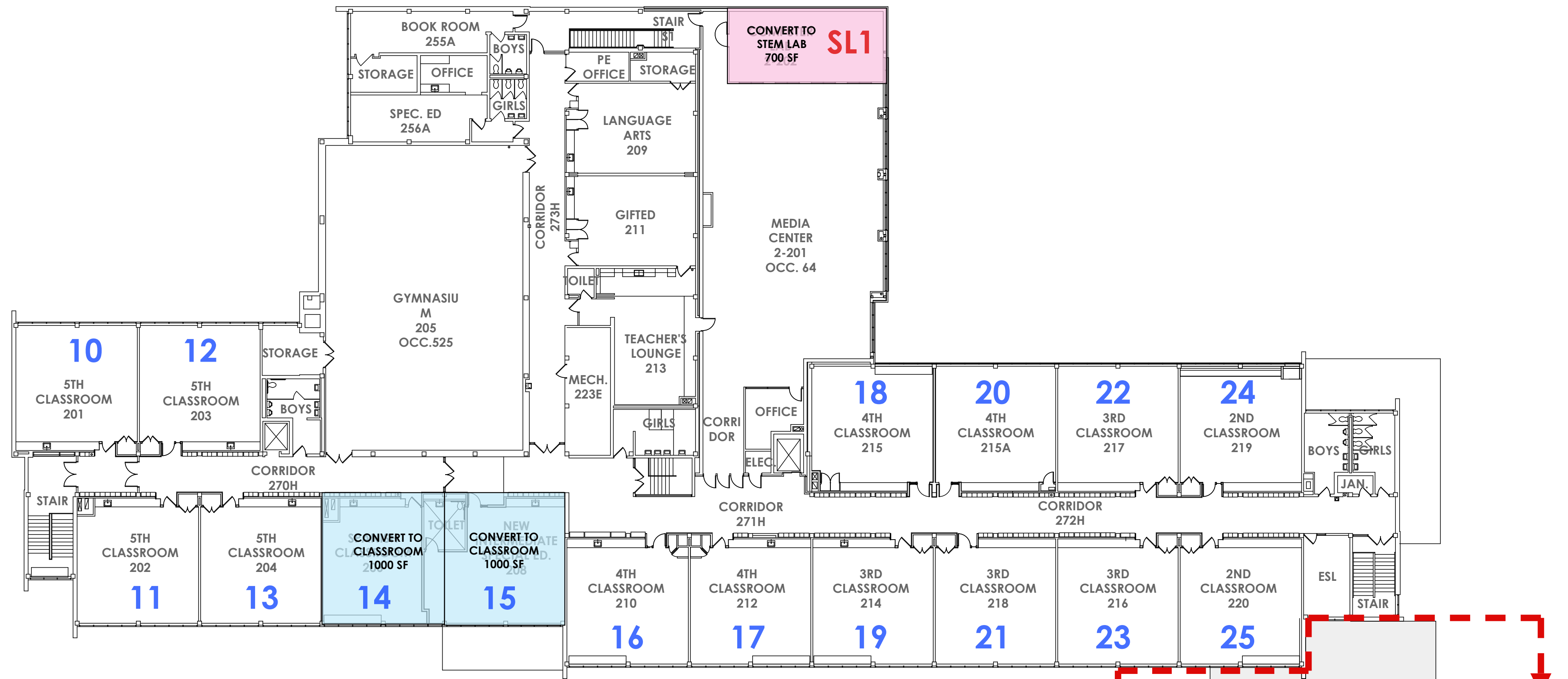

SECOND FLOOR PLAN

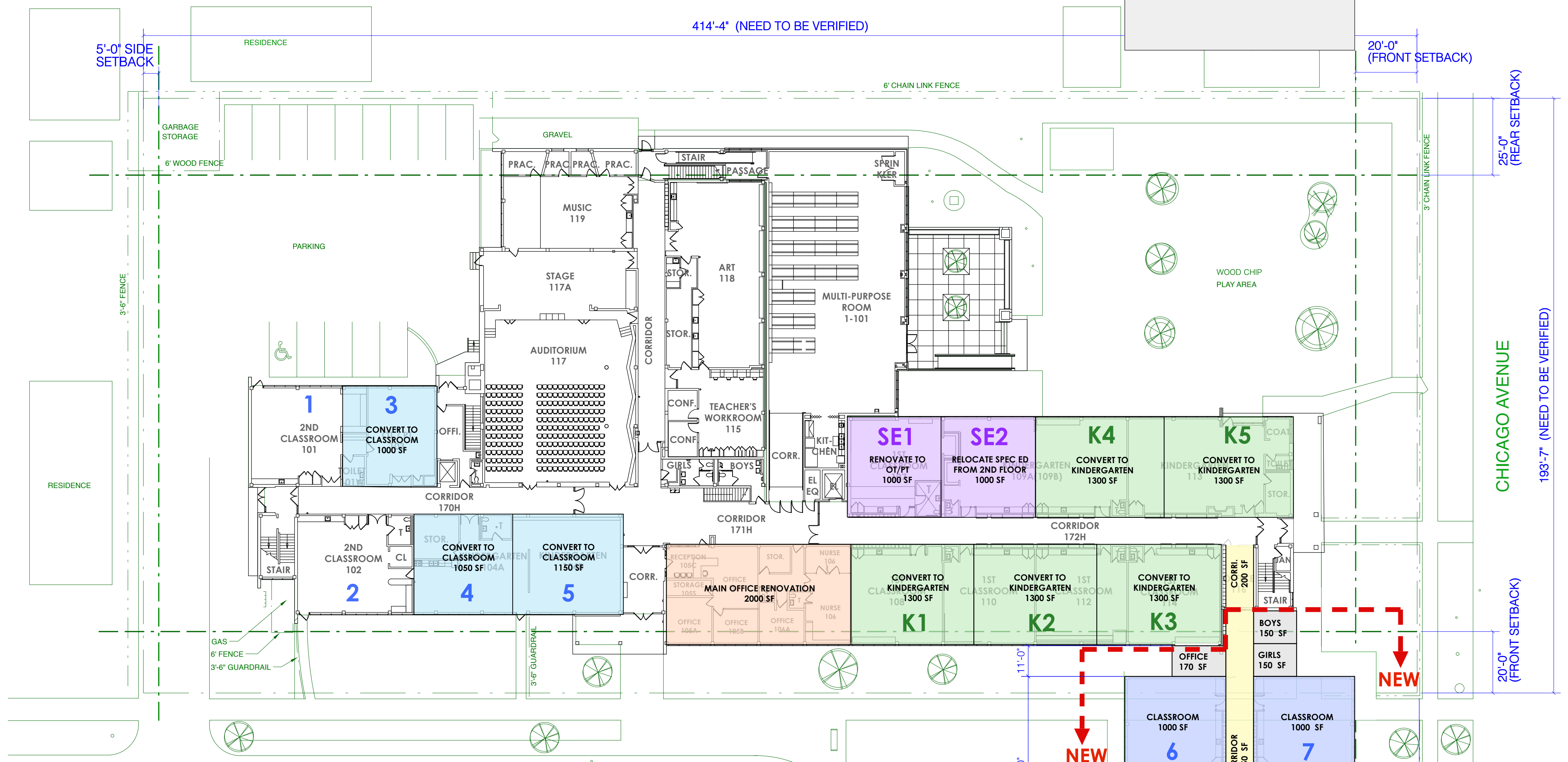

FIRST FLOOR PLAN

C1

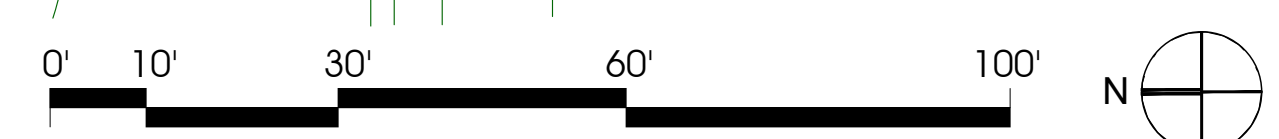

ADDITION TO WEST: 1-STORY 5 CLASSROOM

EXISTING CLASSROOM COUNT:	AFTER ADDITION AND RENO:
GENERAL CLASSROOM (#): 22	25
KINDERGARTEN (K): 5	5
SPECIAL ED (SP): 2	2
COMPUTER LAB (CL): 1	0
STEM LAB (SL): 0	1
TOTAL:	30
	33

COLOR KEY:	NEW CONSTRUCTION AREA:	RENOVATION AREA:
NEW CLASSROOM	5,000 SF	
RENOVATED CLASSROOM		4,200 SF
NEW KINDERGARTEN CLASSROOM		6,800 SF
RENOVATED KINDERGARTEN CLASSROOM		1,500 SF
NEW SPECIAL EDUCATION		2,600 SF
RENOVATED SPECIAL EDUCATION		700 SF
RENOVATED ADMIN OFFICE		200 SF
RENOVATED STEM LAB		640 SF
NEW CORRIDOR	750 SF	
NEW STORAGE OR OFFICE	200 SF	
NEW TOILET		
NEW ROOF GARDEN		
	TOTAL AREA: 5,950 SF	16,640 SF

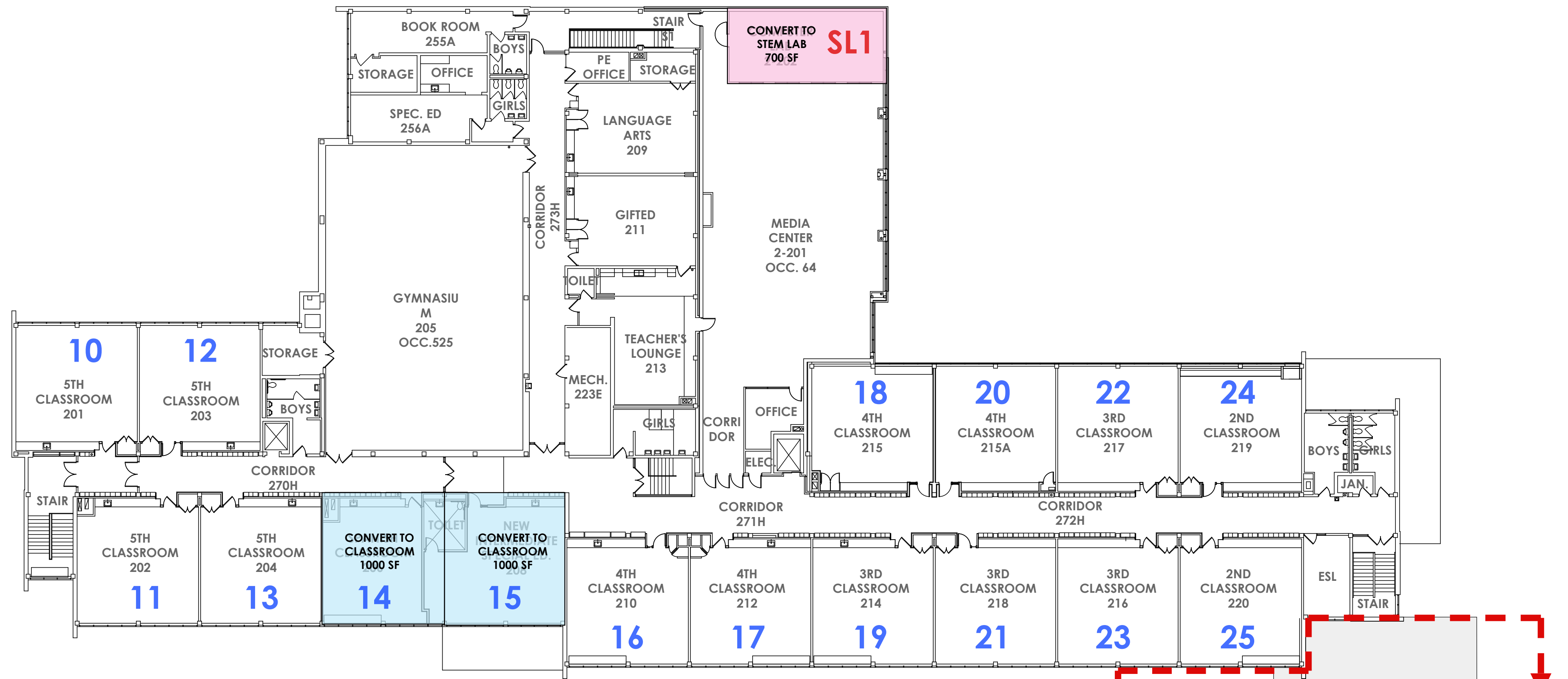

SECOND FLOOR PLAN

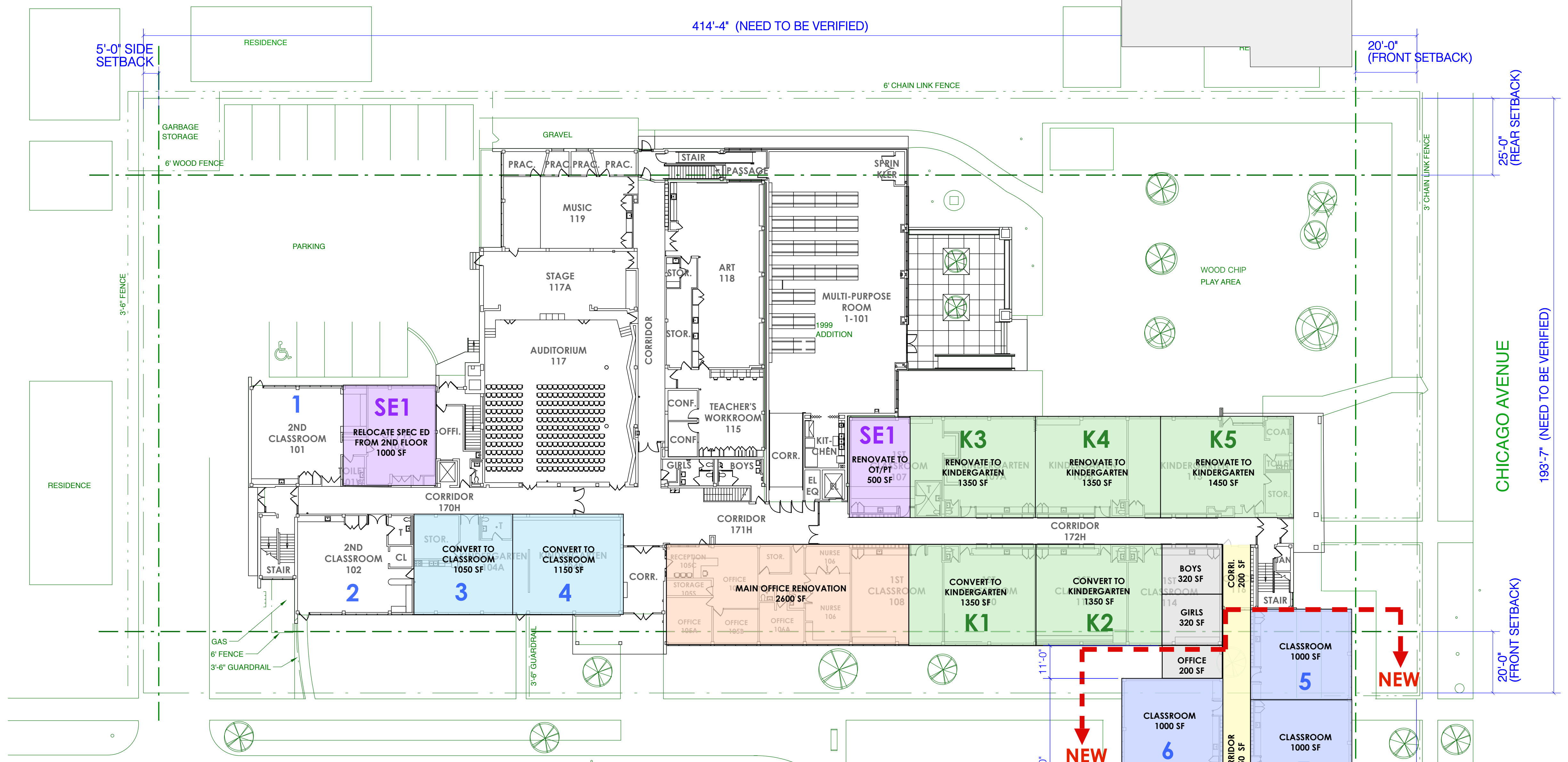

FIRST FLOOR PLAN

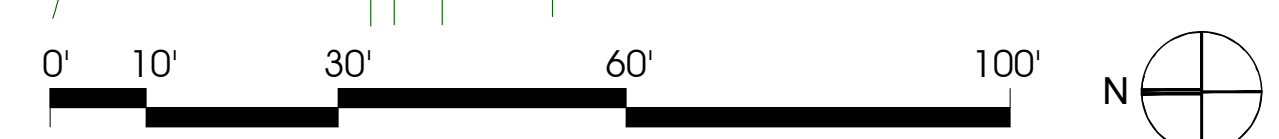

ADDITION TO WEST: C1 & C2 SCHEME

THESE SCHEMES WILL BLOCK THE EXISTING WALKWAY



PHOTO LOOKING NORTH FROM CHICAGO AVE.
SHOWING THE CONTINUITY OF WALK WAY AT THE FRONT OF THE BUILDING

EXISTING AERIAL PHOTO W/ OPTION C

