



ALEDO ISD BOARD MEETING TEMPLATE

MEETING DATE: November 13, 2017

AGENDA ITEM: Consider Approval of Purchase of Playground Equipment for Walsh Elementary School

PRESENTER: Earl Husfeld

ALIGNS TO BOARD GOAL(S): Financial/Facilities – The District shall exhibit excellence in financial and facility planning, management, and stewardship.

BACKGROUND INFORMATION:

- As you are aware, the Walsh Elementary School Project was included within the new construction component of the District's successful 2015 Bond Election.
- Included within this project cost were funds allocated for the purchase of materials and equipment to outfit this building to the same standard as the District's other elementary schools.

ADMINISTRATIVE CONSIDERATIONS:

- For the past several months, district staff have undertaken the process of discussing and evaluating the playground equipment options for the two (2) playground areas at Walsh Elementary School.
- For your review, the following pages provide a detailed overview of the playground equipment being recommended for Walsh Elementary School.
- Incorporated into these designs are a variety of "stations" that are accessible for all students. As you will also note, the wheelchair platform swing, ADA swing, and engineered wood fiber we have installed at the District's other elementary school playgrounds have been incorporated into these designs.
- To ensure the best pricing and value, the District utilized the TIPS purchasing cooperative to obtain this bid/proposal from Heartland Park & Recreation, LLC.

FISCAL NOTE:

The total amount of \$170,290.00 is within the projected FF&E budget and will be paid with 2015 bond funds allotted for Walsh Elementary School.

ADMINISTRATIVE RECOMMENDATION:

The Administration recommends the Board of Trustees approve acceptance of the bid/proposal received from Heartland Park & Recreation, LLC and award them the Walsh Elementary School playground equipment and installation bid/proposal as presented.

ALEDO
NE VIEW

R5

FOR KIDS
AGES
5-12

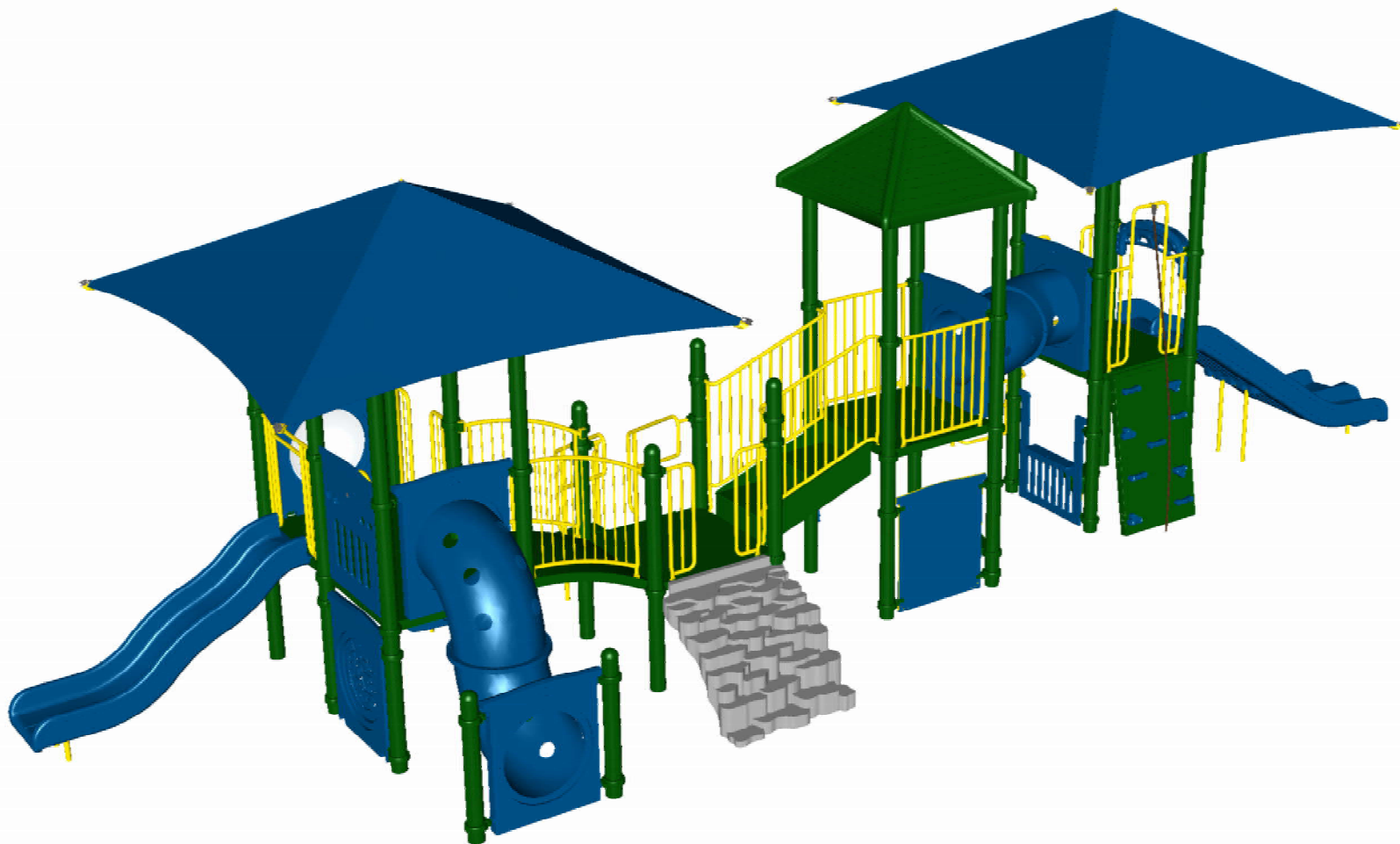

STRUCTURE#: R50626B8A

PROJECT#: HLP173FDC1A

DATE: 9/20/2017 | DRAWN BY: AMG



ALEDO
SW VIEW

R5

FOR KIDS
AGES
5-12

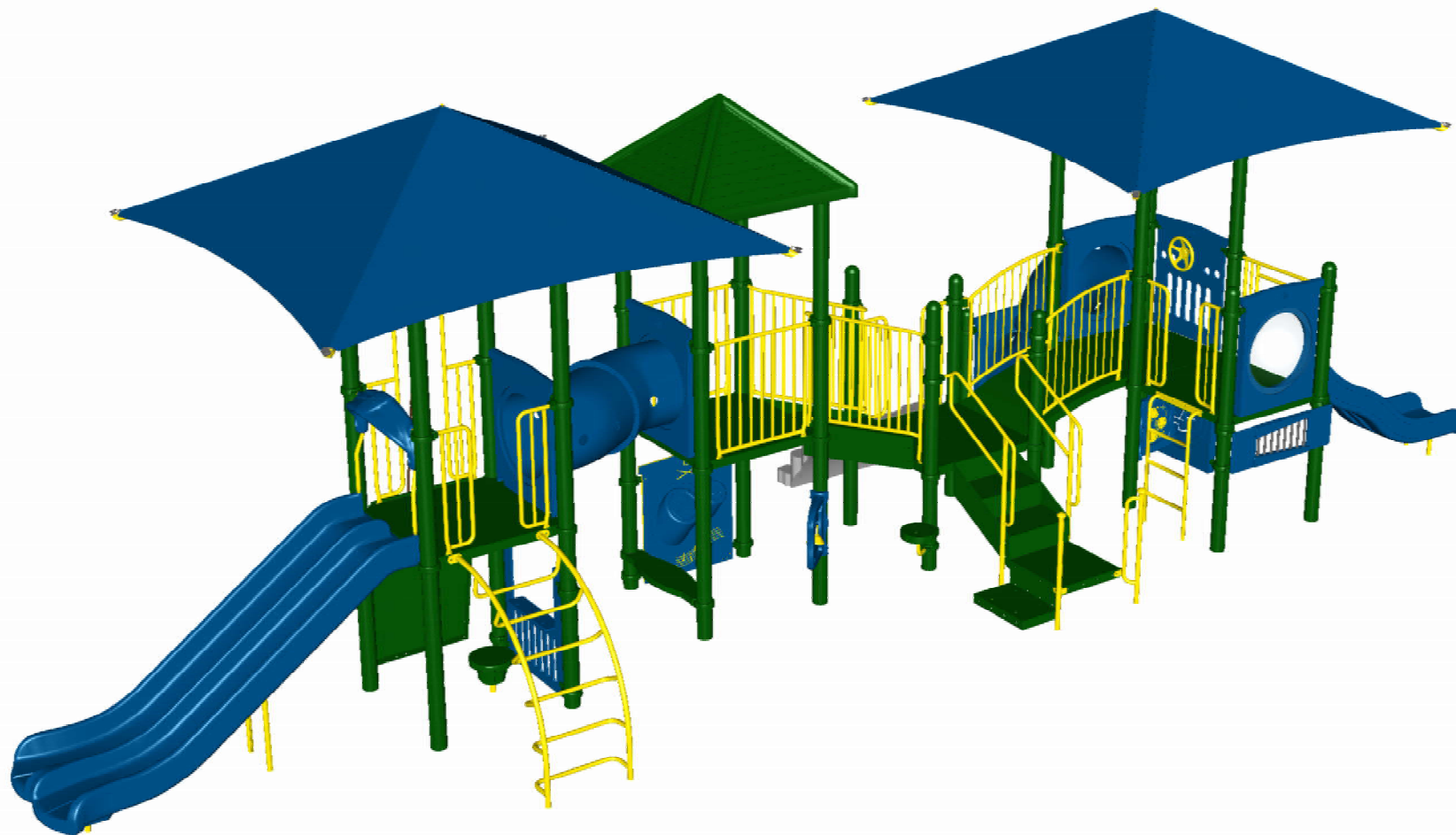

STRUCTURE#: R50626B8A

PROJECT#: HLP173FDC1A

DATE: 9/20/2017 | DRAWN BY: AMG



ALEDO TOP VIEW

ADA ACCESSIBILITY GUIDELINE - ADAAG CONFORMANCE

ELEVATED	ACCESSIBLE	RAMP ACCESSIBLE	GROUND	TYPES
9	9/5	0	8/3	4/3

R5

FOR KIDS
AGES
5-12

GENERAL NOTES:

This conceptual plan is based on information provided prior to construction. Detailed site information, including the following, should be obtained, evaluated, and utilized in the final project design. Exact site dimensions, topography, existing utilities, soil conditions and drainage solutions.

WARNING: Accessible safety surfacing material is required beneath and around this equipment that has a critical height value (Fall Height) appropriate for the highest accessible part of this equipment. Refer to the CPSC's Handbook For Public Playground Safety, Section 4: Surfacing.

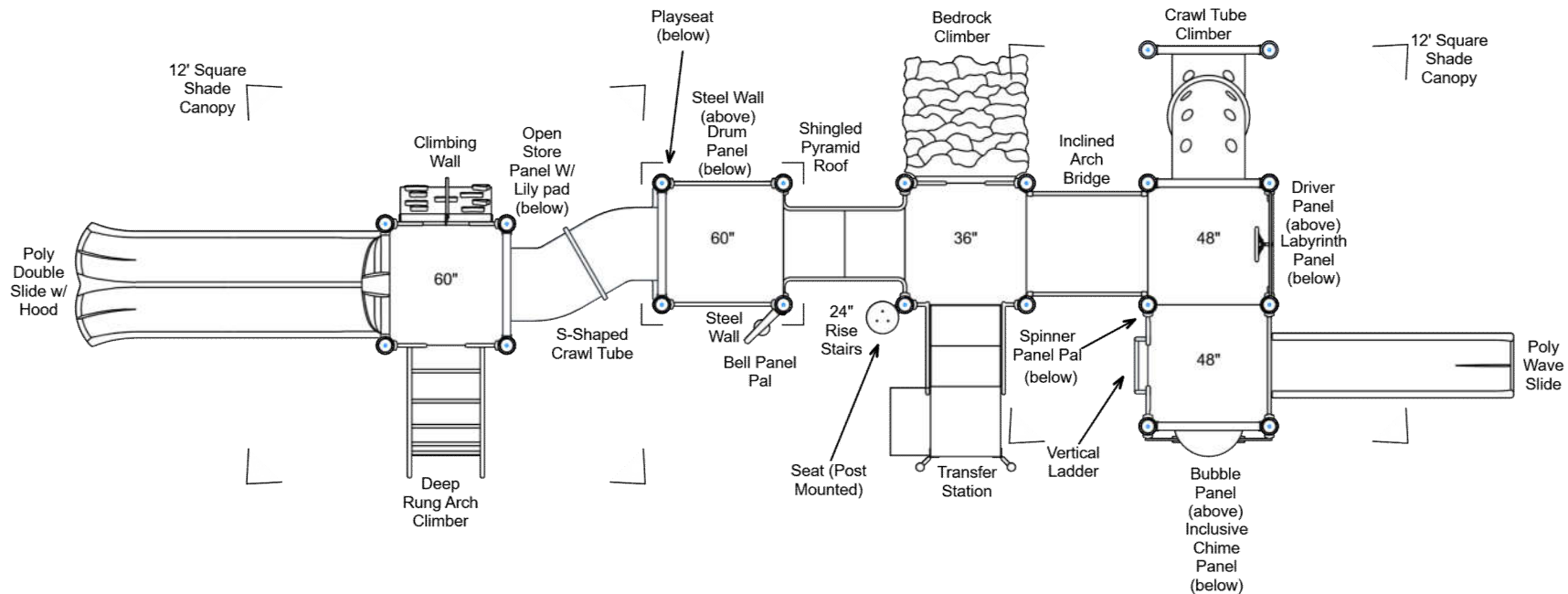

STRUCTURE#: R50626B8A

PROJECT#: HLP173FDC1A

DATE: 9/20/2017 | DRAWN BY: AMG

MIN. USE ZONE: 57' x 26'

PLAYCRAFT REP:

Heartland Park and Recreation,



ALEDO SITE PLAN

ADA ACCESSIBILITY GUIDELINE - ADAAG CONFORMANCE

ELEVATED	ACCESSIBLE	RAMP ACCESSIBLE	GROUND	TYPES
9	9/5	0	8/3	4/3

R5

FOR KIDS
AGES
5-12

GENERAL NOTES:

This Preliminary Site Plan is based on measurements that were provided in the initial planning phase. All dimensions must be verified prior to the submission of a purchase order. Krauss Craft, Inc. will not be held responsible for any discrepancies between actual dimensions and dimensions submitted in the planning phase.

The Minimum Use Zone for a play structure is based on the product design at the time of proposal. Components and structure designs may be subject to change which may affect dimensions. Therefore, before preparing the site, we strongly recommend obtaining final drawings from the factory (available after the order is placed and included in the Assembly Manual).

WARNING: Accessible safety surfacing material is required beneath and around this equipment that has a critical height value (Fall Height) appropriate for the highest accessible part of this equipment. Refer to the CPSC'S Handbook For Public Playground Safety, Section 4: Surfacing.

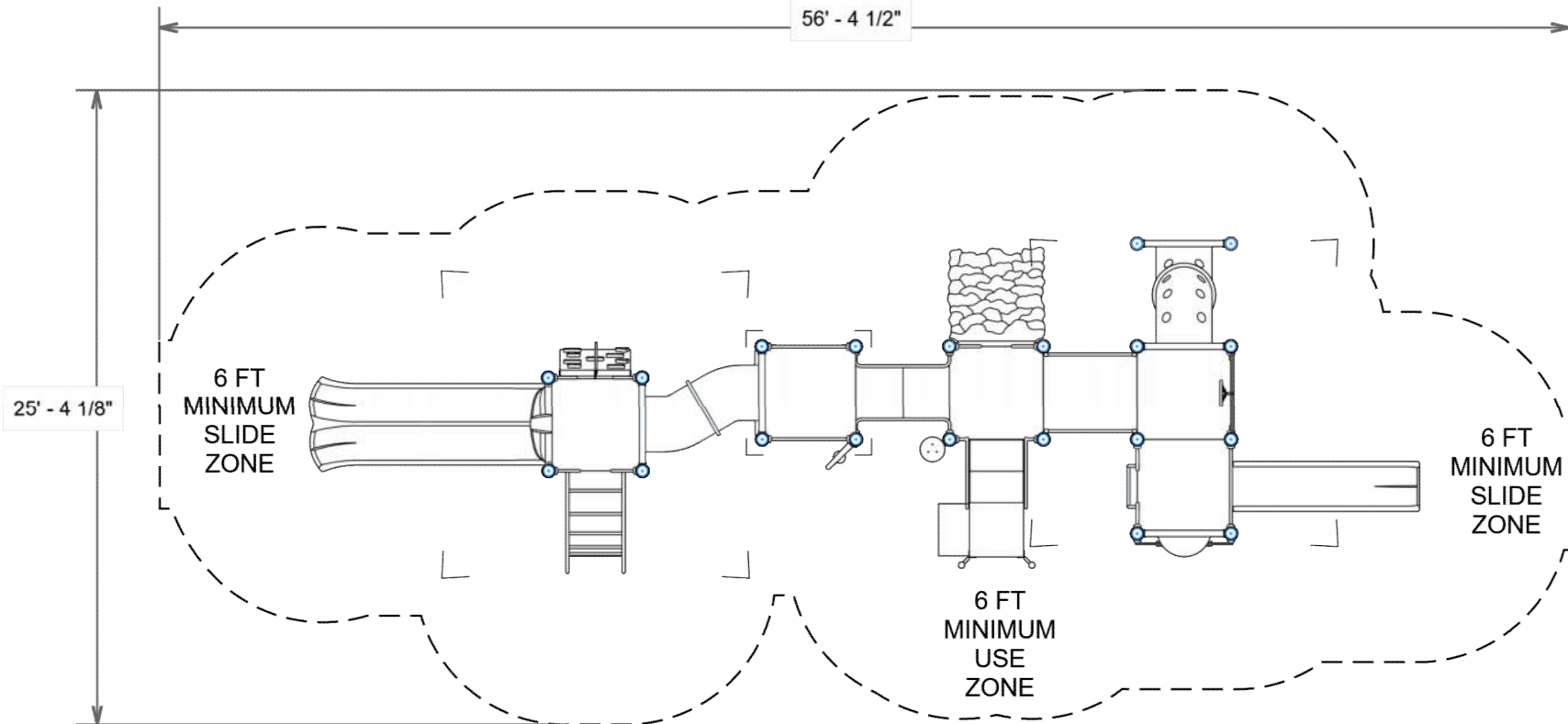

PROJECT#: HLP173FDC1A

DATE: 9/20/2017 | DRAWN BY: AMG

MIN. USE ZONE: 57' x 26'

PLAYCRAFT REP:

Heartland Park and Recreation,





Bill of Materials

ALEDO
Kyle Spencer

Project# HLP173FDC1A
9/20/2017

Item	Description	Quantity
R50626B8A		
HS-1004-R	Collars	63
GF-7002	Dome Cap, R5	8
S-1007-R5-07ft	Post, 07ft R5	2
S-1010-R5-10ft	Post, 10ft R5	2
S-1011-R5-11ft	Post, 11ft R5	4
S-1015-R5-15ft	Post, 15ft R5	8
S-1016-R5-16ft	Post, 16ft R5	4
S-1101-R5	Square Deck	5
S-1206-24R45	ADA Stairs, 24in Rise w/ Walls	1
S-1209-24-R5	Transfer Station, 36in-L	1
S-1210-48R5	Climber, Vertical Ladder 42-48in	1
S-1214-5R5	Climber, Wall 54-60in	1
S-1219-5R5	Climber, Deep Rung Arch 54-60in	1
S-1228-3R	Climber, Bedrock 30-36in	1
S-1301-R5	Wall, Steel 36in (Standard)	2
S-1414	Lily Pad Seat	1
S-1500-2I-48R5G	Climber, Crawl Tube 48in (Ground)	1
S-1500-2S575R5	Crawl Tube, S-Shaped 57.495 (2-Sect., Left)	1
S-1514-45R5	Bridge, Inclined Arch (45in)	1
S-1602-R5	Bubble Panel	1
S-1625-R5	Driver Panel	1
S-1634-R5G	Labyrinth Panel	1
S-1645-R5G	Store Panel (Open)	1
S-1658-R5G	Drum Panel	1
S-1661-R5	Panel Pal, Bell	1



Bill of Materials (continued)

Item	Description	Quantity
S-1666-R5	Panel Pal, Spinner	1
S-1687-R5	Inclusive Panel, Chime	1
S-1702-5R5H	Slide, Double 60in (w/ Hood)	1
S-1704-4R5	Slide, Wave 48in (Single)	1
S-18021-12R5	Shade Canopy, 12ft Square	2
S-1807-R5	Roof, Square Pyramid (Shingled)	1
S-1962-R5	Play Seat	1
S-1963-R5	Seat on Post	1
HS-1100-2	Deck to Deck Hardware	2

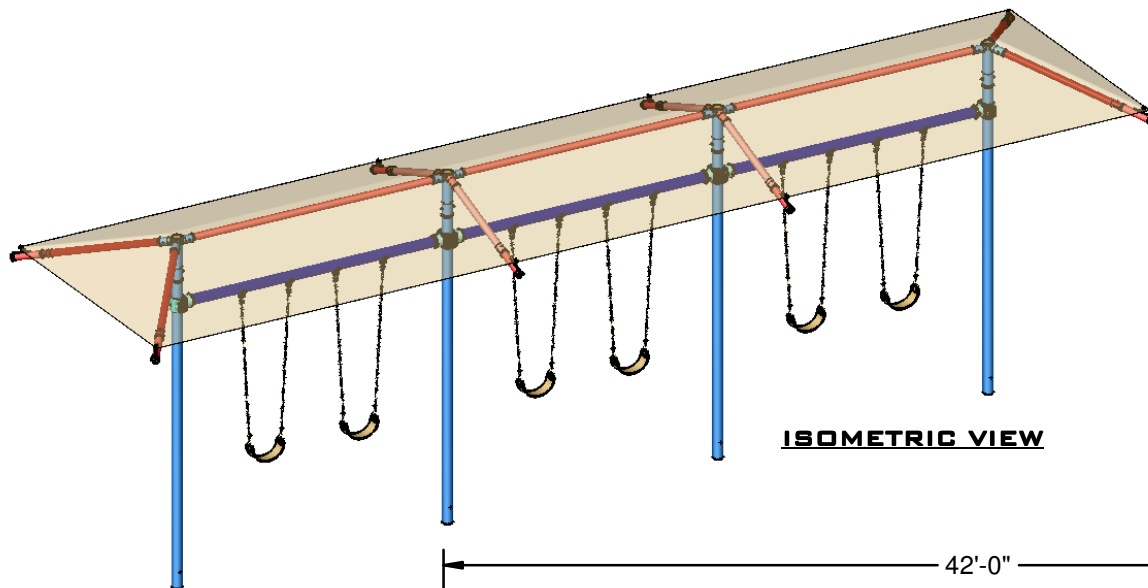

ISOMETRIC VIEW

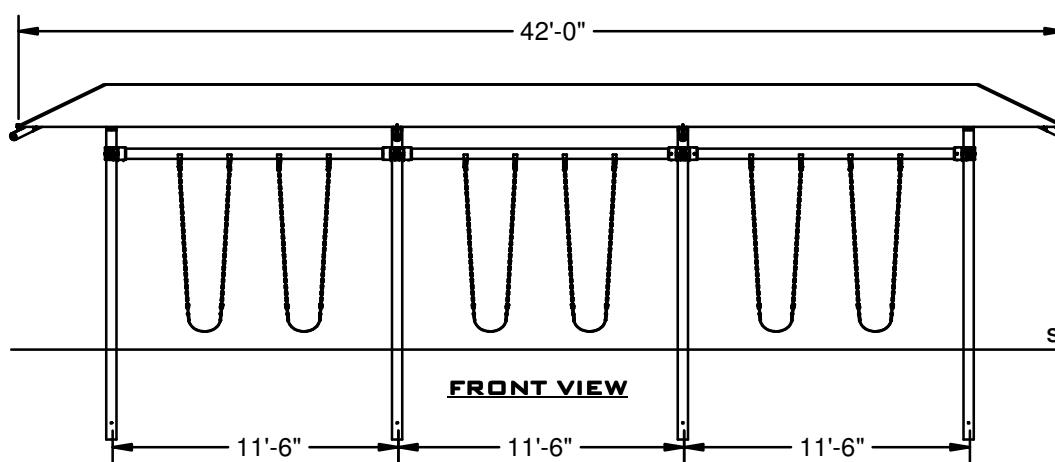

FRONT VIEW

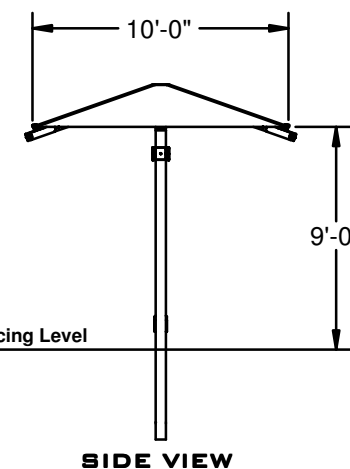

SIDE VIEW

REF.#	PART DESCRIPTION	QTY.
1	Ø5" Three Socket End Crown	2
2	Ø5" Four Socket Mid Crown	2
3	Ø3 1/2" x 131 1/2" Swaged Ridge Pole	3
4	Ø3 1/2" x 64 3/4" Swaged End Rafter	4
5	Ø3 1/2" x 50" Swaged Mid Rafter	4
6	Ø3 1/2" Glide Insert Mechanism	8
7	42' x 10' Fabric Cover w/ Cable	1
8	Frane Hardware Kit	1

SYMBOL KEY:	
1	ITEM NUMBER
1 3	ITEM NUMBER OVER QTY.

SUPERIOR SHADE

150 ADAMSON INDUSTRIAL BOULEVARD
CARROLLTON, GA 30116
1-800-356-4727

DESCRIPTION: ADD-ON THREE BAY SWING SHADE

SCALE:	Varies	SHADE STYLE:	Glide Umbrella	SHEET:	1 OF 3
DATE:		UNITS:	INCHES / FEET	PROPOSAL NO:	

3 2 1 1 2 3

A

B

C

D

A

B

C

D

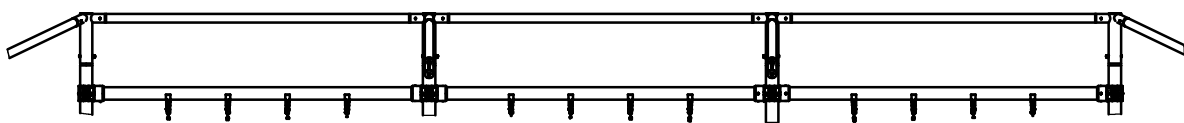

NOTE, IF COLUMNS ARE ALREADY IN CONCRETE:
CROWNS AND RIDGE POLES MUST BE PRE
ASSEMBLED AND LOWERED ON TO COLUMNS.

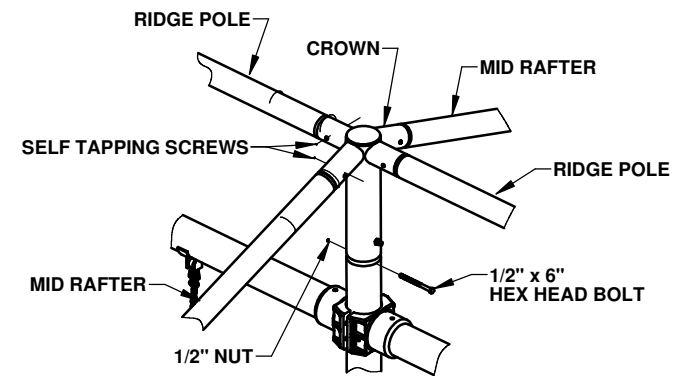
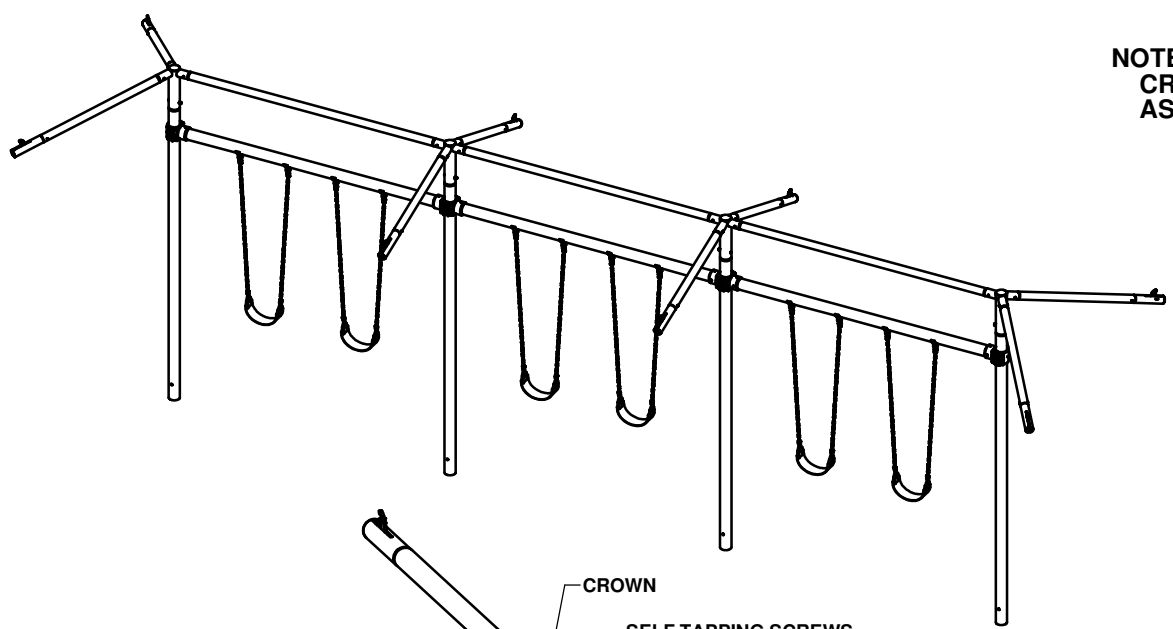

MID CONNECTION

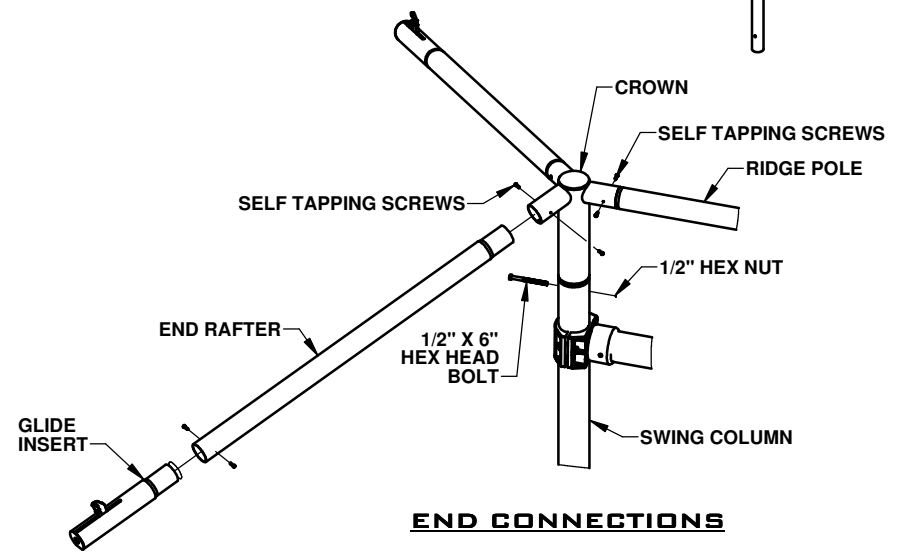

END CONNECTIONS

3 2 1 1 2 3

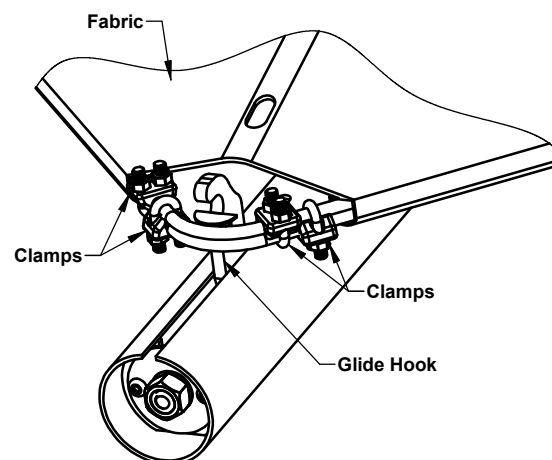
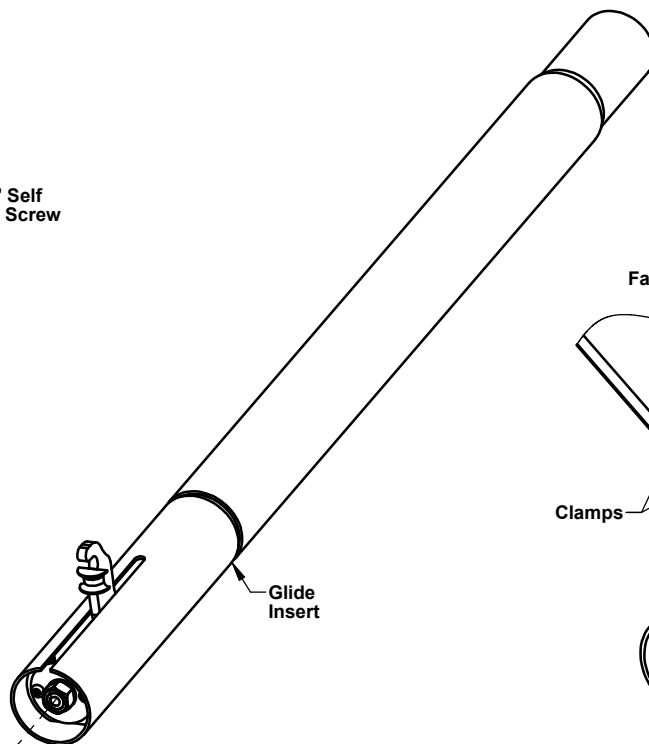
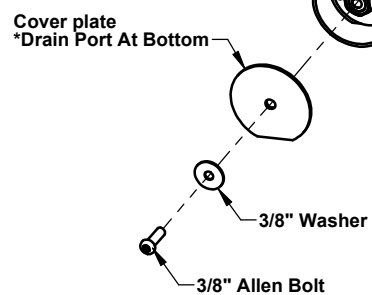
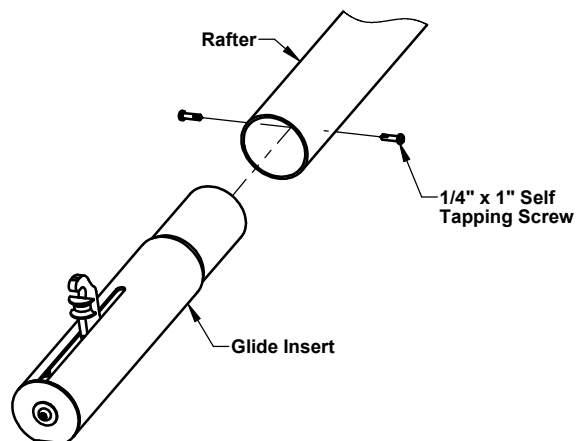

NOTE: On three Of The Four Corners The Cable Will Loop Over Glide Hook Followed By Fabric.

On The Fourth Corner The Cable Ends Will Overlap Under Hook And Secured With TWO Cable Clamps On Both Sides Of Hook. Loose Ends Are Then Tucked Back Into Fabric Hems.

SUPERIOR SHADE

DESCRIPTION: **GLIDE DETAILS**

SHEET: **3 OF 3**

ALEDO
NE VIEW

RH5

FOR KIDS
AGES
5-12



STRUCTURE#: R5HDA265A

PROJECT#: HLP17334C1A

DATE: 9/22/2017 | DRAWN BY: AMG

PLAYCRAFT
SYSTEMS

ALEDO
SW VIEW

RH5

FOR KIDS
AGES
5-12



STRUCTURE#: R5HDA265A

PROJECT#: HLP17334C1A

DATE: 9/22/2017 | DRAWN BY: AMG

PLAYCRAFT
SYSTEMS

ALEDO TOP VIEW

ADA ACCESSIBILITY GUIDELINE - ADAAG CONFORMANCE

ELEVATED	ACCESSIBLE	RAMP ACCESSIBLE	GROUND	TYPES
10	5/5	0	13/3	3/3



GENERAL NOTES:

This conceptual plan is based on information provided prior to construction. Detailed site information, including the following, should be obtained, evaluated, and utilized in the final project design. Exact site dimensions, topography, existing utilities, soil conditions and drainage solutions.

WARNING: Accessible safety surfacing material is required beneath and around this equipment that has a critical height value (Fall Height) appropriate for the highest accessible part of this equipment. Refer to the CPSC's Handbook For Public Playground Safety, Section 4: Surfacing.

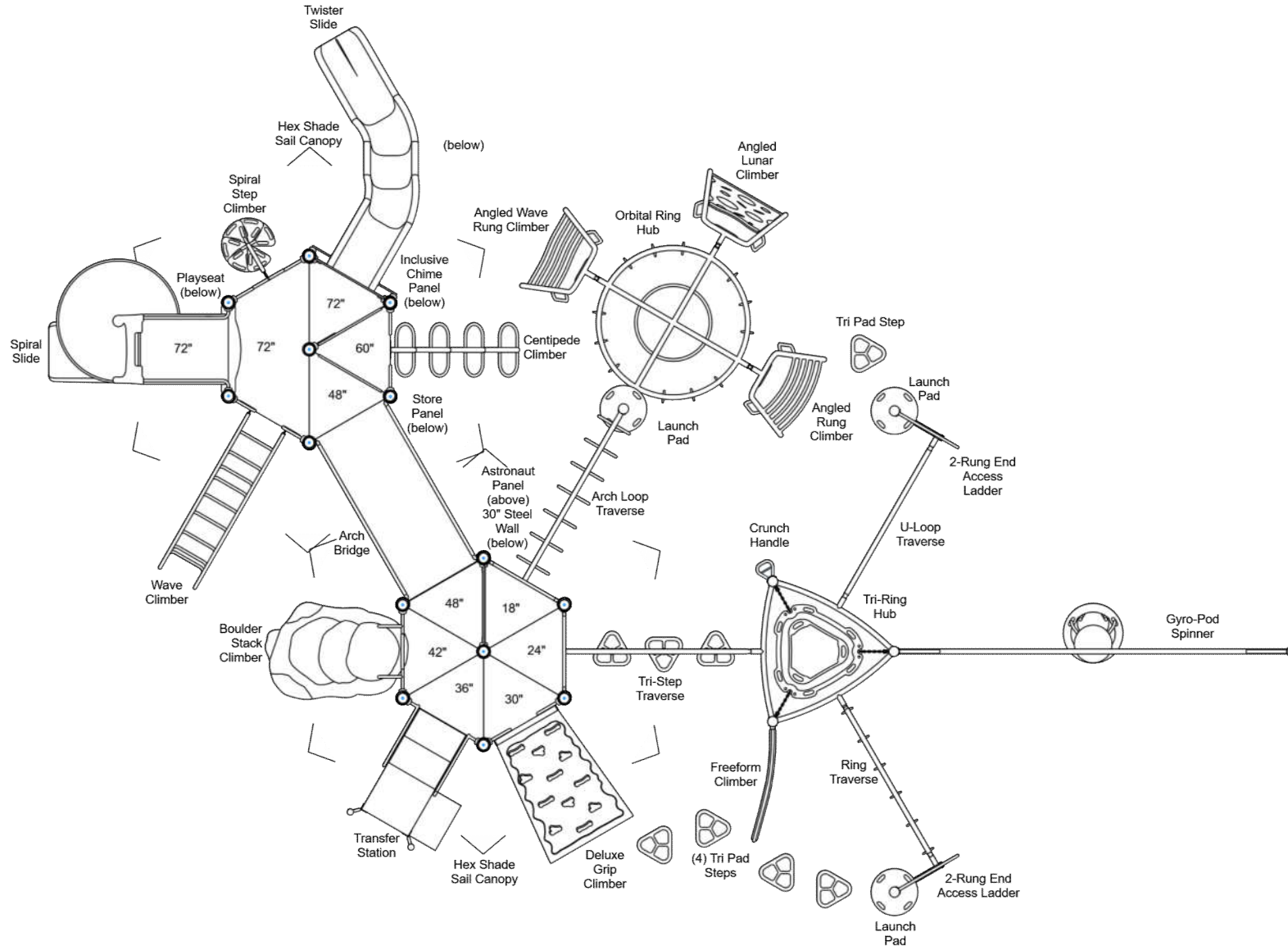

STRUCTURE#: R5HDA265A

PROJECT#: HLP17334C1A

DATE: 9/22/2017 | DRAWN BY: AMG

MIN. USE ZONE: 62' x 48'

PLAYCRAFT REP:

Heartland Park and Recreation,



ALEDO SITE PLAN

ADA ACCESSIBILITY GUIDELINE - ADAAG CONFORMANCE

ELEVATED	ACCESSIBLE	RAMP ACCESSIBLE	GROUND	TYPES
10	5/5	0	13/3	3/3



GENERAL NOTES:

This Preliminary Site Plan is based on measurements that were provided in the initial planning phase. All dimensions must be verified prior to the submission of a purchase order. Krauss Craft, Inc. will not be held responsible for any discrepancies between actual dimensions and dimensions submitted in the planning phase.

The Minimum Use Zone for a play structure is based on the product design at the time of proposal. Components and structure designs may be subject to change which may affect dimensions. Therefore, before preparing the site, we strongly recommend obtaining final drawings from the factory (available after the order is placed and included in the Assembly Manual).

WARNING: Accessible safety surfacing material is required beneath and around this equipment that has a critical height value (Fall Height) appropriate for the highest accessible part of this equipment. Refer to the CPSC'S Handbook For Public Playground Safety, Section 4: Surfacing.

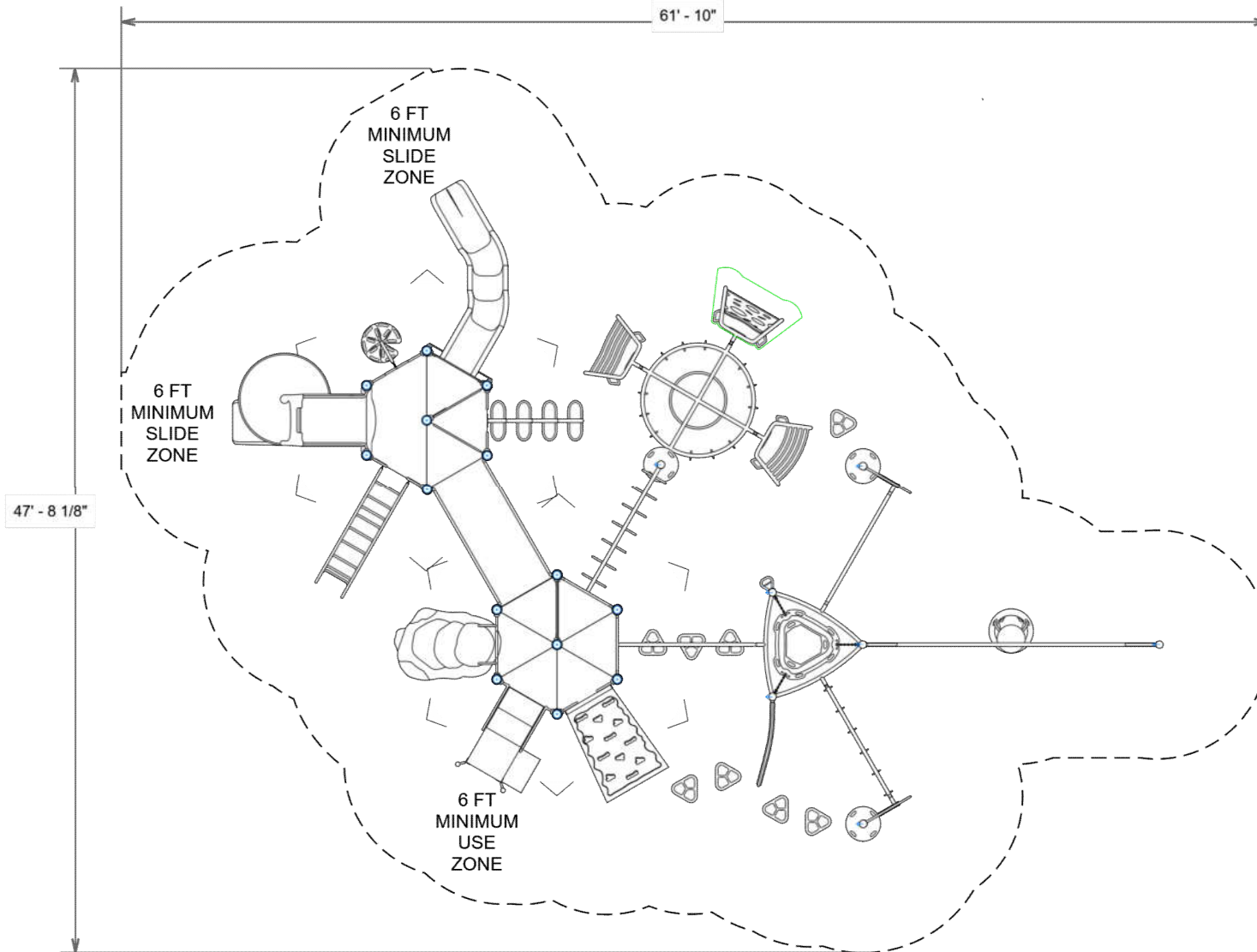

PROJECT#: HLP17334C1A

DATE: 9/22/2017 | DRAWN BY: AMG

MIN. USE ZONE: 62' x 48'

PLAYCRAFT REP:

Heartland Park and Recreation,





Bill of Materials

ALEDO
Kyle Spencer

Project# HLP17334C1A
9/22/2017

Item	Description	Quantity
R5HDA265A		
HS-1004-R	Collars	70
GF-7002	Dome Cap, R5	2
S-1011-R5-11ft	Post, 11ft R5	1
S-10132-RV5	Post (132in) RV5	3
S-10138-RV5	Post (138in) RV5	4
S-1013-R5-13ft	Post, 13ft R5	1
S-1015-R5-15ft	Post, 15ft R5	6
S-1017-R5-17ft	Post, 17ft R5	6
S-1102-R5	Tri-Deck	9
S-1103-R5	Hex Deck, Half (5 Post)	1
S-1110-R	Filler, Universal (12in)	2
S-1209-24-R5	Transfer Station, 36in-R	1
S-1211-R	Filler, Step - 24in, R5	1
S-1216-DLX3R5	Climber, Deluxe Grip 30-36in	1
S-1220-5R5	Climber, Centipede 54-60in	1
S-1225-6R	Climber, Wave 66-72in	1
S-1234-6R	Climber, Spiral Step 66-72in	1
S-1238-RV5	Climber, Freeform	1
S-1277-MNT-RV5	Climber, Angled Lunar	1
S-1278-MNT-RV5	Climber, Angled Rung	1
S-1287-MNT-RV5	Climber, Angled Wave Rung	1
S-1290-D2-R5	Climber, Boulder Stack 42-48in	1
S-1301-30R5	Wall, Steel (30in)	1
S-1309-R5_1R	Half Walls (Single, Right)	1
S-1404-RV2	End Access Ladder (2 Rung)	2



Bill of Materials (continued)

Item	Description	Quantity
S-1408-2RV	Ring (w/ Two Housings)	1
S-1419-CLR-1RH5	Tri-Step (Hybrid w/ 1 Mount, Multi-colored)	1
S-1433-3RV	Orbital Ring Hub (3 Mounts)	1
S-1435-RH5	Arch Loop (RV Post Mount)	1
S-1502-90	Bridge, Arch (90in)	1
S-1615-R5	Store Panel	1
S-1657-R5	Astronaut Panel	1
S-1687-R5	Inclusive Panel, Chime	1
S-1706-R5	Slide, Spiral 72in	1
S-1710-6R5-LSL	Slide, Twister 72in (L-S-L)	1
S-18028-R514	Shade Sail, Hex 14ft	2
S-1937-RV	Crunch Handle	1
S-1959-3RV-3	Tri-Ring Hub (3 Section, 3 Mount)	1
S-1961-RV	Tri Pad	5
S-1962-R5	Play Seat	1
S-1967-2RV	U-Loop (w/ 2 Housings)	1
S-1974-RVSTRT	Gyro-Pod Spinner (Straight)	1
S-21004-LTRV	Hanger (Left Turn)	1
S-21004-RTRV	Hanger (Right Turn)	1
S-21263-RV	Launch Pad RV	3
HS-1100-2	Deck to Deck Hardware	2

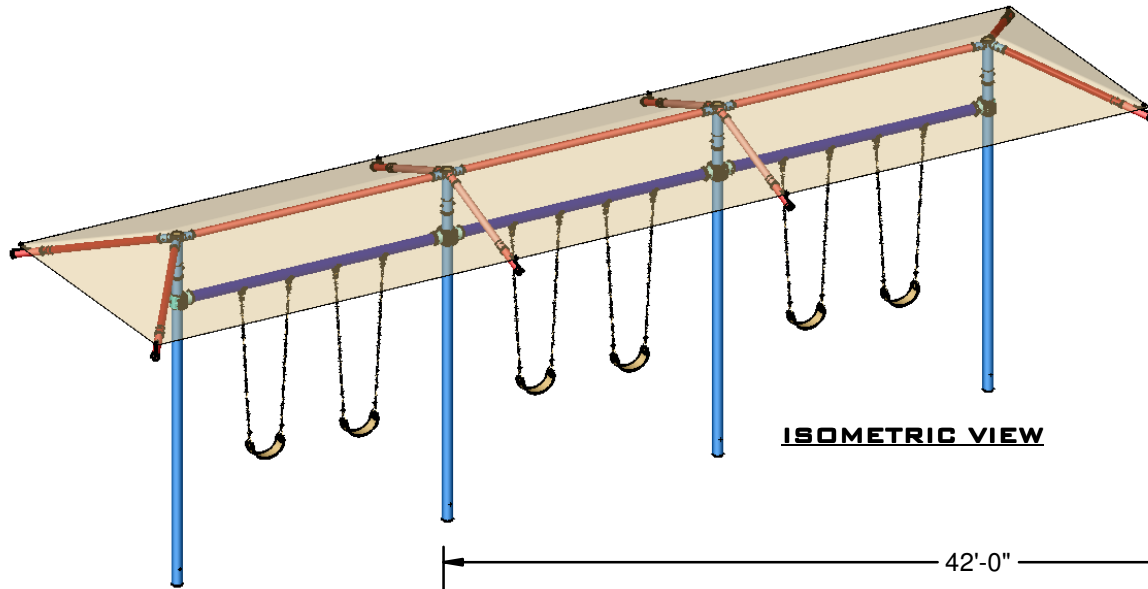

ISOMETRIC VIEW

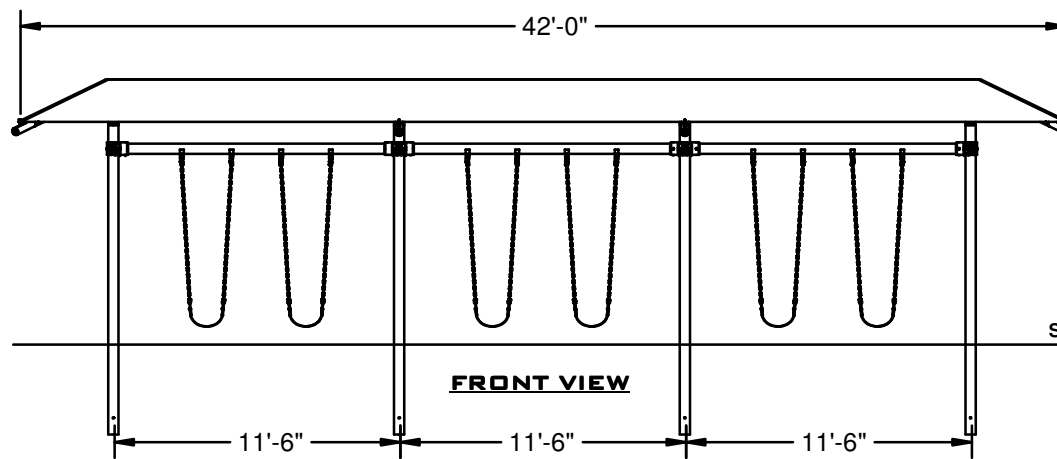

FRONT VIEW

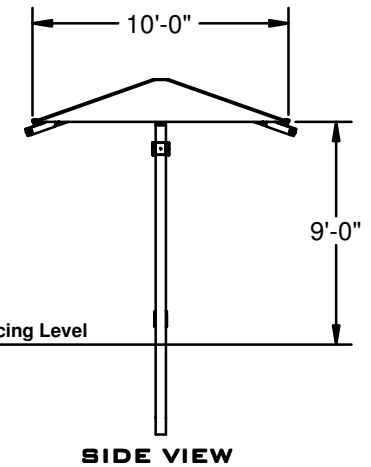

SIDE VIEW

REF.#	PART DESCRIPTION	QTY.
1	Ø5" Three Socket End Crown	2
2	Ø5" Four Socket Mid Crown	2
3	Ø3 1/2" x 131 1/2" Swaged Ridge Pole	3
4	Ø3 1/2" x 64 3/4" Swaged End Rafter	4
5	Ø3 1/2" x 50" Swaged Mid Rafter	4
6	Ø3 1/2" Glide Insert Mechanism	8
7	42' x 10' Fabric Cover w/ Cable	1
8	Frane Hardware Kit	1

SYMBOL KEY:

- 1 — ITEM NUMBER
 1 — ITEM NUMBER
 3 — OVER QTY.

SUPERIOR SHADE

150 ADAMSON INDUSTRIAL BOULEVARD
 CARROLLTON, GA 30116
 1-800-356-4727

DESCRIPTION:

ADD-ON THREE BAY SWING SHADE

SCALE:	Varies	SHADE STYLE:	Glide Umbrella	SHEET:	1 OF 3
DATE:		UNITS:	INCHES / FEET	PROPOSAL NO.:	

3 2 1 1 2 3

A

B

C

D

A

B

C

D

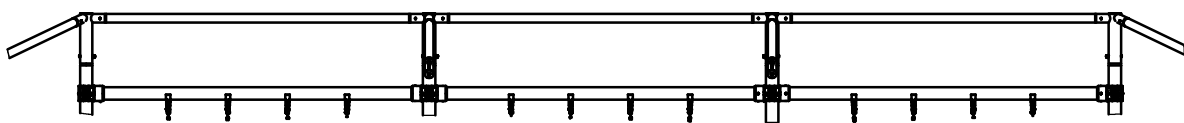

NOTE, IF COLUMNS ARE ALREADY IN CONCRETE:
CROWNS AND RIDGE POLES MUST BE PRE
ASSEMBLED AND LOWERED ON TO COLUMNS.

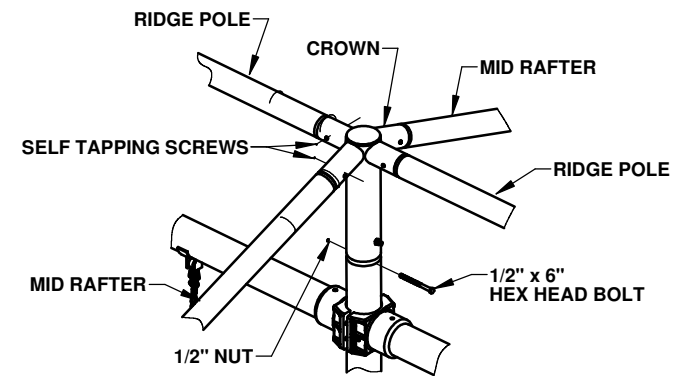
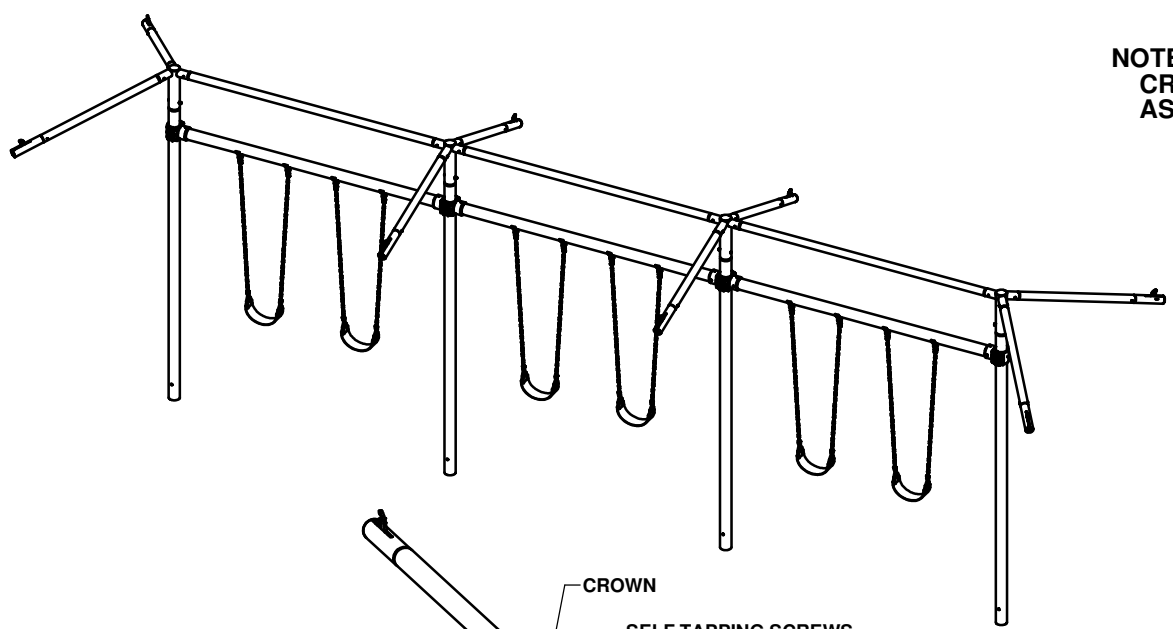

MID CONNECTION

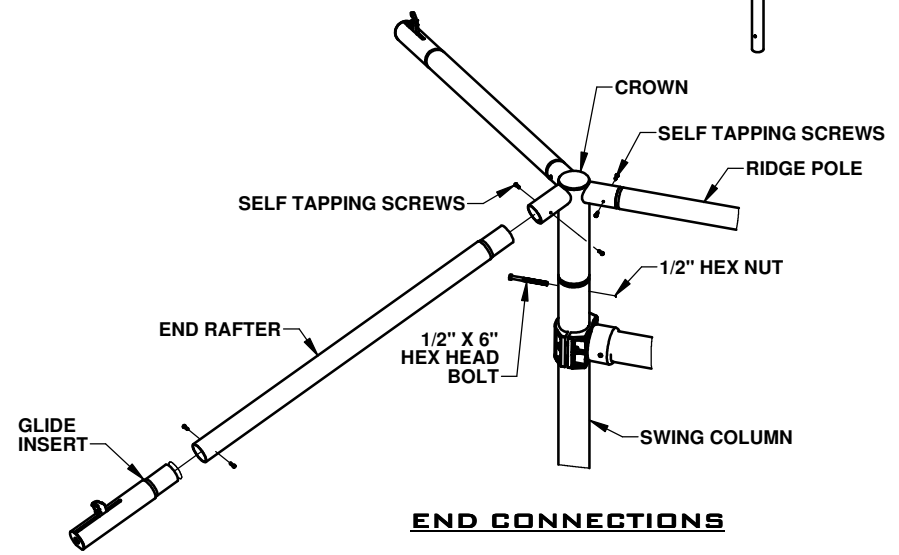

END CONNECTIONS

3 2 1 1 2 3

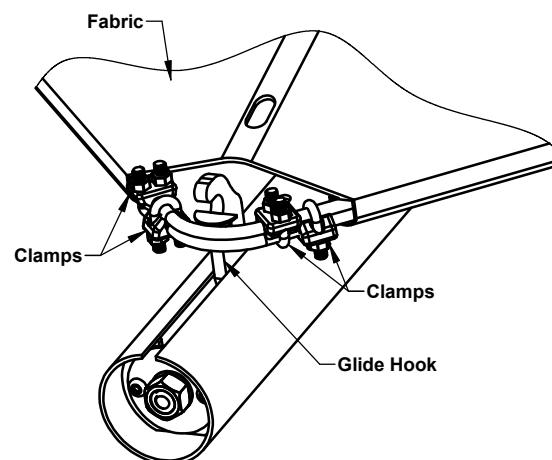
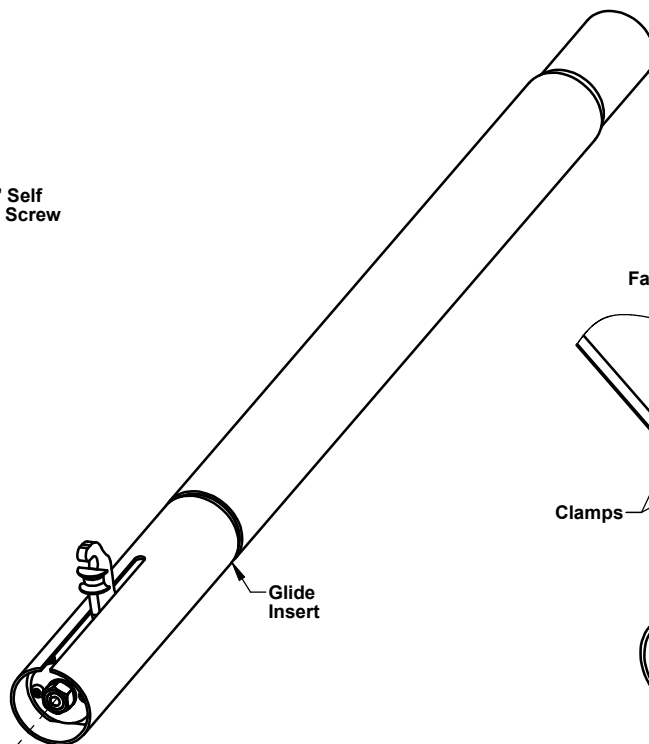
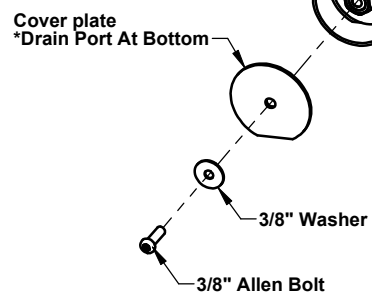
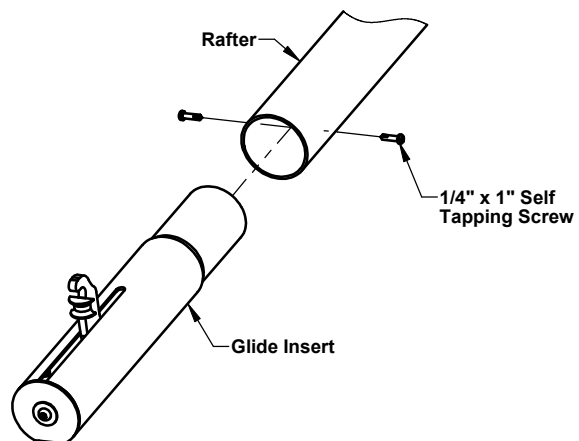

NOTE: On three Of The Four Corners The Cable Will Loop Over Glide Hook Followed By Fabric.

On The Fourth Corner The Cable Ends Will Overlap Under Hook And Secured With TWO Cable Clamps On Both Sides Of Hook. Loose Ends Are Then Tucked Back Into Fabric Hems.

SUPERIOR SHADE

DESCRIPTION: **GLIDE DETAILS**

SHEET: **3 OF 3**