

PLAN KEY

- 1 FOOTBALL FIELD
- 2 PLACE NEW BASE MAT ON EXISTING TRACK AND RESTRIPE
- 3 STORAGE SHED
- 4 18" CURB AND GUTTER
- 5 CONCRETE SIDEWALK
- 6 EXISTING TREES TO REMAIN, TYP.
- 7 LIGHT POLE, TYP.
- 8 TRANSITION TO STANDARD CURB AND BUTTER AT INLET
- 9 ACCESSIBLE SIDEWALK
- 10 10'X10' CONCRETE SHOT PUT PAD, SYNTHETIC TOEBOARD, AND ALUMINUM SHOT CIRCLE. GILL ATHLETICS MODEL 359 AND 372
- 11 DISCUS CAGE AND BARRIER NET. GILL ATHLETICS MODELS 8010 AND 370
- 12 50'X50' HIGH JUMP AREA
- 13 198" X 96" HIGH JUMP PIT. GILL ATHLETICS MODEL 64117 -S1
- 14 LONG/TRIPLE JUMP CONCRETE RUNWAY WITH TRACK SURFACING AND 2" STRIPING
- 15 LONG JUMP/TRIPLE JUMP PIT WITH 6" WIDE X 18" DEEP CONCRETE PERIMETER CURB
- 16 H-STYLE FOOTBALL GOAL POST BY SPORTSFIELD SPECIALTIES
- 17 RELOCATE EXISTING GOAL POST

Site Changes Package: \$221,000

1) SHED: \$90,000

- * Shed to house athletic equipment and maintenance equipment
- * Vogel cost to remove existing shed and install new 20x40 shed, (2) overhead doors, lights, concrete aprons, etc

2) ATHLETIC EQUIPMENT: \$79,000

- * Added shot put, discus, long jump and high jump exterior equipment and associated concrete, pavement and track surfacing

3) SITE STORMWATER: \$52,000

- * Required for added site improvements

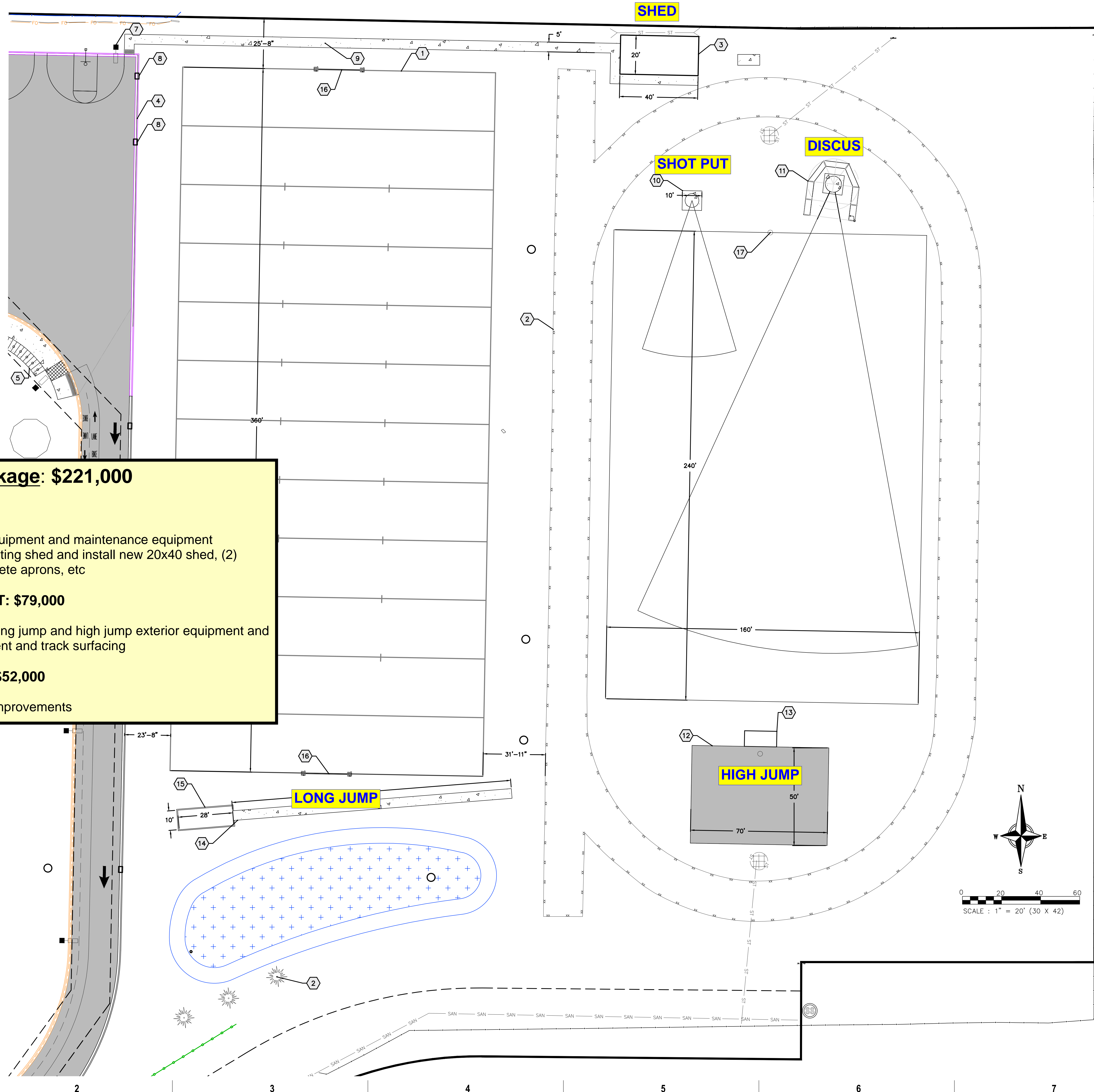

818 N Meadowbrook Ln
Waunakee, WI 53597
(608) 849-9378

PROJECT INFORMATION

WAUNAKEE
COMMUNITY
MIDDLE SCHOOL

501 SOUTH STREET
WAUNAKEE, WI
53597

ISSUANCE AND REVISIONS

DATE	DESCRIPTION
03-08-2024	CONSTRUCTION DOCUMENTS
04-05-2024	ADDENDUM #2
05-24-2024	ADDENDUM #5
02-07-2025	CB 08
05-28-2025	

KEY PLAN

SHEET INFORMATION

PROJECT MANAGER RS
PROJECT NUMBER 319203-01

SITE PLAN

C204

© 2023 Epstein Uhen Architects, Inc.