



A TENCATE COMPANY 

ORIGINAL

ON TIME | ON BUDGET | ON TARGET | EVERY TIME

MARY M. KNIGHT SCHOOL DISTRICT- LIGHTING PROPOSAL



SUBMITTAL DATE

MAY 5, 2026

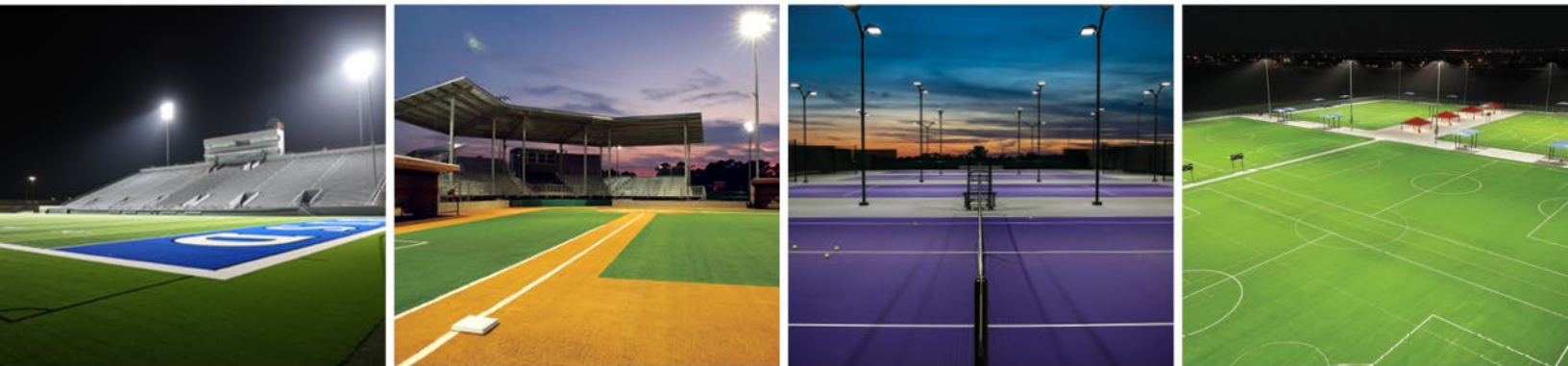



SPORTS LIGHTING PROPOSAL

Mary M Knight
Multipurpose Field – Budget

Hellas Sports Lighting, (herein called Hellas), will provide all materials, labor and equipment as described below.

Proposal materials include:

- 56 - Fixtures for Field Lighting – CLIR2-SV.
- 8 - Fixtures for egress Lighting – TSL-SV.
- Pre-wired plug and play crossarms down to remote distribution panel.
- 7 – 70ft Concrete Encased Direct Embedded Steel Sports Light Poles
- Remote distribution panel inclusive of individual fixture breakers, additional 75kA surge protection and disconnect per pole.
- 10 Year Manufacturers' Warranty.
- Controls – Onsite push button with 10yrs. of offsite service.
- Commissioning and training of new lighting system.
- Freight to job site.

Total cost for lighting package..... \$416,500

Sports Lighting Installation Includes:

- Offloading of sports lighting system.
- Foundations.
- Assembly & installation of new sports lighting system.
- Individual laser aiming of all sports lighting.
- 100ft of underground branch circuit to new sports lighting poles.

QUALIFICATIONS:

1. Pricing is based on installation of sports lighting, and related materials.
2. Fixture installation will require full access to the fields/stadium without the need of any turf protection.
3. Pricing is based on 100ft of underground branch circuit. Branch circuit is based on 480-volt, 3-phase panel being available within 100ft.
4. Customer is responsible for providing all local electrical service utility fees and equipment.
5. Drilling and trenching are based on normal soil conditions without consideration of rock removal/water/sand/etc. Engineered Stamped foundation design to be provided upon award of project based on typical soils unless Geotechnical report is provided by owner. No geotechnical engineering or survey is included with this project. Pricing is subject to adjustment if geotechnical report is provided by the owner and soil conditions require additional installation consideration.

EXCLUSIONS:

1. Any item of work not specifically listed above.
2. Any electrical work outside of what is included in narrative above.
3. Removal, replacement or repair of existing trees or other vegetation.
4. Purchasers must provide Hellas with a valid tax exemption and agree to reimbursement of taxed if exemption provided is deemed invalid.
5. Geotechnical Investigation.
6. Engineering.
7. Construction materials inspection and testing.
8. Supply or installation of perimeter safety or construction fencing.
9. Site Security.
10. Any allowances or contingencies.
11. Labor for warranty replacements/repairs.
12. Any permits or fees, including but not limited to, utility impact fees generated.
13. The owner shall provide ingress/egress for ALL personnel, equipment and materials, and typical construction traffic can be expected for the duration of this project. Hellas is not responsible for damage due to typical construction ingress/egress to the construction site.
14. General Contractor to supply secure laydown area for Hellas materials, if applicable.
15. Strobe light for the top of each pole.
16. Any lightning protection on the poles.



DASHED LINES = FIXTURES TURNED OFF
 POLES A1-A2, MP2, & MP4 - 2 EGRESS MOUNTED 40' ABG

Pole	x-loc	y-loc	height	Narrow	Medium	Wide	XWide	Egress	Total	kw
A1	-55	45	70ft						5	4.0
A2	45	-55	70ft						5	4.0
B1	160	-45	70ft		1	4	1		6	4.8
MP1	-30	385	70ft	1	7		2		10	8.0
MP2	-30	175	70ft		6	2	2		10	8.0
MP3	250	385	70ft	1	7		2		10	8.0
MP4	250	175	70ft		6	2	2		10	8.0
other								8	8	5.1
Total				2	27	16	11	8	64	49.8

NEW POLES

Egress
 GeoSport Clr TSLSV 650W
 Light Loss Factor = 0.950
 Watts per luminaire = 636
 Number luminaires used = 8
 kw these luminaires = 5.1

XWide
 GeoSport Clr2 SV 800W
 Light Loss Factor = 0.950
 Watts per luminaire = 800
 Number luminaires used = 11
 kw these luminaires = 8.8

Wide
 GeoSport Clr2 SV 800W
 Light Loss Factor = 0.950
 Watts per luminaire = 796
 Number luminaires used = 16
 kw these luminaires = 12.7

Narrow
 GeoSport Clr2 SV 800W
 Light Loss Factor = 0.950
 Watts per luminaire = 773
 Number luminaires used = 2
 kw these luminaires = 1.5

Medium
 GeoSport Clr2 SV 800W
 Light Loss Factor = 0.950
 Watts per luminaire = 801
 Number luminaires used = 27
 kw these luminaires = 21.6

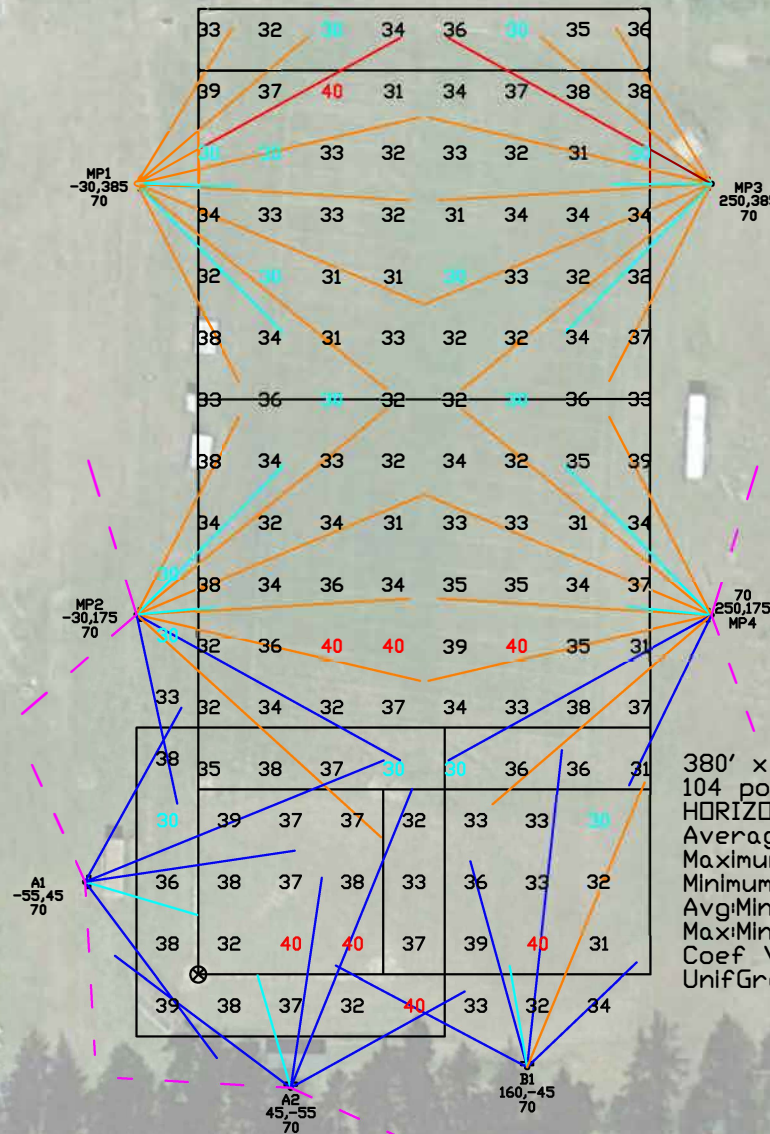

380' x 220' Multi-Purpose Field
 104 points at z=3, sp 30ft by 30ft
HORIZONTAL FOOTCANDLES
 Average 34
 Maximum 40
 Minimum 30
 Avg:Min 1.13
 Max:Min 1.33
 Coef Var 0.08
 UnifGrad 1.33

220/220/200 Baseball
 36 points at z=3, sp 30ft by 30ft
HORIZONTAL FOOTCANDLES
 Average 35
 Maximum 40
 Minimum 30
 Avg:Min 1.17
 Max:Min 1.33
 Coef Var 0.09
 UnifGrad 1.30



MARY M. KNIGHT SCHOOL, ELMA, WA, D1



A TENCATE COMPANY 



MANUFACTURING



DESIGN / BUILD



CONSTRUCTION



TURF



TRACK



COURT SURFACES



SPORT LIGHTING



SERVICE & MAINTENANCE