



Splendora ISD Bond 2022

Elementary Schools

April 28, 2025



A photograph of a classroom filled with young students sitting at tables. The image is overlaid with a semi-transparent blue filter. The text 'Peach Creek Elementary School' is written in white, bold, sans-serif font on the left side. In the bottom left corner is the 'lan' logo, and in the bottom right corner is the circular seal of the 'SUNBELT SCHOOL DISTRICT'.

Peach Creek Elementary School

Construction – Peach Creek

- Completed Activities
 - Transformer set
 - HVAC Chillers set
- Current Activities
 - HVAC piping
 - Casework and doors
 - Ceramic tile
 - MEP rough-in above ceiling
- Upcoming Activities
 - HVAC startup
 - Permanent power
- Substantial Completion
 - July 28, 2025



Construction – Peach Creek



Front Entry



Storefront in area E

Construction – Peach Creek



Casework in area C



Collaboration space

Budget Update– Peach Creek

Peach Creek Elementary Project Budget

Description	Budget	Committed Cost	Forecast	Cost at Completion	Delta
Construction	\$ 40,845,000	\$ 36,187,601	\$ 250,000	\$ 36,437,601	\$ (4,407,399)
Design Services	\$ 2,428,165	\$ 2,403,865	\$ -	\$ 2,403,865	\$ (24,300)
Specialty Services	\$ 536,490	\$ 487,383	\$ 25,000	\$ 512,383	\$ (24,108)
Furniture, Fixtures & Equipment	\$ 1,600,000	\$ 964,721	\$ 400,000	\$ 1,364,721	\$ (235,279)
General Owner Expenses/Allowance	\$ 2,581,010	\$ 1,019,237	\$ 700,000	\$ 1,719,237	\$ (861,773)
Land Acquisition & Development	\$ 1,300,000	\$ 960,000	\$ -	\$ 960,000	\$ (340,000)
Total	\$ 49,290,665	\$ 42,022,806	\$ 1,375,000	\$ 43,397,806	\$ (5,892,859)

Committed to Date

85%

Peach Creek Elementary Allowance Status

Description	Budget	Committed	Remaining	Remaining %
Project Sign	\$1,500	\$1,500	\$0	0%
Utility Allowance	\$67,000	\$0	\$67,000	100%
Owner Betterment Allowance	\$2,567,611	\$1,802,825	\$764,786	30%
Total	\$2,636,111	\$1,804,325	\$831,786	32%





Greenleaf Elementary School

Construction – Greenleaf

- Completed Activities
 - Slab pour area C, D & E
 - Utility tie-in
- Current Activities
 - Steel erection in area B
 - Mechanical hangers in area A
- Upcoming Activities
 - Steel erection in area C & D
 - Masonry wall in area E
- Substantial Completion
 - November 28, 2025

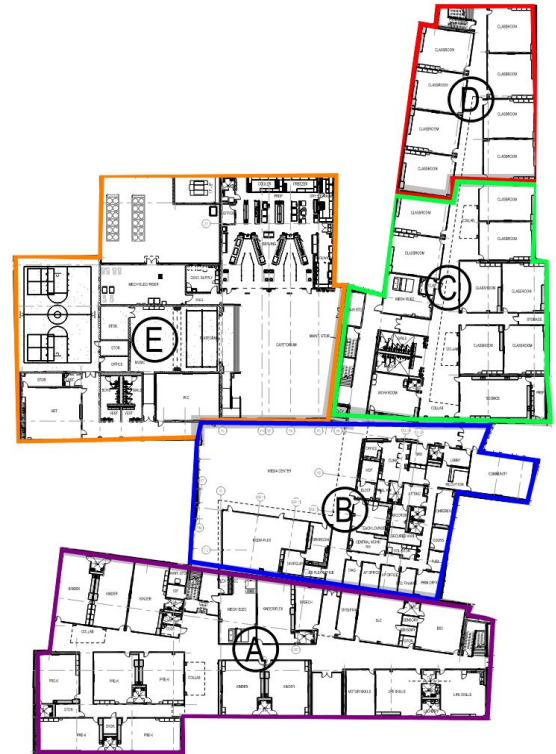

Construction – Greenleaf



Budget Update– Greenleaf

Greenleaf Elementary Project Budget

Description	Budget	Committed Cost	Forecast	Cost at Completion	Delta
Construction	\$ 40,845,000	\$ 36,379,239	\$ 250,000	\$ 36,629,239	\$ (4,215,761)
Design Services	\$ 2,121,828	\$ 2,041,828	\$ 50,000	\$ 2,091,828	\$ (30,001)
Specialty Services	\$ 537,637	\$ 689,461	\$ 25,000	\$ 714,461	\$ 176,824
Furniture, Fixtures & Equipment	\$ 1,600,000	\$ 964,721	\$ 350,000	\$ 1,314,721	\$ (285,279)
General Owner Expenses/Allowance	\$ 2,579,863	\$ 1,228,721	\$ 1,000,000	\$ 2,228,721	\$ (351,142)
Land Acquisition & Development	\$ 4,464,540	\$ 2,172,056	\$ 750,000	\$ 2,922,056	\$ (1,542,484)
Total	\$ 52,148,868	\$ 43,476,026	\$ 2,425,000	\$ 45,901,026	\$ (6,247,842)

Committed to Date

83%

Greenleaf Elementary Allowance Status

Description	Budget	Committed	Remaining	Remaining %
Project Sign	\$1,500	\$0	\$1,500	100%
Onsite Soil Haul off	\$250,000	\$239,656	\$10,344	4%
Owner Betterment Allowance	\$1,500,000	\$0	\$1,500,000	100%
Total	\$1,751,500	\$239,656	\$1,511,844	86%



Questions



Lockwood, Andrews
& Newnam, Inc.

A LEO A DALY COMPANY

