

MASTER PLANNING

Huckabee's in-house master planning team brings value to our clients by providing factual information, at the district and campus levels, as well as provide the District with the tools necessary to develop a phased plan to address facilities and other capital needs. Our team will help you clearly communicate your future plans as well as provide the deliverables that will develop trust with and provide transparency for the taxpayers and potential voters. The master planning phase is when our team asks more questions, facilitates more conversations and gathers more information to better inform scope, schedule and budget for proposed projects.



DISTRICT PROFILE

The District Profile captures district level information about who Stephenville ISD is today.

One, comprehensive document with pertinent information for voters to understand who you are, what you want for your students and begins to build the story on why a long range plan or bond election and how it fits in with your overall goals.

- Guiding Documents
- Educational Methodologies including Grade Level Alignment
- Demographics
- Financial Status
- Technical Standards and Educational Specifications



LONG RANGE PLAN

The Long Range Plan documents both district and campus information of where you want to be in 10 years.

Incorporates all Aging, Evolving and Growth needs for each:

- Educational Methodologies including Grade Level Alignment
- Capital Improvements: Facilities
- Capital Improvements: Technology
- Capital Improvements: Transportation
- Land

AGING	EVOLVING	GROWTH
<ul style="list-style-type: none"> • System Repair/Replacement • Preventive/Deferred Maintenance 	<ul style="list-style-type: none"> • Code Compliance • Instructional Delivery 	<ul style="list-style-type: none"> • Student Enrollment • More Buses & Devices

Category	Item 1	Item 2	Item 3	Item 4	Item 5
Category 1	1	2	3	4	5
Category 2	6	7	8	9	10
Category 3	11	12	13	14	15
Category 4	16	17	18	19	20

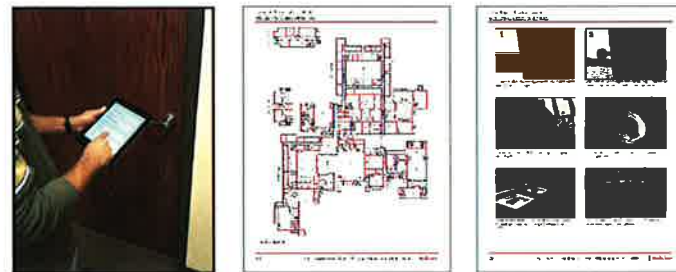

FACILITY PROFILES

The Facility Profiles capture campus level information about the conditions and use of each school today.

Conditions Assessment

Comprehensive report documenting the existing deficiencies of each facility covering up to 27 components.

Campus Utilization Study

Documenting capacities, how each facility is being used by that campus and why.



PROJECT PROFILES

The Project Profiles document project specific information capturing proposed scope, schedule and budget for each bond program project.