



# UNITED INDEPENDENT SCHOOL DISTRICT AGENDA ACTION ITEM

**TOPIC:** Approval of change order No. 1 in the amount of \$112,000.00 for the design and construction of a turning lane at the intersection of HWY 359 and EG Ranch Road.

**SUBMITTED BY:** Ignacio Alaniz **OF:** Construction Management

**APPROVED FOR TRANSMITTAL TO SCHOOL BOARD:** October 15, 2014

**RECOMMENDATION:**

Provide a right turning lane at the intersection of HWY 359 and EG Ranch Road as required by TX DOT, including site work, concrete paving, traffic markings, additional lamps at traffic light, sidewalks, ramps, pedestrian handrail and adjustment of existing grade drainage inlet as per design documents developed by CEC Engineering.

**RATIONALE:**

Modifications have been made to the existing EG Ranch Road as requested by TX DOT and AEP due to separation distance requirements associated with the AEP transmission line. TX DOT has approved a turning lane designed to comply with easement standards and traffic safety measures. See attached Explanation and Recommendation Letter from CEC Engineering, traffic engineering consultant for this project.

<b>Cost: Construction Cost</b>	<b>\$96,848.40</b>
<b>Engineering Design Cost:</b>	<b>\$11,621.76</b>
<b>Materials Testing:</b>	<b>\$3,529.84</b>

**Transportation Complex Budget: \$112,000.00**

**BUDGETARY INFORMATION:**

**General Fund CIP Budget 2014-2015**

**BOARD POLICY REFERENCE AND COMPLIANCE:**

**LEYENDECKER CONSTRUCTION, INC.  
CONSTRUCTORS AND ENGINEERS**

**LAREDO, TEXAS 78041**

TELEPHONE (956)-722-0531  
FAX (956)-722-8215

P. O. BOX 1827  
4220 SANDERS

24-Sep-14  
UISD Transportation Facility  
**C/O Mr. Enrique Rangel, P. E. Assistant Superintendent**  
C/O Mr. Ignacio Alaniz, Construction Director  
3501 East Saunders  
Laredo, Texas 78040

**TRANSPORTATION FACILITY  
Proposed Change Order Turning Lane**

**DESCRIPTION**

---

Provide turning lane per CEC construction documents including site work, conc paving, markings, sidewalks, pedestrian handrail, and adjustment of existing grate inlet	\$ 77,000.00
Contingency allowance	\$ 10,000.00
Subtotal	\$ 87,000.00
GC fee at 10%	\$ 8,700.00
Subtotal	\$ 95,700.00
Bond Cost 1.20%	\$ 1,148.40
Total	\$ 96,848.40

---

---

Sincerely,

*Renee Cortes, Jr.*

Renee Cortes, Jr.  
cc: P.A. Leyendecker, job file



CIVIL ENGINEERING CONSULTANTS  
DON DURDEN, INC.

October 2, 2014

Mr. Ignacio R. Alaniz, Jr., Construction Director  
United Independent School District  
3501 E. Saunders  
Laredo, Texas 78041  
Phone: (956) 473-7963

E0468600

**RE: Traffic Signalization at Highway 359 and EG Ranch Road**  
*Justification for Additional Turn Lane*

Dear Mr. Alaniz,

As you are aware, the UISD Traffic Signalization project at Hwy 359 and EG Ranch Road has encountered several utility related conflicts during the construction of the project, which have caused "in the field" modifications to relocate the signal poles. In addition, the relocations of the signal poles created a situation where a redesign of the intersection was necessary to safely facilitate traffic through the intersection. Therefore, the supporting information and justifications for these necessary revisions are as follows:

1. The original designs for the signal pole locations were based upon the best available utility information provided by the various utility companies through the City of Laredo Utility Coordination Committee Meeting process. Additional above ground utility locates were also established by conducting on the ground surveys for verification of the existing improvements, which was compiled in the base drawings that were used for the designs.
2. Upon completion of the initial staking of the signal pole locations and prior to any construction, AEP and the Contractor (Star Operations, Inc.) determined that the proposed signal pole location at the southeast corner of the intersection would be too close for the Contractor to safely install given the equipment being used. Thus, with the assistance of all present, including TxDOT, CEC and UISD personnel, it was determined that the pole needed to be relocated to the current location, which was approximately 10' to the northwest from its original design location. This relocation prompted a redesign of the EG Ranch intersection with TxDOT to include an island around the new signal pole location and a turning lane with its individual signal. Alternative options were presented to TxDOT, however, they were either too cost prohibited and/or not accepted by TxDOT.
3. Subsequent relocations of the remaining poles were also adjusted in the field to accommodate and maintain proper signal alignments to avoid conflicts with existing identified utilities, power lines and poles. Also during the Contractor's (Star Operations, Inc.) subsurface investigations on the new locations, it was determined that additional minor adjustments needed to be made to avoid existing underground utilities that would have created a conflict.

SAN ANTONIO · LAREDO · BRYAN/COLLEGE STATION

Mr. Ignacio R. Alaniz, Jr.  
Traffic Signalization at Highway 359 and EG Ranch Road  
Justification for Additional Turn Lane  
Page 2  
October 2, 2014

In closing, the relocation of the southeast corner signal pole created a series of multiple adjustments to the other signal pole locations to maintain the proper alignments for adequate function of the intersection, which subsequently required a redesign of the intersection and the current change order request to Leyendecker's contract for the completion of the intersection.

Based on the stated series of events, CEC recommends approval of improvements identified in the change order to Leyendecker to complete the installation of the traffic signal project. To date, all that is remaining includes the intersection improvements by Leyendecker, the installation of the signal detectors for the new turn lane and adjustments of the signal lights by Star Operations and TxDOT's approval to turn on the signal. Star Operations will have its work completed within one day following completion of the intersection improvements by Leyendecker.

Should you have any questions regarding this justification letter for the additional improvements required by TxDOT, please feel free to contact me at (956) 729-7844.

Sincerely,  
**CIVIL ENGINEERING CONSULTANTS**

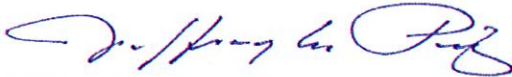

Jeffrey G. Puig, P.E., R.P.L.S.  
Principal – Laredo Division Manager

cc: USD – Enrique Rangel, P.E., Assistant Superintendent for Facilities and Construction  
USD – Ernesto Castillo-Mena P.E, Construction Manager

CONSTRUCTION NOTES:  
 SEE UNITED INDEPENDENT SCHOOL DISTRICT 73589 TRANSPORTATION FACILITY  
 PHASE 1 PLAN SET FOR CONSTRUCTION DETAILS  
 A) SEE STREET PAVING DETAILS SHEET CAS FOR CONCRETE PAVEMENT & CURB DETAILS

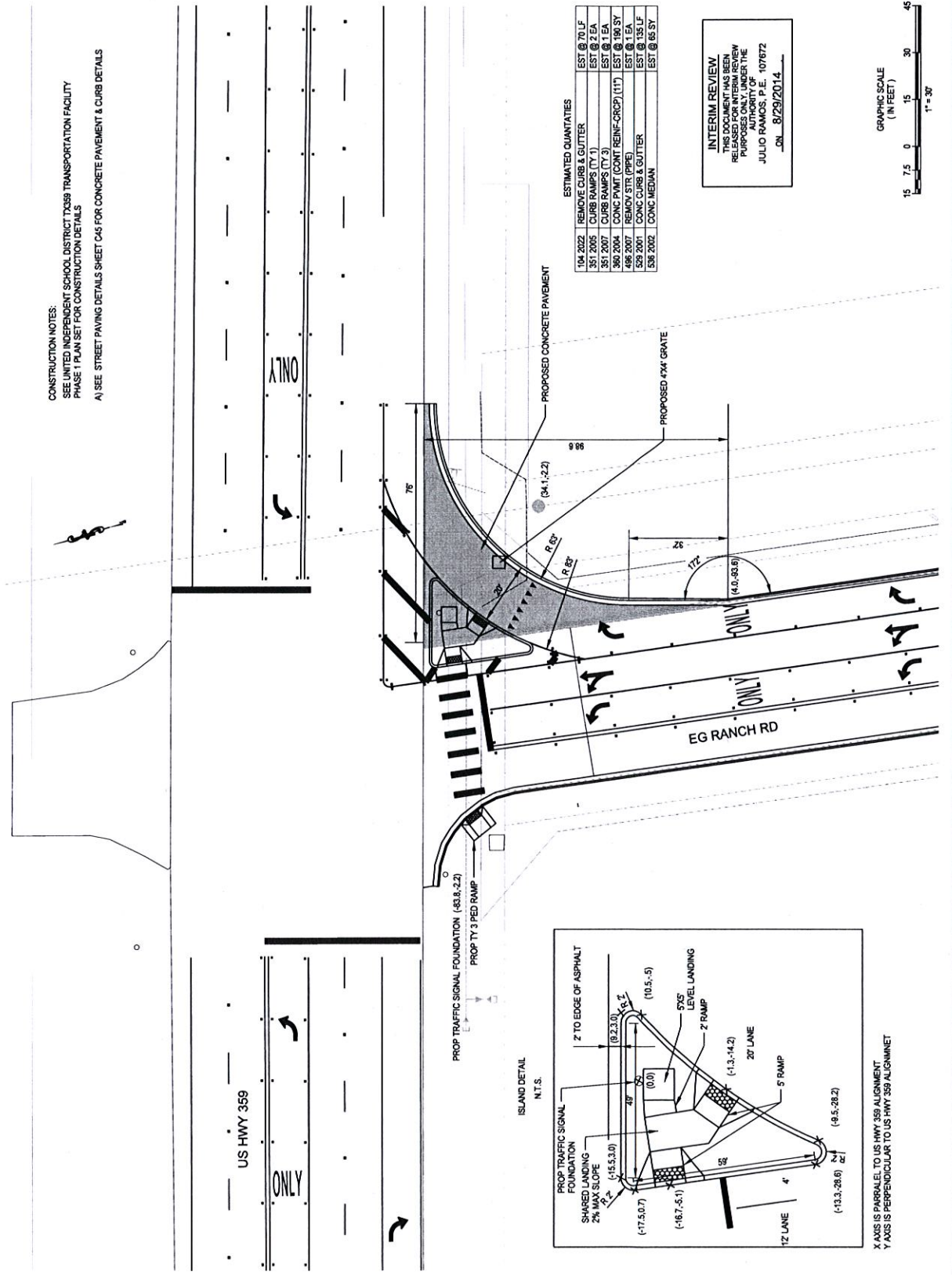

ESTIMATED QUANTITIES

104 2022	REMOVE CURB & GUTTER	EST @ 70 LF
351 2025	CURB RAMPS (17')	EST @ 2 EA
351 2025	CURB RAMPS (17')	EST @ 2 EA
360 2004	CONC PAINT (CONC REINF-CRCP) (11')	EST @ 11 SF
486 2007	REMOVE STR (PRE)	EST @ 1 EA
503 2007	REMOVE CURB & GUTTER	EST @ 135 LF
506 2002	CONC MEDIAN	EST @ 62 SY

**INTERIM REVIEW**  
 THIS DOCUMENT HAS BEEN  
 RELEASED FOR INTERIM REVIEW  
 PURPOSES ONLY UNDER THE  
 AUTHORITY OF  
 JULIO RAMOS, P.E. 107672  
 ON 8/29/2014

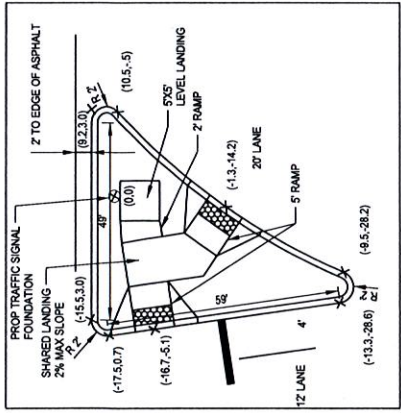

X AXIS IS PARALLEL TO US HWY 359 ALIGNMENT  
 Y AXIS IS PERPENDICULAR TO US HWY 359 ALIGNMENT