



ALEDO ISD BOARD MEETING TEMPLATE

MEETING DATE: May 17, 2022

AGENDA ITEM: Consider Approval of Change Order for 2019 Bond Project Alejo ISD Early Childhood Academy

PRESENTER: Earl Husfeld, Chief Financial Officer and Tyler Boswell, Director of Construction and Facilities

BACKGROUND INFORMATION:

- As you are aware, conversion of the current Vandagriff Elementary School into the Alejo ISD Early Childhood Academy was included within the District's 2019 Bond Program.
- After review of the proposed design/layout of the childcare portion of the facility with the District's Director of Child Development Center, a few modifications are necessary for compliance with licensing requirements and for better utilization of the space.
- Additionally, due to the number of children enrolled in the Child Development Center to date and the expectation that this number will increase, it is prudent to include two (2) additional rooms in the renovations at this time.
- After review and analysis of the attached cost estimations, district staff are recommending we proceed with the additional building modifications as outlined by RJM Contractors, Inc.

FISCAL INFORMATION:

The not to exceed amount of \$96,576.09 for this change order will be paid from 2019 bond program funds.

ATTACHMENTS:

RJM Contractors, Inc. cost estimations with supporting documentation.

ADMINISTRATIVE RECOMMENDATION:

The Administration recommends the Board of Trustees approve a change order to the contract with RJM Contractors, Inc. for the Alejo ISD Early Childhood Academy project in the not to exceed amount of \$96,576.09 as presented.

ROOM FINISH SCHEDULE-AREA A										
ROOM DATA		FLOOR FINISH	BASE FINISH	WALL FINISHES			CEILING FINISH	COMMENTS		
No	NAME			NORTH	EAST	SOUTH				
A100	VEST	LVT	RB-1	PT-2	PT-2	PT-2	PT-2	ACT-1		
A101	CORRIDOR	LVT	RB-1	PT-2	PT-2	PT-2	PT-2	ACT-1		
A102	2 YEAR OLDS	CWT-2	RB-1	PT-2	PT-2	PT-2	PT-2	ACT-1		
A104	RR	CWT-2	CWT-1	CWT-2	CWT-1,CWT-2	CWT-1,CWT-2	CWT-1,CWT-2	ACT-1	CWT ALL WALLS UP TO 7'-0"	
A105	2 YEAR OLDS	LVT	RB-1	PT-2	PT-2	PT-2	PT-2	ACT-1		
A106	2/3 YEAR OLDS FLEX	LVT	RB-1	PT-2	PT-2	PT-2	PT-2	ACT-1		
A110	DAY CARE ADMIN	LVT	RB-1	PT-2	PT-2	PT-2	PT-2	ACT-1		
A111	ADMIN	LVT	RB-1	PT-2	PT-2	PT-2	PT-2	ACT-1		
A112	STO.	LVT	RB-1	PT-2	PT-2	PT-2	PT-2	ACT-1		
A113	OFFICE	LVT	RB-1	PT-2	PT-2	PT-2	PT-2	ACT-1		
A116	STO.	LVT	RB-1	PT-2	PT-2	PT-2	PT-2	ACT-1		
A117	PLAY AREA	RRP-1	RB-1	PT-2	PT-5	PT-2	PT-5	ACT-1		
A120	RR	CWT-2	CWT-1	CWT-1,CWT-2	CWT-1,CWT-2	CWT-1,CWT-2	CWT-1,CWT-2	ACT-1	CWT ALL WALLS UP TO 7'-0"	
A135	CORRIDOR	LVT	RB-1	PT-2	PT-2	PT-2	PT-2	ACT-1		
A136	VEST	LVT	RB-1	PT-2	PT-2	PT-2	PT-2	ACT-1		
A137	INFANTS	LVT	RB-1	PT-2	PT-2	PT-2	PT-2	ACT-1		
A139	1 YEAR OLDS	LVT	RB-1	PT-2	PT-2	PT-2	PT-2	ACT-1		
A140	FUTURE CLASS	LVT	RB-1	PT-2	PT-2	PT-2	PT-2	ACT-1		

DOOR SCHEDULE																			
DOOR			PANEL						FRAME				DETAIL			GENERAL		REMARKS	
MARK	WIDTH	HEIGHT	WIDTH: A/B	TYPE: A/B	THK	MATL	FINISH	GLASS TYPE	TYPE	MATL	FINISH	GLASS TYPE	JAMB	HEAD	SILL	FIRE RATING	HARDWARE SET		
A100	6'-0"	7'-0"	3'-0"/3'-0"	HG-1/HG-1	1 3/4"	WD	PL-1	GL	001	HM	PT-4	NONE							1
A102	6'-0"	7'-0"	3'-0"/3'-0"	HG-1/HG-1	1 3/4"	WD	PL-1	GL	001	HM	PT-4	NONE							1
A103.1	3'-0"	7'-0"	3'-0"	HG-1	1 3/4"	WD	PL-1	GL	001	HM	PT-4	NONE							
A103.2	3'-0"	7'-0"	3'-0"	HG-1	1 3/4"	WD	PL-1	GL	001	HM	PT-4	NONE							
A104.1	3'-0"	7'-0"	3'-0"	F	1 3/4"	WD	PL-1	NONE	001	HM	PT-4	NONE							
A104.2	3'-0"	7'-0"	3'-0"	F	1 3/4"	WD	PL-1	NONE	001	HM	PT-4	NONE							
A105.1	3'-0"	7'-0"	3'-0"	HG-1	1 3/4"	WD	PL-1	GL	001	HM	PT-4	NONE							
A105.2	3'-0"	7'-0"	3'-0"	HG-1	1 3/4"	WD	PL-1	GL	001	HM	PT-4	NONE							
A106.1	3'-0"	7'-0"	3'-0"	HG-1	1 3/4"	WD	PL-1	GL	001	HM	PT-4	NONE							
A106.2	3'-0"	7'-0"	3'-0"	HG-1	1 3/4"	WD	PL-1	GL	001	HM	PT-4	NONE							
A107.1	3'-0"	7'-0"	3'-0"	HG-1	1 3/4"	WD	PL-1	GL	001	HM	PT-4	NONE							
A107.2	3'-0"	7'-0"	3'-0"	HG-1	1 3/4"	WD	PL-1	GL	001	HM	PT-4	NONE							
A110	3'-0"	7'-0"	3'-0"	HG-1	1 3/4"	WD	PL-1	GL	001	HM	PT-4	NONE							
A120	3'-0"	7'-0"	3'-0"	HG-1	1 3/4"	WD	PL-1	NONE	001	HM	PT-4	NONE							
A134	6'-0"	7'-0"	3'-0"/3'-0"	HG-1/HG-1	1 3/4"	WD	PL-1	GL	001	HM	PT-4	NONE							1
A137.1	3'-0"	7'-0"	3'-0"	HG-1	1 3/4"	WD	PL-1	GL	001	HM	PT-4	NONE							
A137.2	3'-0"	7'-0"	3'-0"	DD	1 3/4"	WD	PL-1	GL	001	HM	PT-4	NONE							
A139	3'-0"	7'-0"	3'-0"	HG-1	1 3/4"	WD	PL-1	GL	001	HM	PT-4	NONE							
A140.1	3'-0"	7'-0"	3'-0"	HG-1	1 3/4"	WD	PL-1	GL	001	HM	PT-4	NONE							
A140.2	3'-0"	7'-0"	3'-0"	HG-1	1 3/4"	WD	PL-1	GL	001	HM	PT-4	NONE							
A141.1	3'-0"	7'-0"	3'-0"	HG-1	1 3/4"	WD	PL-1	GL	001	HM	PT-4	NONE							
A141.2	3'-0"	7'-0"	3'-0"	HG-1	1 3/4"	WD	PL-1	GL	001	HM	PT-4	NONE							
A150	4'-0"	6'-0"																	36
A151	4'-0"	6'-0"																	36
A152	3'-0"	6'-0"																	36
A153	3'-0"	6'-0"																	36

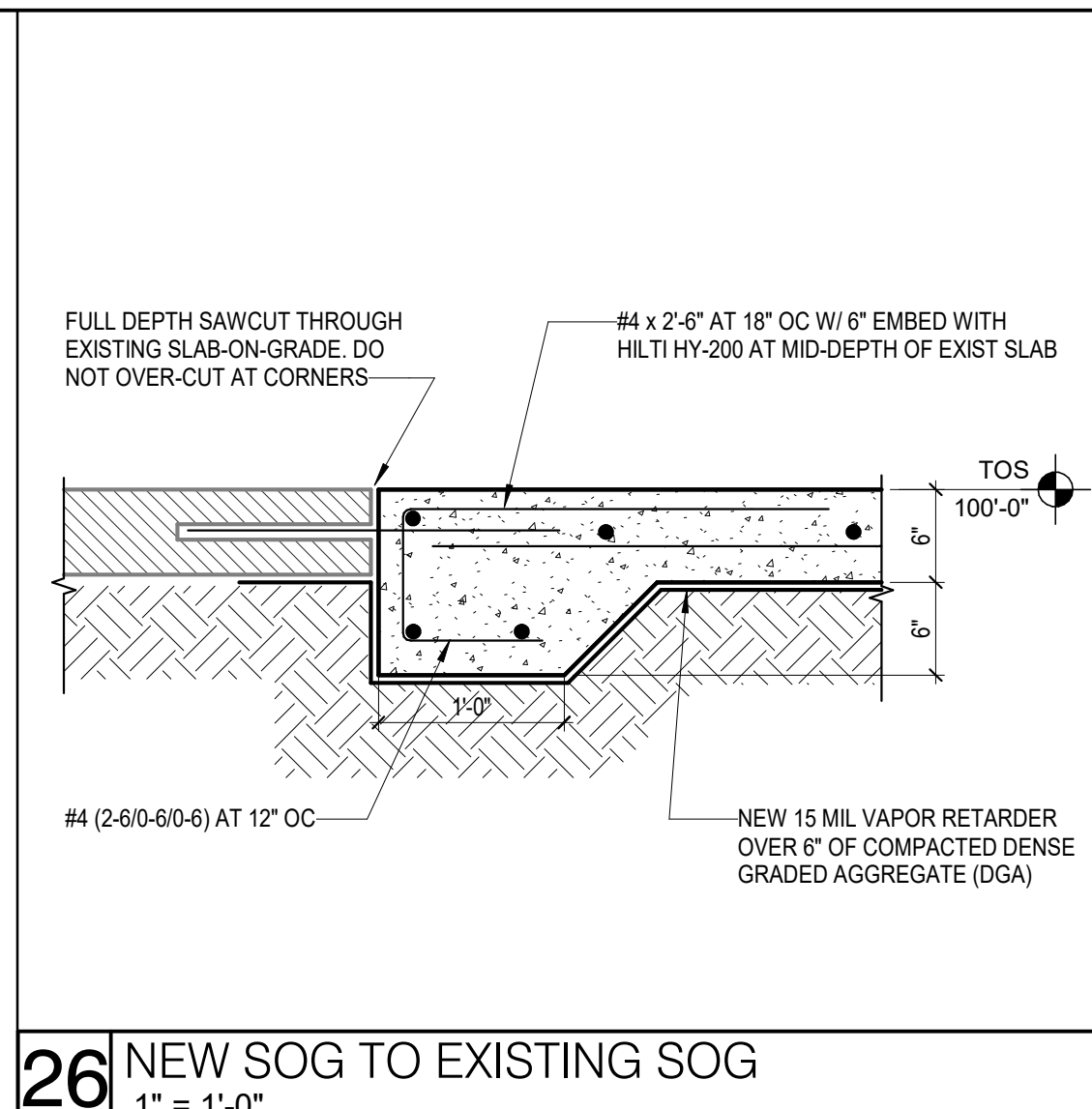

- ### GENERAL ARCH PLAN NOTES
- DO NOT SCALE DRAWINGS. WRITTEN DIMENSIONS TAKE PRECEDENCE. CONTACT ARCH IF CLARIFICATION IS NECESSARY IN ORDER TO DETERMINE THE INTENT OF THE CONTRACT DOCUMENTS
 - DRAWINGS NOTED AS "TYPICAL" OR "TYPICAL" ARE NOT TO SCALE
 - ALL DIMENSIONS ARE TO STRUCTURAL COLUMN LINES OR THE SURFACE OF PARTITION ASSEMBLY U.N.O.
 - BUILD VERIFY ALL DIMENSIONS AND EXISTING CONDITIONS BEFORE COMMENCING WORK. NOTIFY ARCH OF ANY DISCREPANCIES PRIOR TO PROCEEDING WITH AFFECTED WORK
 - NOTES OR DIMENSIONS NOTED AS "TYPICAL" OR "TYPICAL" SHALL APPLY TO CONDITIONS THAT ARE THE SAME OR SIMILAR
 - DIMENSIONS NOTED AS "FIELD VERIFY" OR "FIELD VERIFY" SHALL BE MEASURED AND CONFIRMED AT THE PROJECT SITE BY THE CONTRACTOR AND REVIEWED WITH THE ARCH. BEFORE INCORPORATING INTO THE WORK
 - DIMENSIONS NOTED AS "CLEAR" OR "CLEAR INSIDE" REQUIRE SPECIFIC COORDINATION AMONG DISCIPLINES AND OR MANUFACTURERS
 - REFER TO PARTITION TYPES ON A-800 SERIES SHEETS
 - ALL INTERIOR PARTITIONS THIS SHEET, EXCEPT FOR FURR-OUT PARTITIONS, SHALL BE PARTITION TYPE U.N.O.
 - ALL INTERIOR FURR-OUT PARTITIONS THIS SHEET SHALL BE PARTITION TYPE U.N.O.
 - ALL DOORS SHALL BE SET 6 INCHES OFF THE ADJACENT PERPENDICULAR WALL ON THE HINGE SIDE OF THE DOOR U.N.O. NOTIFY ARCH OF ANY DOOR-RELATED CONFLICTS, INCLUDING BUT NOT LIMITED TO CONFLICTS CONCERNING ACCESSIBILITY STANDARDS
 - ALL DOOR THRESHOLDS AT ALL EXTERIOR DOORS SHALL BE SET IN FULL BED OF SEALANT
 - COORD. ALL DRIP/SPRINKLER LOCATIONS WITH FLOOR PLAN PRIOR TO FLOOR SLAB CONSTRUCTION
 - ALL FLOOR SLOPES TO FLOOR DRAINS SHALL NOT EXCEED 1/8"
 - PROVIDE AND INSTALL SELF-LEVELING UNDERLAYMENT WHERE UNEVEN FLOOR SLAB EXISTS PRIOR TO INSTALLATION OF FLOOR FINISHES
 - COORD. HOUSEKEEPING PAD LOCATIONS AND DIMENSIONS WITH EQUIPMENT TO BE INSTALLED
 - ALL FLOOR FINISH CHANGES SHALL OCCUR AT THE CENTERLINE OF DOORS U.N.O.
 - ALL FLOOR FINISH MATERIAL CHANGES SHALL HAVE REDUCER STRIPS
 - ALL REQUIRED ACCESSIBLE CLEARANCES FOR ALL ITEMS, INCLUDING BUT NOT LIMITED TO ALL COUNTER TOPS, ALL PLUMBING FIXTURES, ALL DRINKING FOUNTAINS, ALL ELECTRIC WATER COOLERS, ALL LAVATORIES, ALL URINALS, ALL TOILETS SHALL BE STRICTLY ENFORCED
 - APPLY BITUMINOUS COATING TO ALL CONCEALED STRUCTURAL STEEL MEMBERS AT ALL EXTERIOR CANOPY LOCATIONS
 - REFER TO OTHER DISCIPLINE DOCUMENTS FOR ADDITIONAL SCOPE OF WORK

- ### PLAN LEGEND
- INTERIOR RENOVATION
- EXISTING WALLS, DOORS, STAIRS, ETC TO REMAIN
- EXISTING AREA NOT IN ARCHITECTURAL SCOPE-OF-WORK. (PATCH AND REPAIR WALLS, CEILINGS AND FLOORS TO LIKE NEW CONDITION. MATCH EXISTING FINISHES.)
- ### KEYNOTE LEGEND
- | NUMBER | DESCRIPTION |
|--------|---|
| 11.15 | NEW CLOTHES WASHER WITH ACCESSIBLE CONTROLS. OWNER FURNISHED, CONTRACTOR INSTALLED. |
| 11.16 | NEW CLOTHES DRYER WITH ACCESSIBLE CONTROLS. OWNER FURNISHED, CONTRACTOR INSTALLED. |

- ### DOOR SCHEDULE REMARKS
- PANIC EXIT HARDWARE
 - NOT AN ENTRY DOOR. EXIT ONLY DOOR WITH LOCKING OPERABLE HARDWARE ON SWING-OUT SIDE OF DOOR
 - NO LOCKING HARDWARE
 - ELEC. DOOR OPENER
 - ELEC. CONTROLLED ACCESS HARDWARE WITH CARD READER
 - ELEC. CONTROLLED ACCESS HARDWARE WITH PUSH-BUTTON
 - ELEC. CONTROLLED ACCESS HARDWARE. ROUGH-IN ONLY
 - KEYED REMOVABLE CENTER MULLION
 - CENTER ASTRAHAL
 - 90 DEGREE SWING
 - CONT. HINGE
 - WEATHER-STRIP SEAL
 - FIRE SMOKE SEAL
 - SOUND SEAL
 - PEEP HOLE
 - DOOR BUZZER
 - DOOR CHIME ON OPEN
 - MANUAL HOLD-OPEN
 - MAGNETIC HOLD-OPEN, CONNECT TO FIRE ALARM
 - MAGNETIC HOLD-OPEN, CONNECT TO SECURITY SYSTEM
 - INSULATED DOOR
 - SOUND RATED DOOR ASSEMBLY, STC AS SPECIFIED
 - WINDSTORM DOOR HARDWARE SHALL BE TESTED AS PART OF A COMPLETE DOOR OPENING ASSEMBLY. THE TESTED DOOR OPENING ASSEMBLY SHALL INCLUDE DOOR HARDWARE. THE ENTIRE DOOR OPENING, INCLUDING DOOR HARDWARE, SHALL BE BY DOOR MANUF.
 - ACUSTICAL GLASS TO MEET FIRE DOOR ASSEMBLY REQUIREMENTS FOR FIRE RATING INDICATED
 - MANUAL PUSH-UP OPERATION
 - ELEC MOTOR OPERATION WITH KEY SWITCH CONTROL. KEY SWITCH ON ONE SIDE OF DOOR ONLY
 - ELEC MOTOR OPERATION WITH KEY SWITCH CONTROL. KEY SWITCH ON BOTH SIDES OF DOOR
 - ELEC MOTOR OPERATION WITH PUSH-BUTTON CONTROL ON ONE SIDE OF DOOR ONLY
 - PANIC EXIT PUSH-BUTTON ON ONE SIDE OF DOOR ONLY
 - AUTOMATIC OPEN ON FIRE ALARM ACTIVATION
 - AUTOMATIC CLOSE ON FIRE ALARM ACTIVATION
 - FAIL-SAFE IN OPEN POSITION
 - FAIL-SAFE IN CLOSED POSITION
 - MAXIMUM OCCUPANCY SIGNAGE NEAR DOOR
 - SHOWAGE ON DOOR TO READ "NOT AN EXIT"
 - DECORATIVE METAL FENCE AND GATES (BASIS OF DESIGN AMERISTAR)

- ### FINISH SCHEDULE REMARKS
- ALL SCHEDULED DIRECTIONS (NORTH, EAST, SOUTH, WEST) ARE PER PLAN DIRECTIONS. NOT TRUE COMPASS DIRECTIONS.
- ALL SCHEDULED CEILING HEIGHTS ARE FROM THE PRIMARY FLOOR LEVEL WITHIN THE ROOM AND OR SPACE. AND ARE NOT FROM AN ELEVATED FLOOR LEVEL, AND ARE NOT FROM A RECESSED FLOOR LEVEL.
- ALL FINISH MATERIALS SHALL MEET FLAME SPREAD RATINGS PER THE BUILDING CODE.
- PROTECT ALL FINISHED FLOORING SURFACES FROM DAMAGE DURING ALL CONSTRUCTION PHASES.
- CARPET PATTERNS SHALL RUN PARALLEL TO CORRIDOR U.N.O.
- PROVIDE AND INSTALL BULLNOSE TRIM AT ALL TRANSITIONS FROM CERAMIC WALL TILE TO OTHER MATERIALS U.N.O.
- PAINT ALL NON-FACORY FINISHED EXPOSED METAL.
- PAINT ALL H.M. DOORS U.N.O.
- PAINT ALL H.M. DOOR FRAMES TO MATCH ADJACENT WALL COLOR U.N.O.
- LAY-IN CEILING TYPES
- | TYPE | FINISH |
|--------|---|
| TYPE A | STANDARD MINERAL FIBER, ANTIMICROBIAL, 24"X24" |
| TYPE B | GLASS FIBER, HIGH-RIC, ANTIMICROBIAL, 24"X24" |
| TYPE C | VINYL-FACED MINERAL FIBER, ANTIMICROBIAL, 24"X24" |
| TYPE D | IMPACT RESISTANT, MINERAL FIBER, ANTIMICROBIAL, 24"X24" |
| TYPE E | WOOD FIBER, 24"X24" |
| TYPE F | MINERAL FIBER, ANTIMICROBIAL, 24"X24" |
- REFER TO FLOOR PATTERN PLANS
 - REFER TO INTERIOR ELEVATIONS
 - REFER TO CEILING PLANS
 - 48" FRP WAINSCOT AT MOP SINK, EXTEND 24" EACH SIDE BEYOND SINK EDGES
 - 48" STAINLESS STEEL WAINSCOT AT MOP SINK, EXTEND 24" EACH SIDE BEYOND SINK EDGES
 - 3/4" TREATED PL WOOD WAINSCOT FULL HEIGHT ALL AROUND. PAINT
 - PAINT ALL EXPOSED CEILING-RELATED ITEMS, INCLUDING BUT NOT LIMITED TO, STRUCT. MEMBERS, STRUCT. DECK, DUCTWORK, DIFFUSERS, PIPING, CONDUIT, EQUIP. HOUSINGS, LIGHT FIXTURE HOUSINGS, CABLE SUPPORTS, CABLE TRAYS, EQUIP. SUPPORTS, HANGERS
 - PAINT ALL EXPOSED CEILING-RELATED ITEMS FLAT BLACK, INCLUDING BUT NOT LIMITED TO, STRUCT. MEMBERS, STRUCT. DECK, DUCTWORK, DIFFUSERS, PIPING, CONDUIT, EQUIP. HOUSINGS, LIGHT FIXTURE HOUSINGS, CABLE SUPPORTS, CABLE TRAYS, EQUIP. SUPPORTS, HANGERS
 - PAINT ALL EXPOSED CEILING-RELATED ITEMS WHITE, INCLUDING BUT NOT LIMITED TO, STRUCT. MEMBERS, STRUCT. DECK, DUCTWORK, DIFFUSERS, PIPING, CONDUIT, EQUIP. HOUSINGS, LIGHT FIXTURE HOUSINGS, CABLE SUPPORTS, CABLE TRAYS, EQUIP. SUPPORTS, HANGERS
 - DO NOT PAINT ACUSTICAL STRUCT. DECK
 - 1-HR FIRE RATED CEILING ASSEMBLY
 - 2-HR FIRE RATED CEILING ASSEMBLY
 - DOUBLE CEILING ASSEMBLY. REFER TO
 - HOLD-DOWN CLIPS AT SUSP. LAY-IN CEILING SYSTEM WITHIN 8" MIN. ANY DIRECTION FROM AN EXTERIOR DOOR LOCATION

PRK

ARCHITECT PRK Architects, Inc.
FORT WORTH
100 Throckmorton Street, Suite 1550
Fort Worth, TX 76102
817-332-4333 P
TX Firm F-1608

PRK.com

TEAGUE WALL AND PERKINS, INC.
1500-000-0000
INDOORSCAPE
TEAGUE WALL AND PERKINS, INC.
1500-000-0000
LEAF ENGINEERS
1500-000-0000
TECHNOLOGY
LEAF ENGINEERS
1500-000-0000
BUILDING ENVELOPE
1500-000-0000

ALEDO ISD ECA RENOVATIONS

408 FM 1187, ALEDO, TX 76008
ISSUED FOR CONSTRUCTION



KEY PLAN
NORTH: PLAN TRUE

DISCIPLINE
REGISTERED ARCHITECT
STATE OF TEXAS
29212
002-0

CLIENT
Aleido ISD
DATE
01/14/2022
PROJECT NUMBER
20149

DRAWING HISTORY

No.	Description	Date
1	ADDENDUM #01	2022/01/24
2	POST BID ADDENDUM #01	2022/03/30

ISSUED FOR CONSTRUCTION

BUILDING NUMBER

1ST LEVEL - FLOOR PLAN - AREA A

A-101A



RJM
Contractors, Inc.

9-May-22

GC's	\$	
Acme Fencing	\$	16,655.00
R2 Concrete	\$	5,100.00
Demolition 20-0LF of wall & 106 LF of millwork	\$	1,460.00
M & M Masonry demo/install four new door frames & deletion of one double door frame for a total of	\$	3,000.00
Mike Conkle's Custom Cabinets Inc.	\$	6,123.14
Woodard Building Supply Doors, Frames, & Hardware	\$	7,062.00
R2 Contractor Floors Add for two rooms	\$	11,463.05
Posadas Painting of two additional Rooms/Hallway	\$	2,923.00
SDI added Toilet Accessories	\$	2,806.00
Riley Plumbing	\$	32,000.00
HVAC new dryer vent/roof patch	\$	678.00
Ridgeline Electric	\$	2,671.90
Sub Total	\$	91,942.09
OH & Profit 4%	\$	3,678.00
Sub Total	\$	95,620.09
Bond	\$	956.00
Total	\$	96,576.09

Kenny Buyers
Vice President
RJM Contractors, Inc.
kbuyers@rj-miller.com
817-716-4841 mobile

7616 Benbrook Pkwy.

Benbrook, Texas 76126

Phone 817.377.0971

Fax 817.377.0973

ACME FENCE SERVICES, INC.
2509 MINNIS DR.
FORT WORTH, TEXAS 76117
817-831-8880 FAX 817-831-8884
AcmeFenceServices.net

Date: May 2, 2022

To: RJM Contractors, Inc.
ATTN: Kenny Buyers
Project: Vandergriff ECA #22004

We propose to furnish and install the following for the above referenced project per plans.

Proposed Change for additional fencing and change in playground perimeter height from 4' to 6'

Add \$16,655

- This quote is good for 7 days.
- This quote covers general insurance limits. Additional charges will be added for additional insurance limits and/or any additional contract requirements.
- Does Not Include: Bond, Permit, Concrete other than post footings, Rock Excavation, Core Drilling
- Additional charges will be added if the contract requires US Department of Labor **Certified Payroll reports (\$350.00 minimum or 0.5%)**
- If awarded the above project all additions, deletions, or revisions will be scheduled with Project Manager once Acme Fence Services, Inc. has received written Change Order. NO CHANGES will be furnished or installed without written executed Change Order from Contractor.
- Quote includes (1) mobilizations. Additional mobilizations will be billed as Change Orders accordingly.

We appreciate the opportunity to submit this proposal and if you should have any questions please call.

Michael Andres
Michaelandres@acmefenceservices.net



7616 BENBROOK PKWY
BENBROOK, TX 76126
Clayton Shackelford Cell: 972-595-8190
Email: Clayton@R2commercialconcrete.com

April 20, 2022

ALEDO ISD EARLY CHILDHOOD ALEDO, TX

R2 Commercial Concrete, LLC proposes to furnish the labor and materials necessary to complete the concrete construction in accordance with the plans and specifications as per the following scope items:

Work scope Inclusions:

RET. WALL FOOTING – 80 LF	5 SLAB ON GRADE POURBACKS – 356 SF	6" PAVING – 134 SF
MOW STRIP – 240 LF	FLOW FILL ON FLUME – 902 SF	5" SIDEWALK – 751 SF
SIDEWALK REPLACEMENTS – 129 SF	RETAINING WALLS – 184 LF	

Total Proposed Estimate:

\$67,128.00

Special Notes:

- This quote is valid for 30 days.
- Proposal is based on a 10% Retainage being held and Net 30 Payment Terms.
- Proposal is based on a standard 40 hour work week
- R2 has included a maximum of 3 mobilizations not to exceed more than 1 week of downtime in between. Each additional mobilization will require a fee of \$3,500.00 - \$5,000.00 depending on job location.
- Gen. Contractor to provide all building corners, benchmark control elevations, & lines and grades for paving.
- Casing of piers requires a min charge of \$5,000.00.
- See Exhibit "W" attached herein for warranty information.

Special Notes Continued:

- See Exhibit "E" for list of general exclusions from our scope of work.
- Time & Material Rates will be the same as Downtime rates listed below:
- Downtime rates will be as follows (per man):
 - Laborer - \$35/hr.
 - Foreman - \$45/hr.
 - Superintendent - \$65/hr.

Downtime is defined as extra time spent onsite due to no fault of R2.

Alternate:

Number	Explanation	ADD	DEDUCT
1.	ADD 28 LF OF MOW STRIP	\$700.00	\$
2.	ADD 200 SF OF SLAB POURBACKS	\$4,400.00	\$

Pier Options:

If a cased pier goes deeper (or more shallow) due to the change in elevation of the bearing stratum, then the Dry Unit Price and the Cased Unit Price must be combined Additional depths and casings are quoted per LF as follows:

Size (diam.)	Greater depth ADD	Lesser depth DEDUCT	Casing(Temp) ADD	Casing(Perm) ADD
	\$	\$	\$	\$
	\$	\$	\$	\$

THIS PROPOSAL IS BASED OFF OF THE PIERS GOING XX' TO BEARING STRATUM

Thank you for your time and consideration on this project. The team here at R2 Commercial Concrete looks forward to doing business with you. Please feel free to contact us with any questions regarding this proposal.

COMMERCIAL CONCRETE

Clayton Shackelford
Clayton Shackelford – Vice President

4/20/2022
Date



**P.O. Box 468
318 West Mansfield Hwy
Kennedale, Tx 76060**

Cabinet Proposal

Customer:	RJM Contractors, Inc.	Estimator:	RG
Attention:	Mr. Kenny Buyers	Bid Date:	4/19/2022
Phone/Fax:	P(817) 377-0971 F	Bid Expires:	7/18/2022
Job Name:	Aledo ISD - ECA Change Order # 1	Bid #	15490
Job Address:	Aledo, TX.		

Bid Specifications

Bid Includes: Shop Drawings, Fabrication, Materials, Delivery and Installation **Cabinets per plans dated:** 4/19/2022
Bid does not include : Paint or Stain Work, Trim, Metal items, Moulding. **Addenda Acknowledged:** 0
Bid does not include : Integral Sinks, Stainless Steel Countertops.
Anything Omitted not Included in Bid.

Room Name/#	Line Item	Qty	U/M
A107 - Flex Room	28"Hx36"Wx24"D Laminate ADA Sink Cabinet w/Laminate Countertop	2.99	lnft
A107 - Flex Room	34"Hx36"Wx24"D Laminate ADA Sink Cabinet w/Laminate Countertop	2.99	lnft
A107 - Flex Room	LH-34"Hx36"Wx24"D Laminate LH Base Cabinet w/Laminate Countert	2.99	lnft
A107 - Flex Room	RH-34"Hx36"Wx24"D Laminate RH Base Cabinet w/Laminate Countert	2.99	lnft
A141 - Flex Room	28"Hx36"Wx24"D Laminate ADA Sink Cabinet w/Laminate Countertop	2.99	lnft
A141 - Flex Room	34"Hx36"Wx24"D Laminate ADA Sink Cabinet w/Laminate Countertop	2.99	lnft
A141 - Flex Room	LH-34"Hx36"Wx24"D Laminate LH Base Cabinet w/Laminate Countert	2.99	lnft
A141 - Flex Room	RH-34"Hx36"Wx24"D Laminate RH Base Cabinet w/Laminate Countert	2.99	lnft
		Base Bid Total	\$6,123.14

WOODARD

Builders Supply

Finish Hardware – Wood Doors – Hollow Metal Doors/Frames

Phone: 817-222-9012
Fax: 817-222-0956

6419 Midway Road
Haltom City, Texas 76117

◆Quote◆

Date: April 19, 2022

To: RJ Miller

From: Trey Woodard

Re: Aledo ISD Early Childhood Academy – Revision 001

We wish to quote you the following prices to furnish materials listed below as an extra to the contract.

Finish Hardware	\$ 4,412.00 Per the Attached
Wood Doors	\$ 1,650.00 Per the Attached
Hollow Metal	\$ 1,000.00 Per the Attached

\$7,062

This price is net FOB the jobsite for material only and does not include sales tax or installation.

★ If we are to proceed as outlined above, we must have a signed purchase/change order agreement before we are able to proceed.

Should you require additional information, please let us know.

Total Pages: 1

Contract Adjustment Worksheet

Job: Aledo ISD - Early Childhood Academy

Job #: 5858 - Revision 001

Date: 04/14/2022

Heading		
Opening	Description	Quantity
Following are results of Architect's comments on Returned Opening Schedule		
GLOBAL	All W12/N wood door elevations changed to W13/G, except at Opening A137.2. All Doors to be PC5 from Butler Door in Lieu of VT Industries to Improve Lead Times. VT Industries would Arrive in October / Butler Door will Arrive Mid July	
	<u>DELETE:</u> VTI WD 3070 5502H PC5 PSROAK F/S W12/N NON-RATED	-10
	<u>ADD:</u> VTI WD 3070 5508H SCL5 PSROAK F/S W13/G NON-RATED	10
HDG 02	Opening deleted.	
A136	<u>DELETE:</u> VTI WD 3070 5508H SCL5 PSROAK F/S W13/G NON-RATED RMM HMF 6070 SU 16GA CONTINWELD CRS PRI 8-3/4"-JD STD/MT H3/B NON-RATED PEM CFM83HD1 628 C-R ED5000DB M54 630 C-R N950ET 630 PEM 18041CNB 2/84" CL C-R DC8210 A11 M54 W33 689 ROC K1050 10" X 35" 4BE CSK 630 PEM S773BL20 BLK	-2 -1 -2 -2 -2 -1 -2 -2 -1

Contract Adjustment Worksheet		
Job:	Aledo ISD - Early Childhood Academy	
Job #:	5858 - Revision 001	
Date:	04/14/2022	
Heading		
Opening	Description	Quantity

COST AMOUNT

Contract Adjustment Worksheet

Job: Aledo ISD - Early Childhood Academy

Job #: 5858 - Revision 001

Date: 04/14/2022

Heading		
Opening	Description	Quantity
HDG 03	New opening.	
A107.1		
A107.2	<u>ADD:</u>	
A141.1	VTI WD 3070 5508H SCL5 PSROAK F/S W13/G NON-RATED	4
A141.2	RMM HMF 6070 SU 16GA CONTINWELD CRS PRI 8-3/4"-JD STD/EO H3/B NON-RATED	4
	MCK TA2714 4.5 X 4.5 652	12
	C-R CLX3351 NZD CT6G 626	4
	C-R CR8000-6 MK-IC 626	4
	C-R DC6200 A1 M54 689	4
	ROC K1050 10" X 34" 4BE CSK 630	4
	ROC 409 630	4
	ROC 608 GRY	12
HDG 04A	Standard door changed to dutch door. Narrow light removed.	
A137.2		
	<u>DELETE:</u>	
	VTI WD 3070 5502H PC5 PSROAK F/S W12/N NON-RATED	-1
	RMM HMF 3070 SU 16GA CONTINWELD CRS PRI 5-3/4"-JD STD/MSZ1 H3/A NON-RATED	-1
	<u>ADD:</u>	
	VTI WD 3070 5502H PC5 PSROAK F/S W12/N NON-RATED	1
	RMM HMF 3070 SU 16GA CONTINWELD CRS PRI 5-3/4"-JD STD/MSZ1 H9/DD NON-RATED	1
	MCK TA2714 4.5 X 4.5 652	1
	ROC 580-8 626	1
	ROC 409 630	1

Contract Adjustment Worksheet

Job: Aledo ISD - Early Childhood Academy

Job #: 5858 - Revision 001

Date: 04/14/2022

Heading		
Opening	Description	Quantity
HDG 08	Opening deleted.	
A138.1		
A138.2	<u>DELETE:</u>	
	VTI WD 3070 5502H PC5 PSROAK F/S W11/F NON-RATED	-2
	RMM HMF 3070 SU 16GA CONTINWELD CRS PRI 5-3/4"-JD STD/MSZ1 H3/A NON-RATED	-2
	MCK TA2714 4.5 X 4.5 652	-6
	C-R CLX3310 NZD 626	-2
	C-R DC6200 M54 689	-2
	ROC K1050 10" X 34" 4BE CSK 630	-2
	ROC K1050 6" X 35" 4BE CSK 630	-2
	ROC 409 630	-2
	ROC 608 GRY	-6
HDG 08	New opening. (Hardware only.)	
A152		
A153	<u>ADD:</u>	
	C-R ED5200 N955ET M54 CT6G 630	2
	C-R CR8000-6 MK-IC 626	2
	RIX 1351 BSP	2

CONTRACT



G2 Contract Flooring
7616 Benbrook Parkway
Benbrook, TX 76126

PHONE: 817.845.2185
CELL: 832.509.9355

JOB NAME: PCO Rooms A107 and A141 with partial corridor		DATE: April 20, 2022
0		
0		
CUSTOMER NAME: RJM		PHONE #
		FAX #
CONTACT: Kenny		PLAN DATE:
		TOTAL BID: \$11,463.05

Pafcraft 00150 Almond 12x12
Flexco base 092 Greystone
Standard floor prep
Demo existing floor

\$9,551.71
\$566.34
\$430.00
\$915.00

** QUOTE GOOD FOR 30 DAYS AND PAYMENT DUE NET 30 DAYS**

EXCLUDES: DEMO, FLOOR PREP, FURNITURE MOVING. NO PRODUCT OR INSTALLATION WARRANTIES FOR MOISTURE RELATED PROBLEMS EXCLUDES MOISTURE BARRIERS Jobs after 5pm will incur additional charges	SUBTOTAL:	\$11,463.05
	Material Tax	\$0.00
	TOTAL:	\$11,463.05

NOTES:

This contract is for labor to be completed on a continuous or daily basis. Labor is not to be performed in phases. All contracts are subject to credit approval before agreement is binding. demo of existing flooring, handling of furnishings and/or furniture, after hours work, work in public corridor, moisture testing, excessive floor prep, & dealing with other trades' material & trash are not included in the contract unless itemized above. Also, final cleaning, waxing and protection/covering of floors are not a part of this contract unless noted. Warranties from manufacturer & G2 Flooring will be provided only if temperature & humidity are correct at time of installation. Bid excludes licensing permits and fees other than that required by the State of Texas. All materials are guaranteed to be as specified. If seller of specified product requires payment before delivery, signee will be responsible for that payment. If manufacturer/seller of specified product fails to honor warranty on a product provided by G2 Flooring, as specified by signee, then G2 Flooring, will not warranty said product. This contract supercedes any other document. Monies from this contract may not be withheld to satisfy other contracts. All work is to be completed in a workmanlike manner according to standard practices. Any alteration or deviation from above specifications involving extra costs will be executed only upon written orders and will become an extra charge over and above the estimate. All agreements contingent upon strikes, accidents, or delays beyond the control of G2 Flooring Owner to carry fire, tornado, and other necessary insurance. Payments not paid within above mentioned terms will be charged a maximum interest allowable by law, including any collection and attorney fees, to secure full payment of the hereunder. Any material held over 2 weeks will be invoiced as a material draw.

PREPARED BY: **Rick Garcia** **817-845-2185**

ACCEPTANCE OF PROPOSAL: The above prices, specifications and conditions are satisfactory and are hereby accepted. You are authorized to do the work as specified. Payments will be made as outlined above.

P.O. # _____

Date of acceptance: _____

Signature: _____

Extra Work Authorization	
Posada's Painting 2746 Alaska Ave. Dallas, TX 75216 Office (214) 792-9580 Fax (214) 792-9274 E-mail: Martin@Posadas-Painting.com	
Submit to:	Project Name:
RJM Contractors, Inc. 7616 Benbrook Parkway Benbrook, TX 76126 Office: (817) 377-0971 Fax: (817) 377-0973	Aledo ISD ECA Renovations Post Bid Addendum No. 1 408 FM 1187 Aledo, TX 76008
Attn: Kenny Buyers	Architect: PBK
E-mail: kbuyers@rj-miller.com	Date of plans: 01/14/22
<p style="text-align: center;">The following will increase our scope of work:</p> <ol style="list-style-type: none"> 1.) Patch as necessary and repaint existing gypboard walls at Flex Rooms A107 & A141 including hallway area. 2.) Paint additional hollow metal door frames. <p style="text-align: center;"><u>Add = \$2,923.00</u></p>	
Addendums: No.1 & 2.	
Alternates: N/A	
Exclusions: Floor finishes, window frames, wood doors, and exterior painting, electrostatic painting and areas shown 'hatched' on the plans.	
Material will be as specified and work to be performed in accordance with the specifications submitted and completed in a workmanlike manner. Any alteration or deviation from above specifications involving extra cost will be executed only upon written order and will become an extra charge over the above estimate. All agreements contingent upon strikes, accidents or delays beyond our control. Owner to carry fire, tornado and other necessary insurance. All tradesmen painters covered by workers' compensation and general liability insurance.	
Submitted On 04/23/22 By: Martin Hernandez	

**PROPOSAL TOTAL:****\$5,357****Tax Included:****\$0.00**

R.4.4 04-2018

Quote#: 22-0095

Date: 2/3/2022

Customer: Bidding GC

Attention: Estimator

Fax/Email:

REV.1

4/18/2022

REV.2

4/25/2022

Plan Date: 30/30/22

Addendums: 1

Sales Rep: House

DIVISION 10 - SPECIALTIES**JOB NAME: Aledo Early Childhood Academy**

QTY	DESCRIPTION			
1	Lot - (2) TP & () US Global/Accurate toilet partitions - (see attached)	Material	\$	2,135
		Installation	\$	671
1	Lot - (19) ASI Accessories, (2) OFCI (see attached)	Material	\$	2,045
		Installation	\$	506
	Lot () ASI Lockers (see attached)	Material	\$	-
		Installation	\$	-
	Lot - () JL Industries Fire extinguishers & cabinets (see attached)	Material	\$	-
		Installation	\$	-
	Lot - Wall protection (see attached)	Material	\$	-
		Installation	\$	-
	Lot - Imperial Fastener Curtain & cubicle tracks (see attached)	Material	\$	-
		Installation	\$	-
	Flag pole(s) (Material price includes installation)	Material	\$	-
		Installation	\$	-
	Lot - () Visual Display boards (see attached)	Material	\$	-
		Installation	\$	-
	Lot - Mailboxes (see attached)	Material	\$	-
		Installation	\$	-
	Lot - Projection screens (see attached)	Material	\$	-
		Installation	\$	-
	Lot - Wire mesh partitions (see attached)	Material	\$	-
		Installation	\$	-
	Lot - Bike racks (see attached)	Material	\$	-
		Installation	\$	-
	Other 1	Material	\$	-
		Installation	\$	-
	Other 2	Material	\$	-
		Installation	\$	-
	Other 3	Material	\$	-
		Installation	\$	-
	DUE TO VOLATILITY OF MATERIAL, WE CAN ONLY HOLD OUR PRICE FOR 60 DAYS	Material	\$	-
		Installation	\$	-

FOR QUALIFIERS PLEASE SEE PAGE 2**PAGE 1 OF 2**

2045
506
- 551



PROPOSAL TOTAL:

5356.8818

Tax Included:

\$0

R.4.4 04-2018

Quote#: 22-0095

PROJECT QUALIFIERS

Plan Date: 30/30/22

Addendums: 1

Sales Rep: House

DIVISION 10 - SPECIALTIES

JOB NAME: Aledo Early Childhood Academy

SDI SPECIALTIES - Fort Worth, TX -

PHONE: 817.831.0337

EMAIL: TBSESTIMATING@SPECIALTIESDIRECT.COM

1.

Pricing good only if all items are awarded as a package. If awarded partially a requote will need to be done. BATTERIES NOT INCLUDED FOR AUTO ITEMS. Color finishes based on Mfg. Availability.

2. Or other Construction Payment Management fee is NOT included in this quote. Specialties Direct standard insurance is included. NO reduction to this quote for any OCIP or CCIP participation. All work is to be 1st shift- weekdays.

3. **Plans** - Quote is based on ASI and affiliated brands which are equal or superior to plans and specs. **If plans and specs are not able to be switch the price will be subject to change.**

4. **Glass/Ceramic/Porcelain Tile** - Specialties Direct is not responsible for damages to tile.

5. **Backing/Support/Electrical Items** - SDI is not responsible for any structural support, blocking, caulking, backing or cut-outs; this work must be completed by the General Contractor prior to installation. Installation of any electrical items such as hand dryers and electrical mirrors by others.

9. **Installation of Entire Scope** - Installation of our scope (all materials) will be completed in an uninterrupted single visit to site; additional trips will result in additional charges. A change order for additional trip charges will be estimated based on each scenario.

10. **Price** - The price on this quotation will not be subject to verbal changes or other agreements unless submitted in an official document and approved by both parties.

11. The quoted price is valid for 60 days. Escalation charges may apply thereafter.

12. **Bond** - If Bond is required, please add 2% to total amount.

**PROPOSAL TOTAL:**

5356.8818

Tax Included:

0

Quote#: 22-0095

ITEMIZED ACCESSORIES

Plan Date:	30/30/22
------------	----------

Addendums:	1
------------	---

Job Name: Aledo Early Childhood Academy

[illegible]

21

← TOTAL ITEMS

RILEY

PLUMBING & MECHANICAL

6704 Azle Avenue
Lake Worth, TX 76135
Phone: (817) 237-8104
Fax: (817) 237-2400
Rpm0221@AOL.COM

Master Plumbing Lic. No. M-5831
Mechanical License No. TACL A006679
Medical Gas Lic. No. M-18265
Liquid Petroleum Gas Lic. No. 08309
Boiler Lic. No. BLRREG00000750

PROPOSAL

Date: April 14, 2022

Proposal No. 2022 0119a Revision 1

To: RJM Contractors
7616 Benbrook Hwy
Benbrook, TX 76126
Kenny Buyers
Phone: 817-716-4841

Aledo ISD Early Childhood Academy Renovation
408 FM 1187
Aledo, TX 76008
Email: Kbuyers@rj-miller.com
Fax:

We purpose to install a COMPLETE OPERABLE PLUMBING SYSTEM per plans PU-101A & P-101A and specifications:
Prepared by: LEAD Engineers Dated: 01/14/2022 . (In compliance with Federal, State and Local Codes).

SCOPE ADDENDUM

INCLUDES:

- | | |
|---|-------------|
| • Furnish and Install (1) Guy-Gary BM200 stainless steel washer box and all related piping. | \$ 4,200.00 |
| • Furnish and Install (3) P5-sinks | \$15,000.00 |
| • Increase domestic water size and insulation | \$ 5,000.00 |
| • Furnish and Install (1) water closet | \$ 5,000.00 |
| • Furnish and Install (1) lavatory | \$ 3,000.00 |

EXCLUDES:

- Condensate drain piping
- Fire Protection
- Any and all Concrete work (pour-back)
- Any and all Electric and HVAC
- Utilities 5' from building
- Any and all sales tax
- Irrigation

ADDENDUM #1

BID: \$32,000.00

Plus Any Applicable Sales Tax

Material is guaranteed to be as specified. All work to be completed in a workmanlike manner according to standard practices. Any alteration or deviation to specifications above involving extra costs will be executed only upon written orders. It will become an extra charge over and above the estimate. All agreements contingent upon strikes, accidents or delays beyond our control. Owner will carry tornado and other necessary insurance. Our workers are fully covered by Workmans Compensation Insurance. Amount of invoices due at our office in Lake Worth, Tarrant County, Texas upon receipt. All accounts past due more than 30 days will be subject to an interest charge not to exceed maximum legal rate interest. This firm operates under the licensure of the State Board of Plumbing Examiners, P.O. Box 4200, Austin, TX 78765. Telephone No. 512-458-2145

ACCEPTANCE OF PROPOSAL: The above prices, specifications and conditions are satisfactory and are hereby accepted. You are authorized to do the work as specified. Payment will be made as outlined above.

Date of Acceptance: _____

Signature: _____

Signature: _____

RILEY PLUMBING & MECHANICAL



Note: This proposal may be withdrawn by us if not accepted within 14 days.



RJM
Contractors, Inc.

RJM Contractors, Inc.

Date

5/9/2022

Project: Aledo ISD ECA Renovations

Architect: PBK Post Bid Addendum # 1

RJM self performed Demolition of 20'-0" of wall @ \$26.00 per LF	\$	520.00
106 LF of Millwork @ \$8.87 LF	\$	940.00
	\$	<u>1,460.00</u>

M & M Masonry Unit pricing for door frames		
savings of install of 1 double frame with new CMU	\$	(2,000.00)
added four 3'-0" x 7'-0" frames demo & install @ \$1,250.00	\$	<u>5,000.00</u>
	\$	3,000.00

Added Dryer Vent RJM Self performed		
Materials	\$	243.00
Labor 12 hours with labor burden \$ 36.25	\$	<u>435.00</u>
	\$	678.00

7616 Benbrook Pkwy.

Benbrook, Texas 76126

Phone 817.377.0971

Fax 817.377.0973