

**BOARD OF EDUCATION
BEEVILLE INDEPENDENT SCHOOL DISTRICT**

Agenda Item No. _____

Date: May 16, 2006

Subject: HMD Preliminary Construction
Cost Estimate for Parking Lot
Addition

Submitted by: Erasmio Rodriguez

Related Pages: 3

Supt's Approval: _____

ACTION

BACKGROUND INFORMATION:

Attached is information for the Hampton-Moreno-Dugat ECC parking lot construction cost estimate from Brooks & Sparks, Inc. of Katy, Texas.

ITEMS ADDRESSED:

Preliminary construction cost estimate for Hampton-Moreno-Dugat ECC parking lot addition project.

RECOMMENDED ACTION:

Approval to proceed with this project.

BUDGETARY INFORMATION:

Preliminary Construction Cost Estimate is \$339,938.50

BROOKS & SPARKS, INC.
CONSULTING ENGINEERING

May 9, 2006

Dr. John Hardwick, Jr. Ed.D.
Beeville Independent School District
2400 North Saint Mary's
Beeville, Texas 78102

Re: Project Update
Parking Lot Addition

Dear Dr. Hardwick,

Brooks & Sparks, Inc. is currently designing the additional parking lot to serve the FMC Elementary School and HMD Early Childhood Center. The internal parking lot will be approximately 0.75 acres and will include 75 angled parking spaces. The project will include construction of the parking lot, drives and sidewalks, area grading, drainage improvements, and some existing sidewalk demolition.

Design for the project will be complete and ready to bid by May 22, 2006. With the help of Beeville I.S.D., a project manual including contract documents and technical specifications will also be provided. The District should bid the project by the end of May.

In order to facilitate completion of the parking lot by August 1, 2006, construction will need to begin by mid-June. This will allow 8 weeks for construction and inspection, which we feel is feasible. Approval from all applicable governing agencies will have to be obtained prior to beginning construction.

Attached is a preliminary construction cost estimate for the project. If you have any questions or require additional information, please feel free to contact me.

Sincerely,



Angela K. Medley, P.E.
Project Manager

I:\Beeville ISD\231-0002-00\L_Hardwick_Project Update_5-9-06.doc

21020 PARK ROW KATY, TX 77449
281-578-9595 - FAX: 281-578-9686

Beeville I.S.D.
Parking Lot Addition
Preliminary Construction Cost Estimate

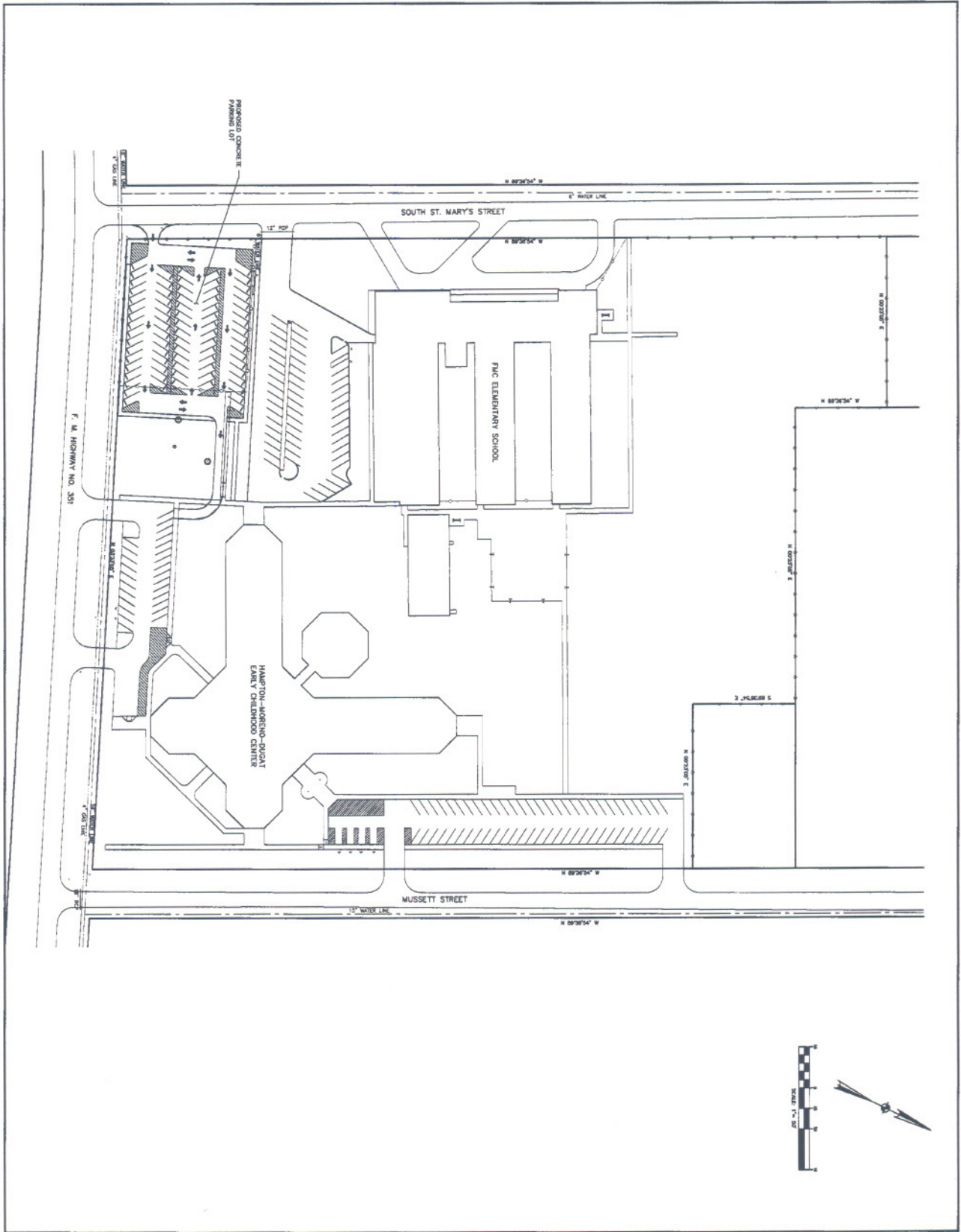
ITEM	COST
Pavement including Drives and Curbs	\$235,755.00
Sidewalks	\$12,000.00
Wheel Stops	\$30,000.00
Site Drainage Pipes	\$1,280.00
Site Grading	\$8,000.00
Pavement Markings	\$12,000.00
Storm Water Pollution Prevention Plan	<u>\$10,000.00</u>
	Subtotal \$309,035.00
	10% Contingency <u>\$30,903.50</u>
	Total <u><u>\$339,938.50</u></u>



BEAVILLE I.S.D. HMD EARLY CHILDHOOD CENTER AND FMC ELEMENTARY SCHOOL PARKING LOT ADDITION	
SITE PLAN	
NO. DATE 1 11/11/05 2 11/11/05 3 11/11/05	REVISIONS 1 2 3
DRAWN BY: JAV CHECKED BY: JAV PROJECT NO: 231-0002 SHEET 3 OF 3	CHECKED BY: JAV APPROVED BY: JAV DATE: 11/11/05
BRIDGES & SPAINCO, INC. CONSULTING ENGINEERS 2100 N. 10th St. Beaville, MO 65013 PHONE: (417) 526-4888 FAX: (417) 526-4888	