

DUCHESNE SCHOOL DISTRICT

UNION HIGH SCHOOL PRE-SCHOOL PLAYGROUND

850 E. LAGOON STREET

ROOSEVELT, UTAH

PROJECT CONTACTS

ARCHITECTURAL
KMA ARCHITECTS
195 EAST 100 NORTH
PROVO, UTAH 84606
(801) 377-5062

170 NORTH MAIN STREET
SPANISH FORK, UTAH 84660
WWW.KMAARCHITECTS.COM

KMA
ARCHITECTS

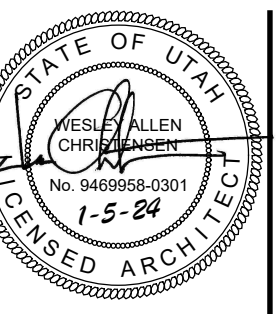

REVISIONS:

VICINITY MAP

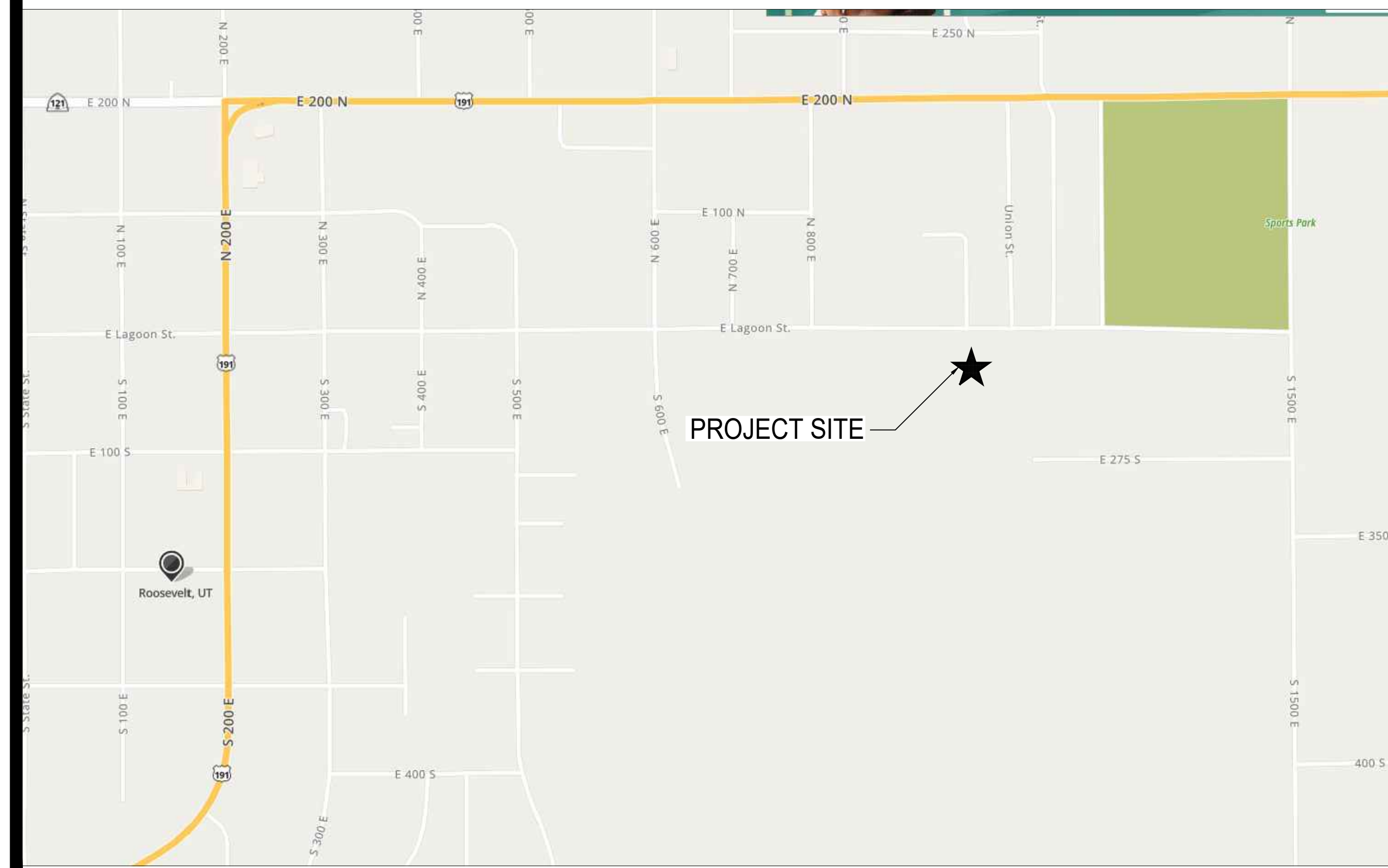

INDEX OF DRAWINGS

SITE WORK

- SD1 - DEMOLITION PLAN / SITE PLAN
- SD2 - GRADING PLAN / UTILITY PLAN
- L1 - LANDSCAPE PLAN / SPRINKLER PLAN

THIS PRINT AND ALL INFORMATION HEREON IS THE PROPERTY OF KMA ARCHITECTS AND SHALL NOT BE USED ON ANY OTHER JOB WITHOUT WRITTEN PERMISSION OF THE ARCHITECT

DUCHESNE SCHOOL DISTRICT
UNION H.S. - PRESCHOOL PLAYGROUND
ROOSEVELT, UTAH
850 E LAGOON STREET

DRAWN BY: RJW
CHECKED BY: WAC
DATE: JAN. 2024
PROJECT #: 172523

TITLE

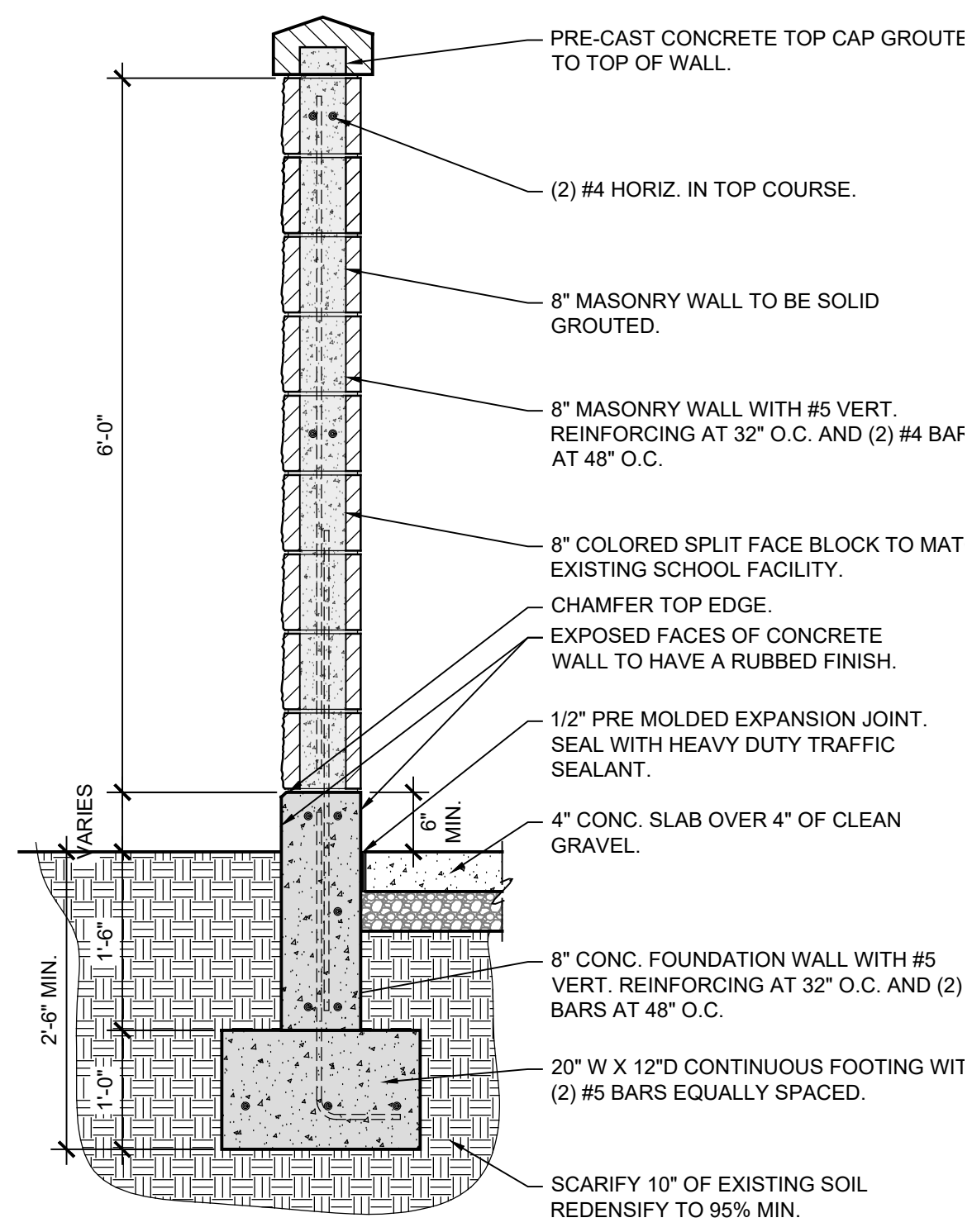

1 ENCLOSURE DETAIL
3/4" = 1'-0"

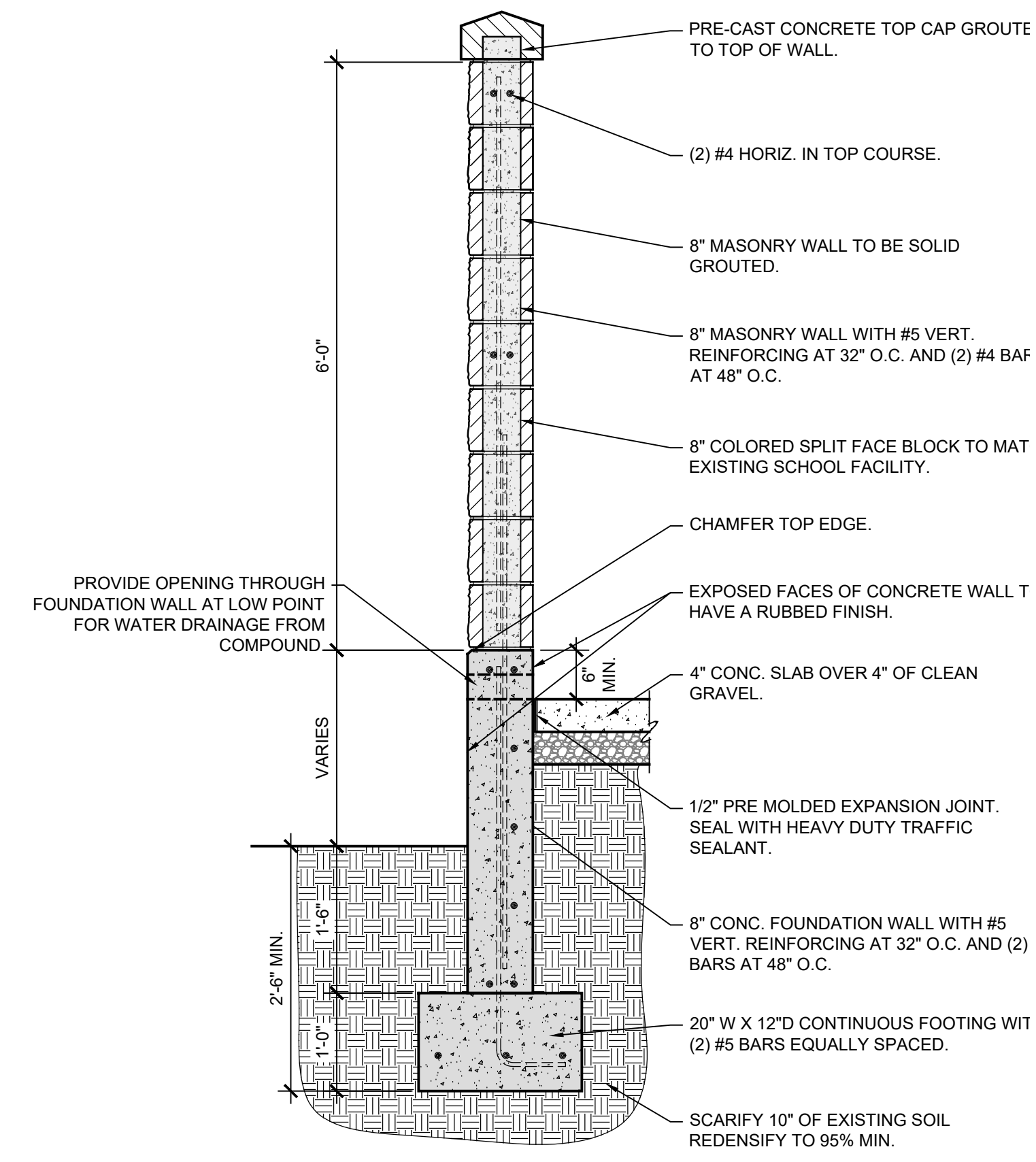

2 ENCLOSURE DETAIL
3/4" = 1'-0"

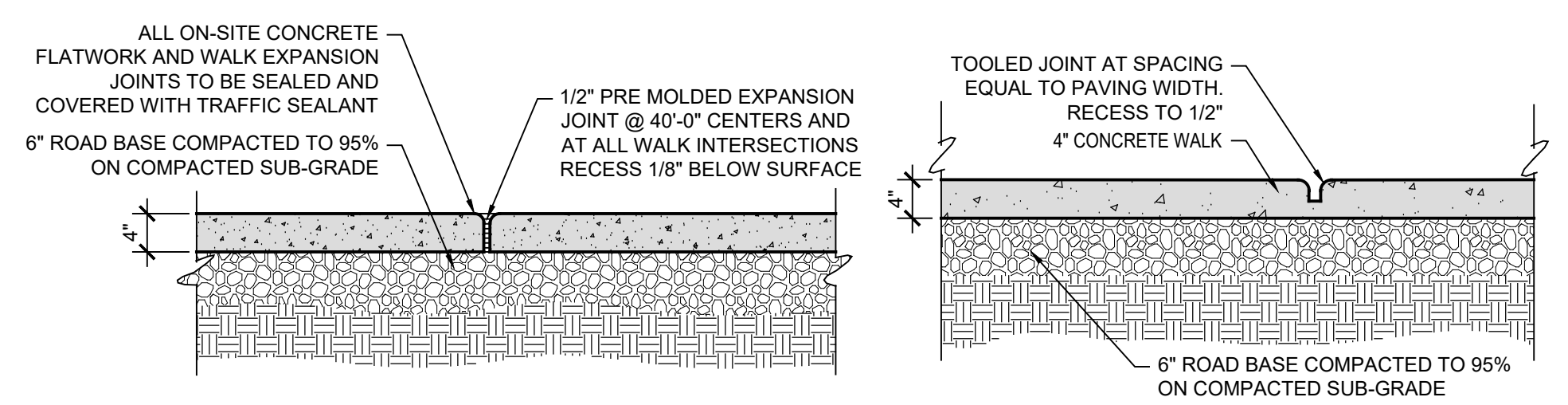

3 EXPANSION JOINT DETAIL
3/4" = 1'-0"

4 CONTROL JOINT DETAIL
3/4" = 1'-0"



DEMOLITION PLAN
1" = 20'-0"
0 10' 20' 35' 45'



SITE PLAN
1" = 20'-0"
0 10' 20' 35' 45'

- SHEET NOTES:**
- 01 - EXISTING BUILDING TO REMAIN. PROTECT THROUGHOUT CONSTRUCTION.
 - 02 - EXISTING CONCRETE WALK TO REMAIN. PROTECT THROUGHOUT CONSTRUCTION.
 - 03 - EXISTING LANDSCAPE CURBING TO REMAIN. PROTECT THROUGHOUT CONSTRUCTION.
 - 04 - EXISTING ROCKSCAPE TO REMAIN. PROTECT THROUGHOUT CONSTRUCTION.
 - 05 - EXISTING LANDSCAPE CURBING TO BE SAWCUT AND REMOVED.
 - 06 - EXISTING ROCKSCAPE TO BE MOVED TO ADJACENT MATCHING ROCKSCAPE AREAS, FOR FUTURE USE.
 - 07 - 4" THICK CONCRETE SLAB OVER 4" THICK CRUSHED GRAVEL.
 - 08 - CONCRETE EXPANSION JOINT. SEE DETAIL 3/SD1.
 - 09 - CONCRETE CONTROL JOINT. SEE DETAIL 4/SD1.
 - 10 - -- NOTE NOT USED --
 - 11 - BLOCK WALL ON CONCRETE FOOTING AND FOUNDATION. SEE DETAILS 1 & 2/SD1.
 - 12 - 4'-0" WIDE BLACK ALUMINUM PICKET FENCING GATE. PROVIDE HEAVY DUTY HINGES. PROVIDE OUTSIDE LOCKING LEVER HARDWARE AND PANIC DEVICE. MOUNT TO MASONRY ENCLOSURE WALLS.
 - 13 - EXTEND LANDSCAPE CURBING AS SHOWN.
 - 14 - EXISTING UNDERGROUND STORM DRAIN LINES TO REMAIN.
 - 15 - EXISTING CATCH BASIN AND ASSOCIATED PIPING TO REMAIN.
 - 16 - CONSTRUCTION AREA LIMIT LINE.

170 NORTH MAIN STREET
 SPANISH FORK, UTAH 84660
 WWW.KMAARCHITECTS.COM

KMA ARCHITECTS

STATE OF UTAH
 JESSE ALLEN
 LICENSED ARCHITECT
 1-5-24

REVISIONS:

DUCHESE SCHOOL DISTRICT
UNION H.S. - PRESCHOOL PLAYGROUND
 ROOSEVELT, UTAH
 850 E LAGOON STREET

DRAWN BY: RJW
 CHECKED BY: WAC
 DATE: JAN. 2024
 PROJECT #: 172523

SD1

THIS PRINT AND ALL INFORMATION HEREON IS THE PROPERTY OF KMA ARCHITECTS AND SHALL NOT BE USED ON ANY OTHER JOB WITHOUT WRITTEN PERMISSION OF THE ARCHITECT

THIS PRINT AND ALL INFORMATION HEREON IS THE PROPERTY OF KMA ARCHITECTS AND SHALL NOT BE USED ON ANY OTHER JOB WITHOUT WRITTEN PERMISSION OF THE ARCHITECT

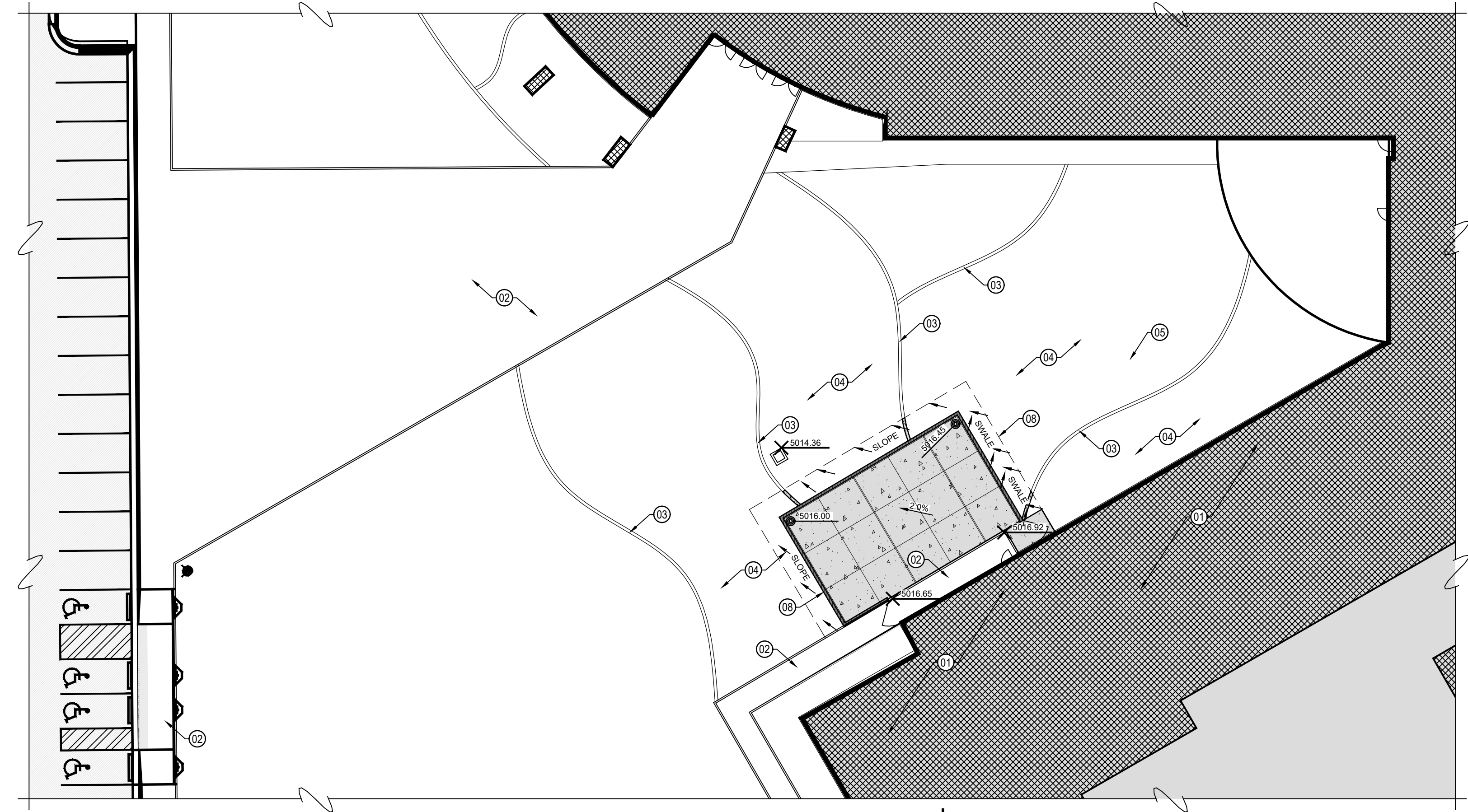

GRADING PLAN

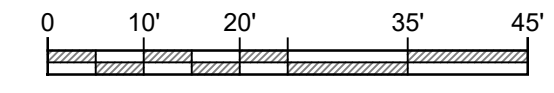

1" = 20'-0"

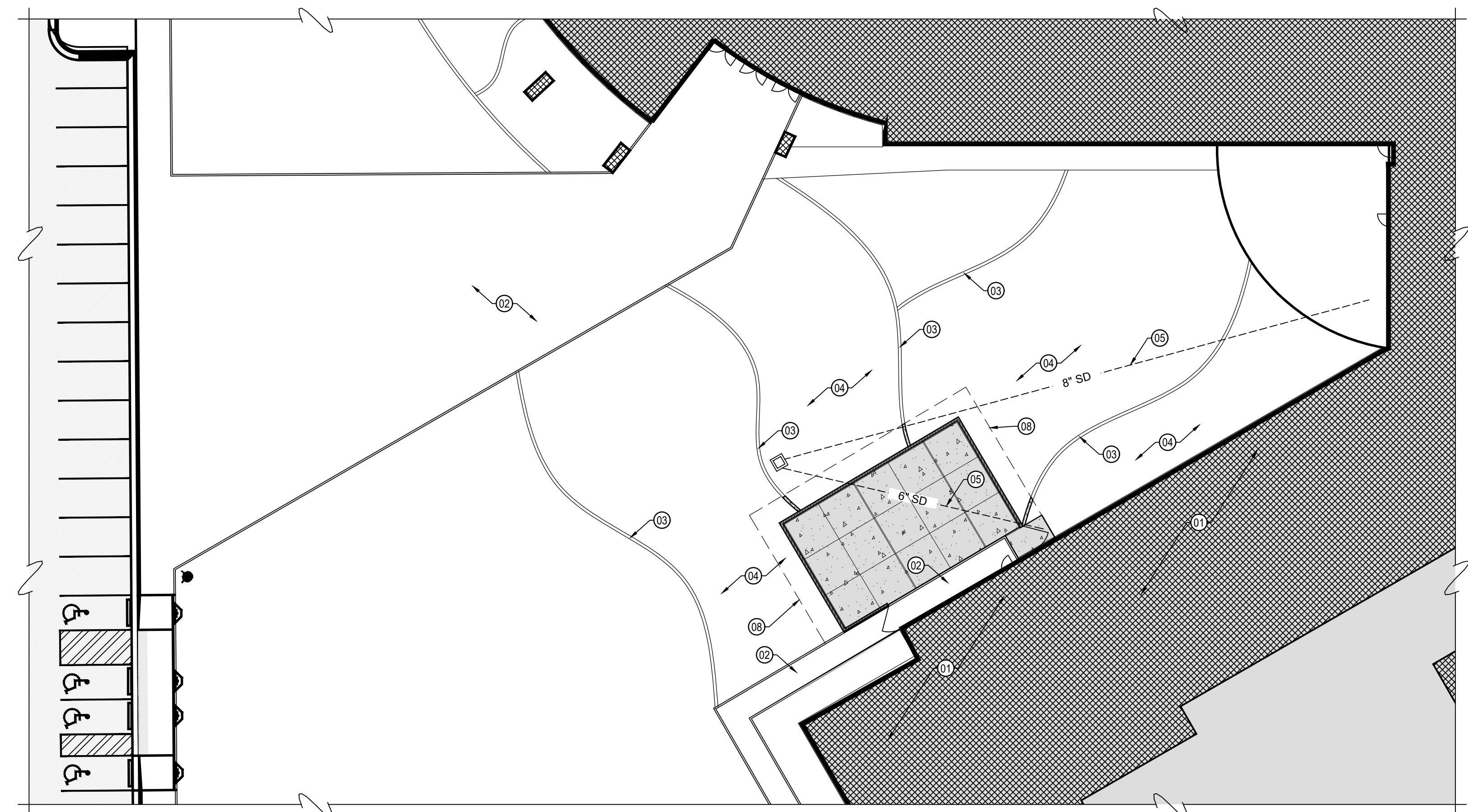
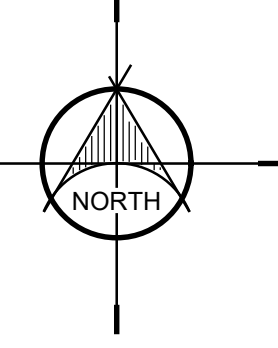

UTILITY PLAN

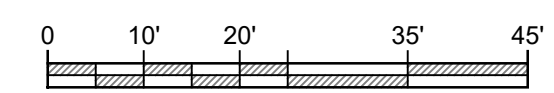

1" = 20'-0"

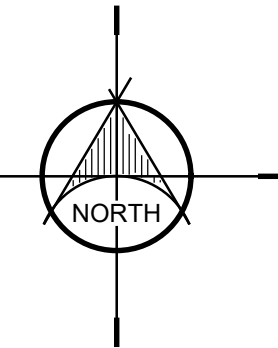

SHEET NOTES:

- 01 - EXISTING BUILDING TO REMAIN. PROTECT THROUGHOUT CONSTRUCTION.
- 02 - EXISTING CONCRETE WALK TO REMAIN. PROTECT THROUGHOUT CONSTRUCTION.
- 03 - EXISTING LANDSCAPE CURBING TO REMAIN. PROTECT THROUGHOUT CONSTRUCTION.
- 04 - EXISTING ROCKSCAPE TO REMAIN. PROTECT THROUGHOUT CONSTRUCTION.
- 05 - EXISTING UNDERGROUND STORM DRAINAGE PIPING TO REMAIN. PROTECT THROUGHOUT CONSTRUCTION.
- 06 -- NOTE NOT USED --
- 07 -- NOTE NOT USED --
- 08 - CONSTRUCTION AREA LIMIT LINE

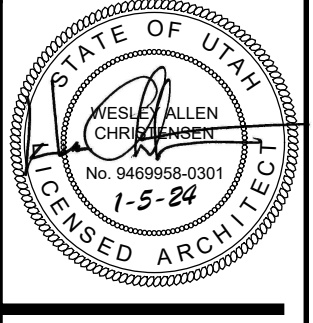

REVISIONS:

DUCHESNE SCHOOL DISTRICT

UNION H.S. - PRESCHOOL PLAYGROUND

ROOSEVELT, UTAH

850 E LAGOON STREET

DRAWN BY: RJW
 CHECKED BY: WAC
 DATE: JAN. 2024
 PROJECT #: 172523

SD2

170 NORTH MAIN STREET
 SPANISH FORK, UTAH 84660
 WWW.KMAARCHITECTS.COM

KMA
 ARCHITECTS

THIS PRINT AND ALL INFORMATION HEREON IS THE PROPERTY OF KMA ARCHITECTS AND SHALL NOT BE USED ON ANY OTHER JOB WITHOUT WRITTEN PERMISSION OF THE ARCHITECT

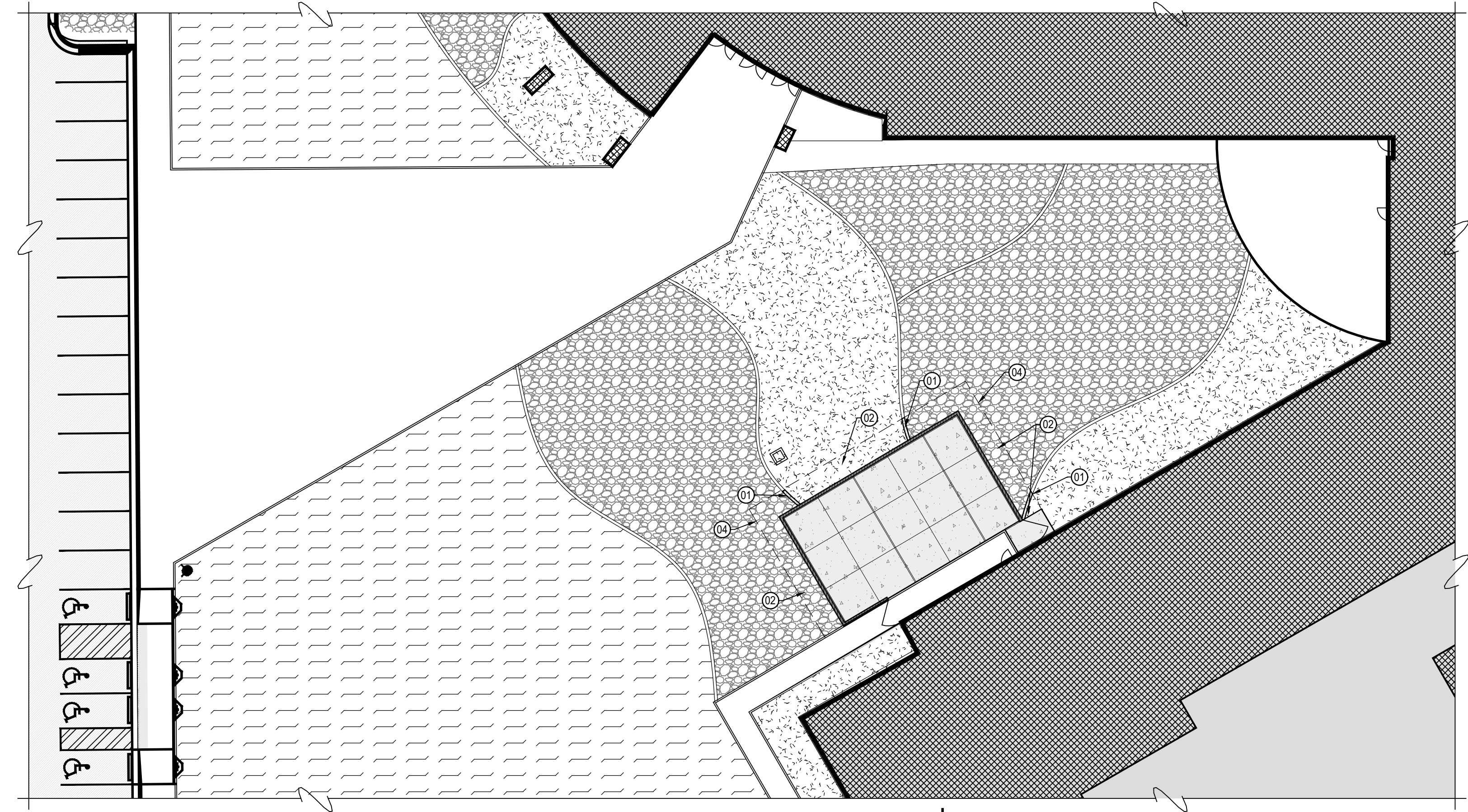

LANDSCAPE PLAN

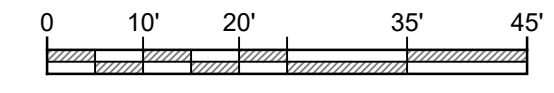

1" = 20'-0"

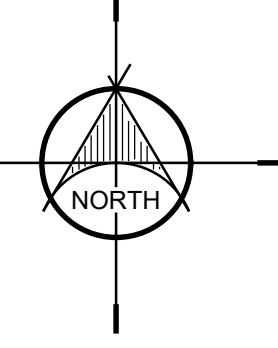

SPRINKLER PLAN

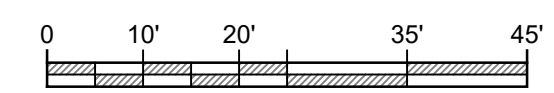

1" = 20'-0"

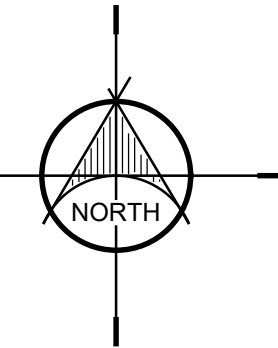

SHEET NOTES:

- 01 - 8" WIDE CONCRETE MOW STRIP BETWEEN VARYING TYPES OF ROCKSCAPE AND AS SHOWN. MATCH EXISTING MOW STRIPS.
- 02 - ROCKSCAPE TO BE PATCHED BACK IN USING EXISTING ROCKSCAPE. PROVIDE HEAVY DUTY COMMERCIAL GRADE WEED BARRIER BELOW.
- 03 - REROUTE ANY SPRINKLER LINES LOCATED WITHIN THE NEW CONCRETE BLOCK WALL AREA TO GO AROUND THE COMPOUND.
- 04 - CONSTRUCTION AREA LIMIT LINE

GENERAL NOTES:

- A - MAINTAIN WATER COVERAGE AND ADJUST SPRINKLER SYSTEM AS NEEDED UNTIL ALL ABOVE IS COMPLETED AND FINAL ACCEPTANCE IS GIVEN.

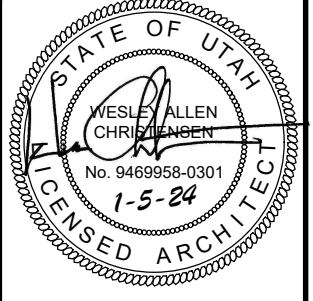

REVISIONS:

DUCHESNE SCHOOL DISTRICT

UNION H.S. - PRESCHOOL PLAYGROUND

ROOSEVELT, UTAH

850 E LAGOON STREET

DRAWN BY: RJW
 CHECKED BY: WAC
 DATE: JAN. 2024
 PROJECT #: 172523

170 NORTH MAIN STREET
 SPANISH FORK, UTAH 84660
 WWW.KMAARCHITECTS.COM

