



Splendora ISD Bond 2022

Elementary Schools

February 24, 2024





Peach Creek Elementary School

Construction – Peach Creek

- Completed Activities
 - Delivery of AHUs, VFDs, Switchgear and generator
 - Service yard paving pour
- Current Activities
 - Exterior brick and stone
 - 2-sided drywall
 - Tape and floating of walls
 - Ceramic tile
 - MEP rough-in above ceiling
- Upcoming Activities
 - Energy transformer
 - Set chillers
- Substantial Completion
 - July 28, 2025



Construction – Peach Creek



Front Entry



Kitchen MEP

Construction – Peach Creek



Ceramic Tile in Area D



2-side drywall in Area A

Budget Update– Peach Creek

Peach Creek Elementary Project Budget

Description	Budget	Committed Cost	Forecast	Cost at Completion	Delta
Construction	\$ 40,845,000	\$ 36,187,601.00	\$ 225,000	\$ 36,412,601	\$ (4,432,399)
Design Services	\$ 2,428,165.00	\$ 2,403,865.00	\$ -	\$ 2,403,865	\$ (24,300)
Specialty Services	\$ 536,490.00	\$ 484,740.00	\$ 25,000	\$ 509,740	\$ (26,750)
Furniture, Fixtures & Equipment	\$ 1,600,000.00	\$ -	\$ 1,600,000	\$ 1,600,000	\$ -
General Owner Expenses/Allowance	\$ 2,581,010.00	\$ 1,019,236.65	\$ 750,000	\$ 1,769,237	\$ (811,773)
Land Acquisition & Development	\$ 1,300,000.00	\$ 960,000.00	\$ -	\$ 960,000	\$ (340,000)
Total	\$ 49,290,665	\$ 41,055,443	\$ 2,600,000	\$ 43,655,443	\$ (5,635,222)

Committed to Date 83%

Peach Creek Elementary Allowance Status

Description	Budget	Committed	Remaining	Remaining %
Project Sign	\$1,500	\$1,500	\$0	0%
Utility Allowance	\$67,000	\$0	\$67,000	100%
Owner Betterment Allowance	\$2,567,611	\$1,655,353	\$912,258	36%
Total	\$2,636,111	\$1,656,853	\$979,258	37%



Greenleaf Elementary School



Construction – Greenleaf

- Current Activities
 - Plumbing underground
 - Grade beams
 - Pier caps
- Upcoming Activities
 - Slab on grade pour
 - Gas line
- Substantial Completion
 - November 28, 2025

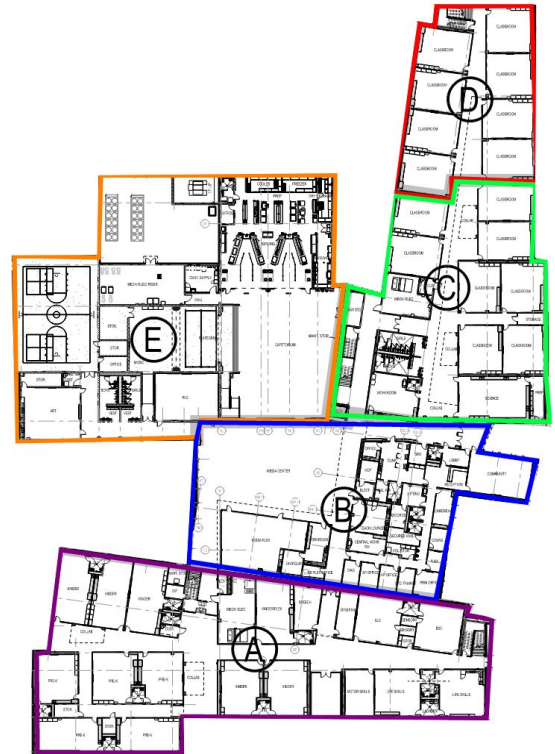

Construction – Greenleaf



Budget Update– Greenleaf

Greenleaf Elementary Project Budget

Description	Budget	Committed Cost	Forecast	Cost at Completion	Delta
Construction	\$ 40,845,000.00	\$ 36,379,239	\$ 200,000	\$ 36,579,239	\$ (4,265,761)
Design Services	\$ 2,121,828.00	\$ 2,041,828	\$ 50,000	\$ 2,091,828	\$ (30,001)
Specialty Services	\$ 618,864.00	\$ 618,864	\$ 75,000	\$ 693,864	\$ 75,000
Furniture, Fixtures & Equipment	\$ 1,600,000.00	\$ -	\$ 1,600,000	\$ 1,600,000	\$ -
General Owner Expenses/Allowance	\$ 2,498,636.00	\$ 1,016,351	\$ 1,000,000	\$ 2,016,351	\$ (482,285)
Land Acquisition & Development	\$ 4,464,540.00	\$ 2,172,056	\$ 750,000	\$ 2,922,056	\$ (1,542,484)
Total	\$ 52,148,868	\$ 42,228,338	\$ 3,675,000	\$ 45,903,338	\$ (6,245,530)

Committed to Date 81%

Greenleaf Elementary Allowance Status

Description	Budget	Committed	Remaining	Remaining %
Project Sign	\$1,500	\$0	\$1,500	100%
Onsite Soil Haul off	\$250,000	\$239,656	\$10,344	4%
Owner Betterment Allowance	\$1,500,000	\$0	\$1,500,000	100%
Total	\$1,751,500	\$239,656	\$1,511,844	86%



Questions



Lockwood, Andrews
& Newnam, Inc.

A LEO A DALY COMPANY

