



Future of Todd Hall

July 24, 2025

Current Reality

Last Major Classroom Renovation - Early 1990's

Rutledge Hall and Lincoln Hall Renovations - Last Decade

Future Needs of Todd Hall

<i>Creating Learning Spaces</i>	<i>Bigger Spaces</i>	<i>Work Spaces</i>
STEM Lab	Instructional Special Education	Conference Room
Sensory Room	NTDSE Program	Office Space (Psych, Soc Wrk)
Additional Section of Pre-K	GATE Program	Teacher Workroom
Math Intervention		Lounge
English Learner Program		

Future Needs of Todd Hall

- Majority of desired features of Todd Hall from previous slide can be built into existing footprint
- Todd Hall must be expanded to build in features AND continue with CCDC as a tenant

Existing Todd Hall Floor Plan



Floor Plan without CCDC

PROPOSED OVERALL PLAN

• CONCEPT 2

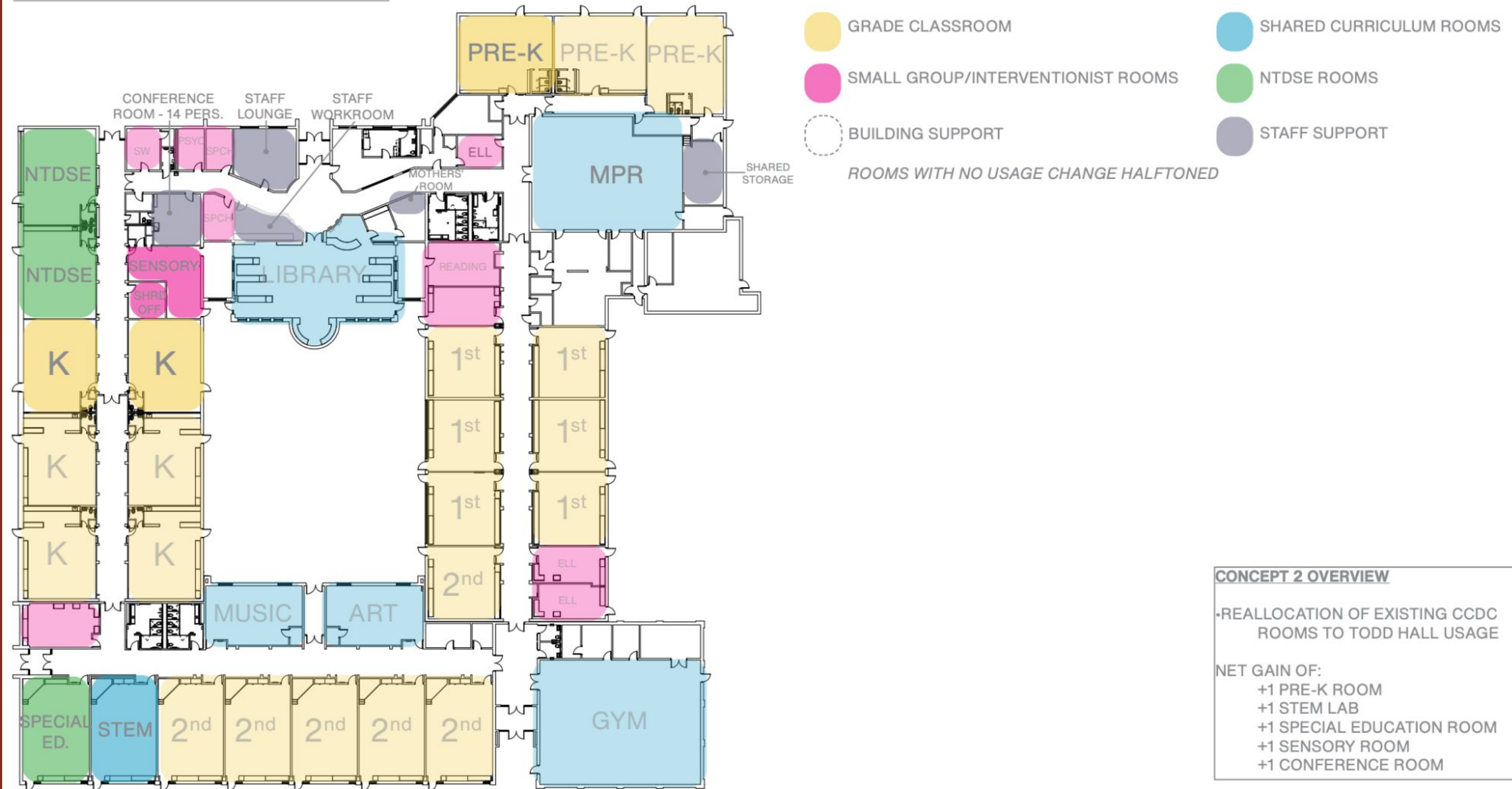

NET GAIN OF:

- +1 PRE-K ROOM
- +1 STEM LAB
- +1 SENSORY ROOM
- +1 CONFERENCE ROOM

Floor Plan with CCDC

PROPOSED OVERALL PLAN

• CONCEPT 3



How much would the District borrow?

<i>Scenario without CCDC*</i>	<i>Scenario with CCDC*</i>
\$5,000,000	\$12,100,000

*Both scenarios assume \$1,500,000 contribution from existing Fund Balances

For how many years would the District’s ability to issue new debt be limited?

<i>Scenario without CCDC*</i>	<i>Scenario with CCDC*</i>
3 Years	13 Years

*Non-Referendum Debt Service Extension Base

When would the District pay off its debt?

<i>Scenario without CCDC</i>	<i>Scenario with CCDC</i>
2040	2048

Are there any restructuring fees?

<i>Scenario without CCDC</i>	<i>Scenario with CCDC</i>
No	Yes - \$413,000

What is the total cost of the debt? (principal + interest)

<i>Scenario without CCDC</i>	<i>Scenario with CCDC</i>
\$7,850,275	\$25,748,414

Other Considerations...

- Lincolnwood Town Center Redevelopment
- District is committed to identifying an afterschool care provider
- Four classroom addition does not address all possible enrollment stresses
 - Do we want to spend money and expand now when we might have to expand and spend more in the near future?