

ACADEMY OF
MATH & SCIENCE
— LITTLE ROCK —

AMS Arkansas

Charter Authorizing Panel Hearing

August 15, 2023

PRESENTED BY: AMS Schools – Arkansas



Agenda



AMS History, Vision, and Impact



AMS Arkansas



Panel Q&A

Meet the Team

Erik Greenberg, Chief Executive Officer

Nate Lowry, Chief Academic Officer

Kate Bracher, Executive Director – AMS Arkansas

Steven Hykes, Chief Financial & Growth Officer

Brandi Adams Bressler, Chief Operating Officer

Robert Biggs, Chief Information Officer

Zachary Larison, Chief of Staff



AMS History, Vision, and Impact

The AMS Story



In 2002, Ms. Tatyana Chayka founded the first Academy of Math and Science with a vision of creating a school for her son that offered education in Math and Science while incorporating well-rounded programs and electives at no additional cost to parents.

AMS started its first year with 30 students total. As the school year progressed, Ms. Chayka was concerned that the school wouldn't financially survive the end of the first year. Determined not to cut important aspects of a well-rounded student experience, Ms. Chayka forged ahead.

Serendipitously, Ms. Chayka received a visit from Cathy Lund from the Walton Family Foundation. Impressed with what the school offered, Ms. Lund urged Ms. Chayka to continue building her vision. With the contribution from the WFF, AMS was able to complete the year successfully.

AMS Today

Since 2002, AMS has served over 30,000 students and their families.

Through a well-rounded education, our mission is to transform today's scholars into tomorrow's global visionaries.

Today, nearly 900 AMS staff members passionately serve 8,500 students at 9 schools across Phoenix and Tucson communities.





AMS Tomorrow

In alignment with our mission and values, AMS only seeks expansion into high FRL communities with a clear, demonstrated need for excellent education.

We are proud to join the ranks of passionate and dedicated members of the community and honored to partner with the state of Arkansas to impact the lives of students and their families.

AMS Vision, Values, and Objectives

Our vision is to provide “The Best Education;
The Best Environment.

We are driven by our values to:

Do Whatever it Takes

Act with Honor

Be Vulnerable, Candid, and Kind

A-Rated Schools

Data-driven approach to
close academic gaps



Fully Enrolled, Fully
Staffed

Excellent service to families
and staff



Growth and
Development

Student learning growth,
staff and leader
development

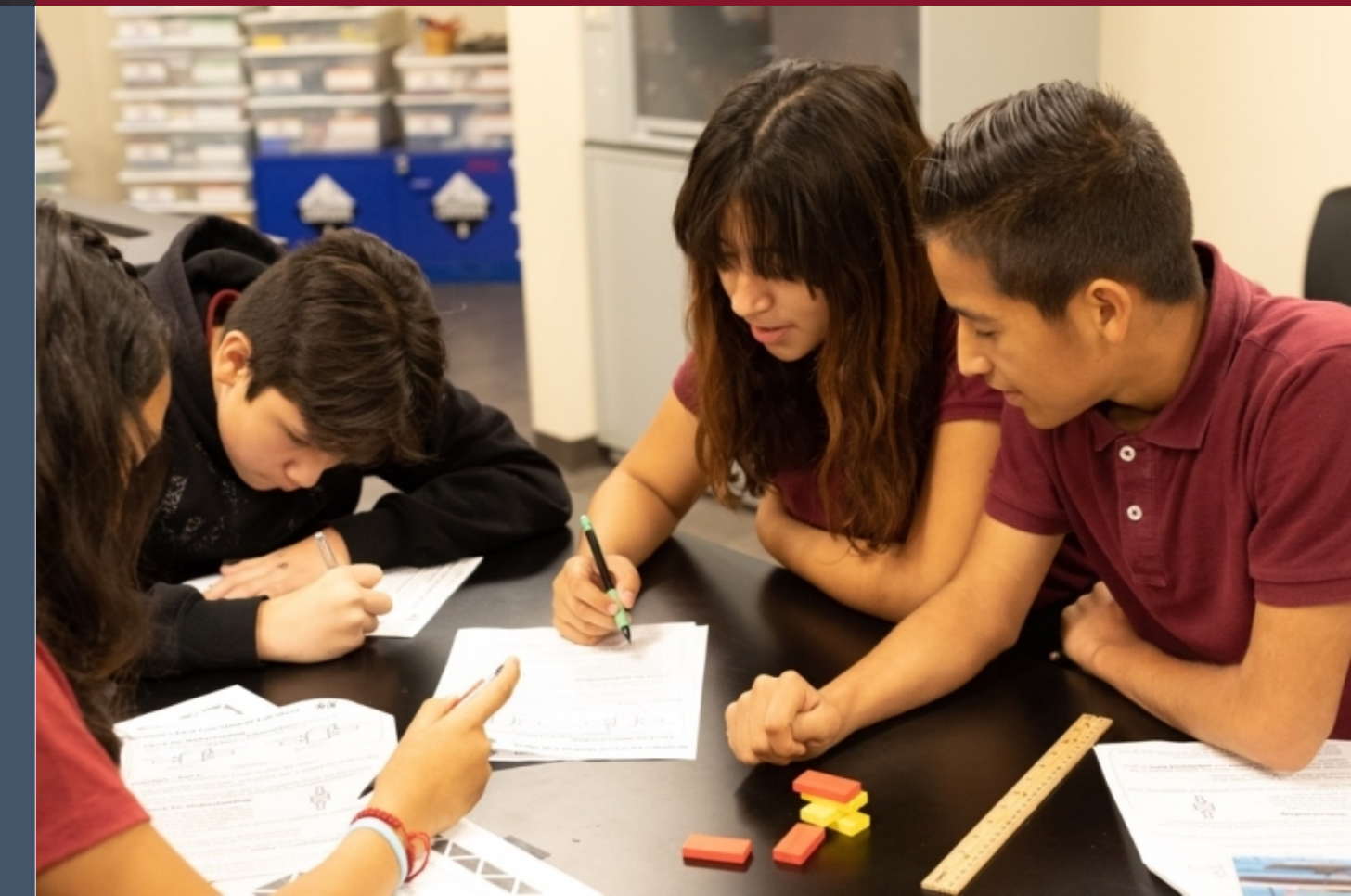

Record of Results

AMS Arizona 2022 & 2023 AASA A-F Accountability Results

School	21-22 Points	22-23 Points	Point Increase	21-22 Grade	Projected 22-23 Grade [†]
AMS Prince	88.23	93.04	+4.81	A	A
MASSA	86.01	87.60	+1.59	A	A
AMS Flower	79.23	84.12	+4.89	B	B
AMS Camelback	60.66	78.73	+18.07	C	B
AMS Desert Sky	78.05	81.27	+3.22	B	B
AMS Glendale	76.03	80.34	+4.31	B	B
AMS Peoria Advanced	59.87*	90.10	+30.23	C	A
AMS Avondale	79.15	82.14	+4.96	B	B
AMS South Mountain	74.10	79.06	+2.99	B	B



2022 Cut Scores	A	B	C	D	F
	100 - 84.67	84.66 - 72.39	72.38 - 60.11	60.1 - 47.83	47.82 - 0

*AMS Peoria Advanced appealed a data error and received a C-letter grade for 2021-22 from the State Board of Education. Points awarded were not adjusted after the fact.
 † Official letter grades and cut scores for 2022-23 have not been released. 2022-23 Grades are projected based on official test data and last year's cut scores.

AMS Arizona 2022 & 2023 AASA Passing Rates

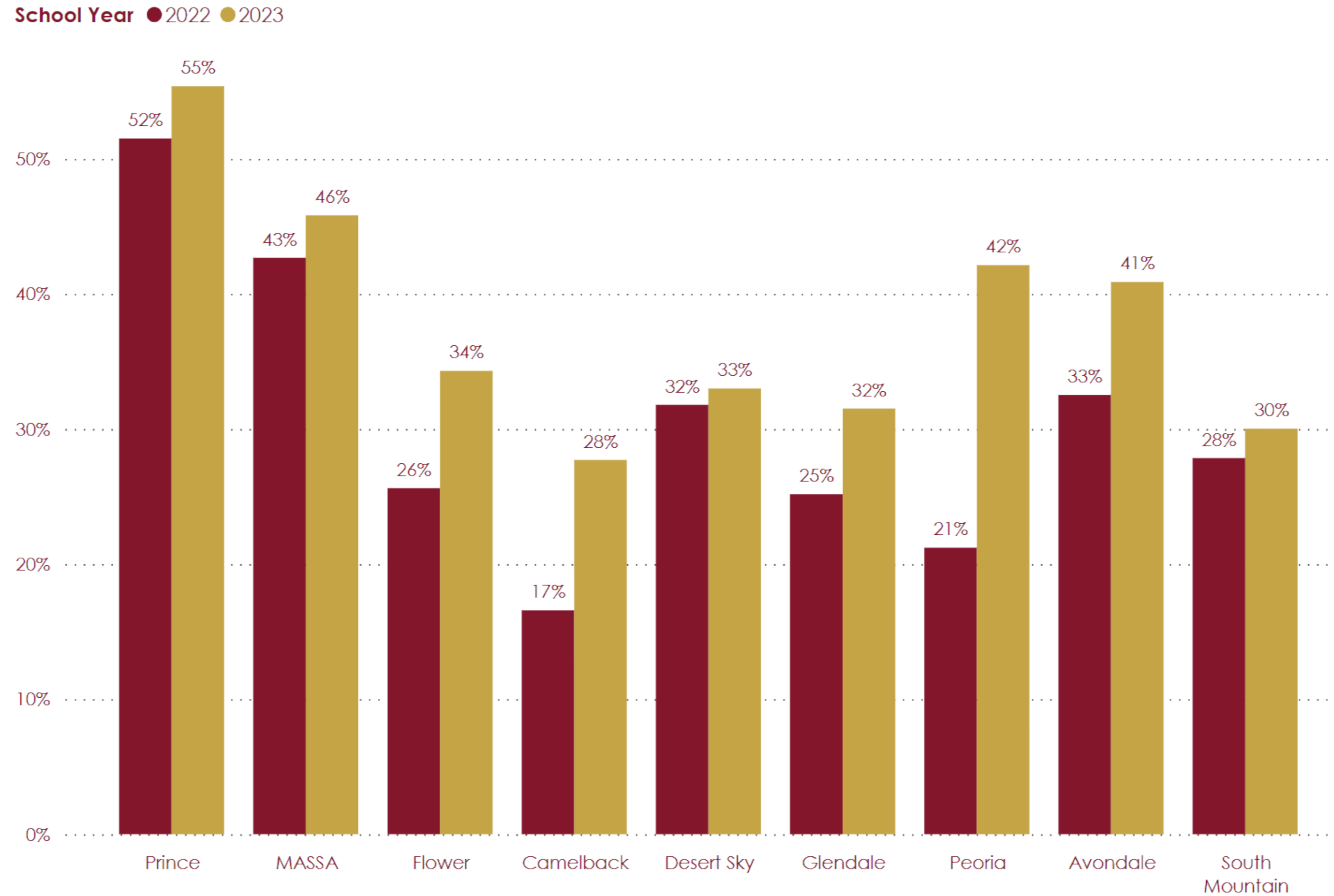

AMS Arkansas

AMS Little Rock

75-90% Students qualify for FRL in surrounding communities

69% Students in area currently attend D or F-rated school

600 K-8 students and families AMS Little Rock could serve

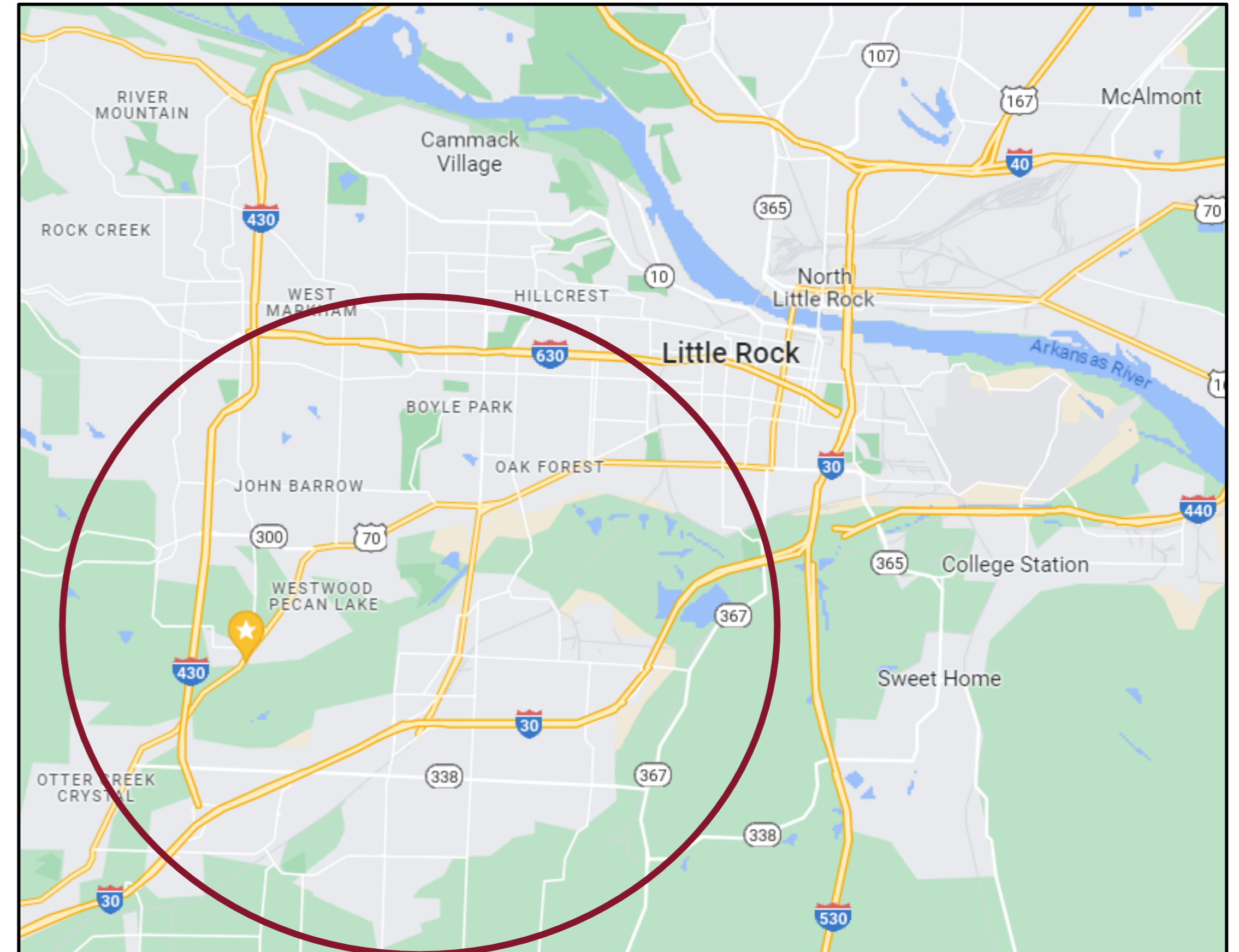

AMS Little Rock Model

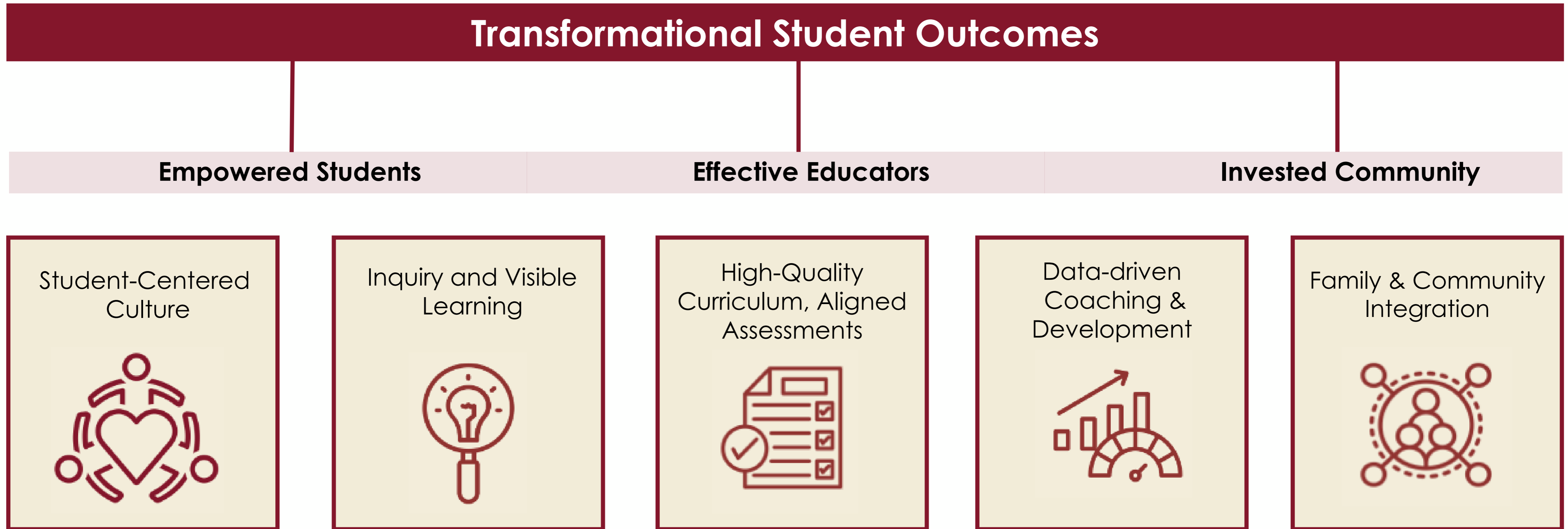

Facilities and Funding

AMS Little Rock

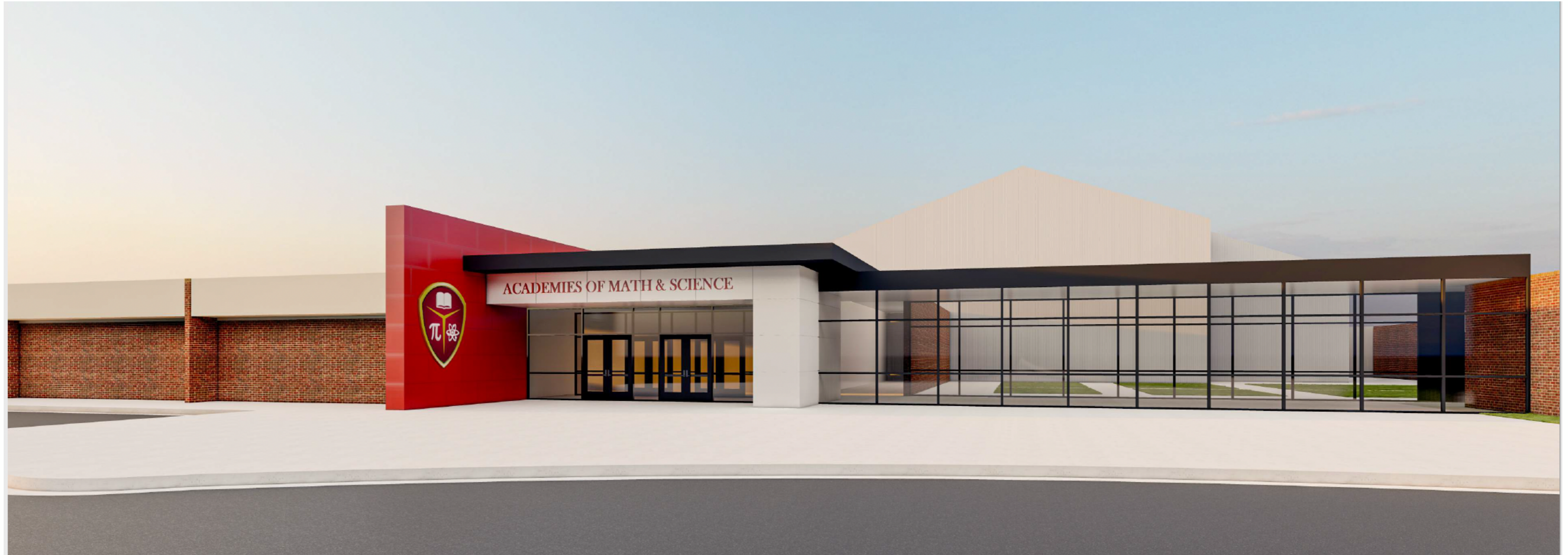

AMS Little Rock

- Purchase agreement in place for former David O. Dodd elementary school for sale by Little Rock School District.
- Site improvements to include brand new indoor sport field and performance stage along with 7 classrooms, full length outdoor soccer field, and new play facility for K-3.
- Break even student enrollment for this campus would be approximately 300 students.
- Building to be owned by non-profit support organization and funded through public bond issuance with no obligation of school or state in the event of charter non-renewal.

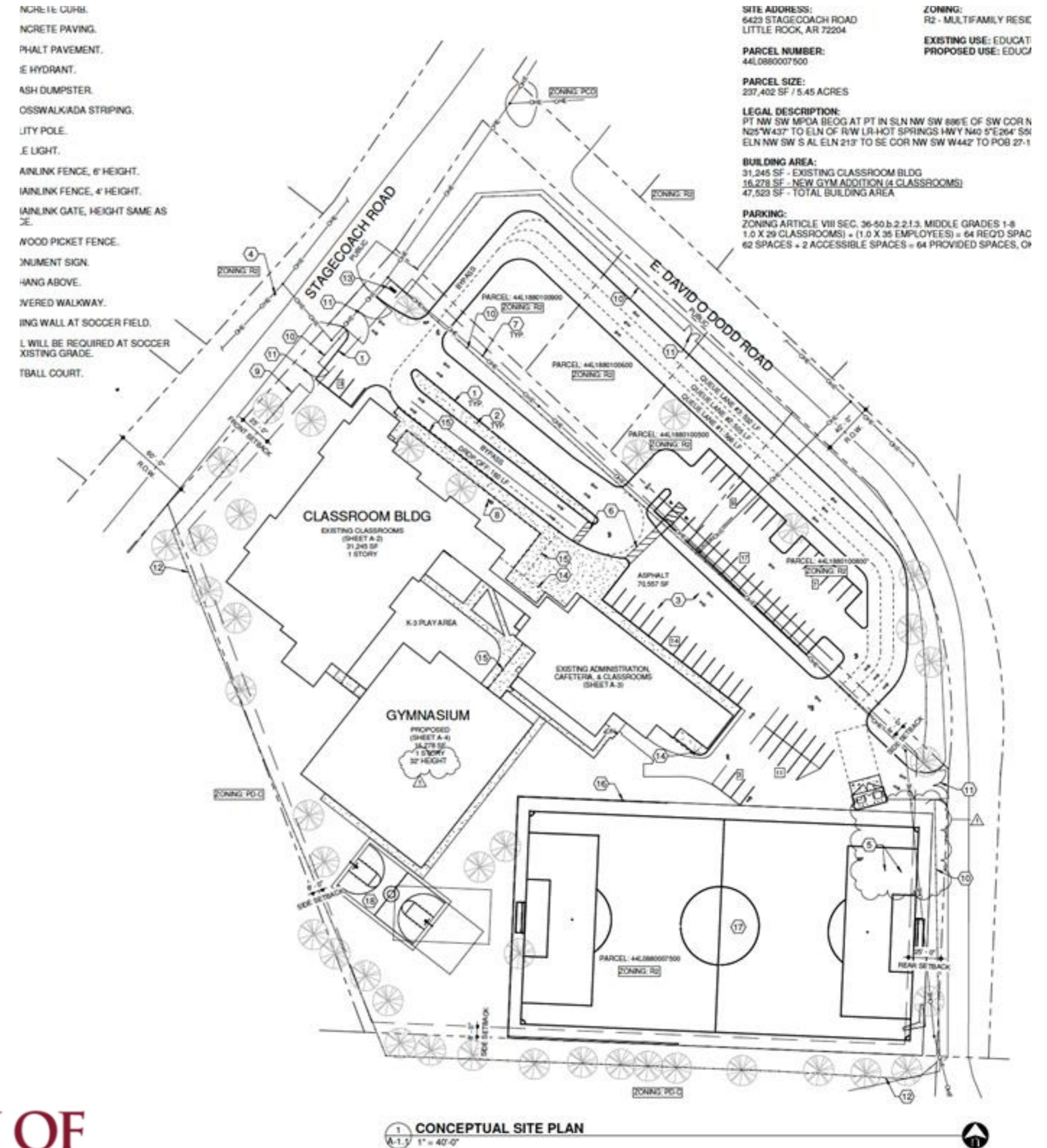

**ACADEMY OF
 MATH & SCIENCE**
 LITTLE ROCK

AMS Arizona Historical and Projected Financials

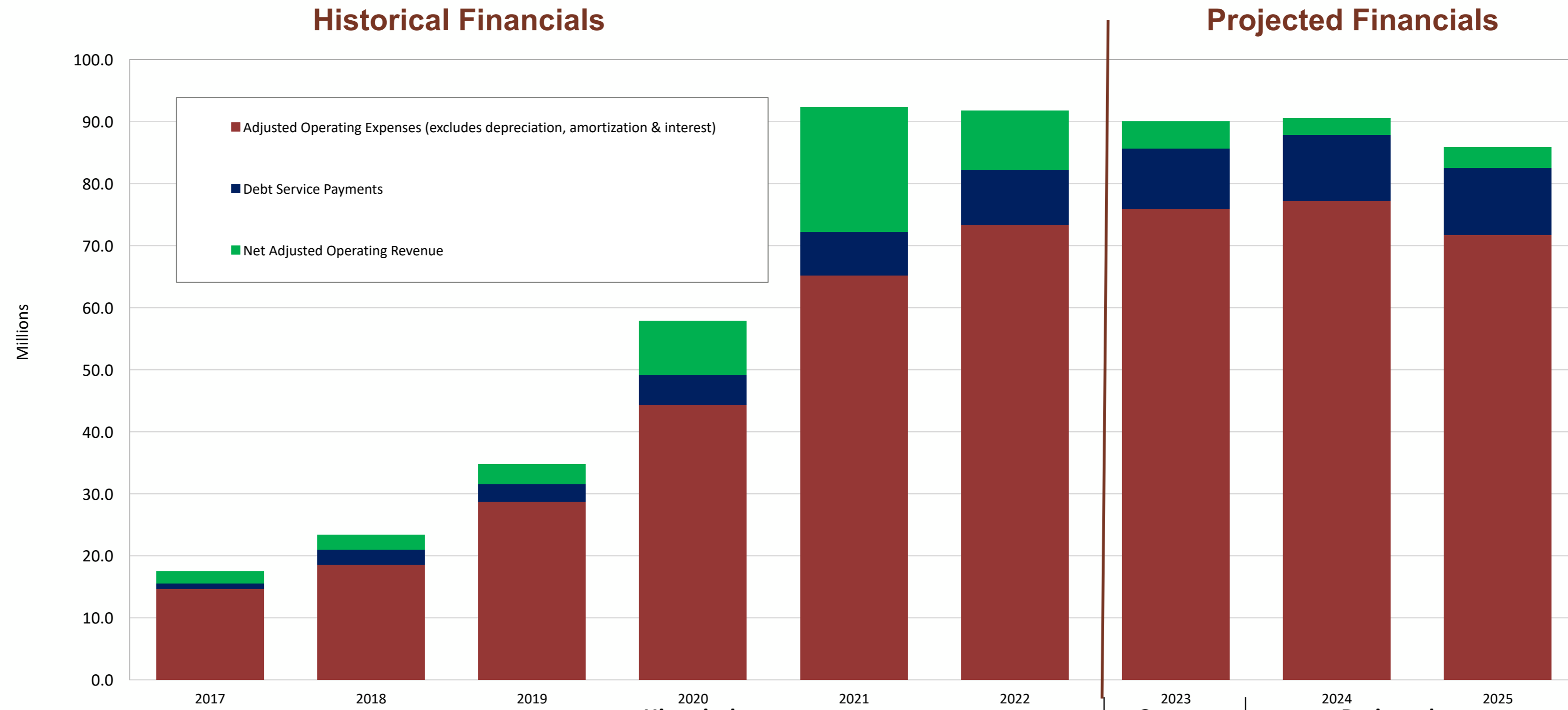

Fiscal Year	Historical						Current	Projected	
	FY17	FY18	FY19	FY20	FY21	FY22	FY23	FY24	FY25
Cash	1,875,887	3,759,176	6,389,120	11,087,501	24,110,936	34,296,523	36,944,480	36,336,997	36,584,668
Days Cash on Hand	49	72	72	81	121	155	162	157	169
Debt Service Payment	922,225	2,428,362	2,754,127	4,797,222	7,077,244	8,900,654	9,697,861	10,677,391	10,850,616
Debt Service Coverage Ratio	3.06	1.97	2.17	2.81	3.83	2.03	1.45	1.36	1.41



Thank You!

