



## Coppell I.S.D.

Date: February 10, 2022

Body Manufacturer: IC Corp

Model: C3411 Conventional ("2023")

Chassis Manufacturer: IC Corp

Model: PB105 ("2023")

Capacity: 77 Passengers

Number of units: 2

**Price/Unit: \$114,707.00**

**TOTAL: \$229,414.00**

*Prices are good 30 days from date of this proposal.*

Standard Body Specifications	Chassis Specifications
78" headroom standard	Engine: Cummins ISB 6.7
13 rows of 39" seats 3pt (passenger side)	Horsepower: 240
12 rows of 39" and 1 row 26" seat 3pt (driver side)	Steering: Power, Tilting
National high back air suspension driver's seat	Power Source: 12 volt
Windshield wipers, cowl mounted	Torque: 560 lb-ft
Seat centers on 27" spacing	Wheelbase: 276"
First aid kit and body fluid clean-up kit, state spec	Alternator: 325 amp
Full insulation (roof & sides)	Transmission: Allison 2500
Body undercoating, fire resistant	Brakes: Full air
Fire extinguisher	Front Axle: 10,000#
Rubber flooring throughout (black)	Rear Axle: 21,000#
Triangle reflectors (3)	Tires: 11R22.5 LRH HSR2 Cont.
Aluminum aisle strips	Fuel Tank: 100 Gallon with barrier
90,000 BTU with defroster	Battery System: (3) 12 volt 2850 CCA
School bus yellow paint	Air-Ride Suspension
Two full rows interior dome lights	Warning Buzzers
Rear view mirror inside (6 x 30)	Auto. Slack Adjusters
Rosco cross over mirrors	
Rear view mirrors "Roscoe"	
Tail pipe, horizontal, exits left side through bumper	
Handle, assist, entrance door, outside entrance	
Flasher system, 8 warning lights, red lights active with door open	
Specialty roof hatches (2)	
Warning light LED strobing type	
State spec LED light pkg.	

### Longhorn Bus Sales

LHB VIN: PB193570,  
PB193571

9100 N. Loop East, Houston, Texas 77029  
Phone: (713) 631-9306

LHB PO: 21-182

Body Options Included	Chassis Options Included
Interior paint - (white) Reflective material Entry door (air), outward opening White roof 5/8" plywood, B-C exterior grade 5-ply floor Air stop arms Four emergency E/E windows, vertical hinge Strobe light Monitor, post trip inspection Light, exterior, check, pre-trip 84,500 BTU rear heater Drivers area defrost fan (left) AM/FM/USB Input/PA system Speakers (6) mounted in light bar PDI DOT inspection Lettering (COPPELL I.S.D.) Defrost kit Govern speed set at 65mph Weigh bus Air conditioning 136K BTU (2 bulkheads, 1 mid-shift and drivers dash) (ProAir) Route changer – 4 digit	Bendix 4-channel ABS brake system Daytime running lights Throttle (electric) Cruise control Seatbelt cutter Warranty towing: 24 months/Unlimited miles to nearest IC bus dealer

Both body and chassis specifications meet or exceed Texas School Bus Specification # 070-SB-16 for 2018.

**Authorized Signature**\_\_\_\_\_

All stock buses are subject to prior sale.

**Buy Board fee not included. If purchasing through Buy Board, and additional \$800.00 must be applied to purchase order (fee is per purchase order not per bus). Longhorn Buy Board number 630-20.**

Estimated delivery is 60 -180 days from receipt of PO (dependent on whether bus is built or scheduled to build). Longhorn Bus Sales will not be held responsible for material shortages or delays due to the global COVID-19 pandemic or any other reasons outside our control of the represented OEMs (IC Corp) or third-party vendors used to complete a customers' bus equipment. A bus may be delivered without third-party products (i.e., A/C, GPS, two-way radios, camera surveillance, etc.) and will be installed when available. These shortages will not hold up invoicing of payments for delivered goods.

**Longhorn Bus Sales**

LHB VIN: PB193570,  
PB193571

9100 N. Loop East, Houston, Texas 77029  
Phone: (713) 631-9306

LHB PO: 21-182





# LONGHORN BUS SALES

9100 N Loop East  
Houston, TX 77029  
(713) 631-9306

## Coppell I.S.D.

Date: February 10, 2022

Body Manufacturer: IC Corp Model: C2608 2023

Chassis Manufacturer: IC Corp Model: PB 105 2023

Capacity: 54 Passenger - 3 w/c positions

**Price/Unit: \$110,102.00** Number of units: **5** **Total: \$550,510.00**

*Prices are good 30 days from date of this proposal.*

### Standard Body Specifications

78" headroom standard  
5 rows 39" (LT) seats, with 3-point seat belts  
5 rows 39" (RT) seats, with 3-point seat belts  
Windshield wipers, cowl mounted  
Seat centers on 27" spacing  
First-aid and body fluid kit, state spec  
Full insulation - roof & sides  
Complete body undercoating  
Fire extinguisher  
Rubber flooring throughout (black)  
Safety triangles  
Aluminum floor covering trim  
90,000 BTU front heater/defrost system  
School bus yellow paint  
Two full rows interior dome lights  
Rear view mirror inside (6 x 30)  
Cross over mirror ("Roscoe")  
Rear view mirrors ("Roscoe")  
Driver fan, defog  
State spec LED light pkg.  
Emergency door buzzer and hold-back device  
National hi-back air ride driver's seat with seat belt  
Two roof hatches ("Transpec")  
Four emergency E/E windows, vertical hinge  
Stop arm, air ("Specialty")  
Monitor, post trip inspection  
Light, exterior, check  
80,000 BTU right wall heater  
White roof

### Chassis Specifications

Engine: Cummins ISB 6.7  
Horsepower: 220  
Fuel tank: 65 gallon  
Torque: 520 ft-lb  
Wheelbase: 217"  
Alternator: 325 amp  
Transmission: Allison 2500 w/7yr warranty  
Brakes: Full Air  
Front axle: 10,000#  
Rear axle: 19,800#  
Tires: 255/70R 22.5H ("Hankook")  
Auto. slack adjusters  
Power steering  
Tilt steering  
Warning buzzers  
Battery system 3-12 volt 2850 CCA  
Power source 12V  
Mud flaps  
Engine exhaust brake  
Idle management system

<b><u>Body Options Included</u></b>	<b><u>Chassis Options Included</u></b>
Entrance air door outward opening Reflective material Interior paint (spring white) 3pt seat belts 16 sets 5/8" marine plywood over steel floor Window tint Collision Mitigation Bendix Advanced Wingman Upholstery, ("Prevail"), (gray) 4 LH track mounted seats, 2 RH track seats 3 w/c positions ("Sure-Lok") retractable ("Titan") Lift - w/c ("Braun") AM/FM stereo/USB input/PA radio system Strobe light PDI DOT inspection Lettering (COPPELL I.S.D.) Govern speed set at 65mph Weigh bus IC factory air conditioning 126K BTU (2 bulkheads and drivers dash) Route changer – 4 digit	Cruise control  Daytime running lights Hand throttle Warranty - towing: 24/unlimited to nearest I/C dealer

Both body and chassis specifications meet or exceed Texas School Bus Specification # 070-SB-16 for 2018.

**Authorized Signature**\_\_\_\_\_

All stock buses are subject to prior sale.

**Buy Board fee not included. If purchasing through Buy Board, and additional \$800.00 must be applied to purchase order (fee is per purchase order not per bus). Longhorn Buy Board number 630-20.**

Estimated delivery is 60 -180 days from receipt of PO (dependent on whether bus is built or scheduled to build). Longhorn Bus Sales will not be held responsible for material shortages or delays due to the global COVID-19 pandemic or any other reasons outside our control of the represented OEMs (IC Corp) or third-party vendors used to complete a customers' bus equipment. A bus may be delivered without third-party products (i.e., A/C, GPS, two-way radios, camera surveillance, etc.) and will be installed when available. These shortages will not hold up invoicing of payments for delivered goods.



**OBTAINING SERVICE**

Return this vehicle to any IC Bus Dealer authorized to service this model vehicle and engine.

**DISCLAIMER**

NO WARRANTIES ARE GIVEN BEYOND THOSE DESCRIBED HEREIN. THIS WARRANTY IS IN LIEU OF ALL OTHER WARRANTIES, EXPRESSED OR IMPLIED. THE COMPANY SPECIFICALLY DISCLAIMS WARRANTIES OF MERCHANTABILITY AND FITNESS FOR A PARTICULAR PURPOSE, ALL OTHER REPRESENTATIONS TO THE USER/PURCHASER, AND ALL OTHER OBLIGATIONS OR LIABILITIES. THE COMPANY FURTHER EXCLUDES LIABILITY FOR INCIDENTAL AND CONSEQUENTIAL DAMAGES, ON THE PART OF THE COMPANY OR SELLER. No person is authorized to give any other warranties or to assume any liabilities on the Company's behalf unless made or assumed in writing by the Company; and no other person is authorized to give any warranties or to assume any liabilities on the seller's behalf unless made or assumed in writing by the seller.

**Remedies Under State or Provincial Law:** Any suit for breach of this Limited Warranty must be initiated within one year after breach. Some States and Provinces do not allow the exclusion or limitation of incidental or consequential damages, so the above limitation or exclusion may not apply to the owner. This warranty gives the owner specific legal rights, and he may also have other legal rights which may vary by state or province.

**RECORD OF OWNERSHIP**

Upon receipt of new vehicle by original owner, complete the following:

I have read this Warranty Brochure and fully understand the warranty coverage, and the limitations and exclusions. I acknowledge that I have received a copy of the Owner's Limited Warranty and I accept the terms described herein.

Customer Signature _____	Date _____
Owner's Address _____	City _____ State/Prov _____ Postal Code _____
Bus Model _____	Vehicle Identification Number _____
Engine Number _____	Engine Serial Number _____
Date Delivered to User (DTU) _____	Odometer Reading at Delivery _____

**IMPORTANT:** The information contained in this Warranty Policy explains the coverage provided on your new IC Bus™ brand vehicle. This policy should be kept in the vehicle for presentation to the Dealer when you request warranty services.

Any provisions of this Limited Warranty that are prohibited or not enforceable in any jurisdiction shall be, as to such jurisdiction, ineffective to the extent of such prohibition or non-enforceability without invalidating the remaining provisions hereof, and any such prohibition or non-enforceability in any jurisdiction shall not invalidate or render non-enforceable any such provisions in any other jurisdiction.

All claims under this Limited Warranty must be submitted in writing to an authorized IC Bus dealer within the warranty period as stated herein. If you have questions regarding this Limited Warranty, contact IC Bus, LLC dealer. To locate nearest dealer, visit the IC Bus website [www.ICBus.com](http://www.ICBus.com).

**EFFECTIVE WITH VEHICLES BUILT MARCH 01, 2017 OR LATER****LIMITED WARRANTY FOR SCHOOL BUS MODELS****CE Series (PB105), RE Series (PB305), BE Series (PB405)**

IC Bus, LLC warrants to the original purchaser (the "Purchaser") that IC Bus, LLC brand buses and component parts thereof are, at the time of purchase, free from defects in material and workmanship and will remain free from such defects under normal use after delivery to the Purchaser as provided herein. Warranty shall begin at the time of delivery unless otherwise approved by IC Bus, LLC. The delivery limitations as set forth herein shall run from the date of delivery to the Purchaser in the United States of America and Canada. The remedy available under this Limited Warranty is non-cumulative in nature and is limited to repair or replacement at IC Bus, LLC option of the bus or component parts thereof that are returned to locations approved by IC Bus, LLC transportation charges prepaid, and which IC Bus, LLC examination disclosed to its satisfaction to be defective. IC Bus, LLC, at its option, will repair or replace any part of this vehicle which proves defective in material and/or workmanship in normal use and service, with new or ReNEWed parts. Exceptions are listed below under *What Is Not Covered*.

*This warranty is automatically transferred to subsequent owners at no charge. Visit your local IC Bus Dealer for name and address change information.*

**COMPONENT COVERAGE**

The components described below are given additional warranty coverage of variable time periods and distance traveled limitations, as shown in the *Warranty Coverage Schedule*.

1. Frame Rails and Crossmembers
2. Body/Cowl Structure
  - Body Structure defined as the steel body frame (which includes the roof, metal floor, sides and front and rear sections only).
  - As to items not considered Body Structure include but are not limited to the following: doors, corner moldings, inner ABS panels, interior wall, plywood, floor covering, windows, and trim moldings.
3. The Body/Cowl is warranted against perforation due to corrosion, except for perforation caused by industrial chemicals and/or corrosion caused by use in a corrosive industrial environment.
4. Navistar Diesel Engine Coverage Includes: Navistar Diesel Engine block, cylinder heads, internally lubricated components fuel pump, high pressure pump, turbocharger, water pump, air compressor, injectors/nozzles; electronic engine modules, engine relays, engine sensors and regulators required for electronic engine operation, and certain aftertreatment components. Excluding: attaching accessories (e.g., fan clutch, alternator, starter, etc.), and externally mounted electrical and filtration systems.
5. Power Solutions International 8.8L Propane and Gas Engine Coverage Includes: Engine block, cylinder heads, internally lubricated components, water pump, air compressor, injectors/nozzles, fuel system components; electronic engine modules, engine relays, engine sensors and regulators required for electronic engine operation, exhaust catalyst. Excluding: attaching accessories (e.g., fan clutch, alternator, starter, etc.)
6. Spicer front & rear axles and propeller shaft, when used with Allison transmission; excluding brakes, wheel ends axle shafts, controls & attachments.

THE PROVISIONS HEREOF CONSTITUTE THE EXCLUSIVE AND COMPLETE WARRANTY BY IC BUS, LLC ON IC BUS™ BRAND BUSES AND COMPONENT PARTS THEREOF MANUFACTURED BY IT, OR APPROVED BUS BODY CONTRACT MANUFACTURERS AND IS IN LIEU OF ALL OTHER OBLIGATIONS OR LIABILITIES OF IC BUS, LLC WHETHER EXPRESS OR IMPLIED.

**Note:** The customer has 365 days and up to a maximum of 100,000 miles (160,000 km) from DTU (delivery to end user) to purchase an extended warranty on the unit. For extended warranty purchases between 181 and 365 days from DTU and <100,000 miles (160,000 km) an additional fee will be assessed. See your local IC Bus dealer for details.



Items Covered	Months	Miles/Km (000)
<b>BASIC VEHICLE COVERAGE</b>		
Basic Vehicle Warranty	12	Unlimited
Towing (Chassis related issues)	3	Unlimited
Towing (Vehicles with Navistar built engine failures only)	24	Unlimited
Towing (Vehicles with Power Solutions International, Inc. 8.8L Propane engine failures only)	60	Unlimited
Towing (Vehicles with Power Solutions International, Inc. 8.8L Gasoline engine failures only)	60	Unlimited
<b>COMPONENTS</b>		
Frame Rails and Crossmembers	60	Unlimited
Body/Cowl Structure (Roof, Metal Floor, Sides and Front and Rear Sections)	60	Unlimited
Body/Cowl Perforation Corrosion	60	Unlimited
Bumper Corrosion and Paint Delamination	36	Unlimited
Body/Cowl/Hood Paint Delamination	60	Unlimited
Brightwork, Chassis Paint and Corrosion	6	Unlimited
IC Bus, LLC Factory Installed Air-Conditioning (IC Air)	30	Unlimited
<b>SEATS***IC Bus manufactured Seats Only</b>		
Foam	48	50/80
Upholstery	24	24/40
Frame and Barriers	60	Unlimited
<b>ENGINE*</b>		
Power Solutions International, Inc. 8.8L Propane Engine	60	Unlimited
Power Solutions International, Inc. 8.8L Gasoline Engine	60	Unlimited
<b>DRIVETRAIN**</b>		
Eaton Procion Transmission	12	Unlimited
Spicer - 3 Part Dana Drivetrain (Front & Rear Axles, Propeller Shaft, When Used With Allison Transmission Only)	48	50/80
Meritor Axles	48	75/120

### WHAT IS NOT COVERED

#### AFTER THE FIRST 90 DAYS FROM DELIVERY TO USER (DTU):

- Correction of loose fasteners, squeaks, rattles and unusual noises.
- Towing (vehicles with non-engine failures only)
- Adjustments (e.g., headlights, brake/clutch adjustments, steering system adjustments, coolant levels, doors).

#### COMPONENTS / ITEMS:

- Warranted by their respective manufacturers (e.g., non Navistar brand engines, tires & tubes, Allison Transmissions, Hybrid electric, lubricants, etc.)
- Bodies, equipment and accessories installed by other than authorized IC Bus employees at IC Bus manufacturing plants.
- Front and rear axle alignment.
- Front & Rear axle coverage excludes brakes, wheel ends, axle shafts, controls & attachments.

#### REPAIRS:

- Maintenance-related items/repairs or those as a result of normal wear and tear, including tune-ups, brake/clutch lining, windshield wiper blades, tire balancing, lubrication and other similar procedures/parts required to keep vehicle in good working condition.
- To any part of the vehicle subjected to misuse, negligence, improper maintenance, improper operation, or which is the result of an accident.
- Fade, runs, mismatch or damage to paint, trim items, upholstery, chrome, polished surfaces, etc., resulting from environmental causes, improper polishes, cleaners or washing solutions, or chemical and industrial fallout.
- In which power train, propeller shaft and suspension sales guidelines (specifications) are not strictly adhered to by all owners and operators of this vehicle.

#### OTHER:

- Vehicles sold and/or operated outside the United States and Canada.
- Vehicles/components that have had unauthorized alterations or modifications.
- Vehicles on which the odometer reading has been altered.
- Loss of time or use of the vehicle, loss of profits, inconvenience, or other consequential or incidental damages or expenses.
- Replacement of defective parts with parts other than those provided by IC Bus, LLC.

#### ***This warranty does not apply, or include coverage for defects attributable to the following:***

- (a) Damage resulting from: (i) misuse, abuse, accident, neglect, negligence, vandalism, fire, riot, war, or Acts of God;
- (b) (ii) Structural or other modifications or alteration without prior express written authorization by IC Bus, LLC; (iii) Repair or attempted repair by unauthorized persons; (iv) Replacement of original components with substitutes without prior express written authorization by IC Bus, LLC; (v) Failure to perform routine preventative maintenance as customarily accepted within the industry or failure to provide proof of such preventative maintenance having been performed; (vi) Exposure to corrosives, contaminants, chemicals, salt, irradiation or atmospheric or environmental conditions; (vii) Usage or loading in excess of recommended capacities or in non-standard applications, including off-road.
- (c) Fading or discoloration of paint, lettering or decals.
- (d) Effects of aftermarket installation and aftermarket parts installed by the dealer or customer.

**\*Emission Coverage:** Refer to engine operator's manual for emission coverage.

#### **\*\*Drivetrain:**

- Allison Transmissions products or Transynd lubricants and fluids are not covered under this warranty. For warranty information see: [www.allisontransmission.com/publications/](http://www.allisontransmission.com/publications/)
- For specific Eaton/Fuller Warranty coverage, see supplier information: [www.roadrangerwarranty.com](http://www.roadrangerwarranty.com)
- For extended component warranty: [www.roadranger.com/Roadranger/warranty/Extended\\_Warranty/index.htm](http://www.roadranger.com/Roadranger/warranty/Extended_Warranty/index.htm)

**\*\*\*For non IC Bus Manufactured seats,** contact the seat supplier for their warranty coverage. For Enova charge sustaining and charge depleting standard warranty to: <http://enovasystems.com/customer-support.html>

\*1/24/2019 removed MaxxForce Engines from coverage as Buses built post March,1,2017 no longer offered this engine.





**Revised 4/1/2019**

**Telematics Data Disclosure**

***Your Navistar vehicle may include an activated telematics subscription service. By accepting this Limited Warranty you consent to our collection and use of data from your vehicle as set forth at [www.oncommandconnection.com](http://www.oncommandconnection.com) on behalf of yourself and any vehicle operators and passengers. Navistar, Inc. or its affiliates will collect and send diagnostic and system data from your vehicle and use it for various purposes as further set forth in our Privacy Policy, posted at [www.oncommandconnection.com](http://www.oncommandconnection.com), such as improving the uptime for your vehicle, improving our vehicles in the future, and reducing warranty events. If you choose not to allow Navistar to access your data, you may suspend your subscription at [www.InternationalTrucks.com/Opt-Out](http://www.InternationalTrucks.com/Opt-Out)***



## 2500/2550 Series



### RATINGS

Model <sup>(1)</sup>		Gross Input Torque <sup>(2)</sup> N•m	Gross Input Power <sup>(2)</sup> kW (hp)	Gross Input Torque <sup>(2)(3)</sup> N•m	Gross Input Power <sup>(2)(3)</sup> kW (hp)	GVW kg	GCW kg
2500	General	780	224 (300)	895	254 (340)	15,000	15,000
	Refuse, On-Highway	746	224 (300)	766	224 (300)	12,000	12,000
	Non-North America School Bus	705	149 (200)	750	164 (220)	15,000	15,000
2500 MH	Motorhome	746	224 (300)	895	254 (340)	15,000	15,000
2500 SP	Specialty Vehicles	CONTACT YOUR ALLISON REPRESENTATIVE FOR DETAILS					
2550	General	780	224 (300)	895	224 (300)	13,600	13,600
	Non-North America School Bus	705	149 (200)	750	149 (200)	13,600	13,600
2550 SP	Specialty Vehicles	CONTACT YOUR ALLISON REPRESENTATIVE FOR DETAILS					

(1). Models including vocational designations (ie: ORS, OFS, SP, MH) are for global markets. All other models within this document are targeted for outside North American markets only.  
 (2). Gross ratings as defined by ISO 1585 or SAE J1995. (3). Shift Energy Management (SEM) engine controls and torque limiting are required to obtain this rating.

### DRIVETRAIN INTERFACES

Acceptable full-load engine governed speed	2200 – 3800* rpm
Acceptable engine idle speed range (with transmission in Drive)	500 – 820 rpm
Maximum output shaft speed at 105 km/hr (65 mi/hr)	4500 rpm

\* Engines with full load governed speed greater than 3800 rpm require Application Engineering review

### MOUNTING

To Engine	SAE No.3, SAE No.2
-----------	--------------------

### TORQUE CONVERTER

Type One stage, three element, polyphase.  
Includes standard integral damper which is operational in lockup.

Model	Stall Torque Ratio
TC-210	2.05
TC-211	1.91
TC-221	1.73
TC-222	1.58

### MECHANICAL RATIOS (Gear ratios do not include torque converter multiplication)

#### Range

First	3.51 : 1
Second	1.90 : 1
Third	1.44 : 1
Fourth	1.00 : 1
Fifth	0.74 : 1
Sixth	0.64 : 1
Reverse	-5.09 : 1

### CONTROL SYSTEM

Description	Allison 5th Generation Electronic Controls with closed loop adaptive shifts
Shift Sequences	[C = Converter mode (lockup clutch disengaged); L = Lockup mode (lockup clutch engaged)]  Option 1: 1C-[1L]-2C-2L-3L-4L-5L Option 2: 1C-[1L]-2C-2L-3L-4L-5L-6L

Driver-to-Transmission Interface	Cab-mounted shift selector
Communication Protocol - Engine/Vehicle Systems Interface	SAE J1939, IECAN, PT-CAN

## PHYSICAL DESCRIPTION

	Installation Length*	Dry Weight	Depth below transmission centerline	
			With Shallow Oil Sump	With Deep Oil Sump
SAE No.3	729 mm	150 kg	272 mm	285 mm
SAE No.2	739 mm	150 kg	272 mm	285 mm

\*Approximate length from engine housing to output flange (depending on output flange type)

## TURBINE-DRIVEN POWER TAKE-OFF PROVISION

PTO drive	Torque converter turbine-driven spur gear
PTO mounting pads	Six-bolt, 3 o'clock and 9 o'clock positions (as viewed from rear)
PTO drive gear rating (continuous operation)	Using one PTO: 339 N•m Total using two PTO's: 271 N•m
PTO drive gear ratio	1.00 x turbine speed
PTO drive gear	64 tooth

## OIL SYSTEM

Allison approved fluids: TES 295 and TES 389

Capacity, excluding external circuits

With Deep Oil Pan 14 litres

With Shallow Oil Pan 12 litres

Spin on canister filter Standard

## SPEEDOMETER PROVISION

Description	Non-zero-crossing square wave
Location	8, 16 or 40 pulses per revolution of transmission output shaft Electronic output from TCM

## TACHOGRAPH PROVISION

Tone wheel	6-tooth
Mounting	M18 x 1.5 metric thread
Location	Transmission rear cover

## 2500/2550 Series

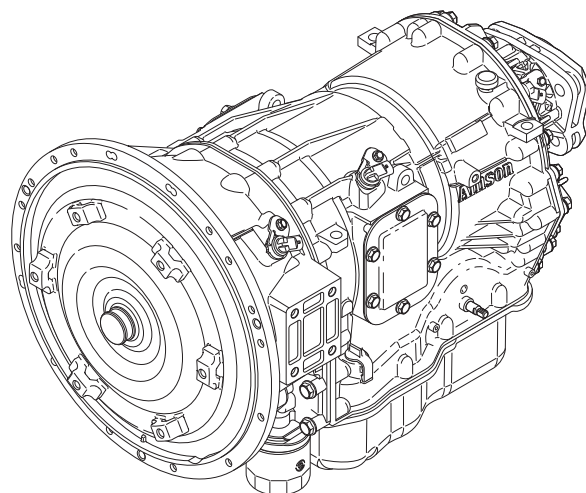
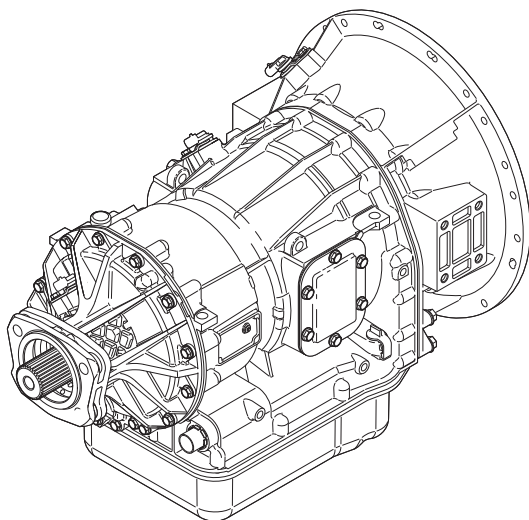



All IC School Buses come with: PROMOTIONAL PACKAGE 84 Month Unlimited Miles/km Warranty, Limited Time Program for Allison 2000 Series Transmission (Supplied directly through Allison)

Allison 3000 Series Transmission 60 Month Unlimited Miles/km Warranty (Supplied directly through Allison)

# **Cummins Warranty**

**All Engines United States And Canada School Bus**

## Coverage

### Products Warranted

This Warranty applies to new diesel, LPG, compressed or liquid natural gas fueled Engines sold by Cummins Inc. or Cummins Westport and delivered to the first user on or after September 15, 1996, that are used in school bus\* applications in the United States\*\* or Canada.

### Base Engine Warranty

The Base Engine Warranty covers any failures of the Engine which result, under normal use and service, from a defect in material or factory workmanship (Warrantable Failure). This Coverage begins with the sale of the Engine by Cummins and continues for five years or 100,000 miles (160,934 kilometers), whichever occurs first, from the date of delivery of the Engine to the first user.

Engine aftertreatment components included in the Cummins Critical Parts List (CPL) and marked with a Cummins part number are covered under Base Engine Warranty.

### Extended Major Components Warranty

The Extended Major Components Warranty applies to all except ISV, ISB6.7 G, B and ISB Series Engines and covers Warrantable Failures of the Engine cylinder block, camshaft, crankshaft and connecting rods (Covered Parts).

Bushing and bearing failures are not covered.

This Coverage begins with the expiration of the Base Engine Warranty and ends three years or 300,000 miles (482,804 kilometers), whichever occurs first, from the date of delivery of the Engine to the first user.

### Emission Warranty

Additional Coverage is outlined under the Emission Warranty.

**THESE WARRANTIES ARE MADE TO ALL OWNERS IN THE CHAIN OF DISTRIBUTION AND COVERAGE CONTINUES TO ALL SUBSEQUENT OWNERS UNTIL THE END OF THE PERIODS OF COVERAGE.**

## Cummins Responsibilities

### During The Base Engine Warranty

Cummins will pay for all parts and labor needed to repair the damage to the Engine resulting from a Warrantable Failure.

Cummins will pay for the lubricating oil, antifreeze, filter elements, belts, hoses and other maintenance items that are not reusable due to the Warrantable Failure.

Cummins will pay for reasonable labor costs for Engine removal and reinstallation when necessary to repair a Warrantable Failure.

Cummins will pay reasonable costs for towing a vehicle disabled by a Warrantable Failure to the nearest

authorized repair location when necessary to make the repair for the first 2 years from the date of delivery of the Engine to the first user. In lieu of towing expenses, Cummins will pay reasonable costs for mechanics to travel to and from the location of the vehicle, including meals, mileage and lodging, when the repair is performed at the site of the failure.

### During The Extended Major Components Warranty

Cummins will pay for the repair or, at its option, replacement of the defective Covered Part and any Covered Part damaged by a Warrantable Failure of the defective Covered Part.

## Owner Responsibilities

### During The Base Engine Warranty

Owner is responsible for the cost of lubricating oil, antifreeze, filter elements and other maintenance items provided during Warranty repairs unless such items are not reusable due to the Warrantable Failure.

### During The Extended Major Components Warranty

Owner is responsible for the cost of all labor needed to repair the Engine, including the labor to remove and reinstall the Engine. When Cummins elects to repair a part instead of replacing it, Owner is not responsible for the labor needed to repair the part.

Owner is responsible for the cost of all parts required for the repair except for the defective Covered Part and any Covered Part damaged by a Warrantable Failure of the defective Covered Part.

Owner is responsible for the cost of lubricating oil, antifreeze, filter elements and other maintenance items replaced during the repair.

### During The Base Engine And Extended Major Components Warranties

Owner is responsible for the operation and maintenance of the Engine as specified in the applicable Cummins Operation and Maintenance Manual. Owner is also responsible for providing proof that all recommended maintenance has been performed.

Before the expiration of the applicable Warranty, Owner must notify a Cummins distributor, authorized dealer or other repair location approved by Cummins of any Warrantable Failure and make the Engine available for repair by such facility. Except for Engines disabled by a Warrantable Failure during the first two years from the date of delivery of the Engine to the first user, Owner must also deliver the Engine to the repair facility.

Service locations are listed on the Cummins Worldwide Service Locator at [cummins.com](http://cummins.com).

Owner is responsible for communication expenses, meals, lodging and similar costs incurred as a result of a Warrantable Failure.

Owner is responsible for non-Engine repairs and for "downtime" expenses, passenger delays, fines, all applicable taxes, all business costs and other losses resulting from a Warrantable Failure.

## Limitations

Engines with an emissions certification listed below must be operated using only diesel fuel having no more than the corresponding maximum sulfur content. Failure to use the specified fuel as listed in the Cummins Fuel Bulletin #3379001 Table 1 (Cummins Inc. Required Diesel Fuel Specifications) can damage the Engine and aftertreatment system within a short period of time. This damage could cause the Engine to become inoperable and failures attributable to the use of incorrect fuels will be denied Warranty Coverage. Fuel specifications also need to comply with local fuel regulations (EN590 for Europe and ASTM D975 for North America) for Warranty eligibility.

### Maximum sulfur levels by emissions certification level as listed on the Engine's dataplate are:

EPA 2007/2010/2013/2017/2021	max. 15 parts per million
EPA Tier 4 Interim / Final / Stage V in North America	max. 15 parts per million
EU Stage IIIB 2011	max. 15 parts per million
EU Stage IV 2011	max. 15 parts per million
EU Stage V	max. 10 parts per million
Euro 4/5	max. 50 parts per million
Euro 6	max. 10 parts per million

Cummins is not responsible for failures or damage resulting from what Cummins determines to be abuse or neglect, including, but not limited to: operation without adequate coolants or lubricants; overfueling; overspeeding; lack of maintenance of lubricating, cooling or intake systems; improper storage, starting, warm-up, run-in or shutdown practices; unauthorized modifications of the Engine.

Any unauthorized modifications to the aftertreatment system could negatively affect emissions certification and void the Warranty.

Cummins is also not responsible for failures caused by incorrect oil, fuel or diesel exhaust fluid or by water, dirt or other contaminants in the fuel, oil or diesel exhaust fluid.

Alternators and starters are covered for the first two years from the date of delivery of the Engine to the first user, or the expiration of the Base Engine Warranty, whichever occurs first.

Excessive oil consumption for ISV and B Series Engines is covered for the duration of the Coverage. Before a claim for excessive oil consumption will be considered, Owner must submit adequate documentation to show that consumption exceeds Cummins published standards.

Failures of belts and hoses supplied by Cummins are not covered beyond the first year from the date of delivery of the Engine to the first user or the expiration of the applicable Base Engine Warranty, whichever occurs first.

Parts used to repair a Warrantable Failure may be new Cummins parts, Cummins approved rebuilt parts or repaired parts. Cummins is not responsible for failures resulting from the use of parts not approved by Cummins.

A new Cummins or Cummins approved rebuilt part used to repair a Warrantable Failure assumes the identity of the part it replaced and is entitled to the remaining Coverage hereunder.

Cummins, Inc. reserves the right to interrogate Electronic Control Module (ECM) data for purposes of failure analysis.

### **CUMMINS DOES NOT COVER WEAR OR WEAROUT OF COVERED PARTS.**

### **CUMMINS IS NOT RESPONSIBLE FOR INCIDENTAL OR CONSEQUENTIAL DAMAGES.**

**THESE WARRANTIES AND THE EMISSION WARRANTY SET FORTH HEREINAFTER ARE THE SOLE WARRANTIES MADE BY CUMMINS IN REGARD TO THESE ENGINES. CUMMINS MAKES NO OTHER WARRANTIES, EXPRESS OR IMPLIED, OR OF MERCHANTABILITY OR FITNESS FOR A PARTICULAR PURPOSE.**

This Warranty gives you specific legal rights, and you may also have other rights which vary from state to state.

## Emission Warranty

### Products Warranted

This Emission Warranty applies to new Engines marketed by Cummins that are used in the United States\*\* or Canada in vehicles designed for transporting persons or property on a street or highway. This Warranty applies to Engines delivered to the ultimate purchaser on or after January 1, 1996.

### Coverage

Cummins warrants to the ultimate purchaser and each subsequent purchaser that the Engine is designed, built and equipped so as to conform at the time of sale by Cummins with all U.S. federal emission regulations applicable at the time of manufacture and that it is free from defects in material or factory workmanship which would cause it not to meet these regulations within the longer of the following periods: (A) Five years or 100,000 miles (160,934 kilometers) of operation, whichever occurs first, as measured from the date of delivery of the Engine to the ultimate purchaser, or (B) The Base Engine Warranty.

If the vehicle in which the Engine is installed is registered in the state of California, a separate California Emission Warranty also applies.



## Limitations

Engines with an emissions certification listed below must be operated using only diesel fuel having no more than the corresponding maximum sulfur content. Failure to use the specified fuel as listed in the Cummins Fuel Bulletin #3379001 Table 1 (Cummins Inc. Required Diesel Fuel Specifications) can damage the engine and aftertreatment system within a short period of time. This damage could cause the engine to become inoperable and failures attributable to the use of incorrect fuels will be denied Warranty Coverage. Fuel specifications also need to comply with local fuel regulations (EN590 for Europe and ASTM D975 for North America) for Warranty eligibility.

### Maximum sulfur levels by emissions certification level as listed on the Engine's dataplate are:

EPA 2007/2010/2013/2017/2021	max. 15 parts per million
EPA Tier 4 Interim / Final / Stage V in North America	max. 15 parts per million
EU Stage IIIB 2011	max. 15 parts per million
EU Stage IV 2011	max. 15 parts per million
EU Stage V	max. 10 parts per million
Euro 4/5	max. 50 parts per million
Euro 6	max. 10 parts per million

Failures, other than those resulting from defects in material or factory workmanship, are not covered by this Warranty.

Cummins is not responsible for failures or damage resulting from what Cummins determines to be abuse or neglect, including, but not limited to: operation without adequate coolants or lubricants; overfueling; overspeeding; lack of maintenance of lubricating, cooling or intake systems; improper storage, starting, warm-up, run-in or shutdown practices; unauthorized modifications of the Engine.

Any unauthorized modifications to the aftertreatment system could negatively affect emissions certification and void the Warranty.

Cummins is also not responsible for failures caused by incorrect oil, fuel or diesel exhaust fluid or by water, dirt or other contaminants in the fuel, oil or diesel exhaust fluid.

Cummins is not responsible for non-Engine repairs, "downtime" expenses, cargo damage, fines, all applicable taxes, all business costs or other losses resulting from a Warrantable Failure.

### CUMMINS IS NOT RESPONSIBLE FOR INCIDENTAL OR CONSEQUENTIAL DAMAGES.

\* A vehicle used to transport students to and from school. Vehicle must be painted yellow, should have warning lights and the words 'SCHOOL BUS' written on the front

and rear roof caps. The requirements pertaining to paint color, warning lights and 'SCHOOL BUS' inscription would not apply if the vehicle is exclusively used to transport students for school related activities and it is owned by a school district.

\*\* United States includes American Samoa, the Commonwealth of Northern Mariana Islands, Guam, Puerto Rico and the U.S. Virgin Islands.



Cummins Inc.  
Box 3005  
Columbus, IN 47202-3005  
U.S.A.

Bulletin No. 3381329  
Printed in U.S.A. Rev 3/20  
©1999 Cummins Inc.



# B6.7™

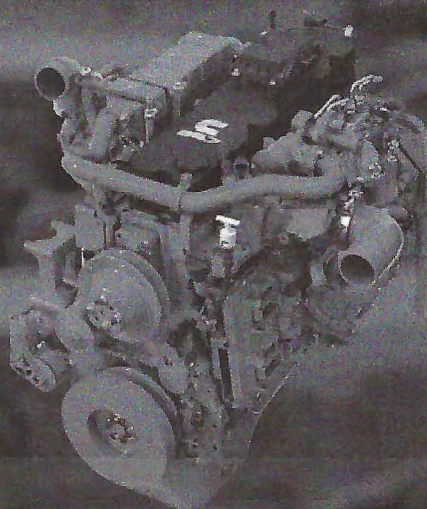

## PROVEN TRACK RECORD

The Cummins B6.7™ is one of the most dependable, durable and reliable medium-duty engines available. It's been tested and proven with more than 12 million engines produced over nearly 40 years, with billions of miles driven. These figures aren't just milestones either. They represent years of experience learning and optimizing the product into what we produce today – the most reliable B6.7 Cummins has ever built. We're proud of this history and proud that Cummins medium-duty products power more school buses in operation across North America than any other engines.

## REDUCED OPERATING COSTS

We know total cost of operation (TCO) is important to our customers, which is why we focused on making enhancements to reliability and durability while also lowering the TCO. New for EPA 2021, the B6.7 features upgrades that allow for extended engine maintenance intervals, including longer oil drain intervals, more time between fuel filter changes and a completely maintenance-free crankcase ventilation filter. Also new for 2021, the B6.7 offers advancements in connectivity to find, prevent and resolve issues faster.

## WE HAVE YOUR BACK

The B6.7 comes with a 5-year / 100,000-mile base warranty. For added peace of mind, we offer multiple extended coverage plan options up to 10 years, designed to provide you with the coverage you need for your operation. All Cummins products are backed by the largest, most capable support network in North America. With over 3,700 certified repair locations across the U.S. and Canada, your school buses are never far from a Cummins-certified technician.

SCHOOL

EMERGENCY



## B6.7 MAINTENANCE INTERVALS

Maintenance Item	Miles/ Kilometers	Hours	Months
*Oil and Filter	30,000 mi/48,000 km	1,000	18
Fuel Filter	60,000 mi/96,000 km	2,000	18
Overhead Adjustment	150,000 mi/240,000 km	5,000	48
Coolant Check	15,000 mi 24,000 km	500	6
DEF Filter	200,000 mi 320,000 km	6,500	N/A
Particulate Filter Cleaning	200,000 mi 320,000 km	6,500	N/A
Crankcase Ventilation Filter	N/A	N/A	N/A

\* With a 19-quart oil pan. Duty-cycle dependent.

Consult your Operation and Maintenance Manual for more information.

## B6.7 SCHOOL BUS RATINGS

Engine Model	Advertised HP (kW)	Peak Torque LB-FT (N•m) @ RPM	Governed Speed
B6.7 260	260 (194)	660 (896) @ 1600	2600
B6.7 250	250 (187)	660 (896) @ 1600	2600
B6.7 240	240 (179)	560 (760) @ 1600	2600
B6.7 220	220 (164)	600 (814) @ 1600	2600
B6.7 220	220 (164)	520 (206) @ 1600	2600
B6.7 200	200 (149)	520 (206) @ 1600	2600

# OVER THE AIR PROGRAMMING CAPABILITY.

When connected to a compatible and participating telematics system, Cummins Connected Software Updates facilitate engine control module calibrations remotely in about five minutes, which slashes downtime by eliminating a traditionally scheduled visit to the service bay. Once Cummins Connected Software Updates have been integrated, customers can leverage the same technology to take advantage of Cummins full upcoming suite of over-the-air programming solutions designed to enhance performance, safety and fuel efficiency.

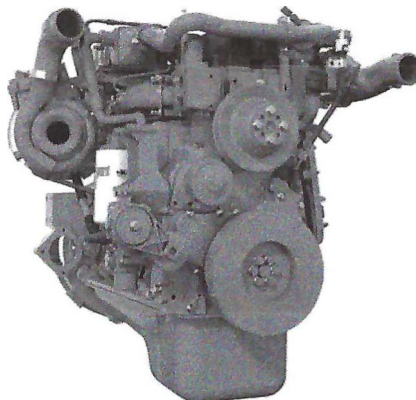
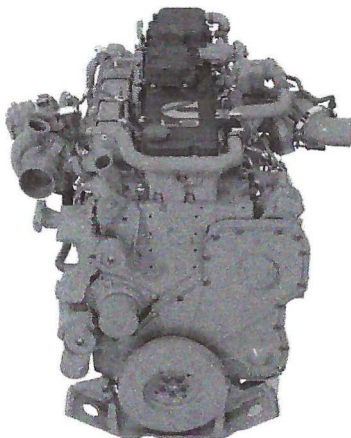

Cummins Inc.  
Box 3005  
Columbus, IN 47202-3005  
U.S.A.

1-800-CUMMINS™ (1-800-286-6467)  
cummins.com

Bulletin 5544101 Printed in U.S.A. Rev. 9/20  
©2020 Cummins Inc.