

HI\PROJECTS\128311748\MARIGOLD PHASES 3 & 4\CADD\SHEETS\PHASE 111748-C-WTR-C.DWG DATE: 10/20/24 2:09:45 PM BY: ELLUSDY

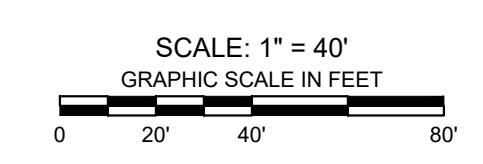
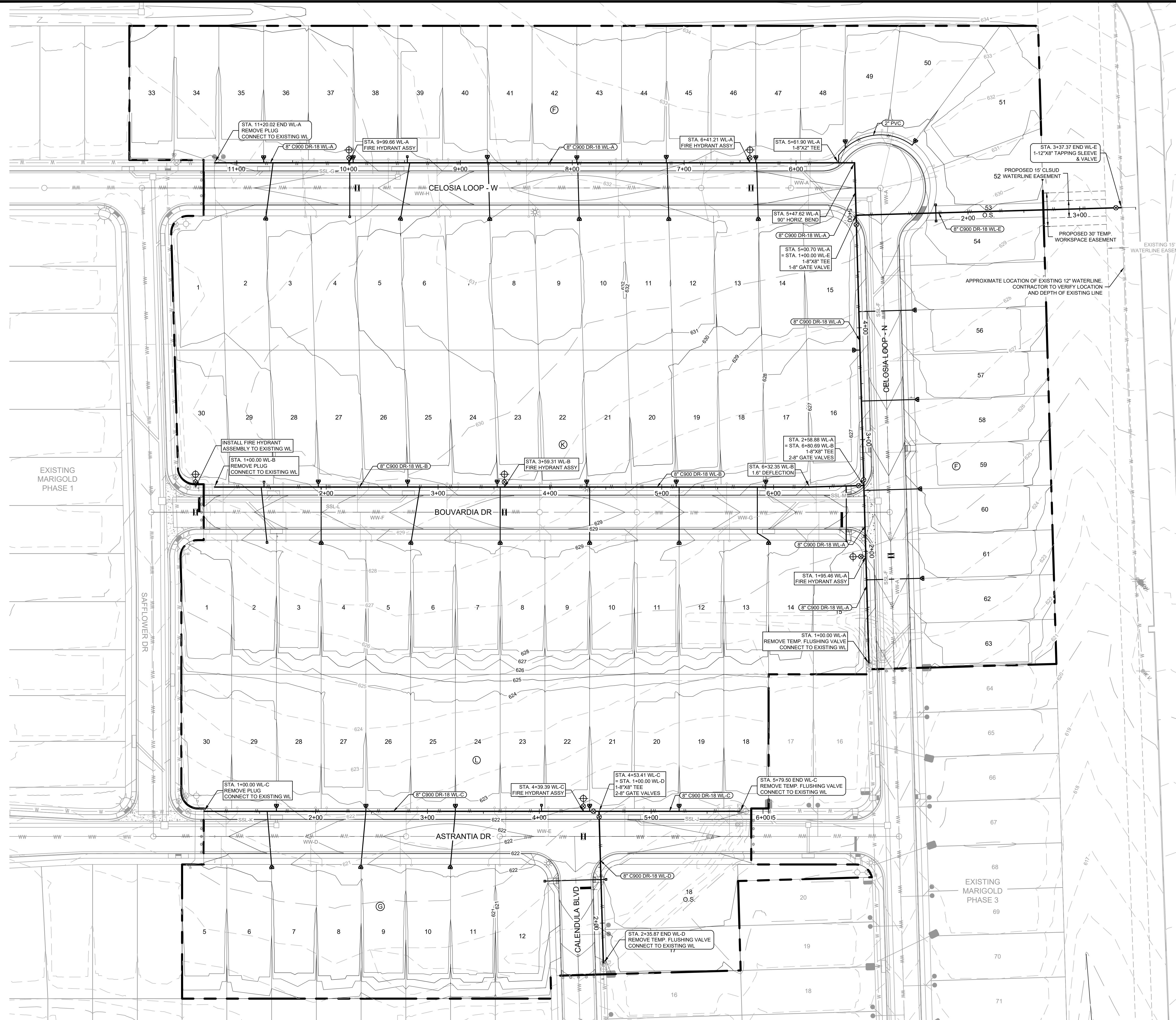

**LEGEND**

	PROPERTY BOUNDARY
	PROPOSED RIGHT OF WAY
	EXISTING MAJOR CONTOUR
	EXISTING MINOR CONTOUR
	PROPOSED WATER LINE
	EXISTING WATER LINE
	FIRE HYDRANT ASSEMBLY (SEE NOTE BELOW)
	GATE VALVE
	PLUG
	DOUBLE WATER SERVICE
	SINGLE WATER SERVICE
	DOUBLE WASTEWATER SERVICE
	SINGLE WASTEWATER SERVICE

\* ALL WATER SYMBOLS ARE NOT TO SCALE AND ARE ONLY SHOWN FOR ILLUSTRATION PURPOSES.  
 \*\* DUCTILE IRON PIPE CROSSING BENEATH PROPOSED STORM PIPE SHALL BE FULLY RESTRAINED.

8834 N. Capital of Texas Hwy.  
 Suite 140  
 Austin, Texas 78759  
 (512) 452-0371  
 FAX (512) 454-9933  
 TBPELS FRM #2946

**GRAY ENGINEERING**

NO.	BY	DATE	REVISION DESCRIPTION

**MARIGOLD PHASE 4**

**OVERALL WATER PLAN**

PROJECT NO: 1283-11748  
 DESIGNED BY: EU  
 DRAWN BY: JM  
 CHECKED BY: EU

NOTICE:  
 ALTERATION OF A SEALED DRAWING WITHOUT PROPER NOTIFICATION TO THE RESPONSIBLE ENGINEER IS A VIOLATION OF THE TEXAS ENGINEERING PRACTICE ACT.

