

Parking Summary

	Existing	Proposed
West Lot	66reg + 2acc = 68	66reg + 3acc = 69
Parent Lot	11reg + 2acc = 13	16reg + 1acc = 17
Total	72reg + 4acc = 81	82reg + 4acc = 86



Scale: 1"=40'

**ERIKSSON
ENGINEERING
ASSOCIATES, LTD.**
145 COMMERCE DRIVE, SUITE A
GRAYSLAKE, ILLINOIS 60030
PHONE: (847) 223-4804
FAX: (847) 223-4864
EMAIL: INFO@EEA-LTD.COM
PROFESSIONAL DESIGN FIRM
LICENSE NO. 184-003220
EXPIRES: 04/30/2021

WESTVIEW ELEMENTARY SCHOOL
2000 N ADDISON ROAD
WOOD DALE, ILLINOIS

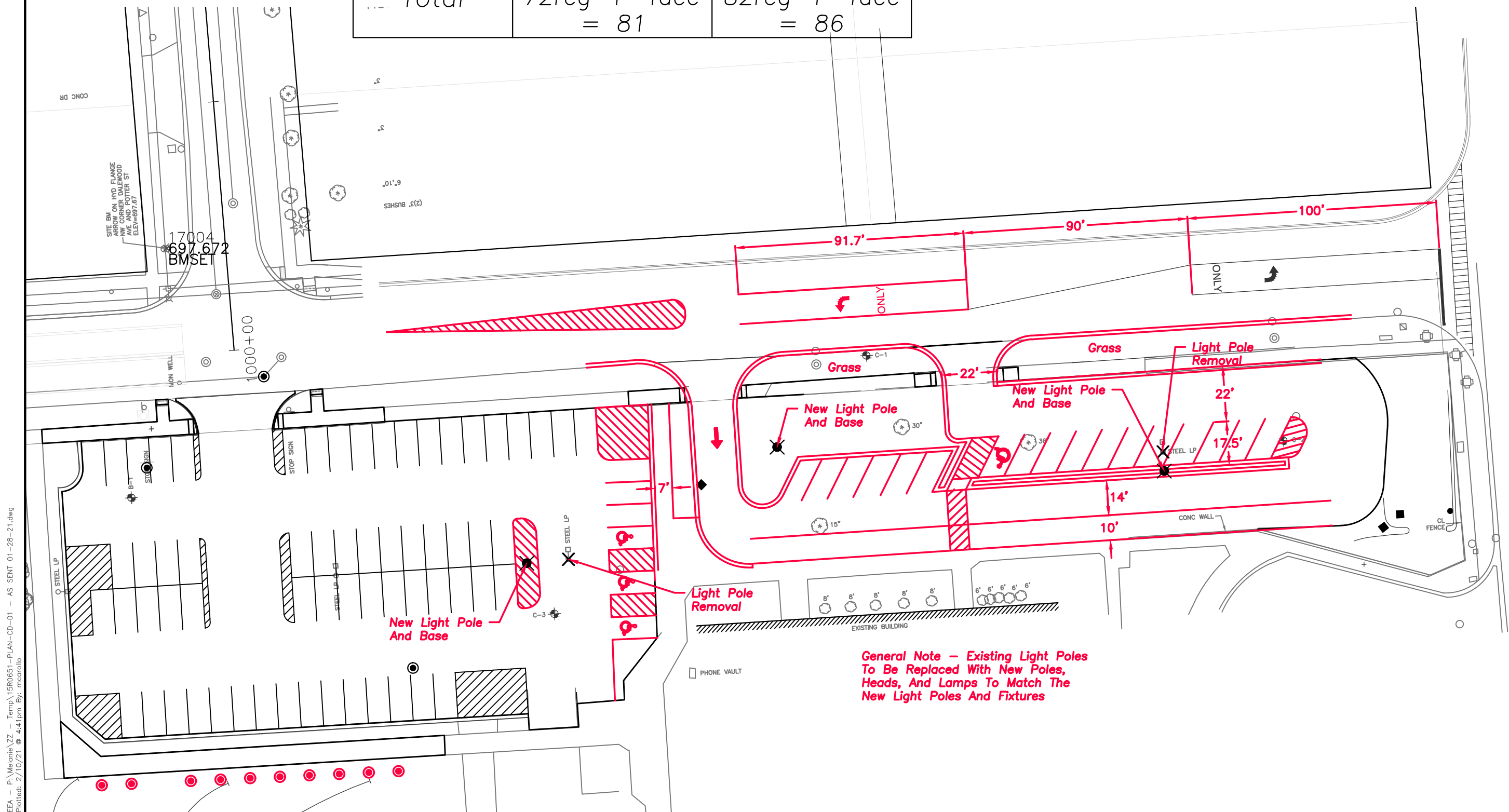

General Note – Existing Light Poles To Be Replaced With New Poles, Heads, And Lamps To Match The New Light Poles And Fixtures

EEA - P:\Melorie\Z7 - Temp\1560651-PLAN-CD-01 - AS SENT 01-28-21.dwg
Plotter: 2/10/21 @ 4:41pm By: micrallo

Design By: MC Checked By: SC Date: 02/10/21

Sheet Title:

**SCHEMATIC
PLAN**

Sheet No:

CX-1