



6/1

3760 W. Ludington Dr
 Farwell, MI 48622
 Phone: 800-248-0270
 Fax: 888-549-9659
 www.rogersathletic.com

Quote for Livonia Public Schools
 Quote: 7708
 Revision: 8
 Offer Valid Through: 6/30/23
 Proposed by: Karl Jenkins
 Phone: (800) 248-0270
 Email: kjenkins@rogersathletic.com

Quote Reference Number: 7708

Address Information

Bill To:

Livonia Public Schools
 15125 Farmington Rd
 Livonia, Michigan 48154
 United States

Franklin High School

Ship To:

Livonia Public Schools
 15125 Farmington Rd
 Livonia, Michigan 48154
 United States

Contact Buying:

Phone:
 Email:

Contact Ship:

Phone:
 Email:



Terms and Conditions

Payment Terms: Net 30 Days

Livonia Public Schools - weight equipment-WR 2023

Products

Description	Part Number	Qty	Price	Ext Price
Dual XL, Base Color: Navy, Accent Color: Navy, Front Cross Bar: Basic Arch	410980	8	\$3,480.00 USD	\$27,840.00 USD
Pendulum Power Lock-N-Load Hooks (Pair) Attachment	410855	16	\$0.00 USD	\$0.00 USD
Pendulum Front Safety Bar (Pair) Attachment	410830	16	\$0.00 USD	\$0.00 USD
Docking FTS Synchro Bench, Base Color: Navy, Seat: Narrow Black	410984	16	\$1,410.00 USD	\$22,560.00 USD
Pro Glute Ham, Base Color: Navy, Accent Color: Navy, FootRest: Fixed, Thi	410836	5	\$2,534.00 USD	\$12,670.00 USD
Pro 3-Way Row, Base Color: Navy, Accent Color: Red, Seat: Molded, Weight Ho	410613	4	\$3,300.00 USD	\$13,200.00 USD
Dumbbell Rack 89", Base Color: Navy, Top Tier: Dumbbell Coated Shelf, Middl	410846	2	\$1,190.00 USD	\$2,380.00 USD
Dumbbell Rack 55" 2 Tier, Base Color: Navy, Top Tier: Dumbbell Coated Shelf, Bottom Tier: Dumbbell Coated Shelf	410976	1	\$715.00 USD	\$715.00 USD
Intek 7' Triple Needle Bearing Olympic Bar - Hard Chrome	purch	16	\$100.00 USD	\$1,600.00 USD
Bridge 82" Single w/ Ball Grip , Base Color: Red	411543	12	\$455.00 USD	\$5,460.00 USD
1 Set Avus LJC-Pro Lock Jaw Collar	409167	25	\$44.00 USD	\$1,100.00 USD
Intek-1 Single 45lb Black Urethane Olympic Bumper plate	purch	96	\$199.00 USD	\$19,104.00 USD

Intek-1 Single 25lb Black Urethane Olympic Bumper plate	purch	48	\$126.00 USD	\$6,048.00 USD
Intek-1 Single 10lb Black Urethane Olympic Bumper plate	purch	40	\$73.00 USD	\$2,920.00 USD
Intek- 5lb Urethane Encased Olympic Plate (Single)	purch	42	\$8.00 USD	\$336.00 USD
Intek- 2.5lb Urethane Encased Olympic Plate (Single)	purch	32	\$9.50 USD	\$304.00 USD
Intek-Armor Series Solid Urethane DB Set 5-50x5	purch	2	\$3,200.00 USD	\$6,400.00 USD
Intek-Armor Series Solid Urethane DB Set 55-100x5	purch	2	\$5,480.00 USD	\$10,960.00 USD
Intek-Custom Urethane In-Lay Bumper Plate Logo (per logo)	purch	292	\$17.00 USD	\$4,964.00 USD
Intek-Custom Urethane In-Lay Dumbbell Logo (per logo)	purch	120	\$14.00 USD	\$1,680.00 USD
Pro Lat Pull Machine, Base Color: Navy, Accent Color: Red, Seat: Molded, We	410604	4	\$4,100.00 USD	\$16,400.00 USD
Weight Tree, Base Color: Navy, Storage Horn. None	410857	1	\$539.00 USD	\$539.00 USD
Super bridge that goes side to side to connect Rack over isle with logo	-Custom	1	\$2,900.00 USD	\$2,900.00 USD
Powersystems Light Strength Band	purch	32	\$15.00 USD	\$480.00 USD
Powersystems Medium Strength Band	purch	32	\$20.00 USD	\$640.00 USD
Powersystems Heavy Strength Band	purch	32	\$25.00 USD	\$800.00 USD
Soft Plyo Boxes navy 18"	purch	16	\$390.00 USD	\$6,240.00 USD
Soft Plyo Boxes navy 24"	purch	16	\$470.00 USD	\$7,520.00 USD
Embroidered Log head wraps for benches	purch	22	\$90.00 USD	\$1,980.00 USD
Above rack logo plate	-Custom	16	\$190.00 USD	\$3,040.00 USD
Troy Dual Grip Hex Bar	purch	8	\$185.00 USD	\$1,480.00 USD
Pendulum Front Band Attachment (Pair) Attachment	410643	16	\$279.00 USD	\$4,464.00 USD
Power Stack Hi-Low, Base Color: Navy, Accent Color: Navy	410833	4	\$3,679.00 USD	\$14,716.00 USD

Services

Description	Qty	Price	Ext Price
Installation Services	1	\$5,200.00 USD	\$5,200.00 USD

Additional Charges/Credits

Description	Qty	Price	Ext Price
Shipping & Freight	1	\$3,700.00 USD	\$3,700.00 USD

Alternates

Description	Part Number	Qty	Price	Ext Price
-------------	-------------	-----	-------	-----------

Products Total:	\$201,440.00 USD
Services Total:	\$5,200.00 USD
Additional Charges/Credits Total:	\$3,700 00 USD
Alternates Total:	\$0.00 USD
*Net Total:	\$210,340.00 USD

Quote Comments

Specific Terms

Assembly required on Sleds/Chutes

Quoted price does not include any State and/or Local Taxes unless specified in the quotation

*Quoted Net Total does not include Alternate items, Ask for a quote revision after approving or rejecting Alternates to see an updated Net Total

Lead time is estimated and varies based on manufacturing capacity Actual ship date will be determined at placement of order. Shipping rates are subject to change Freight Terms: FOB Clare – MI

Rogers Athletic collects tax in the following states AL CA CO FL GA IL IN MI NJ PA TX WA

These can be forwarded to the following email address: taxexemptions@rogersgrp.com

All Labor and costs associated with docking, unloading, transferring or set up of the equipment and removal of debris are not included unless specified in the quotation

Configured parts or part numbers ending in '-Custom' will have a production suffix added to the part number upon sales order creation and may appear different on invoices

Visa – Mastercard – American and Discover Accepted

Order Authorization

Date

All rights reserved. Copyright Rogers Group, Inc

6/6/23

CONCEPT

#23-FHS-S2



COMMERCIAL GENERAL CONTRACTORS

36959 AMRHEIN RD.

LIVONIA, MI 48150

MAIN: 734.838.5900

WWW.MATICKCONSTRUCTION.COM

PREPARED FOR:

DUSTY HALL

FRANKLIN HIGH SCHOOL

31000 JOY RD.

LIVONIA, MI 48150

**EXISTING WEIGHT ROOM REFRESH. CONCEPTUAL PRICING ONLY.
ACTUAL PRICING WILL BE PREPARED ONCE FINAL SCOPE
IS DEFINED AND ALL SPECIFICATIONS ARE SELECTED**

PRICING AND SCOPE BASED ON FRANKLIN H.S. LOCATION

DESCRIPTION OF WORK:	QTY	UNIT	UNIT PRICE	BUDGET COST	SUBTOTAL
DEMOLITION:					
Waste for masonry spoils	1	EA	\$550.00	\$550.00	
Subtotal				\$550.00	\$550.00
ELECTRICAL:					
Emergency light/Exit combo	2	EA	\$325.00	\$650.00	
3-way switch	2	EA	\$90.00	\$180.00	
BigAss Fan (Black) - 72" - 84" VERIFY	2	EA	\$3,200.00	\$6,400.00	
Mount fans	2	EA	\$750.00	\$1,500.00	
Fan power - Dedicated	2	EA	\$750.00	\$1,500.00	
Water cooler power - (PIPED)	1	EA	\$350.00	\$350.00	
New LED Tv's - Allowance - Samsung 75" - METHOD/PLACEMENT TBD	4	EA	\$1,200.00	\$4,800.00	
Tv's Mounted/directional	4	EA	\$240.00	\$960.00	
Subtotal				\$16,340.00	\$16,340.00
AUDIO/LOW VOLTAGE:					
Octasound ceiling mount speakers	2	EA	\$1,490.00	\$2,980.00	
Low voltage wiring	4	EA	\$350.00	\$1,400.00	
Mounting provisions - Uni-strut/Threaded rod to deck	2	EA	\$450.00	\$900.00	
Audio system - WIFI/Bluetooth - Allowance	1	EA	\$2,000.00	\$2,000.00	
Digital (Large) GYM clock w/power - ALLOWANCE	1	EA	\$550.00	\$550.00	
Subtotal				\$7,830.00	\$7,830.00
MIRRORS:					
Mirror removal - TBD	1	ALL	\$0.00	\$0.00	
Subtotal				\$0.00	\$0.00

END PAGE ONE

SPEC (Rogers Flooring) ATHLETIC

2951 Marina Bay Dr. Suite 130, #491 League City, TX 77573
O: 815-254-4414 | F: 815-254-4761
www.specathletic.com

Date: April 26, 2023

Project:	Livonia Franklin HS		
To:	Delivery:	Email:	
Addendums:	Date of Plans:		

Quantity	Units	Scope of Work	Unit Price	Total Price
SECTION 09 65 66 - Resilient Athletic Flooring				
3,665	SF	Prep Existing Rubber Floor	\$ 0.50	\$ 1,832.50
3,665	SF	Supply & Install Regupol Aktiv Plus 12mm in 35%	\$ 10.45	\$ 38,299.25
16	EA	Inlaid Platforms with Avalanche Gray and a logo in the center	\$ 1,100.00	\$ 17,600.00
1	EA	Parrot Head Logo 6' x 6'	\$ 2,945.00	\$ 2,945.00
250	LF	Standard Black 4" Cove Base	\$ 3.00	\$ 750.00
6	LF	Transitions	\$ 7.00	\$ 42.00
				\$ -
Tax:				
Total:				\$ 61,468.75

Estimating:	Henry Proud	henry@specathletic.com	Signature of Acceptance:
Sales:	Kevin Cassidy	kevin@specathletic.com Cell: (614)-736-1533	Date:

Comments: Includes standard wage rates; non-prevailing, non-union. Owner Must Provide a 60-Amp Braker with 3 Phase Power Within 75' Of Gym/Workspace.

Standard Exclusions: Moisture remediation. Demo. Dumpsters. Bleachers. Volleyball Sleeves. Generators. Final clean up. Protection of work after installation. Major prep & leveling or smoothing of substrate other than light sanding & sweeping. We assume installation over clean, dry, & level substrate.

Excludes patching & leveling. Extra costs for patching & leveling:

- Patching & skim coating - \$50 per bag of Feather Finish.
- Leveling - \$110 per bag of self-leveling underlayment.

Terms: 75% due upon receiving a signed PO or quote, 25% due upon convenience fee at the time of invoicing. All accounts with a balance. Material pricing is subject to manufacturer increases & or material stock of invoicing if tax exempt form is not received.

Due to the current volatility in both supply chains & international freight charges will need to be confirmed at time of shipping.

FHS

Recommend

...ssed a 3%
...very 30 days.
...be added at the time
...d for 30 days.

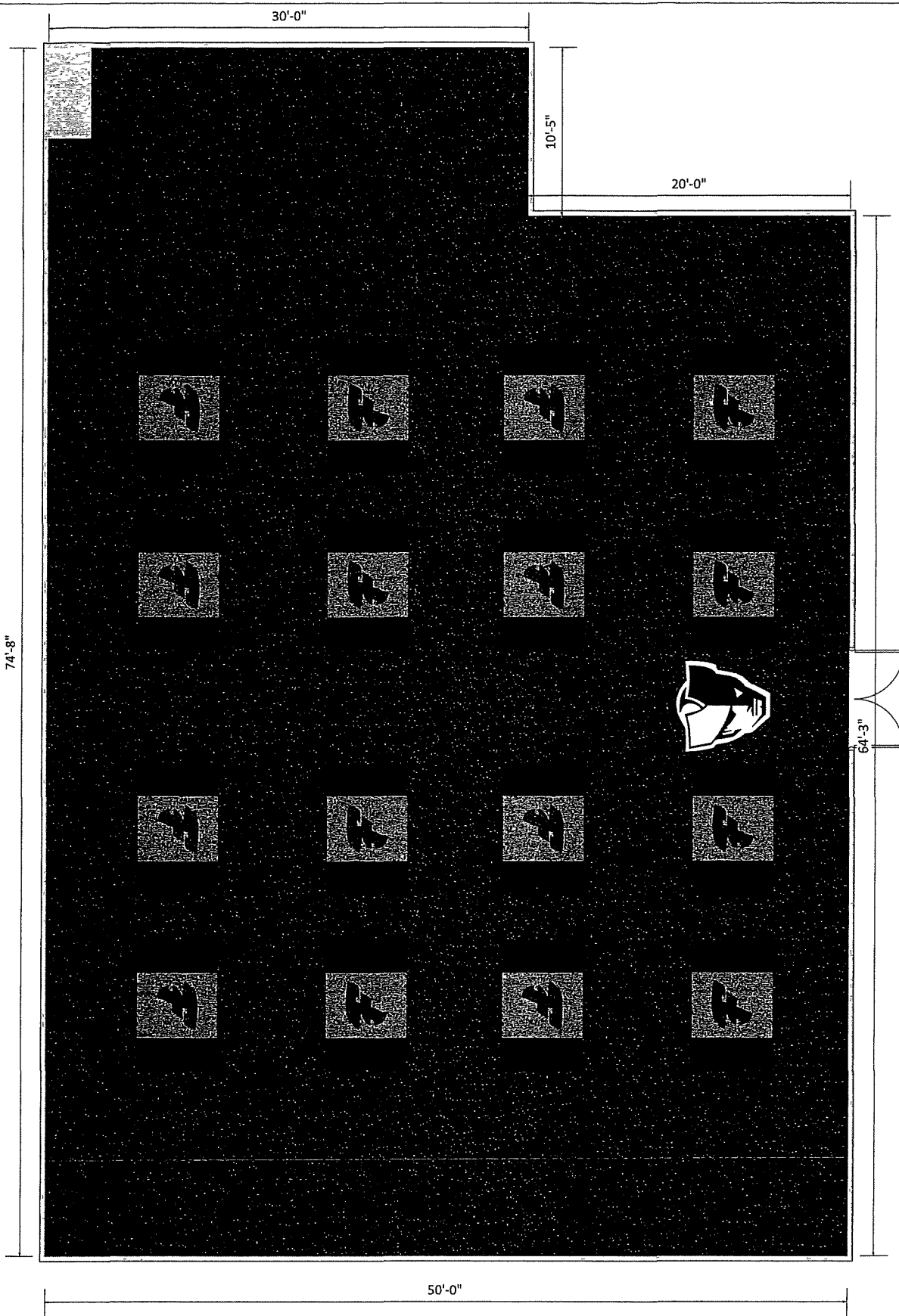

Spec Athletic Flooring
 23824 W Andrew Rd Ste 101
 Plainfield, IL 60585
 815-254-4414

Livonia Franklin High School

4/24/23

Version 1.1

**NOTE: Colors may vary slightly due to screen resolution, please see physical samples for accurate color representation

**BSNSPORTS**PO Box 841393
Dallas, TX 75284-1393
Phone 800-527-7510 Fax 800-899-0149
Visit us at www.bsnsports.com

5/4

QuoteCart #: 9997627
Purchase Order # Weight Room 2
Cart Name: Franklin HS Weight Room 3
Quote Date: 04/27/2023
Quote Valid-to: 05/21/2023
Payment Terms: NT30
Ship Via:
Ordered By: x

Contact Your Rep

Joe Pesci Email jpesci@bsnsports.com | Phone 734-730-7872

Sold to
1442510
FRANKLIN HIGH SCHOOL
3100 JOY RD
LIVONIA MI 48150-3916
USAShip To
1442510
FRANKLIN HIGH SCHOOL
3100 JOY RD
LIVONIA MI 48150-3916
USAPayer
1442510
FRANKLIN HIGH SCHOOL
3100 JOY RD
LIVONIA MI 48150-3916
USA

Item Description	Qty	Unit Price	Total
WF - Varsity Double Rack Item # - 1378745	8 EA	\$ 4,319 00	\$ 34,552 00
WF - Flat-To-90 Bench w/Transport Wheels Item # - 1378759	16 EA	\$ 699 00	\$ 11,184 00
WF - 6' Bridge with Grip Balls Item # - 1390943	8 EA	\$ 448 00	\$ 3,584 00
WF - Glute Ham Machine Item # - 1378778	5 EA	\$ 799 00	\$ 3,995 00
Lock-Jaw PRO 2 Barbell Collar - Black Item # - 1395572	25 PR	\$ 39 00	\$ 975 00
Rubber Dumbbell Set (5-50 lb.) Item # - 1390920	2 SET	\$ 1,049 00	\$ 2,098 00
Rubber Dumbbell Set (55-100 lb.) Item # - 1390922	2 SET	\$ 2,799 00	\$ 5,598 00
WF - 10' - 3 Tier Dumbbell Rack Item # - 1378810	4 EA	\$ 879 00	\$ 3,516 00
V 45lb Bumper Custom Graphics Item # - NSPHG	72 EA	\$ 86 40	\$ 6,220 80
Wright 25lb Bumper Custom Graphics Item # - NSPHG	36 EA	\$ 57 97	\$ 2,086 92
WF - Stack Lat Pulldown/Low Row (SEL) Item # - 1378833	4 EA	\$ 3,645 00	\$ 14,580 00
3 in 1 Plyo Cube Item # - 1455257	16 EA	\$ 405 00	\$ 6,480 00
Light Reactor Strength Band Item # - 1455156	16 EA	\$ 18 89	\$ 302 24
Medium Reactor Strength Band Item # - 1455157	16 EA	\$ 23 00	\$ 368 00
Heavy Reactor Strength Band Item # - 1455158	16 EA	\$ 29 00	\$ 464 00
Ultra Heavy Reactor Strength Band Item # - 1455159	16 EA	\$ 47 00	\$ 752 00
Super Heavy Reactor Strength Band Item # - 1457082	16 EA	\$ 62 00	\$ 992 00
Rubber Flooring/Platforms Installed Item # - NSPHG	1 EA	\$ 67,003 71	\$ 67,003 71
3 Way Row Machine Item # - NSPHG	4 EA	\$ 1,250 00	\$ 5,000 00
OLYMPIC BAR 1500 LB BLACK OXIDE Item # - 1101248	8 EA	\$ 297 49	\$ 2,379 92
Trap/Hip Hex Bar Item # - 1455250	16 EA	\$ 279 99	\$ 4,479 84
WF - Land-Mine Item # - 1378757	16 EA	\$ 239 99	\$ 3,839 84
WF - One Leg Squat Attachment Item # - 1378756	16 EA	\$ 280 49	\$ 4,487 84
Custom Logo'd Bridge Item # - NSPHG	1 EA	\$ 4,675 00	\$ 4,675 00

Subtotal

\$189,614 11



BSN SPORTS

PO Box 841393
Dallas, TX 75284-1393
Phone 800-527-7510 Fax 800-899-0149
Visit us at www.bsnsports.com

Quote

Cart #: 9997627
Purchase Order #: Weight Room 2
Cart Name: Franklin HS Weight Room 3
Quote Date: 04/27/2023
Quote Valid-to: 05/21/2023
Payment Terms: NT30
Ship Via:
Ordered By: x

Item Description	Qty	Unit Price	Total
Other			\$0 00
Freight			\$6,051 95
Sales Tax			\$0 00
Order Total			\$195,666.06
Payment/Credit Applied			\$0.00
Order Total:			\$195,666.06

EZ Strength



Livonia Franklin
31000 Joy Road
Livonia, MI 48150

April 21, 2023

EZ STRENGTH LLC

2312 Draper Ave., Ypsilanti, MI 48197

ConnorJRice17@gmail.com

248-797-4700

Equipment, Gear & Accessories	Quantity	Code
Ultra Pro G2 8' Base Double Half Rack	8	700155
Rack Bridge Connector Chin Up Bar (95")	8	XM95-0006-LOGO
Adjustable Bench with slipcover	22	418060SU
Ultra Pro Cable Stack Lat/Low Row Combo 8'	4	712001
Olympic Bar	18	608000
Vertical Tree Rack	2	509084
Competition Bumper Plate Black 17 7" - 25lb w/ Logo Black (Pair)	18	PL-BP-25B-COMP-LOGO
Competition Bumper Plate Black 17 7" - 45lb w/ Logo Black (Pair)	36	PL-BP-45B-COMP-LOGO
International Hex Bar, Dual Grip, Chrome Finish	8	AOT-56
Troy 12-Sided Urethane Dumbbells (5-50lb set)	2	TSD-005-050U
Troy 12-Sided Urethane Dumbbells (55-100lb set)	2	TSD-055-100U
Troy Dumbbell Rack (3 Tier 15 pair)	4	DR-15
UCS Glute Ham Machine	5	A-630613
G2 Plyo Boxes with Custom Logo (12", 18", 24")	5	A-540281
3 Way Plate Loaded Row	4	IL-ROW
Green Bands	20	GREQ2
Tubing Set (Y, G, R, Bl, Blk)	20	RESY, G, R, Bu, Bk
Lock Jaw Elite Weight Clips (Pair)	25	
Equipment Totals		
SALES TAX (6% of Assets)		
SHIPPING	1	
INSTALLATION & PARTS	1	
TOTAL CAPITAL ASSETS	1	

Retail	Retail Total	Wholesale	Wholesale Total
\$6,044.00	\$48,352.00	\$4,875.00	\$39,000.00
\$606.00	\$4,848.00	\$450.00	\$3,600.00
\$1,348.00	\$29,656.00	\$830.00	\$18,260.00
\$2,593.00	\$10,372.00	\$2,100.00	\$8,400.00
\$502.00	\$9,036.00	\$400.00	\$7,200.00
\$462.00	\$924.00	\$420.00	\$840.00
\$271.00	\$4,878.00	\$200.00	\$3,600.00
\$406.00	\$14,616.00	\$288.00	\$10,368.00
\$287.40	\$2,299.20	\$206.99	\$1,655.92
\$4,727.26	\$9,454.52	\$3,142.78	\$6,285.56
\$9,416.40	\$18,832.80	\$6,260.23	\$12,520.46
\$1,242.10	\$4,968.40	\$894.60	\$3,578.40
\$4,761.00	\$23,805.00	\$4,550.00	\$22,750.00
\$1,984.00	\$9,920.00	\$1,900.00	\$9,500.00
\$3,089.00	\$12,356.00	\$2,800.00	\$11,200.00
\$25.95	\$519.00	\$20.00	\$400.00
\$60.00	\$1,200.00	\$40.00	\$800.00
\$50.00	\$1,250.00	\$40.00	\$1,000.00
	\$207,286.92		\$160,958.34
\$20,000.00	\$20,000.00	\$17,000.00	\$17,000.00
\$5,000.00	\$5,000.00	\$3,000.00	\$3,000.00
	\$232,286.92		\$180,958.34

Equipment, Gear & Accessories	Quantity	Code
Keiser Performance Trainer	2	003010BP
Keiser Mounting Kit to Wall	2	300818B
Keiser Small Compressor 115V 60H-BLK	1	001021B
Keiser Air System Installation Parts:		
Feet of 3/8" tubing	100	953101
Union 1/2C x 3/8C	1	008026
Union Tee 3/8C	2	008101
Union Elbow 3/8	2	008250
Single Outlet 3/8	2	100894
Plastic Plug 3/8	2	105053
Ultra Pro Landmine	12	709007
Ultra Pro Receptacle (Landmine & Pegs)	12	709250
Ultra Pro Split Squat Roller	12	709041
Ultra Pro Dip Attachment	12	709088
Ultra Pro Plyo Step	12	709092
Ultra Pro Storage Post (for storing Above)	10	709104
Bumper Storage Rack	8	509085
Medicine Ball 6#	10	600000
Medicine Ball 8#	10	600001
Medicine Ball 10#	10	600002
Medicine Ball 12#	10	600003
Medicine Ball 14#	10	600004
Medicine Ball 16#	10	600005
Bumper Plate - 17 7"-10LB w/ Logo Economy Black (Pair)	24	PL-BP-10B-OS-LOGO
Kettle Bell Cast Iron 5#	2	KB-005G2
Kettle Bell Cast Iron 10#	2	KB-010G2
Kettle Bell Cast Iron 20#	2	KB-020G2
Kettle Bell Cast Iron 30#	2	KB-030G2
Kettle Bell Cast Iron 40#	2	KB-040G2
Troy 12-Sided Rubber Dumbbells (5-50lb set)	2	TSD-005-050R
Troy 12-Sided Rubber Dumbbells (55-100lb set)	2	TSD-055-100R
Troy 12-Sided Rubber Dumbbells (8lb)	2	TSD-008R
Troy 12-Sided Rubber Dumbbells (12lb)	2	TSD-012R
Trak X Flooring System	12	TX2TX48
Trak X Installation Kit	12	TXIK1F
PerformX Belts	24	MS1BT
Light Jump Band Sets	10	PX2JX3
Medium Jump Band Sets	8	PX3JX4
Heavy Jump Band Sets	8	PX3JX5
Single Leg Squat Roller	4	401479
Floor Glute & Hamstring Developer	4	400939
Prone Leg Curl	2	
Dual Cable Cross	0	G624
Side Winder	8	SDWND

Retail	Retail Total	Wholesale	Wholesale Total
\$3,940.00	\$7,880.00	\$3,546.00	\$7,092.00
\$218.00	\$436.00	\$196.20	\$392.40
\$1,700.00	\$1,700.00	\$1,700.00	\$1,700.00
\$0.54	\$54.00	\$0.54	\$54.00
\$10.59	\$10.59	\$10.59	\$10.59
\$8.18	\$16.36	\$8.18	\$16.36
\$6.18	\$12.36	\$6.18	\$12.36
\$25.53	\$51.06	\$25.53	\$51.06
\$1.04	\$2.08	\$1.04	\$2.08
\$96.00	\$1,152.00	\$72.00	\$864.00
\$75.00	\$900.00	\$72.00	\$864.00
\$282.00	\$3,384.00	\$230.00	\$2,760.00
\$306.00	\$3,672.00	\$250.00	\$3,000.00
\$327.00	\$3,924.00	\$265.00	\$3,180.00
\$845.00	\$8,450.00	\$685.00	\$6,850.00
\$364.00	\$2,912.00	\$350.00	\$2,800.00
\$33.00	\$330.00	\$24.00	\$240.00
\$40.00	\$400.00	\$24.00	\$240.00
\$45.00	\$450.00	\$27.00	\$270.00
\$50.00	\$500.00	\$32.00	\$320.00
\$55.00	\$550.00	\$36.00	\$360.00
\$60.00	\$600.00	\$40.00	\$400.00
\$240.00	\$5,760.00	\$174.00	\$4,176.00
\$11.96	\$23.92	\$8.61	\$17.22
\$24.90	\$49.80	\$17.94	\$35.88
\$49.80	\$99.60	\$35.87	\$71.74
\$74.70	\$149.40	\$53.81	\$107.62
\$99.60	\$199.20	\$71.73	\$143.46
\$1,981.36	\$3,962.72	\$1,427.02	\$2,854.04
\$5,549.32	\$11,098.64	\$3,996.73	\$7,993.46
\$28.64	\$57.28	\$20.62	\$41.24
\$42.96	\$85.92	\$30.94	\$61.88
\$320.00	\$3,840.00	\$300.00	\$3,600.00
\$100.00	\$1,200.00	\$80.00	\$960.00
\$75.00	\$1,800.00	\$75.00	\$1,800.00
\$150.00	\$1,500.00	\$140.00	\$1,400.00
\$150.00	\$1,200.00	\$140.00	\$1,120.00
\$150.00	\$1,200.00	\$140.00	\$1,120.00
\$115.00	\$460.00	\$115.00	\$460.00
\$590.00	\$2,360.00	\$590.00	\$2,360.00
\$7,500.00	\$15,000.00	\$6,000.00	\$12,000.00
\$8,999.00	\$0.00	\$5,400.00	\$0.00
\$27.95	\$223.60	\$20.00	\$160.00

Notes

Cable Cross Alternative

Rack Attachment

Rack Attachment

Rack Attachment

Rack Attachment

Rack Attachment

Storage for Rack Attachments

Add storage for these!

Option 2 (Rubber dumbbells)

Option 2 (Rubber dumbbells)

Plyometric Flooring system

Option 2 instead of Keiser

Deluxe Med Ball Rack (20 balls)	1	MBR3
Custom built-in Ball Rack	1	Custom
Wall Ball 8b	1	MB08
Wall Ball 10b	2	MB10
Wall Ball 12b	2	MB12
Wall Ball 14b	1	MB14
Wall Ball 16b	1	MB16
Wall Ball 20b	1	MB20
Equipment Totals		
FLOORING		
FLOORING - Ecore 1" Everlast Ultra 2' x 2' Rubber Tile (BLACK) 902 tiles	3608	EL00
FLOORING - Ecore 1" Everlast Ultra 2' x 2' Rubber Tile (Blue) - Platform drop zones (48 tiles - 4 per platform)	192	EL500
FLOORING - Ecore quad block. (1 block per Ultra Tile)	950	EL00
GLUE - 28 oz of Egrip III Adhesive (1 per 40 quad blocks)	20	Glue
Ecore Reducer	3	EL00
FLOORING - Ecore Everlast 8mm Rolled Rubber BLACK (4' wide rolls)	0	EL00
GLUE - 4 gallon Egrip	0	Glue
Flooring Totals		

\$537.78	\$537.78	\$350.00	\$350.00
\$700.00	\$700.00	\$500.00	\$500.00
\$95.00	\$95.00	\$90.00	\$90.00
\$100.00	\$200.00	\$95.00	\$190.00
\$105.00	\$210.00	\$100.00	\$200.00
\$111.00	\$111.00	\$108.00	\$108.00
\$117.00	\$117.00	\$113.00	\$113.00
\$130.00	\$130.00	\$125.00	\$125.00
	\$89,757.31		\$73,637.39
\$8.98	\$32,399.84	\$6.25	\$22,550.00
\$12.34	\$2,369.28	\$8.50	\$1,632.00
\$2.94	\$2,793.00	\$2.00	\$1,900.00
\$27.60	\$552.00	\$18.00	\$360.00
\$37.19	\$111.57	\$25.00	\$75.00
\$2.93	\$0.00	\$2.25	\$0.00
\$271.46	\$0.00	\$230.00	\$0.00
	\$38,225.69		\$26,517.00

Livonia Franklin
SF: 3,500
Option 1

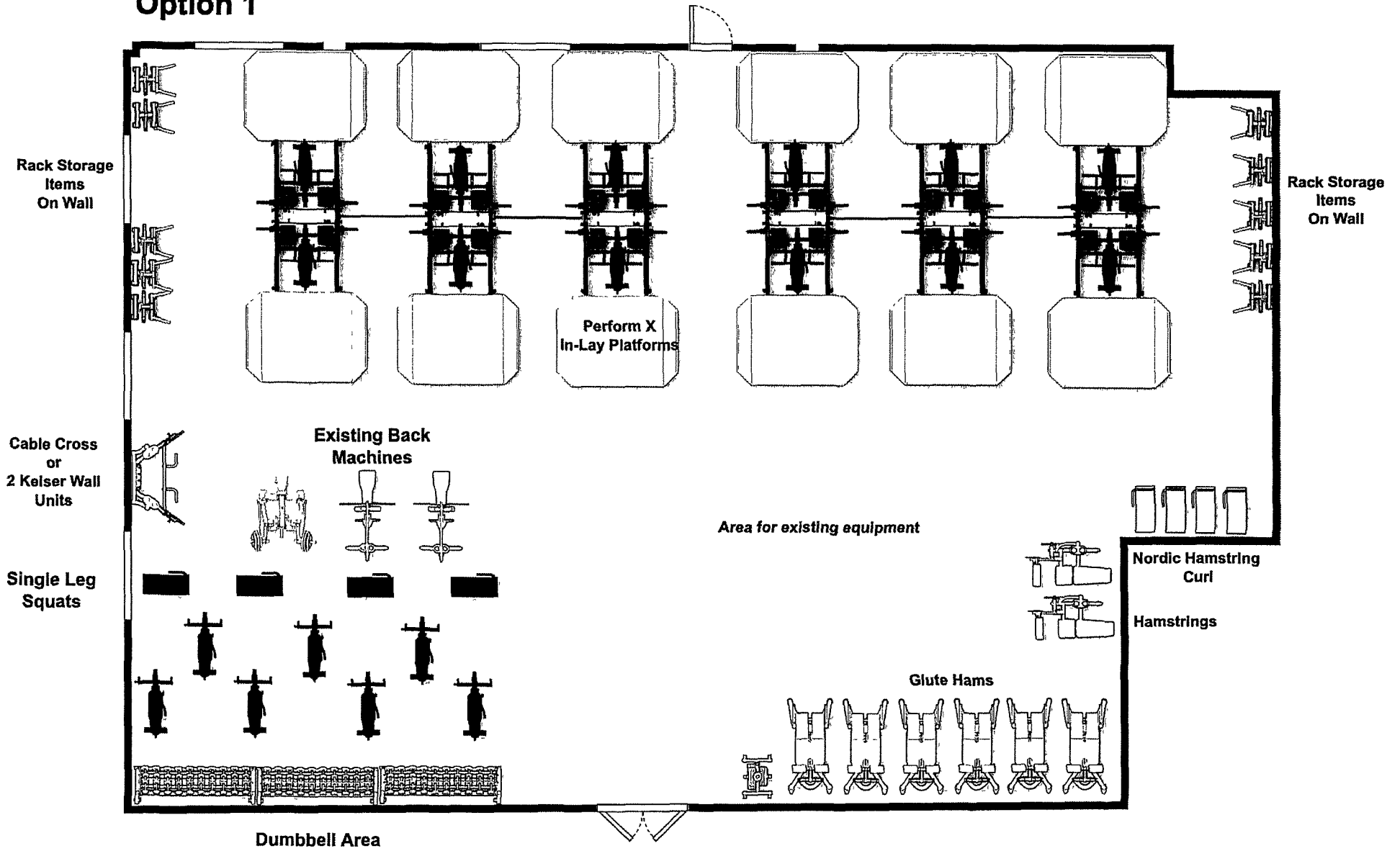

Livonia Franklin
SF: 3,500
Option 2

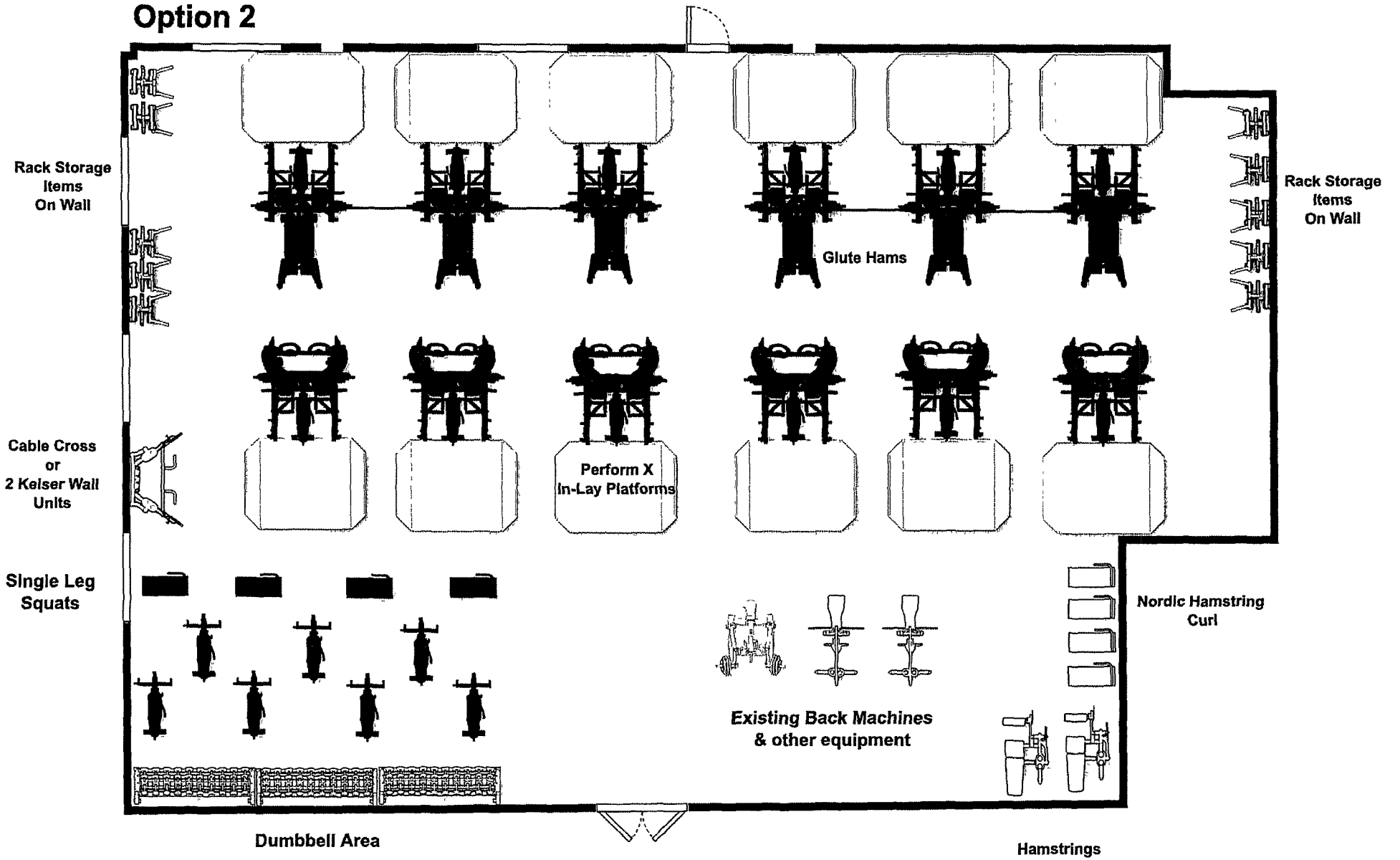

Livonia Franklin
SF: 3,500
Option 3

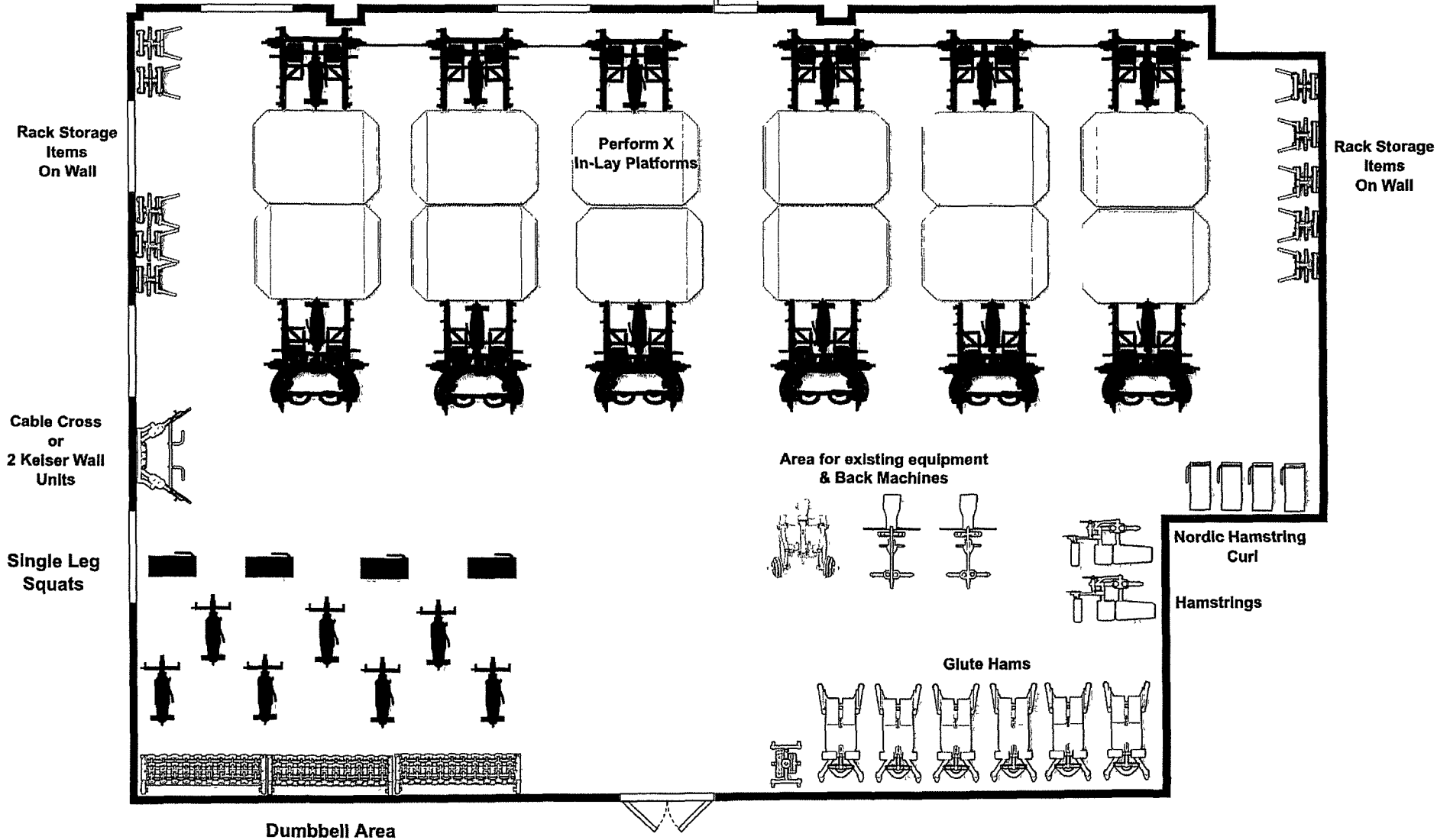



JOHN HALL <jhall9@livoniapublicschools.org>

Fwd: Weight Room Layouts

1 message

CHRISTOPHER KELBERT <ckelbert@livoniapublicschools.org>
To: JOHN HALL <jhall9@livoniapublicschools.org>

Mon, Apr 24, 2023 at 8:18 AM

----- Forwarded message -----

From: **Connor Rice** <connorrice17@gmail.com>
Date: Fri, Apr 21, 2023 at 1:09 PM
Subject: Weight Room Layouts
To: <ckelbert@livoniapublicschools.org>
Cc: Dan Mozes <dmozes@ethosperform.com>

Chris

Attached are a couple of options for the weight room. I'm happy to discuss this over the phone or in person. We can continue to adapt and make changes based on how you would like this to look. Regardless of which layout we go with, the rough estimate came out to about the same number (between \$200,000 and \$225,000). So let's just say \$215,000 to play it safe.

I was conservative with this estimate as well. I added the 1" thick flooring since the space is only 3,500 SF. I also added a couple Keiser Air pieces. These are the top of the line products. If it doesn't fit into the budget, I have alternative options. Let me know your thoughts and if you would like to discuss further

Thanks!

Connor Rice
EZ Strength
Owner
C: 248-797-4700

--
Chris Kelbert
Head Football Coach
Physical Education / Science
Franklin High School



 **Livonia Franklin Layouts.pdf**
2280K

