

January 24, 2025



Tim Helppi  
Building and Grounds Director  
Buffalo-Hanover-Montrose Schools  
214 1st Avenue NE  
Buffalo, MN 55313

**RE: Buffalo High School  
Short-Term Radon Testing Results  
IEA Project #202410993**

Dear Mr. Helppi:

The Institute for Environmental Assessment, Inc. (IEA) placed 239 Air Chek Pro Chek short-term radon test kits in 207 locations in Buffalo High School for the purpose of evaluating radon levels:

The number of kits placed includes those used for quality control purposes. See Appendix A for Quality Control information.

The radon test kits were placed by the following Minnesota Department of Health (MDH) licensed Radon Measurement Professional(s):

Measurement Professional	License Number	Signature
Sashya Wandmaker	RMEA-00470	
Allison Squires	RMEA-00562	

## INTRODUCTION

Radon is a colorless, odorless, tasteless, radioactive gas that occurs naturally in soil, rocks, and underground water supplies and in the ambient air. According to the U.S. Environmental Protection Agency (EPA) and other scientific organizations, naturally occurring radon gas has been associated with an increased risk of developing lung cancer. The chances of developing lung cancer from radon exposure are dependent on several factors, including individual susceptibility and, perhaps more importantly, the dose and duration of exposure. Radon testing in schools is highly recommended by the Minnesota Department of Health (MDH) and EPA.

**BROOKLYN PARK**  
9201 West Broadway, #600  
Brooklyn Park, MN 55445  
763-315-7900 / FAX 763-315-7920  
800-233-9513

**MANKATO**  
610 North Riverfront Drive  
Mankato, MN 56001  
507-345-8818 / FAX 507-345-5301  
800-233-9513

**ROCHESTER**  
210 Woodlake Drive SE  
Rochester, MN 55904  
507-281-6664 / FAX 507-281-6695  
800-233-9513

**BRAINERD**  
601 NW 5<sup>th</sup> Street, Ste. #4  
Brainerd, MN 56401  
218-454-0703 / FAX 218-454-0703  
800-233-9513

**MARSHALL**  
1420 East College Drive  
Marshall, MN 56258  
507-476-3599 / FAX 507-537-6985  
800-233-9513

**VIRGINIA**  
5525 Emerald Avenue  
Mountain Iron, MN 55768  
218-410-9521  
800-233-9513

## METHODOLOGY

IEA placed Air Chek Pro Chek short-term radon test kits in frequently occupied areas in Buffalo High School for the purpose of sampling for radon in accordance with the MDH’s *Guidance for Radon Testing in Minnesota Schools* (2024) and ANSI/AARST MA-MFLB *Protocol for Conducting Measurements of Radon and Radon Decay Products in Multifamily, Schools and Commercial and Multi-Use Buildings* (ANSI/AARST MA-MFLB 2023).

A total of 239 radon test kits were placed from December 17 to December 20, 2024, and January 7-10, 2025, for a total short-term sampling period of 3 days including 2 kits that were inaccessible at the time of pickup and 1 test kit that was missing upon sample retrieval. The radon test kits were analyzed by AirChek, Inc., MDH license #RL-00003, located at 1936 Butler Bridge Road, Mills River, NC 28759. The Analysis Methodologies are provided in Appendix A.

Air intakes and ventilation systems were operating in normal condition at the time of placement and retrieval. IEA was informed that the HVAC was on a normal operating schedule during the testing period.

IEA followed ANSI/AARST MA-MFLB 2023 for quality assurance measurements by including duplicate kits, control kits (blanks), and spiked kits.

Client communications and commitments were delivered to the client and are located in Appendix C:

- Client Commitments, Advisories and Authorizations
- Facilitating Staff Commitments

Occupant notices were sent to the client for distribution on December 11, 2024 for the initial testing, and on January 6, 2025 for the testing of the missed areas.

## EVALUATION CRITERIA

The MDH and the EPA have established a recommended action level in intended to be occupied areas of 4.0 picocuries per liter (pCi/L) for an annual average. Testing was conducted during school days when the building is significantly occupied. The HVAC system was set on a normal occupied operating schedule. Testing was conducted during the heating season when the average outdoor temperature is less than 65°F, as recommended by the MDH, when the ventilation system was operating normally, and windows and doors were closed. Consequently, sampling under these “closed” conditions is when the radon risk is most likely to occur.

MDH recommends follow-up testing for sampling results that are above the action level. Please refer to the following table for MDH guidelines:

RESULTS (pCi/L)	RECOMMENDED ACTION
LESS THAN 4	Re-test after changes to foundation or HVAC and every 5 years
GREATER THAN OR EQUAL TO 4	Conduct CRM short-term testing during winter months
LESS THAN 4 (DURING OCCUPANCY) AFTER CRM TESTING	Repeat CRM testing if not conducted during winter or if conducted during abnormal ventilation. Otherwise consider re-testing after changes to foundation or HVAC and every 5 years
GREATER THAN OR EQUAL TO 4 (DURING OCCUPANCY) AFTER CRM TESTING	Reduce radon in rooms to less than 4 through radon mitigation. Conduct CRM testing to verify radon reduction.

CRM: Continuous Radon Monitor

## RESULTS & DISCUSSION

The laboratory reports and maps of each building with sampling locations are provided in Appendix B. The following includes summary results for each building.

### **Buffalo High School**

877 Bison Blvd.  
 Buffalo, MN 55313

A total of 239 test kits were placed in 207 locations at Buffalo High School. One (1) test kit in Room F137 was missing when the test kits were collected. The number of missing test kits did not exceed allowance in the ANSI/AARST MA-MFLB 2023 standard.

Three (3) test kits were placed on the initial testing date but were invalid or inaccessible at the time of retrieval. IEA completed testing for these 3 locations from January 7-10, 2025.

The results indicated that radon levels for the locations tested in Buffalo High School were below the action level of 4 pCi/L. See Table 1 below for a summary of the results:

TABLE 1: BUFFALO HIGH SCHOOL - RANGE OF RESULTS				
	0.0 – 1.9 pCi/L	2.0 – 2.9 pCi/L	3.0 – 3.9 pCi/L	≥ 4 pCi/L
<b>Number of Locations</b>	203	3	1	0 <sup>1</sup>
<b>207</b>				

<sup>1</sup> All below action level  
 pCi/L: picocuries per liter

## CONCLUSIONS AND RECOMMENDATIONS

It is recommended by ANSI/AARST MA-MFLB 2023 to consider taking action and address results of radon concentrations greater than half the action level (2-3.9 pCi/L).

The EPA has established recommended guidelines for permissible radon concentrations in schools. The following are general recommendations for frequently occupied areas of schools:

- The building should be retested at least every 5 years and in conjunction with any sale of the building.
- Ground contact rooms that were not tested because they were not occupied, should be tested if they become occupied in the future.

In addition, retesting should be conducted when any of the following circumstances occur:

- A new addition is constructed, or a significant renovation occurs
- Heating or cooling systems are significantly altered, resulting in changes to air pressures or distribution
- Ventilation is significantly altered by extensive weatherization, changes to mechanical systems, or comparable procedures
- Significant openings to soil occur due to:
  - Ground water or slab surface water control systems (e.g., sumps, perimeter drain tile, shower/tub retrofits, etc.)
  - Natural settlement causing major cracks to develop
  - Earthquakes, construction blasting, or formation of sink holes nearby
  - A mitigation system is altered, modified, or repaired
- Rooms should be retested during the winter heating season (i.e., under “closed” conditions) which is typically “worst case” conditions.

Per Minnesota Statutes, section 123B.571, school districts are required to report radon test results at a school board meeting and report results to the MDH. IEA is able to assist with presenting results to the school board, and the MDH reporting. The MDH ‘School Radon Testing Form’ is located in Appendix E.

For more information regarding radon, see the EPA’s A Citizen’s Guide to Radon at <http://www.epa.gov/radon>. MDH can be contacted at [health.indoorair@state.mn.us](mailto:health.indoorair@state.mn.us) or 651-201-4601.

## GENERAL COMMENTS

The analysis and opinions expressed in this report are based upon data obtained from radon sampling district-wide and are representative of the locations and time period sampled. This report does not reflect variations in conditions that may occur across the site, property, or facility. Actual conditions may vary and may not become evident without further assessment.

The report is prepared for the exclusive use of our client for specific application to the project discussed and has been prepared in accordance with generally accepted environmental, health and safety practices. Other than as provided in the preceding sentence and in our Proposal #12389 dated September 3, 2024, regarding radon sampling services at the district locations, including the General Conditions attached thereto, no warranties are extended or made.

Should you require additional radon testing or have any questions regarding radon or any other environmental, health, or safety-related concerns, please do not hesitate to contact our office.

Sincerely,

IEA, Inc.

Reviewed by:



Jack Skluzacek  
Project Manager



Emma Squires-Sperling  
Laboratory Director

JS/wb 012425

Enc.

# **Appendix A**

*Analysis Methodology and  
Quality Control Measurements*

## **Analysis Methodology**

---

IEA placed Air Chek, Inc. Pro Chek activated charcoal radon test kits designed specifically for the detection of gamma emissions caused by the decay of Radon-222 and its daughter products. The kit is made of a padded envelope which contains activated charcoal. Upon pick-up, the kit is sealed with vinyl tape after 72 to 96 hours of indoor exposure. Individual kits are uniquely identified with a number and corresponding bar code.

Upon receipt at the analytical laboratory, the kits are logged in using the unique numbers assigned to each kit. The kits are placed on a gamma detector to count the gamma emissions from the decay of radon adsorbed by the charcoal. A calibration factor determined in part by the exposure time and decay time is used to calculate the radon concentration. A correction factor is also applied for weight gain from any moisture absorbed by the charcoal during the sampling period.

Any unusual conditions are noted on the processing form and shown on the exposure report.

## MDH and ANSI/AARST MA-MFLB 2023 Quality Control Measurements

IEA followed ANSI/AARST MA-MFLB 2023 and MDH recommendations for quality assurance measurements to ensure the accuracy of test results. Quality assurance measurements include side-by-side test kits (duplicates) and unexposed control test kits (blanks).

Duplicates are pairs of test kits placed 4-8 inches apart for the same test period. Duplicates are stored, placed, retrieved, and shipped to the laboratory for analysis in the same manner as the other test kits so that the laboratory cannot distinguish them. Since duplicates are placed side-by-side, the measured values for radon should be the same. The average of all duplicates' relative percent difference (RPD) should not exceed 25%. If they do, an investigation to identify the cause may be warranted and could include repeating the measurements. Duplicate averages are listed in Table 1 below.

Table 1: Duplicate Device Measurements and Averages			
Location	Test 1 (pCi/L)	Test 2 (pCi/L)	Average (pCi/L)
A102	1	0.9	0.95
A108	0.7	1	0.85
A110	0.7	1	0.85
A111	0.9	1.1	1
A205	0.6	< 0.3	< 0.45
A215	< 0.3	< 0.3	< 0.3
B145	0.8	< 0.3	< 0.55
B150	0.9	1	0.95
B157	0.9	1.2	1.05
C101	0.7	0.7	0.7
C105	0.9	1.4	1.15
C109	0.9	0.5	0.7
C112	0.9	0.8	0.85
C116	0.6	0.7	0.65
C120	0.8	0.7	0.75
C126	0.9	0.8	0.85
C211	< 0.3	< 0.3	< 0.3
D103	0.9	0.8	0.85
D107 OFFICE	0.7	0.7	0.7
D109	< 0.3	< 0.3	< 0.3
F106	< 0.3	0.5	< 0.4
G102	0.5	< 0.3	< 0.4

Blanks can be used to determine whether the manufacturing, shipping, storage, or processing of the detector has "contaminated" your measurements. Blanks are opened and immediately re-sealed to keep room air from infiltrating the test kit. Blanks are labeled and shipped in the same manner as the exposed test kits so that the laboratory cannot distinguish them. Since blanks are not exposed to radon, their measurement value should be below the lower limit of detection. Field blanks are listed in the laboratory report as FB<Room/Location Name>. Office blanks are listed in the laboratory report as OStorage Room A, OStorage Room B, etc. Lab-Transit Blanks are listed in Table 2 below.



**Table 2: Blanks**

Start Date	End Date	Start Time	End Time	Device ID	Type of Blank	Description	Radon Concentration (pCi/L)
12/17/2024	12/20/2024	1:00 PM	8:00 AM	11382818	Field	FB CUSTODIAL OFFICE 1	< 0.3
12/17/2024	12/20/2024	1:00 PM	8:00 AM	11382852	Field	FB CUSTODIAL OFFICE 2	< 0.3
12/17/2024	12/20/2024	1:00 PM	8:00 AM	11382853	Field	FB CUSTODIAL OFFICE 3	< 0.3
12/17/2024	12/20/2024	1:00 PM	8:00 AM	11382854	Field	FB CUSTODIAL OFFICE 4	< 0.3
12/17/2024	12/20/2024	1:00 PM	8:00 AM	11382825	Field	FB CUSTODIAL OFFICE 5	< 0.3
12/17/2024	12/20/2024	1:00 PM	8:00 AM	11382860	Field	FB CUSTODIAL OFFICE 6	< 0.3
12/17/2024	12/20/2024	1:00 PM	8:00 AM	11382846	Field	FB CUSTODIAL OFFICE 7	< 0.3
12/17/2024	12/20/2024	2:00 PM	3:00 PM	11382824	Office	OSTORAGE ROOM A	< 0.3
12/17/2024	12/20/2024	2:00 PM	3:00 PM	11382826	Office	OSTORAGE ROOM B	< 0.3
12/17/2024	12/20/2024	2:00 PM	3:00 PM	11382831	Office	OSTORAGE ROOM C	< 0.3
9/2/2024	9/4/2024	12:41 PM	12:41 PM	11806501	Lab-Transit	LTBP-1	<0.3
9/2/2024	9/4/2024	12:41 PM	12:41 PM	11806502	Lab-Transit	LTBP-2	<0.3
9/2/2024	9/4/2024	12:41 PM	12:41 PM	11806503	Lab-Transit	LTBP-3	<0.3
9/2/2024	9/4/2024	12:41 PM	12:41 PM	11806504	Lab-Transit	LTBP-4	<0.3
9/2/2024	9/4/2024	12:41 PM	12:41 PM	11806505	Lab-Transit	LTBP-5	<0.3
9/2/2024	9/4/2024	12:41 PM	12:41 PM	11806506	Lab-Transit	LTBP-6	<0.3
9/2/2024	9/4/2024	12:41 PM	12:41 PM	11806507	Lab-Transit	LTBP-7	<0.3
9/2/2024	9/4/2024	12:41 PM	12:41 PM	11806508	Lab-Transit	LTBP-8	<0.3
9/2/2024	9/4/2024	12:41 PM	12:41 PM	11806509	Lab-Transit	LTBP-9	<0.3
9/2/2024	9/4/2024	12:41 PM	12:41 PM	11806510	Lab-Transit	LTBP-10	<0.3
9/2/2024	9/4/2024	12:41 PM	12:41 PM	11806511	Lab-Transit	LTBP-11	<0.3
9/2/2024	9/4/2024	12:41 PM	12:41 PM	11806512	Lab-Transit	LTBP-12	<0.3
9/2/2024	9/4/2024	12:41 PM	12:41 PM	11806513	Lab-Transit	LTBP-13	<0.3
9/2/2024	9/4/2024	12:41 PM	12:41 PM	11806514	Lab-Transit	LTBP-14	<0.3
9/2/2024	9/4/2024	12:41 PM	12:41 PM	11806515	Lab-Transit	LTBP-15	<0.3
9/2/2024	9/4/2024	12:41 PM	12:41 PM	11806516	Lab-Transit	LTBP-16	<0.3
9/2/2024	9/4/2024	12:41 PM	12:41 PM	11806517	Lab-Transit	LTBP-17	<0.3
9/2/2024	9/4/2024	12:41 PM	12:41 PM	11806518	Lab-Transit	LTBP-18	<0.3
9/2/2024	9/4/2024	12:41 PM	12:41 PM	11806519	Lab-Transit	LTBP-19	<0.3
9/2/2024	9/4/2024	12:41 PM	12:41 PM	11806520	Lab-Transit	LTBP-20	<0.3
9/2/2024	9/4/2024	12:41 PM	12:41 PM	11806521	Lab-Transit	LTBP-21	<0.3
9/2/2024	9/4/2024	12:41 PM	12:41 PM	11806522	Lab-Transit	LTBP-22	<0.3
9/2/2024	9/4/2024	12:41 PM	12:41 PM	11806523	Lab-Transit	LTBP-23	<0.3
9/2/2024	9/4/2024	12:41 PM	12:41 PM	11806524	Lab-Transit	LTBP-24	<0.3
9/2/2024	9/4/2024	12:41 PM	12:41 PM	11806525	Lab-Transit	LTBP-25	<0.3
9/2/2024	9/4/2024	12:41 PM	12:41 PM	11806526	Lab-Transit	LTBP-26	<0.3
9/2/2024	9/4/2024	12:41 PM	12:41 PM	11806527	Lab-Transit	LTBP-27	<0.3
9/2/2024	9/4/2024	12:41 PM	12:41 PM	11806528	Lab-Transit	LTBP-28	<0.3
9/2/2024	9/4/2024	12:41 PM	12:41 PM	11806529	Lab-Transit	LTBP-29	<0.3
9/2/2024	9/4/2024	12:41 PM	12:41 PM	11806530	Lab-Transit	LTBP-30	<0.3
9/2/2024	9/4/2024	12:41 PM	12:41 PM	11806531	Lab-Transit	LTBP-31	<0.3
9/2/2024	9/4/2024	12:41 PM	12:41 PM	11806532	Lab-Transit	LTBP-32	<0.3
9/2/2024	9/4/2024	12:41 PM	12:41 PM	11806533	Lab-Transit	LTBP-33	<0.3
9/2/2024	9/4/2024	12:41 PM	12:41 PM	11806534	Lab-Transit	LTBP-34	<0.3
9/2/2024	9/4/2024	12:41 PM	12:41 PM	11806535	Lab-Transit	LTBP-35	<0.3
9/2/2024	9/4/2024	12:41 PM	12:41 PM	11806536	Lab-Transit	LTBP-36	<0.3
9/2/2024	9/4/2024	12:41 PM	12:41 PM	11806537	Lab-Transit	LTBP-37	<0.3
9/2/2024	9/4/2024	12:41 PM	12:41 PM	11806538	Lab-Transit	LTBP-38	<0.3
9/2/2024	9/4/2024	12:41 PM	12:41 PM	11806539	Lab-Transit	LTBP-39	<0.3
9/2/2024	9/4/2024	12:41 PM	12:41 PM	11806540	Lab-Transit	LTBP-40	<0.3
9/2/2024	9/4/2024	12:41 PM	12:41 PM	11806541	Lab-Transit	LTBP-41	<0.3
9/2/2024	9/4/2024	12:41 PM	12:41 PM	11806542	Lab-Transit	LTBP-42	<0.3

9/2/2024	9/4/2024	12:41 PM	12:41 PM	11806543	Lab-Transit	LTBP-43	<0.3
9/2/2024	9/4/2024	12:41 PM	12:41 PM	11806544	Lab-Transit	LTBP-44	<0.3
9/2/2024	9/4/2024	12:41 PM	12:41 PM	11806545	Lab-Transit	LTBP-45	<0.3
9/4/2024	9/6/2024	9:00 am	9:00 am	11801801	Lab-Transit	LTBP-84	<0.3
9/4/2024	9/6/2024	9:00 am	9:00 am	11801802	Lab-Transit	LTBP-64	<0.3
9/4/2024	9/6/2024	9:00 am	9:00 am	11801803	Lab-Transit	LTBP-87	<0.3
9/4/2024	9/6/2024	9:00 am	9:00 am	11801804	Lab-Transit	LTBP-89	<0.3
9/4/2024	9/6/2024	9:00 am	9:00 am	11801805	Lab-Transit	LTBP-67	<0.3
9/4/2024	9/6/2024	9:00 am	9:00 am	11801806	Lab-Transit	LTBP-76	<0.3
9/4/2024	9/6/2024	9:00 am	9:00 am	11801807	Lab-Transit	LTBP-73	<0.3
9/4/2024	9/6/2024	9:00 am	9:00 am	11801808	Lab-Transit	LTBP-88	<0.3
9/4/2024	9/6/2024	9:00 am	9:00 am	11801809	Lab-Transit	LTBP-72	<0.3
9/4/2024	9/6/2024	9:00 am	9:00 am	11801810	Lab-Transit	LTBP-75	<0.3
9/4/2024	9/6/2024	9:00 am	9:00 am	11801811	Lab-Transit	LTBP-82	<0.3
9/4/2024	9/6/2024	9:00 am	9:00 am	11801812	Lab-Transit	LTBP-83	<0.3
9/4/2024	9/6/2024	9:00 am	9:00 am	11801813	Lab-Transit	LTBP-80	<0.3
9/4/2024	9/6/2024	9:00 am	9:00 am	11801814	Lab-Transit	LTBP-78	<0.3
9/4/2024	9/6/2024	9:00 am	9:00 am	11801815	Lab-Transit	LTBP-69	<0.3
9/4/2024	9/6/2024	9:00 am	9:00 am	11801816	Lab-Transit	LTBP-77	<0.3
9/4/2024	9/6/2024	9:00 am	9:00 am	11801817	Lab-Transit	LTBP-90	<0.3
9/4/2024	9/6/2024	9:00 am	9:00 am	11801818	Lab-Transit	LTBP-86	<0.3
9/4/2024	9/6/2024	9:00 am	9:00 am	11801819	Lab-Transit	LTBP-70	<0.3
9/4/2024	9/6/2024	9:00 am	9:00 am	11801820	Lab-Transit	LTBP-68	<0.3
9/4/2024	9/6/2024	9:00 am	9:00 am	11801821	Lab-Transit	LTBP-47	<0.3
9/4/2024	9/6/2024	9:00 am	9:00 am	11801822	Lab-Transit	LTBP-63	<0.3
9/4/2024	9/6/2024	9:00 am	9:00 am	11801823	Lab-Transit	LTBP-62	<0.3
9/4/2024	9/6/2024	9:00 am	9:00 am	11801824	Lab-Transit	LTBP-58	<0.3
9/4/2024	9/6/2024	9:00 am	9:00 am	11801825	Lab-Transit	LTBP-49	<0.3
9/4/2024	9/6/2024	9:00 am	9:00 am	11801826	Lab-Transit	LTBP-50	<0.3
9/4/2024	9/6/2024	9:00 am	9:00 am	11801827	Lab-Transit	LTBP-79	<0.3
9/4/2024	9/6/2024	9:00 am	9:00 am	11801828	Lab-Transit	LTBP-51	<0.3
9/4/2024	9/6/2024	9:00 am	9:00 am	11801829	Lab-Transit	LTBP-57	<0.3
9/4/2024	9/6/2024	9:00 am	9:00 am	11801830	Lab-Transit	LTBP-56	<0.3
9/4/2024	9/6/2024	9:00 am	9:00 am	11801831	Lab-Transit	LTBP-53	<0.3
9/4/2024	9/6/2024	9:00 am	9:00 am	11801832	Lab-Transit	LTBP-54	<0.3
9/4/2024	9/6/2024	9:00 am	9:00 am	11801833	Lab-Transit	LTBP-81	<0.3
9/4/2024	9/6/2024	9:00 am	9:00 am	11801834	Lab-Transit	LTBP-71	<0.3
9/4/2024	9/6/2024	9:00 am	9:00 am	11801835	Lab-Transit	LTBP-66	<0.3
9/4/2024	9/6/2024	9:00 am	9:00 am	11801836	Lab-Transit	LTBP-85	<0.3
9/4/2024	9/6/2024	9:00 am	9:00 am	11801837	Lab-Transit	LTBP-48	<0.3
9/4/2024	9/6/2024	9:00 am	9:00 am	11801838	Lab-Transit	LTBP-74	<0.3
9/4/2024	9/6/2024	9:00 am	9:00 am	11801839	Lab-Transit	LTBP-59	<0.3
9/4/2024	9/6/2024	9:00 am	9:00 am	11801840	Lab-Transit	LTBP-46	<0.3
9/4/2024	9/6/2024	9:00 am	9:00 am	11801841	Lab-Transit	LTBP-52	<0.3
9/4/2024	9/6/2024	9:00 am	9:00 am	11801842	Lab-Transit	LTBP-61	<0.3
9/4/2024	9/6/2024	9:00 am	9:00 am	11801843	Lab-Transit	LTBP-55	<0.3
9/4/2024	9/6/2024	9:00 am	9:00 am	11801844	Lab-Transit	LTBP-60	<0.3
9/4/2024	9/6/2024	9:00 am	9:00 am	11801845	Lab-Transit	LTBP-65	<0.3
9/20/2024	9/23/2024	7:31:00 AM	7:31:00 AM	11625664	Lab-Transit	LTB, STORAGE ROOM A ORAGE ROOM A	<0.3
11/1/2024	11/4/2024	8:10 AM	8:10 AM	11461568	Lab-Transit	LTB, STORAGE ROOM A	<0.3

11/1/2024	11/4/2024	8:10 AM	8:10 AM	11461569	Storage Blank	SB, STORAGE ROOM A	<0.3
11/15/2024	11/18/2024	9:00:00 AM	9:00:00 AM	11461576	Lab-Transit	LTB, STORAGE ROOM A	<0.3
12/6/2024	12/9/2024	8:19:00 AM	8:19:00 AM	11379108	Lab-Transit	LTB, STORAGE ROOM A	<0.3

Spikes are test kits that have been exposed in a chamber to a known concentration of radon. Using spiked measurements can help evaluate the accuracy of a laboratory analysis and/or how accurately test kits supplied by a laboratory measure radon. Spiked test kits are labeled and shipped in the same manner as the exposed test kits so that the laboratory cannot distinguish them. Spiked results completed for our laboratory are included in the following pages. Spiked test kits are listed in Table 3 below.

Table 3: Spiked Detectors						
Start Date	End Date	Start Time	End Time	Device ID	Measured Value (pCi/L)	Reference Value (pCi/L)
12/6/2024	12/9/2024	8:19:00 AM	8:19:00 AM	11379101	27	26.7
12/6/2024	12/9/2024	8:19:00 AM	8:19:00 AM	11379102	23.8	26.7
12/6/2024	12/9/2024	8:19:00 AM	8:19:00 AM	11379103	26.4	26.7
12/6/2024	12/9/2024	8:19:00 AM	8:19:00 AM	11379104	27.6	26.7
12/6/2024	12/9/2024	8:19:00 AM	8:19:00 AM	11379105	27.5	26.7
12/6/2024	12/9/2024	8:19:00 AM	8:19:00 AM	11379106	27.8	26.7

# **Appendix B**

*Laboratory Reports and Maps*

Radon test result report for:

**BUFFALO-HANOVER-MONTROSE  
BUFFALO HIGH SCHOOL**

Kit #	Room Id	Started	Ended	pCi/L	Analyzed
11804859	A04	2024-12-17 @ 11:00 am	2024-12-20 @ 1:00 pm	0.7 ± 0.3	2024-12-21
11804831	A05	2024-12-17 @ 10:00 am	2024-12-20 @ 12:00 pm	1.0 ± 0.3	2024-12-21
11804813	A101	2024-12-17 @ 11:00 am	2024-12-20 @ 1:00 pm	1.0 ± 0.3	2024-12-21
11804865	A103	2024-12-17 @ 11:00 am	2024-12-20 @ 1:00 pm	1.0 ± 0.3	2024-12-21
11804860	A104	2024-12-17 @ 11:00 am	2024-12-20 @ 1:00 pm	1.1 ± 0.3	2024-12-21
11804858	A105	2024-12-17 @ 11:00 am	2024-12-20 @ 1:00 pm	1.2 ± 0.3	2024-12-21
11804857	A106	2024-12-17 @ 11:00 am	2024-12-20 @ 1:00 pm	1.4 ± 0.3	2024-12-21
11804852	A107	2024-12-17 @ 11:00 am	2024-12-20 @ 1:00 pm	1.6 ± 0.3	2024-12-21
11804850	A108 OFFICE	2024-12-17 @ 11:00 am	2024-12-20 @ 1:00 pm	0.8 ± 0.3	2024-12-21
11804807	A109	2024-12-17 @ 10:00 am	2024-12-20 @ 12:00 pm	1.0 ± 0.3	2024-12-21
11804820	A112	2024-12-17 @ 10:00 am	2024-12-20 @ 12:00 pm	1.1 ± 0.3	2024-12-21
11804826	A113	2024-12-17 @ 10:00 am	2024-12-20 @ 12:00 pm	0.9 ± 0.3	2024-12-21
11804825	A114	2024-12-17 @ 10:00 am	2024-12-20 @ 12:00 pm	1.2 ± 0.3	2024-12-21
11804824	A115	2024-12-17 @ 10:00 am	2024-12-20 @ 1:00 pm	1.7 ± 0.3	2024-12-21
11804823	A116	2024-12-17 @ 10:00 am	2024-12-20 @ 1:00 pm	1.1 ± 0.3	2024-12-21
11804827	A116 OFFICE	2024-12-17 @ 11:00 am	2024-12-20 @ 1:00 pm	0.8 ± 0.3	2024-12-21
11804828	A117	2024-12-17 @ 11:00 am	2024-12-20 @ 1:00 pm	0.8 ± 0.3	2024-12-21
11804833	A120	2024-12-17 @ 11:00 am	2024-12-20 @ 1:00 pm	1.1 ± 0.3	2024-12-21
11804834	A120 OFFICE	2024-12-17 @ 11:00 am	2024-12-20 @ 1:00 pm	1.1 ± 0.3	2024-12-21
11804835	A121	2024-12-17 @ 11:00 am	2024-12-20 @ 1:00 pm	0.8 ± 0.3	2024-12-21
11804836	A121 OFFICE	2024-12-17 @ 11:00 am	2024-12-20 @ 1:00 pm	0.9 ± 0.3	2024-12-21
11804842	A124	2024-12-17 @ 11:00 am	2024-12-20 @ 1:00 pm	1.0 ± 0.3	2024-12-21
11804844	A124 OFFICE	2024-12-17 @ 11:00 am	2024-12-20 @ 1:00 pm	0.8 ± 0.3	2024-12-21
11804843	A125	2024-12-17 @ 11:00 am	2024-12-20 @ 1:00 pm	0.9 ± 0.3	2024-12-21
11804841	A125 OFFICE	2024-12-17 @ 11:00 am	2024-12-20 @ 1:00 pm	0.9 ± 0.3	2024-12-21
11382837	A210	2024-12-17 @ 12:00 pm	2024-12-20 @ 1:00 pm	< 0.3	2024-12-21
11804871	B101	2024-12-17 @ 11:00 am	2024-12-20 @ 11:00 am	< 0.3	2024-12-21
11804880	B101A	2024-12-17 @ 11:00 am	2024-12-20 @ 11:00 am	< 0.3	2024-12-21
11804883	B101B	2024-12-17 @ 11:00 am	2024-12-20 @ 11:00 am	0.7 ± 0.3	2024-12-21
11804879	B102	2024-12-17 @ 11:00 am	2024-12-20 @ 11:00 am	< 0.3	2024-12-21
11804870	B103	2024-12-17 @ 11:00 am	2024-12-20 @ 11:00 am	< 0.3	2024-12-21
11804888	B104	2024-12-17 @ 11:00 am	2024-12-20 @ 11:00 am	0.5 ± 0.3	2024-12-21
11804878	B104A	2024-12-17 @ 11:00 am	2024-12-20 @ 11:00 am	< 0.3	2024-12-21
11804882	B105	2024-12-17 @ 11:00 am	2024-12-20 @ 11:00 am	< 0.3	2024-12-21
11804872	B106	2024-12-17 @ 11:00 am	2024-12-20 @ 11:00 am	< 0.3	2024-12-21
11804887	B108	2024-12-17 @ 11:00 am	2024-12-20 @ 11:00 am	< 0.3	2024-12-21
11804869	B109/110	2024-12-17 @ 11:00 am	2024-12-20 @ 11:00 am	< 0.3	2024-12-21

Radon test result report for:

**BUFFALO-HANOVER-MONTROSE  
BUFFALO HIGH SCHOOL**

Kit #	Room Id	Started	Ended	pCi/L	Analyzed
11804829	B114	2024-12-17 @ 11:00 am	2024-12-20 @ 12:00 pm	0.6 ± 0.3	2024-12-21
11804877	B115	2024-12-17 @ 11:00 am	2024-12-20 @ 11:00 am	< 0.3	2024-12-21
11804840	B120	2024-12-17 @ 11:00 am	2024-12-20 @ 12:00 pm	2.0 ± 0.3	2024-12-21
11804847	B121	2024-12-17 @ 11:00 am	2024-12-20 @ 12:00 pm	2.1 ± 0.3	2024-12-21
11804884	B123	2024-12-17 @ 11:00 am	2024-12-20 @ 11:00 am	1.1 ± 0.3	2024-12-21
11804845	B124	2024-12-17 @ 11:00 am	2024-12-20 @ 11:00 am	1.0 ± 0.3	2024-12-21
11804881	B125	2024-12-17 @ 11:00 am	2024-12-20 @ 12:00 pm	1.0 ± 0.3	2024-12-21
11804876	B129	2024-12-17 @ 11:00 am	2024-12-20 @ 11:00 am	1.1 ± 0.3	2024-12-21
11804862	B132	2024-12-17 @ 11:00 am	2024-12-20 @ 11:00 am	0.7 ± 0.3	2024-12-21
11804875	B133	2024-12-17 @ 11:00 am	2024-12-20 @ 12:00 pm	0.6 ± 0.3	2024-12-21
11804853	B135	2024-12-17 @ 11:00 am	2024-12-20 @ 12:00 pm	0.7 ± 0.3	2024-12-21
11804832	B137	2024-12-17 @ 11:00 am	2024-12-20 @ 12:00 pm	0.9 ± 0.3	2024-12-21
11804839	B138	2024-12-17 @ 11:00 am	2024-12-20 @ 12:00 pm	3.5 ± 0.3	2024-12-21
11804822	B139	2024-12-17 @ 11:00 am	2024-12-20 @ 12:00 pm	1.6 ± 0.3	2024-12-21
11804838	B140	2024-12-17 @ 11:00 am	2024-12-20 @ 12:00 pm	0.8 ± 0.3	2024-12-21
11804846	B143	2024-12-17 @ 11:00 am	2024-12-20 @ 12:00 pm	0.9 ± 0.3	2024-12-21
11804821	B144	2024-12-17 @ 11:00 am	2024-12-20 @ 12:00 pm	1.2 ± 0.3	2024-12-21
11804874	B146	2024-12-17 @ 11:00 am	2024-12-20 @ 12:00 pm	0.8 ± 0.3	2024-12-21
11804855	B147	2024-12-17 @ 11:00 am	2024-12-20 @ 12:00 pm	0.7 ± 0.3	2024-12-21
11804856	B148	2024-12-17 @ 11:00 am	2024-12-20 @ 12:00 pm	2.9 ± 0.3	2024-12-21
11804864	B149	2024-12-17 @ 11:00 am	2024-12-20 @ 12:00 pm	0.7 ± 0.3	2024-12-21
11804861	B151	2024-12-17 @ 11:00 am	2024-12-20 @ 12:00 pm	0.8 ± 0.3	2024-12-21
11804848	B152	2024-12-17 @ 11:00 am	2024-12-20 @ 12:00 pm	1.0 ± 0.3	2024-12-21
11382802	B202	2024-12-17 @ 12:00 pm	2024-12-20 @ 1:00 pm	< 0.3	2024-12-21
11462918	BAND OFFICE	2024-12-17 @ 8:00 am	2024-12-20 @ 9:00 am	< 0.3	2024-12-21
11804895	C06	2024-12-17 @ 12:00 pm	2024-12-20 @ 11:00 am	0.9 ± 0.3	2024-12-21
11804889	C102	2024-12-17 @ 12:00 pm	2024-12-20 @ 11:00 am	1.0 ± 0.3	2024-12-21
11804890	C103	2024-12-17 @ 12:00 pm	2024-12-20 @ 11:00 am	1.2 ± 0.3	2024-12-21
11804896	C104	2024-12-17 @ 12:00 pm	2024-12-20 @ 11:00 am	1.2 ± 0.3	2024-12-21
11804897	C106	2024-12-17 @ 12:00 pm	2024-12-20 @ 11:00 am	1.3 ± 0.3	2024-12-21
11804898	C107	2024-12-17 @ 12:00 pm	2024-12-20 @ 11:00 am	1.6 ± 0.3	2024-12-21
11804899	C108	2024-12-17 @ 12:00 pm	2024-12-20 @ 11:00 am	1.4 ± 0.3	2024-12-21
11382830	C110	2024-12-17 @ 12:00 pm	2024-12-20 @ 12:00 pm	0.9 ± 0.3	2024-12-21
11382829	C111	2024-12-17 @ 12:00 pm	2024-12-20 @ 12:00 pm	0.8 ± 0.3	2024-12-21
11382822	C113	2024-12-17 @ 12:00 pm	2024-12-20 @ 12:00 pm	0.8 ± 0.3	2024-12-21
11382821	C114	2024-12-17 @ 12:00 pm	2024-12-20 @ 12:00 pm	1.0 ± 0.3	2024-12-21
11382813	C115	2024-12-17 @ 12:00 pm	2024-12-20 @ 12:00 pm	0.8 ± 0.3	2024-12-21

Radon test result report for:

**BUFFALO-HANOVER-MONTROSE  
BUFFALO HIGH SCHOOL**

Kit #	Room Id	Started	Ended	pCi/L	Analyzed
11382814	C115 OFFICE	2024-12-17 @ 12:00 pm	2024-12-20 @ 12:00 pm	0.6 ± 0.3	2024-12-21
11382801	C117	2024-12-17 @ 12:00 pm	2024-12-20 @ 12:00 pm	0.7 ± 0.3	2024-12-21
11382811	C118	2024-12-17 @ 12:00 pm	2024-12-20 @ 12:00 pm	1.1 ± 0.3	2024-12-21
11382812	C118 OFFICE	2024-12-17 @ 12:00 pm	2024-12-20 @ 12:00 pm	0.8 ± 0.3	2024-12-21
11382806	C119	2024-12-17 @ 12:00 pm	2024-12-20 @ 12:00 pm	0.8 ± 0.3	2024-12-21
11382804	C121	2024-12-17 @ 12:00 pm	2024-12-20 @ 12:00 pm	0.8 ± 0.3	2024-12-21
11804894	C122	2024-12-17 @ 12:00 pm	2024-12-20 @ 11:00 am	1.1 ± 0.3	2024-12-21
11382815	C203	2024-12-17 @ 12:00 pm	2024-12-20 @ 1:00 pm	< 0.3	2024-12-21
11382816	C208	2024-12-17 @ 12:00 pm	2024-12-20 @ 1:00 pm	< 0.3	2024-12-21
11462948	CONCESSIONS	2024-12-17 @ 9:00 am	2024-12-20 @ 9:00 am	0.7 ± 0.3	2024-12-21
11382844	CUSTODIAL OFFICE	2024-12-17 @ 1:00 pm	2024-12-20 @ 1:00 pm	< 0.3	2024-12-21
11462903	D101	2024-12-17 @ 7:00 am	2024-12-20 @ 8:00 am	0.6 ± 0.3	2024-12-21
11462913	D102	2024-12-17 @ 7:00 am	2024-12-20 @ 8:00 am	< 0.3	2024-12-21
11462913	D102	2024-12-17 @ 7:00 am	2024-12-20 @ 8:00 am	< 0.3	2024-12-21
11462902	D102A	2024-12-17 @ 8:00 am	2024-12-20 @ 8:00 am	< 0.3	2024-12-21
11462919	D104	2024-12-17 @ 8:00 am	2024-12-20 @ 8:00 am	0.7 ± 0.3	2024-12-21
11462914	D105A	2024-12-17 @ 8:00 am	2024-12-20 @ 8:00 am	0.8 ± 0.3	2024-12-21
11462920	D105B	2024-12-17 @ 8:00 am	2024-12-20 @ 8:00 am	0.7 ± 0.3	2024-12-21
11462921	D105C	2024-12-17 @ 8:00 am	2024-12-20 @ 8:00 am	1.0 ± 0.3	2024-12-21
11462928	D106	2024-12-17 @ 8:00 am	2024-12-20 @ 8:00 am	0.8 ± 0.3	2024-12-21
11462927	D106A	2024-12-17 @ 8:00 am	2024-12-20 @ 8:00 am	0.6 ± 0.3	2024-12-21
11462922	D106B	2024-12-17 @ 8:00 am	2024-12-20 @ 8:00 am	< 0.3	2024-12-21
11462901	D107	2024-12-17 @ 8:00 am	2024-12-20 @ 8:00 am	0.6 ± 0.3	2024-12-21
11462937	D108	2024-12-17 @ 8:00 am	2024-12-20 @ 9:00 am	< 0.3	2024-12-21
11462924	D110	2024-12-17 @ 8:00 am	2024-12-20 @ 9:00 am	< 0.3	2024-12-21
11462946	D121	2024-12-17 @ 8:00 am	2024-12-20 @ 9:00 am	< 0.3	2024-12-21
11462906	D128	2024-12-17 @ 7:00 am	2024-12-20 @ 1:00 pm	0.5 ± 0.3	2024-12-21
11462904	D135	2024-12-17 @ 7:00 am	2024-12-20 @ 8:00 am	0.6 ± 0.3	2024-12-21
11462905	DANCE	2024-12-17 @ 8:00 am	2024-12-20 @ 9:00 am	0.6 ± 0.3	2024-12-21
11462941	DISH ROOM	2024-12-17 @ 9:00 am	2024-12-20 @ 9:00 am	< 0.3	2024-12-21
11804814	DOOR 2 ENTRANCE	2024-12-17 @ 11:00 am	2024-12-20 @ 12:00 pm	0.6 ± 0.3	2024-12-21
11804866	DUP-A102-1	2024-12-17 @ 11:00 am	2024-12-20 @ 1:00 pm	1.0 ± 0.3	2024-12-21
11804867	DUP-A102-2	2024-12-17 @ 11:00 am	2024-12-20 @ 1:00 pm	0.9 ± 0.3	2024-12-21
11804851	DUP-A108-1	2024-12-17 @ 11:00 am	2024-12-20 @ 1:00 pm	0.7 ± 0.3	2024-12-21
11804849	DUP-A108-2	2024-12-17 @ 11:00 am	2024-12-20 @ 1:00 pm	1.0 ± 0.3	2024-12-21
11804808	DUP-A110-1	2024-12-17 @ 10:00 am	2024-12-20 @ 12:00 pm	0.7 ± 0.3	2024-12-21
11804815	DUP-A110-2	2024-12-17 @ 10:00 am	2024-12-20 @ 12:00 pm	1.0 ± 0.3	2024-12-21

Radon test result report for:

**BUFFALO-HANOVER-MONTROSE  
BUFFALO HIGH SCHOOL**

Kit #	Room Id	Started	Ended	pCi/L	Analyzed
11804816	DUP-A111-1	2024-12-17 @ 10:00 am	2024-12-20 @ 12:00 pm	0.9 ± 0.3	2024-12-21
11804819	DUP-A111-2	2024-12-17 @ 10:00 am	2024-12-20 @ 12:00 pm	1.1 ± 0.3	2024-12-21
11382808	DUP-A205-1	2024-12-17 @ 12:00 pm	2024-12-20 @ 1:00 pm	0.6 ± 0.3	2024-12-21
11382845	DUP-A205-2	2024-12-17 @ 12:00 pm	2024-12-20 @ 1:00 pm	< 0.3	2024-12-21
11382838	DUP-A215-1	2024-12-17 @ 12:00 pm	2024-12-20 @ 1:00 pm	< 0.3	2024-12-21
11382807	DUP-A215-2	2024-12-17 @ 12:00 pm	2024-12-20 @ 1:00 pm	< 0.3	2024-12-21
11804868	DUP-B145-1	2024-12-17 @ 11:00 am	2024-12-20 @ 12:00 pm	0.8 ± 0.3	2024-12-21
11804854	DUP-B145-2	2024-12-17 @ 11:00 am	2024-12-20 @ 12:00 pm	< 0.3	2024-12-21
11804863	DUP-B150-1	2024-12-17 @ 11:00 am	2024-12-20 @ 12:00 pm	0.9 ± 0.3	2024-12-21
11804873	DUP-B150-2	2024-12-17 @ 11:00 am	2024-12-20 @ 12:00 pm	1.0 ± 0.3	2024-12-21
11804830	DUP-B157-1	2024-12-17 @ 11:00 am	2024-12-20 @ 12:00 pm	0.9 ± 0.3	2024-12-21
11804837	DUP-B157-2	2024-12-17 @ 11:00 am	2024-12-20 @ 12:00 pm	1.2 ± 0.3	2024-12-21
11804885	DUP-C101-1	2024-12-17 @ 11:00 am	2024-12-20 @ 11:00 am	0.7 ± 0.3	2024-12-21
11804886	DUP-C101-2	2024-12-17 @ 11:00 am	2024-12-20 @ 11:00 am	0.7 ± 0.3	2024-12-21
11804891	DUP-C105-1	2024-12-17 @ 12:00 pm	2024-12-20 @ 11:00 am	0.9 ± 0.3	2024-12-21
11804892	DUP-C105-2	2024-12-17 @ 12:00 pm	2024-12-20 @ 11:00 am	1.4 ± 0.3	2024-12-21
11382827	DUP-C109-1	2024-12-17 @ 12:00 pm	2024-12-20 @ 12:00 pm	0.9 ± 0.3	2024-12-21
11382828	DUP-C109-2	2024-12-17 @ 12:00 pm	2024-12-20 @ 12:00 pm	0.5 ± 0.3	2024-12-21
11382835	DUP-C112-1	2024-12-17 @ 12:00 pm	2024-12-20 @ 12:00 pm	0.9 ± 0.3	2024-12-21
11382836	DUP-C112-2	2024-12-17 @ 12:00 pm	2024-12-20 @ 12:00 pm	0.8 ± 0.3	2024-12-21
11382819	DUP-C116-1	2024-12-17 @ 12:00 pm	2024-12-20 @ 12:00 pm	0.6 ± 0.3	2024-12-21
11382820	DUP-C116-2	2024-12-17 @ 12:00 pm	2024-12-20 @ 12:00 pm	0.7 ± 0.3	2024-12-21
11382803	DUP-C120-1	2024-12-17 @ 12:00 pm	2024-12-20 @ 12:00 pm	0.8 ± 0.3	2024-12-21
11382805	DUP-C120-2	2024-12-17 @ 12:00 pm	2024-12-20 @ 12:00 pm	0.7 ± 0.3	2024-12-21
11804900	DUP-C126-1	2024-12-17 @ 12:00 pm	2024-12-20 @ 11:00 am	0.9 ± 0.3	2024-12-21
11804893	DUP-C126-2	2024-12-17 @ 12:00 pm	2024-12-20 @ 11:00 am	0.8 ± 0.3	2024-12-21
11382809	DUP-C211-1	2024-12-17 @ 12:00 pm	2024-12-20 @ 1:00 pm	< 0.3	2024-12-21
11382810	DUP-C211-2	2024-12-17 @ 12:00 pm	2024-12-20 @ 1:00 pm	< 0.3	2024-12-21
11462912	DUP-D103-1	2024-12-17 @ 7:00 am	2024-12-20 @ 8:00 am	0.9 ± 0.3	2024-12-21
11462911	DUP-D103-2	2024-12-17 @ 7:00 am	2024-12-20 @ 8:00 am	0.8 ± 0.3	2024-12-21
11462907	DUP-D107 OFFICE-1	2024-12-17 @ 8:00 am	2024-12-20 @ 8:00 am	0.7 ± 0.3	2024-12-21
11462908	DUP-D107 OFFICE-2	2024-12-17 @ 8:00 am	2024-12-20 @ 8:00 am	0.7 ± 0.3	2024-12-21
11462953	DUP-D109-1	2024-12-17 @ 8:00 am	2024-12-20 @ 9:00 am	< 0.3	2024-12-21
11462959	DUP-D109-2	2024-12-17 @ 8:00 am	2024-12-20 @ 9:00 am	< 0.3	2024-12-21
11462950	DUP-F106-1	2024-12-17 @ 9:00 am	2024-12-20 @ 9:00 am	< 0.3	2024-12-21
11462940	DUP-F106-2	2024-12-17 @ 9:00 am	2024-12-20 @ 9:00 am	0.5 ± 0.3	2024-12-21
11462971	DUP-G102-1	2024-12-17 @ 10:00 am	2024-12-20 @ 10:00 am	0.5 ± 0.3	2024-12-21



Radon test result report for:

**BUFFALO-HANOVER-MONTROSE  
BUFFALO HIGH SCHOOL**

Kit #	Room Id	Started	Ended	pCi/L	Analyzed
11462973	DUP-G102-2	2024-12-17 @ 10:00 am	2024-12-20 @ 10:00 am	< 0.3	2024-12-21
11462926	E113	2024-12-17 @ 9:00 am	2024-12-20 @ 10:00 am	< 0.3	2024-12-21
11462955	F100	2024-12-17 @ 9:00 am	2024-12-20 @ 10:00 am	< 0.3	2024-12-21
11462939	F101	2024-12-17 @ 9:00 am	2024-12-20 @ 10:00 am	< 0.3	2024-12-21
11382817	F102	2024-12-17 @ 1:00 pm	2024-12-20 @ 9:00 am	0.5 ± 0.3	2024-12-21
11382843	F102 OFFICE	2024-12-17 @ 1:00 pm	2024-12-20 @ 1:00 pm	< 0.3	2024-12-21
11462967	F104A-1	2024-12-17 @ 9:00 am	2024-12-20 @ 9:00 am	0.6 ± 0.3	2024-12-21
11462969	F104A-2	2024-12-17 @ 9:00 am	2024-12-20 @ 9:00 am	0.7 ± 0.3	2024-12-21
11462970	F104A-3	2024-12-17 @ 9:00 am	2024-12-20 @ 9:00 am	< 0.3	2024-12-21
11462977	F104A-4	2024-12-17 @ 9:00 am	2024-12-20 @ 9:00 am	0.6 ± 0.3	2024-12-21
11462978	F104A-5	2024-12-17 @ 9:00 am	2024-12-20 @ 9:00 am	< 0.3	2024-12-21
11462985	F104A-6	2024-12-17 @ 9:00 am	2024-12-20 @ 9:00 am	0.6 ± 0.3	2024-12-21
11462986	F104A-7	2024-12-17 @ 9:00 am	2024-12-20 @ 9:00 am	0.5 ± 0.3	2024-12-21
11462934	F107	2024-12-17 @ 9:00 am	2024-12-20 @ 9:00 am	0.6 ± 0.3	2024-12-21
11462933	F107A	2024-12-17 @ 9:00 am	2024-12-20 @ 9:00 am	< 0.3	2024-12-21
11462949	F128	2024-12-17 @ 9:00 am	2024-12-20 @ 10:00 am	< 0.3	2024-12-21
11462992	F137	2024-12-17 @ 9:00 am	2024-12-20 @ 10:00 am	< 0.3	2024-12-21
11462991	F140B	2024-12-17 @ 9:00 am	2024-12-20 @ 10:00 am	0.7 ± 0.3	2024-12-21
11382818	FB CUSTODIAL OFFICE 1	2024-12-17 @ 1:00 pm	2024-12-20 @ 8:00 am	< 0.3	2024-12-21
11382852	FB CUSTODIAL OFFICE 2	2024-12-17 @ 1:00 pm	2024-12-20 @ 8:00 am	< 0.3	2024-12-21
11382853	FB CUSTODIAL OFFICE 3	2024-12-17 @ 1:00 pm	2024-12-20 @ 8:00 am	< 0.3	2024-12-21
11382854	FB CUSTODIAL OFFICE 4	2024-12-17 @ 1:00 pm	2024-12-20 @ 8:00 am	< 0.3	2024-12-21
11382825	FB CUSTODIAL OFFICE 5	2024-12-17 @ 1:00 pm	2024-12-20 @ 8:00 am	< 0.3	2024-12-21
11382860	FB CUSTODIAL OFFICE 6	2024-12-17 @ 1:00 pm	2024-12-20 @ 8:00 am	< 0.3	2024-12-21
11382846	FB CUSTODIAL OFFICE 7	2024-12-17 @ 1:00 pm	2024-12-20 @ 8:00 am	< 0.3	2024-12-21
11462957	G101	2024-12-17 @ 10:00 am	2024-12-20 @ 10:00 am	0.6 ± 0.3	2024-12-21
11462963	G101A	2024-12-17 @ 10:00 am	2024-12-20 @ 10:00 am	< 0.3	2024-12-21
11462965	G107	2024-12-17 @ 10:00 am	2024-12-20 @ 10:00 am	0.5 ± 0.3	2024-12-21
11462975	G115-1	2024-12-17 @ 9:00 am	2024-12-20 @ 10:00 am	0.5 ± 0.3	2024-12-21
11462976	G115-2	2024-12-17 @ 9:00 am	2024-12-20 @ 10:00 am	< 0.3	2024-12-21
11462984	G115-3	2024-12-17 @ 9:00 am	2024-12-20 @ 11:00 am	< 0.3	2024-12-21
11462983	G115-4	2024-12-17 @ 9:00 am	2024-12-20 @ 11:00 am	0.6 ± 0.3	2024-12-21
11462958	GYMNASTICS-2	2024-12-17 @ 9:00 am	2024-12-20 @ 10:00 am	0.6 ± 0.3	2024-12-21
11462974	GYMNASTICS-4	2024-12-17 @ 9:00 am	2024-12-20 @ 10:00 am	0.7 ± 0.3	2024-12-21
11382851	H100	2024-12-17 @ 1:00 pm	2024-12-20 @ 11:00 am	0.6 ± 0.3	2024-12-21
11462964	H102	2024-12-17 @ 10:00 am	2024-12-20 @ 10:00 am	0.5 ± 0.3	2024-12-21
11462972	H104-1	2024-12-17 @ 10:00 am	2024-12-20 @ 10:00 am	< 0.3	2024-12-21

Radon test result report for:

**BUFFALO-HANOVER-MONTROSE  
BUFFALO HIGH SCHOOL**

Kit #	Room Id	Started	Ended	pCi/L	Analyzed
11462981	H104-2	2024-12-17 @ 10:00 am	2024-12-20 @ 10:00 am	< 0.3	2024-12-21
11462993	H105A-1	2024-12-17 @ 10:00 am	2024-12-20 @ 10:00 am	< 0.3	2024-12-21
11462999	H105A-2	2024-12-17 @ 10:00 am	2024-12-20 @ 10:00 am	< 0.3	2024-12-21
11462997	H105A-3	2024-12-17 @ 10:00 am	2024-12-20 @ 10:00 am	0.7 ± 0.3	2024-12-21
11462994	H105A-4	2024-12-17 @ 10:00 am	2024-12-20 @ 10:00 am	0.6 ± 0.3	2024-12-21
11463000	H108	2024-12-17 @ 10:00 am	2024-12-20 @ 10:00 am	0.7 ± 0.3	2024-12-21
11804812	H108	2024-12-17 @ 10:00 am	2024-12-20 @ 10:00 am	0.6 ± 0.3	2024-12-21
11462956	H114	2024-12-17 @ 9:00 am	2024-12-20 @ 10:00 am	0.6 ± 0.3	2024-12-21
11804817	J103	2024-12-17 @ 10:00 am	2024-12-20 @ 11:00 am	< 0.3	2024-12-21
11804818	J104	2024-12-17 @ 10:00 am	2024-12-20 @ 11:00 am	< 0.3	2024-12-21
11462998	J105-1	2024-12-17 @ 10:00 am	2024-12-20 @ 11:00 am	< 0.3	2024-12-21
11462980	J105-10	2024-12-17 @ 10:00 am	2024-12-20 @ 11:00 am	< 0.3	2024-12-21
11804803	J105-11	2024-12-17 @ 10:00 am	2024-12-20 @ 11:00 am	< 0.3	2024-12-21
11804805	J105-12	2024-12-17 @ 10:00 am	2024-12-20 @ 11:00 am	< 0.3	2024-12-21
11804806	J105-13	2024-12-17 @ 10:00 am	2024-12-20 @ 11:00 am	< 0.3	2024-12-21
11804809	J105-14	2024-12-17 @ 10:00 am	2024-12-20 @ 11:00 am	< 0.3	2024-12-21
11804810	J105-15	2024-12-17 @ 10:00 am	2024-12-20 @ 11:00 am	< 0.3	2024-12-21
11804811	J105-16	2024-12-17 @ 10:00 am	2024-12-20 @ 11:00 am	< 0.3	2024-12-21
11804804	J105-17	2024-12-17 @ 10:00 am	2024-12-20 @ 11:00 am	< 0.3	2024-12-21
11462995	J105-2	2024-12-17 @ 10:00 am	2024-12-20 @ 11:00 am	< 0.3	2024-12-21
11462996	J105-3	2024-12-17 @ 10:00 am	2024-12-20 @ 11:00 am	< 0.3	2024-12-21
11462982	J105-4	2024-12-17 @ 10:00 am	2024-12-20 @ 11:00 am	< 0.3	2024-12-21
11462990	J105-5	2024-12-17 @ 10:00 am	2024-12-20 @ 11:00 am	< 0.3	2024-12-21
11462989	J105-6	2024-12-17 @ 10:00 am	2024-12-20 @ 11:00 am	< 0.3	2024-12-21
11462987	J105-7	2024-12-17 @ 10:00 am	2024-12-20 @ 11:00 am	< 0.3	2024-12-21
11462979	J105-8	2024-12-17 @ 10:00 am	2024-12-20 @ 11:00 am	< 0.3	2024-12-21
11462988	J105-9	2024-12-17 @ 10:00 am	2024-12-20 @ 11:00 am	< 0.3	2024-12-21
11462962	KITCHEN	2024-12-17 @ 9:00 am	2024-12-20 @ 9:00 am	< 0.3	2024-12-21
11462942	KITCHEN OFFICE	2024-12-17 @ 9:00 am	2024-12-20 @ 9:00 am	< 0.3	2024-12-21
11462909	MAKE-UP	2024-12-17 @ 8:00 am	2024-12-20 @ 9:00 am	0.7 ± 0.3	2024-12-21
11462917	MIDI	2024-12-17 @ 8:00 am	2024-12-20 @ 9:00 am	< 0.3	2024-12-21
11462931	OUTSIDE AUDITORIUM S	2024-12-17 @ 9:00 am	2024-12-20 @ 9:00 am	< 0.3	2024-12-21
11462932	OUTSIDE AUDITORIUM W	2024-12-17 @ 9:00 am	2024-12-20 @ 9:00 am	0.7 ± 0.3	2024-12-21
11462944	PERFORMING ARTS CENTER NE	2024-12-17 @ 8:00 am	2024-12-20 @ 10:00 am	0.6 ± 0.3	2024-12-21
11462910	PERFORMING ARTS CENTER NW	2024-12-17 @ 8:00 am	2024-12-20 @ 10:00 am	< 0.3	2024-12-21
11462952	PERFORMING ARTS CENTER SE	2024-12-17 @ 8:00 am	2024-12-20 @ 10:00 am	0.6 ± 0.3	2024-12-21
11462951	PERFORMING ARTS CENTER SW	2024-12-17 @ 8:00 am	2024-12-20 @ 10:00 am	< 0.3	2024-12-21

Radon test result report for:

**BUFFALO-HANOVER-MONTROSE  
BUFFALO HIGH SCHOOL**

Kit #	Room Id	Started	Ended	pCi/L	Analyzed
11462960	PRACTICE 1	2024-12-17 @ 8:00 am	2024-12-20 @ 9:00 am	< 0.3	2024-12-21
11462923	PRACTICE 10	2024-12-17 @ 8:00 am	2024-12-20 @ 9:00 am	< 0.3	2024-12-21
11462925	PRACTICE 2	2024-12-17 @ 9:00 am	2024-12-20 @ 9:00 am	< 0.3	2024-12-21
11462954	PRACTICE 3	2024-12-17 @ 8:00 am	2024-12-20 @ 9:00 am	< 0.3	2024-12-21
11462961	PRACTICE 4	2024-12-17 @ 8:00 am	2024-12-20 @ 9:00 am	< 0.3	2024-12-21
11462915	PRACTICE 6	2024-12-17 @ 8:00 am	2024-12-20 @ 9:00 am	< 0.3	2024-12-21
11462938	PRACTICE 7	2024-12-17 @ 8:00 am	2024-12-20 @ 9:00 am	< 0.3	2024-12-21
11462916	PRACTICE 8	2024-12-17 @ 8:00 am	2024-12-20 @ 9:00 am	< 0.3	2024-12-21
11462943	PRACTICE 9	2024-12-17 @ 8:00 am	2024-12-20 @ 9:00 am	< 0.3	2024-12-21
11462935	STAGE NORTH	2024-12-17 @ 8:00 am	2024-12-20 @ 9:00 am	0.7 ± 0.3	2024-12-21
11462936	STAGE SOUTH	2024-12-17 @ 8:00 am	2024-12-20 @ 9:00 am	0.6 ± 0.3	2024-12-21
11462968	TICKET BOOTH	2024-12-17 @ 9:00 am	2024-12-20 @ 9:00 am	0.6 ± 0.3	2024-12-21

---

December 21, 2024

**\*\* LABORATORY ANALYSIS REPORT \*\***

---

Radon test result report for:

**BUFFALO\_HANOVER\_MONTROSE SCHOOLS  
BUFFALO HIGH SCHOOL**

---

<b>Kit #</b>	<b>Room Id</b>	<b>Started</b>	<b>Ended</b>	<b>pCi/L</b>	<b>Analyzed</b>
11382824	OSTORAGE ROOM A	2024-12-17 @ 2:00 pm	2024-12-20 @ 3:00 pm	< 0.3	2024-12-21
11382826	OSTORAGE ROOM B	2024-12-17 @ 2:00 pm	2024-12-20 @ 3:00 pm	< 0.3	2024-12-21
11382831	OSTORAGE ROOM C	2024-12-17 @ 2:00 pm	2024-12-20 @ 3:00 pm	< 0.3	2024-12-21

---

Air Chek 1936 Butler Bridge Rd, Mills River, NC 28759-3892 Phone: (828) 684-0893 Fax: (828) 684-8498

---

January 15, 2025

**\*\* LABORATORY ANALYSIS REPORT \*\***

---

Radon test result report for:

**BUFFALO HIGH SCHOOL**

---

<b>Kit #</b>	<b>Room Id</b>	<b>Started</b>	<b>Ended</b>	<b>pCi/L</b>	<b>Analyzed</b>
11462929	GYMNASTICS - 1	2025-01-07 @ 2:00 pm	2025-01-10 @ 3:00 pm	0.7 ± 0.3	2025-01-14
11462930	GYMNASTICS- 3	2025-01-07 @ 2:00 pm	2025-01-10 @ 3:00 pm	0.5 ± 0.3	2025-01-14
11462945	PRACTICE 5	2025-01-07 @ 2:00 pm	2025-01-10 @ 3:00 pm	1.0 ± 0.3	2025-01-14

---

Air Chek 1936 Butler Bridge Rd, Mills River, NC 28759-3892 Phone: (828) 684-0893 Fax: (828) 684-8498

Radon test result report for:

**BUFFALO-HANOVER-MONTROSE  
BUFFALO HIGH SCHOOL**

Kit #	Room Id	Started	Ended	pCi/L	Analyzed
11804859	A04	2024-12-17 @ 11:00 am	2024-12-20 @ 1:00 pm	0.7 ± 0.3	2024-12-21
11804831	A05	2024-12-17 @ 10:00 am	2024-12-20 @ 12:00 pm	1.0 ± 0.3	2024-12-21
11804813	A101	2024-12-17 @ 11:00 am	2024-12-20 @ 1:00 pm	1.0 ± 0.3	2024-12-21
11804865	A103	2024-12-17 @ 11:00 am	2024-12-20 @ 1:00 pm	1.0 ± 0.3	2024-12-21
11804860	A104	2024-12-17 @ 11:00 am	2024-12-20 @ 1:00 pm	1.1 ± 0.3	2024-12-21
11804858	A105	2024-12-17 @ 11:00 am	2024-12-20 @ 1:00 pm	1.2 ± 0.3	2024-12-21
11804857	A106	2024-12-17 @ 11:00 am	2024-12-20 @ 1:00 pm	1.4 ± 0.3	2024-12-21
11804852	A107	2024-12-17 @ 11:00 am	2024-12-20 @ 1:00 pm	1.6 ± 0.3	2024-12-21
11804850	A108 OFFICE	2024-12-17 @ 11:00 am	2024-12-20 @ 1:00 pm	0.8 ± 0.3	2024-12-21
11804807	A109	2024-12-17 @ 10:00 am	2024-12-20 @ 12:00 pm	1.0 ± 0.3	2024-12-21
11804820	A112	2024-12-17 @ 10:00 am	2024-12-20 @ 12:00 pm	1.1 ± 0.3	2024-12-21
11804826	A113	2024-12-17 @ 10:00 am	2024-12-20 @ 12:00 pm	0.9 ± 0.3	2024-12-21
11804825	A114	2024-12-17 @ 10:00 am	2024-12-20 @ 12:00 pm	1.2 ± 0.3	2024-12-21
11804824	A115	2024-12-17 @ 10:00 am	2024-12-20 @ 1:00 pm	1.7 ± 0.3	2024-12-21
11804823	A116	2024-12-17 @ 10:00 am	2024-12-20 @ 1:00 pm	1.1 ± 0.3	2024-12-21
11804827	A116 OFFICE	2024-12-17 @ 11:00 am	2024-12-20 @ 1:00 pm	0.8 ± 0.3	2024-12-21
11804828	A117	2024-12-17 @ 11:00 am	2024-12-20 @ 1:00 pm	0.8 ± 0.3	2024-12-21
11804833	A120	2024-12-17 @ 11:00 am	2024-12-20 @ 1:00 pm	1.1 ± 0.3	2024-12-21
11804834	A120 OFFICE	2024-12-17 @ 11:00 am	2024-12-20 @ 1:00 pm	1.1 ± 0.3	2024-12-21
11804835	A121	2024-12-17 @ 11:00 am	2024-12-20 @ 1:00 pm	0.8 ± 0.3	2024-12-21
11804836	A121 OFFICE	2024-12-17 @ 11:00 am	2024-12-20 @ 1:00 pm	0.9 ± 0.3	2024-12-21
11804842	A124	2024-12-17 @ 11:00 am	2024-12-20 @ 1:00 pm	1.0 ± 0.3	2024-12-21
11804844	A124 OFFICE	2024-12-17 @ 11:00 am	2024-12-20 @ 1:00 pm	0.8 ± 0.3	2024-12-21
11804843	A125	2024-12-17 @ 11:00 am	2024-12-20 @ 1:00 pm	0.9 ± 0.3	2024-12-21
11804841	A125 OFFICE	2024-12-17 @ 11:00 am	2024-12-20 @ 1:00 pm	0.9 ± 0.3	2024-12-21
11382837	A210	2024-12-17 @ 12:00 pm	2024-12-20 @ 1:00 pm	< 0.3	2024-12-21
11804871	B101	2024-12-17 @ 11:00 am	2024-12-20 @ 11:00 am	< 0.3	2024-12-21
11804880	B101A	2024-12-17 @ 11:00 am	2024-12-20 @ 11:00 am	< 0.3	2024-12-21
11804883	B101B	2024-12-17 @ 11:00 am	2024-12-20 @ 11:00 am	0.7 ± 0.3	2024-12-21
11804879	B102	2024-12-17 @ 11:00 am	2024-12-20 @ 11:00 am	< 0.3	2024-12-21
11804870	B103	2024-12-17 @ 11:00 am	2024-12-20 @ 11:00 am	< 0.3	2024-12-21
11804888	B104	2024-12-17 @ 11:00 am	2024-12-20 @ 11:00 am	0.5 ± 0.3	2024-12-21
11804878	B104A	2024-12-17 @ 11:00 am	2024-12-20 @ 11:00 am	< 0.3	2024-12-21
11804882	B105	2024-12-17 @ 11:00 am	2024-12-20 @ 11:00 am	< 0.3	2024-12-21
11804872	B106	2024-12-17 @ 11:00 am	2024-12-20 @ 11:00 am	< 0.3	2024-12-21
11804887	B108	2024-12-17 @ 11:00 am	2024-12-20 @ 11:00 am	< 0.3	2024-12-21
11804869	B109/110	2024-12-17 @ 11:00 am	2024-12-20 @ 11:00 am	< 0.3	2024-12-21

Radon test result report for:

**BUFFALO-HANOVER-MONTROSE  
BUFFALO HIGH SCHOOL**

Kit #	Room Id	Started	Ended	pCi/L	Analyzed
11804829	B114	2024-12-17 @ 11:00 am	2024-12-20 @ 12:00 pm	0.6 ± 0.3	2024-12-21
11804877	B115	2024-12-17 @ 11:00 am	2024-12-20 @ 11:00 am	< 0.3	2024-12-21
11804840	B120	2024-12-17 @ 11:00 am	2024-12-20 @ 12:00 pm	2.0 ± 0.3	2024-12-21
11804847	B121	2024-12-17 @ 11:00 am	2024-12-20 @ 12:00 pm	2.1 ± 0.3	2024-12-21
11804884	B123	2024-12-17 @ 11:00 am	2024-12-20 @ 11:00 am	1.1 ± 0.3	2024-12-21
11804845	B124	2024-12-17 @ 11:00 am	2024-12-20 @ 11:00 am	1.0 ± 0.3	2024-12-21
11804881	B125	2024-12-17 @ 11:00 am	2024-12-20 @ 12:00 pm	1.0 ± 0.3	2024-12-21
11804876	B129	2024-12-17 @ 11:00 am	2024-12-20 @ 11:00 am	1.1 ± 0.3	2024-12-21
11804862	B132	2024-12-17 @ 11:00 am	2024-12-20 @ 11:00 am	0.7 ± 0.3	2024-12-21
11804875	B133	2024-12-17 @ 11:00 am	2024-12-20 @ 12:00 pm	0.6 ± 0.3	2024-12-21
11804853	B135	2024-12-17 @ 11:00 am	2024-12-20 @ 12:00 pm	0.7 ± 0.3	2024-12-21
11804832	B137	2024-12-17 @ 11:00 am	2024-12-20 @ 12:00 pm	0.9 ± 0.3	2024-12-21
11804839	B138	2024-12-17 @ 11:00 am	2024-12-20 @ 12:00 pm	3.5 ± 0.3	2024-12-21
11804822	B139	2024-12-17 @ 11:00 am	2024-12-20 @ 12:00 pm	1.6 ± 0.3	2024-12-21
11804838	B140	2024-12-17 @ 11:00 am	2024-12-20 @ 12:00 pm	0.8 ± 0.3	2024-12-21
11804846	B143	2024-12-17 @ 11:00 am	2024-12-20 @ 12:00 pm	0.9 ± 0.3	2024-12-21
11804821	B144	2024-12-17 @ 11:00 am	2024-12-20 @ 12:00 pm	1.2 ± 0.3	2024-12-21
11804874	B146	2024-12-17 @ 11:00 am	2024-12-20 @ 12:00 pm	0.8 ± 0.3	2024-12-21
11804855	B147	2024-12-17 @ 11:00 am	2024-12-20 @ 12:00 pm	0.7 ± 0.3	2024-12-21
11804856	B148	2024-12-17 @ 11:00 am	2024-12-20 @ 12:00 pm	2.9 ± 0.3	2024-12-21
11804864	B149	2024-12-17 @ 11:00 am	2024-12-20 @ 12:00 pm	0.7 ± 0.3	2024-12-21
11804861	B151	2024-12-17 @ 11:00 am	2024-12-20 @ 12:00 pm	0.8 ± 0.3	2024-12-21
11804848	B152	2024-12-17 @ 11:00 am	2024-12-20 @ 12:00 pm	1.0 ± 0.3	2024-12-21
11382802	B202	2024-12-17 @ 12:00 pm	2024-12-20 @ 1:00 pm	< 0.3	2024-12-21
11462918	BAND OFFICE	2024-12-17 @ 8:00 am	2024-12-20 @ 9:00 am	< 0.3	2024-12-21
11804895	C06	2024-12-17 @ 12:00 pm	2024-12-20 @ 11:00 am	0.9 ± 0.3	2024-12-21
11804889	C102	2024-12-17 @ 12:00 pm	2024-12-20 @ 11:00 am	1.0 ± 0.3	2024-12-21
11804890	C103	2024-12-17 @ 12:00 pm	2024-12-20 @ 11:00 am	1.2 ± 0.3	2024-12-21
11804896	C104	2024-12-17 @ 12:00 pm	2024-12-20 @ 11:00 am	1.2 ± 0.3	2024-12-21
11804897	C106	2024-12-17 @ 12:00 pm	2024-12-20 @ 11:00 am	1.3 ± 0.3	2024-12-21
11804898	C107	2024-12-17 @ 12:00 pm	2024-12-20 @ 11:00 am	1.6 ± 0.3	2024-12-21
11804899	C108	2024-12-17 @ 12:00 pm	2024-12-20 @ 11:00 am	1.4 ± 0.3	2024-12-21
11382830	C110	2024-12-17 @ 12:00 pm	2024-12-20 @ 12:00 pm	0.9 ± 0.3	2024-12-21
11382829	C111	2024-12-17 @ 12:00 pm	2024-12-20 @ 12:00 pm	0.8 ± 0.3	2024-12-21
11382822	C113	2024-12-17 @ 12:00 pm	2024-12-20 @ 12:00 pm	0.8 ± 0.3	2024-12-21
11382821	C114	2024-12-17 @ 12:00 pm	2024-12-20 @ 12:00 pm	1.0 ± 0.3	2024-12-21
11382813	C115	2024-12-17 @ 12:00 pm	2024-12-20 @ 12:00 pm	0.8 ± 0.3	2024-12-21

Radon test result report for:

**BUFFALO-HANOVER-MONTROSE  
BUFFALO HIGH SCHOOL**

Kit #	Room Id	Started	Ended	pCi/L	Analyzed
11382814	C115 OFFICE	2024-12-17 @ 12:00 pm	2024-12-20 @ 12:00 pm	0.6 ± 0.3	2024-12-21
11382801	C117	2024-12-17 @ 12:00 pm	2024-12-20 @ 12:00 pm	0.7 ± 0.3	2024-12-21
11382811	C118	2024-12-17 @ 12:00 pm	2024-12-20 @ 12:00 pm	1.1 ± 0.3	2024-12-21
11382812	C118 OFFICE	2024-12-17 @ 12:00 pm	2024-12-20 @ 12:00 pm	0.8 ± 0.3	2024-12-21
11382806	C119	2024-12-17 @ 12:00 pm	2024-12-20 @ 12:00 pm	0.8 ± 0.3	2024-12-21
11382804	C121	2024-12-17 @ 12:00 pm	2024-12-20 @ 12:00 pm	0.8 ± 0.3	2024-12-21
11804894	C122	2024-12-17 @ 12:00 pm	2024-12-20 @ 11:00 am	1.1 ± 0.3	2024-12-21
11382815	C203	2024-12-17 @ 12:00 pm	2024-12-20 @ 1:00 pm	< 0.3	2024-12-21
11382816	C208	2024-12-17 @ 12:00 pm	2024-12-20 @ 1:00 pm	< 0.3	2024-12-21
11462948	CONCESSIONS	2024-12-17 @ 9:00 am	2024-12-20 @ 9:00 am	0.7 ± 0.3	2024-12-21
11382844	CUSTODIAL OFFICE	2024-12-17 @ 1:00 pm	2024-12-20 @ 1:00 pm	< 0.3	2024-12-21
11462903	D101	2024-12-17 @ 7:00 am	2024-12-20 @ 8:00 am	0.6 ± 0.3	2024-12-21
11462913	D102	2024-12-17 @ 7:00 am	2024-12-20 @ 8:00 am	< 0.3	2024-12-21
11462913	D102	2024-12-17 @ 7:00 am	2024-12-20 @ 8:00 am	< 0.3	2024-12-21
11462902	D102A	2024-12-17 @ 8:00 am	2024-12-20 @ 8:00 am	< 0.3	2024-12-21
11462919	D104	2024-12-17 @ 8:00 am	2024-12-20 @ 8:00 am	0.7 ± 0.3	2024-12-21
11462914	D105A	2024-12-17 @ 8:00 am	2024-12-20 @ 8:00 am	0.8 ± 0.3	2024-12-21
11462920	D105B	2024-12-17 @ 8:00 am	2024-12-20 @ 8:00 am	0.7 ± 0.3	2024-12-21
11462921	D105C	2024-12-17 @ 8:00 am	2024-12-20 @ 8:00 am	1.0 ± 0.3	2024-12-21
11462928	D106	2024-12-17 @ 8:00 am	2024-12-20 @ 8:00 am	0.8 ± 0.3	2024-12-21
11462927	D106A	2024-12-17 @ 8:00 am	2024-12-20 @ 8:00 am	0.6 ± 0.3	2024-12-21
11462922	D106B	2024-12-17 @ 8:00 am	2024-12-20 @ 8:00 am	< 0.3	2024-12-21
11462901	D107	2024-12-17 @ 8:00 am	2024-12-20 @ 8:00 am	0.6 ± 0.3	2024-12-21
11462937	D108	2024-12-17 @ 8:00 am	2024-12-20 @ 9:00 am	< 0.3	2024-12-21
11462924	D110	2024-12-17 @ 8:00 am	2024-12-20 @ 9:00 am	< 0.3	2024-12-21
11462946	D121	2024-12-17 @ 8:00 am	2024-12-20 @ 9:00 am	< 0.3	2024-12-21
11462906	D128	2024-12-17 @ 7:00 am	2024-12-20 @ 1:00 pm	0.5 ± 0.3	2024-12-21
11462904	D135	2024-12-17 @ 7:00 am	2024-12-20 @ 8:00 am	0.6 ± 0.3	2024-12-21
11462905	DANCE	2024-12-17 @ 8:00 am	2024-12-20 @ 9:00 am	0.6 ± 0.3	2024-12-21
11462941	DISH ROOM	2024-12-17 @ 9:00 am	2024-12-20 @ 9:00 am	< 0.3	2024-12-21
11804814	DOOR 2 ENTRANCE	2024-12-17 @ 11:00 am	2024-12-20 @ 12:00 pm	0.6 ± 0.3	2024-12-21
11804866	DUP-A102-1	2024-12-17 @ 11:00 am	2024-12-20 @ 1:00 pm	1.0 ± 0.3	2024-12-21
11804867	DUP-A102-2	2024-12-17 @ 11:00 am	2024-12-20 @ 1:00 pm	0.9 ± 0.3	2024-12-21
11804851	DUP-A108-1	2024-12-17 @ 11:00 am	2024-12-20 @ 1:00 pm	0.7 ± 0.3	2024-12-21
11804849	DUP-A108-2	2024-12-17 @ 11:00 am	2024-12-20 @ 1:00 pm	1.0 ± 0.3	2024-12-21
11804808	DUP-A110-1	2024-12-17 @ 10:00 am	2024-12-20 @ 12:00 pm	0.7 ± 0.3	2024-12-21
11804815	DUP-A110-2	2024-12-17 @ 10:00 am	2024-12-20 @ 12:00 pm	1.0 ± 0.3	2024-12-21



Radon test result report for:

**BUFFALO-HANOVER-MONTROSE  
BUFFALO HIGH SCHOOL**

Kit #	Room Id	Started	Ended	pCi/L	Analyzed
11804816	DUP-A111-1	2024-12-17 @ 10:00 am	2024-12-20 @ 12:00 pm	0.9 ± 0.3	2024-12-21
11804819	DUP-A111-2	2024-12-17 @ 10:00 am	2024-12-20 @ 12:00 pm	1.1 ± 0.3	2024-12-21
11382808	DUP-A205-1	2024-12-17 @ 12:00 pm	2024-12-20 @ 1:00 pm	0.6 ± 0.3	2024-12-21
11382845	DUP-A205-2	2024-12-17 @ 12:00 pm	2024-12-20 @ 1:00 pm	< 0.3	2024-12-21
11382838	DUP-A215-1	2024-12-17 @ 12:00 pm	2024-12-20 @ 1:00 pm	< 0.3	2024-12-21
11382807	DUP-A215-2	2024-12-17 @ 12:00 pm	2024-12-20 @ 1:00 pm	< 0.3	2024-12-21
11804868	DUP-B145-1	2024-12-17 @ 11:00 am	2024-12-20 @ 12:00 pm	0.8 ± 0.3	2024-12-21
11804854	DUP-B145-2	2024-12-17 @ 11:00 am	2024-12-20 @ 12:00 pm	< 0.3	2024-12-21
11804863	DUP-B150-1	2024-12-17 @ 11:00 am	2024-12-20 @ 12:00 pm	0.9 ± 0.3	2024-12-21
11804873	DUP-B150-2	2024-12-17 @ 11:00 am	2024-12-20 @ 12:00 pm	1.0 ± 0.3	2024-12-21
11804830	DUP-B157-1	2024-12-17 @ 11:00 am	2024-12-20 @ 12:00 pm	0.9 ± 0.3	2024-12-21
11804837	DUP-B157-2	2024-12-17 @ 11:00 am	2024-12-20 @ 12:00 pm	1.2 ± 0.3	2024-12-21
11804885	DUP-C101-1	2024-12-17 @ 11:00 am	2024-12-20 @ 11:00 am	0.7 ± 0.3	2024-12-21
11804886	DUP-C101-2	2024-12-17 @ 11:00 am	2024-12-20 @ 11:00 am	0.7 ± 0.3	2024-12-21
11804891	DUP-C105-1	2024-12-17 @ 12:00 pm	2024-12-20 @ 11:00 am	0.9 ± 0.3	2024-12-21
11804892	DUP-C105-2	2024-12-17 @ 12:00 pm	2024-12-20 @ 11:00 am	1.4 ± 0.3	2024-12-21
11382827	DUP-C109-1	2024-12-17 @ 12:00 pm	2024-12-20 @ 12:00 pm	0.9 ± 0.3	2024-12-21
11382828	DUP-C109-2	2024-12-17 @ 12:00 pm	2024-12-20 @ 12:00 pm	0.5 ± 0.3	2024-12-21
11382835	DUP-C112-1	2024-12-17 @ 12:00 pm	2024-12-20 @ 12:00 pm	0.9 ± 0.3	2024-12-21
11382836	DUP-C112-2	2024-12-17 @ 12:00 pm	2024-12-20 @ 12:00 pm	0.8 ± 0.3	2024-12-21
11382819	DUP-C116-1	2024-12-17 @ 12:00 pm	2024-12-20 @ 12:00 pm	0.6 ± 0.3	2024-12-21
11382820	DUP-C116-2	2024-12-17 @ 12:00 pm	2024-12-20 @ 12:00 pm	0.7 ± 0.3	2024-12-21
11382803	DUP-C120-1	2024-12-17 @ 12:00 pm	2024-12-20 @ 12:00 pm	0.8 ± 0.3	2024-12-21
11382805	DUP-C120-2	2024-12-17 @ 12:00 pm	2024-12-20 @ 12:00 pm	0.7 ± 0.3	2024-12-21
11804900	DUP-C126-1	2024-12-17 @ 12:00 pm	2024-12-20 @ 11:00 am	0.9 ± 0.3	2024-12-21
11804893	DUP-C126-2	2024-12-17 @ 12:00 pm	2024-12-20 @ 11:00 am	0.8 ± 0.3	2024-12-21
11382809	DUP-C211-1	2024-12-17 @ 12:00 pm	2024-12-20 @ 1:00 pm	< 0.3	2024-12-21
11382810	DUP-C211-2	2024-12-17 @ 12:00 pm	2024-12-20 @ 1:00 pm	< 0.3	2024-12-21
11462912	DUP-D103-1	2024-12-17 @ 7:00 am	2024-12-20 @ 8:00 am	0.9 ± 0.3	2024-12-21
11462911	DUP-D103-2	2024-12-17 @ 7:00 am	2024-12-20 @ 8:00 am	0.8 ± 0.3	2024-12-21
11462907	DUP-D107 OFFICE-1	2024-12-17 @ 8:00 am	2024-12-20 @ 8:00 am	0.7 ± 0.3	2024-12-21
11462908	DUP-D107 OFFICE-2	2024-12-17 @ 8:00 am	2024-12-20 @ 8:00 am	0.7 ± 0.3	2024-12-21
11462953	DUP-D109-1	2024-12-17 @ 8:00 am	2024-12-20 @ 9:00 am	< 0.3	2024-12-21
11462959	DUP-D109-2	2024-12-17 @ 8:00 am	2024-12-20 @ 9:00 am	< 0.3	2024-12-21
11462950	DUP-F106-1	2024-12-17 @ 9:00 am	2024-12-20 @ 9:00 am	< 0.3	2024-12-21
11462940	DUP-F106-2	2024-12-17 @ 9:00 am	2024-12-20 @ 9:00 am	0.5 ± 0.3	2024-12-21
11462971	DUP-G102-1	2024-12-17 @ 10:00 am	2024-12-20 @ 10:00 am	0.5 ± 0.3	2024-12-21

Radon test result report for:

**BUFFALO-HANOVER-MONTROSE  
BUFFALO HIGH SCHOOL**

Kit #	Room Id	Started	Ended	pCi/L	Analyzed
11462973	DUP-G102-2	2024-12-17 @ 10:00 am	2024-12-20 @ 10:00 am	< 0.3	2024-12-21
11462926	E113	2024-12-17 @ 9:00 am	2024-12-20 @ 10:00 am	< 0.3	2024-12-21
11462955	F100	2024-12-17 @ 9:00 am	2024-12-20 @ 10:00 am	< 0.3	2024-12-21
11462939	F101	2024-12-17 @ 9:00 am	2024-12-20 @ 10:00 am	< 0.3	2024-12-21
11382817	F102	2024-12-17 @ 1:00 pm	2024-12-20 @ 9:00 am	0.5 ± 0.3	2024-12-21
11382843	F102 OFFICE	2024-12-17 @ 1:00 pm	2024-12-20 @ 1:00 pm	< 0.3	2024-12-21
11462967	F104A-1	2024-12-17 @ 9:00 am	2024-12-20 @ 9:00 am	0.6 ± 0.3	2024-12-21
11462969	F104A-2	2024-12-17 @ 9:00 am	2024-12-20 @ 9:00 am	0.7 ± 0.3	2024-12-21
11462970	F104A-3	2024-12-17 @ 9:00 am	2024-12-20 @ 9:00 am	< 0.3	2024-12-21
11462977	F104A-4	2024-12-17 @ 9:00 am	2024-12-20 @ 9:00 am	0.6 ± 0.3	2024-12-21
11462978	F104A-5	2024-12-17 @ 9:00 am	2024-12-20 @ 9:00 am	< 0.3	2024-12-21
11462985	F104A-6	2024-12-17 @ 9:00 am	2024-12-20 @ 9:00 am	0.6 ± 0.3	2024-12-21
11462986	F104A-7	2024-12-17 @ 9:00 am	2024-12-20 @ 9:00 am	0.5 ± 0.3	2024-12-21
11462934	F107	2024-12-17 @ 9:00 am	2024-12-20 @ 9:00 am	0.6 ± 0.3	2024-12-21
11462933	F107A	2024-12-17 @ 9:00 am	2024-12-20 @ 9:00 am	< 0.3	2024-12-21
11462949	F128	2024-12-17 @ 9:00 am	2024-12-20 @ 10:00 am	< 0.3	2024-12-21
11462992	F137	2024-12-17 @ 9:00 am	2024-12-20 @ 10:00 am	< 0.3	2024-12-21
11462991	F140B	2024-12-17 @ 9:00 am	2024-12-20 @ 10:00 am	0.7 ± 0.3	2024-12-21
11382818	FB CUSTODIAL OFFICE 1	2024-12-17 @ 1:00 pm	2024-12-20 @ 8:00 am	< 0.3	2024-12-21
11382852	FB CUSTODIAL OFFICE 2	2024-12-17 @ 1:00 pm	2024-12-20 @ 8:00 am	< 0.3	2024-12-21
11382853	FB CUSTODIAL OFFICE 3	2024-12-17 @ 1:00 pm	2024-12-20 @ 8:00 am	< 0.3	2024-12-21
11382854	FB CUSTODIAL OFFICE 4	2024-12-17 @ 1:00 pm	2024-12-20 @ 8:00 am	< 0.3	2024-12-21
11382825	FB CUSTODIAL OFFICE 5	2024-12-17 @ 1:00 pm	2024-12-20 @ 8:00 am	< 0.3	2024-12-21
11382860	FB CUSTODIAL OFFICE 6	2024-12-17 @ 1:00 pm	2024-12-20 @ 8:00 am	< 0.3	2024-12-21
11382846	FB CUSTODIAL OFFICE 7	2024-12-17 @ 1:00 pm	2024-12-20 @ 8:00 am	< 0.3	2024-12-21
11462957	G101	2024-12-17 @ 10:00 am	2024-12-20 @ 10:00 am	0.6 ± 0.3	2024-12-21
11462963	G101A	2024-12-17 @ 10:00 am	2024-12-20 @ 10:00 am	< 0.3	2024-12-21
11462965	G107	2024-12-17 @ 10:00 am	2024-12-20 @ 10:00 am	0.5 ± 0.3	2024-12-21
11462975	G115-1	2024-12-17 @ 9:00 am	2024-12-20 @ 10:00 am	0.5 ± 0.3	2024-12-21
11462976	G115-2	2024-12-17 @ 9:00 am	2024-12-20 @ 10:00 am	< 0.3	2024-12-21
11462984	G115-3	2024-12-17 @ 9:00 am	2024-12-20 @ 11:00 am	< 0.3	2024-12-21
11462983	G115-4	2024-12-17 @ 9:00 am	2024-12-20 @ 11:00 am	0.6 ± 0.3	2024-12-21
11462958	GYMNASTICS-2	2024-12-17 @ 9:00 am	2024-12-20 @ 10:00 am	0.6 ± 0.3	2024-12-21
11462974	GYMNASTICS-4	2024-12-17 @ 9:00 am	2024-12-20 @ 10:00 am	0.7 ± 0.3	2024-12-21
11382851	H100	2024-12-17 @ 1:00 pm	2024-12-20 @ 11:00 am	0.6 ± 0.3	2024-12-21
11462964	H102	2024-12-17 @ 10:00 am	2024-12-20 @ 10:00 am	0.5 ± 0.3	2024-12-21
11462972	H104-1	2024-12-17 @ 10:00 am	2024-12-20 @ 10:00 am	< 0.3	2024-12-21

Radon test result report for:

**BUFFALO-HANOVER-MONTROSE  
BUFFALO HIGH SCHOOL**

Kit #	Room Id	Started	Ended	pCi/L	Analyzed
11462981	H104-2	2024-12-17 @ 10:00 am	2024-12-20 @ 10:00 am	< 0.3	2024-12-21
11462993	H105A-1	2024-12-17 @ 10:00 am	2024-12-20 @ 10:00 am	< 0.3	2024-12-21
11462999	H105A-2	2024-12-17 @ 10:00 am	2024-12-20 @ 10:00 am	< 0.3	2024-12-21
11462997	H105A-3	2024-12-17 @ 10:00 am	2024-12-20 @ 10:00 am	0.7 ± 0.3	2024-12-21
11462994	H105A-4	2024-12-17 @ 10:00 am	2024-12-20 @ 10:00 am	0.6 ± 0.3	2024-12-21
11463000	H108	2024-12-17 @ 10:00 am	2024-12-20 @ 10:00 am	0.7 ± 0.3	2024-12-21
11804812	H108	2024-12-17 @ 10:00 am	2024-12-20 @ 10:00 am	0.6 ± 0.3	2024-12-21
11462956	H114	2024-12-17 @ 9:00 am	2024-12-20 @ 10:00 am	0.6 ± 0.3	2024-12-21
11804817	J103	2024-12-17 @ 10:00 am	2024-12-20 @ 11:00 am	< 0.3	2024-12-21
11804818	J104	2024-12-17 @ 10:00 am	2024-12-20 @ 11:00 am	< 0.3	2024-12-21
11462998	J105-1	2024-12-17 @ 10:00 am	2024-12-20 @ 11:00 am	< 0.3	2024-12-21
11462980	J105-10	2024-12-17 @ 10:00 am	2024-12-20 @ 11:00 am	< 0.3	2024-12-21
11804803	J105-11	2024-12-17 @ 10:00 am	2024-12-20 @ 11:00 am	< 0.3	2024-12-21
11804805	J105-12	2024-12-17 @ 10:00 am	2024-12-20 @ 11:00 am	< 0.3	2024-12-21
11804806	J105-13	2024-12-17 @ 10:00 am	2024-12-20 @ 11:00 am	< 0.3	2024-12-21
11804809	J105-14	2024-12-17 @ 10:00 am	2024-12-20 @ 11:00 am	< 0.3	2024-12-21
11804810	J105-15	2024-12-17 @ 10:00 am	2024-12-20 @ 11:00 am	< 0.3	2024-12-21
11804811	J105-16	2024-12-17 @ 10:00 am	2024-12-20 @ 11:00 am	< 0.3	2024-12-21
11804804	J105-17	2024-12-17 @ 10:00 am	2024-12-20 @ 11:00 am	< 0.3	2024-12-21
11462995	J105-2	2024-12-17 @ 10:00 am	2024-12-20 @ 11:00 am	< 0.3	2024-12-21
11462996	J105-3	2024-12-17 @ 10:00 am	2024-12-20 @ 11:00 am	< 0.3	2024-12-21
11462982	J105-4	2024-12-17 @ 10:00 am	2024-12-20 @ 11:00 am	< 0.3	2024-12-21
11462990	J105-5	2024-12-17 @ 10:00 am	2024-12-20 @ 11:00 am	< 0.3	2024-12-21
11462989	J105-6	2024-12-17 @ 10:00 am	2024-12-20 @ 11:00 am	< 0.3	2024-12-21
11462987	J105-7	2024-12-17 @ 10:00 am	2024-12-20 @ 11:00 am	< 0.3	2024-12-21
11462979	J105-8	2024-12-17 @ 10:00 am	2024-12-20 @ 11:00 am	< 0.3	2024-12-21
11462988	J105-9	2024-12-17 @ 10:00 am	2024-12-20 @ 11:00 am	< 0.3	2024-12-21
11462962	KITCHEN	2024-12-17 @ 9:00 am	2024-12-20 @ 9:00 am	< 0.3	2024-12-21
11462942	KITCHEN OFFICE	2024-12-17 @ 9:00 am	2024-12-20 @ 9:00 am	< 0.3	2024-12-21
11462909	MAKE-UP	2024-12-17 @ 8:00 am	2024-12-20 @ 9:00 am	0.7 ± 0.3	2024-12-21
11462917	MIDI	2024-12-17 @ 8:00 am	2024-12-20 @ 9:00 am	< 0.3	2024-12-21
11462931	OUTSIDE AUDITORIUM S	2024-12-17 @ 9:00 am	2024-12-20 @ 9:00 am	< 0.3	2024-12-21
11462932	OUTSIDE AUDITORIUM W	2024-12-17 @ 9:00 am	2024-12-20 @ 9:00 am	0.7 ± 0.3	2024-12-21
11462944	PERFORMING ARTS CENTER NE	2024-12-17 @ 8:00 am	2024-12-20 @ 10:00 am	0.6 ± 0.3	2024-12-21
11462910	PERFORMING ARTS CENTER NW	2024-12-17 @ 8:00 am	2024-12-20 @ 10:00 am	< 0.3	2024-12-21
11462952	PERFORMING ARTS CENTER SE	2024-12-17 @ 8:00 am	2024-12-20 @ 10:00 am	0.6 ± 0.3	2024-12-21
11462951	PERFORMING ARTS CENTER SW	2024-12-17 @ 8:00 am	2024-12-20 @ 10:00 am	< 0.3	2024-12-21

Radon test result report for:  
**BUFFALO-HANOVER-MONTROSE**  
**BUFFALO HIGH SCHOOL**

Kit #	Room Id	Started	Ended	pCi/L	Analyzed
11462960	PRACTICE 1	2024-12-17 @ 8:00 am	2024-12-20 @ 9:00 am	< 0.3	2024-12-21
11462923	PRACTICE 10	2024-12-17 @ 8:00 am	2024-12-20 @ 9:00 am	< 0.3	2024-12-21
11462925	PRACTICE 2	2024-12-17 @ 9:00 am	2024-12-20 @ 9:00 am	< 0.3	2024-12-21
11462954	PRACTICE 3	2024-12-17 @ 8:00 am	2024-12-20 @ 9:00 am	< 0.3	2024-12-21
11462961	PRACTICE 4	2024-12-17 @ 8:00 am	2024-12-20 @ 9:00 am	< 0.3	2024-12-21
11462915	PRACTICE 6	2024-12-17 @ 8:00 am	2024-12-20 @ 9:00 am	< 0.3	2024-12-21
11462938	PRACTICE 7	2024-12-17 @ 8:00 am	2024-12-20 @ 9:00 am	< 0.3	2024-12-21
11462916	PRACTICE 8	2024-12-17 @ 8:00 am	2024-12-20 @ 9:00 am	< 0.3	2024-12-21
11462943	PRACTICE 9	2024-12-17 @ 8:00 am	2024-12-20 @ 9:00 am	< 0.3	2024-12-21
11462935	STAGE NORTH	2024-12-17 @ 8:00 am	2024-12-20 @ 9:00 am	0.7 ± 0.3	2024-12-21
11462936	STAGE SOUTH	2024-12-17 @ 8:00 am	2024-12-20 @ 9:00 am	0.6 ± 0.3	2024-12-21
11462968	TICKET BOOTH	2024-12-17 @ 9:00 am	2024-12-20 @ 9:00 am	0.6 ± 0.3	2024-12-21

---

January 15, 2025

**\*\* LABORATORY ANALYSIS REPORT \*\***

---

Radon test result report for:

**BUFFALO\_HANOVER\_MONTROSE SCHOOLS**  
**BUFFALO HIGH SCHOOL**

---

<b>Kit #</b>	<b>Room Id</b>	<b>Started</b>	<b>Ended</b>	<b>pCi/L</b>	<b>Analyzed</b>
11382824	OSTORAGE ROOM A	2024-12-17 @ 2:00 pm	2024-12-20 @ 3:00 pm	< 0.3	2024-12-21
11382826	OSTORAGE ROOM B	2024-12-17 @ 2:00 pm	2024-12-20 @ 3:00 pm	< 0.3	2024-12-21
11382831	OSTORAGE ROOM C	2024-12-17 @ 2:00 pm	2024-12-20 @ 3:00 pm	< 0.3	2024-12-21

---

Air Chek 1936 Butler Bridge Rd, Mills River, NC 28759-3892 Phone: (828) 684-0893 Fax: (828) 684-8498

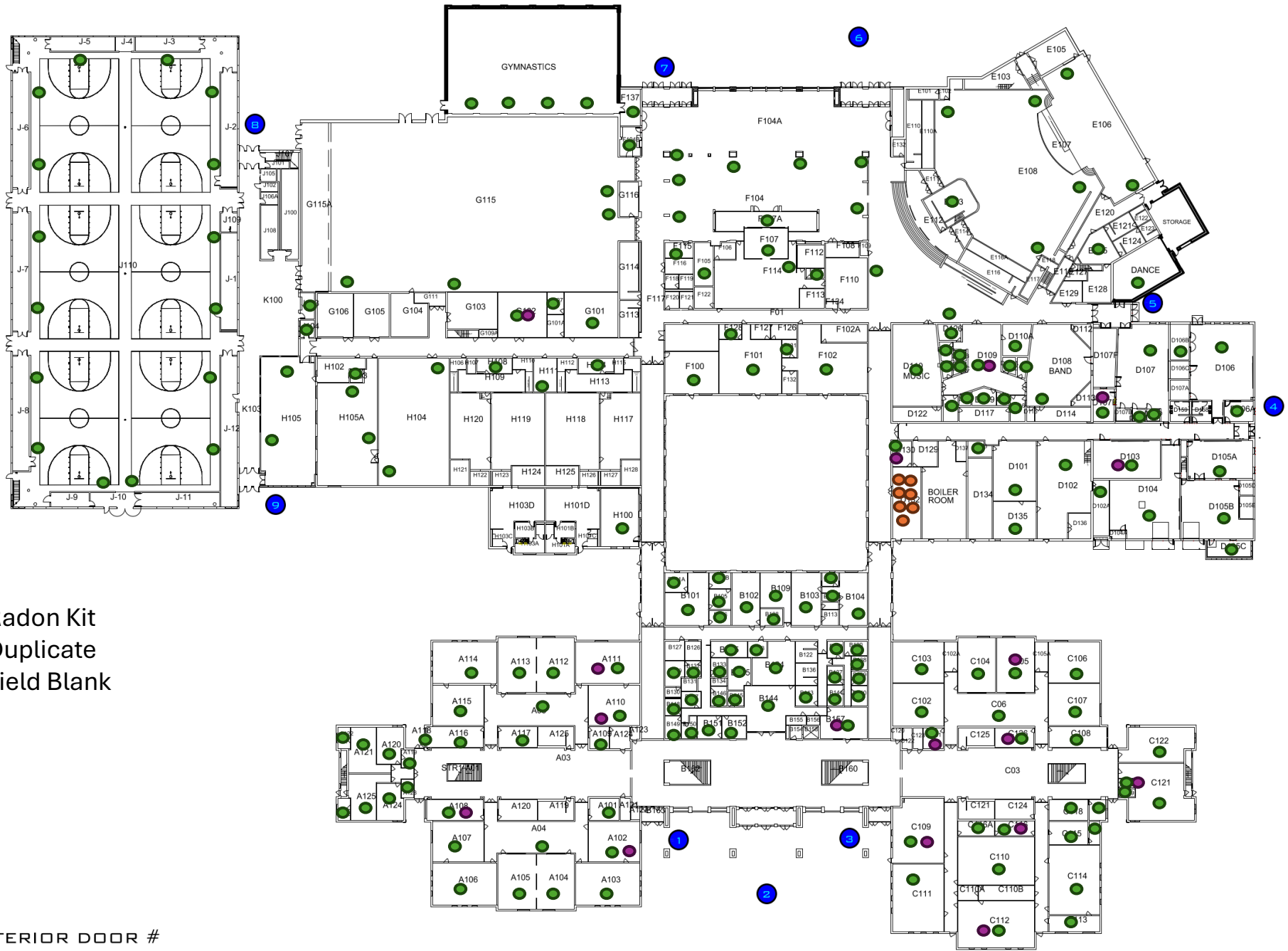

- Radon Kit
- Duplicate
- Field Blank

# EXTERIOR DOOR #



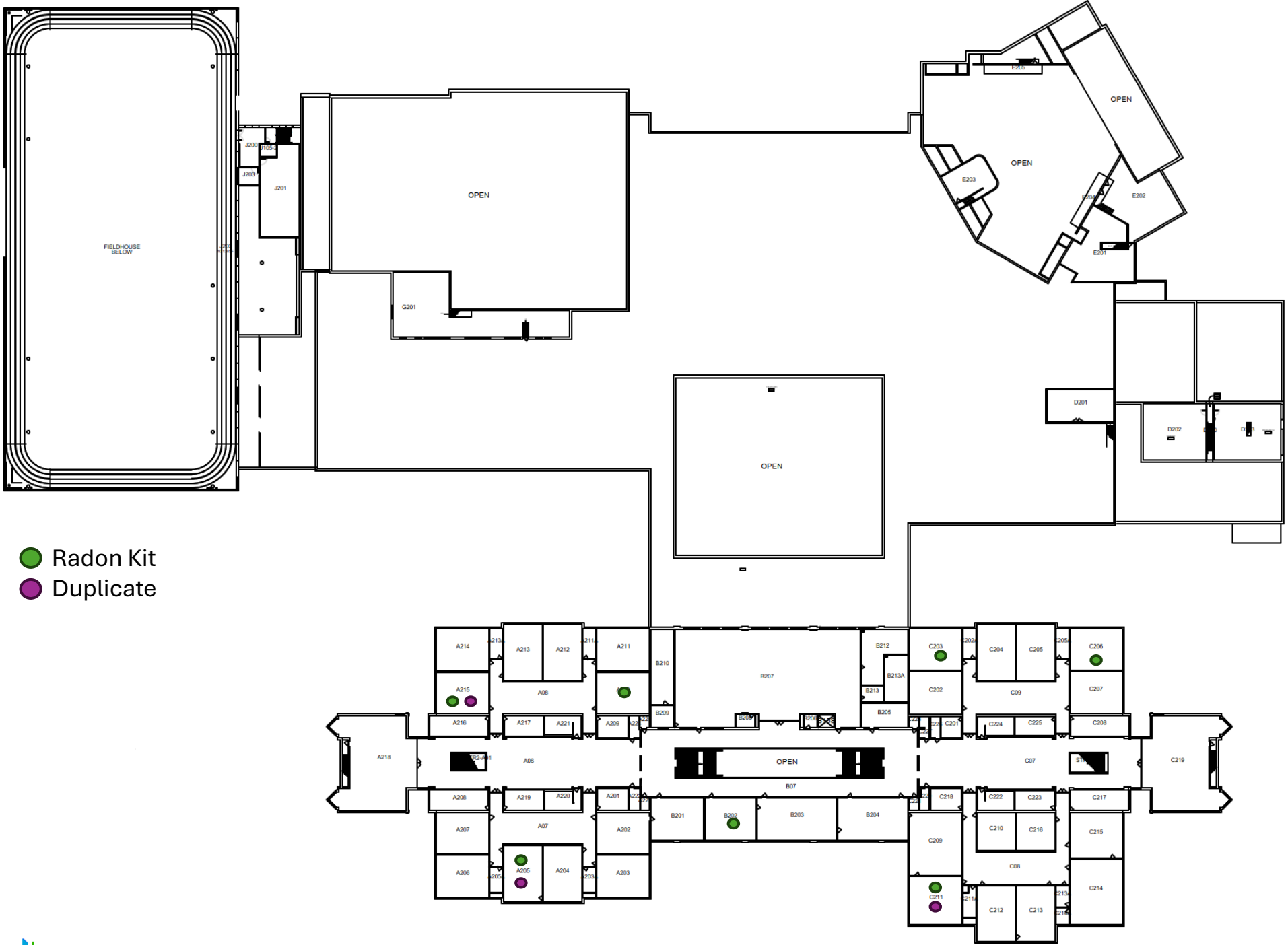

- Radon Kit
- Duplicate



# **Appendix C**

*Signed Non-Interference Agreement*

*and*

*Client Commitments, Advisories, and Authorizations*



# NOTICE OF INSPECTION FOR ALL FACILITATING STAFF

A radon test is scheduled for:

Building: Buffalo High School

Test Start Date: 12-17-2024

Test End Date: 12-20-2024

Please help to maintain the required test conditions throughout the building

1. All windows and exterior doors must be kept closed (aside from momentary entry or exit) for 12 hours before and during the test.
2. Heating and cooling systems must be set to normal occupied operating temperatures.
3. Test devices are not to be disturbed.

Further guidance on required building conditions are located on the next page.

Test devices are not dangerous in any way. The type of devices used for this testing will include:

**Short-term test kits.** It is important that these devices are fully open and not covered. They will be analyzed by a laboratory.

**Continuous radon monitors.** These are electronic devices that record hourly radon readings.

**Long-term test kits.** It is important that these devices are not covered. They will be analyzed by a laboratory.

Declaration of Observed Compliance

Failure to reasonably maintain test conditions can lead to unnecessary expense, disruptions and unreliable data.

Disturbing test devices can also cause unreliable or invalid test results.

- Please report in a timely manner if required test conditions are not maintained.
- Please sign and return this form once the test is complete.

To the best of my knowledge, the required conditions were maintained during the test.

Yes

Name:

Troy Beise

Signature:



Licensed Measurement Professional:

Sashya Wandmaker RMEA-00470

# NOTICE OF INSPECTION FOR ALL FACILITATING STAFF

A radon test is scheduled for:

Building: Buffalo High School

Test Start Date: 01-07-2025

Test End Date: 01-10-2025

Please help to maintain the required test conditions throughout the building

1. All windows and exterior doors must be kept closed (aside from momentary entry or exit) for 12 hours before and during the test.
2. Heating and cooling systems must be set to normal occupied operating temperatures.
3. Test devices are not to be disturbed.

Further guidance on required building conditions are located on the next page.

Test devices are not dangerous in any way. The type of devices used for this testing will include:

**Short-term test kits.** It is important that these devices are fully open and not covered. They will be analyzed by a laboratory.

**Continuous radon monitors.** These are electronic devices that record hourly radon readings.

**Long-term test kits.** It is important that these devices are not covered. They will be analyzed by a laboratory.

Declaration of Observed Compliance

Failure to reasonably maintain test conditions can lead to unnecessary expense, disruptions and unreliable data.

Disturbing test devices can also cause unreliable or invalid test results.

- Please report in a timely manner if required test conditions are not maintained.
- Please sign and return this form once the test is complete.

To the best of my knowledge, the required conditions were maintained during the test.

Yes

Name:

Troy Biese

Signature:



Licensed Measurement Professional:

Jack Skluzacek RMEA-00475

## COMMITMENTS, ADVISORIES, AND AUTHORIZATIONS

I have been informed of test plan options that comply with ANSI/AARST MALB 2014 with 1/2021 Revisions.

To the extent reasonably possible, I commit to helping ensure that building conditions required to achieve reliable radon tests are met, as portrayed herein, by accepting the following responsibilities:

1. **BUILDING PREPARATION:** I accept responsibility that, no later than 12 hours prior to testing, each building scheduled for testing will be reviewed for compliance with closed-building requirements.
2. **COMPLIANCE VERIFICATION:** I accept responsibility for taking actions that could include adjustments to HVAC units and repairs, such as for broken windows, where completion is required no later than 12 hours prior to testing. Verification will be provided as signed/initialed below or initialed on a log sheet, to be provided.
3. **PRIOR NOTIFICATIONS:** Notices will be distributed to all tested, non-tested dwellings and posted in publicly accessible areas such as in corridors, elevators and offices in a timely manner, no later than required by local law for gaining access to a dwelling or not later than the day before testing.
4. **ACCESS:** Access will be provided to each location being tested within a building, with intent to access all locations within a building on the same day for both the event of placing test devices, and a second event for retrieving test devices.

A valid measurement at all test locations in each building is required. There is a possibility of delays and additional expense when test locations are not readily accessible or where requirements for *closed-building conditions* are not observed.

Client: BHM Schools ISD #877

Building: Buffalo High School

Name: Tim Helppi - Director of Buildings and Grounds

Signature: 

Date: 01/06/2025

# **Appendix D**

*Average Building Operating Conditions Comparison*

Climate Zone 6 (includes Southern MN)



		Annual Averages			During the Test
		24 Hour	Daytime	Daytime 9-Month	Prevailing During the Test
<b>Operating Condition</b>	Outdoor Temperature and Weather Conditions	45 °F	50 °F	N/A	Average: 18 °F Minimum: -5 °F Maximum: 29 °F
	Heating Conditions	75%	66%	88%	100%
	Cooling Conditions	-	16%	11%	0%
	Mixed Conditions	25%	16%	-	0%
<b>Normal Operating Condition</b>		<ul style="list-style-type: none"> <li>• Heating conditions</li> <li>• No variance in outdoor air ventilation</li> </ul>			<ul style="list-style-type: none"> <li>• Heating conditions</li> <li>• No variance in outdoor air ventilation</li> <li>• Snow or ice present outdoors</li> </ul>
<b>Condition less likely to inhibit characterization of a radon hazard</b>		<ul style="list-style-type: none"> <li>• Heating and air distribution systems active</li> </ul>			<ul style="list-style-type: none"> <li>• Heating and air distribution systems active</li> </ul>

# **Appendix E**

*MDH Reporting Form*

# School Radon Testing Reporting Form

According to Minnesota Statute 123B.571 subd. 3, a school district that has tested its school buildings for the presence of radon shall report the results of its tests to the Department of Health. Please use this form to submit information about the most recent round or cycle of testing conducted for each building.

## Instructions

1. Complete one form for each building tested. In this case, a building is defined as an occupied facility with a unique address. This includes administrative buildings.
2. Include this form, raw data (e.g. laboratory report) and a building map.
3. Submit this form when all work is completed for a round of testing. This includes reporting to the school board, and follow-up testing and post-mitigation testing, if applicable.
4. Email information to [health.indoorair@state.mn.us](mailto:health.indoorair@state.mn.us).

## Contact Information

(Submitting this report)

Name \_\_\_\_\_

Mailing Address \_\_\_\_\_

Phone \_\_\_\_\_ Email \_\_\_\_\_

## Person(s) Deploying or Retrieving Test Devices<sup>1</sup>

Name \_\_\_\_\_ Organization/Company \_\_\_\_\_

Name \_\_\_\_\_ Organization/Company \_\_\_\_\_

Name \_\_\_\_\_ Organization/Company \_\_\_\_\_

## School Board Reporting

Were all the results reported at a school board meeting?      Yes      No

\_\_\_\_\_

<sup>1</sup> List all individuals that deployed (placed) or retrieved (picked up) test devices including initial, follow-up, and post-mitigation testing. Additional names can be added to notes at end of this form.

## Initial Radon Testing

School Building Name \_\_\_\_\_

School District & District Number \_\_\_\_\_

Building Address \_\_\_\_\_

Test Kit Manufacturer \_\_\_\_\_ Device name \_\_\_\_\_

Date of Kit Retrieval (MM/DD/YY) \_\_\_\_\_ Length of Test (days) \_\_\_\_\_

How many rooms were tested? \_\_\_\_\_

Does the test period include weekends?                      Yes      No

Does the test period include school breaks or holidays?                      Yes      No

Was HVAC operating under occupied conditions?                      Yes      No

Were test devices deployed in all occupied and intended to be occupied rooms in contact with the ground, and, if applicable, 10% of upper floor rooms?                      Yes      No

Were valid measurements obtained in all occupied and intended to be occupied rooms in contact with the ground, and, if applicable, 10% of upper floor rooms?<sup>2</sup>                      Yes      No

If no, were all results obtained under 2.0 pCi/L **and** were there sufficient valid measurements obtained that allowed for no further testing?<sup>3</sup>                      Yes      No

How many rooms had results  $\geq 4$  pCi/L? \_\_\_\_\_

---

<sup>2</sup> This includes rooms, offices, classrooms, and other general use areas. Ground contact means: 1) rooms that have floors or walls in contact with the ground; and 2) rooms that are closest to the ground over untested ground-contact locations, such as a crawl space, utility tunnel, parking garage and other non-habitable space that is in contact with ground. Intended to be occupied rooms are locations where there are plans to occupy rooms even though they are unoccupied at the time of the testing. In addition, if the building has upper floors, at least 10% of these rooms must be tested.

<sup>3</sup> Section 6.2 of the ANSI/AARST standard allows for a specific small number of invalid measurements (e.g., test kits missing, damaged, etc) if all the valid test results were under 2.0 pCi/L. Review this section of the standard and evaluate how many rooms needed testing and how many had valid results. If there were too many invalid results, this means additional testing was required in these locations and answer this question as 'no'.



## Follow-up Testing, Mitigation, & Post-Mitigation Testing

If one or more rooms tested  $\geq 4$  pCi/L, please answer the questions below.

How many rooms had follow-up testing? \_\_\_\_\_

Number of rooms with follow-up results:

$\geq 4$  pCi/L \_\_\_\_\_  $< 4$  pCi/L \_\_\_\_\_

Of the rooms that had test results  $\geq 4$  pCi/L, how many rooms were:

mitigated by diluting or pressurizing the soil or indoor air

(not active soil depressurization)? \_\_\_\_\_

mitigated by installing active soil depressurization system(s)? \_\_\_\_\_

reduced by adjusting the HVAC system? \_\_\_\_\_

Individual who installed mitigation

Name \_\_\_\_\_ Organization/Company \_\_\_\_\_

What was the cost of the installation and/or HVAC service work, to mitigate radon? \_\_\_\_\_

What is the known or anticipated annual operating cost of mitigation (estimate)? \_\_\_\_\_

After radon mitigation, how many rooms were re-tested?<sup>4</sup> \_\_\_\_\_

Post-mitigation results (# of rooms):

$\geq 4$  pCi/L \_\_\_\_\_  $< 4$  pCi/L \_\_\_\_\_

### Notes

Minnesota Department of Health | Environmental Health | Indoor Air Unit

[health.indoorair@state.mn.us](mailto:health.indoorair@state.mn.us)

[www.health.state.mn.us](http://www.health.state.mn.us)

June 2021

To obtain this information in a different format, call: 651-201-4601.

---

<sup>4</sup> The building must be tested, to verify reduction and ensure mitigation has not increased radon in rooms that used to be low.