

# ADDITION TO EAST: 2-STORY 4 CLASSROOM SINGLE LOADED CORRIDOR

EXISTING CLASSROOM COUNT:	AFTER ADDITION AND RENO:
GENERAL CLASSROOM (#): 22	26
KINDERGARTEN (K): 5	5
SPECIAL ED (SP): 2	2
<b>TOTAL:</b>	<b>33</b>

COLOR KEY:	NEW CONSTRUCTION AREA:	RENOVATION AREA:
<span style="background-color: #ADD8E6; border: 1px solid black; display: inline-block; width: 15px; height: 10px;"></span> NEW CLASSROOM	4,000 SF	
<span style="background-color: #ADD8E6; border: 1px solid black; display: inline-block; width: 15px; height: 10px;"></span> RENOVATED CLASSROOM		2,200 SF
<span style="background-color: #90EE90; border: 1px solid black; display: inline-block; width: 15px; height: 10px;"></span> NEW KINDERGARTEN CLASSROOM		
<span style="background-color: #90EE90; border: 1px solid black; display: inline-block; width: 15px; height: 10px;"></span> RENOVATED KINDERGARTEN CLASSROOM		
<span style="background-color: #DDA0DD; border: 1px solid black; display: inline-block; width: 15px; height: 10px;"></span> NEW SPECIAL EDUCATION		
<span style="background-color: #DDA0DD; border: 1px solid black; display: inline-block; width: 15px; height: 10px;"></span> RENOVATED SPECIAL EDUCATION		1,000 SF
<span style="background-color: #FFDAB9; border: 1px solid black; display: inline-block; width: 15px; height: 10px;"></span> RENOVATED ADMIN OFFICE		
<span style="background-color: #FFFF00; border: 1px solid black; display: inline-block; width: 15px; height: 10px;"></span> NEW CORRIDOR	2,535 SF	
<span style="background-color: #D3D3D3; border: 1px solid black; display: inline-block; width: 15px; height: 10px;"></span> NEW STORAGE OR OFFICE	250 SF	
<span style="background-color: #D3D3D3; border: 1px solid black; display: inline-block; width: 15px; height: 10px;"></span> NEW TOILET		400 SF
<span style="background-color: #90EE90; border: 1px solid black; display: inline-block; width: 15px; height: 10px;"></span> NEW ROOF GARDEN		
<b>TOTAL AREA:</b>	<b>6,785 SF</b>	<b>3,600 SF</b>

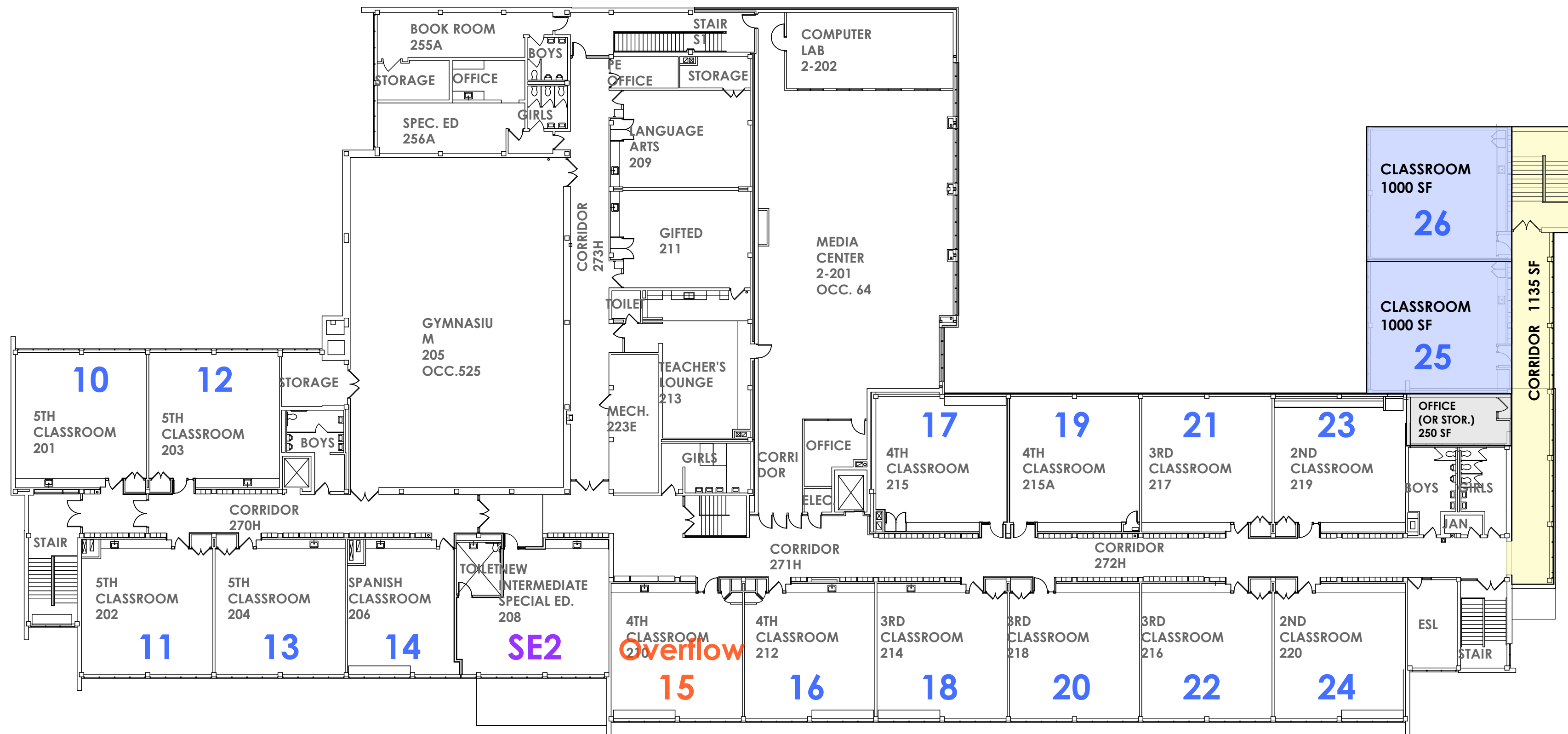

**SECOND FLOOR PLAN**

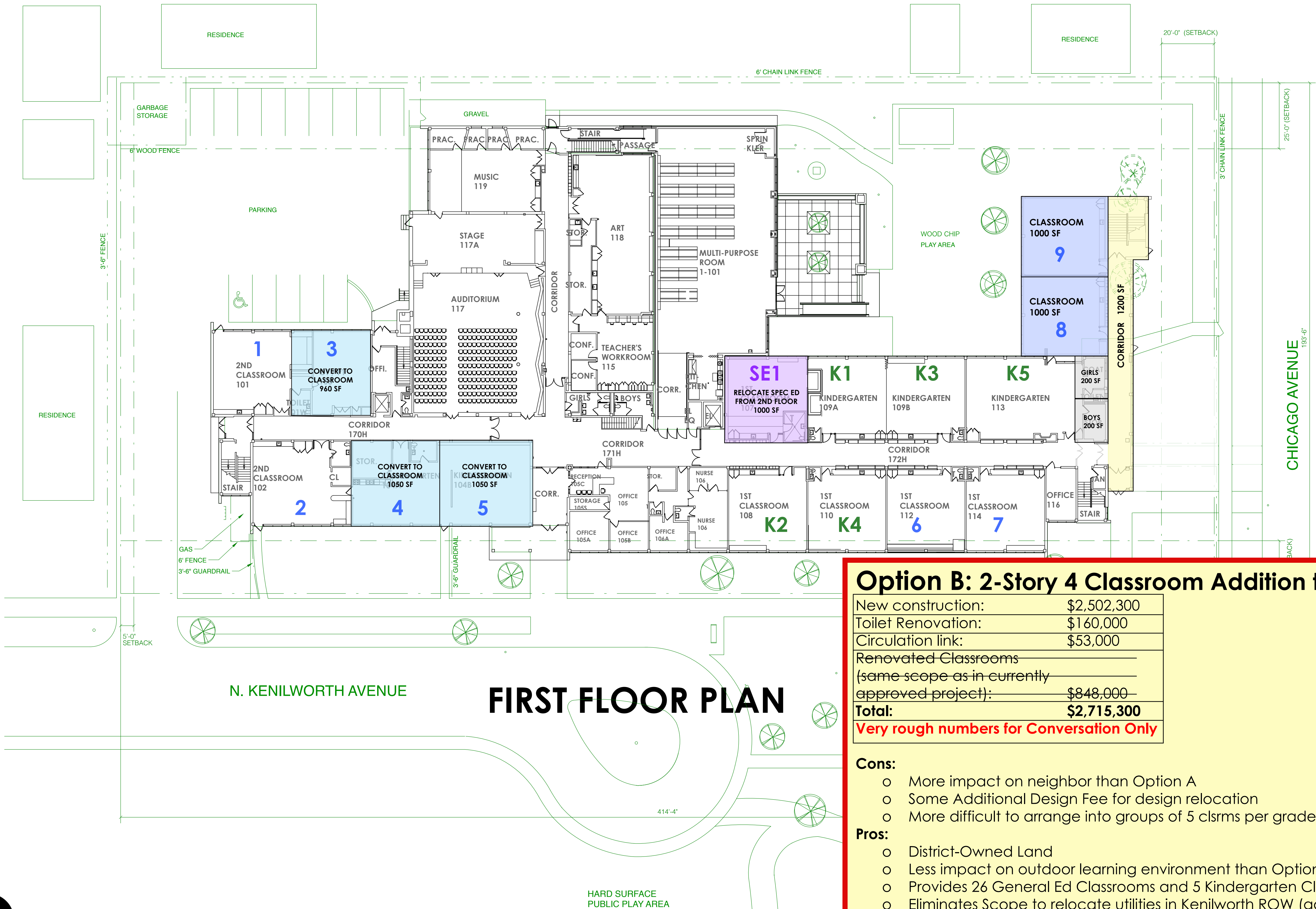

**FIRST FLOOR PLAN**

Option B: 2-Story 4 Classroom Addition to East	
New construction:	\$2,502,300
Toilet Renovation:	\$160,000
Circulation link:	\$53,000
Renovated Classrooms (same scope as in currently approved project):	\$848,000
<b>Total:</b>	<b>\$2,715,300</b>
<b>Very rough numbers for Conversation Only</b>	

- Cons:**
- More impact on neighbor than Option A
  - Some Additional Design Fee for design relocation
  - More difficult to arrange into groups of 5 clsrms per grade
- Pros:**
- District-Owned Land
  - Less impact on outdoor learning environment than Option A
  - Provides 26 General Ed Classrooms and 5 Kindergarten Classrooms
  - Eliminates Scope to relocate utilities in Kenilworth ROW (gas, water, communications, and required concrete encasing of sewer line) - Estimate has not taken this into account yet.
  - Provides buffer between classrooms and Chicago Ave with corridor

**B**