

Denton ISD Elementary School Prototype  
 Board Meeting  
 11.01.22



# VISIONING PROCESS

**Why and how the committee was formed?**



# VISIONING PROCESS

What was the goal of the process?

**In 2042, learning and teaching is...**

I THINK THE EDUCATIONAL ENVIRONMENT SHOULD BE FLEXIBLE TO MANAGE THE CHANGES WE DON'T EVEN RECOGNIZE TODAY. ALSO, THE LEARNING ENVIRONMENT NEEDS TO BE FOCUSED ON MEETING OUR STUDENTS IN THEIR SPACE AND NOT OUR OWN. GOOD LUCK WHO BUT YOU ARE SATT

**In 2042, learning and teaching is...**

based on the belief that all learners have a variety of strengths that leveraged + developed. Educators have the autonomy (+ skills) to differentiate learning pathways so that students ~~are~~ have both successful + meaningful "set-backs" all in the name of lifelong learning. Students + teachers are empowered to identify areas of need in the school community + to take steps towards improvement.

**In 2042, learning and teaching is...**

- Students will be learning in teams
- Curriculum will be organized in an integrated formula
- Sts will learn based on (a) their interests and focus a career (b) allowed to explore additional areas
- Community member partnerships will be evident in all schools - more career-minded teaching & learning taking place
- All classrooms will be learning labs and open to observation by other sts, teachers, community, parents, university staff • Diverse learners

**In 2042, learning and teaching is...**

- Connecting learners virtually across different countries and expanding worldviews/opportunities.
- Tech focused CTE programs
- Educators as guides
- Environment /space equipped for VR + AR
- Constantly adapting

**In 2042, learning and teaching is...**

- Students will be learning in teams
- Curriculum will be organized in an integrated formula
- Sts will learn based on (a) their interests and focus a career (b) allowed to explore additional areas
- Community member partnerships will be evident in all schools - more career-minded teaching & learning taking place
- All classrooms will be learning labs and open to observation by other sts, teachers, community, parents, university staff • Diverse learners

**In 2042, learning and teaching is...**

- Connecting learners virtually across different countries and expanding worldviews/opportunities.
- Tech focused CTE programs
- Educators as guides
- Environment /space equipped for VR + AR
- Constantly adapting

ASPIRATIONS

HIGHEST ASPIRATIONS

- ① OPTIONS & OPPORTUNITIES
- ② SAFE AND COMFORTABLE
- ③ PREPARED FOR DREAMS
- ④ HAVE LOVE OF LEARNING
- ⑤ MAKE POSITIVE CHANGE
- ⑥ FIND WAYS TO BE INSPIRED
- ⑦ EXPERIENCES THAT CHANGE TRAJECTORY
- ⑧ BUILDING MEETS NEEDS
- ⑨ SEE THEMSELVES AS LEARNERS
- ⑩ SATISFIED TEACHERS/STUDENTS SMILING KIDS! ④

- ① SPACES THAT ARE LIMITLESS
- ② SCHOOLS THAT ARE WELCOMING
- ③ MOTIVATED, INSPIRED, ENGAGED
- ④ TEACHERS HAVE TOOLS/RESOURCES
- ⑤ LIFELONG LEARNERS
- ⑥ EQUITY OF ACCESS AND OPPORTUNITY
- ⑦ ENVIRONMENT WHERE ALL CAN EXCEL
- ⑧ PROBLEM FINDERS + SOLVERS
- ⑨ CRITICAL THINKERS
- ⑩ STUDENTS THAT GIVE BACK
- ⑪ FLEXIBLE LEARNING SPACES
- ⑫ DIFFERENT SCALES INTERIOR & EXTERIOR

⑤

# VISIONING PROCESS

How did the Profile of a Graduate guide the planning process?

## College, Career and Life Ready



# VISIONING PROCESS

## What are Findings and Directions?

We believe....

Therefore we will...

THE ELEMENTARY LEARNER	
FINDINGS	DIRECTIONS
<p><i>We believe...</i> It is essential for our elementary learner to be inspired to retain and expand upon their competence, confidence, and curiosity</p>	<p><i>Therefore, we will...</i></p> <ul style="list-style-type: none"> <li>• ENSURE THAT FACULTY IS PROPERLY TRAINED TO PROVIDE FOR COMPETENCE, CONFIDENCE AND CURIOSITY EXPECTED OF LEARNERS WITHIN THE DISTRICT</li> <li>• INSTRUCTION WILL BE IMPLEMENTED IN A MANNER THAT PROVIDES FOR POSITIVE CHANGE, GIVING BACK, DEVELOPING PROBLEM SEEKERS/SOLVERS RELEVANT TO THE WORLD AROUND THEM.</li> </ul>
<p>It is essential for our learners to be independent, creative, collaborative, critical thinkers connected to the world around them</p>	<ul style="list-style-type: none"> <li>• PROVIDE ACCESS TO A VARIETY OF RESOURCES, FLEXIBLE SPACES (POSSIBLY ACROSS GRADE LEVELS)               <ul style="list-style-type: none"> <li>○ SPACES PROVIDE FOR FLEXIBLE LEARNING OPPORTUNITIES THROUGHOUT OUR FUTURE ELEMENTARY SCHOOLS</li> </ul> </li> <li>• STUDENTS WILL BE AWARE OF FUTURE OPPORTUNITIES EVEN AT THE ELEMENTARY LEVEL</li> </ul>

STUDENT DRIVEN LEARNING	
FINDINGS	DIRECTIONS
<p><i>We believe...</i> Student driven learning is essential in creating motivated, inspired, and engaged individuals who become critical thinkers and problem solvers.</p>	<p><i>Therefore, we will...</i></p> <ul style="list-style-type: none"> <li>• PROVIDE OPPORTUNITIES FOR STUDENTS TO FACILITATE THEIR OWN LEARNING.</li> <li>• PROVIDE LEARNING EXPERIENCES THAT ALLOW STUDENT CHOICE.</li> <li>• ENSURE STUDENTS KNOW WHAT THEY ARE LEARNING AND WHY.</li> <li>• CREATE A CULTURE WHERE STUDENTS VALUE FAILURES AND SEE THEM AS PART OF THE LEARNING PROCESS</li> <li>• EQUIP STAFF WITH ON-GOING PROFESSIONAL DEVELOPMENT TO SUPPORT STUDENT DRIVEN LEARNING.</li> <li>• CREATE LEARNING SPACES THAT PROMOTE STUDENT OWNERSHIP</li> </ul>

# VISIONING PROCESS

What does this building want to look and feel like?



# VISIONING PROCESS

How did the Findings and Directions impact the program of spaces?

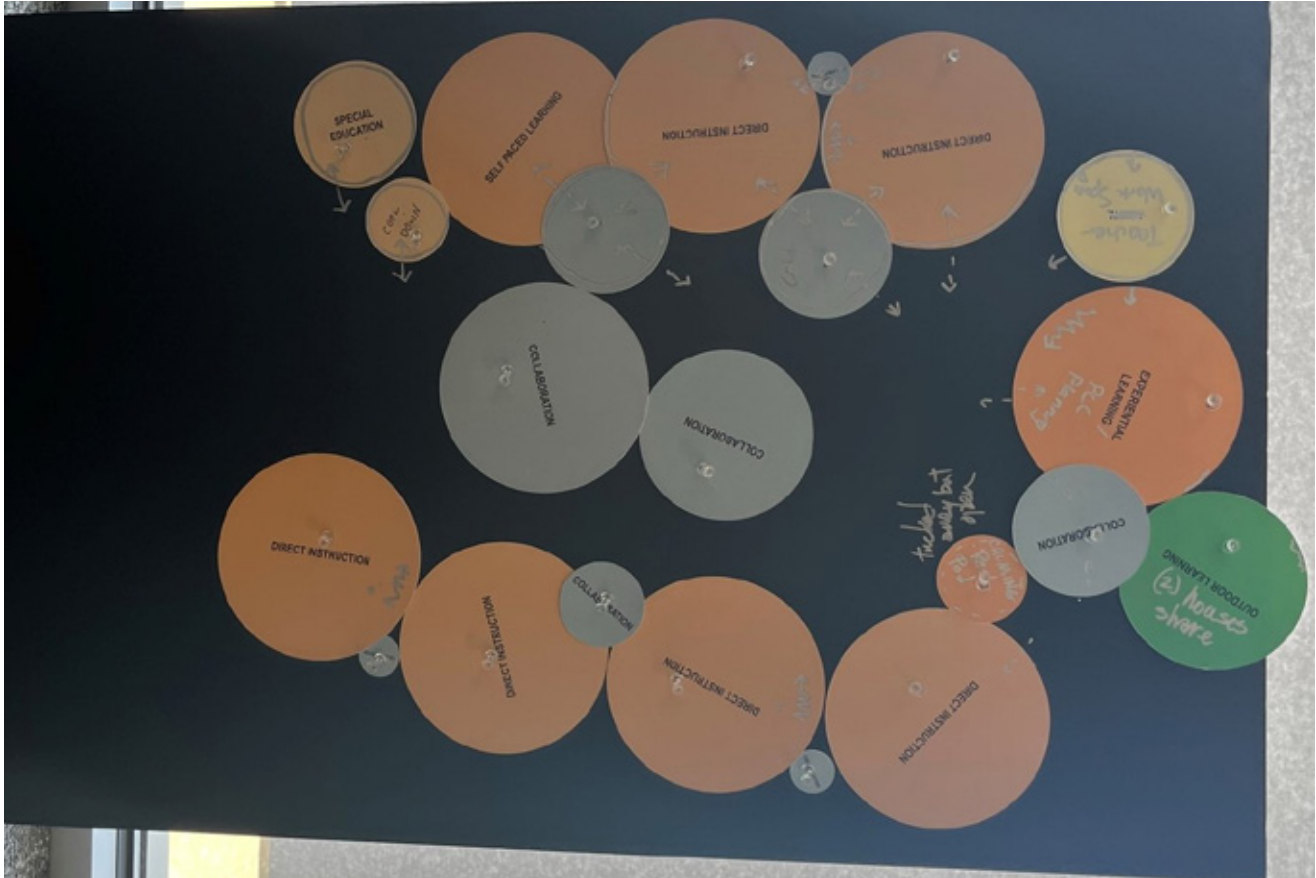

# VISIONING PROCESS

How do the Findings and Directions and Profile of a Graduate guide the building organization?

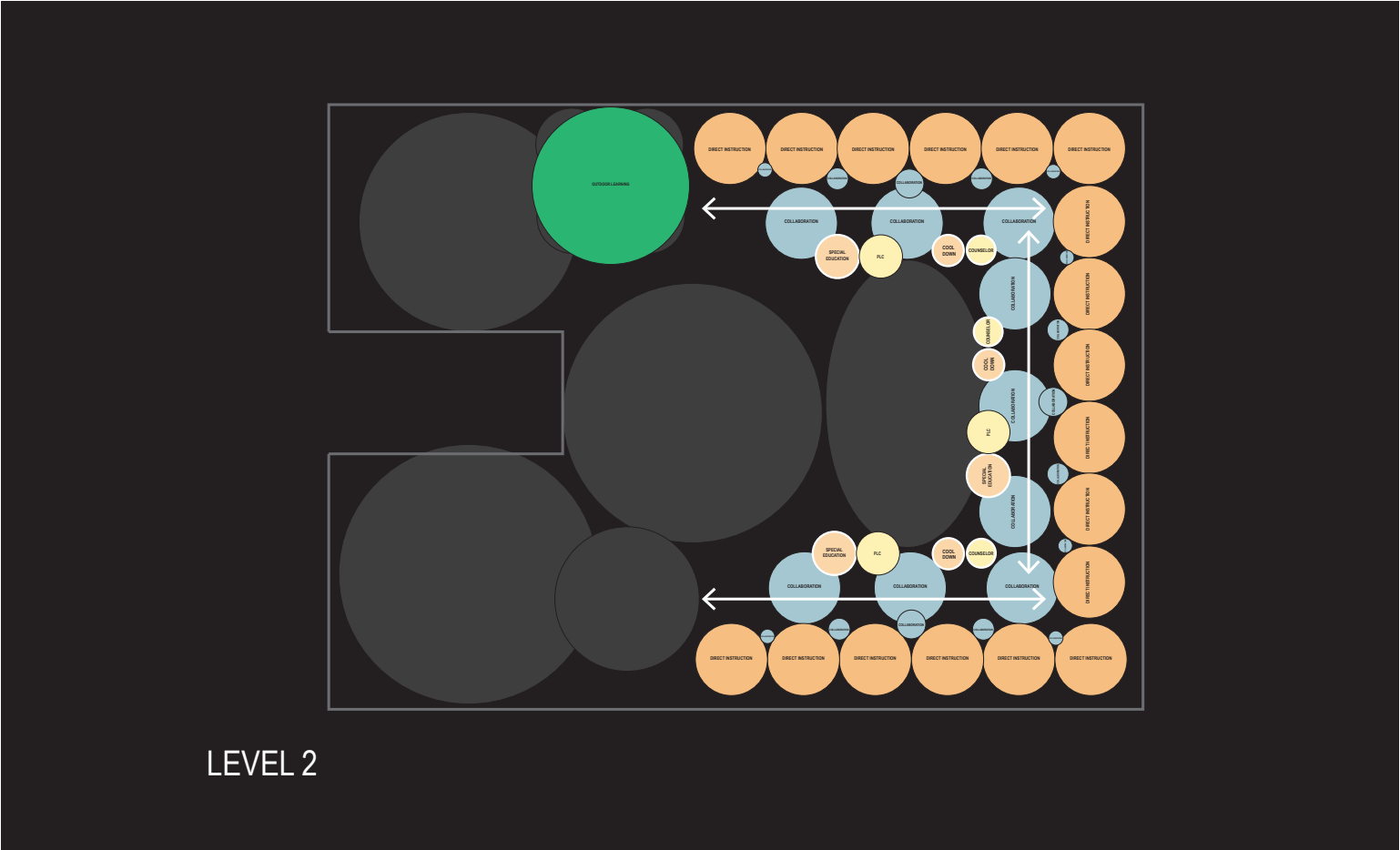
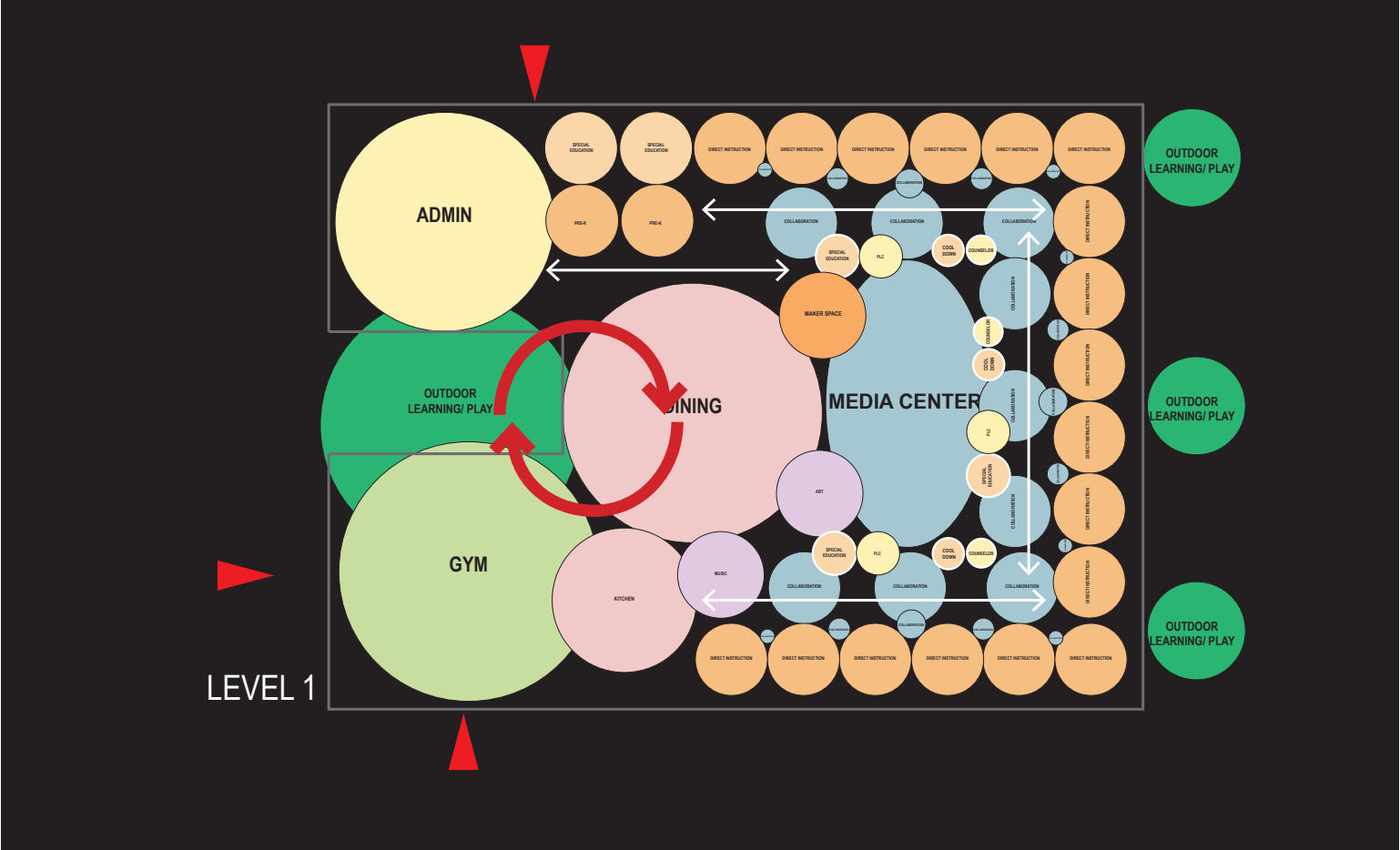



# VISIONING PROCESS

## **Mission Statement**

Empowering lifelong learners to be engaged citizens who positively impact their local and global community

## **Guiding Principles**

1. Create active, flexible, inclusive learning experiences and make learning fun.
2. Provide open spaces so that learning is visible everywhere but limit disruption to others.
3. Integrate environmental safety levels into the design.
4. Ensure that equitable resources are provided to all students and staff.
5. Aesthetics should be geared toward the specific needs /wants /wishes of the community.
6. Provide opportunities for students to facilitate their own learning and allow them to have their own choices.



**THE HUB**

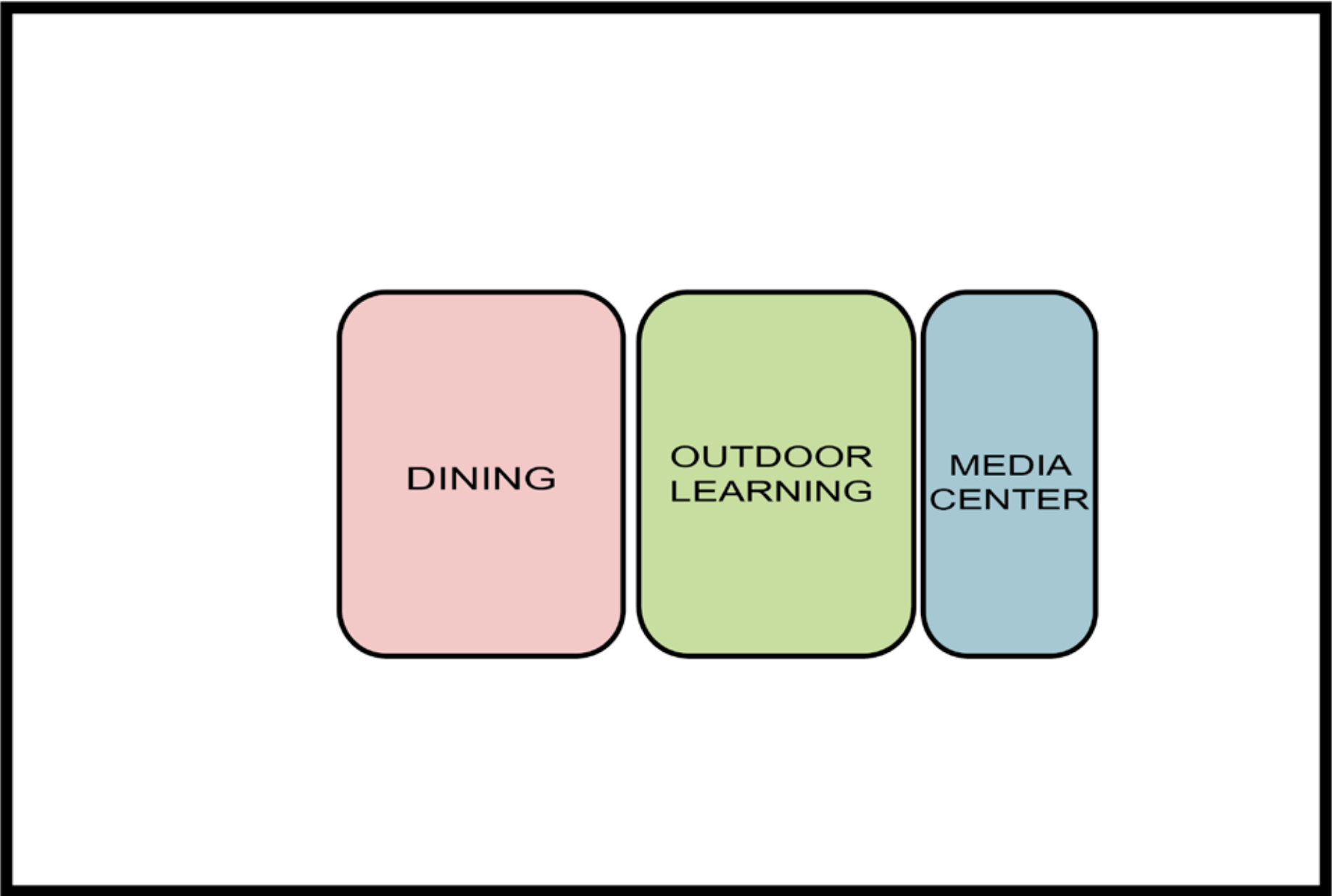

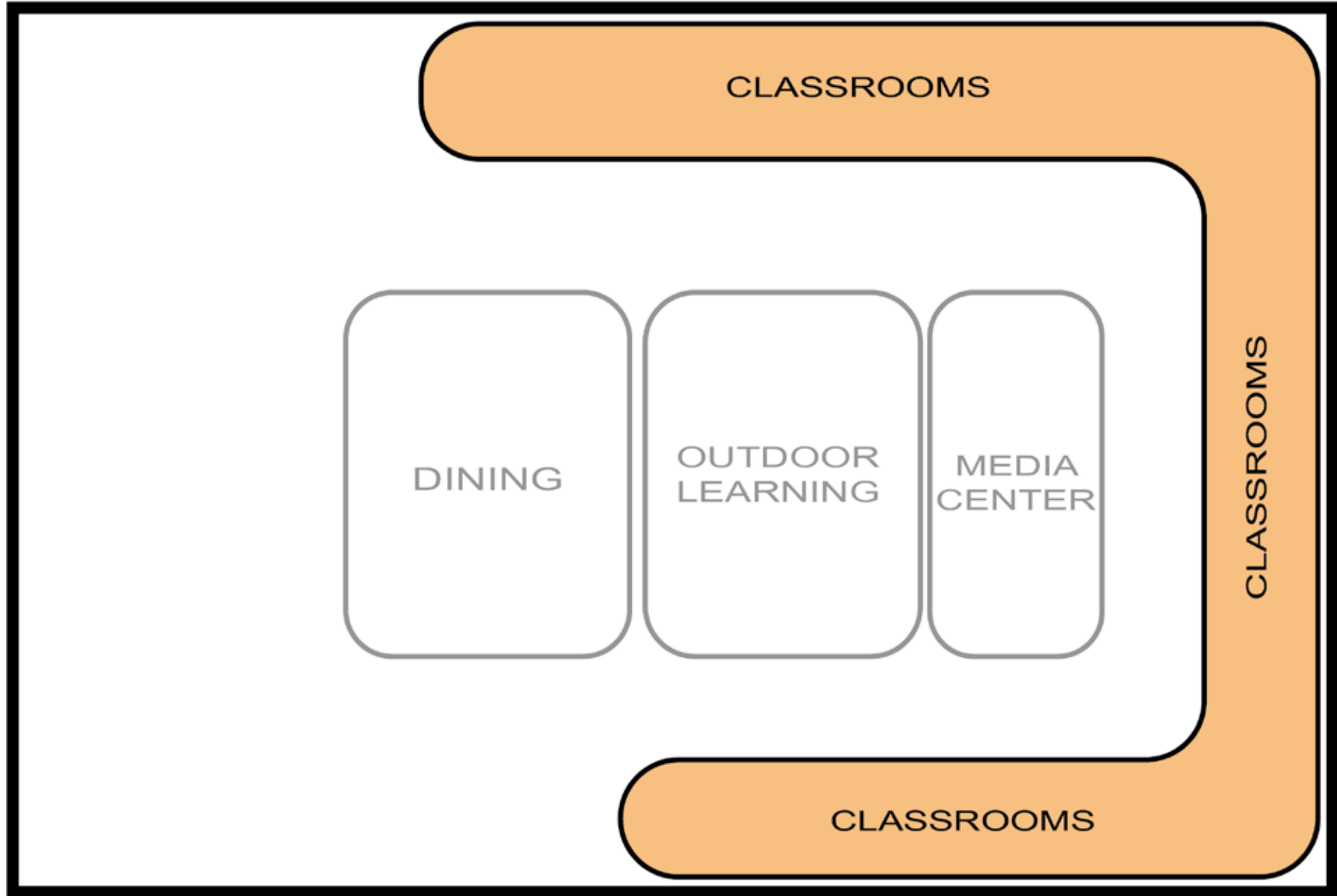

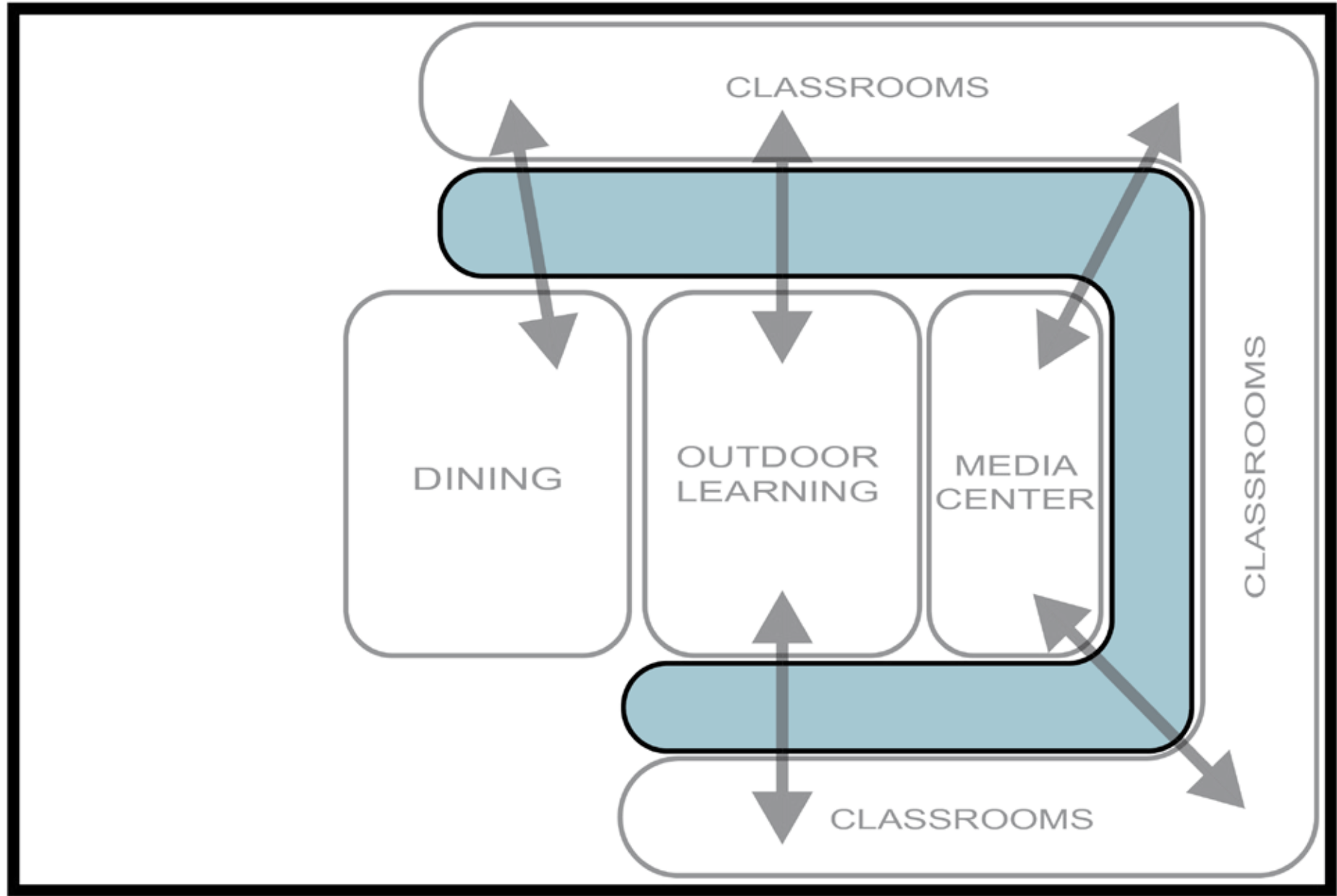

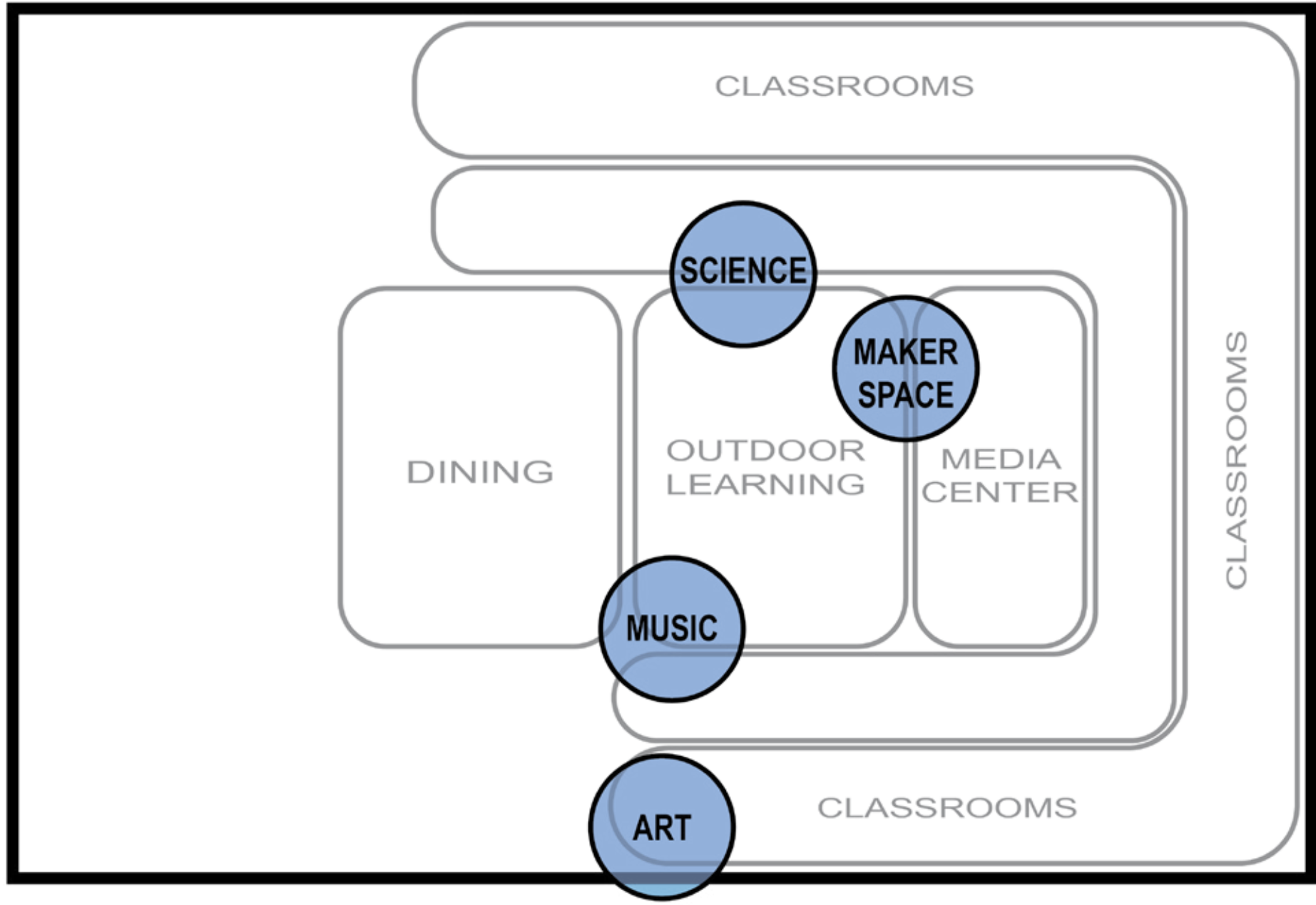

MAIN ENTRY

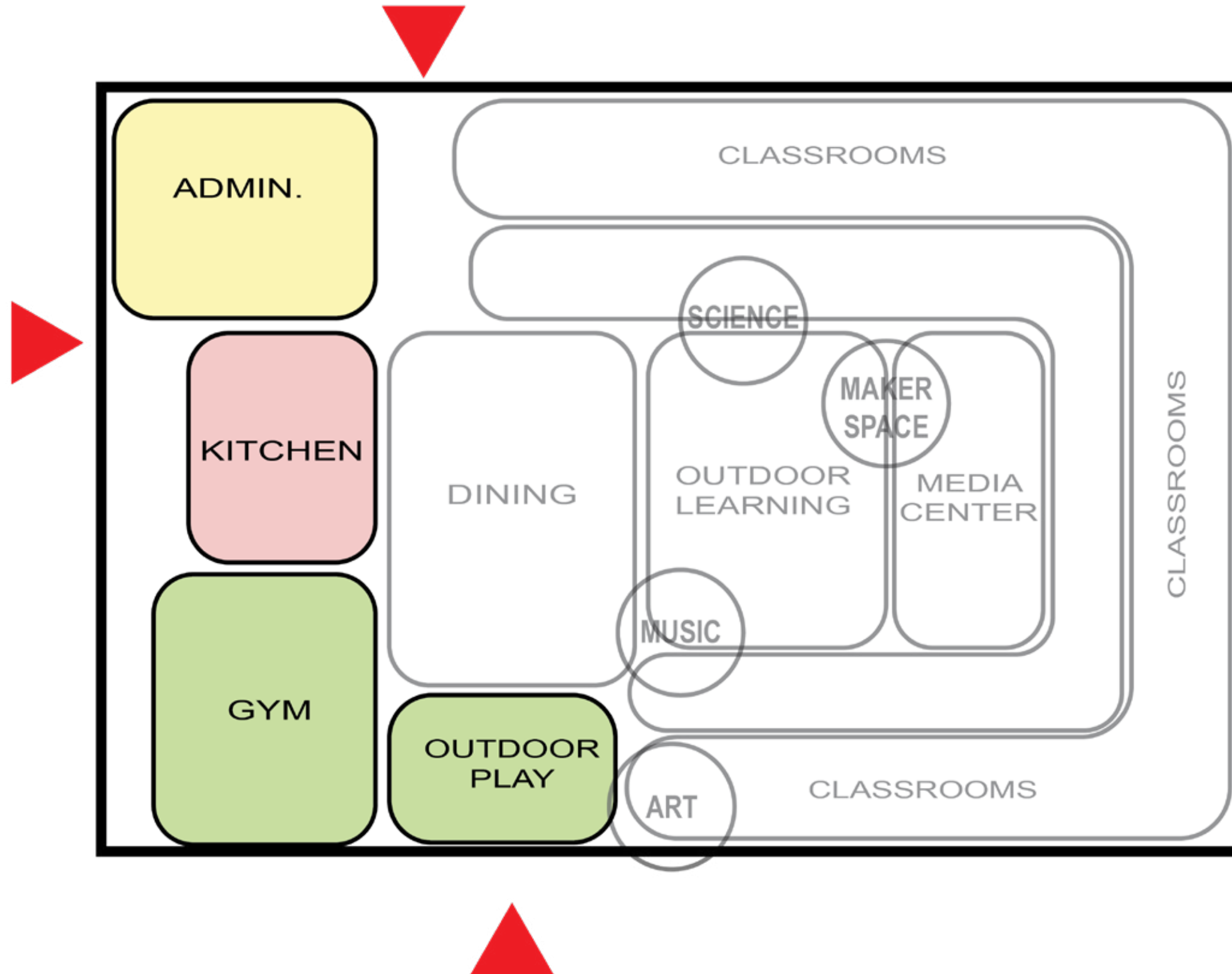

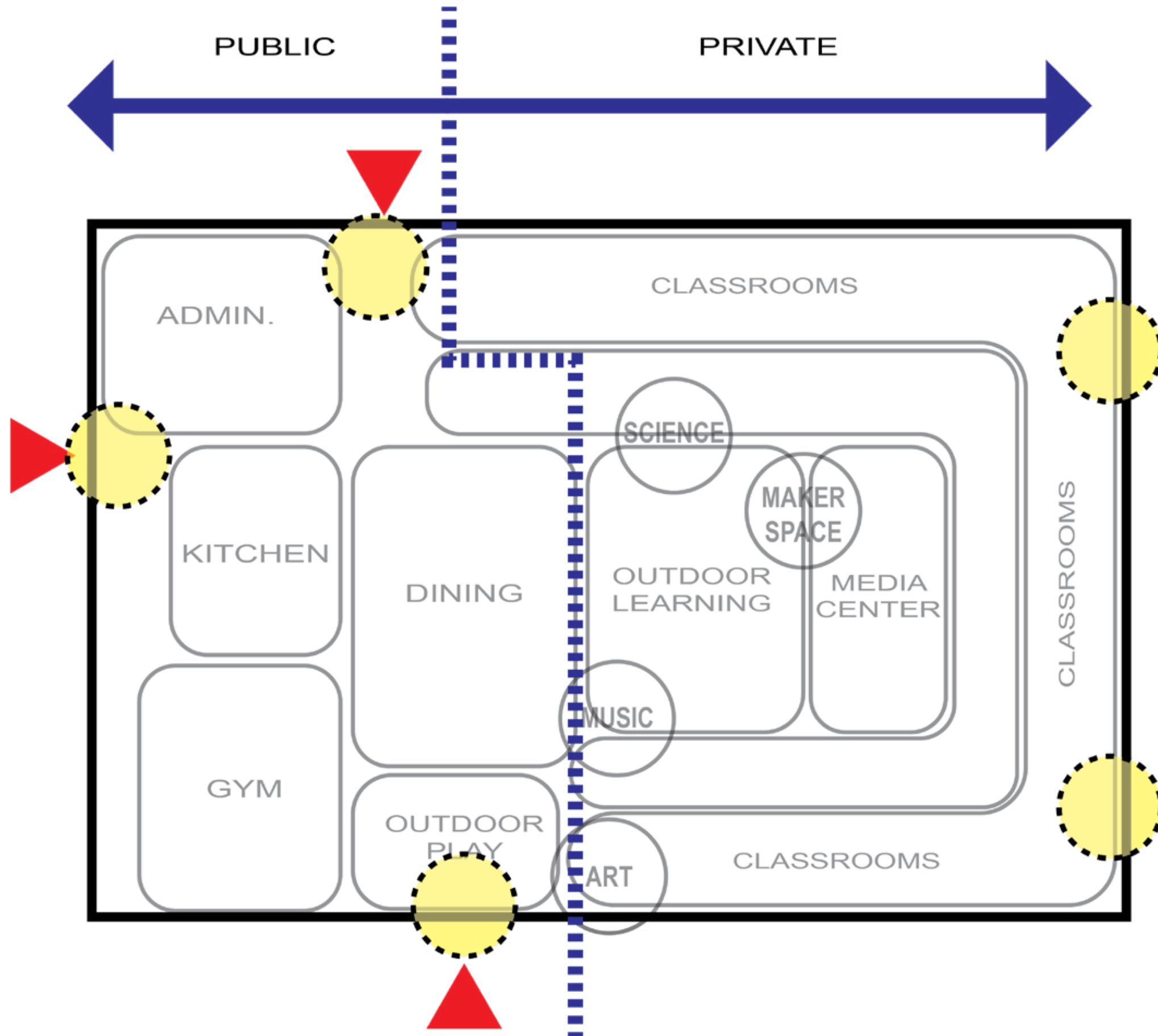



**PARENT DROP  
OFF 1**

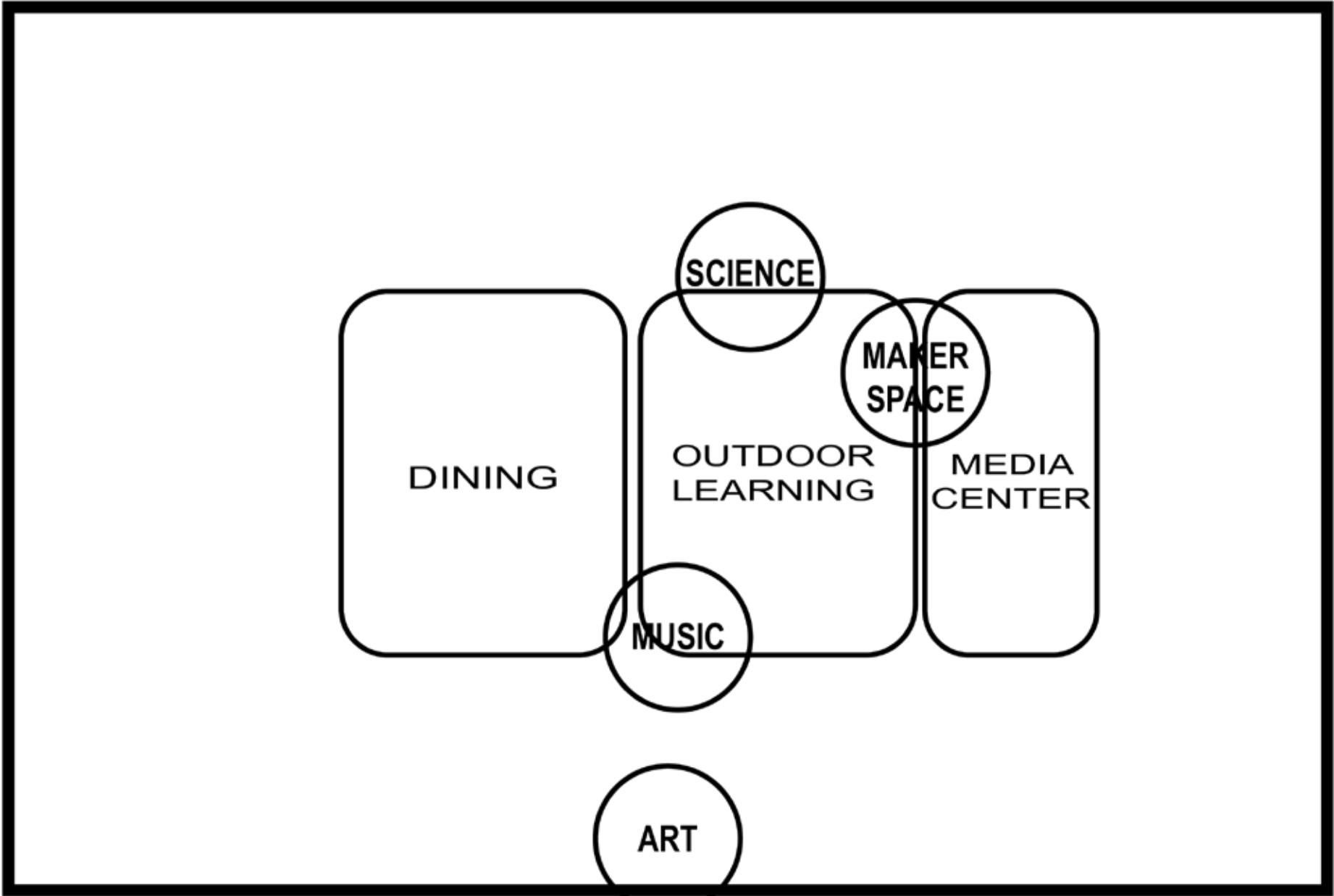

**PARENT  
DROP  
OFF 2**



**BUS DROP OFF**



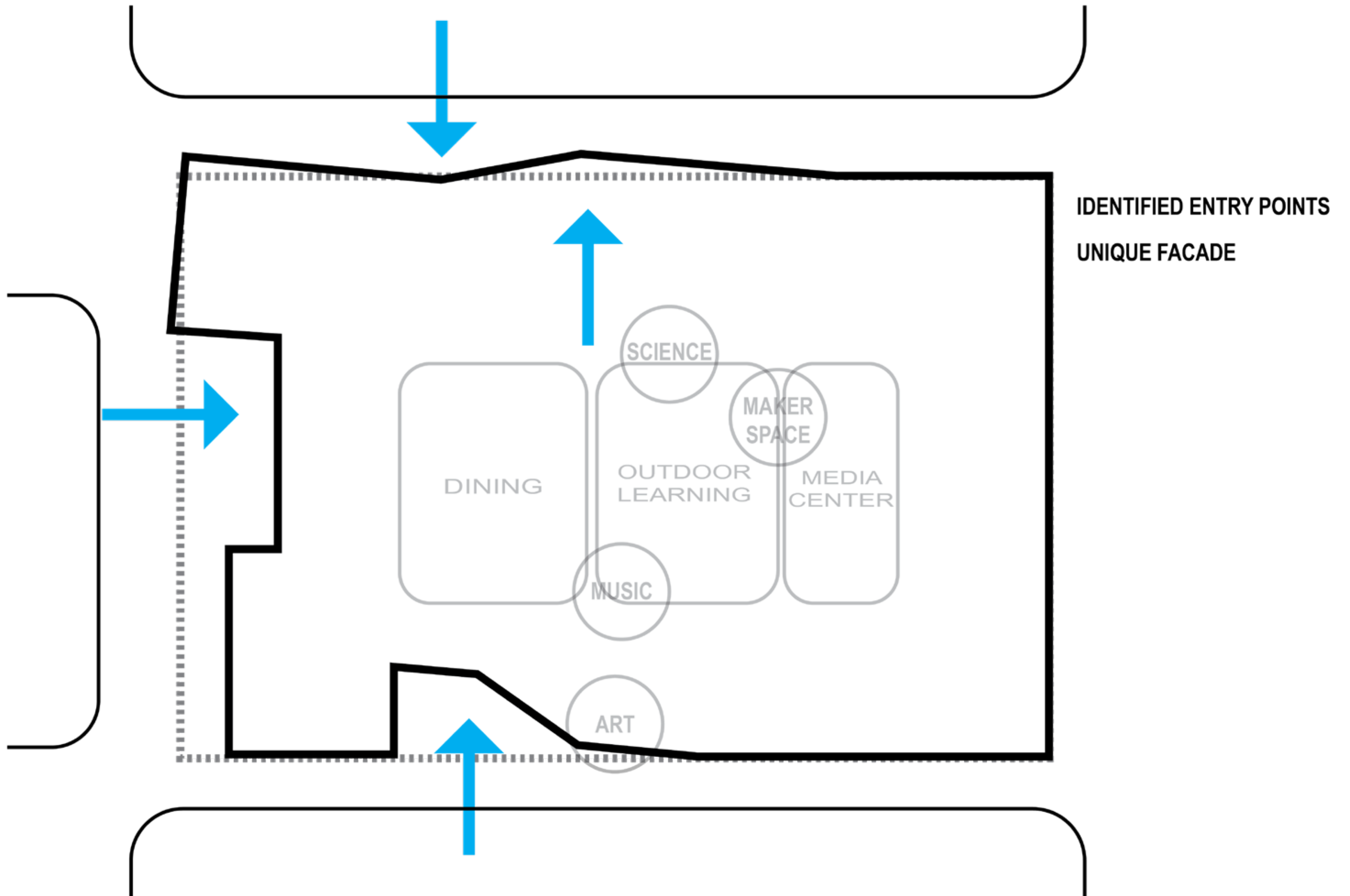

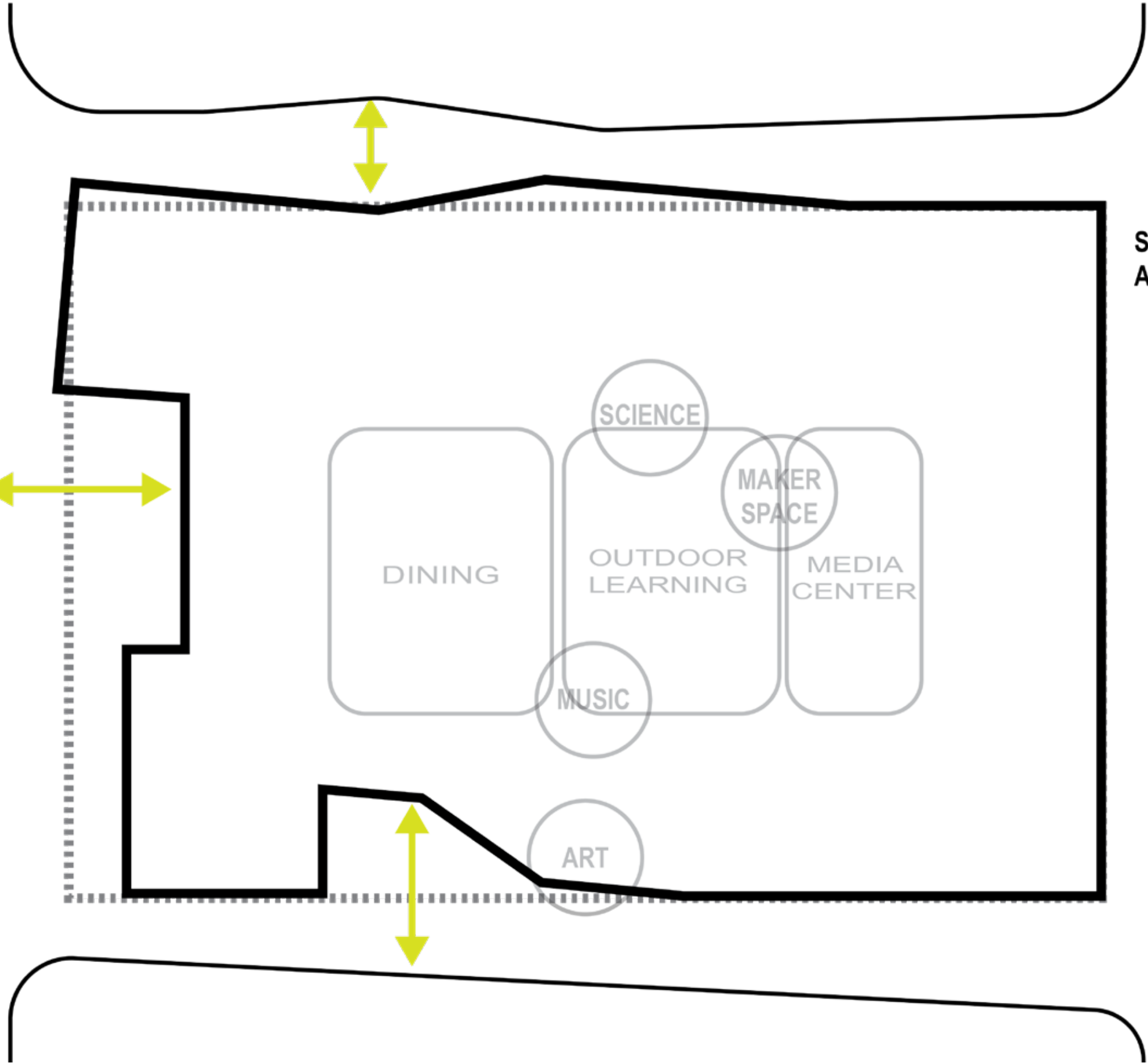

SEPARATION OF VEHICLE  
AND PEDESTRIAN

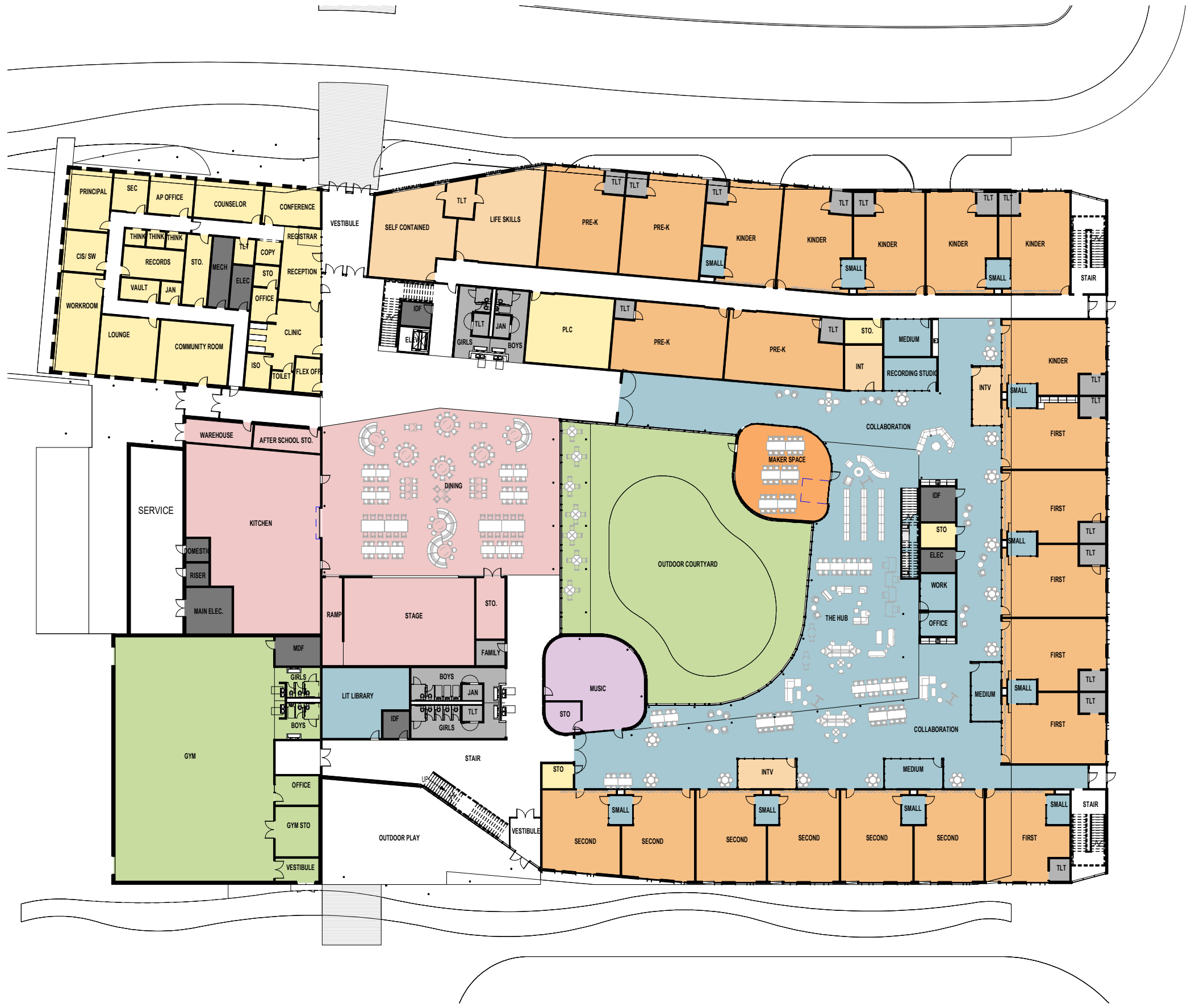



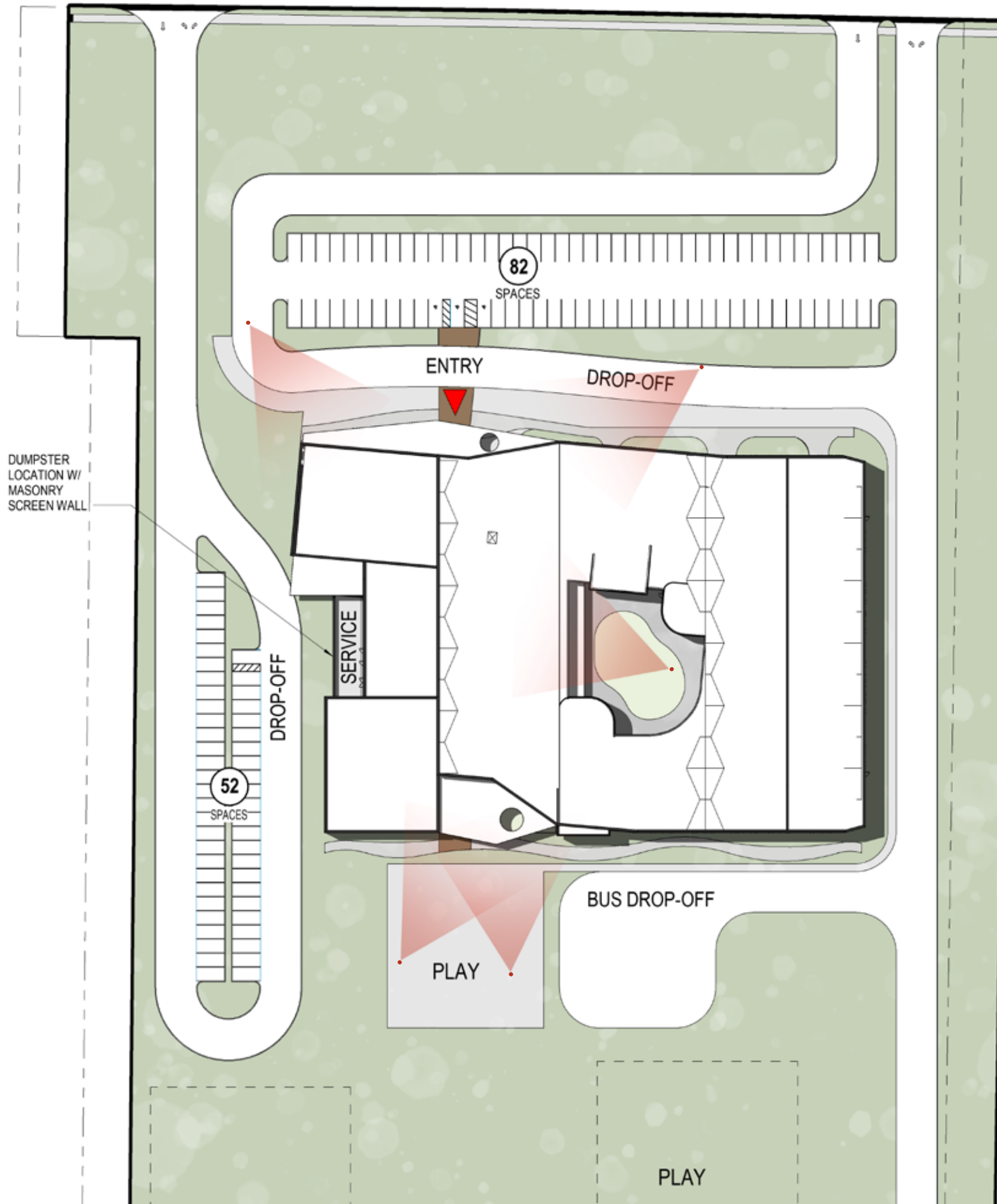

# MELODY

“DENTON ISD NAMED “BEST COMMUNITY FOR MUSIC EDUCATION” 15TH CONSECUTIVE YEAR”

-NAMM Foundation

Along with that, Denton Elementary Schools are some of the few in the metroplex to teach band and orchestra. Denton ISD as a whole also has a strong connection with the music department at UNT. While these proposed schools are not solely focused on a music curriculum, we took interest in a single aspect of music, melody. There is an interesting contrast and intersection of linear forms and organic elements that make up a melody. This allows for inspiration and exploration into how that can inform architectural elements to truly make these projects unique.

Melody is a succession of pitches in rhythm. **The melody is usually the most memorable aspect of a song**, the one the listener remembers and is able to perform.



# MELODY

**Pitch** - A combination of a certain *set of sounds*, most often a *small amount*

**Range** - The *distance* between the *lowest and highest* tones

**Contour** - The form of a *sequence* of melodic *elements, phrases and arcs*

**Melodic Line** - well remembered and *continuous* *throughout* a song

**Intervals** - Measured in semitones, the *distance to the first note* in a certain key/tonic

**Texture** - The *relationship* of melody and harmony. It can be *thick or thin and could have layers*

**Rhythm** - A strong *regular, repeated pattern* of movement



# MELODY

*Pitch* - A combination of a certain *set of sounds*, most often a *small amount*

**Range** - The *distance* between the *lowest and highest* tones

*Contour* - The form of a *sequence* of melodic *elements, phrases and arcs*

**Melodic Line** - well remembered and *continuous* *throughout* a song

*Intervals* - Measured in semitones, the *distance to the first note* in a certain key/tonic

*Texture* - The *relationship* of melody and harmony. It can be *thick or thin* and could have layers

**Rhythm** - A strong *regular, repeated pattern* of movement



WOOD SLATS

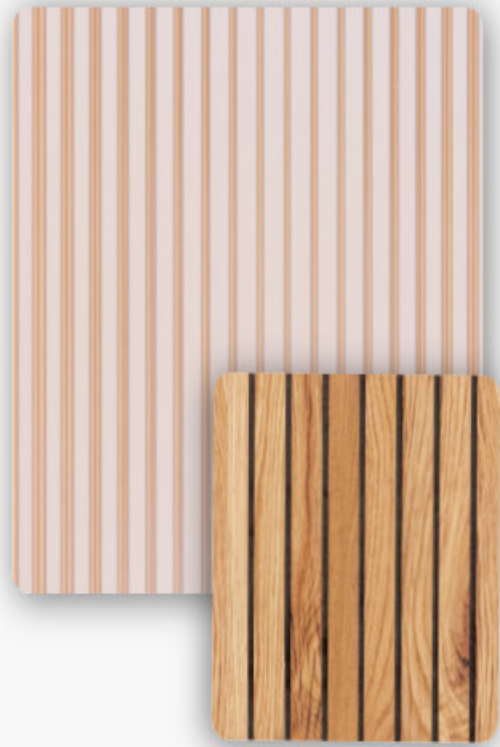

CARPET

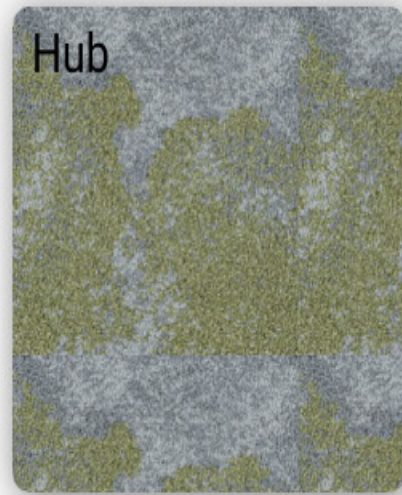

ACOUSTIC PANEL



PAINT

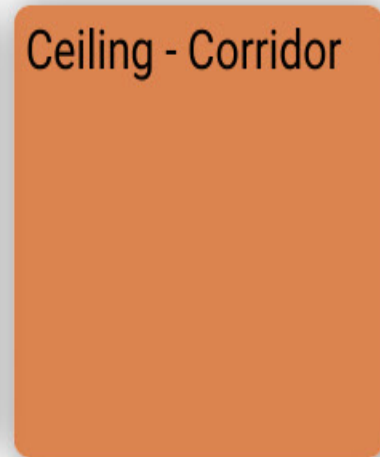
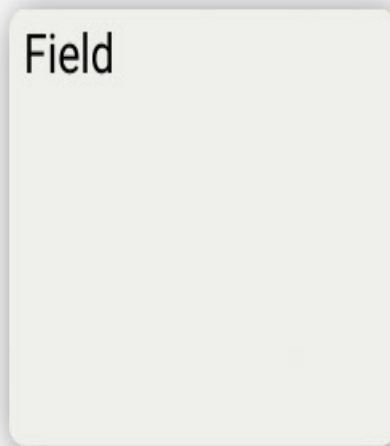

LUXURY VINYL TILE

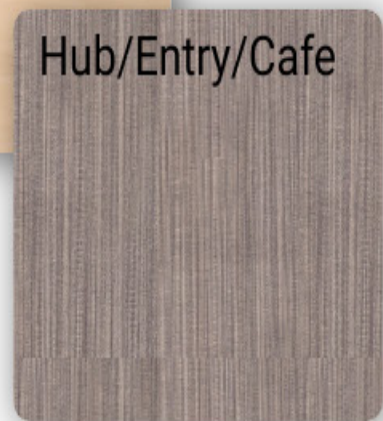
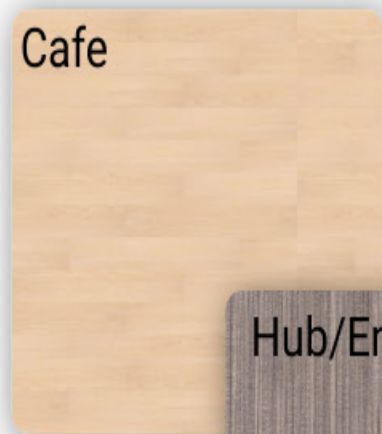

WAINSCOT



POLISHED CONCRETE

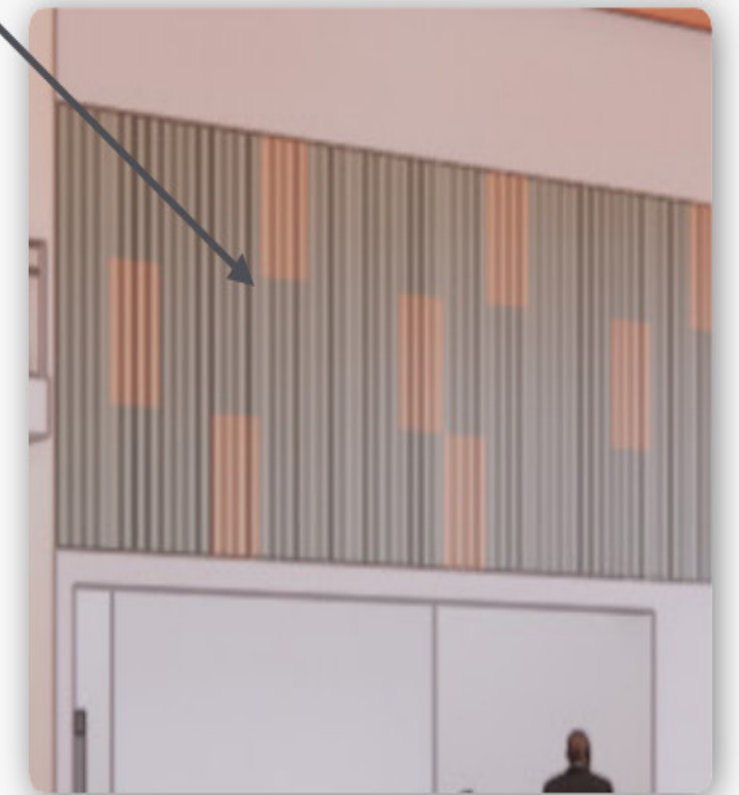

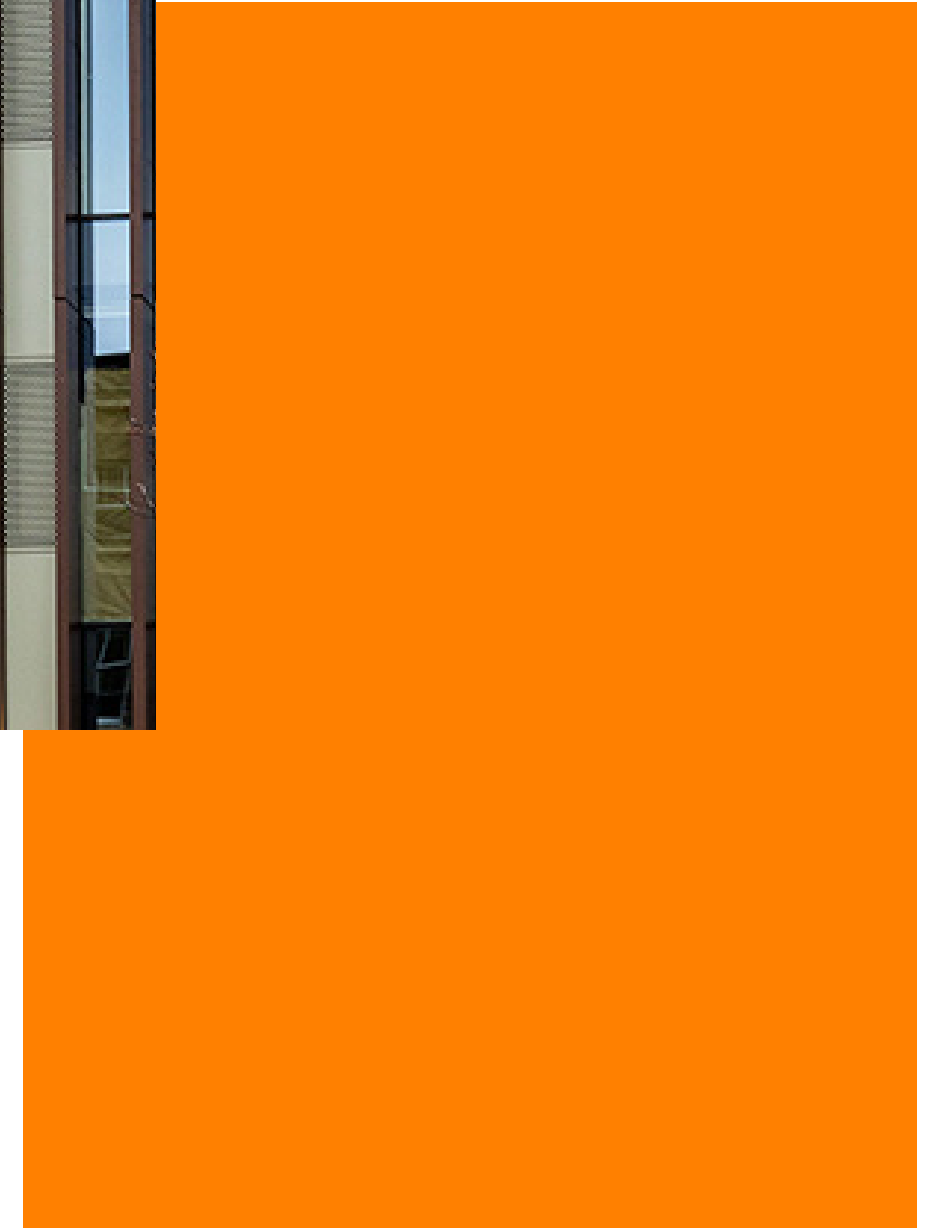
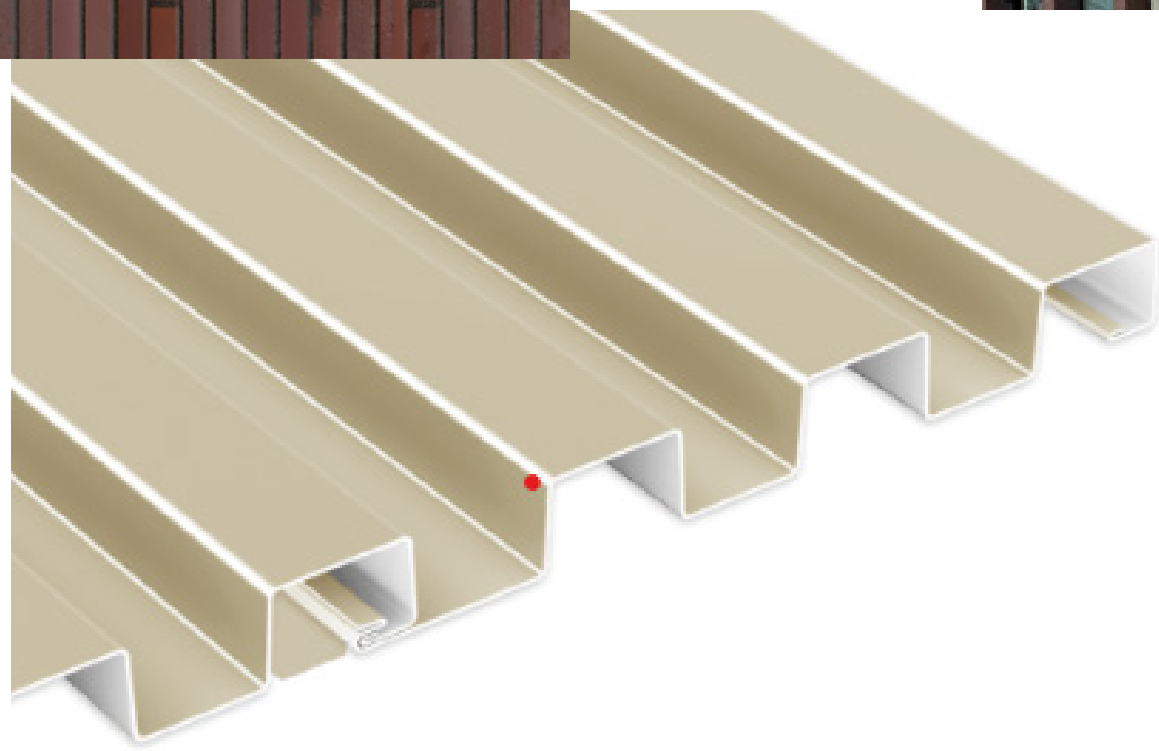
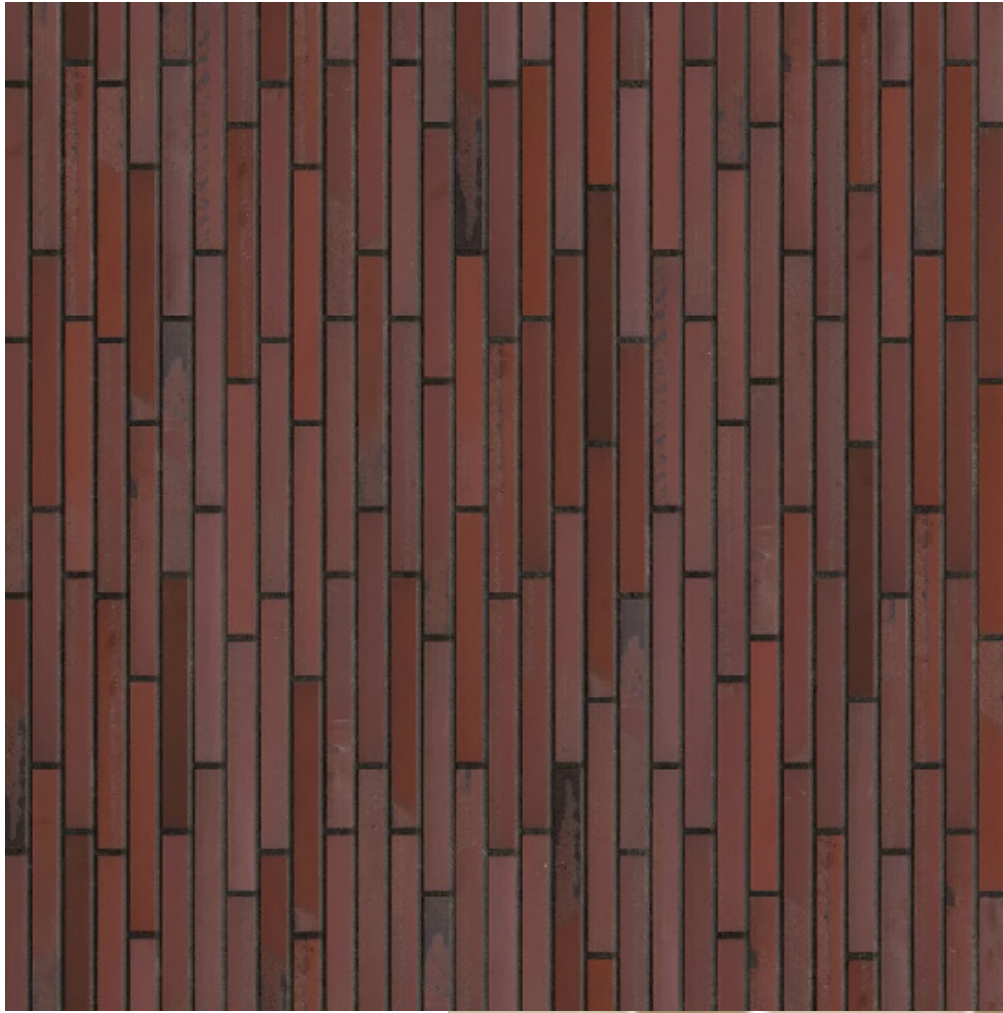



CONCEPTUAL RENDERING\_MAIN ENTRY



CONCEPTUAL RENDERING\_MAIN ENTRY



CONCEPTUAL RENDERING\_BUS ENTRY



CONCEPTUAL RENDERING\_BUS ENTRY









CONCEPTUAL RENDERING\_MAIN CORRIDOR









CONCEPTUAL RENDERING\_COURTYARD