

West Orange-Stark Elementary Kindergarten Playground

Proposal # Kindergarten
June 30, 2011



Presented by
T.F. Harper & Associates L.P.
and





June 30, 2011

Benny Smith
West Orange-Cove CISD
505 N 15th
Orange, TX 77631

Dear Benny Smith:

T.F. Harper & Associates L.P. is delighted to provide West Orange-Stark Elementary with this playground equipment proposal.

This design was developed with your specific needs in mind, and we look forward to discussing this project further with you to ensure your complete satisfaction. T.F. Harper & Associates L.P. is confident that this proposal will satisfy West Orange-Cove CISD's functional, environmental, and safety requirements -- and most importantly -- bring joy and excitement to the children and families directly benefiting from your new playground.

You have our personal commitment to support this project and your organization in every manner possible, and we look forward to continue developing a long-standing relationship with West Orange-Cove CISD. We appreciate your consideration and value this opportunity to earn your business.

Sincerely,

Janet Wachs
T.F. Harper & Associates L.P.
9000 S. Congress
Austin, TX 78745

Design Summary

T.F. Harper & Associates L.P. is very pleased to present this Proposal for consideration for the Kindergarten Playground located in Orange, TX. BCI Burke Company, LLC has been providing recreational playground equipment for over 80 years and has developed the right mix of world-class capabilities to meet the initial and continuing needs of West Orange-Stark Elementary. We believe our proposal will meet or exceed your project's requirements and will deliver the greatest value to you.

The following is a summary of some of the key elements of our Proposal:

- Project Name: Kindergarten Playground
- Project Number: Kindergarten
- User Capacity: 82
- Age Groups: Ages 5-12 years
- Dimensions: 45' 1" x 58' 5"
- Designer Name: Matt Tanner

T.F. Harper & Associates L.P. has developed a custom playground configuration based on the requirements as they have been presented for the Kindergarten Playground project. Our custom design will provide a safe and affordable playground environment that is aesthetically pleasing, full of fun for all users and uniquely satisfies your specific requirements. In addition, proposal # Kindergarten has been designed with a focus on safety, and is fully compliant with ASTM F1487 and CPSC playground safety standards.

We invite you to review this proposal for the Kindergarten Playground project and to contact us with any questions that you may have.

Thank you in advance for giving us the opportunity to make this project a success.

INFORMATION
MINIMUM FALL ZONE
SURFACED WITH
RESILIENT MATERIAL
AREA

1550 SQ.FT.

PERIMETER
279 FT.

STRUCTURE SIZE
45' 1" x 58' 5"

STRUCTURE IS DESIGNED
FOR CHILDREN AGES:

- 6-23 MONTH OLDS
- 2-5 YEAR OLDS
- 5-12 YEAR OLDS



To verify product certification,
visit www.ipema.org

The play components identified
in this plan are IPEMA
certified. The use and layout of
these components conform to the
requirements of ASTM F1487.
To verify product certification,
visit www.ipema.org

The space requirements shown
here are to ASTM standards.
Requirements for other standards
may be different.

The use and layout of play
components identified in this plan
conform to the CPSC guidelines.

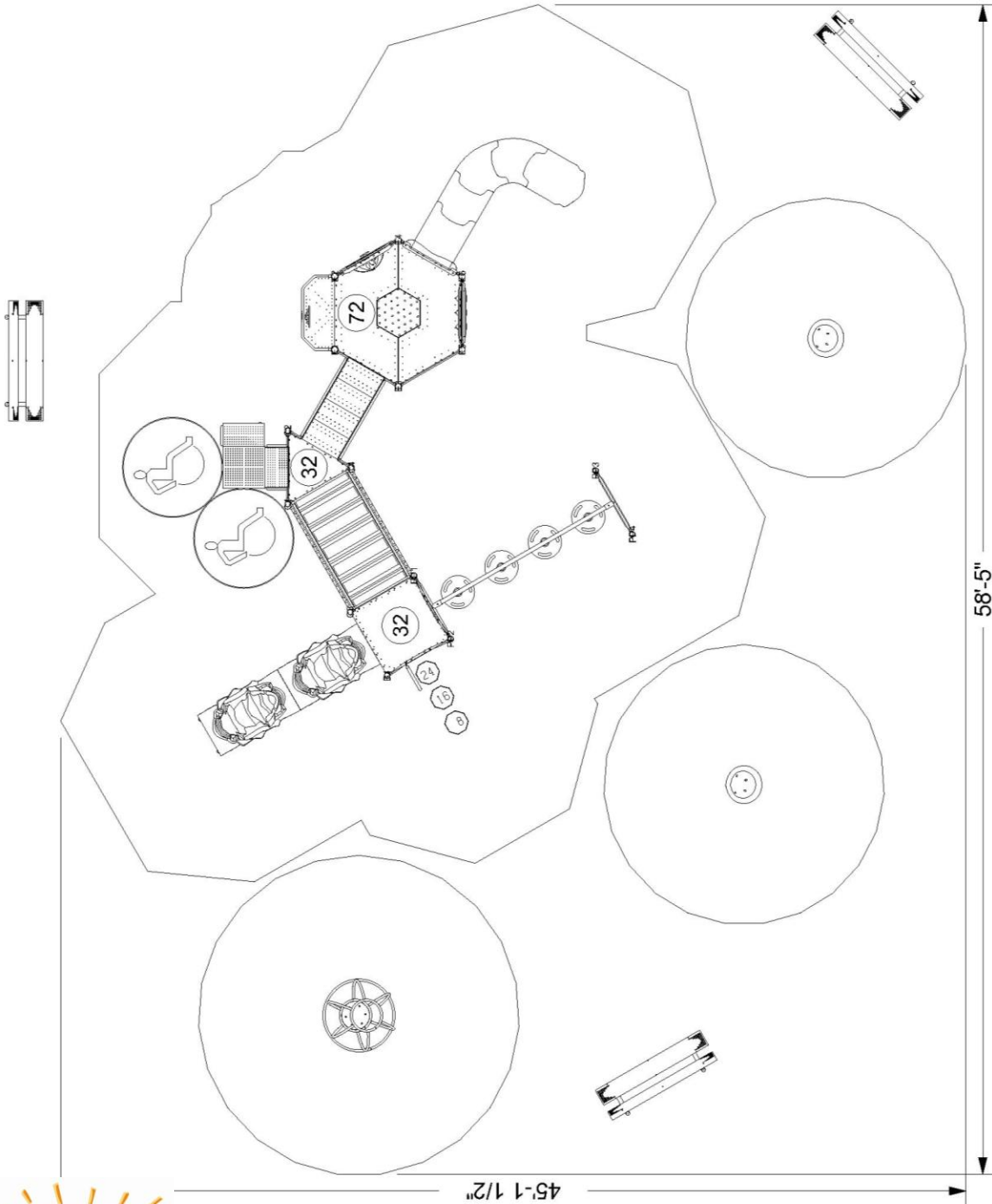

WARNING!

ACCESSIBLE SAFETY SURFACING MATERIAL IS REQUIRED BENEATH
AND AROUND THIS EQUIPMENT.
FOR SLIDE FALL ZONE SURFACING AREA SEE CPSC's Handbook for
Public Playground Safety.
PLATFORM HEIGHTS ARE IN INCHES ABOVE RESILIENT MATERIAL.

ADA ACCESSIBILITY GUIDELINE (ADAAG CONFORMANCE)

NUMBER OF PLAY EVENTS:	15
NUMBER OF ELEVATED PLAY EVENTS:	7
NUMBER OF ELEVATED PLAY EVENTS ACCESSIBLE BY RAMP:	PROVIDED: 0
NUMBER OF ELEVATED PLAY EVENTS ACCESSIBLE BY TRANSFER SYSTEM:	PROVIDED: 7
NUMBER OF ELEVATED PLAY EVENTS ACCESSIBLE BY RAMP OR TRANSFER SYSTEM:	PROVIDED: 8
NUMBER OF GROUND LEVEL PLAY EVENTS:	PROVIDED: 4
NUMBER OF TYPES OF GROUND LEVEL PLAY EVENTS:	RECD: 0
	RECD: 4
	RECD: 2
	RECD: 2



SERIES: Voltage, Basics
SITE PLAN
DRAWN BY: Matt Tanner

Kindergarten Playground

T.F. Harper & Associates L.P.
Kindergarten

June 30, 2011

ITEM	COMP.	DESCRIPTION
1	230-0203	PLATFORM CENTER
2	230-0221	TRIANGLE PLATFORM S3P
3	230-0222	SQUARE PLATFORM S3P
4	230-0225	HEXAGON PLATFORM W/CENTE
5	230-0226	BALCONY
6	230-0228	UNITARY ENCLOSURE, S3
7	230-0240	SHORT BUCKLE BRIDGE W/BARRI
8	330-0247	END RUNGS
9	330-0414	ROCKY MOUNTAIN ADVENTURE
10	330-0430	SKY PODS 16-40
11	330-0619	POD WALK 32"
12	330-0627	40" TRANSITION STAIR W/BARRI
13	330-0710	TRANSFER STATION 32"
14	430-0550	VIPER R2 64-72
15	530-0624	PIPE WALL, S3
16	530-0631	TIC TAG TOE PANEL ASSEMBLY
17	530-0635	PADDLE BALL PANEL BELOW PL
18	530-0678	STEERING WHEEL ASSEMBLY
19	530-1648	CHIMES PANEL
20	530-1663	GEAR PANEL, ABOVE PLATFORM
21	560-2570	COMET 1
22	560-2573	KIDFORCE SPINNER
23	560-0172	6' PVC TRADITIONAL BENCH W/E

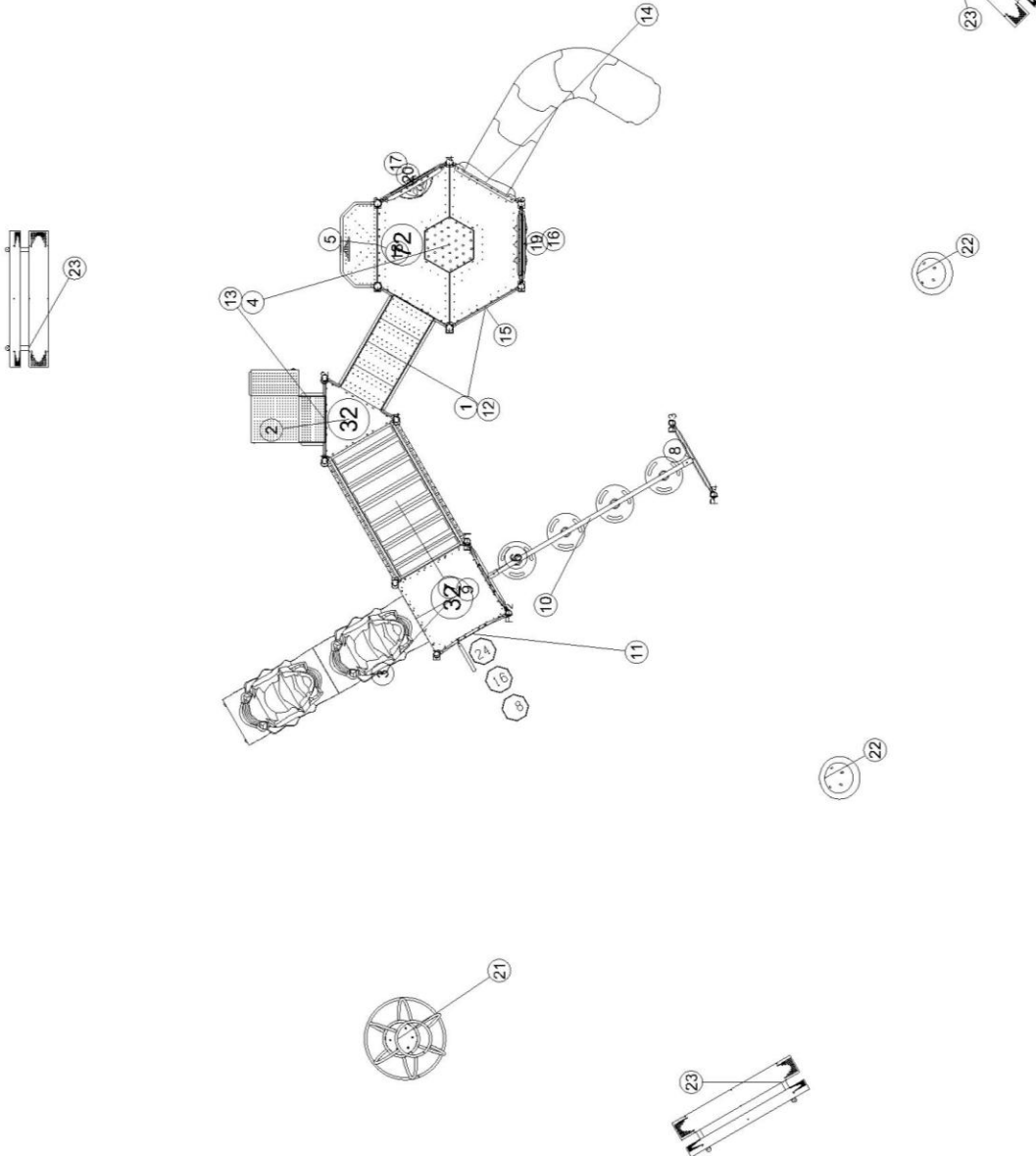

June 30, 2011

SERIES: Voltage, Basics
 COMPONENT PLAN
 DRAWN BY: Matt Tanner

Kindergarten Playground

T.F. Harper & Associates L.P.
 Kindergarten



SERIES: Voltage, Basics
ELEVATION PLAN
DRAWN BY: Matt Tanner

Kindergarten Playground

T.F. Harper & Associates L.P.
Kindergarten

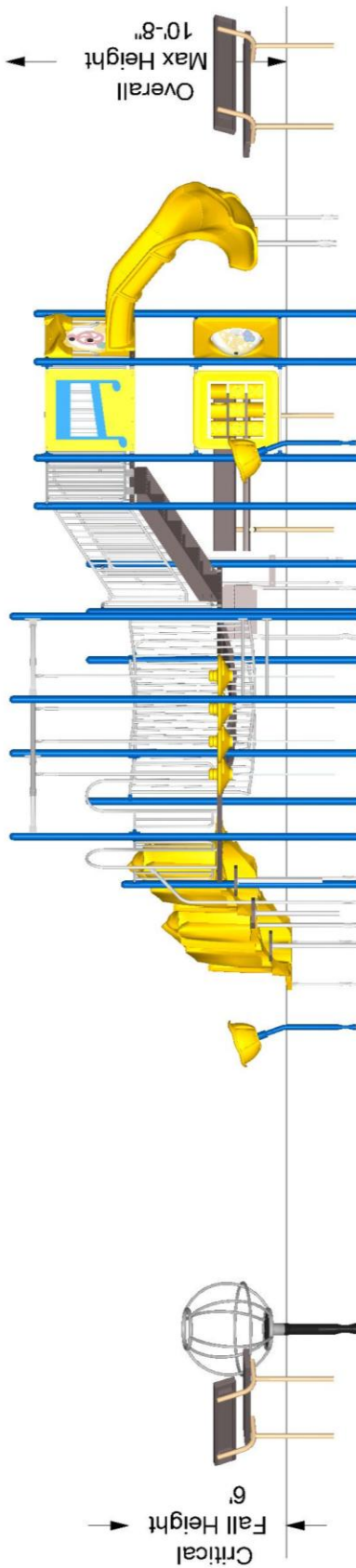

The protective surfacing for this design must accommodate the critical fall height.

June 30, 2011

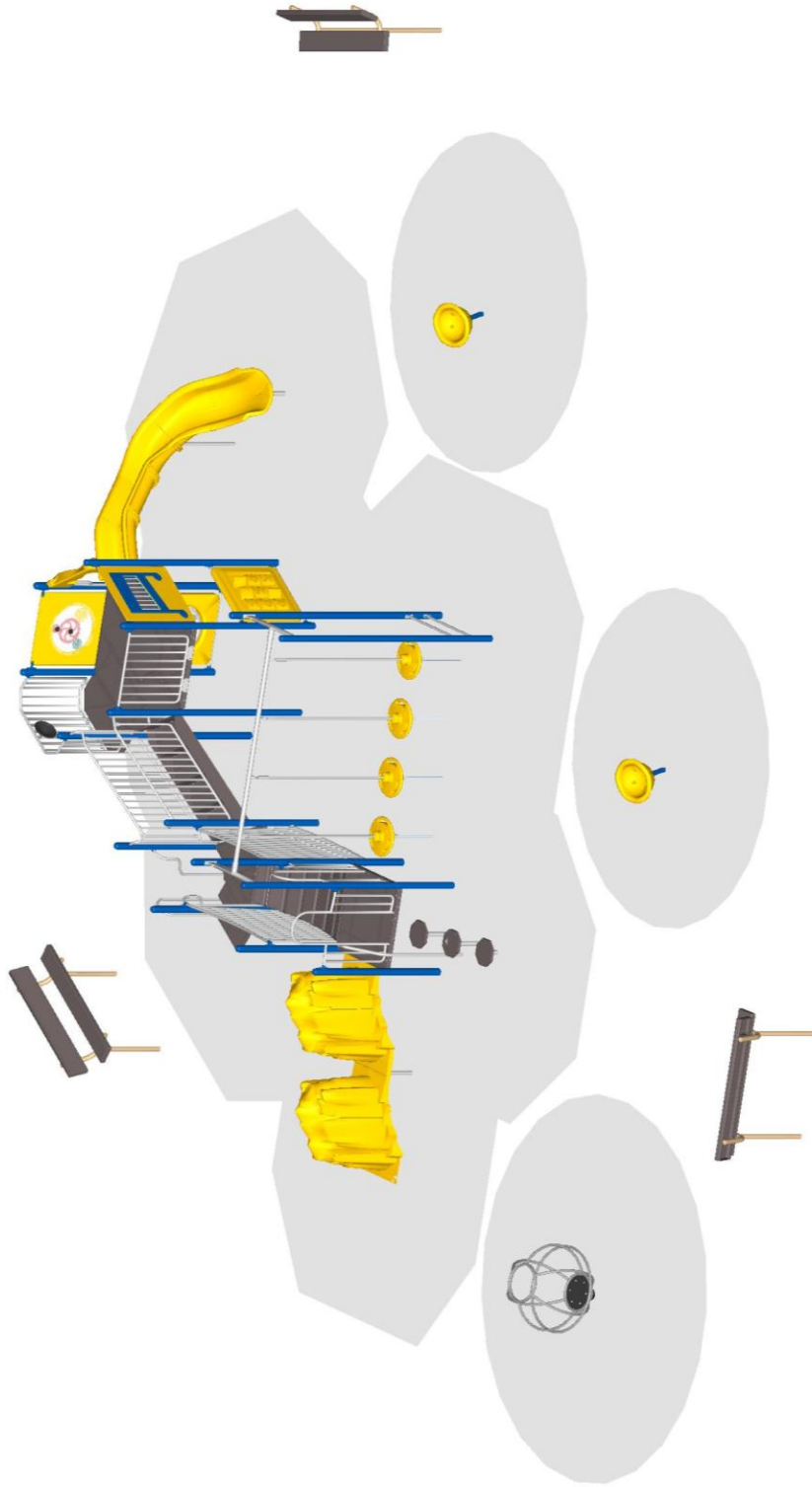

June 30, 2011

SERIES: Voltage, Basics
ISOMETRIC PLAN
DRAWN BY: Matt Tanner

Kindergarten Playground

T.F. Harper & Associates L.P.
Kindergarten



Proposal # Kindergarten

June 30, 2011
2011 Pricing

Proposal Prepared for:

Benny Smith
West Orange-Stark Elementary
505 N 15th
Orange, TX 77631
Phone: 409-882-5630

Project Location:

Kindergarten Playground

Proposal Prepared by:

T.F. Harper & Associates L.P.
9000 S. Congress
Austin, TX 78745
Phone: 512-440-0707
Fax: 512-440-0736
playground@tfharper.com

Janet Wachs
Phone: 512-440-0707
Fax: 512-440-0736
mtanner@tfharper.com

Component No.	Description	Qty.	User Cap.	Ext. User Cap.	Weight	Ext. Weight
Voltage						
230-0203	PLATFORM CENTER	1	0	0	33	33
230-0221	TRIANGLE PLATFORM S3P	1	2	2	31	31
230-0222	SQUARE PLATFORM S3P	1	6	6	103	103
230-0225	HEXAGON PLATFORM W/CENTER HOL...	1	18	18	218	218
230-0226	BALCONY	1	1	1	106	106
230-0228	UNITARY ENCLOSURE, S3	1	0	0	34	34
230-0240	SHORT BUCKLE BRIDGE W/BARRIER	1	7	7	357	357
330-0247	END RUNGS	1	1	1	9	9
330-0414	ROCKY MOUNTAIN ADVENTURE GR L...	1	8	8	271	271
330-0430	SKY PODS 16-40	1	6	6	184	184
330-0619	POD WALK 32"	1	3	3	119	119
330-0627	40" TRANSITION STAIR W/BARRIE...	1	4	4	278	278
330-0710	TRANSFER STATION 32"	1	4	4	160	160
430-0550	VIPER R2 64-72	1	2	2	172	172
530-0624	PIPE WALL, S3	1	0	0	34	34
530-0631	TIC TAC TOE PANEL ASSEMBLY BE...	1	2	2	53	53
530-0635	PADDLE BALL PANEL BELOW PLATF...	1	1	1	45	45
530-0678	STEERING WHEEL ASSEMBLY	1	1	1	7	7
530-1648	CHIMES PANEL	1	4	4	49	49
530-1653	GEAR PANEL, ABOVE PLATFORM	1	4	4	44	44
600-0103	MAINTENANCE KIT	1	0	0	0	0
600-0104	NPPS SUPERVISION SAFETY KIT	1	0	0	3	3
630-0002	POST ASSY 3 1/2 X 107	1	0	0	39	39
630-0003	POST ASSY 3 1/2 X 123	4	0	0	45	180
630-0005	POST ASSY 3 1/2 X 147	6	0	0	54	322
630-0096	MODULAR HARDWARE	1	0	0	5	5
630-0099	3000 INSTALLATION KIT	1	0	0	2	2
630-0113	POST ASSY 3 1/2 X 158	4	0	0	58	231
Burke Basics						
560-2570	COMET I	1	6	6	157	157
560-2573	KIDFORCE SPINNER	2	1	2	43	86
580-0172	6' PVC TRADITIONAL BENCH W/BA...	3	0	0	119	357

Total User Capacity: 82
Total Weight: 3,690 lbs.



Proposal # Kindergarten

June 30, 2011
2011 Pricing

Information is relative to the Jun 14 2011 9:03AM database.

Special Notes:

Prices do not include freight, unloading, material storage, site excavation/preparation, removal of existing equipment, removal of excess soil from footing holes, site security, safety surfacing, installation, or sales tax (if applicable). Prices are based on standard colors per CURRENT YEAR BCI Burke Catalog. Custom colors, where available, would be an extra charge. **Pricing is valid for 45 days from the date of this proposal.**

BCI Burke Generations Warranty™

The Longest and Strongest warranty in the industry

BCI Burke Company, LLC ("Burke") warrants that all standard products are warranted to be free from defects in materials and workmanship, under normal use and service, for a period of one (1) year from the date of invoice.

We stand behind our products.

In addition, the following products are warranted, under normal use and service from the date of invoice as follows:

- One Hundred (100) Year Limited Warranty on aluminum and steel upright posts (including Intensity®, Voltage™, Nucleus™ and Little Buddies®) against structural failure due to corrosion, deterioration or workmanship.
- One Hundred (100) Year Limited Warranty on KoreConnect® clamps against structural failure due to corrosion, deterioration or workmanship.
- One Hundred (100) Year Limited Warranty on Hardware (nuts, bolts, washers).
- One Hundred (100) Year Limited Warranty on bolt-through fastening and Clamp systems (Voltage™, Intensity®, and Nucleus™).
- Twenty-Five (25) Year Limited Warranty on spring assemblies and aluminum cast animals.
- Fifteen (15) Year Limited Warranty on main structure platforms and decks, metal roofs, table tops, bench tops, railings, loops and rungs.
- Fifteen (15) Year Limited Warranty on all plastic components including StoneBorders against structural failure due to materials or workmanship.
- Ten (10) Year Limited Warranty on ShadePlay Canopies fabric, threads, and cables against degradation, cracking or material breakdown resulting from ultra-violet exposure, natural deterioration or manufacturing defects. This warranty is limited to the design loads as stated in the specifications.
- Ten (10) Year Limited Warranty on NaturePlay® Boulders against structural failure due to natural deterioration or workmanship.
- Five (5) Year Limited Warranty on Intensity® cables against premature wear due to natural deterioration or manufacturing defects.
- Five (5) Year Limited Warranty on swing seats and hangers; Kid Koaster® Trolleys and moving parts against structural failure due to materials or workmanship.

The warranty stated above is valid only if the equipment is erected in conformity with the layout plan and/or installation instructions furnished by BCI Burke Company, LLC using approved parts; have been maintained and inspected in accordance with BCI Burke Company, LLC instructions. Burke's liability and your exclusive remedy hereunder will be limited to repair or replacement of those parts found in Burke's reasonable judgment to be defective. Any claim made within the above stated warranty periods must be made promptly after discovery of the defect. A part is covered only for the original warranty period of the applicable part. Replacement parts carry the applicable warranty from the date of shipment of the replacement from Burke. After the expiration of the warranty period, you must pay for all parts, transportation and service charges.

Burke reserves the right to accept or reject any claim in whole or in part. Burke will not accept the return of any product without its prior written approval. Burke will assume transportation charges for shipment of the returned product if it is returned in strict compliance with Burke's written instructions.

THE FOREGOING WARRANTIES ARE EXCLUSIVE AND IN LIEU OF ANY OTHER WARRANTY, EXPRESS OR IMPLIED, INCLUDING BUT NOT LIMITED TO ANY IMPLIED WARRANTY OR MERCHANTABILITY OR FITNESS FOR A PARTICULAR PURPOSE. IF THE FOREGOING DISCLAIMER OF ADDITIONAL WARRANTIES IS NOT GIVEN FULL FORCE AND EFFECT, ANY RESULTING ADDITIONAL WARRANTY SHALL BE LIMITED IN DURATION TO THE EXPRESS WARRANTIES AND BE OTHERWISE SUBJECT TO AND LIMITED BY THE TERMS OF BURKE'S PRODUCT WARRANTY. SOME STATES DO NOT ALLOW THE EXCLUSION OF CERTAIN IMPLIED WARRANTIES, SO THE ABOVE LIMITATION MAY NOT APPLY TO YOU.

Warranty Exclusions: The above stated warranties do not cover: "cosmetic" defects, such as scratches, dents, marring, or fading; damage due to incorrect installation, vandalism, misuse, accident, wear and tear from normal use, exposure to extreme weather; immersion in salt or chlorine water, unauthorized repair or modification, abnormal use, lack of maintenance, or other cause not within Burke's control; and

Limitation of Remedies: Burke is not liable for consequential or incidental damages, including but not limited to labor costs or lost profits resulting from the use of or inability to use the products or from the products being incorporated in or becoming a component of any other product. If, after a reasonable number of repeated efforts, Burke is unable to repair or replace a defective or nonconforming product, Burke shall have the option to accept return of the product, or part thereof, if such does not substantially impair its value, and return the purchase price as the buyer's entire and exclusive remedy. Without limiting the generality of the foregoing, Burke will not be responsible for labor costs involved in the removal of products or the installation of replacement products. Some states do not allow the exclusion of incidental damages, so the above exclusion may not apply to you.

For more information regarding the warranty, call Customer Service at 920-921-9220 or 1-800-356-2070.