



# Request for Board Agenda Item

Purchasing Department

Date: 1-15-14

Campus/Department: Facilities Department

Vendor Name: Byer's Construction, Inc.

Total Cost: ~~\$36,600.00~~ \$36,120.00

Item Description and Justification for Purchase:

Installation of two new marquees at each Middle School.

Participating Schools/Departments: Canutillo Middle School and Alderete Middle

Funding Source: 199.81.6639.00.999.99

(Account number to charge)

Campus/Department Administrator

1/15/14

Date Signed

\*\*\* (Form must be received by the Purchasing Department by the last Wednesday of the month) \*\*\*

(To be completed by the Financial Services Division)

Purchasing Method: RFQ 13-08

Purchasing Agent

1/16/14

Date Signed

Executive Director of Financial Services

1/17/14

Date Signed



# Purchasing Approval Sheet

## For Presentation to Board of Trustees

Purchasing Department

### Financial Services (Verification of Funding Availability and Account Coding)

Approved       Denied

Comment: \_\_\_\_\_  
Signature: Martha Aguirre      Date: 1/17/14

=====

### Federal Programs (For Compliance with Grant Requirements)

Not Required       Approved       Denied

Comment: \_\_\_\_\_  
Signature: \_\_\_\_\_      Date: \_\_\_\_\_

=====

### Curriculum & Instruction (For all Curriculum Related Purchases)

Not Required       Approved       Denied

Comment: \_\_\_\_\_  
Signature: \_\_\_\_\_      Date: \_\_\_\_\_

=====

### Technology (For all Computer/Software/Peripheral Purchases)

Not Required       Approved       Denied

Comment: \_\_\_\_\_  
Signature: \_\_\_\_\_      Date: \_\_\_\_\_

=====

### Legal Review

Not Required       Approved       Denied

Comment: \_\_\_\_\_  
Signature: \_\_\_\_\_      Date: \_\_\_\_\_

=====

### Purchasing

Approved       Denied

Comment: \_\_\_\_\_  
Signature: [Signature]      Date: 1/17/14



# Canutillo Independent School District

7965 Artcraft Rd.  
El Paso, Texas 79932

Mailing Address: PO Box 100  
Canutillo, Texas 79835

**Ron Gatlin**  
Purchasing Agent

Voice (915) 877-7426  
Fax (915) 877-7415  
rgatlin@canutillo-isd.org

## MEMORANDUM

TO: Members of the Board of Trustees

FROM: Ron Gatlin, Purchasing Agent

DATE: January 16, 2014

SUBJECT: Approval of Contract with Byers Construction for Marquee Installations

As stated in Board Policy CH (Local), any purchase that costs or aggregates to a cost of \$10,000 or more shall require board approval before a transaction may take place. This request is to approve the contract with Byers Construction for Marquee Installations at AMS and CMS in the total amount of \$36,120.00.

### **ADMINISTRATIVE RECOMMENDATION:**

Administration recommends approval of the Contract with Byers Construction for Marquee Installations at AMS and CMS in the total amount of \$36,120.00 as presented.

*The Canutillo Independent School District does not discriminate on the basis of race, color, national origin, gender, age or disability in its employment practices, or in providing education services, activities and programs, including technical education programs. For more information regarding the Canutillo Independent School District's policy of non-discrimination contact: Executive Director for Human Resources, (915) 877-7423, 7965 Artcraft Rd., El Paso, TX 79932.*

*El Distrito Escolar Independiente de Canutillo no discrimina en cuanto a raza, color, origen, género, edad o discapacidad en lo que se refiere a sus prácticas de empleo, o al proveer servicios, actividades y programas educativos y vocacionales. Para mayor información respecto a la política de no discriminación del Distrito Escolar Independiente de Canutillo, favor de contactar a: Director Ejecutivo de Recursos Humanos, (915) 877-7423, 7965 Artcraft Rd., El Paso, TX 79932.*

## Marquees for AMS and CMS

Items Included	Byers Contruction	Sign Bros
Exavation	<input checked="" type="checkbox"/>	<input checked="" type="checkbox"/>
Haul Off of exess material	<input checked="" type="checkbox"/>	No price provided
Supervision	<input checked="" type="checkbox"/>	<input checked="" type="checkbox"/>
Insurance	<input checked="" type="checkbox"/>	No price provided
Permits	N/A	N/A
Removal of exisitng sign	<input checked="" type="checkbox"/>	<input checked="" type="checkbox"/>
Relocation of Exisiting Sign	<input checked="" type="checkbox"/>	<input checked="" type="checkbox"/>
Pick up New sign and transport to School	<input checked="" type="checkbox"/>	No price provided
Erection of Marquees	<input checked="" type="checkbox"/>	<input checked="" type="checkbox"/>
Electrical	<input checked="" type="checkbox"/>	<input checked="" type="checkbox"/>
Barricades and temp. fencing	<input checked="" type="checkbox"/>	<input checked="" type="checkbox"/>
Interior repairs	<input checked="" type="checkbox"/>	No price provided
Landscape	<input checked="" type="checkbox"/>	No price provided
Saw cutting of HMAC and concrete	<input checked="" type="checkbox"/>	Concrete Only
Replacement of HMAC and concrete	<input checked="" type="checkbox"/>	Concrete Only
Removal of trees	<input checked="" type="checkbox"/>	<input checked="" type="checkbox"/>
Clean Up	<input checked="" type="checkbox"/>	<input checked="" type="checkbox"/>
<b>Total Price AMS</b>	\$11,266.00	\$32,000.00
<b>Total Price CMS</b>	\$24,854.00	\$14,500.00
<b>Grand Total</b>	<b>\$36,120.00</b>	<b>\$46,500.00</b>





# Canutillo Independent School District

7710 Cap Carter Rd.  
Canutillo, TX 79835

Mailing Address: PO Box 100  
Canutillo, Texas 79835

(915) 727-1555

[dpadilla@canutillo-isd.org](mailto:dpadilla@canutillo-isd.org)

## Dominic Padilla

*Executive Director*

*Facilities and Transportation*

**Date:** January 7, 2014  
**To:** Canutillo ISD Board of Trustees  
**From:** Dominic Padilla, Executive Director of Facilities and Transportation  
**Subject:** AMS and CMS Marquee Installation

As stated in Board Policy CH (Local), any purchase that costs or aggregates to a cost of \$10,000 or more shall require Board approval before a transaction may take place. This item is to consider approval of a proposal for the installation of two marquees (Aldrete Middle School and Canutillo Middle School) in the amount of \$36,600.00

**Cost:** \$ 36,600.00  
**Vendor Name:** Byers Construction  
**Funding Source:** 199.81.6639.00.999.99

### ADMINISTRATIVE RECOMMENDATION

Administration recommends approval of the proposal from Byers Construction in the amount of \$36,600.00

**Attachment:** 1.1 Byers Proposal for Marquees Installation 12.12.13  
1.2 Byers Revised Proposal (Including trees removal) 1.7.13

*Canutillo Independent School District does not discriminate on the basis of race, color, national origin, gender, age, or disability in its employment practices or in providing education services, activities, and programs, including technical education programs. For additional information regarding Canutillo Independent School District's policy of nondiscrimination contact: Executive Director for Human Resources, (915) 877-7423, 7965 Aircraft Road, El Paso, Texas 79932.*

*El Distrito Escolar Independiente de Canutillo no discrimina en cuanto a raza, color, origen, género, edad o discapacidad en lo que se refiere a sus prácticas de empleo o a proveer servicios, actividades y programas educativos y vocacionales. Para mayor información respecto a la política de no discriminación del Distrito Escolar Independiente de Canutillo, favor de contactar a: Director Ejecutivo de Recursos Humanos, (915) 877-7423, 7965 Aircraft Road, El Paso, TX 79932.*

# Attachment 1.1

## MEMORANDUM



CISD Marquee at CMS & AMS, page 2 of 2

**Please note, we EXCLUDE:**

- 1). Furnish or installation of any wireless communication.
- 2). Furnish or install computers or computer components for wireless or Ethernet wired communication.
- 3) Furnish or installation of Ethernet wiring except for conduit with pull line described at: "Additional work at AMS", item # 5 herein above.

**Please also note the Electrical work required for this project is predicated on:**

- 1). Information from the attached Electrical Drawings.
- 2). Stewart Sign recommendation that power to sign be left on 24/7/365. We have, however provide alternate pricing herein below for the addition of "Timed" operation if desired.
- 3). All work to be accomplished from 12/21/13 thru 1/4/14, except erection of marquee to occur when received.

**COST:**

CMS base bid:		\$11,266.00
CMS alternate for time switch control, ADD	\$240.00	
AMS base bid:		\$24,232.00
AMS alternate for time switch control, ADD	\$240.00	

Attached hereto are:

- 1). Bids from four Electrical Contractors. We have used, and recommend the low bid.
- 2). Bid from Martinez Irrigation & Landscaping. We recommend that we use Martinez in order to avoid any Warrantee problems.

Thank you for this opportunity.

Sincerely,

  
Walt Byers

Enclosures

# MEMORANDUM



12 Dec. 2013

TO: Dominic Padilla  
Executive Director, Facilities & Transportation  
Cautillo Independent School District

ATTN: Edgar Goytia, Bond Project Manager  
RE: Marquee Signs at CMS & AMS

Gentlemen,

We are pleased to provide the following information & cost for installation of Owner furnished Marquees at subject campuses.

**Work to be included at each campus:**

- 1). Materials, labor, supervision, plant, equipment, permits, & insurance.
- 2). Excavation & haul-off of excess soils
- 3). Furnish labor & materials to form, place reinforcing, anchor bolts & concrete for marquee foundation.
- 4). Pick-up signs from CISD Facilities warehouse & transport to each campus.
- 5). Assemble & erect marquee signs.
- 6). Electrical work to include conduit & 277 volt, single phase wiring from existing electrical panel at main buildings to point of connection at marquee; final electrical connection at marquee.
- 7). Fencing, barricades, cones & safety flagman as required.
- 8). Interior repairs, touch-up & paint as required at any damage caused by electrical work.
- 9). Final clean-up of site & building interior.

**Additional work at CMS:**

- 1). Removal and replacement of weed barrier, ground cover, irrigation lines and plants at Location of marquee in planter.

**Additional work at AMS:**

- 1) Saw cut and removal of existing concrete sidewalk and HMAC at drives & parking lot.
- 2) Replace removed concrete & HMAC.
- 3) Remove & replace red chat ground cover at electrical trenching.
- 4) Remove and replace sod at trenching in grass areas.
- 5) Conduit & pull line from above ceiling at point of entry to marquee for fiber optic cabling.
- 6) Remove existing marquee, transport to Facilities. Cap existing pipe standards 1 foot below grade with concrete.

Page 1 of 2



Millennium Electrical Contractors, Inc.

3669 Mark Jason Drive  
El Paso, TX 79938

# Estimate

Date	Estimate #
12/10/2013	2007-1429

Name / Address
Byers Construction, Inc. 3662 Doniphan Dr El Paso, Texas 79922

Project
Alderete Middle School Canutillo Middle School Marquee Sign

Description	Qty	Rate	Total
<b>Alderete Middle School</b>			
Base Bid	1	10,500.00	10,500.00
Alternate 1	1	200.00	200.00
<b>Canutillo Middle School</b>			
Base Bid	1	2,500.00	2,500.00
Alternate 1	1	200.00	200.00
<b>Total</b>			<b>\$13,400.00</b>
<b>Phone #</b>	<b>Fax #</b>	<b>Web Site</b>	
915-856-1821	915-855-6394	www.millenniumelectrical-inc.com	



**ALL TRADES ELECTRICAL CONTRACTORS, INC.**  
**11005 ARGAL CT.**  
**EL PASO, TEXAS 79935-3712**  
**PHONE 915-629-0830 / FAX 915-629-0862**  
**WWW.ALLTRADESELECTRICAL.COM**  
**BID PROPOSAL (ELECTRICAL)**

DECEMBER 12, 2013

TO: BYERS CONSTRUCTION, INC.

ATTN: LUPE

JOB NAME: ALDERETE MIDDLE SCHOOL

JOB: RUN POWER TO MARQUEE SIGN.

PRICE FOR THE ABOVE JOB IS: .....\$ 10,919.00

ALT #1: .....\$ 260.00

**1. INCLUDES:**

- ELECTRICAL AS PER ATTACHMENT.
- MATERIAL.
- LABOR.
- TRENCHING FOR ELECTRICAL.
- ADDENDUM #1

**2. EXCLUDES:**

- TAX.
- SCISSOR LIFT.
- SAW, CUT & PATCH OF ANY KIND.
- COMMUNICATION CABLE.
- MARQUEE SIGN.

IF YOU HAVE ANY QUESTIONS, PLEASE FEEL FREE TO GIVE US A CALL.  
THANK YOU,

RAFAEL GUTIERREZ  
ALL TRADES ELECTRICAL CONTRACTORS, INC.  
[rgutierrez@alltradeselectrical.com](mailto:rgutierrez@alltradeselectrical.com)

**ALL TRADES ELECTRICAL CONTRACTORS, INC.**  
**11005 ARGAL CT.**  
**EL PASO, TEXAS 79935-3712**  
**PHONE 915-629-0830 / FAX 915-629-0862**  
**WWW.ALLTRADESELECTRICAL.COM**  
**BID PROPOSAL (ELECTRICAL)**

DECEMBER 12, 2013

TO: BYERS CONSTRUCTION, INC.

ATTN: LUPE

JOB NAME: CANUTILLO MIDDLE SCHOOL

JOB: RUN POWER TO MARQUEE SIGN.

PRICE FOR THE ABOVE JOB IS: .....\$ 3,500.00

ALT #1: .....\$ 260.00

**1. INCLUDES:**

- ELECTRICAL AS PER ATTACHMENT.
- MATERIAL.
- LABOR.
- TRENCHING FOR ELECTRICAL.

**2. EXCLUDES:**

- TAX.
- SCISSOR LIFT.
- SAW, CUT & PATCH OF ANY KIND.
- COMMUNICATION CABLE.
- MARQUEE SIGN.
- ANY PROBLEMS ON EXISTING UNDERGROUND CONDUIT.

IF YOU HAVE ANY QUESTIONS, PLEASE FEEL FREE TO GIVE US A CALL.  
THANK YOU,

RAFAEL GUTIERREZ  
ALL TRADES ELECTRICAL CONTRACTORS, INC.  
[rgutierrez@alltradeselectrical.com](mailto:rgutierrez@alltradeselectrical.com)



# JAG ELECTRIC

BYERS Construction, Inc.  
3662 Doniphan Dr.  
El Paso, TX 79922

Tuesday, December 10, 2013

Attention: Carmen Byers

Regarding: Canutillo Middle School Marquee Electrical

The following is our Electrical Proposal for the above referenced project. It is based on the documents and criteria listed below.

Plans: Drawings Dated 25 Nov. 2013

Specifications Dated: N/A

Addendum: N/A

- Scope:**
- As per drawings, provide and install conduit extending within the existing building to the existing underground conduits that are routed to the general area of the new marquee sign location. Intercept the existing conduit near the new location, and extend over to the new signage area. There are provisions for 277V single phase power included in this proposal. At the marquee location, a disconnect and 2KVA transformer to provide 120V power are also included, prior to the connection to the marquee signage.
  - Excavation for electrical connections and final signage conduit outlined in referenced drawings is included.

**Clarifications:**

- The correctness and completeness of the contract documents is the sole responsibility of those who have prepared them. This proposal covers only that work that is adequately shown, described, and/or detailed in the above referenced contract documents.
- Marque Signage, Mounting, Assembly, Erection, Support, and Foundation to be by others. This proposal ONLY includes piping and wiring to the signage location, with final connection to signage wiring which is to be provided by manufacturer as a single point of connection.
- It is understood through notations on the contract documents used to prepare this proposal that spoils haul-off are to be by this contractor.

**The following items are specifically excluded from our proposal:**

- Painting, Patching, Repair, or Replacement of existing surfaces
- Temporary lighting, telephone, and/or power or costs thereof
- Low Voltage: Telephone, Data, CATV, CCTV, Alarms, Fire Alarm, HVAC Control - wiring or devices

BASE BID: \$ 3,117.00

**- Pricing -**

ALTERNATE: \$ 324.00

- alternate pricing for the time-clock device includes pricing for a standard **NON ASTROLOGICAL** time controller.

*If bonding is required, please add 2.5% to our base bid.*

Should this proposal be accepted, please forward a signed contract or purchase order to our office with the pricing as stated on this proposal. Please forward a resale certificate, if applicable, as our proposal does not include any applicable taxes.

Please call me if you have any questions regarding this proposal.

Sincerely,

Jeremy Funk  
Project Manager / Estimator





# JAG ELECTRIC

BYERS Construction, Inc.  
3662 Doniphan Dr.  
El Paso, TX 79922

Tuesday, December 10, 2013

Attention: Carmen Byers

Regarding: Alderete Middle School Marquee Electrical

The following is our Electrical Proposal for the above referenced project. It is based on the documents and criteria listed below.

Plans: Drawings Dated 25 Nov. 2013

Specifications Dated: N/A

Addendum: #1 - received 12-06-2013

- Scope:**
- As per drawings and addenda, provide and install conduits extending from within the existing building to a new marquee sign location. There are provisions for 277V single phase power and a data raceway included in this proposal. At the marquee location, a disconnect and 2KVA transformer to provide 120V power are also included, prior to the connection to the marquee signage.
  - Trenching for all electrical work outlined in referenced drawings is included.
  - Trench backfill, including 2-sack to bottom of paving in paved or concrete covered areas.

**Clarifications:**

- The correctness and completeness of the contract documents is the sole responsibility of those who have prepared them. This proposal covers only that work that is adequately shown, described, and/or detailed in the above referenced contract documents.
- Marque Signage, Mounting, Assembly, Erection, Support, and Foundation to be by others. This proposal ONLY includes piping and wiring to the signage location, with final connection to signage wiring which is to be provided by manufacturer as a single point of connection.

**The following items are specifically excluded from our proposal:**

- Painting, Patching, Repair, or Replacement of existing surfaces
- Temporary lighting, telephone, and/or power or costs thereof
- Low Voltage; Telephone, Data, CATV, CCTV, Alarms, Fire Alarm, HVAC Control - wiring or devices
- It is understood through notations on the contract documents used to prepare this proposal that concrete cutting, removal, and spoils haul-off are to be by others, and are NOT included in this proposal.

**- Pricing -**

BASE BID:	\$	<u>11,327.00</u>
ALTERNATE:	\$	<u>324.00</u>

- alternate pricing for the time-clock device includes pricing for a standard **NON ASTROLOGICAL** time controller.

*If bonding is required, please add 2.5% to our base bid.*

Should this proposal be accepted, please forward a signed contract or purchase order to our office with the pricing as stated on this proposal. Please forward a resale certificate, if applicable, as our proposal does not include any applicable taxes.

Please call me if you have any questions regarding this proposal.

Sincerely,

Jeremy Funk  
Project Manager / Estimator



**PROPOSAL**

**CODE ELECTRIC, INC.**  
codeelectric.inc@gmail.com

5049 Crossroads  
El Paso, TX 79932

Tel: (915) 581-6979  
Fax: (915) 581-7018

Proposal Submitted To Byers Construction	Phone (915) 740-3331	Fax (915) 599-2829	Date December 11, 2013
Street 3662 Doniphan	Job Name		
City/State El Paso, Texas	Job Address		

We hereby submit specifications and estimate for:

**Includes:** Complete Electrical As Per Plans, Electrical Permit Fee, Davis Bacon Wage Scale.

**Does Not Include:** Paint, Patch, Concrete Cut/Removal, Pavement Cut/Removal, Formed Concrete, Addenda

Canutillo Middle School	\$ 3,281.00	Alternate#1	\$ 282.00 Add
Alderete Middle School	\$17,527.00	Alternate#1	\$ 282.00 Add

We propose hereby to furnish material and labor—complete in accordance with above specifications, for the sum of:

\_\_\_\_\_ dollars ( \$ )

Payment to be made as follows:

All material is guaranteed to be as specified. All work to be completed in workmanlike manner according to standard practices. Any alteration or deviation from above from above specification involving extra costs will be executed only upon written orders, and will become an extra charge over and above estimate. All agreements contingent upon strikes, accidents or delays beyond our control. Owner to carry fire, tornado and other necessary insurance. Our workers are fully covered by Workmen's Compensation Insurance.

Authorized  
Signature **SERGIO RAZO**

Note: This proposal may be  
Withdrawn by us if not accepted within 30 days

**Acceptance of Proposal:** The above prices, specifications and conditions are satisfactory and are hereby accepted. You are authorized to do the work as specified. Payment will be as outlined above.

Date of Acceptance: \_\_\_\_\_

Signature: \_\_\_\_\_

RECEIVED DEC 11 2013



December 11, 2013

Byers Construction, Inc.  
3660 Doniphan Dr.  
El Paso Texas 79932

Attn: Walter Byers

Project: Canutillo Middle School

**PROPOSAL**

Furnishing of all labor, material, and equipment for the above reference project.

Removal of 48 shrubs and store at storage yard  
Removal of 648 sq ft of landscape screenings, weed barrier fabric and store on site  
Removal and re routing of irrigation system lateral lines  
Re installation of 48 shrubs  
Re installation of 648 sq ft landscape screening under layed with weed barrier

**TOTAL \$ 994.00**

Exclusions: Warranty on plant material

Should you require any additional information, please do not hesitate to call me.

RECEIVED DEC 11 2013

Avelardo Martinez

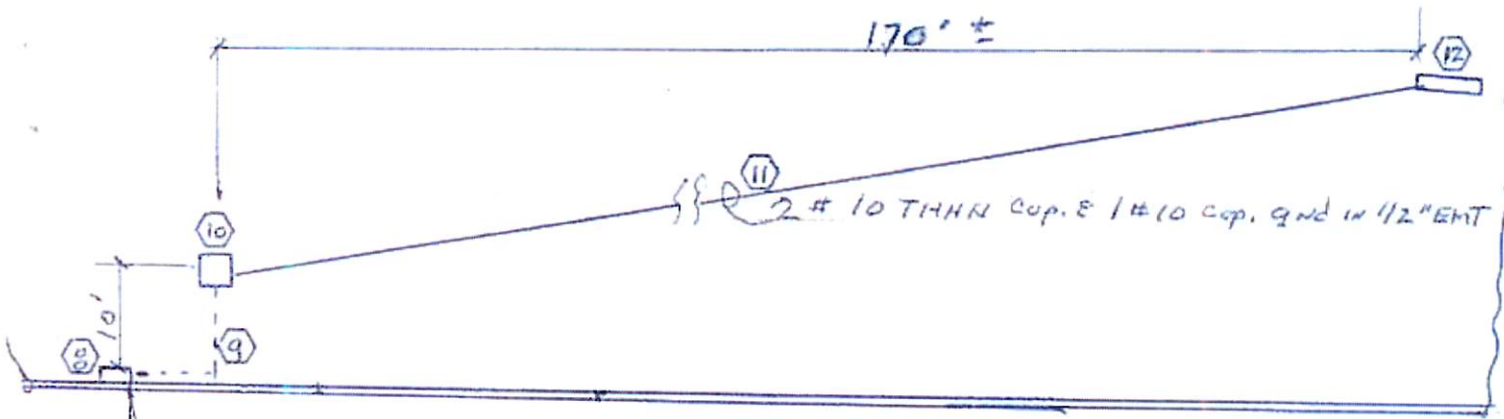

CANUTILLO MIDDLE SCHOOL MARQUEE  
ELECTRICAL KEY NOTES

2 # 10 THHN Cop & 1  
# 10 Cop. Gnd in  
EXIST. 1/4" Conduit.

1. Existing 1-1/4" PVC conduit at paved parking lot
2. Intercept 1-1/4" PVC conduit & reroute to sign
3. Sign Disconnect & Step-Down Transformer SEE DETAIL "A"
4. Concrete Sign Foundation by others
5. MARQUEE SIGN by others
6. Existing 1-1/4" PVC, abandon in place
7. Landscape area, REPORT DAMAGE TO IORRIGATION LINE TO CONTRACTOR  
Protect plants & leave area clean. Haul-off excess soil.
8. Existing J-BOX in room 300G
9. Existing 1-1/4" EMT to above lay-in ceiling
10. New J BOX
11. New 1/2" EMT w/ 2 ea # 10 THHN copper & 1 # 10 copper ground wire
12. Terminate at new 1 pole <sup>20</sup> amp breaker in existing 277/480V panel in room 234

140' ±

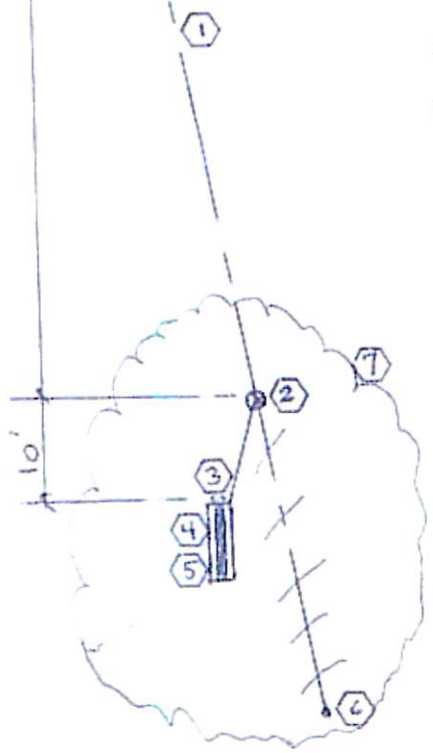

CONSTRUCTION, INC.  
CANUTILLO MIDDLE SCHOOL  
Electrical Drawings for Marquee  
Sheet 1 of 2 25 Nov. 2013

# MEMORANDUM

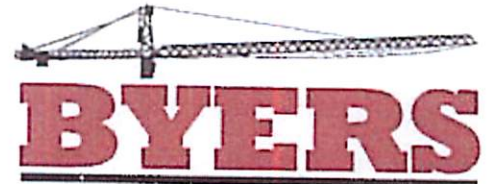

CONSTRUCTION, INC.

CANUTILLO MIDDLE SCHOOL

Electrical Drawings for Marquee

Sheet 2 of 2 25 Nov. 2013

## ELECTRICAL KEY NOTES (H)

1. Connect to sign wiring provided by sign manufacture at base of sign.
2. 1-1/4" PVC. Connect to existing. See note 2, sheet 1 of 2.
3. 30A, 1 pole WT disconnect, lockable
4. Acme # T-2-79742-5 step down transformer, 277V, 1 phase primary  
120V, 1 phase secondary.
5. Galvanized UNISTRUT support, embed in concrete
6. ALTERNATE # 1. Provide 1 pole 30 amp. Time switch in WT enclosure.

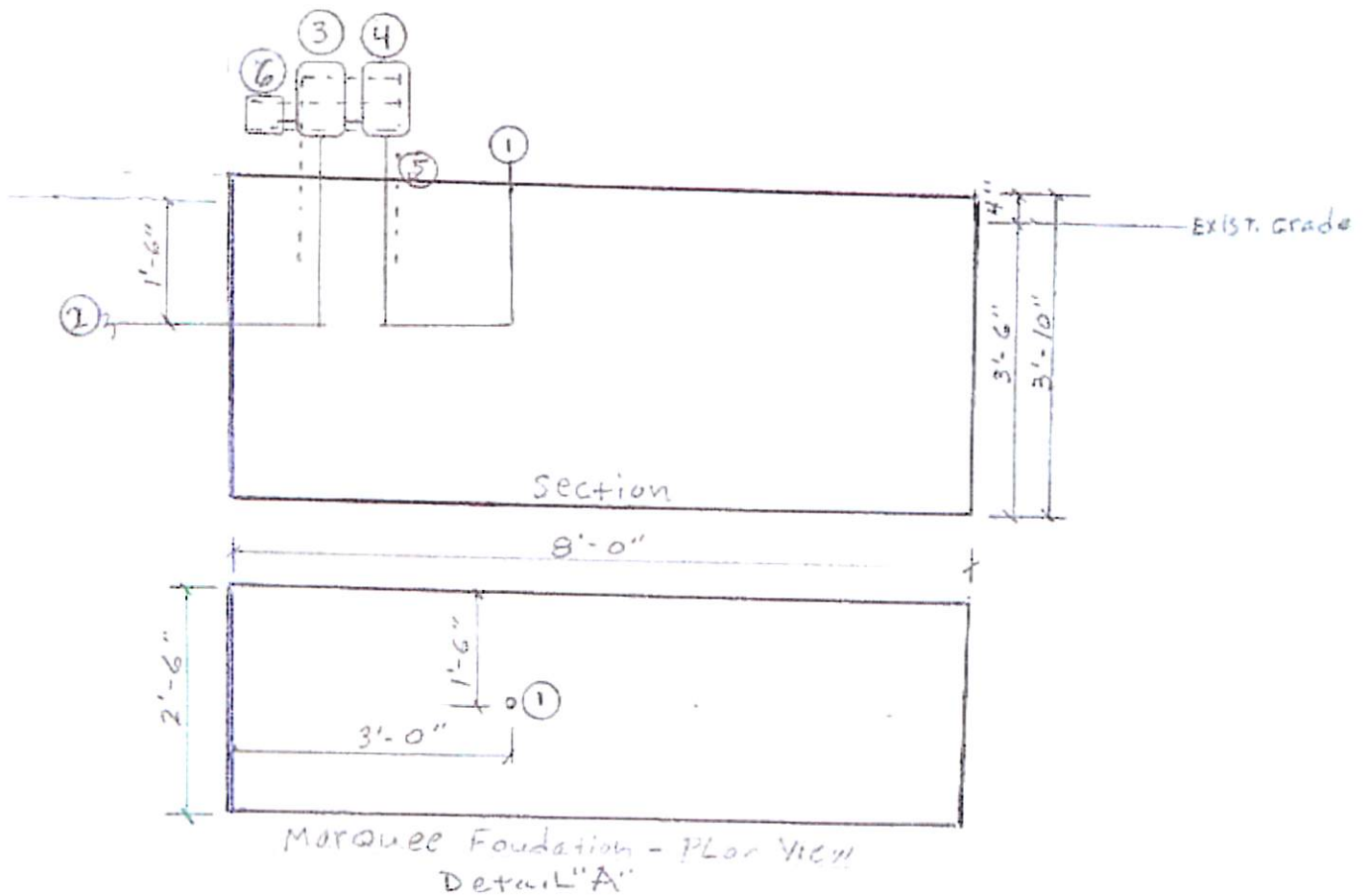

3662 Doniphan Drive El Paso, Texas 79922 Ph: (915) 581-7797 Fax: (915) 599-2829  
Cell: 740-3331 Email: wsbyers@byers-construction.com Web: www.byers-construction.com

A Hard  to Beat



sidewalk

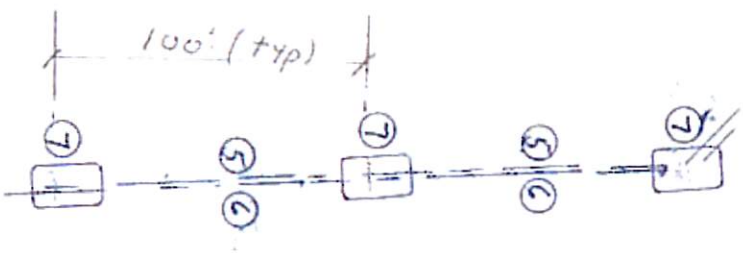
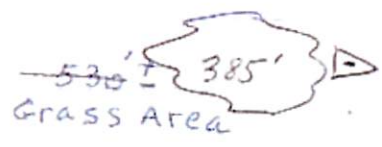
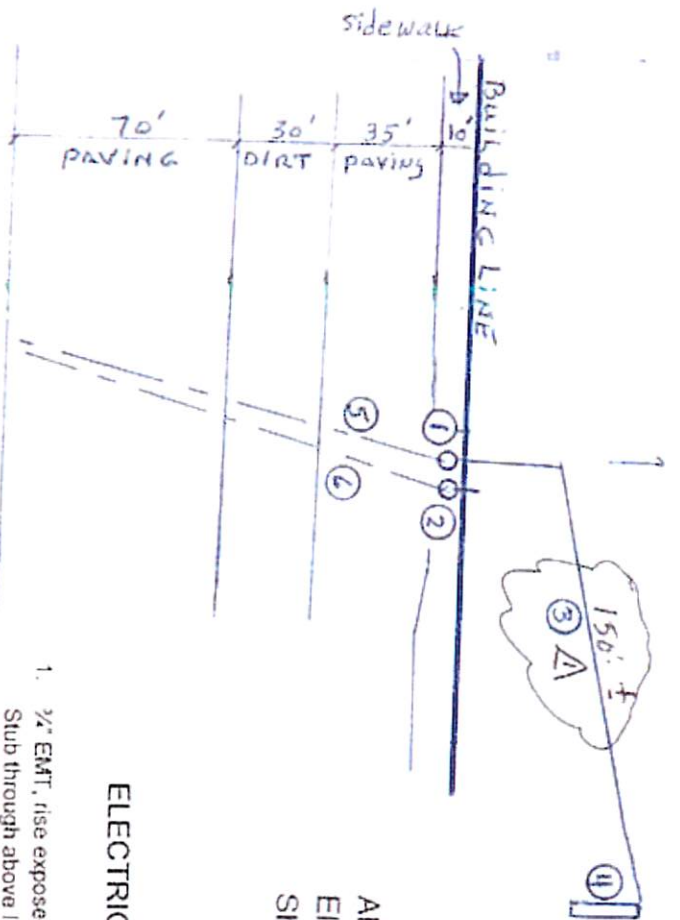

**BYERS**  
 CONSTRUCTION, INC.  
 Alderete Middle School  
 Electrical Drawings for Marquee  
 Sheet 1 of 2 25 Nov. 2013

**ELECTRICAL KEY NOTES**

1. 1/2" EMT, rise exposed on face of building to LB conductor Slub through above lay-in ceiling for power line.
2. 2" EMT, rise exposed on face of building to LB conductor Slub through above lay-in ceiling for Communication lines. Communication lines by others.
3. 1/2" EMT above lay-in ceiling. 2 # 8 copper thn conductors & 1 # 8 copper ground.
4. Terminate at existing 277V/480 panel. Provide 1 pole 20 Amp breaker in spare space.
5. 1/2" PVC underground to sign. See sign detail on sht. 2 of 2
6. 2" PVC underground to sign. See sign detail on sheet 2 of 2
7. Provide 1/4" nylon pull rope at 2" EMT & PVC 12" x 16" x 12" deep underground Pull Box
8. Concrete foundation (by others). See detail on sheet 2 of 2
9. MARQUEE sign by others

**GENERAL NOTES**

- It is anticipated that all work hereunder shall be executed & completed during Christmas break from 12/21/2013 through 1/5/2014
1. Trench excavation to be minimum 6" wide x 24" deep
  2. Install 2" PVC at bottom of trench with 4" covering of excavated soil
  3. Install 1/2" PVC at top of 4" backfill
  4. At sidewalk & parking lots, backfill remainder of trench with 2 sack sand/cement mix up to bottom of concrete or paving
  5. At dirt & grass areas backfill trench to existing grade with excavated material to 90% density
  6. Saw cutting & removal of concrete & paving is by others. Stock pile excess excavated soil at site for removal by others.
  7. Provide barricades & flagman as required for public safety
  8. Provide & pay for any & all permits & fees required by State, County Or City enforcement agencies.
  9. All work must meet Local & national codes.

*1 - addendum # 1 Revised*  
*Am,*

ELECTRICAL KEY NOTES (H)

5. 1/2" PVC, 2 ea. # 8 THWN copper conductors & 1 # 8 gnd. underground to power source in building.
6. 2" PVC conduit underground to above ceiling at building, provide 1/4" nylon pull rope.
10. 30 Amp. 1 pole WT disconnect, lockable.
11. ACME # T-2-79742-5, 2 KVA step down transformer  
277 V, 1 phase primary, 120 V, 1 phase secondary
12. Galvanized Unistrut support, embedded in concrete
13. Connect to sign wiring provided by sign Manufacturer at base of sign.
14. ALTERNATE # 1 Provide 1, pole 30 amp time switch in WT enclosure.

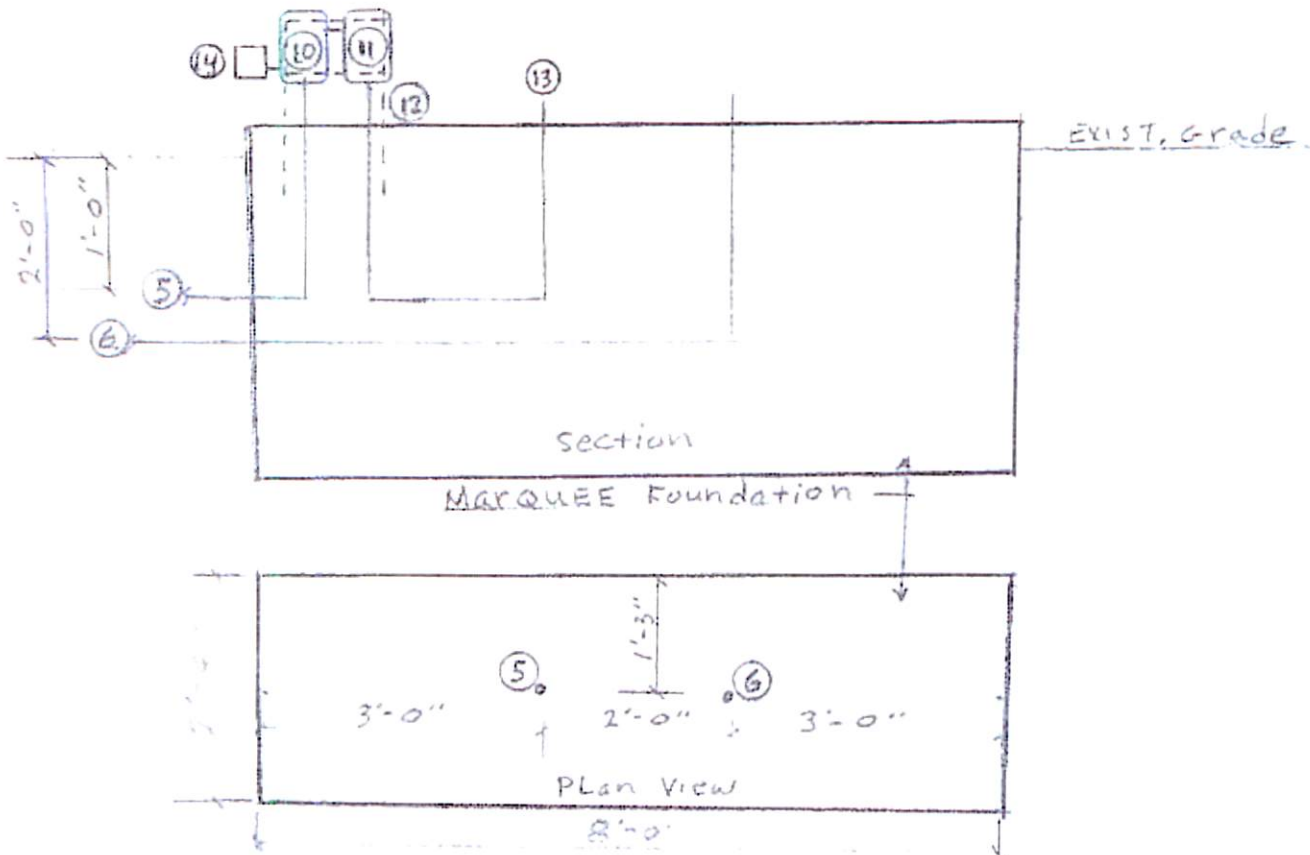

# Attachment 1.2



## MEMORANDUM

Dominic Padilla, Executive Director  
Facilities & Transportation  
Canutillo Independent School District

07 January 2014

ATTN: Edgar Goytia, Bond Project Manager  
Arlene Garcia, Bond Field Superintendent  
RE: Marquees at CMS & AMS

Response is to your telephone request on 06 January 2014 regarding your directive to confirm our quotation of 12 Dec. 2013 on subject project(s), & to provide additional pricing for removal of three (3) each mature mesquite trees adjacent to Talbot Road at Alderate Middle School.

Our price to perform the work at both campuses in accordance with our quotation of 12 Dec. 2013 remains:	\$35,498.00
Your cost for removal of trees is:	\$622.00
Total cost without timed switch control is:	\$36,120.00
Add for timed control operation:	\$480.00
<b>TOTAL COST:</b>	<b>\$36,600.00</b>

Although we will exercise all due precaution during excavation, including implementation of Texas "DIG TESS" procedures, the above pricing does not include any cost associated with inadvertent damage to underground appurtenances of any kind, nor cost of loss of services because of any such inadvertent damage.

Upon receipt of your purchase order & notice to proceed, we will furnish a complete schedule of construction events.

Sincerely,

  
Walter S. Byers, VP Estimator

3662 Doniphan Drive El Paso, Texas 79922 Ph: (915) 581-7797 Fax: (915) 599-2829  
Cell: 740-3331 Email: wsbyers@byers-construction.com Web: www.byers-construction.com

A Hard  to Beat