

5/6/25

Proposed Site Preservation & Historical Marker

- **Bob Kroening**

Out lot H, Liberty on the Lake
Stillwater, MN

Proposed Site Preservation & Historical Marker....

Out lot H, Liberty on the Lake (currently designated as open green space) is near the intersection of Manning Ave. & Highway 12 and adjacent to the Washington county walk/bike trail, *Rutherford Road*, & *Rutherford Elementary School*.

View of Rutherford Elementary from the ✕ on the map

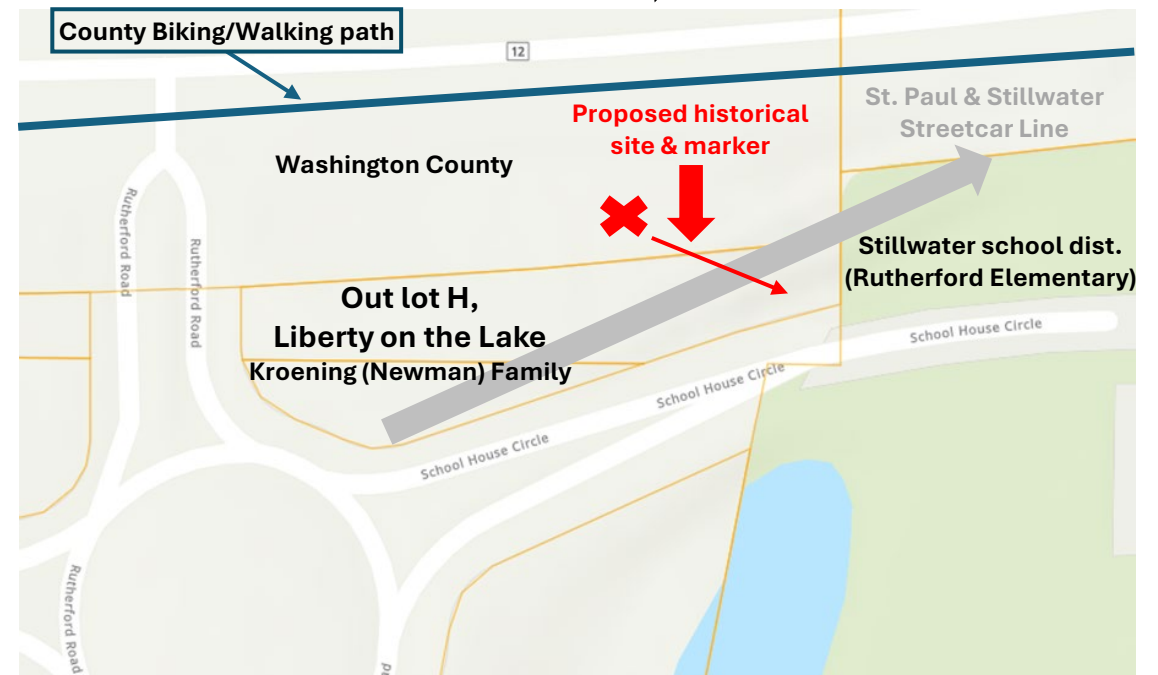
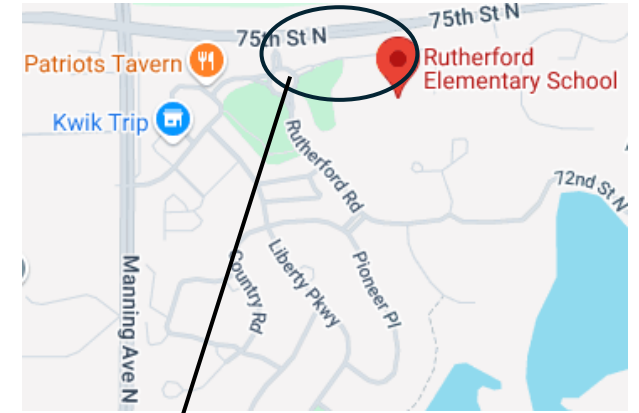

Why preserve the site & have a historical marker?

Utilize dedicated green space to preserve & share unique history of the area.

Historic *Rutherford* Neighborhood

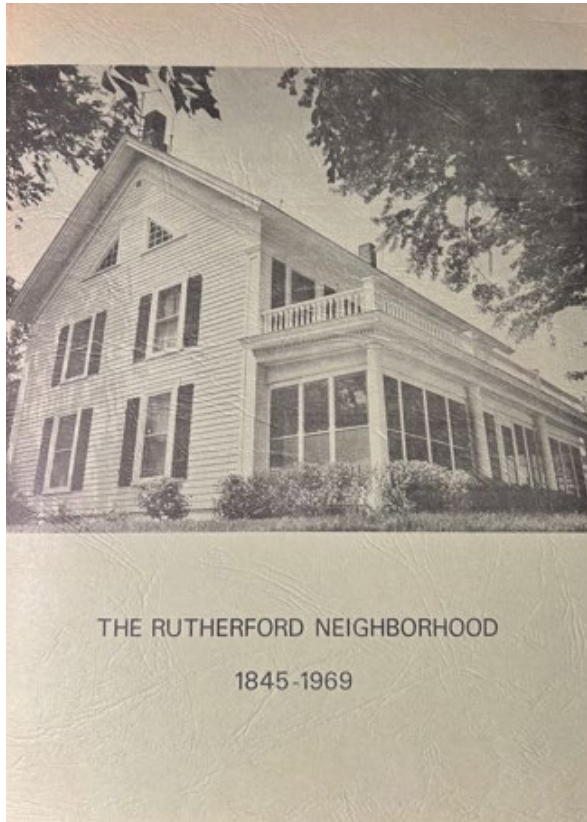

Twin City Lines St. Paul & Stillwater Streetcar Line



Historic Rutherford Neighborhood....

In 1969 Mildred Abbetmeyer Newman wrote & published book on the Rutherford Neighborhood.

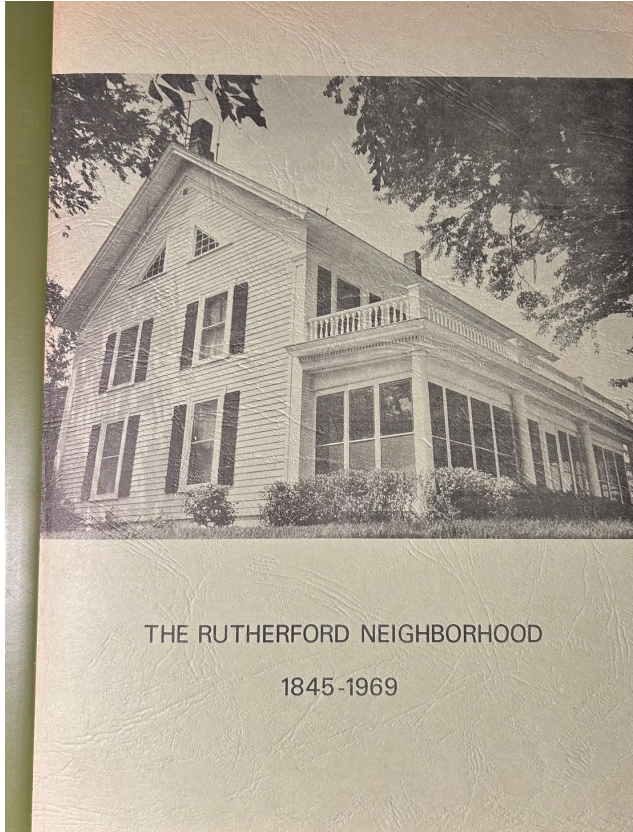

There are many histories written about Minnesota, Washington County and Stillwater. Some of the most interesting and rare stories that are told are those from neighborhoods. Don Empson wrote about several of the Stillwater neighborhoods back in the 1990s and early 2000s, but Mildred Newman wrote the first neighborhood history about the Rutherford Neighborhood.

In the front of the book Mildred noted, “In assembling the information for the twenty-five or more sketches in this Rutherford Neighborhood historical study, the author visited the Neighborhood families, discussing with them their genealogies, experiences, and facts and figures contained in their journals and diaries.” She also said, “The people of the historic Rutherford Neighborhood three miles west of Stillwater, Minnesota, in Washington County, possessed character and stability that contributed strength and vitality to a young and growing nation. The lives of the people here were dominated by love of home and country, by love of the good earth, and by love of God. They were hard working, honest, and frugal. The name of Rutherford was applied to the area because of the numerical dominance of settlers by the name of Rutherford.”

- 7/25/21 Stillwater Gazette, Brent Peterson's Back in Time column.

Historic Rutherford Neighborhood....

Farming community 3 miles west of Stillwater, in Washington County (circled in map below), was homesteaded in the 1840s & 1850s primarily by families from northeastern US including the Boutwell, Brosious, Masterman, Newman, Powell, Ramsden, Rutherford, Taft, & Webster families.

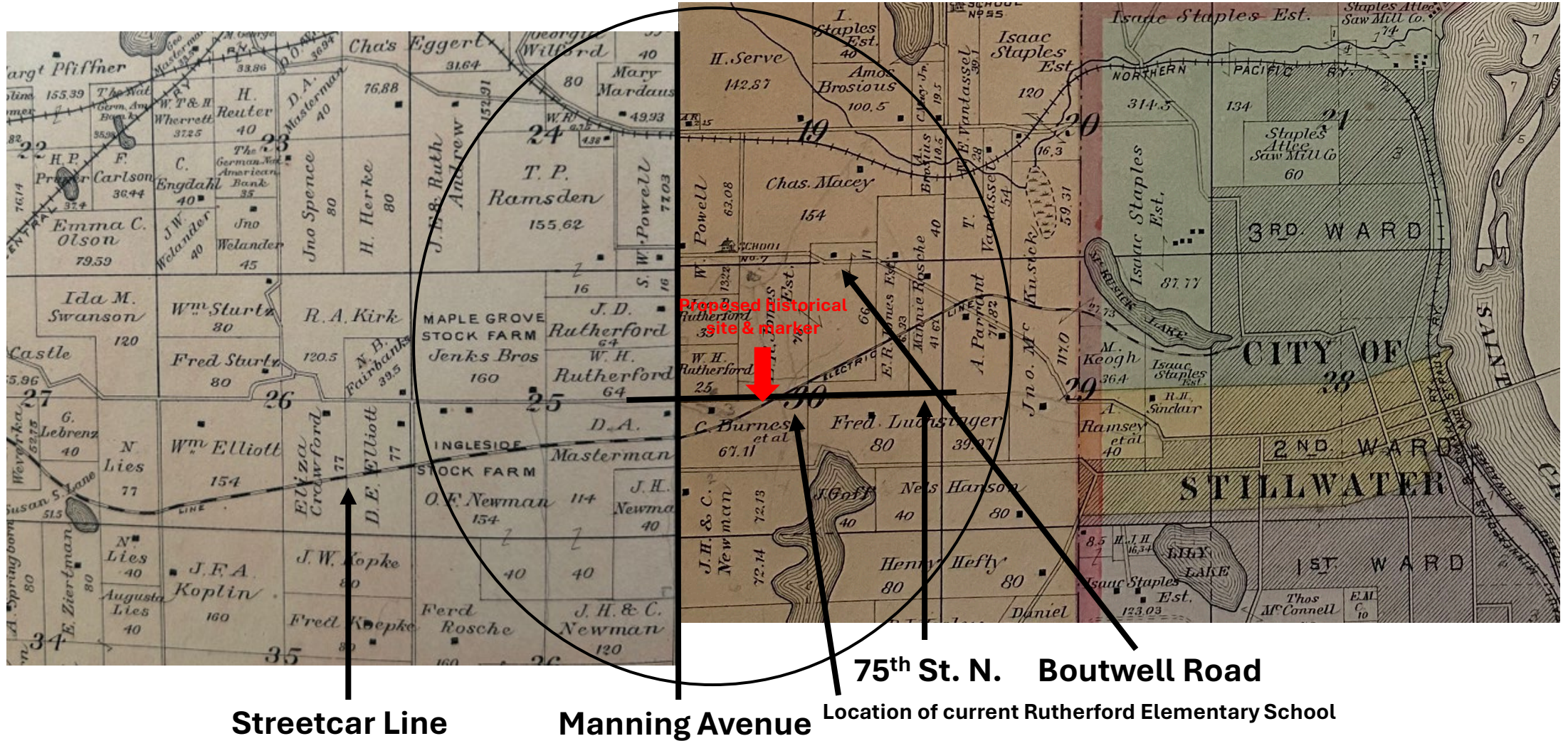

Historic Rutherford Neighborhood....

As the community grew the Rutherford family donated land in 1850s for a cemetery and schoolhouse. Rutherford School (District #7) was located on Stillwater Road (now Boutwell Road) and closed in 1912. The Rutherford cemetery (located on Manning Ave) still serves the community today.

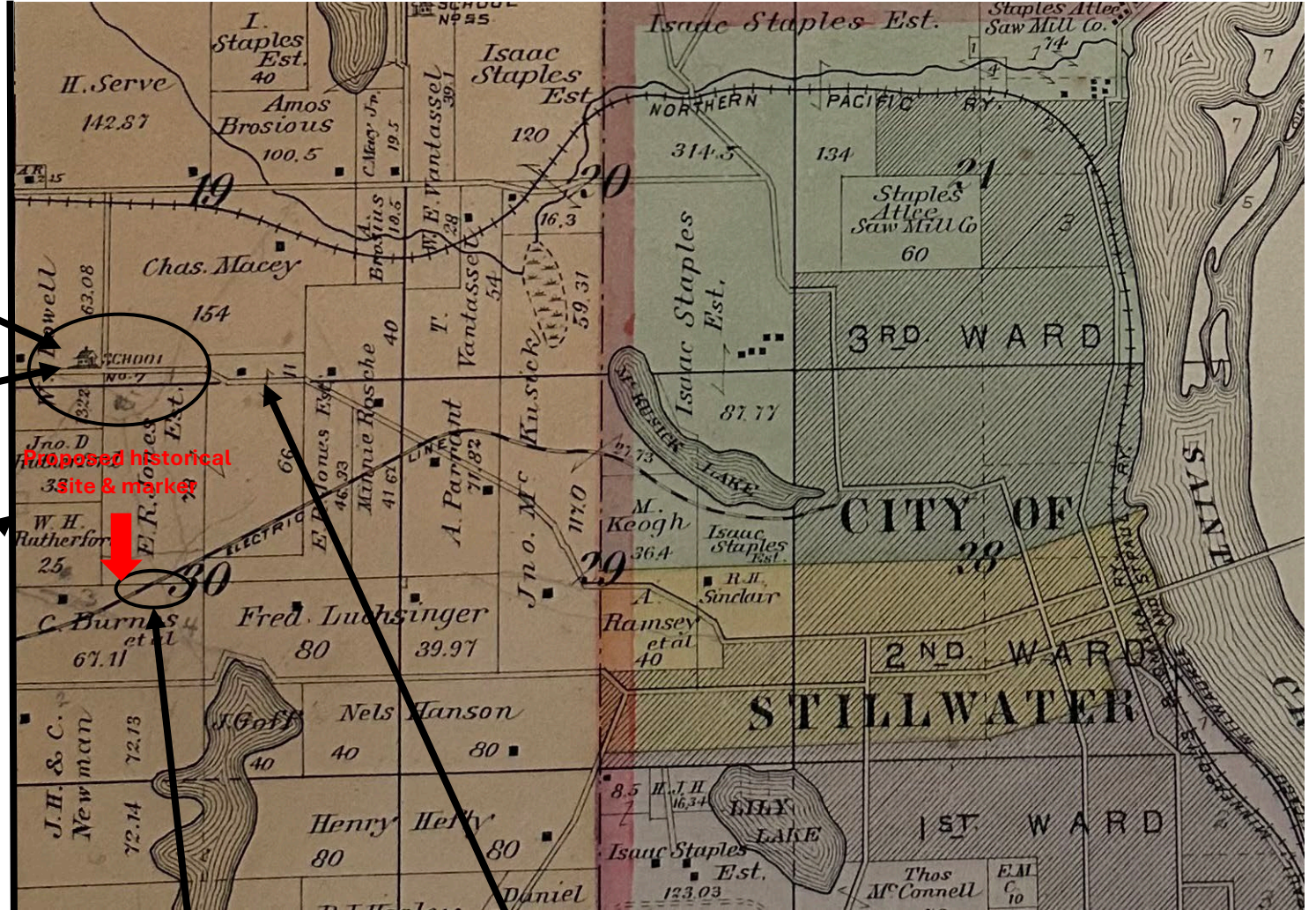

Manning Ave.

Location of current Rutherford Elementary School

Boutwell Road

- Map image from 1901 Washington County Plat Book

Historic Rutherford Neighborhood....

Originally named Browns Creek Elementary local residents successfully petitioned to have the name changed to Rutherford Elementary to honor the history of the Rutherford Neighborhood.



Additionally, inspired by the original district # 7 Rutherford schoolhouse architects designed the main entrance to Rutherford Elementary in recognition of the school's unique history.

St. Paul & Stillwater Streetcar line....

Extended the Twin City Lines streetcar system to Stillwater in 1899. The St. Paul & Stillwater interurban line enabled people to travel by streetcar from Stillwater all the way to Excelsior.

- Map images from 1914 Twin City Lines Streetcar Line Map

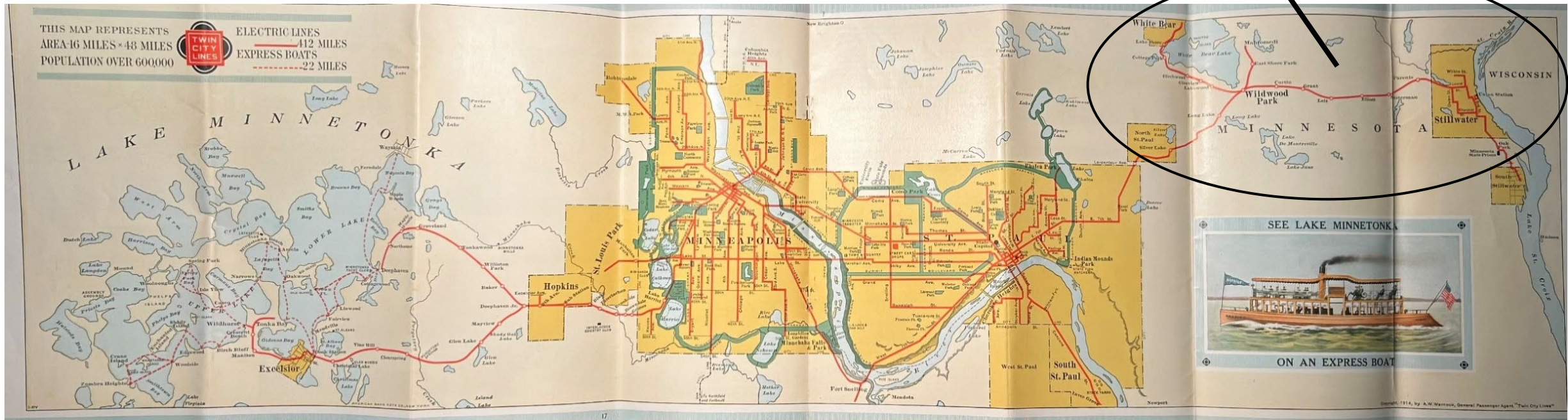
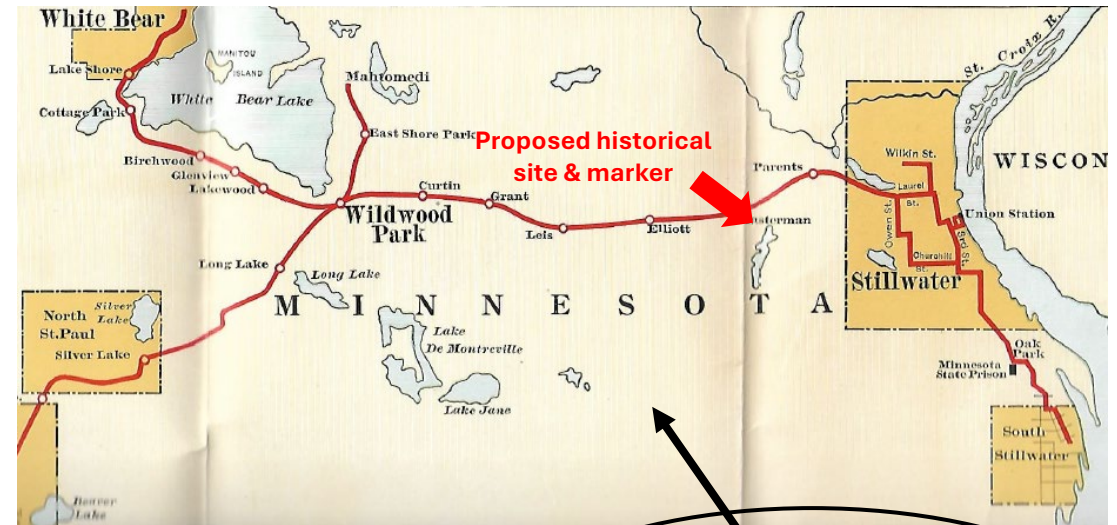

St. Paul & Stillwater Streetcar line....

Provided public transportation for the city of Stillwater passing by the Carnegie Library, St. Croix Drug Company @ corner of Chestnut & Main Street, and stopping at the Stillwater Depot. The line was used until 1932.



- 1906 postcard images

St. Paul & Stillwater Streetcar line....

Traveled across and through the middle of the historic Rutherford Neighborhood and along the shoreline of McKusick Lake.

- Map image from 1914 Twin City Lines Streetcar Line Map

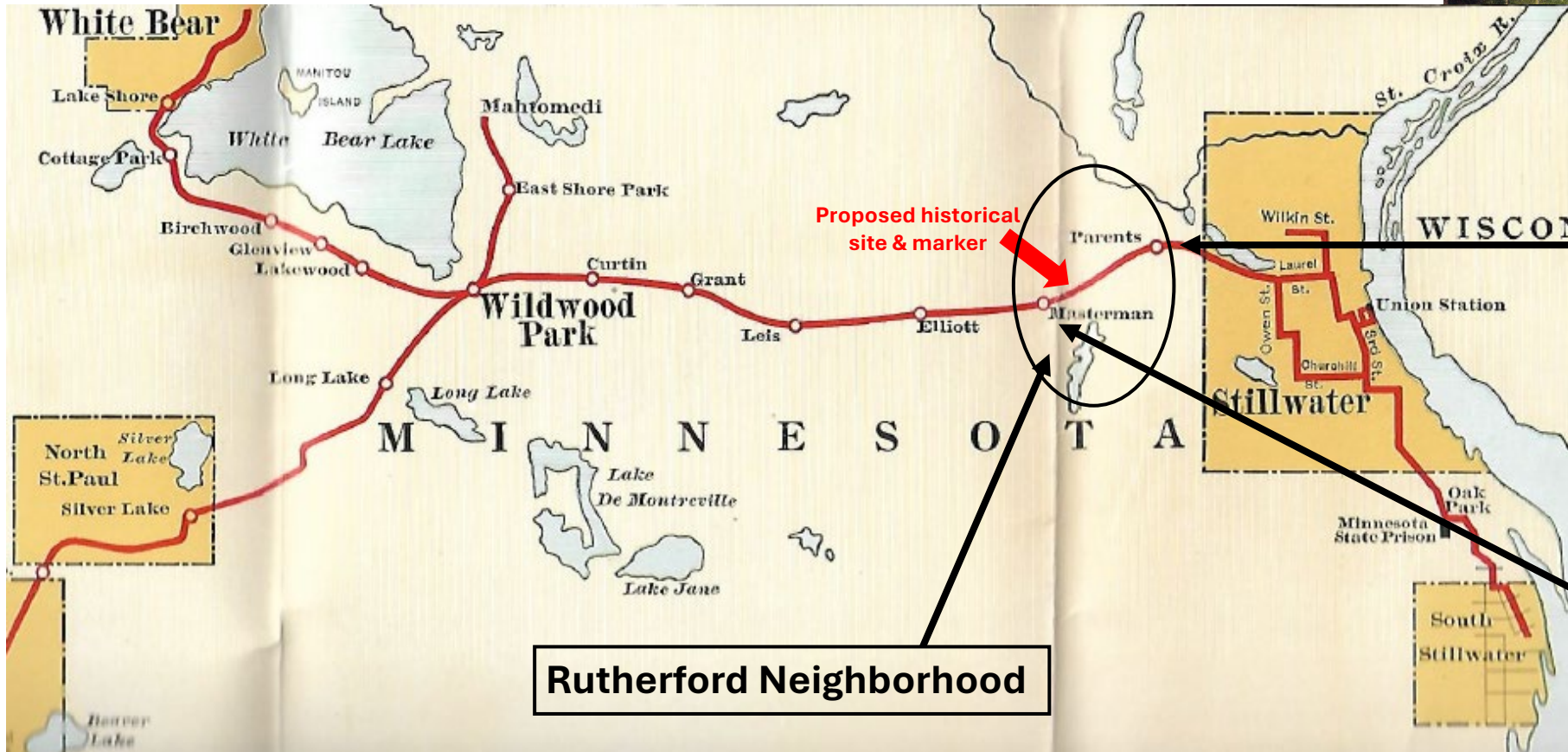

Rutherford Neighborhood



1906 postcard photo taken at this point in streetcar line as interurban car approached Parents Siding.

Parents Siding and Masterman's Crossing (near intersection of Manning Ave & Hwy 12) served historic Rutherford Neighborhood

St. Paul & Stillwater Streetcar line....

Parents Siding – allowed interurban cars going in opposite directions (to St. Paul & Stillwater) to pass.



FRIDAY, MARCH 16, 1917.

SNOW, MORE SNOW

Has Fallen Today With a Strong Northeast Wind—Probably Another Foot of the Beautiful.

The indications were numerous today that we would have a sufficient fall of snow to equal the total of 1903, 80 inches. We had 70 inches before the storm of today broke on us. It snowed hard all day with little indication of a cessation of hostilities.

While not as cold by many degrees as the Sunday a few weeks since, the snow fell as rapidly and as persistently, making street car travel slow and tedious. The interurban cars were seriously impeded, the last car coming in about 11:30 this forenoon.

The trains on the Omaha and the Milwaukee were in on time this forenoon, but what will happen this afternoon is uncertain. The Northern Pacific reports trains in this morning, but the chances for any this afternoon are slim.

It is feared all the cuts in the interurban as well as on the railroad lines will be filled with snow, making it impossible to get through until the storm abates.

LATER—Delayed interurban cars arrived at 12:30 and 2 o'clock p.m., but whether any more will get through is a question. A car left Stillwater for St. Paul about 2 o'clock, but no assurance was given that it would get through.

March 16th – 17th 1917 snowstorm buries St. Paul & Stillwater interurban car @ Parents Siding - 1/2 mile NE of proposed historical marker.



St. Paul & Stillwater Streetcar line....

Masterman's Crossing - named after Rutherford Neighborhood resident Albion Masterman (farm nearby).



Clarence Newman Family Barn

Above: Opposing 1913 views of **Masterman's Crossing** - approx 200 yards SW of proposed historical site & marker.

With Twin City Lines Streetcar Company's support up to 600 people attend Red Cross fundraiser @ Clarence Newman's barn – June 14, 1918.



Priscilla Club (Rutherford Neighborhood women's volunteer community service club) raised \$494.20 for Red Cross.

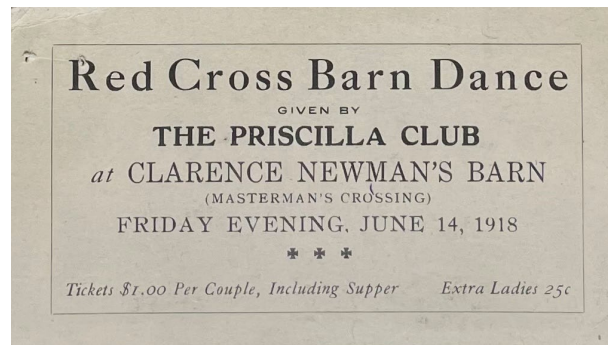

ELECTRIC LIGHTS IN NEWMAN'S BARN

The benefit Red Cross dance at Clarence Newman's barn tonight will have some illumination, electric lights having been installed there today. That's going some for a country dance, we think.

- Stillwater Gazette : June 14th & 15th, 1918

BARN DANCE AT C. NEWMAN FARM DECIDED SUCCESS

Between 500 and 600 people attended the barn dance given at the Clarence Newman farm, a short distance from Masterman station on the interurban line last night, thus assisting in swelling the Red Cross funds as the receipts were donated to that cause.

An owl car was placed in operation by the street car company in order to handle the crowd and this arrived in the city about 2 o'clock.

During the evening short patriotic talks were made by State Senator Sullivan and others, the remarks of the speakers being greeted with cheers by the merrymakers.

It was a great gathering and every one present enjoyed the occasion immensely.

Proposed Site Preservation & Historical Marker....

Utilize dedicated green space to preserve & share unique history of the area.

The original Rutherford school bell was presented to the school by the Kroening (Newman) family @ Rutherford Elementary dedication.

Historical marker location could be positioned to provide a clear line of sight to front entrance of Rutherford Elementary School *AND* restored St. Paul & Stillwater streetcar line bed *PLUS* provide information regarding historic Rutherford Neighborhood, streetcar line, and local native Americans that pre-date the Rutherford Neighborhood.



Underneath all the overgrown/fallen trees & brush is a portion of the original St. Paul & Stillwater streetcar line including a cow pass. When the land is cleaned up & preserved, and small portion of the streetcar line is restored, it would be easily seen from county walk/bike path.



Proposed Site Preservation & Historical Marker....

Will require a partnership with Washington County, City of Stillwater School Board, & Kroening (Newman) family.



View of county biking/walking path



Rutherford Elementary School



Example of historical marker



Out lot H – Kroening (Newman) family

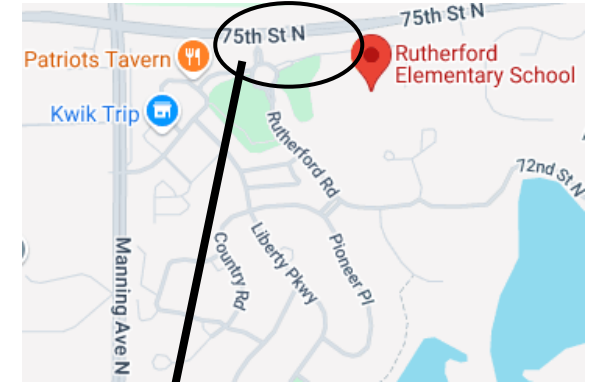

1. **Kroening (Newman) family** is interested in donating land (Out lot H) to Stillwater school district. 2025 property taxes - \$60.00.
2. **Brent Peterson** (Executive Director of the Washington County Historical Society) & **Aaron Isaacs** (Minnesota Streetcar Museum Board Chair) support proposal & are interested in providing their expertise to help preserve the site & install a historical marker.
3. **Bob Kroening** is interested in volunteering to lead representative team to create site plan & submit grants to secure required funding.