



ALEDO ISD BOARD MEETING TEMPLATE

MEETING DATE: May 18, 2015

AGENDA ITEM: Consider Approval of Purchase of Portable Classrooms

PRESENTER: Earl Husfeld

ALIGNS TO BOARD GOAL(S): Financial/Facilities – The District shall exhibit excellence in financial and facility planning, management, and stewardship.

BACKGROUND INFORMATION:

- Per Board Policy CH (Local), any single, budgeted purchase of goods or services that costs \$50,000 or more, regardless of whether the goods or services are competitively purchased, shall require Board approval before a transaction may take place.

ADMINISTRATIVE CONSIDERATIONS:

- During discussions for the 2015 bond election, it was noted that McAnally Intermediate School's enrollment exceeds the facility's functional capacity.
- It is anticipated that schedule modifications for the 2015-2016 school year will address some of the space concerns that have occurred during the current school year.
- To also assist with space concerns, we are recommending a portable classroom building be acquired for the 2015-2016 school year.
- To ensure the best pricing and value, the District utilized the TASB BuyBoard cooperative purchasing method to obtain the quote on the following pages from Ramtech Building Systems, Inc. (Ramtech). As noted on the quote, the District has the option of purchasing or leasing the portable classroom building.
- As Templeton Demographics is scheduled to present their updated demographic report to the Board of Trustees during the June board meeting, I am suggesting the method of payment be determined at that time.
- However, to ensure delivery of the portable classroom building prior to the start of the 2015-2016 school year, I am seeking Board of Trustee approval to commit to Ramtech for the purchase. Ramtech staff has confirmed to me their agreement with this arrangement.

FISCAL NOTE:

The method of purchase will determine the ultimate cost.

ADMINISTRATIVE RECOMMENDATION:

The Administration recommends the Board of Trustees approve the District's commitment to acquire one (1) portable classroom building from Ramtech Building Systems, Inc., with the method of payment being determined at a later date.



AMERICA'S LEADER IN
DESIGN-BUILD
MODULAR
CONSTRUCTION

May 13, 2015

Via e-mail: superintendent@aledo.k12.tx.us

Dr. Derek City
Superintendent
ALED0 INDEPENDENT SCHOOL DISTRICT
1008 Bailey Ranch Rd.
Aledo, TX 76008

Re: Pricing Proposal Portable Classroom Building

Dr. City:

Ramtech appreciates your interest and the opportunity to provide you with a pricing proposal for a portable 24'x64' double classroom building. The BuyBoard pricing (Contract #463-14) is for new state approved commercial grade buildings constructed according to the attached floor plan and specifications.

The lease option is subject to credit review. The finance companies require 3 years audited financials and a current budget summary for review.

Purchase 24'x64' Double Classroom Building without Restrooms: \$50,310.00 per bldg.

Lease 24'x64' Double Classroom Building without Restrooms:

24 Month lease: \$1,100.00 per mo. per bldg

Deliver and installation: \$5,875.00 per bldg.

Dismantle and removal: \$5,875.00 per bldg.

Optional:

Treated 6'x12' wood deck with 4'x30' ramp: \$3,880.00

Note: Pricing for aluminum assemblies will be provided upon request.

Pricing Includes:

- Delivery & Installation - Aledo, TX
- C.M.U. block pad on grade foundation
- Anchor type tie-downs - (Additional cost may be incurred for buildings set on asphalt or concrete surfaced due to anchoring requirements)
- Skirting to grade on all sides
- Metal exterior and roof
- Lay-in acoustical ceiling

Page 2 of 3 - Pricing Proposal Portable Classroom Building

Pricing Includes:

- Vinyl covered gypsum wall panels
- Carpet
- Exterior wall hung HVAC
- Main Distribution Panel and crossovers
- State approved stamped engineered drawings

Pricing does not include:

- Site preparation (including grading, compaction or demolition, landscaping or irrigation)
- Building permits (Any fees charged by the city or county agencies for the movement of mobile office or modular buildings over local roads are considered as part of the local building permit cost.) Building will not be constructed until owner has obtained the required building permit.
- Furniture, window coverings, etc.
- Canopies
- Disconnection of utilities or removal of landing/ramp assemblies at end of lease period
- Entry assemblies (quoted as an option)
- Fire alarm/sprinkler system
- Performance and payment bond
- Permanent foundation
- Poured concrete
- Ramtech's Builders Risk Insurance excludes flood coverage in Flood Zones A, V, or D as defined by FEMA
- Taxes if applicable
- Utility extension/connections
- Waxing or sealing of vct (if required)
- Wind certification (if required)
- The scope of this design does not include accessibility elements required for the site. It is the owner's responsibility to have these designs developed and to make submittal as required by the Texas Architectural Barriers Act, through their design professional. This submittal should be made to: Texas Department of Licensing and Regulations, Architectural Barriers Section, P.O. Box 12157, Austin, TX 78711.



AMERICA'S LEADER IN
DESIGN-BUILD
MODULAR
CONSTRUCTION

Page 3 of 3 - Pricing Proposal Portable Classroom Building

I will contact you to discuss any questions you might have or please feel free to contact me via email at squeen@ramtechgroup.com or by calling 800-568-9376 ext. 145.

Sincerely,
Sabrina Queen
Education Representative

Note: Pricing is for valid for 30 days only, subject to availability and credit review. All pricing is based on a level, accessible site.

Ramtech RT Portable Classroom

Schools all across the SouthWest

Project Size

1536 sq ft

Facility Use

Portable Classroom

Description

Vinyl covered gypsum interior

Wall-hung HVAC units

Metal exterior & roof

Completion

About 30 days

Temporary
Modular
Construction

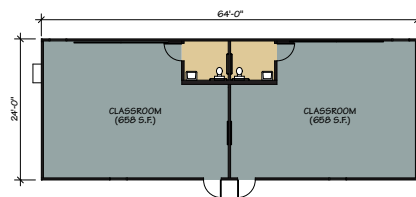

	CLA-1536-A	1536 Sq. Ft.	CONTACT INFORMATION
	DOUBLE CLASSROOM BLDG. WITH RESTROOMS		4400 U.S. Highway 297, Suite 100 Houston, TX 77058-0759 (832) 1536-4576 (817) 474-2559 (fax) info@ramtechmodular.com



In 1982 Ramtech pioneered the concept of building all-modular portable classrooms and relocatable modular buildings that have now been in use by hundreds of public, private, and faith-based schools throughout the Southwest. The Ramtech RT (sale) and LT (lease) series portable classrooms, available with and without restrooms, are the largest selling portable classroom in Texas. At 1,536 square feet, each Ramtech double classroom building includes two three-ton wall-hung HVAC units, carpet or tile flooring, vinyl covered gypsum interiors, and marker boards. All Ramtech portable classrooms are available for sale or lease through the Texas Buy-board, TIPS (The Interlocal Purchasing System) and HGACBuy (Houston Galveston Area Council) purchasing cooperatives.

800-568-9376
ramtechmodular.com