

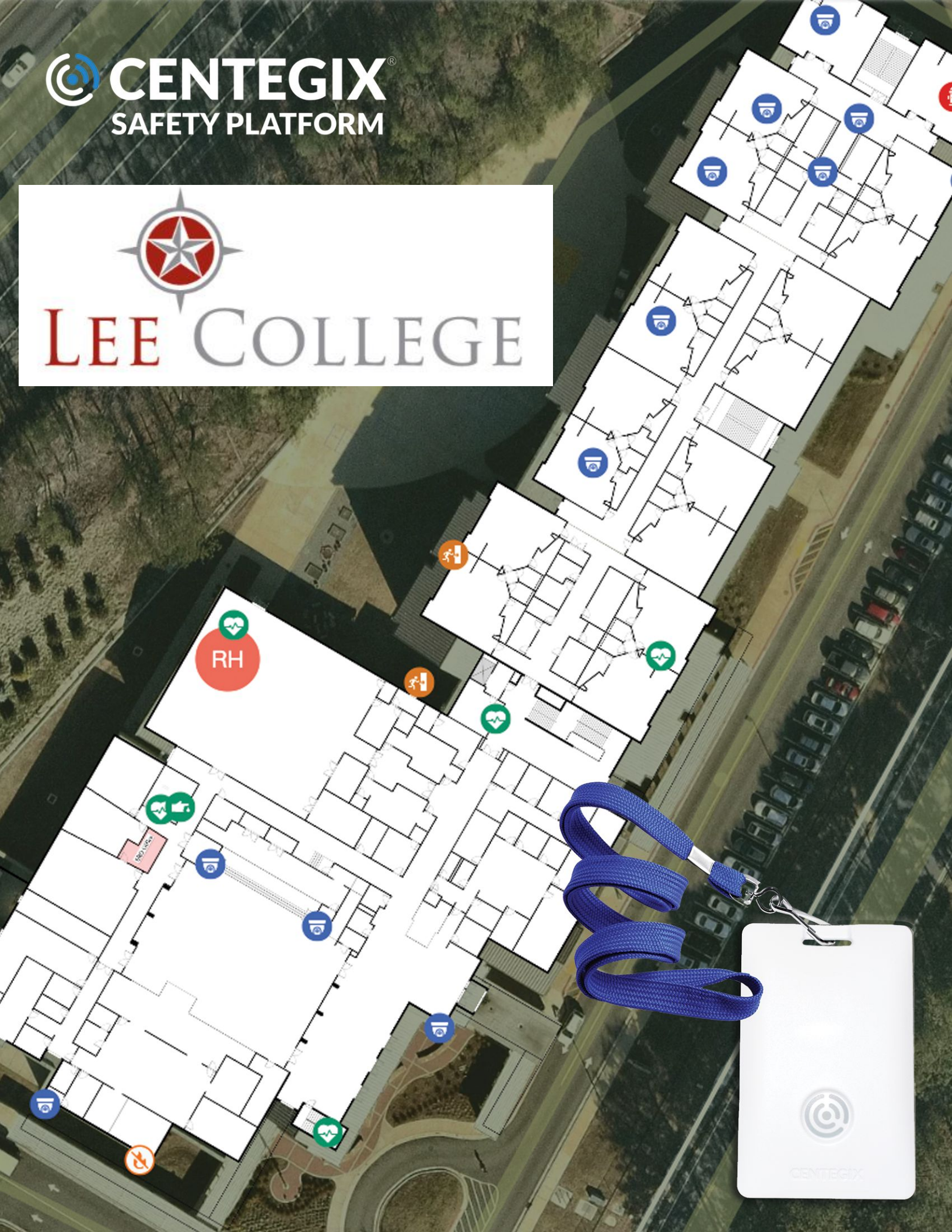

LEE COLLEGE





Executive Summary

Centegix is pleased to partner with Lee College as part of their layered security and safety plan. Lee College faculty and staff are able to indicate discretely that they need help, or feel uncomfortable, at any time on campus with a simple push of a button with our CrisisAlert badge.

CENTEGIX®—the industry leader and largest wearable panic alert provider for education—innovates technology to empower and protect people every day. Trusted by safety leaders nationwide, CENTEGIX was founded in response to concerns that traditional safety solutions didn't reflect the realities on campus or use the best technologies for moments of crisis. Our conversations with education leaders indicated that staff needed more effective solutions for incident response.

We believe that an integrated, layered approach to safety is fundamental and that no one within an organization should be limited in their capacity to be—and feel—safe. The CENTEGIX Safety Platform™ was designed to integrate additional solutions and be the foundation for a safety ecosystem.

Time is the single most critical factor in incident response. The more efficiently you can utilize time, the better the outcome. The Safety Platform accelerates emergency response by minimizing the time to identify, notify, and respond to an emergency.

Identify: All staff must be able to quickly, easily, and discretely indicate that there is an emergency. A one-step button click sends the alert immediately.

Notify: Accelerates the emergency communication to everyone onsite through full audio and visual notifications directing all to follow safety protocols. Onsite response teams immediately receive alerts with a map showing who needs help and where they are located. For a campus-wide alert, local 911 integration directly alerts emergency resources with precise location information.

Respond: How rapidly people take the right action for the best possible outcome. Onsite, in a campus-wide emergency, everyone moves to get behind a hard surface and locked door. The onsite response team has the right location and knows where safety assets are.

Every second matters. With the push of a button on our wearable CrisisAlert badge, an alert instantly reaches administrators and first responders with precise location details mapping out where help is needed. Simultaneously, strobe lights, an intercom announcement, and a desktop computer takeover make *everyone* aware that a lockdown is in effect and what they should do to optimize their safety.

Introduction

The CENTEGIX Safety Platform™ is the foundation for an efficient and effective, layered safety plan. The Safety Platform empowers users to prevent, prepare for, and respond to any adverse incident campus-wide. The platform unites and extends robust industry-leading solutions, including:

- **CrisisAlert™** wearable badge for incident response; the fastest and easiest way for staff to request help in any emergency, from the everyday to the extreme
- **Safety Blueprint™** campus mapping tool that provides a dynamic, precise map of all campus spaces and safety asset locations
- **Unified Control Center** to streamline all safety operations
- **Integrations** with many safety and security solutions offering automation and efficiency
- **Data and Analytics** provide actionable insight assist with compliance

Response time is essential in any emergency—from extreme situations such as an armed intruder to everyday crises like medical emergencies, severe weather, and physical altercations. The sooner you respond, the better the chances for a positive outcome. The CENTEGIX Safety Platform is a simple yet innovative solution that empowers every employee to participate in the safety of your organization.

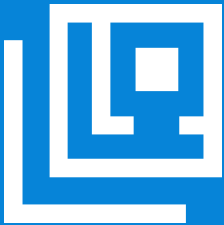

Goals & Objectives

Ensure the safety of students, faculty and staff

- **Maximize safety campus-wide with an innovative layered solution**

The CENTEGIX Safety Platform™ empowers users to address every critical aspect of safety campus-wide—from the everyday to the extreme.

- **Provide confidence and peace of mind**

From everyday incidents to emergency response, the CENTEGIX Safety Platform provides confidence and security through a multilayered approach that addresses all critical aspects of safety, from incident response to reporting, at all times.

- **Total coverage, all employees, all over campus**

The CENTEGIX Safety Platform is easy to install, easy to learn, and easy to use by all personnel. Through integrations with existing technology and safety systems — the Safety Platform increases the value and effectiveness of safety measures in place.



CrisisAlertTM

One Badge, TWO types of Alerts

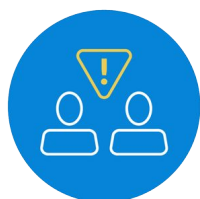

“I Need Help” Staff Alert

Medical, Fight, Flopement



Lockdown Campus-wide Alert

School/District Issue, Campus-wide Threat

CrisisAlert is an incident response solution that empowers all personnel to get help anywhere on campus with the push of a button. The wearable badge and single-button activation were designed with an intense practical focus on reducing response time during all types of emergencies. For campus-wide alerts, campus lockdown protocols start immediately. CrisisAlert instantly notifies 911 dispatch with precise—building, floor, room-level—location details. Visual and audio notifications are initiated campus-wide to make every person within the vicinity aware that a lockdown is in effect and what to do in order to protect themselves.



ONE-BUTTON ACTIVATION

The wearable badge has an accessible, single button enabling quick action under duress.



LOCATION ACCURACY

Alerts are visible on a digital map, down to the individual room and floor. First responders know exactly where they are needed.



IMMEDIATE NOTIFICATION

Campus-wide alerts are immediately sent to administrators and first responders with no time lost.



INDEPENDENT OF WI-FI/CELLULAR

On a private, installed network, separate from wi-fi and cellular, that connects badges, strobes, intercoms & more.



AUDIO & VISUAL NOTIFICATION

Campus-wide alerts communicate an emergency using strobes, desktop alerts and intercom integration.



TOTAL FACILITY COVERAGE

Network covers every square foot of campus, no dead zones. Badges work in the classroom and on the ball field.

Safety Blueprint[™]

THE POWER OF

Mapping



Critical Incident Mapping for Emergency Response

Digital campus and asset maps streamline communication and accelerates response time in workplace emergencies—from the everyday to the extreme.

- Reduce incident response time. Know the precise location of an incident and where to find the closest life saving devices.
- Understand the severity of an incident. Engage cameras at the location of the event to observe in real-time.
- Utilize a single source of truth One map with current and precise location mapping of every building and asset.

Safety Asset Management

Manually capturing all the information for your buildings and assets, especially at a multi-location level, is laborious and time-intensive, Safety Blueprint makes it easy to stay up to date and in compliance with safety protocols.

- Visualize where safety equipment and assets are physically located in your buildings and on your campus'.
- Utilize alerts to take action on assets due for maintenance or replacement.
- Reduce the time needed to manage inventory, maintenance and requisition reports
- Get rid of disparate spreadsheets and questionable version control.

BE ALIGNED & PREPARED

WITH CENTEGIX SAFETY BLUEPRINT™

First Responders have immediate access to relevant campus information that allows for faster, more effective response. Information such as locations of utility shutoff locations, AEDs, fire suppression equipment, alarm panels and cameras are all readily displayed for enhanced situational awareness.

Security Planners can create scenarios where they add assets, add pictures and information about existing assets, to support improvement requests to decision makers regarding needed additional security measures.

Emergency Planners can define zones, update room names and numbers, evacuation routes, evacuation and reunification staging areas and shelter operations by color shades on the map.

Safety and Facilities have a comprehensive view of their resources like utility shutoff locations, campus security resources, IT resources, evacuation points and other user-defined information. Designated safety and facility users can add or update safety information as the facility's structures and assets evolve.



PRECISE ASSET & ALERT LOCATION FOR RESPONDERS

- Safety and security map layer provided at no additional cost with CENTEGIX Safety Platform™
- CENTEGIX CrisisAlert™ locating assets included on the safety layer



SINGLE MAP SOURCE FOR ALL APPLICATIONS

- Map leveraged by **Visitor Management, Safety Planning, Incident Response, and Reunification** aligning all stakeholders with the most current information



MULTIPLE LAYERS BUILT ON MAP FOUNDATION

- Safety, Security, IT and Facilities each have a custom map layer with their assets
- Add, move, change assets as needed
- Changes to the core architectural map roll forward and are reflected on each layer



ACTIVE DIRECTORY/SINGLE SIGN-ON INTEGRATIONS

- Assign access to maps and editable layers based on user logins
- Use assigned roles to authorize/deauthorize access to maps by external groups like local governments and software companies



MAKE UPDATES AS THEY HAPPEN

- Make architectural changes to structures with a scaled drawing
- Add assets of all types to the maps at any time
- Share and adjust maps prior to publishing
- Version control enables maps to be rolled back



- Safety Platform – CrisisAlert & Safety Blueprint
- Full Main Campus coverage
~675k GSF & 950 badges
- Liberty Dual Credit Campus
- Huntsville Center
- McNair Center
- Educational Opportunity Center
- 120-day implementation
- 5-Year Term



Tentative Project Timeline

TASK	ASSIGNED TO	PRE-PLANNING	PLANNING					SYSTEM SET-UP, INSTALLATION, & TRAINING															TESTING, END-USER TRAINING, & GO LIVE		
			WK 1	WK 2	WK 3	WK 4	WK 5	WK 6	WK 7	WK 8	WK 9	WK 10	WK 11	WK 12	WK 13	WK 14	WK 15	WK 16	WK 17	WK 18	WK 19	WK 20	WK 21	WK 22	WK 23
Provide Site Maps <small>(If maps are not received by week one, the timeline will be extended)</small>	Customer																								
Return fully executed P.O. and Order Acknowledgement	Customer																								
Kick-off meeting	Customer & CENTEGIX																								
Review NW Drop Map and Complete Workbook	Customer																								
Ship Gateways and Complete NW Drops	Customer																								
Confirm Gateways are online and on network	Customer & CENTEGIX																								
Ship Equipment	CENTEGIX																								
Complete System Set-Up	Customer																								
Training & District Communication Preparation	Customer & CENTEGIX																								
Install equipment	CENTEGIX																								
Install Revisits if Needed, Final Training Prep	Customer & CENTEGIX																								
Conduct Responder Training	Customer & CENTEGIX																								
Conduct Testing	Customer & CENTEGIX																								
Staff Training & Distribute Badges	Customer																								
Go Live!	Customer																								

Timeline varies based on project size and completion of core dependencies



Quote

Sales Rep: Justin Masek

Submitted on: 4/8/2025
(Valid 45 days)

Quote # JM10092024LC

Terms (Years) 5

Bill To:
Lee College
200 Lee Drive
Baytown, TX. 77520

Product Item / Fee	Annual Recurring Rate	Term Amount
SAFETY PLATFORM with CrisisAlert™ - Main Campus (35 buildings and 675K GSF with 950 badges) - TIPS Contract #230105	\$80,000	\$400,000
Liberty Dual Credit Campus		
Huntsville Center		
McNair Career Center		
Educational Opportunity Center		
Safety Blueprint	included	included
Annual Fees - CrisisAlert		
Wireless Backup	\$1,800	\$9,000
Annual & Full-Term Platform Sub-totals:	\$81,800	\$409,000
One Time Fees - CrisisAlert™		
Installation & Setup		\$29,025
CENTEGIX Gateway Cabling & Installation		\$18,000
Implementation		\$18,950
Shipping		\$2,700
On-Site Responder Training		\$4,000
One Time Fees - Safety Blueprint™		
Remote Installation and Remote Training	included	included

NOTES:
Quote includes site mapping and training, along with software licensing and hardware warranty based on the term selected. *Preliminary site count listed pending a final site list from customer.

Annual contract will renew after the selected term expires at CENTEGIX then current pricing.

CENTEGIX™ will invoice based on the following billing milestones:
• 50% invoiced upon the PO date/order date
• 50% invoiced 120 days after PO date/order date (anniversary date)
• All invoices are payable on Net 30 terms.

Any remaining fees (if applicable) will be invoiced annually upon the

One-Time Fees Sub-total: \$72,675

Full Term Contract Total \$481,675

Hardware and Software as a Service model
\$81,800 per year for 5 years
\$72,675 one-time installation and professional services fee
Year 1 - \$154,475
Year 2 - \$81,800
Year 3 - \$81,800
Year 4 - \$81,800
Year 5 - \$81,800

Amounts do not include local, state or federal taxes. If you are tax exempt, please provide a tax exempt form otherwise sales tax will be charged.

Facilities Address Info

Updated 8/15/2024

Building	Address	Gross SQFT	Assignable SQFT
650 W. Texas Ave	650 W. Texas Ave., Baytown, TX 77520	24,000	21,000
700 W. Texas Ave.	700 W. Texas Ave, Baytown, TX 77520	3,500	3,500
909 Decker	909 Decker Dr., Baytown, Texas 77520	21,168	21,168
Adult Learning Center	101 S. Whiting, Baytown, Texas 77520	7,414	4,338
Advanced Technology Center (ATC/Library)	150 Lee Dr., Baytown, Texas 77520	75,000	54,043
Barney Gray Science Building (SB)	200 Lee Dr., Baytown, TX 77520	38,000	30,000
Bonner Hall	200 Lee Dr., Baytown, TX 77520	30,074	19,220
Diana Gray Childcare Center	#2 Price St., Baytown, Texas 77520	10,000	8,000
Grounds Shop (Maintenance)	511 S. Whiting St., Baytown, Texas 77520	704	588
Gymnasium and Pool	200 Lee Dr., Baytown, TX 77520	34,000	27,180
John Britt Hall	200 Lee Dr., Baytown, TX 77520	28,754	21,970
Liberty Dual Credit Campus	1710 Sam Houston Ave., Liberty, Texas 775	14,791	14,000
Maintenance Storage (Maintenance)	511 S. Whiting St., Baytown, Texas 77520	504	478
McNair Career Center	3411 E. Freeway, Baytown, Texas 77521	6,535	6,535
McNulty Haddick Complex	711 W. Texas Ave, Baytown, Texas 77520	65,000	52,000
Moler Hall	200 Lee Dr., Baytown, TX 77510	25,706	20,467
North Central Plant	616 W. Gulf, Baytown, Texas 77520	5,345	5,194
Performing Arts Center	805 W. Texas Ave., Baytown, Texas 77520	57,960	57,960
Plant Maintenance Building	501 S. Pruett St., Building, Baytown, Texas	10,368	6,932
Rundell Hall (includes Huddle Wing)	200 Lee Dr., Baytown, TX 77520	52,274	37,366
San Jacinto Mall Rental Facility	4804 E. Freeway, Suite B, Baytown, TX 775	3,000	3,000
Shipping and Receiving	511 S. Whiting St., Baytown, Texas 77520	6,094	6,045
South Central Plant	200 Lee Dr., Baytown, TX 77510	6,212	6,036
Student Center Food Bank & Resource Advocacy Center	200 Lee Dr., Baytown, TX 77520	29,455	24,455
Tucker Hall	200 Lee Dr., Baytown, TX 77520	5,000	4,500
TV 1	200 Lee Dr., Baytown, TX 77520	34,566	27,650
TV 2	200 Lee Dr., Baytown, TX 77510	13,679	13,679
TV 3	200 Lee Dr., Baytown, TX 77510	9,763	9,763
TV 4	200 Lee Dr., Baytown, TX 77510	2,252	2,252
TV 5	200 Lee Dr., Baytown, TX 77510	5,000	5,000
TV 6	200 Lee Dr., Baytown, TX 77510	6,000	6,000
TV 7	200 Lee Dr., Baytown, TX 77510	5,202	5,202
TV 8	200 Lee Dr., Baytown, TX 77510	3,358	3,358
TV 9	200 Lee Dr., Baytown, TX 77510	7,623	6,800
Vehicle Maintenance Building	511 S. Whiting St., Baytown, Texas 77520	5,042	4,817
Wellness Center/Sport Complex	550 Lee Dr., Baytown, TX 77520	43,000	23,678
Huntsville Center	168 Col Etheredge Blvd. Huntsville, TX 77	9,100	9,100
Educational Opportunity Center	4804 1-10 Ste.B Baytown, TX 77521	1,000	
	Total	706,443	573,274

- 1 Rundell Hall
- 2 Advanced Technology Center & Library
- 3 Performing Arts Center
- 4 McNulty-Haddick
- 5 Center for Workforce & Community Development
- 6 Student Center
- 7 Tucker Hall
- 8 John Britt Hall
- 9 Huddle Building
- 10 Security Facility
- 11 Bonner Hall
- 12 Moler Hall
- 13 Gymnasium
- 14 Gray Science Building
- 15 Sports Arena & Wellness Center
- 16 Tech-Voc 1
- 17 Tech-Voc 2
- 18 Tech-Voc 3
- 19 Tech-Voc 4
- 20 Tech-Voc 5, Tech-Voc 6, & Tech-Voc 7
- 21 Tech-Voc 8
- 22 Tech-Voc 9
- 24 Pilot Plant
- 25 North Central Plant
- 26 South Central Plant
- 27 Physical Plant
- 28 Transportation
- 29 Shipping & Receiving
- 30 Adult Learning Center
- 31 The Lofts @ 700 W. Texas Ave.
Materials Warehouse (first floor)
- 32 The Salon @ 650 W. Texas Ave.
- 33 Tennis Center
- 34 Warehouses
- 35 119 Whiting House
- 36 Childcare Center

Important Phone Numbers
Main Line 281.427.5611
Admissions & Records 281.425.6393
Cashier Office 281.425.6324
Community Education 281.425.6311
Counseling 281.425.6384
Financial Aid 281.425.6389
Campus Tours 281.425.6260



Deliverables

Digitized Campus Maps

The ability to know where on campus an alert has been initiated, where the nearest AED is, and which entry point first responders should use is based on having your campus maps digitized, accessible, and accurate. The CENTEGIX Safety Platform utilizes your digitized campus maps to enable administrators, staff, and emergency responders to define, customize, and disseminate critical campus information during an emergency response. Staff and first responders have immediate access to relevant campus information and can locate all safety information including campus security resources, evacuation points, and more.

The CrisisAlert Responder App and CrisisAlert Desktop Application display alert notifications using to-scale, interactive maps to pinpoint the location where help is needed. This empowers responders to rapidly and accurately navigate to the alert location, reducing response times and improving overall emergency response.



Safety Network

The CENTEGIX Safety Platform functions on a private network that is managed and wireless and will not put a burden on your facilities team. Because the system does not rely on Wi-Fi or cellular service, neither your systems nor your IT administrators will experience a decreased bandwidth.

Our powerful analytics engine captures incident data, providing valuable information you can leverage to increase safety and security. Generate reports for resource allocation, compliance, and process improvement.

Hardware

Proprietary hardware components drive the **Safety Network's** alert activation, notification, and locating capabilities.

Components may vary based on site installation requirements.



CRISISALERT BADGE

- Provided to every employee
- Vibration signals alert activation
- Multi-year battery life



GATEWAY

- Connects to the Cloud
- 8-hour battery backup
- Cellular backup



STROBE

- Installed in every room
- Multi-color visual alerting
- Multi-year battery life



LOCATING BEACON

- One or more where visual notification not needed
- Indoor and outdoor
- Multi-year battery life

Software & Integrations

CENTEGIX's Safety Platform is powered by a private security network and SaaS cloud application. Via this portal, users can access all of the solutions included in the Safety Platform. From user management to location mapping, alert, and device configuration, every aspect can be seamlessly accessed from any web browser.

CrisisAlert's mobile application empowers users to efficiently manage emergency events directly from their smartphones (Android and iOS).

The platform provides the CrisisAlert Desktop Application for desktop usage compatible with PC and Mac systems, offering alert notifications and screen takeover capabilities.



CrisisAlert's Dashboard provides valuable insights for real-time monitoring and situational awareness. A comprehensive view of specific properties, multiple locations, or all properties, enables you to stay informed and respond to critical situations.

- **CrisisAlert Responder Application:** available to administrative personnel designated by the organization or campus.
- **CrisisAlert Dashboard:** actionable reporting lets you track trends across your campus, inform future incident responses, and measure protocol/process effectiveness.
- **Strategic Integrations:** integrates with key services to deliver notifications and communications to save precious time in an emergency.
 - Intercom systems - delivering audio announcements for campus-wide protection.
 - Data Network - enables screen takeover notifications.
 - National 911 Providers - routes notifications directly to emergency responders.

Methodology

CENTEGIX has a defined methodology for successfully implementing the Safety Platform for your campus. CENTEGIX's approach balances pace with control through a process that delivers value through collaboration and engagement. Each implementation has six stages.



Within each of these stages are the activities and deliverables utilized to properly plan, document, execute, and test the project work. Each stage has a specific objective, activities to be completed, key deliverables, and exit criteria.

CENTEGIX ONBOARDING SPECIALIST (OBS)

We will assign a CENTEGIX Onboarding Specialist (OBS) to be your main point of contact throughout the implementation process. Your OBS will guide you through each of the Phases—planning, collecting data, leading training sessions, conducting working sessions, gathering installation logistics, discussing configuration and testing best practices, monitoring progress, and communicating with stakeholders along the way.

PLANNING

We will understand your requirements, collect data, and prepare for the upcoming equipment installation. CENTEGIX kicks off the project by aligning on the established Statement of Work (SOW).

INSTALLATION & CONFIGURATION

We will install Safety Platform equipment at every site in the Order Acknowledgement unless otherwise noted with a change order. After installation is configuration; this phase includes User Management, Alert Types, Responder Groups, Responder Permissions, Desktop App Deployment, and Internal/External IP Settings for Desktop Takeover. The training consists of virtual admin training.

TESTING & TRAINING

We will test to ensure the system is fully functional based on the approved requirements and expectations. Training follows testing and consists of onsite or virtual responder training.

USER TRAINING/GO-LIVE

The objective of the use training/go-live stage is to ensure all staff are equipped with the knowledge and practice of pressing their CrisisAlert badge in the event of an emergency.

Methodology

PROJECT CLOSEOUT

After the project activities have been completed, we will transition you to our Customer Success Team where an Account Manager will ensure that you are getting the greatest value from the Safety Platform.

ONGOING SUPPORT

Once live, ongoing support is provided via the CENTEGIX Command Center and Support Desk which includes:

- Software/Firmware Upgrades
- Analytics
- 24/7 Proactive Device Monitoring and Notification
- Remote Access Support
- Technical Email Support
- Remote Webinar Training
- Support Library (Recorded Webinars, How To Videos, Digital Training Manual)
- Ongoing Account Review







Here recently, we're averaging probably two students a week that are having medical issues and we've had to call ambulances in. Our staff have gotten so comfortable that they're really hitting it now...Our response time has been in the seconds, not in the minutes. And it's been fantastic for us.

James Perry

Chief of Police, West Georgia
Technical College, GA

Platform Maintenance

Ongoing maintenance of both the software and hardware components of the Safety Platform is essential. Your maintenance agreement includes the following services:

	Safety Platform Cloud Platform provides access to configure, activate, and manage users and alerts.
	<p>Proactive service management software and notifications including automated 24/7 trouble ticketing and ticketing interfaces.</p> <ul style="list-style-type: none">• The CENTEGIX Command Center will proactively identify sites requiring IoT device updates and communicate those to the customer.• CENTEGIX will work with the customer to identify onsite personnel that can replace an IoT device or battery or a field service partner to complete.
	<p>Feature enhancement and routine version updates for all components on a monthly or quarterly basis including</p> <ul style="list-style-type: none">• Device software and firmware including strobe, beacon, hub, solar, and gateway devices.• Analytics and reporting software including an alert dashboard and export capabilities.• Mobile and desktop software for iOS and Android Software, as well as MSI/DMG files.• Responder software and interface available for web and alert software.
	<p>An annual detailed evaluation of each site to evaluate device health, network coverage, and battery life.</p> <ul style="list-style-type: none">• This review typically occurs in the summer months.• CENTEGIX and your partner (if applicable) will review the site evaluation with you, which includes details of the tune-up to be done, such as replacing devices with repeat issues or batteries with less than 6 months remaining.

Conclusion

CENTEGIX Safety Platform is the most effective and comprehensive public safety solution available. Emergencies will happen. When every second matters CENTEGIX CrisisAlert is a practical, accessible, and easy-to-use incident response system that is always available. Paired with our Safety Blueprint mapping software, you have a foundation to connect and extend your layers of safety and security solutions.



**SINGLE BUTTON
ACTIVATION FOR
EVERYONE**



**TOTAL CAMPUS
COVERAGE**



**LOCATION
INFORMATION SAVES
RESPONSE TIME**

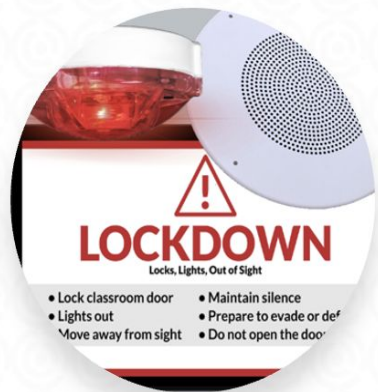

**AUDIO & VISUAL
NOTIFICATIONS
COMMUNICATE TO
EVERYONE**



TERMS & CONDITIONS

CENTEGIX standard terms and conditions, including the software end-user licensing agreement (EULA), are incorporated by reference and can be found at <https://www.centegix.com/legal-tc3/>