



To: Coppel ISD Board of Trustees
From: Sid Grant
Date: November 16, 2017

cc: Brad Hunt, Kelly Penny, Larry Guerra, Louis Macias

Re: Bus Lot Parking Addition at the CISD Service Center

As part of the purchase of fourteen new buses, it is necessary to increase the parking capacity of our bus lot at the CISD Service Center. Additionally, we need additional parking for maintenance, child nutrition, and technology vehicles, as well as, for our other Suburban type vehicles used for student and staff transportation. Our civil engineer, Glenn Engineering, created an efficient plan to add 22 additional bus spaces and about 27 additional spaces for other district vehicles and equipment. Please see drawing on page 2. This additional space should provide space for future vehicle growth, as well.

The Interlocal Contract purchasing method as provided in the Texas Education Code 44.031 was used to obtain proposals through the Educational Purchasing Cooperative of North Texas (EPCNT).

Choice Concrete, Inc. provided the proposal with the best value for the district. Choice Concrete provided a quote of \$186,735.00 as the total turn-key proposal. . The pricing includes all materials, labor, and removal/disposal of debris. Choice Concrete is a long-time, well respected vendor among our neighboring schools districts in the Dallas Fort Worth metroplex. We have used them numerous times, and have always been very pleased with their value and quality of work.

We will utilize a portion of the bond dollars set aside for this type of project (e.g. Project #32 – Recapture M&O Expenditures). This is the same set aside dollars we are using for the purchase of the new buses.

RECOMMENDATION: That the Coppel ISD Board of Trustees approve Choice Concrete, Inc. as the contractor to complete the bus lot parking addition at the CISD Service Center for the sum of \$186,735.00.

**Proposed Bus and Maintenance Vehicle Parking Addition at the
CISD Service Center
(Proposed addition is highlighted in dark grey)**

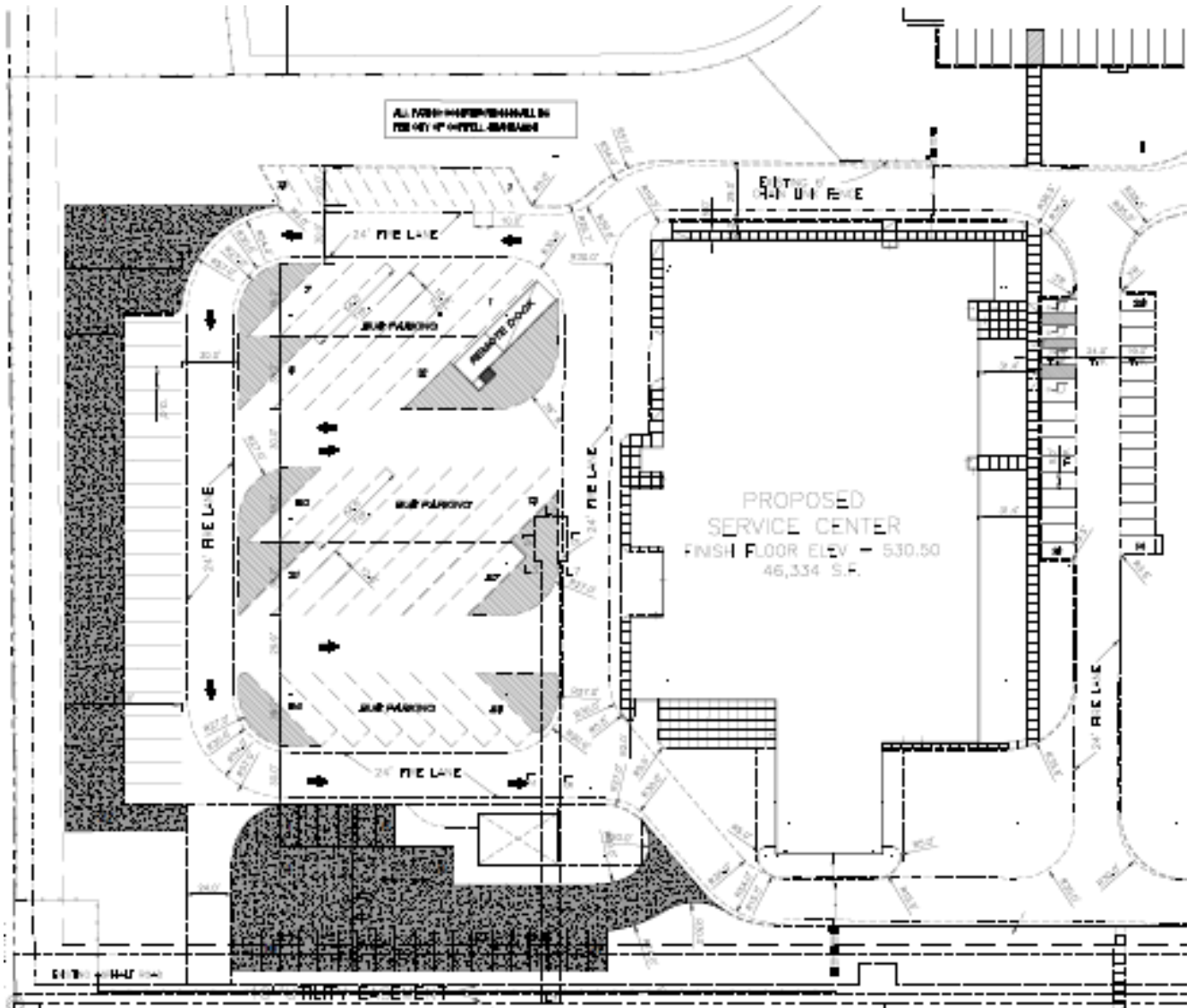

Includes 22 additional bus parking spaces and 27 maintenance vehicle spaces