

**Junior High
Overcrowding Relief
Proposal**

April 2018

Proposed Portable Cost Estimates

	Cost	Provided By
24' x 64'	\$ 52,900	Ramtech
24' x 32'	\$ 39,500	Ramtech
Walkway/ Ramp	\$ 6,775	HISD
Awning	\$ 11,690	HISD
Electric	\$ 8,000	Oncor
Contingency	\$ 6,135	HISD
Total	\$ 125,000	

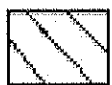
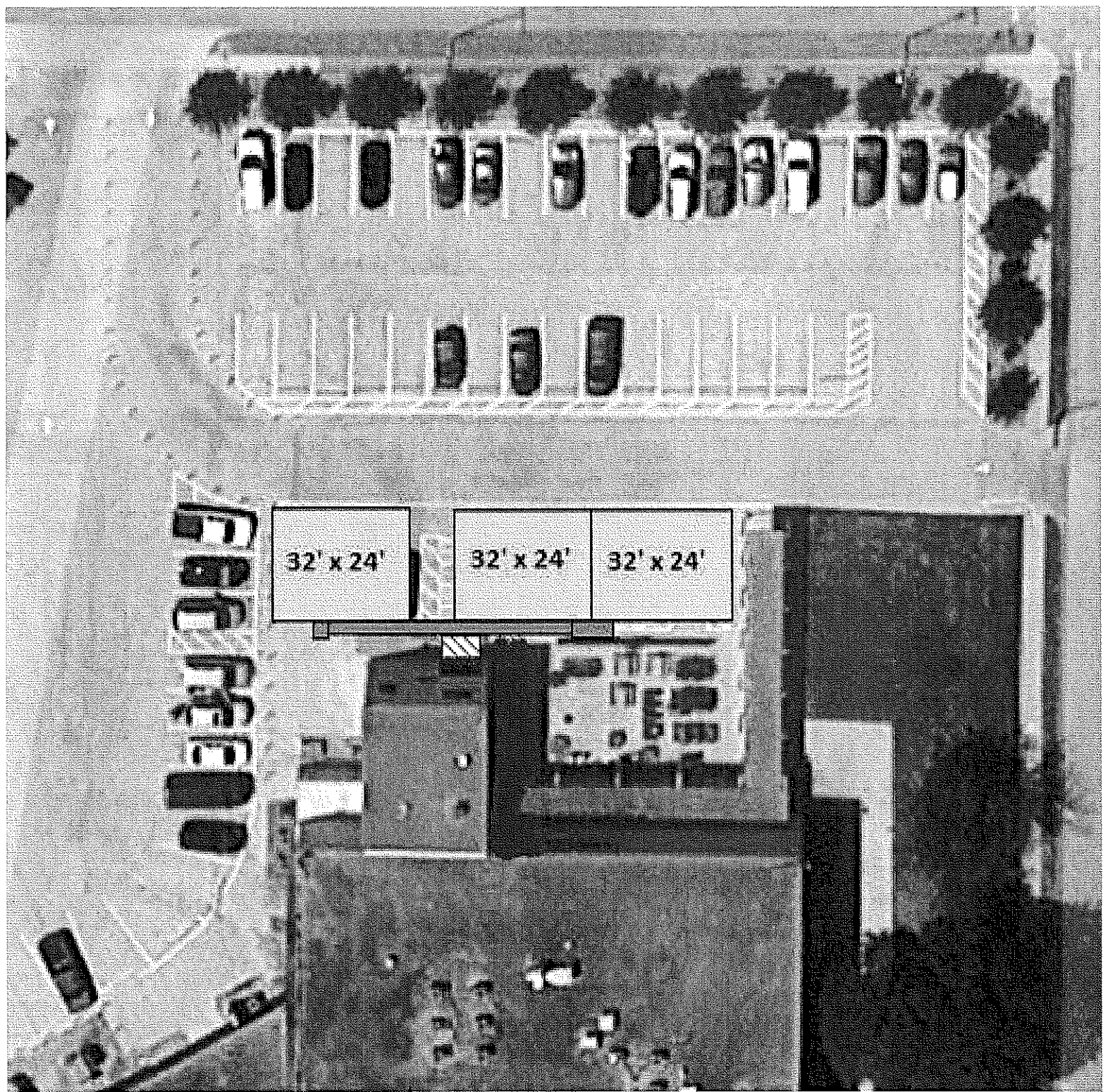

Existing Landing

Ramp from the portables will tie in to the existing landing on the west side of the building.

Proposed Two Classroom Portable Building

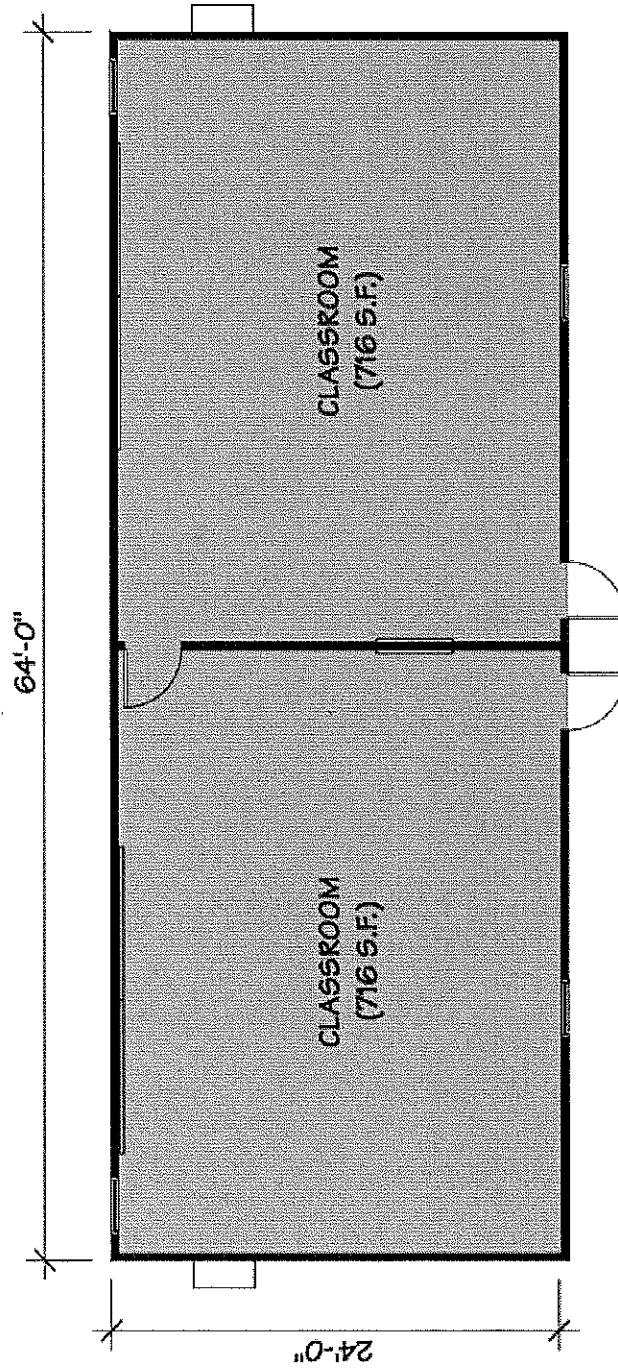

 <p>© 2017 Ramtech Building Systems, Inc.</p>	CLA-1536-B	1536 Sq. Ft.	CONTACT INFORMATION 1400 U.S. Highway 287 South Mansfield, TX 76063-5799 (800) 568-9376 (817) 473-3455 Fax info@ramtechgroup.com
	DOUBLE CLASSROOM BLDG.		

Proposed Single Classroom Portable Building

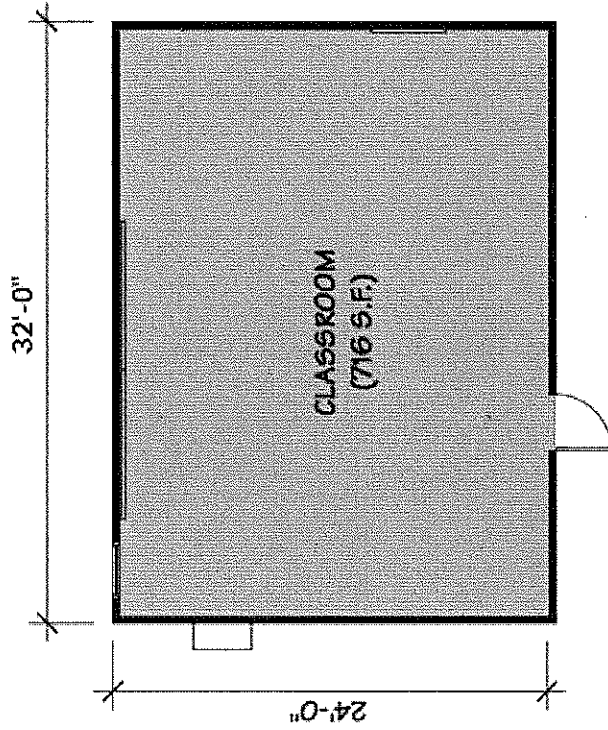

 <p>RAMTECH Building Systems</p> <small>© 2014 Ramtech Building Systems, Inc.</small>	<p>716 Sq. Ft.</p> <p>CLASSROOM BLDG.</p>	<p>CONTACT INFORMATION 1400 W.S. Highway 2817 South Mansfield, TX 76063-5789 (800) 565-3376 (817) 473-2455 Fax info@ramtechcorp.com</p>
---	---	--

Hillsboro ISD
Hillsboro Junior High
Portable Building Options

Vendor	24x64 Double Classroom 60 Month Lease	24x64 Double Classroom Purchase	24x32 Single Classroom 60 Month Lease	24x32 Single Classroom Purchase	Walkway, Steps, Ramp and Cover	Electrical Connection	Fire Alarm Extension	Fencing	Total - Both Buildings	Total With Walkways	Total With Walkways and Electrical
Ramtech Building Systems	\$64,690	\$52,900	\$56,890	\$39,500	\$53,000	Excluded	Excluded	Excluded	\$92,400	\$145,400	\$175,400
Palomar Modular Buildings	\$74,352	\$60,616	\$55,172	\$43,815	Excluded	Excluded	Excluded	Excluded	\$104,431	\$157,431	\$187,431
Sustainable Modular Management	\$159,810	\$153,718	\$71,878	\$65,344	Included	Included	Excluded	Excluded	\$219,062	\$219,062	\$219,062