

D 39°54'51"
 R 1356.38'
 L 944.90'
 CB S 70°24'30" E
 LC 925.91'

NORTH
 SCALE 1" = 50'

C.M. = CONTROLLING MONUMENT
 CIRF = CAPPED 1/2" IRON ROD
 FOUND STAMPED "4613"

CR 88

10' ATMOS ENERGY
 EASEMENT
 1,271 SQ. FT.

75.000 ACRES
 COLLIN COUNTY COMMUNITY COLLEGE DISTRICT
 CALLED 75.00 ACRES
 C.C. NO. 20090818001039820
 D.R.C.C.T.

CELINA DEVELOPMENT NORTH, LLC
 C.C. NO. 20160324000349770
 D.R.C.C.T.

SHELBY GLASS SURVEY, ABSTRACT NO. 346

LINE TABLE		
LINE	BEARING	DISTANCE
L1	N 53°54'18" W	163.42'
L2	S 29°36'35" W	127.14'
L3	N 60°23'25" W	10.00'
L4	N 29°36'35" E	127.63'

D 63°57'09"
 R 750.00'
 L 837.13'
 CB S 07°34'21" W
 LC 794.35'

CURVE TABLE						
CURVE	DELTA ANGLE	RADIUS	ARC LENGTH	CHORD BEARING	CHORD LENGTH	
C1	0°22'16"	1546.17'	10.01'	S 57°34'12" E	10.01'	

SURDUKAN SURVEYING, INC.
 P.O. BOX 126
 ANNA, TEXAS 75409
 (972) 924-8200
 TEXAS FIRM NO. 10069500

EXHIBIT "A"
10' ATMOS ENERGY EASEMENT
COLLIN COUNTY COMMUNITY COLLEGE DISTRICT
SHELBY GLASS SURVEY
ABSTRACT NO. 346
COLLIN COUNTY, TEXAS

LEGAL DESCRIPTION
10' ATMOS ENERGY EASEMENT

BEING situated in the Shelby Glass Survey, Abstract No. 348, Collin County, Texas and being across part of a 75.000 acre tract conveyed to the Collin County Community College District as recorded in County Clerks No. 20090818001039820 recorded in the Land Records of Collin County, Texas, and being more particularly described by metes and bounds as follows:

BEGINNING at a point for corner in the north line of said called 75.000 acre tract, said point being in the south Right Of Way line of County Road No. 88, said point being N 53°54'18" W a distance of 163.42' from a capped iron rod found for corner at the northeast corner of said 75.000 acre tract;

THENCE S 29°36'35" W a distance of 127.14' to a point for corner;

THENCE N 60°23'25" W a distance of 10.00' to a point for corner;

THENCE N 29°36'35" E a distance of 127.63' to a point for corner in the north line of said 75.000 acre tract and being in the south ROW line of said County Road No. 88, said point being in a non-tangent curve to the right;

THENCE along said curve to the right following the north line of said 75.000 acre tract and the south ROW line of said County Road No. 88 through a central angle of 00°22'16", a radius of 1546.17', an arc length of 10.01', with a chord bearing of S 57°34'12" E, and a chord length of 10.01' to the POINT OF BEGINNING and containing 1,274 Square Feet or 0.029 Acres of land.

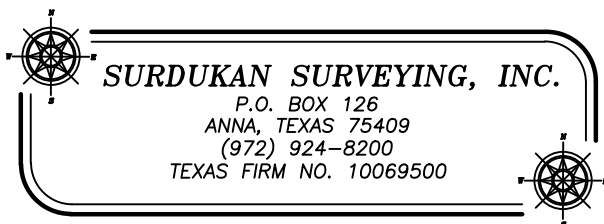

EXHIBIT "A"
10' ATMOS ENERGY EASEMENT
COLLIN COUNTY COMMUNITY COLLEGE DISTRICT
SHELBY GLASS SURVEY
ABSTRACT NO. 346
COLLIN COUNTY, TEXAS