

# RFS SPORTS

## FLOORING & LOCKERS

RUBBER FLOORING SYSTEMS, INC.  
 375 Columbia Memorial Pkwy, Kemah, TX 77565-3187  
 Phone (281) 334-6800 Fax (281) 535-1959

Date: February 13, 2024

<b>Project:</b>	Jefferson High School Weight Room		
<b>To:</b>	Estimating	<b>Delivery:</b>	Email
<b>Addendums:</b>	N/A	<b>Date of Plans:</b>	N/A

Quantity	Units	Scope of Work	Unit Price	Total Price
2,920	SF	Sand Existing Recycled Rubber Floor	\$ 0.50	\$ 1,460.00
2,920	SF	Supply, Deliver, and Install Regupol AktivPlus Rolls - 12mm 10% Standard Color Overlay	\$ 7.50	\$ 21,900.00
220	LF	4" - Standard Black Base	\$ 3.00	\$ 660.00
20	LF	Transitions	\$ 7.00	\$ 140.00
1	EA	School Banner Logo	\$ 4,000.00	\$ 4,000.00
			<b>Tax:</b>	
			<b>Total:</b>	<b>\$ 28,160.00</b>
			<b>P&amp;P Bond (If Needed Add to Total):</b>	N/A

<b>Estimating:</b>	Gage Haley	<a href="mailto:gage@teamrfs.com">gage@teamrfs.com</a>	<b>Signature of Acceptance:</b>
<b>Sales:</b>	Reed Hamilton	<a href="mailto:reed@teamrfs.com">reed@teamrfs.com</a>	
			<b>Date:</b>

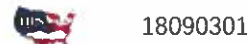

**Comments:** Includes standard wage rates; non-prevailing, non-union. **Owner Must Provide a 60-Amp Braker with 3 Phase Power Within 75' Of Gym/Workspace. Owner must provide a fork lift for off load.**

**Standard Exclusions:** Moisture remediation. Demo. Dumpsters. Bleachers. Volleyball Sleeves. Generators. Final clean up. Protection of work after installation. Major prep & leveling or smoothing of substrate other than light sanding & sweeping. We assume installation over clean, dry, & level substrate.

Excludes patching & leveling. Extra costs for patching & leveling:

- Patching & skim coating - \$50 per bag of Feather Finish.
- Leveling - \$110 per bag of self-leveling underlayment.

**Terms:** 75% due upon receiving a signed PO or quote, final payment due upon completion. All orders paid with a credit card will be assessed a 3% convenience fee at the time of invoicing. All accounts with a balance after 30 days from invoice will be assessed 1.5% interest every 30 days.

Material pricing is subject to manufacturer increases & or material storage fees after 30 days from original proposal. Taxes will be added at the time of invoicing if tax exempt form is not received.

**Due to the current volatility in both supply chains & international challenges with logistics & freight costs, this quote will be valid for 30 days. Freight charges will need to be confirmed at time of shipping.**

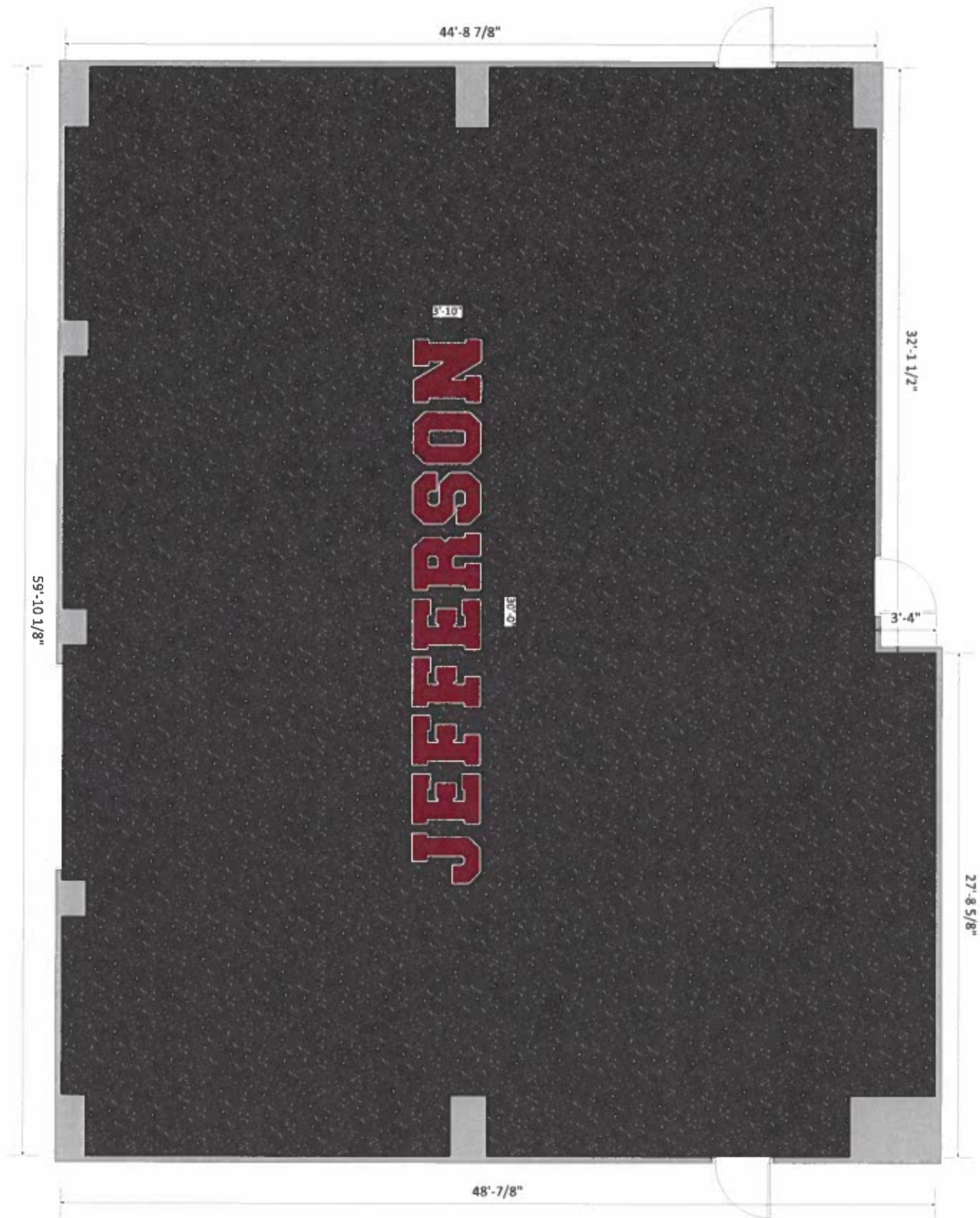

Rubber Flooring Systems Inc.  
 375 Columbia Memorial Pkwy.  
 Kemah, TX 77565  
 (281) 334-6800 phone  
 jenna@team-icon.com

Jefferson High School

2/9/24

Version 3.1

Scale: 1/2" = 1' 0"

NOTE: For design purposes only. Colors may vary due to screen resolutions. Please see physical samples for color representation

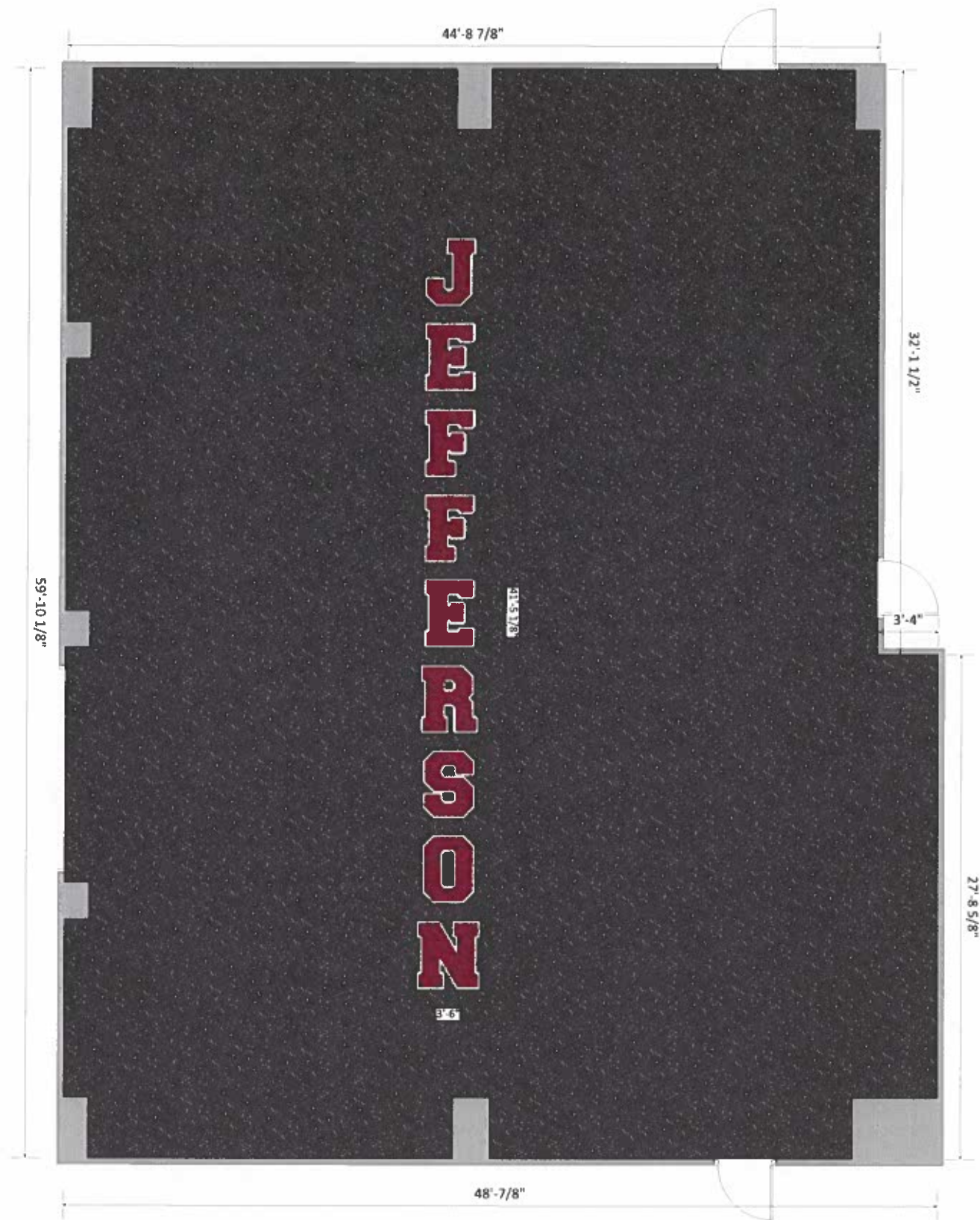

Rubber Flooring Systems Inc.  
 375 Columbia Memorial Pkwy.  
 Kemah, TX 77565  
 (281) 334-6800 phone  
 jenna@team-icon.com

Jefferson High School

2/9/24

Version 3.3

Scale: 1/2"=1' 0"

NOTE: For design purposes only. Colors may vary due to screen resolutions. Please see physical samples for color representation