BOARD AGENDA ITEM

Information/Discussion _____

Future Action _____

Action X

Item: ESC Phase 1 Furniture

Submitted by: Russell Bray

Date: 2/07/2025

Recommended by: Kevin Philipps *KP*

Board Meeting Date: 2/17/2025

RECOMMENDATION:

It is recommended that the Kent ISD board approve furniture purchase for Phase 1 of the ESC renovation in the amount of \$544,845.40 from Custer, Inc.

BACKGROUND:

Furniture plans were developed with input and approval from multiple departments in cooperation with the Facilities Office: This purchase will furnish new offices and workspaces for Human Resources, Safety and Security, REMC, and Technology Services, as well as multiple conference rooms, onboarding rooms, and the reception area.

Approval includes \$1,499.80 for line 307; industrial shelving for REMC. This line is not covered through state approved bidding cooperatives. Multiple quotes are not necessary for this purchase.

All other furniture is purchased through E&I Cooperative Services and Omnia Partners, satisfying state bidding requirements, and will be funded through the ESC project budget.

Attachments:

- Custer Quote for \$544,845.40
 - \$543,345.60 for furniture covered by purchasing agreement
 - \$1,499.80 for REMC shelving not covered by purchasing agreement
- ESC Phase 1 Furniture Plan



cluster

Kent ISD - ESC
PHASE 1 OVERALL LAYOUT

SCALE: 1/8" = 1'
DESIGNER: J
DATE: 06/02

This plan is for informational purposes only and is not to be used for construction. It is intended to be used in conjunction with the project description and other documents. The project description and other documents are the sole basis for the project. The project description and other documents are the sole basis for the project.

PHASE 1
PP-1



cluster

Kent ISD - ESC
HR OVERALL SPACE

SCALE: 1/4" = 1'-0"
DESIGNER: Y.J.
DATE: 2/5/2025

ME & PLUMB

No part of this drawing may be used or reproduced in any form or by any means, or stored in a database or retrieval system, without prior written permission of Cluster Design Projects/ISD Kent Intermediate School District 121756 Social Services Center (ESC)2024 Renovation/RENEO, turn plan in hand.

FURNITURE
PLAN

FP-2



36W storage cabinets on both sides of island



cluster

Kent ISD - ESC
HR OPEN OFFICE AREA

SCALE: 1/8" = 1'-0"
DESIGNER: RJ
DATE: 05/06/25

KEY PLAN

FURNITURE
PLAN
FP3

No part of this drawing may be used or reproduced in any form or by any means, or stored in a database or retrieval system, without prior written permission of Cluster Properties. Kent ISD - ESC Intermediate School District - 12175E Vocational Services Center (CSC) 2024 Renovation/ESC Furniture Plan Change

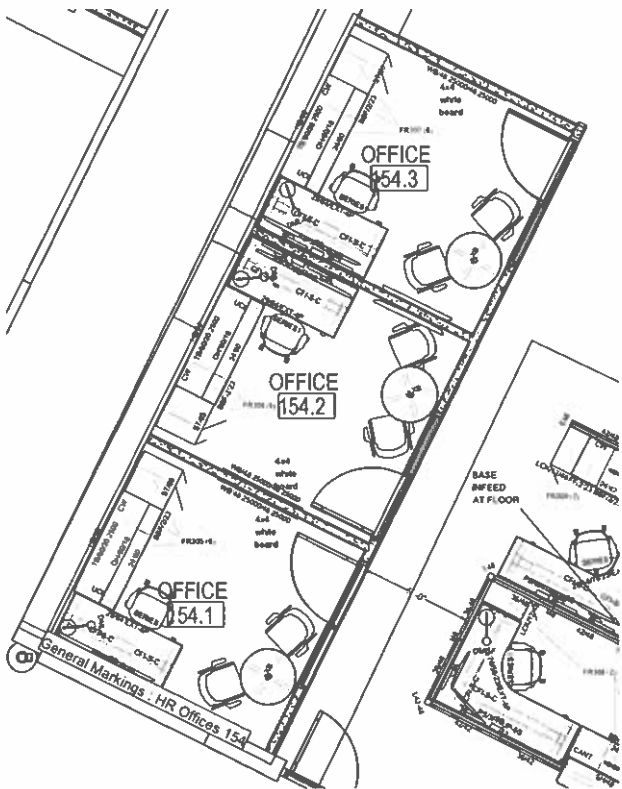

29x64 Hl. Adj desk with 2 monitor arms



3 OFFICES TOTAL

4x4 marker board
installed by
Contractor

custer

Kent ISD - ESC
HR PRIVATE OFFICE TYPICAL

SCALE: 1/4" = 1'-0"
DESIGNER: P
DATE: 05/20/15

REVISIONS

This plan or drawing may be used or reproduced in any form or by any means, or stored in a database or retrieval system, without prior written permission of Custer
p/c Design Project: Kent ISD - Kent Intermediate School District - 2375 Educational Services Center (EESC) 2375 Educational Services Center (EESC) Plan plan only

PROJECT
NO. 154
PAGE 6

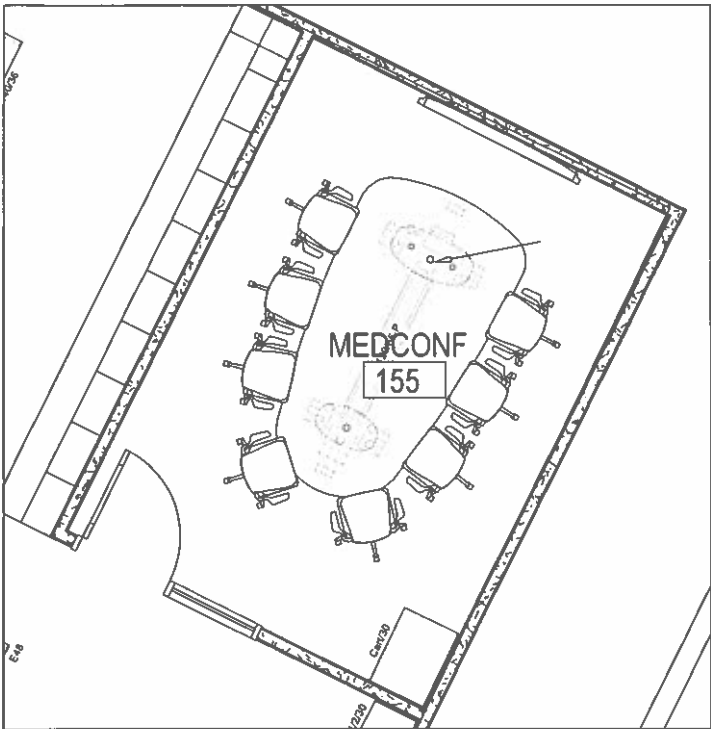

4x8 marker board
installed by
Contractor

cluster

Kent ISD - ESC
HR CONFERENCE ROOM

SCALE: 1/4" = 1'-0"
DESIGNER: J.J.
DATE: 2/4/2025

No part of this drawing may be used or reproduced in any form or by any means or stored in a retrieval system without prior written permission of Cluster Design Project for ISD Kent Intermediate School District 155 2375 E. 3rd Street Services Center (ESC) 2000 E. 1st Street, Kent, OH 44240

REVISIONS

FURNITURE
PLAN
FP-6

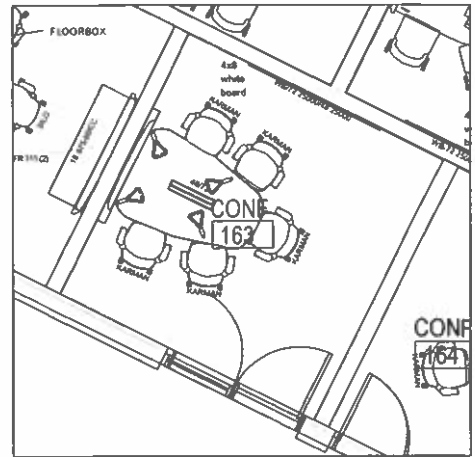
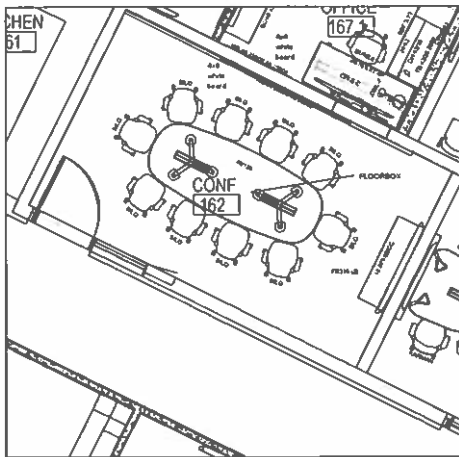

custer

Kent ISD - ESC
CONF 162 & CONF 163

SCALE 1/4" = 1'-0"
DESIGNER: J
DATE: 04/2025

This part of this drawing may be used or reproduced in any form or by any means, or stored in a database or retrieval system, without prior written permission of Custer Design Projects, LLC. It is the property of Custer Design Projects, LLC. It is not to be used for any other project without the written permission of Custer Design Projects, LLC.

KEY PLAN

CONF 162
PLAN
FP-8

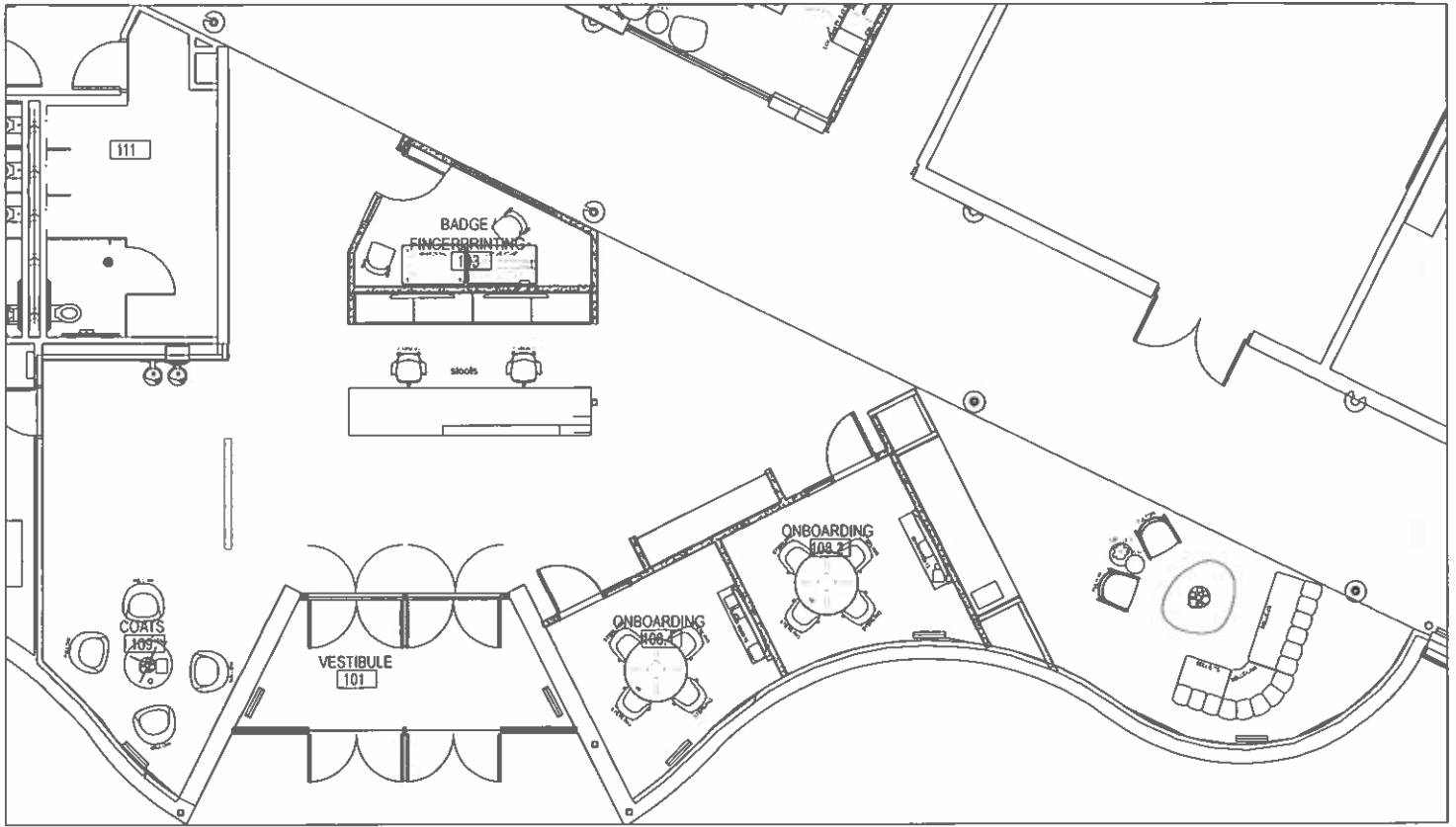

cluster

Kent ISD - ESC
OVERALL RECEPTION SPACE

SCALE: 1/4" = 1'-0"
DESIGNER: #3
DATE: 2/6/2025

KEY PLAN

No part of this drawing may be used or reproduced in any form or by any means, or stored in a database or retrieval system, without prior written permission of Cluster Design Projects, LLC or Intermediate School District #2175 Educational Services Center (ESC) 2025 ReceptionCE/NEBC. Turn plan chair.

FURNITURE
PLAN
FP-10

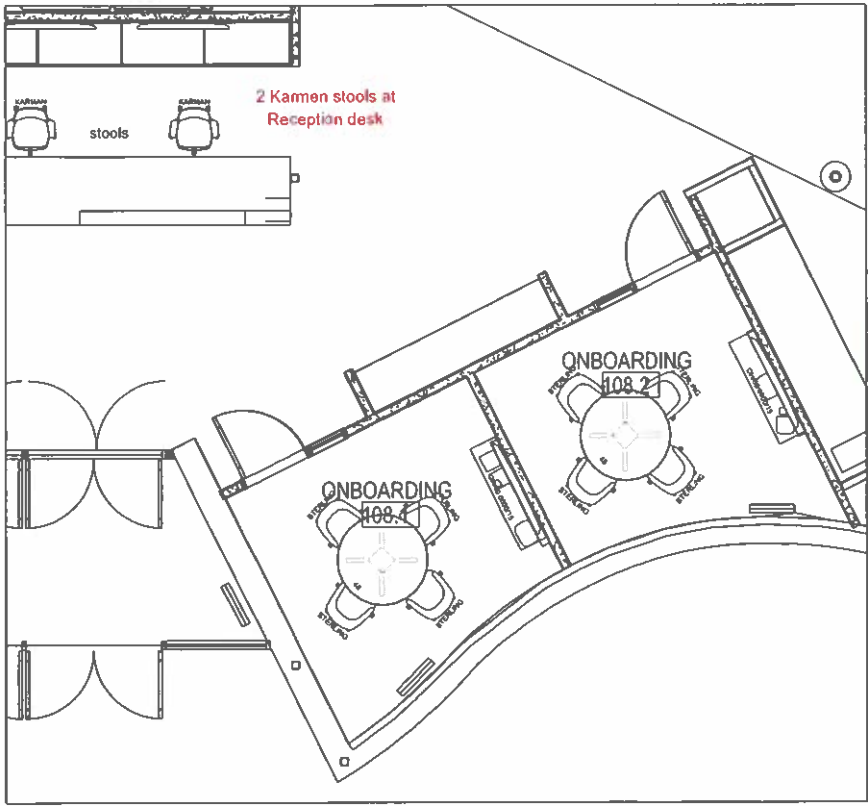

cluster

Kent ISD • ESC
ONBOARDING ROOMS

SCALE 1/4" = 1'-0"
DESIGNER T.J.
DATE 2/4/2025

SEE PLAN

This part of this drawing may be used or reproduced in any form or by any means, or stored in a database or retrieval system, without prior written permission of Cluster Design Projects/ISD, Kent Intermediate School District - 12375 E. 92nd Avenue, Suite 100, Kent, OH 44240-1100. ETS/ESC: Item plan only.

FURNITURE
PLAN
FP-11

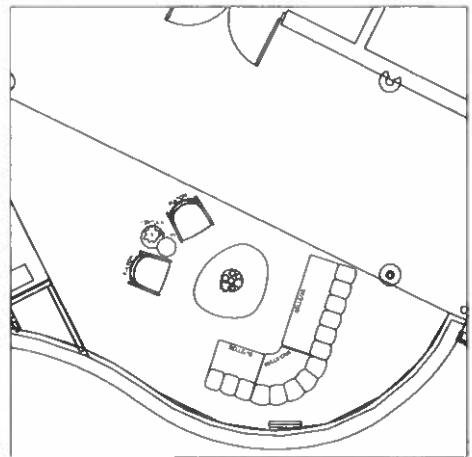
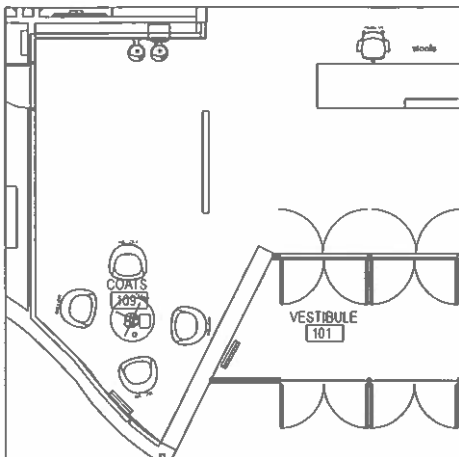

cluster

Kent ISD - ESC
RECEPTION AREAS

SCALE: 1/4" = 1'-0"
DESIGNER: KJ
DATE: 04/02/25

RECEIVING

RECEIVING

PLAN

SP-12

This part of this drawing may be used or reproduced in any form or by any means, or stored in a database or retrieval system, without prior written permission of Cluster Design Projects, Inc. Kent Intermediate School District - 12375E Local Services Center (ESC) 2024 Permitting/ESC Area plan only.

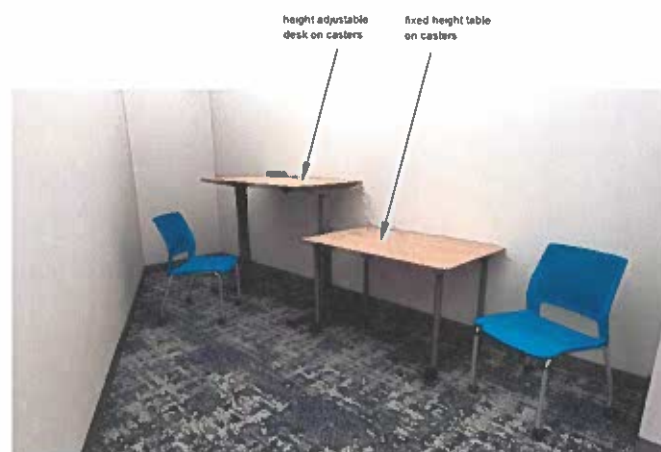
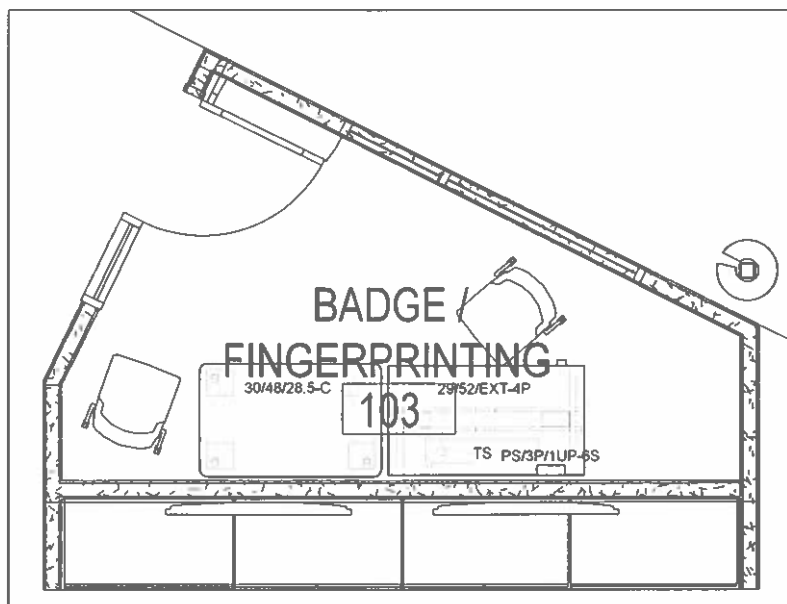

custer

Kent ISD - ESC
BADGE/FINGERPRINTING

SCALE: 1/4" = 1'-0"
DESIGNER: R.J.
DATE: 25/05/22

No part of this drawing may be used or reproduced in any form or by any means or stored in a database or retrieval system without prior written permission of Custer Design Projects Ltd. Kent Intermediate School Design Project 2021/22. Architectural Services Centre Ltd 2022. All Rights Reserved. No part of this drawing may be used or reproduced in any form or by any means or stored in a database or retrieval system without prior written permission of Custer Design Projects Ltd. Kent Intermediate School Design Project 2021/22. Architectural Services Centre Ltd 2022. All Rights Reserved.

FIGURE 13

FURNITURE PLAN

FP-13

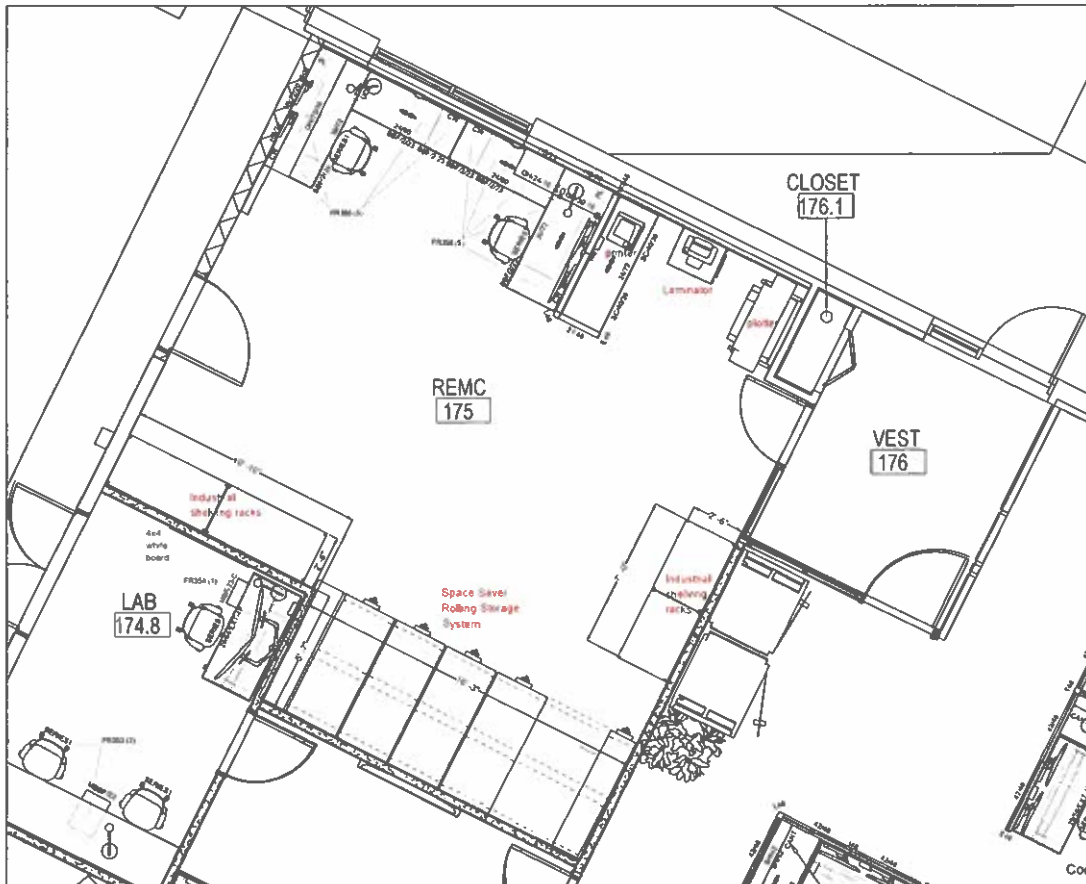

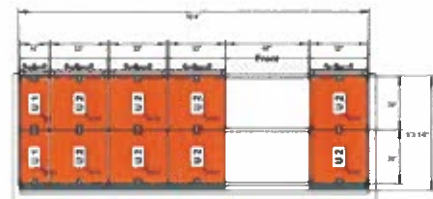

Space Saver rolling storage

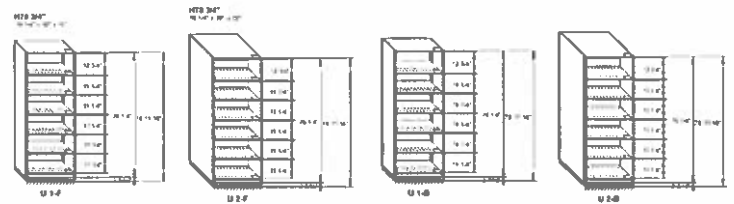

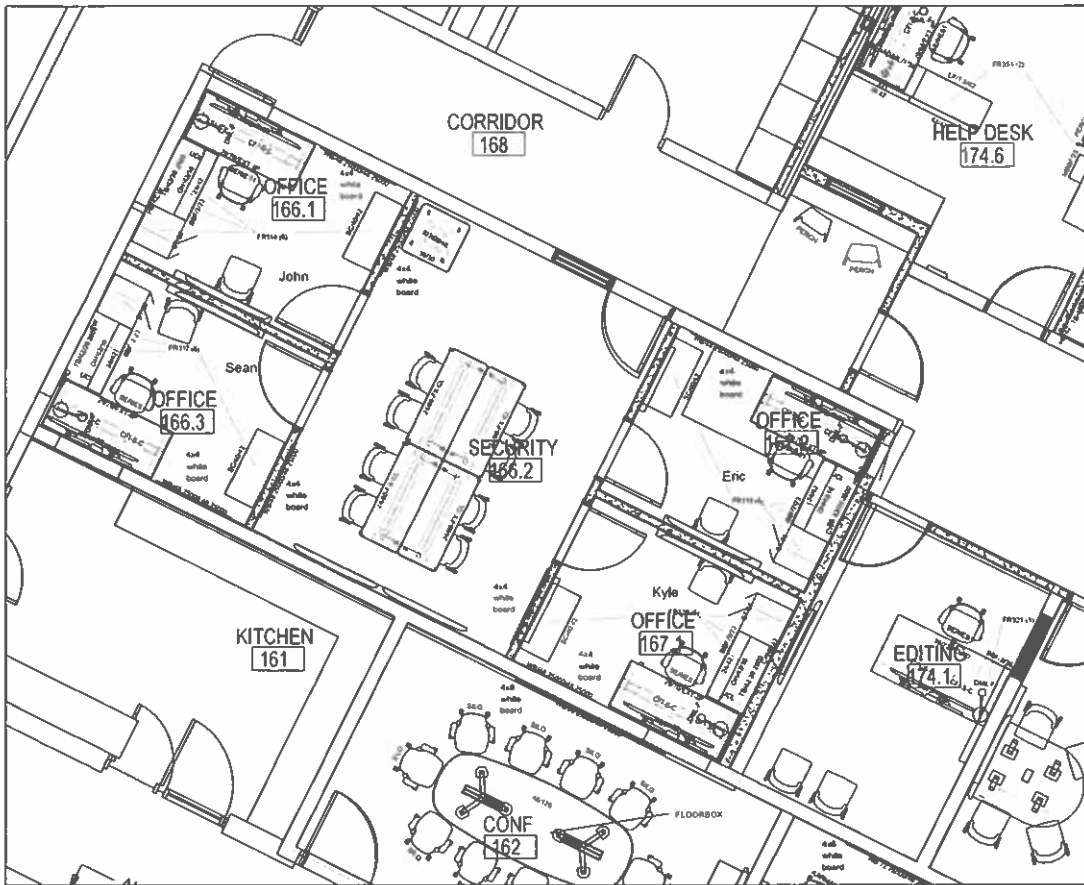

4x4 whiteboards installed by Contractor



24x60 mobile tables with
stack chairs on wheels



Kent ISD - ESC
SECURITY / OPEN OFFICE AREA

SCALE: 1/4" = 1'-0"
DESIGNER: J.J.
DATE: 05/05/24

KEY PLAN

No part of this drawing may be used or reproduced in any form or by any means, or stored in a database or retrieval system, without prior written permission of Custer
p. 16/2024 Project 150 Kent Intermediate School District - 112175-ESC project Services Center (ESC) 2024 Ruled and/or ENE SC Room plan c.m.d.v.

FURNITURE
PLAN

FP-07

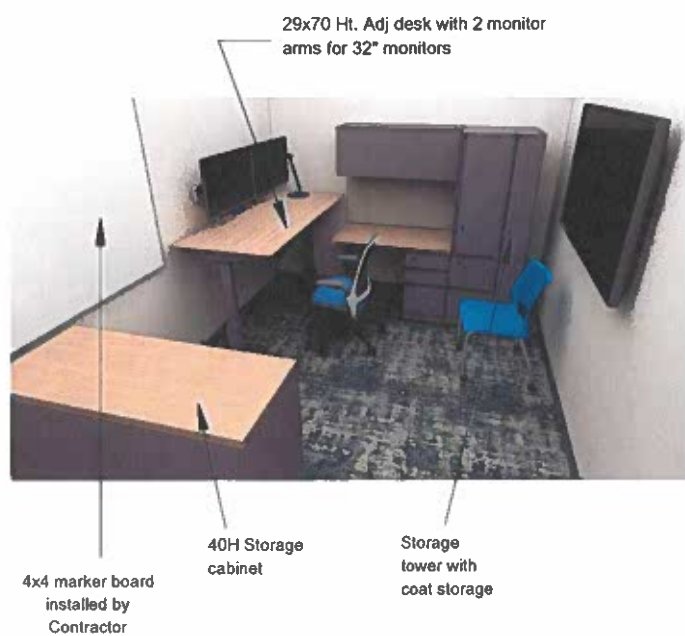
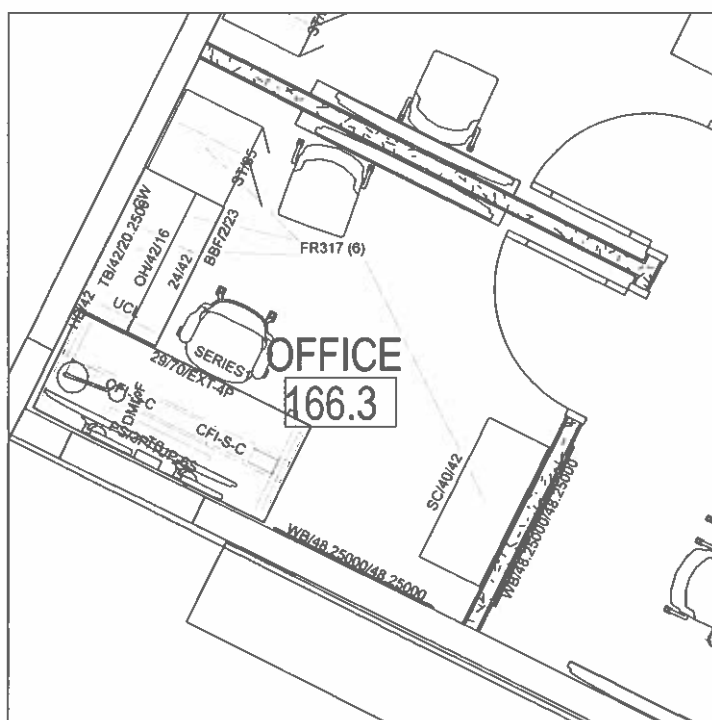

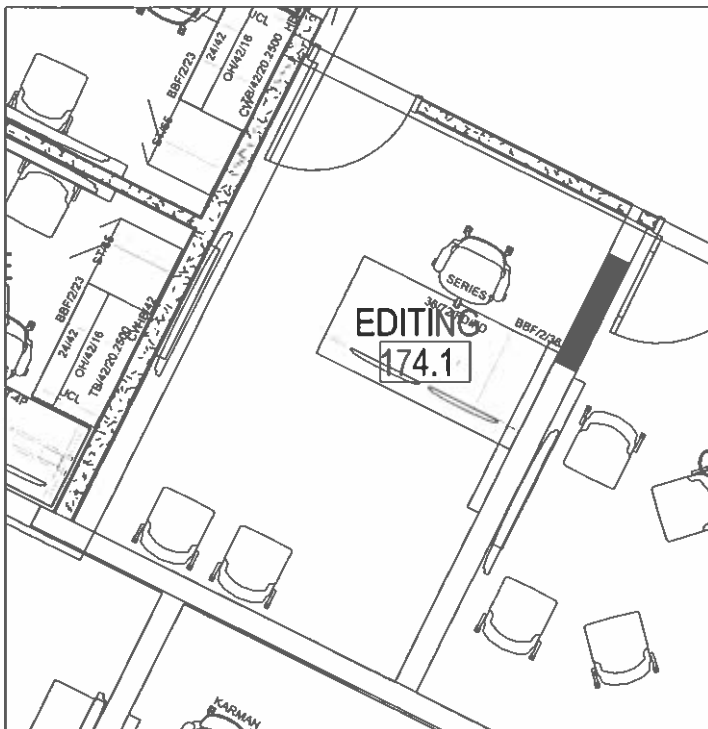

custer

Kent ISD - ESC
EDITING ROOM

SCALE: 1/4" = 1'-0"
DESIGNER: K+J
DATE: 2/4/2019

KEY PLAN

FURNITURE
PLAN
EP-19

No part of this drawing may be used or reproduced in any form or by any means, or stored in a database or retrieval system without prior written permission of Custer Design Projects (915) 741-1111 or Kent Intermediate School District (915) 741-1111. All rights reserved.



VA27EHE:

- Dual monitors
- Single monitor

MSI - MAG321CQR:

- Dual monitors
- Single monitor



cluster

Kent ISD - ESC
ITDS OPEN OFFICE AREA

SCALE: 1/4" = 1'-0"
DESIGNER: J. J.
DATE: 06/05/05

3/6/05 PL 221

No part of this drawing may be used or reproduced in any form or by any means, or stored in a retrieval system, without prior written permission of Cluster Design Projects, Inc. 150 Kent Interiors and School District 111 2175 E 92nd Street, Suite 100, Kent, WA 98042. Please refer to the drawing title block for more information.

FURNITURE
PLAN
FP-21

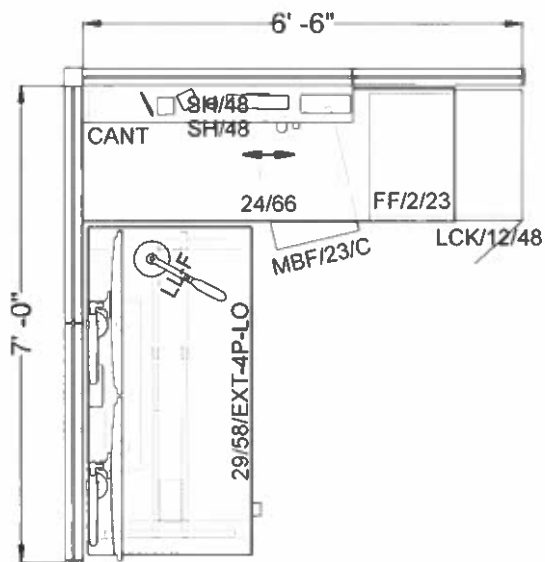

workstation includes:

- 6'-6" x 7'-0" footprint
- 29x58 adjustable ht. desk
- 24x66 fixed side surface
- 2 monitor arms for 32" monitors
- shallow shelves for display
- desk top power unit
- desk lamp
- coat storage
- 1 - 6H drawer & 3 - 12H drawers
- mobile pedestal with cushion top
- 60"H overall panel height
- 48H base panel height
- 12H glass divider screens



cluster

Kent ISD - ESC
ITDS WORKSTATION OPTIONS

SCALE: 1/8" = 1'-0"
DESIGNER: KJ
DATE: 2/6/2025

KENT ISD

FURNITURE
PLAN

FP-23

No part of this drawing may be used or reproduced in any form or by any means, or stored in a database or retrieval system without prior written permission of Cluster Design Project for ISD or any intermediate School District. K2375E Original Services Center (ESC) 2024 Planview and/or ETS/ESC Item plan drawing.

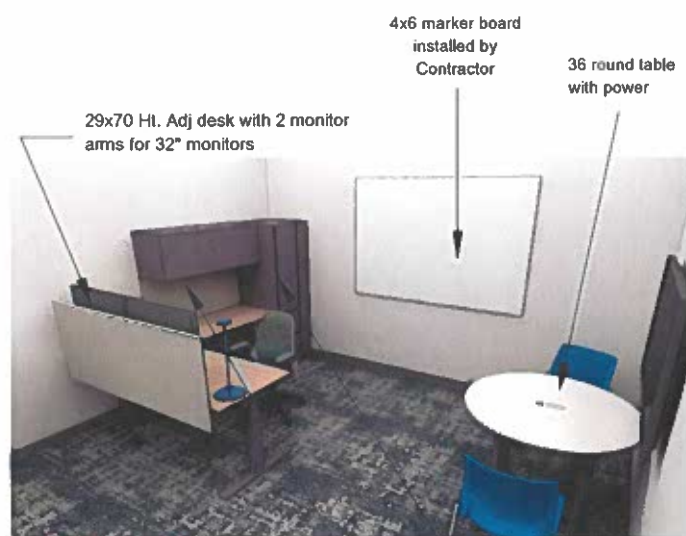

tackboard coat
storage

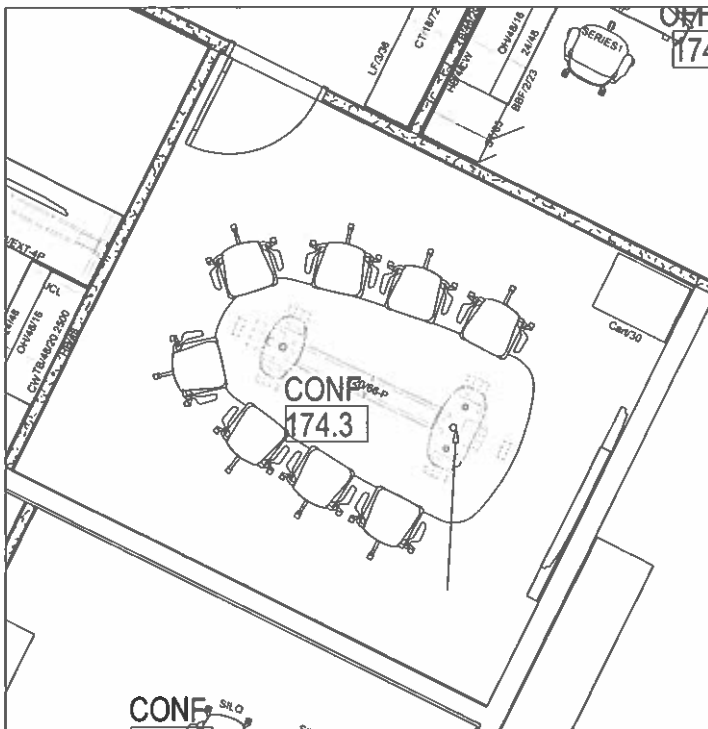

4x8 marker board
installed by
Contractor

custer

Kent ISD - ESC
ITDS CONFERENCE ROOM

SCALE: 1/4" = 1'-0"
DESIGNER: P.J.
DATE: 2/4/2025

No part of this drawing may be used or reproduced in any form or by any means, or stored in a database or retrieval system, without prior written permission of Custer Design Project, 17150 Kent Intermediate School District, 17151 SE 9th Street, Kent, OH 44240. For more information, please contact Custer Design Project at 440.933.1234.

17151 SE 9th

17151 SE 9th
FP-25

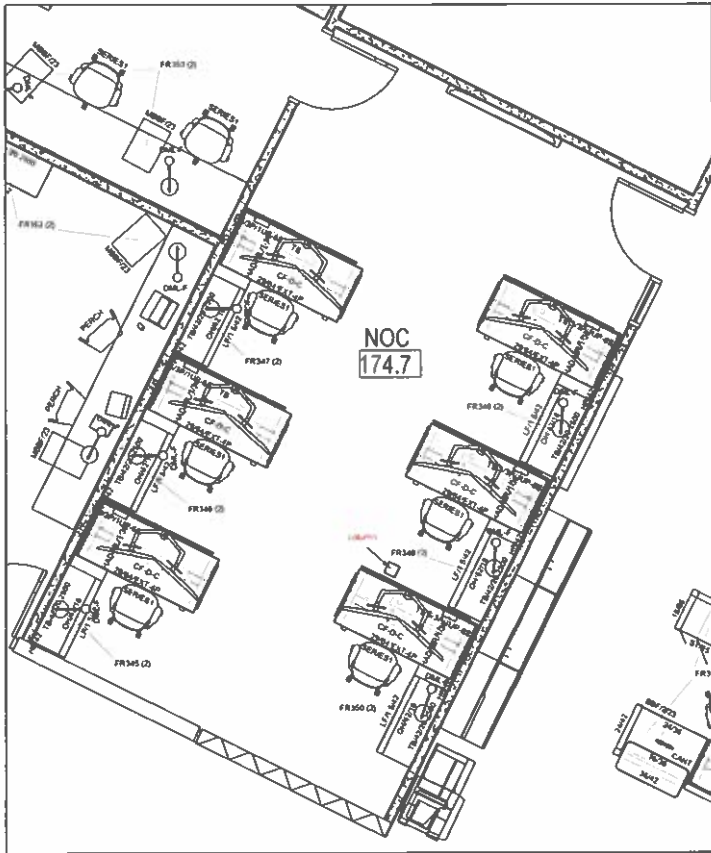

cluster

Keat ISO - ESC
H.O.C.

SCALE: 1/8" = 1'-0"
DESIGNER: J.J.
DATE: 3/20/2025

No part of this drawing may be used or reproduced in any form or by any means, or stored in a database or retrieval system without prior written permission of Cluster Design Projects LLC or the Washington School District. 11375E-01-000000 Services Center (ESC)2025-01-000000 ETE SC turn plan (in.dwg)

W.E. & P.E. 8/11

FURNITURE
PLAN

FP-26

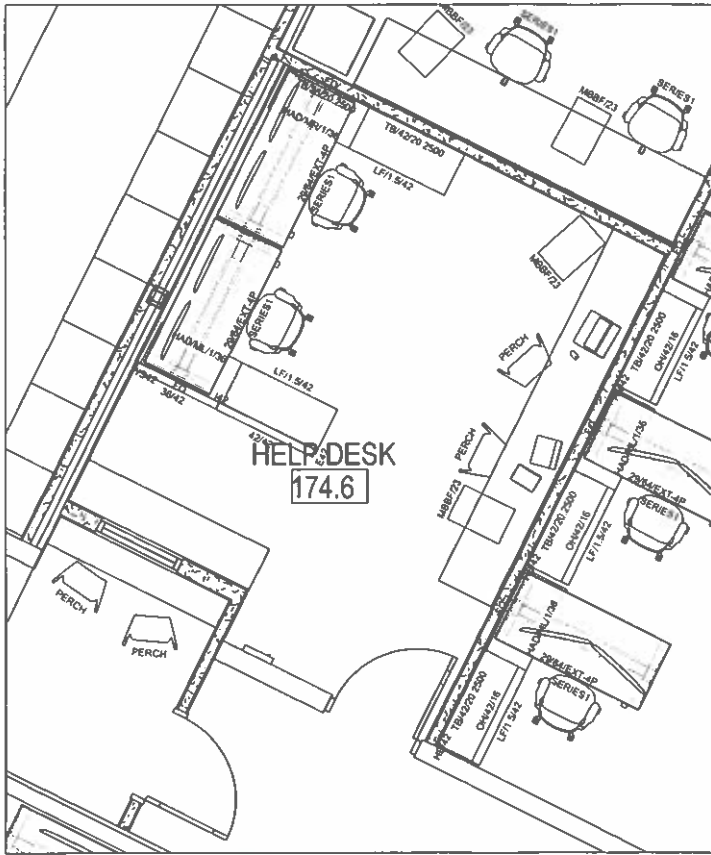

cluster

Kent ISD - ESC
HELP DESK

SCALE: 1/4" = 1'-0"
DESIGNER: J.J.
DATE: 3/6/2025

This plan or this drawing may be used or reproduced in any form or by any means, or stored in a database or retrieval system, without prior written permission of Cluster Project/Project/ISD or Kent Intermediate School District, or 2175 Educational Services Center (ESC) 2024 Renovations/ESC turn plan only.

1/4" = 1'-0"

FURNITURE PLAN

FP-27

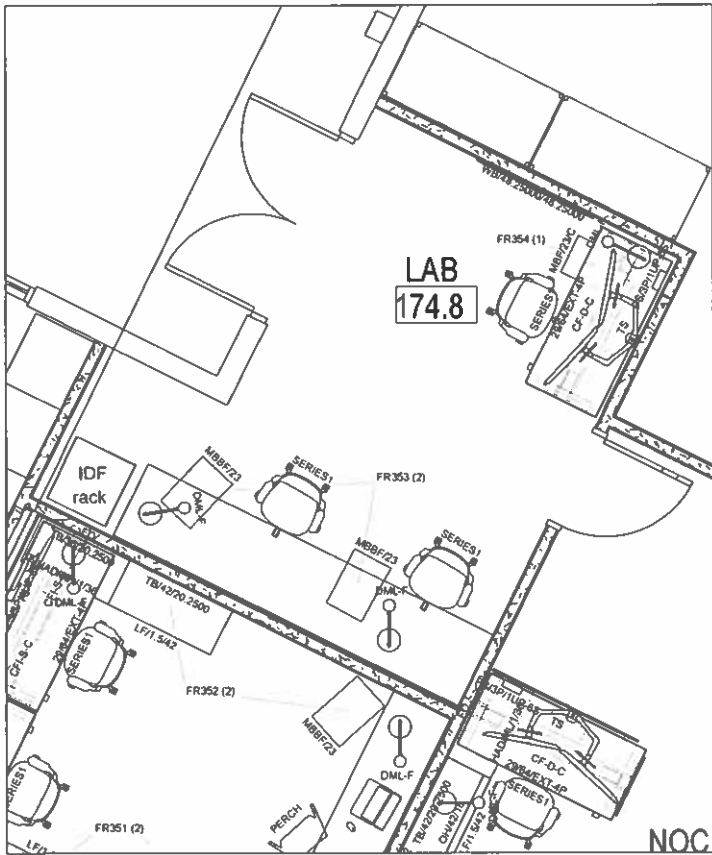

cluster

Kent ISD - ESC
LAB

SCALE: 1" = 1'-0"
DESIGNER: J.J.
DATE: 2/5/2025

No part of this drawing may be used or reproduced in any form or by any means, or stored in a database or retrieval system, without prior written permission of Cluster Design Projector LLC or the School District. 12375E, 2024 Original Services Center © 2024 Permaform LLC, THE 100 Run plan in hand.

4x4 marker
board installed



REV: 25.011

FURNITURE
PLAN
FF-28