

Ililgaat Munaqsriyat

“A children’s place to be cared for.”



Seeking Non-Profit Status
Founding Board Members

Tracey Schaeffer, President & Treasurer
Madeline Gallahorn, Vice President
Madison Schaeffer, Secretary

Child Care: The Foundation of Economic Development

- Workforce Stability & Productivity
 - Quality child care supports local economic development by enabling more community members to join and remain in the workforce.
- Early Childhood Development
 - Investing in child care strengthens the foundation for children's lifelong learning, social-emotional skills, and future success in school and work.
- Community Well-Being
 - A trusted child care center builds stronger, healthier communities by supporting families, reducing stress, and providing safe, nurturing environments for children.
- Shared Responsibility & Reputation
 - Businesses and community partners who support child care demonstrate social responsibility, enhance their reputation, and strengthen partnerships with families and local stakeholders.



Iḷiḷgaat Munaqsriviat Overview

- **Mission Statement:**

To serve our community through sustainable and quality childcare programming that upholds our Inupiaq Iḷitqusiat and strengthens our future generations.

- **Ages Served** 6 months - 5 years,
Primary focus on 6 months to 4 years
- **Capacity** 42 children in approximately 3 classrooms
- **Hours of Operation** 7:30 am - 5:30 pm
- **Year Round or School Year Programming** To be decided based on partnership with School District
- **Tuition Fee Range** - \$1,200 - \$1,500 monthly
Accept both State & Tribal Child Care Assistance
- **Pursue Language Nest Model**
- **Incorporate Apprenticeship Opportunities**





Current proposed space to include four classrooms, one office, including the hallway with dedicated entry, exits and playground space.

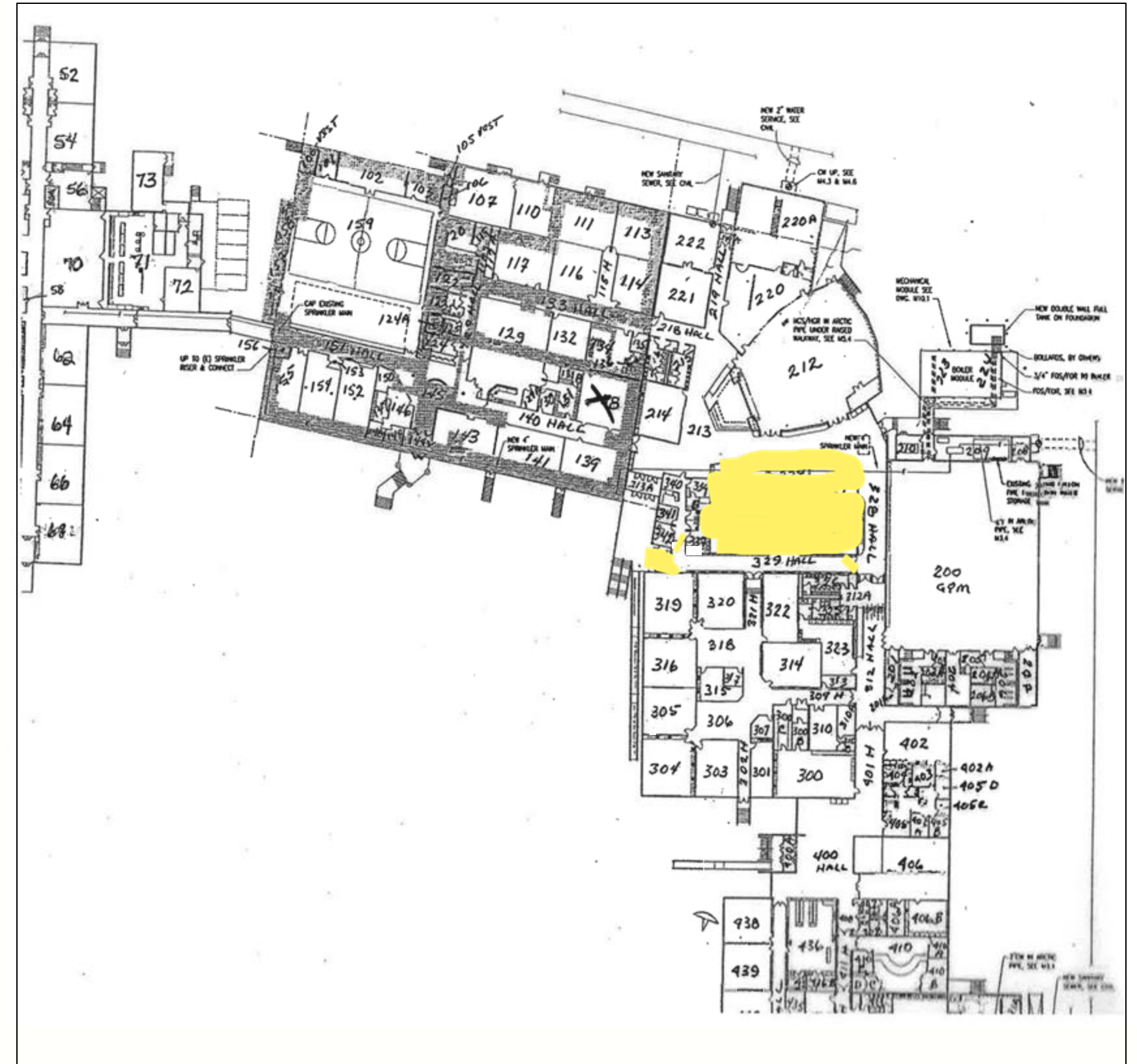

Iḷiḷgaat Munaqsriyat Community Childcare Center KHMS Pod Space Option

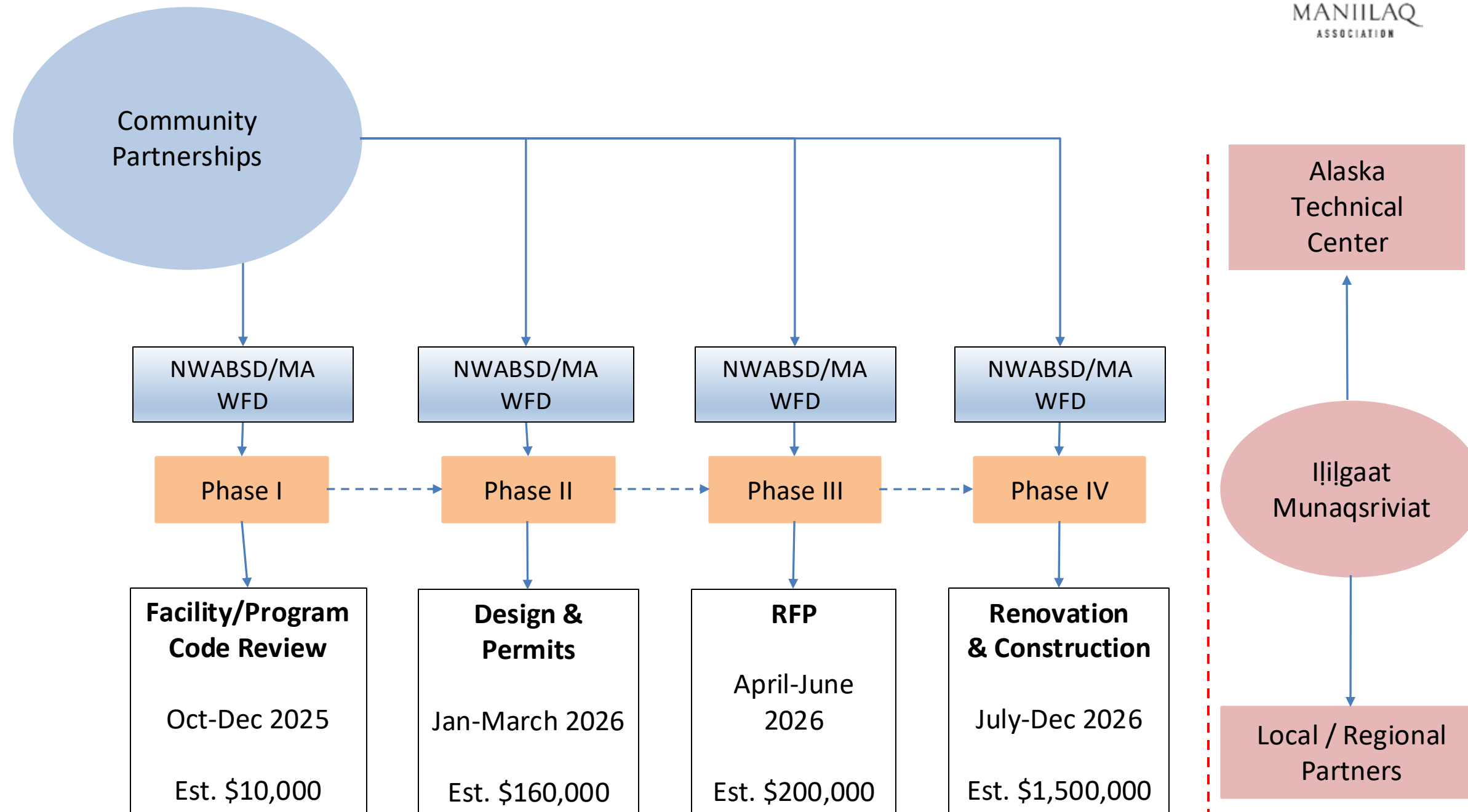

Note:
MA WFD to reimburse via separate individual MOA's

Outline of Cooperative Efforts

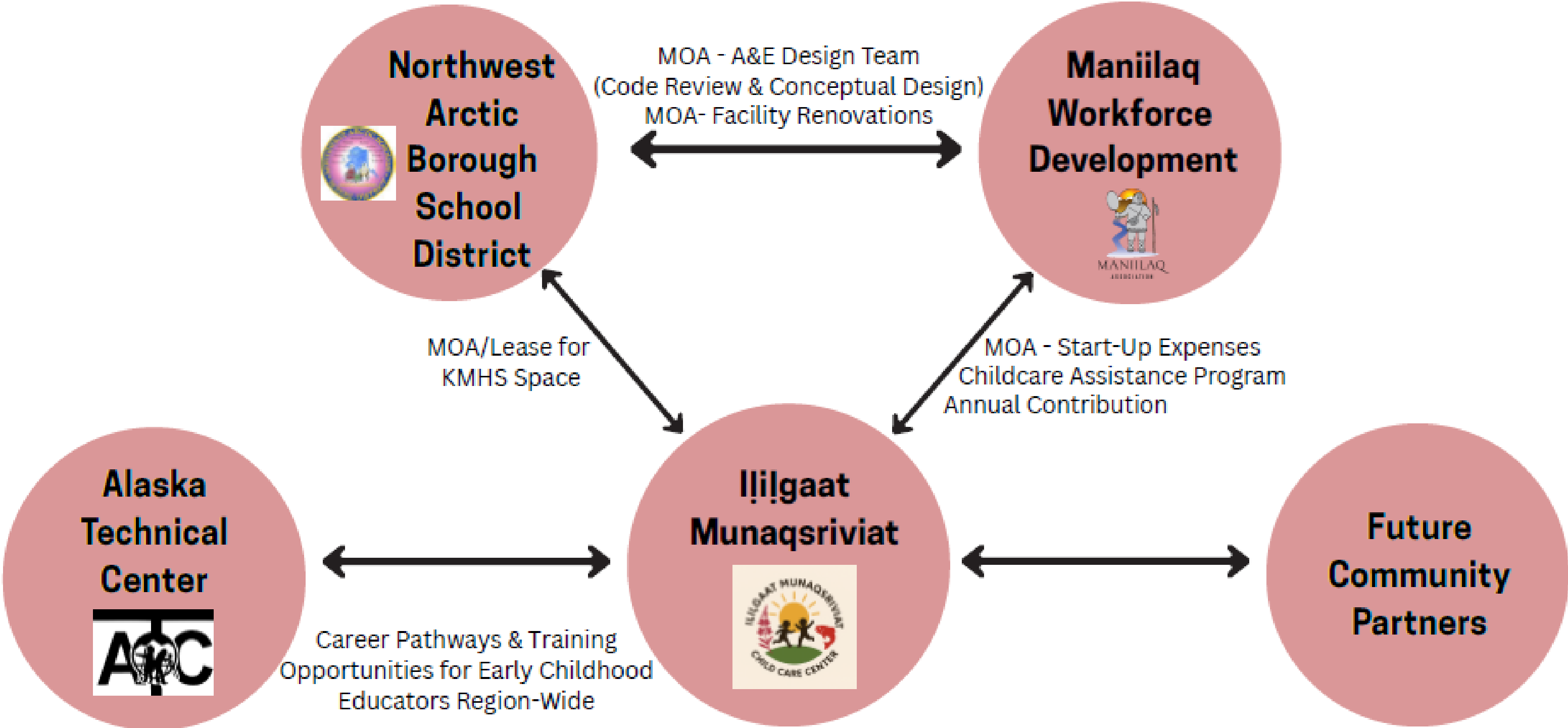

Estimated True Cost of Care By Region

**TABLE 9. CENTER-BASED OPERATING COSTS PER CHILD,
BASE CASE SCENARIO BY PUBLIC HEALTH REGION**

Public Health Region	MONTHLY COST PER CHILD			
	Infants (0-12 months)	Toddlers (13-18 months)	Toddlers (19- 35 months)	Preschoolers (36-59 months)
Anchorage	\$2,105	\$1,781	\$1,565	\$1,186
Gulf Coast	\$1,759	\$1,759	\$1,551	\$1,385
Interlor	\$1,882	\$1,882	\$1,667	\$1,319
Mat-Su	\$1,738	\$1,738	\$1,522	\$1,143
Northern	\$2,123	\$2,123	\$1,915	\$1,749
Southeast	\$1,780	\$1,780	\$1,571	\$1,406
Southwest	\$2,115	\$2,115	\$1,907	\$1,741
Statewide	\$1,785	\$1,785	\$1,571	\$1,250

From the Childcare In Alaska: The True Cost Of Care report created by the McKinley Research Group for the State of Alaska Department of Health

Iliilgaat Munaqsriyat Financial Overview

Budget Overview - School Location	
Estimated Expenditures	
Salaries and wages	\$ 638,360.11
Supplies, rent, utilities, insurance, contractual, etc.	\$ 201,550.00
TOTAL	\$ 839,910.11
Estimated Revenue	
Tuition and fees	\$ 657,300.00
SOA Childcare Grant	\$ 10,000.00
NWABSD Contribution	TBD
Maniilaq WFD Annual Support	TBD
TOTAL	\$ 667,300.00
NET PROFIT/LOSS	\$ (172,610.11)



Sustainability & Community Support for Childcare

- **Childcare is Not Profitable**

The business of childcare rarely generates surplus revenue. Tuition must remain affordable, yet the true costs staffing, facilities, and quality programming far exceed what families can pay.

- **A Community Service, Not a Business**

Childcare is best understood as essential infrastructure—like schools, roads, or healthcare—not as a profit-making venture. It provides stability and long-term benefits for families and the wider community.

- **Economic Development Driver**

Reliable childcare enables parents to work, helps employers recruit and retain staff, and strengthens the local economy. Communities without childcare experience workforce shortages and lost productivity.

- **Need for Community Support & Innovation**

For sustainability, the center requires ongoing support from local entities—businesses, nonprofits, and governments. Grants alone cannot cover the persistent funding gap. We are committed to thinking outside the box to develop innovative funding models, which may include universal childcare initiatives or leveraging public tax funds.

- **Building Local Engagement First**

Our first priority is to seek investments, partnerships, and engagement from the community before pursuing larger grant funding. Local ownership builds commitment and long-term stability.





Next Steps

NWABSD Consideration of In-Kind Contribution level

SEEK Additional Local & Regional Partners

PURSUE State of Alaska Licensing

QUESTIONS



Rita Short

Maniilaq Workforce Development
Child Care Liaison Manager

Phone: 442-7876

Email: rita.short@maniilaq.org
kotzebuechildcare@gmail.com