



## PROPOSED CHANGE ORDERS

### Grate Inlet

ARCHITECT	Wheaton Engineering and Environmental Science, LLC Corpus Christi, Texas	CONTRACT	#2418 - Robstown ISD RECHS Stadium Paving Improvements
PCO NUMBER/REVISION	2	CREATED DATE	07/08/2024
STATUS	pending	SCHEDULE IMPACT	No Impact
CHANGE REASON:	Existing Conditions		
PCO DESCRIPTION:	Add a 2x2 grate inlet and run 50' of 18" RCP on the south end of the parking lot near the existing auditorium to help with drainage.		

TITLE	CATEGORY	TAXABLE	QTY	PRICE	AMOUNT
2x2 Grate Inlet	general		1	\$14,975.00	\$14,975.00
				Subtotal	\$14,975.00
				Sales Tax	\$0.00
				Insurance	\$0.00
				Labor Burden	\$0.00
				Bond	\$0.00
				OH & P	\$0.00
<b>TOTAL</b>					<b>\$14,975.00</b>

BY: \_\_\_\_\_  
Ronald Wheaton, VP

DATE: 7/10/2024

BY: \_\_\_\_\_

DATE: \_\_\_\_\_

**T L Plumbing, Inc.**  
**4717 Westway**  
**Corpus Christi, TX 78408**  
**Phone (361) 853-2215 Fax: (361) 852-5733**  
**Rolando A. Gomez**  
**RMP - 15837**

**Submitted To: Weaver and Jacobs**  
**Attention: Tim Gleinser**

**7-2-24**

**Robstown ISD**

Add 50' of 18" RCP and one 2'X2' Grate Inlet

We hereby propose to furnish labor and materials, complete in accordance with the provided specifications and information for the sum of: **\$14,975 .00 Dollars (No sales Tax Included)**

All materials guaranteed to be as specified. All work to be completed in a workmanlike manner according to standard practices. Any alteration or deviation from above specifications involving extra cost, will be executed only upon written orders, and will become an extra charge over and above the estimate. All agreements are contingent upon strikes, accidents or delays beyond our control. This proposal is subject to acceptance within 30 days and is void thereafter at the option of the undersigned.

If, after acceptance of this proposal, I/we, Roland Gomez, dba T L Plumbing, Inc., hires an attorney to collect monies due from you on this accepted proposal or to enforce any provisions hereof, you agree to pay my attorney's fees, all expenses of collection, and court cost, if any, incurred for said purposes of collection and/or enforcement of provisions.

Date: \_\_\_\_\_ Authorized Signature \_\_\_\_\_

**Roland Gomez, T L Plumbing, Inc.**

**Acceptance of Proposal**

**The above prices, specifications and conditions are hereby accepted. You are authorized to do the work as specified. Payment will be made as outlined above.**

Date: \_\_\_\_\_ Signature \_\_\_\_\_

TEXAS STATE BOARD OF PLUMBING EXAMINERS  
Lisa G. Hill Executive Director  
929 EAST 41<sup>st</sup> ST. PO BOX 4200, AUSTIN, TX 78765-4200  
TEL: (800) 845-6584 (512) 936-5200 FAX (512) 450-0637  
WWW. Tsbpe.texas.gov

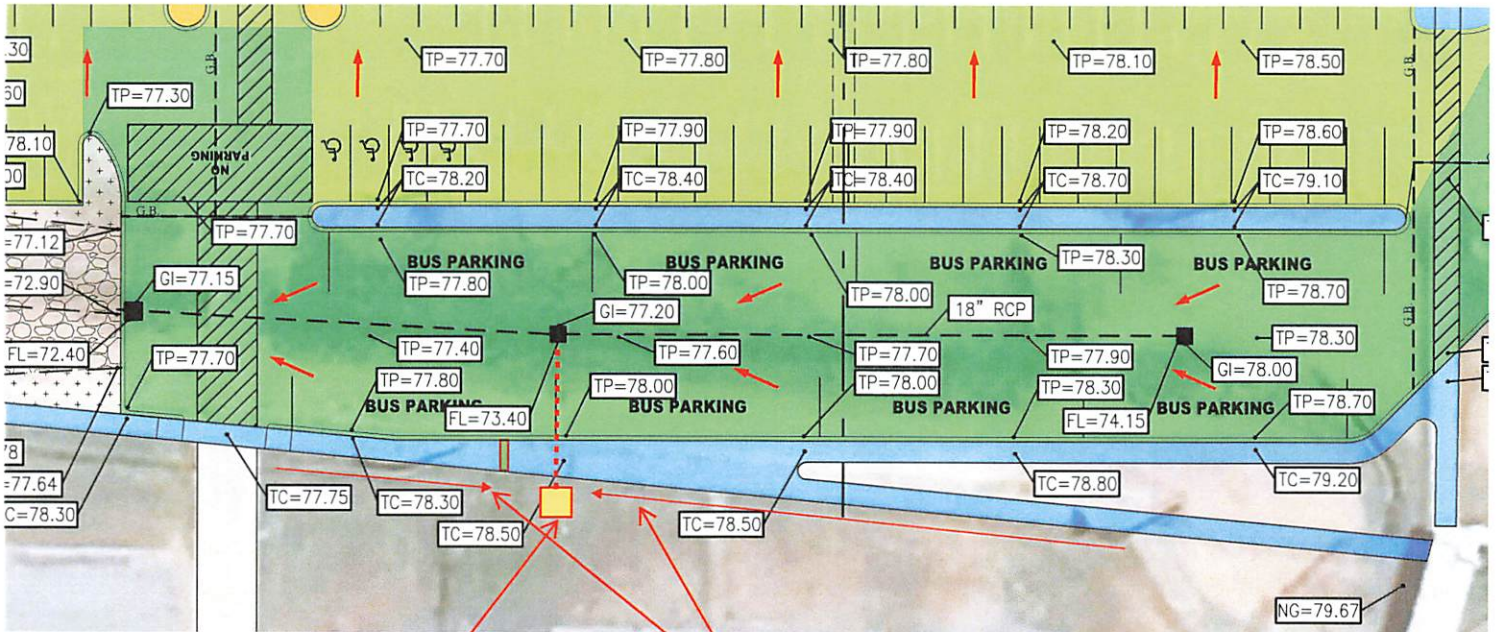

Proposed Location of added grate inlet.

How existing grass area drains.