

Construction Report

11/09/2016

Operations Division

Denton Independent School District

Prepared by:

Paul Andress, Executive Director of Operations

Glen Martin, Construction Manager

Angela Alfonso, Utilities Specialist

Keith Cummins, Corgan

Susan Smith, Corgan

Mike Elmore, Stantec

Justin Hiles, VLK Architects

Leesa Vardeman, VLK Architects

Construction Expenditures

2013 Bond Projects - August 2016 - October 2016

2007 Bond Projects - August 2016 - October 2016

2013 Bond

August 2016

Sub-Project	Project Name	Vendor	Fees	Construction
SP - 28	Guyer High School Additions	D & S Engineering Labs (G16-2049)	\$ 17,500.00	
SP - 28	Guyer High School Additions	Coleman & Assoc. Land Surveying (16-2030-2)	\$ 3,530.00	
SP - 28	Guyer High School Additions	VLK Architects (2-1597.00)	\$ 1,080,625.00	
SP - 28	Guyer High School Additions	Coleman & Assoc. Land Surveying (16-2030-3)	\$ 1,950.00	
SP - 28	Guyer High School Additions	Coleman & Assoc. Land Surveying (16-2030-4)	\$ 2,242.50	
SP - 28	Guyer High School Additions	Coleman & Assoc. Land Surveying (16-2030-5)	\$ 1,362.50	
SP - 51	High School #4	VLK Architects (30-2855.00)	\$ 59,910.43	
SP - 51	High School #4	TD Industries (0001223731)		\$ 10,669.00
SP - 51	High School #4	TD Industries (0001213856)		\$ 47,860.00
SP - 51	High School #4	Balfour Beatty Construction (APP 4)		\$ 2,986,070.63
SP - 51	High School #4	Teague Nall and Perkins, Inc. (13266.08-11)	\$ 2,689.72	
SP - 51	High School #4	D & S Engineering Labs (14-0358 B-33)	\$ 7,044.87	
SP - 51	High School #4	D & S Engineering Labs (16-7-000027)	\$ 1,588.25	
SP - 51	High School #4	TD Industries (0001223730)		\$ 46,424.00
SP - 51	High School #4	TD Industries (0001213856)		\$ 47,860.00
SP - 51	High School #4	VLK Architects (31.2855.00)	\$ 147,821.13	
SP - 51	High School #4	McMahon Contracting, LP		\$ 141,900.07
SP - 51	High School #4	TD Industries (0001231687)		\$ 15,274.00
SP - 51	High School #4	TD Industries (0001231686)		\$ 49,917.00
SP - 56	Elementary School #23	TD Industries (0001223734)		\$ 3,315.00
SP - 56	Elementary School #23	TD Industries (0001223733)		\$ 10,371.00
SP - 56	Elementary School #23	TD Industries (0001213859)		\$ 31,180.00
SP - 56	Elementary School #23	TD Industries (0001223732)		\$ 30,456.00
SP - 56	Elementary School #23	TD Industries (0001231682)		\$ 11,832.00
SP - 56	Elementary School #23	Stantec (1081864)	\$ 10,997.31	
SP - 56	Elementary School #23	Balfour Beatty Construction (APP 15)		\$ 164,234.00
SP - 57	Middle School #8	Corgan (15068.0000-15)	\$ 30,253.20	
SP - 57	Middle School #8	D & S Engineering Labs (16-7-000026)	\$ 27,269.02	

SP - 57	Middle School #8	Balfour Beatty Construction (APP 4)		\$	1,563,147.62
SP - 57	Middle School #8	Teague Nall and Perkins, Inc. (15248.07-04)	\$	978.59	
SP - 57	Middle School #8	Teague Nall and Perkins, Inc. (15248.05-02)	\$	3,266.76	
SP - 57	Middle School #8	Teague Nall and Perkins, Inc. (15248.07-05)	\$	525.60	
SP - 57	Middle School #8	Corgan 15068.0000-16	\$	34,560.00	

() = Invoice # / Pay Application #

Highlighted items are new this week

Sub Total	\$	1,434,114.88	
	\$	5,160,510.32	
	Total		

2013 Bond

September 2016

Sub-Project	Project Name	Vendor	Fees	Construction
SP - 28	Guyer High School Additions	Teague Nall and Perkins, Inc. (16114-02)	\$ 4,207.95	
SP - 28	Guyer High School Additions	Teague Nall and Perkins, Inc. (16113-01)	\$ 10,890.55	
SP - 51	High School #4	D & S Engineering Labs (14-0358 B-34)	\$ 4,603.13	
SP - 51	High School #4	D & S Engineering Labs (16-8-000042)	\$ 1,028.13	
SP - 51	High School #4	DFW Communications (123000098-1)	\$ 72,272.09	
SP - 51	High School #4	Balfour Beatty Construction (APP 24)		\$ 2,845,653.38
SP - 51	High School #4	VLK Architects (33-2855.00)	\$ 42,969.57	
SP - 51	High School #4	TD Industries (0001231685)		\$ 151,724.00
SP - 51	High School #4	TD Industries (0001238478)		\$ 3,335.00
SP - 51	High School #4	TD Industries (0001238477)		\$ 5,927.00
SP - 51	High School #4	TD Industries (0001238476)		\$ 23,930.00
SP - 51	High School #4	McMahon Contracting, L.P. (APP 2)		\$ 184,125.07
SP - 56	Elementary School #23	Stantec (1093668)	\$ 850.00	
SP - 56	Elementary School #23	TD Industries (0001231681)		\$ 34,811.00
SP - 56	Elementary School #23	TD Industries (0001238480)		\$ 4,363.00
SP - 56	Elementary School #23	TD Industries (0001238481)		\$ 4,420.00
SP - 57	Middle School #8	D & S Engineering Labs (16-8-000041)	\$ 27,266.27	

() = Invoice # / Pay Application #

Highlighted items are new this week

Sub Total	\$ 164,087.69	
		\$ 3,258,288.45
	Total	

2013 Bond

October 2016

Sub-Project	Project Name	Vendor	Fees	Construction
SP - 28	Guyer High School Additions	Teague Nall and Perkins, Inc. (16113-02)	\$ 6,139.39	
SP - 28+A9:E	Guyer High School Additions	Teague Nall and Perkins, Inc. (16113-03)	\$ 17,801.53	
SP - 51	High School # 4	McMahon Contracting, L.P. (APP #3)		\$ 34,403.08
SP - 51	High School # 4	D & S Engineering Labs (16-9-000064)	\$ 831.50	
SP - 51	High School # 4	VLK Architects (34-2855.00)	\$ 110,194.96	
SP - 51	High School # 4	Balfour Beatty Construction (APP 25)		\$ 2,577,782.11
SP - 51	High School # 4	McMahon Contracting, L.P. (APP 4)		\$ 18,969.61
SP - 51	High School # 4	TD Industries (0001246431)		\$ 8,300.00
SP - 51	High School # 4	TD Industries (0001246430)		\$ 19,144.00
SP - 56	Elementary School #23	Balfour Beatty Construction (APP 16)		\$ 103,402.00
SP - 56	Elementary School #23	Balfour Beatty Construction (APP 17)		\$ 38,139.00
SP - 56	Elementary School #23	TD Industries (0001246432)		\$ 11,607.00
SP - 56	Elementary School #23	Stantec (1107753)	\$ 19,129.48	
SP - 57	Middle School #8	Balfour Beatty Construction (APP 5)		\$ 1,679,393.43
SP - 57	Middle School #8	D & S Engineering Labs (16-9-000063)	\$ 18,885.98	
SP - 57	Middle School #8	Balfour Beatty Construction (APP 6)		\$ 2,616,687.26
SP - 57	Middle School #8	Corgan (15068.0000-17)	\$ 47,600.00	

() = Invoice # / Pay Application #

Highlighted items are new this week

Sub Total	\$ 220,582.84	
		\$ 7,107,827.49
	Total	

2007 Bond

August 2016

Sub-Project	Project Name	Vendor	Fees	Construction
SP - 55	Support Services Building	Corgan (16025.0000-6)	\$ 62,110.29	
SP - 55	Support Services Building	Coleman & Assoc. Land Surveying (16-2027-)	\$ 470.00	
SP - 55	Support Services Building	Corgan (16025.0000-7)	\$ 124,269.09	
SP - 55	Support Services Building	Coleman & Assoc. Land Surveying (16-2027-4)	\$ 1,497.50	
SP - 55	Support Services Building	Coleman & Assoc. Land Surveying (16-2046-2)	\$ 1,266.25	

() = Invoice # / Pay Application #

Highlighted items are new this week

Sub Total	\$ 189,613.13		
	Total	\$	-

2007 Bond

October 2016

Sub-Project	Project Name	Vendor	Fees	Construction
SP - 55	Support Services Building	Corgan (16025.0000-8)	\$ 55,256.25	
SP - 55	Support Services Building	Coleman & Assoc. Land Surveying (16-2027-5)	\$ 1,092.50	
SP - 55	Support Services Building	Corgan (16025.0000-9)	\$ 82,842.14	

() = Invoice # / Pay Application #

Highlighted items are new this week

Sub Total	\$ 139,190.89		
	Total	\$	-

Project – 55

Support Services Building

(2007 Bond Referendum)

Project – 57

Middle School #8

(2013 Bond Referendum)



Construction Progress Update:

- Underground Utilities are complete.
- Area C, D, E and F Slabs are in place.
- Concrete Masonry Walls are ongoing at the Competition and Practice Gymnasiums
- Integrated Concrete Forms (ICF) construction is ongoing at Area C, D and F.
- Site Paving is in progress.
- Retention Pond is constructed at the entry of the site.

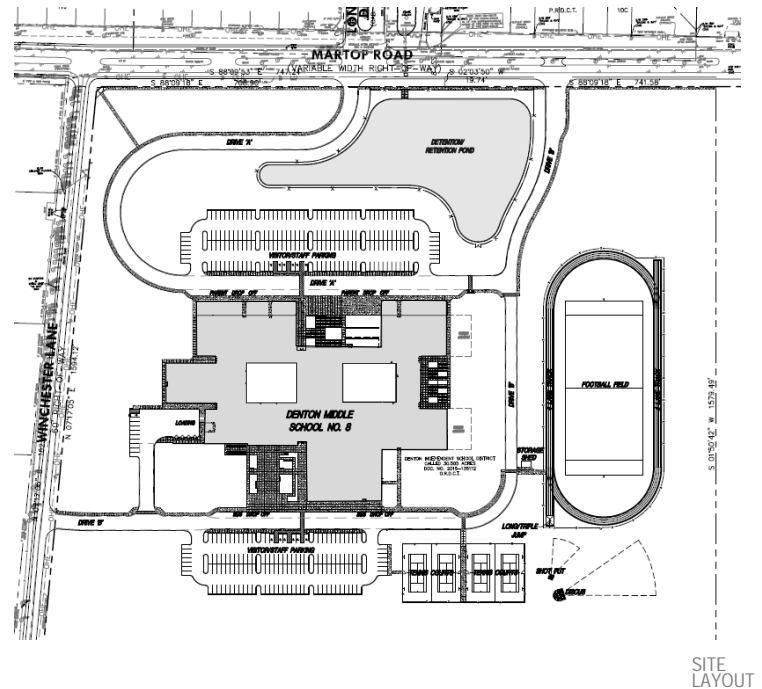

SITE
LAYOUT

November 09th, 2016



RUDY & ROSEMARY RODRIGUEZ MIDDLE SCHOOL
Denton ISD

CORGAN



Area E Competition and Practice
Gymnasiums, CMU Construction.



Classroom Area ICF
Construction.

November 09th, 2016



RUDY & ROSEMARY RODRIGUEZ MIDDLE SCHOOL
Denton ISD

CORGAN 



Site Retention Pond at the Entry of the Site.



Tennis Court grading and foundation in progress.

November 09th, 2016



RUDY & ROSEMARY RODRIGUEZ MIDDLE SCHOOL
Denton ISD

CORGAN 

Project – 28

Guyer High School Addition/Renovations

(2013 Bond Referendum)

11.09.2016



New Additions and Renovations Site Plan

Project Milestone Dates

Guyer High School Additions and Renovations

OFP Drawings to BBC

Proposals due at 2:00 p.m. - BBC

GMP for School Board Packet

Denton ISD - Board Meeting for GMP Review

Anticipated Notice to Proceed

Substantial Completion Date

October 17, 2016 (Monday)

November 15, 2016 (Tuesday)

December 5, 2016 (Monday)

December 13, 2016 (Tuesday)

December 14, 2016 (Wednesday)

July 2018

11.09.2016



STUDENT

Rendering of Student Entrance



Bird's Eye View of Additions and Renovations

11.09.2016

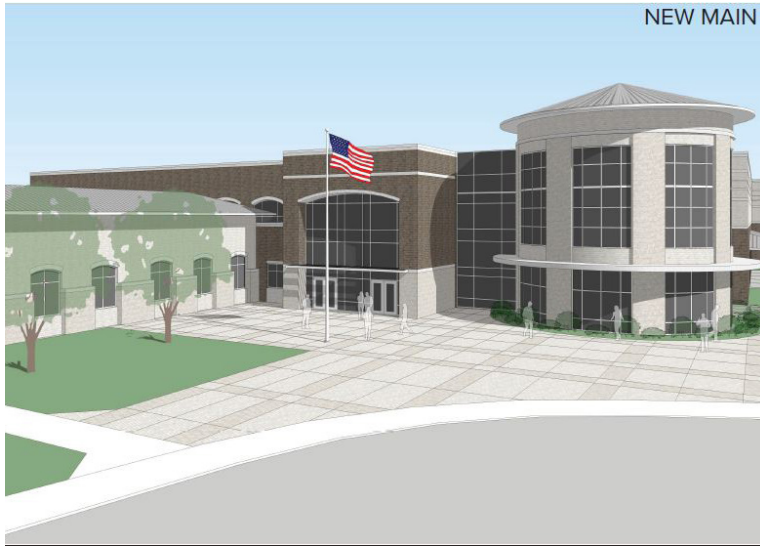

NEW MAIN Rendering of New Main Entrance



MEN Rendering of Men's Field House

Project – 51

Comprehensive High School # 4

(2013 Bond Referendum)

11.9.2016



Aerial of main gym

Completed Activities

Main Building

- Main gym is complete

Site Buildings

- Multi-sport field house is complete
- Field events are complete

11.9.2016



Aerial of Multi-Sport Field House

Projected Activities

Main Building

- Completion of third classroom wing
- Completion of auditorium and lecture hall
- Completion of south courtyard
- Continue close out activities

Site Buildings

- Completion of baseball and softball field houses
- Completion of baseball and softball fields
- Completion of tennis courts
- Continue close out activities

The construction progress 95% complete.

11.9.2016



View of Baseball & Softball Fields



View of Auditorium



View of Auditorium

11.9.2016



View of Practice Fields



View of Cafeteria



View of Field Events

11.9.2016



View of Gymnasium



View of South Courtyard



View of South Courtyard

Project – 56

Elementary School # 23

(2013 Bond Referendum)

Catherine Coleman Bell Elementary



11.09.16

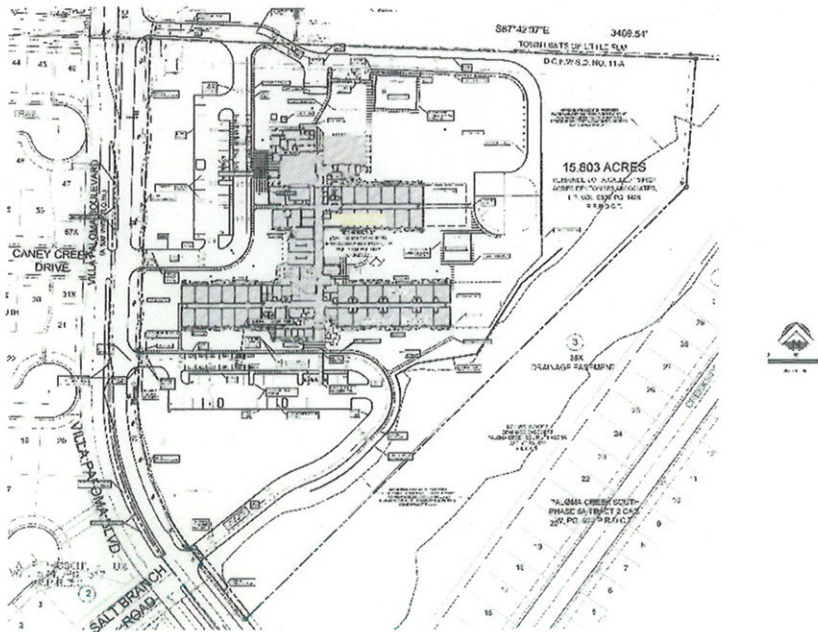

- Catherine Bell Elementary is complete is operating smoothly.

Balfour Beatty
Construction

Denton Elementary School #23
Catherine Coleman Bell Elementary

August 2016



Catherine Coleman Bell Elementary

11.09.16

Catherine Coleman Bell Elementary

11.09.16



- Main entrance.
- Marquee sign.



Catherine Coleman Bell Elementary

11.09.16

Catherine Coleman Bell Elementary

11.09.16



- Entrance Lobby
- Main Entrance



Catherine Coleman Bell Elementary

11.09.16



- Playground
- Cafeteria Entrance



11.09.16



- Exterior wall of Classroom Wing.
- K - 1st Classroom.



11.09.16



- K – 1st Classroom

- Library



11.09.16



- Computer Labs



11.09.16



Science Classroom



Science Prep Room

11.09.16



Art Classroom



Gymnasium

11.09.16



Cafeteria and Stage