

Michigan Bus Purchasing
Price Comparison Report - Spec #25610
 Mar 11, 2026 5:15 PM

Buying Organization **Holland**
 670 E 16th St
 Holland MI 49423-3738

Notes Livonia GAS GM 1 WC phase 2 25-26

Product Category A-II (2025-26 Phase 2)

Product 29/30 Passenger

Quantity 1

	Option	Option SKU Buyer Comments	Hoekstra	Holland	Midwest Transit
Product Base Price			\$101,776.00	\$107,809.00	\$108,889.00

Chassis Options

Headlights

LED Headlamps	C266	N/A	S/E	N/A
---------------	------	-----	-----	-----

Tire Pressure Monitor

Tire Pressure Monitoring System (TPMS)	C405	N/A	S/E	N/A
--	------	-----	-----	-----

Warranty, Engine

5-year/unlimited mileage	C465	S/E	S/E	N/A
--------------------------	------	-----	-----	-----

New

Body Options

Air Conditioning

MCC/Carrier AC5W13, 50,000 BTU	B123	\$4,250.00	---	---
Victory 70,000 BTU, rear flush in-wall evaporator, rooftop condenser (GM only)	B140	N/A	\$7,498.00	\$7,999.00

All Light Monitor System

Add all light monitor system	B160	S/E	\$382.00	S/E
------------------------------	------	-----	----------	-----

Color, Interior

Walls white	B234	N/A	S/E	S/E
-------------	------	-----	-----	-----

Door, Entrance

Electric, double out, split type	B260	\$509.00	S/E	\$489.00
----------------------------------	------	----------	-----	----------

Entrance Step

Driver's side	B275	\$84.00	\$150.00	\$229.00
---------------	------	---------	----------	----------

Exit, Roof Hatch

1 Transpec Low Profile, 1170 series	B320	S/E	S/E	S/E
-------------------------------------	------	-----	-----	-----

Fenderettes

Metal fenderettes	B350	S/E	S/E	N/A
-------------------	------	-----	-----	-----

Floor Covering

Rubberized colored flooring	B370	N/A	S/E	S/E
-----------------------------	------	-----	-----	-----

Floor Tracking System

4 floor rows/1 row over windows/L-track/1 WC (each) (Qty: 5)	B380	(\$500.00)	\$3,075.00	N/A
--	------	------------	------------	-----

Grab Rail at Entrance

Dual height	B400	N/A	N/C	N/A
-------------	------	-----	-----	-----

Heater, Mid-body Rear

50,000 BTU	B430	\$220.00	S/E	N/A
------------	------	----------	-----	-----

Lettering and Trim

Substitute Reflexite tape	B450	N/C	N/C	N/A
---------------------------	------	-----	-----	-----

Lights, Strobe

Delete light & wiring	B480	(\$80.00)	(\$194.00)	(\$152.00)
-----------------------	------	-----------	------------	------------

Lights, Overhead Warning

Halogen bulbs (downgrade)	B483	(\$764.00)	S/E	(\$550.00)
---------------------------	------	------------	-----	------------

Mirrors, Rearview

Rosco Accustyle, heated	B577	\$61.00	S/E	S/E
-------------------------	------	---------	-----	-----

Noise Reduction System

Perforated ceiling, full bus	B595	\$189.00	S/E	S/E
------------------------------	------	----------	-----	-----

Seats, Passenger

Deduct for delete seat (per seat) (Qty: 4)	B705	(\$908.00)	(\$800.00)	(\$2,200.00)
--	------	------------	------------	--------------

Seats, Passenger: Color

Gray	B713	S/E	S/E	S/E
------	------	-----	-----	-----

Seats, Passenger: Restraining

Seatbelts, 3 per seat, entire bus	B721	\$436.00	\$245.00	\$599.00
-----------------------------------	------	----------	----------	----------

Seats, Track-mounted

39" seat w/3 seatbelts (per seat) (Qty: 6)	B732	\$2,526.00	\$1,464.00	\$354.00
--	------	------------	------------	----------

Step Tread

Pebble tread w/metal backing	B750	S/E	N/A	N/A
------------------------------	------	-----	-----	-----

Storage Pouch

Mounted on barrier behind driver	B782	\$19.00	\$20.00	\$75.00
----------------------------------	------	---------	---------	---------

Wheelchair Entry

Rear lift door w/Braun 1,000 lb cap. NCL3451	B837	N/A	\$8,850.00	\$7,059.00
--	------	-----	------------	------------

Wheelchair Securements (L-Track)

Sure-Lok Retraktor FF612S-4C (each)	B850	N/A	\$301.00	\$719.00
-------------------------------------	------	-----	----------	----------

Window, Rear

Tempered, 28% tinted	B870	S/E	S/E	N/C
----------------------	------	-----	-----	-----

Configured Price	\$107,818.00	\$128,800.00	\$123,510.00
-------------------------	---------------------	---------------------	---------------------

Dealer Options

Student Reminder	\$300.00		
student reminder		\$300.00	
Student Reminder			\$300.00
Wheelchair lift NOT AVAILABLE	\$8,850.00		
No full track option			\$3,075.00
Tariff	\$3,000.00		
Tariff		\$3,000.00	
Tariff			\$3,000.00
	Unit Price	<u>Hoekstra</u>	<u>Holland</u>
		\$119,968.00	\$129,885.00
	Total Price	\$132,100.00	\$129,885.00
	Grand Total	\$119,968.00	\$132,100.00
		\$129,885.00	\$129,885.00



QUOTATION: 077507
VERSION : 00

G.M.

G5 SCHOOL BUS
18 PASSENGERS

PREPARED FOR: HOLLAND MOTOR HOMES & BUS CO.
670 EAST 16TH ST.

HOLLAND
MI 49423

VEHICLE DESCRIPTION:

U.S.
CHEVY / GMC
6.6L Gas
G5
159" DRW 5 ROWS 76" FLAT FLOOR
REAR HANDI DOOR
HIGH WINDOWS FOR 74"/75"/76" BODY
DOD 32"
SCHOOL BUS

CERTIFICATION:
CERTIFICATION STATE:

SCHOOL BUS
MI

PREPARED BY: GRACIELA MILLAR

EXPIRATION DATE: APRIL 9 , 2026

CONTROL ID:

LIST CODE: 5T

PRICE LIST: 2026-01





Quoted by:
GRACIELA MILLAR
HOLLAND MOTOR HOMES & BUS CO.
HOLLAND , MI, 49423

Quoted to:
GM 2025 18+1

Body - Base

Option	Description	Option	Description
ALI	ALIGNMENT	LGT-1	LIFT/D GLASS (2) LIGHT TINT 62%
BC5	BODY FLAT FLOOR 158/159" 76"	LGZ	STEPWELL LED LIGHT
BUA-1	BACKING SAFETY HORN SAE 112DBA	LJ2-L	EXTERIOR LIGHTS LED SIDE LIFT DOOR
BUC-1	BACKUP CAMERA W/SCREEN IN MIRROR	LLP-L	LICENSE PLATE LIGHT LED
BU1-S	BUMPER REAR - STEEL 3/16	LN2-3M	REFLECTORS REAR RED - 3M
BWP	BLACK AROUND WARNING LAMPS PAINT 3"	LR0-N	HDCP DOOR HANDLE NO KEY
BW1	PANEL BELOW WINDOW - ALUMINUM	LST-L	STOP & TAIL LED LIGHTS
CPO	CHASSIS PREPARATION	L2N-1	RR DOOR LATCH/SLIDE BAR/3 POINT
DFO	DECAL "?????? FUEL ONLY"	MVW	MORE VIEW CLR GLASS TP
DG1	DRIVE LINE GUARD FRONT	NWH	NO WHEEL HOUSINGS
DMB-EY	DECAL MICRO BIRD ENG YLW BACK	PAG	FUEL FILLER POT
EEC	DOD ELECT CONTROL	PEY	PAINT EXTERIOR SCHOOL BUS YELLOW
EIB	DECAL EMERGENCY DOOR	PRW5	PAINT ROOF WHITE G5
ESK	EXTERIOR SKINS	PSBC	PAINTED ENT/STEP BODY COLOR MATCH
EFW	EXT WINDOW TRIM	RDB	EMERGENCY EXIT AJAR BUZZER
EXB	RELOCATE EXHAUST TO REAR	RDR	TELESCOPIC RETAINER REAR DOOR
E32	DOUBLE OPENING DOOR 32 IN	RDW2-T	REAR DOOR GLASS (2) LIGHT TINT 62%
FDC	FORD OR GM CONSOLE W/SWITCHES	RFCF	FRONT CAP SB OR COM STANDARD
FGL	INT & EXT FINISHING PARTS	RFCR	REAR CAP SB OR COM STANDARD
FGSW-Z	SMOOTH GREY FLR WHT NOSE ZEN	RFT-Y-3M	REFLEC TAPE EMER/D YELLOW 3M
FIR	FUEL INTEGRITY REINFORCEMENTS	RRF	RUB RAIL FLOOR LEVEL
FSR-1	STANDARD FRONT STRUCTURE	RRN	RUB RAIL BLACK
FS1	FLOOR STEEL GALVANIZED 14GA	RRS	RUB RAIL SEAT LEVEL
GCS	ENTR GRAB LH 1/4 IN SS PLAIN	RSR-1	REAR STRUCTURE STANDARD
GLC	GLOVE COMPARTMENT	SFS	STANDARD FLOOR STRUCTURE
GRG	GRAVEL SHIELDS MOLDED	SLND	ELEC SYS W/SOLENOID 200A
GUT	DRIP RAILS	SSM1	STOP ARM SMI STOP INCANDESCENT
GVWR-123	GVWR 12,300LB GM	SV1	STATIC ROOF VENT
HHNC	HEATER HOSE ONLY (1X)	UC1	UNDERCOATING BODY ONLY
HSF-1	HEAT SHIELD FOR FUEL TANK DELETE	US	U.S. SCHOOL BUS VEHICLE
IM	INT MIRROR 6X16 IN	V20	SHUT-OFF VALVE UNDER BODY(AUX HEAT)
ISF	INT FRONT SKINS STD	WHT	WHEEL WELL TRIM BLACK
ISRR	INT FINISH RR STD	WPI	8 WAY WIRING POWER ON IGNITION
LAH-S	STANDARD LED DOME LIGHTS	WRG	2 BACK WINDOWS LIGHT TINT (62%)
LBU-L	BACK-UP LIGHTS LED	WSQ	SEQUENTIAL 8WAY SYSTEM
LCL-L	IDENTIF.& CLEARANCE LIGHTS LED	WSS-S	WIRING SYSTEM STANDARD
LDN-L	DIRECTIONAL LED LIGHTS NO ARROW	8WS	8 WAYS STANDARD (4 AMBER 4 RED)
LGM-DS	DEC BIRD BLACK		





Quoted by:
GRACIELA MILLAR
HOLLAND MOTOR HOMES & BUS CO.
HOLLAND, MI, 49423

Quoted to:
GM 2025 18+1

Body - Requirements

Option	Description	Option	Description
2 DPU-Y-3M	DECAL+TAPE P/O US YELLOW 3M	MUD	MUDFLAPS STANDARD
EFK	KIT REFLEC (3) & FLARE (3)	M08	MONITOR 8 LIGHTS
EX2	EXTINGUISHER 5 LBS	NNS-S	NOISE SUPPRESSION SWITCH
FAK-PKG	FIRST AID KIT FED. SPEC U.S LOOSE	PGY	PAINT CHASSIS GRILL YELLOW
HCD-2	TWO (2) HANDICAP DECALS (2) 6X6	P3S	SELECT PLYWOOD 5/8INCH
I10	INTERLOCK LIFT ON IGNITION	RD2-MI	RR DOOR FOR GLASSES - MICHIGAN
LDS	LIFT DOOR SWITCH 2ND DOOR	SRT-S-2	STANDARD SPEAKERS WITH 2 DELETED
LJ1-L	EXTERIOR LIGHTS LED ENTRANCE DOOR	SSD	SEAT SPACING INSTRUCTIONS DECAL FOR
MI	MICHIGAN	TQG	WALL MOUNT L-TRACK LH&RH SHLDR BELT

Body - Options

Option	Description	Option	Description
AA-67TCG	A/C SPH 67K+OEM EVA/RR/GR W/COND	LTS-CT	4 X L-TRACK FULL LENGTH W/SEAT LH
ALS	ADDITIONAL LEAF SPRING (1)	LTS-CTR	4 X L-TRACK FULL LENGTH W/SEAT RH
BBX-DXT17	BBX DELETE W/BAT AUX ON RIGHT	MRSB-Z6	MIRROR ROSCO SB HTD W/TIMER
BH39LAA000	HSM BAR 39" LH HB GREY FB.WO/COR	PLH-3	REINF.PLATE HDPC DOOR 403/404 1000
BH39RAA000	HSM BAR 39" RH HB GREY FB. WO/COR	PST-H	HPADS GREY W/LIFT D. 2.0
BUS-6	CHILD DETEC SYSTEM 8 WAYS/DOD	RF8	LEFT STD ALU RUNNINGBOARD PAINTED
CBF	MANUEL RESETTING CIRCUIT BREAKERS	RHL	OEM RADIO WITH MICROBIRD SPEAKERS
CST-H	STRUCTURAL CAGE A/PORTE ELEV 2.0	RRSK	RUB RAIL SKIRT
DSB	DECAL -SCHOOL BUS- REFLEC 3M	RRW	RUB RAIL WINDOW LEVEL
EDG-TH	CLEAR THERMAL GLASS ENTRANCE DOOR	RSS1	ROOF HATCH SPHEROS SMART
F2A-1	2-SPD FAN RH ABOVE WINDSHIELD	6 SBK3	SEAT BELT KIT FOR (3) PASSENGERS
GDS	ENTR GRAB RH 1 1/4 IN SS PLAIN	3 SH39LAA026	HSM STD 39" LH HB GREY FB. WO/COR
HDA	HEATER REAR 42000BTU	3 SH39RAA026	HSM STD 39" RH HB GREY FB. WO/COR
ITC-P1RS	PNT ROOF SKINS 1 R/H SPEAKERS STD	SKG-2	SIDE SKIN SUPP & M/FLAP W/AC COND
ITST-H	INTERIOR FINISH 2.0 LIFT DOOR	SSS-D	STANDARD SEAT SUPPORT DELETE
LBS9	BRAUN LIFT CENT 1000LB 34X54 OFFSET	STC-39C	INT STOR COMPT BARRIER 39IN GRAY FB
6 LEGS-SQ	LEG T/S CEW QSTRAINT	TSS-L	SINGLE LEFT TRACK SEAT SUPPORTS
LR0-H	LIFT DOOR 2 LEAVES REAR 2.0	TSS-R	SINGLE RIGHT TRACK SEAT SUPPORTS
LTK-SDR1	L-TRK SURE-LOK RET FF600 (ADD TQG)	WBJ2	WIN S/S TINT 62% W/2 P/O +2 TH





Quoted by:
GRACIELA MILLAR
HOLLAND MOTOR HOMES & BUS CO.
HOLLAND , MI, 49423

Quoted to:
GM 2025 18+1

CHASSIS

Option	Description	Option	Description
ABS	4 WHEEL DISC BRAKES WITH ABS	TC	TRANSPORTATION CHARGES
AJ3	AIR BAG DRIVER'S SIDE ONLY	TGK	SPECIAL PAINT
AR7	SEAT FRONT BUCKET WITH VINYL TRIM	TP3	DUAL BATTERIES EACH 770 AMPS
BNC	BODY MOUNT CUSHIONS (PUCK)	UE0	ONSTAR DELETE
B3D	SCHOOL BUS CHASSIS EQUIPMENT	UJ1	BRAKE WARNING INDICATOR
C60	FRONT DASH AIR	U0F	RADIO AM/FM WITH MP3
C7N	12300 LBS GVWR	U05	HORN DUAL NOTE TONE
DTRL	DAYTIME RUNNING LAMPS	VK3	LICENSE PLATE BRACKET
D31	TILT REARVIEW MIRROR	VQ2	FLEET PROGRAM
ENC-HVAC	PROV.AUX.HEATER PLUMBING & WIRING	VTP	VOLMETER TEMPERATURE & OIL PRESSURE
FE9	EMISSIONS FEDERAL SPECS	V4D	STOP TURN SIGNAL CIRCUITS
FTC-21	FUEL TANK 32 GALLONS / 121.1 LITERS	XHF	TIRE FRONT LT225/75R16E ALS B/L DRW
GT4	REAR AXLE RATIO: 3.73	ZQ3	TILT STEERING & SPEED CONTROL
JL4	STABILITRAK SYSTEM	ZX1	HIGH BACK BUCKET DRIVER'S ONLY
KC4	COOLING EXTERNAL ENGINE OIL COOLER	01U	EXTERIOR PAINT YELLOW
KW5	ALTERNATOR 220 AMPS	1WT	EQUIPMENT GR 1WT MDEL 3500 / GAS
L8T	ENGINE GAS 6.6L V8	159	159" WHEELBASE
NB8	EMISSION OVERRIDE (NY FE9)	4300	FRONT GAWR 4300 LBS
NST	WITHOUT SPARE TIRE	8E8	FRONT BUMPER PAINTED BLACK
N8X	8 SPEED HD TRANSMISSION	8600	REAR GAWR 8600 LBS
PWS	POWER STEERING	9L7	ACCESSORY POWER CIRCUITS
QT4	WHEEL 16 X 6.5 STEEL HD DRW	9T7	RIGHT SIDE DOOR DELETE
R05	DUAL REAR WHEELS	93W	TRIM VINYL MEDIUM DARK PEWTER
R6H	GM UPFITTER ALLOWANCE		



SEAT PLAN: SP65004

QUOTE: 077507

HOLLAND MOTOR HOMES & BUS CO.

		LEFT	RIGHT
BARRIERS		BH39LAA000 CEW BARRIER STANDARD RIGID HI 39 /LVL: 1 GRY GREY	BH39RAA000 CEW BARRIER STANDARD RIGID HI 39 /LVL: 1 GRY GREY
		-	-
ROW	1	SH39LAA026 CEW SCHOOL STANDARD RIGID HI 39 /LVL: 1 GRY GREY /LIGHT PACKAGE /LATCH LEGS-SQ LEG T/S CEW QSTRAINT SBK3 SEAT BELT KIT FOR (3) PASSENGERS	SH39RAA026 CEW SCHOOL STANDARD RIGID HI 39 /LVL: 1 GRY GREY /LIGHT PACKAGE /LATCH LEGS-SQ LEG T/S CEW QSTRAINT SBK3 SEAT BELT KIT FOR (3) PASSENGERS
		-	-
ROW	2	SH39LAA026 CEW SCHOOL STANDARD RIGID HI 39 /LVL: 1 GRY GREY /LIGHT PACKAGE /LATCH LEGS-SQ LEG T/S CEW QSTRAINT SBK3 SEAT BELT KIT FOR (3) PASSENGERS	SH39RAA026 CEW SCHOOL STANDARD RIGID HI 39 /LVL: 1 GRY GREY /LIGHT PACKAGE /LATCH LEGS-SQ LEG T/S CEW QSTRAINT SBK3 SEAT BELT KIT FOR (3) PASSENGERS
		-	-
ROW	3	SH39LAA026 CEW SCHOOL STANDARD RIGID HI 39 /LVL: 1 GRY GREY /LIGHT PACKAGE /LATCH LEGS-SQ LEG T/S CEW QSTRAINT SBK3 SEAT BELT KIT FOR (3) PASSENGERS	SH39RAA026 CEW SCHOOL STANDARD RIGID HI 39 /LVL: 1 GRY GREY /LIGHT PACKAGE /LATCH LEGS-SQ LEG T/S CEW QSTRAINT SBK3 SEAT BELT KIT FOR (3) PASSENGERS
		-	-

NOTE: The wheelchair restraint configuration for this bus is as shown below:

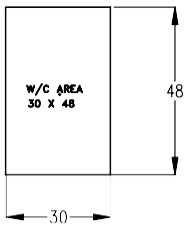

IMPORTANT NOTICE / AVIS IMPORTANT
 VEHICLE CONFIGURATION AND CAPACITY ARE SUBJECT TO CHANGE TO REFLECT ANY AND ALL CHASSIS SPECIFICATIONS OF THE MODEL YEAR UTILIZED.
 LA CONFIGURATION ET LA CAPACITÉ DE CE VÉHICULE SONT SUJETTES À DES MODIFICATIONS AFIN DE TENIR COMPTE DES SPÉCIFICATIONS DU CHÂSSIS DE L'ANNÉE MODÈLE UTILISÉ.

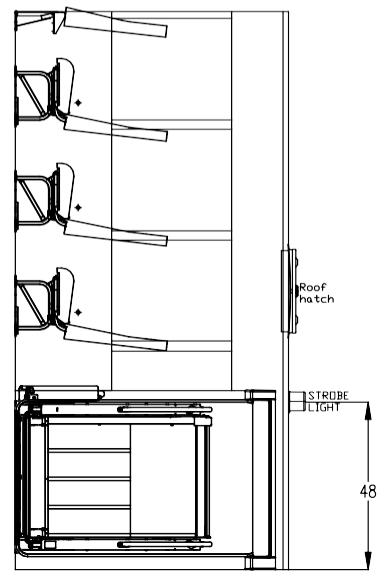
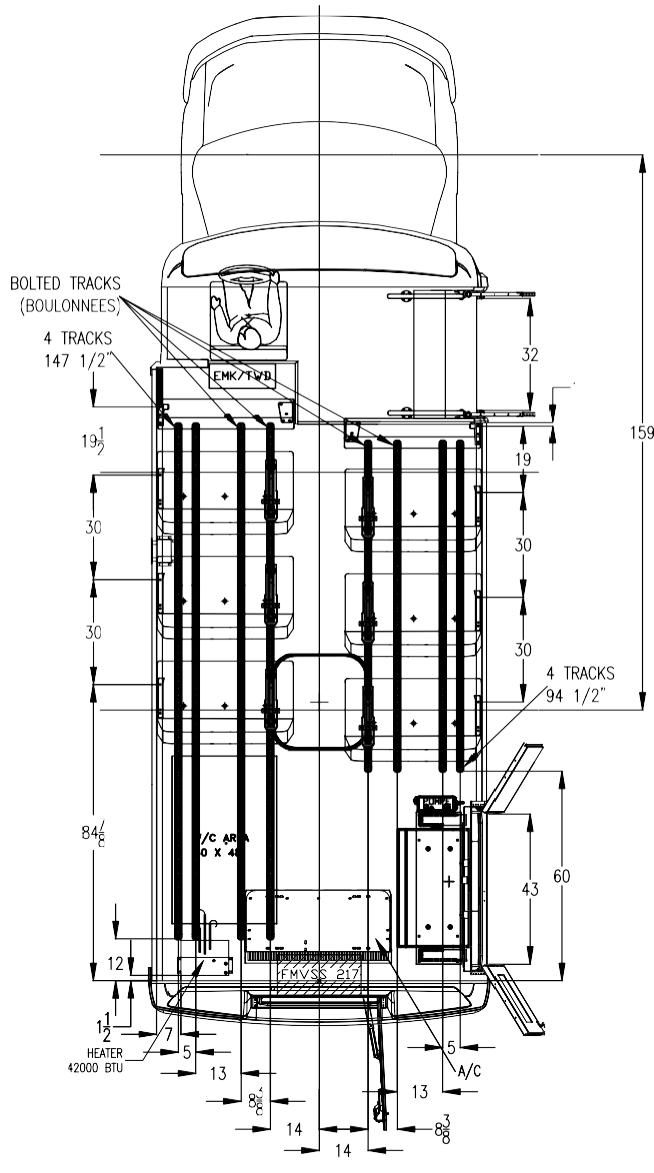
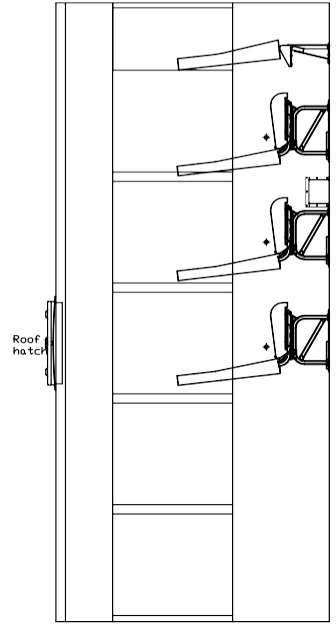

SEAT	DIM.	SIDE	QTY
SH-CI	39	LH	3
SH-CT	39	RH	3

Seat spacing = See drawing D.O.D.: 32"

APPROVED CONFIGURATIONS

Total ambulatory passengers : 18	Total wheel chair passengers : 1
Load cap. (pass. + cargo) : 1184kg	261 lbs

A01	2023/05/16	JD	VALIDATION DRAWING
REV.	YYYY/MM/DD	BY	DESCRIPTION
Stock Number:			
Customer Approval:			Date:

Drawn by : DENSY R.R.

MODEL: UGU5 CRH WST

Drawing no. F04946A

UNIT = INCHES
SCALE = DO NOT SCALE

NOTE: Any option added to this floorplan shall be approved by the Corporation Micro Bird inc technical department.