



TODD HALL CONCEPTS

February 25th, 2025

EXISTING BUILDING UTILIZATION

BUILDING UTILIZATION

EXISTING



- GRADE CLASSROOM
- SMALL GROUP/INTERVENTIONIST ROOMS
- STAFF / BUILDING SUPPORT
- SHARED CURRICULUM ROOMS
- NTDSE ROOMS
- CCDC ROOMS

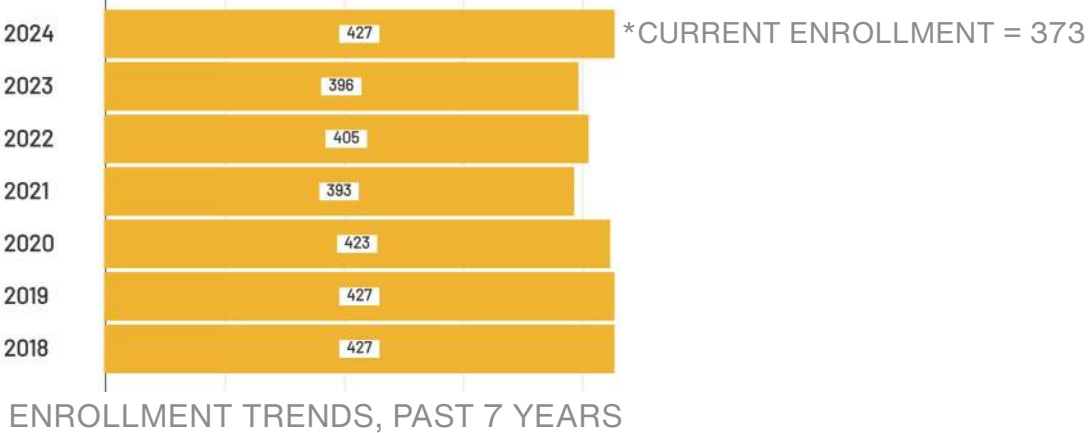

EXISTING					
Building Area (GSF)	60,378				
Current Enrollment (2024-2025)	373				
	QUANTITY	STUDENT CAPACITY PER ROOM (MAX)	BUILDING CAPACITY	TARGET UTILIZATION (90% TYP.)	FUNCTIONAL CAPACITY
Pre-K Classrooms	2	20	40	90%	36
Kindergarten Classrooms	6	20	120	90%	108
1st Grade Classrooms	6	24	144	90%	130
2nd Grade Classrooms	6	24	144	90%	130
Small Group/Intervention/ELL	12				-
Art Room	1		-		-
Music Room	1		-		-
STEM Room	-		-		-
Gymnasiums/MPR/Library	3		-		-
NTDSE Rooms	2		-		-
CCDC Rooms	4		-		-
			448		403

UTILIZATION	
	(CURRENT CAPACITY / BUILDING CAPACITY)
Current Enrollment (2024-2025)	83%

BUILDING UTILIZATION
AVERAGE ELEMENTARY SCHOOL UTILIZATION = 90%-100%

CONCEPT A: RENOVATION WITH CCDC

PROPOSED SCOPE OF WORK - EXISTING LAYOUT

• NORTH PLAN

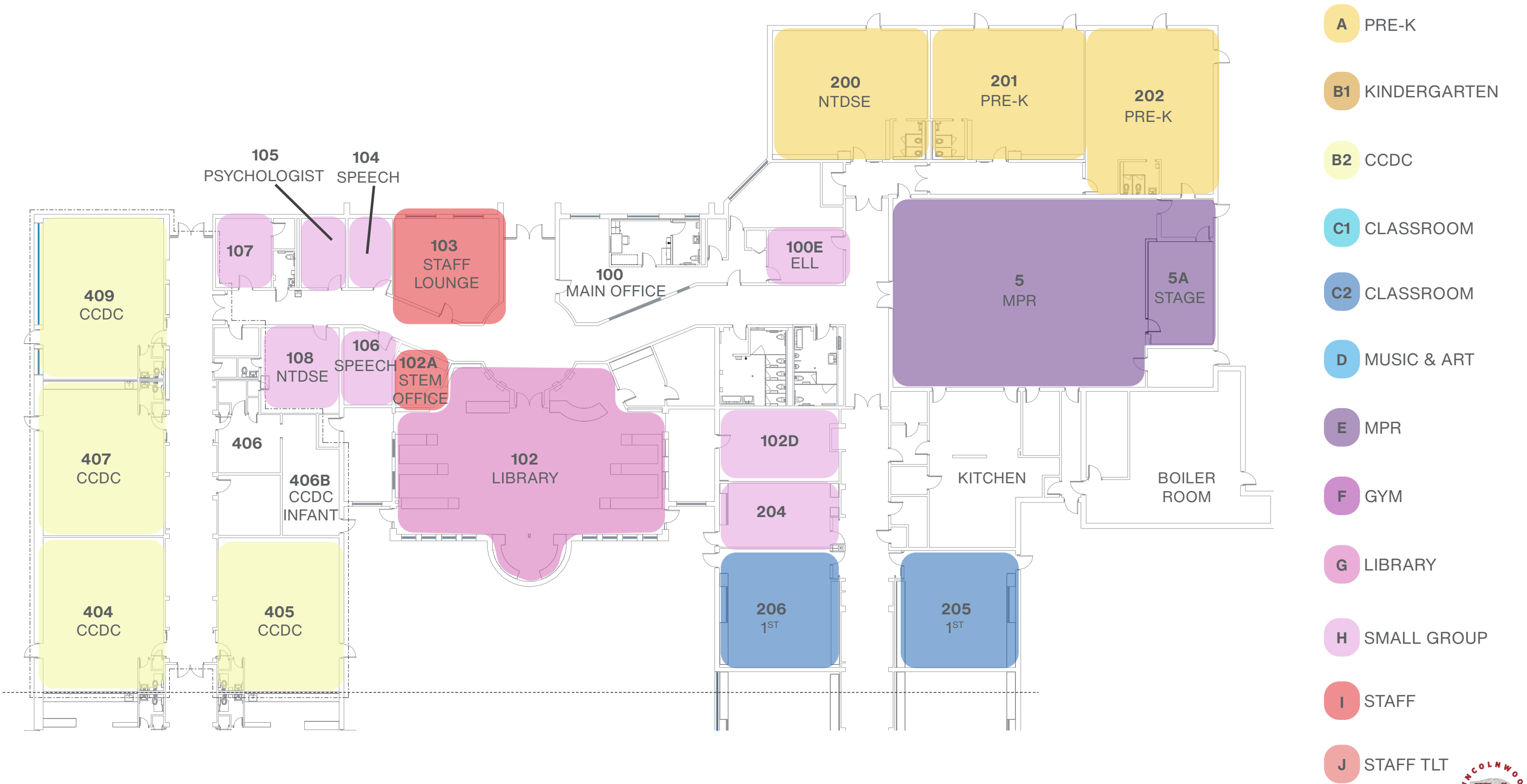

PROPOSED SCOPE OF WORK - EXISTING LAYOUT

• SOUTH PLAN



- A PRE-K
- B1 KINDERGARTEN
- B2 CCDC
- C1 CLASSROOM
- C2 CLASSROOM
- D MUSIC & ART
- E MPR
- F GYM
- G LIBRARY
- H SMALL GROUP
- I STAFF LOUNGE
- J STAFF TLT

PROPOSED SCOPE OF WORK

	RENOVATE TOILETS FOR ADA COMPLIANCE	REPLACE CASEWORK	REPLACE CEILING & LIGHTS	REPLACE FLOOR	FUR OUT WALLS	PAINT / WALL PANELS	ADD STORAGE (FURN./ CASEW.)	MODIFY OR ELIMINATE STAGE	REPLACE / ADD FURNITURE	PAINT DUCTWORK	REPLACE BASKETBALL HOOPS	MISC. MECH, ELEC, AV	OTHER CHANGES & NOTES
A: PRE-K 200, 201, 202	●	●	●	●	●	●	●		● TCHR DESK/ CHAIR ONLY			●	REPLACE CUBBIES; TOILET ROOMS TO BE RENOVATED
B1: KINDERGARTEN 400, 401, 402, 403	●	●	●		●	●	●		● TCHR DESK/ CHAIR & STOR.			●	TOILET ROOMS TO BE EXPANDED
B2: CCDC 404, 405, 407, 409	●	●	●		●	●	●		●			●	ALTERNATE BID; MECH. IS BASE BID; CONSIDER OPTIONAL ALT. FOR MOTHERS' ROOM
C1: TYPICAL CLASSROOM 301, 303, 305, 307, 309, 311, 313		●	●		●	●		●	● TCHR DESK/ CHAIR ONLY			●	
C2: TYPICAL CLASSROOM 205, 206, 207, 208, 209, 210, 212		●	●		●	●			●			●	REPLACE EXISTING CLASSROOM SINKS
D: MUSIC & ART 300, 302		●	●	●		●			●			●	CONSIDER SECOND SINK IN ART
E: MPR 5				●				●		●	●	● LINCOLNWOOD 74 SCHOOL DISTRICT	REPLACE BASKETBALL HOOPS
F: GYM 215				●		●					●	● LINCOLNWOOD 74 SCHOOL DISTRICT	ADD 2 BASKETBALL HOOPS ON WEST AND REPLACE 2 ON EAST
G: LIBRARY 102			●									●	ENCLOSE WEST READ. ROOM W/ WALL & DOOR; EXPLORE DIVIDING FOR NEW STEM LAB
H: SMALL GROUP ROOMS 100E, 102D, 104, 105, 106, 107, 108, 204, 211, 213, 315		●	●		●	●			●			●	CASEWORK EXISTS ONLY IN 204, 211, 213, 315
I: STAFF LOUNGE 103		●	●	●		●			●			●	REPLACE FURNITURE; ELIMINATE OPERABLE PARTITION
J: STAFF TOILETS				●		●							ELIMINATE SHOWER IN GYM STAFF TOILET



PROPOSED DEMOLITION - ADDITIONAL SCOPE CONSIDERATIONS

• NORTH PLAN

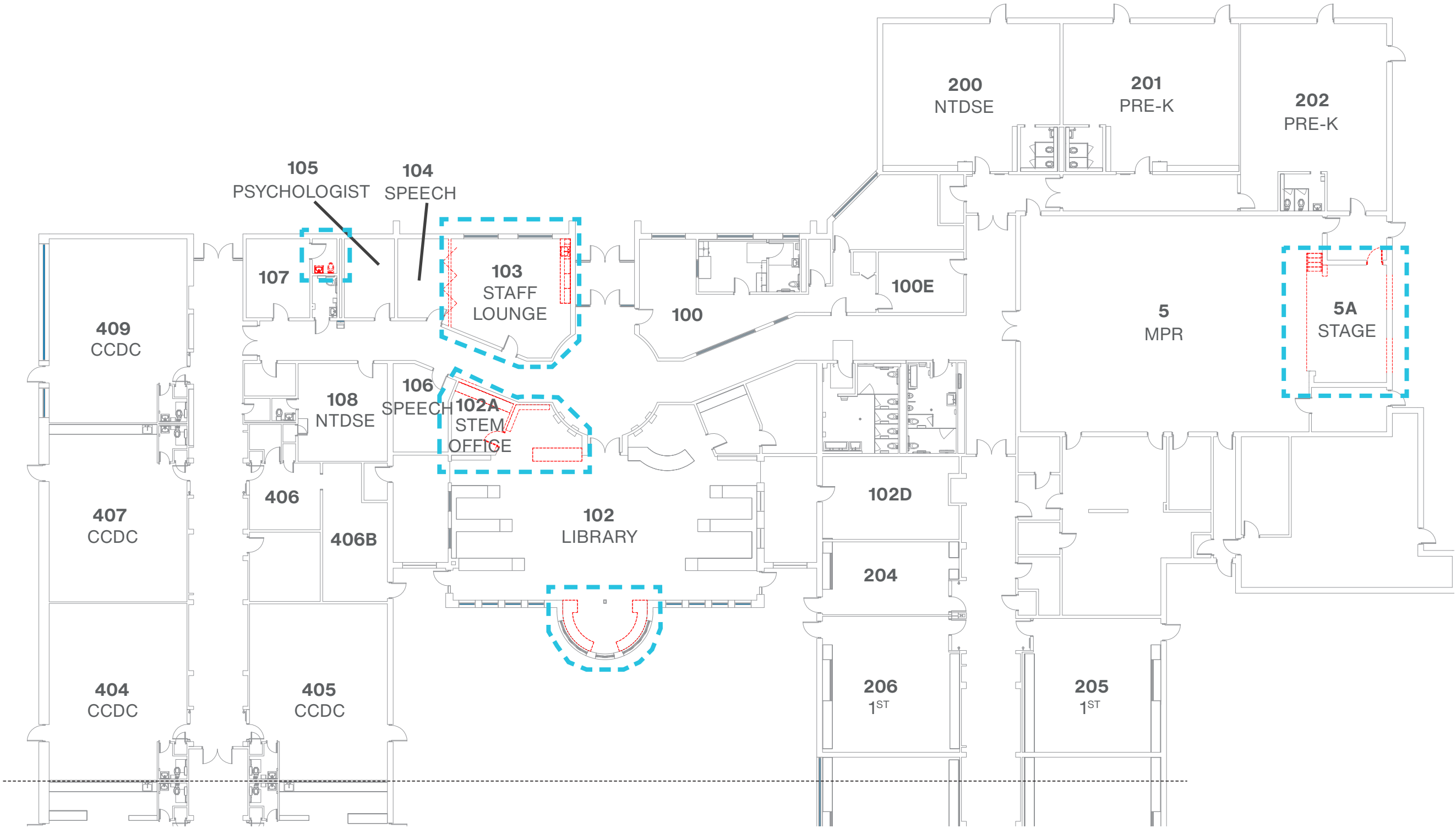

PROPOSED NEW CONSTRUCTION - ADDITIONAL SCOPE CONSIDERATIONS

• NORTH PLAN

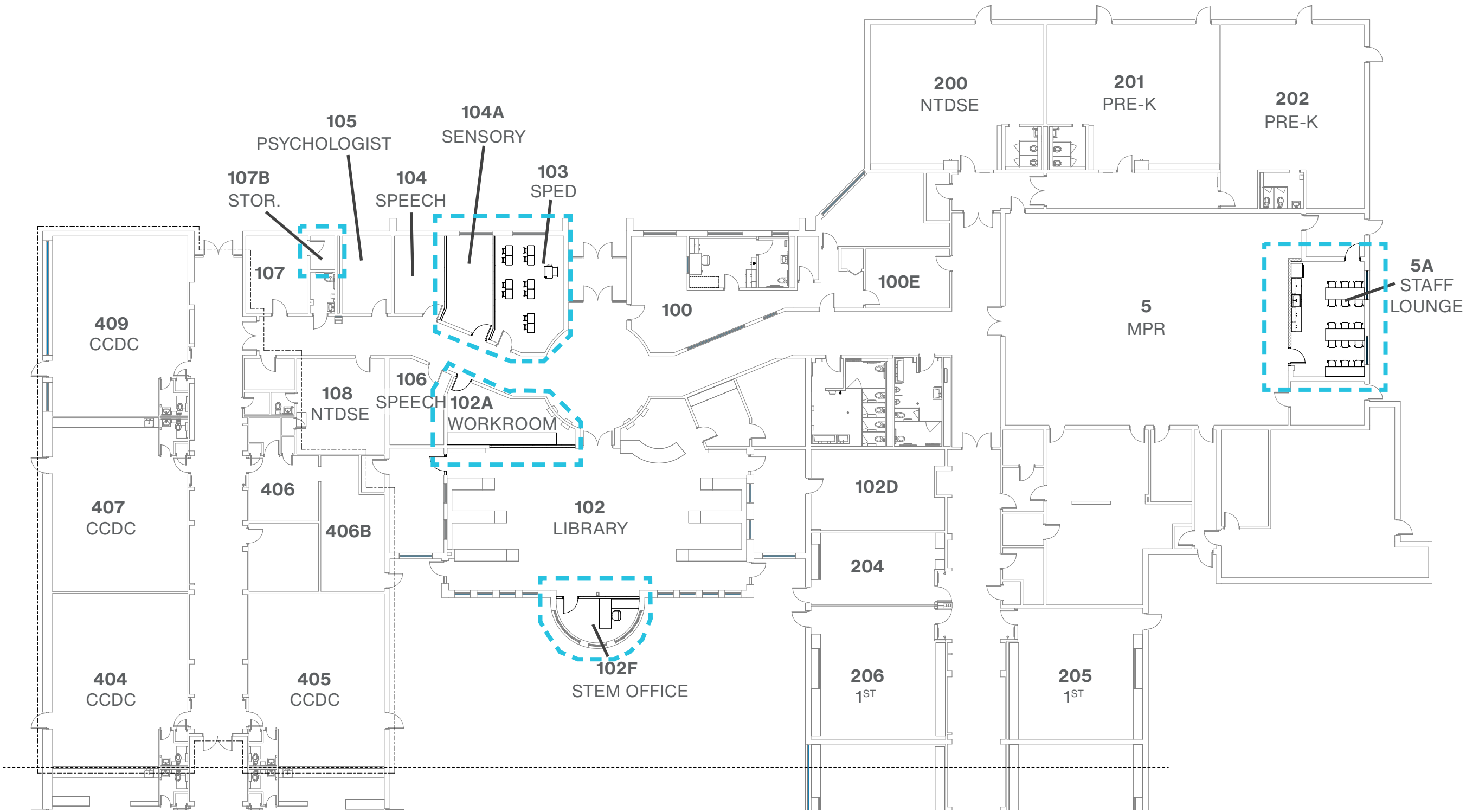

LIBRARY/STEM LAB - ALTERNATE CONSIDERATION

- LIBRARY AREA - DEMO & NEW

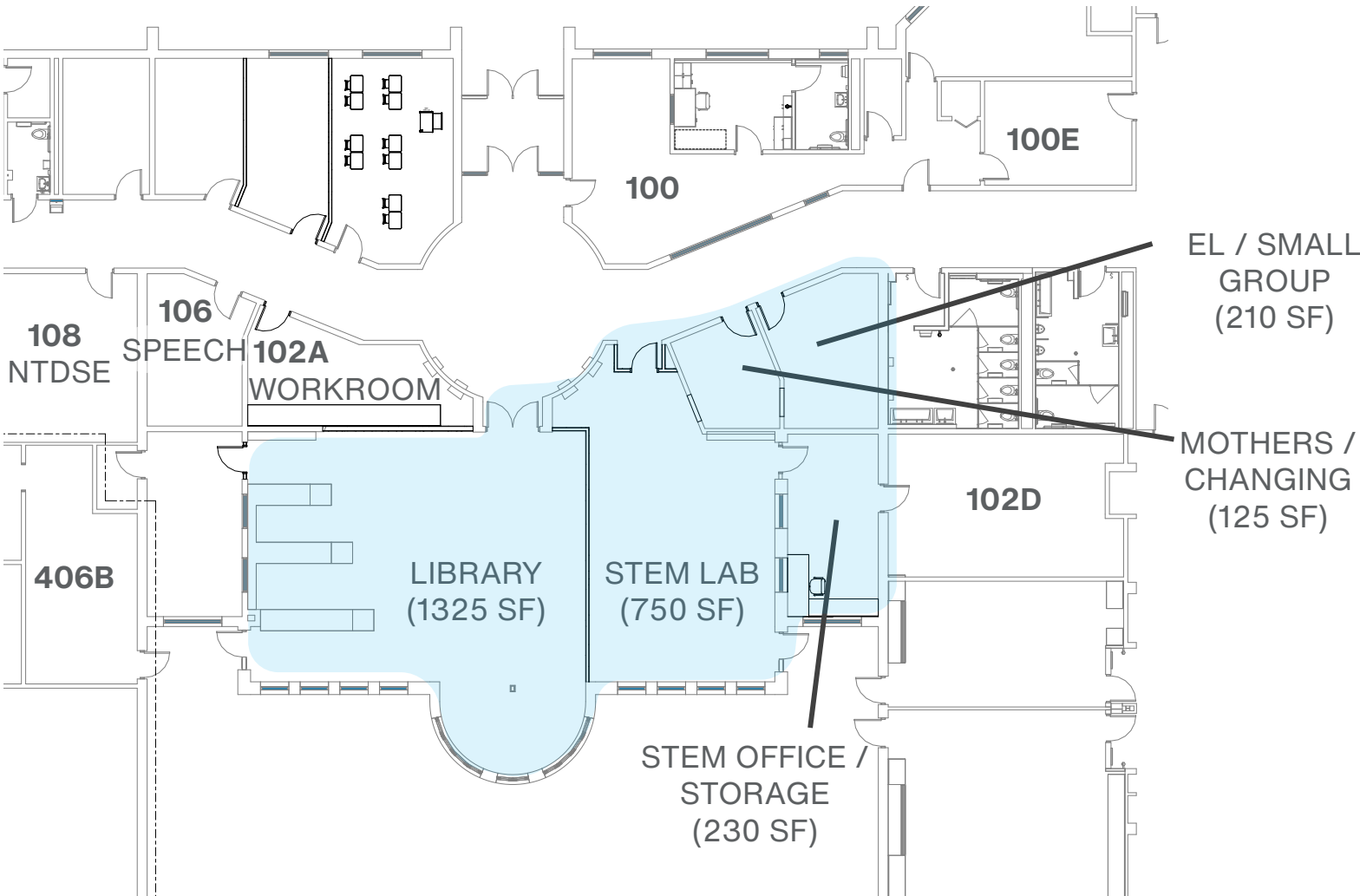
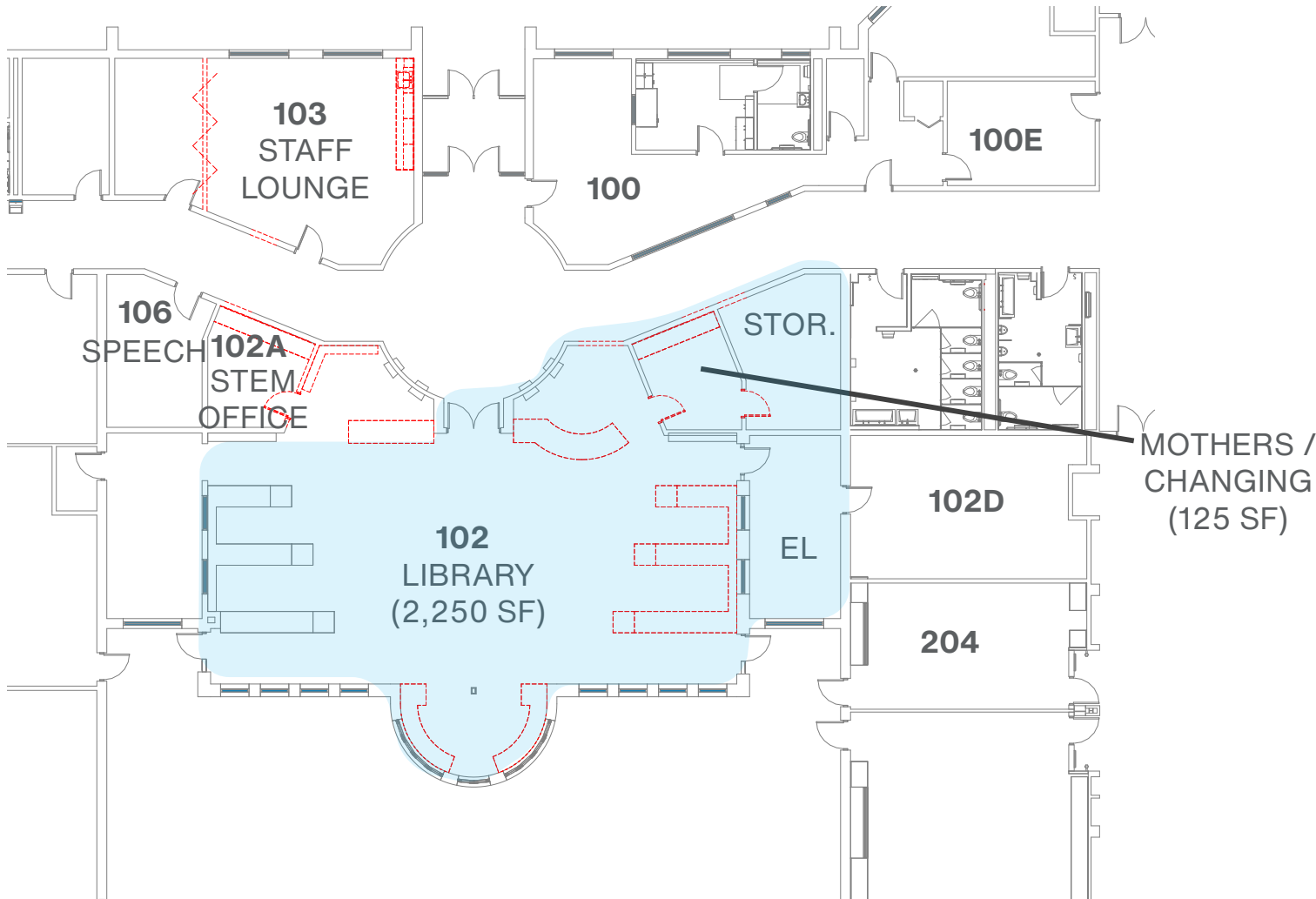

CONCEPT B: RENOVATION WITHOUT CCDC

PROPOSED PLAN



- GRADE CLASSROOM
- SMALL GROUP/INTERVENTIONIST ROOMS
- BUILDING SUPPORT
- ROOMS WITH NO CHANGE HALFTONED
- SHARED CURRICULUM ROOMS
- NTDSE ROOMS
- STAFF SUPPORT

CONCEPT C: ADDITION

PROPOSED ADDITION

• SITE PLAN

CCDC ENTRANCE
EXISTING TO REMAIN

ADDITION
4-CLASSROOMS
(NET GAIN OF +3)

RELOCATED CCDC
PLAYGROUND

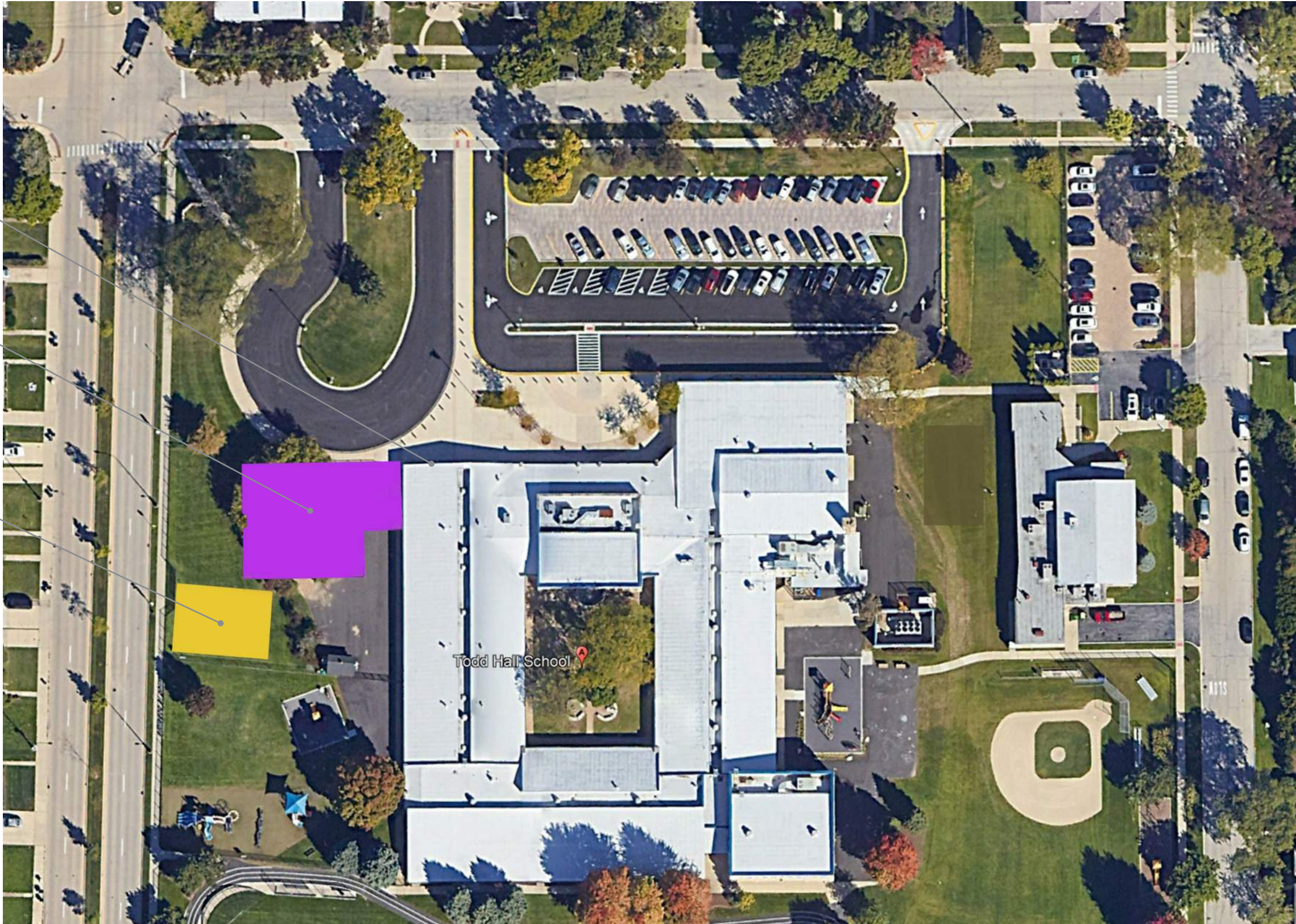

PROPOSED ADDITION

• PARTIAL FLOOR PLAN

- CCDC
- NTDSE ROOMS
- SMALL GROUP/INTERVENTIONIST ROOMS
- SHARED CURRICULUM ROOMS
- STAFF SUPPORT
- BUILDING SUPPORT

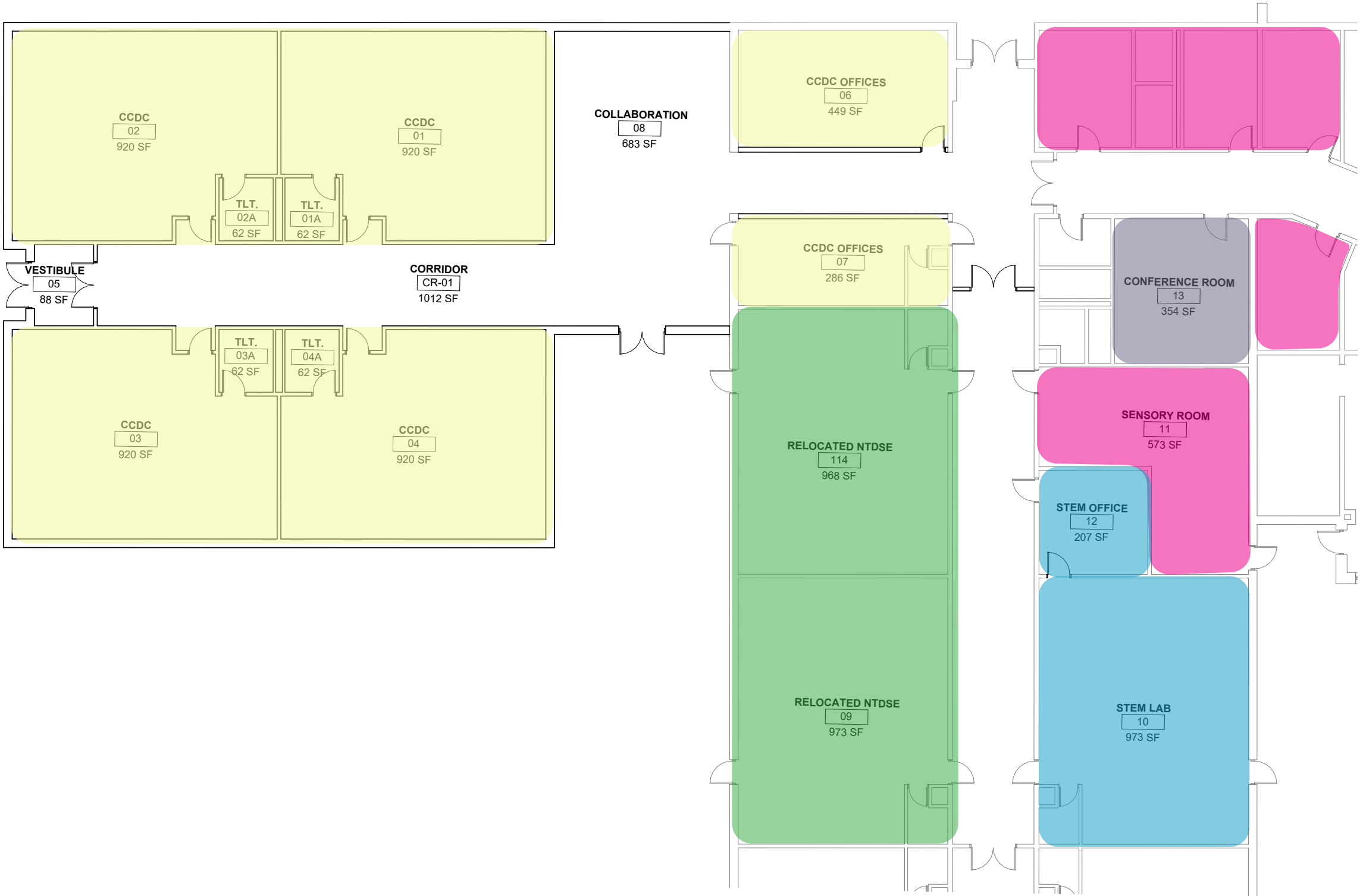

PROPOSED OVERALL PLAN



EXISTING CONDITIONS FOR REFERENCE

EXISTING CONDITIONS

- PRE-K



TYPICAL EXISTING TOILET ROOM TO BE RENOVATED



EXISTING CUBBIES

EXISTING CONDITIONS

- KINDERGARTEN

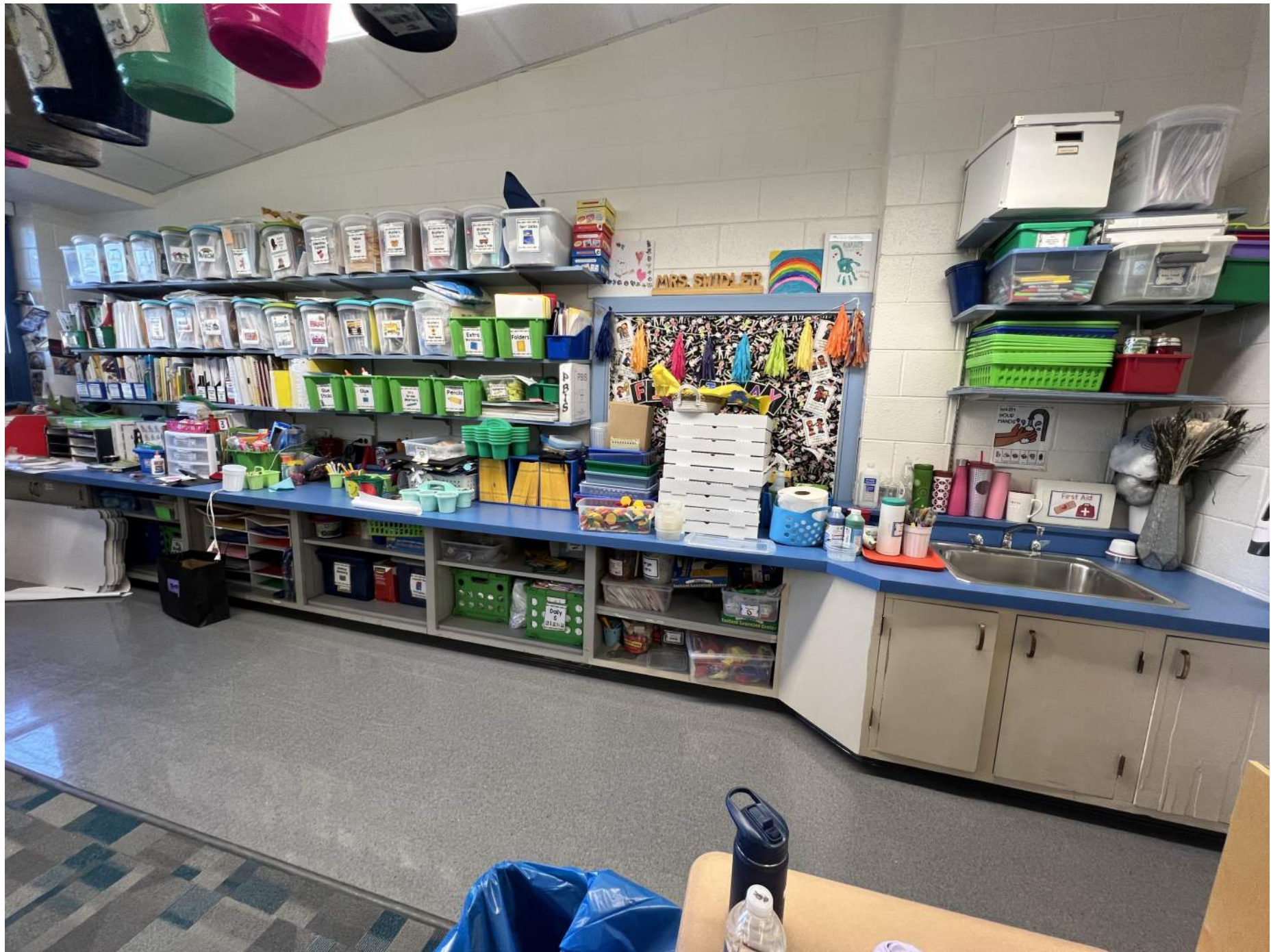

TYPICAL EXISTING CASEWORK AND SINK TO BE REPLACED

EXISTING CONDITIONS

- TYPICAL CLASSROOM C1



TYPICAL EXISTING CLASSROOM STAGE AND CASEWORK

EXISTING CONDITIONS

• TYPICAL CLASSROOM C2

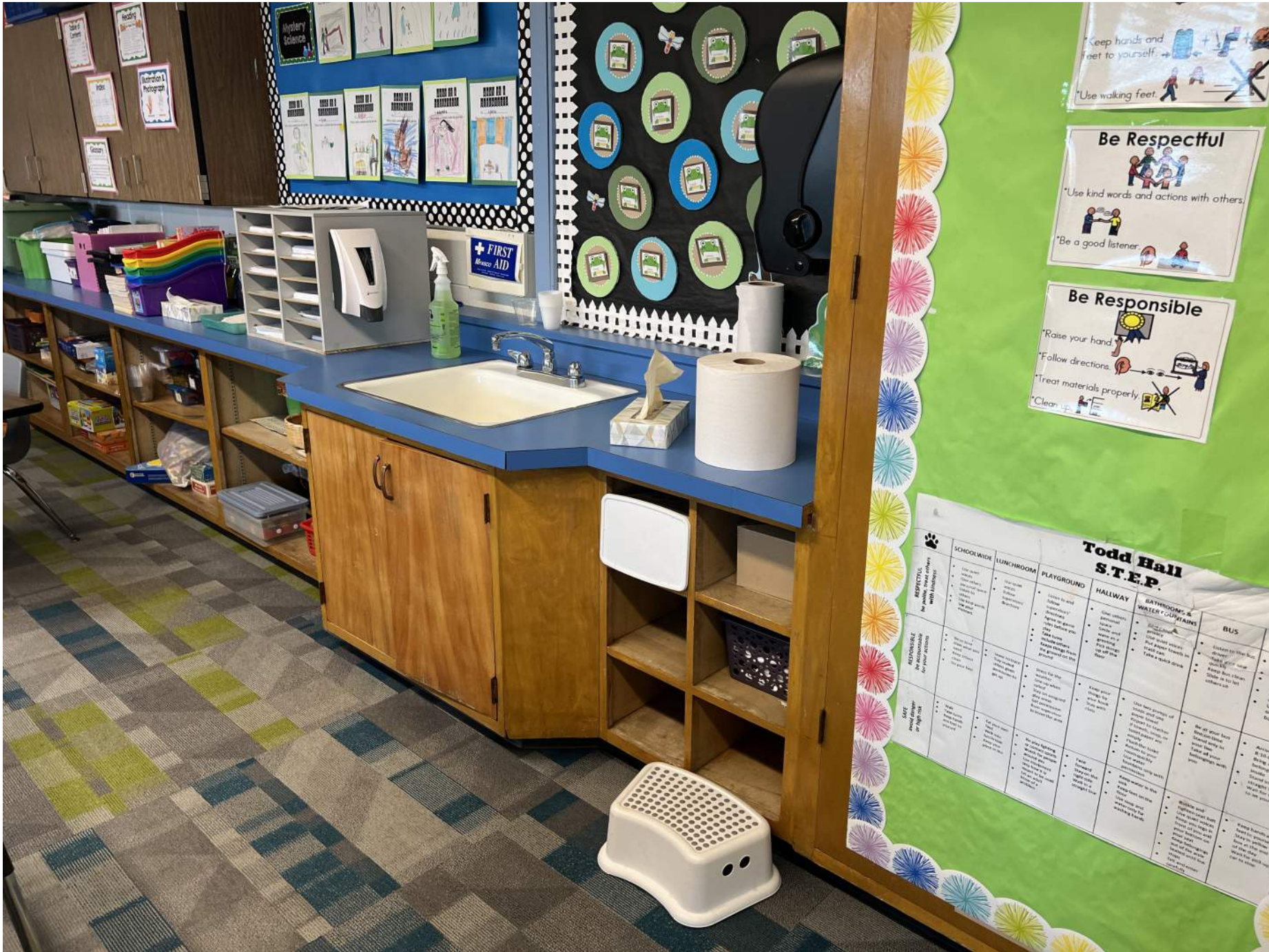

TYPICAL 1ST GRADE, AND (1) 2ND GRADE CLASSROOM SINK AND CASEWORK TO BE REPLACED

EXISTING CONDITIONS

- MUSIC AND ART



EXISTING MUSIC ROOM



EXISTING ART ROOM

EXISTING CONDITIONS

- MPR



EXISTING CONDITIONS

- GYM

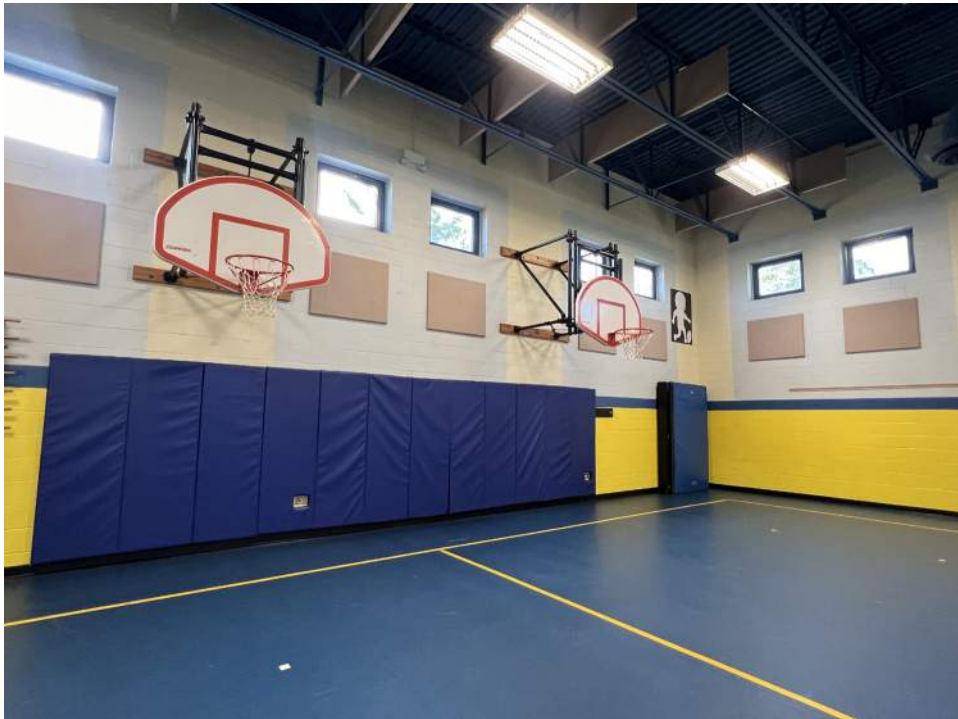

EXISTING CONDITIONS

- STAFF LOUNGE
- STAFF TOILETS



EXISTING STAFF TOILET

THANK YOU!