

**\*EXHIBIT "A"\***  
**Oncor Electric Delivery Co. LLC**

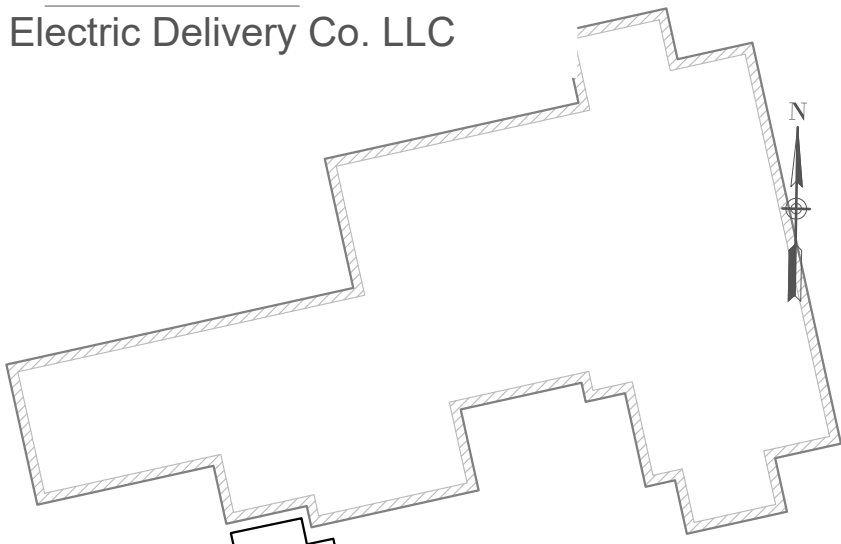

**PROPERTY:** 26556.00010.00000  
**OWNER:** ECISD  
**SITUS ADDRESS:** 1800 E 87TH ST, ODESSA 79765  
**LEGAL DESCRIPTION:** RATLIFF RANCH 38-1 BLOCK 1 LOT 1  
**LEE BUICE ELEMENTARY**  
**ACRES:** 28

**PROPERTY:** 40050.00010.04100

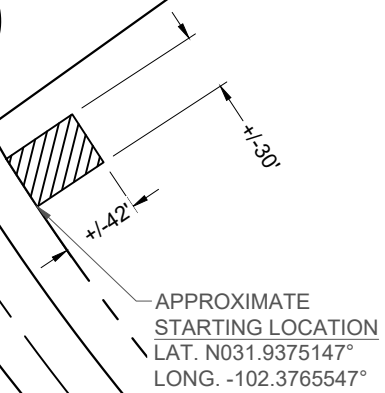

**ONCOR Electric Delivery Co. LLC**  
**Easement Exhibit**

The intent of this Exhibit is for the Grantor to recognize that the general course of said easement area as described above agrees that the easement area and right-of-way and its general dimensions hereby granted shall apply to the location of said line(s) when constructed.

Grantor(s): \_\_\_\_\_

Instrument #: \_\_\_\_\_ Volume: \_\_\_\_\_ Page: \_\_\_\_\_

Survey: T&P RR CO Abstract: 107

City: ODESSA County: ECTOR

WO#: 25433989 District: WEST

**NOT TO SCALE**

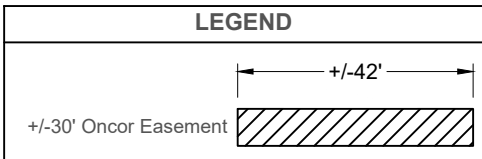

d:\frost C:\pw\_working\powereng\_d\prod\pw\_prod\pw02\0837004\0254730 Continental Resources Chlemeyer.dwg WO WTX Easement (3)