



RANTOUL CITY SCHOOLS
BROADMEADOW-EASTLAWN-NORTHVIEW-PLEASANT ACRES
PREK CENTER - RISE ACADEMY - JW EATER
1 AVIATION CENTER DRIVE, RANTOUL, IL 61866
217.893.5400 - WWW.RCS137.ORG

To: Illinois Department of Transportation, District 5
From: Scott Woods, Superintendent
Date: June 18, 2025
Re: Serious Safety Hazard Finding 2025-4

Beginning with the 2025-2026 school year attendance boundaries for our school district will change, resulting in students living less than 1.5 miles from school but experiencing a serious safety hazard on their regular walking route. For Finding 2025-1, some students who previously attended Broadmeadow Elementary School will now be assigned to Northview Elementary School. This will result in students with a walking route that will require them to cross N Century Blvd (Route 45) as well as walk along W Champaign Avenue (Route 136) under a train track viaduct where the walkway narrows. Because of this we are submitting a Combination Hazard of Type I and Type III.

To determine the Type I, we utilized IDOTs annual average daily traffic count data at the allowable 10% factor. We also contacted the Village of Rantoul to determine the width of the road.

To determine the Type III, we utilized IDOTs annual average daily traffic count data at the allowable 10% factor. We also contacted the Village of Rantoul to determine the width of the road. Additionally, we are making the assumption that students will only cross this road at the intersection of N Century Blvd and W Champaign Avenue where traffic speed is reduced to 35 mph.

Attached is a map showing the affected areas as well as the Serious Safety Hazard Finding form.



Illinois Department of Transportation

Serious Safety Hazard Finding

A publication entitled "School Safety Busing and Instructions for Submitting Findings" is available from the Illinois Department of Transportation, 2300 South Dirksen Parkway, Springfield, Illinois 62764. The school administrator preparing this submittal should refer to the instructions in the booklet.

Two copies of this form are to be submitted to the IDOT District Office indicated in the instruction booklet. The IDOT District Office will approve or disapprove the submittal within thirty (30) days and return one copy to the school district indicating the action taken.

Name of School District Rantoul City Schools				Address of Administrative Office 1 Aviation Center Drive Rantoul, IL 61866	
District # 137	County Champaign	City Rantoul	Zip Code 61866		
Name of Contact Representative Scott Woods			Title Superintendent	Phone Number (217) 893-5400	
Name of School to Which Children Are Walking Northview				Annual Sequential Number (Use on Map and Attachments) 2025-4	

Type of Condition	1. <input type="checkbox"/> Single Hazard	Type
	2. <input checked="" type="checkbox"/> Combination Hazard	Type I and Type III
Location Attach a map showing the described location(s).	3. Along (Street or Road Name) <u>Viaduct on Rt. 136</u>	
	4. <input checked="" type="checkbox"/> Type I	From _____ To _____
	5. Type II	From _____ To _____
	6. Type III	At <u>N Century Blvd (Route 45)</u>
	7. Type IV	At _____

Type I – Walking Along a Roadway

Points Complete only for types listed on lines 1 or 2.	8. Highest qualifying grade level (through <u>8th</u> grade)	<u>5</u>	Points Table 1
	9. Location of walkway walkway (on shoulder _____ feet from roadway) OR (behind curb or ditch <u><4</u> feet from roadway)	<u>2</u>	Points Table 2
	10. Speed of traffic (<u>35</u> mph)	<u>0.5</u>	Points Table 3
	11. Volume of traffic (<u>1270</u> vehicles/hour) (<u>4</u> lanes)	<u>3</u>	Points Table 4
	12. Length of hazardous section (<u>0.2-0.4</u> miles)	<u>0.5</u>	Points Table 5
	13. Board's judgment points (attach explanation)	_____	Points
	14. Total of lines 8 through 13	<u>11</u>	Points

Type II – Walking on a Roadway

15. Highest qualifying grade level (through _____ grade)	_____	Points Table 6
16. Reason for walking on roadway: (No shoulder or walkway off pavement for _____ feet, OR Narrow bridge or underpass for _____ feet)	_____	Points Table 7
17. Speed of traffic (_____ mph)	_____	Points Table 8
18. Volume of traffic (_____ vehicles/hour) (_____ lanes)	_____	Points Table 9
19. Length of hazardous section (_____ miles)	_____	Points Table 10
20. Board's judgment points (attach explanation)	_____	Points
21. Total of lines 15 through 20	_____	Points

**Points
(Continued)**

Type III – Crossing a Roadway (Name of roadway being crossed N Century Blvd (Route 45))

- | | | |
|---|-----------|--------------------|
| 22. Highest qualifying grade level (through <u>8th</u> grade) | <u>5</u> | Points
Table 11 |
| 23. Control on roadway being crossed (<u>Traffic Signals</u>) | <u>2</u> | Points
Table 12 |
| 24. Speed and volume of traffic (<u>35</u> mph) (<u>690</u> vehicles/hour) | <u>2</u> | Points
Table 13 |
| 25. Width of roadway (<u>55</u> feet) | <u>2</u> | Points
Table 14 |
| 26. Board's judgment points (attach explanation) | | Points |
| 27. Total of lines 22 through 26 | <u>11</u> | Points |

Type IV – Crossing Railroad Tracks

- | | | |
|--|--|--------------------|
| 28. Highest qualifying grade level (through _____ grade) | | Points
Table 15 |
| 29. Crossing protection and number of tracks: (_____ protection; _____ tracks used) | | Points
Table 16 |
| 30. Speed and number of trains: (_____ mph; _____ trains) | | Points
Table 17 |
| 31. Board's judgment points (attach explanation) | | Points |
| 32. Total of lines 28 through 31 | | Points |

Finding

33. ☐ Single hazard qualifies since _____ points in a Type _____ situation equals or exceeds 12.
34. ☒ Combination hazard qualifies since the total of 11 points in a Type III situation and 11 points in a Type I situation equals or exceeds 20.
35. ☐ Hazard is temporary for _____ school year (resubmit annually).
36. ☐ No hazard

Certification

I hereby certify that the date in this application, including accompanying maps and statements, are true and correct to the best of my knowledge and belief.

Board approval was given on 06/18/2025 , and the minutes of this meeting bear evidence of this approval.

Date

06/18/2025

Date

Signature of Secretary or President of Board of Education
or Board of Directors

Action by Illinois Department of Transportation

Date Submittal Received _____, 20 _____

Serial No. _____

☐ Approved

☐ Disapproved for corrections, additions, or clarifications noted in transmittal letter.

☐ Disapproved for reason or reasons noted in transmittal letter.

Date

Signature of IDOT Regional Engineer

Reimbursement Estimate (This information will have no effect on IDOT's action on the submittal.)

1. Approximately how many students will annually be qualified for busing by this submittal that did not previously qualify for reimbursable busing? _____ students

2. What is the projected additional annual reimbursement that will result from this submittal? \$ _____

2025-4

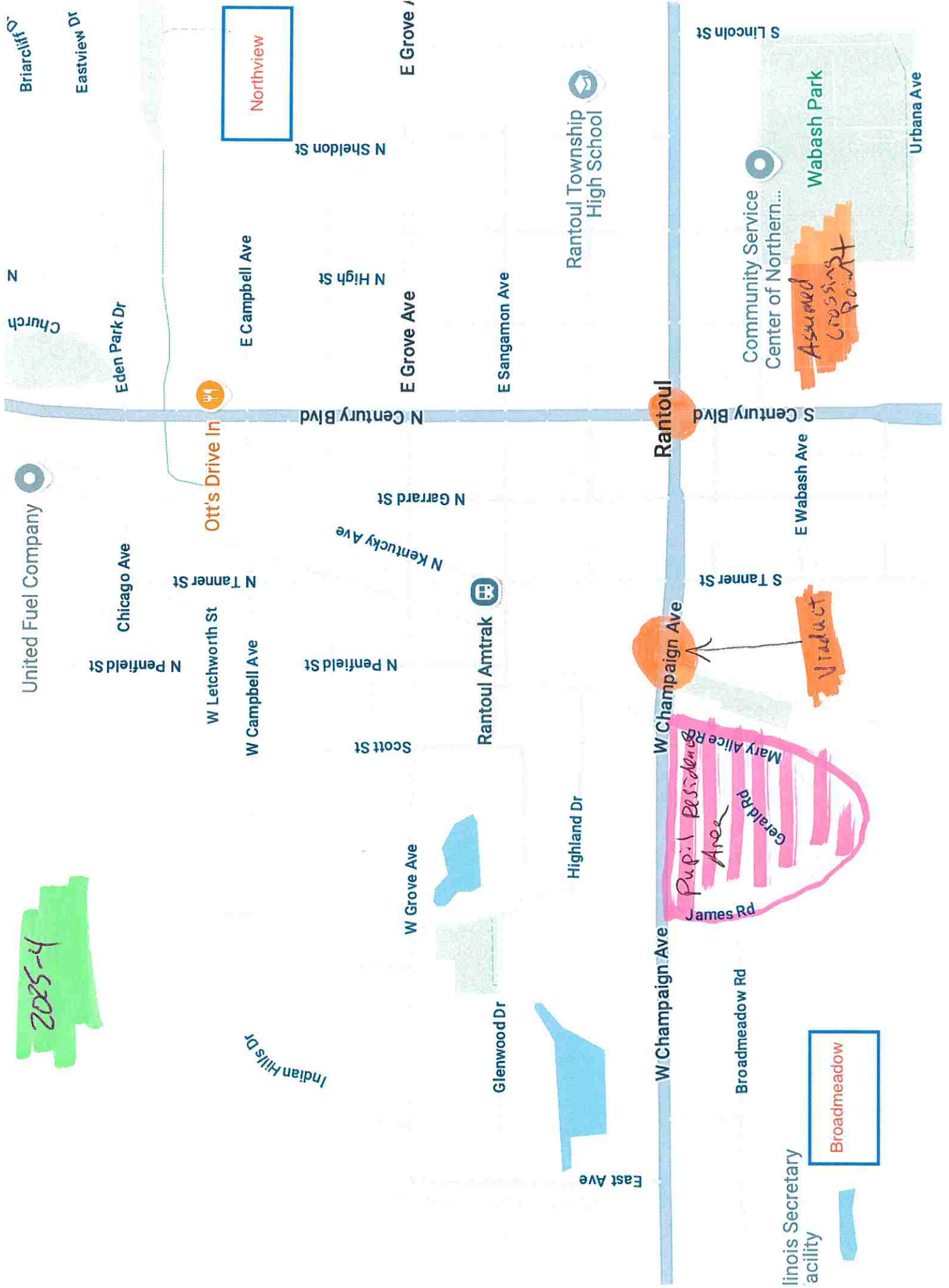

Broadmeadow

Illinois Secretary's Facility

Rantoul

W Champaign Ave

W Champaign Ave

S Century Blvd

Rantoul Township High School

Rantoul Amtrak

Indian Hills Dr

W Grove Ave

Glenwood Dr

Highland Dr

Scott St

N Penfield St

N Kentucky Ave

N Garrard St

N Tanner St

W Letchworth St

W Campbell Ave

Chicago Ave

N Penfield St

Eden Park Dr

E Campbell Ave

N High St

E Grove Ave

E Sangamon Ave

E Grove Ave

N Sheldon St

Northview

Eastview Dr

N

Church

Briarcliff Dr

S Lincoln St

Community Service Center of Northern...

Wabash Park

Urbana Ave

Broadmeadow Rd

Pupil Residence Area

Assumed Crossing Point

Viaduct

Broadmeadow