

MANSFIELD INDEPENDENT SCHOOL  
DISTRICT  
EARLY LEARNERS ACADEMY #2

December 10th, 2024

# SCHEMATIC DESIGN PRESENTATION



PROCESS	01
ACKNOWLEDGMENTS	02
PLANNING	03
PRECEDENT IMAGERY	04
SITE PLAN	05
SITE PLAN ANALYSIS	06
FLOOR PLAN	
07 ENLARGED POD	
PLAN 08 EXTERIOR	
IMAGERY	09
SCHEDULE	10

# Journey of Pre-K in MISD



**Huckabee**

MANSFIELD INDEPENDENT SCHOOL DISTRICT EARLY LEARNERS  
ACADEMY #2

PROCES  
S

# The Research about READING

## SCARBOROUGH'S READING ROPE

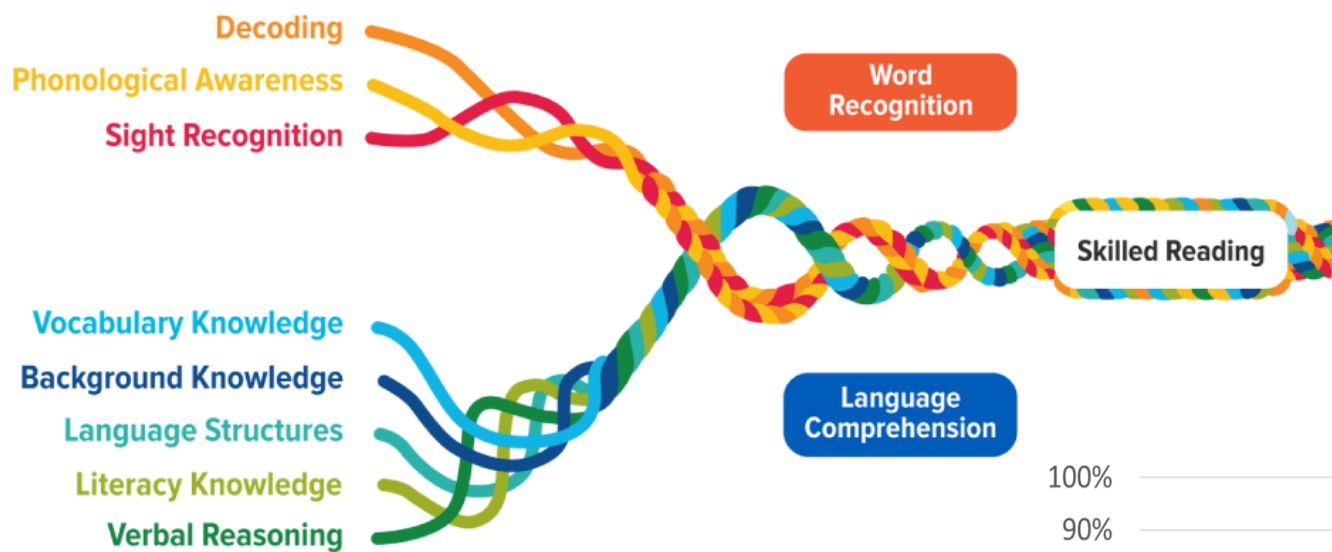

By age three, children from low-income families may hear **30 million** fewer words than their more affluent peers.

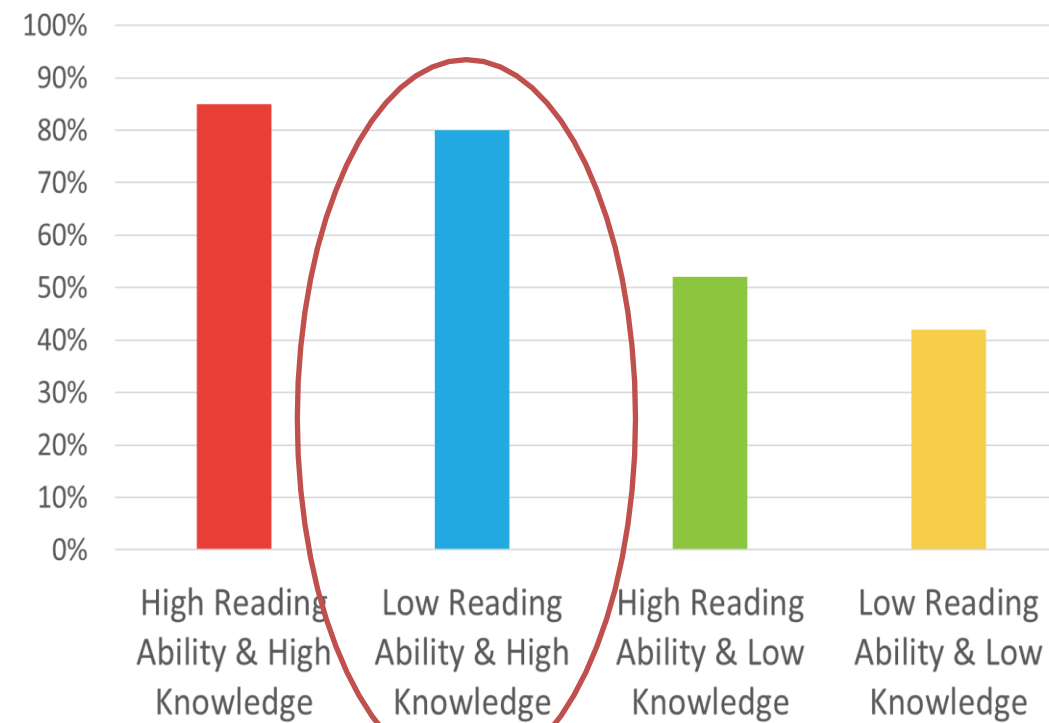

## The Science of Teaching Reading



**Huckabee**

MANSFIELD INDEPENDENT SCHOOL DISTRICT EARLY LEARNERS ACADEMY #2

PROCES  
S

# The Research about ENVIRONMENT

“During the primary years, real world experiences are the most important thing schools provide. As we all know, children *learn by doing*. They remember what they have personally experienced. In addition, concept development is optimized through *active, explorative experiences*.”

Nabors, Edwards, Murray, 2009



90%  
of a child's brain  
development  
happens before  
age 5

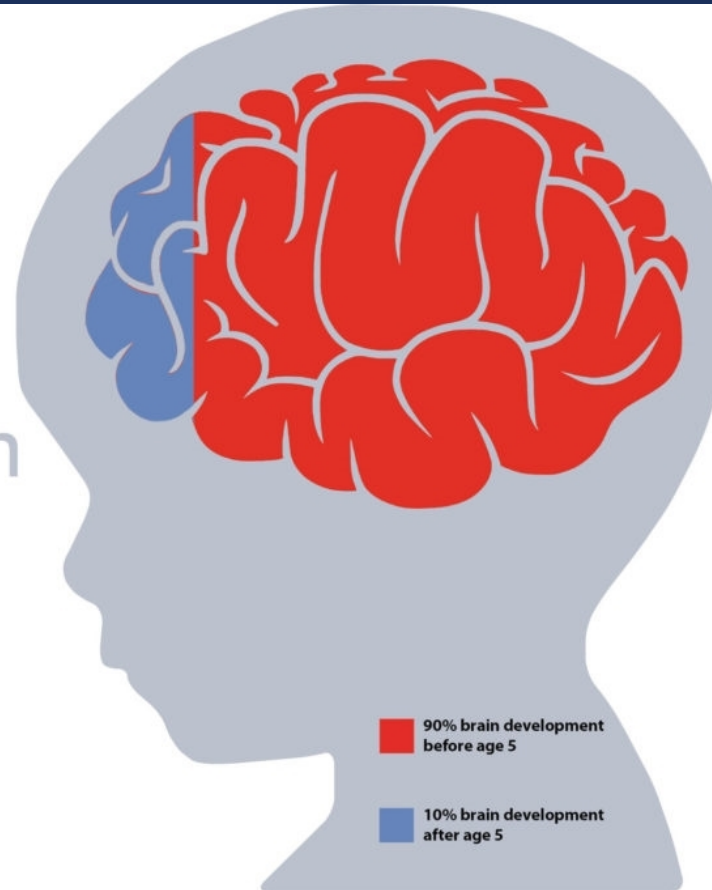

\$1



INVESTED IN EARLY  
CHILDHOOD YIELDS A  
**\$16 RETURN**

**INCREASED**

- High School Graduation
- College Matriculation
- Economic Development  
& Personal Income

**DECREASED**

- Special Education/Remediation
- Dependence on Social Welfare
- Crime-related Costs &  
Incarceration Rates

“Early childhood education is the **KEY** to the betterment of society.”

*Maria Montessori*

# 2021-2022 Cohort Data

## Jandrucko Cohort (2021-2022) – Kinder BOY Literacy Rates (Fall 2022)

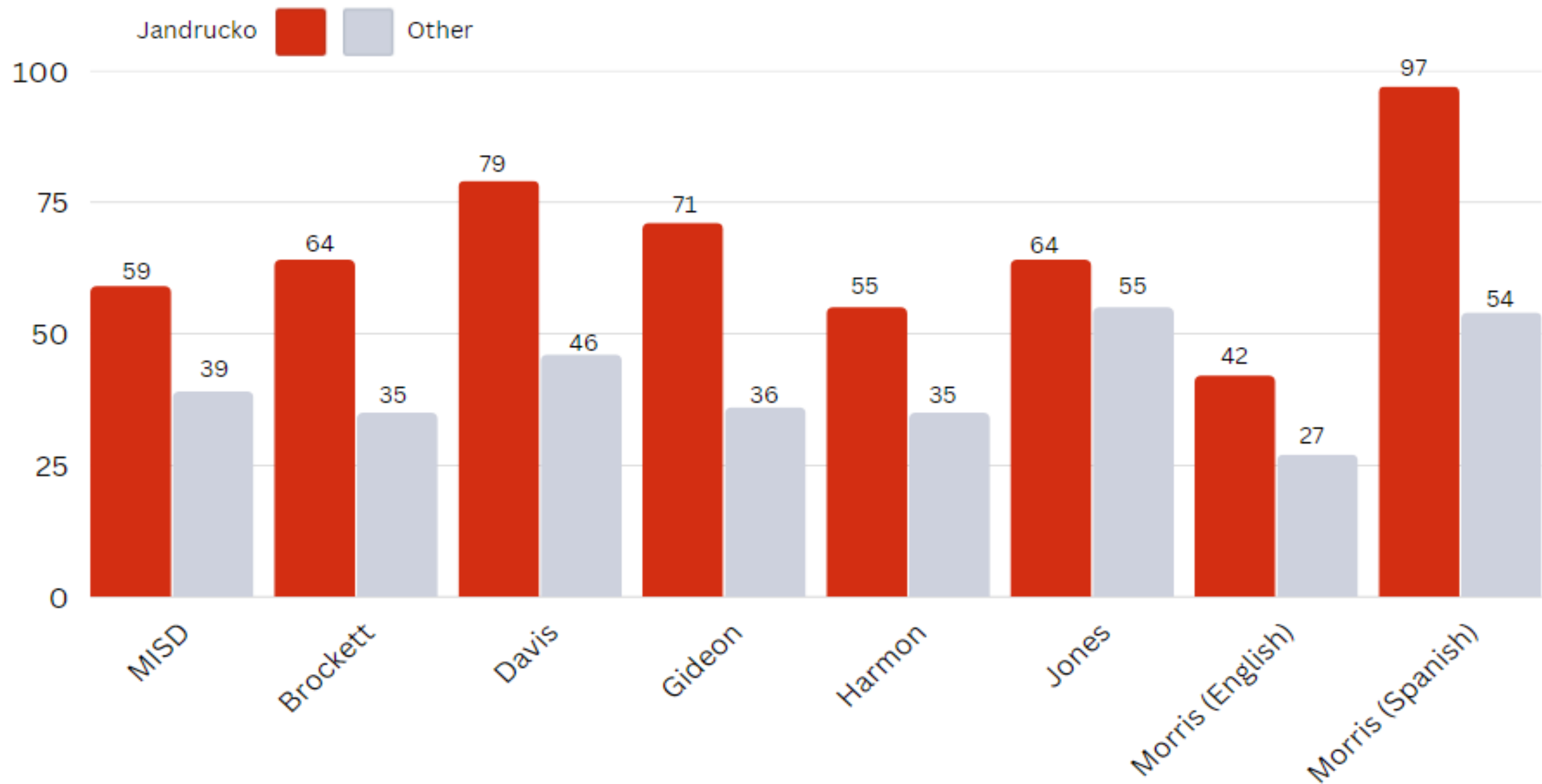

# 2022-2023 Cohort Data

## Jandrucko Cohort (2022-2023) – Kinder BOY Literacy Rates (Fall 2023)

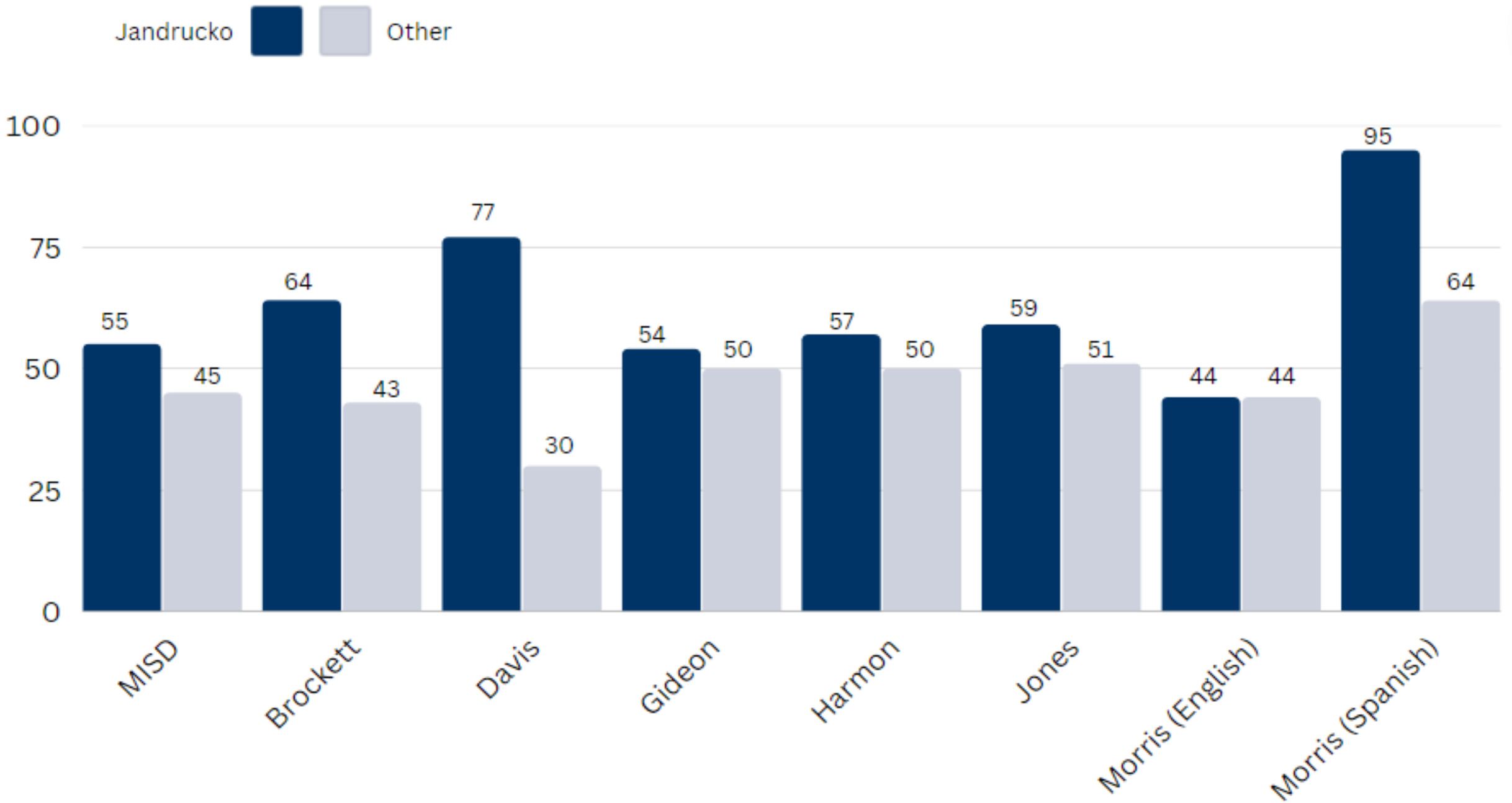





# MANSFIELD INDEPENDENT SCHOOL DISTRICT EARLY LEARNERS ACADEMY #2



**Huckabee**

MANSFIELD INDEPENDENT SCHOOL DISTRICT EARLY LEARNERS  
ACADEMY #2

ACKNOWLEDGMENT  
TS

# EARLY CHILDHOOD INSTRUCTIONAL/DESIGN APPROACHES

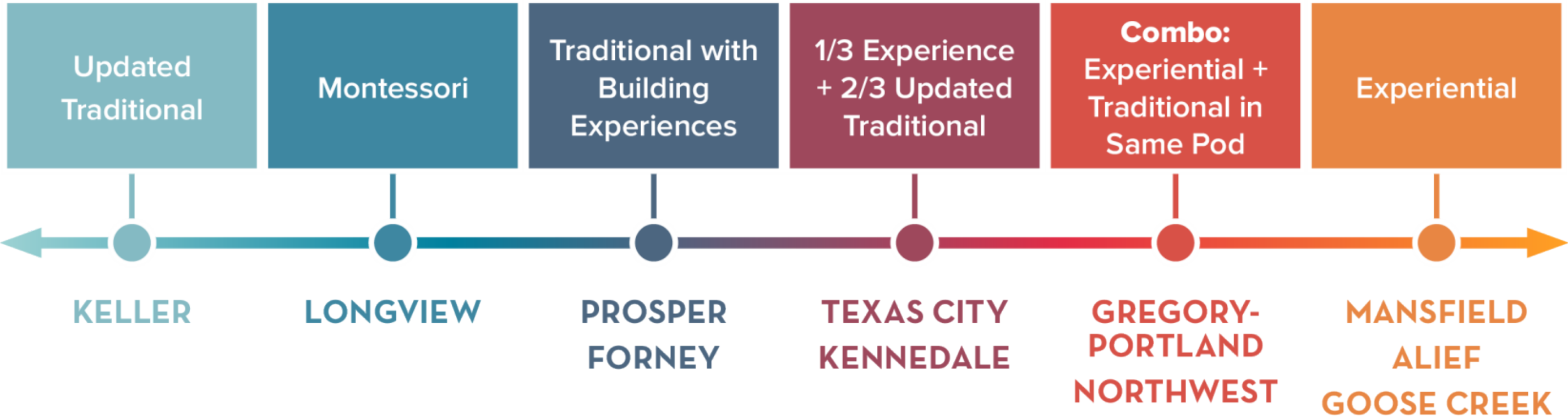

# Gregory Portland ISD ECC



# What Do You Want to ... ?

## See



## Hear

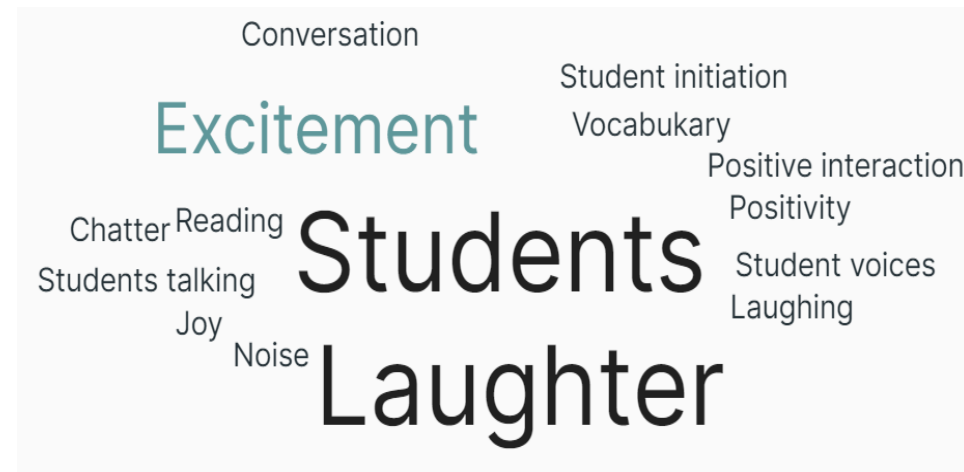

## Feel



## Do

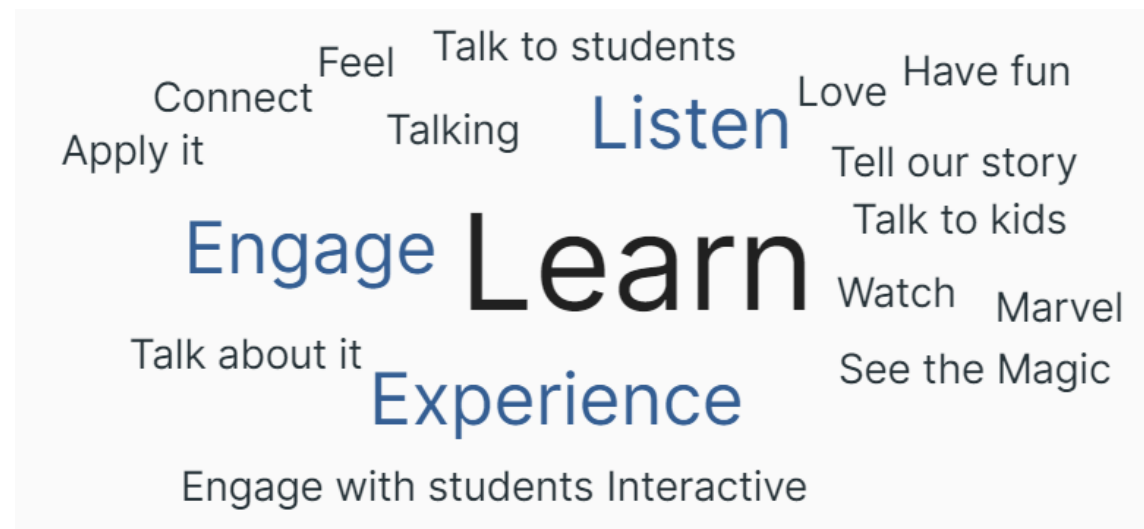

## Think

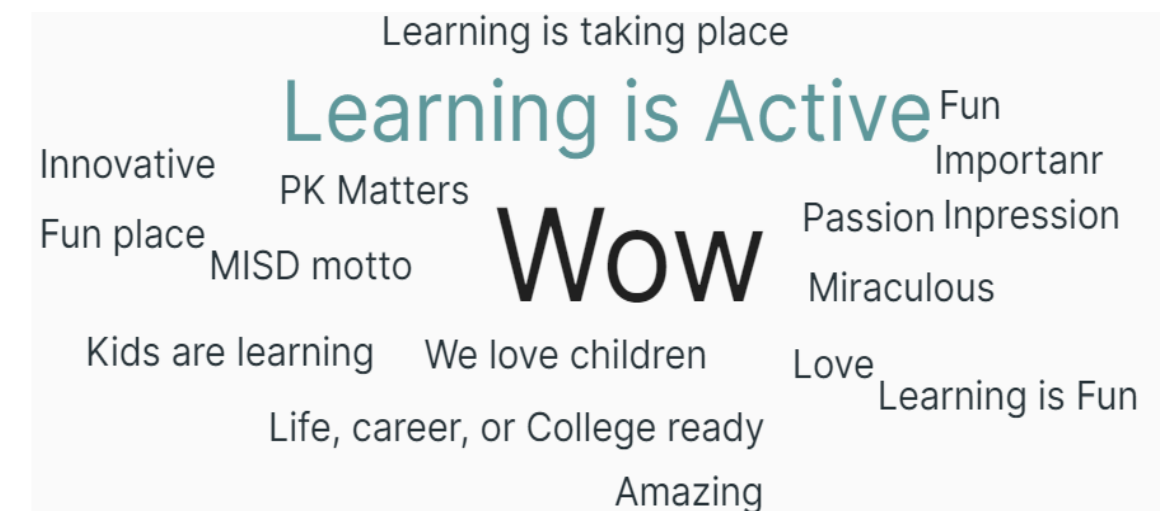

# Customer Requirements

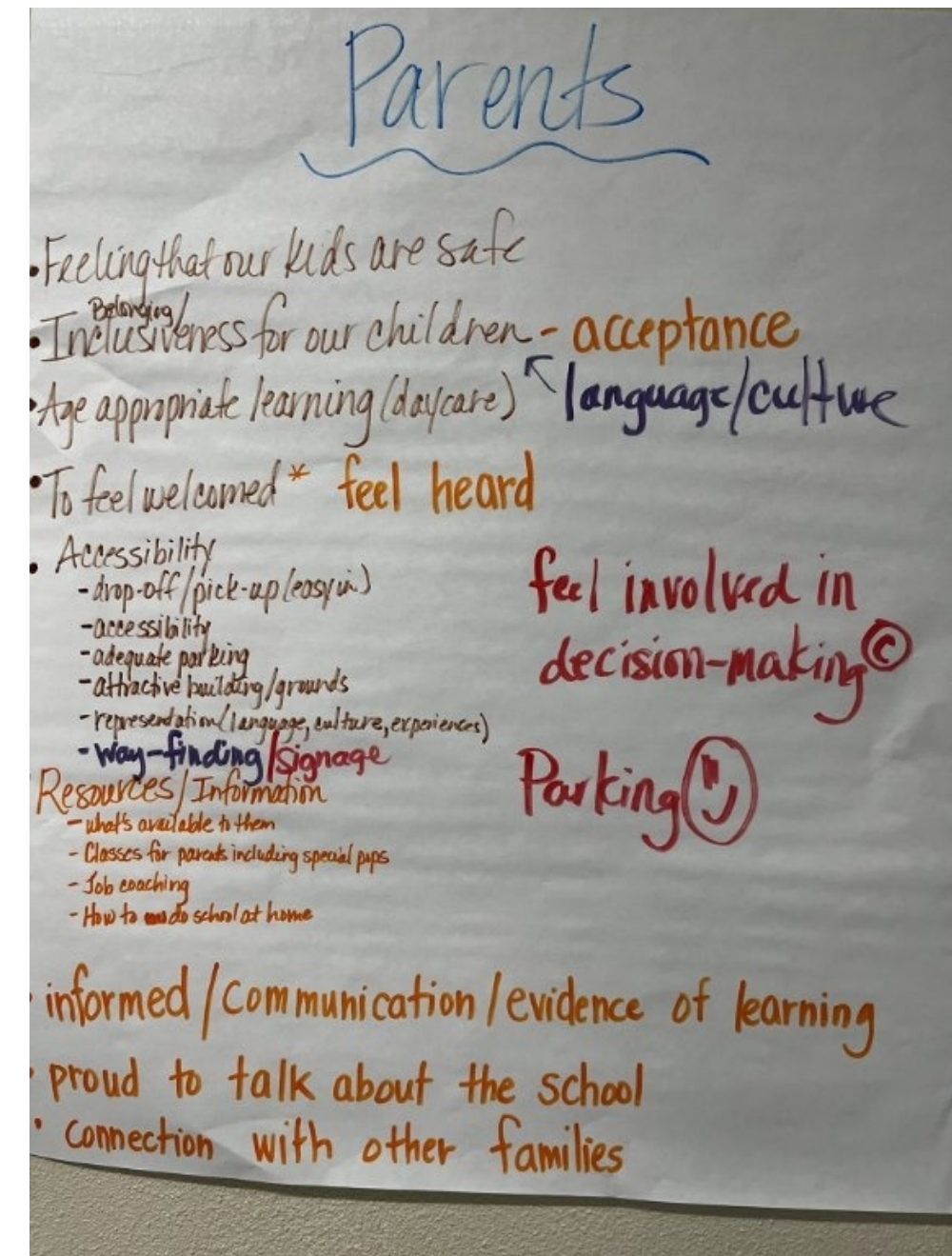
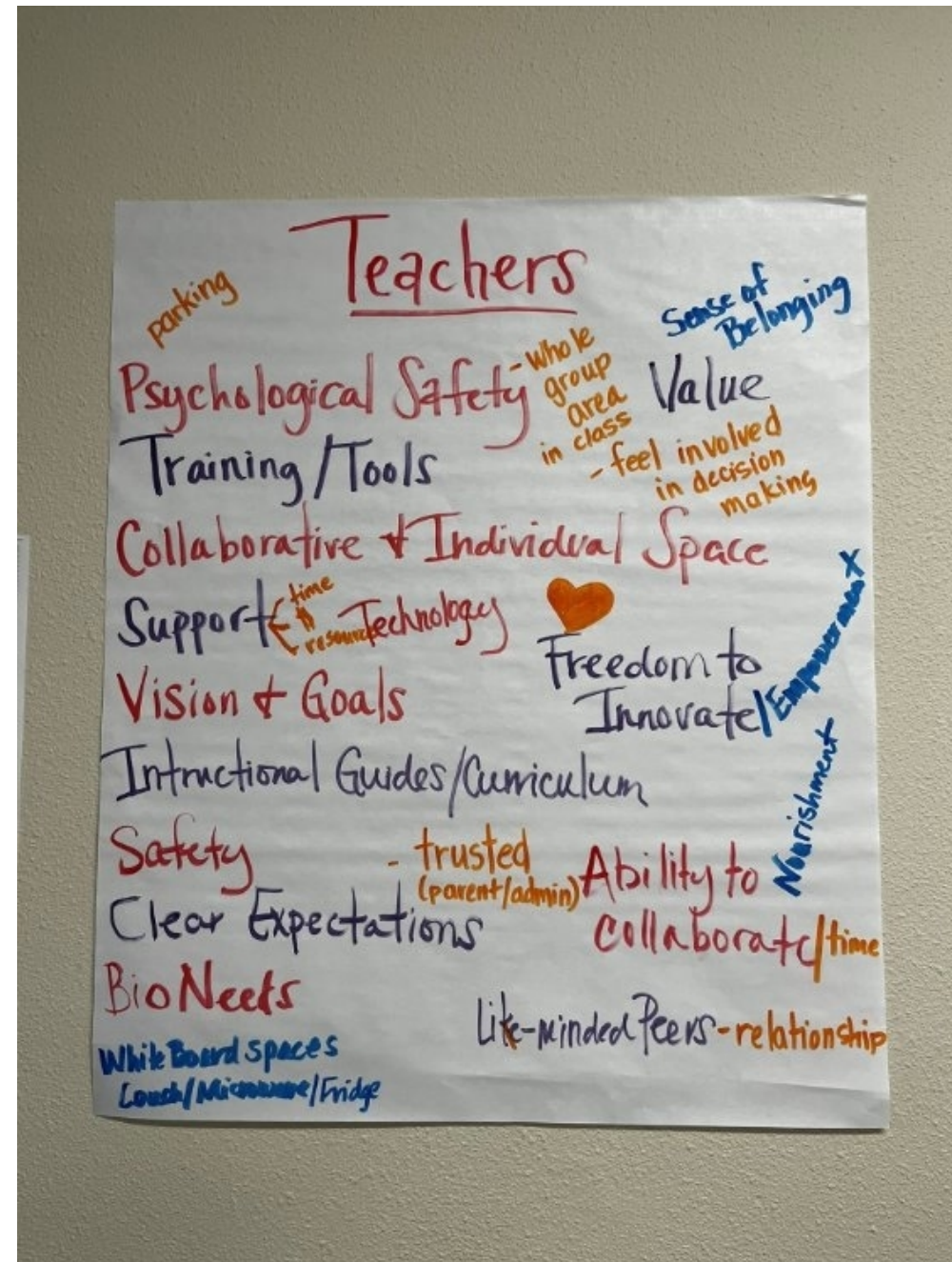
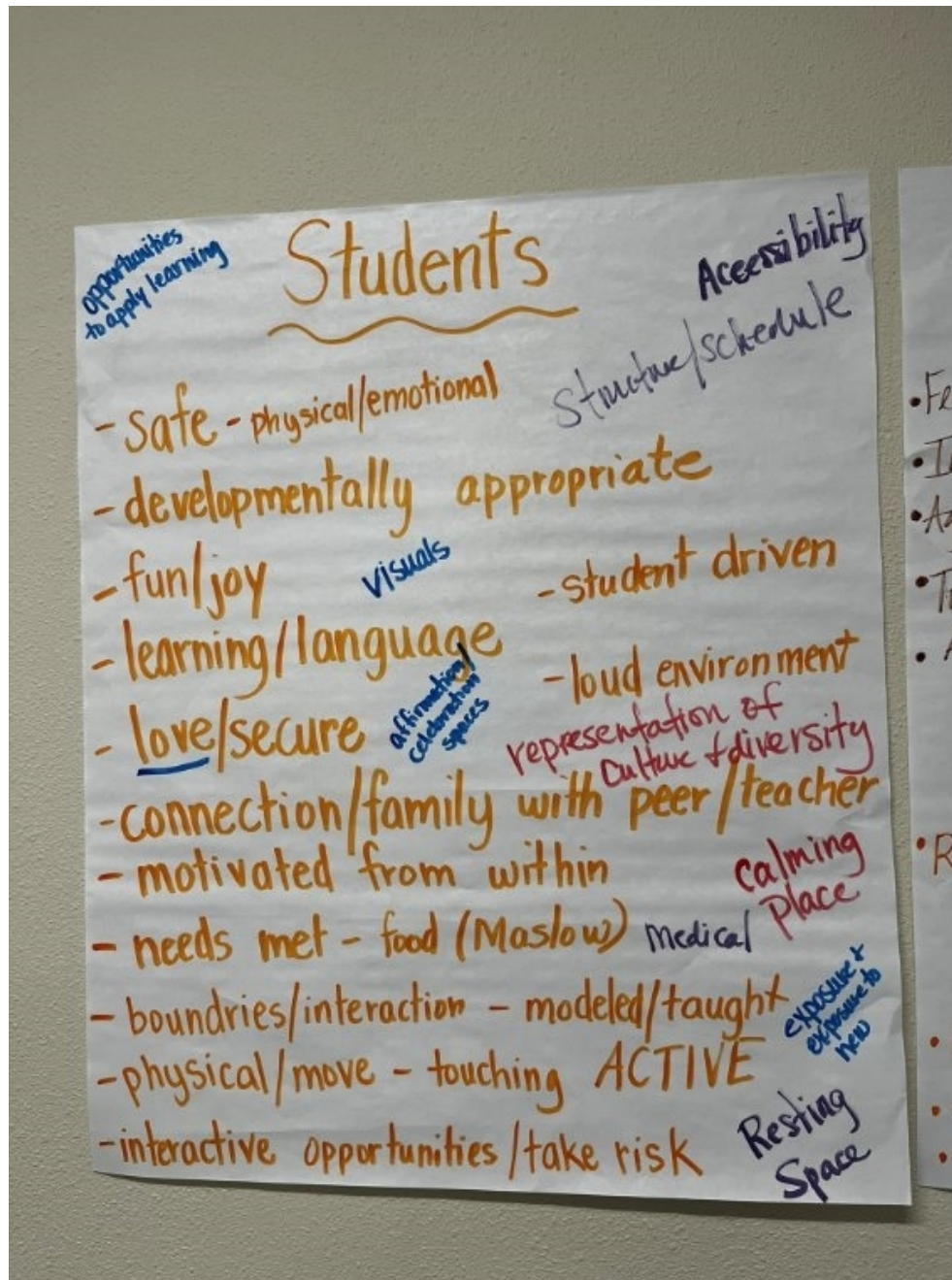

# The Charrette

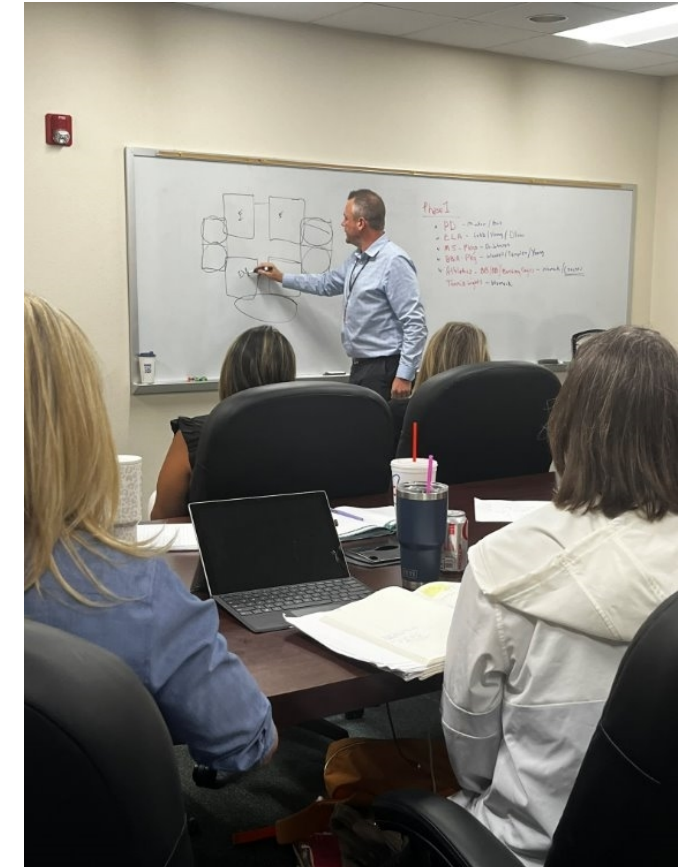
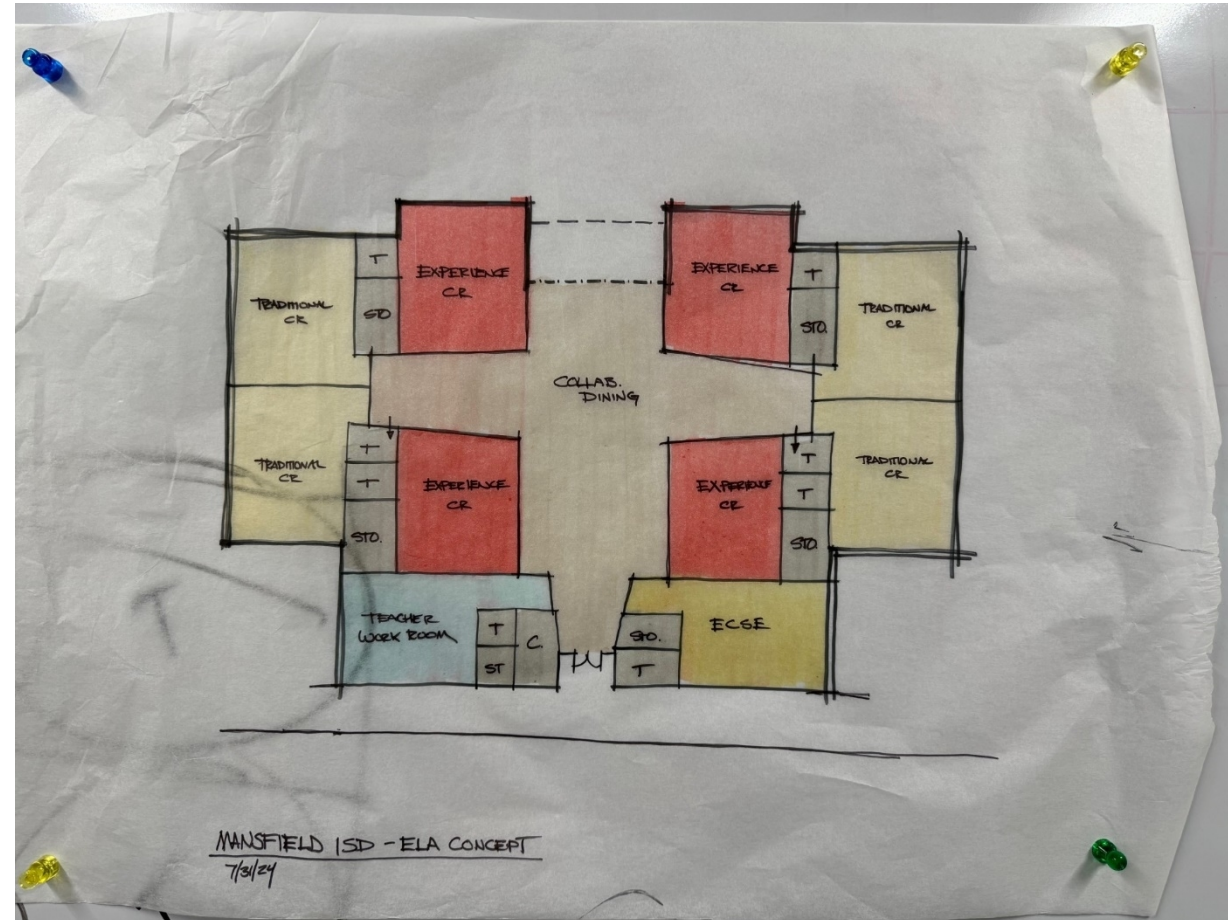
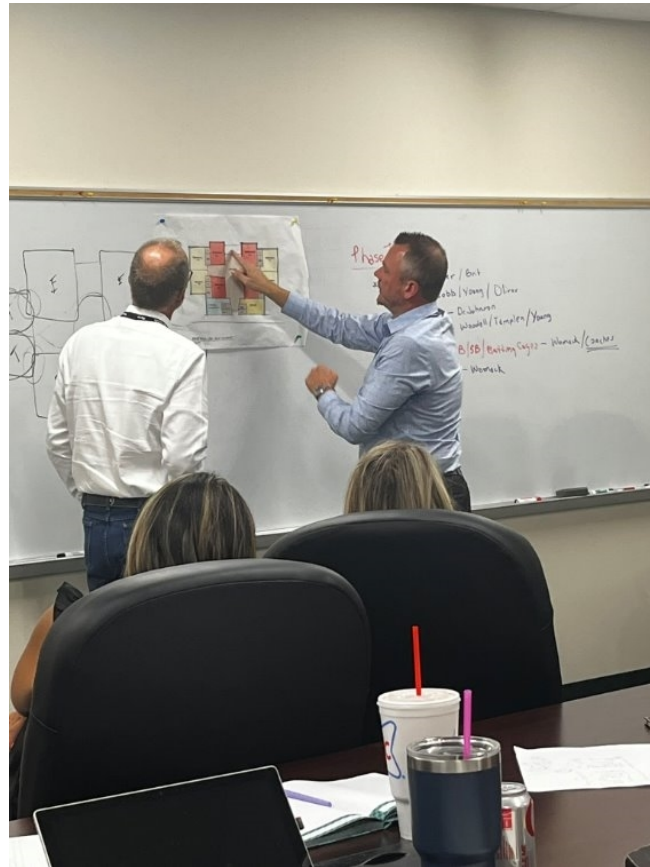

# Academy for Early Learners 2.0



## KEEP

- 16 experiences
- Family-style dining
- Transparency
- No teacher desks or chairs
- Picture rich environment
- Common space in pods
- SEL space / room
- Daycare
- Pod storage
- Adult restrooms in pod
- Magnetic / whiteboard in each experience
- Wayfinding
- Limited student seating
- Adult learning area
- Student restroom in rooms
- ECSE room with restroom
- Activity center / gym
- Outdoor space
- Laundry



## TOSS

- Indoor entry to adult learning
- Receptionist opening
- Outdoor space for pods
- Hard keys
- Isolated ESCE
- Separated teacher space
- Small parking lot
- Arrival / dismissal areas
- Placement of structures in the middle of the room
- Portable wall in children's center

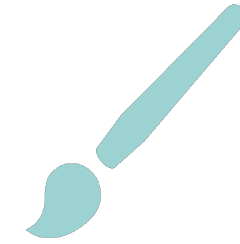

## CREATE

- Adult learning with opening to the outside
- Animal storage / structures
- Enclosed playground
- Shade / cover in drop off area
- ECSE in pods
- Add traditional rooms
- Add child find area for SPED space
- Communal restrooms
- Interactive panel in gym
- Motor lab staff
- Climbing wall
- Restroom close to playground
- Acoustic treatment in gym
- Nap mat storage
- Centrally located kitchen
- Electronic shades for nap
- Restructure office space

## PURPOSE + OBJECTIVES

The campus is a pioneering space where innovation meets education to provide unique and unforgettable experiences. Students engage in literacy and numeracy through creative active exploration.



The design will promote joy in learning through explorative experiences.



The building will promote engaging, safe spaces and be an inviting atmosphere for joy in learning and teaching.



The building will provide a secure environment that creates a safe space for learning.



The campus will provide a culture of joyful teaching and learning.





MANSFIELD INDEPENDENT SCHOOL DISTRICT  
EARLY LEARNERS ACADEMY #2

DINOSAUR



AQUARIUM



MARKET



ZOO



**Huckabee**

MANSFIELD INDEPENDENT SCHOOL DISTRICT EARLY LEARNERS  
ACADEMY #2

PRECEDENT  
IMAGERY



# MANSFIELD INDEPENDENT SCHOOL DISTRICT

## EARLY LEARNERS ACADEMY #2



### COLOR LEGEND

- Pavement/Roads
- Sidewalks
- Grass
- Buildings

- Parent Access
- School Bus
- Access Daycare

- Access
- 1 MAIN ENTRY
  - 2 PARENT DROP-OFF
  - 3 DAYCARE DROP-OFF
  - 4 OFF
  - 5 BUS DROP-OFF AND SERVICE ENTRANCE
  - 6 VISITOR PARKING
  - 7 STAFF PARKING
  - 8 DAYCARE
  - 9 PLAYGROUND
- ADDITIONAL PARKING





MANSFIELD INDEPENDENT SCHOOL  
DISTRICT  
EARLY LEARNERS ACADEMY #2

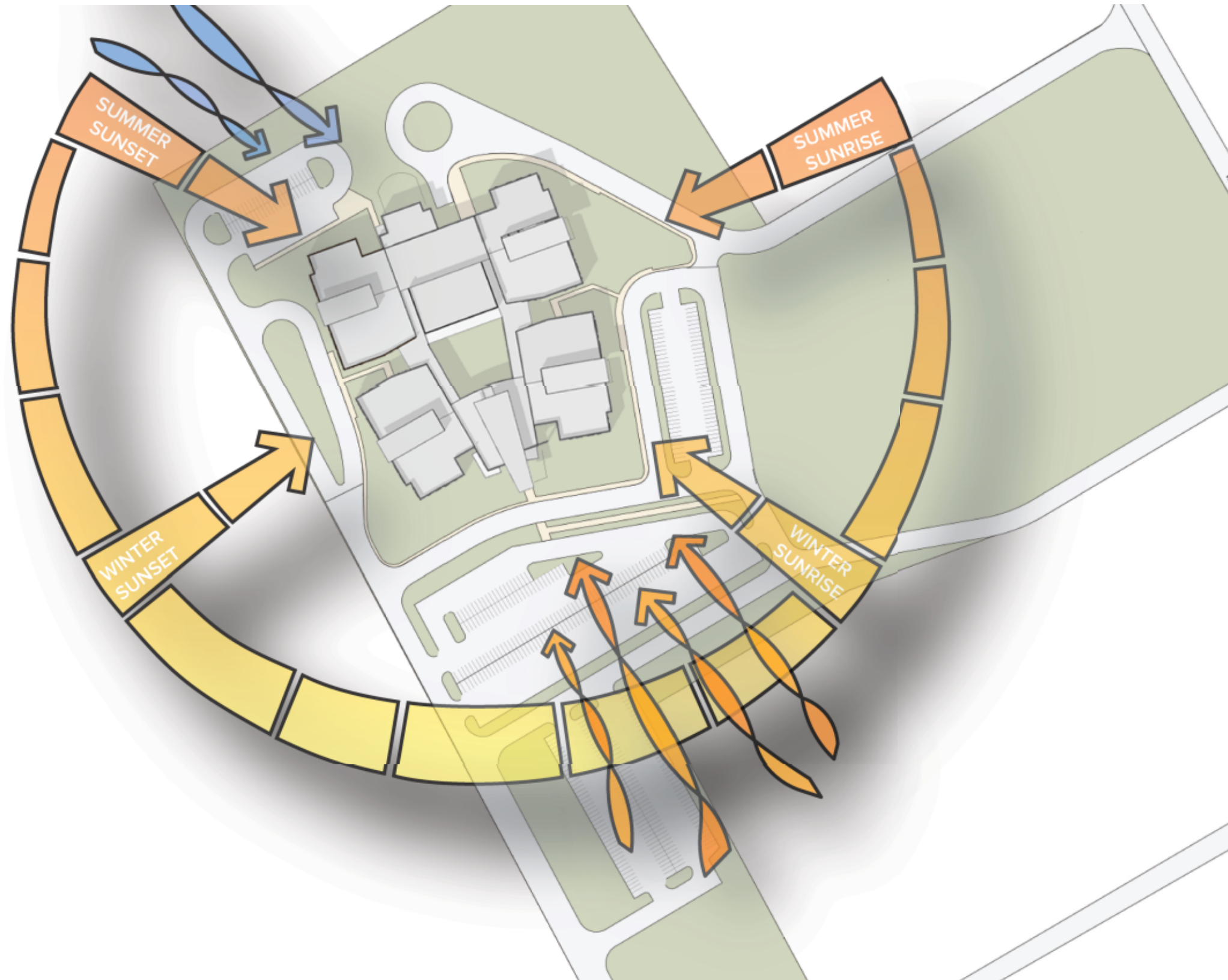



**MANSFIELD INDEPENDENT SCHOOL DISTRICT**  
**EARLY LEARNERS ACADEMY #2**

**COLOR LEGEND**

- Administration
- Administration Support
- Academic
- Academic
- Interactive
- Academic Support
- Kitchen
- Activity
- Activity
- Support
- Daycare
- Daycare
- Support
- Circulation
- Restrooms/ Support Spaces





MANSFIELD INDEPENDENT SCHOOL DISTRICT  
EARLY LEARNERS ACADEMY #2

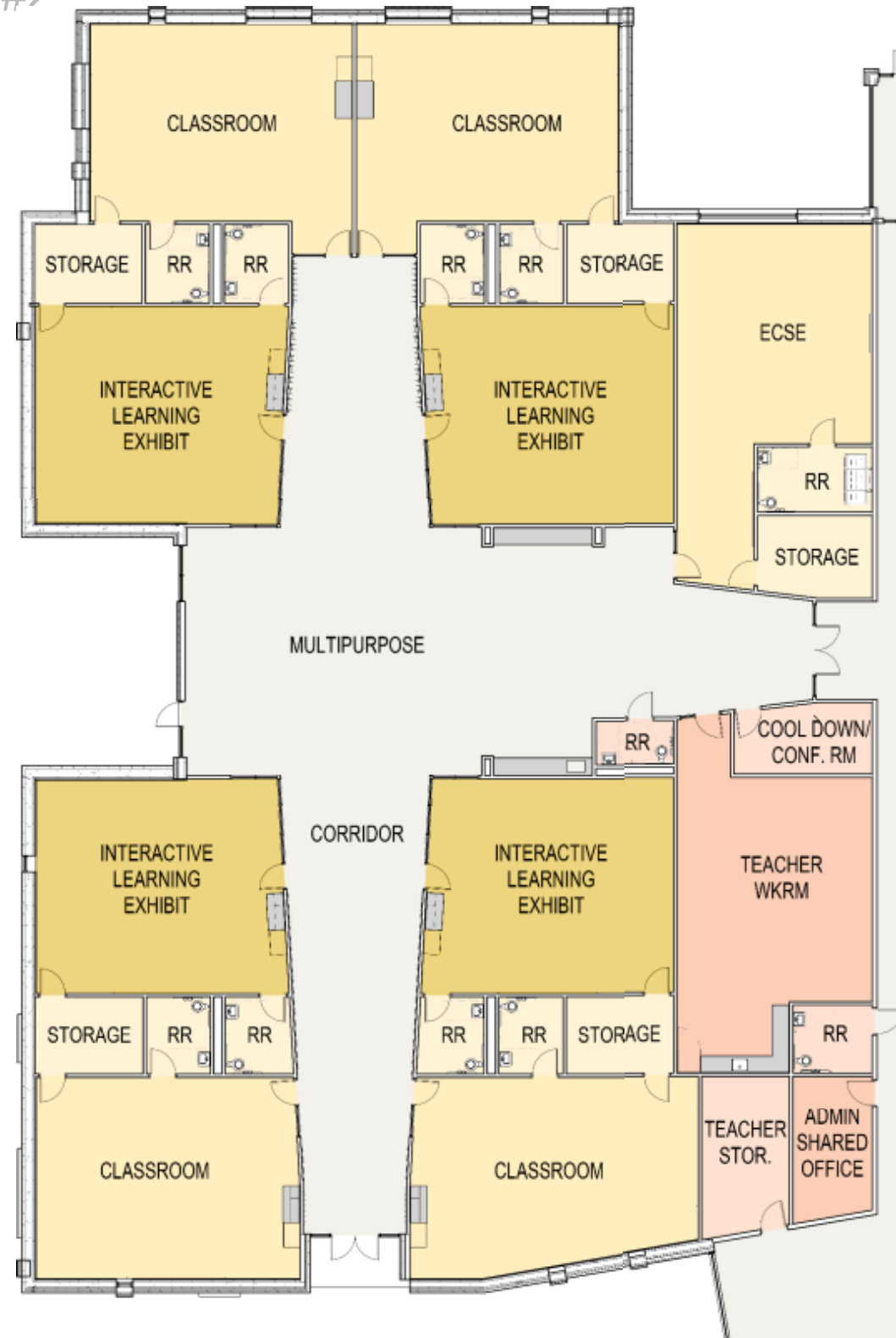

COLOR

- Administration
- Administration Support
- Academic
- Academic
- Interactive
- Academic Support
- Circulation
- Restrooms/ Support Spaces



MANSFIELD INDEPENDENT SCHOOL  
DISTRICT  
EARLY LEARNERS ACADEMY #2





**MANSFIELD INDEPENDENT SCHOOL DISTRICT**  
**EARLY LEARNERS ACADEMY #2**

PROJECT DATES
Schematic Design
Design Development
Construction Documents
Jurisdictional Review
Bid Proposal
Construction

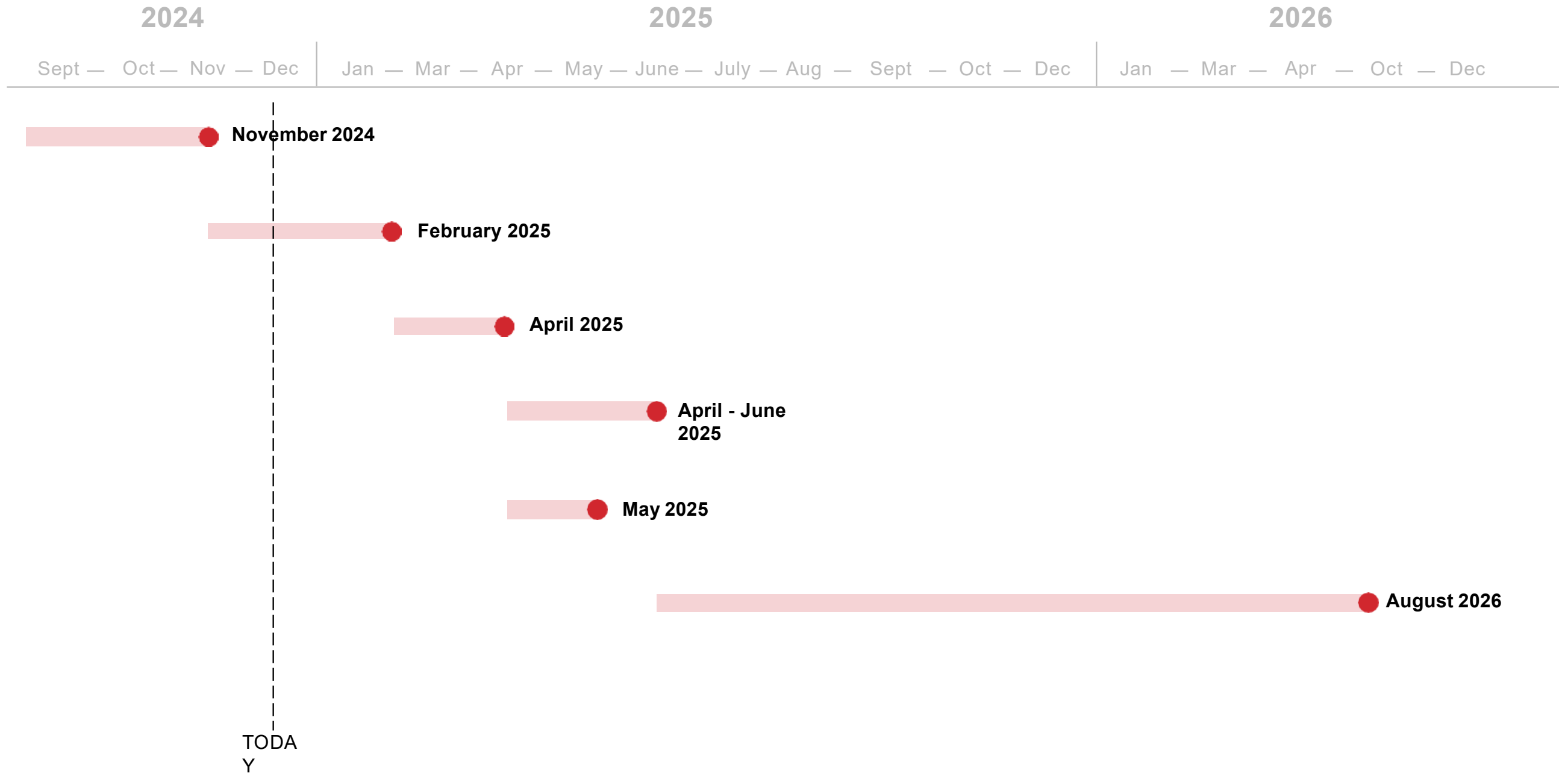

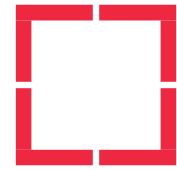

**MORE THAN** ARCHITECTS